

(Fact Sheet Begins Next)

## Act Now to Continue Receiving Information About This Site!

DEC's Division of Environmental Remediation (DER) now distributes information about contaminated sites *electronically by email*.

If you would like to continue to receive information about the contaminated site featured in this fact sheet:

**You must sign up for the DER email listserv:**

[www.dec.ny.gov/chemical/61092.html](http://www.dec.ny.gov/chemical/61092.html)

DER cannot register your email address - only the email address owner can do so. If you already have signed up for the listserv for the county in which the site is located, you need do nothing.

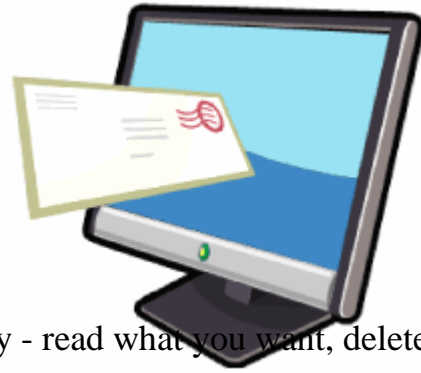

### **Why You Should Go “Paperless”:**

Get site information faster and share it easily;

Receive information about all sites in a chosen county - read what you want, delete the rest;

It helps the environment and stretches your tax dollars.

**If “paperless” is not an option for you**, call or write to the DER project manager identified in this fact sheet. Indicate that you need to receive paper copies of fact sheets through the Postal Service. Include the site name in your correspondence. The option to receive paper is available to individuals only. Groups, organizations, businesses, and government entities are assumed to have email access.

This page intentionally left blank.



FACT SHEET Voluntary Cleanup Program

Receive Site Fact Sheets by Email. See "For More Information" to Learn How.

Site Name: RG&E Geneseo-Park St Manufactured Gas Plant (MGP)
DEC Site #: V00731
Address: 4 and 6 Park St
Geneseo, NY 14454

Have questions? See "Who to Contact" Below

Site Investigation Completed and Cleanup Proposed for RG&E Geneseo Park St. Site; Public Comments Accepted

The New York State Department of Environmental Conservation (NYSDEC) has released a proposed cleanup plan for the former RG&E Geneseo-Park St Manufactured Gas Plant (MGP) site ("site") located at 4 and 6 Park Street, Geneseo, Livingston County. Please see the map on Figure 1 for the site location. Documents related to the cleanup of this site can be found at the location(s) identified below under "Where to Find Information."

The NYSDEC accepted the "Site Characterization Report," dated May 2016 and submitted by Rochester Gas & Electric Corporation ("volunteer") for the site. The report describes the results and recommends development of a remedy. The proposed cleanup plan is described in the "Alternatives Analysis Letter Report," dated July 2016, submitted to the NYSDEC by the volunteer.

How to Comment

NYSDEC is accepting written comments about the proposed plan for 30 days, from September 30, 2016 through October 30, 2016. The proposed plan is available for public review at the location(s) identified below under "Where to Find Information." Please submit comments to the NYSDEC project manager listed under Project Related Questions in the "Who to Contact" area below.

Elements of the Proposed Remedy

The proposed remedy was developed by the volunteer after performing a detailed investigation of the site under the NYSDEC's oversight. The proposed remedy consists of:

- 1. Groundwater monitoring using the existing monitoring well network to monitor dissolved concentrations of MGP-related contaminants identified in groundwater at the site. One additional monitoring well would be installed to expand the monitoring well network and delineate contaminant concentrations in groundwater.
2. Development and implementation of a Site Management Plan which would include:
- further investigation and, if necessary, further remediation if site redevelopment occurs;
- an excavation plan to manage future excavations;
- evaluation of the potential for soil vapor intrusion for future buildings developed on the site;
- preparation and submittal of a periodic certification of institutional controls to the NYSDEC;
and
- a Monitoring Plan to assess conditions at the site. This plan would include, but may not be limited to, monitoring of coal tar and groundwater, including a schedule and frequency, and monitoring of vapor intrusion of any new buildings developed on the site.

3. Placement of a deed restriction on the property to limit use to commercial (to non-residential uses, such as the present parking lot) which also allows for industrial uses, as permitted by local zoning. The use of groundwater as a source of potable or process water would require the necessary water quality treatment and compliance with an approved site management plan.

#### *Summary of the Investigation*

The Geneseo Gas Light Company (a predecessor company to RG&E) owned and operated the former MGP, which produced coal gas at the site. Byproducts of this process, which remain on-site, include coal tar, low levels of volatile organic compounds (VOCs), semi-volatile organic compounds (SVOCs), and metals.

An removal action was completed at the site in September 2002, after SUNY acquired the 4 and 6 Park Street properties and began activities to build a parking lot. During final preparation for paving, a stone/brick containment structure was encountered approximately four feet below ground surface (bgs). The structure contained a black tarry material. The structure, liquid material inside and outside the structure, and visually impacted soil surrounding the structure were excavated and disposed of off-site. The final excavation depth was 20 feet bgs, terminating at the top of fractured bedrock. An area near the center of the excavation was excavated an additional five feet into fractured bedrock to approximately 25 feet bgs. The approximate location of the coal tar structure and the area limits of the excavation are shown on Figure 2. In January 2003, excavation activities were terminated and it was later determined that because the Geneseo Gas Light Company was one of its predecessor companies, RG&E was responsible for any additional investigation and remediation at the site related to the former MGP. RG&E entered into an agreement with SUNY in June 2010 to address contamination at the site.

Observations of MGP material during the current investigation of the site were limited to trace oil-like material observed in bedrock fractures while drilling a monitoring well at the site.

Soil analytical data collected at the site was compared to the soil cleanup objectives (SCOs) for commercial use. SCOs are concentrations of individual chemicals for a specific site that must be achieved for a site's current, intended, or reasonably anticipated future use, included unrestricted residential, restricted-residential, commercial, and industrial uses.

Soil data collected at the site indicate that VOCs, SVOCs, and metals were detected at concentrations greater than the SCOs for unrestricted use; however, only SVOCs and metals were detected above SCOs for commercial use. SVOC impacts were identified at depths ranging from 5 to 14 feet bgs in areas north and west of the former IRM excavation area. Metal contaminants detected at concentrations exceeding the soil cleanup objectives for commercial use include arsenic and cyanide. Each metal was detected above its commercial use SCO in one boring location each, at depths of 5 to 7 and 9 to 11 feet bgs, respectively.

Groundwater at the site contains VOCs at levels slightly exceeding the groundwater standards. Additionally, coal tar was detected at a thickness of 0.4 feet in a well located just west of the IRM excavation area.

Soil vapor samples were collected adjacent to the exterior of the State University of New York (SUNY) Brodie Fine Arts Building and in the vicinity of the former MGP structures to evaluate the presence of soil vapors and the potential for soil vapor intrusion into current SUNY buildings. The results indicated there is no concern for vapor intrusion related to MGP contamination into the on-site buildings.

## Next Steps

NYSDEC will consider public comments, revise the plan as necessary, and issue a final Decision Document. New York State Department of Health (NYSDOH) must concur with the proposed remedy. After approval, the proposed remedy becomes the selected remedy. The remedy will be revised as needed to describe the selected remedy, and will be made available to the public. The volunteer(s) may then design and perform the cleanup action to address the site contamination, with oversight by NYSDEC and NYSDOH.

NYSDEC will keep the public informed throughout the investigation and cleanup of the site.

## Background

**Location:** The Park Street former MGP site, was owned and operated by Geneseo Gas Light Company, and is located at 6 Park Street in the Village of Geneseo, Livingston County, New York. The former gas works operations covered approximately  $\frac{3}{4}$  of an acre that was located on what is now the eastern side of the SUNY Geneseo campus.

**Site Features:** Most of the area occupied by the former MGP is either paved or located under buildings. The eastern portion of the site is a paved parking lot, and the western portion is covered by a campus access road, buildings, and small landscaped area.

**Current Zoning and Land Use:** The site is currently owned by SUNY and is a campus entrance that includes a small landscaped area and a parking lot. The site is zoned for residential use (R-1).

### Past Use of the Site:

A manufactured gas plant operated at the site from 1860 through 1906. The Plant operated as a coal carbonization facility. Other subsequent uses include a paint shop, electric generating plant and a hardware store.

### Site Geology and Hydrogeology:

Drilling completed at the site indicates fill material at the site varies from less than two feet bgs to nine feet bgs and is generally observed to be thicker near former MGP structures. Beneath the fill is a medium to very dense till unit with varying amounts of clay and gravel from approximately two to 14.5 feet bgs. Bedrock at the site is shale with a weathered bedrock surface observed from approximately eight to 18.5 feet bgs. The depth to groundwater at the site is approximately 10 to 15 feet bgs. Groundwater flows west-northwest, in the direction of the Genesee River.

Additional site details, including environmental and health assessment summaries, are available on NYSDEC's website at:

<http://www.dec.ny.gov/cfmx/extapps/derexternal/haz/details.cfm?pageid=3&progno=V00731>

**Voluntary Cleanup Program:** New York's Voluntary Cleanup Program (VCP) was developed to encourage private sector volunteers to investigate and clean up contaminated properties and return these sites to productive use. Once cleaned up, the properties may be redeveloped for commercial, industrial, residential or public use.

For more information about the VCP, visit: <http://www.dec.ny.gov/chemical/8442.html>

## FOR MORE INFORMATION

### Where to Find Information

Project documents are available at the following location(s) to help the public stay informed.

Wadsworth Library  
Attn: Anna Grace, Director  
24 Center Street  
Geneseo, NY 14454  
phone: (585) 243-0440

New York State Department of Environmental Conservation  
Attn: Ms. Linda Vera  
6274 East Avon-Lima Road  
Avon, NY 14414  
phone: (585) 226-5324

### Who to Contact

Comments and questions are always welcome and should be directed as follows:

#### Project Related Questions

Sarah Saucier  
NYS Department of Environmental Conservation  
Division of Environmental Remediation  
625 Broadway  
Albany, NY 12233-7014  
518-402-9675  
sarah.saucier@dec.ny.gov

#### Site-Related Health Questions

Anthony Peretta  
New York State Department of Health  
Bureau of Environmental Exposure Investigation  
Empire State Plaza, Corning Tower, Room 1787  
Albany, NY 12237  
518-402-7860  
BEEI@health.ny.gov

**We encourage you to share this fact sheet with neighbors and tenants, and/or post this fact sheet in a prominent area of your building for others to see.**

#### **Receive Site Fact Sheets by Email**

Have site information such as this fact sheet sent right to your email inbox. NYSDEC invites you to sign up with one or more contaminated sites county email listservs available at the following web page: <http://www.dec.ny.gov/chemical/61092.html>. It's quick, it's free, and it will help keep you *better informed*.

As a listserv member, you will periodically receive site-related information/announcements for all contaminated sites in the county(ies) you select.

Note: Please disregard if you already have signed up and received this fact sheet electronically.





Source: Esri, Digital Globe, GeoEye, Earthstar Geographics, CNES/Airbus DS, USDA, USGS, AeroGRID, IGN, IGP, swisstopo, and the GIS User Community

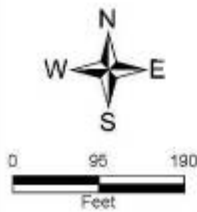

**Figure 1**  
**Site Map**  
Park Street Former MGP Site  
Geneseo, Genesee County  
Site No. V00731



NO. 1080 10/11/16  
 PROJECT NO. 1602001001  
 DATE: 10/11/16  
 SHEET: 2 OF 2  
 DRAWN BY: J.M.S.  
 CHECKED BY: J.M.S.  
 SCALE: 1"=50'-0"

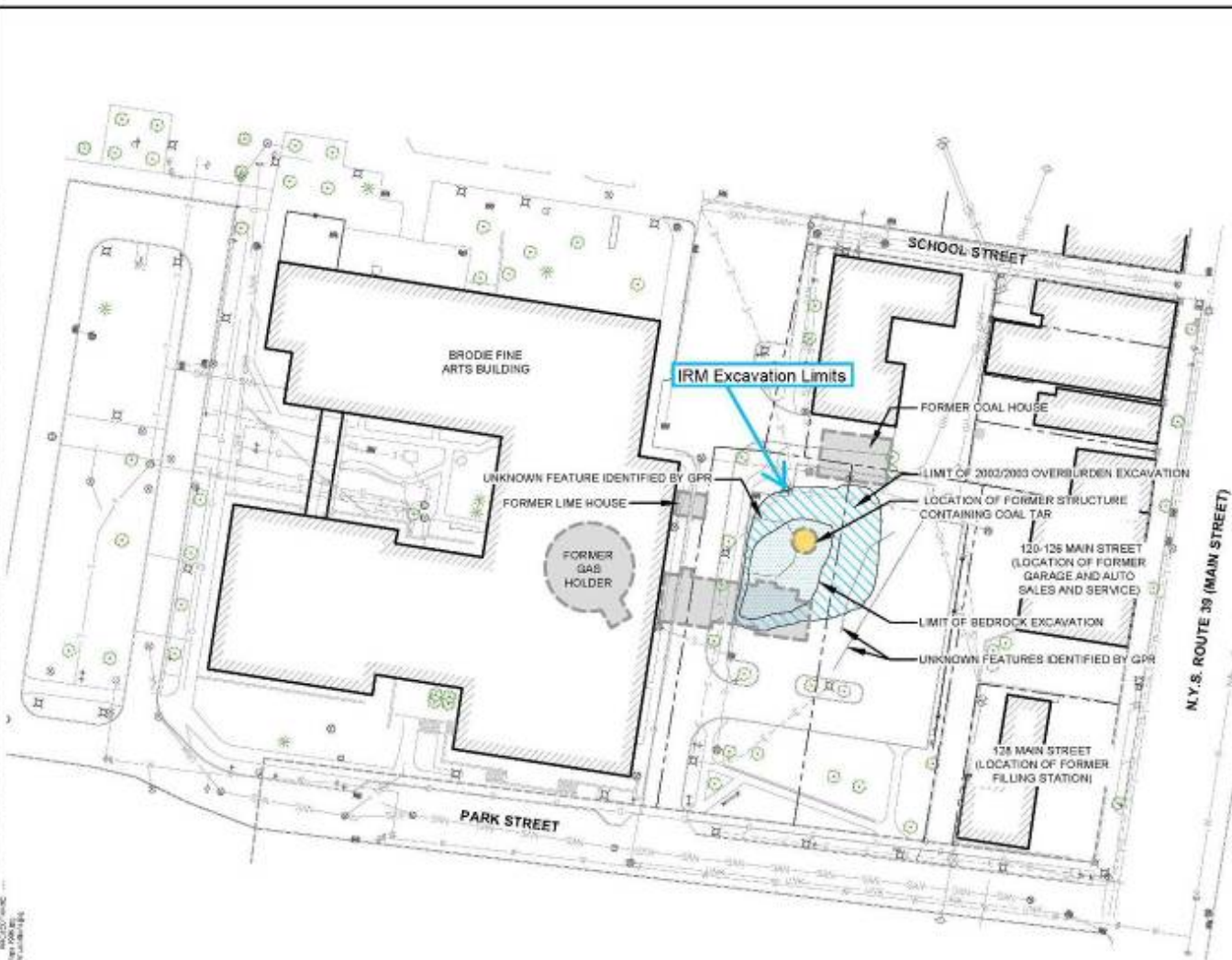

**LEGEND:**

	PROPERTY LINE
	RIGHT-OF-WAY LINE
	BUILDING LINE
	FENCE LINE
	VEGETATION
	SANITARY SEWER LINE
	STORM SEWER LINE
	WATER LINE
	OVERHEAD ELECTRIC LINE
	UNDERGROUND ELECTRIC LINE
	NATURAL GAS LINE
	OVERHEAD TELEPHONE & CABLE LINE
	TELEPHONE & CABLE LINE
	UNKNOWN UTILITY
	FORMER MGP STRUCTURE
	LIMITS OF BEDROCK EXCAVATION
	LIMITS OF OVERBURDEN EXCAVATION
	FORMER STONE/BRICK STRUCTURE CONTAINING COAL TAR

- NOTES:**
- FORMER LOCATIONS OF GAS WORKS STRUCTURES FROM SANBORN LIBRARY, LLC 1908 MAP. LOCATIONS ARE APPROXIMATE.
  - LIMITS OF THE 2002/2003 OVERBURDEN EXCAVATION, BEDROCK EXCAVATION, AND LOCATIONS OF THE FORMER STRUCTURE CONTAINING COAL TAR FROM REPORT OF ACTIVITIES AT LL-LD1, SUNY GENESIO (2003). LOCATIONS ARE APPROXIMATE.
  - GROUND PENETRATING RADAR SURVEY AND UTILITY LOCATION PERFORMED BY UNDERGROUND SERVICES JULY 2015.

**SOURCE:**

- BASemap INFORMATION PROVIDED BY FISHER ASSOCIATES, LLC, DATED JUNE, 2015. FILENAME: GENESIO.TOPOL.DWG. GEOREFERENCED TO NEW YORK STATE PLANE NAD83 COORDINATE SYSTEM.

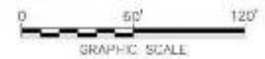

ROCHESTER GAS & ELECTRIC PARK STREET FORMER MGP SITE <b>SITE CHARACTERIZATION REPORT</b>	
<b>SITE MAP</b>	
	FIG. NO.   <b>2</b>