



Consolidated Edison Company of
New York, Inc.
31-01 20th Avenue
Long Island City NY 11105-2048
www.conEd.com

April 24, 2018

Mr. Scott Deyette
New York State Department of Environmental Conservation
Division of Environmental Remediation
625 Broadway
Albany, New York 12233-1011

**RE: Consolidated Edison Company of New York, Inc.
York Avenue Former Gas Holder Station Site,
New York, New York
Additional Surface Soil Sampling Work Plan**

Dear Mr. Deyette:

Consolidated Edison is submitting for your review and approval the following Additional Surface Soil Sampling Work Plan to conduct field activities related to the York Avenue Former Gas Holder Station site (the Site) in New York, New York. This Work Plan has been prepared to further investigate surface soil at the Mount Vernon Hotel Museum Parcel located at 421 E. 61st Street, New York, New York (Block 1456, Lot 12). The Parcel and proposed sample locations are shown in Figure 1.

Surface soil samples will be collected in accordance with the NYSDEC-approved Remedial Investigation Work Plan (RIWP, AECOM, 2012) at six locations (SS-4 through SS-9). Soil samples will be collected for chemical analysis from 0 to 6 inches and from 8 to 12 inches at each sample location to evaluate the presence of soil impacts in the shallow subsurface. Stainless-steel sampling implements (including spoons, trowels, and hand augers) and stainless-steel bowls will be used to collect each surface soil sample. Each soil sample will be homogenized prior to being placed in laboratory-provided sample containers and analyzed for Polycyclic Aromatic Hydrocarbons (PAHs) by United States Environmental Protection Agency (EPA) Method 8270D and metals (arsenic, lead, cadmium, and mercury) by EPA Method 6010C.

Each sampling implement will be decontaminated in accordance with decontamination procedures described in the RIWP. QA/QC samples will include one blind duplicate sample, one MS/MSD sample, and one equipment rinsate blank sample.

The samples will be analyzed by a NYSDOH environmental lab approval program accredited laboratory. Analytical results will be provided in a New York State Category B data deliverable format. The data will be validated in accordance with New York State Analytical Service Protocols, and a data usability summary report will be prepared documenting the adequacy of the analytical data obtained from the laboratory and discussing any quality

control non-compliance issues or limitations on the use of the data.

The information collected as part of this Work Plan will be submitted to NYSDEC as a data summary report. Field activities can commence following NYSDEC and NYSDOH approval of this Work Plan and at the convenience of the Property Owner.

If you have any questions or require additional information, please feel free to contact me at (718) 204-4331 or by e-mail at reindl@coned.com.

Sincerely,

A handwritten signature in black ink that reads "Melissa Reindl". The signature is written in a cursive, flowing style.

Melissa Reindl, P.G.
Project Manager
EH&S, Remediation
Con Edison

cc: Arunesh Ghosh, NYS DOH
C. Lombardi, Con Edison
K. Kaiser, Con Edison

Enc.

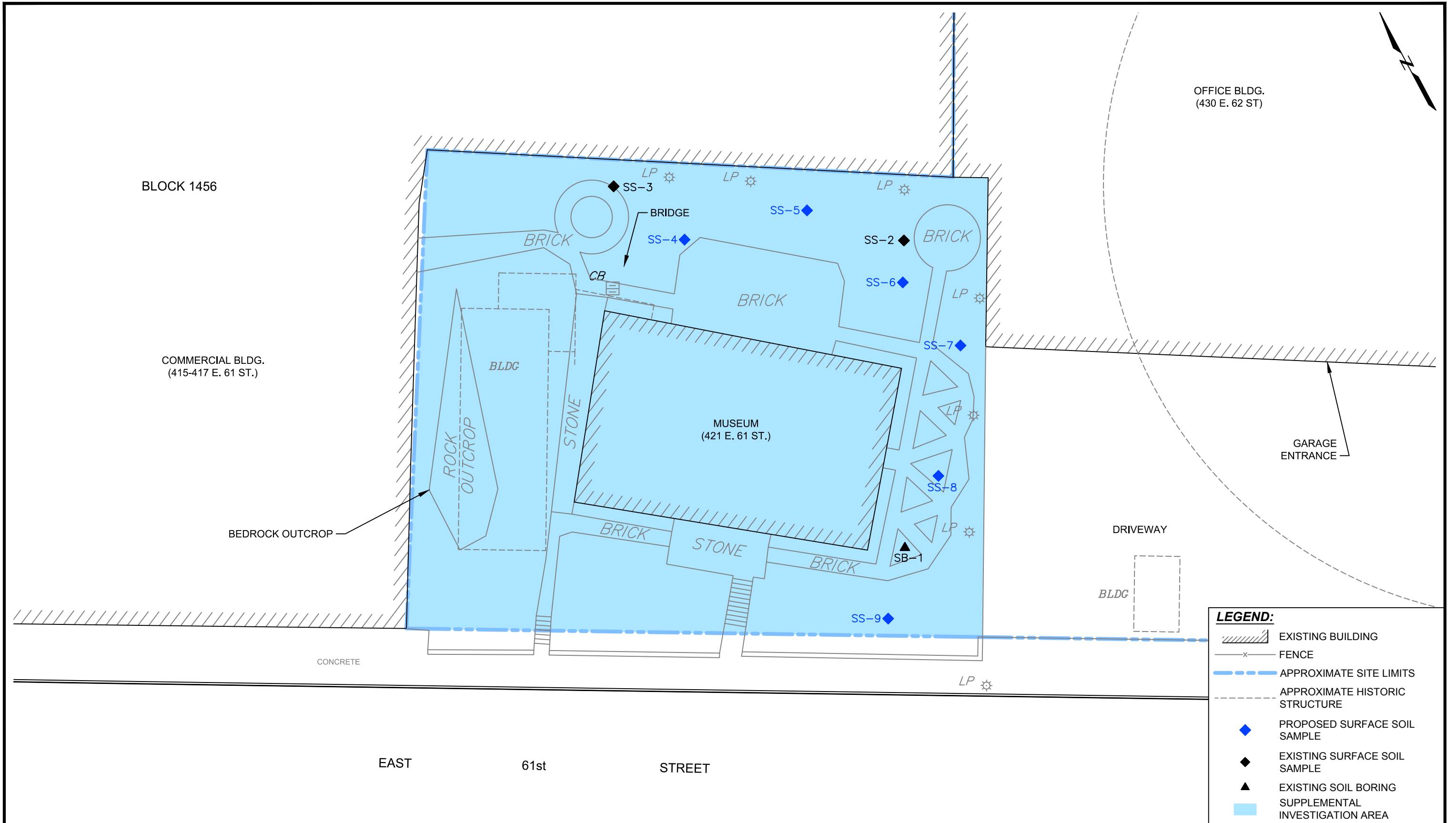

SOURCE:
 FIGURE BASED ON FIGURE 4-1: GEOLOGICAL CROSS SECTIONS
 A-A' & B-B' LOCATION PLAN FROM THE REMEDIAL INVESTIGATION
 REPORT, DATED 11/2011, PREPARED BY AECOM.

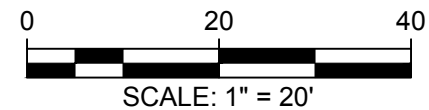

Additional Surface Soil Sampling Work Plan
 York Avenue Former Gas Holder Station
 Manhattan, New York
 Consolidated Edison Company of New York, Inc.
 Astoria, New York



SAMPLE LOCATIONS
 Project 1800120 April 2018 Fig. 1