

NO.	DATE	SUBJECT	BY	CHK'D	APP.
1	05/18/05	ADDED POST DREDGING CONTOURS, ADJUSTED TITLE BLOCK	KC	TPA	MTD
2	11/11/05	MODIFIED LEGEND TO SHOW RESIDUAL SAMPLE LOCATIONS	TPA	TPA	MTD
3	07/07/06	MODIFIED DRAWING TO INCLUDE CITY SAMPLES	TPA	TPA	MPS
4					
5					



amec EARTH & ENVIRONMENTAL, INC.
 EDISON PLAZA, 2nd FLOOR
 155 ERIE BOULEVARD
 SCHENECTADY, NY 12305

REMEDIAL ACTION WORK PLAN

PREPARED FOR: CSX TRANSPORTATION, INC.
 SUBMITTED TO: MANAGER ENVIRONMENTAL REMEDIATION
 500 WATER STREET, J-275
 JACKSONVILLE, FL 32202

DESIGNED BY: PAUL KURZANSKI

TITLE: REMEDIAL ACTION WORK PLAN
 CSXT GENESSEE RIVER SITE
 ROCHESTER, NEW YORK

RESIDUAL SEDIMENT SAMPLE LOCATIONS

DRAWN BY: TPA
 CHECKED BY: MDP
 DATE: 11/11/05
 SCALE: AS SHOWN
 Dwg. No. FIG. 4 SHEET

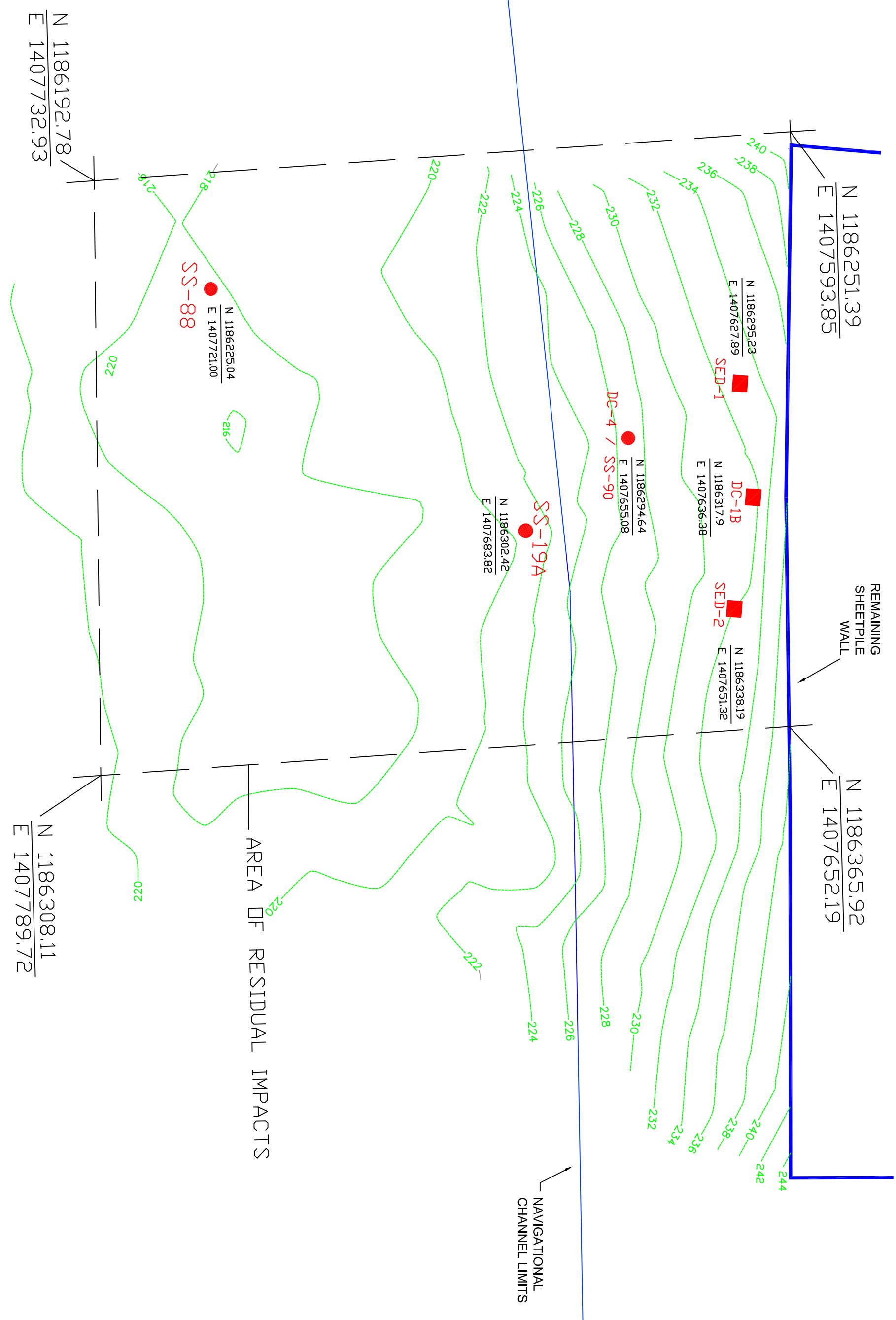

LEGEND:

- POST-DREDGING RIVER BOTTOM CONTOUR
- CSXT SEDIMENT SAMPLE LOCATION CONTAINING RESIDUAL METHYLENE CHLORIDE CONCENTRATIONS
- CITY SEDIMENT SAMPLE LOCATION CONTAINING RESIDUAL METHYLENE CHLORIDE CONCENTRATIONS

NOTES:

- BATHYMETRIC SURVEY SERVICES WERE PROVIDED BY THEW ASSOCIATES, CANTON, NY TO DOCUMENT AS-BUILT CONDITIONS.
- THE EXISTING SHEET PILE WALL WAS LEFT IN PLACE AND CUT FLUSH WITH THE RIVER BED.
- ORIGINAL BASE MAP PROVIDED BY LABELLA ASSOCIATES, P.C, ROCHESTER, NY
- RESIDUAL IS DEFINED IN THIS DRAWING AS: A SAMPLE LOCATION CONTAINING METHYLENE CHLORIDE CONCENTRATIONS GREATER THAN THE ESTABLISHED SCGS. SAMPLES WERE COLLECTED DURING THE POST DREDGING SAMPLING EVENT (APRIL 2005).

GRAPHIC SCALE
 (IN FEET)
 1 Inch = 10 Ft.

NORTH