

## Lee, Ronnie (DEC)

---

**From:** Weinstock, Eric <eric.weinstock@amecfw.com>  
**Sent:** Friday, November 04, 2016 4:18 PM  
**To:** Lee, Ronnie (DEC)  
**Cc:** Burt Lewis  
**Subject:** Annual sampling  
**Attachments:** Memo 11-3-16.pdf

**ATTENTION: This email came from an external source. Do not open attachments or click on links from unknown senders or unexpected emails.**

Hello Ronnie,

Please see the attached memo. With your okay, we will schedule this work.

Have a nice weekend.

Eric Weinstock  
Principal Scientist  
Amec Foster Wheeler  
1979 Marcus Avenue, Suite 210  
Lake Success, NY  
Phone: 516-622-2254  
Cell: 516-413-6643  
Email: [eric.weinstock@amecfw.com](mailto:eric.weinstock@amecfw.com)  
Website: [www.amecfw.com](http://www.amecfw.com)



This message is the property of Amec Foster Wheeler plc and/or its subsidiaries and/or affiliates and is intended only for the named recipient(s). Its contents (including any attachments) may be confidential, legally privileged or otherwise protected from disclosure by law. Unauthorised use, copying, distribution or disclosure of any of it may be unlawful and is strictly prohibited. We assume no responsibility to persons other than the intended named recipient(s) and do not accept liability for any errors or omissions which are a result of email transmission. If you have received this message in error, please notify us immediately by reply email to the sender and confirm that the original message and any attachments and copies have been destroyed and deleted from your system. This disclaimer applies to any and all messages originating from us and set out above. If you do not wish to receive future unsolicited commercial electronic messages from us, **please forward this email to: [unsubscribe@amecfw.com](mailto:unsubscribe@amecfw.com) and include "Unsubscribe" in the subject line.** If applicable, you will continue to receive invoices, project communications and similar factual, non-commercial electronic communications.

Please click <http://amecfw.com/email-disclaimer> for notices and company information in relation to emails originating in the UK, Italy or France.

# Memo



To: Ronnie Lee  
From: Eric Weinstock  
Project: Ralph Associates/former Bon Ton Cleaners/Flatlands Shopping Ctr.  
Date: November 3, 2016  
Subject: Annual Sampling

---

We plan to perform termination testing of the SSD system at this facility this Winter. In accordance with the SMP, we will follow these procedures:

- 1 – Turn off all the fans in mid-November;
- 2 – Collect both indoor air and sub-slab vapor samples 30 days later in mid to late December using Summa Canisters and Method TO-15;
- 3 – Compare the results to the NYSDOH standards.

The proposed sample locations are included on the attached map. With your okay, we will schedule this work.



Z:\Projects\Clifton Park Misc Proj\13 Ralph Ave\Fig-1 Loc.dwg Mon, 29 Feb 2016 4:09pm william.whitten

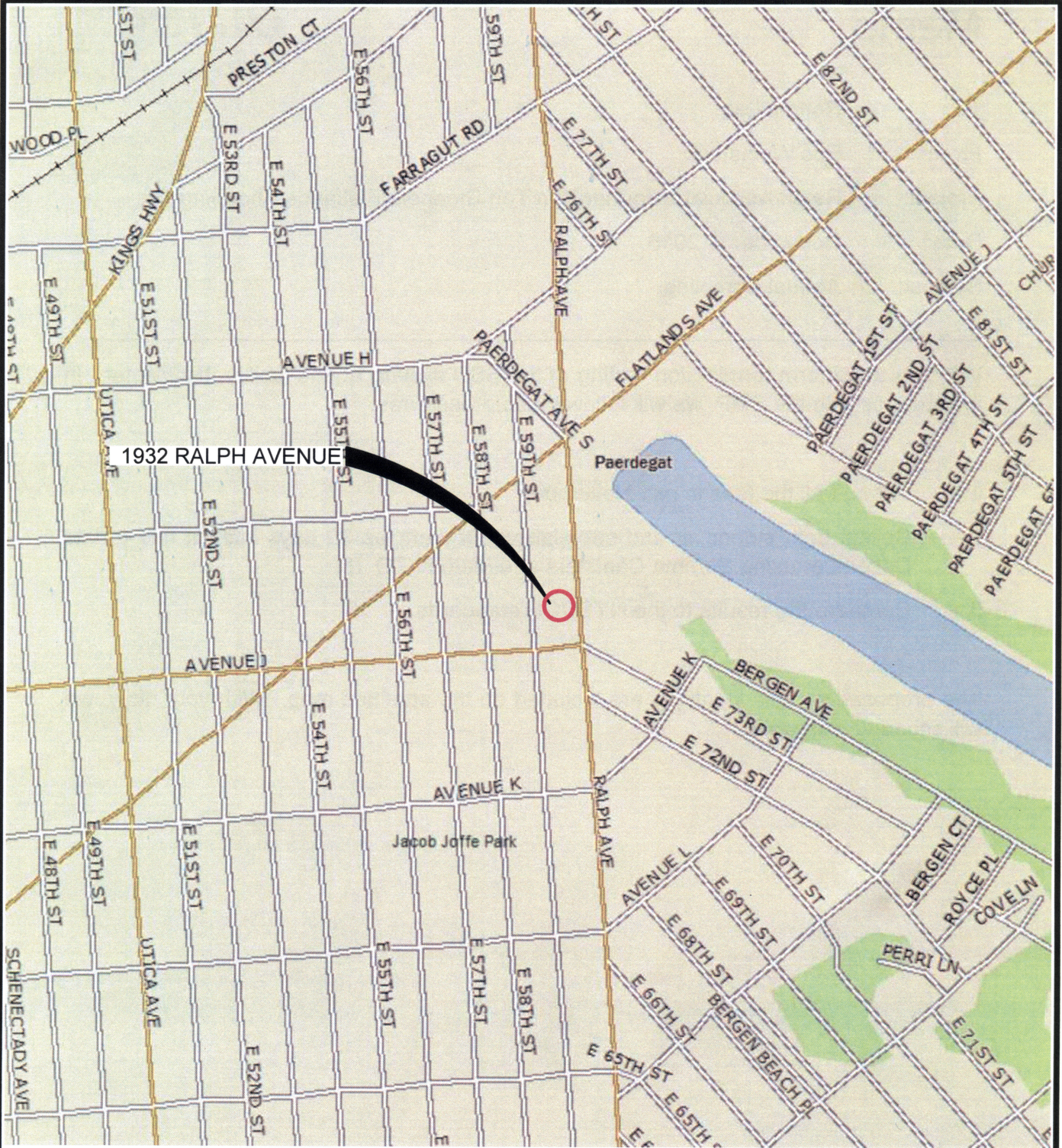

Source: DeLorme Topo North America



Prepared/Date: WJW 02/29/2016  
Checked/Date: EAW 02/29/2016

Ralph & Flatlands Associates  
1932 Ralph Avenue  
Brooklyn, NY

Amec Foster Wheeler  
1979 Marcus Ave., Suite 210  
Lake Success, New York 11042  
(516) 622-2254



PROPERTY  
LOCATION MAP  
Project 3612152301  
Figure 1



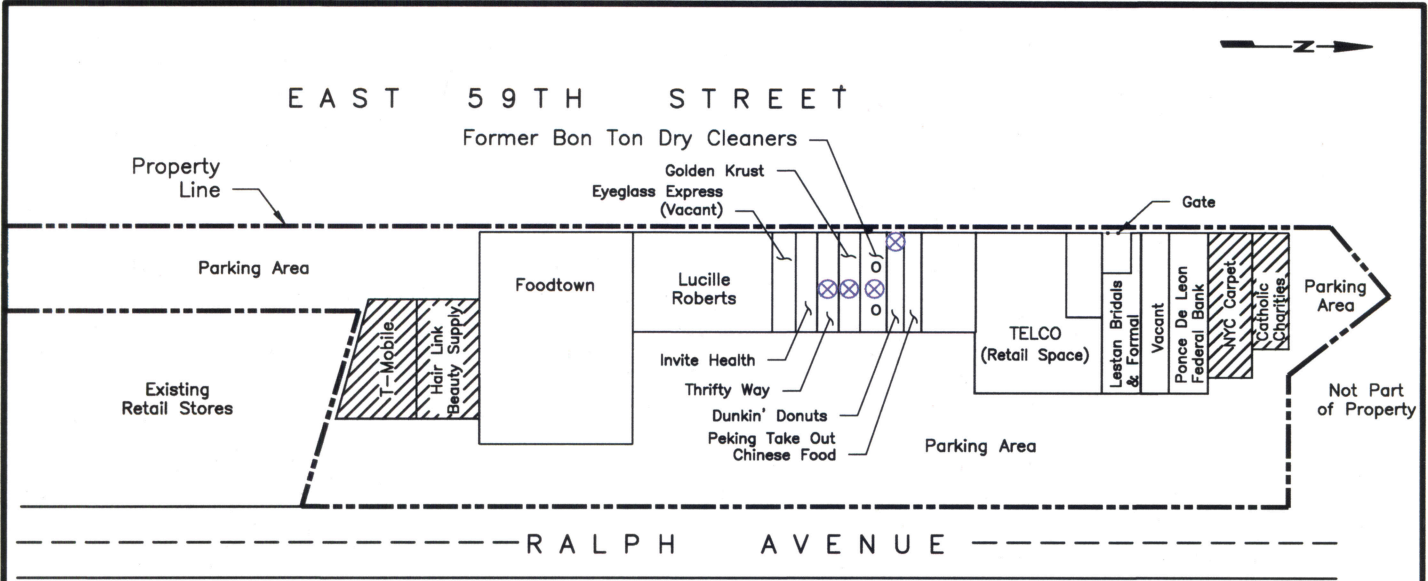

**Legend**

- Indoor Air
- ⊗ SAMPLE LOCATION
- ▨ UNIT HAS NO BASEMENT
- Sub-slab vapor sample location

**NOTE:**

1. MAP ADAPTED FROM PROPERTY SURVEY BY MONTROSE SURVEYING CO., LLP, DATED MAY 2, 2001 AND USGS BROOKLYN QUADRANGLE 1979.

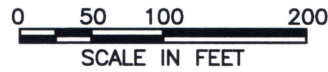

Prepared/Date: WJW 03/01/2016  
Checked/Date: EAW 03/01/2016

Ralph & Flatlands Associates  
1932 Ralph Avenue  
Brooklyn, NY

Amec Foster Wheeler  
1979 Marcus Ave., Suite 210  
Lake Success, New York 11042  
(516) 622-2254



**BASEMENT INDOOR AIR  
SAMPLE LOCATIONS**  
Project 3612-152-301  
Figure 2