

SHEET 1 OF 11

Site Location Map

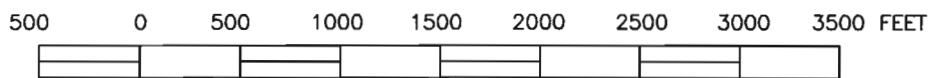

SCALE 1:12000



Reproduced from USGS Bayshore West, New York Quadrangle

Fenley & Nicol
 Professional Services Division
 445 Brook Ave.
 Deer Park, N.Y. 11729

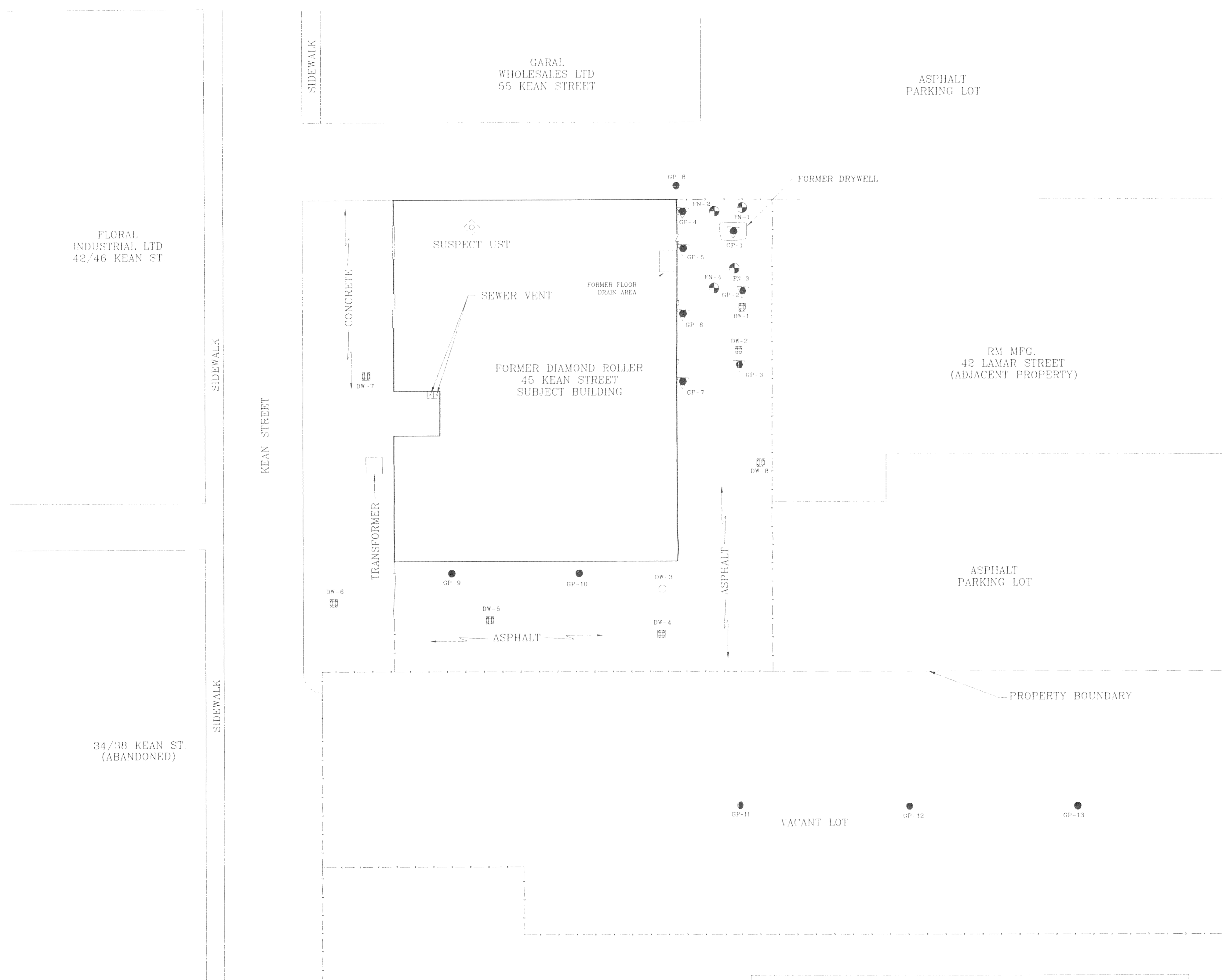
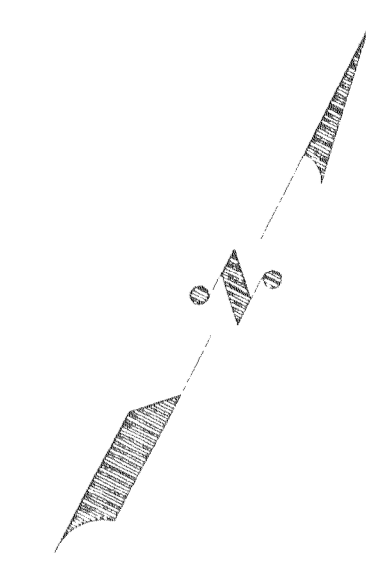

LEGEND

- FN-1 - MONITORING WELL LOCATION
- DK-4 - DRYWELL SEDIMENT SAMPLE LOCATION
- DK-3 - OVERFLOW LOCATION
- GP-8 - GROUNDWATER SAMPLING LOCATION
- GP-1 - SOIL / GROUNDWATER SAMPLING LOCATION

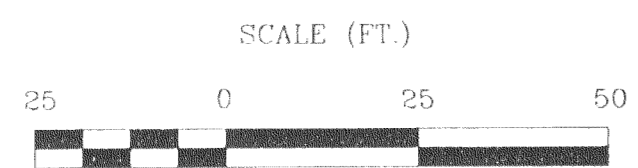

SHEET 2 OF 11

GF Fenley & Nicol Professional Services Division 25 FERRIS AVENUE, DEER PARK, NEW YORK 11762 (516) 466-1000			SITE PLAN DIAMOND ROLLER 45 KEAN STREET N. BABYLON, NEW YORK
SCALE: 1" = 25' DATE: 07-08	GEODESIST: J.C. DRAWN BY: J.C.	JOB #: 060419 CUSTOMER: PWSA, LLC	

FLORAL INDUSTRIAL LTD
42/46 KEAN ST.

GARAL WHOLESales LTD
55 KEAN STREET

ASPHALT PARKING LOT

KEAN STREET

SIDEWALK

SIDEWALK

SIDEWALK

34/38 KEAN ST.
(ABANDONED)

SUSPECT UST

SEWER VENT

FORMER DIAMOND ROLLER
45 KEAN STREET
SUBJECT BUILDING

CONCRETE

TRANSFORMER

LN	DEPTH
1	1.0
2	2.0
3	3.0
4	4.0
5	5.0
6	6.0
7	7.0
8	8.0
9	9.0
10	10.0
11	11.0
12	12.0
13	13.0
14	14.0
15	15.0
16	16.0
17	17.0
18	18.0
19	19.0
20	20.0
21	21.0
22	22.0
23	23.0
24	24.0
25	25.0
26	26.0
27	27.0
28	28.0
29	29.0
30	30.0
31	31.0
32	32.0
33	33.0
34	34.0
35	35.0
36	36.0
37	37.0
38	38.0
39	39.0
40	40.0
41	41.0
42	42.0
43	43.0
44	44.0
45	45.0
46	46.0
47	47.0
48	48.0
49	49.0
50	50.0

LN	DEPTH
1	1.0
2	2.0
3	3.0
4	4.0
5	5.0
6	6.0
7	7.0
8	8.0
9	9.0
10	10.0
11	11.0
12	12.0
13	13.0
14	14.0
15	15.0
16	16.0
17	17.0
18	18.0
19	19.0
20	20.0
21	21.0
22	22.0
23	23.0
24	24.0
25	25.0
26	26.0
27	27.0
28	28.0
29	29.0
30	30.0
31	31.0
32	32.0
33	33.0
34	34.0
35	35.0
36	36.0
37	37.0
38	38.0
39	39.0
40	40.0
41	41.0
42	42.0
43	43.0
44	44.0
45	45.0
46	46.0
47	47.0
48	48.0
49	49.0
50	50.0

LN	DEPTH
1	1.0
2	2.0
3	3.0
4	4.0
5	5.0
6	6.0
7	7.0
8	8.0
9	9.0
10	10.0
11	11.0
12	12.0
13	13.0
14	14.0
15	15.0
16	16.0
17	17.0
18	18.0
19	19.0
20	20.0
21	21.0
22	22.0
23	23.0
24	24.0
25	25.0
26	26.0
27	27.0
28	28.0
29	29.0
30	30.0
31	31.0
32	32.0
33	33.0
34	34.0
35	35.0
36	36.0
37	37.0
38	38.0
39	39.0
40	40.0
41	41.0
42	42.0
43	43.0
44	44.0
45	45.0
46	46.0
47	47.0
48	48.0
49	49.0
50	50.0

LN	DEPTH
1	1.0
2	2.0
3	3.0
4	4.0
5	5.0
6	6.0
7	7.0
8	8.0
9	9.0
10	10.0
11	11.0
12	12.0
13	13.0
14	14.0
15	15.0
16	16.0
17	17.0
18	18.0
19	19.0
20	20.0
21	21.0
22	22.0
23	23.0
24	24.0
25	25.0
26	26.0
27	27.0
28	28.0
29	29.0
30	30.0
31	31.0
32	32.0
33	33.0
34	34.0
35	35.0
36	36.0
37	37.0
38	38.0
39	39.0
40	40.0
41	41.0
42	42.0
43	43.0
44	44.0
45	45.0
46	46.0
47	47.0
48	48.0
49	49.0
50	50.0

FORMER DRYWELL

RM MFG.
42 LAMAR STREET
(ADJACENT PROPERTY)

ASPHALT PARKING LOT

PROPERTY BOUNDARY

VACANT LOT

GP-12

GP-13

NASSAU TOOL WORKS
21 LAMAR ST.

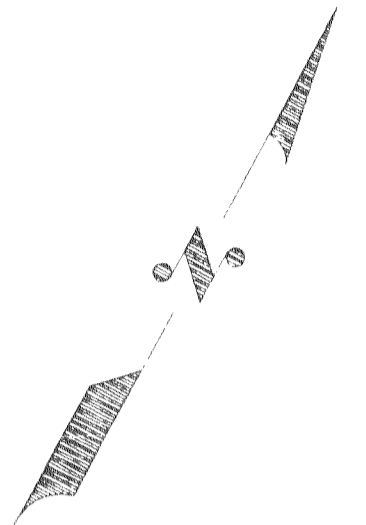

LEGEND

- MONITORING WELL LOCATION
- DRYWELL SEDIMENT SAMPLE LOCATION
- OVERFLOW LOCATION
- GROUNDWATER SAMPLING LOCATION
- SOIL / GROUNDWATER SAMPLING LOCATION
- TOTAL VOC'S CONCENTRATION (ug/KG) AND DEPTH
- NONE DETECTED

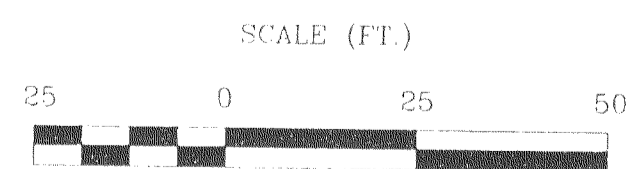

SHEET 3 OF 11

GF Fenley & Nicol
Professional Services Division
115 E. 42ND STREET, 11TH FLOOR
NEW YORK, NY 10017 (212) 693-0000

SCALE: AS SHOWN	DATE: 08/11/09	JOB # 09-001
DRAWN BY: J.C.L.	CHECKED BY: J.C.L.	CUSTOMER: PRAVATI

TOTAL VOC'S IN SOIL

DIAMOND ROLLER
45 KEAN STREET
S. BABYLON, NEW YORK

FLORAL INDUSTRIAL LTD
42/46 KEAN ST.

GARAL WHOLESALERS LTD
55 KEAN STREET

ASPHALT PARKING LOT

KEAN STREET

SIDEWALK

SIDEWALK

SIDEWALK

34/38 KEAN ST.
(ABANDONED)

SUSPECT UST

SEWER VENT

FORMER DIAMOND ROLLER
45 KEAN STREET
SUBJECT BUILDING

CONCRETE

TRANSFORMER

LN	DEPTH
1	1.0
2	2.0
3	3.0
4	4.0
5	5.0
6	6.0
7	7.0
8	8.0
9	9.0
10	10.0
11	11.0
12	12.0
13	13.0
14	14.0
15	15.0
16	16.0
17	17.0
18	18.0
19	19.0
20	20.0
21	21.0
22	22.0
23	23.0
24	24.0
25	25.0
26	26.0
27	27.0
28	28.0
29	29.0
30	30.0
31	31.0
32	32.0
33	33.0
34	34.0
35	35.0
36	36.0
37	37.0
38	38.0
39	39.0
40	40.0
41	41.0
42	42.0
43	43.0
44	44.0
45	45.0
46	46.0
47	47.0
48	48.0
49	49.0
50	50.0

LN	DEPTH
1	1.0
2	2.0
3	3.0
4	4.0
5	5.0
6	6.0
7	7.0
8	8.0
9	9.0
10	10.0
11	11.0
12	12.0
13	13.0
14	14.0
15	15.0
16	16.0
17	17.0
18	18.0
19	19.0
20	20.0
21	21.0
22	22.0
23	23.0
24	24.0
25	25.0
26	26.0
27	27.0
28	28.0
29	29.0
30	30.0
31	31.0
32	32.0
33	33.0
34	34.0
35	35.0
36	36.0
37	37.0
38	38.0
39	39.0
40	40.0
41	41.0
42	42.0
43	43.0
44	44.0
45	45.0
46	46.0
47	47.0
48	48.0
49	49.0
50	50.0

LN	DEPTH
1	1.0
2	2.0
3	3.0
4	4.0
5	5.0
6	6.0
7	7.0
8	8.0
9	9.0
10	10.0
11	11.0
12	12.0
13	13.0
14	14.0
15	15.0
16	16.0
17	17.0
18	18.0
19	19.0
20	20.0
21	21.0
22	22.0
23	23.0
24	24.0
25	25.0
26	26.0
27	27.0
28	28.0
29	29.0
30	30.0
31	31.0
32	32.0
33	33.0
34	34.0
35	35.0
36	36.0
37	37.0
38	38.0
39	39.0
40	40.0
41	41.0
42	42.0
43	43.0
44	44.0
45	45.0
46	46.0
47	47.0
48	48.0
49	49.0
50	50.0

LN	DEPTH
1	1.0
2	2.0
3	3.0
4	4.0
5	5.0
6	6.0
7	7.0
8	8.0
9	9.0
10	10.0
11	11.0
12	12.0
13	13.0
14	14.0
15	15.0
16	16.0
17	17.0
18	18.0
19	19.0
20	20.0
21	21.0
22	22.0
23	23.0
24	24.0
25	25.0
26	26.0
27	27.0
28	28.0
29	29.0
30	30.0
31	31.0
32	32.0
33	33.0
34	34.0
35	35.0
36	36.0
37	37.0
38	38.0
39	39.0
40	40.0
41	41.0
42	42.0
43	43.0
44	44.0
45	45.0
46	46.0
47	47.0
48	48.0
49	49.0
50	50.0

LN	DEPTH
1	1.0
2	2.0
3	3.0
4	4.0
5	5.0
6	6.0
7	7.0
8	8.0
9	9.0
10	10.0
11	11.0
12	12.0
13	13.0
14	14.0
15	15.0
16	16.0
17	17.0
18	18.0
19	19.0
20	20.0
21	21.0
22	22.0
23	23.0
24	24.0
25	25.0
26	26.0
27	27.0
28	28.0
29	29.0
30	30.0
31	31.0
32	32.0
33	33.0
34	34.0
35	35.0
36	36.0
37	37.0
38	38.0
39	39.0
40	40.0
41	41.0
42	42.0
43	43.0
44	44.0
45	45.0
46	46.0
47	47.0
48	48.0
49	49.0
50	50.0

FORMER DRYWELL

RM MFG.
42 LAMAR STREET
(ADJACENT PROPERTY)

ASPHALT PARKING LOT

PROPERTY BOUNDARY

GP-11

VACANT LOT

GP-12

GP-13

NASSAU TOOL WORKS
21 LAMAR ST.

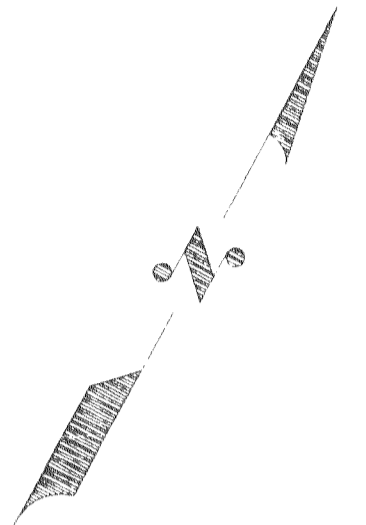

LEGEND

- MONITORING WELL LOCATION
- DRYWELL SEDIMENT SAMPLE LOCATION
- OVERFLOW LOCATION
- GROUNDWATER SAMPLING LOCATION
- SOIL / GROUNDWATER SAMPLING LOCATION
- TOTAL VOC'S CONCENTRATION (µg/KG) AND DEPTH
- NONE DETECTED

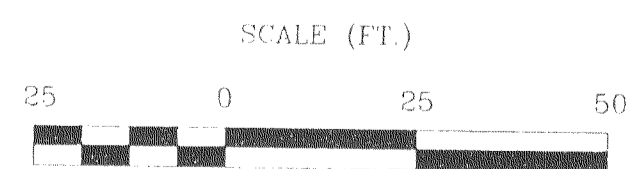

SHEET 3 OF 11

GD Fenley & Nicol
Professional Services Division
115 FERRIS AVENUE, LITTLETON,
NEW YORK 11203 (516) 466-0000

SCALE: AS SHOWN	DATE: 08/11/09	JOB # 09-001
DRAWN BY: J.C.	CHECKED BY: J.C.	CUSTOMER: PWSA

TOTAL VOC'S IN SOIL:

DIAMOND ROLLER
45 KEAN STREET
S. BABYLON, NEW YORK

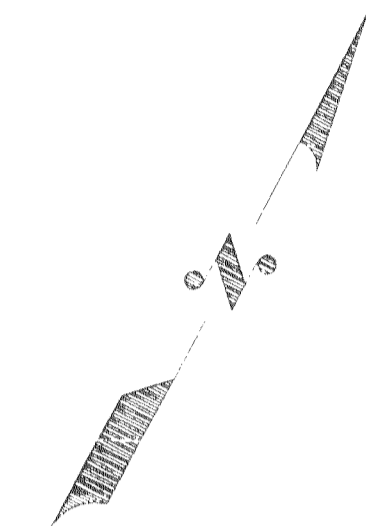

FLORAL INDUSTRIAL LTD
42/46 KEAN ST.

GARAL WHOLESALERS LTD
55 KEAN STREET

ASPHALT PARKING LOT

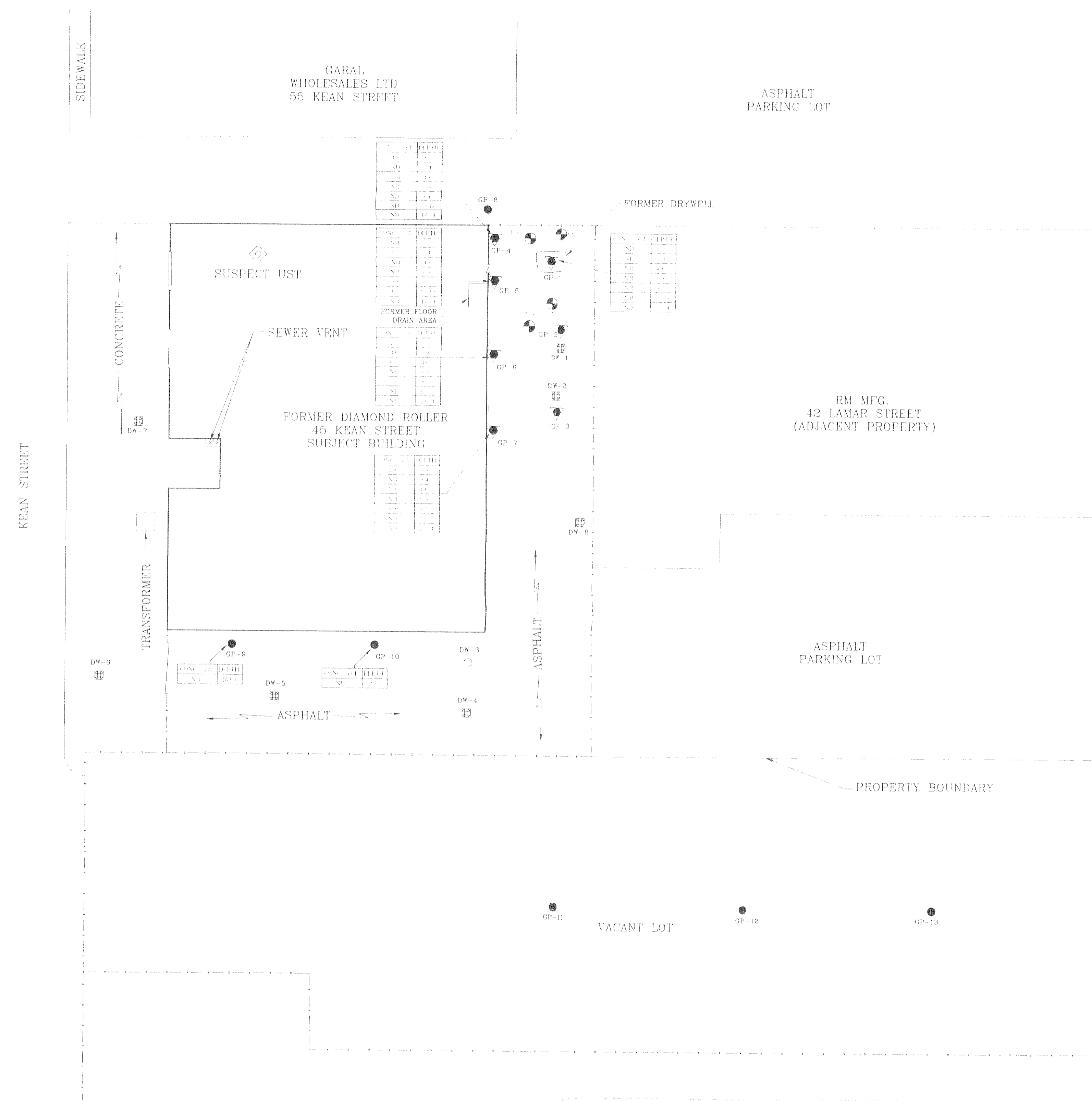

34/38 KEAN ST.
(ABANDONED)

LEGEND

- MONITORING WELL LOCATION
- DRYWELL SEDIMENT SAMPLE LOCATION
- OVERFLOW LOCATION
- GROUNDWATER SAMPLING LOCATION
- SOIL / GROUNDWATER SAMPLING LOCATION
- TETRACHLOROETHENE CONCENTRATION (ug/KG) AND DEPTH
- NONE DETECTED

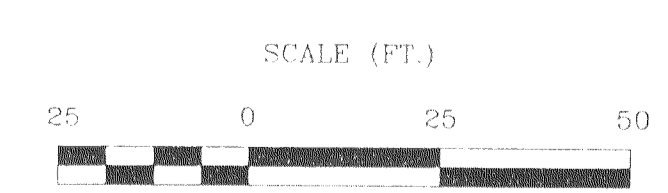

SHEET 4 OF 11

Fenley & Nicol
Professional Services Division
100 HERRICK AVENUE, 10TH FLOOR
NEW YORK, NY 10019-2099

TETRACHLOROETHENE
IN SOIL

PROJECT NO.	CLIENT NAME	DATE
DATE	DRAWN BY	CUSTOMER PROJECT

DIAMOND ROLLER
45 KEAN STREET
N BABYLON, NEW YORK

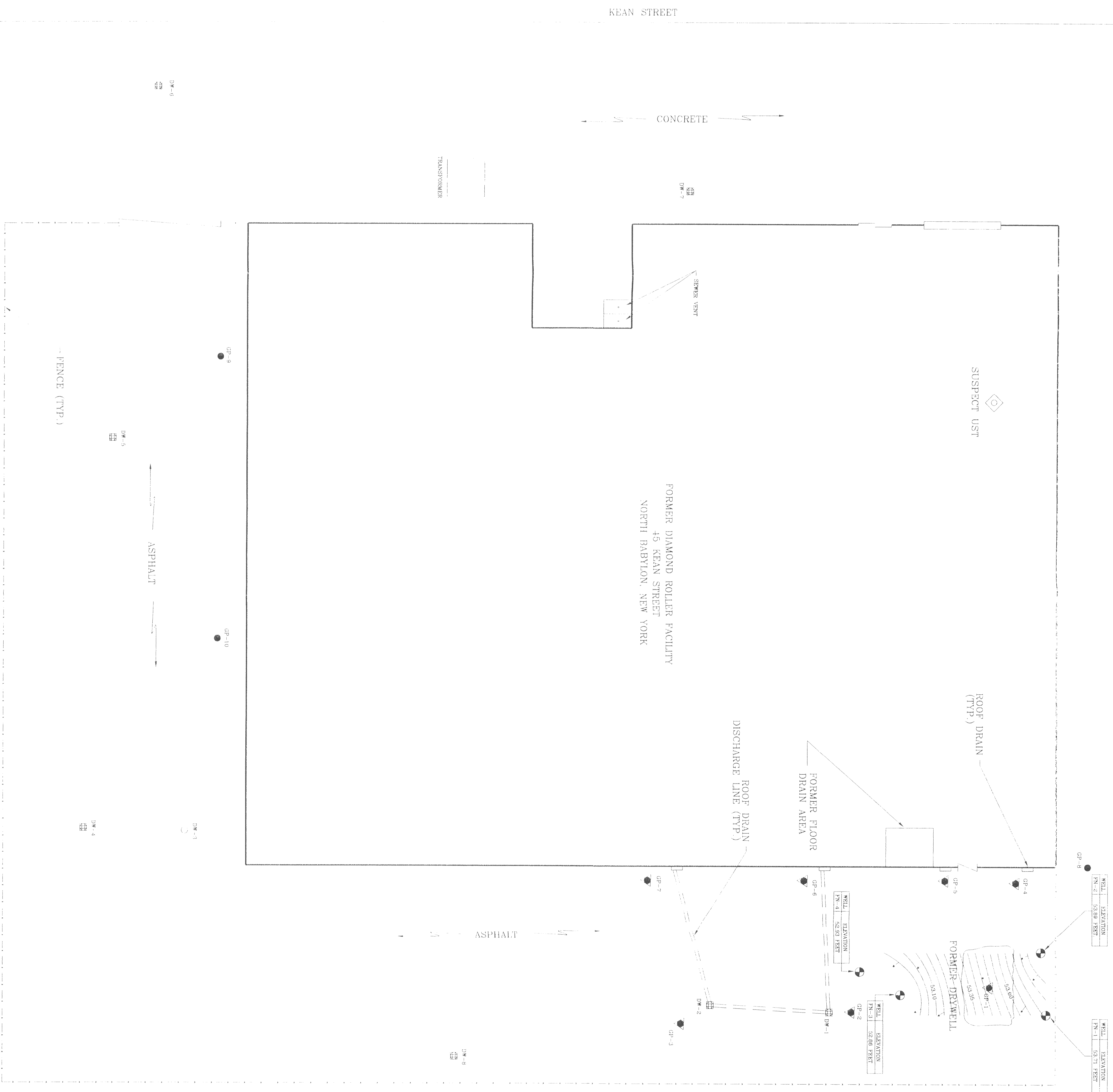
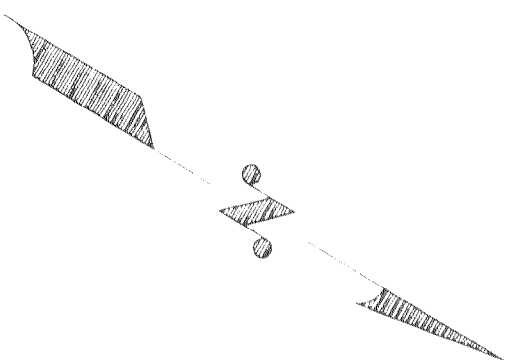

KEAN STREET

CONCRETE

FORMER DIAMOND ROLLER FACILITY
45 KEAN STREET
NORTH BABYLON, NEW YORK

SUSPECT UST

ROOF DRAIN (TYP)

FORMER FLOOR DRAIN AREA

ROOF DRAIN DISCHARGE LINE (TYP)

FORMER DEYWELL

MW-1 ELEVATION 52.00 FEET

MW-2 ELEVATION 52.00 FEET

MW-3 ELEVATION 52.00 FEET

MW-4 ELEVATION 52.00 FEET

MW-5 ELEVATION 52.00 FEET

MW-6 ELEVATION 52.00 FEET

LEGEND

- MW-1 MONITORING WELL LOCATION
- MW-2 DRYWELL, SEDIMENT SAMPLE LOCATION
- MW-3 OVERFLOW LOCATION
- SP-1 GROUNDWATER SAMPLING LOCATION
- SP-2 GROUNDWATER SAMPLING LOCATION
- SP-3 GROUNDWATER SAMPLING LOCATION
- SP-4 GROUNDWATER SAMPLING LOCATION
- SP-5 GROUNDWATER SAMPLING LOCATION
- SP-6 GROUNDWATER SAMPLING LOCATION

MONITORING WELL	CASING ELEVATION
MW-1	49.00
MW-2	49.00
MW-3	49.00
MW-4	49.10

NOTES: 1. ELEVATIONS BASED UPON SITE-SPECIFIC DATUM
2. C.I. - 0.05 FT

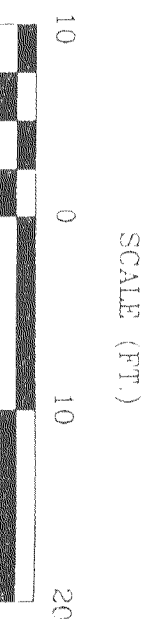

SHEET 6 OF 11

Geo-Fenley & Nicol
Professional Services Corporation
445 BRADDOCK AVENUE, THIRD FLOOR
NEW YORK, NY 11220 (212) 486-8800

DATE: 08/03/00
DRAWN BY: VJ
CHECKED BY: VJ
SCALE: AS SHOWN

DIAMOND ROLLER
45 KEAN STREET
N. BABYLON, N.Y. 11704

AUGUST 3, 2000

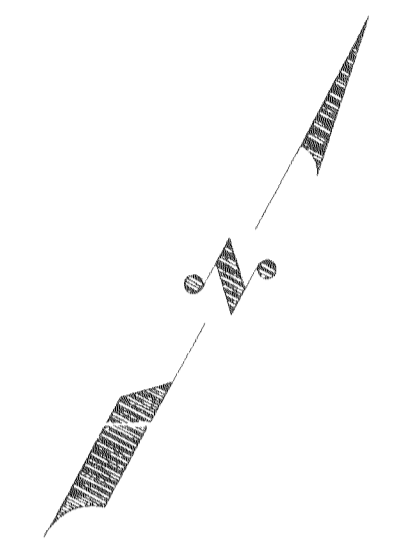

FLORAL INDUSTRIAL LTD
42/46 KEAN ST.

GARAL WHOLESLES LTD
55 KEAN STREET

ASPHALT PARKING LOT



34/38 KEAN ST.
(ABANDONED)

RM MFG.
42 LAMAR STREET
(ADJACENT PROPERTY)

ASPHALT PARKING LOT

PROPERTY BOUNDARY

CONC. ug/L	DEPTH
ND	1411
ND	1411
ND	1411

CONC. ug/L	DEPTH
ND	1411
ND	1411
ND	1411

CONC. ug/L	DEPTH
248	1411
29	1411
17	1411
11	1411

GP-11 VACANT LOT

GP-12

GP-13

NASSAU TOOL WORKS
21 LAMAR ST.

LEGEND

- IN - MONITORING WELL LOCATION
 - DW-4 - DRYWELL SEDIMENT SAMPLE LOCATION
 - DW-3 - OVERFLOW LOCATION
 - GP-8 - GROUNDWATER SAMPLING LOCATION
 - GP-1 - SOIL / GROUNDWATER SAMPLING LOCATION
- | CONC. ug/L | DEPTH |
|------------|-------|
| 192 | 1411 |
| ND | |
- TOTAL VOCs CONCENTRATION (ug/L) AND DEPTH
 - NONE DETECTED

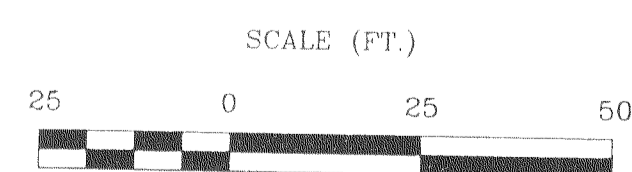

SHEET 7 OF 11

GD Fenley & Nicol
Professional Services Division
415 BRONX AVENUE, 10111 PHR.
NEW YORK, NY 10450 (212) 691-1000

SCALE: 1" = 25'	DATE: 02/01	DRAWN BY: A.L.	CUSTOMER: PRIVATE
-----------------	-------------	----------------	-------------------

TOTAL VOCs
IN GROUNDWATER

DIAMOND ROLLER
45 KEAN STREET
N. BABYLON, NEW YORK

FLORAL INDUSTRIAL LTD
42/46 KEAN ST.

GARAL WHOLESALERS LTD
55 KEAN STREET

ASPHALT PARKING LOT

KEAN STREET

SIDEWALK

34/38 KEAN ST.
(ABANDONED)

CONCRETE

SUSPECT UST

SEWER VENT

FORMER DIAMOND ROLLER
45 KEAN STREET
SUBJECT BUILDING

TRANSFORMER

ASPHALT

RM MFG.
42 LAMAR STREET
(ADJACENT PROPERTY)

ASPHALT PARKING LOT

PROPERTY BOUNDARY

VACANT LOT

NASSAU TOOL WORKS
21 LAMAR ST.

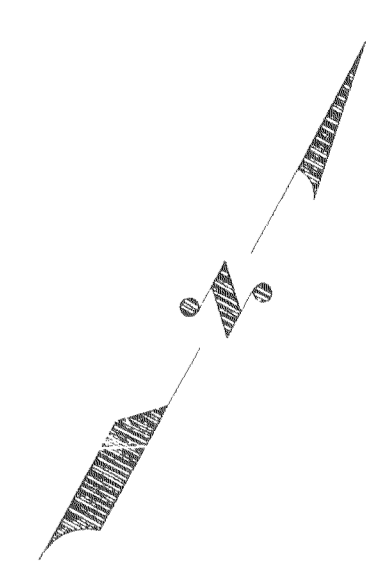

CONC. (ug/L)	DEPTH
ND	14 FT
ND	24 FT
ND	34 FT
ND	44 FT

CONC. (ug/L)	DEPTH
61	14 FT

CONC. (ug/L)	DEPTH
ND	14 FT

CONC. (ug/L)	DEPTH
25	14 FT

CONC. (ug/L)	DEPTH
ND	14 FT

CONC. (ug/L)	DEPTH
22	14 FT

CONC. (ug/L)	DEPTH
22	14 FT

CONC. (ug/L)	DEPTH
19	14 FT

CONC. (ug/L)	DEPTH
ND	14 FT
ND	24 FT
ND	34 FT
ND	44 FT

CONC. (ug/L)	DEPTH
ND	14 FT
ND	24 FT
ND	34 FT
ND	44 FT

CONC. (ug/L)	DEPTH
ND	14 FT
ND	24 FT
ND	34 FT
ND	44 FT

CONC. (ug/L)	DEPTH
ND	14 FT
ND	24 FT
ND	34 FT
ND	44 FT

CONC. (ug/L)	DEPTH
ND	14 FT
ND	24 FT
ND	34 FT
ND	44 FT

CONC. (ug/L)	DEPTH
ND	14 FT
ND	24 FT
ND	34 FT
ND	44 FT

CONC. (ug/L)	DEPTH
ND	14 FT
ND	24 FT
ND	34 FT
ND	44 FT

CONC. (ug/L)	DEPTH
ND	14 FT
ND	24 FT
ND	34 FT
ND	44 FT

CONC. (ug/L)	DEPTH
15	14 FT
20	24 FT
11	34 FT
11	44 FT

LEGEND

- IN - MONITORING WELL LOCATION
- DW-4 - DRYWELL SEDIMENT SAMPLE LOCATION
- DW-3 - OVERFLOW LOCATION
- GP-8 - GROUNDWATER SAMPLING LOCATION
- GP-1 - SOIL / GROUNDWATER SAMPLING LOCATION
- CONC. (ug/L) DEPTH - 1, 1, 1 - TRICHLOROETHANE CONCENTRATION (ug/L) AND DEPTH
- ND - NONE DETECTED

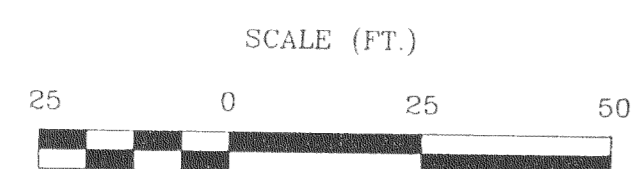

SHEET 8 OF 11

G.D. Fenley & Nicol Professional Services Division 4-45 HUDSON AVENUE, DELHI MANORS NEW YORK, NY 10011 (212) 695-5000		1, 1, 1 - TRICHLOROETHANE IN GROUNDWATER DIAMOND ROLLER 45 KEAN STREET N. BABYLON, NEW YORK
SCALE: 1" = 10'	DATE: 02/01/00	DRAWN BY: A.L.
REVISION: 01	DATE: 06/25/02	CUSTOMER: PRIVATE

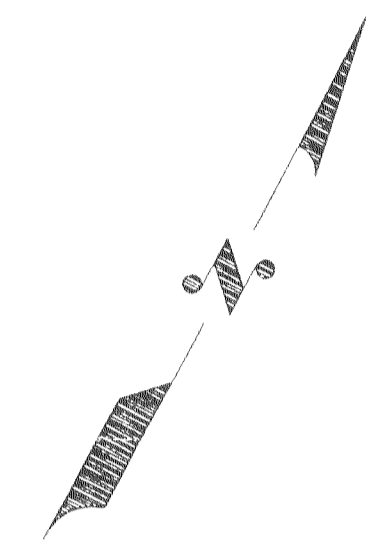

FLORAL INDUSTRIAL LTD
42/46 KEAN ST.

GARAL WHOLESALERS LTD
55 KEAN STREET

ASPHALT PARKING LOT

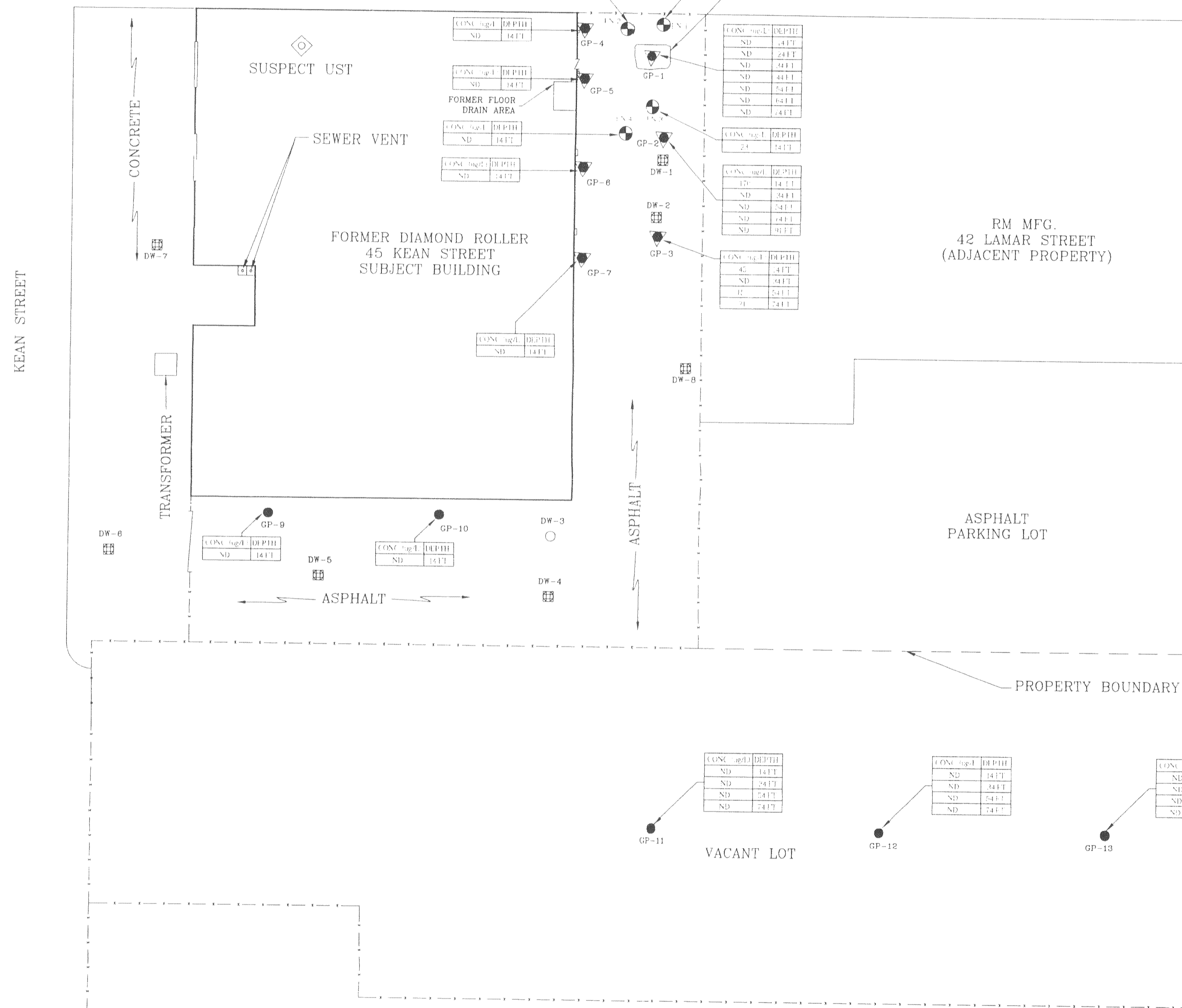

34/38 KEAN ST
(ABANDONED)

NASSAU TOOL WORKS
21 LAMAR ST.

- LEGEND**
- NS - MONITORING WELL LOCATION
 - DW-4 - DRYWELL SEDIMENT SAMPLE LOCATION
 - DW-3 - OVERFLOW LOCATION
 - GP-8 - GROUNDWATER SAMPLING LOCATION
 - GP-1 - SOIL / GROUNDWATER SAMPLING LOCATION
 - CONC. (ug/L) DEPTH (ft) - 1,1-DICHLOROETHANE CONCENTRATION (ug/L) AND DEPTH
 - ND - NONE DETECTED

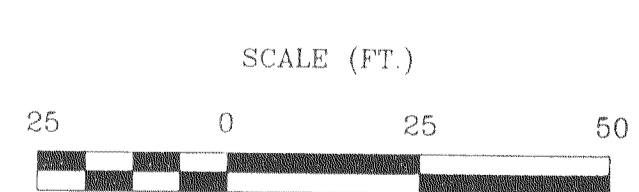

SHEET 9 OF 11

Fenley & Nicol
Professional Services Division
4-55 BRONX AVENUE, BELLGARDEN,
NEW YORK 11224 (718) 506-3000

1,1-DICHLOROETHANE
IN GROUNDWATER

SCALE: 1" = 20'-0" G.E. GILBERT, S.E.R. JOB # 9615107
DATE: 11-30 DRAWN BY: A.L. CUSTOMER PROVIDED

DIAMOND ROLLER
45 KEAN STREET
N. BABYLON, NEW YORK

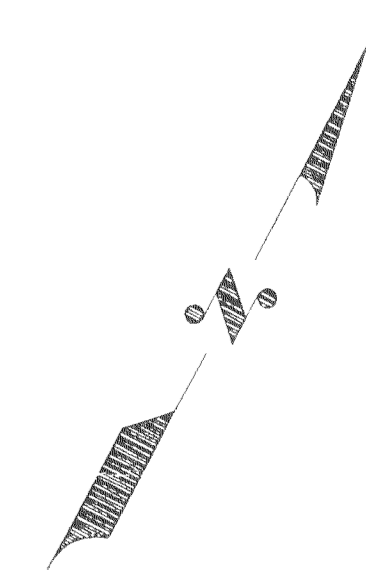

FLORAL INDUSTRIAL LTD
42/46 KEAN ST.

GARAL WHOLESALERS LTD
55 KEAN STREET

ASPHALT PARKING LOT

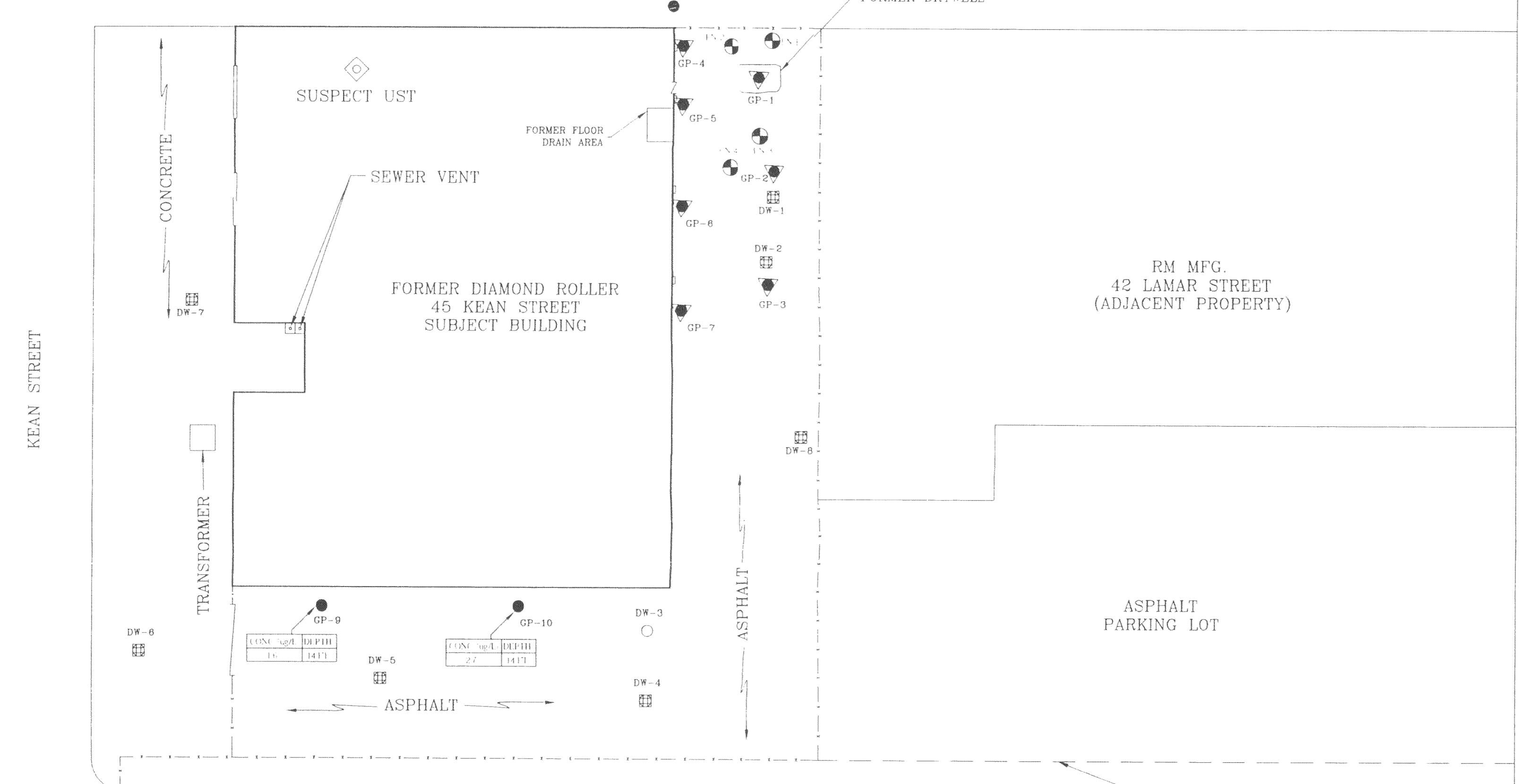

RM MFG.
42 LAMAR STREET
(ADJACENT PROPERTY)

ASPHALT PARKING LOT

34/38 KEAN ST.
(ABANDONED)

VACANT LOT

NASSAU TOOL WORKS
21 LAMAR ST.

LEGEND

- MONITORING WELL LOCATION
- DRYWELL SEDIMENT SAMPLE LOCATION
- OVERFLOW LOCATION
- GROUNDWATER SAMPLING LOCATION
- SOIL / GROUNDWATER SAMPLING LOCATION
- | | |
|--------------|------------|
| CONC. (ug/L) | DEPTH (ft) |
| 10 | 1411 |

 - TOTAL SVOC'S CONCENTRATION (ug/L) AND DEPTH

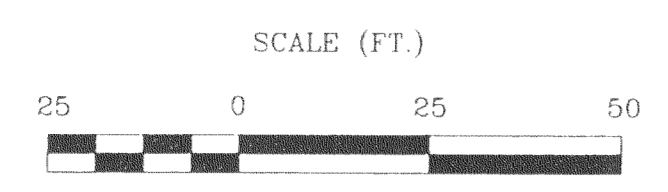

SHEET 10 OF 11

 Fenley & Nicol <i>Professional Services Division</i> <small>450 BROADWAY, SUITE 1411, NEW YORK, NY 10013-1411</small>			TOTAL SEMI-VOCS IN GROUNDWATER
SCALE: 1" = 25'-0"	CLIENT: NYS DEC	PROJECT: 0615102	DIAMOND ROLLER 45 KEAN STREET N. BABYLON, NEW YORK
DATE: 06/03	DRAWN BY: A.L.	CUSTOMER: DEC/11	

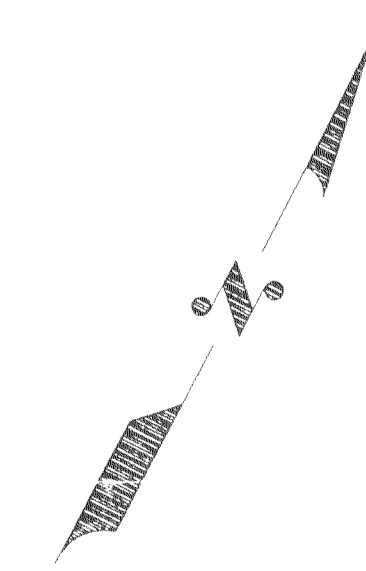

FLORAL INDUSTRIAL LTD
42/46 KEAN ST.

GARAL WHOLESALS LTD
55 KEAN STREET

ASPHALT PARKING LOT

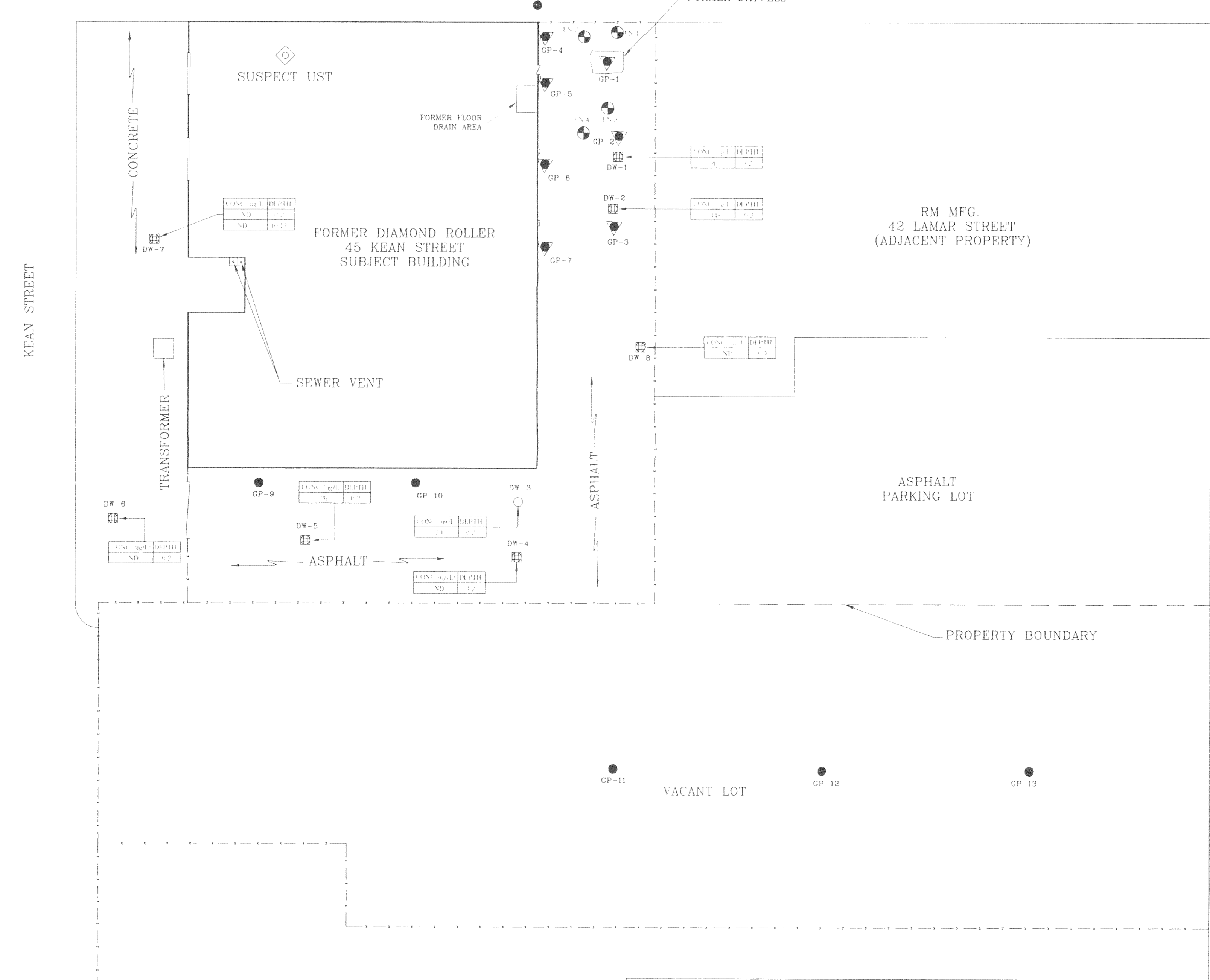

34/38 KEAN ST.
(ABANDONED)

NASSAU TOOL WORKS
21 LAMAR ST.

LEGEND

- MONITORING WELL LOCATION
- DRYWELL SEDIMENT SAMPLE LOCATION
- OVERFLOW LOCATION
- GROUNDWATER SAMPLING LOCATION
- SOIL / GROUNDWATER SAMPLING LOCATION
- TOTAL VOC'S CONCENTRATION (ug/KG) AND DEPTH
- NONE DETECTED

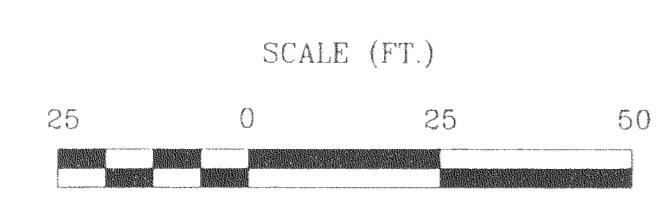

SHEET 11 OF 11

Fenley & Nicol Professional Services Division 345 HERRICK AVENUE, DEAL TOWNSHIP NEW YORK 11761 (845) 586-4900			TOTAL VOC'S IN DRYWELLS
SCALE: 1" = 25'-0"	CLIENT: MTR	PROJECT: 0612107	DIAMOND ROLLER 45 KEAN STREET N BABYLON, NEW YORK
DATE: 1-08	DRAWN BY: J.L.	CUSTOMER: PRIVATE	