



# QUADRANGLE LOCATION



SOURCE:  
USGS; 1966, ARTHUR KILL, NY-NJ  
7.5 Minute Topographic Quadrangle



0 2000'

Title:

## SITE LOCATION MAP

FINAL ENGINEERING REPORT FOR OU-1

Prepared for:

NASSAU METALS CORPORATION  
STATEN ISLAND, NEW YORK

**ROUX**  
ROUX ASSOCIATES, INC.  
Environmental Consulting  
& Management

Compiled by: M.R.	Date: 01FEB11
Prepared by: J.A.D.	Scale: AS SHOWN
Project Mgr.: M.R.	Project No.: 0770.0002Y011
File: 0770.0002Y432.01	

FIGURE

1



V:\CAD\PROJECTS\0770Y\0002Y\432\0770.0002Y432.02.DWG

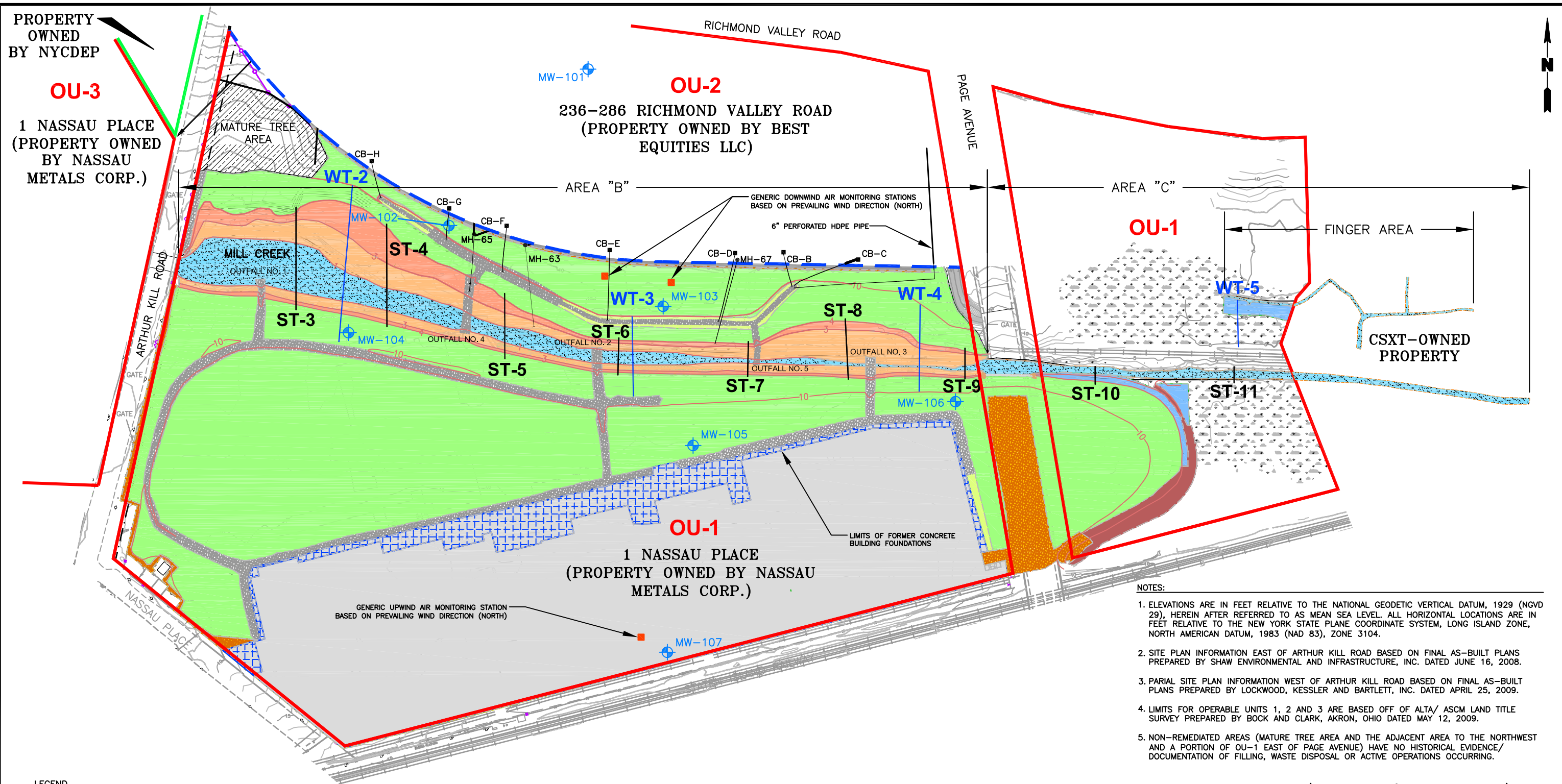

LEGEND

	EXISTING BUILDING/STRUCTURE		NEW FENCE GATE		SAND CAP		ASPHALT CAP ABOVE FORMER PARKING AREAS, SLABS AND BUILDING FOUNDATIONS
	MINOR CONTOUR ELEVATION (DASHED WHERE INFERRED) - CONTOUR INTERVAL 1 FOOT (FEET ABOVE MEAN SEA LEVEL). ONLY THE 1, 3 AND 4 FOOT CONTOURS (HIGHLIGHTED IN BROWN) SHOWN WITHIN LIMITS OF CAPPED AREAS FOR CLARITY.		VCA SITE BOUNDARY/ OPERABLE UNIT LIMITS		COMPOSITE GCL CAP (SAND-TOPSOIL VEGETATED COVER OUTSIDE LIMITS OF SWALE)		ASPHALT CAP ABOVE GCL
	INDEX CONTOUR ELEVATION (DASHED WHERE INFERRED) - CONTOUR INTERVAL 1 FOOT (FEET ABOVE MEAN SEA LEVEL). ONLY THE 10 FOOT CONTOUR (HIGHLIGHTED IN BROWN) SHOWN WITHIN LIMITS OF CAPPED AREAS FOR CLARITY.		BOUNDARY BETWEEN OU-1 AND OU-2		COMPOSITE GCL CAP (SAND-TOPSOIL VEGETATED COVER WITHIN LIMITS OF SWALE)		NYCDEP DRAINAGE SWALE
	EXISTING FENCELINE		NEW FENCING		COMPOSITE GCL CAP (STONE/RIPRAP COVER WITHIN LIMITS OF SWALE)		RESTORED BRACKISH MARSH AREAS
	LIGHT POLE		LOCATION AND DESIGNATION OF MONITORING WELL		VEGETATED STABILIZATION SOIL CAP (WITHIN LIMITS OF LOW MARSH AREAS)		MH-65 MANHOLE LOCATION AND DESIGNATION AND ASSOCIATED SUBSURFACE PIPING
	EXISTING RAILROAD TRACKS		OU-1 OPERABLE UNIT DESIGNATION		VEGETATED STABILIZATION SOIL CAP (WITHIN LIMITS OF HIGH MARSH AREAS)		CB-E CATCH BASIN LOCATION AND DESIGNATION AND ASSOCIATED SUBSURFACE PIPING
	ELECTRIC POLE		ST-3 SAND TRANSECT				OUTFALL LOCATION AND ASSOCIATED SUBSURFACE PIPING
			WT-2 WETLAND TRANSECT				

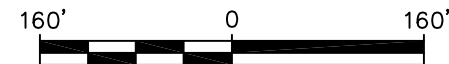

Title:			
OU-1 SITE PLAN			
FINAL ENGINEERING REPORT FOR OU-1			
Prepared For:			
NASSAU METALS CORPORATION STATEN ISLAND, NEW YORK			
 ROUX ASSOCIATES, INC. Environmental Consulting and Management	Compiled by: O.R.	Date: 01FEB11	FIGURE  <b>2</b>
	Prepared by: O.R.	Scale: AS SHOWN	
	Project Mgr: O.R.	Project: 0770.0002Y011	
	File: 0770.0002Y432.02		

**APPENDICES A – AD  
(See Attached DVD)**

- A. NYSDEC Approval Letters/ Emails
- B. Daily Construction Reports
- C. Monthly Construction Progress Reports
- D. Regulatory Permits
- E. Key Documentation Provided to the NYSDEC
- F. CAMP Data and Action Level Exceedance Reports
- G. Imported Potable Water Tickets
- H. On-Site Wastewater Treatment Facility Analytical Results
- I. As-Built Drawings (Hard Copy Also Included in Addition to DVD)
- J. Sediment Stabilization Testing Results
- K. Compaction Testing Results
- L. Product Specifications for Geogrid, Geosynthetic Filter Fabric, Erosion Control Matting, Geosynthetic Clay Liner and Turf Reinforcement Mat
- M. GCL Layouts and Subgrade Acceptance Forms
- N. Off-Site Fill Material Import Tickets
- O. Off-Site Fill Material Clean Fill Certifications
- P. Asphalt Load Tickets
- Q. Closure Documentation for Spill No. 0609869
- R. Off-Site Fill Material Chemical Quality Assurance Data
- S. Off-Site Fill Material Physical Quality Assurance Data
- T. C&D Debris and Bulky Waste Disposal Tickets
- U. Hazardous Waste Manifests (Hard Copy Also Included in Addition to DVD)
- V. Hazardous Disposal Facility Weight Scale Tickets
- W. Waste Characterization Profiles and Analytical Data
- X. Non-hazardous Treatment System Spent Media Bills of Lading
- Y. Non-hazardous Construction Wastewater Bills of Lading
- Z. Monitoring Well Abandonment Logs

**APPENDICES (Continued)**

- AA. Monitoring Well Construction Logs
- AB. Equipment Decontamination Certificates
- AC. Site Management Plan
- AD. Declaration of Covenants and Restrictions

**APPENDIX I**

**As-Built Drawings**

**(Hard Copy Also Included in Addition to DVD)**

## **Hazardous Waste Manifests**

**(Hard Copy Also Included in Addition to DVD)**