	Daily Activity Report			
	Former United Hospital			
	Port Chester, NY BCP No. C360202			
General Site Information				
Date:	Friday, April 14, 2023			
Weather:	Sunny, ~85°F			
Wind Direction/Speed:	Wind from the south @ ~3mph			
AKRF Personnel on Site:	Steve Schmid			
AKRF Equipment on Site:	Handheld PID and Dustrak			
Visitors:	None			
Contractor Information				
Contracting Company	Key Personnel		Equipment	
Capital Industries Corp.	Joe Cianciulli		Boom Lift, Excavator, and Hand Tools	
Description and Location of Work Activities Performed				
NOVA completed abatement of asbestos- and PCB-containing caulking at the former power plant building.				
NOVA began to demob from the work area at the former power plant.				
Site Soil Disposal Tracking Information				
Destination Facility	Daily Trucks	Daily Approx. Cubic Yds.	Total Site Loads	Total Approximate Cubic Yards
Not Applicable (N/A)	N/A	N/A	N/A	N/A
	Daily Import (CY)	0	Total Import (CY)	0
Imported Fill Tracking Information				
Origin Facility	Daily Trucks	Daily Approx. Cubic Yds.	Total Site Loads	Total Approximate Cubic Yards
Not Applicable (N/A)	N/A	N/A	N/A	N/A
	Daily Import (CY)	0	Total Import (CY)	0
CAMP Information				
	Roving Equipment		Upwind	Downwind
Odors:	None Observed		N/A	N/A
VOC Action Level Exceedance(s) Above Background:	No		N/A	N/A
Particulate Action Level Exceedance(s) Above Background:	No		N/A	N/A
Additional Information				
Planned Work Activity for Following Day(s):	Continue interior abatement of asbestos-containing materials from the main hospital buildings.			
Comments:	None			

Site Photographs

Photograph 1 -
Breaking windows on
the former power
plant building to
facilitate the
abatement of asbestos
and PCB-containing
caulking, view facing
north.



Photograph 2 -
Abatement of
asbestos- and PCB-
containing caulking
at the former power
plant using hand
tools, view facing
west.





Photograph 3 -
Abatement of
asbestos- and PCB-
containing caulking
at the former power
plant using hand
tools, view facing
northeast.

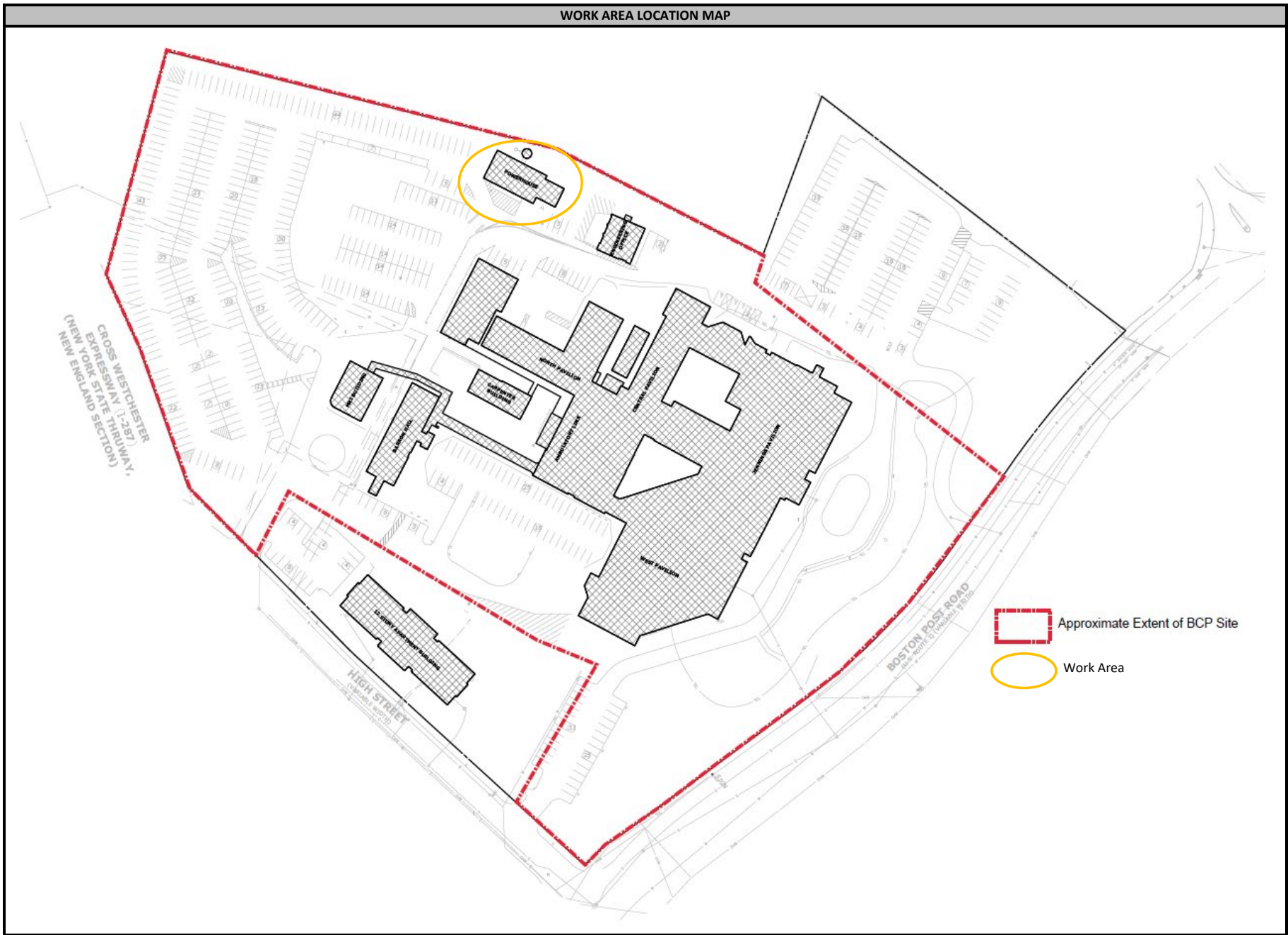

WORK AREA LOCATION MAP



-  Approximate Extent of BCP Site
-  Work Area

Roving CAMP Log

AKRF, Inc.			Air Monitoring Log		
Project: Former United Hospital		Client: Rose Associates		Date: 4/14/23	
Work Activity: <i>abatement at power plant</i>			Logged By: <i>ST</i>		
Weather: <i>~85 Sunny</i>			Wind Direction: <i>S</i>		Job No: 200057
			Wind Speed: <i>3 mph</i>		COMMENTS (activity, work zone, upwind or downwind)
TIME	LOCATION	PID (ppm)	DUST (mg/m ³)	ODORS	
715	UW	0.0	0.073	none	BACKGROUND
745	DW	0.0	0.077	none	<i>prep</i>
815	WZ	0.0	0.084	none	<i>abatement @ power plant</i>
845	UW	0.0	0.069	none	↓
915	DW	0.0	0.079	none	↓
945	WZ	0.0	0.081	none	↓
1015	UW	0.0	0.075	none	↓
1045	DW	0.0	0.090	none	↓
1115	WZ	0.0	0.089	none	↓
1145	UW	0.0	0.076	none	↓
1230	DW	0.0	0.094	none	↓
1300	WZ	0.0	0.099	none	↓
1330	UW	0.0	0.083	none	↓
1400	DW	0.0	0.092	none	↓
1430	WZ	0.0	0.100	none	↓
1500	UW	0.0	0.088	none	↓
1530	DW	0.0	0.093	none	↓
1600	WZ	0.0	0.096	none	↓
1630	UW	0.0	0.079	none	↓

Work Zone Action Levels	
PID	DUST
<5 ppm: Level D	<0.150 mg/m ³ above background in breathing zone:
Between 5 ppm and 50 ppm: level C	level D
>50 ppm: STOP	>0.150 mg/m ³ above background in breathing zone: Dust suppression

Community (Perimeter) Action Levels	
PID	DUST
>5 ppm above background: vapor suppression	>0.1 mg/m ³ above background: dust suppression
>25 ppm above background: STOP	>0.15 mg/m ³ above background: STOP