	Daily Activity Report			
	Former United Hospital Port Chester, NY BCP No. C360202			
	General Site Information			
Date:	Thursday, April 13, 2023			
Weather:	Sunny, ~85°F			
Wind Direction/Speed:	Wind from the northwest @ ~7mph			
AKRF Personnel on Site:	Steve Schmid			
AKRF Equipment on Site:	Handheld PID and Dustrak			
Visitors:	None			
Contractor Information				
Contracting Company	Key Personnel		Equipment	
Capital Industries Corp.	Joe Cianciulli		Boom Lift, Excavator, and Hand Tools	
Description and Location of Work Activities Performed				
NOVA prepped the work area around the former power plant building and mobilized equipment and supplies.				
NOVA began abatement of asbestos- and PCB-containing caulking at the former power plant building.				
Site Soil Disposal Tracking Information				
Destination Facility	Daily Trucks	Daily Approx. Cubic Yds.	Total Site Loads	Total Approximate Cubic Yards
Not Applicable (N/A)	N/A	N/A	N/A	N/A
	Daily Import (CY)	0	Total Import (CY)	0
Imported Fill Tracking Information				
Origin Facility	Daily Trucks	Daily Approx. Cubic Yds.	Total Site Loads	Total Approximate Cubic Yards
Not Applicable (N/A)	N/A	N/A	N/A	N/A
	Daily Import (CY)	0	Total Import (CY)	0
CAMP Information				
	Roving Equipment		Upwind	Downwind
Odors:	None Observed		N/A	N/A
VOC Action Level Exceedance(s) Above Background:	No		N/A	N/A
Particulate Action Level Exceedance(s) Above Background:	No		N/A	N/A
Additional Information				
Planned Work Activity for Following Day(s):	Continue abatement of asbestos- and PCB-containing caulking at the former power plant building.			
Comments:	None			

Site Photographs

Photograph 1 - A
view of the work area
prior to mobilization,
view facing north.



Photograph 2 -
Preparation of the
work area and boom
lift with poly, view
facing northeast.



Photograph 3 -
Abatement of
asbestos- and PCB-
containing caulking
at the former power
plant using hand
tools, view facing
east.



WORK AREA LOCATION MAP

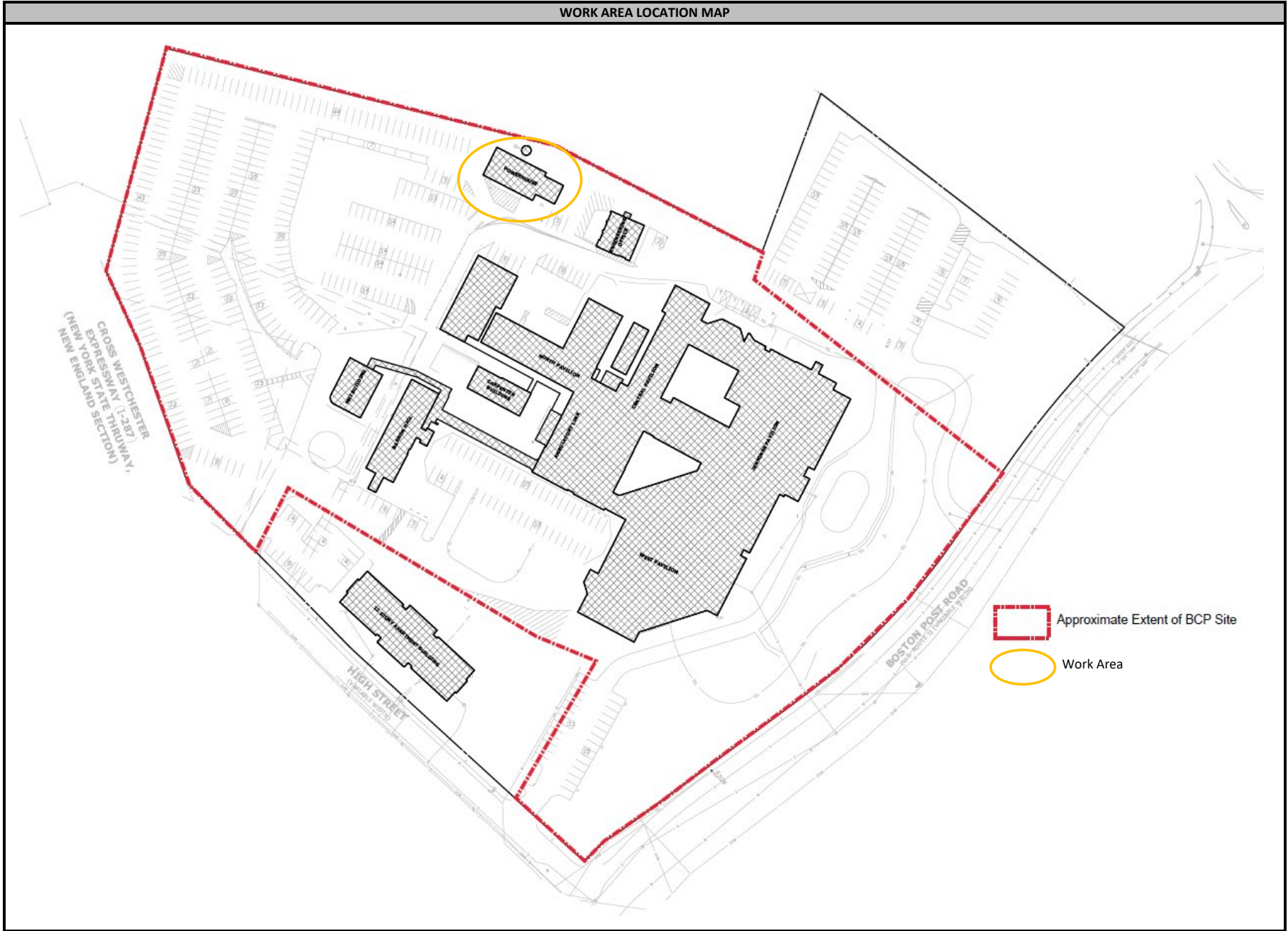

Roving CAMP Log

AKRF, Inc.

Air Monitoring Log

Project: Former United Hospital

Client: Rose Associates

Date: 4/13/23

Work Activity: interior work @ SW hospital building
abatement @ power plant

Logged By: SS

Job No: 200057

Weather: ~85 sunny

Wind Direction: NW

Wind Speed: 7 mph

TIME	LOCATION	PID (ppm)	DUST (mg/m ³)	ODORS	COMMENTS (activity; work zone, upwind or downwind)
700	UW	0.0	0.057	none	BACKGROUND
730	DW	0.0	0.069	none	interior work @ SW hospital building
800	UW	0.0	0.054	none	↓
830	DW	0.0	0.060	none	↓
900	UW	0.0	0.049	none	↓
930	DW	0.0	0.055	none	mobilize + prep @ power plant
1000	UW	0.0	0.051	none	↓
1030	WZ	0.0	0.058	none	caulking removed @ exterior
1100	DW	0.0	0.063	none	↓
1130	UW	0.0	0.056	none	↓
1200	WZ	0.0	0.061	none	↓ / lunch break
1230	DW	0.0	0.068	none	↓
1300	UW	0.0	0.043	none	↓
1330	WZ	0.0	0.052	none	↓
1400	DW	0.0	0.055	none	↓
1430	UW	0.0	0.050	none	↓
1500	WZ	0.0	0.059	none	↓
1530	DW	0.0	0.064	none	↓
1600	UW	0.0	0.039	none	clean up WA
1630	WZ	0.0	0.044	none	↓

Work Zone Action Levels	
PID	DUST
<5 ppm: Level D	<0.150 mg/m ³ above background in breathing zone:
Between 5 ppm and 50 ppm: level C	level D
>50 ppm: STOP	>0.150 mg/m ³ above background in breathing zone: Dust suppression

Community (Perimeter) Action Levels	
PID	DUST
>5 ppm above background: vapor suppression	>0.1 mg/m ³ above background: dust suppression
>25 ppm above background: STOP	>0.15 mg/m ³ above background: STOP