



Parameters	Units	AWQS	GW-4 3/4/2016
VOCs			
Trichloroethene	ug/L	5	6.3
SVOCs			
Benzo-a-Anthracene	ug/L	0.002	0.1
Benzo-b-Fluoranthene	ug/L	0.002	0.09
Benzo-k-Fluoranthene	ug/L	0.002	0.09
Chrysene	ug/L	0.002	0.1
Indeno(1,2,3-cd)Pyrene	ug/L	0.002	0.05

Note:

In March 2016, CE performed a Phase II ESA at the Subject Property. The groundwater samples showed evidence of impact from historic fuel oil and gasoline operations. The maximum fuel oil related SVOCs in groundwater was 13,000 ug/L.

In February 2017, CE performed a Supplemental Subsurface Investigation (SSI) at the Subject Property. The SSI concluded that the existing groundwater contamination originated from the fuel oil application on the Subject Property; and that the extent of the existing groundwater contamination is limited within the Site boundary.

Parameters	Units	AWQS	GW-3 3/3/2016
VOCs			
Isopropylbenzene	ug/L	5	14
Naphthalene	ug/L	10	100
n-Butylbenzene	ug/L	5	16
n-Propylbenzene	ug/L	5	18
sec-Butylbenzene	ug/L	5	18
SVOCs			
Benzo-a-Anthracene	ug/L	0.002	0.55
Benzo-b-Fluoranthene	ug/L	0.002	0.35
Benzo-k-Fluoranthene	ug/L	0.002	0.29
Chrysene	ug/L	0.002	0.55
Naphthalene	ug/L	10	64

Parameters	Units	AWQS	GW-1 3/3/2016
VOCs			
Isopropylbenzene	ug/L	5	190
Naphthalene	ug/L	10	870
n-Butylbenzene	ug/L	5	240
n-Propylbenzene	ug/L	5	400
sec-Butylbenzene	ug/L	5	220
SVOCs			
Naphthalene	ug/L	10	760
Phenanthrene	ug/L	50	340

Parameters	AWQS	GW-6 02/15/2017
VOCs		
1,2,4-Trimethylbenzene	5	20
1,3,5-Trimethylbenzene	5	6
Ethylbenzene	5	5.9
n-Propylbenzene	5	5.9
Naphthalene	10	23
SVOCs		
Chrysene	0.002	0.57
Naphthalene	10	68
Phenanthrene	50	59

Parameters	Units	AWQS	GW-2 3/3/2016
VOCs			
Naphthalene	ug/L	10	420
n-Butylbenzene	ug/L	5	150
n-Propylbenzene	ug/L	5	130
sec-Butylbenzene	ug/L	5	130
SVOCs			
Fluorene	ug/L	50	1,700
Naphthalene	ug/L	10	2,900
Phenanthrene	ug/L	50	2,900

Parameters	Units	AWQS	GW-5 3/4/2016
VOCs			
Ethylbenzene	ug/L	5	22
Isopropylbenzene	ug/L	5	160
n-Butylbenzene	ug/L	5	41
n-Propylbenzene	ug/L	5	170
p-Isopropyltoluene	ug/L	5	48
sec-Butylbenzene	ug/L	5	49
SVOCs			
Chrysene	ug/L	0.002	0.24
Naphthalene	ug/L	10	16

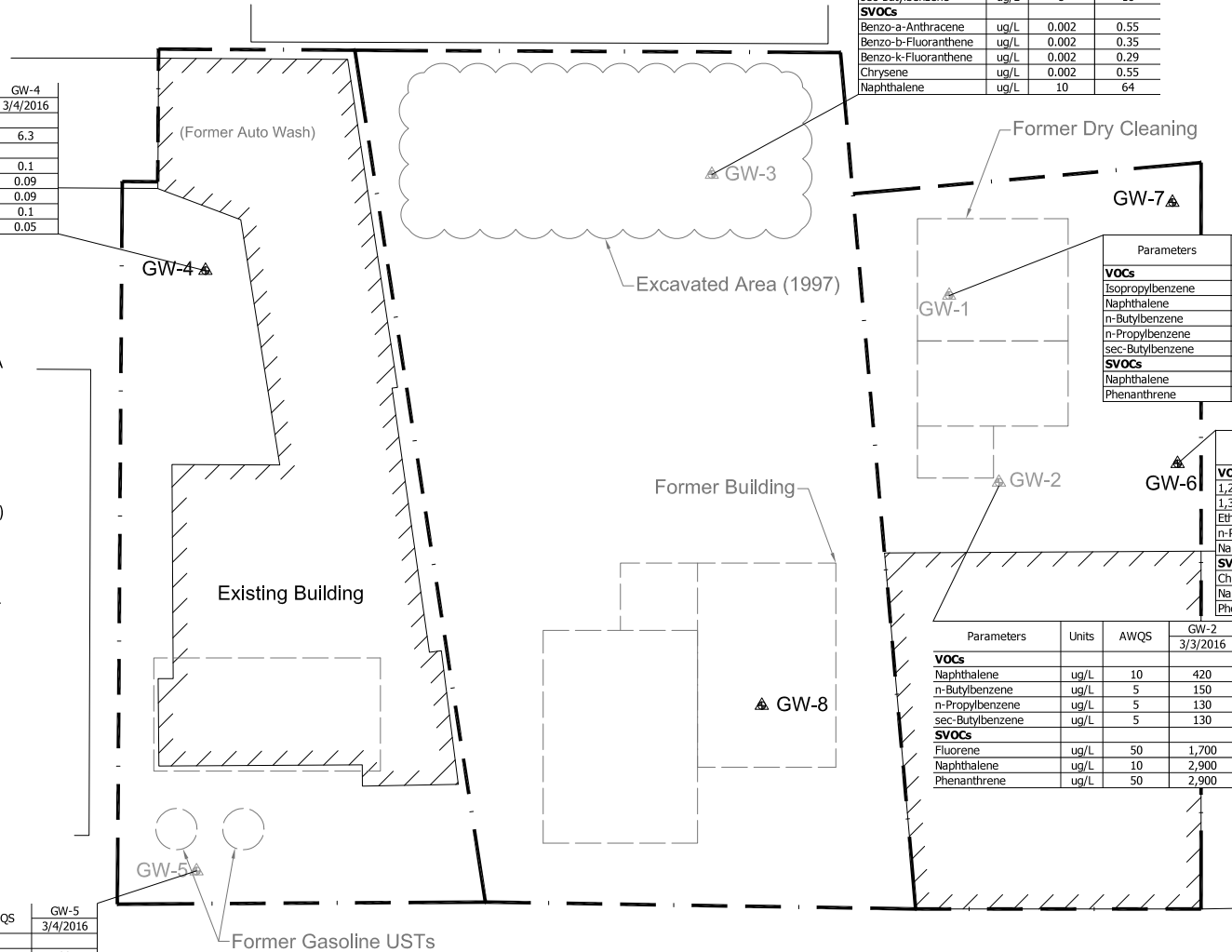

Groundwater Flow Direction

Huguenot Street

Scale in Feet



Legend

- ▲ SSI Groundwater Temporary Well
- ▲ Phase II Groundwater Temporary Well

The information included on this graphic representation has been compiled from a variety of sources and is subject to change without notice. Cider Environmental makes no representations or warranties, express or implied, as to accuracy, completeness, timeliness, or rights to the use of such information. This document is not intended for use as a land survey product nor is it designed or intended as a construction design document. The use or misuse of the information contained on this graphic representation is at the sole risk of the party using or misusing the information.

TITLE: Summary of Exceedances- Groundwater			
381-393 Huguenot Street, New Rochelle, New York			
DRAWN BY:	WF	REVISED BY:	
CHECKED BY:	JC	REVISED DATE:	
DATE:	2-23-2017	APPROVED BY:	
SCALE:	1" = 25'	FILE NAME:	
PROJECT No. 2015-188		FIGURE No. 05	

Tel: (631) 616-4000 Fax: (631) 988-7972
www.CiderEnvironmental.com
6288 Jericho Tpke, Suite 12, Commack, NY 11725