



57 MALL DRIVE  
 COMMACK, NEW YORK 11725  
 516-864-4200  
 FAX: 516-864-8494

DATE: 12/8/97

SUBMITTED BY:

NAME: J.R. Myers

NO. OF PAGES (INCLUDING COVER): 13

SEND TO:

NAME: Angela Chechile

FIRM/UNIT: New Rochelle Sensors Ltd.

FAX NUMBER: 914-632-8142

HANDLING INSTRUCTIONS:

- |   |  |
|---|--|
| <input type="checkbox"/> HIGH PRIORITY        | <input type="checkbox"/> CALL WHEN COMPLETED         |
| <input type="checkbox"/> NORMAL PROCESSING    | <input type="checkbox"/> CALL TO CONFIRM TRANSMITTAL |
| <input type="checkbox"/> OTHER(SPECIFY) _____ |  |

COMMENTS:

Report for 391 Huguenot St.  
Any questions, please call me.

PHO\_FAX.DOC



December 5, 1997

Chechile Realty  
Amelia Earhart Lane  
Rye, New York 10580

Attention: Angela Chechile

Reference: 391 Huguenot Street, New Rochelle, New York

Dear Ms. Chechile:

As per your request, Phoenix Environmental collected three sidewall (3) soil samples from the excavation found at the above referenced location. A sample was also collected from the water present in the bottom of the excavation. All soil samples were retrieved at least 6-inches beneath the surface of the excavation sidewall, approximately 3-feet below grade. The soil sampling locations were designated as ES-1, ES-2 and ES-3 and are shown on the attached site plan. All samples were collected in the appropriate containers, placed in a cooler at 4°C and delivered to EcoTest Laboratories, Inc., North Babylon, New York for analysis. Each sample was analyzed for volatile and semi-volatile organics typically found in petroleum products in accordance with EPA Methods 8021 and 8270.

Except for methyl tert butyl ether (MTBE), no organic compounds were detected in the collected water sample (SW-1). MTBE was measured at 3 ug/l, which is below the New York State Department of Environmental Conservation (NYSDEC) groundwater standard of 50 ug/l. Complete laboratory report can be found in Attachment A.

As shown in Table 2, target compounds were measured in the excavation sidewall at sampling location ES-2 that exceed the NYSDEC soil clean-up guidance levels. No compounds were found at sampling locations ES-1 or ES-3 that exceeded the guidance levels. Complete laboratory results can be found in Attachment A.

The results suggest that petroleum impacted soil is still present in the subsurface near sampling location ES-2. However, the exact extent of the impact is unknown.

If you have any questions or need any additional information, please give us a call.

Very truly yours,  
PHOENIX ENVIRONMENTAL

  
Jed A. Myers, Ph.D.  
ohoo116.rpt

**TABLE 1. VOLATILE ORGANICS, SEMI-VOLATILE ORGANICS AND METHYL-TERT-BUTYL-ETHER (MTBE) MEASURED IN SOIL SAMPLES COLLECTED FROM EXCAVATION SIDEWALLS ON NOVEMBER 14, 1997, AND NEW YORK STATE DEPARTMENT OF CONSERVATION SOIL CLEANUP GUIDANCE LEVELS**

PARAMETER	SAMPLING LOCATION (a)			SOIL GUIDANCE VALUES (b)
	ES-1	ES-2	ES-3	
	ug/kg			
Methyl-Tert-Butyl Ether	ND	ND	ND	1,000
Benzene	ND	ND	ND	14
Ethylbenzene	ND	ND	ND	100
Toluene	ND	ND	ND	100
o-Xylene	ND	ND	ND	100
m+p-Xylene	ND	ND	ND	100
Isopropylbenzene	ND	ND	ND	100
n-Propylbenzene	ND	ND	ND	100
p-Isopropyltoluene	?	ND	ND	100
1,2,4-Trimethylbenzene	ND	ND	ND	100
1,3,5-Trimethylbenzene	ND	ND	ND	100
n-Butylbenzene	ND	ND	ND	100
sec-Butylbenzene	ND	ND	ND	100
tert-Butylbenzene	ND	ND	ND	100
Naphthalene	ND	44	ND	200
Acenaphthene	ND	31	ND	400
Fluorene	ND	31	ND	1,000
Phenanthrene	ND	240	36	1,000
Anthracene	ND	66	ND	1,000
Fluoranthene	64	430	37	1,000
Pyrene	ND	820	ND	1,000
Benzo(a)anthracene	ND	330	ND	0.04
Chrysene	ND	360	ND	0.04
Benzo(b)fluoranthene	ND	365 (c)	ND	0.04
Benzo(k)fluoranthene	ND	365 (c)	ND	0.04
Benzo(a)pyrene	ND	420	ND	0.04
Dibenz(a,h)anthracene	ND	ND	ND	1,000
Indeno(1,2,3-cd)pyrene	ND	300	ND	0.04
Benzo(ghi)perylene	ND	300	ND	0.04

(a): Refer to site plan for sampling locations

(b): Soil cleanup guidance values listed in NYSDDEC STARS Memo #1, Petroleum Contaminated Soil Guidance Policy, August 1992

(c): Total = 730 ug/kg, unable to separate isomers.

ND: Non-Detect, below method detection limit.

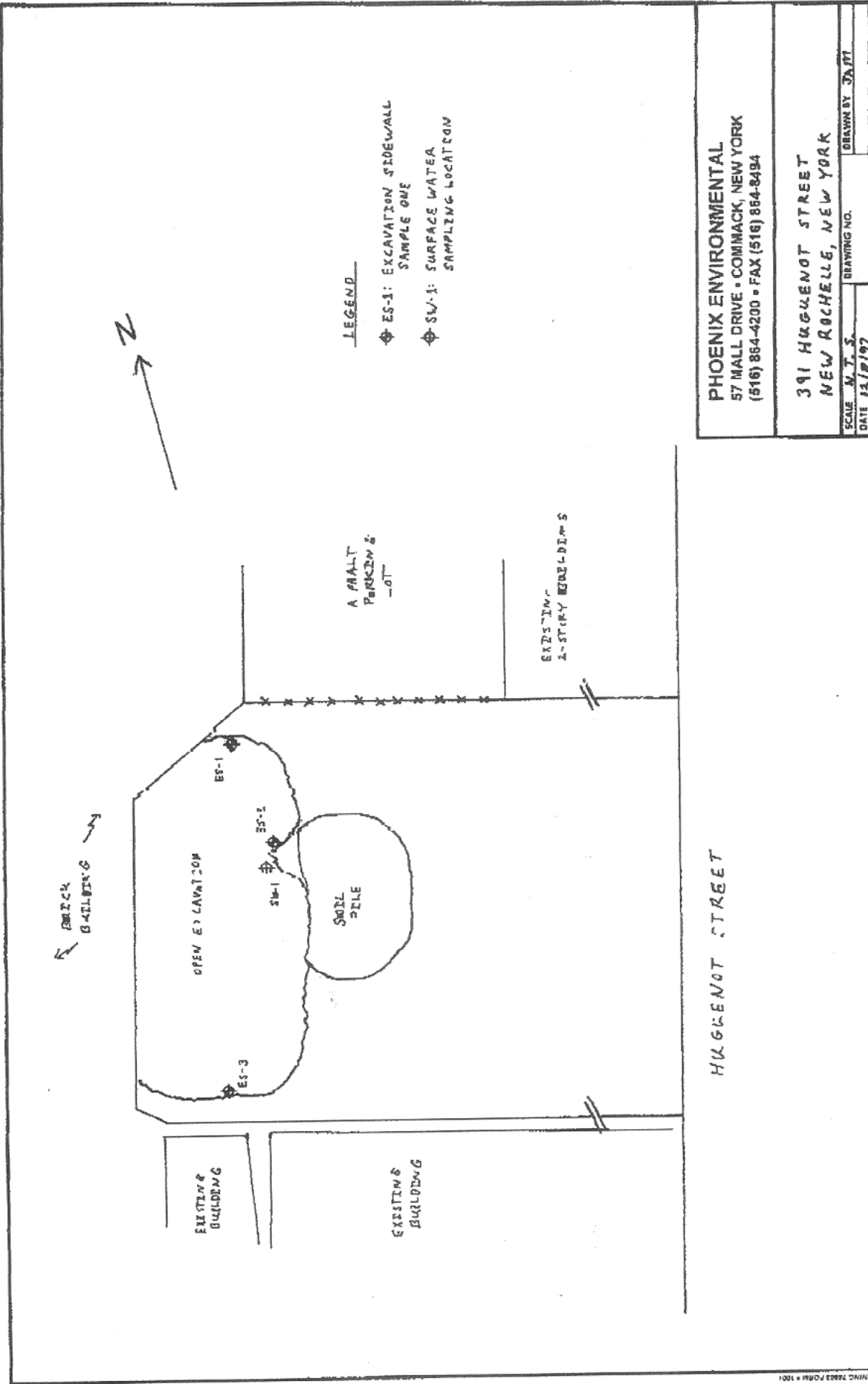

**ECOTEST** LABORATORIES, INC.

## ENVIRONMENTAL TESTING

377 SHEFFIELD AVE. • N. BABYLON, N.Y. 11703 • (516) 422-5777 • FAX (516) 422-5770

LAB NO. C974820/1

12/01/97

Phoenix Environmental  
57 Mall Drive  
Commack, NY 11725

ATTN: Jed Myers

SOURCE OF SAMPLE: 391 Huguenot St., New Rochelle  
COLLECTED BY: Client DATE COL'D: 11/14/97 RECEIVED: 11/14/97

SAMPLE: Soil sample, ES-1, 1:00 pm

## ANALYTICAL PARAMETERS

## ANALYTICAL PARAMETERS

ter-ButylMethylEther	ug/Kg	<2
Benzene	ug/Kg	<2
Toluene	ug/Kg	<2
Ethyl Benzene	ug/Kg	<2
m + p Xylene	ug/Kg	<4
o Xylene	ug/Kg	<2
Xylene	ug/Kg	<6
Isopropylbenzene	ug/Kg	<2
n-Propylbenzene	ug/Kg	<2
135-Trimethylbenzene	ug/Kg	<2
124-Trimethylbenzene	ug/Kg	<2
sec-Butylbenzene	ug/Kg	<2
p-Isopropyltoluene	ug/Kg	2
n-Butylbenzene	ug/Kg	<2
Naphthalene	ug/Kg	<2
tert-Butylbenzene	ug/Kg	<2
% Solids		81

cc:

REMARKS: EPA Method 8021.

DIRECTOR 

**ECOTEST** LABORATORIES, INC.

## ENVIRONMENTAL TESTING

377 SHEFFIELD AVE. • N. BABYLON, N.Y. 11703 • (516) 422-5777 • FAX (516) 422-5770

LAB NO. C974820/1

12/01/97

Phoenix Environmental  
57 Mall Drive  
Commack, NY 11725  
ATTN: Jed Myers

SOURCE OF SAMPLE: 391 Huguenot St., New Rochelle  
COLLECTED BY: Client DATE COL'D: 11/14/97 RECEIVED: 11/14/97

SAMPLE: Soil sample. ES-1, 1:00 pm  
UNITS: ug/Kg

## ANALYTICAL PARAMETERS

Naphthalene	<30
Acenaphthene	<30
Fluorene	<30
Phenanthrene	<30
Anthracene	<30
Fluoranthene	84
Pyrene	<300
Benzo(a)anthracene	<300
Chrysene	<300
Benzo(b)fluoranthene	<300
Benzo(k)fluoranthene	<300
Benzo(a)pyrene	<300
Dibenzo(a,h)anthracene	<300
Indeno(1,2,3-cd)pyrene	<300
Benzo(ghi)perylene	<300

## ANALYTICAL PARAMETERS

cc:

REMARKS: EPA Method 625.  
Elevated detection limit due to interference in sample.

DIRECTOR 

rn= 29659

NYSDOH ID# 10320

**ECOTEST LABORATORIES, INC.****ENVIRONMENTAL TESTING**

117 SHERRILL BLVD • NEW HAVEN, CT 06511 (616) 822-6777 • FAX (616) 822-6770

LAB NO. C974820/2

12/01/97

Phoenix Environmental  
57 Mall Drive  
Commack, NY 11725  
ATTN: Ted Hyatt

SOURCE OF SAMPLE: 391 Huguenot St., New Rochelle  
COLLECTED BY: Client DATE COL'D: 11/14/97 RECEIVED: 11/14/97

SAMPLE: Soil sample, ES-2, 1:05 pm

## ANALYTICAL PARAMETERS

ter-ButylMethylEther	ug/Kg	<2
Benzene	ug/Kg	<2
Toluene	ug/Kg	<2
Ethyl Benzene	ug/Kg	<2
m + p Xylene	ug/Kg	<4
o Xylene	ug/Kg	<2
Xylene	ug/Kg	<6
Isopropylbenzene	ug/Kg	<2
n-Propylbenzene	ug/Kg	<2
135-Trimethylbenzene	ug/Kg	<2
124-Trimethylbenzene	ug/Kg	<2
sec-Butylbenzene	ug/Kg	<2
p-Isopropyltoluene	ug/Kg	<2
m-Butylbenzene	ug/Kg	<1
Naphthalene	ug/Kg	<2
tert-Butylbenzene	ug/Kg	<2

% DILUTE 00

## ANALYTICAL PARAMETERS

cc:

REMARKS: EPA Method 8021.

DIRECTOR \_\_\_\_\_

rn= 29662

NYSDOH ID# 10320

**ECOTEST** LABORATORIES, INC.

## ENVIRONMENTAL TESTING

377 SHEFFIELD AVE. • N. BABYLON, N.Y. 11703 • (516) 422-5777 • FAX (516) 422-5770

LAB NO. C974820/2

12/01/97

Phoenix Environmental  
57 Mall Drive  
Commack, NY 11725

ATTN: Jed Myers

SOURCE OF SAMPLE: 391 Huguenot St., New Rochelle  
COLLECTED BY: Client DATE COL'D: 11/14/97 RECEIVED: 11/14/97

SAMPLE: Fall sample, EC D, 1:08 pm

UNITS: ug/Kg

## ANALYTICAL PARAMETERS

Naphthalene	44
Acenaphthene	31
Fluorene	31
Phenanthrene	240
Anthracene	66
Fluoranthene	430
Pyrene	820
Benzo(a)anthracene	330
Chrysene	360
Benzo(b)fluoranthene	365
Benzo(k)fluoranthene	365^^
Benzo(a)pyrene	420
Dibenzo(a,h)anthracene	<300
Indeno(1,2,3-cd)pyrene	300
Benzo(ghi)perylene	300

## ANALYTICAL PARAMETERS

CC:

REMARKS: EPA Method 625.

^^Total = 730 ug/Kg, unable to separate isomers.

DIRECTOR 

rn= 29661

NYSDOH ID# 10320



**ECOTEST LABORATORIES, INC.****ENVIRONMENTAL TESTING**

377 SHEFFIELD AVE. • N. BABYLON, N.Y. 11703 • (516) 422-5777 • FAX (516) 422-5770

LAB NO. G974820/3

12/01/97

Phoenix Environmental  
57 Mall Drive  
Commack NY 11796  
ATTN: Jed Myers

SOURCE OF SAMPLE: 391 Huguenot St., New Rochelle  
COLLECTED BY: QIANG DATE COL'D: 11/14/97 RECEIVED: 11/14/97

SAMPLE: Soil sample, ES-3, 1:15 pm

## ANALYTICAL PARAMETERS

## ANALYTICAL PARAMETERS

ter-ButylMethylEther	ug/Kg	<2
Benzene	ug/Kg	<2
Toluene	ug/Kg	<2
Ethyl Benzene	ug/Kg	<2
m + p Xylene	ug/Kg	<4
o Xylene	ug/Kg	<2
Xylene	ug/Kg	<6
Isopropylbenzene	ug/Kg	<2
n-Propylbenzene	ug/Kg	<2
135-Trimethylbenzene	ug/Kg	<2
124-Trimethylbenzene	ug/Kg	<2
sec-Butylbenzene	ug/Kg	<2
p-Isopropyltoluene	ug/Kg	<2
n-Butylbenzene	ug/Kg	<2
Naphthalene	ug/Kg	<2
tert-Butylbenzene	ug/Kg	<2
% Solids		79

cc:

REMARKS: EPA Method 8021.

DIRECTOR 

# ECOTEST LABORATORIES, INC.

## ENVIRONMENTAL TESTING

377 SHEFFIELD AVF. • N. HAVEN, NY 11703 • (516) 422-5777 • FAX (516) 422-5770

LAB NO. C9/4820/3

12/01/97

Phoenix Environmental  
57 Mall Drive  
Commack, NY 11725

ATTN: Jed Myers

SOURCE OF SAMPLE: 391 Huguenot St., New Rochelle  
COLLECTED BY: GILBERT DATE COL'D. 11/14/97 RECEIVED: 11/14/97

SAMPLE: Soil sample, ES-3, 1:15 pm  
UNITS: ug/Kg

### ANALYTICAL PARAMETERS

Naphthalene	<30
Acenaphthene	<30
Fluorene	<30
Phenanthrene	36
Anthracene	<30
Fluoranthene	37
Pyrene	<300
Benzo(a)anthracene	<300
Chrysene	<300
Benzo(b)fluoranthene	<300
Benzo(k)fluoranthene	<300
Benzo(a)pyrene	<300
Dibenzo(a,h)anthracene	<300
Indeno(1,2,3-cd)pyrene	<300
Benzo(ghi)perylene	<300

### ANALYTICAL PARAMETERS

cc:

REMARKS: EPA Method 625.  
Elevated detection limits due to interference in sample.

DIRECTOR

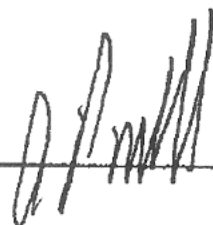

rn= 29663

NYSDOH ID# 10320

**ECOTEST LABORATORIES, INC.****ENVIRONMENTAL TESTING**

377 SHEFFIELD AVE. • N. BABYLON, N.Y. 11703 • (516) 422-5777 • FAX (516) 422-5770

LAB NO. C974820/4

12/01/97

Phoenix Environmental  
57 Mall Drive  
Commack, NY 11725  
ATTN: Jed Myers

SOURCE OF SAMPLE: 391 Huguenot St., New Rochelle  
COLLECTED BY: Client DATE COL'D: 11/14/97 RECEIVED: 11/14/97

SAMPLE: Water sample, SW-1, 1:30 pm

ANALYTICAL PARAMETERS		
ter-ButylMethylEther	ug/L	3
Benzene	ug/L	<1
Toluene	ug/L	<1
Ethyl Benzene	ug/L	<1
m + p Xylene	ug/L	<2
o Xylene	ug/L	<1
Xylene	ug/L	<3
Isopropylbenzene	ug/L	<1
n-Propylbenzene	ug/L	<1
135-Trimethylbenzene	ug/L	<1
124 Trimethylbenzene	ug/L	<1
sec-Butylbenzene	ug/L	<1
p-Isopropyltoluene	ug/L	<1
n-Butylbenzene	ug/L	<1
Naphthalene	ug/L	<1
tert-Butylbenzene	ug/L	<1

## ANALYTICAL PARAMETERS

cc:

REMARKS: EPA Method 8021.

DIRECTOR 

# ECOTEST LABORATORIES, INC.

## ENVIRONMENTAL TESTING

377 SHEFFIELD AVE. • N. BABYLON, N.Y. 11703 • (516) 422-5777 • FAX (516) 422-5770

LAB NO. C974820/4

12/01/97

Phoenix Environmental  
57 Mall Drive  
Commack, NY 11725

ATTN: Jed Myers

SOURCE OF SAMPLE: 391 Huguenot St., New Rochelle  
COLLECTED BY: Client DATE COLLECTED: 11/14/97 RECEIVED: 11/14/97

SAMPLE: Water sample, SW-1, 1:30 pm  
UNITS: ug/L

### ANALYTICAL PARAMETERS

Naphthalene	<1
Acenaphthene	<1
Fluorene	<1
Phenanthrene	<1
Anthracene	<1
Fluoranthene	<1
Pyrene	<1
Benzo(a)anthracene	<1
Chrysene	<1
Benzo(b)fluoranthene	<1
Benzo(k)fluoranthene	<1
Benzo(a)pyrene	<1
Dibenzo(a,h)anthracene	<1
Indeno(1,2,3-cd)pyrene	<1
Benzo(ghi)perylene	<1

### ANALYTICAL PARAMETERS

oo:

REMARKS: EPA Method 625.

DIRECTOR

