



Quality Environmental Solutions & Technologies, Inc.

**PRE-DEMOLITION SURVEY REPORT
FOR
ASBESTOS-CONTAINING MATERIALS (ACM)**

**Prepared for:
PVE, LLC
48 Springside Ave
Poughkeepsie, NY 12603**

at

**164 Garden Street
Poughkeepsie, NY 12601**

January 29, 2020

QuES&T Project #Q20-3106

QuES&T

Quality Environmental Solutions & Technologies, Inc.

January 29, 2020

PVE, LLC
48 Springside Ave
Poughkeepsie, NY 12603

ATTN: Conor Tarbell

Via E-mail: ctarbell@pve-llc.com

Re: 164 Garden Street
Poughkeepsie, NY 12601
Pre-Demolition Asbestos Inspection
QuES&T Project #Q20-3106

Dear Mr. Tarbell,

Attached is the Pre-Demolition Inspection Report for Asbestos-containing Materials (ACM) identified throughout interior and exterior areas included within the above-referenced location(s) by **Quality Environmental Solutions & Technologies, Inc. (QuES&T)**. The inspection included visual assessment and representative sampling for the detection of ACM in compliance with the requirements of Title 12 NYCRR Part 56-5.1.

The attached report summarizes the inspection protocol and inspection results for your review. **QuES&T** believes this report accurately reflects the material condition existing in the functional spaces at the time of our inspection.

Should you wish to discuss this matter further or require additional information concerning this submittal, please contact us at (845) 298-6031. **QuES&T** appreciates the opportunity to assist PVE, LLC in the environmental services area.

Sincerely,

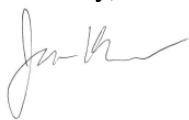

James Klemm

Field & Technical Services
NYS/AHERA Inspector
Cert. #AH 13-11486
NYS Mold Assessor #MA01616

QuES&T

Quality Environmental Solutions & Technologies, Inc.

TABLE OF CONTENTS

I.	Introduction	Page 1
II.	Inspection Summary	Page 2
III.	Identified Asbestos-containing Materials (ACM)	Page 3
IV.	General Discussion	Page 3
V.	Abatement Required	Page 4
VII.	Disclaimers	Page 5
Appendix A	ACM Location Drawings & Photos	
Appendix B	Sample Locations & Results	
Appendix C	Personnel Licenses & Certifications	

I. INTRODUCTION:

Quality Environmental Solutions & Technologies, Inc. (**QuES&T**) performed a Pre-Demolition Asbestos Survey, in conformance with Title 12 NYCRR Part 56-5.1, on January 9th, 2020 for PVE, LLC in support of the planned demolition of the building located at 164 Garden Street, Poughkeepsie, NY 12601. The survey included a visual inspection / assessment for Presumed Asbestos-containing Materials (PACM) and suspect miscellaneous Asbestos-containing Materials (ACM) throughout accessible interior and exterior locations to be affected by future demolition activities.

QuES&T established functional spaces based either on physical barriers (i.e. walls, doors, etc.) or homogeneity of material. Within each functional space identified, a visual inspection was performed using reasonable care and judgment, to identify and assess location, quantity, friability and condition of all accessible installed ACM building materials observed at the affected portion of the building/structure.

Limited localized demolition of building surfaces was performed, as part of this survey, to access concealed surfaces. No disassembly of installed equipment was conducted as part of this inspection. ACM concealed within structural components and equipment interiors or that is accessible only through extensive mechanical or structural demolition may not have been identified as part of this survey. When any construction activity, such as demolition, remodeling, renovation or repair work, reveals PACM or suspect miscellaneous ACM that has not been identified, as part of this survey, all construction activities shall cease in the affected area.

The survey included both visual inspection of accessible spaces and representative sampling of suspect building materials for ACM. Samples collected were analyzed by a laboratory approved under the New York State Department of Health Environmental Laboratory Approval Program (NYSDOH ELAP). Samples were analyzed in the laboratory by Polarized Light Microscopy (PLM), Polarized Light Microscopy-NOB (PLM-NOB) and/or Quantitative Transmission Electron Microscopy (QTEM), as required. Sample collection and laboratory analysis were conducted in compliance with the requirements of Title 12 NYCRR Part 56-5.1, 29 CFR 1926.1101 and standard EPA & OSHA accepted methods. Samples consisting of multiple layers were separated and analyzed independently in the laboratory.

Certified **QuES&T** personnel (Appendix C), Mr. James Klemm (Cert. #AH 13-11486) performed visual assessments throughout interior and exterior demolition areas. A total of one hundred and ninety-five (**195**) samples of installed and accessible suspect building materials were analyzed by a laboratory approved under the NYSDOH ELAP. Forty-six (46) samples were analyzed using Polarized Light Microscopy (PLM) for friable materials; seventy-seven (77) samples were analyzed using Polarized Light Microscopy (PLM-NOB) for non-friable organically bound materials; and seventy-two (72) samples were analyzed by Confirmatory-QTEM following negative-determinations using PLM-NOB protocols.

II. INSPECTION SUMMARY:

A visual inspection was performed and homogenous material types were established based on appearance, color and texture. The findings presented in this report are based upon reasonably available information and observed site conditions at the time the assessment was performed. The findings and conclusions of this report are not meant to be indicative of future conditions at the site and does not warrant against conditions that were not evident from visual observations or historical information obtained from others.

Representative bulk sampling was performed on suspect building materials for laboratory analysis using PLM, PLM-NOB, and/or QTEM. The following is a summary of installed building materials sampled:

- Wall Materials – Joint Compound, Sheetrock, Tape, Cove Base Molding & Adhesive (Multiple Varieties), Fiberboard & Adhesive, Adhesives (Multiple Varieties), Corkboard, Ceramic Tile Systems (Adhesive, Grout, etc.), Cementitious Block & Mortar, Cement Panel, Stucco.
- Ceiling Materials – Joint Compound, Tape, Ceiling Tiles (Multiple Varieties), Cement Panel.
- Flooring Materials – Ceramic Tile Systems (Grout, Mudset, etc.), Carpet Mastic, Peel ‘N’ Stick Floor Tile, Modified Flooring, Floor Tile & Mastic, Cementitious Slab.
- Roofing Materials – Rolled Roofing, Built-up Roofing, Fiberboard, Isofoam, EPDM, Flashing Tars, White Coating.
- Miscellaneous Materials – Fiber Panel, Flue Packing, Vibration Dampener, Window Glazing, Caulk (Multiple Varieties).

III. IDENTIFIED ASBESTOS-CONTAINING MATERIALS (ACM):

IDENTIFIED ACM
164 GARDEN STREET, POUGHKEEPSIE, NY 12601
(Refer to Appendix A for details)

KEY: **ACM** = Materials containing greater than 1% of asbestos;
LF = Linear Feet; **SF** = Square Feet; **PACM** = Presumed Asbestos-containing Materials;
Friable = ACM capable of being released into air, and which can be crumbled, pulverized, powdered, crushed or exposed by hand-pressure.

Location	Material	Approximate Quantity	Friable?	Condition
164 Garden Street (Interiors)				
Room 1, Walls & Ceiling	Cement Panels	320 SF	No	Good
Bathrooms 3 & 4, Wall, Behind Ceramic Tile, on Cementitious Block	Adhesive	300 SF	No	Good
Garage 2, Open Space Above Ceilings of Bathrooms 3 & 4, Under HVAC Equipment	Fiber Panel	50 SF	Yes	Good
Multiple Rooms, Walls & Ceilings, on Sheetrock	Joint Compound	3,500 SF	Yes	Good
164 Garden Street (Exteriors)				
Roof, Field, Second Layer	Built-up Roofing	4,000 SF	No	Good
Roof, Perimeter Flashing, Second Layer	Tar	400 SF	No	Good
Roof, Equipment Flashing, On Metal	Flashing Tar	20 SF	No	Good
Roof, Pitch Pocket	Tar	10 SF	Yes	Good

IV. GENERAL DISCUSSION:

All construction personnel as well as individuals who have access to locations where asbestos containing materials (ACM) exists should be informed of its presence and the proper work practices in these areas. Conspicuous labeling of all ACM is suggested to ensure personnel is adequately informed. Personnel should be informed not to rest, lean or store material or equipment on or near these surfaces and not to cut, saw, drill, sand or disturb ACM. All removal, disturbance, and repair of ACM should be performed in compliance with Title 12 NYCRR Part 56 by persons properly trained to handle ACM. Facility custodial and maintenance personnel should receive training commensurate with their work activities; as defined in 29 CFR 1910.1001.

The findings presented in this report are based upon reasonably available information and observed site conditions at the time the assessment was performed. Conditions may have changed since that time and the findings and conclusions of this report are not meant to be indicative of future conditions at the Site. This report does not warrant against conditions that were not evident from visual observations or historical information obtained, or conditions that could only be determined by physical sampling or other intrusive investigation techniques that are outside the proposed scope of work.

V. ABATEMENT REQUIRED:

As specified in Title 12 NYCRR Part 56-5.1 (h) and (i), "If the building/structure asbestos survey finds that the portion of the building/structure to be demolished, renovated, remodeled, or have repair work contains ACM, PACM, suspect miscellaneous ACM assumed to be ACM, or asbestos material, which is impacted by the work, the owner or the owner's agent shall conduct, or cause to have conducted, asbestos removal performed by a licensed asbestos abatement contractor in conformance with all standards set forth in this Part. All ACM, PACM, suspect miscellaneous ACM assumed to be ACM, or asbestos material impacted by the demolition, renovation, remodeling or repair project shall be removed as per this Part, prior to access or disturbance by other uncertified trades or personnel. No demolition, renovation, remodeling or repair work shall be commenced by any owner or the owner's agent prior to the completion of the asbestos abatement in accordance with the notification requirements of this Part...All building/structure owners and asbestos abatement contractors on a demolition, renovation, remodeling, or repair project, which includes work covered by this part, shall inform all trades on the work site about PACM, ACM, asbestos material and suspect miscellaneous ACM...Bids may be advertised and contracts awarded for demolition, remodeling, renovation, or repair work, but no work on the current intermediate portion of the project shall commence on the demolition, renovation, remodeling or repair work by any owner or agent prior to completion of all necessary asbestos abatement work for the current intermediate portion of the entire project, in conformance with all standards set forth in this Part."

Prior to conducting demolition or construction work at the building, all ACM affected/impacted by such activities shall be removed utilizing a licensed asbestos abatement contractor and NYSDOL/EPA/ NYC certified personnel prior to construction/demolition activities. All work conducted should be in accordance with all legal requirements, including but not limited to U.S. Environmental Protection Agency (EPA) National Emissions Standards for Hazardous Air Pollutants (NESHAP) [40 CFR Part 61], New York State Industrial Code Rule 56 Asbestos Regulations (ICR 56) and Chapter 1 of Title 15 of the Rules of the City of New York Regulations, as applicable. Advance notification of the asbestos project to the USEPA, NYSDOL, and NYCDEP may be required.

All suspect building materials not sampled during this survey should be considered ACM until these materials are sampled and analyzed for ACM in the laboratory. Concealed ACM: In addition to the ACMs identified at the site, there is a possibility that concealed ACM may exist at the subject facility. As such, if any concealed suspect ACM is encountered during future construction related activities, the work should immediately stop. Prior to resuming the work, the suspect ACM should either be 1) Sampled by an appropriately-certified asbestos professional and submitted to an Approved NYSDOH ELAP laboratory for asbestos analysis or 2) Presumed to be ACM (PACM) and removed by a licensed asbestos abatement contractor for disposal in accordance with all applicable regulations.

VII. DISCLAIMERS

It should be noted that the information contained within this report is based solely upon site observations and the results of laboratory analysis for samples collected by **QuES&T**. These observations and results are time dependent, subject to changing site conditions and revisions to Federal, State and Local regulations. **QuES&T** warrants that these findings have been promulgated after being prepared in general accordance with generally accepted practices in the abatement industries. **QuES&T** also recognizes that inspection laboratory data is not usually sufficient to make all abatement and management decisions.

Due to the potential for concealed Asbestos-containing Materials (ACM) or other regulated materials, this report should not be construed to represent all ACM or regulated materials within the site(s). All quantities of ACM or other regulated materials identified, and all dimensions listed within this report are approximate and should be verified On-site.

This inspection report is not intended to be used as the sole basis for soliciting pricing for asbestos abatement. An abatement plan, specification, drawing and/or Variances should be developed to identify scope, timing, phasing and remediation means & methods for any asbestos project. The Linear and/or Square Footages (LF / SF) listed within this Report are only approximates. Abatement Contractor(s) are required to visit the building(s) in order to take actual field measurements within each listed location.



Quality Environmental Solutions & Technologies, Inc.

Appendix A: ACM LOCATION DRAWINGS & PHOTOS

1376 Route 9, Wappingers Falls, NY 12590 Phone (845) 298-6031 Fax (845) 298-6251

NYS MWBD MBE Cert # 49952-2006 NYSUCP DBE Certified NJUCP DBE Certified www.Qualityenv.com

164 Garden Street

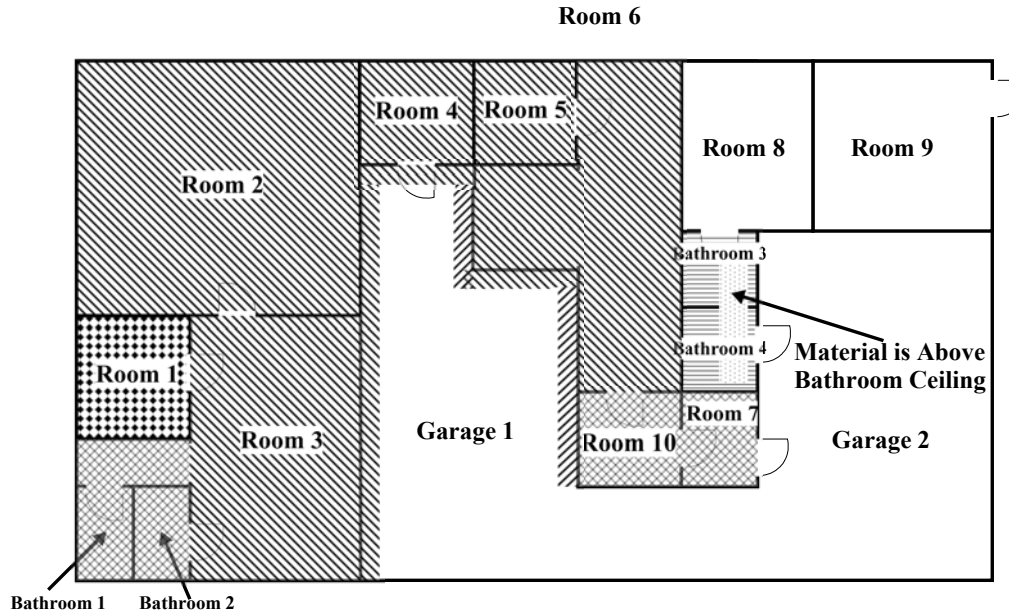

ACM LEGEND: (see report for details)	
	ACM Ceramic Tile Adhesive on Non-ACM CMU Walls & ACM Joint Compound on Non-ACM Sheetrock Ceiling
	ACM Cement Board on Walls and Ceiling
	ACM Fiber Panel Below Air Handler Units
	ACM Joint Compound on Non-ACM Sheetrock Walls
	ACM Joint Compound on Non-ACM Sheetrock Walls & Ceilings



First Floor Key Plan - ACM Locations

Drawing Not to Scale

This Drawing is not intended to be used as the sole basis for soliciting pricing for asbestos abatement. An abatement plan, specification, drawing and/or variances should be developed to identify scope, timing, phasing and remediation means & methods for any asbestos project.

PVE, LLC
48 Springside Ave
Poughkeepsie, NY 12603

164 Garden Street
Poughkeepsie, New York 12601



Quality Environmental
Solutions & Technologies, Inc.
1376 Route 9
Wappingers Falls, NY 12590
Phone: (845) 298-6031
Fax: (845) 298-6251

Date: 1-29-2020
Version # 1

Issued For:
Asbestos Survey

Project NO:
Q20-3106

Project Manager:
Rudy Lipinski

Drawing Prepared By:
James Klemm

ASB-01

164 Garden Street

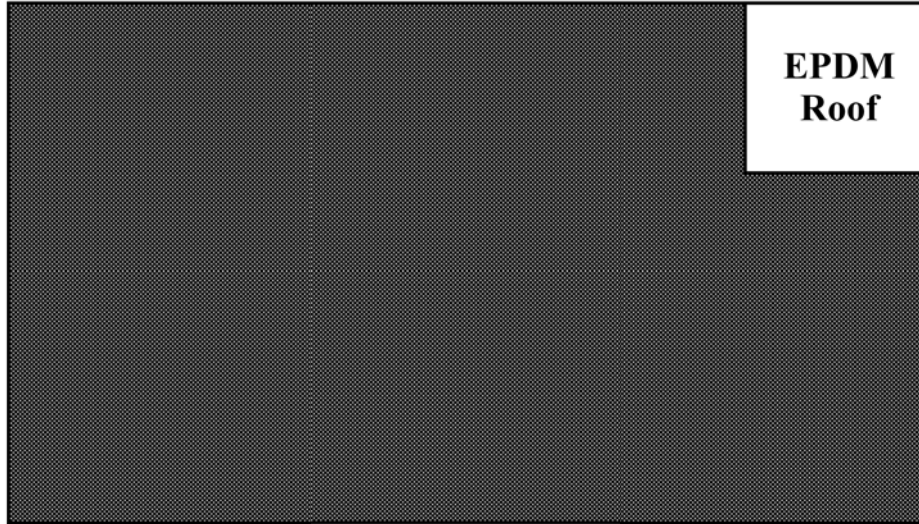

Roof Key Plan - ACM Locations

****Drawing Not to Scale****

This Drawing is not intended to be used as the sole basis for soliciting pricing for asbestos abatement. An abatement plan, specification, drawing and/or variances should be developed to identify scope, timing, phasing and remediation means & methods for any asbestos project.

ACM LEGEND: (see report for details)	
	ACM Roofing Throughout; Second Layer Built-up Roofing on Field, Second Layer Tar on Perimeter Flashing, Flashing Tar on Metal Vents/ Dunnage, Pitch Pocket Tar.

PVE, LLC
48 Springside Ave
Poughkeepsie, NY 12603

164 Garden Street
Poughkeepsie, New York 12601



Quality Environmental
Solutions & Technologies, Inc.
1376 Route 9
Wappingers Falls, NY 12590
Phone: (845) 298-6031
Fax: (845) 298-6251

Date: 1-29-2020	Version # 1
Issued For: Asbestos Survey	
Project NO: Q20-3106	
Project Manager: Rudy Lipinski	
Drawing Prepared By: James Klemm	

ASB-02



(ACM Ceramic Tile Adhesive Behind Ceramic Tiles in Bathroom 4)



(ACM Cement Panels on Walls & Ceiling in Room 1)



(ACM Fiber Panel Under HVAC Equipment in Garage 2)



(Circled in Red: Location of Fiber Panel under HVAC Equipment in Garage 2)



(ACM Joint Compound on Non-ACM Sheetrock Walls in Room 2)



(Roof with Second Layer ACM Built-up Roofing and Second Layer ACM Perimeter Flashing Tar)



(ACM Flashing Tar and ACM Pitch Pocket Tar on Roof)



Quality Environmental Solutions & Technologies, Inc.

Appendix B: SAMPLE LOCATIONS & RESULTS

1376 Route 9, Wappingers Falls, NY 12590 Phone (845) 298-6031 Fax (845) 298-6251

NYS MWBD MBE Cert # 49952-2006 NYSUCP DBE Certified NJUCP DBE Certified www.Qualityenv.com

164 Garden Street

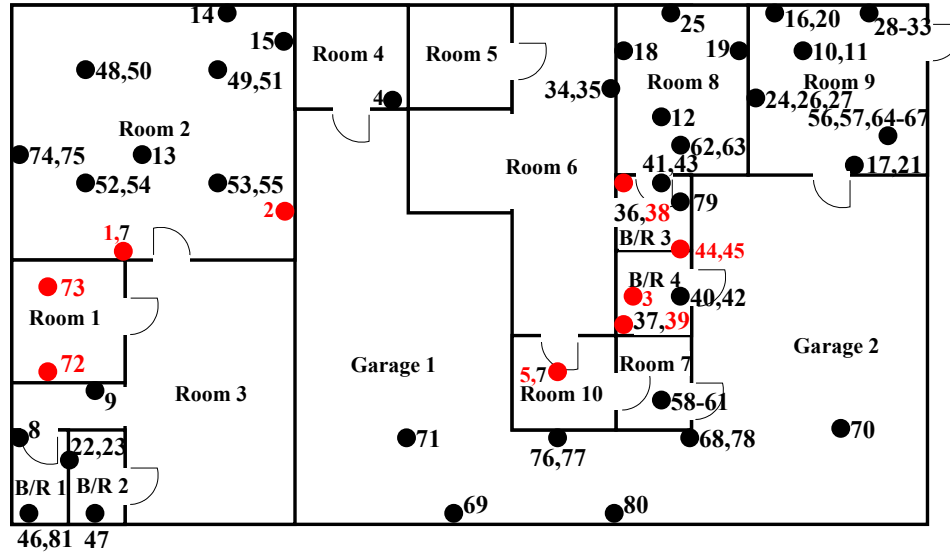

Room Key Plan - Sample Locations

Drawing Not to Scale

This Drawing is not intended to be used as the sole basis for soliciting pricing for asbestos abatement. An abatement plan, specification, drawing and/or variances should be developed to identify scope, timing, phasing and remediation means & methods for any asbestos project.

ACM LEGEND: (Please refer asbestos report for details)	
●	Non-ACM Sample Location
●	ACM Sample Location

PVE, LLC
48 Springside Ave
Poughkeepsie, NY 12603

164 Garden Street
Poughkeepsie, New York 12601



Quality Environmental
Solutions & Technologies, Inc.
1376 Route 9
Wappingers Falls, NY 12590
Phone: (845) 298-6031
Fax: (845) 298-6251

Date: 1-29-2020
Version #: 1

Issued For:
Asbestos Survey

Project NO:
Q20-3106

Project Manager:
Rudy Lipinski

Drawing Prepared By:
James Klemm

SL-01

164 Garden Street

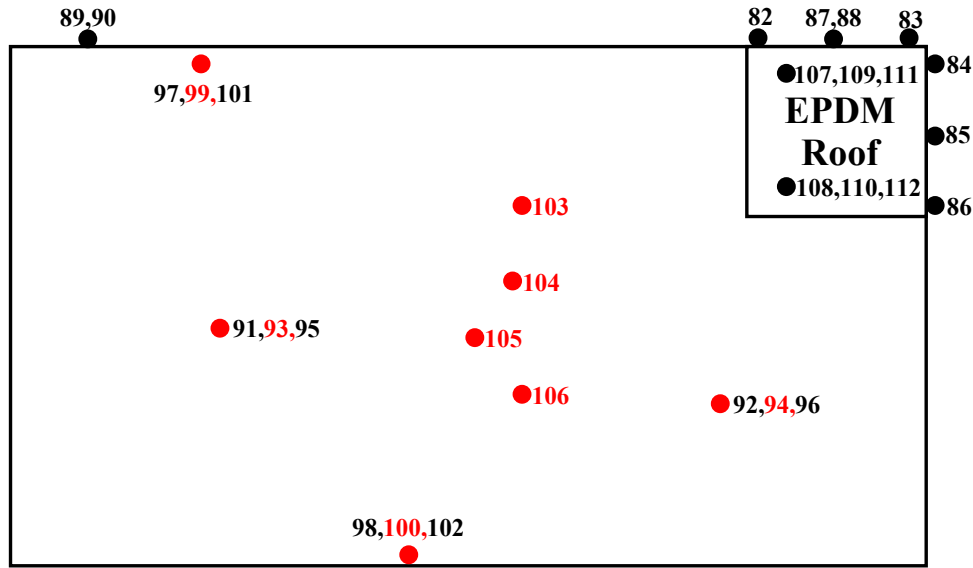

Exterior Key Plan - Sample Locations

Drawing Not to Scale

This Drawing is not intended to be used as the sole basis for soliciting pricing for asbestos abatement. An abatement plan, specification, drawing and/or variances should be developed to identify scope, timing, phasing and remediation means & methods for any asbestos project.

ACM LEGEND: (Please refer asbestos report for details)	
	Non-ACM Sample Location
	ACM Sample Location

PVE, LLC
48 Springside Ave
Poughkeepsie, NY 12603

164 Garden Street
Poughkeepsie, New York 12601



Quality Environmental
Solutions & Technologies, Inc.
1376 Route 9
Wappingers Falls, NY 12590
Phone: (845) 298-6031
Fax: (845) 298-6251

Date: 1-29-2020
Version #: 1

Issued For:
Asbestos Survey

Project NO:
Q20-3106

Project Manager:
Rudy Lipinski

Drawing Prepared By:
James Klemm

SL-02



EMSL Analytical, Inc.

307 West 38th Street New York, NY 10018
Tel/Fax: (212) 290-0051 / (212) 290-0058
<http://www.EMSL.com / manhattanlab@emsl.com>

EMSL Order: 032000750
Customer ID: QUES51
Customer PO:
Project ID:

Attention: Quality Environmental Solution & Tech
1376 Route 9
Wappingers Falls, NY 12590
Phone: (845) 298-6031
Fax: (845) 298-6251
Received Date: 01/11/2020 10:49 AM
Analysis Date: 01/15/2020 - 01/16/2020
Collected Date: 01/09/2020
Project: Q20-3106/ PVE, LLC./ 164 GARDEN ST. POUGHKEEPSIE, NY 12601/ PRE-DEMO ASB SURVEY

Test Report:Asbestos Analysis of Bulk Material

Test	Analyzed Date	Color	Non-Asbestos		Asbestos
			Fibrous	Non-Fibrous	
Sample ID 3106-01 <i>032000750-0001</i>		Description	ROOM 2, WALL, ON SHEETROCK - JOINT COMPOUND		
		Homogeneity	Homogeneous		
PLM NYS 198.1 Friable	01/16/2020	Tan	None	10.00% Mica 88.20% Non-fibrous (other)	1.80% Chrysotile
PLM NYS 198.6 VCM					Not Analyzed
PLM NYS 198.6 NOB					Not Analyzed
TEM NYS 198.4 NOB					Not Analyzed
Sample ID 3106-02 <i>032000750-0002</i>		Description	ROOM 2, WALL, ON SHEETROCK - JOINT COMPOUND		
		Homogeneity	Homogeneous		
PLM NYS 198.1 Friable	01/16/2020	Tan	None	10.00% Mica 87.90% Non-fibrous (other)	2.10% Chrysotile
PLM NYS 198.6 VCM					Not Analyzed
PLM NYS 198.6 NOB					Not Analyzed
TEM NYS 198.4 NOB					Not Analyzed
Sample ID 3106-03 <i>032000750-0003</i>		Description	ROOM 4, WALL, ON SHEETROCK - JOINT COMPOUND		
		Homogeneity	Homogeneous		
PLM NYS 198.1 Friable	01/16/2020	White		30.00% Ca Carbonate 15.00% Mica 55.00% Non-fibrous (other)	None Detected
PLM NYS 198.6 VCM					Not Analyzed
PLM NYS 198.6 NOB					Not Analyzed
TEM NYS 198.4 NOB					Not Analyzed
Sample ID 3106-04 <i>032000750-0004</i>		Description	BATHROOM 4, CEILING, ON SHEETROCK - JOINT COMPOUND		
		Homogeneity	Homogeneous		
PLM NYS 198.1 Friable	01/16/2020	Tan	None	10.00% Mica 88.60% Non-fibrous (other)	1.40% Chrysotile
PLM NYS 198.6 VCM					Not Analyzed
PLM NYS 198.6 NOB					Not Analyzed
TEM NYS 198.4 NOB					Not Analyzed

Initial report from: 01/16/2020 10:24:11



EMSL Analytical, Inc.

307 West 38th Street New York, NY 10018

Tel/Fax: (212) 290-0051 / (212) 290-0058

<http://www.EMSL.com> / manhattanlab@emsl.com

EMSL Order: 032000750
Customer ID: QUES51
Customer PO:
Project ID:

Test Report:Asbestos Analysis of Bulk Material

Test	Analyzed Date	Color	Non-Asbestos		Asbestos
			Fibrous	Non-Fibrous	
Sample ID 3106-05 <i>032000750-0005</i>		Description	ROOM 10, CEILING, ON SHEETROCK - JOINT COMPOUND		
		Homogeneity	Homogeneous		
PLM NYS 198.1 Friable	01/16/2020	Tan/ White	5.00% Cellulose	35.00% Ca Carbonate 15.00% Mica 43.90% Non-fibrous (other)	1.10% Chrysotile
Result includes a small amount of inseparable attached material.					
PLM NYS 198.6 VCM					Not Analyzed
PLM NYS 198.6 NOB					Not Analyzed
TEM NYS 198.4 NOB					Not Analyzed
Sample ID 3106-06 <i>032000750-0006</i>		Description	ROOM 10, CEILING, ON SHEETROCK - TAPE		
		Homogeneity	Homogeneous		
PLM NYS 198.1 Friable	01/16/2020	Tan	90.00% Cellulose	9.25% Non-fibrous (other)	0.75% Chrysotile
On-site contamination from attached joint compound					
PLM NYS 198.6 VCM					Not Analyzed
PLM NYS 198.6 NOB					Not Analyzed
TEM NYS 198.4 NOB					Not Analyzed
Sample ID 3106-07 <i>032000750-0007</i>		Description	ROOM 2, WALL, ON SHEETROCK - TAPE		
		Homogeneity	Homogeneous		
PLM NYS 198.1 Friable	01/16/2020	Beige	90.00% Cellulose	10.00% Non-fibrous (other)	None Detected
PLM NYS 198.6 VCM					Not Analyzed
PLM NYS 198.6 NOB					Not Analyzed
TEM NYS 198.4 NOB					Not Analyzed
Sample ID 3106-08 <i>032000750-0008</i>		Description	BATHROOM 1, WALL - SHEETROCK		
		Homogeneity	Homogeneous		
PLM NYS 198.1 Friable	01/16/2020	Brown/ Gray	15.00% Cellulose	50.00% Gypsum 35.00% Non-fibrous (other)	None Detected
PLM NYS 198.6 VCM					Not Analyzed
PLM NYS 198.6 NOB					Not Analyzed
TEM NYS 198.4 NOB					Not Analyzed
Sample ID 3106-09 <i>032000750-0009</i>		Description	HALLWAY, WALL - SHEETROCK		
		Homogeneity	Heterogeneous		
PLM NYS 198.1 Friable	01/16/2020	Brown/ Gray	15.00% Cellulose	25.00% Ca Carbonate 40.00% Gypsum 20.00% Non-fibrous (other)	None Detected
PLM NYS 198.6 VCM					Not Analyzed
PLM NYS 198.6 NOB					Not Analyzed
TEM NYS 198.4 NOB					Not Analyzed
Sample ID 3106-10 <i>032000750-0010</i>		Description	ROOM 9, SUSPENDED CEILING, 2'X4' SMOOTH - CEILING TILE		
		Homogeneity	Heterogeneous		
PLM NYS 198.1 Friable					Not Analyzed
PLM NYS 198.6 VCM					Not Analyzed
PLM NYS 198.6 NOB	01/15/2020	White	2.10% Min. Wool	97.90% Other	Inconclusive: None Detected
TEM NYS 198.4 NOB	01/16/2020	White		100.00% Other	None Detected

Initial report from: 01/16/2020 10:24:11



EMSL Analytical, Inc.

307 West 38th Street New York, NY 10018

Tel/Fax: (212) 290-0051 / (212) 290-0058

<http://www.EMSL.com> / manhattanlab@emsl.com

EMSL Order: 032000750

Customer ID: QUES51

Customer PO:

Project ID:

Test Report:Asbestos Analysis of Bulk Material

Test	Analyzed Date	Color	Non-Asbestos		Asbestos
			Fibrous	Non-Fibrous	
Sample ID 3106-11 <i>032000750-0011</i>		Description	ROOM 9, SUSPENDED CEILING, 2'X4' SMOOTH - CEILING TILE		
		Homogeneity	Heterogeneous		
PLM NYS 198.1 Friable					Not Analyzed
PLM NYS 198.6 VCM					Not Analyzed
PLM NYS 198.6 NOB	01/15/2020	White	1.90% Min. Wool	98.10% Other	Inconclusive: None Detected
TEM NYS 198.4 NOB	01/16/2020	White		100.00% Other	None Detected
Sample ID 3106-12 <i>032000750-0012</i>		Description	ROOM 8, SUSPENDED CEILING, 2'X4', DOT CANYON - CEILING TILE		
		Homogeneity	Heterogeneous		
PLM NYS 198.1 Friable					Not Analyzed
PLM NYS 198.6 VCM					Not Analyzed
PLM NYS 198.6 NOB	01/15/2020	White	10.00% Min. Wool	90.00% Other	Inconclusive: None Detected
TEM NYS 198.4 NOB	01/16/2020	White		100.00% Other	None Detected
Sample ID 3106-13 <i>032000750-0013</i>		Description	ROOM 2, SUSPENDED CEILING, 2'X4', DOT CANYON - CEILING TILE		
		Homogeneity	Heterogeneous		
PLM NYS 198.1 Friable					Not Analyzed
PLM NYS 198.6 VCM					Not Analyzed
PLM NYS 198.6 NOB	01/15/2020	White	6.30% Min. Wool	93.70% Other	Inconclusive: None Detected
TEM NYS 198.4 NOB	01/16/2020	White		100.00% Other	None Detected
Sample ID 3106-14-Cove Base <i>032000750-0014</i>		Description	ROOM 2, WALL, ON WOOD PANELS, TAN - COVE BASE MODLING & ADHESIVE		
		Homogeneity	Heterogeneous		
PLM NYS 198.1 Friable					Not Analyzed
PLM NYS 198.6 VCM					Not Analyzed
PLM NYS 198.6 NOB	01/15/2020	Brown	<1.00% Fibrous (other)	100.00% Other	Inconclusive: None Detected
Final Residue <1% of original subsample					
TEM NYS 198.4 NOB	01/16/2020	Brown		100.00% Other	None Detected
Sample ID 3106-14-Adhesive <i>032000750-0014A</i>		Description	ROOM 2, WALL, ON WOOD PANELS, TAN - COVE BASE MODLING & ADHESIVE		
		Homogeneity	Heterogeneous		
PLM NYS 198.1 Friable					Not Analyzed
PLM NYS 198.6 VCM					Not Analyzed
PLM NYS 198.6 NOB	01/15/2020	Tan	<1.00% Fibrous (other)	100.00% Other	Inconclusive: None Detected
TEM NYS 198.4 NOB	01/16/2020	Tan		100.00% Other	None Detected
Sample ID 3106-15-Cove Base <i>032000750-0015</i>		Description	ROOM 2, WALL, ON WOOD PANELS, TAN - COVE BASE MODLING & ADHESIVE		
		Homogeneity	Heterogeneous		
PLM NYS 198.1 Friable					Not Analyzed
PLM NYS 198.6 VCM					Not Analyzed
PLM NYS 198.6 NOB	01/15/2020	Brown	<1.00% Fibrous (other)	100.00% Other	Inconclusive: None Detected
TEM NYS 198.4 NOB	01/16/2020	Brown		100.00% Other	None Detected

Initial report from: 01/16/2020 10:24:11



EMSL Analytical, Inc.

307 West 38th Street New York, NY 10018
Tel/Fax: (212) 290-0051 / (212) 290-0058
<http://www.EMSL.com / manhattanlab@emsl.com>

EMSL Order: 032000750
Customer ID: QUES51
Customer PO:
Project ID:

Test Report:Asbestos Analysis of Bulk Material

Test	Analyzed Date	Color	Non-Asbestos		Asbestos
			Fibrous	Non-Fibrous	
Sample ID 3106-15-Adhesive <i>032000750-0015A</i>			Description ROOM 2, WALL, ON WOOD PANELS, TAN - COVE BASE MODLING & ADHESIVE Homogeneity Heterogeneous		
PLM NYS 198.1 Friable					Not Analyzed
PLM NYS 198.6 VCM					Not Analyzed
PLM NYS 198.6 NOB 01/15/2020		Tan		100.00% Other	Inconclusive: None Detected
TEM NYS 198.4 NOB 01/16/2020		Tan		100.00% Other	None Detected
Sample ID 3106-16-Cove Base <i>032000750-0016</i>			Description ROOM 9, WALL, ON BLACK COVE BASE MOLDING, YELLOW - COVE BASE MODLING & ADHESIVE Homogeneity Heterogeneous		
PLM NYS 198.1 Friable					Not Analyzed
PLM NYS 198.6 VCM					Not Analyzed
PLM NYS 198.6 NOB 01/15/2020 Final Residue <1% of original subsample		Gray		100.00% Other	Inconclusive: None Detected
TEM NYS 198.4 NOB 01/16/2020		Gray		100.00% Other	None Detected
Sample ID 3106-16-Adhesive <i>032000750-0016A</i>			Description ROOM 9, WALL, ON BLACK COVE BASE MOLDING, YELLOW - COVE BASE MODLING & ADHESIVE Homogeneity Heterogeneous		
PLM NYS 198.1 Friable					Not Analyzed
PLM NYS 198.6 VCM					Not Analyzed
PLM NYS 198.6 NOB 01/15/2020 Final Residue <1% of original subsample		Yellow		100.00% Other	Inconclusive: None Detected
TEM NYS 198.4 NOB 01/16/2020		Yellow		100.00% Other	None Detected
Sample ID 3106-17-Cove Base <i>032000750-0017</i>			Description ROOM 9, WALL, ON BLACK COVE BASE MOLDING, YELLOW - COVE BASE MODLING & ADHESIVE Homogeneity Heterogeneous		
PLM NYS 198.1 Friable					Not Analyzed
PLM NYS 198.6 VCM					Not Analyzed
PLM NYS 198.6 NOB 01/15/2020 Final Residue <1% of original subsample		Gray		100.00% Other	Inconclusive: None Detected
TEM NYS 198.4 NOB 01/16/2020		Gray		100.00% Other	None Detected
Sample ID 3106-17-Adhesive <i>032000750-0017A</i>			Description ROOM 9, WALL, ON BLACK COVE BASE MOLDING, YELLOW - COVE BASE MODLING & ADHESIVE Homogeneity Heterogeneous		
PLM NYS 198.1 Friable					Not Analyzed
PLM NYS 198.6 VCM					Not Analyzed
PLM NYS 198.6 NOB 01/15/2020 Final Residue <1% of original subsample		Yellow		100.00% Other	Inconclusive: None Detected
TEM NYS 198.4 NOB 01/16/2020		Yellow		100.00% Other	None Detected
Sample ID 3106-18-Cove Base <i>032000750-0018</i>			Description ROOM 8, WALL, ON WOOD PANELS, BROWN - COVE BASE MODLING & ADHESIVE Homogeneity Heterogeneous		
PLM NYS 198.1 Friable					Not Analyzed
PLM NYS 198.6 VCM					Not Analyzed
PLM NYS 198.6 NOB 01/15/2020 Final Residue <1% of original subsample		Black		100.00% Other	Inconclusive: None Detected
TEM NYS 198.4 NOB 01/16/2020		Black		100.00% Other	None Detected

Initial report from: 01/16/2020 10:24:11



EMSL Analytical, Inc.

307 West 38th Street New York, NY 10018
Tel/Fax: (212) 290-0051 / (212) 290-0058
<http://www.EMSL.com / manhattanlab@emsl.com>

EMSL Order: 032000750
Customer ID: QUES51
Customer PO:
Project ID:

Test Report:Asbestos Analysis of Bulk Material

Test	Analyzed Date	Color	Non-Asbestos		Asbestos
			Fibrous	Non-Fibrous	
Sample ID 3106-18-Adhesive 032000750-0018A		Description	ROOM 8, WALL, ON WOOD PANELS, BROWN - COVE BASE MODLING & ADHESIVE		
		Homogeneity	Heterogeneous		
PLM NYS 198.1 Friable					Not Analyzed
PLM NYS 198.6 VCM					Not Analyzed
PLM NYS 198.6 NOB	01/15/2020	Brown	<1.00% Fibrous (other)	100.00% Other	Inconclusive: None Detected
TEM NYS 198.4 NOB	01/16/2020	Brown		100.00% Other	None Detected
Sample ID 3106-19-Cove Base 032000750-0019		Description	ROOM 8, WALL, ON WOOD PANELS, BROWN - COVE BASE MODLING & ADHESIVE		
		Homogeneity	Heterogeneous		
PLM NYS 198.1 Friable					Not Analyzed
PLM NYS 198.6 VCM					Not Analyzed
PLM NYS 198.6 NOB	01/15/2020	Black		100.00% Other	Inconclusive: None Detected
Final Residue <1% of original subsample					
TEM NYS 198.4 NOB	01/16/2020	Black		100.00% Other	None Detected
Sample ID 3106-19-Adhesive 032000750-0019A		Description	ROOM 8, WALL, ON WOOD PANELS, BROWN - COVE BASE MODLING & ADHESIVE		
		Homogeneity	Heterogeneous		
PLM NYS 198.1 Friable					Not Analyzed
PLM NYS 198.6 VCM					Not Analyzed
PLM NYS 198.6 NOB	01/15/2020	Brown		100.00% Other	Inconclusive: None Detected
TEM NYS 198.4 NOB	01/16/2020	Brown		100.00% Other	None Detected
Sample ID 3106-20-Cove Base 032000750-0020		Description	ROOM 8, WALL, ON WOOD PANELS, GRAY - COVE BASE MODLING & ADHESIVE		
		Homogeneity	Heterogeneous		
PLM NYS 198.1 Friable					Not Analyzed
PLM NYS 198.6 VCM					Not Analyzed
PLM NYS 198.6 NOB	01/15/2020	Gray/ Black		100.00% Other	Inconclusive: None Detected
Final Residue <1% of original subsample					
TEM NYS 198.4 NOB	01/16/2020	Gray/ Black		100.00% Other	None Detected
Sample ID 3106-20-Adhesive 032000750-0020A		Description	ROOM 9, WALL, ON WOOD PANELS, GRAY - COVE BASE MODLING & ADHESIVE		
		Homogeneity	Heterogeneous		
PLM NYS 198.1 Friable					Not Analyzed
PLM NYS 198.6 VCM					Not Analyzed
PLM NYS 198.6 NOB	01/15/2020	Tan		100.00% Other	Inconclusive: None Detected
TEM NYS 198.4 NOB	01/16/2020	Tan		100.00% Other	None Detected
Sample ID 3106-21-Cove Base 032000750-0021		Description	ROOM 9, WALL, ON WOOD PANELS, GRAY - COVE BASE MODLING & ADHESIVE		
		Homogeneity	Heterogeneous		
PLM NYS 198.1 Friable					Not Analyzed
PLM NYS 198.6 VCM					Not Analyzed
PLM NYS 198.6 NOB	01/15/2020	Gray/ Black		100.00% Other	Inconclusive: None Detected
Final Residue <1% of original subsample					
TEM NYS 198.4 NOB	01/16/2020	Gray/ Black		100.00% Other	None Detected

Initial report from: 01/16/2020 10:24:11



EMSL Analytical, Inc.

307 West 38th Street New York, NY 10018

Tel/Fax: (212) 290-0051 / (212) 290-0058

<http://www.EMSL.com> / manhattanlab@emsl.com

EMSL Order: 032000750

Customer ID: QUES51

Customer PO:

Project ID:

Test Report:Asbestos Analysis of Bulk Material

Test	Analyzed Date	Color	Non-Asbestos		Asbestos
			Fibrous	Non-Fibrous	
Sample ID 3106-21-Adhesive 032000750-0021A			Description ROOM 9, WALL, ON WOOD PANELS, GRAY - COVE BASE MODLING & ADHESIVE Homogeneity Heterogeneous		
PLM NYS 198.1 Friable					Not Analyzed
PLM NYS 198.6 VCM					Not Analyzed
PLM NYS 198.6 NOB	01/15/2020	Tan		100.00% Other	Inconclusive: None Detected
TEM NYS 198.4 NOB	01/16/2020	Tan		100.00% Other	None Detected
Sample ID 3106-22-Fiberboard 032000750-0022			Description BATHROOM 1, WALL PANEL ON SHEETROCK - FIBERBOARD & ADHESIVE Homogeneity Heterogeneous		
PLM NYS 198.1 Friable					Not Analyzed
PLM NYS 198.6 VCM					Not Analyzed
PLM NYS 198.6 NOB	01/15/2020	Brown		100.00% Other	Inconclusive: None Detected
TEM NYS 198.4 NOB	01/16/2020	Brown		100.00% Other	None Detected
Sample ID 3106-22-Adhesive 032000750-0022A			Description BATHROOM 1, WALL PANEL ON SHEETROCK - FIBERBOARD & ADHESIVE Homogeneity Heterogeneous		
PLM NYS 198.1 Friable					Not Analyzed
PLM NYS 198.6 VCM					Not Analyzed
PLM NYS 198.6 NOB	01/15/2020	Yellow		100.00% Other	Inconclusive: None Detected
TEM NYS 198.4 NOB	01/16/2020	Yellow		100.00% Other	None Detected
Sample ID 3106-23-Fiberboard 032000750-0023			Description BATHROOM 2, WALL PANEL ON SHEETROCK - FIBERBOARD & ADHESIVE Homogeneity Heterogeneous		
PLM NYS 198.1 Friable					Not Analyzed
PLM NYS 198.6 VCM					Not Analyzed
PLM NYS 198.6 NOB	01/15/2020	Brown		100.00% Other	Inconclusive: None Detected
TEM NYS 198.4 NOB	01/16/2020	Brown		100.00% Other	None Detected
Sample ID 3106-23-Adhesive 032000750-0023A			Description BATHROOM 2, WALL PANEL ON SHEETROCK - FIBERBOARD & ADHESIVE Homogeneity Heterogeneous		
PLM NYS 198.1 Friable					Not Analyzed
PLM NYS 198.6 VCM					Not Analyzed
PLM NYS 198.6 NOB	01/15/2020	Yellow	<1.00% Fibrous (other)	100.00% Other	Inconclusive: None Detected
TEM NYS 198.4 NOB	01/16/2020	Yellow		100.00% Other	None Detected
Sample ID 3106-24 032000750-0024			Description ROOM 9, WALL, BEHIND WOOD PANELS, ON SHEETROCK - ADHESIVE Homogeneity Heterogeneous		
PLM NYS 198.1 Friable					Not Analyzed
PLM NYS 198.6 VCM					Not Analyzed
PLM NYS 198.6 NOB	01/15/2020	Black		100.00% Other	Inconclusive: None Detected
TEM NYS 198.4 NOB	01/16/2020	Black		100.00% Other	None Detected

Initial report from: 01/16/2020 10:24:11



EMSL Analytical, Inc.

307 West 38th Street New York, NY 10018
Tel/Fax: (212) 290-0051 / (212) 290-0058
<http://www.EMSL.com / manhattanlab@emsl.com>

EMSL Order: 032000750
Customer ID: QUES51
Customer PO:
Project ID:

Test Report:Asbestos Analysis of Bulk Material

Test	Analyzed Date	Color	Non-Asbestos		Asbestos
			Fibrous	Non-Fibrous	
Sample ID 3106-25 032000750-0025		Description	ROOM 8, WALL, BEHIND WOOD PANELS, ON SHEETROCK - ADHESIVE		
		Homogeneity	Heterogeneous		
PLM NYS 198.1 Friable					Not Analyzed
PLM NYS 198.6 VCM					Not Analyzed
PLM NYS 198.6 NOB	01/15/2020	Black		100.00% Other	Inconclusive: None Detected
TEM NYS 198.4 NOB	01/16/2020	Black		100.00% Other	None Detected
Sample ID 3106-26 032000750-0026		Description	ROOM 9, WALL, BEHIND WOOD PANELS, ON SHEETROCK - ADHESIVE		
		Homogeneity	Heterogeneous		
PLM NYS 198.1 Friable					Not Analyzed
PLM NYS 198.6 VCM					Not Analyzed
PLM NYS 198.6 NOB	01/15/2020	Brown		100.00% Other	Inconclusive: None Detected
TEM NYS 198.4 NOB	01/16/2020	Brown		100.00% Other	None Detected
Sample ID 3106-27 032000750-0027		Description	ROOM 9, WALL, BEHIND WOOD PANELS, ON SHEETROCK - ADHESIVE		
		Homogeneity	Heterogeneous		
PLM NYS 198.1 Friable					Not Analyzed
PLM NYS 198.6 VCM					Not Analyzed
PLM NYS 198.6 NOB	01/15/2020	Brown		100.00% Other	Inconclusive: None Detected
TEM NYS 198.4 NOB	01/16/2020	Brown		100.00% Other	None Detected
Sample ID 3106-28 032000750-0028		Description	ROOM 9, WALL, ON FIBERBOARD - CORKBOARD		
		Homogeneity	Heterogeneous		
PLM NYS 198.1 Friable					Not Analyzed
PLM NYS 198.6 VCM					Not Analyzed
PLM NYS 198.6 NOB	01/16/2020	Brown		100.00% Other	Inconclusive: None Detected
Final Residue <1% of original subsample.					
TEM NYS 198.4 NOB	01/16/2020	Brown		100.00% Other	None Detected
Sample ID 3106-29 032000750-0029		Description	ROOM 9, WALL, ON FIBERBOARD - CORKBOARD		
		Homogeneity	Heterogeneous		
PLM NYS 198.1 Friable					Not Analyzed
PLM NYS 198.6 VCM					Not Analyzed
PLM NYS 198.6 NOB	01/16/2020	Brown		100.00% Other	Inconclusive: None Detected
Final Residue <1% of original subsample.					
TEM NYS 198.4 NOB	01/16/2020	Brown		100.00% Other	None Detected
Sample ID 3106-30 032000750-0030		Description	ROOM 9, WALL, BEHIND CORKBOARD, ON FIBERBOARD - ADHESIVE		
		Homogeneity	Heterogeneous		
PLM NYS 198.1 Friable					Not Analyzed
PLM NYS 198.6 VCM					Not Analyzed
PLM NYS 198.6 NOB	01/15/2020	Black		100.00% Other	Inconclusive: None Detected
TEM NYS 198.4 NOB	01/16/2020	Black		100.00% Other	None Detected

Initial report from: 01/16/2020 10:24:11



EMSL Analytical, Inc.

307 West 38th Street New York, NY 10018
Tel/Fax: (212) 290-0051 / (212) 290-0058
<http://www.EMSL.com / manhattanlab@emsl.com>

EMSL Order: 032000750
Customer ID: QUES51
Customer PO:
Project ID:

Test Report:Asbestos Analysis of Bulk Material

Test	Analyzed Date	Color	Non-Asbestos		Asbestos
			Fibrous	Non-Fibrous	
Sample ID 3106-31 <i>032000750-0031</i>		Description	ROOM 9, WALL, BEHIND CORKBOARD, ON FIBERBOARD - ADHESIVE		
		Homogeneity	Heterogeneous		
PLM NYS 198.1 Friable					Not Analyzed
PLM NYS 198.6 VCM					Not Analyzed
PLM NYS 198.6 NOB	01/15/2020	Black		100.00% Other	Inconclusive: None Detected
TEM NYS 198.4 NOB	01/16/2020	Black		100.00% Other	None Detected
Sample ID 3106-32 <i>032000750-0032</i>		Description	ROOM 9, WALL, BEHIND CORKBOARD - FIBERBOARD		
		Homogeneity	Homogeneous		
PLM NYS 198.1 Friable	01/16/2020	Gray	90.00% Cellulose	10.00% Non-fibrous (other)	None Detected
PLM NYS 198.6 VCM					Not Analyzed
PLM NYS 198.6 NOB					Not Analyzed
TEM NYS 198.4 NOB					Not Analyzed
Sample ID 3106-33 <i>032000750-0033</i>		Description	ROOM 9, WALL, BEHIND CORKBOARD - FIBERBOARD		
		Homogeneity	Homogeneous		
PLM NYS 198.1 Friable	01/16/2020	Gray	85.00% Cellulose	15.00% Non-fibrous (other)	None Detected
PLM NYS 198.6 VCM					Not Analyzed
PLM NYS 198.6 NOB					Not Analyzed
TEM NYS 198.4 NOB					Not Analyzed
Sample ID 3106-34 <i>032000750-0034</i>		Description	ROOM 6, BEHIND PANELS, ON SHEETROCK - ADHESIVE		
		Homogeneity	Heterogeneous		
PLM NYS 198.1 Friable					Not Analyzed
PLM NYS 198.6 VCM					Not Analyzed
PLM NYS 198.6 NOB	01/15/2020	White		100.00% Other	Inconclusive: None Detected
TEM NYS 198.4 NOB	01/16/2020	White		100.00% Other	None Detected
Sample ID 3106-35 <i>032000750-0035</i>		Description	ROOM 6, BEHIND PANELS, ON SHEETROCK - ADHESIVE		
		Homogeneity	Heterogeneous		
PLM NYS 198.1 Friable					Not Analyzed
PLM NYS 198.6 VCM					Not Analyzed
PLM NYS 198.6 NOB	01/15/2020	White		100.00% Other	Inconclusive: None Detected
TEM NYS 198.4 NOB	01/16/2020	White		100.00% Other	None Detected
Sample ID 3106-36-Ceramic Tile <i>032000750-0036</i>		Description	BATHROOM 3, WALL - CERAMIC TILE & GROUT		
		Homogeneity	Homogeneous		
PLM NYS 198.1 Friable	01/16/2020	White/ Green		100.00% Non-fibrous (other)	None Detected
PLM NYS 198.6 VCM					Not Analyzed
PLM NYS 198.6 NOB					Not Analyzed
TEM NYS 198.4 NOB					Not Analyzed

Initial report from: 01/16/2020 10:24:11



EMSL Analytical, Inc.

307 West 38th Street New York, NY 10018

Tel/Fax: (212) 290-0051 / (212) 290-0058

<http://www.EMSL.com> / manhattanlab@emsl.com

EMSL Order: 032000750

Customer ID: QUES51

Customer PO:

Project ID:

Test Report:Asbestos Analysis of Bulk Material

Test	Analyzed Date	Color	Non-Asbestos		Asbestos
			Fibrous	Non-Fibrous	
Sample ID 3106-36-Grout 032000750-0036A			Description BATHROOM 3, WALL - CERAMIC TILE & GROUT Homogeneity Homogeneous		
PLM NYS 198.1 Friable	01/16/2020	White	3.00% Cellulose	40.00% Ca Carbonate 57.00% Non-fibrous (other)	None Detected
PLM NYS 198.6 VCM					Not Analyzed
PLM NYS 198.6 NOB					Not Analyzed
TEM NYS 198.4 NOB					Not Analyzed
Sample ID 3106-37-Ceramic Tile 032000750-0037			Description BATHROOM 4, WALL - CERAMIC TILE & GROUT Homogeneity Homogeneous		
PLM NYS 198.1 Friable	01/16/2020	Beige		5.00% Ca Carbonate 75.00% Non-fibrous (other) 20.00% Quartz	None Detected
PLM NYS 198.6 VCM					Not Analyzed
PLM NYS 198.6 NOB					Not Analyzed
TEM NYS 198.4 NOB					Not Analyzed
Sample ID 3106-37-Grout 032000750-0037A			Description BATHROOM 4, WALL - CERAMIC TILE & GROUT Homogeneity Homogeneous		
PLM NYS 198.1 Friable	01/16/2020	White		60.00% Ca Carbonate 25.00% Non-fibrous (other) 15.00% Quartz	None Detected
PLM NYS 198.6 VCM					Not Analyzed
PLM NYS 198.6 NOB					Not Analyzed
TEM NYS 198.4 NOB					Not Analyzed
Sample ID 3106-38 032000750-0038			Description BATHROOM 3, WALL, BEHIND CERAMIC TILE, ON CMU - ADHESIVE Homogeneity Heterogeneous		
PLM NYS 198.1 Friable					Not Analyzed
PLM NYS 198.6 VCM					Not Analyzed
PLM NYS 198.6 NOB	01/15/2020	Green	None	97.20% Other	2.80% Chrysotile
TEM NYS 198.4 NOB	01/16/2020				Positive Stop (Not Analyzed)
Sample ID 3106-39 032000750-0039			Description BATHROOM 4, WALL, BEHIND CERAMIC TILE, ON CMU - ADHESIVE Homogeneity		
PLM NYS 198.1 Friable					Not Analyzed
PLM NYS 198.6 VCM					Not Analyzed
PLM NYS 198.6 NOB	01/15/2020				Positive Stop (Not Analyzed)
TEM NYS 198.4 NOB	01/16/2020				Positive Stop (Not Analyzed)
Sample ID 3106-40-Ceramic Tile 032000750-0040			Description BATHROOM 4, FLOOR - CERAMIC TILE & GROUT Homogeneity Homogeneous		
PLM NYS 198.1 Friable	01/16/2020	White		100.00% Non-fibrous (other)	None Detected
PLM NYS 198.6 VCM					Not Analyzed
PLM NYS 198.6 NOB					Not Analyzed
TEM NYS 198.4 NOB					Not Analyzed

Initial report from: 01/16/2020 10:24:11



EMSL Analytical, Inc.

307 West 38th Street New York, NY 10018
Tel/Fax: (212) 290-0051 / (212) 290-0058
<http://www.EMSL.com / manhattanlab@emsl.com>

EMSL Order: 032000750
Customer ID: QUES51
Customer PO:
Project ID:

Test Report:Asbestos Analysis of Bulk Material

Test	Analyzed Date	Color	Non-Asbestos		Asbestos
			Fibrous	Non-Fibrous	
Sample ID 3106-40-Grout 032000750-0040A			Description BATHROOM 4, FLOOR - CERAMIC TILE & GROUT Homogeneity Homogeneous		
PLM NYS 198.1 Friable	01/16/2020	Gray		30.00% Ca Carbonate 30.00% Non-fibrous (other) 40.00% Quartz	None Detected
PLM NYS 198.6 VCM					Not Analyzed
PLM NYS 198.6 NOB					Not Analyzed
TEM NYS 198.4 NOB					Not Analyzed
Sample ID 3106-41-Ceramic Tile 032000750-0041			Description BATHROOM 3, FLOOR - CERAMIC TILE & GROUT Homogeneity Homogeneous		
PLM NYS 198.1 Friable	01/16/2020	Green		5.00% Ca Carbonate 60.00% Non-fibrous (other) 35.00% Quartz	None Detected
PLM NYS 198.6 VCM					Not Analyzed
PLM NYS 198.6 NOB					Not Analyzed
TEM NYS 198.4 NOB					Not Analyzed
Sample ID 3106-41-Grout 032000750-0041A			Description BATHROOM 3, FLOOR - CERAMIC TILE & GROUT Homogeneity Homogeneous		
PLM NYS 198.1 Friable	01/16/2020	Gray		35.00% Ca Carbonate 5.00% Mica 35.00% Non-fibrous (other) 25.00% Quartz	None Detected
PLM NYS 198.6 VCM					Not Analyzed
PLM NYS 198.6 NOB					Not Analyzed
TEM NYS 198.4 NOB					Not Analyzed
Sample ID 3106-42 032000750-0042			Description BATHROOM 4, FLOOR, UNDER CERAMIC TILE, ON SLAB - MUDSET Homogeneity Homogeneous		
PLM NYS 198.1 Friable	01/16/2020	Brown		15.00% Ca Carbonate 45.00% Non-fibrous (other) 40.00% Quartz	None Detected
PLM NYS 198.6 VCM					Not Analyzed
PLM NYS 198.6 NOB					Not Analyzed
TEM NYS 198.4 NOB					Not Analyzed
Sample ID 3106-43 032000750-0043			Description BATHROOM 3, FLOOR, UNDER CERAMIC TILE, ON SLAB - MUDSET Homogeneity Homogeneous		
PLM NYS 198.1 Friable	01/16/2020	Brown/ Gray		40.00% Ca Carbonate 5.00% Mica 25.00% Non-fibrous (other) 30.00% Quartz	None Detected
PLM NYS 198.6 VCM					Not Analyzed
PLM NYS 198.6 NOB					Not Analyzed
TEM NYS 198.4 NOB					Not Analyzed

Initial report from: 01/16/2020 10:24:11



EMSL Analytical, Inc.

307 West 38th Street New York, NY 10018
Tel/Fax: (212) 290-0051 / (212) 290-0058
<http://www.EMSL.com / manhattanlab@emsl.com>

EMSL Order: 032000750
Customer ID: QUES51
Customer PO:
Project ID:

Test Report:Asbestos Analysis of Bulk Material

Test	Analyzed Date	Color	Non-Asbestos		Asbestos
			Fibrous	Non-Fibrous	
Sample ID 3106-44 <i>032000750-0044</i>		Description	GARAGE 1, UNDER AIR HANDLER UNIT - FIBER PANEL		
		Homogeneity	Homogeneous		
PLM NYS 198.1 Friable	01/16/2020	White	None	33.00% Non-fibrous (other)	67.00% Chrysotile
PLM NYS 198.6 VCM					Not Analyzed
PLM NYS 198.6 NOB					Not Analyzed
TEM NYS 198.4 NOB					Not Analyzed
Sample ID 3106-45 <i>032000750-0045</i>		Description	GARAGE 1, UNDER AIR HANDLER UNIT - FIBER PANEL		
		Homogeneity			
PLM NYS 198.1 Friable	01/16/2020				Positive Stop (Not Analyzed)
PLM NYS 198.6 VCM					Not Analyzed
PLM NYS 198.6 NOB					Not Analyzed
TEM NYS 198.4 NOB					Not Analyzed
Sample ID 3106-46-Floor Tile <i>032000750-0046</i>		Description	BATHROOM 1, FLOOR, 1'X1', ON SLAB - FLOOR TILE & MASTIC		
		Homogeneity	Heterogeneous		
PLM NYS 198.1 Friable					Not Analyzed
PLM NYS 198.6 VCM					Not Analyzed
PLM NYS 198.6 NOB	01/15/2020	Brown		100.00% Other	Inconclusive: None Detected
TEM NYS 198.4 NOB	01/16/2020	Brown		100.00% Other	None Detected
Sample ID 3106-46-Mastic <i>032000750-0046A</i>		Description	BATHROOM 1, FLOOR, 1'X1', ON SLAB - FLOOR TILE & MASTIC		
		Homogeneity	Heterogeneous		
PLM NYS 198.1 Friable					Not Analyzed
PLM NYS 198.6 VCM					Not Analyzed
PLM NYS 198.6 NOB	01/15/2020	Brown		100.00% Other	Inconclusive: None Detected
TEM NYS 198.4 NOB	01/16/2020	Brown		100.00% Other	None Detected
Sample ID 3106-47-Floor Tile <i>032000750-0047</i>		Description	BATHROOM 2, FLOOR, 1'X1', ON SLAB - FLOOR TILE & MASTIC		
		Homogeneity	Heterogeneous		
PLM NYS 198.1 Friable					Not Analyzed
PLM NYS 198.6 VCM					Not Analyzed
PLM NYS 198.6 NOB	01/15/2020	Brown		100.00% Other	Inconclusive: None Detected
TEM NYS 198.4 NOB	01/16/2020	Brown		100.00% Other	None Detected
Sample ID 3106-47-Mastic <i>032000750-0047A</i>		Description	BATHROOM 2, FLOOR, 1'X1', ON SLAB - FLOOR TILE & MASTIC		
		Homogeneity	Heterogeneous		
PLM NYS 198.1 Friable					Not Analyzed
PLM NYS 198.6 VCM					Not Analyzed
PLM NYS 198.6 NOB	01/16/2020	Brown		100.00% Other	Inconclusive: None Detected
TEM NYS 198.4 NOB	01/16/2020	Brown		100.00% Other	None Detected

Initial report from: 01/16/2020 10:24:11



EMSL Analytical, Inc.

307 West 38th Street New York, NY 10018

Tel/Fax: (212) 290-0051 / (212) 290-0058

<http://www.EMSL.com> / manhattanlab@emsl.com

EMSL Order: 032000750

Customer ID: QUES51

Customer PO:

Project ID:

Test Report:Asbestos Analysis of Bulk Material

Test	Analyzed Date	Color	Non-Asbestos		Asbestos
			Fibrous	Non-Fibrous	
Sample ID 3106-48 032000750-0048			Description ROOM 2, FARMSIDE, FLOOR, 1'X1', BROWN MATTED - FLOOR TILE		
			Homogeneity Heterogeneous		
PLM NYS 198.1 Friable					Not Analyzed
PLM NYS 198.6 VCM					Not Analyzed
PLM NYS 198.6 NOB	01/16/2020	Brown		100.00% Other	Inconclusive: None Detected
TEM NYS 198.4 NOB	01/16/2020	Brown		100.00% Other	None Detected
Sample ID 3106-49 032000750-0049			Description ROOM 2, FARMSIDE, FLOOR, 1'X1', BROWN MATTED - FLOOR TILE		
			Homogeneity Heterogeneous		
PLM NYS 198.1 Friable					Not Analyzed
PLM NYS 198.6 VCM					Not Analyzed
PLM NYS 198.6 NOB	01/16/2020	Brown		100.00% Other	Inconclusive: None Detected
TEM NYS 198.4 NOB	01/16/2020	Brown		100.00% Other	None Detected
Sample ID 3106-50 032000750-0050			Description ROOM 2, FARMSIDE, FLOOR, UNDER 1'X1', BROWN MATTED FLOOR TILE, ON SLAB - MASTIC		
			Homogeneity Heterogeneous		
PLM NYS 198.1 Friable					Not Analyzed
PLM NYS 198.6 VCM					Not Analyzed
PLM NYS 198.6 NOB	01/16/2020	Brown		100.00% Other	Inconclusive: None Detected
TEM NYS 198.4 NOB	01/16/2020	Brown		100.00% Other	None Detected
Sample ID 3106-51 032000750-0051			Description ROOM 2, FARMSIDE, FLOOR, UNDER 1'X1', BROWN MATTED FLOOR TILE, ON SLAB - MASTIC		
			Homogeneity Heterogeneous		
PLM NYS 198.1 Friable					Not Analyzed
PLM NYS 198.6 VCM					Not Analyzed
PLM NYS 198.6 NOB	01/16/2020	Brown		100.00% Other	Inconclusive: None Detected
TEM NYS 198.4 NOB	01/16/2020	Brown		100.00% Other	None Detected
Sample ID 3106-52 032000750-0052			Description ROOM 2, NEARMSIDE, FLOOR, 1'X1', ON SLAB - PEEL 'N' STICK FLOOR TILE		
			Homogeneity Heterogeneous		
PLM NYS 198.1 Friable					Not Analyzed
PLM NYS 198.6 VCM					Not Analyzed
PLM NYS 198.6 NOB	01/16/2020	Brown		100.00% Other	Inconclusive: None Detected
TEM NYS 198.4 NOB	01/16/2020	Brown		100.00% Other	None Detected
Sample ID 3106-53 032000750-0053			Description ROOM 2, NEARMSIDE, FLOOR, 1'X1', ON SLAB - PEEL 'N' STICK FLOOR TILE		
			Homogeneity Heterogeneous		
PLM NYS 198.1 Friable					Not Analyzed
PLM NYS 198.6 VCM					Not Analyzed
PLM NYS 198.6 NOB	01/16/2020	Brown		100.00% Other	Inconclusive: None Detected
TEM NYS 198.4 NOB	01/16/2020	Brown		100.00% Other	None Detected

Initial report from: 01/16/2020 10:24:11



EMSL Analytical, Inc.

307 West 38th Street New York, NY 10018
Tel/Fax: (212) 290-0051 / (212) 290-0058
<http://www.EMSL.com / manhattanlab@emsl.com>

EMSL Order: 032000750
Customer ID: QUES51
Customer PO:
Project ID:

Test Report:Asbestos Analysis of Bulk Material

Test	Analyzed Date	Color	Non-Asbestos		Asbestos
			Fibrous	Non-Fibrous	
Sample ID 3106-54 <i>032000750-0054</i>		Description	ROOM 2, NEARSIDE, FLOOR, UNDER 1'X1' PEEL 'N' STICK FLOOR TILE, ON SLAB - ADHESIVE		
		Homogeneity	Heterogeneous		
PLM NYS 198.1 Friable					Not Analyzed
PLM NYS 198.6 VCM					Not Analyzed
PLM NYS 198.6 NOB	01/16/2020	Gray	<1.00% Fibrous (other)	100.00% Other	Inconclusive: None Detected
TEM NYS 198.4 NOB	01/16/2020	Gray		100.00% Other	None Detected
Sample ID 3106-55 <i>032000750-0055</i>		Description	ROOM 2, NEARSIDE, FLOOR, UNDER 1'X1' PEEL 'N' STICK FLOOR TILE, ON SLAB - ADHESIVE		
		Homogeneity	Heterogeneous		
PLM NYS 198.1 Friable					Not Analyzed
PLM NYS 198.6 VCM					Not Analyzed
PLM NYS 198.6 NOB	01/16/2020	Gray	<1.00% Fibrous (other)	100.00% Other	Inconclusive: None Detected
Final Residue <1% of original subsample					
TEM NYS 198.4 NOB	01/16/2020	Gray		100.00% Other	None Detected
Sample ID 3106-56 <i>032000750-0056</i>		Description	ROOM 9, FLOOR, UNDER 1'X1' FLOOR TILE, ON SLAB - MASTIC		
		Homogeneity	Heterogeneous		
PLM NYS 198.1 Friable					Not Analyzed
PLM NYS 198.6 VCM					Not Analyzed
PLM NYS 198.6 NOB	01/16/2020	Black		100.00% Other	Inconclusive: None Detected
TEM NYS 198.4 NOB	01/16/2020	Black		100.00% Other	None Detected
Sample ID 3106-57 <i>032000750-0057</i>		Description	ROOM 9, FLOOR, UNDER 1'X1' FLOOR TILE, ON SLAB - MASTIC		
		Homogeneity	Heterogeneous		
PLM NYS 198.1 Friable					Not Analyzed
PLM NYS 198.6 VCM					Not Analyzed
PLM NYS 198.6 NOB	01/16/2020	Black		100.00% Other	Inconclusive: None Detected
TEM NYS 198.4 NOB	01/16/2020	Black		100.00% Other	None Detected
Sample ID 3106-58 <i>032000750-0058</i>		Description	ROOM 7, FLOOR, ON SLAB - MODIFIED FLOORING		
		Homogeneity	Heterogeneous		
PLM NYS 198.1 Friable					Not Analyzed
PLM NYS 198.6 VCM					Not Analyzed
PLM NYS 198.6 NOB	01/16/2020	Brown		100.00% Other	Inconclusive: None Detected
Final Residue <1% of original subsample					
TEM NYS 198.4 NOB	01/16/2020	Brown		100.00% Other	None Detected
Sample ID 3106-59 <i>032000750-0059</i>		Description	ROOM 7, FLOOR, ON SLAB - MODIFIED FLOORING		
		Homogeneity	Heterogeneous		
PLM NYS 198.1 Friable					Not Analyzed
PLM NYS 198.6 VCM					Not Analyzed
PLM NYS 198.6 NOB	01/16/2020	Brown		100.00% Other	Inconclusive: None Detected
Final Residue <1% of original subsample					
TEM NYS 198.4 NOB	01/16/2020	Brown		100.00% Other	None Detected

Initial report from: 01/16/2020 10:24:11



EMSL Analytical, Inc.

307 West 38th Street New York, NY 10018

Tel/Fax: (212) 290-0051 / (212) 290-0058

<http://www.EMSL.com> / manhattanlab@emsl.com

EMSL Order: 032000750
Customer ID: QUES51
Customer PO:
Project ID:

Test Report:Asbestos Analysis of Bulk Material

Test	Analyzed Date	Color	Non-Asbestos		Asbestos
			Fibrous	Non-Fibrous	
Sample ID 3106-60 <i>032000750-0060</i>		Description	ROOM 7, FLOOR, UNDER MODIFIED FLOORING, ON SLAB - MASTIC		
		Homogeneity	Heterogeneous		
PLM NYS 198.1 Friable					Not Analyzed
PLM NYS 198.6 VCM					Not Analyzed
PLM NYS 198.6 NOB	01/16/2020	Black		100.00% Other	Inconclusive: None Detected
TEM NYS 198.4 NOB	01/16/2020	Black		100.00% Other	None Detected
Sample ID 3106-61 <i>032000750-0061</i>		Description	ROOM 7, FLOOR, UNDER MODIFIED FLOORING, ON SLAB - MASTIC		
		Homogeneity	Heterogeneous		
PLM NYS 198.1 Friable					Not Analyzed
PLM NYS 198.6 VCM					Not Analyzed
PLM NYS 198.6 NOB	01/16/2020	Black		100.00% Other	Inconclusive: None Detected
TEM NYS 198.4 NOB	01/16/2020	Black		100.00% Other	None Detected
Sample ID 3106-62 <i>032000750-0062</i>		Description	ROOM 8, FLOOR, UNDER CARPET, ON SLAB - CARPET MASTIC		
		Homogeneity	Heterogeneous		
PLM NYS 198.1 Friable					Not Analyzed
PLM NYS 198.6 VCM					Not Analyzed
PLM NYS 198.6 NOB	01/16/2020	Yellow		100.00% Other	Inconclusive: None Detected
TEM NYS 198.4 NOB	01/16/2020	Yellow		100.00% Other	None Detected
Sample ID 3106-63 <i>032000750-0063</i>		Description	ROOM 8, FLOOR, UNDER CARPET, ON SLAB - CARPET MASTIC		
		Homogeneity	Heterogeneous		
PLM NYS 198.1 Friable					Not Analyzed
PLM NYS 198.6 VCM					Not Analyzed
PLM NYS 198.6 NOB	01/16/2020	Yellow		100.00% Other	Inconclusive: None Detected
TEM NYS 198.4 NOB	01/16/2020	Yellow		100.00% Other	None Detected
Sample ID 3106-64 <i>032000750-0064</i>		Description	ROOM 9, FLOOR, BOTTOM LAYER, 1'X1', WHITE - FLOOR TILE		
		Homogeneity	Heterogeneous		
PLM NYS 198.1 Friable					Not Analyzed
PLM NYS 198.6 VCM					Not Analyzed
PLM NYS 198.6 NOB	01/16/2020	White		100.00% Other	Inconclusive: None Detected
TEM NYS 198.4 NOB	01/16/2020	White		100.00% Other	None Detected
Sample ID 3106-65 <i>032000750-0065</i>		Description	ROOM 9, FLOOR, BOTTOM LAYER, 1'X1', WHITE, ON SLAB - FLOOR TILE		
		Homogeneity	Heterogeneous		
PLM NYS 198.1 Friable					Not Analyzed
PLM NYS 198.6 VCM					Not Analyzed
PLM NYS 198.6 NOB	01/16/2020	White		100.00% Other	Inconclusive: None Detected
TEM NYS 198.4 NOB	01/16/2020	White		100.00% Other	None Detected

Initial report from: 01/16/2020 10:24:11



EMSL Analytical, Inc.

307 West 38th Street New York, NY 10018

Tel/Fax: (212) 290-0051 / (212) 290-0058

<http://www.EMSL.com / manhattanlab@emsl.com>

EMSL Order: 032000750
Customer ID: QUES51
Customer PO:
Project ID:

Test Report:Asbestos Analysis of Bulk Material

Test	Analyzed Date	Color	Non-Asbestos		Asbestos
			Fibrous	Non-Fibrous	
Sample ID 3106-66 <i>032000750-0066</i>			Description ROOM 9, FLOOR, TOP LAYER, ON 1'X1' FLOOR TILE - PEEN 'N' STICK FLOOR TILE		
			Homogeneity Heterogeneous		
PLM NYS 198.1 Friable					Not Analyzed
PLM NYS 198.6 VCM					Not Analyzed
PLM NYS 198.6 NOB	01/16/2020	Gray		100.00% Other	Inconclusive: None Detected
Final Residue <1% of original subsample					
TEM NYS 198.4 NOB	01/16/2020	Gray		100.00% Other	None Detected
Sample ID 3106-67 <i>032000750-0067</i>			Description ROOM 9, FLOOR, TOP LAYER, ON 1'X1' FLOOR TILE - PEEN 'N' STICK FLOOR TILE		
			Homogeneity Heterogeneous		
PLM NYS 198.1 Friable					Not Analyzed
PLM NYS 198.6 VCM					Not Analyzed
PLM NYS 198.6 NOB	01/16/2020	Gray		100.00% Other	Inconclusive: None Detected
Final Residue <1% of original subsample					
TEM NYS 198.4 NOB	01/16/2020	Gray		100.00% Other	None Detected
Sample ID 3106-68-Block <i>032000750-0068</i>			Description GARAGE 2, WALL - CEMENTITIOUS BLOCK & MORTAR		
			Homogeneity Homogeneous		
PLM NYS 198.1 Friable	01/16/2020	Gray		15.00% Ca Carbonate 45.00% Non-fibrous (other) 40.00% Quartz	None Detected
PLM NYS 198.6 VCM					Not Analyzed
PLM NYS 198.6 NOB					Not Analyzed
TEM NYS 198.4 NOB					Not Analyzed
Sample ID 3106-68-Mortar <i>032000750-0068A</i>			Description GARAGE 2, WALL - CEMENTITIOUS BLOCK & MORTAR		
			Homogeneity Homogeneous		
PLM NYS 198.1 Friable	01/16/2020	Gray		25.00% Ca Carbonate 35.00% Non-fibrous (other) 40.00% Quartz	None Detected
PLM NYS 198.6 VCM					Not Analyzed
PLM NYS 198.6 NOB					Not Analyzed
TEM NYS 198.4 NOB					Not Analyzed
Sample ID 3106-69-Block <i>032000750-0069</i>			Description GARAGE 1, WALL - CEMENTITIOUS BLOCK & MORTAR		
			Homogeneity Homogeneous		
PLM NYS 198.1 Friable	01/16/2020	Gray		35.00% Ca Carbonate 45.00% Non-fibrous (other) 20.00% Quartz	None Detected
PLM NYS 198.6 VCM					Not Analyzed
PLM NYS 198.6 NOB					Not Analyzed
TEM NYS 198.4 NOB					Not Analyzed

Initial report from: 01/16/2020 10:24:11



EMSL Analytical, Inc.

307 West 38th Street New York, NY 10018

Tel/Fax: (212) 290-0051 / (212) 290-0058

<http://www.EMSL.com> / manhattanlab@emsl.com

EMSL Order: 032000750

Customer ID: QUES51

Customer PO:

Project ID:

Test Report:Asbestos Analysis of Bulk Material

Test	Analyzed Date	Color	Non-Asbestos		Asbestos
			Fibrous	Non-Fibrous	
Sample ID 3106-69-Mortar 032000750-0069A		Description	GARAGE 1, WALL - CEMENTITIOUS BLOCK & MORTAR		
		Homogeneity	Homogeneous		
PLM NYS 198.1 Friable	01/16/2020	Gray		30.00% Ca Carbonate 45.00% Non-fibrous (other) 25.00% Quartz	None Detected
PLM NYS 198.6 VCM					Not Analyzed
PLM NYS 198.6 NOB					Not Analyzed
TEM NYS 198.4 NOB					Not Analyzed
Sample ID 3106-70 032000750-0070		Description	GARAGE 2, FLOOR - CEMENTITIOUS SLAB		
		Homogeneity	Homogeneous		
PLM NYS 198.1 Friable	01/16/2020	Gray		30.00% Ca Carbonate 30.00% Non-fibrous (other) 40.00% Quartz	None Detected
PLM NYS 198.6 VCM					Not Analyzed
PLM NYS 198.6 NOB					Not Analyzed
TEM NYS 198.4 NOB					Not Analyzed
Sample ID 3106-71 032000750-0071		Description	GARAGE 1, FLOOR - CEMENTITIOUS SLAB		
		Homogeneity	Homogeneous		
PLM NYS 198.1 Friable	01/16/2020	Gray		45.00% Ca Carbonate 30.00% Non-fibrous (other) 25.00% Quartz	None Detected
PLM NYS 198.6 VCM					Not Analyzed
PLM NYS 198.6 NOB					Not Analyzed
TEM NYS 198.4 NOB					Not Analyzed
Sample ID 3106-72 032000750-0072		Description	ROOM 1, WALL - CEMENT PANELS		
		Homogeneity	Homogeneous		
PLM NYS 198.1 Friable	01/16/2020	Gray/ White	None	25.00% Ca Carbonate 39.00% Non-fibrous (other)	36.00% Chrysotile
PLM NYS 198.6 VCM					Not Analyzed
PLM NYS 198.6 NOB					Not Analyzed
TEM NYS 198.4 NOB					Not Analyzed
Sample ID 3106-73 032000750-0073		Description	ROOM 1, CEILING - CEMENT PANELS		
		Homogeneity			
PLM NYS 198.1 Friable	01/16/2020				Positive Stop (Not Analyzed)
PLM NYS 198.6 VCM					Not Analyzed
PLM NYS 198.6 NOB					Not Analyzed
TEM NYS 198.4 NOB					Not Analyzed
Sample ID 3106-74 032000750-0074		Description	ROOM 2, WALL, AROUND METAL EXHAUST PIPE, ON SHEETROCK - FLUE PACKING		
		Homogeneity	Homogeneous		
PLM NYS 198.1 Friable	01/16/2020	Gray/ Yellow	15.00% Fibrous (other) 15.00% Min. Wool	70.00% Non-fibrous (other)	None Detected
PLM NYS 198.6 VCM					Not Analyzed
PLM NYS 198.6 NOB					Not Analyzed
TEM NYS 198.4 NOB					Not Analyzed

Initial report from: 01/16/2020 10:24:11



EMSL Analytical, Inc.

307 West 38th Street New York, NY 10018

Tel/Fax: (212) 290-0051 / (212) 290-0058

<http://www.EMSL.com / manhattanlab@emsl.com>

EMSL Order: 032000750
Customer ID: QUES51
Customer PO:
Project ID:

Test Report:Asbestos Analysis of Bulk Material

Test	Analyzed Date	Color	Non-Asbestos		Asbestos
			Fibrous	Non-Fibrous	
Sample ID 3106-75 <i>032000750-0075</i>		Description	ROOM 2, WALL, AROUND METAL EXHAUST PIPE, ON SHEETROCK - FLUE PACKING		
		Homogeneity	Heterogeneous		
PLM NYS 198.1 Friable	01/16/2020	Gray/ Yellow	15.00% Glass 20.00% Wollastonite	30.00% Ca Carbonate 35.00% Non-fibrous (other)	None Detected
PLM NYS 198.6 VCM					Not Analyzed
PLM NYS 198.6 NOB					Not Analyzed
TEM NYS 198.4 NOB					Not Analyzed
Sample ID 3106-76 <i>032000750-0076</i>		Description	GARAGE 2, AIR HANDLER #2 - VIBRATION DAMPENER		
		Homogeneity	Heterogeneous		
PLM NYS 198.1 Friable					Not Analyzed
PLM NYS 198.6 VCM					Not Analyzed
PLM NYS 198.6 NOB	01/16/2020	Black		100.00% Other	Inconclusive: None Detected
TEM NYS 198.4 NOB	01/16/2020	Black		100.00% Other	None Detected
Sample ID 3106-77 <i>032000750-0077</i>		Description	GARAGE 2, AIR HANDLER #2 - VIBRATION DAMPENER		
		Homogeneity	Heterogeneous		
PLM NYS 198.1 Friable					Not Analyzed
PLM NYS 198.6 VCM					Not Analyzed
PLM NYS 198.6 NOB	01/16/2020	Black		100.00% Other	Inconclusive: None Detected
Final Residue <1% of original subsample					
TEM NYS 198.4 NOB	01/16/2020	Black		100.00% Other	None Detected
Sample ID 3106-78 <i>032000750-0078</i>		Description	GARAGE 1, AIR HANDLER - VIBRATION DAMPENER		
		Homogeneity	Heterogeneous		
PLM NYS 198.1 Friable					Not Analyzed
PLM NYS 198.6 VCM					Not Analyzed
PLM NYS 198.6 NOB	01/16/2020	Black		100.00% Other	Inconclusive: None Detected
Final Residue <1% of original subsample					
TEM NYS 198.4 NOB	01/16/2020	Black		100.00% Other	None Detected
Sample ID 3106-79 <i>032000750-0079</i>		Description	GARAGE 1, AIR HANDLER - VIBRATION DAMPENER		
		Homogeneity	Heterogeneous		
PLM NYS 198.1 Friable					Not Analyzed
PLM NYS 198.6 VCM					Not Analyzed
PLM NYS 198.6 NOB	01/16/2020	Black		100.00% Other	Inconclusive: None Detected
Final Residue <1% of original subsample					
TEM NYS 198.4 NOB	01/16/2020	Black		100.00% Other	None Detected
Sample ID 3106-80 <i>032000750-0080</i>		Description	GARAGE 1, WINDOW, WOOD TO GLASS - GLAZING		
		Homogeneity	Heterogeneous		
PLM NYS 198.1 Friable					Not Analyzed
PLM NYS 198.6 VCM					Not Analyzed
PLM NYS 198.6 NOB	01/16/2020	Gray/ Black		100.00% Other	Inconclusive: None Detected
TEM NYS 198.4 NOB	01/16/2020	Gray/ Black		100.00% Other	None Detected

Initial report from: 01/16/2020 10:24:11



EMSL Analytical, Inc.

307 West 38th Street New York, NY 10018

Tel/Fax: (212) 290-0051 / (212) 290-0058

<http://www.EMSL.com> / manhattanlab@emsl.com

EMSL Order: 032000750

Customer ID: QUES51

Customer PO:

Project ID:

Test Report:Asbestos Analysis of Bulk Material

Test	Analyzed Date	Color	Non-Asbestos		Asbestos
			Fibrous	Non-Fibrous	
Sample ID 3106-81 <i>032000750-0081</i>		Description	BATHROOM 1, WINDOW, WOOD TO GLASS - GLAZING		
		Homogeneity	Heterogeneous		
PLM NYS 198.1 Friable					Not Analyzed
PLM NYS 198.6 VCM					Not Analyzed
PLM NYS 198.6 NOB	01/16/2020	Gray/ Black		100.00% Other	Inconclusive: None Detected
TEM NYS 198.4 NOB	01/16/2020	Gray/ Black		100.00% Other	None Detected
Sample ID 3106-82 <i>032000750-0082</i>		Description	EXTERIOR, CORNER FAÇADE - STUCCO		
		Homogeneity	Homogeneous		
PLM NYS 198.1 Friable	01/16/2020	Gray/ White		40.00% Ca Carbonate 30.00% Non-fibrous (other) 30.00% Quartz	None Detected
PLM NYS 198.6 VCM					Not Analyzed
PLM NYS 198.6 NOB					Not Analyzed
TEM NYS 198.4 NOB					Not Analyzed
Sample ID 3106-83 <i>032000750-0083</i>		Description	EXTERIOR, CORNER FAÇADE - STUCCO		
		Homogeneity	Homogeneous		
PLM NYS 198.1 Friable	01/16/2020	Gray/ White		40.00% Ca Carbonate 30.00% Non-fibrous (other) 30.00% Quartz	None Detected
PLM NYS 198.6 VCM					Not Analyzed
PLM NYS 198.6 NOB					Not Analyzed
TEM NYS 198.4 NOB					Not Analyzed
Sample ID 3106-84 <i>032000750-0084</i>		Description	EXTERIOR, CORNER FAÇADE - STUCCO		
		Homogeneity	Homogeneous		
PLM NYS 198.1 Friable	01/16/2020	Gray/ White		40.00% Ca Carbonate 30.00% Non-fibrous (other) 30.00% Quartz	None Detected
PLM NYS 198.6 VCM					Not Analyzed
PLM NYS 198.6 NOB					Not Analyzed
TEM NYS 198.4 NOB					Not Analyzed
Sample ID 3106-85 <i>032000750-0085</i>		Description	EXTERIOR, CORNER FAÇADE - STUCCO		
		Homogeneity	Homogeneous		
PLM NYS 198.1 Friable	01/16/2020	Beige		45.00% Ca Carbonate 25.00% Non-fibrous (other) 30.00% Quartz	None Detected
PLM NYS 198.6 VCM					Not Analyzed
PLM NYS 198.6 NOB					Not Analyzed
TEM NYS 198.4 NOB					Not Analyzed

Initial report from: 01/16/2020 10:24:11



EMSL Analytical, Inc.

307 West 38th Street New York, NY 10018

Tel/Fax: (212) 290-0051 / (212) 290-0058

<http://www.EMSL.com / manhattanlab@emsl.com>

EMSL Order: 032000750
Customer ID: QUES51
Customer PO:
Project ID:

Test Report:Asbestos Analysis of Bulk Material

Test	Analyzed Date	Color	Non-Asbestos		Asbestos
			Fibrous	Non-Fibrous	
Sample ID 3106-86 <i>032000750-0086</i>		Description	EXTERIOR, CORNER FAÇADE - STUCCO		
		Homogeneity	Homogeneous		
PLM NYS 198.1 Friable	01/16/2020	Beige		45.00% Ca Carbonate 25.00% Non-fibrous (other) 30.00% Quartz	None Detected
PLM NYS 198.6 VCM					Not Analyzed
PLM NYS 198.6 NOB					Not Analyzed
TEM NYS 198.4 NOB					Not Analyzed
Sample ID 3106-87 <i>032000750-0087</i>		Description	EXTERIOR, WINDOW, GLASS TO METAL - CAULK		
		Homogeneity	Heterogeneous		
PLM NYS 198.1 Friable					Not Analyzed
PLM NYS 198.6 VCM					Not Analyzed
PLM NYS 198.6 NOB	01/16/2020	Black		100.00% Other	Inconclusive: None Detected
Final Residue <1% of original subsample					
TEM NYS 198.4 NOB	01/16/2020	Black		100.00% Other	None Detected
Sample ID 3106-88 <i>032000750-0088</i>		Description	EXTERIOR, WINDOW, GLASS TO METAL - CAULK		
		Homogeneity	Heterogeneous		
PLM NYS 198.1 Friable					Not Analyzed
PLM NYS 198.6 VCM					Not Analyzed
PLM NYS 198.6 NOB	01/16/2020	Black		100.00% Other	Inconclusive: None Detected
Final Residue <1% of original subsample					
TEM NYS 198.4 NOB	01/16/2020	Black		100.00% Other	None Detected
Sample ID 3106-89 <i>032000750-0089</i>		Description	EXTERIOR, DOOR, METAL CASE TO CMU - CAULK		
		Homogeneity	Heterogeneous		
PLM NYS 198.1 Friable					Not Analyzed
PLM NYS 198.6 VCM					Not Analyzed
PLM NYS 198.6 NOB	01/16/2020	Gray	<1.00% Fibrous (other)	100.00% Other	Inconclusive: None Detected
TEM NYS 198.4 NOB	01/16/2020	Gray		100.00% Other	None Detected
Sample ID 3106-90 <i>032000750-0090</i>		Description	EXTERIOR, DOOR, METAL CASE TO CMU - CAULK		
		Homogeneity	Heterogeneous		
PLM NYS 198.1 Friable					Not Analyzed
PLM NYS 198.6 VCM					Not Analyzed
PLM NYS 198.6 NOB	01/16/2020	Gray	<1.00% Fibrous (other)	100.00% Other	Inconclusive: None Detected
TEM NYS 198.4 NOB	01/16/2020	Gray		100.00% Other	None Detected
Sample ID 3106-91 <i>032000750-0091</i>		Description	ROOF, FIELD, TOP LAYER - ROLLED ROOFING		
		Homogeneity	Heterogeneous		
PLM NYS 198.1 Friable					Not Analyzed
PLM NYS 198.6 VCM					Not Analyzed
PLM NYS 198.6 NOB	01/16/2020	White/ Black	<1.00% Fibrous (other)	100.00% Other	Inconclusive: None Detected
TEM NYS 198.4 NOB	01/16/2020	White/ Black		100.00% Other	None Detected

Initial report from: 01/16/2020 10:24:11



EMSL Analytical, Inc.

307 West 38th Street New York, NY 10018

Tel/Fax: (212) 290-0051 / (212) 290-0058

<http://www.EMSL.com> / manhattanlab@emsl.com

EMSL Order: 032000750

Customer ID: QUES51

Customer PO:

Project ID:

Test Report:Asbestos Analysis of Bulk Material

Test	Analyzed Date	Color	Non-Asbestos		Asbestos
			Fibrous	Non-Fibrous	
Sample ID 3106-92 <i>032000750-0092</i>			Description ROOF, FIELD, TOP LAYER - ROLLED ROOFING Homogeneity Heterogeneous		
PLM NYS 198.1 Friable					Not Analyzed
PLM NYS 198.6 VCM					Not Analyzed
PLM NYS 198.6 NOB	01/16/2020	White/ Black	<1.00% Fibrous (other)	100.00% Other	Inconclusive: None Detected
TEM NYS 198.4 NOB	01/16/2020	White/ Black		100.00% Other	None Detected
Sample ID 3106-93 <i>032000750-0093</i>			Description ROOF, FIELD, SECOND LAYER - BUILT-UP ROOFING Homogeneity Heterogeneous		
PLM NYS 198.1 Friable					Not Analyzed
PLM NYS 198.6 VCM					Not Analyzed
PLM NYS 198.6 NOB	01/16/2020	Black	None	98.30% Other	1.70% Chrysotile
TEM NYS 198.4 NOB	01/16/2020				Positive Stop (Not Analyzed)
Sample ID 3106-94 <i>032000750-0094</i>			Description ROOF, FIELD, SECOND LAYER - BUILT-UP ROOFING Homogeneity		
PLM NYS 198.1 Friable					Not Analyzed
PLM NYS 198.6 VCM					Not Analyzed
PLM NYS 198.6 NOB	01/16/2020				Positive Stop (Not Analyzed)
TEM NYS 198.4 NOB	01/16/2020				Positive Stop (Not Analyzed)
Sample ID 3106-95 <i>032000750-0095</i>			Description ROOF, FIELD, BOTTOM LAYER, ON METAL - FIBERBOARD Homogeneity Homogeneous		
PLM NYS 198.1 Friable	01/16/2020	Brown	95.00% Cellulose	5.00% Non-fibrous (other)	None Detected
PLM NYS 198.6 VCM					Not Analyzed
PLM NYS 198.6 NOB					Not Analyzed
TEM NYS 198.4 NOB					Not Analyzed
Sample ID 3106-96 <i>032000750-0096</i>			Description ROOF, FIELD, BOTTOM LAYER, ON METAL - FIBERBOARD Homogeneity Homogeneous		
PLM NYS 198.1 Friable	01/16/2020	Brown	70.00% Cellulose	25.00% Non-fibrous (other) 5.00% Quartz	None Detected
PLM NYS 198.6 VCM					Not Analyzed
PLM NYS 198.6 NOB					Not Analyzed
TEM NYS 198.4 NOB					Not Analyzed
Sample ID 3106-97 <i>032000750-0097</i>			Description ROOF, PERIMETER FLASHING, TOP LAYER - ROLLED ROOFING Homogeneity Heterogeneous		
PLM NYS 198.1 Friable					Not Analyzed
PLM NYS 198.6 VCM					Not Analyzed
PLM NYS 198.6 NOB	01/16/2020	White/ Black	<1.00% Fibrous (other)	100.00% Other	Inconclusive: None Detected
TEM NYS 198.4 NOB	01/16/2020	White/ Black		100.00% Other	None Detected

Initial report from: 01/16/2020 10:24:11



EMSL Analytical, Inc.

307 West 38th Street New York, NY 10018

Tel/Fax: (212) 290-0051 / (212) 290-0058

<http://www.EMSL.com> / manhattanlab@emsl.com

EMSL Order: 032000750

Customer ID: QUES51

Customer PO:

Project ID:

Test Report:Asbestos Analysis of Bulk Material

Test	Analyzed Date	Color	Non-Asbestos		Asbestos
			Fibrous	Non-Fibrous	
Sample ID 3106-98 032000750-0098			Description ROOF, PERIMETER FLASHING, TOP LAYER - ROLLED ROOFING		
			Homogeneity Heterogeneous		
PLM NYS 198.1 Friable					Not Analyzed
PLM NYS 198.6 VCM					Not Analyzed
PLM NYS 198.6 NOB	01/16/2020	White/ Black	<1.00% Fibrous (other)	100.00% Other	Inconclusive: None Detected
TEM NYS 198.4 NOB	01/16/2020	White/ Black		100.00% Other	None Detected
Sample ID 3106-99 032000750-0099			Description ROOF, PERIMETER FLASHING, SECOND LAYER - TAR		
			Homogeneity Heterogeneous		
PLM NYS 198.1 Friable					Not Analyzed
PLM NYS 198.6 VCM					Not Analyzed
PLM NYS 198.6 NOB	01/16/2020	Black	None	98.20% Other	1.80% Chrysotile
TEM NYS 198.4 NOB	01/16/2020				Positive Stop (Not Analyzed)
Sample ID 3106-100 032000750-0100			Description ROOF, PERIMETER FLASHING, SECOND LAYER - TAR		
			Homogeneity		
PLM NYS 198.1 Friable					Not Analyzed
PLM NYS 198.6 VCM					Not Analyzed
PLM NYS 198.6 NOB	01/16/2020				Positive Stop (Not Analyzed)
TEM NYS 198.4 NOB	01/16/2020				Positive Stop (Not Analyzed)
Sample ID 3106-101 032000750-0101			Description ROOF, PERIMETER FLASHING, BOTTOM LAYER, ON METAL - FIBERBOARD		
			Homogeneity Homogeneous		
PLM NYS 198.1 Friable	01/16/2020	Brown	95.00% Cellulose	5.00% Non-fibrous (other)	None Detected
PLM NYS 198.6 VCM					Not Analyzed
PLM NYS 198.6 NOB					Not Analyzed
TEM NYS 198.4 NOB					Not Analyzed
Sample ID 3106-102 032000750-0102			Description ROOF, PERIMETER FLASHING, BOTTOM LAYER, ON METAL - FIBERBOARD		
			Homogeneity Homogeneous		
PLM NYS 198.1 Friable	01/16/2020	Brown	85.00% Cellulose	15.00% Non-fibrous (other)	None Detected
PLM NYS 198.6 VCM					Not Analyzed
PLM NYS 198.6 NOB					Not Analyzed
TEM NYS 198.4 NOB					Not Analyzed
Sample ID 3106-103 032000750-0103			Description ROOF, A/C UNIT 1, PITCH POCKET - TAR		
			Homogeneity Heterogeneous		
PLM NYS 198.1 Friable					Not Analyzed
PLM NYS 198.6 VCM					Not Analyzed
PLM NYS 198.6 NOB	01/16/2020	Black/ Green	None	89.00% Other	11.00% Chrysotile
TEM NYS 198.4 NOB	01/16/2020				Positive Stop (Not Analyzed)

Initial report from: 01/16/2020 10:24:11



EMSL Analytical, Inc.

307 West 38th Street New York, NY 10018

Tel/Fax: (212) 290-0051 / (212) 290-0058

<http://www.EMSL.com> / manhattanlab@emsl.com

EMSL Order: 032000750

Customer ID: QUES51

Customer PO:

Project ID:

Test Report:Asbestos Analysis of Bulk Material

Test	Analyzed Date	Color	Non-Asbestos		Asbestos
			Fibrous	Non-Fibrous	
Sample ID 3106-104 032000750-0104			Description ROOF, A/C UNIT 2, PITCH POCKET - TAR Homogeneity		
PLM NYS 198.1 Friable					Not Analyzed
PLM NYS 198.6 VCM					Not Analyzed
PLM NYS 198.6 NOB	01/16/2020				Positive Stop (Not Analyzed)
TEM NYS 198.4 NOB	01/16/2020				Positive Stop (Not Analyzed)
Sample ID 3106-105 032000750-0105			Description ROOF, ON METAL VENT PIPE - FLASHING TAR Homogeneity Heterogeneous		
PLM NYS 198.1 Friable					Not Analyzed
PLM NYS 198.6 VCM					Not Analyzed
PLM NYS 198.6 NOB	01/16/2020	Black/ Green	None	91.30% Other	8.70% Chrysotile
TEM NYS 198.4 NOB	01/16/2020				Positive Stop (Not Analyzed)
Sample ID 3106-106 032000750-0106			Description ROOF, A/C UNIT 1, ON METAL DUNNAGE - FLASHING TAR Homogeneity		
PLM NYS 198.1 Friable					Not Analyzed
PLM NYS 198.6 VCM					Not Analyzed
PLM NYS 198.6 NOB	01/16/2020				Positive Stop (Not Analyzed)
TEM NYS 198.4 NOB	01/16/2020				Positive Stop (Not Analyzed)
Sample ID 3106-107 032000750-0107			Description ROOF, FIELD, ON EPDM - WHITE COATING Homogeneity Heterogeneous		
PLM NYS 198.1 Friable					Not Analyzed
PLM NYS 198.6 VCM					Not Analyzed
PLM NYS 198.6 NOB	01/16/2020	White	<1.00% Fibrous (other)	100.00% Other	Inconclusive: None Detected
TEM NYS 198.4 NOB	01/16/2020	White		100.00% Other	None Detected
Sample ID 3106-108 032000750-0108			Description ROOF, FIELD, ON EPDM - WHITE COATING Homogeneity Heterogeneous		
PLM NYS 198.1 Friable					Not Analyzed
PLM NYS 198.6 VCM					Not Analyzed
PLM NYS 198.6 NOB	01/16/2020	White	<1.00% Fibrous (other)	100.00% Other	Inconclusive: None Detected
TEM NYS 198.4 NOB	01/16/2020	White		100.00% Other	None Detected
Sample ID 3106-109 032000750-0109			Description ROOF, FIELD, TOP LAYER - EPDM Homogeneity Heterogeneous		
PLM NYS 198.1 Friable					Not Analyzed
PLM NYS 198.6 VCM					Not Analyzed
PLM NYS 198.6 NOB	01/16/2020	Black		100.00% Other	Inconclusive: None Detected
TEM NYS 198.4 NOB	01/16/2020	Black		100.00% Other	None Detected

Initial report from: 01/16/2020 10:24:11



EMSL Analytical, Inc.

307 West 38th Street New York, NY 10018

Tel/Fax: (212) 290-0051 / (212) 290-0058

<http://www.EMSL.com> / manhattanlab@emsl.com

EMSL Order: 032000750
Customer ID: QUES51
Customer PO:
Project ID:

Test Report:Asbestos Analysis of Bulk Material

Test	Analyzed Date	Color	Non-Asbestos		Asbestos
			Fibrous	Non-Fibrous	
Sample ID 3106-110 <i>032000750-0110</i>		Description	ROOF, FIELD, TOP LAYER - EPDM		
		Homogeneity	Heterogeneous		
PLM NYS 198.1 Friable					Not Analyzed
PLM NYS 198.6 VCM					Not Analyzed
PLM NYS 198.6 NOB	01/16/2020	Black		100.00% Other	Inconclusive: None Detected
TEM NYS 198.4 NOB	01/16/2020	Black		100.00% Other	None Detected
Sample ID 3106-111 <i>032000750-0111</i>		Description	ROOF, FIELD, BOTTOM LAYER, ON METAL - ISOFOAM		
		Homogeneity	Homogeneous		
PLM NYS 198.1 Friable Foam	01/16/2020	Yellow		100.00% Non-fibrous (other)	None Detected
PLM NYS 198.6 VCM					Not Analyzed
PLM NYS 198.6 NOB					Not Analyzed
TEM NYS 198.4 NOB					Not Analyzed
Sample ID 3106-112 <i>032000750-0112</i>		Description	ROOF, FIELD, BOTTOM LAYER, ON METAL - ISOFOAM		
		Homogeneity	Homogeneous		
PLM NYS 198.1 Friable Sample is Foam.	01/16/2020	Yellow		100.00% Non-fibrous (other)	None Detected
PLM NYS 198.6 VCM					Not Analyzed
PLM NYS 198.6 NOB					Not Analyzed
TEM NYS 198.4 NOB					Not Analyzed

Initial report from: 01/16/2020 10:24:11



EMSL Analytical, Inc.

307 West 38th Street New York, NY 10018

Tel/Fax: (212) 290-0051 / (212) 290-0058

<http://www.EMSL.com> / manhattanlab@emsl.com

EMSL Order: 032000750
Customer ID: QUES51
Customer PO:
Project ID:

Test Report:Asbestos Analysis of Bulk Material

The samples in this report were submitted to EMSL for analysis by Asbestos Analysis of Bulk Materials via NYS ELAP Approved Methods. The reference number for these samples is the EMSL Order ID above. Please use this reference number when calling about these samples.

Report Comments:

Sample Receipt Date: 1/11/2020
Analysis Completed Date: 1/16/2020

Sample Receipt Time: 10:49 AM
Analysis Completed Time: 4:11 AM

Analyst(s):

Jessica Cox PLM NYS 198.1 Friable (24)

Kerrie Gibson PLM NYS 198.1 Friable (18)

Jessica Cox PLM NYS 198.6 NOB (55)

Kerrie Gibson PLM NYS 198.6 NOB (2)

Kleyvin Vaquero PLM NYS 198.6 NOB (24)

Hongyan Ran TEM NYS 198.4 NOB (2)

Steven Li TEM NYS 198.4 NOB (60)

Venisha Lazarus-Barnes TEM NYS 198.4 NOB (14)

Samples reviewed and approved by:

James Hall, Laboratory Manager
or Other Approved Signatory

NOB = Non Friable Organically Bound N/A = Not Applicable VCM = Vermiculite Containing Material

-In New York State, TEM is currently the only method that can be used to determine if NOB materials can be considered or treated as non-asbestos containing.

All samples examined for the presence of vermiculite when analyzed via NYS 198.1.

-NYS Guidelines for Vermiculite containing samples are available at http://www.wadsworth.org/labcert/elapcert/forms/VermiculiteInterimGuidance_Rev070913.pdf EMSL maintains liability limited to cost of analysis. This report relates only to the samples reported above and may not be reproduced, except in full, without written approval by EMSL. EMSL bears no responsibility for sample collection activities or analytical method limitations. Interpretation and use of test results are the responsibility of the client. Samples were received in good condition unless otherwise noted.

This report must not be used by the client to claim product certification, approval, or endorsement by NVLAP, NIST, or any agency of the federal government. This report may contain data that is not covered by the NVLAP accreditation.

Samples analyzed by EMSL Analytical, Inc. New York, NY NYS ELAP 11506

Initial report from: 01/16/2020 10:24:11

032000750

QUALITY ENVIRONMENTAL SOLUTIONS & TECHNOLOGIES, INC.

BULK SAMPLE FORM

CLIENT: PVE, LLC
 ADDRESS: 48 Springside Ave
Poughkeepsie, NY 12603
 CONTACT: Conor Tarbell
 PROJECT ID: 164 Garden St, Poughkeepsie, NY 12601
Pre-Demo ASB Survey
 PROJECT #: Q20-3106

SAMPLED BY: J. Klemm, J. Mages, S. Talsma
T. Ranadive
 DATE SAMPLED: 9-Jan-20
 ANALYSIS METHOD: PLM/NOB/QTEM as Required **(HP)** **(HR)**
 TURN-AROUND TIME: _____ HOURS
5 DAYS
 OTHER

Please contact Laurence Goldstein (lgoldstein@qualityenv.com) if samples test positive for vermiculite

SAMPLE # LAB#	LOCATION	SAMPLE DESCRIPTION	COMMENTS
3106-01	Room 2, Wall, on Sheetrock	Joint Compound	ENCL. MATERIAL LAB RECEIVED 20 JAN 11 AM 10:49
3106-02	Room 2, Wall, on Sheetrock	Joint Compound	
3106-03	Room 4, Wall, on Sheetrock	Joint Compound	
3106-04	Bathroom 4, Ceiling, on Sheetrock	Joint Compound	
3106-05	Room 10, Ceiling, on Sheetrock	Joint Compound	
3106-06	Room 10, Ceiling, on Sheetrock	Tape	
3106-07	Room 2, Wall, on Sheetrock	Tape	
3106-08	Bathroom 1, Wall	Sheetrock	
3106-09	Hallway, Wall	Sheetrock	
3106-10	Room 9, Suspended Ceiling, 2' x 4', Smooth	Ceiling Tile	

Please contact Rudy Lipinski (rlipinski@qualityenv.com) if samples test positive for vermiculite

CHAIN OF CUSTODY (SEE LAST PAGE)

SUBMITTED BY: [Signature]

DATE: 1/10/2020

RECEIVED BY: [Signature]

DATE: 1/11/20

HR 1/16/2020

QUALITY ENVIRONMENTAL SOLUTIONS & TECHNOLOGIES, INC.

BULK SAMPLE FORM

CLIENT: PVE, LLC
 ADDRESS: 48 Springside Ave
Poughkeepsie, NY 12603
 CONTACT: Conor Tarbell
 PROJECT ID: 164 Garden St, Poughkeepsie, NY 12601
Pre-Demo ASB Survey
 PROJECT #: Q20-3106

SAMPLED BY: J. Klemm, J. Mages, S. Talsma
T. Ranadive
 DATE SAMPLED: 9-Jan-20
 ANALYSIS METHOD: PLM/NOB/QTEM as Required
 TURN-AROUND TIME: _____ HOURS
5 DAYS
 OTHER

20 JAN 11 AM 10:49
 EMSL MANHATTAN LAB
 RECEIVED

Please contact Laurence Goldstein (lgoldstein@qualityenv.com) if samples test positive for vermiculite

SAMPLE # LAB#	LOCATION	SAMPLE DESCRIPTION	COMMENTS
3106-11	Room 9, Suspended Ceiling, 2' x 4', Smooth	Ceiling Tile	First Positive
3106-12	Room 8, Suspended Ceiling, 2' x 4', Dot Canyon	Ceiling Tile	Stop At First
3106-13	Room 2, Suspended Ceiling, 2' x 4', Dot Canyon	Ceiling Tile	Positive
3106-14	Room 2, Wall, on Wood Panels, Tan	Cove Base Molding & Adhesive (Separate Layers)	Stop At First
3106-15	Room 2, Wall, on Wood Panels, Tan	Cove Base Molding & Adhesive (Separate Layers)	Positive
3106-16	Room 9, Wall, on Black Cove Base Molding, Yellow	Cove Base Molding & Adhesive (Separate Layers)	Stop At First
3106-17	Room 9, Wall, on Black Cove Base Molding, Yellow	Cove Base Molding & Adhesive (Separate Layers)	Positive
3106-18	Room 8, Wall, on Wood Panels, Brown	Cove Base Molding & Adhesive (Separate Layers)	Stop At First
3106-19	Room 8, Wall, on Wood Panels, Brown	Cove Base Molding & Adhesive (Separate Layers)	Positive
3106-20	Room 9, Wall, on Wood Panels, Gray	Cove Base Molding & Adhesive (Separate Layers)	Stop At

Please contact Rudy Lipinski (rlipinski@qualityenv.com) if samples test positive for vermiculite

CHAIN OF CUSTODY (SEE LAST PAGE)

SUBMITTED BY: [Signature]
 RECEIVED BY: [Signature]

DATE: 1/10/2020
 DATE: 1/11/20

HR 1/16/2020

QUALITY ENVIRONMENTAL SOLUTIONS & TECHNOLOGIES, INC.

BULK SAMPLE FORM

CLIENT: PVE, LLC
ADDRESS: 48 Springside Ave
Poughkeepsie, NY 12603
CONTACT: Conor Tarbell
PROJECT ID: 164 Garden St, Poughkeepsie, NY 12601
Pre-Demo ASB Survey
PROJECT #: Q20-3106

SAMPLED BY: J. Klemm, J. Magee, S. Talsma
T. Ranadive
DATE SAMPLED: 9-Jan-20
ANALYSIS METHOD: PLM/NOB/QTEM as Required
TURN-AROUND TIME: 5 DAYS

EMSL MANHATTAN LAB
RECEIVED
20 JAN 11 11:41 AM

Table with 4 columns: SAMPLE # LAB#, LOCATION, SAMPLE DESCRIPTION, COMMENTS. Contains 10 rows of sample data including locations like Room 9, Bathroom 1, and Bathroom 2, and descriptions like Cove Base Molding & Adhesive, Fiberboard & Adhesive, and Adhesive.

Please contact Rudy Lipinski (rlipinski@qualityenv.com) if samples test positive for vermiculite

CHAIN OF CUSTODY (SEE LAST PAGE)

SUBMITTED BY: [Signature]

DATE: 1/10/2020

RECEIVED BY: Leah Ranadive

DATE: 1/11/20

HR 1/16/2020

QUALITY ENVIRONMENTAL SOLUTIONS & TECHNOLOGIES, INC.

BULK SAMPLE FORM

CLIENT: PVE, LLC
ADDRESS: 48 Springside Ave
Poughkeepsie, NY 12603
CONTACT: Conor Tarbell
PROJECT ID: 164 Garden St, Poughkeepsie, NY 12601
Pre-Demo ASB Survey
PROJECT #: Q20-3106

SAMPLED BY: J. Klemm, J. Mages, S. Talsma
T. Ranadive
DATE SAMPLED: 9-Jan-20
ANALYSIS METHOD: PLM/NOB/QTEM as Required
TURN-AROUND TIME: 5 HOURS
5 DAYS
OTHER

20 JAN 11 AM 10:49
EMSL MANHATTAN LAB
RECEIVED

Table with 4 columns: SAMPLE # LAB#, LOCATION, SAMPLE DESCRIPTION, COMMENTS. Contains 10 rows of sample data with locations like Room 9, Room 6, Bathroom 3, Bathroom 4 and descriptions like Adhesive, Fiberboard, Ceramic Tile & Grout.

CHAIN OF CUSTODY (SEE LAST PAGE)

SUBMITTED BY: [Signature]
RECEIVED BY: Leah Roman

DATE: 1/10/2020
DATE: 1/11/20

HR 1/16/2020

QUALITY ENVIRONMENTAL SOLUTIONS & TECHNOLOGIES, INC.

BULK SAMPLE FORM

CLIENT: PVE, LLC SAMPLED BY: J. Klemm, J. Mages, S. Talsma
T. Ranadive
 ADDRESS: 48 Springside Ave DATE SAMPLED: 9-Jan-20
Poughkeepsie, NY 12603
 CONTACT: Conor Tarbell ANALYSIS METHOD: PLM/NOB/QTEM as Required
 PROJECT ID: 164 Garden St, Poughkeepsie, NY 12601 TURN-AROUND TIME: _____ HOURS
Pre-Demo ASB Survey 5 DAYS
 PROJECT #: Q20-3106 OTHER

EMSSL MANHATTAN LAB
 RECEIVED
 20 JAN 11 AM 10:4

Please contact Laurence Goldstein (lgoldstein@qualityenv.com) if samples test positive for vermiculite

SAMPLE # LAB#	LOCATION	SAMPLE DESCRIPTION	COMMENTS
3106-41	Bathroom 3, Floor	Ceramic Tile & Grout (Separate Layers)	First Positive
3106-42	Bathroom 4, Floor, Under Ceramic Tile, on Slab	Mudset	Stop At First
3106-43	Bathroom 3, Floor, Under Ceramic Tile, on Slab	Mudset	Positive
3106-44	Garage 1, Under Air Handler Unit	Fiber Panel	Stop At First
3106-45	Garage 1, Under Air Handler Unit	Fiber Panel	Positive
3106-46	Bathroom 1, Floor, 1' x 1', on Slab	Floor Tile & Mastic (Separate Layer)	Stop At First
3106-47	Bathroom 2, Floor, 1' x 1', on Slab	Floor Tile & Mastic (Separate Layer)	Positive
3106-48	Room 2, Farside, Floor, 1' x 1', Brown Matted	Floor Tile	Stop At First
3106-49	Room 2, Farside, Floor, 1' x 1', Brown Matted	Floor Tile	Positive
3106-50	Room 2, Farside, Floor, Under 1' x 1' Brown Matted Floor Tile, on Slab	Mastic	Stop At

Please contact Rudy Lipinski (rlipinski@qualityenv.com) if samples test positive for vermiculite

CHAIN OF CUSTODY (SEE LAST PAGE)

SUBMITTED BY: [Signature] DATE: 1/10/2020
 RECEIVED BY: [Signature] DATE: [Signature] 1/11/20

HR 1/16/2020

QUALITY ENVIRONMENTAL SOLUTIONS & TECHNOLOGIES, INC.

BULK SAMPLE FORM

CLIENT: PVE, LLC
 ADDRESS: 48 Springside Ave
Poughkeepsie, NY 12603
 CONTACT: Conor Tarbell
 PROJECT ID: 164 Garden St, Poughkeepsie, NY 12601
Pre-Demo ASB Survey
 PROJECT #: Q20-3106

SAMPLED BY: J. Klemm, J. Mages, S. Talsma
T. Ranadive
 DATE SAMPLED: 9-Jan-20
 ANALYSIS METHOD: PLM/NOB/QTEM as Required
 TURN-AROUND TIME: _____ HOURS
5 DAYS
 OTHER _____

EMSL MANHATTAN LAB
 RECEIVED
 20 JAN 11 AM 10:4

Please contact Laurence Goldstein (lgoldstein@qualityenv.com) if samples test positive for vermiculite

SAMPLE # LAB#	LOCATION	SAMPLE DESCRIPTION	COMMENTS
3106-51	Room 2, Farside, Floor, Under 1' x 1' Brown Matted Floor Tile, on Slab	Mastic	First Positive
3106-52	Room 2, Nearside, Floor, 1' x 1', on Slab	Peel 'N' Stick Floor Tile	Stop At First
3106-53	Room 2, Nearside, Floor, 1' x 1', on Slab	Peel 'N' Stick Floor Tile	Positive
3106-54	Room 2, Nearside, Floor, Under 1' x 1' Peel 'N' Stick Floor Tile, on Slab	Adhesive	Stop At First
3106-55	Room 2, Nearside, Floor, Under 1' x 1' Peel 'N' Stick Floor Tile, on Slab	Adhesive	Positive
3106-56	Room 9, Floor, Under 1' x 1' Floor Tile, on Slab	Mastic	Stop At First
3106-57	Room 9, Floor, Under 1' x 1' Floor Tile, on Slab	Mastic	Positive
3106-58	Room 7, Floor, on Slab	Modified Flooring	Stop At First
3106-59	Room 7, Floor, on Slab	Modified Flooring	Positive
3106-60	Room 7, Floor, Under Modified Flooring, on Slab	Mastic	Stop At

Please contact Rudy Lipinski (rlipinski@qualityenv.com) if samples test positive for vermiculite

CHAIN OF CUSTODY (SEE LAST PAGE)

SUBMITTED BY: [Signature] DATE: 1/10/2020
 RECEIVED BY: [Signature] DATE: 1/11/20

HR 1/16/2020

QUALITY ENVIRONMENTAL SOLUTIONS & TECHNOLOGIES, INC.

BULK SAMPLE FORM

CLIENT: PVE, LLC
 ADDRESS: 48 Springside Ave
Poughkeepsie, NY 12603
 CONTACT: Conor Tarbell
 PROJECT ID: 164 Garden St, Poughkeepsie, NY 12601
Pre-Demo ASB Survey
 PROJECT #: Q20-3106

SAMPLED BY: J. Klemm, J. Mages, S. Talsma
T. Ranadive
 DATE SAMPLED: 9-Jan-20
 ANALYSIS METHOD: PLM/NOB/QTEM as Required
 TURN-AROUND TIME: _____ HOURS
5 DAYS
 OTHER

20 JAN 11 AM 10:50
 EMSL MANHATTAN LAB
 RECEIVED

Please contact Laurence Goldstein (lgoldstein@qualityenv.com) if samples test positive for vermiculite

SAMPLE # LAB#	LOCATION	SAMPLE DESCRIPTION	COMMENTS
3106-61	Room 7, Floor, Under Modified Flooring, on Slab	Mastic	First Positive
3106-62	Room 8, Floor, Under Carpet, on Slab	Carpet Mastic	Stop At First
3106-63	Room 8, Floor, Under Carpet, on Slab	Carpet Mastic	Positive
3106-64	Room 9, Floor, Bottom Layer, 1' x 1' White	Floor Tile	Stop At First
3106-65	Room 9, Floor, Bottom Layer, 1' x 1' White, on Slab	Floor Tile	Positive
3106-66	Room 9, Floor, Top Layer, on 1' x 1' Floor Tile	Peel 'N' Stick Floor Tile	Stop At First
3106-67	Room 9, Floor, Top Layer, on 1' x 1' Floor Tile	Peel 'N' Stick Floor Tile	Positive
3106-68	Garage 2, Wall	Cementitious Block & Mortar (Separate Layers)	
3106-69	Garage 1, Wall	Cementitious Block & Mortar (Separate Layers)	
3106-70	Garage 2, Floor	Cementitious Slab	

Please contact Rudy Lipinski (rlipinski@qualityenv.com) if samples test positive for vermiculite

CHAIN OF CUSTODY (SEE LAST PAGE)

SUBMITTED BY: [Signature] DATE: 1/10/2020

RECEIVED BY: Leah Ramon DATE: 1/11/20 1050am

HR 1/16/20

QUALITY ENVIRONMENTAL SOLUTIONS & TECHNOLOGIES, INC.

BULK SAMPLE FORM

CLIENT: PVE, LLC
ADDRESS: 48 Springside Ave
Poughkeepsie, NY 12603
CONTACT: Conor Tarbell
PROJECT ID: 164 Garden St, Poughkeepsie, NY 12601
Pre-Demo ASB Survey
PROJECT #: Q20-3106

SAMPLED BY: J. Klemm, J. Mages, S. Talsma
T. Ranadive
DATE SAMPLED: 9-Jan-20
ANALYSIS METHOD: PLM/NOB/QTEM as Required
TURN-AROUND TIME: 5 DAYS

EMSL MANHATTAN LAB
RECEIVED
20 JAN 11 AM 10:50

Table with 4 columns: SAMPLE # LAB#, LOCATION, SAMPLE DESCRIPTION, COMMENTS. Contains 10 rows of sample data including locations like Garage 1, Room 1, Room 2, and Garage 2.

CHAIN OF CUSTODY (SEE LAST PAGE)

SUBMITTED BY: [Signature]

DATE: 1/10/2020

RECEIVED BY: Pearl Kamen

DATE: 1/11/20 1050am

HR 1/16/2020

QUALITY ENVIRONMENTAL SOLUTIONS & TECHNOLOGIES, INC.

BULK SAMPLE FORM

CLIENT: PVE, LLC
 ADDRESS: 48 Springside Ave
Poughkeepsie, NY 12603
 CONTACT: Conor Tarbell
 PROJECT ID: 164 Garden St, Poughkeepsie, NY 12601
Pre-Demo ASB Survey
 PROJECT #: Q20-3106

SAMPLED BY: J. Klemm, J. Mages, S. Talsma
T. Ranadive
 DATE SAMPLED: 9-Jan-20
 ANALYSIS METHOD: PLM/NOB/QTEM as Required
 TURN-AROUND TIME: _____ HOURS
5 DAYS
 OTHER

20 JAN 11 AM 10:50
 EMSL MANHATTAN LAB
 RECEIVED

Please contact Laurence Goldstein (lgoldstein@qualityenv.com) if samples test positive for vermiculite

SAMPLE # LAB#	LOCATION	SAMPLE DESCRIPTION	COMMENTS
3106-81	Bathroom 1, Window, Wood to Glass	Glazing	First Positive
3106-82	Exterior, Corner Façade	Stucco	
3106-83	Exterior, Corner Façade	Stucco	
3106-84	Exterior, Corner Façade	Stucco	
3106-85	Exterior, Corner Façade	Stucco	
3106-86	Exterior, Corner Façade	Stucco	
3106-87	Exterior, Window, Glass to Metal	Caulk	Stop At First Positive
3106-88	Exterior, Window, Glass to Metal	Caulk	
3106-89	Exterior, Door, Metal Case to CMU	Caulk	Stop At First Positive
3106-90	Exterior, Door, Metal Case to CMU	Caulk	

Please contact Rudy Lipinski (rlipinski@qualityenv.com) if samples test positive for vermiculite

CHAIN OF CUSTODY (SEE LAST PAGE)

SUBMITTED BY: [Signature]

DATE: 1/10/2020

RECEIVED BY: [Signature]

DATE: 1/11/20 10:50am

HR 1/16/20

QUALITY ENVIRONMENTAL SOLUTIONS & TECHNOLOGIES, INC.

BULK SAMPLE FORM

CLIENT: PVE, LLC

SAMPLED BY: J. Klemm, J. Mages, S. Talsma
T. Ranadive

ADDRESS: 48 Springside Ave

DATE SAMPLED: 9-Jan-20

Poughkeepsie, NY 12603

CONTACT: Conor Tarbell

ANALYSIS METHOD: PLM/NOB/QTEM as Required

PROJECT ID: 164 Garden St, Poughkeepsie, NY 12601

TURN-AROUND TIME: _____ HOURS

Pre-Demo ASB Survey

5 DAYS

PROJECT #: Q20-3106

OTHER

EMSL MANHATTAN LAB
RECEIVED
20 JAN 11 AM 10:50

Please contact Laurence Goldstein (lgoldstein@qualityenv.com) if samples test positive for vermiculite

SAMPLE # LAB#	LOCATION	SAMPLE DESCRIPTION	COMMENTS
3106-91	Roof, Field, Top Layer	Rolled Roofing	Stop At First
3106-92	Roof, Field, Top Layer	Rolled Roofing	Positive
3106-93	Roof, Field, Second Layer	Built-up Roofing	Stop At First
3106-94	Roof, Field, Second Layer	Built-up Roofing	Positive
3106-95	Roof, Field, Bottom Layer, on Metal	Fiberboard	
3106-96	Roof, Field, Bottom Layer, on Metal	Fiberboard	
3106-97	Roof, Perimeter Flashing, Top Layer	Rolled Roofing	Stop At First
3106-98	Roof, Perimeter Flashing, Top Layer	Rolled Roofing	Positive
3106-99	Roof, Perimeter Flashing, Second Layer	Tar	Stop At First
3106-100	Roof, Perimeter Flashing, Second Layer	Tar	Positive

Please contact Rudy Lipinski (rlipinski@qualityenv.com) if samples test positive for vermiculite

CHAIN OF CUSTODY (SEE LAST PAGE)

SUBMITTED BY: [Signature]

DATE: 1/10/2020

RECEIVED BY: [Signature]

DATE: 1/11/20 1050am

HR 1/16/2020

PAGE 10 OF 12

QUALITY ENVIRONMENTAL SOLUTIONS & TECHNOLOGIES, INC.

BULK SAMPLE FORM

CLIENT: PVE, LLC
 ADDRESS: 48 Springside Ave
Poughkeepsie, NY 12603
 CONTACT: Conor Tarbell
 PROJECT ID: 164 Garden St, Poughkeepsie, NY 12601
Pre-Demo ASB Survey
 PROJECT #: Q20-3106

SAMPLED BY: J. Klemm, J. Mages, S. Talsma
T. Ranadive
 DATE SAMPLED: 9-Jan-20
 ANALYSIS METHOD: PLM/NOB/QTEM as Required
 TURN-AROUND TIME: _____ HOURS
5 DAYS
 OTHER

20 JAN 11 AM 10:50
 EMSL MANHATTAN LAB
 RECEIVED

Please contact Laurence Goldstein (lgoldstein@qualityenv.com) if samples test positive for vermiculite

SAMPLE # LAB#	LOCATION	SAMPLE DESCRIPTION	COMMENTS
3106-101	Roof, Perimeter Flashing, Bottom Layer, on Metal	Fiberboard	
3106-102	Roof, Perimeter Flashing, Bottom Layer, on Metal	Fiberboard	
3106-103	Roof, A/C Unit 1, Pitch Pocket	Tar	
3106-104	Roof, A/C Unit 2, Pitch Pocket	Tar	
3106-105	Roof, on Metal Vent Pipe	Flashing Tar	
3106-106	Roof, A/C Unit 1, on Metal Dunnage	Flashing Tar	
3106-107	Roof, Field, on EPDM	White Coating	
3106-108	Roof, Field, on EPDM	White Coating	
3106-109	Roof, Field, Top Layer	EPDM	
3106-110	Roof, Field, Top Layer	EPDM	

Please contact Rudy Lipinski (rlipinski@qualityenv.com) if samples test positive for vermiculite

CHAIN OF CUSTODY (SEE LAST PAGE)

SUBMITTED BY: [Signature] DATE: 1/10/2020

RECEIVED BY: [Signature] DATE: 1/11/20 1050am

HR 1/16/2020

QUALITY ENVIRONMENTAL SOLUTIONS & TECHNOLOGIES, INC.

BULK SAMPLE FORM

CLIENT: PVE, LLC

SAMPLED BY: J. Klemm, J. Mages, S. Talsma
T. Ranadive

ADDRESS: 48 Springside Ave

DATE SAMPLED: 9-Jan-20

Poughkeepsie, NY 12603

CONTACT: Conor Tarbell

ANALYSIS METHOD: PLM/NOB/QTEM as Required

PROJECT ID: 164 Garden St, Poughkeepsie, NY 12601

TURN-AROUND TIME: _____ HOURS

Pre-Demo ASB Survey

5 DAYS

PROJECT #: Q20-3106

OTHER

20 JAN 11 AM 10:50
EMSL MANHATTAN LAB
RECEIVED

Please contact Laurence Goldstein (lgoldstein@qualityenv.com) if samples test positive for vermiculite

SAMPLE # LAB#	LOCATION	SAMPLE DESCRIPTION	COMMENTS
3106-111	Roof, Field, Bottom Layer, on Metal	Isofoam	
3106-112	Roof, Field, Bottom Layer, on Metal	Isofoam	

Please contact Rudy Lipinski (rlipinski@qualityenv.com) if samples test positive for vermiculite

CHAIN OF CUSTODY (SEE LAST PAGE)

SUBMITTED BY: 

DATE: 1/10/2020

RECEIVED BY: 

DATE: 1/11/20 1050am

HR 1/16/2020

032000750

QUALITY ENVIRONMENTAL SOLUTIONS & TECHNOLOGIES, INC.

BULK SAMPLE FORM

CLIENT: PVE, LLC
 ADDRESS: 48 Springside Ave
Poughkeepsie, NY 12603
 CONTACT: Conor Tarbell
 PROJECT ID: 164 Garden St, Poughkeepsie, NY 12601
Pre-Demo ASB Survey
 PROJECT #: Q20-3106

SAMPLED BY: J. Klemm, J. Mages, S. Talsma
T. Ranadive
 DATE SAMPLED: 9-Jan-20
 ANALYSIS METHOD: PLM/NOB/QTEM as Required 140
 TURN-AROUND TIME: _____ HOURS
5 DAYS
 OTHER

2/11/20

140

Please contact Laurence Goldstein (lgoldstein@qualityenv.com) if samples test positive for vermiculite

SAMPLE # LAB#	LOCATION	SAMPLE DESCRIPTION	COMMENTS
3106-01	Room 2, Wall, on Sheetrock	Joint Compound	ERNST HANNAH TAYLOR LAB RECEIVED 20 JAN 11 AM 10:49
3106-02	Room 2, Wall, on Sheetrock	Joint Compound	
3106-03	Room 4, Wall, on Sheetrock	Joint Compound	
3106-04	Bathroom 4, Ceiling, on Sheetrock	Joint Compound	
3106-05	Room 10, Ceiling, on Sheetrock	Joint Compound	
3106-06	Room 10, Ceiling, on Sheetrock	Tape	
3106-07	Room 2, Wall, on Sheetrock	Tape	
3106-08	Bathroom 1, Wall	Sheetrock	
3106-09	Hallway, Wall	Sheetrock	
3106-10	Room 9, Suspended Ceiling, 2' x 4', Smooth	Ceiling Tile	

Please contact Rudy Lipinski (rlipinski@qualityenv.com) if samples test positive for vermiculite

CHAIN OF CUSTODY (SEE LAST PAGE)

SUBMITTED BY: *[Signature]*
 RECEIVED BY: *[Signature]*

DATE: 1/10/2020
 DATE: 1/11/20

QUALITY ENVIRONMENTAL SOLUTIONS & TECHNOLOGIES, INC.

BULK SAMPLE FORM

20 JAN 11 AM 10:49
 EMSL MANHATTAN LAB
 RECEIVED

CLIENT: PVE, LLC
 ADDRESS: 48 Springside Ave
Poughkeepsie, NY 12603
 CONTACT: Conor Tarbell
 PROJECT ID: 164 Garden St, Poughkeepsie, NY 12601
Pre-Demo ASB Survey

SAMPLED BY: J. Klemm, J. Mages, S. Talsma
T. Ranadive
 DATE SAMPLED: 9-Jan-20
 ANALYSIS METHOD: PLM/NOB/QTEM as Required
 TURN-AROUND TIME: _____ HOURS
5 DAYS

PROJECT #: Q20-3106

OTHER

Please contact Laurence Goldstein (lgoldstein@qualityenv.com) if samples test positive for vermiculite

SAMPLE # LAB#	LOCATION	SAMPLE DESCRIPTION	COMMENTS
3106-11	Room 9, Suspended Ceiling, 2' x 4', Smooth	Ceiling Tile	First Positive
3106-12	Room 8, Suspended Ceiling, 2' x 4', Dot Canyon	Ceiling Tile	Stop At First
3106-13	Room 2, Suspended Ceiling, 2' x 4', Dot Canyon	Ceiling Tile	Positive
3106-14	Room 2, Wall, on Wood Panels, Tan	Cove Base Molding & Adhesive (Separate Layers)	Stop At First
3106-15	Room 2, Wall, on Wood Panels, Tan	Cove Base Molding & Adhesive (Separate Layers)	Positive
3106-16	Room 9, Wall, on Black Cove Base Molding, Yellow	Cove Base Molding & Adhesive (Separate Layers)	Stop At First
3106-17	Room 9, Wall, on Black Cove Base Molding, Yellow	Cove Base Molding & Adhesive (Separate Layers)	Positive
3106-18	Room 8, Wall, on Wood Panels, Brown	Cove Base Molding & Adhesive (Separate Layers)	Stop At First
3106-19	Room 8, Wall, on Wood Panels, Brown	Cove Base Molding & Adhesive (Separate Layers)	Positive
3106-20	Room 9, Wall, on Wood Panels, Gray	Cove Base Molding & Adhesive (Separate Layers)	Stop At

Please contact Rudy Lipinski (rlipinski@qualityenv.com) if samples test positive for vermiculite

CHAIN OF CUSTODY (SEE LAST PAGE)

SUBMITTED BY: [Signature]
 RECEIVED BY: [Signature]

DATE: 1/10/2020
 DATE: 1/11/20

QUALITY ENVIRONMENTAL SOLUTIONS & TECHNOLOGIES, INC.

BULK SAMPLE FORM

CLIENT: PVE, LLC
 ADDRESS: 48 Springside Ave
Poughkeepsie, NY 12603
 CONTACT: Conor Tarbell
 PROJECT ID: 164 Garden St, Poughkeepsie, NY 12601
Pre-Demo ASB Survey
 PROJECT #: Q20-3106

SAMPLED BY: J. Klemm, J. Magos, S. Talsma
T. Ranadive
 DATE SAMPLED: 9-Jan-20
 ANALYSIS METHOD: PLM/NOB/QTEM as Required
 TURN-AROUND TIME: _____ HOURS
5 DAYS
 OTHER

20 JAN 11 11:49 AM
 EMSL MANHATTAN LAB RECEIVED

Please contact Laurence Goldstein (lgoldstein@qualityenv.com) if samples test positive for vermiculite

SAMPLE # LAB#	LOCATION	SAMPLE DESCRIPTION	COMMENTS
3106-21	Room 9, Wall, on Wood Panels, Gray	Cove Base Molding & Adhesive (Separate Layers)	First Positive
3106-22	Bathroom 1, Wall Panel on Sheetrock	Fiberboard & Adhesive (Separate Layers)	Stop At First
3106-23	Bathroom 2, Wall Panel on Sheetrock	Fiberboard & Adhesive (Separate Layers)	Positive
3106-24	Room 9, Wall, Behind Wood Panels, on Sheetrock	Adhesive	Stop At First
3106-25	Room 8, Wall, Behind Wood Panels, on Sheetrock	Adhesive	Positive
3106-26	Room 9, Wall, Behind Wood Panels, on Sheetrock	Adhesive	Stop At First
3106-27	Room 9, Wall, Behind Wood Panels, on Sheetrock	Adhesive	Positive
3106-28	Room 9, Wall, on Fiberboard	Corkboard	
3106-29	Room 9, Wall, on Fiberboard	Corkboard	
3106-30	Room 9, Wall, Behind Corkboard, on Fiberboard	Adhesive	Stop At

Please contact Rudy Lipinski (rlipinski@qualityenv.com) if samples test positive for vermiculite

CHAIN OF CUSTODY (SEE LAST PAGE)

SUBMITTED BY: [Signature]
 RECEIVED BY: [Signature]

DATE: 1/10/2020
 DATE: 1/11/20

QUALITY ENVIRONMENTAL SOLUTIONS & TECHNOLOGIES, INC.

BULK SAMPLE FORM

CLIENT: PVE, LLC
 ADDRESS: 48 Springside Ave
Poughkeepsie, NY 12603
 CONTACT: Conor Tarbell
 PROJECT ID: 164 Garden St, Poughkeepsie, NY 12601
Pre-Demo ASB Survey
 PROJECT #: Q20-3106

SAMPLED BY: J. Klemm, J. Mages, S. Talsma
T. Ranadive
 DATE SAMPLED: 9-Jan-20
 ANALYSIS METHOD: PLM/NOB/QTEM as Required
 TURN-AROUND TIME: _____ HOURS
5 DAYS
 OTHER

20 JAN 11 AM 10:49
 EMSL MANHATTAN LAB
 RECEIVED

Please contact Laurence Goldstein (lgoldstein@qualityenv.com) if samples test positive for vermiculite

SAMPLE # LAB#	LOCATION	SAMPLE DESCRIPTION	COMMENTS
3106-31	Room 9, Wall, Behind Corkboard, on Fiberboard	Adhesive	First Positive
3106-32	Room 9, Wall, Behind Corkboard	Fiberboard	
3106-33	Room 9, Wall, Behind Corkboard	Fiberboard	
3106-34	Room 6, Behind Panels, on Sheetrock	Adhesive	Stop At First
3106-35	Room 6, Behind Panels, on Sheetrock	Adhesive	Positive
3106-36	Bathroom 3, Wall	Ceramic Tile & Grout (Separate Layers)	Stop At First
3106-37	Bathroom 4, Wall	Ceramic Tile & Grout (Separate Layers)	Positive
3106-38	Bathroom 3, Wall, Behind Ceramic Tile, on CMU	Adhesive	Stop At First
3106-39	Bathroom 4, Wall, Behind Ceramic Tile, on CMU	Adhesive	Positive
3106-40	Bathroom 4, Floor	Ceramic Tile & Grout (Separate Layers)	Stop At

Please contact Rudy Lipinski (rlipinski@qualityenv.com) if samples test positive for vermiculite

CHAIN OF CUSTODY (SEE LAST PAGE)

SUBMITTED BY: [Signature]
 RECEIVED BY: [Signature]

DATE: 1/10/2020
 DATE: 1/11/20

QUALITY ENVIRONMENTAL SOLUTIONS & TECHNOLOGIES, INC.

BULK SAMPLE FORM

CLIENT: PVE, LLC
 ADDRESS: 48 Springside Ave
Poughkeepsie, NY 12603
 CONTACT: Conor Tarbell
 PROJECT ID: 164 Garden St, Poughkeepsie, NY 12601
Pre-Demo ASB Survey
 PROJECT #: Q20-3106

SAMPLED BY: J. Klemm, J. Mages, S. Talsma
T. Ranadive
 DATE SAMPLED: 9-Jan-20
 ANALYSIS METHOD: PLM/NOB/QTEM as Required
 TURN-AROUND TIME: _____ HOURS
5 DAYS
 OTHER

20 JAN 11 AM 10:41
 EMSL MANHATTAN LAB RECEIVED

Please contact Laurence Goldstein (lgoldstein@qualityenv.com) if samples test positive for vermiculite

SAMPLE # LAB#	LOCATION	SAMPLE DESCRIPTION	COMMENTS
3106-41	Bathroom 3, Floor	Ceramic Tile & Grout (Separate Layers)	First Positive
3106-42	Bathroom 4, Floor, Under Ceramic Tile, on Slab	Mudset	Stop At First Positive
3106-43	Bathroom 3, Floor, Under Ceramic Tile, on Slab	Mudset	Positive
3106-44	Garage 1, Under Air Handler Unit	Fiber Panel	Stop At First Positive
3106-45	Garage 1, Under Air Handler Unit	Fiber Panel	Positive
3106-46	Bathroom 1, Floor, 1' x 1', on Slab	Floor Tile & Mastic (Separate Layer)	Stop At First Positive
3106-47	Bathroom 2, Floor, 1' x 1', on Slab	Floor Tile & Mastic (Separate Layer)	Positive
3106-48	Room 2, Farside, Floor, 1' x 1', Brown Matted	Floor Tile	Stop At First Positive
3106-49	Room 2, Farside, Floor, 1' x 1', Brown Matted	Floor Tile	Positive
3106-50	Room 2, Farside, Floor, Under 1' x 1' Brown Matted Floor Tile, on Slab	Mastic	Stop At

Please contact Rudy Lipinski (rlipinski@qualityenv.com) if samples test positive for vermiculite

CHAIN OF CUSTODY (SEE LAST PAGE)

SUBMITTED BY: [Signature] DATE: 1/10/2020
 RECEIVED BY: [Signature] DATE: 1/11/20

QUALITY ENVIRONMENTAL SOLUTIONS & TECHNOLOGIES, INC.

BULK SAMPLE FORM

CLIENT: PVE, LLC
 ADDRESS: 48 Springside Ave
Poughkeepsie, NY 12603
 CONTACT: Conor Tarbell
 PROJECT ID: 164 Garden St, Poughkeepsie, NY 12601
Pre-Demo ASB Survey
 PROJECT #: Q20-3106

SAMPLED BY: J. Klemm, J. Mages, S. Talsma
T. Ranadive
 DATE SAMPLED: 9-Jan-20
 ANALYSIS METHOD: PLM/NOB/QTEM as Required
 TURN-AROUND TIME: _____ HOURS
5 DAYS
 OTHER

EMSL MANHATTAN LAB
 RECEIVED
 20 JAN 11 AM 10:46

Please contact Laurence Goldstein (lgoldstein@qualityenv.com) if samples test positive for vermiculite

SAMPLE # LAB#	LOCATION	SAMPLE DESCRIPTION	COMMENTS
3106-51	Room 2, Farside, Floor, Under 1' x 1' Brown Matted Floor Tile, on Slab	Mastic	First Positive
3106-52	Room 2, Nearside, Floor, 1' x 1', on Slab	Peel 'N' Stick Floor Tile	Stop At First Positive
3106-53	Room 2, Nearside, Floor, 1' x 1', on Slab	Peel 'N' Stick Floor Tile	Positive
3106-54	Room 2, Nearside, Floor, Under 1' x 1' Peel 'N' Stick Floor Tile, on Slab	Adhesive	Stop At First Positive
3106-55	Room 2, Nearside, Floor, Under 1' x 1' Peel 'N' Stick Floor Tile, on Slab	Adhesive	Positive
3106-56	Room 9, Floor, Under 1' x 1' Floor Tile, on Slab	Mastic	Stop At First Positive
3106-57	Room 9, Floor, Under 1' x 1' Floor Tile, on Slab	Mastic	Positive
3106-58	Room 7, Floor, on Slab	Modified Flooring	Stop At First Positive
3106-59	Room 7, Floor, on Slab	Modified Flooring	Positive
3106-60	Room 7, Floor, Under Modified Flooring, on Slab	Mastic	Stop At

Please contact Rudy Lipinski (rlipinski@qualityenv.com) if samples test positive for vermiculite

CHAIN OF CUSTODY (SEE LAST PAGE)

SUBMITTED BY: [Signature] DATE: 1/10/2020

RECEIVED BY: [Signature] DATE: 1/11/20

QUALITY ENVIRONMENTAL SOLUTIONS & TECHNOLOGIES, INC.

BULK SAMPLE FORM

CLIENT: PVE, LLC
 ADDRESS: 48 Springside Ave
Poughkeepsie, NY 12603
 CONTACT: Conor Tarbell
 PROJECT ID: 164 Garden St, Poughkeepsie, NY 12601
Pre-Demo ASB Survey
 PROJECT #: Q20-3106

SAMPLED BY: J. Klemm, J. Mages, S. Talsma
T. Ranadive
 DATE SAMPLED: 9-Jan-20
 ANALYSIS METHOD: PLM/NOB/QTEM as Required
 TURN-AROUND TIME: _____ HOURS
5 DAYS
 OTHER

20 JAN 11 AM 10:50
 EMSL MANHATTAN LAB RECEIVED

Please contact Laurence Goldstein (lgoldstein@qualityenv.com) if samples test positive for vermiculite

SAMPLE # LAB#	LOCATION	SAMPLE DESCRIPTION	COMMENTS
3106-61	Room 7, Floor, Under Modified Flooring, on Slab	Mastic	First Positive
3106-62	Room 8, Floor, Under Carpet, on Slab	Carpet Mastic	Stop At First Positive
3106-63	Room 8, Floor, Under Carpet, on Slab	Carpet Mastic	
3106-64	Room 9, Floor, Bottom Layer, 1' x 1' White	Floor Tile	Stop At First Positive
3106-65	Room 9, Floor, Bottom Layer, 1' x 1' White, on Slab	Floor Tile	
3106-66	Room 9, Floor, Top Layer, on 1' x 1' Floor Tile	Peel 'N' Stick Floor Tile	Stop At First Positive
3106-67	Room 9, Floor, Top Layer, on 1' x 1' Floor Tile	Peel 'N' Stick Floor Tile	
3106-68	Garage 2, Wall	Cementitious Block & Mortar (Separate Layers)	
3106-69	Garage 1, Wall	Cementitious Block & Mortar (Separate Layers)	
3106-70	Garage 2, Floor	Cementitious Slab	

Please contact Rudy Lipinski (rlipinski@qualityenv.com) if samples test positive for vermiculite

CHAIN OF CUSTODY (SEE LAST PAGE)

SUBMITTED BY: [Signature] DATE: 1/10/2020
 RECEIVED BY: Leah Ramon DATE: 1/11/20 1050am

QUALITY ENVIRONMENTAL SOLUTIONS & TECHNOLOGIES, INC.

BULK SAMPLE FORM

EMSSL MARSHATTAN LAB
 RECEIVED
 20 JAN 11 AM 10:50

CLIENT: PVE, LLC
 ADDRESS: 48 Springside Ave
Poughkeepsie, NY 12603
 CONTACT: Conor Tarbell
 PROJECT ID: 164 Garden St, Poughkeepsie, NY 12601
Pre-Demo ASB Survey
 PROJECT #: Q20-3106

SAMPLED BY: J. Klemm, J. Mages, S. Talsma
T. Ranadive
 DATE SAMPLED: 9-Jan-20
 ANALYSIS METHOD: PLM/NOB/QTEM as Required
 TURN-AROUND TIME: _____ HOURS
5 DAYS
 OTHER

Please contact Laurence Goldstein (lgoldstein@qualityenv.com) if samples test positive for vermiculite

SAMPLE # LAB#	LOCATION	SAMPLE DESCRIPTION	COMMENTS
3106-71	Garage 1, Floor	Cementitious Slab	
3106-72	Room 1, Wall	Cement Panels	Stop At First
3106-73	Room 1, Ceiling	Cement Panels	Positive
3106-74	Room 2, Wall, Around Metal Exhaust Pipe, on Sheetrock	Flue Packing	Stop At First
3106-75	Room 2, Wall, Around Metal Exhaust Pipe, on Sheetrock	Flue Packing	Positive
3106-76	Garage 2, Air Handler #2	Vibration Dampener	Stop At First
3106-77	Garage 2, Air Handler #2	Vibration Dampener	Positive
3106-78	Garage 1, Air Handler	Vibration Dampener	Stop At First
3106-79	Garage 1, Air Handler	Vibration Dampener	Positive
3106-80	Garage 1, Window, Wood to Glass	Glazing	Stop At

Please contact Rudy Lipinski (rlipinski@qualityenv.com) if samples test positive for vermiculite

CHAIN OF CUSTODY (SEE LAST PAGE)

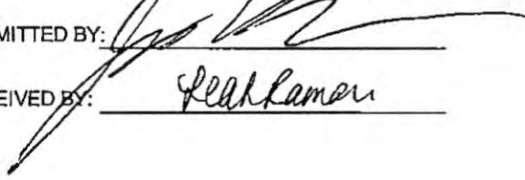
SUBMITTED BY: 
 RECEIVED BY: Rud Lipinski

DATE: 1/10/2020
 DATE: 1/11/20 1050am

QUALITY ENVIRONMENTAL SOLUTIONS & TECHNOLOGIES, INC.

BULK SAMPLE FORM

EMSL MANHATTAN LAB
 RECEIVED
 20 JAN 11 AM 10:50

CLIENT: PVE, LLC
 ADDRESS: 48 Springside Ave
Poughkeepsie, NY 12603
 CONTACT: Conor Tarbell
 PROJECT ID: 164 Garden St, Poughkeepsie, NY 12601
Pre-Demo ASB Survey
 PROJECT #: Q20-3106

SAMPLED BY: J. Klemm, J. Mages, S. Talsma
T. Ranadive
 DATE SAMPLED: 9-Jan-20
 ANALYSIS METHOD: PLM/NOB/QTEM as Required
 TURN-AROUND TIME: _____ HOURS
5 DAYS
 OTHER

Please contact Laurence Goldstein (lgoldstein@qualityenv.com) if samples test positive for vermiculite

SAMPLE # LAB#	LOCATION	SAMPLE DESCRIPTION	COMMENTS
3106-81	Bathroom 1, Window, Wood to Glass	Glazing	First Positive
3106-82	Exterior, Corner Façade	Stucco	
3106-83	Exterior, Corner Façade	Stucco	
3106-84	Exterior, Corner Façade	Stucco	
3106-85	Exterior, Corner Façade	Stucco	
3106-86	Exterior, Corner Façade	Stucco	
3106-87	Exterior, Window, Glass to Metal	Caulk	
3106-88	Exterior, Window, Glass to Metal	Caulk	Positive
3106-89	Exterior, Door, Metal Case to CMU	Caulk	Stop At First
3106-90	Exterior, Door, Metal Case to CMU	Caulk	Positive

Please contact Rudy Lipinski (rlipinski@qualityenv.com) if samples test positive for vermiculite

CHAIN OF CUSTODY (SEE LAST PAGE)

SUBMITTED BY: [Signature]
 RECEIVED BY: Rash Raman

DATE: 1/10/2020
 DATE: 1/11/20 1050am

QUALITY ENVIRONMENTAL SOLUTIONS & TECHNOLOGIES, INC.

BULK SAMPLE FORM

EMSSL MANHATTAN LAB
 RECEIVED
 20 JAN 11 AM 10:50

CLIENT: PVE, LLC
 ADDRESS: 48 Springside Ave
Poughkeepsie, NY 12603
 CONTACT: Conor Tarbell
 PROJECT ID: 164 Garden St, Poughkeepsie, NY 12601
Pre-Demo ASB Survey
 PROJECT #: Q20-3106

SAMPLED BY: J. Klemm, J. Mages, S. Talsma
T. Ranadive
 DATE SAMPLED: 9-Jan-20
 ANALYSIS METHOD: PLM/NOB/QTEM as Required
 TURN-AROUND TIME: _____ HOURS
5 DAYS
 OTHER

Please contact Laurence Goldstein (lgoldstein@qualityenv.com) if samples test positive for vermiculite

SAMPLE # LAB#	LOCATION	SAMPLE DESCRIPTION	COMMENTS
3106-91	Roof, Field, Top Layer	Rolled Roofing	Stop At First
3106-92	Roof, Field, Top Layer	Rolled Roofing	Positive
3106-93	Roof, Field, Second Layer	Built-up Roofing	Stop At First
3106-94	Roof, Field, Second Layer	Built-up Roofing	Positive
3106-95	Roof, Field, Bottom Layer, on Metal	Fiberboard	
3106-96	Roof, Field, Bottom Layer, on Metal	Fiberboard	
3106-97	Roof, Perimeter Flashing, Top Layer	Rolled Roofing	Stop At First
3106-98	Roof, Perimeter Flashing, Top Layer	Rolled Roofing	Positive
3106-99	Roof, Perimeter Flashing, Second Layer	Tar	Stop At First
3106-100	Roof, Perimeter Flashing, Second Layer	Tar	Positive

Please contact Rudy Lipinski (rlipinski@qualityenv.com) if samples test positive for vermiculite

CHAIN OF CUSTODY (SEE LAST PAGE)

SUBMITTED BY: [Signature]
 RECEIVED BY: [Signature]

DATE: 1/10/2020
 DATE: 1/11/20 1050am

QUALITY ENVIRONMENTAL SOLUTIONS & TECHNOLOGIES, INC.

BULK SAMPLE FORM

CLIENT: PVE, LLC
 ADDRESS: 48 Springside Ave
Poughkeepsie, NY 12603
 CONTACT: Conor Tarbell
 PROJECT ID: 164 Garden St, Poughkeepsie, NY 12601
Pre-Demo ASB Survey
 PROJECT #: Q20-3106

SAMPLED BY: J. Klemm, J. Mages, S. Talsma
T. Ranadive
 DATE SAMPLED: 9-Jan-20
 ANALYSIS METHOD: PLM/NOB/QTEM as Required
 TURN-AROUND TIME: _____ HOURS
5 DAYS
 OTHER

20 JAN 11 AM 10:50
 EMSL MANHATTAN LAB
 RECEIVED

Please contact Laurence Goldstein (lgoldstein@qualityenv.com) if samples test positive for vermiculite

SAMPLE # LAB#	LOCATION	SAMPLE DESCRIPTION	COMMENTS
3106-101	Roof, Perimeter Flashing, Bottom Layer, on Metal	Fiberboard	
3106-102	Roof, Perimeter Flashing, Bottom Layer, on Metal	Fiberboard	
3106-103	Roof, A/C Unit 1, Pitch Pocket	Tar	
3106-104	Roof, A/C Unit 2, Pitch Pocket	Tar	
3106-105	Roof, on Metal Vent Pipe	Flashing Tar	
3106-106	Roof, A/C Unit 1, on Metal Dunnage	Flashing Tar	
3106-107	Roof, Field, on EPDM	White Coating	
3106-108	Roof, Field, on EPDM	White Coating	
3106-109	Roof, Field, Top Layer	EPDM	
3106-110	Roof, Field, Top Layer	EPDM	

Please contact Rudy Lipinski (rlipinski@qualityenv.com) if samples test positive for vermiculite

CHAIN OF CUSTODY (SEE LAST PAGE)

SUBMITTED BY: [Signature]
 RECEIVED BY: [Signature]

DATE: 1/10/2020
 DATE: 1/11/20 1050am

QUALITY ENVIRONMENTAL SOLUTIONS & TECHNOLOGIES, INC.

BULK SAMPLE FORM

CLIENT: PVE, LLC
 ADDRESS: 48 Springside Ave
Poughkeepsie, NY 12603
 CONTACT: Conor Tarbell
 PROJECT ID: 164 Garden St, Poughkeepsie, NY 12601
Pre-Demo ASB Survey

SAMPLED BY: J. Klemm, J. Mages, S. Talsma
T. Ranadive
 DATE SAMPLED: 9-Jan-20
 ANALYSIS METHOD: PLM/NOB/QTEM as Required
 TURN-AROUND TIME: _____ HOURS
5 DAYS
 OTHER

20 JAN 11 AM 10:50
 EMSL MANHATTAN LAB
 RECEIVED

PROJECT #: Q20-3106

Please contact Laurence Goldstein (lgoldstein@qualityenv.com) if samples test positive for vermiculite

SAMPLE # LAB#	LOCATION	SAMPLE DESCRIPTION	COMMENTS
3106-111	Roof, Field, Bottom Layer, on Metal	Isofoam	
3106-112	Roof, Field, Bottom Layer, on Metal	Isofoam	

Please contact Rudy Lipinski (rlipinski@qualityenv.com) if samples test positive for vermiculite

CHAIN OF CUSTODY (SEE LAST PAGE)

SUBMITTED BY: [Signature]
 RECEIVED BY: [Signature]

DATE: 1/10/2020
 DATE: 1/11/20 1050am

032000750

QUALITY ENVIRONMENTAL SOLUTIONS & TECHNOLOGIES, INC.

BULK SAMPLE FORM

CLIENT: PVE, LLC

SAMPLED BY: J. Klemm, J. Mages, S. Talsma
T. Ranadive

ADDRESS: 48 Springside Ave

DATE SAMPLED: 9-Jan-20

Poughkeepsie, NY 12603

CONTACT: Conor Tarbell

ANALYSIS METHOD: PLM/NOB/QTEM as Required 140

PROJECT ID: 164 Garden St, Poughkeepsie, NY 12601

TURN-AROUND TIME: _____ HOURS

Pre-Demo ASB Survey

5 DAYS

PROJECT #: Q20-3106

OTHER

Please contact Laurence Goldstein (lgoldstein@qualityenv.com) if samples test positive for vermiculite			
SAMPLE # LAB#	LOCATION	SAMPLE DESCRIPTION	COMMENTS
3106-01	Room 2, Wall, on Sheetrock	Joint Compound	ENST LABORATORY LAB RECEIVED 20 JAN 11 AM 10:49 AT 01/14/2020
3106-02	Room 2, Wall, on Sheetrock	Joint Compound	
3106-03	Room 4, Wall, on Sheetrock	Joint Compound	
3106-04	Bathroom 4, Ceiling, on Sheetrock	Joint Compound	
3106-05	Room 10, Ceiling, on Sheetrock	Joint Compound	
3106-06	Room 10, Ceiling, on Sheetrock	Tape	
3106-07	Room 2, Wall, on Sheetrock	Tape	
3106-08	Bathroom 1, Wall	Sheetrock	
3106-09	Hallway, Wall	Sheetrock	
3106-10	Room 9, Suspended Ceiling, 2' x 4', Smooth	Ceiling Tile	

Please contact Rudy Lipinski (rlipinski@qualityenv.com) if samples test positive for vermiculite

CHAIN OF CUSTODY (SEE LAST PAGE)

SUBMITTED BY: [Signature]

DATE: 1/10/2020

[Signature]
1-16-20

RECEIVED BY: [Signature]

DATE: 1/11/20

KV 15 Jan 2020

QUALITY ENVIRONMENTAL SOLUTIONS & TECHNOLOGIES, INC.

BULK SAMPLE FORM

EMSL MANHATTAN LAB
 RECEIVED
 20 JAN 11 AM 10:49

CLIENT: PVE, LLC
 ADDRESS: 48 Springside Ave
Poughkeepsie, NY 12603
 CONTACT: Conor Tarbell
 PROJECT ID: 164 Garden St, Poughkeepsie, NY 12601
Pre-Demo ASB Survey
 PROJECT #: Q20-3106

SAMPLED BY: J. Klemm, J. Mages, S. Talsma
T. Ranadive
 DATE SAMPLED: 9-Jan-20
 ANALYSIS METHOD: PLM/NOB/QTEM as Required
 TURN-AROUND TIME: _____ HOURS
5 DAYS
 OTHER

Please contact Laurence Goldstein (lgoldstein@qualityenv.com) if samples test positive for vermiculite			
SAMPLE # LAB#	LOCATION	SAMPLE DESCRIPTION	COMMENTS
3106-11	Room 9, Suspended Ceiling, 2' x 4', Smooth	Ceiling Tile	First Positive
3106-12	Room 8, Suspended Ceiling, 2' x 4', Dot Canyon	Ceiling Tile	Stop At First Positive
3106-13	Room 2, Suspended Ceiling, 2' x 4', Dot Canyon	Ceiling Tile	Positive
3106-14	Room 2, Wall, on Wood Panels, Tan	Cove Base Molding & Adhesive (Separate Layers)	Stop At First Positive
3106-15	Room 2, Wall, on Wood Panels, Tan	Cove Base Molding & Adhesive (Separate Layers)	Positive
3106-16	Room 9, Wall, on Black Cove Base Molding, Yellow	Cove Base Molding & Adhesive (Separate Layers)	Stop At First Positive
3106-17	Room 9, Wall, on Black Cove Base Molding, Yellow	Cove Base Molding & Adhesive (Separate Layers)	Positive
3106-18	Room 8, Wall, on Wood Panels, Brown	Cove Base Molding & Adhesive (Separate Layers)	Stop At First Positive
3106-19	Room 8, Wall, on Wood Panels, Brown	Cove Base Molding & Adhesive (Separate Layers)	Positive
3106-20	Room 9, Wall, on Wood Panels, Gray	Cove Base Molding & Adhesive (Separate Layers)	Stop At
Please contact Rudy Lipinski (rlipinski@qualityenv.com) if samples test positive for vermiculite			

CHAIN OF CUSTODY (SEE LAST PAGE)

SUBMITTED BY: [Signature]
 RECEIVED BY: [Signature]

DATE: 1/10/2020
 DATE: 1/11/20

QUALITY ENVIRONMENTAL SOLUTIONS & TECHNOLOGIES, INC.

BULK SAMPLE FORM

CLIENT: PVE, LLC
 ADDRESS: 48 Springside Ave
Poughkeepsie, NY 12603
 CONTACT: Conor Tarbell
 PROJECT ID: 164 Garden St, Poughkeepsie, NY 12601
Pre-Demo ASB Survey
 PROJECT #: Q20-3106

SAMPLED BY: J. Klemm, J. Mages, S. Talsma
T. Ranadive
 DATE SAMPLED: 9-Jan-20
 ANALYSIS METHOD: PLM/NOB/QTEM as Required
 TURN-AROUND TIME: _____ HOURS
5 DAYS
 OTHER

20 JAN 11 AM 10:45
 EMSL MANHATTAN LAB RECEIVED

Please contact Laurence Goldstein (lgoldstein@qualityenv.com) if samples test positive for vermiculite			
SAMPLE # LAB#	LOCATION	SAMPLE DESCRIPTION	COMMENTS
3106-21	Room 9, Wall, on Wood Panels, Gray	Cove Base Molding & Adhesive (Separate Layers)	First Positive
3106-22	Bathroom 1, Wall Panel on Sheetrock	Fiberboard & Adhesive (Separate Layers)	Stop At First Positive
3106-23	Bathroom 2, Wall Panel on Sheetrock	Fiberboard & Adhesive (Separate Layers)	Positive
3106-24	Room 9, Wall, Behind Wood Panels, on Sheetrock	Adhesive	Stop At First Positive
3106-25	Room 8, Wall, Behind Wood Panels, on Sheetrock	Adhesive	Positive
3106-26	Room 9, Wall, Behind Wood Panels, on Sheetrock	Adhesive	Stop At First Positive
3106-27	Room 9, Wall, Behind Wood Panels, on Sheetrock	Adhesive	Positive
3106-28	Room 9, Wall, on Fiberboard	Corkboard	
3106-29	Room 9, Wall, on Fiberboard	Corkboard	
3106-30	Room 9, Wall, Behind Corkboard, on Fiberboard	Adhesive	Stop At

Please contact Rudy Lipinski (rlipinski@qualityenv.com) if samples test positive for vermiculite

CHAIN OF CUSTODY (SEE LAST PAGE)

SUBMITTED BY: [Signature] DATE: 1/10/2020
 RECEIVED BY: Leah Ranadive DATE: 1/11/20

QUALITY ENVIRONMENTAL SOLUTIONS & TECHNOLOGIES, INC.

BULK SAMPLE FORM

CLIENT: PVE, LLC
 ADDRESS: 48 Springside Ave
Poughkeepsie, NY 12603
 CONTACT: Conor Tarbell
 PROJECT ID: 164 Garden St, Poughkeepsie, NY 12601
Pre-Demo ASB Survey
 PROJECT #: Q20-3106

SAMPLED BY: J. Klemm, J. Mages, S. Talsma
T. Ranadive
 DATE SAMPLED: 9-Jan-20
 ANALYSIS METHOD: PLM/NOB/QTEM as Required
 TURN-AROUND TIME: _____ HOURS
5 DAYS
 OTHER

20 JAN 11 AM 10:49
 EMSL MANHATTAN LAB RECEIVED

1/11/20

Please contact Laurence Goldstein (lgoldstein@qualityenv.com) if samples test positive for vermiculite			
SAMPLE # LAB#	LOCATION	SAMPLE DESCRIPTION	COMMENTS
3106-31	Room 9, Wall, Behind Corkboard, on Fiberboard	Adhesive	First Positive
3106-32	Room 9, Wall, Behind Corkboard	Fiberboard	
3106-33	Room 9, Wall, Behind Corkboard	Fiberboard	
3106-34	Room 6, Behind Panels, on Sheetrock	Adhesive	Stop At First Positive
3106-35	Room 6, Behind Panels, on Sheetrock	Adhesive	
3106-36	Bathroom 3, Wall	Ceramic Tile & Grout (Separate Layers)	Stop At First Positive
3106-37	Bathroom 4, Wall	Ceramic Tile & Grout (Separate Layers)	
3106-38	Bathroom 3, Wall, Behind Ceramic Tile, on CMU	Adhesive	Stop At First Positive
3106-39	Bathroom 4, Wall, Behind Ceramic Tile, on CMU	Adhesive	
3106-40	Bathroom 4, Floor	Ceramic Tile & Grout (Separate Layers)	Stop At

Please contact Rudy Lipinski (rlipinski@qualityenv.com) if samples test positive for vermiculite

CHAIN OF CUSTODY (SEE LAST PAGE)

SUBMITTED BY: [Signature]
 RECEIVED BY: Seah Romani

DATE: 1/10/2020
 DATE: 1/11/20
1-16-20

QUALITY ENVIRONMENTAL SOLUTIONS & TECHNOLOGIES, INC.

BULK SAMPLE FORM

CLIENT: PVE, LLC
 ADDRESS: 48 Springside Ave
Poughkeepsie, NY 12603
 CONTACT: Conor Tarbell
 PROJECT ID: 164 Garden St, Poughkeepsie, NY 12601
Pre-Demo ASB Survey
 PROJECT #: Q20-3106

SAMPLED BY: J. Klemm, J. Mages, S. Talsma
T. Ranadive
 DATE SAMPLED: 9-Jan-20
 ANALYSIS METHOD: PLM/NOB/QTEM as Required
 TURN-AROUND TIME: _____ HOURS
5 DAYS
 OTHER

20 JAN 11 AM 10:44
 ENSL MANHATTAN LAB
 RECEIVED

Please contact Laurence Goldstein (lgoldstein@qualityenv.com) if samples test positive for vermiculite

SAMPLE # LAB#	LOCATION	SAMPLE DESCRIPTION	COMMENTS
3106-41	Bathroom 3, Floor	Ceramic Tile & Grout (Separate Layers)	First Positive
3106-42	Bathroom 4, Floor, Under Ceramic Tile, on Slab	Mudset	Stop At First
3106-43	Bathroom 3, Floor, Under Ceramic Tile, on Slab	Mudset	Positive
3106-44	Garage 1, Under Air Handler Unit	Fiber Panel	Stop At First
3106-45	Garage 1, Under Air Handler Unit	Fiber Panel	Positive
3106-46	Bathroom 1, Floor, 1' x 1', on Slab	Floor Tile & Mastic (Separate Layer)	Stop At First
3106-47	Bathroom 2, Floor, 1' x 1', on Slab	Floor Tile & Mastic (Separate Layer)	Positive
3106-48	Room 2, Farside, Floor, 1' x 1', Brown Matted	Floor Tile	Stop At First
3106-49	Room 2, Farside, Floor, 1' x 1', Brown Matted	Floor Tile	Positive
3106-50	Room 2, Farside, Floor, Under 1' x 1' Brown Matted Floor Tile, on Slab	Mastic	Stop At

Please contact Rudy Lipinski (rlipinski@qualityenv.com) if samples test positive for vermiculite

CHAIN OF CUSTODY (SEE LAST PAGE)

SUBMITTED BY: [Signature]
 RECEIVED BY: [Signature]

DATE: 1/10/2020
 DATE: [Signature] 1/11/20

[Signature] 1.16.20

QUALITY ENVIRONMENTAL SOLUTIONS & TECHNOLOGIES, INC.

BULK SAMPLE FORM

CLIENT: PVE, LLC
 ADDRESS: 48 Springside Ave
Poughkeepsie, NY 12603
 CONTACT: Conor Tarbell
 PROJECT ID: 164 Garden St, Poughkeepsie, NY 12601
Pre-Demo ASB Survey
 PROJECT #: Q20-3106

SAMPLED BY: J. Klemm, J. Mages, S. Talsma
T. Ranadive
 DATE SAMPLED: 9-Jan-20
 ANALYSIS METHOD: PLM/NOB/QTEM as Required
 TURN-AROUND TIME: _____ HOURS
5 DAYS
 OTHER

EMSL MANHATTAN LAB
 RECEIVED
 20 JAN 11 AM 10:4

Please contact Laurence Goldstein (lgoldstein@qualityenv.com) if samples test positive for vermiculite			
SAMPLE # LAB#	LOCATION	SAMPLE DESCRIPTION	COMMENTS
3106-51	Room 2, Farside, Floor, Under 1' x 1' Brown Matted Floor Tile, on Slab	Mastic	First Positive
3106-52	Room 2, Nearside, Floor, 1' x 1', on Slab	Peel 'N' Stick Floor Tile	Stop At First Positive
3106-53	Room 2, Nearside, Floor, 1' x 1', on Slab	Peel 'N' Stick Floor Tile	
3106-54	Room 2, Nearside, Floor, Under 1' x 1' Peel 'N' Stick Floor Tile, on Slab	Adhesive	Stop At First Positive
3106-55	Room 2, Nearside, Floor, Under 1' x 1' Peel 'N' Stick Floor Tile, on Slab	Adhesive	
3106-56	Room 9, Floor, Under 1' x 1' Floor Tile, on Slab	Mastic	Stop At First Positive
3106-57	Room 9, Floor, Under 1' x 1' Floor Tile, on Slab	Mastic	
3106-58	Room 7, Floor, on Slab	Modified Flooring	Stop At First Positive
3106-59	Room 7, Floor, on Slab	Modified Flooring	
3106-60	Room 7, Floor, Under Modified Flooring, on Slab	Mastic	Stop At

Please contact Rudy Lipinski (rlipinski@qualityenv.com) if samples test positive for vermiculite

CHAIN OF CUSTODY (SEE LAST PAGE)
 SUBMITTED BY: [Signature] DATE: 1/10/2020
 RECEIVED BY: [Signature] DATE: 1/11/20

[Signature] 1.16.20

QUALITY ENVIRONMENTAL SOLUTIONS & TECHNOLOGIES, INC.

BULK SAMPLE FORM

CLIENT: PVE, LLC
 ADDRESS: 48 Springside Ave
Poughkeepsie, NY 12603
 CONTACT: Conor Tarbell
 PROJECT ID: 164 Garden St, Poughkeepsie, NY 12601
Pre-Demo ASB Survey
 PROJECT #: Q20-3106

SAMPLED BY: J. Klemm, J. Mages, S. Talsma
T. Ranadive
 DATE SAMPLED: 9-Jan-20
 ANALYSIS METHOD: PLM/NOB/QTEM as Required
 TURN-AROUND TIME: _____ HOURS
5 DAYS
 OTHER

20 JAN 11 AM 10:50
 EMSL MANHATTAN LAB
 RECEIVED

Please contact Laurence Goldstein (lgoldstein@qualityenv.com) if samples test positive for vermiculite			
SAMPLE # LAB#	LOCATION	SAMPLE DESCRIPTION	COMMENTS
3106-61	Room 7, Floor, Under Modified Flooring, on Slab	Mastic	First Positive
3106-62	Room 8, Floor, Under Carpet, on Slab	Carpet Mastic	Stop At First Positive
3106-63	Room 8, Floor, Under Carpet, on Slab	Carpet Mastic	
3106-64	Room 9, Floor, Bottom Layer, 1' x 1' White	Floor Tile	Stop At First Positive
3106-65	Room 9, Floor, Bottom Layer, 1' x 1' White, on Slab	Floor Tile	
3106-66	Room 9, Floor, Top Layer, on 1' x 1' Floor Tile	Peel 'N' Stick Floor Tile	Stop At First Positive
3106-67	Room 9, Floor, Top Layer, on 1' x 1' Floor Tile	Peel 'N' Stick Floor Tile	
3106-68	Garage 2, Wall	Cementitious Block & Mortar (Separate Layers)	
3106-69	Garage 1, Wall	Cementitious Block & Mortar (Separate Layers)	
3106-70	Garage 2, Floor	Cementitious Slab	

Please contact Rudy Lipinski (rlipinski@qualityenv.com) if samples test positive for vermiculite

CHAIN OF CUSTODY (SEE LAST PAGE)

SUBMITTED BY: [Signature] DATE: 1/10/2020
 RECEIVED BY: Leah Ramon DATE: 1/11/20 1050am 1.16.20

QUALITY ENVIRONMENTAL SOLUTIONS & TECHNOLOGIES, INC.

BULK SAMPLE FORM

EMSL MANHATTAN LAB
 RECEIVED
 20 JAN 11 AM 10:50

CLIENT: PVE, LLC
 ADDRESS: 48 Springside Ave
Poughkeepsie, NY 12603
 CONTACT: Conor Tarbell
 PROJECT ID: 164 Garden St, Poughkeepsie, NY 12601
Pre-Demo ASB Survey
 PROJECT #: Q20-3106

SAMPLED BY: J. Klemm, J. Mages, S. Talsma
T. Ranadive
 DATE SAMPLED: 9-Jan-20
 ANALYSIS METHOD: PLM/NOB/QTEM as Required
 TURN-AROUND TIME: _____ HOURS
5 DAYS
 OTHER

Please contact Laurence Goldstein (lgoldstein@qualityenv.com) if samples test positive for vermiculite			
SAMPLE # LAB#	LOCATION	SAMPLE DESCRIPTION	COMMENTS
3106-71	Garage 1, Floor	Cementitious Slab	
3106-72	Room 1, Wall	Cement Panels	Stop At First Positive
3106-73	Room 1, Ceiling	Cement Panels	
3106-74	Room 2, Wall, Around Metal Exhaust Pipe, on Sheetrock	Flue Packing	Stop At First Positive
3106-75	Room 2, Wall, Around Metal Exhaust Pipe, on Sheetrock	Flue Packing	
3106-76	Garage 2, Air Handler #2	Vibration Dampener	Stop At First Positive
3106-77	Garage 2, Air Handler #2	Vibration Dampener	
3106-78	Garage 1, Air Handler	Vibration Dampener	Stop At First Positive
3106-79	Garage 1, Air Handler	Vibration Dampener	
3106-80	Garage 1, Window, Wood to Glass	Glazing	Stop At
Please contact Rudy Lipinski (rlipinski@qualityenv.com) if samples test positive for vermiculite			

CHAIN OF CUSTODY (SEE LAST PAGE)

SUBMITTED BY: [Signature]
 RECEIVED BY: Reah Kamen

DATE: 1/10/2020
 DATE: 1/11/20 1050am

PAGE 8 OF 12 [Signature]
1-16-20

[Signature]
1/16/20

QUALITY ENVIRONMENTAL SOLUTIONS & TECHNOLOGIES, INC.

BULK SAMPLE FORM

CLIENT: PVE, LLC
 ADDRESS: 48 Springside Ave
Poughkeepsie, NY 12603
 CONTACT: Conor Tarbell
 PROJECT ID: 164 Garden St, Poughkeepsie, NY 12601
Pre-Demo ASB Survey
 PROJECT #: Q20-3106

SAMPLED BY: J. Klemm, J. Mages, S. Talsma
T. Ranadive
 DATE SAMPLED: 9-Jan-20
 ANALYSIS METHOD: PLM/NOB/QTEM as Required
 TURN-AROUND TIME: _____ HOURS
5 DAYS
 OTHER

20 JAN 11 AM 10:50

EMSL MANHATTAN LAB
 RECEIVED

Please contact Laurence Goldstein (lgoldstein@qualityenv.com) if samples test positive for vermiculite			
SAMPLE # LAB#	LOCATION	SAMPLE DESCRIPTION	COMMENTS
3106-81	Bathroom 1, Window, Wood to Glass	Glazing	First Positive
3106-82	Exterior, Corner Façade	Stucco	
3106-83	Exterior, Corner Façade	Stucco	
3106-84	Exterior, Corner Façade	Stucco	
3106-85	Exterior, Corner Façade	Stucco	
3106-86	Exterior, Corner Façade	Stucco	
3106-87	Exterior, Window, Glass to Metal	Caulk	
3106-88	Exterior, Window, Glass to Metal	Caulk	Stop At First Positive
3106-89	Exterior, Door, Metal Case to CMU	Caulk	
3106-90	Exterior, Door, Metal Case to CMU	Caulk	Stop At First Positive
Please contact Rudy Lipinski (rlipinski@qualityenv.com) if samples test positive for vermiculite			

CHAIN OF CUSTODY (SEE LAST PAGE)

SUBMITTED BY: [Signature]
 RECEIVED BY: Leah Ramar

DATE: 1/10/2020
 DATE: 1/11/20 1050am

[Signature]
 1-16-20

[Signature]
 1-11-20

QUALITY ENVIRONMENTAL SOLUTIONS & TECHNOLOGIES, INC.

BULK SAMPLE FORM

EMSL MANHATTAN LAB
 RECEIVED
 20 JAN 11 AM 10:50

CLIENT: PVE, LLC
 ADDRESS: 48 Springside Ave
Poughkeepsie, NY 12603
 CONTACT: Conor Tarbell
 PROJECT ID: 164 Garden St, Poughkeepsie, NY 12601
Pre-Demo ASB Survey
 PROJECT #: Q20-3106

SAMPLED BY: J. Klemm, J. Mages, S. Talsma
T. Ranadive
 DATE SAMPLED: 9-Jan-20
 ANALYSIS METHOD: PLM/NOB/QTEM as Required
 TURN-AROUND TIME: _____ HOURS
5 DAYS
 OTHER

Please contact Laurence Goldstein (lgoldstein@qualityenv.com) if samples test positive for vermiculite			
SAMPLE # LAB#	LOCATION	SAMPLE DESCRIPTION	COMMENTS
3106-91	Roof, Field, Top Layer	Rolled Roofing	Stop At First Positive
3106-92	Roof, Field, Top Layer	Rolled Roofing	
3106-93	Roof, Field, Second Layer	Built-up Roofing	Stop At First Positive
3106-94	Roof, Field, Second Layer	Built-up Roofing	
3106-95	Roof, Field, Bottom Layer, on Metal	Fiberboard	
3106-96	Roof, Field, Bottom Layer, on Metal	Fiberboard	
3106-97	Roof, Perimeter Flashing, Top Layer	Rolled Roofing	Stop At First Positive
3106-98	Roof, Perimeter Flashing, Top Layer	Rolled Roofing	
3106-99	Roof, Perimeter Flashing, Second Layer	Tar	Stop At First Positive
3106-100	Roof, Perimeter Flashing, Second Layer	Tar	

Please contact Rudy Lipinski (rlipinski@qualityenv.com) if samples test positive for vermiculite

CHAIN OF CUSTODY (SEE LAST PAGE)

SUBMITTED BY: 

DATE: 1/10/2020 

RECEIVED BY: 

DATE: 1/11/20 1050am

 1/16/20

QUALITY ENVIRONMENTAL SOLUTIONS & TECHNOLOGIES, INC.

BULK SAMPLE FORM

CLIENT: PVE, LLC
 ADDRESS: 48 Springside Ave
Poughkeepsie, NY 12603
 CONTACT: Conor Tarbell
 PROJECT ID: 164 Garden St, Poughkeepsie, NY 12601
Pre-Demo ASB Survey
 PROJECT #: Q20-3106

SAMPLED BY: J. Klemm, J. Mages, S. Talsma
T. Ranadive
 DATE SAMPLED: 9-Jan-20
 ANALYSIS METHOD: PLM/NOB/QTEM as Required
 TURN-AROUND TIME: _____ HOURS
5 DAYS
 OTHER

EMSL MANHATTAN LAB
 RECEIVED
 20 JAN 11 AM 10:50

Please contact Laurence Goldstein (lgoldstein@qualityenv.com) if samples test positive for vermiculite			
SAMPLE # LAB#	LOCATION	SAMPLE DESCRIPTION	COMMENTS
3106-101	Roof, Perimeter Flashing, Bottom Layer, on Metal	Fiberboard	
3106-102	Roof, Perimeter Flashing, Bottom Layer, on Metal	Fiberboard	
3106-103	Roof, A/C Unit 1, Pitch Pocket	Tar	
3106-104	Roof, A/C Unit 2, Pitch Pocket	Tar	
3106-105	Roof, on Metal Vent Pipe	Flashing Tar	
3106-106	Roof, A/C Unit 1, on Metal Dunnage	Flashing Tar	
3106-107	Roof, Field, on EPDM	White Coating	
3106-108	Roof, Field, on EPDM	White Coating	
3106-109	Roof, Field, Top Layer	EPDM	
3106-110	Roof, Field, Top Layer	EPDM	

Please contact Rudy Lipinski (rlipinski@qualityenv.com) if samples test positive for vermiculite

CHAIN OF CUSTODY (SEE LAST PAGE)

SUBMITTED BY: [Signature] DATE: 1/10/2020
 RECEIVED BY: [Signature] DATE: 1/11/20 1050am

[Signature] 1.16.20

[Signature] 1/16/20

QUALITY ENVIRONMENTAL SOLUTIONS & TECHNOLOGIES, INC.

BULK SAMPLE FORM

CLIENT: PVE, LLC

SAMPLED BY: J. Klemm, J. Mages, S. Talsma
T. Ranadive

ADDRESS: 48 Springside Ave

DATE SAMPLED: 9-Jan-20

Poughkeepsie, NY 12603

CONTACT: Conor Tarbell

ANALYSIS METHOD: PLM/NOB/QTEM as Required

PROJECT ID: 164 Garden St, Poughkeepsie, NY 12601

TURN-AROUND TIME: _____ HOURS

Pre-Demo ASB Survey

5 DAYS

PROJECT #: Q20-3106

OTHER _____

EMSL MANHATTAN LAB
RECEIVED
20 JAN 11 AM 10:50

Please contact Laurence Goldstein (lgoldstein@qualityenv.com) if samples test positive for vermiculite

SAMPLE # LAB#	LOCATION	SAMPLE DESCRIPTION	COMMENTS
3106-111	Roof, Field, Bottom Layer, on Metal	Isofoam	
3106-112	Roof, Field, Bottom Layer, on Metal	Isofoam	

Please contact Rudy Lipinski (rlipinski@qualityenv.com) if samples test positive for vermiculite

CHAIN OF CUSTODY (SEE LAST PAGE)

SUBMITTED BY: [Signature]

DATE: 1/10/2020

RECEIVED BY: [Signature]

DATE: 1/11/20 1050am

[Signature] 1/11/20



Quality Environmental Solutions & Technologies, Inc.

Appendix C: PERSONNEL LICENSES & CERTIFICATIONS

1376 Route 9, Wappingers Falls, NY 12590 Phone (845) 298-6031 Fax (845) 298-6251

NYS MWBD MBE Cert # 49952-2006 NYSUCP DBE Certified NJUCP DBE Certified www.Qualityenv.com

New York State – Department of Labor

Division of Safety and Health
License and Certificate Unit
State Campus, Building 12
Albany, NY 12240

ASBESTOS HANDLING LICENSE

Quality Environmental Solutions & Technologies, Inc.

1376 Route 9

Wappinger Falls, NY 12590

FILE NUMBER: 99-0018

LICENSE NUMBER: 29085

LICENSE CLASS: RESTRICTED

DATE OF ISSUE: 01/17/2020

EXPIRATION DATE: 01/31/2021

Duly Authorized Representative – Lawrence J Holzapfel:

This license has been issued in accordance with applicable provisions of Article 30 of the Labor Law of New York State and of the New York State Codes, Rules and Regulations (12 NYCRR Part 56). It is subject to suspension or revocation for a (1) serious violation of state, federal or local laws with regard to the conduct of an asbestos project, or (2) demonstrated lack of responsibility in the conduct of any job involving asbestos or asbestos material.

This license is valid only for the contractor named above and this license or a photocopy must be prominently displayed at the asbestos project worksite. This license verifies that all persons employed by the licensee on an asbestos project in New York State have been issued an Asbestos Certificate, appropriate for the type of work they perform, by the New York State Department of Labor.



Eileen M. Franko, Director
For the Commissioner of Labor



NEW YORK STATE
MINORITY- AND WOMEN-OWNED BUSINESS
ENTERPRISE ("MWBE")
CERTIFICATION

Empire State Development's Division of Minority and Women's Business
Development grants a

Women Business Enterprise (WBE)

pursuant to New York State Executive Law, Article 15-A to:

Quality Environmental Solutions & Technologies Inc.

Certification Awarded on: March 28, 2019

Expiration Date: March 28, 2022

File ID#: WBE- 49952



Division of Minority
and Women's
Business Development

A Division of Empire State Development



Division of Minority
and Women's
Business Development

New York State Department of Economic Development
633 Third Avenue New York New York 10017 Tel 212 803 2414
Web Site: www.esd.ny.gov/MWBE/html

March 28, 2019

File ID: 49952

Quality Environmental Solutions & Technologies Inc. will be listed in New York State's Directory of Certified Businesses with the following list of codes for products and services:

NAICS 541620: ENVIRONMENTAL CONSULTING SERVICES

NIGP 91843: ENVIRONMENTAL CONSULTING

STATE OF NEW YORK - DEPARTMENT OF LABOR
ASBESTOS CERTIFICATE



JAMES D KLEMM
CLASS(EXPIRES)
C ATEC(06/20) D INSP(06/20)
H PM (06/20)

CERT# 13-11486
DMV# 949876493

MUST BE CARRIED ON ASBESTOS PROJECTS



01213 005007256 09

EYES BLU
HAIR BRO
HGT 5' 10"

IF FOUND RETURN TO:
NYS DOL - L&C UNIT
ROOM 161A BUILDING 12
STATE OFFICE CAMPUS
ALBANY NY 12240



12-004336042

This card acknowledges that the recipient has successfully completed a 10-hour Occupational Safety and Health Training Course in
Construction Safety and Health

JAMES KLEMM

David Veit

06/05/2013

Trainer name – print or type)

(Course end date)

OSHA recommends Outreach Training Courses as an orientation to occupational safety and health for workers. Participation is voluntary. Workers must receive additional training on specific hazards of their job. This course completion card does not expire.

Use or distribution of this card for fraudulent purposes, including false claims of having received training, may result in prosecution under 18 U.S.C. 1001. Potential penalties include substantial criminal fines, imprisonment up to five years, or both.

For OSHA Outreach Training Program go to "Training" at www.osha.gov

Rev. 9/2009

STATE OF NEW YORK - DEPARTMENT OF LABOR
ASBESTOS CERTIFICATE



TANAY RANADIVE
CLASS(EXPIRES)
C ATEC(06/20) D (NSP(06/20)
H PM (06/20)

CERT# 15-10696
DMV# 859664473

MUST BE CARRIED ON ASBESTOS PROJECTS



01213 005007143 06

EYES BRO
HAIR BLK
HGT 5' 10"

IF FOUND RETURN TO:
NYS DOL - L&C UNIT
ROOM 161A BUILDING 12
STATE OFFICE CAMPUS
ALBANY NY 12240



12-005398747

This card acknowledges that the recipient has successfully completed a
10-hour Occupational Safety and Health Training Course in
Construction Safety and Health

Tanay Ranadive

David Veit

06/05/2015

Trainer name – print or type

(Course and date)

OSHA recommends Outreach Training Courses as an orientation to occupational safety and health for workers. Participation is voluntary. Workers must receive additional training on specific hazards of their job. This course completion card does not expire.

Use or distribution of this card for fraudulent purposes, including false claims of having received training, may result in prosecution under 18 U.S.C. 1001. Potential penalties include substantial criminal fines, imprisonment up to five years, or both.

For OSHA Outreach Training Program go to "Training" at www.osha.gov

STATE OF NEW YORK - DEPARTMENT OF LABOR
ASBESTOS CERTIFICATE

N.Y.S.



JONATHAN R MAGES

CLASS(EXPIRES)

C ATEC(01/21) D INSP(01/21)

H PM (01/21)

CERT# 18-53364
DMV# 345648492

MUST BE CARRIED ON ASBESTOS PROJECTS



01213 005237340 42

EYES HAZ

HAIR BRO "

HGT 5' 10"

IF FOUND RETURN TO:

NYS DOL - L&C UNIT

ROOM 161A BUILDING 12

STATE OFFICE CAMPUS

ALBANY NY 12240



11-006052324

This card acknowledges that the recipient has successfully completed:

10-hour Construction Safety and Health

This card issued to:

Jonathan Mages

Paul Rodriguez

Trainer Name

6/6/2018

Date of Issue



800-449-6742
outreach.keeneosha.com

OSHA recommends Outreach Training Courses as an orientation to occupational safety and health for workers. Participation is voluntary. Workers must receive additional training on specific hazards of their job. This course completion card does not expire.

Use or distribution of this card for fraudulent purposes, including false claims of having received training, may result in prosecution under 18 U.S.C. 1001. Potential penalties include substantial criminal fines, imprisonment up to 5 years, or both.



To verify this training, scan the QR code with your mobile device.

Rev. 1/2016

STATE OF NEW YORK - DEPARTMENT OF LABOR
ASBESTOS CERTIFICATE



SHANNON D TALSMA
CLASS(EXPIRES)
C ATEC(10/20) D INSP(10/20)
H PM (10/20)

CERT# 16-07559
DMV# 963348232

MUST BE CARRIED ON ASBESTOS PROJECTS



01213 003129218 32

EYES GRN
HAIR BLN
HGT 6' 00"

IF FOUND RETURN TO:
NYS DOL - L&C UNIT
ROOM 161A BUILDING 12
STATE OFFICE CAMPUS
ALBANY NY 12240



12-006010504

This card acknowledges that the recipient has successfully completed:

10-hour Construction Safety and Health

This card issued to:

Shannon D. Talsma

David Veit

04/22/2016

Trainer Name

Date of Issue



732.235.9450
aotc.sph.rutgers.edu

OSHA recommends Outreach Training Courses as an orientation to occupational safety and health for workers. Participation is voluntary. Workers must receive additional training on specific hazards of their job. This course completion card does not expire.

Use or distribution of this card for fraudulent purposes, including false claims of having received training, may result in prosecution under 18 U.S.C. 1001. Potential penalties include substantial criminal fines, imprisonment up to 5 years, or both.



To verify this training, scan the QR code with your mobile device.

Rev. 1/2016