

DAILY STATUS REPORT

WEATHER	Snow		Rain		Overcast		Partly Cloudy		Bright Sun	X
TEMP.	< 32		32-50		50-70		70-85	X	> 85	

Prepared By:

JESSICA PROSCIA

NYSDEC BCP Project No.	C241199	NYCOER Project No.	17CVCP044Q	DATE:	10/12/2023
Project Name:	148-28 Hillside Avenue				

<u>Consultant:</u> Thomas Brown CA RICH Consultants	<u>Safety Officer:</u> Thomas Brown CA RICH Consultants
<u>General Contractor:</u> Oscar Velasquez, New York Fast General Contracting Corp.	<u>Site Manager/Supervisor:</u> Joseph Valente (3T Construction Inc.)
<u>Personnel Present and Affiliation:</u> -Thomas Brown (CA RICH) -Cesar (New York Fast General Contracting Corp.) -Roberto (New York Fast General Contracting Corp.) -Consallo (New York Fast General Contracting Corp.) - Joseph Valente (3T Construction Inc.) - Ying Yun (3T Construction Inc.) - Jordan (Big Apple Group)	<u>Equipment:</u> - Dusttrack II (upwind and downwind) - PID (upwind and downwind) - Caterpillar 318E Excavator
<p>Work Activities Performed (Since Last Report):</p> <ul style="list-style-type: none"> • Thomas Brown of CA RICH arrived on the site around 7:15 am. • CA RICH was present to document remediation activities and implement Community Air Monitoring Program (CAMP) in accordance with the NYSDEC approved April 2023 Interim Remedial Measure Work Plan (IRM). • CA RICH setup an upwind CAMP station in B1 and a downwind CAMP station in C4. • Excavation for framework and underpinning on the eastern side was performed in grids C1, C2, D1 and D2. • CA RICH representative left the site around 4:00 pm. 	
Grids Worked In: C1, C2, D1 and D2	
Samples Collected (Since Last Report): None	

Air Monitoring (Since Last Report):

An Upwind PDR station was set up in grid: B1

Odors: None

Maximum VOC level (PPM): 0.0

Pre-start Conditions – PID = 0.2 ppm, Dust = 58 $\mu\text{g}/\text{m}^3$

Maximum Particulate Level Upwind (ug/m^3): 58

No 15min TWA exceedances were identified in the upwind station.

A Downwind PDR station was set up in grid: C4

Odors: None

Maximum VOC level (PPM): 0.0

Pre-start Conditions – PID = 0.0 ppm, Dust = 75 $\mu\text{g}/\text{m}^3$

Maximum Particulate Level Downwind (ug/m^3): 75

No 15min TWA exceedances were identified in the downwind station.

Problems Encountered:

None

Planned Activities for the Next Day/Week:

- Perform community air monitoring using PIDs and dust monitors;
- Underpinning;
- Soil removal to Clean Earth of Carteret;
- Soil removal to the Clean Soil Bank; and
- End-point soil sampling.

Locations of work and quantities of material imported and exported from the Site:

Facility # Name/ location type of waste	Clean Earth of Carteret 24 Middlesex Ave. Carteret, NJ Solid	
Trucks or Cubic Yards	Trucks	Cubic Yards
Today	0	0
Totals	192	3,840

NYC Clean Soil Bank	Receiving Facility: 830 Forbell Street, Brooklyn NY 11208	
Trucks or Cubic Yards	Trucks	Cubic Yards
Today	0	0
Totals	67	1,944

Site Grid Map

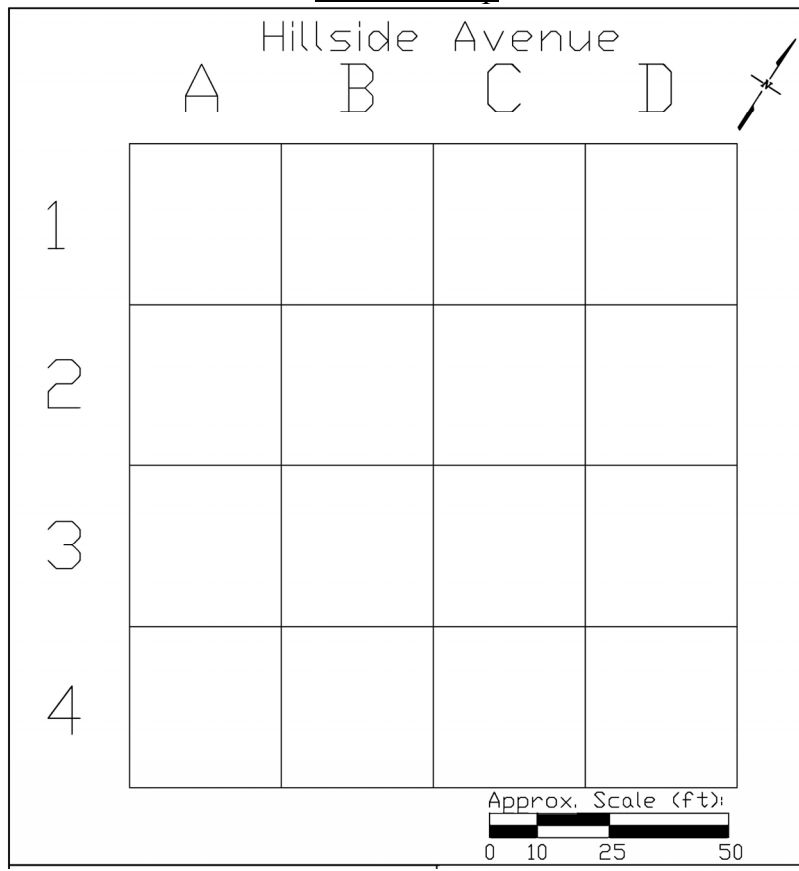

Photo Log

Photo 1 –

View of area
for shoring.



Photo 2 –

View of excavation shoring.



Photo 3 –

View of
formwork



Photo 4 –

View of formwork



Hillside Avenue

A B C D



1
2
3
4

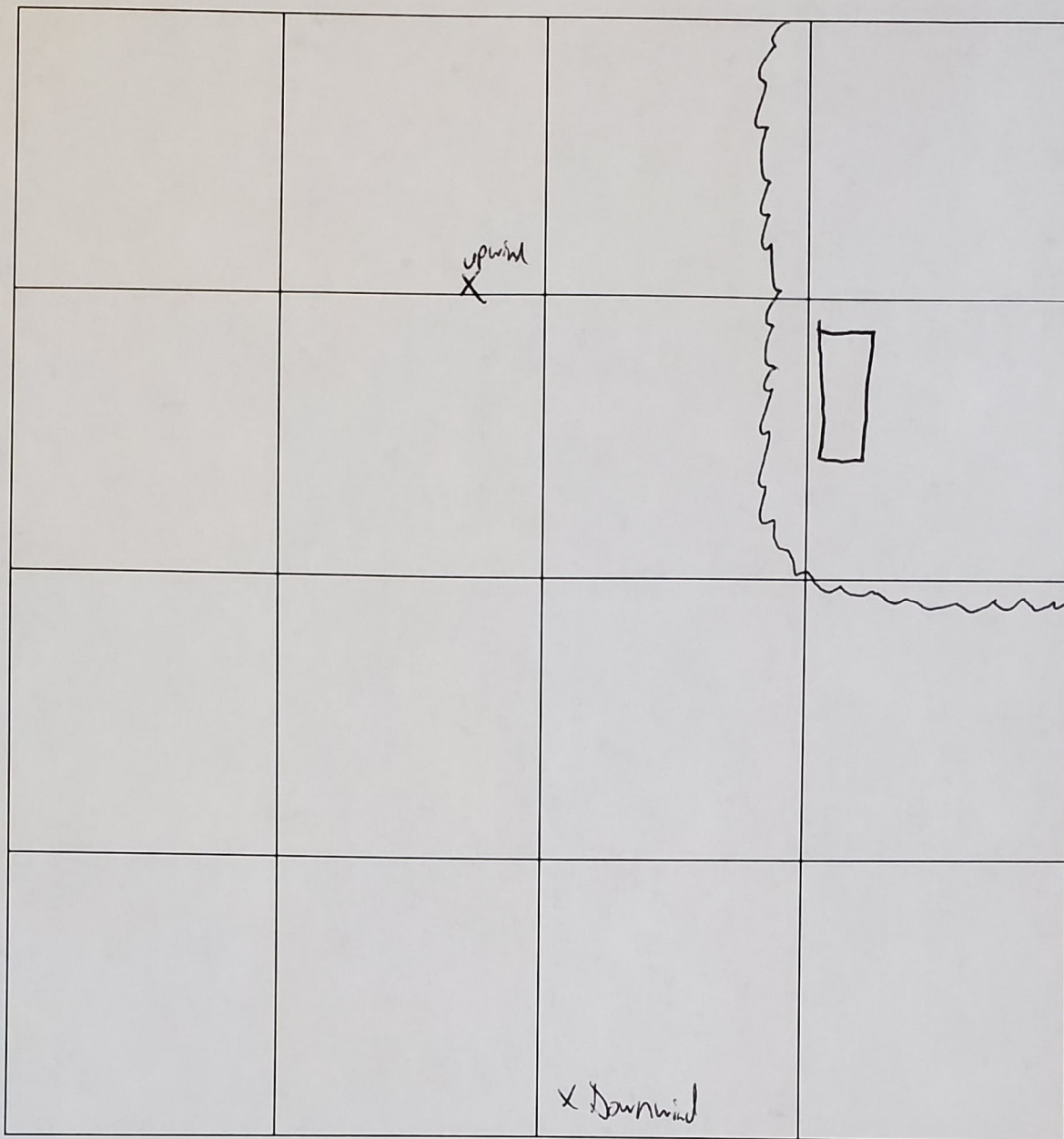

Approx. Scale (ft):

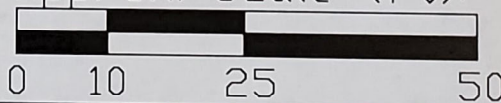

Date: 10/12/23
Notes:

CA RICH CONSULTANTS

Environmental Specialists Since 1982
17 Dupont Street, Plainview, New York 11803

TITLE: Daily Report Grid		DATE: 8/25/2023
FIGURE: 1		SCALE: As Shown
DRAWING NO: 2023-1	148-28 Hillside Avenue Jamaica, Queens, NY	DRAWN BY: T.R.B. APPR. BY: J.E.P.

Air Monitoring
(Parts Per Million)
Hillside 168 Inc.
148-28 Hillside Avenue
Jamaica, Queens, NY

Date: *10/12/23*
Meter Reading: PID (ppm)

TIME	LOCATION					
	A	B	C	D	E	F
7:00						
7:30	<i>0.6</i>	<i>0.0</i>				
8:00	<i>0.0</i>	<i>0.0</i>				
8:30	<i>0.0</i>	<i>0.0</i>				
9:00	<i>0.0</i>	<i>0.0</i>				
9:30	<i>0.6</i>	<i>0.0</i>				
10:00	<i>0.0</i>	<i>0.0</i>				
10:30	<i>0.0</i>	<i>0.0</i>				
11:00	<i>0.0</i>	<i>0.0</i>				
11:30	<i>0.0</i>	<i>0.0</i>				
12:00	<i>0.6</i>	<i>0.0</i>				
12:30	<i>0.0</i>	<i>0.0</i>				
13:00	<i>0.0</i>	<i>0.0</i>				
13:30	<i>0.0</i>	<i>0.0</i>				
14:00	<i>0.0</i>	<i>0.0</i>				
14:30	<i>0.0</i>	<i>0.0</i>				
15:00						
15:30						
16:00						
16:30						
17:00						

Locations:

- A *upwind*
- B *downwind*
- C
- D
- E
- F

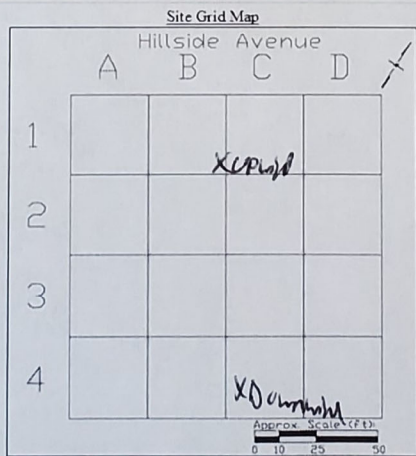

CA RICH Consultants
Community Air Monitoring Program - DUST (PM-10)

Project: Hillside 168 Inc.
 Location: 148-28 Hillside Avenue, Queens NY
 Date: 10/12/2023

Upwind Serial Number 8530203032
 Downwind Serial Number 8530172012

Upwind		Downwind		Corrected Downwind	Comments
Time	Concentration [ug/m3]	Time	Concentration [ug/m3]	Concentration [ug/m3]	
7:37:43 AM	58	7:40:52 AM	75	17	
7:52:43 AM	46	7:55:52 AM	65	19	
8:07:43 AM	40	8:10:52 AM	55	15	
8:22:43 AM	30	8:25:52 AM	42	12	
8:37:43 AM	25	8:40:52 AM	34	9	
8:52:43 AM	25	8:55:52 AM	44	19	
9:07:43 AM	21	9:10:52 AM	32	11	
9:22:43 AM	21	9:25:52 AM	34	13	
9:37:43 AM	22	9:40:52 AM	38	16	
9:52:43 AM	24	9:55:52 AM	41	17	
10:07:43 AM	23	10:10:52 AM	43	20	
10:22:43 AM	24	10:25:52 AM	42	18	
10:37:43 AM	23	10:40:52 AM	41	18	
10:52:43 AM	23	10:55:52 AM	38	15	
11:07:43 AM	19	11:10:52 AM	33	14	
11:22:43 AM	17	11:25:52 AM	26	9	
11:37:43 AM	15	11:40:52 AM	23	8	
11:52:43 AM	17	11:55:52 AM	27	10	
12:07:43 PM	23	12:10:52 PM	36	13	
12:22:43 PM	28	12:25:52 PM	44	16	
12:37:43 PM	26	12:40:52 PM	38	12	
12:52:43 PM	33	12:55:52 PM	49	16	
1:07:43 PM	34	1:10:52 PM	48	14	
1:22:43 PM	32	1:25:52 PM	45	13	
1:37:43 PM	27	1:40:52 PM	37	10	
1:52:43 PM	21	1:55:52 PM	27	6	
2:07:43 PM	19	2:10:52 PM	23	4	
2:22:43 PM	17	2:25:52 PM	22	5	
2:37:43 PM	18	2:40:52 PM	22	4	
2:52:43 PM	17	2:55:52 PM	21	4	
3:07:43 PM	8	3:10:52 PM	12	4	
3:22:43 PM	9	3:25:52 PM	12	3	
3:37:43 PM	0	3:40:52 PM	12	12	