

**DAILY STATUS REPORT**

WEATHER	Snow		Rain		Overcast		Partly Cloudy		Bright Sun	X
TEMP.	< 32		32-50		50-70		70-85	X	> 85	

Prepared By:

JESSICA PROSCIA

NYSDEC BCP Project No.	C241199	NYCOER Project No.	17CVCP044Q	DATE:	10/11/2023
Project Name:	148-28 Hillside Avenue				

<u>Consultant:</u> Tim Maines CA RICH Consultants	<u>Safety Officer:</u> Tim Maines CA RICH Consultants
<u>General Contractor:</u> Oscar Velasquez, New York Fast General Contracting Corp.	<u>Site Manager/Supervisor:</u> Joseph Valente (3T Construction Inc.)
<u>Personnel Present and Affiliation:</u> -Tim Maines (CA RICH) -Cesar (New York Fast General Contracting Corp.) -Roberto (New York Fast General Contracting Corp.) -Consallo (New York Fast General Contracting Corp.) - Joseph Valente (3T Construction Inc.) - Ying Yun (3T Construction Inc.) - Jordan (Big Apple Group)	<u>Equipment:</u> - Dusttrack II (upwind and downwind) - PID (upwind and downwind) - Caterpillar 318E Excavator
<p>Work Activities Performed (Since Last Report):</p> <ul style="list-style-type: none"> <li>• Tim Maines of CA RICH arrived on the site around 7:30 am.</li> <li>• CA RICH was present to document remediation activities and implement Community Air Monitoring Program (CAMP) in accordance with the NYSDEC approved April 2023 Interim Remedial Measure Work Plan (IRM).</li> <li>• CA RICH setup an upwind CAMP station in B1 and a downwind CAMP station in C4.</li> <li>• Excavation for framework and shoring on the eastern side was performed in grids C1, C2, D1 and D2.</li> <li>• CA RICH representative left the site around 4:25 pm.</li> </ul>	
Grids Worked In: C1, C2, D1 and D2	
Samples Collected (Since Last Report): None	

Air Monitoring (Since Last Report):

An Upwind PDR station was set up in grid: B1

Odors: None

Maximum VOC level (PPM): 0.7

Pre-start Conditions – PID = 0.2 ppm, Dust = 47  $\mu\text{g}/\text{m}^3$

Maximum Particulate Level Upwind ( $\text{ug}/\text{m}^3$ ): 132

No 15min TWA exceedances were identified in the upwind station.

A Downwind PDR station was set up in grid: C4

Odors: None

Maximum VOC level (PPM): 0.0

Pre-start Conditions – PID = 0.0 ppm, Dust = 47  $\mu\text{g}/\text{m}^3$

Maximum Particulate Level Downwind ( $\text{ug}/\text{m}^3$ ): 64

No 15min TWA exceedances were identified in the downwind station.

Problems Encountered:

None

Planned Activities for the Next Day/Week:

- Perform community air monitoring using PIDs and dust monitors;
- Underpinning;
- Soil removal to Clean Earth of Carteret;
- Soil removal to the Clean Soil Bank; and
- End-point soil sampling.

Locations of work and quantities of material imported and exported from the Site:

<b>Facility # Name/ location type of waste</b>	<b>Clean Earth of Carteret 24 Middlesex Ave. Carteret, NJ Solid</b>	
<b>Trucks or Cubic Yards</b>	<b>Trucks</b>	<b>Cubic Yards</b>
<b>Today</b>	0	0
<b>Totals</b>	192	3,840

<b>NYC Clean Soil Bank</b>	<b>Receiving Facility: 830 Forbell Street, Brooklyn NY 11208</b>	
<b>Trucks or Cubic Yards</b>	<b>Trucks</b>	<b>Cubic Yards</b>
<b>Today</b>	0	0
<b>Totals</b>	67	1,944

Site Grid Map

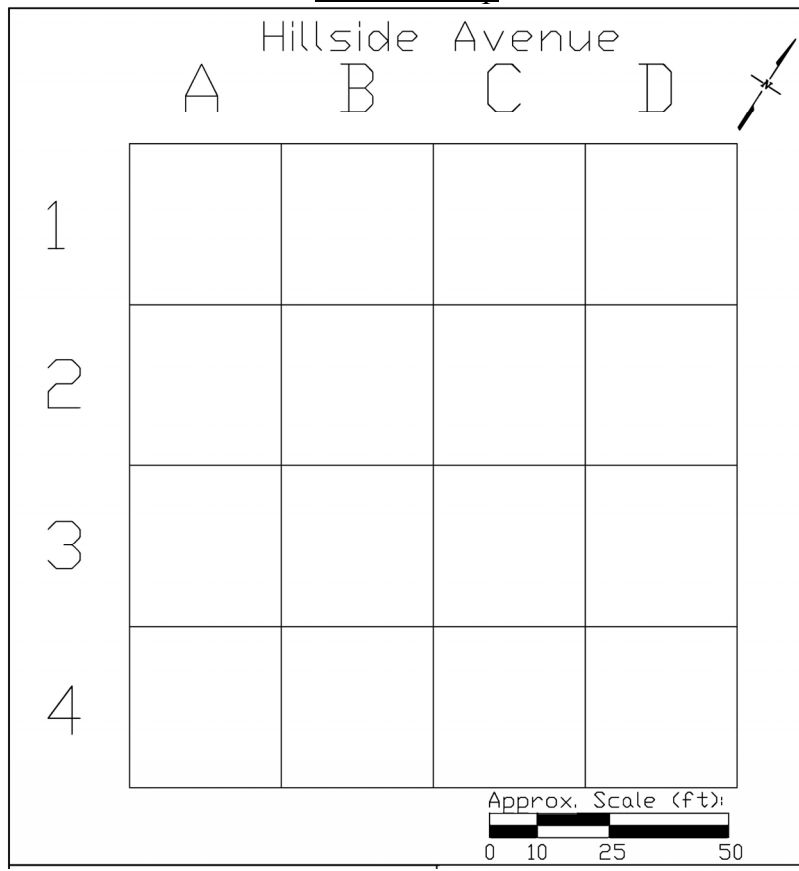

Photo Log

Photo 1 –

View of  
area for  
shoring.



Photo 2 –

View of excavation for shoring.



Photo 3 –

View of shoring.



Photo 4 –

View of  
area for  
shoring





# Hillside Avenue

A

B

C

D



1

2

3

4

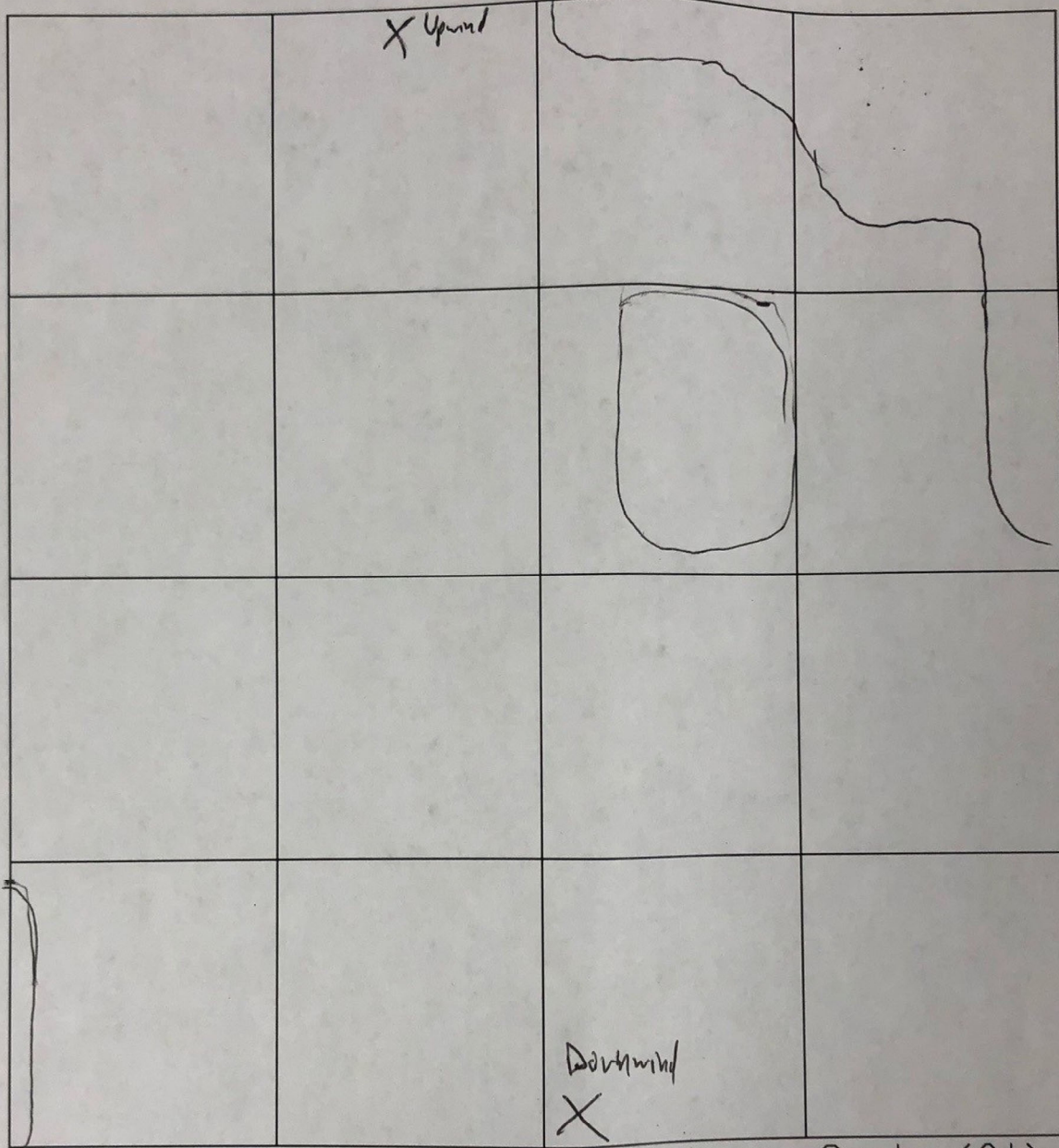

Approx. Scale (ft):

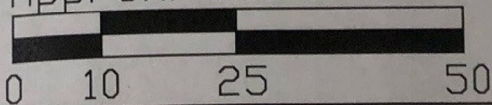

Date: 10/11/23  
Notes:

## CA RICH CONSULTANTS

Environmental Specialists Since 1982  
17 Dupont Street, Plainview, New York 11803

TITLE:

Daily Report Grid

DATE:

8/25/2023

SCALE:

As Shown

FIGURE:

1

148-28 Hillside Avenue  
Jamaica, Queens, NY

DRAWN BY:

T.R.B.

DRAWING NO:

2023-1

APPR. BY:

J.E.P.

Air Monitoring  
(Parts Per Million)  
Hillside 168 Inc.  
148-28 Hillside Avenue  
Jamaica, Queens, NY

Date:  
Meter Reading: PID (ppm)

TIME	LOCATION					
	A	B	C	D	E	F
7:00						
7:30	0.2	0.0				
8:00	0.3	0.0				
8:30	0.3	0.0				
9:00	0.4	0.0				
9:30	0.5	0.0				
10:00	0.6	0.0				
10:30	0.6	0.0				
11:00	0.7	0.0				
11:30	0.7	0.0				
12:00	0.7	0.0				
12:30	0.7	0.0				
13:00	0.7	0.0				
13:30	0.7	0.0				
14:00	0.7	0.0				
14:30	0.6	0.0				
15:00	0.4	0.0				
15:30						
16:00						
16:30						
17:00						

Locations:  
A Upwind  
B Downwind  
C  
D  
E  
F

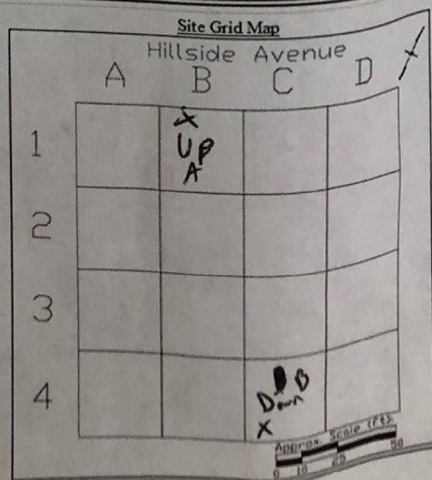

**CA RICH Consultants**  
**Community Air Monitoring Program - DUST (PM-10)**

Project: Hillside 168 Inc.  
 Location: 148-28 Hillside Avenue, Queens NY  
 Date: 10/11/2023

Upwind Serial Number 8530203032  
 Downwind Serial Number 8530172012

Upwind		Downwind		Corrected Downwind	Comments
Time	Concentration [ug/m3]	Time	Concentration [ug/m3]	Concentration [ug/m3]	
8:07:55 AM	47	8:04:13 AM	47	0	
8:22:55 AM	49	8:19:13 AM	45	-4	
8:37:55 AM	69	8:34:13 AM	44	-25	
8:52:55 AM	94	8:49:13 AM	42	-52	
9:07:55 AM	60	9:04:13 AM	39	-21	
9:22:55 AM	29	9:19:13 AM	30	1	
9:37:55 AM	22	9:34:13 AM	30	8	
9:52:55 AM	39	9:49:13 AM	27	-12	
10:07:55 AM	22	10:04:13 AM	28	6	
10:22:55 AM	17	10:19:13 AM	25	8	
10:37:55 AM	28	10:34:13 AM	24	-4	
10:52:55 AM	41	10:49:13 AM	25	-16	
11:07:55 AM	34	11:04:13 AM	56	22	
11:22:55 AM	61	11:19:13 AM	25	-36	
11:37:55 AM	88	11:34:13 AM	29	-59	
11:52:55 AM	85	11:49:13 AM	29	-56	
12:07:55 PM	42	12:04:13 PM	38	-4	
12:22:55 PM	42	12:19:13 PM	64	22	
12:37:55 PM	132	12:34:13 PM	39	-93	
12:52:55 PM	67	12:49:13 PM	28	-39	
1:07:55 PM	28	1:04:13 PM	32	4	
1:22:55 PM	12	1:19:13 PM	18	6	
1:37:55 PM	12	1:34:13 PM	16	4	
1:52:55 PM	9	1:49:13 PM	15	6	
2:07:55 PM	34	2:04:13 PM	16	-18	
2:22:55 PM	32	2:19:13 PM	21	-11	
2:37:55 PM	19	2:34:13 PM	15	-4	
2:52:55 PM	14	2:49:13 PM	19	5	
3:07:55 PM	12	3:04:13 PM	14	2	
3:22:55 PM	34	3:19:13 PM	35	1	
3:37:55 PM	8	3:34:13 PM	12	4	
3:52:55 PM	9	3:49:13 PM	12	3	
4:07:55 PM	0	4:04:13 PM	12	12	