



**ENVIRONMENTAL BUSINESS CONSULTANTS**

---

March 29, 2018

Ms. Ruth Curley  
New York State Department of Environmental Conservation  
Division of Environmental Remediation, Region 2  
625 Broadway, Albany, New York 12233

**Re: *Quarterly Inspection Report  
Former Union Wire Die Corp.  
39-40 30th Street, Queens, New York  
NYSDEC BCP Number: C241163***

Dear Ms. Curley:

Please find the enclosed Quarterly Inspection Report for the above referenced project for the first quarter of 2018. In accordance with the Site Management Plan (SMP). Data from four Soil Vapor Extraction (SVE) system monitoring ports, VE-1 though VE-4, Pre-Carbon, and Post-Carbon are included in this report.

If you have any questions or comments regarding the attached report, please do not hesitate to contact me.

Very truly yours,

Amy Kasten  
Environmental Geologist

Chawinie Reilly  
Project Manager

Cc: M. Komoroske, NYSDEC  
K. Lewandowski, NYSDEC  
C. Sosik, EBC  
A. Czemerinski, AMC



**ENVIRONMENTAL BUSINESS CONSULTANTS**

---

1808 MIDDLE COUNTRY ROAD | PHONE 631.504.6000  
RIDGE, NY 11961 | FAX 631.924.2870

**FORMER UNION WIRE DIE CORP.**  
**NYSDEC BCP Number C241163**  
**Project Status Report**  
**2018**

**Reporting Summary**

**Report Date:** March 29, 2018

**Reporting Period:** 1st Quarter of 2018

**Site Status:** The building is currently in service.

**Work Performed this Quarter:** March 19, 2018 – Quarterly PID measurements of SVE wells, influent and after GSC units.

**Monitoring Program Summary**

**No. of Sampling Points:** 4 SVE wells (VE-1 - VE-4), Pre-carbon, Post-carbon.

**Gauging Frequency:** Quarterly for PID measurements for SVE wells, Pre-carbon and Post-carbon.

**Sampling Frequency:** Quarterly for PID measurements for SVE wells (VE-1 - VE-4), Pre-carbon and Post-carbon.

**Reporting Frequency:** Quarterly Inspection Report (Quarterly).

**Groundwater Depth:** 20 feet below sidewalk grade

**GW Flow Direction:** South.

**Monitoring Results:** Not Applicable.

**Sampling Results:** Quarterly sampling occurred during this report. Based on PID readings system is running properly.

## **AIR SAMPLING**

The most recent sampling event was performed on March 19, 2018. The SVE sampling ports, pre carbon and post carbon locations were field screened with a photo-ionization detector (PID), and an SVE pre carbon sample was collected with a 1 L tedlar bag using a peristaltic pump.

Routine System Inspection Forms are attached in **Appendix A**.

## **QUATERLY PID MEASUREMENTS**

VE-1 – PID reading for this port was 0.1 ppm with a vacuum of -13.79 iwc.

VE-2 – PID reading for this port was 0.1 ppm with a vacuum of -13.90 iwc.

VE-3 – PID reading for this port was 0.0 ppm with a vacuum of -13.80 iwc.

VE-4 – PID reading for this port was 0.0 ppm with a vacuum of -13.83 iwc.

PRE-CARBON – PID reading for this port was 0.0 ppm.

POST-CARBON –PID reading for this port was 0.0 ppm.

## **FUTURE PLANS / RECOMMENDATIONS**

The SVE system is currently operating at optimal conditions; no repairs or modifications are required at this time. EBC recommends continued operation of the SVE system and continuing quarterly PID monitoring, annual groundwater sampling and annual air sampling (pre-carbon location, IA1, IA2, IA3, IA4, IA5, IA6 and OA1).

# *FIGURES*



40TH STREET  
SIDEWALK

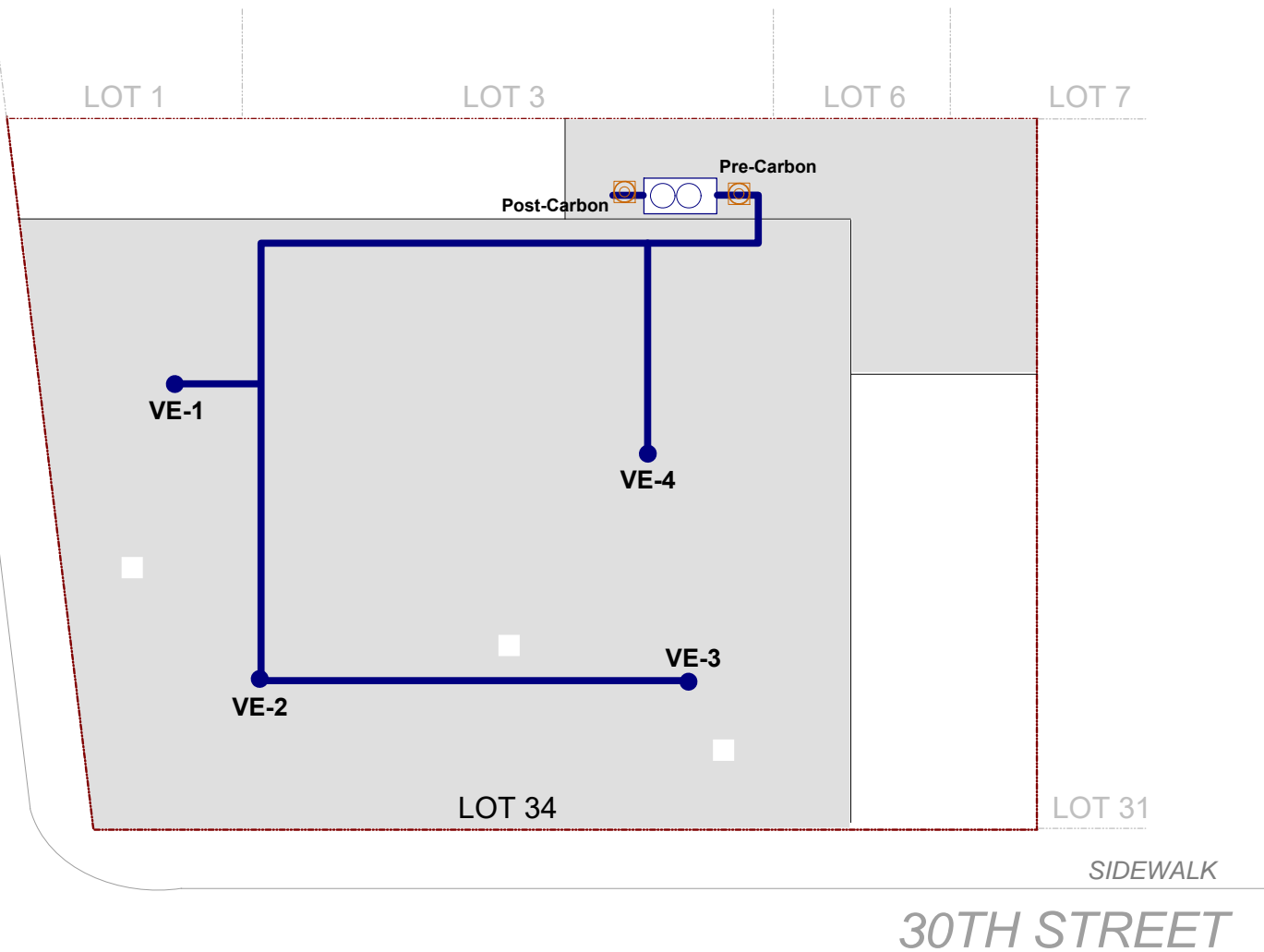

**KEY:**

 Property Boundary

**SCALE:**

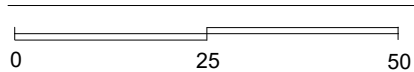

Scale: 1 inch = 25 feet



ENVIRONMENTAL BUSINESS CONSULTANTS

Phone 631.504.6000  
Fax 631.924.2870

Figure  
1

Site Name: REDEVELOPMENT PROJECT  
Site Address: 39-40 30TH STREET, QUEENS, NY  
Drawing Title: SVE SYSTEM SAMPLING LOCATIONS

# **APPENDIX A**

## **Routine System Inspection Form**



**Former Union Wire Die Corp  
Soil Vapor Extraction  
ROUTINE SYSTEM INSPECTION FORM**

Last Carbon Filter Installation Date: 6-20-2017

Date: 3/19/18

Inspector: Thomas Gallo

Time: 10:00

Inspector's Signature: Thomas Gallo

Weather: Sunny

Extraction Point	Operation Range	Vacuum (inwc)	PID Reading (ppb) ppm
VE-1	Typically -20 to -14" wc	-13.79	0.1
VE-2	Typically -20 to -14" wc	-13.90	0.1
VE-3	Typically -20 to -14" wc	-13.80	6.0
VE-4	Typically -20 to -14" wc	-13.83	0.0
Blower Inlet	Typically -35 to -25" wc	-29	
Before Carbon	Typically -20 to -14" wc	N/A	0.0
After Carbon	n/a	N/A	0.0

Inspection:	Yes / No	Comments
Blower Operating?	Yes	
<b>Spare Carbon Drums:</b>		
On-Site and Labeled New?	Yes	Two spare drums in warehouse area.
<b>System Integrity:</b>		
All PVC Piping Intact?	Yes	
Unusual Noises (i.e. hissing)?	No	
Gauges Intact & Operating?	Yes	

*This form is to be maintained onsite in a binder to be kept with the SVE system.*