

DAILY FIELD REPORT 181

Prepared By: LANGAN

WEATHER	Snow		Rain	X	Overcast		Partly Cloudy	X	Sunny	
TEMP.	< 32		32-50		50-70		70-85		>85	

BCP Project No:	C231153	Date:	February 2, 2024
------------------------	---------	--------------	------------------

Project Name:	Kasser Scrap Metal and Rector Cleaners Site	Time:	6:45 am to 3:45 pm
----------------------	---	--------------	--------------------

Consultant: Langan Engineering, Environmental, Surveying, Landscape Architecture and Geology, D.P.C. (Langan)	Langan Field Personnel: Caitlyn Dempsey (Environmental) Xianglei Zheng (Geotechnical)
Construction Manager: Consigli Construction Co., Inc. (Consigli)	
Foundation Contractor: Urban Foundation/Engineering (Urban)	

Work Activities Performed:

- Urban excavated an about 10-foot-long by about 10-foot-wide area from about 15 feet below grade surface (bgs) to about 22 feet bgs in the central part of grids WC02_15-20 and WC02_20-25 to install timber lagging. Excavated soil/fill was stockpiled in the southwestern corner of WC04, pending off-site disposal.
- Urban relocated a portion of the stockpile in the southern part of WC04 to the southern part of WC02, pending off-site disposal.
- Urban graded an about 20-foot-long by about 30-foot-wide area in the southern part of grid WC02 and an about 20-foot-long by about 40-foot-wide area in the center of grids WC04 and WC05 to mobilize equipment.
- Excavated and graded soil/fill consisted of non-native soil; odors, staining, elevated photoionization detector (PID) readings, or other evidence of a petroleum or chemical release were not observed.
- Urban installed reinforcement and grouted two caissons in the southern part of grids WC04 and WC05.
- Urban installed one rock socket for one caisson in the southern part of grid WC04.

Material Tracking:

- The following soil/fill was exported from the site:
 - 6 loads of soil/fill from waste characterization grids WC02_15-20, WC02_20-25, WC02_25-20, WC03_10-15, WC03_15-20, WC03_20-25, WC03_25-30, WC04_0-5, and WC05_0-5 were exported for off-site disposal at the Clean Earth of Carteret LLC facility in Carteret, NJ.
- No material was imported to the site.

Materials Export Summary								
Facility Name	Bayshore Soil Management, LLC		Clean Earth of Carteret, LLC		PPark NJ		Faztec Solutions	
Location	Keasbey, NJ		Carteret, NJ		Prospect Park, NJ		Staten Island, NY	
Type of Waste	Non-hazardous Soil		Non-hazardous Soil		Non-hazardous Soil		C&D	
Today	Number of Loads	Approx. Volume (CY)	Number of Loads	Approx. Volume (CY)	Number of Loads	Approx. Volume (CY)	Number of Loads	Approximate Volume (CY)
		0	-	6	120	0	-	0
Total	Number of Loads	Approx. Volume (CY)	Number of Loads	Approx. Volume (CY)	Number of Loads	Approx. Volume (CY)	Number of Loads	Approximate Volume (CY)
	139	2,780	258	5,160	0	-	15	300

Materials Export Summary		
Facility Name	Dale Transfer Corp.	
Location	West Babylon, NY	
Type of Waste	Concrete	
Today	Number of Loads	Approx. Volume (CY)
		0
Total	Number of Loads	Approx. Volume (CY)
	2	40

Materials Import Summary						
Facility Name	Greenpoint Quarry / North Shore Terminal		Stavola Bound Brook / North Shore Terminal		North American Aggregate Mining Operations	
Location	Staten Island, NY		Staten Island, NY		Perth Amboy, NJ	
Type of Material	ASTM #57 0.75-inch Stone		ASTM #2 2.5-inch Stone		Pipe Sand Backfill	
Today	Number of Loads	Approx. Volume (CY)	Number of Loads	Approx. Volume (CY)	Number of Loads	Approx. Volume (CY)
		0	-	0	-	0
Total	Number of Loads	Approx. Volume (CY)	Number of Loads	Approx. Volume (CY)	Number of Loads	Approx. Volume (CY)
	6	120	3	60	0	-
Approved Quantity	-	500	-	200	-	300

Samples Collected:

- No samples were collected.

Air Monitoring:

The 15-minute average site contributions for particulates and volatile organic compounds (VOCs) are calculated by subtracting the upwind readings from the downwind readings. A true action level exceedance is realized when this net result exceeds 100 µg/m³ for particulates and 5 ppm for organic vapors. No particulates (PM10) or organic vapors exceeded the 15-minute average site contribution action level of 100 µg/m³ or 5 ppm, respectively, on this day.

The Community Air Monitoring Program (CAMP) was not implemented from 10:06 to 14:09 due to sustained precipitation.

Particulate Monitoring (µg/m ³)		Organic Vapor Monitoring (ppm)	
Daily Background	25.4	Daily Background	0.00
PM10 Average Site Contribution (Minimum)	-8.7	VOC Average Site Contribution (Minimum)	-0.01
PM10 Average Site Contribution (Maximum)	4.0	VOC Average Site Contribution (Maximum)	0.02

µg/m³: micrograms per cubic meter.

ppm: parts per million.

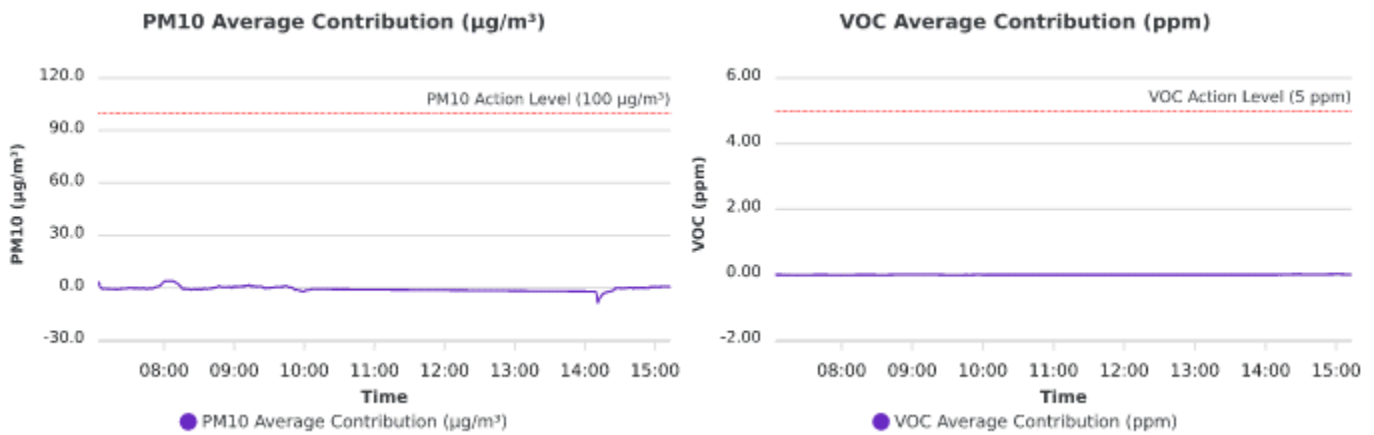

Planned Activities:

- Urban will continue to excavate and grade site soil/fill in support of foundation installation.
- Urban will continue to advance caissons and soldier piles.

SITE PLAN

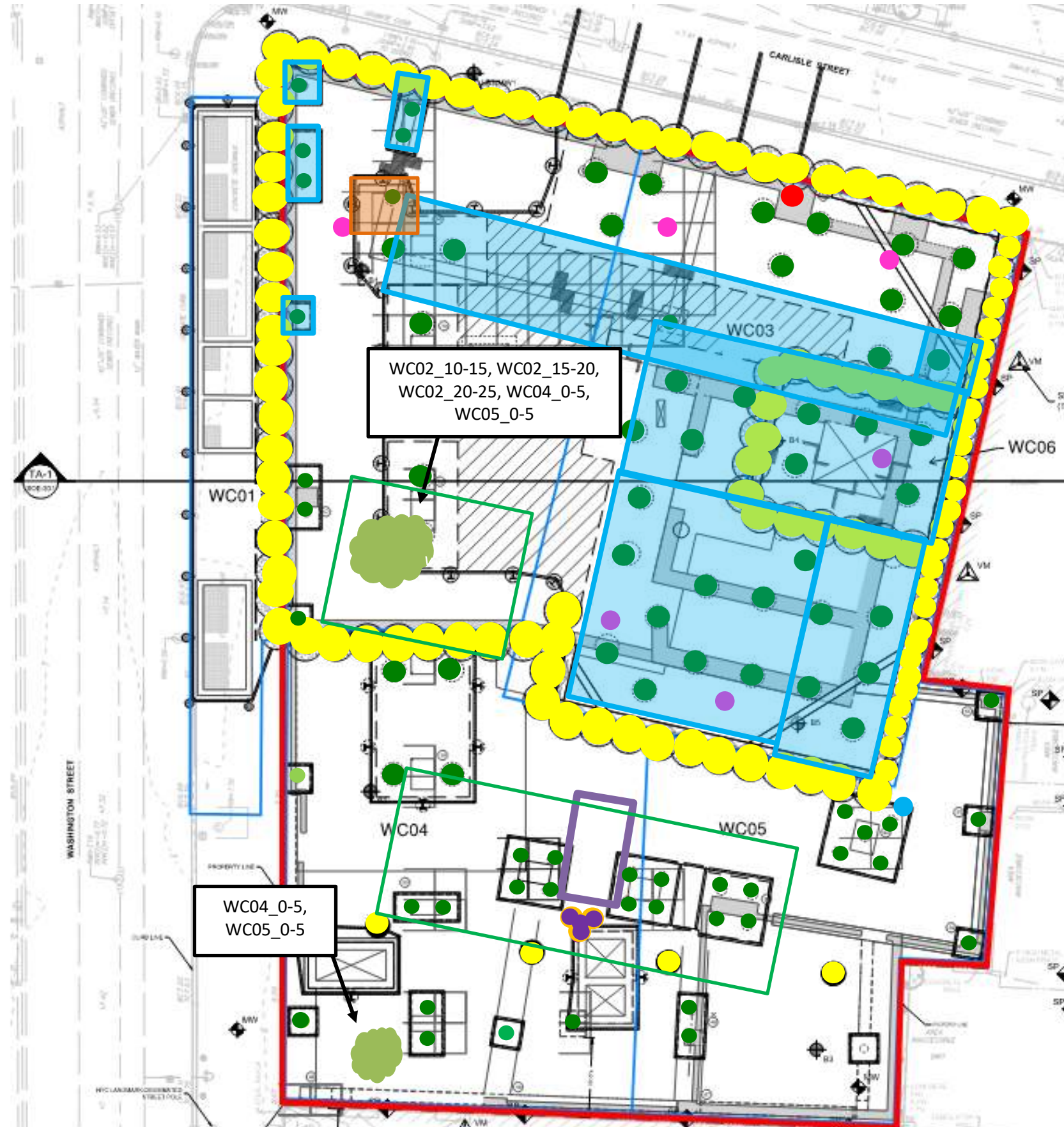

- Site Boundary**
- Waste Characterization Grid Boundary**
- **CAMP station 1**
- **CAMP station 2**
- **Stockpile – Soil (no impacts)**
- **Stockpile – C&D**
- **Stockpile – Timber Piles**
- Approximate Location of Excavation**
- Approximate Area of Grading**
- Approximate Backfill Location**
- **Completed Soil-Mix Column**
- **Completed Caisson Casing**
- **Completed Caisson**
- **Reinstalled Soil-Mix Column as part of the In-Situ Stabilization of NAPL-contaminated Soil**
- **Soil-Mix Core Advanced**
- **Documentation Endpoint Sample**
- Completed Waterproofing Installation**
- Approximate Location of the Former UST**

Note: Waste characterization grid areas were developed by PT Consultants and Urban and is shown on this site plan for reference only.

Photo Log

Photo 1: Urban grading soil/fill in WC05_0-5 (facing southwest).



Photo 2: Urban loading a truck for soil/fill export (facing south).



LANGAN	Air Monitoring Report	170695201 - 111 Washington St	
		Report Period	
		From:	2/2/2024 06:00
		To:	2/2/2024 19:00
		PM10 Action Level:	100.0 $\mu\text{g}/\text{m}^3$
VOC Action Level:	5.00 ppm		

Daily Environmental Summary	Windspeed (mph)	Prevailing wind direction
2/2/2024	0.2-5.5	SE

Daily Monitoring Summary	PM10 ($\mu\text{g}/\text{m}^3$)	Time	VOC (ppm)	Time
Min Contribution (15 min avg.) - 2/2/2024	-8.7	14:11	-0.01	07:58
Max Contribution (15 min avg.) - 2/2/2024	4.0	08:05	0.02	15:00

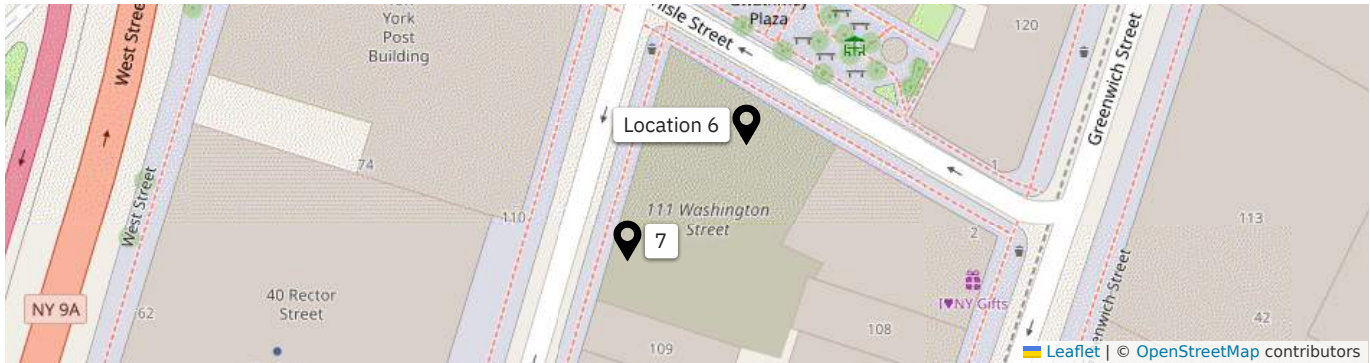

PM10 Average Contribution ($\mu\text{g}/\text{m}^3$)

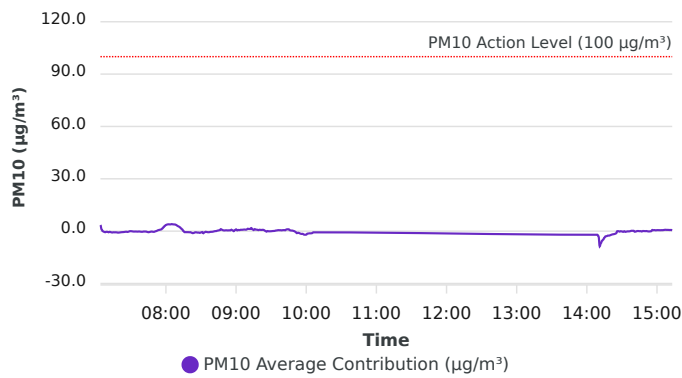

VOC Average Contribution (ppm)

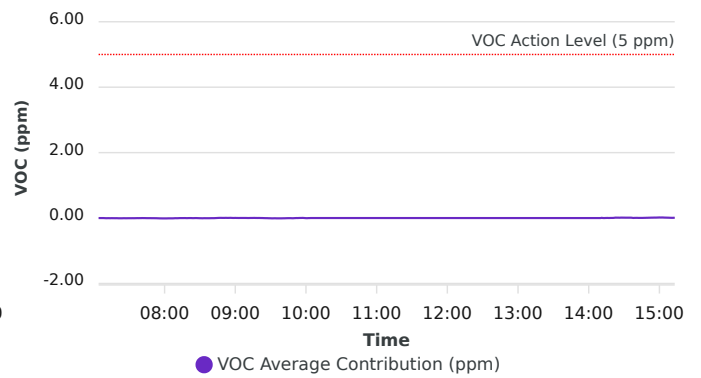

Contribution wind rose (mph)

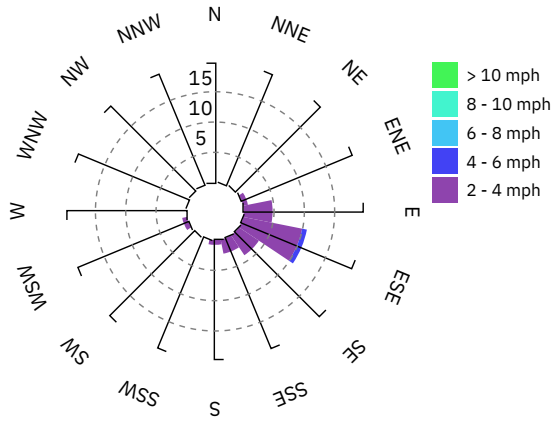

Date/Time	Average Upwind PM10 (µg/m³)	Average Downwind PM10 (µg/m³)	Average Contribution PM10 (µg/m³)	Average Upwind VOC (ppm)	Average Downwind VOC (ppm)	Average Contribution VOC (ppm)	Wind Speed 15 min Avg	Wind Direction
2/2/2024 07:04:00	25.4	28.9	3.5	0.00	0.00	0.00	1.1	SSW
2/2/2024 07:05:00	25.1	26.1	1.0	0.00	0.00	0.00	1.9	WSW
2/2/2024 07:06:00	24.1	24.1	0.0	0.00	0.00	0.00	1.9	WSW
2/2/2024 07:07:00	23.1	22.7	-0.4	0.00	0.00	0.00	2.0	WSW
2/2/2024 07:08:00	22.4	21.7	-0.6	0.00	0.00	0.00	1.9	SSE
2/2/2024 07:09:00	21.6	21.2	-0.4	0.00	0.00	0.00	1.9	WSW
2/2/2024 07:10:00	21.1	20.7	-0.4	0.00	0.00	0.00	1.7	SW
2/2/2024 07:11:00	20.8	20.1	-0.7	0.01	0.00	-0.01	1.6	SW
2/2/2024 07:12:00	20.2	19.8	-0.4	0.00	0.00	0.00	1.5	ESE
2/2/2024 07:13:00	20.0	19.4	-0.6	0.01	0.00	0.00	1.4	SW
2/2/2024 07:14:00	19.9	19.1	-0.8	0.01	0.00	-0.01	1.4	WSW
2/2/2024 07:15:00	19.6	19.0	-0.7	0.01	0.00	0.00	1.3	E
2/2/2024 07:16:00	19.5	18.8	-0.7	0.01	0.00	0.00	1.3	SSE
2/2/2024 07:17:00	19.2	18.6	-0.7	0.01	0.00	0.00	1.3	SSE
2/2/2024 07:18:00	19.1	18.3	-0.7	0.01	0.00	-0.01	1.2	SW
2/2/2024 07:19:00	18.3	17.4	-0.9	0.01	0.00	0.00	1.2	SE
2/2/2024 07:20:00	17.6	16.9	-0.8	0.01	0.00	-0.01	1.1	WSW
2/2/2024 07:21:00	17.2	16.4	-0.7	0.01	0.00	-0.01	1.0	WSW
2/2/2024 07:22:00	16.9	16.3	-0.6	0.01	0.00	-0.01	0.9	WSW
2/2/2024 07:23:00	16.7	16.2	-0.6	0.01	0.00	-0.01	0.9	SE
2/2/2024 07:24:00	16.6	16.1	-0.5	0.01	0.00	-0.01	0.8	SW
2/2/2024 07:25:00	16.4	16.0	-0.4	0.01	0.00	-0.01	0.8	ESE
2/2/2024 07:26:00	16.1	15.8	-0.3	0.01	0.00	-0.01	0.8	S
2/2/2024 07:27:00	16.1	15.6	-0.5	0.01	0.00	-0.01	0.8	SSE
2/2/2024 07:28:00	15.9	15.6	-0.3	0.01	0.00	-0.01	0.8	SSE
2/2/2024 07:29:00	15.5	15.5	-0.1	0.01	0.00	-0.01	0.8	E
2/2/2024 07:30:00	15.2	15.2	0.0	0.01	0.00	-0.01	0.8	E
2/2/2024 07:31:00	15.1	15.0	-0.1	0.01	0.00	-0.01	0.8	SSE
2/2/2024 07:32:00	15.0	14.7	-0.2	0.01	0.00	-0.01	0.8	WSW

Date/Time	Average Upwind PM10 (µg/m³)	Average Downwind PM10 (µg/m³)	Average Contribution PM10 (µg/m³)	Average Upwind VOC (ppm)	Average Downwind VOC (ppm)	Average Contribution VOC (ppm)	Wind Speed 15 min Avg	Wind Direction
2/2/2024 07:33:00	14.8	14.6	-0.2	0.01	0.00	0.00	0.8	SSW
2/2/2024 07:34:00	14.7	14.5	-0.2	0.01	0.00	-0.01	0.7	NE
2/2/2024 07:35:00	14.6	14.4	-0.2	0.01	0.00	0.00	0.7	SSE
2/2/2024 07:36:00	14.6	14.3	-0.3	0.01	0.00	0.00	0.7	W
2/2/2024 07:37:00	14.4	14.2	-0.2	0.01	0.00	0.00	0.8	ESE
2/2/2024 07:38:00	14.3	14.0	-0.3	0.01	0.00	0.00	0.8	WSW
2/2/2024 07:39:00	14.1	13.7	-0.4	0.01	0.00	0.00	0.8	ESE
2/2/2024 07:40:00	14.0	13.7	-0.4	0.01	0.00	0.00	0.8	ESE
2/2/2024 07:41:00	13.9	13.7	-0.2	0.01	0.01	0.00	0.9	E
2/2/2024 07:42:00	13.7	13.5	-0.2	0.01	0.01	0.00	0.9	SW
2/2/2024 07:43:00	13.6	13.4	-0.2	0.01	0.01	0.00	1.0	SW
2/2/2024 07:44:00	13.6	13.2	-0.5	0.01	0.01	0.00	1.0	WSW
2/2/2024 07:45:00	13.6	12.9	-0.6	0.01	0.00	0.00	1.1	SSW
2/2/2024 07:46:00	13.3	12.8	-0.5	0.01	0.00	0.00	1.1	SSW
2/2/2024 07:47:00	13.1	12.8	-0.3	0.01	0.00	0.00	1.1	WSW
2/2/2024 07:48:00	12.9	12.7	-0.2	0.01	0.00	0.00	1.2	SSW
2/2/2024 07:49:00	12.8	12.4	-0.4	0.01	0.00	0.00	1.2	SSW
2/2/2024 07:50:00	12.7	12.3	-0.4	0.01	0.00	0.00	1.3	WSW
2/2/2024 07:51:00	12.5	12.4	-0.1	0.01	0.00	0.00	1.4	WSW
2/2/2024 07:52:00	12.5	12.6	0.1	0.01	0.00	-0.01	1.3	SW
2/2/2024 07:53:00	12.3	12.7	0.5	0.01	0.00	-0.01	1.3	SW
2/2/2024 07:54:00	12.2	12.8	0.7	0.01	0.00	-0.01	1.4	WSW
2/2/2024 07:55:00	12.1	12.9	0.8	0.01	0.00	-0.01	1.5	SW
2/2/2024 07:56:00	12.3	13.3	1.0	0.01	0.00	-0.01	1.5	WSW
2/2/2024 07:57:00	12.3	13.9	1.6	0.01	0.00	-0.01	1.5	WSW
2/2/2024 07:58:00	12.3	14.6	2.3	0.01	0.00	-0.01	1.5	SW
2/2/2024 07:59:00	12.4	15.4	3.0	0.01	0.00	-0.01	1.4	W
2/2/2024 08:00:00	12.6	16.1	3.5	0.01	0.00	-0.01	1.4	S
2/2/2024 08:01:00	12.9	16.7	3.8	0.01	0.00	-0.01	1.4	S

Date/Time	Average Upwind PM10 (µg/m³)	Average Downwind PM10 (µg/m³)	Average Contribution PM10 (µg/m³)	Average Upwind VOC (ppm)	Average Downwind VOC (ppm)	Average Contribution VOC (ppm)	Wind Speed 15 min Avg	Wind Direction
2/2/2024 08:02:00	13.1	17.0	3.9	0.01	0.00	-0.01	1.3	S
2/2/2024 08:03:00	13.3	17.2	3.9	0.01	0.00	-0.01	1.2	ESE
2/2/2024 08:04:00	13.6	17.5	3.9	0.01	0.00	-0.01	1.2	SE
2/2/2024 08:05:00	13.7	17.7	4.0	0.01	0.00	-0.01	1.1	S
2/2/2024 08:06:00	13.8	17.7	3.9	0.01	0.00	-0.01	1.0	SW
2/2/2024 08:07:00	13.9	17.7	3.9	0.01	0.00	-0.01	1.0	WSW
2/2/2024 08:08:00	14.0	17.8	3.8	0.01	0.00	-0.01	1.0	W
2/2/2024 08:09:00	14.2	17.7	3.5	0.01	0.01	0.00	1.0	WSW
2/2/2024 08:10:00	14.6	17.6	3.0	0.01	0.01	-0.01	0.9	SW
2/2/2024 08:11:00	14.6	17.3	2.6	0.01	0.01	-0.01	0.8	S
2/2/2024 08:12:00	14.6	16.8	2.2	0.01	0.01	0.00	0.8	ESE
2/2/2024 08:13:00	14.8	16.3	1.5	0.01	0.01	0.00	0.7	E
2/2/2024 08:14:00	14.8	15.7	0.9	0.01	0.01	0.00	0.8	W
2/2/2024 08:15:00	15.2	15.2	0.0	0.01	0.01	0.00	0.8	WNW
2/2/2024 08:16:00	15.6	15.0	-0.6	0.01	0.01	0.00	0.8	SW
2/2/2024 08:17:00	15.5	14.9	-0.6	0.01	0.01	0.00	0.8	NNW
2/2/2024 08:18:00	15.5	14.9	-0.6	0.01	0.01	0.00	0.8	S
2/2/2024 08:19:00	15.4	14.8	-0.6	0.01	0.01	0.00	0.7	WSW
2/2/2024 08:20:00	15.3	14.7	-0.6	0.01	0.01	0.00	0.8	ENE
2/2/2024 08:21:00	15.3	14.7	-0.6	0.01	0.01	0.00	0.8	E
2/2/2024 08:22:00	15.3	14.3	-0.9	0.01	0.01	0.00	0.8	WSW
2/2/2024 08:23:00	15.2	14.1	-1.2	0.01	0.01	0.00	0.8	NW
2/2/2024 08:24:00	14.9	14.0	-1.0	0.01	0.00	0.00	0.9	ENE
2/2/2024 08:25:00	14.5	13.9	-0.7	0.01	0.00	0.00	0.9	ESE
2/2/2024 08:26:00	14.5	13.8	-0.7	0.00	0.00	0.00	0.9	E
2/2/2024 08:27:00	14.6	13.7	-0.8	0.00	0.00	0.00	0.9	ENE
2/2/2024 08:28:00	14.4	13.6	-0.8	0.01	0.00	0.00	1.0	WSW
2/2/2024 08:29:00	14.4	13.4	-1.0	0.01	0.00	0.00	0.9	SW
2/2/2024 08:30:00	14.1	13.4	-0.7	0.01	0.00	-0.01	0.9	W

Date/Time	Average Upwind PM10 (µg/m³)	Average Downwind PM10 (µg/m³)	Average Contribution PM10 (µg/m³)	Average Upwind VOC (ppm)	Average Downwind VOC (ppm)	Average Contribution VOC (ppm)	Wind Speed 15 min Avg	Wind Direction
2/2/2024 08:31:00	13.8	13.3	-0.5	0.01	0.00	-0.01	0.9	SSE
2/2/2024 08:32:00	14.3	13.1	-1.2	0.01	0.00	-0.01	0.9	SSE
2/2/2024 08:33:00	14.2	13.5	-0.7	0.01	0.00	-0.01	0.9	ESE
2/2/2024 08:34:00	14.1	13.8	-0.4	0.01	0.00	0.00	1.0	ENE
2/2/2024 08:35:00	14.2	13.7	-0.5	0.01	0.00	-0.01	1.0	SSW
2/2/2024 08:36:00	14.4	13.7	-0.6	0.01	0.00	-0.01	1.0	E
2/2/2024 08:37:00	14.5	13.9	-0.6	0.01	0.00	-0.01	1.0	SW
2/2/2024 08:38:00	14.5	14.1	-0.4	0.01	0.00	-0.01	1.0	NE
2/2/2024 08:39:00	14.5	14.1	-0.4	0.01	0.01	0.00	1.0	E
2/2/2024 08:40:00	14.5	14.2	-0.3	0.01	0.01	0.00	1.0	NE
2/2/2024 08:41:00	14.4	14.3	-0.2	0.01	0.01	0.00	1.0	ENE
2/2/2024 08:42:00	14.3	14.3	0.0	0.01	0.01	0.00	1.0	E
2/2/2024 08:43:00	14.3	14.4	0.0	0.01	0.01	0.00	1.0	E
2/2/2024 08:44:00	14.2	14.4	0.3	0.01	0.01	0.00	1.0	ESE
2/2/2024 08:45:00	14.0	14.4	0.4	0.00	0.01	0.00	1.0	NW
2/2/2024 08:46:00	13.8	14.4	0.6	0.00	0.01	0.01	1.0	E
2/2/2024 08:47:00	13.3	14.4	1.1	0.00	0.01	0.01	1.1	ENE
2/2/2024 08:48:00	13.3	14.1	0.8	0.00	0.01	0.01	1.1	NE
2/2/2024 08:49:00	13.3	13.8	0.5	0.00	0.01	0.01	1.2	SSE
2/2/2024 08:50:00	13.4	13.8	0.4	0.00	0.01	0.01	1.1	SSE
2/2/2024 08:51:00	13.4	13.9	0.5	0.00	0.01	0.01	1.1	E
2/2/2024 08:52:00	13.4	13.8	0.5	0.00	0.01	0.01	1.1	ESE
2/2/2024 08:53:00	13.5	13.9	0.4	0.00	0.01	0.01	1.1	SSE
2/2/2024 08:54:00	13.7	14.2	0.5	0.00	0.01	0.01	1.1	N
2/2/2024 08:55:00	14.1	14.5	0.4	0.00	0.01	0.01	1.2	SE
2/2/2024 08:56:00	14.2	15.0	0.8	0.00	0.01	0.01	1.2	NE
2/2/2024 08:57:00	14.5	14.9	0.4	0.00	0.01	0.01	1.2	W
2/2/2024 08:58:00	14.9	14.9	0.0	0.01	0.01	0.00	1.2	WSW
2/2/2024 08:59:00	15.1	15.7	0.6	0.01	0.01	0.00	1.2	NNE

Date/Time	Average Upwind PM10 (µg/m³)	Average Downwind PM10 (µg/m³)	Average Contribution PM10 (µg/m³)	Average Upwind VOC (ppm)	Average Downwind VOC (ppm)	Average Contribution VOC (ppm)	Wind Speed 15 min Avg	Wind Direction
2/2/2024 09:00:00	15.2	16.2	1.0	0.00	0.01	0.01	1.2	ESE
2/2/2024 09:01:00	15.8	16.3	0.4	0.01	0.01	0.00	1.2	WNW
2/2/2024 09:02:00	15.8	16.5	0.7	0.01	0.01	0.00	1.1	E
2/2/2024 09:03:00	15.8	16.4	0.6	0.01	0.01	0.00	1.1	SSW
2/2/2024 09:04:00	15.7	16.5	0.8	0.01	0.01	0.00	1.1	ENE
2/2/2024 09:05:00	15.8	16.6	0.8	0.01	0.01	0.00	1.2	NW
2/2/2024 09:06:00	15.7	16.5	0.8	0.01	0.01	0.00	1.2	E
2/2/2024 09:07:00	15.6	16.6	0.9	0.01	0.01	0.00	1.1	E
2/2/2024 09:08:00	15.7	16.5	0.8	0.01	0.01	0.00	1.1	SSW
2/2/2024 09:09:00	15.7	16.6	0.9	0.01	0.01	0.00	1.1	NNW
2/2/2024 09:10:00	15.6	17.0	1.4	0.01	0.01	0.00	1.1	E
2/2/2024 09:11:00	15.9	17.2	1.3	0.01	0.01	0.00	1.1	ESE
2/2/2024 09:12:00	16.1	17.3	1.2	0.00	0.01	0.00	1.1	S
2/2/2024 09:13:00	15.7	17.4	1.8	0.00	0.01	0.00	1.1	E
2/2/2024 09:14:00	15.8	16.8	1.0	0.00	0.01	0.00	1.1	ENE
2/2/2024 09:15:00	15.9	16.6	0.7	0.00	0.01	0.00	1.1	ESE
2/2/2024 09:16:00	15.7	16.9	1.2	0.00	0.01	0.01	1.1	SE
2/2/2024 09:17:00	15.9	16.8	0.9	0.00	0.01	0.00	1.1	SW
2/2/2024 09:18:00	16.1	16.9	0.8	0.00	0.01	0.00	1.1	SW
2/2/2024 09:19:00	16.2	16.8	0.6	0.00	0.01	0.00	1.1	WSW
2/2/2024 09:20:00	16.0	16.8	0.8	0.00	0.01	0.00	1.0	SE
2/2/2024 09:21:00	16.0	16.7	0.7	0.00	0.01	0.00	1.0	W
2/2/2024 09:22:00	16.0	16.7	0.7	0.01	0.01	0.00	1.0	SW
2/2/2024 09:23:00	15.8	16.6	0.8	0.01	0.01	0.00	1.1	WSW
2/2/2024 09:24:00	15.8	16.3	0.6	0.01	0.01	0.00	1.0	WSW
2/2/2024 09:25:00	15.6	15.7	0.1	0.01	0.00	0.00	1.1	WSW
2/2/2024 09:26:00	15.3	15.0	-0.3	0.01	0.00	0.00	1.1	WSW
2/2/2024 09:27:00	14.9	14.9	0.1	0.01	0.00	0.00	1.1	WNW
2/2/2024 09:28:00	14.9	14.8	-0.1	0.01	0.00	-0.01	1.1	SW

Date/Time	Average Upwind PM10 (µg/m³)	Average Downwind PM10 (µg/m³)	Average Contribution PM10 (µg/m³)	Average Upwind VOC (ppm)	Average Downwind VOC (ppm)	Average Contribution VOC (ppm)	Wind Speed 15 min Avg	Wind Direction
2/2/2024 09:29:00	14.7	14.6	-0.1	0.01	0.00	-0.01	1.1	SW
2/2/2024 09:30:00	14.4	14.3	-0.1	0.01	0.00	-0.01	1.0	SW
2/2/2024 09:31:00	14.0	14.1	0.0	0.01	0.00	-0.01	1.1	W
2/2/2024 09:32:00	13.9	14.0	0.1	0.01	0.00	-0.01	1.1	SSW
2/2/2024 09:33:00	13.8	14.0	0.1	0.01	0.00	-0.01	1.1	NNW
2/2/2024 09:34:00	13.8	14.2	0.3	0.01	0.00	-0.01	1.1	WSW
2/2/2024 09:35:00	13.8	14.3	0.4	0.01	0.00	-0.01	1.1	SW
2/2/2024 09:36:00	13.8	14.4	0.6	0.01	0.00	-0.01	1.2	WSW
2/2/2024 09:37:00	13.9	14.4	0.5	0.01	0.00	-0.01	1.1	WSW
2/2/2024 09:38:00	13.9	14.4	0.5	0.01	0.00	-0.01	1.1	W
2/2/2024 09:39:00	13.9	14.4	0.5	0.01	0.00	-0.01	1.1	WSW
2/2/2024 09:40:00	13.9	14.5	0.6	0.01	0.00	-0.01	1.1	E
2/2/2024 09:41:00	13.9	14.5	0.6	0.01	0.00	-0.01	1.1	ENE
2/2/2024 09:42:00	14.1	14.6	0.5	0.01	0.00	-0.01	1.0	SSE
2/2/2024 09:43:00	14.2	15.1	1.0	0.01	0.00	-0.01	1.1	SE
2/2/2024 09:44:00	14.2	15.3	1.1	0.01	0.00	0.00	1.1	NNE
2/2/2024 09:45:00	14.4	15.5	1.1	0.01	0.00	0.00	1.1	ENE
2/2/2024 09:46:00	15.2	15.7	0.5	0.01	0.00	0.00	1.0	SW
2/2/2024 09:47:00	15.3	15.7	0.3	0.01	0.00	0.00	1.0	W
2/2/2024 09:48:00	15.4	15.7	0.3	0.01	0.00	-0.01	1.0	SSE
2/2/2024 09:49:00	15.5	15.6	0.2	0.01	0.00	-0.01	1.0	WSW
2/2/2024 09:50:00	15.6	15.5	-0.1	0.01	0.01	0.00	1.1	E
2/2/2024 09:51:00	16.0	15.5	-0.6	0.01	0.01	0.00	1.1	E
2/2/2024 09:52:00	17.0	15.9	-1.1	0.01	0.01	0.00	1.2	E
2/2/2024 09:53:00	17.0	16.1	-0.9	0.01	0.01	0.00	1.2	W
2/2/2024 09:54:00	17.2	16.1	-1.1	0.01	0.01	0.00	1.2	E
2/2/2024 09:55:00	17.4	15.9	-1.4	0.01	0.01	0.00	1.2	ESE
2/2/2024 09:56:00	17.4	15.8	-1.6	0.01	0.01	0.00	1.2	SE
2/2/2024 09:57:00	17.3	15.8	-1.5	0.01	0.01	0.01	1.3	NE

Date/Time	Average Upwind PM10 (µg/m³)	Average Downwind PM10 (µg/m³)	Average Contribution PM10 (µg/m³)	Average Upwind VOC (ppm)	Average Downwind VOC (ppm)	Average Contribution VOC (ppm)	Wind Speed 15 min Avg	Wind Direction
2/2/2024 09:58:00	17.3	15.3	-2.0	0.01	0.01	0.00	1.3	W
2/2/2024 09:59:00	17.3	15.3	-2.1	0.01	0.01	0.00	1.3	SSE
2/2/2024 10:00:00	17.1	15.1	-2.0	0.01	0.01	0.00	1.3	W
2/2/2024 10:01:00	16.5	15.1	-1.4	0.01	0.01	0.00	1.3	SE
2/2/2024 10:02:00	16.4	15.1	-1.3	0.01	0.01	0.00	1.4	SE
2/2/2024 10:03:00	16.4	15.1	-1.2	0.01	0.01	0.00	1.4	SW
2/2/2024 10:04:00	16.4	15.1	-1.3	0.01	0.01	0.00	1.4	E
2/2/2024 10:05:00	16.3	15.2	-1.1	0.01	0.01	0.00	1.5	ENE
2/2/2024 10:06:00	16.1	15.4	-0.7	0.01	0.01	0.00	1.5	ENE
2/2/2024 14:09:00	19.0	16.9	-2.1	0.00	0.00	0.00	2.8	E
2/2/2024 14:10:00	18.0	15.0	-3.0	0.00	0.00	0.00	2.7	ESE
2/2/2024 14:11:00	22.4	13.7	-8.7	0.00	0.01	0.01	3.0	ESE
2/2/2024 14:12:00	19.1	12.2	-6.9	0.00	0.01	0.00	2.7	SSE
2/2/2024 14:13:00	17.3	11.8	-5.5	0.00	0.00	0.00	2.6	SSE
2/2/2024 14:14:00	16.2	11.4	-4.8	0.00	0.01	0.00	2.6	ESE
2/2/2024 14:15:00	14.7	11.0	-3.7	0.00	0.01	0.00	2.7	ESE
2/2/2024 14:16:00	13.6	10.6	-3.0	0.00	0.01	0.00	2.7	E
2/2/2024 14:17:00	12.9	10.0	-2.9	0.00	0.01	0.00	2.7	SSE
2/2/2024 14:18:00	12.2	9.7	-2.5	0.00	0.01	0.00	2.6	SE
2/2/2024 14:19:00	12.0	9.5	-2.6	0.00	0.01	0.00	2.6	SE
2/2/2024 14:20:00	11.7	9.3	-2.4	0.00	0.01	0.00	2.5	E
2/2/2024 14:21:00	11.1	9.1	-2.0	0.00	0.01	0.01	2.5	ESE
2/2/2024 14:22:00	10.7	8.9	-1.8	0.00	0.01	0.01	2.5	E
2/2/2024 14:23:00	10.5	8.7	-1.7	0.00	0.02	0.01	2.5	ESE
2/2/2024 14:24:00	9.7	8.1	-1.6	0.00	0.02	0.01	2.5	SSE
2/2/2024 14:25:00	8.8	7.6	-1.3	0.00	0.02	0.01	2.5	ENE
2/2/2024 14:26:00	7.2	7.1	0.0	0.01	0.01	0.01	2.3	SW
2/2/2024 14:27:00	7.1	7.0	0.0	0.00	0.02	0.01	2.4	SE
2/2/2024 14:28:00	7.0	6.8	-0.3	0.00	0.02	0.01	2.3	SE

Date/Time	Average Upwind PM10 (µg/m³)	Average Downwind PM10 (µg/m³)	Average Contribution PM10 (µg/m³)	Average Upwind VOC (ppm)	Average Downwind VOC (ppm)	Average Contribution VOC (ppm)	Wind Speed 15 min Avg	Wind Direction
2/2/2024 14:29:00	6.8	6.7	0.0	0.00	0.02	0.01	2.3	SSW
2/2/2024 14:30:00	6.8	6.6	-0.2	0.00	0.02	0.01	2.2	ESE
2/2/2024 14:31:00	6.8	6.4	-0.4	0.00	0.02	0.01	2.2	S
2/2/2024 14:32:00	6.7	6.6	-0.1	0.00	0.02	0.01	2.2	SSE
2/2/2024 14:33:00	6.9	6.5	-0.4	0.00	0.02	0.01	2.2	ESE
2/2/2024 14:34:00	6.7	6.4	-0.3	0.00	0.02	0.01	2.5	ESE
2/2/2024 14:35:00	6.4	6.3	-0.1	0.00	0.02	0.01	2.5	SE
2/2/2024 14:36:00	6.4	6.3	-0.1	0.00	0.02	0.01	2.6	SE
2/2/2024 14:37:00	6.3	6.3	0.0	0.00	0.01	0.01	2.6	E
2/2/2024 14:38:00	6.0	6.2	0.2	0.00	0.01	0.00	2.7	E
2/2/2024 14:39:00	5.9	6.1	0.2	0.00	0.01	0.01	2.7	ESE
2/2/2024 14:40:00	6.0	6.2	0.2	0.00	0.01	0.01	2.7	ESE
2/2/2024 14:41:00	6.6	6.2	-0.3	0.00	0.01	0.01	2.8	SE
2/2/2024 14:42:00	6.4	6.2	-0.2	0.00	0.01	0.01	2.8	SSE
2/2/2024 14:43:00	6.1	6.2	0.1	0.00	0.01	0.01	2.8	SSE
2/2/2024 14:44:00	6.0	6.0	0.1	0.00	0.01	0.01	2.9	S
2/2/2024 14:45:00	5.8	5.8	0.0	0.00	0.01	0.01	2.8	SSE
2/2/2024 14:46:00	5.8	5.8	0.0	0.00	0.01	0.01	2.9	ESE
2/2/2024 14:47:00	5.7	5.5	-0.2	0.00	0.01	0.01	2.9	E
2/2/2024 14:48:00	5.3	5.4	0.1	0.00	0.01	0.01	3.0	ESE
2/2/2024 14:49:00	5.2	5.2	0.0	0.00	0.01	0.01	2.7	E
2/2/2024 14:50:00	5.2	5.2	0.0	0.00	0.01	0.01	2.7	SE
2/2/2024 14:51:00	5.1	5.1	0.1	0.00	0.01	0.01	2.7	ESE
2/2/2024 14:52:00	5.1	5.0	-0.1	0.00	0.01	0.01	2.7	SE
2/2/2024 14:53:00	5.0	4.8	-0.2	0.00	0.01	0.01	2.6	E
2/2/2024 14:54:00	4.8	4.7	-0.1	0.00	0.01	0.01	2.8	ESE
2/2/2024 14:55:00	4.5	4.5	-0.1	0.00	0.01	0.01	2.8	ESE
2/2/2024 14:56:00	3.6	4.3	0.7	0.00	0.02	0.01	2.8	SE
2/2/2024 14:57:00	3.4	3.9	0.5	0.00	0.02	0.01	2.8	WNW

Date/Time	Average Upwind PM10 (µg/m³)	Average Downwind PM10 (µg/m³)	Average Contribution PM10 (µg/m³)	Average Upwind VOC (ppm)	Average Downwind VOC (ppm)	Average Contribution VOC (ppm)	Wind Speed 15 min Avg	Wind Direction
2/2/2024 14:58:00	3.1	3.7	0.6	0.00	0.02	0.02	2.9	ESE
2/2/2024 14:59:00	3.0	3.4	0.5	0.00	0.02	0.02	3.0	ESE
2/2/2024 15:00:00	2.8	3.4	0.6	0.00	0.02	0.02	3.0	E
2/2/2024 15:01:00	2.7	3.2	0.6	0.00	0.02	0.02	2.9	SE
2/2/2024 15:02:00	2.5	3.1	0.6	0.00	0.02	0.02	3.0	ESE
2/2/2024 15:03:00	2.5	3.0	0.5	0.00	0.02	0.02	2.9	ESE
2/2/2024 15:04:00	2.4	2.9	0.6	0.00	0.02	0.01	3.0	S
2/2/2024 15:05:00	2.2	2.7	0.6	0.00	0.02	0.01	3.0	SE
2/2/2024 15:06:00	2.1	2.8	0.7	0.00	0.02	0.01	3.0	ESE
2/2/2024 15:07:00	2.1	2.9	0.8	0.00	0.02	0.01	3.0	ESE
2/2/2024 15:08:00	2.1	2.9	0.7	0.00	0.01	0.01	3.1	ESE
2/2/2024 15:09:00	2.3	3.0	0.7	0.00	0.01	0.01	2.9	ESE
2/2/2024 15:10:00	2.4	3.1	0.7	0.00	0.01	0.01	2.9	ESE
2/2/2024 15:11:00	2.6	3.3	0.6	0.00	0.01	0.01	3.0	E
2/2/2024 15:12:00	2.7	3.4	0.7	0.00	0.01	0.01	3.0	ESE
2/2/2024 15:13:00	2.8	3.3	0.5	0.00	0.01	0.01	2.9	S