

DAILY FIELD REPORT 132

Prepared By: LANGAN

WEATHER	Snow		Rain	x	Overcast	x	Partly Cloudy		Sunny	
TEMP.	< 32		32-50	x	50-70		70-85		>85	

BCP Project No:	C231153	Date:	December 1, 2023
------------------------	---------	--------------	------------------

Project Name:	Kasser Scrap Metal and Rector Cleaners Site	Time:	6:45 am to 5:30 pm
----------------------	---------------------------------------------	--------------	--------------------

Consultant: Langan Engineering, Environmental, Surveying, Landscape Architecture and Geology, D.P.C. (Langan)	Langan Field Personnel: Pepper Greenley (Environmental) Deo Persaud (Geotechnical)
Construction Manager: Consigli Construction Co., Inc. (Consigli)	
Foundation Contractor: Urban Foundation/Engineering (Urban)	
Drilling Contractor: Aquifer Drilling Testing (ADT)	

Work Activities Performed:

- Urban excavated an about 25-foot-long by 20-foot-wide area from about 15 feet below grade surface (bgs) to about 20 feet bgs in the northern part of grid WC03_15-20 to assist with caisson installation. Excavated soil/fill was live-loaded into trucks for off-site disposal. Additional soil/fill was graded adjacent to the excavation area.
- Urban graded an about 20-foot-long by 15-foot-wide area in the eastern part of WC04 and an about 20-foot-long by 10-foot-wide area in the western part of WC05 to prepare for equipment mobilization.
- Excavated and graded soil/fill consisted of non-native soil; odors, staining, elevated PID readings, or other evidence of a petroleum or chemical release were not observed.
- Urban backfilled imported 0.75-inch stone in an about 25-foot-long by 20-foot-wide area in the northern part of grid WC03.

Material Tracking:

- The following soil/fill was exported from the site:
 - 6 loads of soil/fill from waste characterization grids WC02_10-15, WC02_15-20, WC03_10-15, and WC03_15-20 were exported for off-site disposal at the Clean Earth of Carteret LLC facility in Carteret, NJ.
- The following materials were imported to the site:
 - 2 loads (about 40 cubic yards) of 0.75-inch stone sourced from the Greenport Quarry in Hudson, NY, locally distributed by North Shore Terminal in Staten Island, NY.

Materials Export Summary								
Facility Name	<i>Bayshore Soil Management, LLC</i>		<i>Clean Earth of Carteret, LLC</i>		<i>PPark NJ</i>		<i>Faztec Solutions</i>	
Location	<i>Keasbey, NJ</i>		<i>Carteret, NJ</i>		<i>Prospect Park, NJ</i>		<i>Staten Island, NY</i>	
Type of Waste	<i>Non-hazardous Soil</i>		<i>Non-hazardous Soil</i>		<i>Non-hazardous Soil</i>		<i>C&D</i>	
Today	Number of Loads	Approx. Volume (CY)	Number of Loads	Approx. Volume (CY)	Number of Loads	Approx. Volume (CY)	Number of Loads	Approximate Volume (CY)
	0	-	6	120	0	-	0	-
Total	Number of Loads	Approx. Volume (CY)	Number of Loads	Approx. Volume (CY)	Number of Loads	Approx. Volume (CY)	Number of Loads	Approximate Volume (CY)
	129	2,540	168	3,360	0	-	15	300

Materials Export Summary		
Facility Name	<i>Dale Transfer Corp.</i>	
Location	<i>West Babylon, NY</i>	
Type of Waste	<i>Concrete</i>	
Today	Number of Loads	Approx. Volume (CY)
	0	-
Total	Number of Loads	Approx. Volume (CY)
	2	40

Materials Import Summary		
Distribution Facility Name	<i>North Shore Terminal</i>	
Location	<i>Staten Island, NY</i>	
Type of Material	<i>0.75-inch Stone</i>	
Today	Number of Loads	Approx. Volume (CY)
	2	40
Total	Number of Loads	Approx. Volume (CY)
	2	40

Samples Collected:

- No samples were collected.

Air Monitoring:

The 15-minute average site contributions for particulates and volatile organic compounds (VOCs) are calculated by subtracting the upwind readings from the downwind readings. A true action level exceedance is realized when this net result exceeds 100 µg/m³ for particulates and 5 ppm for organic vapors. No particulates (PM10) or organic vapors exceeded the 15-minute average site contribution action levels of 100 µg/m³ or 5 ppm, respectively, on this day.

Particulate Monitoring (µg/m ³)		Organic Vapor Monitoring (ppm)	
Daily Background	21.8	Daily Background	0.02
PM10 Average Site Contribution (Minimum)	-66.5	VOC Average Site Contribution (Minimum)	-0.07
PM10 Average Site Contribution (Maximum)	5.8	VOC Average Site Contribution (Maximum)	0.02

µg/m³: micrograms per cubic meter.

ppm: parts per million.

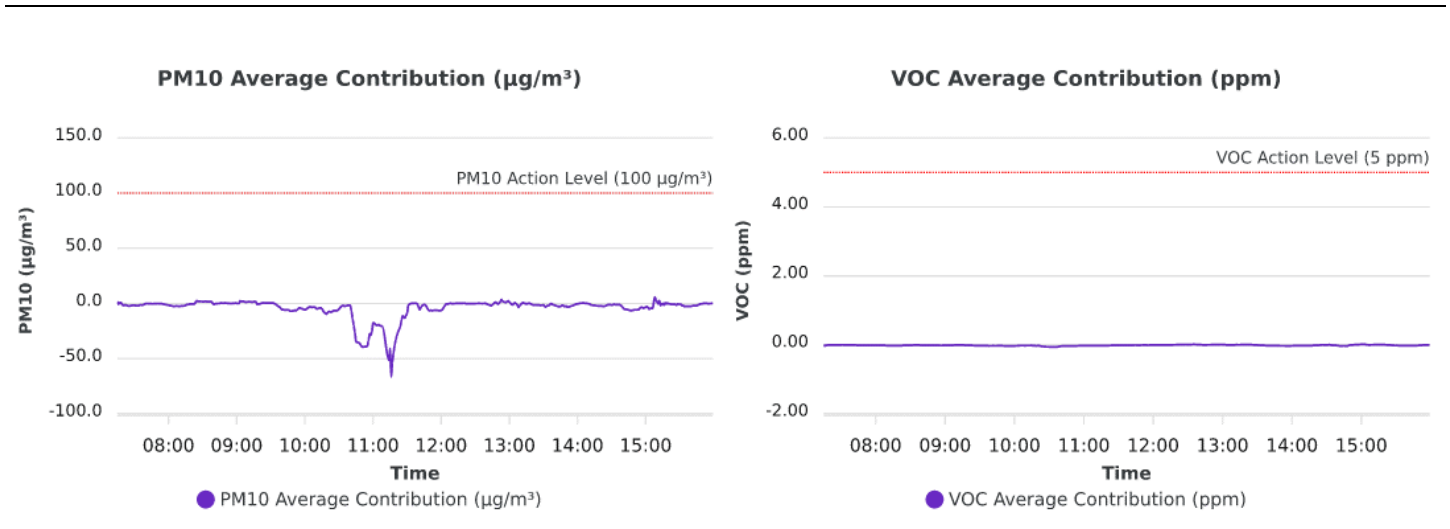

Planned Activities:

- Urban will continue excavation throughout the site to assist in the advancement of caissons and soldier piles.

SITE PLAN

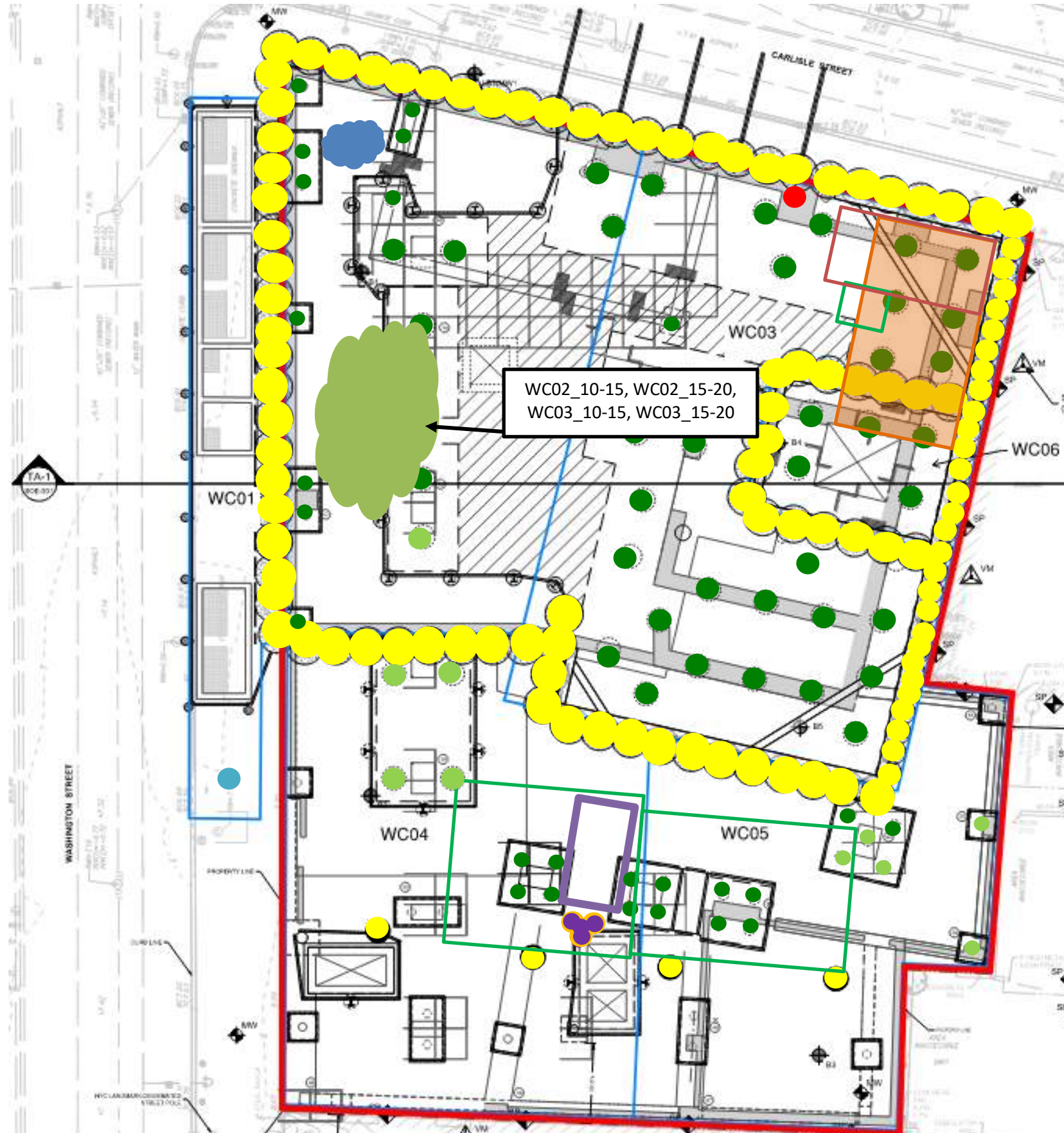

- Site Boundary**
- Waste Characterization Grid Boundary**
- CAMP station 1**
- CAMP station 2**
- Stockpile – Soil (no impacts)**
- Stockpile – Imported 0.75-inch Stone**
- Approximate Location of Excavation**
- Approximate Area of Grading**
- Approximate Backfill Location**
- Completed Soil-Mix Column**
- Completed Caisson Casing**
- Completed Caisson**
- Reinstalled Soil-Mix Column as part of the In-Situ Stabilization of NAPL-contaminated Soil**
- Soil-Mix Core Advanced**
- Approximate Location of the Former UST**

Note: Waste characterization grid areas were developed by PT Consultants and Urban and is shown on this site plan for reference only.

Photo Log

Photo 1: View of Urban loading a truck with soil/fill for off-site disposal (facing southeast).



Photo 2: View of Urban excavating in the northern part of grid WC03 (facing northeast).



Photo 3: View of the site entrance/exit at the corner of Carlisle and Washington Street at the end of the work day (facing south).



LANGAN	Air Monitoring Report	170695201 - 111 Washington St	
		Report Period	
		From:	12/1/2023 06:00
		To:	12/1/2023 19:00
		PM10 Action Level:	100.0 $\mu\text{g}/\text{m}^3$
VOC Action Level:	5.00 ppm		

Daily Environmental Summary	Windspeed (mph)	Prevailing wind direction
12/1/2023	0.2-3.2	WSW

Daily Monitoring Summary	PM10 ($\mu\text{g}/\text{m}^3$)	Time	VOC (ppm)	Time
Min Contribution (15 min avg.) - 12/1/2023	-66.5	11:16	-0.07	10:35
Max Contribution (15 min avg.) - 12/1/2023	5.8	15:08	0.02	15:03

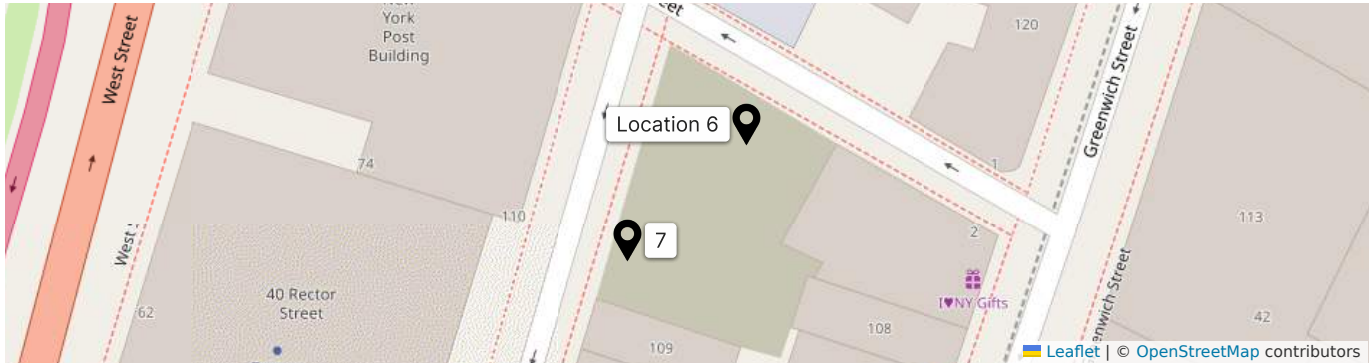

PM10 Average Contribution ($\mu\text{g}/\text{m}^3$)

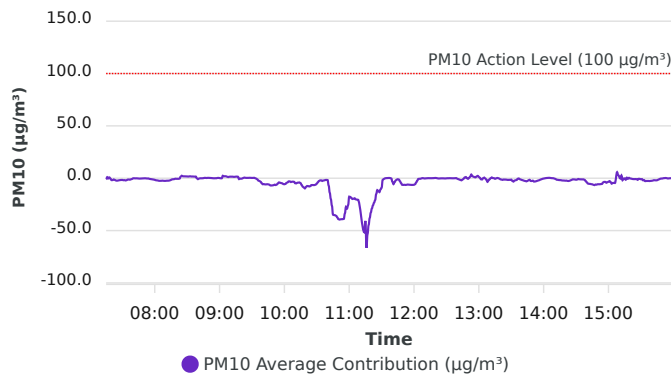

VOC Average Contribution (ppm)

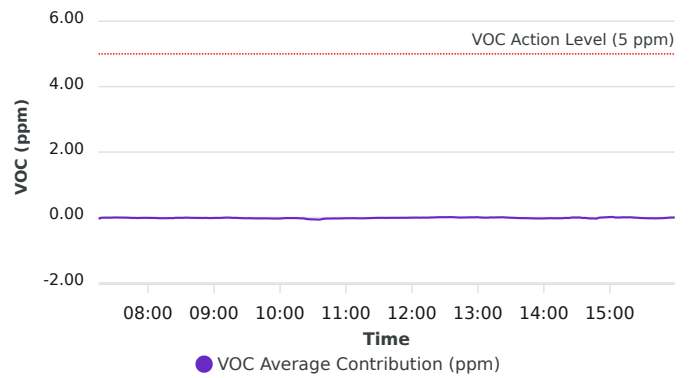

Contribution wind rose (mph)

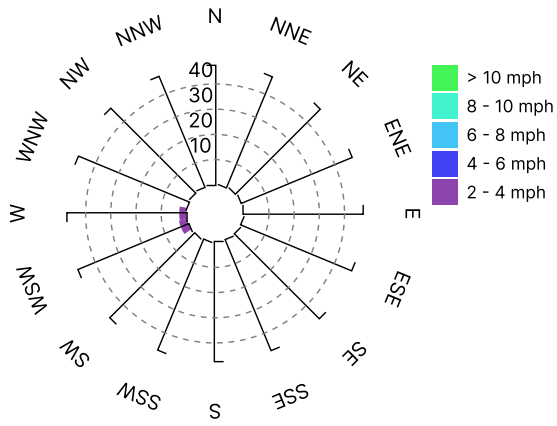

Date/Time	Average Upwind PM10 (µg/m³)	Average Downwind PM10 (µg/m³)	Average Contribution PM10 (µg/m³)	Average Upwind VOC (ppm)	Average Downwind VOC (ppm)	Average Contribution VOC (ppm)	Wind Speed 15 min Avg	Wind Direction
12/1/2023 07:14:00							0.8	WSW
12/1/2023 07:15:00	21.8	20.7	-1.1	0.02	0.00	-0.02	0.7	E
12/1/2023 07:16:00	19.1	20.1	1.0	0.03	0.00	-0.03	0.7	SE
12/1/2023 07:17:00	17.9	17.7	-0.2	0.02	0.01	-0.01	0.6	W
12/1/2023 07:18:00	16.4	17.2	0.8	0.02	0.01	-0.01	0.6	N
12/1/2023 07:19:00	16.4	16.0	-0.4	0.01	0.01	-0.01	0.6	W
12/1/2023 07:20:00	17.0	15.2	-1.8	0.01	0.01	-0.01	0.6	WSW
12/1/2023 07:21:00	16.5	14.8	-1.8	0.02	0.01	-0.01	0.6	WSW
12/1/2023 07:22:00	16.0	14.8	-1.2	0.02	0.01	-0.01	0.6	W
12/1/2023 07:23:00	16.2	14.6	-1.6	0.02	0.01	0.00	0.7	WSW
12/1/2023 07:24:00	16.8	14.6	-2.1	0.02	0.01	-0.01	0.8	WSW
12/1/2023 07:25:00	16.8	14.5	-2.4	0.02	0.01	-0.01	0.9	WSW
12/1/2023 07:26:00	16.6	14.4	-2.2	0.02	0.01	-0.01	0.9	WSW
12/1/2023 07:27:00	16.2	14.3	-1.9	0.02	0.01	-0.01	0.9	WSW
12/1/2023 07:28:00	15.9	14.1	-1.8	0.02	0.01	0.00	0.9	WSW
12/1/2023 07:29:00	15.5	13.9	-1.7	0.02	0.02	0.00	0.9	WSW
12/1/2023 07:30:00	14.8	13.2	-1.6	0.02	0.02	0.00	1.0	W
12/1/2023 07:31:00	14.5	12.6	-1.9	0.02	0.02	0.00	1.0	W
12/1/2023 07:32:00	14.2	12.4	-1.8	0.02	0.02	0.00	1.0	W
12/1/2023 07:33:00	14.2	12.1	-2.1	0.02	0.02	0.00	1.0	WSW
12/1/2023 07:34:00	13.8	12.0	-1.9	0.02	0.02	0.00	1.0	WSW
12/1/2023 07:35:00	13.3	12.0	-1.3	0.02	0.02	0.00	1.1	W
12/1/2023 07:36:00	13.1	11.9	-1.2	0.02	0.02	0.00	1.1	WSW
12/1/2023 07:37:00	12.9	11.5	-1.4	0.02	0.02	0.00	1.2	WSW
12/1/2023 07:38:00	12.4	11.3	-1.0	0.02	0.02	0.00	1.2	W
12/1/2023 07:39:00	11.8	11.1	-0.7	0.02	0.02	0.00	1.1	WSW
12/1/2023 07:40:00	11.4	11.4	-0.1	0.02	0.01	-0.01	1.0	W
12/1/2023 07:41:00	11.3	11.3	-0.1	0.02	0.01	-0.01	1.1	WSW
12/1/2023 07:42:00	11.2	11.1	-0.1	0.02	0.01	-0.01	1.1	WSW
12/1/2023 07:43:00	11.2	11.1	-0.1	0.02	0.01	-0.01	1.0	WSW
12/1/2023 07:44:00	11.1	11.0	-0.1	0.02	0.01	-0.01	1.0	SW
12/1/2023 07:45:00	11.2	10.9	-0.3	0.02	0.01	-0.01	1.0	W

Date/Time	Average Upwind PM10 (µg/m³)	Average Downwind PM10 (µg/m³)	Average Contribution PM10 (µg/m³)	Average Upwind VOC (ppm)	Average Downwind VOC (ppm)	Average Contribution VOC (ppm)	Wind Speed 15 min Avg	Wind Direction
12/1/2023 07:46:00	11.2	10.9	-0.4	0.02	0.01	-0.01	1.0	WSW
12/1/2023 07:47:00	11.1	10.8	-0.3	0.02	0.01	-0.01	1.0	WSW
12/1/2023 07:48:00	10.9	10.7	-0.2	0.02	0.01	-0.01	1.0	WSW
12/1/2023 07:49:00	10.8	10.6	-0.2	0.03	0.01	-0.01	1.0	SW
12/1/2023 07:50:00	10.7	10.6	-0.1	0.03	0.01	-0.02	1.0	WSW
12/1/2023 07:51:00	10.6	10.6	-0.1	0.03	0.01	-0.02	0.9	WSW
12/1/2023 07:52:00	10.7	10.6	-0.1	0.03	0.01	-0.01	0.9	W
12/1/2023 07:53:00	10.8	10.6	-0.3	0.03	0.01	-0.01	0.9	W
12/1/2023 07:54:00	10.8	10.6	-0.2	0.03	0.01	-0.01	1.0	WSW
12/1/2023 07:55:00	10.8	10.2	-0.6	0.03	0.01	-0.01	1.0	W
12/1/2023 07:56:00	10.9	10.1	-0.8	0.03	0.01	-0.01	1.0	W
12/1/2023 07:57:00	11.1	10.1	-0.9	0.03	0.01	-0.01	1.0	WSW
12/1/2023 07:58:00	11.2	10.1	-1.1	0.03	0.01	-0.01	1.0	WSW
12/1/2023 07:59:00	11.5	10.2	-1.3	0.03	0.01	-0.01	1.0	WSW
12/1/2023 08:00:00	11.8	10.2	-1.5	0.03	0.01	-0.01	1.0	WSW
12/1/2023 08:01:00	12.3	10.3	-1.9	0.03	0.01	-0.01	1.1	WSW
12/1/2023 08:02:00	12.5	10.4	-2.0	0.03	0.01	-0.01	1.1	W
12/1/2023 08:03:00	12.7	10.5	-2.2	0.03	0.01	-0.01	1.1	WSW
12/1/2023 08:04:00	13.0	10.5	-2.5	0.03	0.01	-0.01	1.1	W
12/1/2023 08:05:00	13.0	10.6	-2.5	0.03	0.01	-0.01	1.2	WSW
12/1/2023 08:06:00	13.0	10.5	-2.5	0.03	0.01	-0.01	1.2	WSW
12/1/2023 08:07:00	12.9	10.6	-2.3	0.02	0.01	-0.01	1.1	SE
12/1/2023 08:08:00	12.9	10.5	-2.4	0.02	0.01	-0.02	1.1	W
12/1/2023 08:09:00	12.9	10.4	-2.5	0.03	0.01	-0.02	1.0	W
12/1/2023 08:10:00	12.9	10.3	-2.5	0.03	0.01	-0.02	0.9	WSW
12/1/2023 08:11:00	12.7	10.4	-2.4	0.03	0.00	-0.02	0.9	W
12/1/2023 08:12:00	12.7	10.4	-2.4	0.03	0.00	-0.02	0.9	WSW
12/1/2023 08:13:00	12.6	10.3	-2.3	0.03	0.00	-0.02	0.9	W
12/1/2023 08:14:00	12.3	10.2	-2.1	0.03	0.00	-0.02	0.9	WSW
12/1/2023 08:15:00	11.8	10.2	-1.6	0.03	0.00	-0.02	0.9	W
12/1/2023 08:16:00	11.2	10.1	-1.1	0.02	0.00	-0.02	0.9	WSW
12/1/2023 08:17:00	11.1	10.1	-1.0	0.02	0.00	-0.02	0.8	S

Date/Time	Average Upwind PM10 (µg/m³)	Average Downwind PM10 (µg/m³)	Average Contribution PM10 (µg/m³)	Average Upwind VOC (ppm)	Average Downwind VOC (ppm)	Average Contribution VOC (ppm)	Wind Speed 15 min Avg	Wind Direction
12/1/2023 08:18:00	11.0	10.1	-0.9	0.02	0.00	-0.02	0.8	S
12/1/2023 08:19:00	10.8	10.3	-0.5	0.02	0.00	-0.02	0.7	W
12/1/2023 08:20:00	10.8	10.3	-0.6	0.02	0.00	-0.02	0.7	WSW
12/1/2023 08:21:00	10.9	10.3	-0.6	0.02	0.01	-0.02	0.7	WSW
12/1/2023 08:22:00	10.8	10.3	-0.6	0.03	0.00	-0.02	0.7	WNW
12/1/2023 08:23:00	10.7	10.3	-0.4	0.02	0.01	-0.02	0.7	ENE
12/1/2023 08:24:00	10.5	12.1	1.5	0.02	0.01	-0.01	0.7	ESE
12/1/2023 08:25:00	10.5	12.9	2.4	0.02	0.01	-0.01	0.6	E
12/1/2023 08:26:00	11.1	12.9	1.9	0.02	0.01	-0.01	0.6	NW
12/1/2023 08:27:00	11.1	12.9	1.8	0.02	0.01	-0.01	0.6	W
12/1/2023 08:28:00	11.1	12.9	1.8	0.02	0.01	-0.01	0.7	W
12/1/2023 08:29:00	11.2	13.0	1.8	0.02	0.01	-0.01	0.6	S
12/1/2023 08:30:00	11.3	13.0	1.7	0.02	0.01	-0.01	0.7	W
12/1/2023 08:31:00	11.4	13.0	1.6	0.02	0.01	-0.01	0.7	W
12/1/2023 08:32:00	11.4	13.2	1.8	0.02	0.01	-0.01	0.8	WSW
12/1/2023 08:33:00	11.4	13.3	1.8	0.02	0.01	-0.01	0.8	E
12/1/2023 08:34:00	11.5	13.2	1.6	0.02	0.02	-0.01	0.8	ESE
12/1/2023 08:35:00	11.5	13.2	1.7	0.02	0.02	-0.01	0.8	W
12/1/2023 08:36:00	11.6	13.2	1.6	0.02	0.02	-0.01	0.8	W
12/1/2023 08:37:00	11.6	13.2	1.5	0.02	0.02	-0.01	0.8	W
12/1/2023 08:38:00	11.6	13.2	1.6	0.03	0.02	-0.01	0.9	W
12/1/2023 08:39:00	11.6	11.5	-0.1	0.03	0.02	-0.01	0.9	WSW
12/1/2023 08:40:00	11.5	10.6	-0.9	0.03	0.02	-0.01	1.0	WSW
12/1/2023 08:41:00	10.9	10.6	-0.3	0.03	0.02	-0.01	1.0	SSW
12/1/2023 08:42:00	10.7	10.6	-0.1	0.03	0.02	-0.01	1.0	WSW
12/1/2023 08:43:00	10.7	10.6	-0.1	0.03	0.02	-0.01	1.0	WSW
12/1/2023 08:44:00	10.7	10.6	0.0	0.03	0.01	-0.01	1.0	W
12/1/2023 08:45:00	10.6	10.7	0.1	0.03	0.01	-0.01	1.0	W
12/1/2023 08:46:00	10.5	10.8	0.3	0.03	0.01	-0.01	1.0	WSW
12/1/2023 08:47:00	10.6	10.9	0.3	0.03	0.01	-0.01	1.0	WSW
12/1/2023 08:48:00	10.6	10.8	0.2	0.03	0.01	-0.01	1.0	NNW
12/1/2023 08:49:00	10.4	10.8	0.3	0.03	0.01	-0.02	1.1	WSW

Date/Time	Average Upwind PM10 (µg/m³)	Average Downwind PM10 (µg/m³)	Average Contribution PM10 (µg/m³)	Average Upwind VOC (ppm)	Average Downwind VOC (ppm)	Average Contribution VOC (ppm)	Wind Speed 15 min Avg	Wind Direction
12/1/2023 08:50:00	10.5	10.8	0.4	0.03	0.01	-0.01	1.2	WSW
12/1/2023 08:51:00	10.6	10.8	0.3	0.03	0.01	-0.01	1.2	WSW
12/1/2023 08:52:00	10.7	10.9	0.2	0.03	0.01	-0.01	1.3	WSW
12/1/2023 08:53:00	10.9	11.0	0.1	0.03	0.01	-0.01	1.2	W
12/1/2023 08:54:00	11.0	11.0	0.0	0.03	0.01	-0.01	1.3	W
12/1/2023 08:55:00	11.1	11.0	-0.1	0.03	0.01	-0.02	1.3	WSW
12/1/2023 08:56:00	11.0	11.0	0.0	0.03	0.01	-0.02	1.4	W
12/1/2023 08:57:00	11.0	11.0	0.0	0.03	0.01	-0.02	1.4	WSW
12/1/2023 08:58:00	10.9	11.1	0.3	0.03	0.01	-0.02	1.5	WSW
12/1/2023 08:59:00	10.8	11.1	0.3	0.03	0.01	-0.01	1.6	WSW
12/1/2023 09:00:00	11.0	11.1	0.1	0.03	0.01	-0.01	1.6	WSW
12/1/2023 09:01:00	11.1	11.1	-0.1	0.03	0.01	-0.01	1.6	WSW
12/1/2023 09:02:00	11.2	11.1	-0.1	0.03	0.01	-0.01	1.5	ESE
12/1/2023 09:03:00	11.1	13.5	2.4	0.03	0.01	-0.01	1.6	E
12/1/2023 09:04:00	11.8	13.6	1.8	0.03	0.01	-0.01	1.5	W
12/1/2023 09:05:00	11.9	13.8	1.9	0.03	0.01	-0.01	1.4	WSW
12/1/2023 09:06:00	12.1	13.9	1.8	0.03	0.01	-0.01	1.3	ENE
12/1/2023 09:07:00	12.5	14.0	1.4	0.02	0.01	-0.01	1.3	ESE
12/1/2023 09:08:00	12.9	14.0	1.1	0.02	0.01	-0.01	1.2	ENE
12/1/2023 09:09:00	12.9	14.3	1.4	0.02	0.01	-0.01	1.1	WSW
12/1/2023 09:10:00	12.9	14.4	1.5	0.02	0.02	-0.01	1.1	WSW
12/1/2023 09:11:00	13.0	14.5	1.5	0.02	0.02	0.00	1.0	E
12/1/2023 09:12:00	13.0	14.5	1.5	0.02	0.02	0.00	0.9	WSW
12/1/2023 09:13:00	13.1	14.4	1.3	0.02	0.02	0.00	0.8	W
12/1/2023 09:14:00	13.2	14.5	1.3	0.02	0.02	-0.01	0.7	WSW
12/1/2023 09:15:00	13.1	14.6	1.5	0.02	0.02	-0.01	0.7	WSW
12/1/2023 09:16:00	13.0	14.6	1.6	0.03	0.02	-0.01	0.7	W
12/1/2023 09:17:00	13.0	14.4	1.4	0.03	0.02	-0.01	0.7	WSW
12/1/2023 09:18:00	13.0	12.1	-0.8	0.03	0.01	-0.01	0.7	WSW
12/1/2023 09:19:00	12.4	12.0	-0.4	0.03	0.02	-0.01	0.8	WNW
12/1/2023 09:20:00	12.2	11.8	-0.5	0.03	0.02	-0.01	0.8	ESE
12/1/2023 09:21:00	11.9	11.7	-0.2	0.03	0.02	-0.01	0.8	WSW

Date/Time	Average Upwind PM10 (µg/m³)	Average Downwind PM10 (µg/m³)	Average Contribution PM10 (µg/m³)	Average Upwind VOC (ppm)	Average Downwind VOC (ppm)	Average Contribution VOC (ppm)	Wind Speed 15 min Avg	Wind Direction
12/1/2023 09:22:00	11.3	11.7	0.3	0.03	0.01	-0.02	0.8	WSW
12/1/2023 09:23:00	11.0	11.6	0.6	0.03	0.01	-0.02	0.8	E
12/1/2023 09:24:00	11.0	11.4	0.4	0.03	0.01	-0.02	0.8	WSW
12/1/2023 09:25:00	11.0	11.3	0.3	0.03	0.01	-0.02	0.8	WSW
12/1/2023 09:26:00	10.9	11.3	0.3	0.03	0.01	-0.02	0.9	W
12/1/2023 09:27:00	10.9	11.3	0.4	0.03	0.01	-0.02	0.9	W
12/1/2023 09:28:00	10.9	11.4	0.4	0.03	0.01	-0.02	1.0	WSW
12/1/2023 09:29:00	11.0	11.3	0.4	0.03	0.01	-0.02	1.0	W
12/1/2023 09:30:00	11.0	11.3	0.3	0.03	0.01	-0.02	1.1	WSW
12/1/2023 09:31:00	11.0	11.3	0.3	0.03	0.01	-0.02	1.1	WNW
12/1/2023 09:32:00	11.0	11.4	0.4	0.03	0.01	-0.02	1.0	W
12/1/2023 09:33:00	11.5	11.5	0.0	0.03	0.01	-0.02	0.9	WSW
12/1/2023 09:34:00	12.1	11.7	-0.4	0.04	0.01	-0.02	0.9	WSW
12/1/2023 09:35:00	13.2	12.0	-1.2	0.04	0.01	-0.03	0.9	WSW
12/1/2023 09:36:00	14.6	12.3	-2.3	0.04	0.01	-0.03	1.0	WSW
12/1/2023 09:37:00	15.2	12.5	-2.7	0.04	0.01	-0.03	1.0	WSW
12/1/2023 09:38:00	16.2	12.8	-3.4	0.04	0.01	-0.03	1.0	SW
12/1/2023 09:39:00	17.8	13.0	-4.8	0.04	0.01	-0.03	1.1	W
12/1/2023 09:40:00	19.4	13.6	-5.8	0.04	0.01	-0.03	1.1	W
12/1/2023 09:41:00	20.0	14.3	-5.6	0.04	0.01	-0.03	1.1	WSW
12/1/2023 09:42:00	20.8	14.9	-5.9	0.04	0.01	-0.03	1.1	WSW
12/1/2023 09:43:00	21.2	15.3	-5.9	0.04	0.01	-0.03	1.1	WSW
12/1/2023 09:44:00	21.2	15.5	-5.7	0.04	0.01	-0.03	1.1	WSW
12/1/2023 09:45:00	21.7	15.9	-5.8	0.04	0.01	-0.03	1.1	W
12/1/2023 09:46:00	22.2	16.1	-6.1	0.04	0.01	-0.03	1.2	W
12/1/2023 09:47:00	23.0	16.1	-6.9	0.04	0.01	-0.03	1.3	WSW
12/1/2023 09:48:00	23.1	16.1	-6.9	0.04	0.01	-0.03	1.3	WSW
12/1/2023 09:49:00	22.9	16.1	-6.8	0.04	0.01	-0.03	1.4	WSW
12/1/2023 09:50:00	22.5	15.9	-6.6	0.04	0.01	-0.03	1.4	WSW
12/1/2023 09:51:00	21.8	15.6	-6.2	0.04	0.01	-0.03	1.5	WSW
12/1/2023 09:52:00	22.0	15.4	-6.5	0.04	0.01	-0.03	1.5	WSW
12/1/2023 09:53:00	21.3	15.3	-6.0	0.04	0.01	-0.03	1.6	WSW

Date/Time	Average Upwind PM10 (µg/m³)	Average Downwind PM10 (µg/m³)	Average Contribution PM10 (µg/m³)	Average Upwind VOC (ppm)	Average Downwind VOC (ppm)	Average Contribution VOC (ppm)	Wind Speed 15 min Avg	Wind Direction
12/1/2023 09:54:00	20.1	15.2	-5.0	0.04	0.01	-0.03	1.5	W
12/1/2023 09:55:00	18.6	14.7	-4.0	0.04	0.01	-0.03	1.5	WSW
12/1/2023 09:56:00	18.3	14.0	-4.3	0.04	0.01	-0.03	1.5	WSW
12/1/2023 09:57:00	18.1	13.5	-4.6	0.04	0.01	-0.03	1.5	W
12/1/2023 09:58:00	18.1	13.3	-4.8	0.04	0.01	-0.03	1.4	W
12/1/2023 09:59:00	18.7	13.1	-5.6	0.04	0.01	-0.03	1.4	WSW
12/1/2023 10:00:00	18.6	12.8	-5.8	0.04	0.01	-0.03	1.4	WNW
12/1/2023 10:01:00	18.2	12.7	-5.4	0.04	0.01	-0.03	1.4	ENE
12/1/2023 10:02:00	17.6	13.2	-4.5	0.04	0.01	-0.03	1.3	W
12/1/2023 10:03:00	17.6	13.7	-3.9	0.03	0.01	-0.02	1.2	NNW
12/1/2023 10:04:00	18.0	15.0	-3.0	0.03	0.01	-0.02	1.2	NNW
12/1/2023 10:05:00	18.2	15.2	-3.0	0.03	0.01	-0.02	1.1	SW
12/1/2023 10:06:00	19.0	15.3	-3.7	0.03	0.01	-0.02	1.0	W
12/1/2023 10:07:00	18.7	15.3	-3.4	0.03	0.01	-0.02	1.0	W
12/1/2023 10:08:00	18.5	15.2	-3.3	0.03	0.01	-0.02	0.9	WSW
12/1/2023 10:09:00	18.5	15.1	-3.5	0.03	0.01	-0.02	0.9	SW
12/1/2023 10:10:00	19.7	14.9	-4.8	0.03	0.01	-0.02	1.0	WSW
12/1/2023 10:11:00	19.7	14.8	-4.9	0.03	0.01	-0.02	1.0	WSW
12/1/2023 10:12:00	19.1	14.8	-4.3	0.03	0.01	-0.02	1.1	W
12/1/2023 10:13:00	18.8	14.6	-4.2	0.03	0.01	-0.02	1.1	W
12/1/2023 10:14:00	18.6	14.5	-4.1	0.03	0.01	-0.02	1.2	WSW
12/1/2023 10:15:00	19.2	14.5	-4.7	0.03	0.01	-0.02	1.1	WSW
12/1/2023 10:16:00	21.0	14.5	-6.5	0.03	0.01	-0.02	1.1	WNW
12/1/2023 10:17:00	22.1	14.1	-8.0	0.03	0.01	-0.02	1.1	W
12/1/2023 10:18:00	22.6	13.7	-8.9	0.03	0.01	-0.03	1.2	SW
12/1/2023 10:19:00	22.2	12.5	-9.7	0.04	0.01	-0.03	1.2	WSW
12/1/2023 10:20:00	21.5	13.2	-8.3	0.03	0.01	-0.03	1.2	NE
12/1/2023 10:21:00	20.6	13.2	-7.4	0.04	0.01	-0.03	1.2	WSW
12/1/2023 10:22:00	20.8	13.3	-7.5	0.04	0.01	-0.03	1.2	W
12/1/2023 10:23:00	21.3	13.4	-7.9	0.05	0.01	-0.04	1.2	W
12/1/2023 10:24:00	21.2	13.6	-7.6	0.06	0.01	-0.04	1.2	SW
12/1/2023 10:25:00	20.3	13.8	-6.5	0.06	0.01	-0.05	1.1	WSW

Date/Time	Average Upwind PM10 (µg/m³)	Average Downwind PM10 (µg/m³)	Average Contribution PM10 (µg/m³)	Average Upwind VOC (ppm)	Average Downwind VOC (ppm)	Average Contribution VOC (ppm)	Wind Speed 15 min Avg	Wind Direction
12/1/2023 10:26:00	20.4	13.9	-6.5	0.07	0.01	-0.05	1.1	W
12/1/2023 10:27:00	20.5	14.0	-6.6	0.07	0.01	-0.06	1.0	W
12/1/2023 10:28:00	20.6	14.1	-6.5	0.07	0.01	-0.06	0.9	W
12/1/2023 10:29:00	20.2	14.1	-6.1	0.07	0.01	-0.06	0.9	W
12/1/2023 10:30:00	19.4	14.2	-5.2	0.07	0.01	-0.06	0.9	W
12/1/2023 10:31:00	18.1	14.2	-3.8	0.07	0.01	-0.06	0.9	WNW
12/1/2023 10:32:00	17.2	14.5	-2.7	0.07	0.01	-0.06	0.9	W
12/1/2023 10:33:00	16.6	14.6	-2.1	0.07	0.01	-0.06	0.9	WSW
12/1/2023 10:34:00	16.7	14.7	-2.0	0.07	0.01	-0.06	0.8	W
12/1/2023 10:35:00	16.9	14.3	-2.6	0.07	0.01	-0.07	0.8	WSW
12/1/2023 10:36:00	16.7	14.5	-2.2	0.07	0.01	-0.06	0.7	WSW
12/1/2023 10:37:00	16.6	14.6	-2.0	0.07	0.01	-0.06	0.8	WSW
12/1/2023 10:38:00	16.5	14.8	-1.7	0.06	0.01	-0.05	0.9	W
12/1/2023 10:39:00	16.6	15.0	-1.6	0.05	0.01	-0.04	0.9	WSW
12/1/2023 10:40:00	16.8	15.1	-1.7	0.04	0.01	-0.04	1.0	W
12/1/2023 10:41:00	22.4	15.4	-7.0	0.04	0.01	-0.04	1.0	W
12/1/2023 10:42:00	30.2	16.3	-13.9	0.04	0.01	-0.03	1.0	WSW
12/1/2023 10:43:00	37.1	17.2	-19.9	0.04	0.01	-0.03	0.9	SW
12/1/2023 10:44:00	43.9	17.6	-26.3	0.04	0.00	-0.03	0.9	WNW
12/1/2023 10:45:00	52.9	18.0	-34.8	0.04	0.00	-0.03	0.9	WSW
12/1/2023 10:46:00	53.5	18.3	-35.2	0.04	0.01	-0.03	1.0	WSW
12/1/2023 10:47:00	53.8	18.4	-35.4	0.04	0.01	-0.03	1.1	W
12/1/2023 10:48:00	54.8	18.8	-36.0	0.04	0.01	-0.03	1.2	W
12/1/2023 10:49:00	56.3	18.8	-37.5	0.04	0.01	-0.03	1.3	WSW
12/1/2023 10:50:00	57.7	18.6	-39.1	0.04	0.01	-0.03	1.4	WSW
12/1/2023 10:51:00	58.0	18.5	-39.5	0.04	0.01	-0.03	1.4	W
12/1/2023 10:52:00	57.7	18.4	-39.3	0.04	0.01	-0.03	1.4	WSW
12/1/2023 10:53:00	57.4	18.2	-39.1	0.04	0.01	-0.03	1.4	WSW
12/1/2023 10:54:00	57.1	18.0	-39.1	0.03	0.01	-0.03	1.5	W
12/1/2023 10:55:00	56.7	17.9	-38.9	0.03	0.00	-0.03	1.5	WSW
12/1/2023 10:56:00	51.3	17.6	-33.7	0.03	0.00	-0.03	1.4	WSW
12/1/2023 10:57:00	44.1	16.8	-27.3	0.03	0.00	-0.03	1.4	WSW

Date/Time	Average Upwind PM10 (µg/m³)	Average Downwind PM10 (µg/m³)	Average Contribution PM10 (µg/m³)	Average Upwind VOC (ppm)	Average Downwind VOC (ppm)	Average Contribution VOC (ppm)	Wind Speed 15 min Avg	Wind Direction
12/1/2023 10:58:00	44.8	15.9	-28.9	0.03	0.00	-0.03	1.6	W
12/1/2023 10:59:00	41.1	15.4	-25.7	0.03	0.00	-0.03	1.7	WSW
12/1/2023 11:00:00	32.6	15.0	-17.6	0.03	0.00	-0.02	1.7	WSW
12/1/2023 11:01:00	32.6	14.8	-17.9	0.02	0.00	-0.02	1.7	WSW
12/1/2023 11:02:00	33.2	14.3	-18.9	0.02	0.00	-0.02	1.7	WSW
12/1/2023 11:03:00	33.6	13.8	-19.8	0.02	0.00	-0.02	1.7	W
12/1/2023 11:04:00	33.2	13.6	-19.6	0.02	0.00	-0.02	1.7	W
12/1/2023 11:05:00	32.6	13.4	-19.2	0.02	0.00	-0.02	1.8	W
12/1/2023 11:06:00	33.4	13.3	-20.1	0.02	0.00	-0.02	1.8	W
12/1/2023 11:07:00	33.6	13.2	-20.4	0.02	0.00	-0.02	1.8	W
12/1/2023 11:08:00	33.5	13.0	-20.5	0.02	0.00	-0.02	1.8	W
12/1/2023 11:09:00				0.02	0.00	-0.02	1.8	WSW
12/1/2023 11:10:00				0.02	0.00	-0.02	1.9	WSW
12/1/2023 11:11:00				0.03	0.00	-0.03	1.9	W
12/1/2023 11:12:00				0.03	0.00	-0.03	2.1	WSW
12/1/2023 11:13:00				0.03	0.00	-0.03	2.0	WSW
12/1/2023 11:14:00	63.3	11.7	-51.6	0.03	0.00	-0.03	2.0	WSW
12/1/2023 11:15:00	51.9	11.1	-40.8	0.03	0.00	-0.03	2.0	W
12/1/2023 11:16:00	78.1	11.6	-66.5	0.03	0.00	-0.03	2.0	W
12/1/2023 11:17:00	66.4	13.1	-53.3	0.02	0.00	-0.02	2.1	WSW
12/1/2023 11:18:00	58.2	13.5	-44.6	0.02	0.00	-0.02	2.0	W
12/1/2023 11:19:00	51.3	13.3	-38.0	0.02	0.00	-0.02	2.0	WSW
12/1/2023 11:20:00	45.6	12.8	-32.8	0.02	0.00	-0.02	2.0	W
12/1/2023 11:21:00	41.3	12.3	-28.9	0.02	0.00	-0.02	2.0	WSW
12/1/2023 11:22:00	38.0	12.1	-25.9	0.02	0.00	-0.02	2.0	WSW
12/1/2023 11:23:00	35.3	11.9	-23.4	0.02	0.00	-0.02	1.9	WSW
12/1/2023 11:24:00	33.4	12.4	-21.0	0.02	0.00	-0.02	1.9	WSW
12/1/2023 11:25:00	31.9	16.8	-15.1	0.01	0.00	-0.01	1.9	WSW
12/1/2023 11:26:00	32.5	21.1	-11.3	0.01	0.00	-0.01	1.9	WSW
12/1/2023 11:27:00	33.6	21.1	-12.5	0.01	0.00	-0.01	1.8	W
12/1/2023 11:28:00	34.0	20.7	-13.2	0.01	0.00	-0.01	1.9	W
12/1/2023 11:29:00	31.5	20.8	-10.7	0.01	0.00	-0.01	2.0	WSW

Date/Time	Average Upwind PM10 (µg/m³)	Average Downwind PM10 (µg/m³)	Average Contribution PM10 (µg/m³)	Average Upwind VOC (ppm)	Average Downwind VOC (ppm)	Average Contribution VOC (ppm)	Wind Speed 15 min Avg	Wind Direction
12/1/2023 11:30:00	30.0	20.9	-9.1	0.01	0.00	-0.01	2.0	WSW
12/1/2023 11:31:00	22.3	20.7	-1.5	0.01	0.00	-0.01	1.9	W
12/1/2023 11:32:00	20.9	20.2	-0.8	0.01	0.00	-0.01	2.0	WSW
12/1/2023 11:33:00	19.9	19.8	-0.2	0.01	0.00	-0.01	1.9	W
12/1/2023 11:34:00	19.5	19.6	0.1	0.01	0.00	-0.01	1.9	W
12/1/2023 11:35:00	19.4	19.5	0.1	0.01	0.00	-0.01	1.8	W
12/1/2023 11:36:00	19.3	19.5	0.2	0.01	0.00	-0.01	1.8	WSW
12/1/2023 11:37:00	19.2	19.4	0.3	0.01	0.00	-0.01	1.8	WSW
12/1/2023 11:38:00	19.2	19.3	0.1	0.01	0.00	-0.01	1.7	WSW
12/1/2023 11:39:00	19.0	18.8	-0.3	0.01	0.00	-0.01	1.7	WSW
12/1/2023 11:40:00	18.6	15.3	-3.4	0.01	0.00	-0.01	1.7	N
12/1/2023 11:41:00	16.6	11.0	-5.6	0.01	0.00	-0.01	1.6	WSW
12/1/2023 11:42:00	13.9	10.1	-3.8	0.01	0.00	-0.01	1.6	WSW
12/1/2023 11:43:00	12.0	9.8	-2.2	0.01	0.00	-0.01	1.5	WSW
12/1/2023 11:44:00	10.8	9.5	-1.4	0.01	0.00	-0.01	1.4	WSW
12/1/2023 11:45:00	10.3	9.3	-1.0	0.01	0.00	-0.01	1.4	W
12/1/2023 11:46:00	10.5	9.3	-1.3	0.01	0.00	-0.01	1.3	WSW
12/1/2023 11:47:00	12.2	9.3	-2.9	0.01	0.00	-0.01	1.1	WNW
12/1/2023 11:48:00	14.1	9.4	-4.7	0.01	0.00	-0.01	1.1	W
12/1/2023 11:49:00	15.8	9.6	-6.3	0.01	0.00	-0.01	1.0	WSW
12/1/2023 11:50:00	16.2	9.8	-6.4	0.01	0.00	-0.01	1.0	W
12/1/2023 11:51:00	16.4	10.1	-6.3	0.01	0.00	-0.01	0.9	E
12/1/2023 11:52:00	16.6	10.2	-6.4	0.01	0.00	-0.01	0.8	WSW
12/1/2023 11:53:00	16.6	10.3	-6.3	0.01	0.00	-0.01	0.8	W
12/1/2023 11:54:00	16.5	10.4	-6.0	0.01	0.00	-0.01	0.8	WSW
12/1/2023 11:55:00	16.5	10.4	-6.1	0.01	0.00	-0.01	0.8	SW
12/1/2023 11:56:00	16.6	10.4	-6.2	0.01	0.00	-0.01	0.7	ENE
12/1/2023 11:57:00	16.7	10.4	-6.3	0.01	0.00	-0.01	0.6	E
12/1/2023 11:58:00	16.8	10.4	-6.4	0.01	0.00	-0.01	0.6	E
12/1/2023 11:59:00	16.8	10.5	-6.4	0.01	0.00	-0.01	0.5	ESE
12/1/2023 12:00:00	16.7	10.5	-6.3	0.01	0.00	-0.01	0.5	WSW
12/1/2023 12:01:00	16.2	10.5	-5.7	0.01	0.00	-0.01	0.5	W

Date/Time	Average Upwind PM10 (µg/m³)	Average Downwind PM10 (µg/m³)	Average Contribution PM10 (µg/m³)	Average Upwind VOC (ppm)	Average Downwind VOC (ppm)	Average Contribution VOC (ppm)	Wind Speed 15 min Avg	Wind Direction
12/1/2023 12:02:00	14.5	10.4	-4.0	0.01	0.00	0.00	0.4	WNW
12/1/2023 12:03:00	12.7	10.4	-2.3	0.01	0.00	0.00	0.4	W
12/1/2023 12:04:00	10.9	10.3	-0.7	0.01	0.00	0.00	0.4	WSW
12/1/2023 12:05:00	10.7	10.1	-0.5	0.01	0.00	0.00	0.4	W
12/1/2023 12:06:00	10.5	10.0	-0.5	0.01	0.00	-0.01	0.4	WSW
12/1/2023 12:07:00	10.3	10.3	-0.1	0.01	0.00	-0.01	0.4	W
12/1/2023 12:08:00	10.3	10.4	0.1	0.01	0.00	-0.01	0.4	W
12/1/2023 12:09:00	10.5	10.4	-0.1	0.01	0.00	0.00	0.4	NE
12/1/2023 12:10:00	10.6	10.3	-0.3	0.01	0.00	0.00	0.4	ENE
12/1/2023 12:11:00	10.5	10.4	-0.1	0.01	0.00	0.00	0.4	SW
12/1/2023 12:12:00	10.4	10.4	0.0	0.01	0.00	0.00	0.4	E
12/1/2023 12:13:00	10.4	10.5	0.1	0.01	0.00	-0.01	0.4	W
12/1/2023 12:14:00	10.6	10.6	0.0	0.01	0.00	-0.01	0.4	E
12/1/2023 12:15:00	10.6	10.7	0.0	0.01	0.00	0.00	0.4	E
12/1/2023 12:16:00	10.7	10.7	0.0	0.01	0.01	0.00	0.4	ESE
12/1/2023 12:17:00	10.6	10.6	0.1	0.01	0.01	0.00	0.5	E
12/1/2023 12:18:00	10.6	10.6	0.1	0.01	0.01	0.00	0.5	ESE
12/1/2023 12:19:00	10.5	10.7	0.2	0.01	0.01	0.00	0.5	W
12/1/2023 12:20:00	10.5	10.7	0.3	0.01	0.01	0.00	0.5	W
12/1/2023 12:21:00	10.5	10.6	0.1	0.00	0.01	0.00	0.5	ESE
12/1/2023 12:22:00	10.5	10.3	-0.1	0.00	0.01	0.01	0.5	E
12/1/2023 12:23:00	10.4	10.2	-0.3	0.00	0.01	0.01	0.5	E
12/1/2023 12:24:00	10.3	10.2	-0.2	0.00	0.01	0.01	0.5	E
12/1/2023 12:25:00	10.3	10.2	-0.1	0.00	0.01	0.01	0.5	NNW
12/1/2023 12:26:00	10.3	10.3	-0.1	0.00	0.01	0.01	0.5	E
12/1/2023 12:27:00	10.4	10.3	-0.1	0.00	0.01	0.01	0.5	W
12/1/2023 12:28:00	10.4	10.3	-0.2	0.00	0.01	0.01	0.5	E
12/1/2023 12:29:00	10.5	10.3	-0.2	0.00	0.01	0.01	0.5	W
12/1/2023 12:30:00	10.7	10.6	-0.1	0.00	0.01	0.01	0.5	E
12/1/2023 12:31:00	10.8	10.8	0.0	0.00	0.01	0.01	0.5	E
12/1/2023 12:32:00	10.9	10.9	0.0	0.00	0.01	0.01	0.5	NNW
12/1/2023 12:33:00	10.9	11.0	0.0	0.00	0.01	0.01	0.5	E

Date/Time	Average Upwind PM10 (µg/m³)	Average Downwind PM10 (µg/m³)	Average Contribution PM10 (µg/m³)	Average Upwind VOC (ppm)	Average Downwind VOC (ppm)	Average Contribution VOC (ppm)	Wind Speed 15 min Avg	Wind Direction
12/1/2023 12:34:00	11.0	11.0	0.0	0.00	0.01	0.01	0.4	NNW
12/1/2023 12:35:00	11.1	11.0	0.0	0.00	0.01	0.01	0.5	E
12/1/2023 12:36:00	11.1	11.1	-0.1	0.00	0.01	0.01	0.5	WSW
12/1/2023 12:37:00	11.2	11.2	0.0	0.01	0.01	0.01	0.5	WSW
12/1/2023 12:38:00	11.3	11.3	0.0	0.01	0.01	0.01	0.5	W
12/1/2023 12:39:00	11.7	11.8	0.1	0.01	0.01	0.01	0.5	ESE
12/1/2023 12:40:00	12.3	11.9	-0.4	0.01	0.01	0.00	0.5	W
12/1/2023 12:41:00	12.8	11.9	-0.9	0.01	0.01	0.00	0.5	W
12/1/2023 12:42:00	13.4	12.1	-1.3	0.01	0.01	0.00	0.5	W
12/1/2023 12:43:00	14.3	12.6	-1.7	0.01	0.01	0.00	0.6	WSW
12/1/2023 12:44:00	14.9	12.9	-2.0	0.01	0.01	0.00	0.6	WSW
12/1/2023 12:45:00	15.0	13.8	-1.3	0.01	0.01	0.00	0.6	E
12/1/2023 12:46:00	15.2	14.8	-0.4	0.01	0.01	0.00	0.6	N
12/1/2023 12:47:00	15.3	16.1	0.8	0.01	0.01	0.00	0.6	E
12/1/2023 12:48:00	15.4	16.5	1.1	0.01	0.01	0.00	0.6	E
12/1/2023 12:49:00	16.7	16.7	0.0	0.02	0.02	0.00	0.5	WNW
12/1/2023 12:50:00	17.3	16.8	-0.6	0.02	0.02	0.00	0.5	W
12/1/2023 12:51:00	17.3	17.6	0.4	0.02	0.02	0.00	0.5	ENE
12/1/2023 12:52:00	17.3	18.8	1.5	0.02	0.03	0.01	0.5	ESE
12/1/2023 12:53:00	17.3	20.8	3.5	0.02	0.03	0.01	0.5	ENE
12/1/2023 12:54:00	18.6	20.6	2.0	0.02	0.03	0.01	0.5	WSW
12/1/2023 12:55:00	19.1	20.6	1.5	0.02	0.03	0.01	0.5	W
12/1/2023 12:56:00	19.9	20.9	1.0	0.02	0.03	0.01	0.6	WSW
12/1/2023 12:57:00	20.1	21.0	0.9	0.03	0.03	0.00	0.6	WSW
12/1/2023 12:58:00	19.5	21.3	1.8	0.02	0.03	0.01	0.5	NE
12/1/2023 12:59:00	18.9	21.2	2.3	0.02	0.03	0.01	0.6	E
12/1/2023 13:00:00	18.9	20.2	1.3	0.02	0.03	0.01	0.6	SW
12/1/2023 13:01:00	18.9	19.2	0.4	0.02	0.03	0.00	0.6	S
12/1/2023 13:02:00	19.0	18.0	-1.0	0.02	0.03	0.00	0.6	E
12/1/2023 13:03:00	19.0	17.8	-1.2	0.02	0.02	0.00	0.6	SW
12/1/2023 13:04:00	17.8	17.9	0.1	0.02	0.02	0.00	0.7	ESE
12/1/2023 13:05:00	17.3	17.9	0.6	0.02	0.01	-0.01	0.7	SSE

Date/Time	Average Upwind PM10 (µg/m³)	Average Downwind PM10 (µg/m³)	Average Contribution PM10 (µg/m³)	Average Upwind VOC (ppm)	Average Downwind VOC (ppm)	Average Contribution VOC (ppm)	Wind Speed 15 min Avg	Wind Direction
12/1/2023 13:06:00	17.4	17.1	-0.3	0.02	0.01	0.00	0.7	E
12/1/2023 13:07:00	17.5	16.0	-1.5	0.02	0.01	-0.01	0.7	SSW
12/1/2023 13:08:00	17.5	14.0	-3.5	0.02	0.01	-0.01	0.8	E
12/1/2023 13:09:00	16.0	14.0	-2.0	0.01	0.01	0.00	0.7	E
12/1/2023 13:10:00	14.9	13.9	-0.9	0.01	0.01	0.00	0.7	W
12/1/2023 13:11:00	13.9	13.9	0.1	0.01	0.01	0.00	0.7	SE
12/1/2023 13:12:00	13.1	13.9	0.7	0.01	0.01	0.00	0.8	E
12/1/2023 13:13:00	13.1	13.2	0.1	0.01	0.01	0.00	0.8	SW
12/1/2023 13:14:00	13.0	13.0	0.0	0.01	0.01	0.00	0.8	ESE
12/1/2023 13:15:00	13.6	13.0	-0.6	0.01	0.01	0.00	0.8	SW
12/1/2023 13:16:00	13.5	13.3	-0.2	0.01	0.01	0.00	0.7	ESE
12/1/2023 13:17:00	13.2	13.4	0.3	0.01	0.01	0.00	0.7	E
12/1/2023 13:18:00	13.2	13.2	0.1	0.01	0.01	0.00	0.7	NW
12/1/2023 13:19:00	13.3	12.9	-0.4	0.01	0.01	0.00	0.7	E
12/1/2023 13:20:00	13.9	12.8	-1.1	0.01	0.01	0.01	0.7	ESE
12/1/2023 13:21:00	14.1	12.8	-1.3	0.01	0.01	0.01	0.6	NNE
12/1/2023 13:22:00	14.3	12.7	-1.6	0.01	0.01	0.01	0.6	E
12/1/2023 13:23:00	14.3	13.0	-1.2	0.01	0.01	0.01	0.6	WSW
12/1/2023 13:24:00	14.3	13.0	-1.3	0.01	0.01	0.00	0.6	WSW
12/1/2023 13:25:00	14.3	13.0	-1.3	0.01	0.01	0.00	0.5	W
12/1/2023 13:26:00	14.3	12.9	-1.5	0.01	0.01	0.00	0.5	NW
12/1/2023 13:27:00	14.4	12.8	-1.6	0.01	0.01	0.00	0.5	WSW
12/1/2023 13:28:00	14.4	12.9	-1.5	0.01	0.01	0.00	0.5	W
12/1/2023 13:29:00	14.6	13.0	-1.6	0.01	0.01	-0.01	0.4	WNW
12/1/2023 13:30:00	14.4	13.1	-1.3	0.01	0.01	-0.01	0.4	W
12/1/2023 13:31:00	15.3	12.7	-2.5	0.02	0.01	-0.01	0.4	S
12/1/2023 13:32:00	16.4	13.2	-3.2	0.02	0.01	-0.01	0.4	ESE
12/1/2023 13:33:00	16.7	14.5	-2.2	0.02	0.01	-0.01	0.5	W
12/1/2023 13:34:00	16.7	14.7	-1.9	0.02	0.01	-0.01	0.5	W
12/1/2023 13:35:00	16.6	14.9	-1.7	0.02	0.01	-0.01	0.4	NNW
12/1/2023 13:36:00	16.6	16.0	-0.5	0.02	0.01	-0.02	0.5	WSW
12/1/2023 13:37:00	16.6	16.4	-0.2	0.03	0.01	-0.02	0.5	WSW

Date/Time	Average Upwind PM10 ($\mu\text{g}/\text{m}^3$)	Average Downwind PM10 ($\mu\text{g}/\text{m}^3$)	Average Contribution PM10 ($\mu\text{g}/\text{m}^3$)	Average Upwind VOC (ppm)	Average Downwind VOC (ppm)	Average Contribution VOC (ppm)	Wind Speed 15 min Avg	Wind Direction
12/1/2023 13:38:00	17.0	16.0	-1.0	0.03	0.01	-0.02	0.6	W
12/1/2023 13:39:00	17.3	16.0	-1.3	0.03	0.01	-0.02	0.8	WSW
12/1/2023 13:40:00	17.6	15.9	-1.7	0.03	0.01	-0.02	0.8	W
12/1/2023 13:41:00	18.0	15.9	-2.0	0.03	0.01	-0.02	0.9	WSW
12/1/2023 13:42:00	18.4	16.0	-2.4	0.03	0.01	-0.02	1.1	W
12/1/2023 13:43:00	18.6	16.0	-2.6	0.03	0.01	-0.02	1.2	WSW
12/1/2023 13:44:00	18.8	15.9	-3.0	0.03	0.01	-0.02	1.3	WSW
12/1/2023 13:45:00	18.5	15.8	-2.6	0.03	0.01	-0.02	1.4	WSW
12/1/2023 13:46:00	17.8	15.8	-1.9	0.03	0.01	-0.02	1.4	W
12/1/2023 13:47:00	16.8	15.3	-1.5	0.03	0.01	-0.03	1.5	WSW
12/1/2023 13:48:00	16.4	13.8	-2.6	0.03	0.01	-0.03	1.5	WSW
12/1/2023 13:49:00	16.3	13.6	-2.7	0.03	0.01	-0.02	1.6	WSW
12/1/2023 13:50:00	15.7	13.4	-2.3	0.03	0.01	-0.03	1.6	SSE
12/1/2023 13:51:00	15.6	12.4	-3.2	0.03	0.00	-0.03	1.6	W
12/1/2023 13:52:00	15.1	12.0	-3.1	0.03	0.00	-0.03	1.5	WSW
12/1/2023 13:53:00	14.7	11.8	-2.9	0.03	0.00	-0.03	1.5	WSW
12/1/2023 13:54:00	14.3	11.8	-2.5	0.03	0.00	-0.03	1.4	SW
12/1/2023 13:55:00	13.9	11.7	-2.2	0.03	0.00	-0.03	1.4	WSW
12/1/2023 13:56:00	13.4	11.6	-1.9	0.03	0.00	-0.03	1.3	W
12/1/2023 13:57:00	12.9	11.6	-1.3	0.03	0.00	-0.03	1.3	WSW
12/1/2023 13:58:00	12.6	11.6	-1.0	0.03	0.00	-0.03	1.2	WSW
12/1/2023 13:59:00	12.2	11.7	-0.5	0.03	0.00	-0.03	1.1	WSW
12/1/2023 14:00:00	11.9	11.6	-0.3	0.03	0.00	-0.03	1.1	WSW
12/1/2023 14:01:00	11.7	11.6	-0.1	0.03	0.00	-0.03	1.0	WSW
12/1/2023 14:02:00	11.6	11.6	0.1	0.03	0.00	-0.03	1.0	WSW
12/1/2023 14:03:00	11.5	11.7	0.3	0.03	0.00	-0.03	0.9	W
12/1/2023 14:04:00	11.5	11.8	0.3	0.03	0.00	-0.03	0.9	W
12/1/2023 14:05:00	11.6	12.0	0.4	0.02	0.00	-0.02	0.9	ENE
12/1/2023 14:06:00	11.8	12.1	0.3	0.02	0.00	-0.02	0.9	W
12/1/2023 14:07:00	12.1	12.2	0.1	0.03	0.00	-0.02	0.9	W
12/1/2023 14:08:00	12.3	12.4	0.0	0.03	0.00	-0.02	0.9	WSW
12/1/2023 14:09:00	12.5	12.5	0.0	0.03	0.00	-0.02	0.9	W

Date/Time	Average Upwind PM10 (µg/m³)	Average Downwind PM10 (µg/m³)	Average Contribution PM10 (µg/m³)	Average Upwind VOC (ppm)	Average Downwind VOC (ppm)	Average Contribution VOC (ppm)	Wind Speed 15 min Avg	Wind Direction
12/1/2023 14:10:00	13.1	12.8	-0.4	0.03	0.00	-0.02	0.9	WSW
12/1/2023 14:11:00	13.8	13.1	-0.7	0.03	0.00	-0.02	0.9	WSW
12/1/2023 14:12:00	14.6	13.2	-1.4	0.03	0.01	-0.02	1.0	WSW
12/1/2023 14:13:00	14.9	13.3	-1.5	0.03	0.01	-0.02	1.0	W
12/1/2023 14:14:00	15.1	13.3	-1.7	0.03	0.01	-0.03	1.0	WSW
12/1/2023 14:15:00	15.2	13.4	-1.8	0.03	0.01	-0.03	1.0	WSW
12/1/2023 14:16:00	15.4	13.6	-1.9	0.03	0.01	-0.02	1.0	NNE
12/1/2023 14:17:00	15.8	13.7	-2.1	0.03	0.01	-0.02	0.9	W
12/1/2023 14:18:00	16.0	13.8	-2.2	0.03	0.01	-0.02	0.9	SE
12/1/2023 14:19:00	16.5	14.3	-2.2	0.03	0.01	-0.01	0.9	E
12/1/2023 14:20:00	16.9	14.5	-2.4	0.03	0.01	-0.01	1.0	E
12/1/2023 14:21:00	16.9	14.7	-2.3	0.03	0.01	-0.01	1.0	WSW
12/1/2023 14:22:00	17.2	14.7	-2.5	0.03	0.01	-0.01	1.0	W
12/1/2023 14:23:00	17.4	14.7	-2.6	0.03	0.01	-0.02	1.0	WSW
12/1/2023 14:24:00	17.2	14.8	-2.4	0.03	0.01	-0.01	1.0	N
12/1/2023 14:25:00	16.8	14.8	-2.0	0.02	0.02	0.00	0.9	ESE
12/1/2023 14:26:00	16.3	14.8	-1.5	0.02	0.02	0.00	0.9	ESE
12/1/2023 14:27:00	15.8	14.7	-1.1	0.02	0.02	0.00	0.8	W
12/1/2023 14:28:00	15.7	14.6	-1.1	0.02	0.02	0.00	0.8	WSW
12/1/2023 14:29:00	15.9	14.7	-1.2	0.02	0.02	0.00	0.7	W
12/1/2023 14:30:00	16.2	14.7	-1.4	0.02	0.02	0.00	0.7	W
12/1/2023 14:31:00	16.1	14.9	-1.3	0.02	0.02	0.00	0.7	N
12/1/2023 14:32:00	15.8	15.1	-0.7	0.02	0.02	0.00	0.7	SE
12/1/2023 14:33:00	16.1	15.1	-1.0	0.02	0.02	0.00	0.7	W
12/1/2023 14:34:00	15.8	14.7	-1.1	0.03	0.02	-0.01	0.7	WSW
12/1/2023 14:35:00	15.7	14.6	-1.1	0.03	0.01	-0.01	0.7	WSW
12/1/2023 14:36:00	15.7	14.6	-1.1	0.03	0.01	-0.01	0.8	WSW
12/1/2023 14:37:00	15.7	14.6	-1.1	0.03	0.01	-0.01	0.8	W
12/1/2023 14:38:00	16.2	14.6	-1.6	0.03	0.01	-0.01	0.8	WSW
12/1/2023 14:39:00	17.3	14.5	-2.8	0.03	0.01	-0.02	0.9	WSW
12/1/2023 14:40:00	18.6	14.6	-4.0	0.03	0.01	-0.02	0.9	WSW
12/1/2023 14:41:00	19.7	14.6	-5.1	0.03	0.01	-0.03	1.0	WSW

Date/Time	Average Upwind PM10 (µg/m³)	Average Downwind PM10 (µg/m³)	Average Contribution PM10 (µg/m³)	Average Upwind VOC (ppm)	Average Downwind VOC (ppm)	Average Contribution VOC (ppm)	Wind Speed 15 min Avg	Wind Direction
12/1/2023 14:42:00	20.1	14.8	-5.4	0.03	0.00	-0.03	1.0	WSW
12/1/2023 14:43:00	20.4	15.0	-5.4	0.03	0.00	-0.03	1.0	WSW
12/1/2023 14:44:00	20.9	15.2	-5.7	0.03	0.00	-0.03	1.0	WSW
12/1/2023 14:45:00	21.2	15.4	-5.8	0.03	0.00	-0.03	1.1	WSW
12/1/2023 14:46:00	21.5	15.2	-6.3	0.03	0.00	-0.03	1.2	W
12/1/2023 14:47:00	21.7	15.1	-6.6	0.04	0.00	-0.04	1.3	W
12/1/2023 14:48:00	21.4	15.4	-6.0	0.04	0.00	-0.04	1.3	NE
12/1/2023 14:49:00	21.6	15.4	-6.1	0.04	0.01	-0.02	1.2	W
12/1/2023 14:50:00	21.3	15.6	-5.7	0.03	0.02	-0.01	1.2	WSW
12/1/2023 14:51:00	21.3	15.6	-5.7	0.03	0.03	-0.01	1.2	SW
12/1/2023 14:52:00	21.3	15.5	-5.8	0.03	0.03	0.00	1.1	WSW
12/1/2023 14:53:00	21.1	15.5	-5.6	0.03	0.03	0.00	1.1	WSW
12/1/2023 14:54:00	20.9	15.4	-5.5	0.03	0.03	0.00	1.1	W
12/1/2023 14:55:00	19.7	15.6	-4.0	0.03	0.03	0.01	1.0	ESE
12/1/2023 14:56:00	18.9	15.4	-3.5	0.03	0.04	0.01	0.9	WSW
12/1/2023 14:57:00	18.6	15.0	-3.5	0.03	0.04	0.01	0.9	W
12/1/2023 14:58:00	18.9	14.6	-4.3	0.03	0.04	0.01	0.8	S
12/1/2023 14:59:00	18.7	14.9	-3.9	0.03	0.04	0.01	0.8	SE
12/1/2023 15:00:00	18.5	15.2	-3.3	0.03	0.04	0.01	0.8	W
12/1/2023 15:01:00	18.3	15.6	-2.8	0.02	0.04	0.01	0.7	E
12/1/2023 15:02:00	19.1	15.3	-3.7	0.03	0.04	0.01	0.6	WNW
12/1/2023 15:03:00	20.0	14.8	-5.2	0.02	0.04	0.02	0.7	WSW
12/1/2023 15:04:00	19.4	14.9	-4.5	0.02	0.03	0.01	0.6	ESE
12/1/2023 15:05:00	19.3	14.8	-4.5	0.02	0.02	0.00	0.6	SE
12/1/2023 15:06:00	19.0	14.5	-4.6	0.02	0.02	0.00	0.6	W
12/1/2023 15:07:00				0.02	0.02	0.00	0.6	E
12/1/2023 15:08:00	10.5	16.3	5.8	0.01	0.01	0.00	0.6	E
12/1/2023 15:09:00	11.9	14.8	2.9	0.01	0.01	0.00	0.6	ESE
12/1/2023 15:10:00				0.01	0.01	0.00	0.7	E
12/1/2023 15:11:00	12.6	12.3	-0.3	0.01	0.01	0.00	0.7	ESE
12/1/2023 15:12:00	12.9	15.5	2.6	0.01	0.01	0.01	0.7	ESE
12/1/2023 15:13:00	16.6	14.7	-1.9	0.01	0.01	0.01	0.7	SSE

Date/Time	Average Upwind PM10 (µg/m³)	Average Downwind PM10 (µg/m³)	Average Contribution PM10 (µg/m³)	Average Upwind VOC (ppm)	Average Downwind VOC (ppm)	Average Contribution VOC (ppm)	Wind Speed 15 min Avg	Wind Direction
12/1/2023 15:14:00	15.9	15.6	-0.3	0.01	0.01	0.01	0.7	ESE
12/1/2023 15:15:00	15.6	15.4	-0.2	0.01	0.01	0.01	0.7	WSW
12/1/2023 15:16:00	16.4	15.0	-1.4	0.01	0.01	0.00	0.7	WNW
12/1/2023 15:17:00	15.6	16.2	0.6	0.01	0.01	0.01	0.7	ENE
12/1/2023 15:18:00	16.0	15.5	-0.5	0.01	0.01	0.01	0.7	S
12/1/2023 15:19:00	15.3	15.8	0.4	0.01	0.01	0.01	0.7	ESE
12/1/2023 15:20:00	15.4	15.2	-0.2	0.01	0.01	0.00	0.7	WNW
12/1/2023 15:21:00	15.2	14.9	-0.4	0.01	0.01	0.00	0.7	WSW
12/1/2023 15:22:00	15.3	14.6	-0.7	0.01	0.01	0.00	0.7	W
12/1/2023 15:23:00	15.1	14.3	-0.8	0.02	0.01	-0.01	0.6	W
12/1/2023 15:24:00	14.9	14.1	-0.9	0.02	0.01	-0.01	0.6	S
12/1/2023 15:25:00	14.6	13.8	-0.8	0.02	0.01	-0.01	0.6	NNW
12/1/2023 15:26:00	14.6	13.7	-0.9	0.02	0.01	-0.01	0.6	WSW
12/1/2023 15:27:00	14.7	13.2	-1.5	0.02	0.01	-0.01	0.6	WSW
12/1/2023 15:28:00	13.7	13.2	-0.6	0.02	0.01	-0.01	0.6	WSW
12/1/2023 15:29:00	13.6	12.9	-0.7	0.03	0.01	-0.02	0.7	WSW
12/1/2023 15:30:00	13.8	12.8	-1.0	0.03	0.01	-0.02	0.8	WSW
12/1/2023 15:31:00	13.6	12.8	-0.8	0.02	0.01	-0.02	0.8	WSW
12/1/2023 15:32:00	14.0	12.0	-2.0	0.03	0.01	-0.02	0.9	WSW
12/1/2023 15:33:00	13.8	12.0	-1.8	0.03	0.01	-0.02	0.9	WSW
12/1/2023 15:34:00	14.2	11.5	-2.8	0.03	0.00	-0.03	0.9	WSW
12/1/2023 15:35:00	14.0	11.4	-2.6	0.03	0.00	-0.03	1.0	WSW
12/1/2023 15:36:00	13.9	11.3	-2.6	0.03	0.00	-0.03	1.0	WSW
12/1/2023 15:37:00	13.8	11.2	-2.6	0.03	0.00	-0.02	1.2	W
12/1/2023 15:38:00	13.8	11.1	-2.7	0.03	0.00	-0.02	1.2	W
12/1/2023 15:39:00	13.6	11.1	-2.5	0.03	0.00	-0.02	1.3	W
12/1/2023 15:40:00	13.5	11.0	-2.5	0.03	0.00	-0.03	1.3	W
12/1/2023 15:41:00	13.2	10.9	-2.3	0.03	0.00	-0.03	1.3	W
12/1/2023 15:42:00	12.8	10.9	-1.9	0.03	0.00	-0.03	1.3	WSW
12/1/2023 15:43:00	12.6	10.6	-1.9	0.03	0.00	-0.03	1.3	WSW
12/1/2023 15:44:00	12.3	10.3	-2.0	0.03	0.00	-0.03	1.2	W
12/1/2023 15:45:00	11.9	9.9	-1.9	0.02	0.00	-0.02	1.1	SE

Date/Time	Average Upwind PM10 (µg/m³)	Average Downwind PM10 (µg/m³)	Average Contribution PM10 (µg/m³)	Average Upwind VOC (ppm)	Average Downwind VOC (ppm)	Average Contribution VOC (ppm)	Wind Speed 15 min Avg	Wind Direction
12/1/2023 15:46:00	11.2	9.7	-1.4	0.02	0.00	-0.02	1.2	WSW
12/1/2023 15:47:00	10.6	9.7	-1.0	0.02	0.00	-0.02	1.1	WSW
12/1/2023 15:48:00	10.0	9.6	-0.5	0.02	0.00	-0.02	1.1	WSW
12/1/2023 15:49:00	9.7	9.4	-0.3	0.02	0.00	-0.02	1.0	E
12/1/2023 15:50:00	9.7	9.4	-0.3	0.02	0.00	-0.01	1.0	ENE
12/1/2023 15:51:00	9.4	9.5	0.0	0.02	0.00	-0.01	0.9	WSW
12/1/2023 15:52:00	9.2	9.3	0.1	0.02	0.01	-0.01	0.7	E
12/1/2023 15:53:00	8.9	9.2	0.2	0.01	0.01	-0.01	0.7	E
12/1/2023 15:54:00	9.1	9.1	0.0	0.01	0.01	-0.01	0.6	E
12/1/2023 15:55:00	9.2	8.9	-0.3	0.01	0.01	0.00	0.6	N
12/1/2023 15:56:00	9.1	9.0	-0.1	0.01	0.01	0.00	0.6	W
12/1/2023 15:57:00	9.1	9.1	0.0	0.01	0.01	0.00	0.6	WSW
12/1/2023 15:58:00	9.0	9.1	0.0	0.01	0.01	0.00	0.6	WSW
12/1/2023 15:59:00	9.0	9.0	0.0	0.01	0.01	0.00	0.6	W