

DAILY FIELD REPORT 130

Prepared By: LANGAN

WEATHER	Snow		Rain		Overcast		Partly Cloudy	x	Sunny	x
TEMP.	< 32	X	32-50	x	50-70		70-85		>85	

BCP Project No:	C231153	Date:	November 29, 2023
------------------------	---------	--------------	-------------------

Project Name:	Kasser Scrap Metal and Rector Cleaners Site	Time:	6:45 am to 5:30 pm
----------------------	---	--------------	--------------------

Consultant: Langan Engineering, Environmental, Surveying, Landscape Architecture and Geology, D.P.C. (Langan)	Langan Field Personnel: Caitlyn Dempsey (Environmental) Jesse Matza (Geotechnical)
Construction Manager: Consigli Construction Co., Inc. (Consigli)	
Foundation Contractor: Urban Foundation/Engineering (Urban)	
Drilling Contractor: Aquifer Drilling Testing (ADT)	

Work Activities Performed:

- Aquifer Drilling and Testing (ADT) under contract to Urban continued advancing one, 3-inch core (ISS-2B-C1) through the center of in-situ stabilization (ISS) Column #2B from about 6.0 feet below grade surface (bgs) (about elevation^[1] 1) to about 25 feet bgs (about elevation -18), and advanced one, 3-inch core (ISS-1B-C1) through the center of ISS Column #1B to about 5.5 feet bgs (about elevation 1.5) using an Acker Diesel Restricted Access Drill (RAD) mobile drilling rig with a 5-inch coring bit and PQ core barrel. Soil mix coring is being implemented as part of the quality assurance/quality control (QA/QC) program for the ISS of non-aqueous phase liquid (NAPL)-contaminated soil established in the New York State Department of Environmental Conservation (NYSDEC)-approved Remedial Action Work Plan (RAWP).
 - Recovered cores were screened with a photoionization detector (PID) and exhibited a maximum PID reading of 1.2 parts per million (ppm). Detailed soil mix coring logs will be included in the Final Engineering Report (FER).
- Urban excavated an about 20-foot-long by 20-foot-wide area from about 10 feet bgs to about 13 feet bgs in the northern part of grids WC02_10-15 and WC03_10-15 to assist with caisson installation. Excavated soil/fill was graded adjacent to the excavation area.
- Urban excavated an about 15-foot-long by 15-foot-wide area from about 15 feet bgs to about 18 feet bgs in the eastern part of grid WC03_15-20 to assist with caisson installation. Excavated soil/fill was stockpiled in the western part of WC02, pending off-site disposal.
- Urban graded an about 40-foot-long by 40-foot-wide area of soil/fill in the eastern part of WC02 to prepare for equipment mobilization.
- Urban used an excavator with a jack hammer attachment to break up concrete in the eastern part of waste characterization grid WC02 to prepare for equipment mobilization.
- Excavated and graded soil/fill consisted of non-native soil; odors, staining, elevated PID readings, or other evidence of a petroleum or chemical release were not observed.

^[1] Elevations are based on the North American Vertical Datum of 1988 (NAVD88)

Material Tracking:

- The following soil/fill was exported from the site:
 - 9 loads of soil/fill from waste characterization grids WC02_0-5, WC02_5-10, WC02_10-15, WC03_5-10, WC03_10-15, WC03_15-20, WC04_0-5 and/or WC05_0-5 were exported for off-site disposal at the Clean Earth of Carteret LLC facility in Carteret, NJ.
- No material was imported to the site.

Materials Export Summary								
Facility Name	Bayshore Soil Management, LLC		Clean Earth of Carteret, LLC		PPark NJ		Faztec Solutions	
Location	Keasbey, NJ		Carteret, NJ		Prospect Park, NJ		Staten Island, NY	
Type of Waste	Non-hazardous Soil		Non-hazardous Soil		Non-hazardous Soil		C&D	
Today	Number of Loads	Approx. Volume (CY)	Number of Loads	Approx. Volume (CY)	Number of Loads	Approx. Volume (CY)	Number of Loads	Approximate Volume (CY)
		0	-	9	180	0	-	0
Total	Number of Loads	Approx. Volume (CY)	Number of Loads	Approx. Volume (CY)	Number of Loads	Approx. Volume (CY)	Number of Loads	Approximate Volume (CY)
	129	2,540	153	3,060	0	-	15	300

Materials Export Summary		
Facility Name	Dale Transfer Corp.	
Location	West Babylon, NY	
Type of Waste	Concrete	
Today	Number of Loads	Approx. Volume (CY)
		0
Total	Number of Loads	Approx. Volume (CY)
	2	40

Samples Collected:

- Langan collected eight soil-mix core samples, as noted below, for laboratory analysis of compressive strength and hydraulic conductivity as part of the soil mix QA/QC program. The core samples will be analyzed for compressive strength by Fenagh Engineering and hydraulic conductivity by TerraSense. The following soil-mix core samples were collected:
 - ISS-2-B_C1_el_-9'_to_-9'6";
 - ISS-2-B_C1_el_-10'_to_-10'10";
 - ISS-2-B_C1_el_-12'1" _to_-12'8";
 - ISS-2-B_C1_el_-12'8" _to_-13'5";
 - ISS-2-B_C1_el_-14'_to_-14'6";
 - ISS-2-B_C1_el_-14'6" _to_-15'6";
 - ISS-2-B_C1_el_-16'16" _to_-17'; and
 - ISS-2-B_C1_el_-17'4" _to_-18

Air Monitoring:

The 15-minute average site contributions for particulates and volatile organic compounds (VOCs) are calculated by subtracting the upwind readings from the downwind readings. A true action level exceedance is realized when this net result exceeds 100 $\mu\text{g}/\text{m}^3$ for particulates and 5 ppm for organic vapors. No particulates (PM10) or organic vapors exceeded the 15-minute average site contribution action levels of 100 $\mu\text{g}/\text{m}^3$ or 5 ppm, respectively, on this day.

Particulate Monitoring ($\mu\text{g}/\text{m}^3$)		Organic Vapor Monitoring (ppm)	
Daily Background	4.8	Daily Background	0.00
PM10 Average Site Contribution (Minimum)	-51.1	VOC Average Site Contribution (Minimum)	-0.08
PM10 Average Site Contribution (Maximum)	19.5	VOC Average Site Contribution (Maximum)	0.03

$\mu\text{g}/\text{m}^3$: micrograms per cubic meter.

ppm: parts per million.

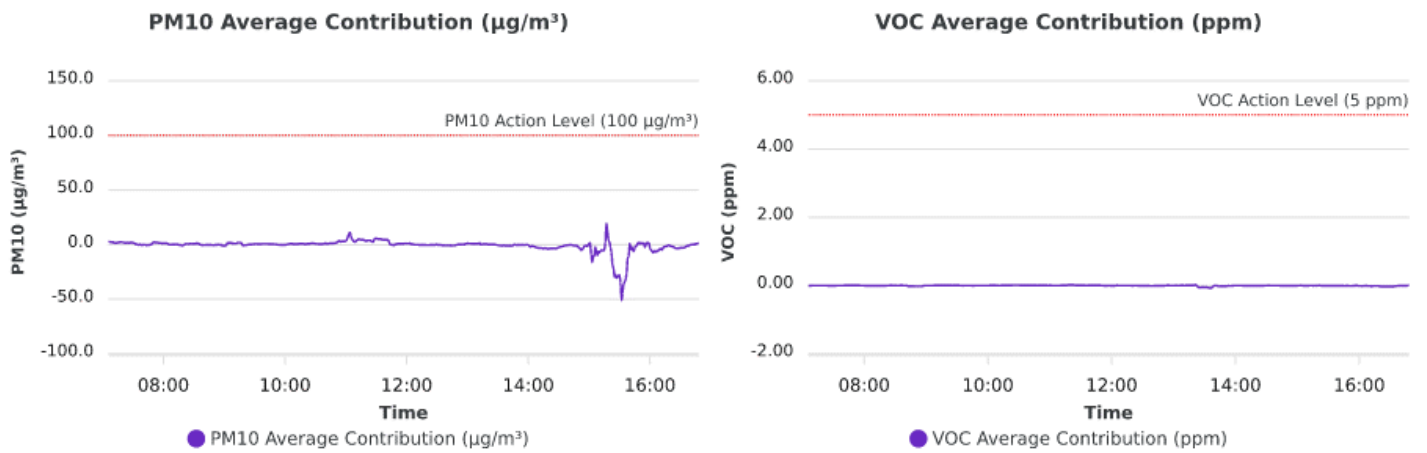

Planned Activities:

- Urban will continue excavation throughout the site to assist in the advancement of caissons and soldier piles.
- Urban will export soil/fill off-site.

SITE PLAN

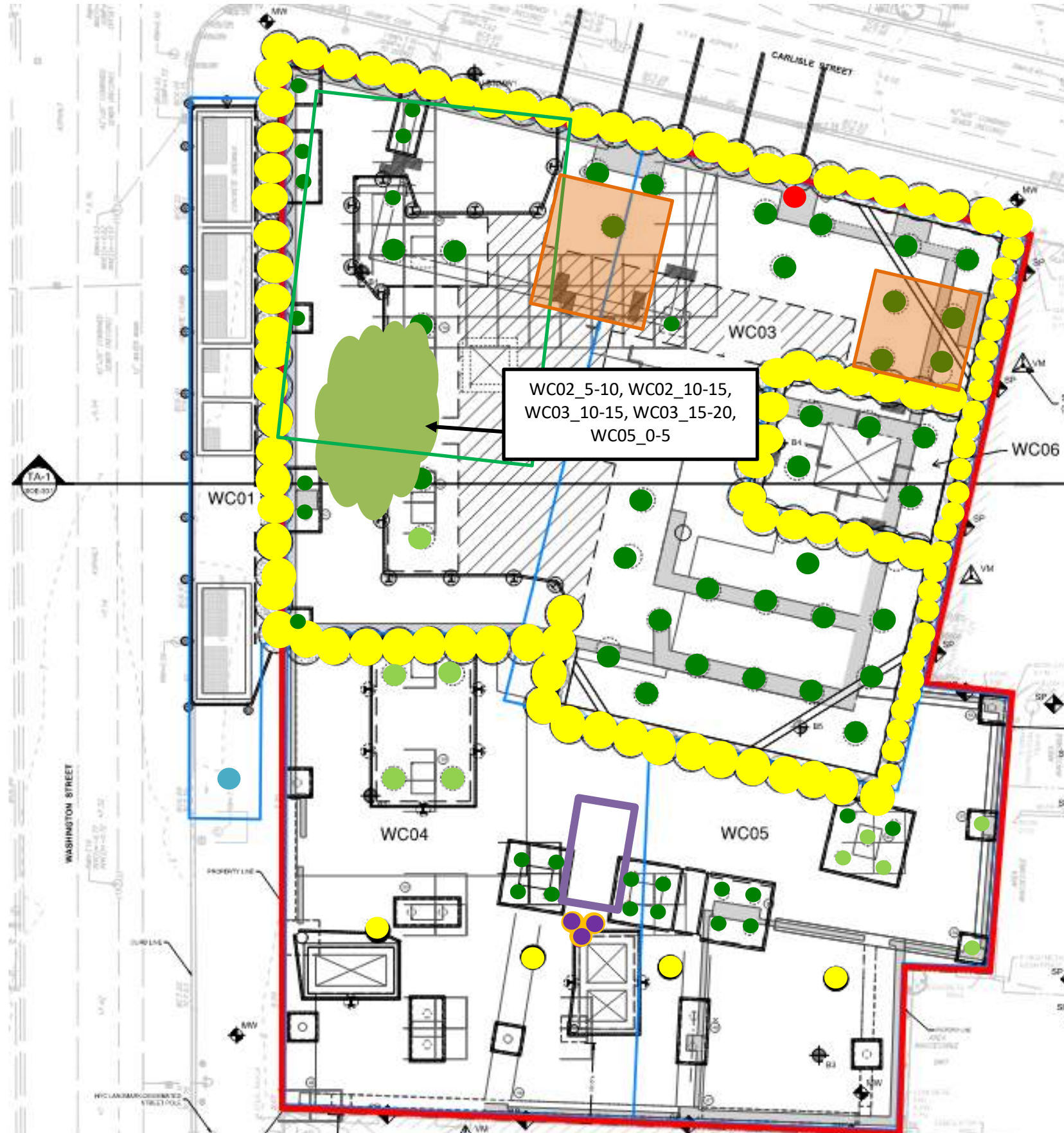

- Site Boundary**
- Waste Characterization Grid Boundary**
- **CAMP station 1**
- **CAMP station 2**
- **Stockpile – Soil (no impacts)**
- **Stockpile – C&D**
- Approximate Location of Excavation**
- Approximate Area of Grading**
- Approximate Backfill Location**
- **Completed Soil-Mix Column**
- **Completed Caisson Casing**
- **Completed Caisson**
- **Reinstalled Soil-Mix Column as part of the In-Situ Stabilization of NAPL-contaminated Soil**
- **Soil-Mix Core Advanced**
- Approximate Location of the Former UST**

Note: Waste characterization grid areas were developed by PT Consultants and Urban and is shown on this site plan for reference only.

Photo Log

Photo 1: View of Urban loading a truck with soil/fill for off-site disposal (facing north).



Photo 2: View of ADT advancing a core at ISS column #2B (facing east).



Photo 3: View of a collected soil mix core from ISS Column #1B.



Photo 4: View of the site entrance/exit at the corner of Carlisle and Washington Street at the end of the work day (facing south).



LANGAN	Air Monitoring Report	170695201 - 111 Washington St	
		Report Period	
		From:	11/29/2023 06:00
		To:	11/29/2023 19:00
		PM10 Action Level:	100.0 $\mu\text{g}/\text{m}^3$
VOC Action Level:	5.00 ppm		

Daily Environmental Summary	Windspeed (mph)	Prevailing wind direction
11/29/2023	0.3-1.8	ESE

Daily Monitoring Summary	PM10 ($\mu\text{g}/\text{m}^3$)	Time	VOC (ppm)	Time
Min Contribution (15 min avg.) - 11/29/2023	-51.1	15:32	-0.08	13:36
Max Contribution (15 min avg.) - 11/29/2023	19.5	15:17	0.03	13:21

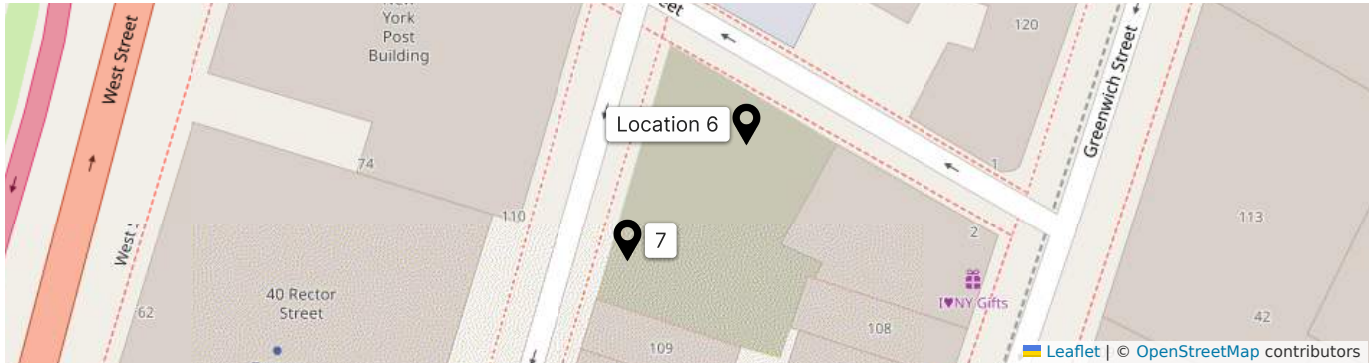

PM10 Average Contribution ($\mu\text{g}/\text{m}^3$)

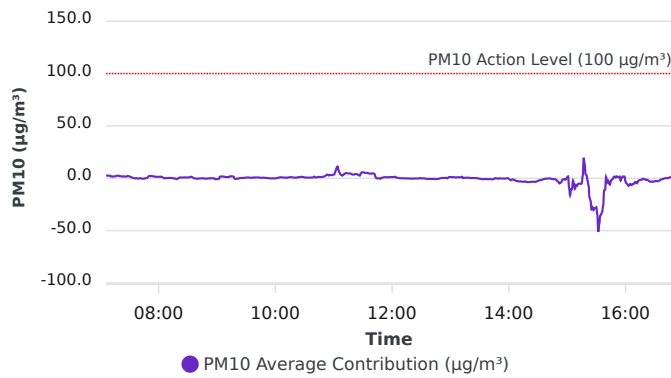

VOC Average Contribution (ppm)

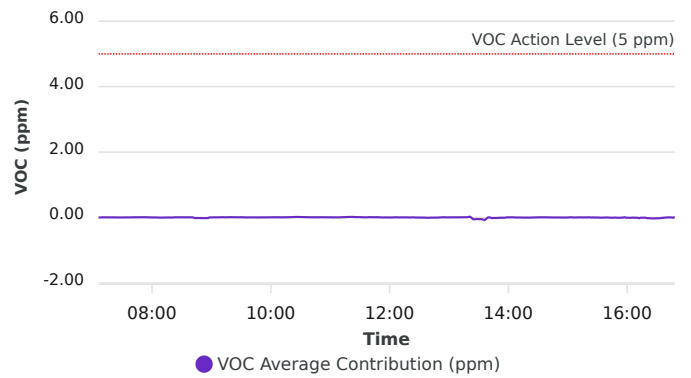

Contribution wind rose (mph)

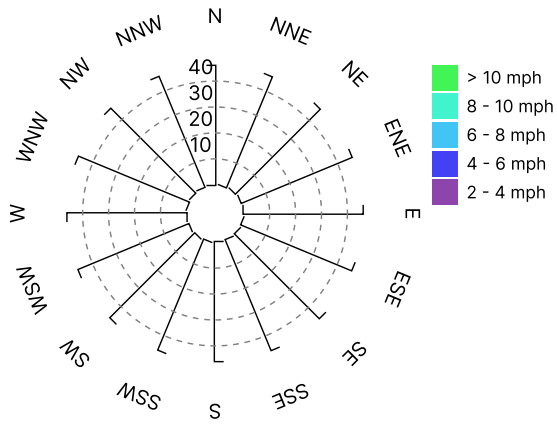

Date/Time	Average Upwind PM10 (µg/m³)	Average Downwind PM10 (µg/m³)	Average Contribution PM10 (µg/m³)	Average Upwind VOC (ppm)	Average Downwind VOC (ppm)	Average Contribution VOC (ppm)	Wind Speed 15 min Avg	Wind Direction
11/29/2023 07:06:00	4.8	7.6	2.8	0.00	0.00	0.00	1.7	ENE
11/29/2023 07:07:00	4.8	7.3	2.5	0.00	0.00	0.00	1.2	E
11/29/2023 07:08:00	4.8	7.2	2.4	0.00	0.00	0.00	1.1	ESE
11/29/2023 07:09:00	4.7	7.1	2.4	0.00	0.00	0.00	1.1	E
11/29/2023 07:10:00	4.8	7.2	2.4	0.00	0.01	0.01	1.1	E
11/29/2023 07:11:00	5.3	7.0	1.7	0.00	0.01	0.00	1.1	SSW
11/29/2023 07:12:00	5.2	7.1	1.8	0.00	0.01	0.00	1.0	E
11/29/2023 07:13:00	5.6	7.1	1.5	0.00	0.01	0.01	1.0	ESE
11/29/2023 07:14:00	5.6	7.3	1.7	0.00	0.01	0.00	1.0	E
11/29/2023 07:15:00	5.5	7.3	1.9	0.00	0.01	0.00	1.0	E
11/29/2023 07:16:00	5.4	7.4	2.0	0.00	0.01	0.00	1.0	E
11/29/2023 07:17:00	5.3	7.7	2.4	0.00	0.00	0.00	1.0	ESE
11/29/2023 07:18:00	5.2	7.8	2.5	0.00	0.01	0.00	1.0	E
11/29/2023 07:19:00	5.4	7.6	2.2	0.00	0.00	0.00	1.0	WSW
11/29/2023 07:20:00	5.3	7.5	2.2	0.00	0.01	0.00	1.0	E
11/29/2023 07:21:00	5.5	7.4	1.9	0.00	0.01	0.00	1.0	W
11/29/2023 07:22:00	5.7	7.3	1.7	0.00	0.01	0.00	1.0	W
11/29/2023 07:23:00	5.7	7.4	1.7	0.00	0.01	0.00	1.0	E
11/29/2023 07:24:00	5.7	7.6	1.9	0.00	0.01	0.00	1.0	ESE
11/29/2023 07:25:00	5.9	7.5	1.6	0.00	0.00	0.00	0.9	SW
11/29/2023 07:26:00	5.9	7.5	1.6	0.00	0.00	0.00	1.0	W
11/29/2023 07:27:00	6.0	7.5	1.6	0.00	0.01	0.00	1.0	NNE
11/29/2023 07:28:00	5.7	7.8	2.1	0.00	0.01	0.00	1.0	ESE
11/29/2023 07:29:00	5.9	7.8	1.9	0.00	0.01	0.00	1.0	ESE
11/29/2023 07:30:00	6.1	7.8	1.7	0.01	0.01	0.00	1.0	WSW
11/29/2023 07:31:00	6.4	7.8	1.4	0.01	0.01	0.00	1.0	ESE
11/29/2023 07:32:00	6.6	7.5	0.9	0.01	0.01	0.00	1.0	E
11/29/2023 07:33:00	6.9	7.3	0.4	0.01	0.01	0.00	1.0	NNE
11/29/2023 07:34:00	7.0	7.3	0.3	0.00	0.01	0.00	1.0	ENE
11/29/2023 07:35:00	7.5	7.3	-0.1	0.00	0.01	0.00	1.0	ESE
11/29/2023 07:36:00	7.5	7.3	-0.2	0.00	0.01	0.00	0.9	SW
11/29/2023 07:37:00	7.3	7.4	0.1	0.00	0.01	0.01	0.9	E

Date/Time	Average Upwind PM10 (µg/m³)	Average Downwind PM10 (µg/m³)	Average Contribution PM10 (µg/m³)	Average Upwind VOC (ppm)	Average Downwind VOC (ppm)	Average Contribution VOC (ppm)	Wind Speed 15 min Avg	Wind Direction
11/29/2023 07:38:00	7.3	7.1	-0.2	0.00	0.01	0.00	0.9	WNW
11/29/2023 07:39:00	7.3	6.8	-0.4	0.00	0.01	0.00	0.9	E
11/29/2023 07:40:00	7.0	6.9	-0.1	0.00	0.01	0.01	0.9	E
11/29/2023 07:41:00	6.8	6.8	0.1	0.00	0.01	0.01	1.0	ESE
11/29/2023 07:42:00	6.8	6.8	-0.1	0.00	0.01	0.01	1.0	E
11/29/2023 07:43:00	6.8	6.3	-0.5	0.00	0.01	0.01	0.9	ENE
11/29/2023 07:44:00	6.5	6.1	-0.4	0.00	0.01	0.01	0.9	E
11/29/2023 07:45:00	6.4	6.1	-0.3	0.00	0.01	0.01	1.0	E
11/29/2023 07:46:00	6.1	6.0	-0.1	0.00	0.01	0.01	1.0	E
11/29/2023 07:47:00	5.9	5.9	-0.1	0.00	0.01	0.01	1.0	E
11/29/2023 07:48:00	5.6	5.9	0.2	0.00	0.01	0.01	1.1	E
11/29/2023 07:49:00	5.3	6.4	1.1	0.00	0.01	0.01	1.1	ESE
11/29/2023 07:50:00	4.9	7.0	2.0	0.00	0.01	0.01	1.1	E
11/29/2023 07:51:00	4.8	7.1	2.3	0.00	0.01	0.01	1.1	E
11/29/2023 07:52:00	4.9	7.0	2.0	0.00	0.01	0.01	1.1	NW
11/29/2023 07:53:00	5.0	7.1	2.1	0.00	0.01	0.01	1.1	E
11/29/2023 07:54:00	5.1	7.0	1.9	0.00	0.01	0.01	1.1	WSW
11/29/2023 07:55:00	5.2	6.9	1.7	0.00	0.01	0.01	1.1	S
11/29/2023 07:56:00	5.3	6.8	1.6	0.00	0.01	0.01	1.0	E
11/29/2023 07:57:00	5.3	6.7	1.5	0.00	0.01	0.01	1.0	ENE
11/29/2023 07:58:00	5.3	6.6	1.4	0.00	0.01	0.00	1.0	WSW
11/29/2023 07:59:00	5.3	6.6	1.4	0.00	0.01	0.00	1.0	E
11/29/2023 08:00:00	5.3	6.7	1.4	0.00	0.01	0.00	1.0	ESE
11/29/2023 08:01:00	5.3	6.5	1.3	0.01	0.01	0.00	1.0	W
11/29/2023 08:02:00	5.2	6.6	1.4	0.01	0.01	0.00	1.0	E
11/29/2023 08:03:00	5.2	6.7	1.5	0.01	0.01	0.00	1.0	ESE
11/29/2023 08:04:00	5.2	6.1	0.9	0.01	0.01	0.00	0.9	ESE
11/29/2023 08:05:00	5.1	5.5	0.4	0.01	0.01	0.00	0.9	ESE
11/29/2023 08:06:00	5.4	5.4	0.0	0.01	0.01	0.00	0.9	SW
11/29/2023 08:07:00	5.3	5.3	0.0	0.01	0.01	0.00	1.0	E
11/29/2023 08:08:00	5.1	5.2	0.1	0.01	0.01	0.00	1.0	E
11/29/2023 08:09:00	4.9	5.2	0.2	0.01	0.01	0.00	1.0	E

Date/Time	Average Upwind PM10 (µg/m³)	Average Downwind PM10 (µg/m³)	Average Contribution PM10 (µg/m³)	Average Upwind VOC (ppm)	Average Downwind VOC (ppm)	Average Contribution VOC (ppm)	Wind Speed 15 min Avg	Wind Direction
11/29/2023 08:10:00	4.9	5.2	0.3	0.01	0.01	0.00	1.0	E
11/29/2023 08:11:00	4.8	5.1	0.2	0.01	0.01	0.00	1.0	WSW
11/29/2023 08:12:00	4.8	5.1	0.3	0.01	0.01	0.00	1.0	SE
11/29/2023 08:13:00	4.9	5.2	0.3	0.01	0.01	0.00	1.0	E
11/29/2023 08:14:00	5.1	5.3	0.2	0.01	0.01	0.00	1.1	E
11/29/2023 08:15:00	5.4	5.3	-0.1	0.01	0.01	0.00	1.1	SSE
11/29/2023 08:16:00	5.5	5.4	-0.1	0.01	0.01	0.00	1.1	E
11/29/2023 08:17:00	5.7	5.3	-0.3	0.01	0.01	0.00	1.0	ESE
11/29/2023 08:18:00	6.1	5.3	-0.8	0.01	0.01	0.00	1.0	ESE
11/29/2023 08:19:00	6.4	5.8	-0.7	0.01	0.01	0.00	1.0	E
11/29/2023 08:20:00	6.6	6.3	-0.3	0.01	0.01	0.00	1.0	E
11/29/2023 08:21:00	6.3	6.7	0.4	0.01	0.01	0.00	1.0	ESE
11/29/2023 08:22:00	6.3	6.9	0.7	0.01	0.01	0.00	1.0	ESE
11/29/2023 08:23:00	6.4	7.1	0.7	0.00	0.01	0.01	1.0	SE
11/29/2023 08:24:00	6.7	7.3	0.7	0.00	0.01	0.01	1.0	E
11/29/2023 08:25:00	6.8	7.5	0.6	0.00	0.01	0.01	1.0	ENE
11/29/2023 08:26:00	6.9	7.7	0.8	0.00	0.01	0.01	1.0	W
11/29/2023 08:27:00	6.9	7.7	0.8	0.00	0.01	0.01	1.0	E
11/29/2023 08:28:00	6.9	7.6	0.7	0.00	0.01	0.01	1.0	ESE
11/29/2023 08:29:00	6.8	7.5	0.6	0.00	0.01	0.01	1.0	ESE
11/29/2023 08:30:00	6.6	7.4	0.8	0.00	0.01	0.01	1.0	E
11/29/2023 08:31:00	6.5	7.3	0.8	0.00	0.01	0.01	1.0	SW
11/29/2023 08:32:00	6.3	7.3	1.0	0.00	0.01	0.01	1.0	E
11/29/2023 08:33:00	5.8	7.2	1.4	0.00	0.01	0.01	1.0	ESE
11/29/2023 08:34:00	5.5	6.8	1.3	0.00	0.01	0.01	1.0	E
11/29/2023 08:35:00	5.5	6.2	0.7	0.00	0.01	0.01	1.0	ENE
11/29/2023 08:36:00	5.8	5.9	0.1	0.00	0.01	0.01	1.0	ESE
11/29/2023 08:37:00	5.9	5.7	-0.2	0.00	0.01	0.01	0.9	ESE
11/29/2023 08:38:00	5.9	5.7	-0.2	0.00	0.01	0.01	0.9	SSE
11/29/2023 08:39:00	6.1	5.6	-0.4	0.00	0.01	0.01	0.9	ENE
11/29/2023 08:40:00	5.9	5.6	-0.3	0.00	0.01	0.01	0.9	E
11/29/2023 08:41:00	5.8	5.5	-0.3	0.01	0.01	0.00	0.9	SE

Date/Time	Average Upwind PM10 (µg/m³)	Average Downwind PM10 (µg/m³)	Average Contribution PM10 (µg/m³)	Average Upwind VOC (ppm)	Average Downwind VOC (ppm)	Average Contribution VOC (ppm)	Wind Speed 15 min Avg	Wind Direction
11/29/2023 08:42:00	5.6	5.4	-0.3	0.01	0.01	-0.01	0.8	E
11/29/2023 08:43:00	5.5	5.3	-0.2	0.02	0.01	-0.01	0.8	E
11/29/2023 08:44:00	5.4	5.3	-0.1	0.03	0.01	-0.02	0.8	E
11/29/2023 08:45:00	5.4	5.3	-0.2	0.03	0.01	-0.02	0.9	E
11/29/2023 08:46:00	5.3	5.3	-0.1	0.03	0.01	-0.02	0.9	E
11/29/2023 08:47:00	5.5	5.2	-0.3	0.03	0.01	-0.02	0.9	E
11/29/2023 08:48:00	5.6	5.3	-0.3	0.03	0.01	-0.02	0.8	SSE
11/29/2023 08:49:00	5.7	5.2	-0.4	0.03	0.01	-0.02	0.8	ESE
11/29/2023 08:50:00	5.6	5.2	-0.4	0.03	0.01	-0.02	0.8	SSE
11/29/2023 08:51:00	5.3	5.1	-0.1	0.03	0.01	-0.02	0.9	E
11/29/2023 08:52:00	5.2	5.1	-0.1	0.03	0.01	-0.02	0.8	NNE
11/29/2023 08:53:00	5.1	4.8	-0.2	0.03	0.01	-0.02	0.9	ESE
11/29/2023 08:54:00	4.6	4.7	0.1	0.03	0.01	-0.02	0.9	E
11/29/2023 08:55:00	4.7	4.6	0.0	0.03	0.01	-0.02	0.9	W
11/29/2023 08:56:00	4.7	4.6	-0.1	0.03	0.01	-0.02	0.9	E
11/29/2023 08:57:00	4.8	4.7	-0.1	0.02	0.01	-0.01	0.9	E
11/29/2023 08:58:00	5.6	4.8	-0.8	0.01	0.01	0.00	0.9	ENE
11/29/2023 08:59:00	5.8	4.9	-0.9	0.01	0.01	0.00	1.0	E
11/29/2023 09:00:00	5.8	5.0	-0.8	0.01	0.01	0.00	0.9	ESE
11/29/2023 09:01:00	5.9	5.0	-0.9	0.01	0.01	0.00	0.9	SW
11/29/2023 09:02:00	5.8	5.2	-0.6	0.00	0.01	0.01	0.9	NNW
11/29/2023 09:03:00	5.7	7.1	1.5	0.00	0.01	0.00	0.9	E
11/29/2023 09:04:00	5.6	7.3	1.7	0.00	0.01	0.00	0.9	E
11/29/2023 09:05:00	5.6	7.3	1.7	0.00	0.01	0.01	0.9	E
11/29/2023 09:06:00	5.6	7.2	1.6	0.00	0.01	0.01	0.9	E
11/29/2023 09:07:00	5.6	7.2	1.6	0.00	0.01	0.01	0.9	E
11/29/2023 09:08:00	5.9	7.2	1.3	0.00	0.01	0.01	0.9	ESE
11/29/2023 09:09:00	6.1	7.2	1.1	0.00	0.01	0.01	0.9	E
11/29/2023 09:10:00	6.1	7.2	1.1	0.00	0.01	0.01	0.9	ESE
11/29/2023 09:11:00	6.0	7.1	1.1	0.00	0.01	0.01	0.9	WNW
11/29/2023 09:12:00	6.0	7.1	1.0	0.00	0.01	0.01	0.9	E
11/29/2023 09:13:00	5.5	7.2	1.7	0.00	0.01	0.01	0.9	E

Date/Time	Average Upwind PM10 (µg/m³)	Average Downwind PM10 (µg/m³)	Average Contribution PM10 (µg/m³)	Average Upwind VOC (ppm)	Average Downwind VOC (ppm)	Average Contribution VOC (ppm)	Wind Speed 15 min Avg	Wind Direction
11/29/2023 09:14:00	5.4	7.3	1.9	0.00	0.01	0.01	0.8	S
11/29/2023 09:15:00	5.5	7.3	1.8	0.00	0.01	0.01	0.8	E
11/29/2023 09:16:00	5.6	7.3	1.8	0.00	0.01	0.01	0.8	E
11/29/2023 09:17:00	5.6	7.1	1.6	0.00	0.01	0.01	0.8	E
11/29/2023 09:18:00	5.5	5.0	-0.5	0.00	0.01	0.01	0.9	E
11/29/2023 09:19:00	5.5	4.9	-0.6	0.00	0.01	0.01	0.9	E
11/29/2023 09:20:00	5.4	4.9	-0.5	0.00	0.01	0.01	0.8	NNE
11/29/2023 09:21:00	5.4	5.0	-0.3	0.00	0.01	0.01	0.9	E
11/29/2023 09:22:00	5.4	5.0	-0.4	0.00	0.01	0.01	0.9	W
11/29/2023 09:23:00	5.0	5.0	0.0	0.00	0.01	0.01	0.9	ENE
11/29/2023 09:24:00	4.9	5.0	0.1	0.00	0.01	0.01	0.9	SSW
11/29/2023 09:25:00	4.8	5.1	0.3	0.00	0.01	0.01	0.9	E
11/29/2023 09:26:00	4.9	5.1	0.2	0.01	0.01	0.01	0.8	S
11/29/2023 09:27:00	4.8	5.1	0.3	0.01	0.01	0.01	0.8	E
11/29/2023 09:28:00	4.5	4.9	0.4	0.01	0.01	0.01	0.8	E
11/29/2023 09:29:00	4.3	4.8	0.6	0.01	0.01	0.01	0.8	E
11/29/2023 09:30:00	4.1	4.7	0.6	0.01	0.01	0.01	0.8	E
11/29/2023 09:31:00	4.0	4.7	0.8	0.01	0.01	0.01	0.9	ENE
11/29/2023 09:32:00	4.0	4.6	0.7	0.01	0.01	0.01	0.9	WSW
11/29/2023 09:33:00	4.0	4.6	0.6	0.01	0.01	0.00	0.9	WSW
11/29/2023 09:34:00	4.0	4.6	0.6	0.01	0.01	0.00	0.8	E
11/29/2023 09:35:00	4.1	4.5	0.4	0.01	0.01	0.00	0.8	WNW
11/29/2023 09:36:00	4.1	4.5	0.4	0.01	0.01	0.00	0.8	E
11/29/2023 09:37:00	4.0	4.7	0.7	0.01	0.01	0.00	0.8	E
11/29/2023 09:38:00	4.0	4.8	0.7	0.01	0.01	0.00	0.8	ENE
11/29/2023 09:39:00	4.1	4.8	0.7	0.01	0.01	0.00	0.8	NW
11/29/2023 09:40:00	4.1	4.8	0.7	0.01	0.01	0.00	0.8	E
11/29/2023 09:41:00	4.1	4.8	0.8	0.00	0.01	0.00	0.8	SSE
11/29/2023 09:42:00	4.1	4.9	0.7	0.00	0.01	0.00	0.8	ENE
11/29/2023 09:43:00	4.2	5.0	0.8	0.00	0.01	0.00	0.8	E
11/29/2023 09:44:00	4.3	4.8	0.5	0.00	0.01	0.00	0.8	SSW
11/29/2023 09:45:00	4.4	4.8	0.4	0.00	0.01	0.00	0.7	ESE

Date/Time	Average Upwind PM10 (µg/m³)	Average Downwind PM10 (µg/m³)	Average Contribution PM10 (µg/m³)	Average Upwind VOC (ppm)	Average Downwind VOC (ppm)	Average Contribution VOC (ppm)	Wind Speed 15 min Avg	Wind Direction
11/29/2023 09:46:00	4.4	4.9	0.5	0.00	0.01	0.00	0.7	E
11/29/2023 09:47:00	4.5	4.9	0.4	0.00	0.01	0.00	0.6	SW
11/29/2023 09:48:00	4.6	5.1	0.5	0.00	0.01	0.00	0.7	E
11/29/2023 09:49:00	4.7	5.0	0.3	0.00	0.01	0.00	0.7	SSE
11/29/2023 09:50:00	4.7	5.0	0.4	0.00	0.01	0.00	0.7	ESE
11/29/2023 09:51:00	4.8	5.1	0.3	0.00	0.01	0.00	0.7	ESE
11/29/2023 09:52:00	4.8	4.9	0.1	0.00	0.01	0.00	0.7	SW
11/29/2023 09:53:00	4.9	4.8	-0.1	0.00	0.01	0.00	0.7	ENE
11/29/2023 09:54:00	4.9	4.8	0.0	0.00	0.01	0.00	0.7	E
11/29/2023 09:55:00	4.9	4.7	-0.2	0.00	0.01	0.00	0.7	E
11/29/2023 09:56:00	4.9	4.7	-0.1	0.00	0.01	0.01	0.7	ENE
11/29/2023 09:57:00	4.8	4.8	-0.1	0.00	0.01	0.01	0.8	E
11/29/2023 09:58:00	4.9	4.7	-0.3	0.00	0.01	0.00	0.8	SW
11/29/2023 09:59:00	4.8	4.7	-0.1	0.00	0.01	0.01	0.8	ESE
11/29/2023 10:00:00	4.8	4.7	-0.1	0.00	0.01	0.01	0.8	ESE
11/29/2023 10:01:00	4.8	4.7	-0.1	0.00	0.01	0.01	0.8	SE
11/29/2023 10:02:00	4.6	4.9	0.3	0.00	0.01	0.01	0.8	NNE
11/29/2023 10:03:00	4.6	5.0	0.5	0.00	0.01	0.01	0.8	ESE
11/29/2023 10:04:00	4.5	5.2	0.7	0.00	0.01	0.01	0.7	ESE
11/29/2023 10:05:00	4.6	5.4	0.8	0.00	0.01	0.01	0.8	SW
11/29/2023 10:06:00	4.7	5.6	0.9	0.00	0.01	0.01	0.7	N
11/29/2023 10:07:00	5.0	5.8	0.8	0.00	0.01	0.01	0.7	SSW
11/29/2023 10:08:00	5.4	5.9	0.5	0.01	0.01	0.01	0.7	E
11/29/2023 10:09:00	5.5	6.1	0.6	0.01	0.01	0.01	0.8	W
11/29/2023 10:10:00	5.4	6.1	0.6	0.01	0.01	0.01	0.8	E
11/29/2023 10:11:00	5.5	6.1	0.6	0.01	0.01	0.01	0.8	E
11/29/2023 10:12:00	5.6	6.0	0.4	0.01	0.01	0.01	0.8	E
11/29/2023 10:13:00	5.6	6.3	0.7	0.01	0.01	0.01	0.8	ENE
11/29/2023 10:14:00	5.6	6.5	0.9	0.01	0.01	0.01	0.8	E
11/29/2023 10:15:00	5.7	6.7	1.0	0.01	0.01	0.01	0.8	E
11/29/2023 10:16:00	5.7	6.8	1.0	0.01	0.01	0.01	0.8	ESE
11/29/2023 10:17:00	5.8	6.8	0.9	0.01	0.01	0.01	0.8	NE

Date/Time	Average Upwind PM10 (µg/m³)	Average Downwind PM10 (µg/m³)	Average Contribution PM10 (µg/m³)	Average Upwind VOC (ppm)	Average Downwind VOC (ppm)	Average Contribution VOC (ppm)	Wind Speed 15 min Avg	Wind Direction
11/29/2023 10:18:00	5.9	6.7	0.8	0.01	0.01	0.01	0.8	SE
11/29/2023 10:19:00	6.0	6.6	0.6	0.01	0.01	0.01	0.8	E
11/29/2023 10:20:00	5.9	6.5	0.6	0.01	0.02	0.01	0.8	E
11/29/2023 10:21:00	5.8	6.3	0.5	0.01	0.02	0.01	0.8	ESE
11/29/2023 10:22:00	5.6	6.2	0.6	0.01	0.02	0.01	0.8	ESE
11/29/2023 10:23:00	5.2	6.2	1.0	0.00	0.02	0.01	0.8	ENE
11/29/2023 10:24:00	5.2	6.1	0.9	0.00	0.01	0.01	0.8	E
11/29/2023 10:25:00	5.2	6.2	1.0	0.00	0.02	0.02	0.8	ESE
11/29/2023 10:26:00	5.3	6.5	1.2	0.00	0.02	0.02	0.8	E
11/29/2023 10:27:00	5.2	6.5	1.4	0.00	0.02	0.02	0.8	E
11/29/2023 10:28:00	5.2	6.4	1.2	0.00	0.02	0.02	0.8	SE
11/29/2023 10:29:00	5.2	6.2	1.1	0.00	0.02	0.02	0.8	E
11/29/2023 10:30:00	5.2	6.0	0.8	0.00	0.01	0.01	0.8	W
11/29/2023 10:31:00	5.2	5.9	0.7	0.00	0.01	0.01	0.8	E
11/29/2023 10:32:00	5.2	5.9	0.7	0.00	0.01	0.01	0.7	E
11/29/2023 10:33:00	5.1	5.7	0.6	0.00	0.01	0.01	0.7	SE
11/29/2023 10:34:00	5.2	5.8	0.6	0.00	0.01	0.01	0.7	SSE
11/29/2023 10:35:00	5.2	5.7	0.6	0.00	0.01	0.01	0.8	E
11/29/2023 10:36:00	5.2	5.8	0.7	0.00	0.01	0.01	0.8	E
11/29/2023 10:37:00	5.2	5.8	0.6	0.00	0.01	0.01	0.8	SE
11/29/2023 10:38:00	5.2	5.8	0.7	0.00	0.01	0.01	0.7	ENE
11/29/2023 10:39:00	5.0	6.0	0.9	0.00	0.01	0.01	0.8	E
11/29/2023 10:40:00	5.0	6.4	1.5	0.00	0.01	0.01	0.7	E
11/29/2023 10:41:00	5.5	6.2	0.7	0.00	0.01	0.01	0.8	S
11/29/2023 10:42:00	5.5	6.2	0.8	0.00	0.01	0.01	0.8	SE
11/29/2023 10:43:00	5.3	6.3	1.0	0.00	0.01	0.01	0.7	ESE
11/29/2023 10:44:00	5.3	6.5	1.2	0.00	0.01	0.01	0.8	ESE
11/29/2023 10:45:00	5.4	6.6	1.2	0.00	0.01	0.01	0.8	WSW
11/29/2023 10:46:00	5.4	6.6	1.2	0.00	0.01	0.01	0.8	SE
11/29/2023 10:47:00	5.4	6.5	1.1	0.00	0.01	0.01	0.8	ENE
11/29/2023 10:48:00	5.6	6.7	1.2	0.00	0.01	0.01	0.8	ESE
11/29/2023 10:49:00	5.5	7.0	1.5	0.00	0.01	0.01	0.8	E

Date/Time	Average Upwind PM10 (µg/m³)	Average Downwind PM10 (µg/m³)	Average Contribution PM10 (µg/m³)	Average Upwind VOC (ppm)	Average Downwind VOC (ppm)	Average Contribution VOC (ppm)	Wind Speed 15 min Avg	Wind Direction
11/29/2023 10:50:00	5.6	7.2	1.6	0.00	0.01	0.01	0.8	ESE
11/29/2023 10:51:00	5.7	7.7	2.0	0.00	0.01	0.01	0.8	ESE
11/29/2023 10:52:00	5.6	8.3	2.7	0.00	0.01	0.01	0.8	ENE
11/29/2023 10:53:00	5.7	9.1	3.4	0.00	0.01	0.01	0.8	E
11/29/2023 10:54:00	5.7	9.1	3.3	0.00	0.01	0.01	0.8	ENE
11/29/2023 10:55:00	5.9	8.5	2.6	0.00	0.01	0.01	0.8	WSW
11/29/2023 10:56:00	5.4	8.6	3.2	0.00	0.01	0.01	0.8	W
11/29/2023 10:57:00	5.6	8.6	3.0	0.00	0.01	0.01	0.8	SE
11/29/2023 10:58:00	5.8	8.7	2.9	0.00	0.01	0.01	0.8	E
11/29/2023 10:59:00	5.9	9.0	3.1	0.00	0.01	0.01	0.8	E
11/29/2023 11:00:00	6.0	9.4	3.4	0.00	0.01	0.01	0.8	ESE
11/29/2023 11:01:00				0.00	0.01	0.01	0.8	E
11/29/2023 11:02:00				0.00	0.01	0.01	0.9	SW
11/29/2023 11:03:00				0.00	0.01	0.00	0.9	SSW
11/29/2023 11:04:00	4.5	15.7	11.2	0.00	0.01	0.00	0.8	ENE
11/29/2023 11:05:00	5.0	12.3	7.4	0.00	0.01	0.01	0.8	E
11/29/2023 11:06:00	5.3	10.4	5.2	0.00	0.01	0.01	0.8	E
11/29/2023 11:07:00	5.5	9.1	3.6	0.00	0.01	0.00	0.8	SSE
11/29/2023 11:08:00	5.4	8.3	2.8	0.00	0.01	0.00	0.8	E
11/29/2023 11:09:00	5.3	7.8	2.5	0.00	0.01	0.00	0.8	E
11/29/2023 11:10:00	5.3	8.6	3.4	0.00	0.01	0.01	0.9	E
11/29/2023 11:11:00	5.3	9.5	4.1	0.00	0.01	0.01	0.9	E
11/29/2023 11:12:00	5.3	10.1	4.8	0.00	0.01	0.01	0.8	ESE
11/29/2023 11:13:00	5.3	10.2	4.9	0.00	0.01	0.01	0.8	ESE
11/29/2023 11:14:00	5.3	10.0	4.7	0.00	0.01	0.01	0.8	ENE
11/29/2023 11:15:00	5.3	9.8	4.6	0.00	0.01	0.01	0.8	ESE
11/29/2023 11:16:00	5.3	9.8	4.5	0.00	0.01	0.01	0.8	E
11/29/2023 11:17:00	5.3	9.8	4.5	0.00	0.02	0.01	0.7	E
11/29/2023 11:18:00	5.2	9.5	4.3	0.00	0.02	0.02	0.7	E
11/29/2023 11:19:00	5.3	8.8	3.5	0.00	0.02	0.02	0.8	ESE
11/29/2023 11:20:00	5.2	8.7	3.5	0.00	0.02	0.02	0.8	E
11/29/2023 11:21:00	5.2	8.8	3.6	0.00	0.02	0.02	0.8	E

Date/Time	Average Upwind PM10 (µg/m³)	Average Downwind PM10 (µg/m³)	Average Contribution PM10 (µg/m³)	Average Upwind VOC (ppm)	Average Downwind VOC (ppm)	Average Contribution VOC (ppm)	Wind Speed 15 min Avg	Wind Direction
11/29/2023 11:22:00	5.1	9.1	4.0	0.00	0.02	0.02	0.8	ENE
11/29/2023 11:23:00	5.2	9.1	4.0	0.00	0.02	0.02	0.8	WSW
11/29/2023 11:24:00	5.2	9.2	3.9	0.00	0.02	0.01	0.8	E
11/29/2023 11:25:00	5.3	8.6	3.3	0.01	0.02	0.01	0.8	E
11/29/2023 11:26:00	5.4	8.0	2.6	0.01	0.02	0.01	0.8	WSW
11/29/2023 11:27:00	5.4	8.0	2.6	0.01	0.02	0.01	0.8	E
11/29/2023 11:28:00	5.4	10.3	4.9	0.01	0.02	0.01	0.8	E
11/29/2023 11:29:00	5.3	11.1	5.8	0.01	0.02	0.01	0.8	E
11/29/2023 11:30:00	5.3	10.9	5.7	0.01	0.01	0.01	0.8	ENE
11/29/2023 11:31:00	5.3	10.8	5.5	0.01	0.01	0.01	0.8	ENE
11/29/2023 11:32:00	5.3	10.4	5.1	0.01	0.01	0.01	0.8	WSW
11/29/2023 11:33:00	5.3	10.5	5.2	0.01	0.01	0.01	0.8	NE
11/29/2023 11:34:00	5.3	10.4	5.1	0.01	0.01	0.01	0.8	E
11/29/2023 11:35:00	5.3	10.2	4.9	0.01	0.01	0.01	0.8	E
11/29/2023 11:36:00	5.2	9.9	4.7	0.01	0.01	0.01	0.8	ENE
11/29/2023 11:37:00	5.2	9.5	4.4	0.01	0.01	0.01	0.8	NE
11/29/2023 11:38:00	5.0	9.5	4.4	0.01	0.01	0.01	0.8	ESE
11/29/2023 11:39:00	4.9	9.3	4.4	0.00	0.01	0.01	0.8	E
11/29/2023 11:40:00	4.7	9.3	4.6	0.00	0.01	0.01	0.8	W
11/29/2023 11:41:00	4.7	9.2	4.5	0.00	0.01	0.01	0.8	NNW
11/29/2023 11:42:00	4.6	8.5	3.9	0.00	0.01	0.01	0.8	WSW
11/29/2023 11:43:00	4.7	5.8	1.1	0.00	0.01	0.01	0.8	ESE
11/29/2023 11:44:00	4.7	4.7	0.0	0.00	0.01	0.01	0.8	E
11/29/2023 11:45:00	4.8	4.7	-0.1	0.00	0.01	0.01	0.8	ESE
11/29/2023 11:46:00	4.7	4.6	-0.1	0.00	0.01	0.01	0.8	E
11/29/2023 11:47:00	4.7	4.6	-0.1	0.00	0.01	0.01	0.8	SE
11/29/2023 11:48:00	5.0	4.5	-0.5	0.00	0.01	0.01	0.8	WSW
11/29/2023 11:49:00	5.0	5.4	0.4	0.00	0.01	0.01	0.7	ENE
11/29/2023 11:50:00	5.1	5.6	0.5	0.01	0.01	0.00	0.7	NE
11/29/2023 11:51:00	5.1	5.9	0.8	0.01	0.01	0.00	0.6	E
11/29/2023 11:52:00	5.2	6.1	0.9	0.01	0.01	0.00	0.6	E
11/29/2023 11:53:00	5.3	6.3	1.0	0.01	0.01	0.00	0.6	SSW

Date/Time	Average Upwind PM10 (µg/m³)	Average Downwind PM10 (µg/m³)	Average Contribution PM10 (µg/m³)	Average Upwind VOC (ppm)	Average Downwind VOC (ppm)	Average Contribution VOC (ppm)	Wind Speed 15 min Avg	Wind Direction
11/29/2023 11:54:00	5.4	6.4	1.0	0.01	0.01	0.00	0.6	E
11/29/2023 11:55:00	5.5	6.4	0.8	0.01	0.01	0.00	0.7	ESE
11/29/2023 11:56:00	5.5	6.4	1.0	0.01	0.01	0.00	0.7	SSE
11/29/2023 11:57:00	5.5	6.5	1.0	0.01	0.01	0.00	0.7	E
11/29/2023 11:58:00	5.5	6.6	1.1	0.01	0.01	0.00	0.7	ENE
11/29/2023 11:59:00	5.6	6.7	1.1	0.01	0.01	0.00	0.7	E
11/29/2023 12:00:00	5.6	6.7	1.1	0.01	0.01	0.00	0.7	S
11/29/2023 12:01:00	5.6	6.8	1.1	0.01	0.01	0.00	0.7	ESE
11/29/2023 12:02:00	5.7	6.8	1.1	0.01	0.01	0.00	0.7	SE
11/29/2023 12:03:00	5.4	6.8	1.4	0.01	0.01	0.00	0.7	W
11/29/2023 12:04:00	5.4	6.0	0.6	0.01	0.01	0.00	0.8	E
11/29/2023 12:05:00	5.3	5.9	0.6	0.00	0.01	0.01	0.8	E
11/29/2023 12:06:00	5.3	5.7	0.3	0.00	0.01	0.01	0.8	W
11/29/2023 12:07:00	5.4	5.5	0.1	0.01	0.01	0.00	0.8	WSW
11/29/2023 12:08:00	5.4	5.3	0.0	0.01	0.01	0.00	0.8	WSW
11/29/2023 12:09:00	5.3	5.3	0.0	0.01	0.01	0.00	0.8	NNW
11/29/2023 12:10:00	5.3	5.3	0.0	0.01	0.01	0.00	0.8	ESE
11/29/2023 12:11:00	5.3	5.2	0.0	0.01	0.01	0.00	0.8	ESE
11/29/2023 12:12:00	5.2	5.1	-0.1	0.01	0.01	0.00	0.8	E
11/29/2023 12:13:00	5.1	5.0	-0.1	0.01	0.01	0.00	0.8	ESE
11/29/2023 12:14:00	5.0	4.8	-0.2	0.01	0.01	0.00	0.8	E
11/29/2023 12:15:00	4.9	4.8	-0.2	0.01	0.01	0.01	0.8	E
11/29/2023 12:16:00	4.9	4.7	-0.2	0.01	0.01	0.00	0.8	ESE
11/29/2023 12:17:00	4.9	4.7	-0.3	0.01	0.01	0.00	0.8	W
11/29/2023 12:18:00	4.9	4.6	-0.3	0.01	0.01	0.00	0.8	ENE
11/29/2023 12:19:00	4.9	4.6	-0.3	0.01	0.01	0.00	0.8	SW
11/29/2023 12:20:00	4.9	4.5	-0.4	0.01	0.01	0.00	0.8	SSW
11/29/2023 12:21:00	4.9	4.5	-0.4	0.01	0.01	0.00	0.7	ESE
11/29/2023 12:22:00	4.8	4.4	-0.3	0.01	0.01	0.00	0.7	ENE
11/29/2023 12:23:00	4.7	4.4	-0.3	0.01	0.01	0.00	0.7	SW
11/29/2023 12:24:00	4.7	4.4	-0.3	0.01	0.01	0.00	0.7	WSW
11/29/2023 12:25:00	4.6	4.4	-0.3	0.01	0.01	0.00	0.7	E

Date/Time	Average Upwind PM10 (µg/m³)	Average Downwind PM10 (µg/m³)	Average Contribution PM10 (µg/m³)	Average Upwind VOC (ppm)	Average Downwind VOC (ppm)	Average Contribution VOC (ppm)	Wind Speed 15 min Avg	Wind Direction
11/29/2023 12:26:00	4.6	4.4	-0.2	0.01	0.01	0.00	0.7	ESE
11/29/2023 12:27:00	4.7	4.5	-0.2	0.01	0.01	0.00	0.7	W
11/29/2023 12:28:00	4.7	4.6	-0.1	0.01	0.01	0.00	0.6	ENE
11/29/2023 12:29:00	4.7	4.9	0.1	0.01	0.01	0.00	0.6	SE
11/29/2023 12:30:00	5.2	5.0	-0.2	0.01	0.01	0.00	0.6	SSE
11/29/2023 12:31:00	5.5	5.3	-0.2	0.01	0.01	0.00	0.6	ESE
11/29/2023 12:32:00	5.6	5.5	-0.1	0.01	0.01	0.00	0.6	E
11/29/2023 12:33:00	5.9	5.7	-0.2	0.01	0.01	0.00	0.6	S
11/29/2023 12:34:00	6.3	5.9	-0.3	0.01	0.01	0.00	0.6	W
11/29/2023 12:35:00	6.7	6.2	-0.6	0.01	0.01	0.00	0.6	SW
11/29/2023 12:36:00	6.9	6.3	-0.6	0.01	0.01	-0.01	0.7	NE
11/29/2023 12:37:00	7.0	6.4	-0.6	0.01	0.01	-0.01	0.7	E
11/29/2023 12:38:00	7.2	6.5	-0.7	0.02	0.01	-0.01	0.7	ESE
11/29/2023 12:39:00	7.4	6.6	-0.8	0.02	0.01	-0.01	0.6	E
11/29/2023 12:40:00	7.5	6.8	-0.6	0.02	0.01	-0.01	0.6	NW
11/29/2023 12:41:00	7.7	7.0	-0.7	0.01	0.01	-0.01	0.6	ESE
11/29/2023 12:42:00	8.0	7.3	-0.7	0.01	0.01	-0.01	0.6	E
11/29/2023 12:43:00	8.2	7.7	-0.5	0.01	0.01	-0.01	0.6	E
11/29/2023 12:44:00	8.7	7.8	-0.9	0.01	0.01	-0.01	0.6	E
11/29/2023 12:45:00	8.7	8.0	-0.7	0.01	0.01	0.00	0.6	E
11/29/2023 12:46:00	9.0	8.3	-0.7	0.01	0.01	0.00	0.6	E
11/29/2023 12:47:00	9.3	8.6	-0.7	0.01	0.01	-0.01	0.6	W
11/29/2023 12:48:00	9.3	8.7	-0.6	0.01	0.01	0.00	0.6	E
11/29/2023 12:49:00	9.2	8.9	-0.3	0.01	0.01	0.00	0.7	ESE
11/29/2023 12:50:00	8.9	9.0	0.1	0.01	0.01	0.00	0.6	E
11/29/2023 12:51:00	9.0	9.2	0.2	0.01	0.01	0.00	0.6	ENE
11/29/2023 12:52:00	9.2	9.4	0.2	0.01	0.01	0.00	0.6	SW
11/29/2023 12:53:00	9.3	9.6	0.3	0.01	0.01	0.01	0.6	E
11/29/2023 12:54:00	9.7	9.9	0.2	0.01	0.01	0.01	0.6	ENE
11/29/2023 12:55:00	9.9	10.3	0.4	0.01	0.01	0.01	0.7	E
11/29/2023 12:56:00	10.1	10.3	0.2	0.01	0.01	0.01	0.7	SW
11/29/2023 12:57:00	10.1	10.1	0.0	0.01	0.01	0.00	0.7	WSW

Date/Time	Average Upwind PM10 (µg/m³)	Average Downwind PM10 (µg/m³)	Average Contribution PM10 (µg/m³)	Average Upwind VOC (ppm)	Average Downwind VOC (ppm)	Average Contribution VOC (ppm)	Wind Speed 15 min Avg	Wind Direction
11/29/2023 12:58:00	10.1	11.0	0.9	0.01	0.01	0.00	0.7	ESE
11/29/2023 12:59:00	9.8	11.0	1.1	0.01	0.01	0.00	0.7	ENE
11/29/2023 13:00:00	9.7	10.8	1.2	0.01	0.01	0.00	0.7	ESE
11/29/2023 13:01:00	9.3	10.4	1.1	0.01	0.01	0.00	0.7	E
11/29/2023 13:02:00	9.0	10.1	1.0	0.01	0.01	0.01	0.7	E
11/29/2023 13:03:00	8.9	9.9	1.0	0.01	0.01	0.01	0.7	SE
11/29/2023 13:04:00	8.8	9.7	0.9	0.01	0.01	0.01	0.7	E
11/29/2023 13:05:00	8.7	9.5	0.8	0.01	0.01	0.01	0.7	E
11/29/2023 13:06:00	8.5	9.3	0.8	0.01	0.01	0.01	0.7	SE
11/29/2023 13:07:00	8.3	9.2	0.9	0.01	0.01	0.01	0.8	SE
11/29/2023 13:08:00	8.2	9.0	0.9	0.01	0.01	0.01	0.8	E
11/29/2023 13:09:00	7.7	8.8	1.1	0.00	0.01	0.01	0.8	ESE
11/29/2023 13:10:00	7.5	8.3	0.8	0.00	0.01	0.01	0.9	SW
11/29/2023 13:11:00	7.3	8.2	0.9	0.00	0.01	0.01	0.9	SSW
11/29/2023 13:12:00	6.9	8.4	1.4	0.00	0.01	0.01	0.9	ESE
11/29/2023 13:13:00	6.8	7.0	0.2	0.00	0.01	0.01	0.9	E
11/29/2023 13:14:00	6.6	6.9	0.3	0.00	0.01	0.01	0.9	NE
11/29/2023 13:15:00	6.4	6.8	0.5	0.00	0.01	0.01	1.0	ENE
11/29/2023 13:16:00	6.2	6.8	0.6	0.00	0.01	0.01	1.0	SE
11/29/2023 13:17:00	6.2	6.7	0.5	0.00	0.01	0.01	1.0	SE
11/29/2023 13:18:00	6.3	6.9	0.6	0.00	0.01	0.01	1.0	E
11/29/2023 13:19:00	6.4	6.9	0.5	0.00	0.01	0.01	1.0	W
11/29/2023 13:20:00	6.6	6.9	0.3	0.00	0.02	0.02	0.9	WSW
11/29/2023 13:21:00	6.9	7.0	0.1	0.01	0.03	0.03	0.9	W
11/29/2023 13:22:00	6.9	7.2	0.2	0.03	0.03	0.01	0.9	ESE
11/29/2023 13:23:00	7.0	7.2	0.2	0.06	0.04	-0.02	0.8	ENE
11/29/2023 13:24:00	7.0	7.2	0.2	0.09	0.04	-0.05	0.8	ESE
11/29/2023 13:25:00	7.0	7.1	0.1	0.10	0.04	-0.06	0.8	SE
11/29/2023 13:26:00	6.9	7.2	0.3	0.10	0.05	-0.05	0.8	WSW
11/29/2023 13:27:00	6.9	6.9	0.0	0.10	0.05	-0.05	0.8	SW
11/29/2023 13:28:00	6.9	6.8	0.0	0.10	0.05	-0.05	0.7	SW
11/29/2023 13:29:00	7.3	7.0	-0.3	0.10	0.06	-0.04	0.7	SW

Date/Time	Average Upwind PM10 (µg/m³)	Average Downwind PM10 (µg/m³)	Average Contribution PM10 (µg/m³)	Average Upwind VOC (ppm)	Average Downwind VOC (ppm)	Average Contribution VOC (ppm)	Wind Speed 15 min Avg	Wind Direction
11/29/2023 13:30:00	7.5	7.0	-0.5	0.11	0.06	-0.05	0.7	E
11/29/2023 13:31:00	7.8	7.0	-0.7	0.11	0.06	-0.05	0.6	ESE
11/29/2023 13:32:00	7.8	7.0	-0.7	0.11	0.06	-0.05	0.6	W
11/29/2023 13:33:00	7.6	6.8	-0.8	0.12	0.06	-0.05	0.6	E
11/29/2023 13:34:00	7.6	6.7	-0.9	0.12	0.06	-0.06	0.6	E
11/29/2023 13:35:00	7.5	6.7	-0.9	0.12	0.05	-0.07	0.6	E
11/29/2023 13:36:00	7.3	6.8	-0.6	0.12	0.04	-0.08	0.6	SSE
11/29/2023 13:37:00	7.3	6.5	-0.8	0.10	0.04	-0.06	0.6	ENE
11/29/2023 13:38:00	7.3	6.4	-0.9	0.07	0.04	-0.03	0.7	E
11/29/2023 13:39:00	7.2	6.3	-0.9	0.04	0.04	-0.01	0.7	ENE
11/29/2023 13:40:00	7.1	6.3	-0.8	0.03	0.04	0.01	0.7	ESE
11/29/2023 13:41:00	7.0	6.3	-0.8	0.03	0.03	0.00	0.7	WSW
11/29/2023 13:42:00	7.2	6.3	-0.9	0.03	0.03	-0.01	0.7	E
11/29/2023 13:43:00	7.5	6.4	-1.1	0.04	0.02	-0.01	0.7	ESE
11/29/2023 13:44:00	7.1	6.3	-0.9	0.04	0.02	-0.02	0.7	E
11/29/2023 13:45:00	6.9	6.3	-0.6	0.04	0.02	-0.02	0.7	W
11/29/2023 13:46:00	6.6	6.7	0.1	0.03	0.02	-0.01	0.7	SW
11/29/2023 13:47:00	6.6	6.6	0.0	0.04	0.02	-0.02	0.8	E
11/29/2023 13:48:00	6.6	6.3	-0.3	0.03	0.02	-0.01	0.8	ENE
11/29/2023 13:49:00	6.5	6.1	-0.5	0.03	0.02	-0.01	0.8	E
11/29/2023 13:50:00	6.3	6.2	0.0	0.03	0.02	-0.01	0.8	SW
11/29/2023 13:51:00	6.3	6.0	-0.3	0.03	0.02	-0.01	0.8	SW
11/29/2023 13:52:00	6.2	5.9	-0.2	0.03	0.02	-0.01	0.8	SW
11/29/2023 13:53:00	6.2	5.9	-0.3	0.03	0.02	-0.01	0.8	W
11/29/2023 13:54:00	6.2	5.9	-0.3	0.03	0.02	-0.01	0.8	E
11/29/2023 13:55:00	6.2	6.0	-0.2	0.03	0.02	-0.01	0.8	SSE
11/29/2023 13:56:00	6.2	5.8	-0.4	0.03	0.02	-0.01	0.8	E
11/29/2023 13:57:00	6.0	5.8	-0.3	0.03	0.02	0.00	0.8	E
11/29/2023 13:58:00	5.7	5.7	0.0	0.02	0.02	0.00	0.9	E
11/29/2023 13:59:00	5.6	5.6	-0.1	0.01	0.02	0.01	0.9	E
11/29/2023 14:00:00	5.8	5.3	-0.5	0.01	0.02	0.00	0.9	ESE
11/29/2023 14:01:00	6.0	4.8	-1.2	0.01	0.01	0.00	1.0	E

Date/Time	Average Upwind PM10 (µg/m³)	Average Downwind PM10 (µg/m³)	Average Contribution PM10 (µg/m³)	Average Upwind VOC (ppm)	Average Downwind VOC (ppm)	Average Contribution VOC (ppm)	Wind Speed 15 min Avg	Wind Direction
11/29/2023 14:02:00	6.8	4.8	-2.0	0.01	0.01	0.01	0.9	ENE
11/29/2023 14:03:00	6.8	5.4	-1.4	0.01	0.01	0.01	1.0	SSE
11/29/2023 14:04:00	6.6	5.5	-1.1	0.01	0.01	0.01	1.0	E
11/29/2023 14:05:00	6.7	5.2	-1.5	0.01	0.01	0.01	1.0	ESE
11/29/2023 14:06:00	6.9	5.2	-1.7	0.01	0.01	0.00	1.0	E
11/29/2023 14:07:00	7.4	5.1	-2.3	0.01	0.01	0.00	1.1	E
11/29/2023 14:08:00	7.7	5.1	-2.6	0.01	0.01	0.00	1.1	E
11/29/2023 14:09:00	7.7	5.1	-2.7	0.01	0.01	0.00	1.2	E
11/29/2023 14:10:00	8.0	4.9	-3.0	0.01	0.01	0.00	1.2	E
11/29/2023 14:11:00	8.1	5.0	-3.1	0.01	0.01	0.00	1.2	ESE
11/29/2023 14:12:00	8.0	5.1	-3.0	0.01	0.00	0.00	1.2	S
11/29/2023 14:13:00	8.1	5.0	-3.2	0.01	0.00	0.00	1.1	E
11/29/2023 14:14:00	8.2	4.9	-3.3	0.01	0.01	0.00	1.1	E
11/29/2023 14:15:00	8.2	4.8	-3.4	0.01	0.01	0.00	1.2	E
11/29/2023 14:16:00	8.1	4.8	-3.3	0.01	0.01	0.00	1.1	ESE
11/29/2023 14:17:00	7.8	4.8	-3.0	0.01	0.01	-0.01	1.1	SE
11/29/2023 14:18:00	7.9	4.4	-3.5	0.01	0.01	0.00	1.1	ESE
11/29/2023 14:19:00	8.1	4.4	-3.7	0.01	0.01	0.00	1.1	E
11/29/2023 14:20:00	8.1	4.4	-3.7	0.01	0.01	0.00	1.1	E
11/29/2023 14:21:00	8.0	4.3	-3.6	0.01	0.01	0.00	1.1	E
11/29/2023 14:22:00	7.6	4.2	-3.4	0.01	0.01	0.00	1.1	ESE
11/29/2023 14:23:00	7.7	4.2	-3.5	0.01	0.00	0.00	1.1	SE
11/29/2023 14:24:00	7.7	4.2	-3.4	0.01	0.00	0.00	1.0	SE
11/29/2023 14:25:00	7.7	4.4	-3.3	0.01	0.01	0.00	1.0	ENE
11/29/2023 14:26:00	7.7	4.4	-3.3	0.01	0.01	0.00	1.0	E
11/29/2023 14:27:00	7.9	4.3	-3.6	0.00	0.01	0.00	1.0	ENE
11/29/2023 14:28:00	7.9	4.5	-3.4	0.00	0.01	0.00	1.1	ENE
11/29/2023 14:29:00	8.0	5.2	-2.8	0.00	0.01	0.00	1.1	E
11/29/2023 14:30:00	8.2	5.6	-2.5	0.00	0.01	0.01	1.0	E
11/29/2023 14:31:00	8.2	6.0	-2.2	0.00	0.01	0.01	1.1	E
11/29/2023 14:32:00	7.9	6.1	-1.8	0.00	0.01	0.01	1.0	ESE
11/29/2023 14:33:00	7.9	6.1	-1.9	0.00	0.01	0.01	1.0	NNE

Date/Time	Average Upwind PM10 (µg/m³)	Average Downwind PM10 (µg/m³)	Average Contribution PM10 (µg/m³)	Average Upwind VOC (ppm)	Average Downwind VOC (ppm)	Average Contribution VOC (ppm)	Wind Speed 15 min Avg	Wind Direction
11/29/2023 14:34:00	7.7	6.3	-1.4	0.00	0.01	0.01	1.0	SW
11/29/2023 14:35:00	7.7	6.5	-1.2	0.00	0.01	0.01	0.9	SSE
11/29/2023 14:36:00	7.8	7.0	-0.8	0.00	0.01	0.01	0.9	SE
11/29/2023 14:37:00	7.8	7.2	-0.6	0.00	0.01	0.01	0.9	E
11/29/2023 14:38:00	7.8	7.4	-0.4	0.00	0.01	0.01	0.9	E
11/29/2023 14:39:00	7.8	7.3	-0.4	0.00	0.01	0.01	0.9	E
11/29/2023 14:40:00	7.5	7.3	-0.3	0.00	0.00	0.00	0.9	SSE
11/29/2023 14:41:00	7.4	7.2	-0.2	0.00	0.00	0.00	0.9	E
11/29/2023 14:42:00	7.4	7.2	-0.2	0.00	0.00	0.00	0.9	E
11/29/2023 14:43:00	7.5	7.1	-0.4	0.00	0.00	0.00	0.8	E
11/29/2023 14:44:00	7.2	6.5	-0.7	0.00	0.00	0.00	0.8	E
11/29/2023 14:45:00	7.1	6.3	-0.8	0.00	0.00	0.00	0.8	E
11/29/2023 14:46:00	7.0	6.0	-1.0	0.00	0.00	0.00	0.9	SE
11/29/2023 14:47:00	6.8	6.0	-0.8	0.00	0.00	0.00	0.9	ESE
11/29/2023 14:48:00	6.9	6.0	-0.9	0.00	0.00	0.00	0.9	E
11/29/2023 14:49:00	7.7	5.9	-1.8	0.00	0.00	0.00	0.9	ENE
11/29/2023 14:50:00	8.8	5.9	-2.9	0.00	0.00	0.00	1.0	E
11/29/2023 14:51:00	9.2	5.7	-3.4	0.00	0.00	0.00	1.0	ESE
11/29/2023 14:52:00	10.8	5.9	-5.0	0.00	0.00	0.00	1.0	E
11/29/2023 14:53:00	10.7	6.3	-4.5	0.00	0.00	0.00	0.9	E
11/29/2023 14:54:00	11.1	7.4	-3.7	0.00	0.00	0.00	0.9	SSW
11/29/2023 14:55:00	11.8	10.3	-1.5	0.00	0.00	0.00	0.9	W
11/29/2023 14:56:00	12.6	11.5	-1.1	0.00	0.00	0.00	0.9	WSW
11/29/2023 14:57:00	14.1	13.2	-0.8	0.00	0.00	0.00	0.8	E
11/29/2023 14:58:00	16.0	14.6	-1.4	0.00	0.00	0.00	0.8	E
11/29/2023 14:59:00				0.00	0.00	0.00	0.8	S
11/29/2023 15:00:00				0.00	0.01	0.00	0.8	S
11/29/2023 15:01:00	10.5	12.3	1.7	0.00	0.01	0.00	0.8	WSW
11/29/2023 15:02:00	22.7	13.4	-9.3	0.01	0.01	0.00	0.7	ENE
11/29/2023 15:03:00	29.7	13.5	-16.3	0.01	0.01	0.01	0.7	ENE
11/29/2023 15:04:00	26.5	16.0	-10.5	0.01	0.01	0.01	0.6	SSE
11/29/2023 15:05:00	28.9	18.4	-10.5	0.01	0.01	0.00	0.6	E

Date/Time	Average Upwind PM10 (µg/m³)	Average Downwind PM10 (µg/m³)	Average Contribution PM10 (µg/m³)	Average Upwind VOC (ppm)	Average Downwind VOC (ppm)	Average Contribution VOC (ppm)	Wind Speed 15 min Avg	Wind Direction
11/29/2023 15:06:00	28.6	26.5	-2.1	0.02	0.02	0.00	0.6	E
11/29/2023 15:07:00	32.9	27.6	-5.3	0.02	0.02	0.00	0.6	W
11/29/2023 15:08:00	36.5	26.5	-10.0	0.02	0.02	0.00	0.6	WSW
11/29/2023 15:09:00	33.9	27.5	-6.3	0.02	0.02	0.00	0.6	ENE
11/29/2023 15:10:00	33.5	26.0	-7.5	0.02	0.02	0.00	0.6	SW
11/29/2023 15:11:00	31.9	26.2	-5.7	0.02	0.02	0.00	0.6	ESE
11/29/2023 15:12:00	30.8	25.6	-5.2	0.02	0.03	0.00	0.6	WSW
11/29/2023 15:13:00	30.6	25.4	-5.1	0.02	0.03	0.00	0.6	WSW
11/29/2023 15:14:00	30.1	24.7	-5.4	0.02	0.03	0.00	0.6	WSW
11/29/2023 15:15:00	29.4	24.4	-5.0	0.03	0.03	0.00	0.6	SSW
11/29/2023 15:16:00	30.8	33.0	2.2	0.03	0.03	0.00	0.6	SSW
11/29/2023 15:17:00	30.2	49.7	19.5	0.02	0.03	0.00	0.6	SW
11/29/2023 15:18:00	36.9	50.3	13.4	0.03	0.03	0.00	0.6	E
11/29/2023 15:19:00	46.9	50.5	3.7	0.02	0.02	0.00	0.6	ESE
11/29/2023 15:20:00	47.1	49.8	2.7	0.02	0.02	0.00	0.6	E
11/29/2023 15:21:00	48.6	46.3	-2.3	0.02	0.02	0.01	0.6	E
11/29/2023 15:22:00	52.5	45.6	-6.8	0.02	0.02	0.00	0.6	ENE
11/29/2023 15:23:00	65.6	46.9	-18.7	0.02	0.02	0.00	0.6	E
11/29/2023 15:24:00	67.3	46.2	-21.1	0.02	0.02	0.00	0.6	E
11/29/2023 15:25:00	76.5	47.0	-29.6	0.02	0.02	0.00	0.6	ESE
11/29/2023 15:26:00	77.3	49.8	-27.4	0.02	0.02	0.00	0.7	S
11/29/2023 15:27:00	80.3	49.8	-30.5	0.02	0.02	0.00	0.7	ESE
11/29/2023 15:28:00	79.7	50.6	-29.0	0.02	0.01	0.00	0.7	WSW
11/29/2023 15:29:00	79.0	50.6	-28.3	0.02	0.02	0.00	0.6	WSW
11/29/2023 15:30:00	78.8	51.0	-27.8	0.02	0.02	0.00	0.6	SSW
11/29/2023 15:31:00	77.6	42.7	-34.9	0.02	0.01	0.00	0.6	WSW
11/29/2023 15:32:00	76.8	25.8	-51.1	0.02	0.01	-0.01	0.6	E
11/29/2023 15:33:00	68.7	24.8	-43.8	0.02	0.01	-0.01	0.7	ENE
11/29/2023 15:34:00	59.3	23.5	-35.8	0.02	0.01	-0.01	0.7	E
11/29/2023 15:35:00	57.1	22.8	-34.3	0.02	0.01	-0.01	0.8	ESE
11/29/2023 15:36:00	54.3	22.2	-32.1	0.01	0.01	0.00	0.8	E
11/29/2023 15:37:00	47.0	20.9	-26.1	0.01	0.01	0.00	0.8	E

Date/Time	Average Upwind PM10 (µg/m³)	Average Downwind PM10 (µg/m³)	Average Contribution PM10 (µg/m³)	Average Upwind VOC (ppm)	Average Downwind VOC (ppm)	Average Contribution VOC (ppm)	Wind Speed 15 min Avg	Wind Direction
11/29/2023 15:38:00	30.5	18.8	-11.7	0.01	0.01	0.00	0.9	E
11/29/2023 15:39:00	28.8	17.8	-11.0	0.01	0.01	0.00	0.9	NE
11/29/2023 15:40:00	18.2	19.3	1.1	0.01	0.01	0.00	0.9	WSW
11/29/2023 15:41:00	19.1	15.0	-4.1	0.01	0.01	0.00	0.9	E
11/29/2023 15:42:00	16.3	14.2	-2.1	0.01	0.01	-0.01	0.9	E
11/29/2023 15:43:00	17.4	12.5	-4.8	0.01	0.01	-0.01	0.9	NE
11/29/2023 15:44:00	18.8	12.7	-6.1	0.01	0.01	-0.01	0.9	ESE
11/29/2023 15:45:00	19.0	16.5	-2.4	0.01	0.01	-0.01	0.9	S
11/29/2023 15:46:00	20.8	19.5	-1.3	0.01	0.01	-0.01	0.9	SW
11/29/2023 15:47:00	21.6	20.9	-0.7	0.01	0.01	-0.01	0.9	WSW
11/29/2023 15:48:00	21.4	22.8	1.4	0.01	0.01	0.00	0.9	W
11/29/2023 15:49:00	21.7	23.3	1.6	0.01	0.01	-0.01	0.9	E
11/29/2023 15:50:00	24.0	24.8	0.8	0.02	0.01	-0.01	0.9	ESE
11/29/2023 15:51:00	25.8	27.6	1.8	0.02	0.01	-0.01	0.9	SW
11/29/2023 15:52:00	28.0	29.1	1.1	0.02	0.01	-0.01	0.8	NE
11/29/2023 15:53:00	29.3	30.2	0.9	0.02	0.01	-0.01	0.8	WSW
11/29/2023 15:54:00	29.6	31.0	1.5	0.02	0.02	0.00	0.7	W
11/29/2023 15:55:00	31.1	28.8	-2.3	0.03	0.02	-0.01	0.7	E
11/29/2023 15:56:00	29.4	29.6	0.3	0.03	0.02	0.00	0.7	WSW
11/29/2023 15:57:00	28.8	30.4	1.6	0.02	0.03	0.01	0.7	SSE
11/29/2023 15:58:00	28.8	30.4	1.6	0.03	0.03	0.00	0.7	E
11/29/2023 15:59:00	28.2	29.7	1.6	0.04	0.03	-0.01	0.7	E
11/29/2023 16:00:00	27.9	24.7	-3.3	0.04	0.03	-0.01	0.7	ESE
11/29/2023 16:01:00	26.1	21.1	-5.0	0.04	0.03	-0.01	0.7	ESE
11/29/2023 16:02:00	25.1	19.4	-5.7	0.04	0.03	-0.01	0.8	ESE
11/29/2023 16:03:00	24.5	17.2	-7.3	0.04	0.03	-0.01	0.8	E
11/29/2023 16:04:00	23.1	16.6	-6.5	0.03	0.03	-0.01	0.8	E
11/29/2023 16:05:00	20.6	15.2	-5.4	0.03	0.03	-0.01	0.8	ENE
11/29/2023 16:06:00	18.9	12.3	-6.6	0.03	0.02	-0.01	0.8	E
11/29/2023 16:07:00	16.8	10.7	-6.1	0.03	0.02	0.00	0.9	E
11/29/2023 16:08:00	15.2	10.0	-5.2	0.03	0.02	-0.01	0.9	WSW
11/29/2023 16:09:00	14.5	9.3	-5.2	0.03	0.01	-0.01	0.9	WSW

Date/Time	Average Upwind PM10 (µg/m³)	Average Downwind PM10 (µg/m³)	Average Contribution PM10 (µg/m³)	Average Upwind VOC (ppm)	Average Downwind VOC (ppm)	Average Contribution VOC (ppm)	Wind Speed 15 min Avg	Wind Direction
11/29/2023 16:10:00	12.8	9.2	-3.6	0.02	0.01	-0.01	0.9	W
11/29/2023 16:11:00	12.6	8.5	-4.0	0.02	0.01	-0.01	0.9	E
11/29/2023 16:12:00	12.6	7.8	-4.8	0.03	0.00	-0.02	0.9	ESE
11/29/2023 16:13:00	10.7	8.1	-2.5	0.01	0.01	-0.01	0.9	W
11/29/2023 16:14:00	10.1	8.1	-2.0	0.01	0.01	-0.01	0.9	E
11/29/2023 16:15:00	10.0	8.4	-1.6	0.01	0.01	-0.01	0.9	E
11/29/2023 16:16:00	10.1	8.5	-1.5	0.01	0.01	-0.01	0.9	E
11/29/2023 16:17:00	9.9	8.7	-1.3	0.01	0.01	-0.01	0.9	E
11/29/2023 16:18:00	9.7	9.2	-0.5	0.01	0.01	-0.01	0.9	WSW
11/29/2023 16:19:00	9.9	9.2	-0.7	0.02	0.01	-0.01	0.8	ESE
11/29/2023 16:20:00	10.1	9.1	-1.0	0.03	0.01	-0.02	0.8	E
11/29/2023 16:21:00	10.9	9.2	-1.6	0.03	0.01	-0.02	0.8	ESE
11/29/2023 16:22:00	11.3	9.9	-1.4	0.03	0.01	-0.02	0.7	WSW
11/29/2023 16:23:00	11.7	9.9	-1.8	0.03	0.01	-0.02	0.7	E
11/29/2023 16:24:00	12.3	9.8	-2.5	0.03	0.01	-0.03	0.8	SE
11/29/2023 16:25:00	12.5	9.3	-3.2	0.04	0.01	-0.03	0.8	E
11/29/2023 16:26:00	12.4	9.0	-3.3	0.04	0.01	-0.03	0.8	E
11/29/2023 16:27:00	12.0	8.8	-3.2	0.03	0.01	-0.03	0.8	ESE
11/29/2023 16:28:00	11.9	8.4	-3.5	0.03	0.01	-0.03	0.8	WSW
11/29/2023 16:29:00	11.2	8.2	-3.1	0.03	0.01	-0.03	0.8	E
11/29/2023 16:30:00	10.8	7.7	-3.1	0.03	0.01	-0.03	0.8	E
11/29/2023 16:31:00	10.2	7.6	-2.6	0.03	0.01	-0.02	0.8	SW
11/29/2023 16:32:00	10.1	7.4	-2.7	0.03	0.01	-0.03	0.8	ESE
11/29/2023 16:33:00	10.1	7.1	-3.0	0.03	0.01	-0.02	0.8	SSW
11/29/2023 16:34:00	9.9	7.3	-2.6	0.03	0.01	-0.02	0.8	SSE
11/29/2023 16:35:00	9.8	7.6	-2.2	0.02	0.01	-0.01	0.8	E
11/29/2023 16:36:00	8.9	7.6	-1.3	0.02	0.01	-0.01	0.8	E
11/29/2023 16:37:00	8.2	7.2	-1.0	0.02	0.01	-0.01	0.8	SSE
11/29/2023 16:38:00	8.0	7.0	-1.0	0.02	0.01	0.00	0.8	SSW
11/29/2023 16:39:00	7.6	7.1	-0.5	0.02	0.01	0.00	0.8	ESE
11/29/2023 16:40:00	7.5	7.3	-0.1	0.01	0.02	0.00	0.7	SW
11/29/2023 16:41:00	7.5	7.5	0.0	0.02	0.02	0.00	0.7	E

Date/Time	Average Upwind PM10 (µg/m³)	Average Downwind PM10 (µg/m³)	Average Contribution PM10 (µg/m³)	Average Upwind VOC (ppm)	Average Downwind VOC (ppm)	Average Contribution VOC (ppm)	Wind Speed 15 min Avg	Wind Direction
11/29/2023 16:42:00	7.6	7.8	0.2	0.02	0.02	0.00	0.8	E
11/29/2023 16:43:00	7.9	7.9	0.0	0.02	0.02	0.00	0.8	WSW
11/29/2023 16:44:00	8.2	8.3	0.1	0.02	0.02	0.00	0.7	ESE
11/29/2023 16:45:00	8.4	9.1	0.7	0.02	0.02	0.00	0.7	E
11/29/2023 16:46:00	8.8	9.8	0.9	0.02	0.02	-0.01	0.7	SE
11/29/2023 16:47:00	9.1	10.2	1.1	0.02	0.02	0.00	0.7	WSW
11/29/2023 16:48:00	9.2	10.4	1.2	0.02	0.03	0.01	0.7	WSW