

DAILY FIELD REPORT 069

Prepared By: LANGAN

WEATHER	Snow		Rain		Overcast		Partly Cloudy		Sunny	X
TEMP.	< 32		32-50		50-70	X	70-85	X	>85	

BCP Project No:	C231153	Date:	September 14, 2023
------------------------	---------	--------------	--------------------

Project Name:	Kasser Scrap Metal and Rector Cleaners Site	Time:	7:00 am to 6:00 pm
----------------------	---	--------------	--------------------

Consultant: Langan Engineering, Environmental, Surveying, Landscape Architecture and Geology, D.P.C. (Langan)

Construction Manager: Consigli Construction Co., Inc. (Consigli)

Foundation Contractor: Urban Foundation/Engineering (Urban)

Langan Field Personnel:
 Emily Rodriguez (Environmental)
 Xianglei Zheng (Geotechnical)

Work Activities Performed:

- Urban excavated an about 15-foot-long by 20-foot-wide area to about 10 feet below grade surface (bgs) in the northeastern part of waste characterization grids WC03_0-5 and WC03_5-10 to prepare for equipment mobilization. Excavated soil/fill was stockpiled in WC02 and covered with polyethylene sheeting at the end of the day, pending off-site disposal.
- Urban graded an about 200-foot-long by 150-foot-wide area of soil/fill in the northern and central parts of waste characterization grids WC02 and WC03 to prepare for equipment mobilization.
- Excavated and graded soil/fill consisted of non-native soil; odors, staining, elevated photoionization detector (PID) readings, or other evidence of a petroleum or chemical release were not observed.
- Urban drilled two rock sockets for caissons in the northern and eastern part of the site.

Material Tracking:

- The following soil/fill was exported from the site:
 - 3 loads of soil/fill from waste characterization grids WC03_0-5 and WC03_5-10 to the Bayshore Soil Management, LLC facility in Keasbey, NJ.
- No material was imported to the site.

Materials Export Summary								
Facility Name	<i>Bayshore Soil Management, LLC</i>		<i>Clean Earth of Carteret, LLC</i>		<i>PPark NJ</i>		<i>Faztec Solutions</i>	
Location	<i>Keasbey, NJ</i>		<i>Carteret, NJ</i>		<i>Prospect Park, NJ</i>		<i>Staten Island, NY</i>	
Type of Waste	<i>Non-hazardous Soil</i>		<i>Non-hazardous Soil</i>		<i>Non-hazardous Soil</i>		<i>C&D</i>	
Today	Number of Loads	Approx. Volume (CY)	Number of Loads	Approx. Volume (CY)	Number of Loads	Approx. Volume (CY)	Number of Loads	Approximate Volume (CY)
	3	60	0	-	0	-	0	-
Total	Number of Loads	Approx. Volume (CY)	Number of Loads	Approx. Volume (CY)	Number of Loads	Approx. Volume (CY)	Number of Loads	Approximate Volume (CY)
	81	1,620	29	580	0	-	14	280

Materials Export Summary		
Facility Name	<i>Dale Transfer Corp.</i>	
Location	<i>West Babylon, NY</i>	
Type of Waste	<i>Concrete</i>	
Today	Number of Loads	Approx. Volume (CY)
	0	-
Total	Number of Loads	Approx. Volume (CY)
	2	40

Samples Collected:

- No samples were collected.

Air Monitoring:

The 15-minute average site contributions for particulates and volatile organic compounds (VOCs) are calculated by subtracting the upwind readings from the downwind readings. A true action level exceedance is realized when this net result exceeds 100 $\mu\text{g}/\text{m}^3$ for particulates and 5 ppm for organic vapors. No particulates (PM10) or organic vapors exceeded the 15-minute average site contribution action level of 100 $\mu\text{g}/\text{m}^3$ or 5 ppm, respectively, on this day.

Particulate Monitoring ($\mu\text{g}/\text{m}^3$)		Organic Vapor Monitoring (ppm)	
Daily Background	3.0	Daily Background	0.00
0PM10 Average Site Contribution (Minimum)	-404.9	VOC Average Site Contribution (Minimum)	-0.02
PM10 Average Site Contribution (Maximum)	34.6	VOC Average Site Contribution (Maximum)	0.01

$\mu\text{g}/\text{m}^3$: micrograms per cubic meter.

ppm: parts per million.

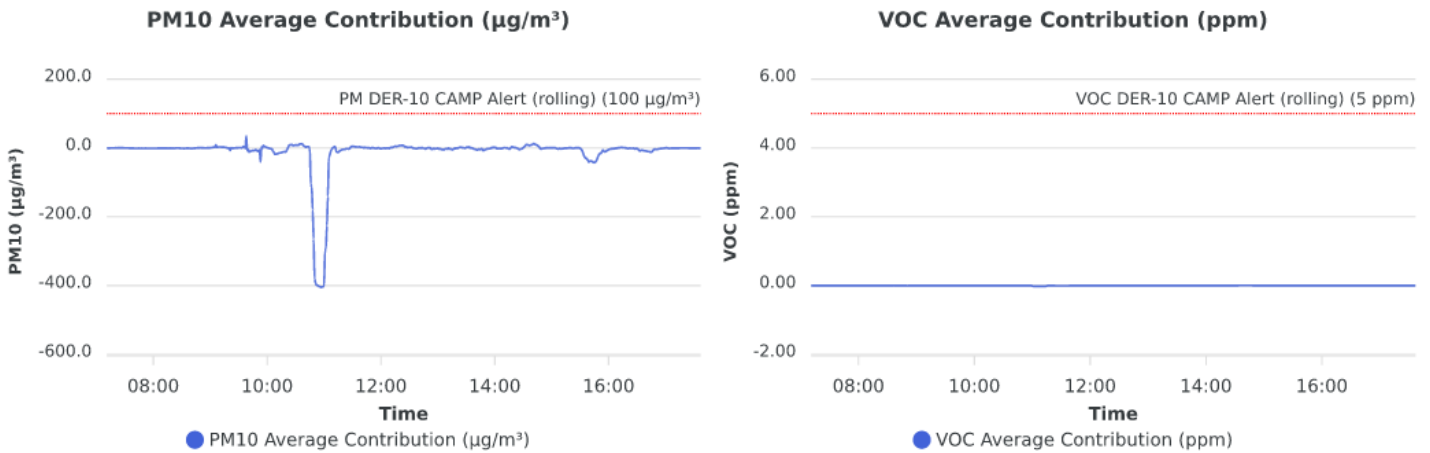

Planned Activities:

- Urban will continue installing caisson casings throughout the site.
- Urban will apply grout to caissons.
- Urban will export soil/fill from WC03_0-5 and WC03_5-10.

SITE PLAN

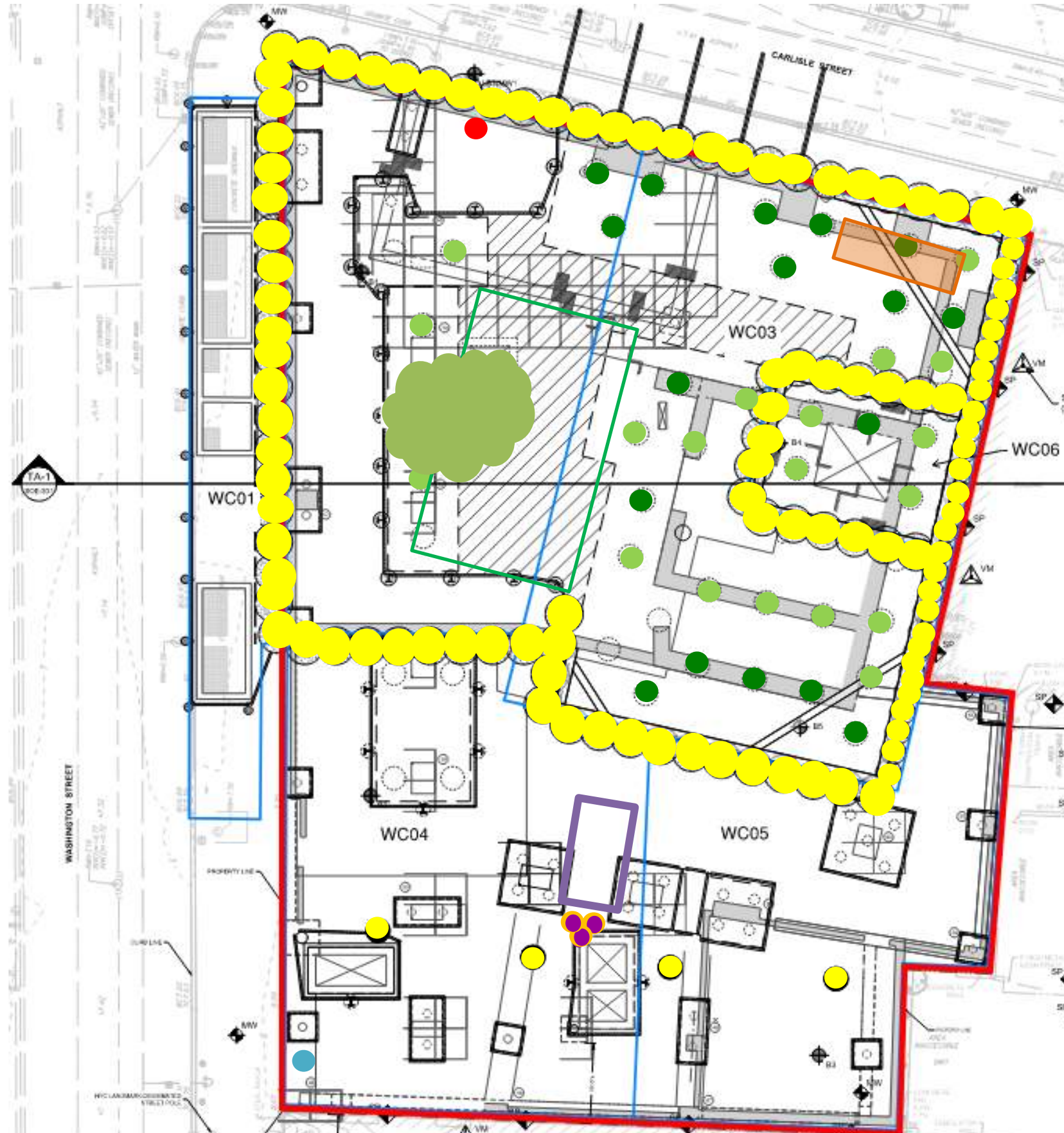

- Site Boundary**
- Waste Characterization Grid Boundary**
- CAMP station 1**
- CAMP station 2**
- Stockpile – Soil (no impacts)**
- Stockpile – C&D**
- Approximate Location of Excavation**
- Approximate Area of Grading**
- Approximate Backfill Location**
- Completed Soil-Mix Column**
- Completed Caisson Casing**
- Completed Caisson**
- Installed Soil-Mix Column as part of the In-Situ Stabilization of NAPL-contaminated Soil**
- Completed Soil-Mix Core**
- Approximate Location of the Former UST**

Note: Waste characterization grid areas were developed by PT Consultants and Urban and is shown on this site plan for reference only.

Photo Log

Photo 1: View of Urban loading a truck with soil/fill for off-site disposal to the Bayshore Soil Management facility (facing north).



Photo 2: View of Urban covering the stockpiled soil/fill with polyethylene sheeting at the end of the day, pending off-site disposal (facing southeast).



Photo 3: View of CAMP Station 1 in the northern part of the site (facing east).



Photo 4: View of CAMP Station 2 in the southwestern part of the site (facing southeast).



LANGAN	Air Monitoring Report	170695201 - 111 Washington St	
		Report Period	
		From:	9/14/2023 00:00
		To:	9/14/2023 22:00
		PM10 Action Level:	100.0 $\mu\text{g}/\text{m}^3$
VOC Action Level:	5.00 ppm		

Daily Environmental Summary	Windspeed (mph)	Prevailing wind direction
9/14/2023	0.5-3.8	N

Daily Monitoring Summary	PM10 ($\mu\text{g}/\text{m}^3$)	Time	VOC (ppm)	Time
Min Contribution (15 min avg.) - 9/14/2023	-404.9	10:57	-0.02	11:02
Max Contribution (15 min avg.) - 9/14/2023	34.6	09:38	0.01	08:36



PM10 Average Contribution ($\mu\text{g}/\text{m}^3$)

VOC Average Contribution (ppm)

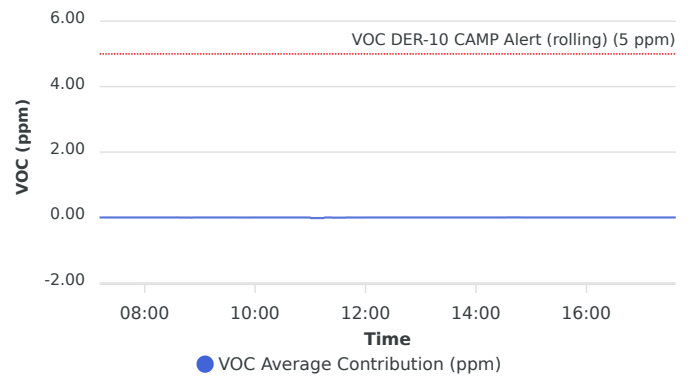
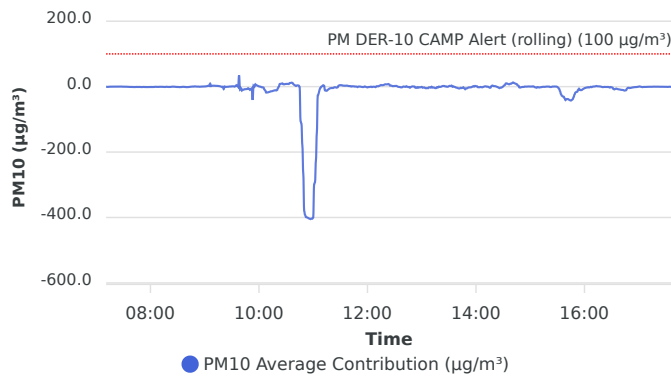

Contribution wind rose (mph)

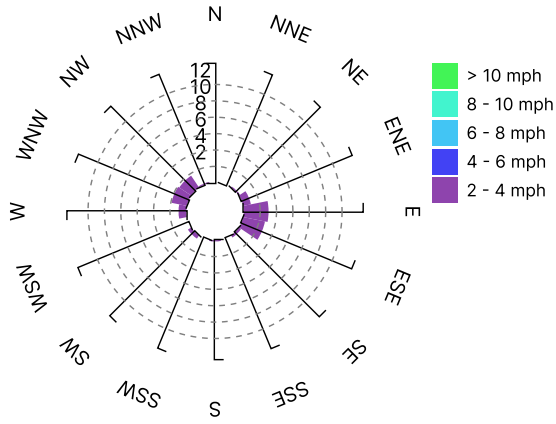

Date/Time	Average Upwind PM10 (µg/m³)	Average Downwind PM10 (µg/m³)	Average Contribution PM10 (µg/m³)	Average Upwind VOC (ppm)	Average Downwind VOC (ppm)	Average Contribution VOC (ppm)	Wind Speed 15 min Avg	Wind Direction
9/14/2023 07:11:00	3.0	2.8	-0.1	0.00	0.00	0.00	3.0	ENE
9/14/2023 07:12:00	3.7	3.0	-0.7	0.00	0.00	0.00	2.7	ESE
9/14/2023 07:13:00	4.1	3.2	-0.9	0.00	0.00	0.00	2.6	E
9/14/2023 07:14:00	3.6	3.2	-0.5	0.00	0.00	0.00	2.8	E
9/14/2023 07:15:00	3.4	3.1	-0.3	0.00	0.00	0.00	2.6	SE
9/14/2023 07:16:00	3.1	3.0	-0.1	0.00	0.00	0.00	2.5	E
9/14/2023 07:17:00	3.1	2.9	-0.1	0.00	0.00	0.00	2.5	ESE
9/14/2023 07:18:00	3.0	2.9	-0.1	0.00	0.00	0.00	2.4	W
9/14/2023 07:19:00	3.0	2.9	-0.1	0.00	0.00	0.00	2.3	E
9/14/2023 07:20:00	3.0	3.0	0.0	0.00	0.00	0.00	2.3	E
9/14/2023 07:21:00	3.0	3.0	-0.1	0.00	0.00	0.00	2.2	SW
9/14/2023 07:22:00	3.0	3.0	0.0	0.00	0.00	0.00	2.2	E
9/14/2023 07:23:00	2.9	2.9	0.0	0.00	0.00	0.00	2.3	E
9/14/2023 07:24:00	2.9	2.9	0.0	0.00	0.00	0.00	2.3	E
9/14/2023 07:25:00	2.9	2.9	0.1	0.00	0.00	0.00	2.3	ESE
9/14/2023 07:26:00	2.8	2.9	0.1	0.00	0.00	0.00	2.3	E
9/14/2023 07:27:00	2.7	2.9	0.2	0.00	0.00	0.00	2.3	ESE
9/14/2023 07:28:00	2.7	2.8	0.1	0.00	0.00	0.00	2.2	NNE
9/14/2023 07:29:00	2.9	2.8	-0.1	0.00	0.00	0.00	2.2	ESE
9/14/2023 07:30:00	3.0	2.8	-0.3	0.00	0.00	0.00	2.2	E
9/14/2023 07:31:00	3.1	2.9	-0.2	0.00	0.00	0.00	2.1	ENE
9/14/2023 07:32:00	3.2	2.9	-0.3	0.00	0.00	0.00	2.1	NW
9/14/2023 07:33:00	3.3	2.9	-0.3	0.00	0.00	0.00	2.1	NE
9/14/2023 07:34:00	3.4	2.9	-0.4	0.00	0.00	0.00	2.2	ESE
9/14/2023 07:35:00	3.4	2.9	-0.6	0.00	0.00	0.00	2.2	ESE
9/14/2023 07:36:00	3.6	2.9	-0.7	0.00	0.00	0.00	2.2	ESE
9/14/2023 07:37:00	3.8	2.8	-0.9	0.00	0.00	0.00	2.3	ENE
9/14/2023 07:38:00	3.8	2.9	-0.9	0.00	0.00	0.00	2.2	E
9/14/2023 07:39:00	3.8	2.9	-0.9	0.00	0.00	0.00	2.1	NNE
9/14/2023 07:40:00	4.0	2.9	-1.1	0.00	0.00	0.00	2.0	ESE
9/14/2023 07:41:00	4.2	3.0	-1.2	0.00	0.00	0.00	2.0	ESE
9/14/2023 07:42:00	4.3	3.1	-1.2	0.00	0.00	0.00	1.9	E

Date/Time	Average Upwind PM10 (µg/m³)	Average Downwind PM10 (µg/m³)	Average Contribution PM10 (µg/m³)	Average Upwind VOC (ppm)	Average Downwind VOC (ppm)	Average Contribution VOC (ppm)	Wind Speed 15 min Avg	Wind Direction
9/14/2023 07:43:00	4.4	3.1	-1.3	0.00	0.00	0.00	1.9	ESE
9/14/2023 07:44:00	4.3	3.2	-1.0	0.00	0.00	0.00	1.9	SE
9/14/2023 07:45:00	4.2	3.3	-0.9	0.00	0.00	0.00	1.9	N
9/14/2023 07:46:00	4.4	3.3	-1.1	0.00	0.00	0.00	2.0	ESE
9/14/2023 07:47:00	4.4	3.4	-1.1	0.00	0.00	0.00	2.0	NE
9/14/2023 07:48:00	4.5	3.4	-1.0	0.00	0.00	0.00	2.1	ESE
9/14/2023 07:49:00	4.5	3.5	-1.1	0.00	0.00	0.00	2.0	ESE
9/14/2023 07:50:00	4.8	3.5	-1.4	0.00	0.00	0.00	2.0	ESE
9/14/2023 07:51:00	4.8	3.5	-1.3	0.00	0.00	0.00	1.9	SE
9/14/2023 07:52:00	4.7	3.7	-0.9	0.00	0.00	0.00	2.0	SW
9/14/2023 07:53:00	4.8	3.8	-1.1	0.00	0.00	0.00	2.1	E
9/14/2023 07:54:00	5.0	3.8	-1.2	0.00	0.00	0.00	2.1	E
9/14/2023 07:55:00	5.1	3.8	-1.3	0.00	0.00	0.00	2.2	ESE
9/14/2023 07:56:00	5.1	3.8	-1.3	0.00	0.00	0.00	2.3	E
9/14/2023 07:57:00	5.0	3.7	-1.3	0.00	0.00	0.00	2.4	E
9/14/2023 07:58:00	5.0	3.7	-1.3	0.00	0.00	0.00	2.4	SE
9/14/2023 07:59:00	5.0	3.8	-1.2	0.00	0.00	0.00	2.5	NW
9/14/2023 08:00:00	4.9	3.7	-1.1	0.00	0.00	0.00	2.5	ENE
9/14/2023 08:01:00	4.9	3.7	-1.2	0.00	0.00	0.00	2.5	E
9/14/2023 08:02:00	4.8	3.7	-1.1	0.00	0.00	0.00	2.6	E
9/14/2023 08:03:00	4.8	3.6	-1.2	0.00	0.00	0.00	2.6	ESE
9/14/2023 08:04:00	4.7	3.6	-1.1	0.00	0.00	0.00	2.6	ESE
9/14/2023 08:05:00	4.3	3.6	-0.7	0.00	0.00	0.00	2.6	SE
9/14/2023 08:06:00	4.2	3.6	-0.6	0.00	0.00	0.00	2.6	SE
9/14/2023 08:07:00	4.2	3.4	-0.8	0.00	0.00	0.00	2.5	E
9/14/2023 08:08:00	4.2	3.4	-0.8	0.00	0.00	0.00	2.4	ENE
9/14/2023 08:09:00	4.3	3.4	-0.9	0.00	0.00	0.00	2.4	E
9/14/2023 08:10:00	4.0	3.5	-0.6	0.00	0.00	0.00	2.4	W
9/14/2023 08:11:00	4.0	3.4	-0.6	0.00	0.00	0.00	2.2	NE
9/14/2023 08:12:00	4.0	3.4	-0.6	0.00	0.00	0.00	2.2	SE
9/14/2023 08:13:00	4.0	3.4	-0.6	0.00	0.00	0.00	2.1	ENE
9/14/2023 08:14:00	4.0	3.2	-0.8	0.00	0.00	0.00	2.1	ESE
9/14/2023 08:15:00	4.1	3.2	-1.0	0.00	0.00	0.00	2.0	E

Date/Time	Average Upwind PM10 (µg/m³)	Average Downwind PM10 (µg/m³)	Average Contribution PM10 (µg/m³)	Average Upwind VOC (ppm)	Average Downwind VOC (ppm)	Average Contribution VOC (ppm)	Wind Speed 15 min Avg	Wind Direction
9/14/2023 08:16:00	4.3	3.2	-1.1	0.00	0.00	0.00	2.0	E
9/14/2023 08:17:00	4.2	3.5	-0.8	0.00	0.00	0.00	1.9	SSE
9/14/2023 08:18:00	4.2	3.8	-0.4	0.00	0.00	0.00	1.8	SSE
9/14/2023 08:19:00	4.7	3.8	-0.9	0.00	0.00	0.00	1.7	ESE
9/14/2023 08:20:00	4.8	3.7	-1.1	0.00	0.00	0.00	1.7	E
9/14/2023 08:21:00	4.8	3.9	-0.9	0.00	0.00	0.00	1.7	W
9/14/2023 08:22:00	4.9	3.8	-1.1	0.00	0.00	0.00	1.7	SE
9/14/2023 08:23:00	4.8	4.2	-0.6	0.00	0.00	0.00	1.6	W
9/14/2023 08:24:00	4.6	4.4	-0.2	0.00	0.00	0.00	1.6	SSW
9/14/2023 08:25:00	4.6	4.5	-0.1	0.00	0.00	0.00	1.5	SSW
9/14/2023 08:26:00	4.8	4.5	-0.3	0.00	0.00	0.00	1.5	SE
9/14/2023 08:27:00	5.0	4.6	-0.4	0.00	0.00	0.00	1.5	NE
9/14/2023 08:28:00	5.5	4.7	-0.8	0.00	0.00	0.00	1.4	E
9/14/2023 08:29:00	5.9	4.8	-1.1	0.00	0.00	0.00	1.4	ESE
9/14/2023 08:30:00	6.0	4.9	-1.1	0.00	0.00	0.00	1.4	NNW
9/14/2023 08:31:00	6.0	4.9	-1.1	0.00	0.00	0.00	1.4	SE
9/14/2023 08:32:00	6.2	4.6	-1.6	0.00	0.00	0.00	1.4	E
9/14/2023 08:33:00	6.1	4.8	-1.3	0.00	0.00	0.00	1.4	W
9/14/2023 08:34:00	6.1	4.7	-1.3	0.00	0.00	0.00	1.4	NNW
9/14/2023 08:35:00	5.9	5.2	-0.8	0.00	0.00	0.00	1.3	W
9/14/2023 08:36:00	5.9	5.2	-0.7	0.00	0.01	0.01	1.3	NW
9/14/2023 08:37:00	5.8	5.2	-0.6	0.01	0.01	0.00	1.3	ESE
9/14/2023 08:38:00	6.1	4.9	-1.1	0.01	0.01	0.00	1.3	E
9/14/2023 08:39:00	6.2	5.1	-1.1	0.01	0.01	0.00	1.4	WSW
9/14/2023 08:40:00	6.5	4.9	-1.6	0.01	0.01	0.00	1.4	WNW
9/14/2023 08:41:00	6.6	5.2	-1.4	0.01	0.01	0.00	1.4	WSW
9/14/2023 08:42:00	6.8	5.5	-1.3	0.01	0.01	0.00	1.4	NW
9/14/2023 08:43:00	6.7	5.8	-0.9	0.01	0.01	0.00	1.4	WNW
9/14/2023 08:44:00	6.5	5.9	-0.6	0.01	0.01	0.00	1.5	NW
9/14/2023 08:45:00	6.4	6.3	-0.2	0.01	0.01	0.00	1.5	WNW
9/14/2023 08:46:00	6.4	6.3	0.0	0.01	0.01	0.00	1.5	N
9/14/2023 08:47:00	6.2	6.6	0.4	0.01	0.01	0.00	1.5	SW
9/14/2023 08:48:00	6.3	6.3	0.0	0.01	0.01	0.00	1.5	S

Date/Time	Average Upwind PM10 (µg/m³)	Average Downwind PM10 (µg/m³)	Average Contribution PM10 (µg/m³)	Average Upwind VOC (ppm)	Average Downwind VOC (ppm)	Average Contribution VOC (ppm)	Wind Speed 15 min Avg	Wind Direction
9/14/2023 08:49:00	5.9	6.7	0.8	0.01	0.01	0.00	1.5	WSW
9/14/2023 08:50:00	6.0	6.5	0.5	0.01	0.01	0.00	1.5	W
9/14/2023 08:51:00	6.2	6.3	0.1	0.01	0.00	-0.01	1.5	NNW
9/14/2023 08:52:00	6.4	6.4	0.0	0.00	0.00	0.00	1.5	NW
9/14/2023 08:53:00	6.4	6.6	0.2	0.00	0.00	0.00	1.6	W
9/14/2023 08:54:00	6.9	6.5	-0.4	0.00	0.00	0.00	1.7	WNW
9/14/2023 08:55:00	6.8	6.6	-0.2	0.00	0.00	0.00	1.7	W
9/14/2023 08:56:00	6.5	6.4	-0.1	0.00	0.00	0.00	1.8	WNW
9/14/2023 08:57:00	5.9	6.2	0.3	0.00	0.00	0.00	1.8	WNW
9/14/2023 08:58:00	5.7	5.9	0.2	0.00	0.00	0.00	1.8	W
9/14/2023 08:59:00	5.5	5.9	0.4	0.00	0.00	0.00	1.7	SW
9/14/2023 09:00:00	5.4	5.9	0.6	0.00	0.00	0.00	1.7	WSW
9/14/2023 09:01:00	5.4	6.1	0.7	0.00	0.00	0.00	1.7	WNW
9/14/2023 09:02:00	5.4	6.6	1.2	0.00	0.00	0.00	1.8	WNW
9/14/2023 09:03:00	5.4	7.2	1.8	0.00	0.00	0.00	1.8	WNW
9/14/2023 09:04:00	6.4	9.0	2.7	0.00	0.00	0.00	1.9	ESE
9/14/2023 09:05:00	8.5	10.4	1.9	0.00	0.00	0.00	1.9	WNW
9/14/2023 09:06:00	8.6	17.6	9.1	0.00	0.00	0.00	1.9	WNW
9/14/2023 09:07:00	16.5	18.0	1.5	0.00	0.00	0.00	1.9	SE
9/14/2023 09:08:00	16.3	18.7	2.4	0.00	0.00	0.00	2.0	WNW
9/14/2023 09:09:00	15.8	18.6	2.8	0.00	0.00	0.00	1.9	N
9/14/2023 09:10:00	15.8	18.5	2.7	0.00	0.00	0.00	1.9	SW
9/14/2023 09:11:00	16.1	18.9	2.8	0.00	0.00	0.00	1.9	WNW
9/14/2023 09:12:00	16.4	18.9	2.4	0.00	0.00	0.00	1.9	NW
9/14/2023 09:13:00	16.6	18.9	2.3	0.00	0.00	0.00	1.9	SSE
9/14/2023 09:14:00	16.8	19.0	2.3	0.00	0.00	0.00	1.9	WNW
9/14/2023 09:15:00	16.9	18.8	1.9	0.00	0.00	0.00	1.9	NE
9/14/2023 09:16:00	17.0	18.6	1.6	0.00	0.00	0.00	1.8	E
9/14/2023 09:17:00	17.1	18.1	1.0	0.00	0.00	0.00	1.8	S
9/14/2023 09:18:00	17.1	17.3	0.1	0.00	0.00	0.00	1.8	NE
9/14/2023 09:19:00	16.1	15.1	-1.1	0.00	0.00	0.00	1.7	SE
9/14/2023 09:20:00	14.0	13.8	-0.2	0.00	0.00	0.00	1.8	S
9/14/2023 09:21:00	14.0	6.6	-7.4	0.00	0.00	0.00	1.8	E

Date/Time	Average Upwind PM10 (µg/m³)	Average Downwind PM10 (µg/m³)	Average Contribution PM10 (µg/m³)	Average Upwind VOC (ppm)	Average Downwind VOC (ppm)	Average Contribution VOC (ppm)	Wind Speed 15 min Avg	Wind Direction
9/14/2023 09:22:00	5.9	6.3	0.4	0.00	0.00	0.00	1.8	NE
9/14/2023 09:23:00	5.9	5.3	-0.6	0.00	0.00	0.00	1.7	ENE
9/14/2023 09:24:00	6.1	5.3	-0.8	0.00	0.00	0.00	1.6	ESE
9/14/2023 09:25:00	5.9	5.4	-0.5	0.00	0.00	0.00	1.6	S
9/14/2023 09:26:00	5.6	5.3	-0.3	0.00	0.00	0.00	1.6	SSE
9/14/2023 09:27:00	5.3	5.4	0.1	0.00	0.00	0.00	1.6	SSE
9/14/2023 09:28:00	5.1	5.8	0.6	0.00	0.00	0.00	1.6	SE
9/14/2023 09:29:00	5.5	5.8	0.2	0.00	0.00	0.00	1.6	NNW
9/14/2023 09:30:00	5.5	6.4	0.8	0.00	0.00	0.00	1.6	SSW
9/14/2023 09:31:00	5.5	6.5	0.9	0.00	0.00	0.00	1.5	N
9/14/2023 09:32:00	5.8	6.6	0.9	0.00	0.00	0.00	1.5	WNW
9/14/2023 09:33:00	7.2	7.2	0.0	0.00	0.00	0.00	1.5	WNW
9/14/2023 09:34:00	9.5	10.7	1.2	0.00	0.00	0.00	1.5	WNW
9/14/2023 09:35:00	10.8	15.1	4.3	0.00	0.00	0.00	1.5	WNW
9/14/2023 09:36:00	13.4	15.8	2.4	0.00	0.00	0.00	1.5	ENE
9/14/2023 09:37:00	17.1	16.3	-0.8	0.00	0.00	0.00	1.5	NNW
9/14/2023 09:38:00	17.4	52.1	34.6	0.00	0.00	0.00	1.5	WNW
9/14/2023 09:39:00	60.3	52.4	-7.9	0.00	0.00	0.00	1.5	NNE
9/14/2023 09:40:00	60.7	56.2	-4.5	0.00	0.00	0.00	1.5	NW
9/14/2023 09:41:00	68.9	56.8	-12.2	0.00	0.00	0.00	1.5	ESE
9/14/2023 09:42:00	69.8	60.4	-9.4	0.00	0.00	0.00	1.5	W
9/14/2023 09:43:00	70.6	61.2	-9.4	0.00	0.00	0.00	1.5	NW
9/14/2023 09:44:00	70.7	62.7	-8.0	0.00	0.00	0.00	1.6	NW
9/14/2023 09:45:00	70.8	62.9	-7.9	0.00	0.00	0.00	1.6	NE
9/14/2023 09:46:00	71.0	63.5	-7.5	0.00	0.00	0.00	1.6	NNW
9/14/2023 09:47:00	71.1	63.9	-7.3	0.00	0.00	0.00	1.6	NW
9/14/2023 09:48:00	70.5	65.6	-5.0	0.00	0.00	0.00	1.6	NNW
9/14/2023 09:49:00	69.3	62.7	-6.6	0.00	0.00	0.00	1.6	WNW
9/14/2023 09:50:00	68.4	58.5	-9.8	0.00	0.00	0.00	1.5	WNW
9/14/2023 09:51:00	66.2	58.3	-7.9	0.00	0.00	0.00	1.5	SE
9/14/2023 09:52:00	63.6	58.1	-5.5	0.00	0.00	0.00	1.4	E
9/14/2023 09:53:00	64.0	23.4	-40.5	0.00	0.00	0.00	1.4	NW
9/14/2023 09:54:00	21.6	24.1	2.5	0.00	0.00	0.00	1.5	N

Date/Time	Average Upwind PM10 ($\mu\text{g}/\text{m}^3$)	Average Downwind PM10 ($\mu\text{g}/\text{m}^3$)	Average Contribution PM10 ($\mu\text{g}/\text{m}^3$)	Average Upwind VOC (ppm)	Average Downwind VOC (ppm)	Average Contribution VOC (ppm)	Wind Speed 15 min Avg	Wind Direction
9/14/2023 09:55:00	21.9	21.4	-0.4	0.00	0.00	0.00	1.5	N
9/14/2023 09:56:00	14.4	21.5	7.1	0.00	0.00	0.00	1.5	NW
9/14/2023 09:57:00	13.8	18.6	4.7	0.00	0.00	0.00	1.5	SE
9/14/2023 09:58:00	14.3	17.7	3.4	0.00	0.00	0.00	1.5	N
9/14/2023 09:59:00	14.2	16.3	2.0	0.00	0.00	0.00	1.4	E
9/14/2023 10:00:00	14.7	15.5	0.8	0.00	0.00	0.00	1.4	ENE
9/14/2023 10:01:00	15.0	15.0	0.1	0.00	0.00	0.00	1.4	NE
9/14/2023 10:02:00	15.3	14.9	-0.4	0.00	0.00	0.00	1.3	ENE
9/14/2023 10:03:00	15.1	12.9	-2.1	0.00	0.00	0.00	1.3	NW
9/14/2023 10:04:00	14.8	12.7	-2.1	0.00	0.00	0.00	1.3	ESE
9/14/2023 10:05:00	15.5	12.7	-2.9	0.00	0.00	0.00	1.3	E
9/14/2023 10:06:00	21.4	12.8	-8.7	0.00	0.00	0.00	1.4	ESE
9/14/2023 10:07:00	24.7	12.6	-12.1	0.00	0.00	0.00	1.4	ENE
9/14/2023 10:08:00	30.0	11.7	-18.2	0.00	0.00	0.00	1.3	NNW
9/14/2023 10:09:00	30.2	12.3	-17.8	0.00	0.00	0.00	1.4	WNW
9/14/2023 10:10:00	30.2	12.6	-17.5	0.00	0.00	0.00	1.4	NW
9/14/2023 10:11:00	30.2	13.7	-16.5	0.00	0.00	0.00	1.5	NNW
9/14/2023 10:12:00	30.8	15.1	-15.8	0.00	0.00	0.00	1.5	ENE
9/14/2023 10:13:00	30.3	15.8	-14.4	0.00	0.00	0.00	1.5	WNW
9/14/2023 10:14:00	29.9	15.7	-14.3	0.00	0.00	0.00	1.5	N
9/14/2023 10:15:00	29.4	15.8	-13.5	0.00	0.00	0.00	1.5	WNW
9/14/2023 10:16:00	28.9	16.4	-12.5	0.00	0.00	0.00	1.6	N
9/14/2023 10:17:00	28.6	16.9	-11.7	0.00	0.00	0.00	1.6	NE
9/14/2023 10:18:00	28.2	17.3	-11.0	0.00	0.00	0.00	1.7	NW
9/14/2023 10:19:00	28.9	17.1	-11.8	0.00	0.00	0.00	1.7	NW
9/14/2023 10:20:00	28.0	17.4	-10.6	0.00	0.00	0.00	1.7	NW
9/14/2023 10:21:00	21.8	17.1	-4.7	0.00	0.00	0.00	1.7	N
9/14/2023 10:22:00	17.6	17.9	0.3	0.00	0.00	0.00	1.7	ENE
9/14/2023 10:23:00	11.8	19.8	8.0	0.00	0.00	0.00	1.7	NNW
9/14/2023 10:24:00	11.1	19.5	8.4	0.00	0.00	0.00	1.7	NW
9/14/2023 10:25:00	10.5	19.7	9.2	0.00	0.00	0.00	1.7	NNW
9/14/2023 10:26:00	10.0	19.7	9.7	0.00	0.00	0.00	1.7	N
9/14/2023 10:27:00	11.2	18.4	7.2	0.00	0.00	0.00	1.7	NW

Date/Time	Average Upwind PM10 (µg/m³)	Average Downwind PM10 (µg/m³)	Average Contribution PM10 (µg/m³)	Average Upwind VOC (ppm)	Average Downwind VOC (ppm)	Average Contribution VOC (ppm)	Wind Speed 15 min Avg	Wind Direction
9/14/2023 10:28:00	11.2	18.2	7.1	0.00	0.00	0.00	1.7	S
9/14/2023 10:29:00	11.2	19.2	8.0	0.00	0.00	0.00	1.7	NNE
9/14/2023 10:30:00	11.4	19.5	8.1	0.00	0.00	0.00	1.7	N
9/14/2023 10:31:00	11.3	19.8	8.5	0.00	0.00	0.00	1.7	NNW
9/14/2023 10:32:00	11.1	19.3	8.2	0.00	0.00	0.00	1.7	NW
9/14/2023 10:33:00	11.1	19.1	8.0	0.00	0.00	0.00	1.7	NNE
9/14/2023 10:34:00	10.1	21.0	10.9	0.00	0.00	0.00	1.6	E
9/14/2023 10:35:00	10.4	21.6	11.2	0.00	0.00	0.00	1.6	NNE
9/14/2023 10:36:00	10.3	22.3	12.0	0.00	0.00	0.00	1.6	ENE
9/14/2023 10:37:00	10.6	22.1	11.5	0.00	0.00	0.00	1.6	NW
9/14/2023 10:38:00	12.3	20.2	7.9	0.00	0.00	0.00	1.6	NW
9/14/2023 10:39:00	13.7	19.0	5.4	0.00	0.00	0.00	1.5	WNW
9/14/2023 10:40:00	14.1	17.6	3.6	0.00	0.00	0.00	1.5	NW
9/14/2023 10:41:00	14.0	16.1	2.1	0.00	0.00	0.00	1.5	N
9/14/2023 10:42:00	12.0	15.5	3.5	0.00	0.00	0.00	1.5	NE
9/14/2023 10:43:00	11.7	15.5	3.8	0.00	0.00	0.00	1.5	NNW
9/14/2023 10:44:00	11.7	14.9	3.2	0.00	0.00	0.00	1.5	NW
9/14/2023 10:45:00	17.0	15.8	-1.3	0.00	0.00	0.00	1.5	NNW
9/14/2023 10:46:00	121.5	15.9	-105.6	0.00	0.00	0.00	1.5	N
9/14/2023 10:47:00	130.8	17.5	-113.3	0.00	0.00	0.00	1.5	NNE
9/14/2023 10:48:00	198.9	19.1	-179.8	0.00	0.00	0.00	1.5	ENE
9/14/2023 10:49:00	285.3	20.1	-265.2	0.00	0.00	0.00	1.4	ENE
9/14/2023 10:50:00	401.6	21.6	-380.0	0.00	0.00	0.00	1.4	NNW
9/14/2023 10:51:00	414.7	22.4	-392.3	0.00	0.00	0.00	1.4	NNE
9/14/2023 10:52:00	422.0	23.2	-398.8	0.00	0.00	0.00	1.3	NW
9/14/2023 10:53:00	426.2	26.6	-399.6	0.00	0.00	0.00	1.4	N
9/14/2023 10:54:00	429.3	28.5	-400.8	0.00	0.00	0.00	1.4	NNE
9/14/2023 10:55:00	432.7	30.0	-402.7	0.00	0.00	0.00	1.4	NNE
9/14/2023 10:56:00	436.0	32.2	-403.8	0.00	0.00	0.00	1.4	NW
9/14/2023 10:57:00	439.0	34.1	-404.9	0.00	0.00	0.00	1.4	N
9/14/2023 10:58:00	439.5	36.0	-403.5	0.00	0.00	0.00	1.3	S
9/14/2023 10:59:00	442.0	38.3	-403.7	0.00	0.00	0.00	1.3	NW
9/14/2023 11:00:00	438.9	38.6	-400.3	0.01	0.00	-0.01	1.3	NNE

Date/Time	Average Upwind PM10 ($\mu\text{g}/\text{m}^3$)	Average Downwind PM10 ($\mu\text{g}/\text{m}^3$)	Average Contribution PM10 ($\mu\text{g}/\text{m}^3$)	Average Upwind VOC (ppm)	Average Downwind VOC (ppm)	Average Contribution VOC (ppm)	Wind Speed 15 min Avg	Wind Direction
9/14/2023 11:01:00	336.7	38.2	-298.5	0.02	0.00	-0.02	1.4	NNW
9/14/2023 11:02:00	329.4	37.2	-292.2	0.02	0.00	-0.02	1.3	NNE
9/14/2023 11:03:00	262.6	37.0	-225.6	0.02	0.00	-0.02	1.4	NW
9/14/2023 11:04:00	177.5	35.9	-141.6	0.02	0.00	-0.02	1.5	NW
9/14/2023 11:05:00	62.1	35.2	-26.9	0.02	0.00	-0.02	1.4	NW
9/14/2023 11:06:00				0.02	0.00	-0.02	1.5	ENE
9/14/2023 11:07:00				0.02	0.00	-0.02	1.5	NW
9/14/2023 11:08:00	12.4	8.4	-4.0	0.02	0.00	-0.02	1.5	NNW
9/14/2023 11:09:00	15.6	15.5	-0.1	0.02	0.00	-0.02	1.5	NE
9/14/2023 11:10:00	18.1	19.7	1.6	0.02	0.00	-0.02	1.5	N
9/14/2023 11:11:00	17.4	21.5	4.1	0.02	0.00	-0.02	1.5	NNE
9/14/2023 11:12:00	18.6	21.4	2.8	0.02	0.00	-0.02	1.6	WNW
9/14/2023 11:13:00	36.5	25.0	-11.5	0.02	0.00	-0.02	1.6	NNW
9/14/2023 11:14:00	36.1	23.7	-12.3	0.02	0.00	-0.02	1.7	WNW
9/14/2023 11:15:00	35.3	22.6	-12.7	0.01	0.00	-0.01	1.8	WNW
9/14/2023 11:16:00	33.0	23.0	-10.0	0.00	0.00	0.00	1.8	NNW
9/14/2023 11:17:00	31.2	23.3	-8.0	0.00	0.00	0.00	1.7	NE
9/14/2023 11:18:00	29.9	23.9	-5.9	0.00	0.00	0.00	1.8	NW
9/14/2023 11:19:00	28.1	23.2	-4.9	0.00	0.00	0.00	1.8	WNW
9/14/2023 11:20:00	27.0	22.7	-4.3	0.00	0.00	0.00	1.8	NNW
9/14/2023 11:21:00	26.3	22.0	-4.3	0.00	0.00	0.00	1.8	ENE
9/14/2023 11:22:00	26.3	22.0	-4.3	0.00	0.00	0.00	1.7	NW
9/14/2023 11:23:00	26.5	23.8	-2.6	0.00	0.00	0.00	1.7	NNE
9/14/2023 11:24:00	26.5	24.5	-2.0	0.01	0.00	0.00	1.6	NNW
9/14/2023 11:25:00	26.1	23.7	-2.4	0.01	0.00	-0.01	1.6	NNE
9/14/2023 11:26:00	26.1	22.9	-3.2	0.01	0.00	-0.01	1.6	NNW
9/14/2023 11:27:00	25.8	23.6	-2.1	0.01	0.00	-0.01	1.5	NNE
9/14/2023 11:28:00	19.1	21.8	2.7	0.01	0.00	-0.01	1.5	NNE
9/14/2023 11:29:00	17.6	21.8	4.2	0.01	0.00	-0.01	1.4	N
9/14/2023 11:30:00	17.4	21.9	4.5	0.01	0.00	-0.01	1.3	WNW
9/14/2023 11:31:00	17.4	21.9	4.4	0.01	0.00	-0.01	1.4	N
9/14/2023 11:32:00	17.4	21.4	4.0	0.01	0.00	-0.01	1.4	NE
9/14/2023 11:33:00	17.3	20.4	3.0	0.01	0.00	-0.01	1.3	NNE

Date/Time	Average Upwind PM10 (µg/m³)	Average Downwind PM10 (µg/m³)	Average Contribution PM10 (µg/m³)	Average Upwind VOC (ppm)	Average Downwind VOC (ppm)	Average Contribution VOC (ppm)	Wind Speed 15 min Avg	Wind Direction
9/14/2023 11:34:00	17.5	20.5	3.0	0.01	0.00	-0.01	1.3	NW
9/14/2023 11:35:00	17.7	20.5	2.8	0.01	0.00	-0.01	1.3	W
9/14/2023 11:36:00	17.8	20.5	2.8	0.01	0.00	-0.01	1.3	NW
9/14/2023 11:37:00	16.9	20.1	3.2	0.01	0.00	-0.01	1.3	WNW
9/14/2023 11:38:00	16.6	19.3	2.7	0.01	0.00	0.00	1.3	NW
9/14/2023 11:39:00	16.1	18.0	1.9	0.00	0.00	0.00	1.3	NNW
9/14/2023 11:40:00	16.3	18.0	1.7	0.00	0.00	0.00	1.3	SSW
9/14/2023 11:41:00	16.4	18.0	1.6	0.00	0.00	0.00	1.3	S
9/14/2023 11:42:00	16.0	16.3	0.2	0.00	0.00	0.00	1.2	NW
9/14/2023 11:43:00	14.9	16.2	1.3	0.00	0.00	0.00	1.2	W
9/14/2023 11:44:00	15.0	15.8	0.8	0.00	0.00	0.00	1.3	NW
9/14/2023 11:45:00	14.8	15.8	1.0	0.00	0.00	0.00	1.3	WNW
9/14/2023 11:46:00	15.0	15.2	0.1	0.00	0.00	0.00	1.2	W
9/14/2023 11:47:00	14.5	14.9	0.3	0.00	0.00	0.00	1.2	WNW
9/14/2023 11:48:00	14.4	14.3	0.0	0.00	0.00	0.00	1.2	ESE
9/14/2023 11:49:00	15.5	14.0	-1.5	0.00	0.00	0.00	1.2	NE
9/14/2023 11:50:00	15.1	15.3	0.2	0.00	0.00	0.00	1.2	WSW
9/14/2023 11:51:00	15.0	15.3	0.3	0.00	0.00	0.00	1.2	NNW
9/14/2023 11:52:00	14.9	15.1	0.1	0.00	0.00	0.00	1.2	WNW
9/14/2023 11:53:00	14.8	14.3	-0.6	0.00	0.00	0.00	1.2	WNW
9/14/2023 11:54:00	14.9	14.0	-0.9	0.00	0.00	0.00	1.2	ESE
9/14/2023 11:55:00	14.9	13.5	-1.5	0.00	0.00	0.00	1.2	ESE
9/14/2023 11:56:00	14.4	13.6	-0.8	0.00	0.00	0.00	1.2	SSE
9/14/2023 11:57:00	13.9	14.4	0.5	0.00	0.00	0.00	1.2	WSW
9/14/2023 11:58:00	14.4	13.9	-0.6	0.00	0.00	0.00	1.3	ENE
9/14/2023 11:59:00	15.1	13.4	-1.6	0.00	0.00	0.00	1.2	NNW
9/14/2023 12:00:00	15.1	12.8	-2.4	0.00	0.00	0.00	1.2	NNW
9/14/2023 12:01:00	14.2	13.0	-1.2	0.00	0.00	0.00	1.2	SSW
9/14/2023 12:02:00	14.1	12.8	-1.3	0.00	0.00	0.00	1.2	WNW
9/14/2023 12:03:00	13.7	13.0	-0.7	0.00	0.00	0.00	1.2	WNW
9/14/2023 12:04:00	12.8	12.7	-0.2	0.00	0.00	0.00	1.2	NW
9/14/2023 12:05:00	12.5	11.0	-1.5	0.00	0.00	0.00	1.3	W
9/14/2023 12:06:00	11.8	11.3	-0.5	0.00	0.00	0.00	1.3	WNW

Date/Time	Average Upwind PM10 (µg/m³)	Average Downwind PM10 (µg/m³)	Average Contribution PM10 (µg/m³)	Average Upwind VOC (ppm)	Average Downwind VOC (ppm)	Average Contribution VOC (ppm)	Wind Speed 15 min Avg	Wind Direction
9/14/2023 12:07:00	11.5	11.2	-0.2	0.00	0.00	0.00	1.3	NW
9/14/2023 12:08:00	11.6	10.9	-0.7	0.00	0.00	0.00	1.3	NE
9/14/2023 12:09:00	12.6	11.0	-1.5	0.00	0.00	0.00	1.2	NNE
9/14/2023 12:10:00	11.7	12.8	1.1	0.00	0.00	0.00	1.2	W
9/14/2023 12:11:00	11.7	12.9	1.2	0.00	0.00	0.00	1.2	W
9/14/2023 12:12:00	11.6	12.7	1.1	0.00	0.00	0.00	1.3	SSW
9/14/2023 12:13:00	11.0	13.3	2.3	0.00	0.00	0.00	1.3	W
9/14/2023 12:14:00	10.1	13.7	3.6	0.00	0.00	0.00	1.3	W
9/14/2023 12:15:00	9.0	14.0	5.0	0.00	0.00	0.00	1.3	W
9/14/2023 12:16:00	9.0	13.3	4.3	0.00	0.00	0.00	1.3	W
9/14/2023 12:17:00	8.8	13.4	4.6	0.00	0.00	0.00	1.3	SW
9/14/2023 12:18:00	8.7	13.6	4.9	0.00	0.00	0.00	1.3	SW
9/14/2023 12:19:00	7.9	14.5	6.6	0.00	0.00	0.00	1.2	WSW
9/14/2023 12:20:00	7.8	14.9	7.1	0.00	0.00	0.00	1.3	W
9/14/2023 12:21:00	7.7	14.6	6.9	0.00	0.00	0.00	1.2	W
9/14/2023 12:22:00	7.5	14.6	7.1	0.00	0.00	0.00	1.2	WNW
9/14/2023 12:23:00	7.0	14.9	7.9	0.00	0.00	0.00	1.2	W
9/14/2023 12:24:00	7.8	14.5	6.7	0.00	0.00	0.00	1.2	NNE
9/14/2023 12:25:00	9.4	12.5	3.1	0.00	0.00	0.00	1.2	ESE
9/14/2023 12:26:00	9.4	12.8	3.4	0.00	0.00	0.00	1.2	WSW
9/14/2023 12:27:00	10.0	12.4	2.4	0.00	0.00	0.00	1.2	SW
9/14/2023 12:28:00	10.7	12.1	1.4	0.00	0.00	0.00	1.2	SSE
9/14/2023 12:29:00	10.7	12.3	1.6	0.00	0.00	0.00	1.2	ESE
9/14/2023 12:30:00	10.8	12.8	1.9	0.00	0.00	0.00	1.2	SSE
9/14/2023 12:31:00	11.2	13.2	2.0	0.00	0.00	0.00	1.2	WSW
9/14/2023 12:32:00	11.4	13.6	2.2	0.00	0.00	0.00	1.2	SW
9/14/2023 12:33:00	12.3	13.1	0.8	0.00	0.00	0.00	1.2	NNW
9/14/2023 12:34:00	13.2	12.6	-0.6	0.00	0.00	0.00	1.2	N
9/14/2023 12:35:00	14.5	13.5	-1.0	0.00	0.00	0.00	1.2	SSW
9/14/2023 12:36:00	15.9	14.6	-1.4	0.00	0.00	0.00	1.2	WNW
9/14/2023 12:37:00	17.7	15.5	-2.3	0.00	0.00	0.00	1.3	E
9/14/2023 12:38:00	18.3	16.0	-2.3	0.00	0.00	0.00	1.3	WNW
9/14/2023 12:39:00	17.2	16.6	-0.6	0.00	0.00	0.00	1.3	ESE

Date/Time	Average Upwind PM10 (µg/m³)	Average Downwind PM10 (µg/m³)	Average Contribution PM10 (µg/m³)	Average Upwind VOC (ppm)	Average Downwind VOC (ppm)	Average Contribution VOC (ppm)	Wind Speed 15 min Avg	Wind Direction
9/14/2023 12:40:00	17.1	17.4	0.4	0.00	0.00	0.00	1.3	SE
9/14/2023 12:41:00	18.1	17.8	-0.3	0.00	0.00	0.00	1.3	WSW
9/14/2023 12:42:00	19.1	18.4	-0.7	0.00	0.00	0.00	1.3	ENE
9/14/2023 12:43:00	18.6	19.7	1.1	0.00	0.00	0.00	1.3	WSW
9/14/2023 12:44:00	20.1	19.9	-0.2	0.00	0.00	0.00	1.2	E
9/14/2023 12:45:00	21.3	19.9	-1.4	0.00	0.00	0.00	1.3	NNW
9/14/2023 12:46:00	21.6	20.5	-1.1	0.00	0.00	0.00	1.3	WSW
9/14/2023 12:47:00	22.9	19.7	-3.2	0.00	0.00	0.00	1.2	ESE
9/14/2023 12:48:00	22.6	21.3	-1.3	0.00	0.00	0.00	1.2	WSW
9/14/2023 12:49:00	22.5	22.6	0.2	0.00	0.00	0.00	1.3	WSW
9/14/2023 12:50:00	21.9	22.6	0.7	0.00	0.00	0.00	1.3	SSE
9/14/2023 12:51:00	21.3	21.7	0.3	0.00	0.00	0.00	1.3	NE
9/14/2023 12:52:00	20.4	20.6	0.2	0.00	0.00	0.00	1.2	NE
9/14/2023 12:53:00	22.9	19.5	-3.4	0.00	0.00	0.00	1.2	NW
9/14/2023 12:54:00	22.8	19.1	-3.7	0.00	0.00	0.00	1.2	NNW
9/14/2023 12:55:00	21.3	19.7	-1.7	0.00	0.00	0.00	1.2	NW
9/14/2023 12:56:00	21.7	18.4	-3.3	0.00	0.00	0.00	1.3	NNW
9/14/2023 12:57:00	20.1	18.3	-1.8	0.00	0.00	0.00	1.3	WNW
9/14/2023 12:58:00	19.9	17.4	-2.4	0.00	0.00	0.00	1.3	WNW
9/14/2023 12:59:00	19.6	18.0	-1.7	0.00	0.00	0.00	1.4	NNE
9/14/2023 13:00:00	20.8	19.9	-0.9	0.00	0.00	0.00	1.4	N
9/14/2023 13:01:00	23.1	19.7	-3.4	0.00	0.00	0.00	1.4	NW
9/14/2023 13:02:00	23.3	20.5	-2.8	0.00	0.00	0.00	1.4	ESE
9/14/2023 13:03:00	24.5	21.9	-2.7	0.00	0.00	0.00	1.4	NNW
9/14/2023 13:04:00	25.4	20.9	-4.6	0.00	0.00	0.00	1.4	NW
9/14/2023 13:05:00	25.5	20.5	-5.0	0.00	0.00	0.00	1.4	WNW
9/14/2023 13:06:00	26.0	21.7	-4.3	0.00	0.00	0.00	1.4	NW
9/14/2023 13:07:00	28.0	23.2	-4.8	0.00	0.00	0.00	1.4	WSW
9/14/2023 13:08:00	26.8	24.6	-2.2	0.00	0.00	0.00	1.4	ENE
9/14/2023 13:09:00	27.9	25.7	-2.2	0.00	0.00	0.00	1.4	NNE
9/14/2023 13:10:00	28.8	25.7	-3.1	0.00	0.00	0.00	1.3	W
9/14/2023 13:11:00	28.3	27.7	-0.6	0.00	0.00	0.00	1.3	W
9/14/2023 13:12:00	30.2	27.2	-3.0	0.00	0.00	0.00	1.3	E

Date/Time	Average Upwind PM10 (µg/m³)	Average Downwind PM10 (µg/m³)	Average Contribution PM10 (µg/m³)	Average Upwind VOC (ppm)	Average Downwind VOC (ppm)	Average Contribution VOC (ppm)	Wind Speed 15 min Avg	Wind Direction
9/14/2023 13:13:00	31.4	28.7	-2.7	0.00	0.00	0.00	1.3	WNW
9/14/2023 13:14:00	32.5	29.0	-3.5	0.00	0.00	0.00	1.3	NNW
9/14/2023 13:15:00	31.7	27.1	-4.7	0.00	0.00	0.00	1.3	N
9/14/2023 13:16:00	31.3	26.9	-4.5	0.00	0.00	0.00	1.2	NW
9/14/2023 13:17:00	30.3	28.7	-1.6	0.00	0.00	0.00	1.3	NNW
9/14/2023 13:18:00	29.1	26.6	-2.5	0.00	0.00	0.00	1.3	W
9/14/2023 13:19:00	28.1	28.1	0.0	0.00	0.00	0.00	1.3	SSW
9/14/2023 13:20:00	29.0	28.2	-0.8	0.00	0.00	0.00	1.3	NNE
9/14/2023 13:21:00	28.6	27.9	-0.7	0.00	0.00	0.00	1.3	WNW
9/14/2023 13:22:00	26.9	27.5	0.6	0.00	0.00	0.00	1.3	NNW
9/14/2023 13:23:00	26.0	27.7	1.7	0.00	0.00	0.00	1.3	WNW
9/14/2023 13:24:00	24.9	27.0	2.1	0.00	0.00	0.00	1.3	SE
9/14/2023 13:25:00	24.5	26.4	1.9	0.00	0.00	0.00	1.3	NNW
9/14/2023 13:26:00	24.8	25.3	0.5	0.00	0.00	0.00	1.3	ENE
9/14/2023 13:27:00	24.8	25.5	0.7	0.00	0.00	0.00	1.3	ESE
9/14/2023 13:28:00	24.6	24.1	-0.5	0.00	0.00	0.00	1.3	SE
9/14/2023 13:29:00	22.9	22.7	-0.2	0.00	0.00	0.00	1.2	NNW
9/14/2023 13:30:00	20.9	22.4	1.5	0.00	0.00	0.00	1.2	WNW
9/14/2023 13:31:00	19.1	21.5	2.4	0.00	0.00	0.00	1.2	NNW
9/14/2023 13:32:00	18.3	20.1	1.7	0.00	0.00	0.00	1.2	WSW
9/14/2023 13:33:00	17.8	20.8	3.0	0.00	0.00	0.00	1.2	SSE
9/14/2023 13:34:00	18.9	18.5	-0.4	0.00	0.00	0.00	1.2	NE
9/14/2023 13:35:00	17.2	18.0	0.8	0.00	0.00	0.00	1.2	SW
9/14/2023 13:36:00	17.1	16.6	-0.6	0.00	0.00	0.00	1.2	NE
9/14/2023 13:37:00	16.9	15.4	-1.5	0.00	0.00	0.00	1.3	ENE
9/14/2023 13:38:00	16.9	13.8	-3.0	0.00	0.00	0.00	1.3	E
9/14/2023 13:39:00	16.7	13.2	-3.5	0.00	0.00	0.00	1.3	ESE
9/14/2023 13:40:00	17.1	12.4	-4.7	0.00	0.00	0.00	1.3	ENE
9/14/2023 13:41:00	16.9	11.3	-5.5	0.00	0.00	0.00	1.3	NNE
9/14/2023 13:42:00	16.2	10.7	-5.6	0.00	0.00	0.00	1.3	N
9/14/2023 13:43:00	15.1	11.2	-3.8	0.00	0.00	0.00	1.3	NW
9/14/2023 13:44:00	15.5	11.0	-4.5	0.00	0.00	0.00	1.3	ESE
9/14/2023 13:45:00	15.6	11.9	-3.7	0.00	0.00	0.00	1.3	W

Date/Time	Average Upwind PM10 (µg/m³)	Average Downwind PM10 (µg/m³)	Average Contribution PM10 (µg/m³)	Average Upwind VOC (ppm)	Average Downwind VOC (ppm)	Average Contribution VOC (ppm)	Wind Speed 15 min Avg	Wind Direction
9/14/2023 13:46:00	15.1	12.8	-2.2	0.00	0.00	0.00	1.3	SW
9/14/2023 13:47:00	16.5	11.4	-5.0	0.00	0.00	0.00	1.4	ENE
9/14/2023 13:48:00	17.6	9.8	-7.8	0.00	0.00	0.00	1.4	ENE
9/14/2023 13:49:00	15.9	10.6	-5.3	0.00	0.00	0.00	1.3	WSW
9/14/2023 13:50:00	15.9	10.5	-5.4	0.00	0.00	0.00	1.3	W
9/14/2023 13:51:00	15.2	11.4	-3.7	0.00	0.00	0.00	1.3	W
9/14/2023 13:52:00	14.3	11.8	-2.5	0.00	0.00	0.00	1.2	WSW
9/14/2023 13:53:00	14.4	11.9	-2.5	0.00	0.00	0.00	1.2	E
9/14/2023 13:54:00	14.2	11.9	-2.2	0.00	0.00	0.00	1.2	E
9/14/2023 13:55:00	13.8	12.0	-1.8	0.00	0.00	0.00	1.2	NW
9/14/2023 13:56:00	12.6	12.3	-0.3	0.00	0.00	0.00	1.3	NW
9/14/2023 13:57:00	11.2	12.6	1.3	0.00	0.00	0.00	1.3	NW
9/14/2023 13:58:00	11.2	11.3	0.2	0.00	0.00	0.00	1.3	W
9/14/2023 13:59:00	9.6	11.7	2.1	0.00	0.00	0.00	1.4	W
9/14/2023 14:00:00	9.3	10.5	1.2	0.00	0.00	0.00	1.3	W
9/14/2023 14:01:00	9.0	10.3	1.3	0.00	0.00	0.00	1.3	W
9/14/2023 14:02:00	11.8	10.2	-1.7	0.00	0.00	0.00	1.3	NW
9/14/2023 14:03:00	12.3	10.3	-2.0	0.00	0.00	0.00	1.3	N
9/14/2023 14:04:00	12.4	10.6	-1.8	0.00	0.00	0.00	1.3	SSW
9/14/2023 14:05:00	12.4	11.4	-1.0	0.00	0.00	0.00	1.4	W
9/14/2023 14:06:00	12.5	10.8	-1.7	0.00	0.00	0.00	1.4	W
9/14/2023 14:07:00	12.7	10.6	-2.1	0.00	0.00	0.00	1.4	WNW
9/14/2023 14:08:00	12.1	11.1	-1.0	0.00	0.00	0.00	1.4	WNW
9/14/2023 14:09:00	11.4	11.5	0.1	0.00	0.00	0.00	1.4	WNW
9/14/2023 14:10:00	10.8	11.7	0.9	0.00	0.00	0.00	1.5	WNW
9/14/2023 14:11:00	10.8	11.6	0.8	0.00	0.00	0.00	1.4	WNW
9/14/2023 14:12:00	11.6	11.3	-0.3	0.00	0.00	0.00	1.4	N
9/14/2023 14:13:00	11.6	11.7	0.0	0.00	0.00	0.00	1.4	SE
9/14/2023 14:14:00	12.6	11.3	-1.3	0.00	0.00	0.00	1.3	NE
9/14/2023 14:15:00	14.2	10.9	-3.3	0.00	0.00	0.00	1.3	N
9/14/2023 14:16:00	14.2	11.0	-3.2	0.00	0.00	0.00	1.3	WNW
9/14/2023 14:17:00	9.9	11.3	1.4	0.00	0.00	0.00	1.3	WNW
9/14/2023 14:18:00	8.3	11.4	3.2	0.00	0.00	0.00	1.4	W

Date/Time	Average Upwind PM10 (µg/m³)	Average Downwind PM10 (µg/m³)	Average Contribution PM10 (µg/m³)	Average Upwind VOC (ppm)	Average Downwind VOC (ppm)	Average Contribution VOC (ppm)	Wind Speed 15 min Avg	Wind Direction
9/14/2023 14:19:00	7.9	10.4	2.5	0.00	0.00	0.00	1.4	W
9/14/2023 14:20:00	7.5	8.9	1.4	0.00	0.00	0.00	1.4	WNW
9/14/2023 14:21:00	7.2	8.8	1.5	0.00	0.00	0.00	1.4	NW
9/14/2023 14:22:00	7.3	8.1	0.8	0.00	0.00	0.00	1.4	N
9/14/2023 14:23:00	7.8	7.3	-0.5	0.00	0.00	0.00	1.4	NE
9/14/2023 14:24:00	8.2	6.8	-1.4	0.00	0.00	0.00	1.4	NE
9/14/2023 14:25:00	9.6	6.4	-3.2	0.00	0.00	0.00	1.4	ENE
9/14/2023 14:26:00	10.7	6.0	-4.6	0.00	0.00	0.00	1.4	NE
9/14/2023 14:27:00	9.9	6.7	-3.1	0.00	0.00	0.00	1.4	W
9/14/2023 14:28:00	9.7	6.5	-3.2	0.00	0.00	0.00	1.4	W
9/14/2023 14:29:00	8.7	7.0	-1.7	0.00	0.00	0.00	1.5	W
9/14/2023 14:30:00	7.0	7.4	0.4	0.00	0.00	0.00	1.4	W
9/14/2023 14:31:00	6.8	10.3	3.4	0.00	0.00	0.00	1.4	W
9/14/2023 14:32:00	6.7	11.9	5.1	0.00	0.00	0.00	1.4	W
9/14/2023 14:33:00	6.7	16.4	9.7	0.00	0.00	0.00	1.4	WNW
9/14/2023 14:34:00	6.7	16.6	9.9	0.00	0.00	0.00	1.3	WSW
9/14/2023 14:35:00	7.5	16.3	8.7	0.00	0.00	0.00	1.3	NNE
9/14/2023 14:36:00	8.6	15.9	7.3	0.00	0.00	0.00	1.3	E
9/14/2023 14:37:00	8.8	15.9	7.2	0.00	0.00	0.00	1.2	NW
9/14/2023 14:38:00	7.7	16.6	8.9	0.00	0.00	0.00	1.2	SSW
9/14/2023 14:39:00	7.5	16.5	9.0	0.00	0.00	0.00	1.2	ENE
9/14/2023 14:40:00	5.9	16.9	11.0	0.00	0.00	0.00	1.3	SE
9/14/2023 14:41:00	4.7	17.4	12.7	0.00	0.00	0.00	1.3	WSW
9/14/2023 14:42:00	5.4	16.7	11.3	0.00	0.00	0.00	1.3	ESE
9/14/2023 14:43:00	6.2	16.1	9.9	0.00	0.00	0.00	1.3	E
9/14/2023 14:44:00	6.8	15.5	8.7	0.00	0.00	0.00	1.2	ENE
9/14/2023 14:45:00	7.2	14.9	7.7	0.00	0.00	0.00	1.3	NNW
9/14/2023 14:46:00	7.2	11.4	4.2	0.00	0.00	0.00	1.3	W
9/14/2023 14:47:00	7.2	10.1	2.9	0.00	0.00	0.00	1.3	W
9/14/2023 14:48:00	7.7	5.2	-2.6	0.00	0.00	0.00	1.3	NW
9/14/2023 14:49:00	7.7	4.9	-2.8	0.00	0.00	0.00	1.3	WNW
9/14/2023 14:50:00	6.9	5.2	-1.7	0.00	0.00	0.00	1.3	WNW
9/14/2023 14:51:00	6.3	5.1	-1.3	0.00	0.00	0.00	1.3	N

Date/Time	Average Upwind PM10 (µg/m³)	Average Downwind PM10 (µg/m³)	Average Contribution PM10 (µg/m³)	Average Upwind VOC (ppm)	Average Downwind VOC (ppm)	Average Contribution VOC (ppm)	Wind Speed 15 min Avg	Wind Direction
9/14/2023 14:52:00	6.0	5.0	-1.0	0.00	0.00	0.00	1.3	SE
9/14/2023 14:53:00	5.9	5.0	-0.9	0.00	0.00	0.00	1.3	NW
9/14/2023 14:54:00	5.3	5.5	0.2	0.00	0.00	0.00	1.3	NW
9/14/2023 14:55:00	5.3	5.4	0.0	0.00	0.00	0.00	1.3	WNW
9/14/2023 14:56:00	5.3	5.3	0.0	0.00	0.00	0.00	1.3	WNW
9/14/2023 14:57:00	5.0	5.2	0.2	0.00	0.00	0.00	1.3	NNW
9/14/2023 14:58:00	4.9	5.3	0.5	0.00	0.00	0.00	1.2	E
9/14/2023 14:59:00	5.0	5.4	0.5	0.00	0.00	0.00	1.2	E
9/14/2023 15:00:00	5.3	5.5	0.1	0.00	0.00	0.00	1.2	SE
9/14/2023 15:01:00	5.4	5.9	0.5	0.00	0.00	0.00	1.1	SW
9/14/2023 15:02:00	5.7	5.8	0.1	0.00	0.00	0.00	1.1	W
9/14/2023 15:03:00	5.4	6.3	0.9	0.00	0.00	0.00	1.1	WNW
9/14/2023 15:04:00				0.00	0.00	0.00	1.0	W
9/14/2023 15:05:00				0.00	0.00	0.00	1.0	W
9/14/2023 15:06:00	6.4	3.9	-2.5	0.00	0.00	0.00	1.0	ENE
9/14/2023 15:07:00	7.2	3.9	-3.3	0.00	0.00	0.00	1.1	E
9/14/2023 15:08:00	5.9	4.4	-1.5	0.00	0.00	0.00	1.1	W
9/14/2023 15:09:00	6.2	4.2	-2.0	0.00	0.00	0.00	1.1	NNW
9/14/2023 15:10:00	6.8	4.2	-2.7	0.00	0.00	0.00	1.1	N
9/14/2023 15:11:00	6.6	4.5	-2.0	0.00	0.00	0.00	1.1	SW
9/14/2023 15:12:00	6.5	4.7	-1.8	0.00	0.00	0.00	1.2	NNW
9/14/2023 15:13:00	6.1	5.1	-1.0	0.00	0.00	0.00	1.3	W
9/14/2023 15:14:00	5.8	5.2	-0.6	0.00	0.00	0.00	1.3	W
9/14/2023 15:15:00	5.7	5.1	-0.6	0.00	0.00	0.00	1.4	WNW
9/14/2023 15:16:00	5.7	5.0	-0.7	0.00	0.00	0.00	1.4	WNW
9/14/2023 15:17:00	5.7	5.3	-0.4	0.00	0.00	0.00	1.4	W
9/14/2023 15:18:00	5.5	5.7	0.1	0.00	0.00	0.00	1.4	W
9/14/2023 15:19:00	5.4	5.6	0.1	0.00	0.00	0.00	1.3	WNW
9/14/2023 15:20:00	5.4	5.4	0.1	0.00	0.00	0.00	1.3	NW
9/14/2023 15:21:00	5.4	5.4	0.0	0.00	0.00	0.00	1.3	NNW
9/14/2023 15:22:00	6.7	5.5	-1.3	0.00	0.00	0.00	1.4	NW
9/14/2023 15:23:00	7.2	6.0	-1.2	0.00	0.00	0.00	1.4	NW
9/14/2023 15:24:00	7.9	7.4	-0.5	0.00	0.00	0.00	1.4	WNW

Date/Time	Average Upwind PM10 ($\mu\text{g}/\text{m}^3$)	Average Downwind PM10 ($\mu\text{g}/\text{m}^3$)	Average Contribution PM10 ($\mu\text{g}/\text{m}^3$)	Average Upwind VOC (ppm)	Average Downwind VOC (ppm)	Average Contribution VOC (ppm)	Wind Speed 15 min Avg	Wind Direction
9/14/2023 15:25:00	7.9	8.2	0.3	0.00	0.00	0.00	1.4	NE
9/14/2023 15:26:00	8.1	8.3	0.1	0.00	0.00	0.00	1.4	NW
9/14/2023 15:27:00	8.1	8.4	0.4	0.00	0.00	0.00	1.3	WNW
9/14/2023 15:28:00	8.0	8.3	0.2	0.00	0.00	0.00	1.3	NW
9/14/2023 15:29:00	8.1	8.2	0.2	0.00	0.00	0.00	1.3	WNW
9/14/2023 15:30:00	9.2	8.2	-1.0	0.00	0.00	0.00	1.2	ENE
9/14/2023 15:31:00	11.9	8.4	-3.4	0.00	0.00	0.00	1.3	NE
9/14/2023 15:32:00	15.7	8.6	-7.1	0.00	0.00	0.00	1.3	E
9/14/2023 15:33:00	22.4	8.3	-14.2	0.00	0.00	0.00	1.3	NE
9/14/2023 15:34:00	31.5	8.5	-23.0	0.00	0.00	0.00	1.4	ESE
9/14/2023 15:35:00	36.6	8.8	-27.9	0.00	0.00	0.00	1.5	ENE
9/14/2023 15:36:00	39.1	8.9	-30.2	0.00	0.00	0.00	1.5	E
9/14/2023 15:37:00	39.6	8.9	-30.6	0.00	0.00	0.00	1.6	E
9/14/2023 15:38:00	44.0	8.3	-35.8	0.00	0.00	0.00	1.6	E
9/14/2023 15:39:00	48.0	6.8	-41.2	0.00	0.00	0.00	1.6	E
9/14/2023 15:40:00	47.5	9.3	-38.3	0.00	0.00	0.00	1.6	W
9/14/2023 15:41:00	47.2	9.3	-37.9	0.00	0.00	0.00	1.6	WNW
9/14/2023 15:42:00	47.5	9.2	-38.3	0.00	0.00	0.00	1.6	E
9/14/2023 15:43:00	49.4	9.1	-40.3	0.00	0.00	0.00	1.6	ENE
9/14/2023 15:44:00	50.8	9.0	-41.8	0.00	0.00	0.00	1.7	ENE
9/14/2023 15:45:00	51.7	9.1	-42.6	0.00	0.00	0.00	1.8	E
9/14/2023 15:46:00	49.7	8.9	-40.8	0.00	0.00	0.00	1.8	E
9/14/2023 15:47:00	46.9	8.6	-38.3	0.00	0.00	0.00	1.8	E
9/14/2023 15:48:00	40.5	8.7	-31.9	0.00	0.00	0.00	1.8	NE
9/14/2023 15:49:00	32.6	8.6	-24.0	0.00	0.00	0.00	1.8	ENE
9/14/2023 15:50:00	27.4	9.3	-18.1	0.00	0.00	0.00	1.8	NW
9/14/2023 15:51:00	25.4	9.2	-16.3	0.00	0.00	0.00	1.8	E
9/14/2023 15:52:00	24.9	9.2	-15.7	0.00	0.00	0.00	1.6	E
9/14/2023 15:53:00	20.1	10.4	-9.7	0.00	0.00	0.00	1.5	SSW
9/14/2023 15:54:00	17.0	10.6	-6.4	0.00	0.00	0.00	1.6	E
9/14/2023 15:55:00	17.7	7.4	-10.3	0.00	0.00	0.00	1.6	N
9/14/2023 15:56:00	18.1	7.3	-10.8	0.00	0.00	0.00	1.6	NNW
9/14/2023 15:57:00	17.9	7.5	-10.4	0.00	0.00	0.00	1.6	NE

Date/Time	Average Upwind PM10 (µg/m³)	Average Downwind PM10 (µg/m³)	Average Contribution PM10 (µg/m³)	Average Upwind VOC (ppm)	Average Downwind VOC (ppm)	Average Contribution VOC (ppm)	Wind Speed 15 min Avg	Wind Direction
9/14/2023 15:58:00	16.3	8.3	-8.0	0.00	0.00	0.00	1.6	ENE
9/14/2023 15:59:00	15.2	8.6	-6.7	0.00	0.00	0.00	1.5	NE
9/14/2023 16:00:00	13.5	8.8	-4.7	0.00	0.00	0.00	1.5	WNW
9/14/2023 16:01:00	12.8	8.8	-4.0	0.00	0.00	0.00	1.4	W
9/14/2023 16:02:00	11.9	9.0	-2.9	0.00	0.00	0.00	1.3	W
9/14/2023 16:03:00	11.7	8.9	-2.8	0.00	0.00	0.00	1.3	NE
9/14/2023 16:04:00	10.7	9.0	-1.7	0.00	0.00	0.00	1.3	WNW
9/14/2023 16:05:00	10.7	8.1	-2.6	0.00	0.00	0.00	1.3	WNW
9/14/2023 16:06:00	10.0	8.2	-1.8	0.00	0.00	0.00	1.3	WNW
9/14/2023 16:07:00	8.6	8.1	-0.5	0.00	0.00	0.00	1.3	NNE
9/14/2023 16:08:00	8.8	7.0	-1.7	0.00	0.00	0.00	1.3	WNW
9/14/2023 16:09:00	7.3	7.1	-0.2	0.00	0.00	0.00	1.3	NW
9/14/2023 16:10:00	6.7	7.1	0.4	0.00	0.00	0.00	1.2	WSW
9/14/2023 16:11:00	6.5	7.0	0.4	0.00	0.00	0.00	1.2	ENE
9/14/2023 16:12:00	6.3	7.2	0.9	0.00	0.00	0.00	1.2	WNW
9/14/2023 16:13:00	6.0	7.9	1.9	0.00	0.00	0.00	1.3	WNW
9/14/2023 16:14:00	6.3	7.5	1.2	0.00	0.00	0.00	1.3	NE
9/14/2023 16:15:00	6.3	7.2	0.9	0.00	0.00	0.00	1.3	E
9/14/2023 16:16:00	6.3	7.1	0.8	0.00	0.00	0.00	1.3	E
9/14/2023 16:17:00	6.4	6.9	0.5	0.00	0.00	0.00	1.3	NW
9/14/2023 16:18:00	6.7	6.8	0.1	0.00	0.00	0.00	1.2	NNE
9/14/2023 16:19:00	7.3	6.6	-0.8	0.00	0.00	0.00	1.3	E
9/14/2023 16:20:00	8.3	6.8	-1.6	0.00	0.00	0.00	1.2	NE
9/14/2023 16:21:00	8.8	7.6	-1.3	0.00	0.00	0.00	1.2	WNW
9/14/2023 16:22:00	9.0	8.1	-0.9	0.00	0.00	0.00	1.2	W
9/14/2023 16:23:00	9.1	8.1	-1.0	0.00	0.00	0.00	1.3	NE
9/14/2023 16:24:00	9.2	8.1	-1.1	0.00	0.00	0.00	1.3	E
9/14/2023 16:25:00	9.2	8.0	-1.2	0.00	0.00	0.00	1.3	NE
9/14/2023 16:26:00	9.0	8.2	-0.8	0.00	0.00	0.00	1.3	SSW
9/14/2023 16:27:00	9.2	7.6	-1.6	0.00	0.00	0.00	1.2	ESE
9/14/2023 16:28:00	9.3	6.4	-2.9	0.00	0.00	0.00	1.2	SW
9/14/2023 16:29:00	8.6	7.3	-1.3	0.00	0.00	0.00	1.2	NW
9/14/2023 16:30:00	9.5	7.5	-2.0	0.00	0.00	0.00	1.2	E

Date/Time	Average Upwind PM10 ($\mu\text{g}/\text{m}^3$)	Average Downwind PM10 ($\mu\text{g}/\text{m}^3$)	Average Contribution PM10 ($\mu\text{g}/\text{m}^3$)	Average Upwind VOC (ppm)	Average Downwind VOC (ppm)	Average Contribution VOC (ppm)	Wind Speed 15 min Avg	Wind Direction
9/14/2023 16:31:00	10.6	7.6	-3.0	0.00	0.00	0.00	1.3	E
9/14/2023 16:32:00	14.9	7.6	-7.3	0.00	0.00	0.00	1.3	N
9/14/2023 16:33:00	16.1	7.5	-8.5	0.00	0.00	0.00	1.4	ENE
9/14/2023 16:34:00	15.3	8.0	-7.3	0.00	0.00	0.00	1.4	W
9/14/2023 16:35:00	14.3	8.3	-6.0	0.00	0.00	0.00	1.4	SW
9/14/2023 16:36:00	14.4	7.4	-7.0	0.00	0.00	0.00	1.4	E
9/14/2023 16:37:00	14.8	6.9	-7.9	0.00	0.00	0.00	1.3	NE
9/14/2023 16:38:00	15.1	6.8	-8.3	0.00	0.00	0.00	1.3	ENE
9/14/2023 16:39:00	15.7	6.8	-8.9	0.00	0.00	0.00	1.3	ENE
9/14/2023 16:40:00	16.3	6.8	-9.5	0.00	0.00	0.00	1.3	ESE
9/14/2023 16:41:00	16.8	6.8	-10.0	0.00	0.00	0.00	1.4	NE
9/14/2023 16:42:00	17.0	6.9	-10.1	0.00	0.00	0.00	1.4	NNE
9/14/2023 16:43:00	17.4	6.8	-10.7	0.00	0.00	0.00	1.5	ENE
9/14/2023 16:44:00	18.1	6.1	-12.1	0.00	0.00	0.00	1.5	ENE
9/14/2023 16:45:00	18.0	6.2	-11.7	0.00	0.00	0.00	1.4	ESE
9/14/2023 16:46:00	17.4	6.3	-11.1	0.00	0.00	0.00	1.4	E
9/14/2023 16:47:00	13.0	7.0	-6.0	0.00	0.00	0.00	1.4	W
9/14/2023 16:48:00	11.4	7.6	-3.8	0.00	0.00	0.00	1.3	W
9/14/2023 16:49:00	11.4	7.9	-3.5	0.00	0.00	0.00	1.3	NW
9/14/2023 16:50:00	11.9	7.5	-4.4	0.00	0.00	0.00	1.3	E
9/14/2023 16:51:00	11.7	7.7	-4.0	0.00	0.00	0.00	1.3	ENE
9/14/2023 16:52:00	11.3	7.9	-3.4	0.00	0.00	0.00	1.3	E
9/14/2023 16:53:00	10.7	8.1	-2.6	0.00	0.00	0.00	1.2	SE
9/14/2023 16:54:00	10.2	8.0	-2.2	0.00	0.00	0.00	1.2	E
9/14/2023 16:55:00	9.7	8.0	-1.7	0.00	0.00	0.00	1.2	E
9/14/2023 16:56:00	9.5	8.0	-1.5	0.00	0.00	0.00	1.2	E
9/14/2023 16:57:00	9.4	8.1	-1.4	0.00	0.00	0.00	1.2	ESE
9/14/2023 16:58:00	9.2	8.2	-1.0	0.00	0.00	0.00	1.2	SW
9/14/2023 16:59:00	8.7	8.1	-0.6	0.00	0.00	0.00	1.2	ENE
9/14/2023 17:00:00	7.9	8.0	0.1	0.00	0.00	0.00	1.2	E
9/14/2023 17:01:00	7.3	7.9	0.6	0.00	0.00	0.00	1.2	E
9/14/2023 17:02:00	7.5	7.2	-0.2	0.00	0.00	0.00	1.3	ESE
9/14/2023 17:03:00	7.6	6.8	-0.8	0.00	0.00	0.00	1.3	ENE

Date/Time	Average Upwind PM10 (µg/m³)	Average Downwind PM10 (µg/m³)	Average Contribution PM10 (µg/m³)	Average Upwind VOC (ppm)	Average Downwind VOC (ppm)	Average Contribution VOC (ppm)	Wind Speed 15 min Avg	Wind Direction
9/14/2023 17:04:00	7.8	6.2	-1.6	0.00	0.00	0.00	1.3	SE
9/14/2023 17:05:00	7.3	6.3	-1.1	0.00	0.00	0.00	1.3	SSE
9/14/2023 17:06:00	7.1	6.2	-0.9	0.00	0.00	0.00	1.3	NNE
9/14/2023 17:07:00	7.0	6.1	-0.9	0.00	0.00	0.00	1.3	N
9/14/2023 17:08:00	7.0	6.0	-1.0	0.00	0.00	0.00	1.3	NNW
9/14/2023 17:09:00	6.9	6.1	-0.8	0.00	0.00	0.00	1.3	E
9/14/2023 17:10:00	6.7	6.1	-0.6	0.00	0.00	0.00	1.3	ENE
9/14/2023 17:11:00	6.6	6.1	-0.5	0.00	0.00	0.00	1.3	E
9/14/2023 17:12:00	6.4	6.0	-0.4	0.00	0.00	0.00	1.3	ENE
9/14/2023 17:13:00	6.3	5.7	-0.5	0.00	0.00	0.00	1.2	N
9/14/2023 17:14:00	6.1	5.6	-0.5	0.00	0.00	0.00	1.2	ENE
9/14/2023 17:15:00	5.9	5.5	-0.4	0.00	0.00	0.00	1.2	SE
9/14/2023 17:16:00	5.7	5.5	-0.2	0.00	0.00	0.00	1.2	WNW
9/14/2023 17:17:00	5.6	5.5	-0.1	0.00	0.00	0.00	1.2	NE
9/14/2023 17:18:00	5.4	5.3	-0.2	0.00	0.00	0.00	1.2	E
9/14/2023 17:19:00	5.3	5.0	-0.3	0.00	0.00	0.00	1.1	NE
9/14/2023 17:20:00	5.3	5.0	-0.2	0.00	0.00	0.00	1.2	WNW
9/14/2023 17:21:00	5.3	5.1	-0.2	0.00	0.00	0.00	1.1	NW
9/14/2023 17:22:00	5.4	5.1	-0.3	0.00	0.00	0.00	1.1	NE
9/14/2023 17:23:00	5.4	5.0	-0.4	0.00	0.00	0.00	1.1	E
9/14/2023 17:24:00	5.4	5.0	-0.4	0.00	0.00	0.00	1.1	NE
9/14/2023 17:25:00	5.3	4.9	-0.5	0.00	0.00	0.00	1.1	E
9/14/2023 17:26:00	5.3	4.8	-0.4	0.00	0.00	0.00	1.1	ENE
9/14/2023 17:27:00	5.2	4.8	-0.5	0.00	0.00	0.00	1.1	NNE
9/14/2023 17:28:00	5.2	4.7	-0.5	0.00	0.00	0.00	1.1	ESE
9/14/2023 17:29:00	5.2	4.6	-0.6	0.00	0.00	0.00	1.1	ESE
9/14/2023 17:30:00	5.2	4.5	-0.6	0.00	0.00	0.00	1.0	W
9/14/2023 17:31:00	5.2	4.6	-0.6	0.00	0.00	0.00	1.0	WSW
9/14/2023 17:32:00	5.6	4.6	-1.0	0.00	0.00	0.00	1.0	N
9/14/2023 17:33:00	5.5	4.8	-0.6	0.00	0.00	0.00	1.0	WSW
9/14/2023 17:34:00	5.3	5.0	-0.3	0.00	0.00	0.00	1.1	WNW
9/14/2023 17:35:00	5.4	4.8	-0.6	0.00	0.00	0.00	1.1	N
9/14/2023 17:36:00	5.2	4.7	-0.5	0.00	0.00	0.00	1.1	WNW

Date/Time	Average Upwind PM10 ($\mu\text{g}/\text{m}^3$)	Average Downwind PM10 ($\mu\text{g}/\text{m}^3$)	Average Contribution PM10 ($\mu\text{g}/\text{m}^3$)	Average Upwind VOC (ppm)	Average Downwind VOC (ppm)	Average Contribution VOC (ppm)	Wind Speed 15 min Avg	Wind Direction
9/14/2023 17:37:00	5.0	4.5	-0.5	0.00	0.00	0.00	1.2	NNE