

## DAILY STATUS REPORT

Prepared By: Lauren Kott

WEATHER	Snow		Rain		Overcast		Partly Cloudy	x	Bright Sun	
TEMP.	< 32		40-50		50-70	x	70-85		>85	

Langan Project No:	100688801	Project:	12074 Flatlands Avenue p/o Lot 1	Date:	11/1/2022
NYSDEC BCP Site No:	C224353			Time:	06:45 – 2:45

### Consultant:

Langan Engineering, Environmental, Surveying, Landscape Architecture and Geology, D.P.C.

### PERSONNEL ON SITE:

**Langan:** Patrick Lenihan (Geotechnical)

**Craig:** George Zackman, John Millington (Drillers)

**EQUIPMENT ON SITE:** Two (2) CME truck-mounted drill rigs

### Site Activities

- Langan mobilized to the site with Craig Geotechnical Drilling Co., Inc. (Craig), the geotechnical drilling contractor.
- Craig used a CME truck-mounted drill rig to advance soil borings B-18 to a depth of 75-feet bgs and B-22 to a depth of 100-feet bgs. No soil impacts were observed during the installation of the boring.
- Craig used a CME truck-mounted drill rig to advance soil boring B-21 to a depth of 30-feet bgs. Elevated PID readings (between 0.6 and 3.3 parts per million [ppm]) were observed between 8 and 22 feet bgs within the soil boring. All soil between 8 to 22 feet was placed within glass sample jars.

### Samples Collected

- None.

### Community Air Monitoring Program (CAMP)

- Langan implemented the CAMP during soil disturbance. The CAMP equipment consisted of a DustTrack II and photoionization detector (PID) at dedicated locations on the downwind perimeter and upwind perimeter of the site, as well as a personal DataRam (pDR) and Photoionization Detector (PID) at a work zone monitoring station.
- Dust and VOC concentrations were not detected in exceedance of the daily STEL.

### Problems Encountered

- None.

### Activities Scheduled for Next Day

- Craig will continue the installation of soil borings.

## Photo Log

Photo 1 – Craig collecting a split spoon sample at B-22, facing west.



Photo 2 – Split spoon sample in fill at B-21.



# SITE MAP

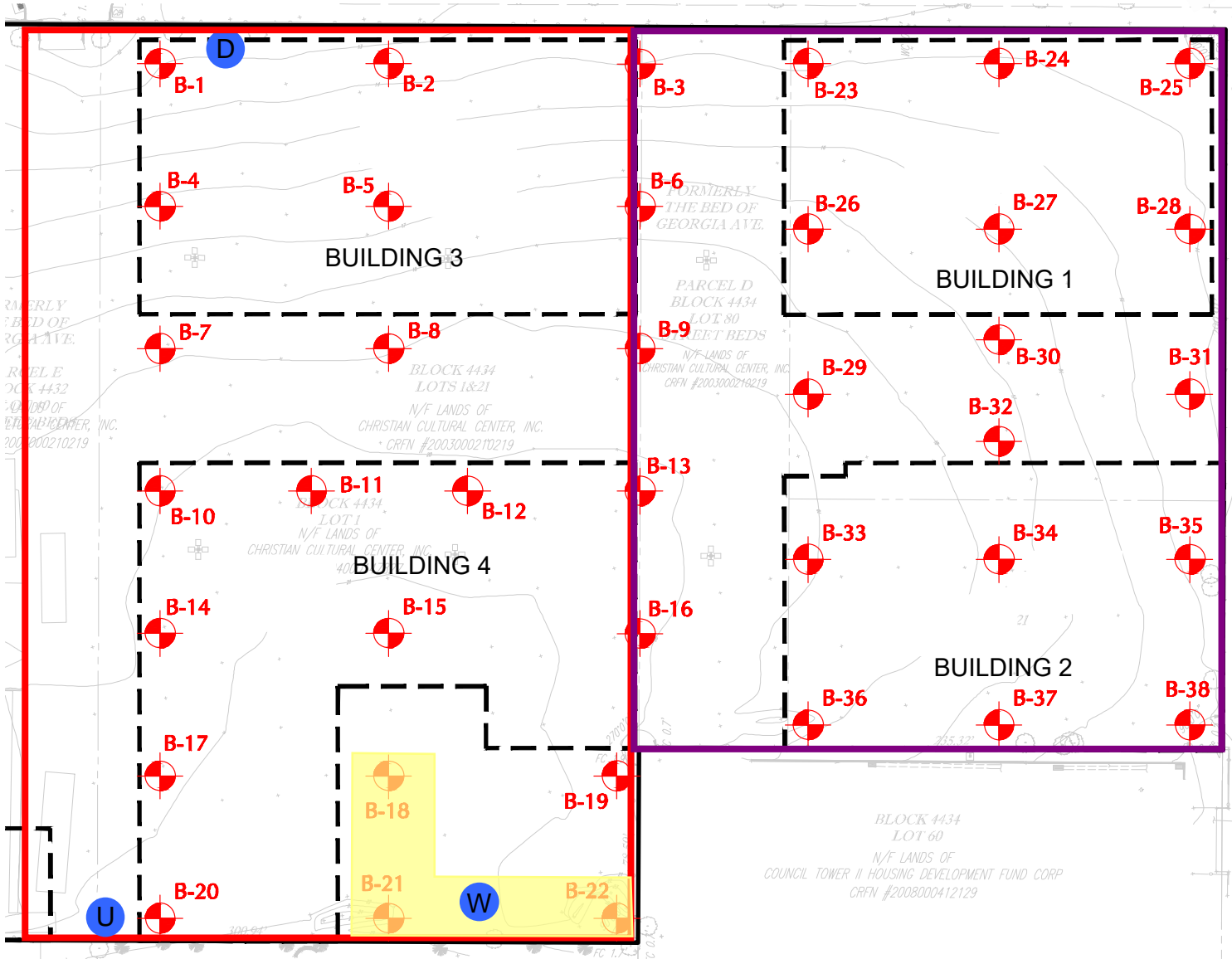

Approximate and Not to Scale

## LEGEND



BCP Site No. C224353 (12074 Flatlands Avenue p/o Lot 1) Site Boundary



BCP Site No. C224290 (12096 Flatlands Avenue) Site Boundary



Proposed Building Area



Geotechnical Boring



Work Zone Air Monitoring Station



Downwind Perimeter Air Monitoring Station



Upwind Perimeter Air Monitoring Station



Work Area

## NOTES

1. Basemap taken from Figure 1 - Proposed Phase IA & Phase IB Subsurface Investigation Plan.