

LANGAN SITE OBSERVATION REPORT – Day 214

<p>CLIENT: Gowanus Canal LLC, GowCan Owner, LLC, and Bayside Gowanus Owner, L.L.C.</p> <p>PROJECT No.: 170295301</p> <p>PROJECT: Gowanus Canal Northside</p> <p>LOCATION: Brooklyn, New York</p>	<p>DATE: Wednesday, June 7, 2023</p> <p>WEATHER: Cloudy, 60 – 72 °F Wind: WNW @ 2 – 6 mph</p> <p>TIME: 06:30 – 18:15</p> <p>BCP SITE ID: C224080</p>
<p>EQUIPMENT: Komatsu PC 490 Excavator Komatsu PC 240 Excavator Komatsu PC 78 US Excavator Komatsu Wheel Loader Komatsu PC 490 Excavator</p>	<p>PRESENT AT SITE: Langan: Lauren Roper (Environmental) Urban Atelier Group (UAG): Seth Anderson Kingdom Associates, Inc. (Kingdom): George Minchala TT Mechanical Corp. (TT Mechanical): Damien Sokol</p>
<p>OBSERVATIONS, DISCUSSIONS, TEST RESULTS, ETC.:</p> <p>Langan was on-site to document implementation of the New York State Department of Environmental Conservation (NYSDEC)-approved March 24, 2022 Remedial Action Work Plan (RAWP) for Brownfield Cleanup Program (BCP) Site No. C224080. Site Map 1 presents the Society Brooklyn and Sackett Place developments, which together comprise the BCP site.</p> <p>Site Activities</p> <ul style="list-style-type: none"> • Kingdom placed concrete for the first-floor slab in the central and northeastern parts of Society Brooklyn. The composite cover system is now complete within the building footprints. • Kingdom performed utility installation-related work in the Sackett Street right-of-way outside the BCP boundary as part of development-related construction. This work is not part of RAWP implementation. 	
<p>Cc: J. Hayes, M. Burke, P. Farnham, E. Adkins, A. Nesci</p>	<p>By: Lauren Roper Langan, D.P.C.</p>

Import and Export Tracking

- No material was imported to the site.
- No material was exported from the site.

Soil/Fill Export Summary			
Facility	Exported	Today	Total
Bayshore Soil Management Keasbey, NJ Non-Hazardous Soil/Fill	No. Loads	0	764
	Quantity (CY)	0	15,280
Bayshore Soil Management Keasbey, NJ Non-Hazardous MGP-Impacted Soil/Fill	No. Loads	0	79
	Quantity (CY)	0	1,580
Phase III Environmental Palmerton, PA Non-Hazardous Soil/Fill	No. Loads	0	67
	Quantity (CY)	0	1,340

Material Import Summary				
Facility	NYSDEC Approved Quantity (CY)	Imported	Today	Total
Stavola Construction Materials, Inc Bridgewater, NJ 2.5-inch Stone	1,000	No. Loads	0	15
		Quantity (CY)	0	300
87 19th Avenue Astoria, NY 2.5-inch Stone	2,000	No. Loads	0	31
		Quantity (CY)	0	650
Impact Environmental Jersey City, NJ 0.5-inch Crushed Stone	5,000	No. Loads	0	224
		Quantity (CY)	0	4,480
Impact Environmental Lyndhurst, NJ 0.5-inch Crushed Stone	6,000	No. Loads	0	48
		Quantity (CY)	0	960
Impact Environmental Lyndhurst, NJ 0.75-inch Crushed Stone	4,000	No. Loads	0	29
		Quantity (CY)	0	580
Tilcon New York Inc. Wharton, NJ ASTM #5 Virgin Quarry Stone	3,500	No. Loads	0	95
		Quantity (CY)	0	1,900

Sampling

- No samples were collected.

Community Air Monitoring

- No on-site soil-intrusive work was performed.

Anticipated Activities

- Kingdom will continue to perform utility-related work in Sackett Street.

Cc:	J. Hayes, M. Burke, P. Farnham, E. Adkins, A. Nesci	By:	Lauren Roper
			Langan, D.P.C.

Site Photographs



Photo 1: General view of Society Brooklyn during concrete slab installation (facing north)





Photo 2: Kingdom placing concrete for the first-floor slab in the northeastern part of Society Brooklyn (facing northeast)

Cc:	J. Hayes, M. Burke, P. Farnham, E. Adkins, A. Nesci	By:	Lauren Roper Langan, D.P.C.
-----	---	-----	---------------------------------------

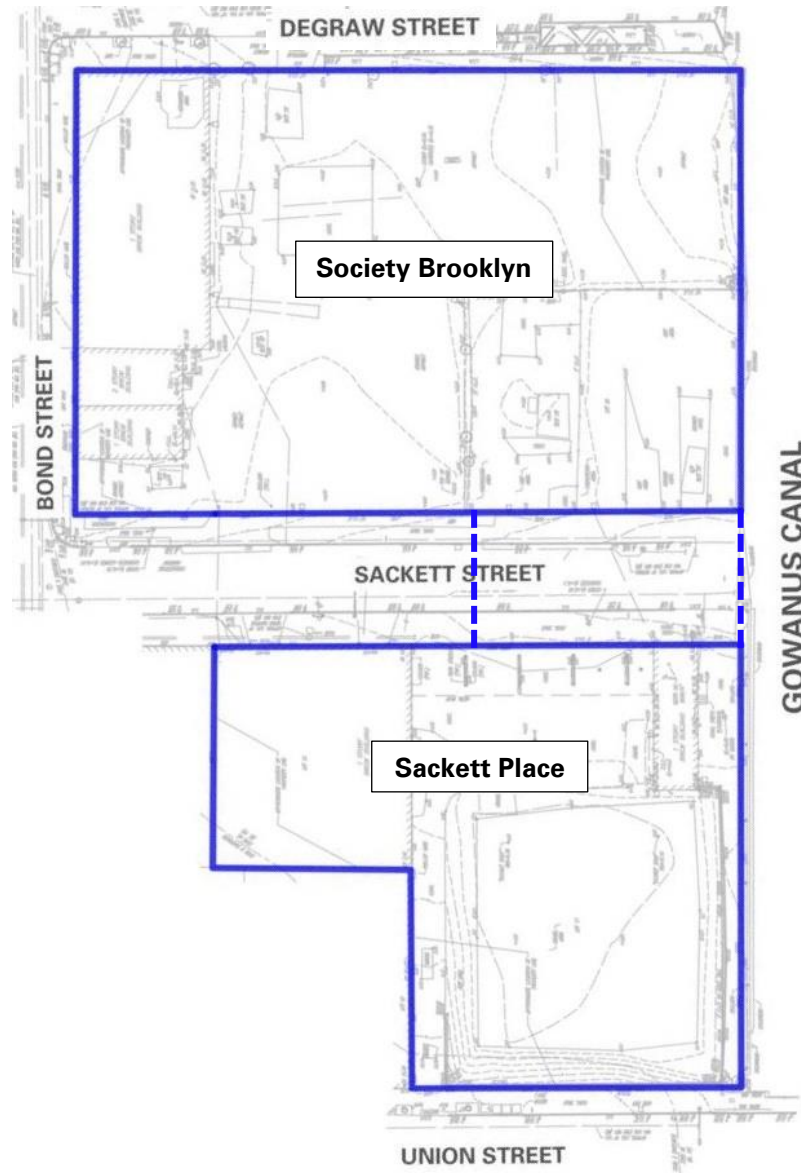
Site Map 1:



Legend

-  Approximate BCP site boundary
-  Approximate construction fence boundary

Notes

1. Base map adapted from 24 March 2022 RAWP, Figure 2 – Site Plan.
2. This Site Map is provided for context only; refer to the Northern (Society Brooklyn) and Southern (Sackett Place) Work Area Maps on the following pages for work and air monitoring location(s).

Cc:	J. Hayes, M. Burke, P. Farnham, E. Adkins, A. Nesci	By:	Lauren Roper Langan, D.P.C.
-----	---	-----	---------------------------------------

Site Map 2: Northern Work Area Map (Society Brooklyn)

Base map adapted from 1 April 2022 drawing FO-201.00, "Ground Floor Framing Plan" for Society Brooklyn, prepared by DeSimone Consulting Engineers.

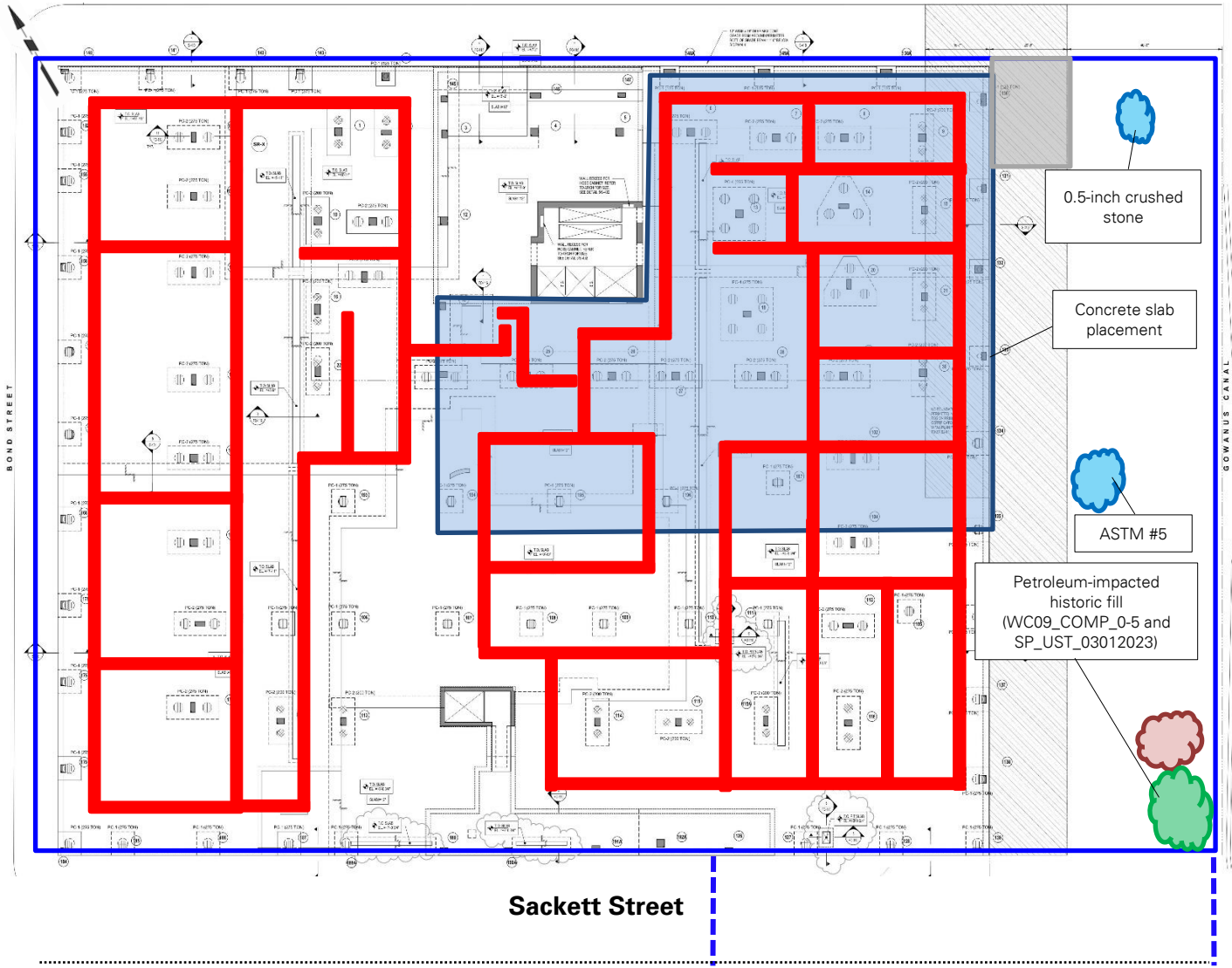

Legend:

- Approximate site boundary
- - - Approximate construction fence boundary
- ⊗ Upwind air monitoring station
- ⊗ Downwind air monitoring station
- Approximate work area
- Approximate stabilized construction entrance
- Approximate soil/fill stockpile location
- Approximate import stockpile location
- Approximate C&D debris stockpile location
- Approximate location of 20 cubic yard scrap metal container
- Approximate location of SMD piping installation

Cc: J. Hayes, M. Burke, P. Farnham, E. Adkins, A. Nesci

By: Lauren Roper
Langan, D.P.C.

Site Map 3: Southern Work Area Map (Sackett Place)

Base map adapted from 1 April 2022 drawing FO-201.00, "Ground Floor Framing Plan" for Sackett Place, prepared by DeSimone Consulting Engineers.



Legend:

-  Approximate site boundary
-  Approximate construction fence boundary
-  Upwind air monitoring station
-  Downwind air monitoring station
-  Approximate work area
-  Approximate stabilized construction entrance
-  Approximate soil/fill stockpile location
-  Approximate import stockpile location
-  Approximate C&D debris stockpile location
-  Approximate location of SMD piping installation

Cc:	J. Hayes, M. Burke, P. Farnham, E. Adkins, A. Nesci	By:	Lauren Roper Langan, D.P.C.
-----	---	-----	---------------------------------------