

**NYC DEPARTMENT OF FINANCE
OFFICE OF THE CITY REGISTER**

This page is part of the instrument. The City Register will rely on the information provided by you on this page for purposes of indexing this instrument. The information on this page will control for indexing purposes in the event of any conflict with the rest of the document.

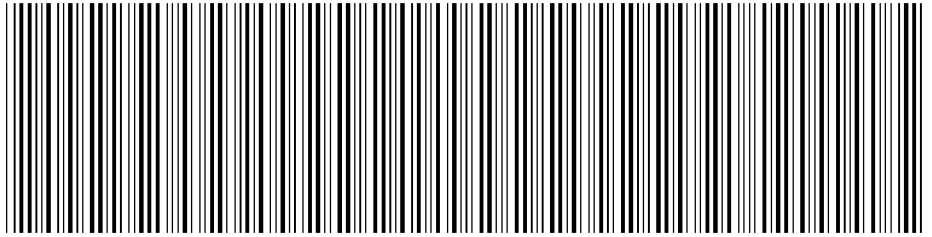

2013112700990001001E4555

RECORDING AND ENDORSEMENT COVER PAGE

PAGE 1 OF 15

Document ID: 2013112700990001

Document Date: 11-22-2013

Preparation Date: 11-27-2013

Document Type: EASEMENT

Document Page Count: 13

PRESENTER:

PRESTIGE RESEARCH (PICK UP RED VISION)
15 WEST 39TH STREET, 10TH FLOOR
NEW YORK, NY 10018
212-651-1200
SS13-265

RETURN TO:

PHILLIPS NIZER LLP (P/U RED VISION)
666 FIFTH AVENUE
NEW YORK, NY 10103

PROPERTY DATA

Borough	Block	Lot	Unit	Address
BROOKLYN	1886	10	Entire Lot	35 SKILLMAN STREET

Property Type: OTHER Easement

Borough	Block	Lot	Unit	Address
BROOKLYN	1886	11	Entire Lot	43 SKILLMAN STREET

Property Type: OTHER Easement

Additional Properties on Continuation Page

CROSS REFERENCE DATA

CRFN _____ or DocumentID _____ or _____ Year _____ Reel _____ Page _____ or File Number _____

PARTIES

GRANTOR/SELLER:

39 SKILLMAN STREET LLC
266 BROADWAY, SUITE 301
BROOKLYN, NY 11211

GRANTEE/BUYER:

NEW YORK STATE DEPARTMENT OF
ENVIRONMENTAL
CONSERVATION, 625 BROADWAY
ALBANY, NY 12233

FEES AND TAXES

Mortgage :

Mortgage Amount: \$ 0.00

Taxable Mortgage Amount: \$ 0.00

Exemption:

TAXES: County (Basic): \$ 0.00

City (Additional): \$ 0.00

Spec (Additional): \$ 0.00

TASF: \$ 0.00

MTA: \$ 0.00

NYCTA: \$ 0.00

Additional MRT: \$ 0.00

TOTAL: \$ 0.00

Recording Fee: \$ 108.00

Affidavit Fee: \$ 0.00

Filing Fee:

\$ 100.00

NYC Real Property Transfer Tax:

\$ 0.00

NYS Real Estate Transfer Tax:

\$ 0.00

RECORDED OR FILED IN THE OFFICE

OF THE CITY REGISTER OF THE

CITY OF NEW YORK

Recorded/Filed 12-06-2013 14:34

City Register File No.(CRFN):

2013000503181



Annette McMill

City Register Official Signature

NYC DEPARTMENT OF FINANCE
OFFICE OF THE CITY REGISTER

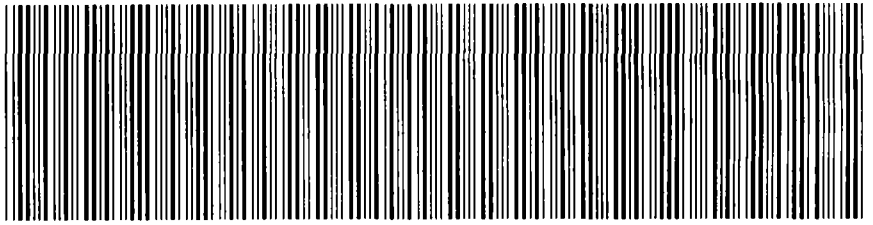

2013112700990001001C47D5

RECORDING AND ENDORSEMENT COVER PAGE (CONTINUATION)

PAGE 2 OF 15

Document ID: 2013112700990001

Document Date: 11-22-2013

Preparation Date: 11-27-2013

Document Type: EASEMENT

PROPERTY DATA

Borough	Block Lot	Unit	Address
BROOKLYN	1886 12 Entire Lot		49 SKILLMAN STREET

Property Type: OTHER Easement

**ENVIRONMENTAL EASEMENT GRANTED PURSUANT TO ARTICLE 71, TITLE 36
OF THE NEW YORK STATE ENVIRONMENTAL CONSERVATION LAW**

THIS INDENTURE made this 26th day of November, 2013 between Owner(s) 39 SKILLMAN STREET LLC, having an office at 266 Broadway, Suite 301, County of Kings, State of New York (the "Grantor"), and The People of the State of New York (the "Grantee."), acting through their Commissioner of the Department of Environmental Conservation (the "Commissioner", or "NYSDEC" or "Department" as the context requires) with its headquarters located at 625 Broadway, Albany, New York 12233.

WHEREAS, the Legislature of the State of New York has declared that it is in the public interest to encourage the remediation of abandoned and likely contaminated properties ("sites") that threaten the health and vitality of the communities they burden while at the same time ensuring the protection of public health and the environment; and

WHEREAS, the Legislature of the State of New York has declared that it is in the public interest to establish within the Department a statutory environmental remediation program that includes the use of Environmental Easements as an enforceable means of ensuring the performance of operation, maintenance, and/or monitoring requirements and the restriction of future uses of the land, when an environmental remediation project leaves residual contamination at levels that have been determined to be safe for a specific use, but not all uses, or which includes engineered structures that must be maintained or protected against damage to perform properly and be effective, or which requires groundwater use or soil management restrictions; and

WHEREAS, the Legislature of the State of New York has declared that Environmental Easement shall mean an interest in real property, created under and subject to the provisions of Article 71, Title 36 of the New York State Environmental Conservation Law ("ECL") which contains a use restriction and/or a prohibition on the use of land in a manner inconsistent with engineering controls which are intended to ensure the long term effectiveness of a site remedial program or eliminate potential exposure pathways to hazardous waste or petroleum; and

WHEREAS, Grantor, is the owner of real property located at the address of 39 Skillman Street (a/k/a 35, 43 and 49 Skillman Street in the City of Brooklyn, County of Kings and State of New York, known and designated on the tax map of the City Register of the City of New York as tax map parcel numbers: Section 7 Block 1886 Lot (s) 10,11 and 12, being the same as that property conveyed to Grantor by Bargain and Sale deed dated December 27, 2011 and Confirmatory Deeds dated October 11, 2013 and recorded in the City Register of the City of New York as CRFN No (s): 2012000061792, 2013000430464, 2013000430465 and 2013000430578. The property subject to this Environmental Easement (the "Controlled Property") comprises approximately 0.5739 +/- acres, and is hereinafter more fully described in the Land Title Survey dated February 20, 2013, recently updated on November 13, 2013 prepared by AAA Group Land Surveyor Services, which will be attached to the Site Management Plan. The Controlled Property description is set forth in and attached hereto as Schedule A; and

WHEREAS, the Department accepts this Environmental Easement in order to ensure the protection of public health and the environment and to achieve the requirements for remediation established for the Controlled Property until such time as this Environmental Easement is

[10/12]

extinguished pursuant to ECL Article 71, Title 36; and

NOW THEREFORE, in consideration of the mutual covenants contained herein and the terms and conditions of Brownfield Cleanup Agreement Index Number: C224156-03-12, Grantor conveys to Grantee a permanent Environmental Easement pursuant to ECL Article 71, Title 36 in, on, over, under, and upon the Controlled Property as more fully described herein ("Environmental Easement")

1. Purposes. Grantor and Grantee acknowledge that the Purposes of this Environmental Easement are: to convey to Grantee real property rights and interests that will run with the land in perpetuity in order to provide an effective and enforceable means of encouraging the reuse and redevelopment of this Controlled Property at a level that has been determined to be safe for a specific use while ensuring the performance of operation, maintenance, and/or monitoring requirements; and to ensure the restriction of future uses of the land that are inconsistent with the above-stated purpose.

2. Institutional and Engineering Controls. The controls and requirements listed in the Department approved Site Management Plan ("SMP") including any and all Department approved amendments to the SMP are incorporated into and made part of this Environmental Easement. These controls and requirements apply to the use of the Controlled Property, run with the land, are binding on the Grantor and the Grantor's successors and assigns, and are enforceable in law or equity against any owner of the Controlled Property, any lessees and any person using the Controlled Property.

A. (1) The Controlled Property may be used for:

**Restricted Residential as described in 6 NYCRR Part 375-1.8(g)(2)(ii),
Commercial as described in 6 NYCRR Part 375-1.8(g)(2)(iii) and Industrial
as described in 6 NYCRR Part 375-1.8(g)(2)(iv)**

(2) All Engineering Controls must be operated and maintained as specified in the Site Management Plan (SMP);

(3) All Engineering Controls must be inspected at a frequency and in a manner defined in the SMP;

(4) The use of groundwater underlying the property is prohibited without necessary water quality treatment as determined by the NYSDOH or the Kings County Department of Health to render it safe for use as drinking water or for industrial purposes, and the user must first notify and obtain written approval to do so from the Department;

(5) Groundwater and other environmental or public health monitoring must be performed as defined in the SMP;

(6) Data and information pertinent to Site Management of the Controlled Property must be reported at the frequency and in a manner defined in the SMP;

(7) All future activities on the property that will disturb remaining

contaminated material must be conducted in accordance with the SMP;

(8) Monitoring to assess the performance and effectiveness of the remedy must be performed as defined in the SMP;

(9) Operation, maintenance, monitoring, inspection, and reporting of any mechanical or physical components of the remedy shall be performed as defined in the SMP;

(10) Access to the site must be provided to agents, employees or other representatives of the State of New York with reasonable prior notice to the property owner to assure compliance with the restrictions identified by this Environmental Easement.

B. The Controlled Property shall not be used for Residential purposes as defined in 6NYCRR 375-1.8(g)(2)(i), and the above-stated engineering controls may not be discontinued without an amendment or extinguishment of this Environmental Easement.

C. The SMP describes obligations that the Grantor assumes on behalf of Grantor, its successors and assigns. The Grantor's assumption of the obligations contained in the SMP which may include sampling, monitoring, and/or operating a treatment system, and providing certified reports to the NYSDEC, is and remains a fundamental element of the Department's determination that the Controlled Property is safe for a specific use, but not all uses. The SMP may be modified in accordance with the Department's statutory and regulatory authority. The Grantor and all successors and assigns, assume the burden of complying with the SMP and obtaining an up-to-date version of the SMP from:

Site Control Section
Division of Environmental Remediation
NYSDEC
625 Broadway
Albany, New York 12233
Phone: (518) 402-9553

D. Grantor must provide all persons who acquire any interest in the Controlled Property a true and complete copy of the SMP that the Department approves for the Controlled Property and all Department-approved amendments to that SMP.

E. Grantor covenants and agrees that until such time as the Environmental Easement is extinguished in accordance with the requirements of ECL Article 71, Title 36 of the ECL, the property deed and all subsequent instruments of conveyance relating to the Controlled Property shall state in at least fifteen-point bold-faced type:

This property is subject to an Environmental Easement held by the New York State Department of Environmental Conservation pursuant to Title 36 of Article 71 of the Environmental Conservation Law.

F. Grantor covenants and agrees that this Environmental Easement shall be [10/12]

incorporated in full or by reference in any leases, licenses, or other instruments granting a right to use the Controlled Property.

G. Grantor covenants and agrees that it shall, at such time as NYSDEC may require, submit to NYSDEC a written statement by an expert the NYSDEC may find acceptable certifying under penalty of perjury, in such form and manner as the Department may require, that:

(1) the inspection of the site to confirm the effectiveness of the institutional and engineering controls required by the remedial program was performed under the direction of the individual set forth at 6 NYCRR Part 375-1.8(h)(3).

(2) the institutional controls and/or engineering controls employed at such site:
(i) are in-place;
(ii) are unchanged from the previous certification, or that any identified changes to the controls employed were approved by the NYSDEC and that all controls are in the Department-approved format; and

(iii) that nothing has occurred that would impair the ability of such control to protect the public health and environment;

(3) the owner will continue to allow access to such real property to evaluate the continued maintenance of such controls;

(4) nothing has occurred that would constitute a violation or failure to comply with any site management plan for such controls;

(5) the report and all attachments were prepared under the direction of, and reviewed by, the party making the certification;

(6) to the best of his/her knowledge and belief, the work and conclusions described in this certification are in accordance with the requirements of the site remedial program, and generally accepted engineering practices; and

(7) the information presented is accurate and complete.

3. Right to Enter and Inspect. Grantee, its agents, employees, or other representatives of the State may enter and inspect the Controlled Property in a reasonable manner and at reasonable times to assure compliance with the above-stated restrictions.

4. Reserved Grantor's Rights. Grantor reserves for itself, its assigns, representatives, and successors in interest with respect to the Property, all rights as fee owner of the Property, including:

A. Use of the Controlled Property for all purposes not inconsistent with, or limited by the terms of this Environmental Easement;

B. The right to give, sell, assign, or otherwise transfer part or all of the underlying fee interest to the Controlled Property, subject and subordinate to this Environmental Easement;

5. Enforcement

A. This Environmental Easement is enforceable in law or equity in perpetuity by Grantor, Grantee, or any affected local government, as defined in ECL Section 71-3603, against the owner of the Property, any lessees, and any person using the land. Enforcement shall not be defeated because of any subsequent adverse possession, laches, estoppel, or waiver. It is not a defense in any action to enforce this Environmental Easement that: it is not appurtenant to an interest in real property; it is not of a character that has been recognized traditionally at common
[10/12]

law; it imposes a negative burden; it imposes affirmative obligations upon the owner of any interest in the burdened property; the benefit does not touch or concern real property; there is no privity of estate or of contract; or it imposes an unreasonable restraint on alienation.

B. If any person violates this Environmental Easement, the Grantee may revoke the Certificate of Completion with respect to the Controlled Property.

C. Grantee shall notify Grantor of a breach or suspected breach of any of the terms of this Environmental Easement. Such notice shall set forth how Grantor can cure such breach or suspected breach and give Grantor a reasonable amount of time from the date of receipt of notice in which to cure. At the expiration of such period of time to cure, or any extensions granted by Grantee, the Grantee shall notify Grantor of any failure to adequately cure the breach or suspected breach, and Grantee may take any other appropriate action reasonably necessary to remedy any breach of this Environmental Easement, including the commencement of any proceedings in accordance with applicable law.

D. The failure of Grantee to enforce any of the terms contained herein shall not be deemed a waiver of any such term nor bar any enforcement rights.

6. Notice. Whenever notice to the Grantee (other than the annual certification) or approval from the Grantee is required, the Party providing such notice or seeking such approval shall identify the Controlled Property by referencing the following information:

County, NYSDEC Site Number, NYSDEC Brownfield Cleanup Agreement, State Assistance Contract or Order Number, and the County tax map number or the Liber and Page or computerized system identification number.

Parties shall address correspondence to: Site Number: C224156
Office of General Counsel
NYSDEC
625 Broadway
Albany New York 12233-5500

With a copy to: Site Control Section
Division of Environmental Remediation
NYSDEC
625 Broadway
Albany, NY 12233

All notices and correspondence shall be delivered by hand, by registered mail or by Certified mail and return receipt requested. The Parties may provide for other means of receiving and communicating notices and responses to requests for approval.

7. Recordation. Grantor shall record this instrument, within thirty (30) days of execution of this instrument by the Commissioner or her/his authorized representative in the office of the recording officer for the county or counties where the Property is situated in the manner prescribed by Article 9 of the Real Property Law.

8. Amendment. Any amendment to this Environmental Easement may only be executed by the Commissioner of the New York State Department of Environmental Conservation or the Commissioner's Designee, and filed with the office of the recording officer for the county or counties where the Property is situated in the manner prescribed by Article 9 of the Real Property Law.

9. Extinguishment. This Environmental Easement may be extinguished only by a release by the Commissioner of the New York State Department of Environmental Conservation, or the Commissioner's Designee, and filed with the office of the recording officer for the county or counties where the Property is situated in the manner prescribed by Article 9 of the Real Property Law.

10. Joint Obligation. If there are two or more parties identified as Grantor herein, the obligations imposed by this instrument upon them shall be joint and several.

IN WITNESS WHEREOF, Grantor has caused this instrument to be signed in its name.

Grantor: 39 SKILLMAN STREET LLC

By: [Signature]

Print Name: ZELIG WEISS

Title: MEMBER Date: 11/21/13

Grantor's Acknowledgment

STATE OF NEW YORK)
) ss:
COUNTY OF Kings)

On the 21 day of November, in the year 20 13, before me, the undersigned, personally appeared Zelig Weiss, personally known to me or proved to me on the basis of satisfactory evidence to be the individual(s) whose name is (are) subscribed to the within instrument and acknowledged to me that he/she/they executed the same in his/her/their capacity(ies), and that by his/her/their signature(s) on the instrument, the individual(s), or the person upon behalf of which the individual(s) acted, executed the instrument.

[Signature]
SHIA W. GREENFELD
NOTARY PUBLIC, State of New York
No. 01-GR8273116
Qualified in Kings County
Commission Expires 12/03/2018
Notary Public - State of New York

SEAL

THIS ENVIRONMENTAL EASEMENT IS HEREBY ACCEPTED BY THE PEOPLE OF THE STATE OF NEW YORK, Acting By and Through the Department of Environmental Conservation as Designee of the Commissioner,

By: 
Robert W. Schick, Director
Division of Environmental Remediation

Grantee's Acknowledgment

STATE OF NEW YORK)
) ss:
COUNTY OF ALBANY)

On the 26th day of November, in the year 2013, before me, the undersigned, personally appeared Robert W. Schick, personally known to me or proved to me on the basis of satisfactory evidence to be the individual(s) whose name is (are) subscribed to the within instrument and acknowledged to me that he/she/ executed the same in his/her/ capacity as Designee of the Commissioner of the State of New York Department of Environmental Conservation, and that by his/her/ signature on the instrument, the individual, or the person upon behalf of which the individual acted, executed the instrument.

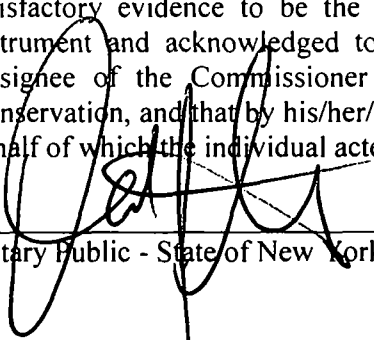
Notary Public - State of New York

David J. Chiusano
Notary Public, State of New York
No. 01CH5032146
Qualified in Schenectady County,
Commission Expires August 22, 2014

SEAL

SCHEDULE "A"
ENVIRONMENTAL EASEMENT
PROPERTY DESCRIPTION

AAA GROUP

100-A Broadway

Brooklyn NY 11249

Tel: (718) 387-9800 Fax: (718) 384-5050

E-mail= Info@aaagrouponline.com

SCHEDULE 'A'

DESCRIPTION OF ENVIRONMENTAL EASEMENT AREA

BLOCK 1886 LOT 10

35 SKILLMAN STREET

ALL that certain plot, piece or parcel of land, with the buildings and improvements thereon erected, situate, lying and being in the borough of Brooklyn, County of Kings, City and State of New York, bounded and described as follows:

BEGINNING at a point which is distant 240.00 feet northerly formed the corner formed by the intersection of the northerly side of Park Avenue with the easterly side of Skillman Street;

THENCE easterly parallel with Park Avenue 63.83 feet;

THENCE northwesterly 38.09 feet;

THENCE northerly parallel with Skillman Street 73.54 feet;

THENCE westerly parallel with Park Avenue, 100 feet;

THENCE southerly along the easterly side of Skillman Street, 85.5 feet, to the point or place of BEGINNING.

"Being the same piece and parcel of land as described in confirmation deed dated December 27, 2011 recorded February 15, 2012 as CRFN : 2012000061792 in the office of the City Register of the City of New York"

AAA GROUP

100-A Broadway

Brooklyn NY 11249

Tel: (718) 387-9800 Fax: (718) 384-5050

E-mail= Info@aaagrouponline.com

SCHEDULE 'A'

DESCRIPTION OF ENVIRONMENTAL EASEMENT AREA

BLOCK 1886 LOT 11

43 SKILLMAN STREET

ALL that certain plot, piece or parcel of land, with the buildings and improvements thereon erected, situate, lying and being in the borough of Brooklyn, County of Kings, City and State of New York, bounded and described as follows:

BEGINNING at a point which is distant 163.33 feet northerly formed the corner formed by the intersection of the northerly side of Park Avenue with the easterly side of Skillman Street;

THENCE easterly parallel with Park Avenue 63.83 feet;

THENCE southeasterly 43.89 feet;

THENCE northerly parallel with Skillman Street 113.5 feet;

THENCE southwesterly 38.09 feet;

THENCE westerly parallel with Park Avenue, 63.83 feet;

THENCE southerly along the easterly side of Skillman Street, 76.67 feet, to the point or place of BEGINNING.

"Being the same piece and parcel of land as described in confirmation deed dated December 27, 2011 recorded February 15, 2012 as CRFN : 2012000061792 in the office of the City Register of the City of New York

AAA GROUP

100-A Broadway

Brooklyn NY 11249

Tel: (718) 387-9800 Fax: (718) 384-5050

E-mail= Info@aaagrouponline.com

SCHEDULE 'A'

DESCRIPTION OF ENVIRONMENTAL EASEMENT AREA

BLOCK 1886 LOT 12

49 SKILLMAN STREET

ALL that certain plot, piece or parcel of land, with the buildings and improvements thereon erected, situate, lying and being in the borough of Brooklyn, County of Kings, City and State of New York, bounded and described as follows:

BEGINNING at a point which is distant 75.50 feet northerly formed the corner formed by the intersection of the northerly side of Park Avenue with the easterly side of Skillman Street;

THENCE easterly parallel with Park Avenue 100 feet;

THENCE northerly parallel with Skillman Street 62.96 feet;

THENCE northwesterly 43.89 feet;

THENCE westerly parallel with Park Avenue, 63.83 feet;

THENCE southerly along the easterly side of Skillman Street, 87.83 feet, to the point or place of BEGINNING.

"Being the same piece and parcel of land as described in confirmation deed dated December 27, 2011 recorded February 15, 2012 as CRFN : 2012000061792 in the office of the City Register of the City of New York"

AAA GROUP

100-A Broadway

Brooklyn NY 11249

Tel: (718) 387-9800 Fax: (718) 384-5050

E-mail= Info@aaagrouponline.com

SCHEDULE 'A'

DESCRIPTION OF ENVIRONMENTAL EASEMENT AREA

BLOCK 1886 LOT 10, 11, 12

OVERALL DESCRIPTION

ALL that certain plot, piece or parcel of land, with the buildings and improvements thereon erected, situate, lying and being in the borough of Brooklyn, County of Kings, City and State of New York, bounded and described as follows:

BEGINNING at a point which is distant 75.50 feet northerly formed the corner formed by the intersection of the northerly side of Park Avenue with the easterly side of Skillman Street;

THENCE easterly parallel with Park Avenue 100 feet;

THENCE northerly parallel with Skillman Street 250 feet;

THENCE westerly parallel with Park Avenue 100 feet;

THENCE southerly along the easterly side of Skillman Street, 250 feet, to the point or place of BEGINNING.

"Being the same piece and parcel of land as described in confirmation deed dated December 27, 2011 recorded February 15, 2012 as CRFN : 2012000061792 in the office of the City Register of the City of New York"

SURVEY

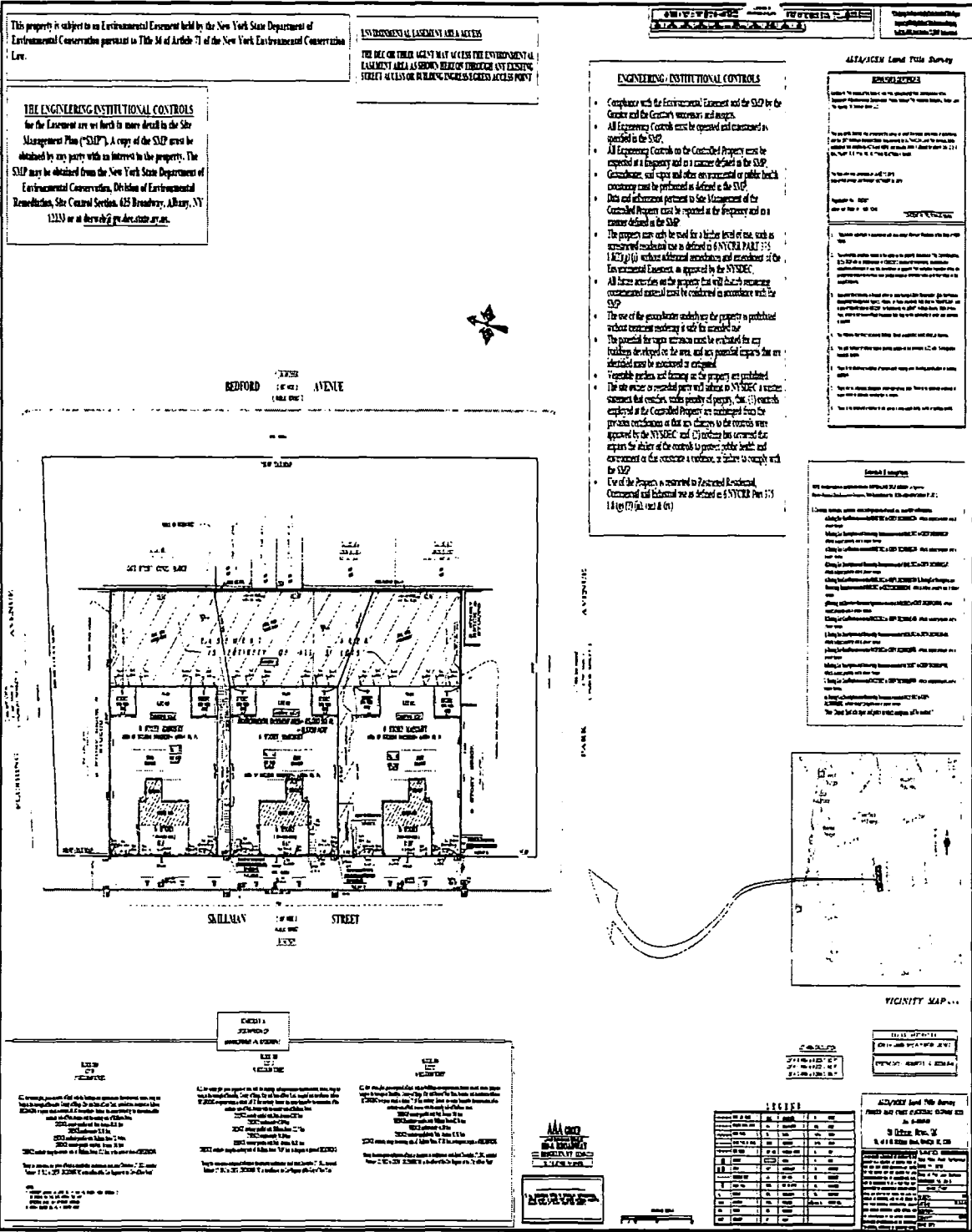

This property is subject to an Environmental Easement held by the New York State Department of Environmental Conservation pursuant to Title 24 of Article 77 of the New York Environmental Conservation Law.

THE DEED OR OTHER LEGAL INSTRUMENT MAY AT TIMES STATE THE ENVIRONMENTAL EASEMENT AREA AS BEING A RECORD OF RECORDS ON THE RECORDS OF THE STATE OF NEW YORK. THIS SURVEY DOES NOT CONSTITUTE A RECORD OF RECORDS ON THE RECORDS OF THE STATE OF NEW YORK.

THE ENGINEERING/ INSTITUTIONAL CONTROLS
for the Easement are set forth in more detail in the Site Management Plan ("SMP"). A copy of the SMP must be obtained by any party with an interest in the property. The SMP may be obtained from the New York State Department of Environmental Conservation, Division of Environmental Remediation, Site Control Section, 625 Broadway, Albany, NY 12242 or at derweb@pa.dce.state.ny.us.

ENGINEERING/ INSTITUTIONAL CONTROLS

- Compliance with the Environmental Easement and the SMP by the Owner and the Owner's successors and assigns.
- All Emergency Controls must be operated and maintained as specified in the SMP.
- All Emergency Controls on the Controlled Property must be inspected at a frequency and on a manner defined in the SMP.
- Groundwater, soil vapor and other environmental or public health concerns must be performed as defined in the SMP.
- Data and information pertinent to Site Management of the Controlled Property must be reported at the frequency and on a manner defined in the SMP.
- The property may only be used for a higher level of use, such as unrestricted residential use as defined in 6 NYCRR PART 247.1 (b)(3) (i) without additional restrictions and amendments of the Environmental Easement, as approved by the NYSDCE.
- All future activities on the property that will directly or indirectly affect the environment must be restricted in accordance with the SMP.
- The use of the groundwater underlying the property is prohibited and cannot be used for any purpose.
- The potential for vapor intrusion must be evaluated for any buildings developed on the area, and any potential impacts that are identified must be corrected or mitigated.
- Vegetative practices and landscaping on the property are prohibited.
- The site owner or potential party will adhere to NYSDCE's written statement that restricts certain types of property, use (3) controls employed at the Controlled Property as set forth in the specific restrictions of that any changes to the controls were approved by the NYSDCE, and (3) written has occurred that requires for the ability of the controls to protect public health and environment of the resource a restriction, a failure to comply with the SMP.
- Use of the Property is restricted to Restricted Residential, Commercial and Industrial use as defined in 6 NYCRR Part 247.1 (a) (i) (3) (b) (i) and (iv).

434/436E Land Title Survey

GENERAL NOTES

1. This survey was prepared for the purpose of recording the Environmental Easement.
2. The Environmental Easement is a restriction on the use of the property and is not a lien in favor of the State of New York.
3. The Environmental Easement is subject to the terms and conditions of the Environmental Easement as set forth in the SMP.
4. The Environmental Easement is subject to the terms and conditions of the Environmental Easement as set forth in the SMP.
5. The Environmental Easement is subject to the terms and conditions of the Environmental Easement as set forth in the SMP.
6. The Environmental Easement is subject to the terms and conditions of the Environmental Easement as set forth in the SMP.
7. The Environmental Easement is subject to the terms and conditions of the Environmental Easement as set forth in the SMP.
8. The Environmental Easement is subject to the terms and conditions of the Environmental Easement as set forth in the SMP.
9. The Environmental Easement is subject to the terms and conditions of the Environmental Easement as set forth in the SMP.
10. The Environmental Easement is subject to the terms and conditions of the Environmental Easement as set forth in the SMP.

Summary of Easement

The Environmental Easement is a restriction on the use of the property and is not a lien in favor of the State of New York.

The Environmental Easement is subject to the terms and conditions of the Environmental Easement as set forth in the SMP.

The Environmental Easement is subject to the terms and conditions of the Environmental Easement as set forth in the SMP.

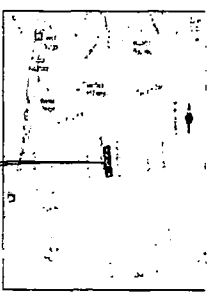

TABLE 1: AREA OF ENVIRONMENTAL EASEMENT

Lot No.	Area (sq. ft.)	Area (sq. m.)
1	1,234	113.7
2	5,678	523.4
3	9,012	834.5
4	3,456	319.2
5	7,890	730.1
6	2,345	217.9
7	6,789	629.0
8	4,567	422.3
9	8,901	825.6
10	1,234	113.7

TABLE 2: AREA OF EASEMENT

Lot No.	Area (sq. ft.)	Area (sq. m.)
1	1,234	113.7
2	5,678	523.4
3	9,012	834.5
4	3,456	319.2
5	7,890	730.1
6	2,345	217.9
7	6,789	629.0
8	4,567	422.3
9	8,901	825.6
10	1,234	113.7

AAA
REGISTERED
SURVEYOR
STATE OF NEW YORK

434/436E Land Title Survey

FILED FOR RECORD IN THE OFFICE OF THE CLERK OF THE COUNTY OF KINGS, NEW YORK, ON [DATE] AT [TIME].