



# Daily Activity Report

Seton Brilla Charter School  
 1956 Jerome Avenue, Bronx, NY  
 BCP No. C203152

## General Site Information

Date:	Thursday, August 10, 2023
Weather:	Cloudy, Rain 70-81°F
Wind Direction/Speed:	SW @ 3 mph
AKRF Personnel on Site:	Michael Valenzi
AKRF Equipment on Site:	Mini RAE 3000 Photoionization Detector [(PID) x1], Roving SidePak Particulate Monitor (1), 2 Fixed Air Monitoring Stations [DustTrak Aerosol Monitors (x2) & MiniRAE 3000 PIDs (x2)].
Visitors:	None

## Contractor Information

Contracting Company	Main Personnel	Equipment
Casino Construction	Carlos	Mini-excavator

## Description and Location of Work Activities Performed

- Casino poured the remaining sections of concrete slab in grids WC-01 and WC-02. The composite cover system is now complete at the Site.
- There were no soil disturbance activities at the Site.

Destination Facility	Daily Trucks	Total Trucks	Daily Approx. Cubic Yds	Total Approx. Cubic Yds	Total Site Loads	Total Approximate Cubic Yards
Clean Earth Carteret	0	112	0	2,240	210	4,200
Clean Earth Southeastern Pennsylvania	0	67	0	1,340		
Clean Earth Bethlehem	0	31	0	620		
Concrete Disposal	0	27	0	540		
N/A	0	0	0	0		

## CAMP Air Monitoring Results

CAMP Station	UPWIND			DOWNWIND		
Odors:	None	Number of Exceedances	Time of Exceedance(s)	None	Number of Exceedances	Time of Exceedance(s)
VOC Action Level Exceedance(s):	None			None		
Particulate Action Level Exceedance(s):	None			None		
Maximum VOC Level (15 min ppm):	0.4613			0.0000		
Maximum Particulate Level (15 min mg/m <sup>3</sup> ):	0.0609			0.0675		

Notes: CAMP air monitoring occurred between approximately 07:12 until 13:04.

## Additional Information

Planned Work Activity for Following Day/Week:	1) Steel beams put into place. 2) Installing monitoring point MP-1.
Comments:	

Site Map

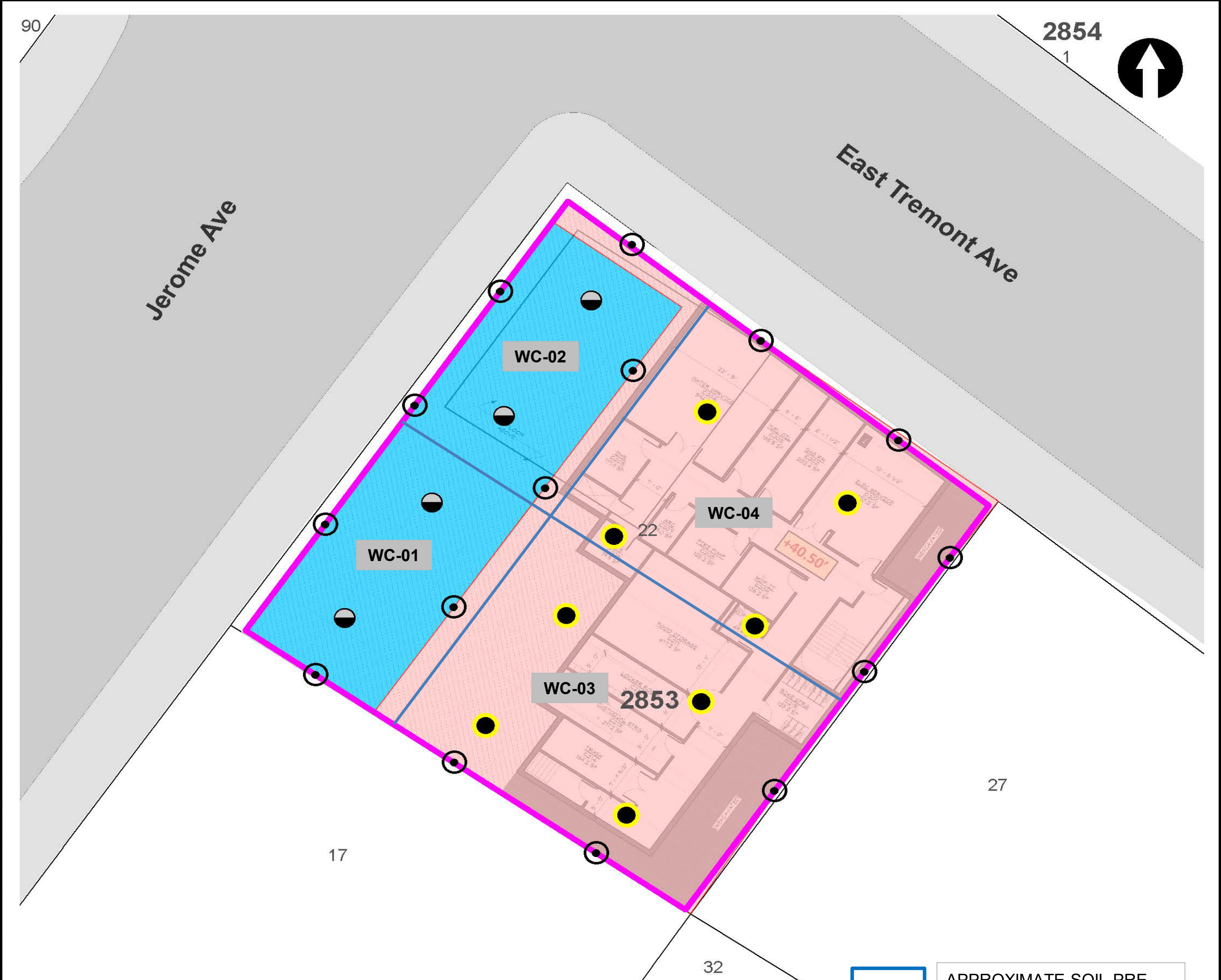

**LEGEND**

- PROJECT SITE BOUNDARY
- LOT BOUNDARY AND TAX LOT NUMBER
- 2853** BLOCK NUMBER
- REMEDIAL EXCAVATION TO APPROXIMATELY TWO FEET BELOW EXISTING GRADE
- REMEDIAL EXCAVATION TO GROUNDWATER (SOURCE AREA)

- CONFIRMATION DOCUMENTATION BOTTOM SAMPLE
- SOURCE AREA DOCUMENTATION BOTTOM SAMPLE
- DOCUMENTATION SIDEWALL SAMPLE

**NOTE**  
 REMEDIAL EXCAVATION WILL INCLUDE REMOVAL OF APPROXIMATELY 1,280 TONS (850 CUBIC YARDS) OF SOURCE MATERIAL ASSOCIATED WITH NYSDEC SPILL NO. 2103719 AND APPROXIMATELY 860 TONS (570 CUBIC YARDS) OF SOIL/FILL FROM THE UPPER 2 FEET SITE-WIDE.



Map Source:  
 NYCDOP (NYC Dept. of City Planning) GIS database

© 2021 AKRF. W:\Projects\210024 - 1956 JEROME AVENUE\Technical\GIS and Graphics\AR\RAW\210024 Figure 9 Proposed Remedial Excavation and Documentation Sample Location Plan.mxd 10/25/2021 2:03:38 PM iszalus



440 Park Avenue South, New York, NY 10016

**1956 Jerome Avenue**  
 Bronx, New York

**TRACK 4 CLEANUP AND DOCUMENTATION  
 SAMPLE LOCATION PLAN**

DATE  
**04/29/2022**

PROJECT NO.  
**210024**

FIGURE  
**11**

Site Photographs

Photograph 1 - The crew pouring a concrete wall. View facing south.



Photograph 2 - The crew pouring the concrete slab in WC-01. View facing southwest.



Photograph 3 - A view of the Site with a completed concrete slab. View facing southwest.



Upwind Station						
Time	Instaneous VOC (ppm)	Instaneous Mass Conc. Total (mg/m <sup>3</sup> )	Mass Conc. Total mg/m <sup>3</sup> AVG 15m (mg/m <sup>3</sup> )	Dust Exceedance	VOC ppm AVG 15m (ppm)	VOC Exceedance
8/10/2023 7:12	0	0.036	0.036	No	0	No
8/10/2023 7:13	0	0.037	0.0365	No	0	No
8/10/2023 7:14	0	0.04	0.0377	No	0	No
8/10/2023 7:15	0	0.042	0.0388	No	0	No
8/10/2023 7:16	0	0.04	0.039	No	0	No
8/10/2023 7:17	0	0.047	0.0403	No	0	No
8/10/2023 7:18	0	0.039	0.0401	No	0	No
8/10/2023 7:19	0	0.037	0.0397	No	0	No
8/10/2023 7:20	0	0.036	0.0393	No	0	No
8/10/2023 7:21	0	0.034	0.0388	No	0	No
8/10/2023 7:22	0	0.049	0.0397	No	0	No
8/10/2023 7:23	0	0.042	0.0399	No	0	No
8/10/2023 7:24	0	0.037	0.0397	No	0	No
8/10/2023 7:25	0	0.034	0.0393	No	0	No
8/10/2023 7:26	0	0.034	0.0389	No	0	No
8/10/2023 7:27	0	0.037	0.039	No	0	No
8/10/2023 7:28	0	0.037	0.039	No	0	No
8/10/2023 7:29	0	0.035	0.0387	No	0	No
8/10/2023 7:30	0	0.035	0.0382	No	0	No
8/10/2023 7:31	0	0.036	0.0379	No	0	No
8/10/2023 7:32	0	0.034	0.0371	No	0	No
8/10/2023 7:33	0	0.034	0.0367	No	0	No
8/10/2023 7:34	0	0.035	0.0366	No	0	No
8/10/2023 7:35	0	0.037	0.0367	No	0	No
8/10/2023 7:36	0	0.036	0.0368	No	0	No
8/10/2023 7:37	0	0.035	0.0359	No	0	No
8/10/2023 7:38	0	0.037	0.0355	No	0	No
8/10/2023 7:39	0	0.059	0.037	No	0	No
8/10/2023 7:40	0	0.07	0.0394	No	0	No
8/10/2023 7:41	0	0.037	0.0396	No	0	No
8/10/2023 7:42	0	0.038	0.0397	No	0	No
8/10/2023 7:43	0	0.038	0.0397	No	0	No
8/10/2023 7:44	0	0.035	0.0397	No	0	No
8/10/2023 7:45	0	0.039	0.04	No	0	No
8/10/2023 7:46	0.024	0.037	0.0401	No	0.0016	No
8/10/2023 7:47	0.583	0.038	0.0403	No	0.0405	No
8/10/2023 7:48	1.041	0.084	0.0437	No	0.1099	No
8/10/2023 7:49	1.605	0.04	0.044	No	0.2169	No
8/10/2023 7:50	1.463	0.043	0.0444	No	0.3144	No
8/10/2023 7:51	0.508	0.044	0.0449	No	0.3483	No
8/10/2023 7:52	0.431	0.038	0.0451	No	0.377	No
8/10/2023 7:53	0.232	0.042	0.0455	No	0.3925	No
8/10/2023 7:54	0.184	0.044	0.0445	No	0.4047	No
8/10/2023 7:55	0.198	0.05	0.0431	No	0.4179	No
8/10/2023 7:56	0.14	0.042	0.0435	No	0.4273	No
8/10/2023 7:57	0.117	0.069	0.0455	No	0.4351	No
8/10/2023 7:58	0.102	0.078	0.0482	No	0.4419	No
8/10/2023 7:59	0.131	0.05	0.0492	No	0.4506	No
8/10/2023 8:00	0.112	0.052	0.0501	No	0.4581	No
8/10/2023 8:01	0.073	0.05	0.0509	No	0.4613	No
8/10/2023 8:02	0.035	0.041	0.0511	No	0.4248	No
8/10/2023 8:03	0.026	0.036	0.0479	No	0.3571	No

Upwind Station						
Time	Instaneous VOC (ppm)	Instaneous Mass Conc. Total (mg/m <sup>3</sup> )	Mass Conc. Total mg/m <sup>3</sup> AVG 15m (mg/m <sup>3</sup> )	Dust Exceedance	VOC ppm AVG 15m (ppm)	VOC Exceedance
8/10/2023 8:04	0.025	0.039	0.0479	No	0.2518	No
8/10/2023 8:05	0.089	0.051	0.0484	No	0.1602	No
8/10/2023 8:06	0.036	0.049	0.0487	No	0.1287	No
8/10/2023 8:07	0	0.041	0.0489	No	0.1	No
8/10/2023 8:08	0	0.039	0.0487	No	0.0845	No
8/10/2023 8:09	0	0.043	0.0487	No	0.0723	No
8/10/2023 8:10	0	0.041	0.0481	No	0.0591	No
8/10/2023 8:11	0.079	0.065	0.0496	No	0.055	No
8/10/2023 8:12	0.045	0.181	0.0571	No	0.0502	No
8/10/2023 8:13	0	0.058	0.0557	No	0.0434	No
8/10/2023 8:14	0	0.04	0.0551	No	0.0347	No
8/10/2023 8:15	0	0.04	0.0543	No	0.0272	No
8/10/2023 8:16	0	0.04	0.0536	No	0.0223	No
8/10/2023 8:17	0	0.039	0.0535	No	0.02	No
8/10/2023 8:18	0	0.04	0.0537	No	0.0183	No
8/10/2023 8:19	0	0.044	0.0541	No	0.0166	No
8/10/2023 8:20	0	0.04	0.0533	No	0.0107	No
8/10/2023 8:21	0	0.046	0.0531	No	0.0083	No
8/10/2023 8:22	0	0.052	0.0539	No	0.0083	No
8/10/2023 8:23	0	0.041	0.054	No	0.0083	No
8/10/2023 8:24	0	0.041	0.0539	No	0.0083	No
8/10/2023 8:25	0	0.048	0.0543	No	0.0083	No
8/10/2023 8:26	0	0.046	0.0531	No	0.003	No
8/10/2023 8:27	0	0.042	0.0438	No	0	No
8/10/2023 8:28	0	0.046	0.043	No	0	No
8/10/2023 8:29	0	0.048	0.0435	No	0	No
8/10/2023 8:30	0	0.041	0.0436	No	0	No
8/10/2023 8:31	0	0.041	0.0437	No	0	No
8/10/2023 8:32	0	0.04	0.0437	No	0	No
8/10/2023 8:33	0	0.04	0.0437	No	0	No
8/10/2023 8:34	0	0.04	0.0435	No	0	No
8/10/2023 8:35	0	0.044	0.0437	No	0	No
8/10/2023 8:36	0	0.047	0.0438	No	0	No
8/10/2023 8:37	0	0.052	0.0438	No	0	No
8/10/2023 8:38	0	0.048	0.0443	No	0	No
8/10/2023 8:39	0	0.046	0.0446	No	0	No
8/10/2023 8:40	0	0.044	0.0443	No	0	No
8/10/2023 8:41	0	0.044	0.0442	No	0	No
8/10/2023 8:42	0	0.046	0.0445	No	0	No
8/10/2023 8:43	0	0.05	0.0447	No	0	No
8/10/2023 8:44	0	0.049	0.0448	No	0	No
8/10/2023 8:45	0	0.06	0.0461	No	0	No
8/10/2023 8:46	0	0.069	0.0479	No	0	No
8/10/2023 8:47	0	0.058	0.0491	No	0	No
8/10/2023 8:48	0	0.05	0.0498	No	0	No
8/10/2023 8:49	0	0.043	0.05	No	0	No
8/10/2023 8:50	0	0.051	0.0505	No	0	No
8/10/2023 8:51	0	0.058	0.0512	No	0	No
8/10/2023 8:52	0	0.05	0.0511	No	0	No
8/10/2023 8:53	0	0.043	0.0507	No	0	No
8/10/2023 8:54	0	0.047	0.0508	No	0	No
8/10/2023 8:55	0	0.047	0.051	No	0	No

**Upwind Station**

Time	Instantaneous VOC (ppm)	Instantaneous Mass Conc. Total (mg/m <sup>3</sup> )	Mass Conc. Total mg/m <sup>3</sup> AVG 15m (mg/m <sup>3</sup> )	Dust Exceedance	VOC ppm AVG 15m (ppm)	VOC Exceedance
8/10/2023 8:56	0	0.055	0.0517	No	0	No
8/10/2023 8:57	0	0.043	0.0515	No	0	No
8/10/2023 8:58	0	0.045	0.0512	No	0	No
8/10/2023 8:59	0	0.044	0.0509	No	0	No
8/10/2023 9:00	0	0.045	0.0499	No	0	No
8/10/2023 9:01	0	0.045	0.0483	No	0	No
8/10/2023 9:02	0	0.05	0.0477	No	0	No
8/10/2023 9:03	0	0.05	0.0477	No	0	No
8/10/2023 9:04	0	0.049	0.0481	No	0	No
8/10/2023 9:05	0	0.053	0.0483	No	0	No
8/10/2023 9:06	0	0.051	0.0478	No	0	No
8/10/2023 9:07	0	0.049	0.0477	No	0	No
8/10/2023 9:08	0	0.046	0.0479	No	0	No
8/10/2023 9:09	0	0.046	0.0479	No	0	No
8/10/2023 9:10	0	0.045	0.0477	No	0	No
8/10/2023 9:11	0	0.044	0.047	No	0	No
8/10/2023 9:12	0	0.044	0.0471	No	0	No
8/10/2023 9:13	0	0.044	0.047	No	0	No
8/10/2023 9:14	0	0.045	0.0471	No	0	No
8/10/2023 9:15	0	0.046	0.0471	No	0	No
8/10/2023 9:16	0	0.046	0.0472	No	0	No
8/10/2023 9:17	0	0.045	0.0469	No	0	No
8/10/2023 9:18	0	0.045	0.0465	No	0	No
8/10/2023 9:19	0	0.047	0.0464	No	0	No
8/10/2023 9:20	0	0.048	0.0461	No	0	No
8/10/2023 9:21	0	0.047	0.0458	No	0	No
8/10/2023 9:22	0	0.048	0.0457	No	0	No
8/10/2023 9:23	0	0.049	0.0459	No	0	No
8/10/2023 9:24	0	0.049	0.0461	No	0	No
8/10/2023 9:25	0	0.047	0.0463	No	0	No
8/10/2023 9:26	0	0.046	0.0464	No	0	No
8/10/2023 9:27	0	0.047	0.0466	No	0	No
8/10/2023 9:28	0	0.047	0.0468	No	0	No
8/10/2023 9:29	0	0.074	0.0487	No	0	No
8/10/2023 9:30	0	0.05	0.049	No	0	No
8/10/2023 9:31	0	0.049	0.0492	No	0	No
8/10/2023 9:32	0	0.047	0.0493	No	0	No
8/10/2023 9:33	0	0.046	0.0494	No	0	No
8/10/2023 9:34	0	0.051	0.0497	No	0	No
8/10/2023 9:35	0	0.05	0.0498	No	0	No
8/10/2023 9:36	0	0.05	0.05	No	0	No
8/10/2023 9:37	0	0.05	0.0501	No	0	No
8/10/2023 9:38	0	0.048	0.0501	No	0	No
8/10/2023 9:39	0	0.045	0.0498	No	0	No
8/10/2023 9:40	0	0.049	0.0499	No	0	No
8/10/2023 9:41	0	0.049	0.0501	No	0	No
8/10/2023 9:42	0	0.046	0.0501	No	0	No
8/10/2023 9:43	0	0.046	0.05	No	0	No
8/10/2023 9:44	0	0.046	0.0481	No	0	No
8/10/2023 9:45	0	0.047	0.0479	No	0	No
8/10/2023 9:46	0	0.047	0.0478	No	0	No
8/10/2023 9:47	0	0.045	0.0477	No	0	No

**Upwind Station**

Time	Instaneous VOC (ppm)	Instaneous Mass Conc. Total (mg/m <sup>3</sup> )	Mass Conc. Total mg/m <sup>3</sup> AVG 15m (mg/m <sup>3</sup> )	Dust Exceedance	VOC ppm AVG 15m (ppm)	VOC Exceedance
8/10/2023 9:48	0	0.046	0.0477	No	0	No
8/10/2023 9:49	0	0.047	0.0474	No	0	No
8/10/2023 9:50	0	0.047	0.0472	No	0	No
8/10/2023 9:51	0	0.053	0.0474	No	0	No
8/10/2023 9:52	0	0.045	0.0471	No	0	No
8/10/2023 9:53	0	0.055	0.0475	No	0	No
8/10/2023 9:54	0	0.059	0.0485	No	0	No
8/10/2023 9:55	0	0.047	0.0483	No	0	No
8/10/2023 9:56	0	0.047	0.0482	No	0	No
8/10/2023 9:57	0	0.046	0.0482	No	0	No
8/10/2023 9:58	0	0.046	0.0482	No	0	No
8/10/2023 9:59	0	0.047	0.0483	No	0	No
8/10/2023 10:00	0	0.046	0.0482	No	0	No
8/10/2023 10:01	0	0.047	0.0482	No	0	No
8/10/2023 10:02	0	0.049	0.0485	No	0	No
8/10/2023 10:03	0	0.049	0.0487	No	0	No
8/10/2023 10:04	0	0.05	0.0489	No	0	No
8/10/2023 10:05	0	0.05	0.0491	No	0	No
8/10/2023 10:06	0	0.05	0.0489	No	0	No
8/10/2023 10:07	0	0.049	0.0491	No	0	No
8/10/2023 10:08	0	0.049	0.0487	No	0	No
8/10/2023 10:09	0	0.049	0.0481	No	0	No
8/10/2023 10:10	0	0.05	0.0483	No	0	No
8/10/2023 10:11	0	0.05	0.0485	No	0	No
8/10/2023 10:12	0	0.049	0.0487	No	0	No
8/10/2023 10:13	0	0.049	0.0489	No	0	No
8/10/2023 10:14	0	0.049	0.049	No	0	No
8/10/2023 10:15	0	0.049	0.0492	No	0	No
8/10/2023 10:16	0	0.05	0.0494	No	0	No
8/10/2023 10:17	0	0.053	0.0497	No	0	No
8/10/2023 10:18	0	0.054	0.05	No	0	No
8/10/2023 10:19	0	0.054	0.0503	No	0	No
8/10/2023 10:20	0	0.057	0.0507	No	0	No
8/10/2023 10:21	0	0.06	0.0514	No	0	No
8/10/2023 10:22	0	0.056	0.0519	No	0	No
8/10/2023 10:23	0	0.052	0.0521	No	0	No
8/10/2023 10:24	0	0.051	0.0522	No	0	No
8/10/2023 10:25	0	0.057	0.0527	No	0	No
8/10/2023 10:26	0	0.055	0.053	No	0	No
8/10/2023 10:27	0	0.06	0.0537	No	0	No
8/10/2023 10:28	0	0.057	0.0543	No	0	No
8/10/2023 10:29	0	0.054	0.0546	No	0	No
8/10/2023 10:30	0	0.052	0.0548	No	0	No
8/10/2023 10:31	0	0.053	0.055	No	0	No
8/10/2023 10:32	0	0.062	0.0556	No	0	No
8/10/2023 10:33	0	0.05	0.0553	No	0	No
8/10/2023 10:34	0	0.05	0.0551	No	0	No
8/10/2023 10:35	0	0.05	0.0546	No	0	No
8/10/2023 10:36	0	0.052	0.0541	No	0	No
8/10/2023 10:37	0	0.05	0.0537	No	0	No
8/10/2023 10:38	0	0.048	0.0534	No	0	No
8/10/2023 10:39	0	0.048	0.0532	No	0	No

Upwind Station						
Time	Instaneous VOC (ppm)	Instaneous Mass Conc. Total (mg/m <sup>3</sup> )	Mass Conc. Total mg/m <sup>3</sup> AVG 15m (mg/m <sup>3</sup> )	Dust Exceedance	VOC ppm AVG 15m (ppm)	VOC Exceedance
8/10/2023 10:40	0	0.048	0.0526	No	0	No
8/10/2023 10:41	0	0.049	0.0522	No	0	No
8/10/2023 10:42	0	0.05	0.0515	No	0	No
8/10/2023 10:43	0	0.049	0.051	No	0	No
8/10/2023 10:44	0	0.049	0.0507	No	0	No
8/10/2023 10:45	0	0.05	0.0505	No	0	No
8/10/2023 10:46	0	0.051	0.0504	No	0	No
8/10/2023 10:47	0	0.052	0.0497	No	0	No
8/10/2023 10:48	0	0.052	0.0499	No	0	No
8/10/2023 10:49	0	0.051	0.0499	No	0	No
8/10/2023 10:50	0	0.055	0.0503	No	0	No
8/10/2023 10:51	0	0.051	0.0502	No	0	No
8/10/2023 10:52	0	0.05	0.0502	No	0	No
8/10/2023 10:53	0	0.05	0.0503	No	0	No
8/10/2023 10:54	0	0.05	0.0505	No	0	No
8/10/2023 10:55	0	0.049	0.0505	No	0	No
8/10/2023 10:56	0	0.05	0.0506	No	0	No
8/10/2023 10:57	0	0.053	0.0508	No	0	No
8/10/2023 10:58	0	0.052	0.051	No	0	No
8/10/2023 10:59	0	0.055	0.0514	No	0	No
8/10/2023 11:00	0	0.055	0.0517	No	0	No
8/10/2023 11:01	0	0.051	0.0517	No	0	No
8/10/2023 11:02	0	0.052	0.0517	No	0	No
8/10/2023 11:03	0	0.055	0.0519	No	0	No
8/10/2023 11:04	0	0.052	0.052	No	0	No
8/10/2023 11:05	0	0.051	0.0517	No	0	No
8/10/2023 11:06	0	0.051	0.0517	No	0	No
8/10/2023 11:07	2.583	0.052	0.0519	No	0.1722	No
8/10/2023 11:08	0.464	0.06	0.0525	No	0.2031	No
8/10/2023 11:09	0.148	0.055	0.0529	No	0.213	No
8/10/2023 11:10	0.102	0.052	0.0531	No	0.2198	No
8/10/2023 11:11	0.065	0.052	0.0532	No	0.2241	No
8/10/2023 11:12	0.054	0.053	0.0532	No	0.2277	No
8/10/2023 11:13	0.068	0.058	0.0536	No	0.2323	No
8/10/2023 11:14	0.032	0.053	0.0535	No	0.2344	No
8/10/2023 11:15	0.029	0.054	0.0534	No	0.2363	No
8/10/2023 11:16	0.046	0.052	0.0535	No	0.2394	No
8/10/2023 11:17	0.124	0.054	0.0536	No	0.2477	No
8/10/2023 11:18	0.101	0.054	0.0535	No	0.2544	No
8/10/2023 11:19	0.038	0.053	0.0536	No	0.2569	No
8/10/2023 11:20	0.015	0.065	0.0545	No	0.2579	No
8/10/2023 11:21	0.027	0.051	0.0545	No	0.2597	No
8/10/2023 11:22	0	0.055	0.0547	No	0.0875	No
8/10/2023 11:23	0	0.058	0.0546	No	0.0566	No
8/10/2023 11:24	0	0.052	0.0544	No	0.0467	No
8/10/2023 11:25	0	0.053	0.0545	No	0.0399	No
8/10/2023 11:26	0	0.071	0.0557	No	0.0356	No
8/10/2023 11:27	0	0.061	0.0563	No	0.032	No
8/10/2023 11:28	0	0.052	0.0559	No	0.0275	No
8/10/2023 11:29	0	0.052	0.0558	No	0.0253	No
8/10/2023 11:30	0	0.052	0.0557	No	0.0234	No
8/10/2023 11:31	0	0.055	0.0559	No	0.0203	No



Upwind Station						
Time	Instaneous VOC (ppm)	Instaneous Mass Conc. Total (mg/m <sup>3</sup> )	Mass Conc. Total mg/m <sup>3</sup> AVG 15m (mg/m <sup>3</sup> )	Dust Exceedance	VOC ppm AVG 15m (ppm)	VOC Exceedance
8/10/2023 11:32	0	0.055	0.0559	No	0.0121	No
8/10/2023 11:33	0.109	0.058	0.0562	No	0.0126	No
8/10/2023 11:34	0	0.054	0.0563	No	0.0101	No
8/10/2023 11:35	0	0.058	0.0558	No	0.0091	No
8/10/2023 11:36	0.001	0.057	0.0562	No	0.0073	No
8/10/2023 11:37	0	0.05	0.0559	No	0.0073	No
8/10/2023 11:38	0	0.051	0.0554	No	0.0073	No
8/10/2023 11:39	0	0.051	0.0553	No	0.0073	No
8/10/2023 11:40	0.02	0.053	0.0553	No	0.0087	No
8/10/2023 11:41	0	0.052	0.0541	No	0.0087	No
8/10/2023 11:42	0	0.052	0.0535	No	0.0087	No
8/10/2023 11:43	0	0.051	0.0534	No	0.0087	No
8/10/2023 11:44	0	0.052	0.0534	No	0.0087	No
8/10/2023 11:45	0	0.053	0.0535	No	0.0087	No
8/10/2023 11:46	0.043	0.056	0.0535	No	0.0115	No
8/10/2023 11:47	0	0.05	0.0532	No	0.0115	No
8/10/2023 11:48	0.002	0.05	0.0527	No	0.0044	No
8/10/2023 11:49	0.118	0.05	0.0524	No	0.0123	No
8/10/2023 11:50	0	0.05	0.0519	No	0.0123	No
8/10/2023 11:51	0	0.051	0.0515	No	0.0122	No
8/10/2023 11:52	0	0.054	0.0517	No	0.0122	No
8/10/2023 11:53	0	0.056	0.0521	No	0.0122	No
8/10/2023 11:54	0	0.054	0.0523	No	0.0122	No
8/10/2023 11:55	0	0.049	0.052	No	0.0109	No
8/10/2023 11:56	0	0.05	0.0519	No	0.0109	No
8/10/2023 11:57	0	0.051	0.0518	No	0.0109	No
8/10/2023 11:58	0	0.051	0.0518	No	0.0109	No
8/10/2023 11:59	0	0.049	0.0516	No	0.0109	No
8/10/2023 12:00	0	0.052	0.0515	No	0.0109	No
8/10/2023 12:01	0	0.053	0.0513	No	0.008	No
8/10/2023 12:02	0	0.052	0.0515	No	0.008	No
8/10/2023 12:03	0	0.052	0.0516	No	0.0079	No
8/10/2023 12:04	0	0.056	0.052	No	0	No
8/10/2023 12:05	0	0.056	0.0524	No	0	No
8/10/2023 12:06	0	0.054	0.0526	No	0	No
8/10/2023 12:07	0	0.054	0.0526	No	0	No
8/10/2023 12:08	0	0.053	0.0524	No	0	No
8/10/2023 12:09	0.013	0.054	0.0524	No	0.0009	No
8/10/2023 12:10	0	0.054	0.0527	No	0.0009	No
8/10/2023 12:11	0	0.055	0.0531	No	0.0009	No
8/10/2023 12:12	0.027	0.056	0.0534	No	0.0027	No
8/10/2023 12:13	0	0.055	0.0537	No	0.0027	No
8/10/2023 12:14	0	0.053	0.0539	No	0.0027	No
8/10/2023 12:15	0	0.056	0.0542	No	0.0027	No
8/10/2023 12:16	0	0.056	0.0544	No	0.0027	No
8/10/2023 12:17	0	0.055	0.0546	No	0.0027	No
8/10/2023 12:18	0	0.054	0.0547	No	0.0027	No
8/10/2023 12:19	0	0.056	0.0547	No	0.0027	No
8/10/2023 12:20	0	0.055	0.0547	No	0.0027	No
8/10/2023 12:21	0.033	0.058	0.0549	No	0.0049	No
8/10/2023 12:22	0	0.056	0.0551	No	0.0049	No
8/10/2023 12:23	0	0.052	0.055	No	0.0049	No

Upwind Station						
Time	Instaneous VOC (ppm)	Instaneous Mass Conc. Total (mg/m <sup>3</sup> )	Mass Conc. Total mg/m <sup>3</sup> AVG 15m (mg/m <sup>3</sup> )	Dust Exceedance	VOC ppm AVG 15m (ppm)	VOC Exceedance
8/10/2023 12:24	0	0.051	0.0548	No	0.004	No
8/10/2023 12:25	0	0.052	0.0547	No	0.004	No
8/10/2023 12:26	0	0.049	0.0543	No	0.004	No
8/10/2023 12:27	0	0.051	0.0539	No	0.0022	No
8/10/2023 12:28	0	0.05	0.0536	No	0.0022	No
8/10/2023 12:29	0	0.048	0.0533	No	0.0022	No
8/10/2023 12:30	0	0.048	0.0527	No	0.0022	No
8/10/2023 12:31	0	0.051	0.0524	No	0.0022	No
8/10/2023 12:32	0	0.051	0.0521	No	0.0022	No
8/10/2023 12:33	0	0.051	0.0519	No	0.0022	No
8/10/2023 12:34	0	0.051	0.0516	No	0.0022	No
8/10/2023 12:35	0	0.051	0.0513	No	0.0022	No
8/10/2023 12:36	0	0.049	0.0507	No	0	No
8/10/2023 12:37	0	0.052	0.0505	No	0	No
8/10/2023 12:38	0	0.052	0.0505	No	0	No
8/10/2023 12:39	0	0.054	0.0507	No	0	No
8/10/2023 12:40	0	0.052	0.0507	No	0	No
8/10/2023 12:41	0	0.052	0.0509	No	0	No
8/10/2023 12:42	0	0.051	0.0509	No	0	No
8/10/2023 12:43	0	0.052	0.051	No	0	No
8/10/2023 12:44	0	0.054	0.0514	No	0	No
8/10/2023 12:45	0	0.053	0.0517	No	0	No
8/10/2023 12:46	0.05	0.054	0.0519	No	0.003	No
8/10/2023 12:47	0	0.053	0.0521	No	0.003	No
8/10/2023 12:48	0	0.051	0.0521	No	0.003	No
8/10/2023 12:49	0.065	0.051	0.0521	No	0.0077	No
8/10/2023 12:50	0.049	0.059	0.0526	No	0.0109	No
8/10/2023 12:51	0	0.061	0.0534	No	0.0109	No
8/10/2023 12:52	0	0.057	0.0537	No	0.0109	No
8/10/2023 12:53	0	0.059	0.0542	No	0.0109	No
8/10/2023 12:54	0	0.065	0.0549	No	0.0109	No
8/10/2023 12:55	0.041	0.061	0.0555	No	0.0137	No
8/10/2023 12:56	0	0.067	0.0565	No	0.0137	No
8/10/2023 12:57	0	0.066	0.0575	No	0.0137	No
8/10/2023 12:58	0	0.067	0.0585	No	0.0137	No
8/10/2023 12:59	0	0.064	0.0592	No	0.0137	No
8/10/2023 13:00	0	0.06	0.0597	No	0.0137	No
8/10/2023 13:01	0	0.06	0.0601	No	0.0103	No
8/10/2023 13:02	0	0.065	0.0609	No	0.0103	No

Downwind Station						
Time	Instantaneous VOC (ppm)	Instantaneous Mass Conc. Total (mg/m <sup>3</sup> )	Mass Conc. Total mg/m <sup>3</sup> AVG 15m (mg/m <sup>3</sup> )	Dust Exceedance	VOC ppm AVG 15m (ppm)	VOC Exceedance
8/10/2023 7:19	0			No	0	No
8/10/2023 7:20	0	0.032	0.032	No	0	No
8/10/2023 7:21	0	0.034	0.033	No	0	No
8/10/2023 7:22	0	0.035	0.0337	No	0	No
8/10/2023 7:23	0	0.036	0.0343	No	0	No
8/10/2023 7:24	0	0.035	0.0344	No	0	No
8/10/2023 7:25	0	0.036	0.0347	No	0	No
8/10/2023 7:26	0	0.035	0.0347	No	0	No
8/10/2023 7:27	0	0.035	0.0348	No	0	No
8/10/2023 7:28	0	0.034	0.0347	No	0	No
8/10/2023 7:29	0	0.035	0.0347	No	0	No
8/10/2023 7:30	0	0.037	0.0349	No	0	No
8/10/2023 7:31	0	0.037	0.0351	No	0	No
8/10/2023 7:32	0	0.036	0.0352	No	0	No
8/10/2023 7:33	0	0.038	0.0354	No	0	No
8/10/2023 7:34	0	0.037	0.0355	No	0	No
8/10/2023 7:35	0	0.037	0.0358	No	0	No
8/10/2023 7:36	0	0.04	0.0362	No	0	No
8/10/2023 7:37	0	0.038	0.0364	No	0	No
8/10/2023 7:38	0	0.037	0.0365	No	0	No
8/10/2023 7:39	0	0.037	0.0366	No	0	No
8/10/2023 7:40	0	0.038	0.0367	No	0	No
8/10/2023 7:41	0	0.041	0.0371	No	0	No
8/10/2023 7:42	0	0.038	0.0373	No	0	No
8/10/2023 7:43	0	0.038	0.0376	No	0	No
8/10/2023 7:44	0	0.043	0.0381	No	0	No
8/10/2023 7:45	0	0.038	0.0382	No	0	No
8/10/2023 7:46	0	0.037	0.0382	No	0	No
8/10/2023 7:47	0	0.039	0.0384	No	0	No
8/10/2023 7:48	0	0.037	0.0383	No	0	No
8/10/2023 7:49	0	0.038	0.0384	No	0	No
8/10/2023 7:50	0	0.04	0.0386	No	0	No
8/10/2023 7:51	0	0.038	0.0385	No	0	No
8/10/2023 7:52	0	0.037	0.0384	No	0	No
8/10/2023 7:53	0	0.043	0.0388	No	0	No
8/10/2023 7:54	0	0.047	0.0395	No	0	No
8/10/2023 7:55	0	0.046	0.04	No	0	No
8/10/2023 7:56	0	0.041	0.04	No	0	No
8/10/2023 7:57	0	0.039	0.0401	No	0	No
8/10/2023 7:58	0	0.048	0.0407	No	0	No
8/10/2023 7:59	0	0.041	0.0406	No	0	No
8/10/2023 8:00	0	0.041	0.0408	No	0	No
8/10/2023 8:01	0	0.037	0.0408	No	0	No
8/10/2023 8:02	0	0.037	0.0407	No	0	No
8/10/2023 8:03	0	0.038	0.0407	No	0	No
8/10/2023 8:04	0	0.04	0.0409	No	0	No
8/10/2023 8:05	0	0.04	0.0409	No	0	No
8/10/2023 8:06	0	0.039	0.0409	No	0	No
8/10/2023 8:07	0	0.04	0.0411	No	0	No
8/10/2023 8:08	0	0.04	0.0409	No	0	No
8/10/2023 8:09	0	0.042	0.0406	No	0	No
8/10/2023 8:10	0	0.043	0.0404	No	0	No
8/10/2023 8:11	0	0.045	0.0407	No	0	No
8/10/2023 8:12	0	0.05	0.0414	No	0	No
8/10/2023 8:13	0	0.044	0.0411	No	0	No

Downwind Station						
Time	Instantaneous VOC (ppm)	Instantaneous Mass Conc. Total (mg/m <sup>3</sup> )	Mass Conc. Total mg/m <sup>3</sup> AVG 15m (mg/m <sup>3</sup> )	Dust Exceedance	VOC ppm AVG 15m (ppm)	VOC Exceedance
8/10/2023 8:14	0	0.046	0.0415	No	0	No
8/10/2023 8:15	0	0.042	0.0415	No	0	No
8/10/2023 8:16	0	0.041	0.0418	No	0	No
8/10/2023 8:17	0	0.041	0.0421	No	0	No
8/10/2023 8:18	0	0.041	0.0423	No	0	No
8/10/2023 8:19	0	0.042	0.0424	No	0	No
8/10/2023 8:20	0	0.041	0.0425	No	0	No
8/10/2023 8:21	0	0.042	0.0427	No	0	No
8/10/2023 8:22	0	0.041	0.0427	No	0	No
8/10/2023 8:23	0	0.042	0.0429	No	0	No
8/10/2023 8:24	0	0.047	0.0432	No	0	No
8/10/2023 8:25	0	0.042	0.0431	No	0	No
8/10/2023 8:26	0	0.042	0.0429	No	0	No
8/10/2023 8:27	0	0.044	0.0425	No	0	No
8/10/2023 8:28	0	0.044	0.0425	No	0	No
8/10/2023 8:29	0	0.048	0.0427	No	0	No
8/10/2023 8:30	0	0.043	0.0427	No	0	No
8/10/2023 8:31	0	0.043	0.0429	No	0	No
8/10/2023 8:32	0	0.044	0.0431	No	0	No
8/10/2023 8:33	0	0.042	0.0431	No	0	No
8/10/2023 8:34	0	0.043	0.0432	No	0	No
8/10/2023 8:35	0	0.043	0.0433	No	0	No
8/10/2023 8:36	0	0.043	0.0434	No	0	No
8/10/2023 8:37	0	0.044	0.0436	No	0	No
8/10/2023 8:38	0	0.043	0.0437	No	0	No
8/10/2023 8:39	0	0.043	0.0434	No	0	No
8/10/2023 8:40	0	0.044	0.0435	No	0	No
8/10/2023 8:41	0	0.045	0.0437	No	0	No
8/10/2023 8:42	0	0.049	0.0441	No	0	No
8/10/2023 8:43	0	0.052	0.0446	No	0	No
8/10/2023 8:44	0	0.045	0.0444	No	0	No
8/10/2023 8:45	0	0.048	0.0447	No	0	No
8/10/2023 8:46	0	0.046	0.0449	No	0	No
8/10/2023 8:47	0	0.046	0.0451	No	0	No
8/10/2023 8:48	0	0.047	0.0454	No	0	No
8/10/2023 8:49	0	0.047	0.0457	No	0	No
8/10/2023 8:50	0	0.049	0.0461	No	0	No
8/10/2023 8:51	0	0.051	0.0466	No	0	No
8/10/2023 8:52	0	0.052	0.0471	No	0	No
8/10/2023 8:53	0	0.049	0.0475	No	0	No
8/10/2023 8:54	0	0.051	0.0481	No	0	No
8/10/2023 8:55	0	0.051	0.0485	No	0	No
8/10/2023 8:56	0	0.051	0.0489	No	0	No
8/10/2023 8:57	0	0.049	0.0489	No	0	No
8/10/2023 8:58	0	0.05	0.0488	No	0	No
8/10/2023 8:59	0	0.048	0.049	No	0	No
8/10/2023 9:00	0	0.053	0.0493	No	0	No
8/10/2023 9:01	0	0.05	0.0496	No	0	No
8/10/2023 9:02	0	0.05	0.0499	No	0	No
8/10/2023 9:03	0	0.052	0.0502	No	0	No
8/10/2023 9:04	0	0.06	0.0511	No	0	No
8/10/2023 9:05	0	0.064	0.0521	No	0	No
8/10/2023 9:06	0	0.064	0.0529	No	0	No
8/10/2023 9:07	0	0.052	0.0529	No	0	No
8/10/2023 9:08	0	0.051	0.0531	No	0	No

Downwind Station						
Time	Instantaneous VOC (ppm)	Instantaneous Mass Conc. Total (mg/m <sup>3</sup> )	Mass Conc. Total mg/m <sup>3</sup> AVG 15m (mg/m <sup>3</sup> )	Dust Exceedance	VOC ppm AVG 15m (ppm)	VOC Exceedance
8/10/2023 9:09	0	0.053	0.0532	No	0	No
8/10/2023 9:10	0	0.049	0.0531	No	0	No
8/10/2023 9:11	0	0.049	0.0529	No	0	No
8/10/2023 9:12	0	0.048	0.0529	No	0	No
8/10/2023 9:13	0	0.049	0.0528	No	0	No
8/10/2023 9:14	0	0.048	0.0528	No	0	No
8/10/2023 9:15	0	0.05	0.0526	No	0	No
8/10/2023 9:16	0	0.049	0.0525	No	0	No
8/10/2023 9:17	0	0.048	0.0524	No	0	No
8/10/2023 9:18	0	0.049	0.0522	No	0	No
8/10/2023 9:19	0	0.05	0.0515	No	0	No
8/10/2023 9:20	0	0.051	0.0507	No	0	No
8/10/2023 9:21	0	0.05	0.0497	No	0	No
8/10/2023 9:22	0	0.052	0.0497	No	0	No
8/10/2023 9:23	0	0.053	0.0499	No	0	No
8/10/2023 9:24	0	0.056	0.0501	No	0	No
8/10/2023 9:25	0	0.052	0.0503	No	0	No
8/10/2023 9:26	0	0.051	0.0504	No	0	No
8/10/2023 9:27	0	0.057	0.051	No	0	No
8/10/2023 9:28	0	0.052	0.0512	No	0	No
8/10/2023 9:29	0	0.053	0.0515	No	0	No
8/10/2023 9:30	0	0.055	0.0519	No	0	No
8/10/2023 9:31	0	0.054	0.0522	No	0	No
8/10/2023 9:32	0	0.05	0.0523	No	0	No
8/10/2023 9:33	0	0.055	0.0527	No	0	No
8/10/2023 9:34	0	0.049	0.0527	No	0	No
8/10/2023 9:35	0	0.053	0.0528	No	0	No
8/10/2023 9:36	0	0.053	0.053	No	0	No
8/10/2023 9:37	0	0.054	0.0531	No	0	No
8/10/2023 9:38	0	0.051	0.053	No	0	No
8/10/2023 9:39	0	0.05	0.0526	No	0	No
8/10/2023 9:40	0	0.055	0.0528	No	0	No
8/10/2023 9:41	0	0.053	0.0529	No	0	No
8/10/2023 9:42	0	0.049	0.0524	No	0	No
8/10/2023 9:43	0	0.05	0.0523	No	0	No
8/10/2023 9:44	0	0.05	0.0521	No	0	No
8/10/2023 9:45	0	0.052	0.0519	No	0	No
8/10/2023 9:46	0	0.051	0.0517	No	0	No
8/10/2023 9:47	0	0.052	0.0518	No	0	No
8/10/2023 9:48	0	0.053	0.0517	No	0	No
8/10/2023 9:49	0	0.053	0.0519	No	0	No
8/10/2023 9:50	0	0.051	0.0518	No	0	No
8/10/2023 9:51	0	0.05	0.0516	No	0	No
8/10/2023 9:52	0	0.049	0.0513	No	0	No
8/10/2023 9:53	0	0.05	0.0512	No	0	No
8/10/2023 9:54	0	0.062	0.052	No	0	No
8/10/2023 9:55	0	0.05	0.0517	No	0	No
8/10/2023 9:56	0	0.051	0.0515	No	0	No
8/10/2023 9:57	0	0.05	0.0516	No	0	No
8/10/2023 9:58	0	0.053	0.0518	No	0	No
8/10/2023 9:59	0	0.051	0.0519	No	0	No
8/10/2023 10:00	0	0.051	0.0518	No	0	No
8/10/2023 10:01	0	0.052	0.0519	No	0	No
8/10/2023 10:02	0	0.053	0.0519	No	0	No
8/10/2023 10:03	0	0.056	0.0521	No	0	No

Downwind Station						
Time	Instantaneous VOC (ppm)	Instantaneous Mass Conc. Total (mg/m <sup>3</sup> )	Mass Conc. Total mg/m <sup>3</sup> AVG 15m (mg/m <sup>3</sup> )	Dust Exceedance	VOC ppm AVG 15m (ppm)	VOC Exceedance
8/10/2023 10:04	0	0.054	0.0522	No	0	No
8/10/2023 10:05	0	0.055	0.0525	No	0	No
8/10/2023 10:06	0	0.054	0.0527	No	0	No
8/10/2023 10:07	0	0.054	0.0531	No	0	No
8/10/2023 10:08	0	0.054	0.0533	No	0	No
8/10/2023 10:09	0	0.055	0.0529	No	0	No
8/10/2023 10:10	0	0.053	0.0531	No	0	No
8/10/2023 10:11	0	0.056	0.0534	No	0	No
8/10/2023 10:12	0	0.054	0.0537	No	0	No
8/10/2023 10:13	0	0.054	0.0537	No	0	No
8/10/2023 10:14	0	0.057	0.0541	No	0	No
8/10/2023 10:15	0	0.055	0.0544	No	0	No
8/10/2023 10:16	0	0.056	0.0547	No	0	No
8/10/2023 10:17	0	0.058	0.055	No	0	No
8/10/2023 10:18	0	0.058	0.0551	No	0	No
8/10/2023 10:19	0	0.058	0.0554	No	0	No
8/10/2023 10:20	0	0.057	0.0555	No	0	No
8/10/2023 10:21	0	0.057	0.0557	No	0	No
8/10/2023 10:22	0	0.059	0.0561	No	0	No
8/10/2023 10:23	0	0.057	0.0563	No	0	No
8/10/2023 10:24	0	0.057	0.0564	No	0	No
8/10/2023 10:25	0	0.058	0.0567	No	0	No
8/10/2023 10:26	0	0.06	0.057	No	0	No
8/10/2023 10:27	0	0.062	0.0575	No	0	No
8/10/2023 10:28	0	0.061	0.058	No	0	No
8/10/2023 10:29	0	0.059	0.0581	No	0	No
8/10/2023 10:30	0	0.055	0.0581	No	0	No
8/10/2023 10:31	0	0.057	0.0582	No	0	No
8/10/2023 10:32	0	0.06	0.0583	No	0	No
8/10/2023 10:33	0	0.063	0.0587	No	0	No
8/10/2023 10:34	0	0.061	0.0589	No	0	No
8/10/2023 10:35	0	0.058	0.0589	No	0	No
8/10/2023 10:36	0	0.058	0.059	No	0	No
8/10/2023 10:37	0	0.054	0.0587	No	0	No
8/10/2023 10:38	0	0.054	0.0585	No	0	No
8/10/2023 10:39	0	0.054	0.0583	No	0	No
8/10/2023 10:40	0	0.054	0.058	No	0	No
8/10/2023 10:41	0	0.055	0.0577	No	0	No
8/10/2023 10:42	0	0.056	0.0573	No	0	No
8/10/2023 10:43	0	0.054	0.0568	No	0	No
8/10/2023 10:44	0	0.054	0.0565	No	0	No
8/10/2023 10:45	0	0.056	0.0565	No	0	No
8/10/2023 10:46	0	0.058	0.0566	No	0	No
8/10/2023 10:47	0	0.058	0.0565	No	0	No
8/10/2023 10:48	0	0.057	0.0561	No	0	No

Downwind Station						
Time	Instantaneous VOC (ppm)	Instantaneous Mass Conc. Total (mg/m <sup>3</sup> )	Mass Conc. Total mg/m <sup>3</sup> AVG 15m (mg/m <sup>3</sup> )	Dust Exceedance	VOC ppm AVG 15m (ppm)	VOC Exceedance
8/10/2023 10:49	0	0.057	0.0558	No	0	No
8/10/2023 10:50	0	0.059	0.0559	No	0	No
8/10/2023 10:51	0	0.057	0.0558	No	0	No
8/10/2023 10:52	0	0.057	0.056	No	0	No
8/10/2023 10:53	0	0.055	0.0561	No	0	No
8/10/2023 10:54	0	0.056	0.0562	No	0	No
8/10/2023 10:55	0	0.055	0.0563	No	0	No
8/10/2023 10:56	0	0.056	0.0563	No	0	No
8/10/2023 10:57	0	0.058	0.0565	No	0	No
8/10/2023 10:58	0	0.055	0.0565	No	0	No
8/10/2023 10:59	0	0.058	0.0568	No	0	No
8/10/2023 11:00	0	0.057	0.0569	No	0	No
8/10/2023 11:01	0	0.057	0.0568	No	0	No
8/10/2023 11:02	0	0.06	0.0569	No	0	No
8/10/2023 11:03	0	0.06	0.0571	No	0	No
8/10/2023 11:04	0	0.058	0.0572	No	0	No
8/10/2023 11:05	0	0.058	0.0571	No	0	No
8/10/2023 11:06	0	0.057	0.0571	No	0	No
8/10/2023 11:07	0	0.059	0.0573	No	0	No
8/10/2023 11:08	0	0.058	0.0575	No	0	No
8/10/2023 11:09	0	0.057	0.0575	No	0	No
8/10/2023 11:10	0	0.06	0.0579	No	0	No
8/10/2023 11:11	0	0.059	0.0581	No	0	No
8/10/2023 11:12	0	0.058	0.0581	No	0	No
8/10/2023 11:13	0	0.059	0.0583	No	0	No
8/10/2023 11:14	0	0.058	0.0583	No	0	No
8/10/2023 11:15	0	0.061	0.0586	No	0	No
8/10/2023 11:16	0	0.059	0.0587	No	0	No
8/10/2023 11:17	0	0.059	0.0587	No	0	No
8/10/2023 11:18	0	0.061	0.0587	No	0	No
8/10/2023 11:19	0	0.059	0.0588	No	0	No
8/10/2023 11:20	0	0.06	0.0589	No	0	No
8/10/2023 11:21	0	0.065	0.0595	No	0	No
8/10/2023 11:22	0	0.062	0.0597	No	0	No
8/10/2023 11:23	0	0.062	0.0599	No	0	No
8/10/2023 11:24	0	0.067	0.0606	No	0	No
8/10/2023 11:25	0	0.067	0.0611	No	0	No
8/10/2023 11:26	0	0.061	0.0612	No	0	No
8/10/2023 11:27	0	0.109	0.0646	No	0	No
8/10/2023 11:28	0	0.073	0.0655	No	0	No
8/10/2023 11:29	0	0.058	0.0655	No	0	No
8/10/2023 11:30	0	0.06	0.0655	No	0	No
8/10/2023 11:31	0	0.059	0.0655	No	0	No
8/10/2023 11:32	0	0.061	0.0656	No	0	No
8/10/2023 11:33	0	0.065	0.0659	No	0	No
8/10/2023 11:34	0	0.07	0.0666	No	0	No
8/10/2023 11:35	0	0.073	0.0675	No	0	No
8/10/2023 11:36	0	0.059	0.0671	No	0	No
8/10/2023 11:37	0	0.063	0.0671	No	0	No
8/10/2023 11:38	0	0.059	0.0669	No	0	No
8/10/2023 11:39	0	0.057	0.0663	No	0	No
8/10/2023 11:40	0	0.058	0.0657	No	0	No
8/10/2023 11:41	0	0.06	0.0656	No	0	No
8/10/2023 11:42	0	0.06	0.0623	No	0	No
8/10/2023 11:43	0	0.06	0.0615	No	0	No

Downwind Station						
Time	Instaneous VOC (ppm)	Instaneous Mass Conc. Total (mg/m <sup>3</sup> )	Mass Conc. Total mg/m <sup>3</sup> AVG 15m (mg/m <sup>3</sup> )	Dust Exceedance	VOC ppm AVG 15m (ppm)	VOC Exceedance
8/10/2023 11:44	0	0.06	0.0616	No	0	No
8/10/2023 11:45	0	0.061	0.0617	No	0	No
8/10/2023 11:46	0	0.062	0.0619	No	0	No
8/10/2023 11:47	0	0.057	0.0616	No	0	No
8/10/2023 11:48	0	0.058	0.0611	No	0	No
8/10/2023 11:49	0	0.058	0.0603	No	0	No
8/10/2023 11:50	0	0.058	0.0593	No	0	No
8/10/2023 11:51	0	0.059	0.0593	No	0	No
8/10/2023 11:52	0	0.058	0.059	No	0	No
8/10/2023 11:53	0	0.056	0.0588	No	0	No
8/10/2023 11:54	0	0.056	0.0587	No	0	No
8/10/2023 11:55	0	0.056	0.0586	No	0	No
8/10/2023 11:56	0	0.057	0.0584	No	0	No
8/10/2023 11:57	0	0.061	0.0585	No	0	No
8/10/2023 11:58	0	0.058	0.0583	No	0	No
8/10/2023 11:59	0	0.058	0.0582	No	0	No
8/10/2023 12:00	0	0.061	0.0582	No	0	No
8/10/2023 12:01	0	0.059	0.058	No	0	No
8/10/2023 12:02	0	0.06	0.0582	No	0	No
8/10/2023 12:03	0	0.06	0.0583	No	0	No
8/10/2023 12:04	0	0.061	0.0585	No	0	No
8/10/2023 12:05	0	0.062	0.0588	No	0	No
8/10/2023 12:06	0	0.061	0.0589	No	0	No
8/10/2023 12:07	0	0.061	0.0591	No	0	No
8/10/2023 12:08	0	0.062	0.0595	No	0	No
8/10/2023 12:09	0	0.061	0.0599	No	0	No
8/10/2023 12:10	0	0.062	0.0603	No	0	No
8/10/2023 12:11	0	0.061	0.0605	No	0	No
8/10/2023 12:12	0	0.061	0.0605	No	0	No
8/10/2023 12:13	0	0.061	0.0607	No	0	No
8/10/2023 12:14	0	0.062	0.061	No	0	No
8/10/2023 12:15	0	0.074	0.0619	No	0	No
8/10/2023 12:16	0	0.064	0.0622	No	0	No
8/10/2023 12:17	0	0.063	0.0624	No	0	No
8/10/2023 12:18	0	0.062	0.0625	No	0	No
8/10/2023 12:19	0	0.062	0.0626	No	0	No
8/10/2023 12:20	0	0.061	0.0625	No	0	No
8/10/2023 12:21	0	0.062	0.0626	No	0	No
8/10/2023 12:22	0	0.059	0.0625	No	0	No
8/10/2023 12:23	0	0.067	0.0628	No	0	No
8/10/2023 12:24	0	0.065	0.0631	No	0	No
8/10/2023 12:25	0	0.058	0.0628	No	0	No
8/10/2023 12:26	0	0.063	0.0629	No	0	No
8/10/2023 12:27	0	0.059	0.0628	No	0	No
8/10/2023 12:28	0	0.06	0.0627	No	0	No
8/10/2023 12:29	0	0.058	0.0625	No	0	No
8/10/2023 12:30	0	0.058	0.0614	No	0	No
8/10/2023 12:31	0	0.057	0.0609	No	0	No
8/10/2023 12:32	0	0.06	0.0607	No	0	No
8/10/2023 12:33	0	0.061	0.0607	No	0	No
8/10/2023 12:34	0	0.062	0.0607	No	0	No
8/10/2023 12:35	0	0.06	0.0606	No	0	No
8/10/2023 12:36	0	0.061	0.0605	No	0	No
8/10/2023 12:37	0	0.062	0.0607	No	0	No
8/10/2023 12:38	0	0.064	0.0605	No	0	No



**Downwind Station**

Time	Instantaneous VOC (ppm)	Instantaneous Mass Conc. Total (mg/m <sup>3</sup> )	Mass Conc. Total mg/m <sup>3</sup> AVG 15m (mg/m <sup>3</sup> )	Dust Exceedance	VOC ppm AVG 15m (ppm)	VOC Exceedance
8/10/2023 12:39	0	0.063	0.0604	No	0	No
8/10/2023 12:40	0	0.062	0.0607	No	0	No
8/10/2023 12:41	0	0.059	0.0604	No	0	No
8/10/2023 12:42	0	0.062	0.0606	No	0	No
8/10/2023 12:43	0	0.066	0.061	No	0	No
8/10/2023 12:44	0	0.064	0.0614	No	0	No
8/10/2023 12:45	0	0.065	0.0619	No	0	No
8/10/2023 12:46	0	0.063	0.0623	No	0	No
8/10/2023 12:47	0	0.063	0.0625	No	0	No
8/10/2023 12:48	0	0.059	0.0623	No	0	No
8/10/2023 12:49	0	0.062	0.0623	No	0	No
8/10/2023 12:50	0	0.06	0.0623	No	0	No
8/10/2023 12:51	0	0.061	0.0623	No	0	No
8/10/2023 12:52	0	0.061	0.0623	No	0	No
8/10/2023 12:53	0	0.064	0.0623	No	0	No
8/10/2023 12:54	0	0.064	0.0623	No	0	No
8/10/2023 12:55	0	0.065	0.0625	No	0	No
8/10/2023 12:56	0	0.062	0.0627	No	0	No
8/10/2023 12:57	0	0.065	0.0629	No	0	No
8/10/2023 12:58	0	0.065	0.0629	No	0	No
8/10/2023 12:59	0	0.071	0.0633	No	0	No
8/10/2023 13:00	0	0.064	0.0633	No	0	No
8/10/2023 13:01	0	0.067	0.0635	No	0	No
8/10/2023 13:02	0	0.069	0.0639	No	0	No
8/10/2023 13:03	0	0.07	0.0647	No	0	No
8/10/2023 13:04	0	0.087	0.0663	No	0	No