



## Daily Activity Report

Seton Brilla Charter School  
1956 Jerome Avenue, Bronx, NY  
BCP No. C203152

### General Site Information

Date:	Wednesday, June 28, 2023
Weather:	Mostly Sunny 68-81°
Wind Direction/Speed:	N @ 3 mph
AKRF Personnel on Site:	Lucas Belangia
AKRF Equipment on Site:	Mini RAE 3000 Photoionization Detector [(PID) x1], Roving SidePak Particulate Monitor (1), 2 Fixed Air Monitoring Stations [DustTrak Aerosol Monitors (x2) & MiniRAE 3000 PIDs (x2)].
Visitors:	None

### Contractor Information

Contracting Company	Main Personnel	Equipment
Casino Construction	Carlos	Excavator and a mini-excavator

### Description and Location of Work Activities Performed

- 1) Formwork and excavation in grid WC-02.
- 2) Plumbing installation in grid WC-01.

Destination Facility	Daily Trucks	Total Trucks	Daily Approx. Cubic Yds	Total Approx. Cubic Yds	Total Site Loads	Total Approximate Cubic Yards
Clean Earth Carteret	0	108	0	2,160	206	4,120
Clean Earth Southeastern Pennsylvania	0	67	0	1,340		
Clean Earth Bethlehem	0	31	0	620		
Concrete Disposal	0	27	0	540		
N/A	0	0	0	0		

### CAMP Air Monitoring Results

CAMP Station	UPWIND			DOWNWIND		
Odors:	None	Number of Exceedances	Time of Exceedance(s)	None	Number of Exceedances	Time of Exceedance(s)
VOC Action Level Exceedance(s):	None			None.		
Particulate Action Level Exceedance(s):	None			None		
Maximum VOC Level (15 min ppm):	0.00			0.000		
Maximum Particulate Level (15 min mg/m <sup>3</sup> ):	0.078			0.049		

Notes: CAMP monitoring was performed throughout the day until approx. 1408 due to precipitation. No exceedances were reported throughout the day.

### Additional Information

Planned Work Activity for Following Day/Week:	1) Grading gas permeable aggregate for SSDS installation. 2) SSDS and SVE installation.
Comments:	

Site Map

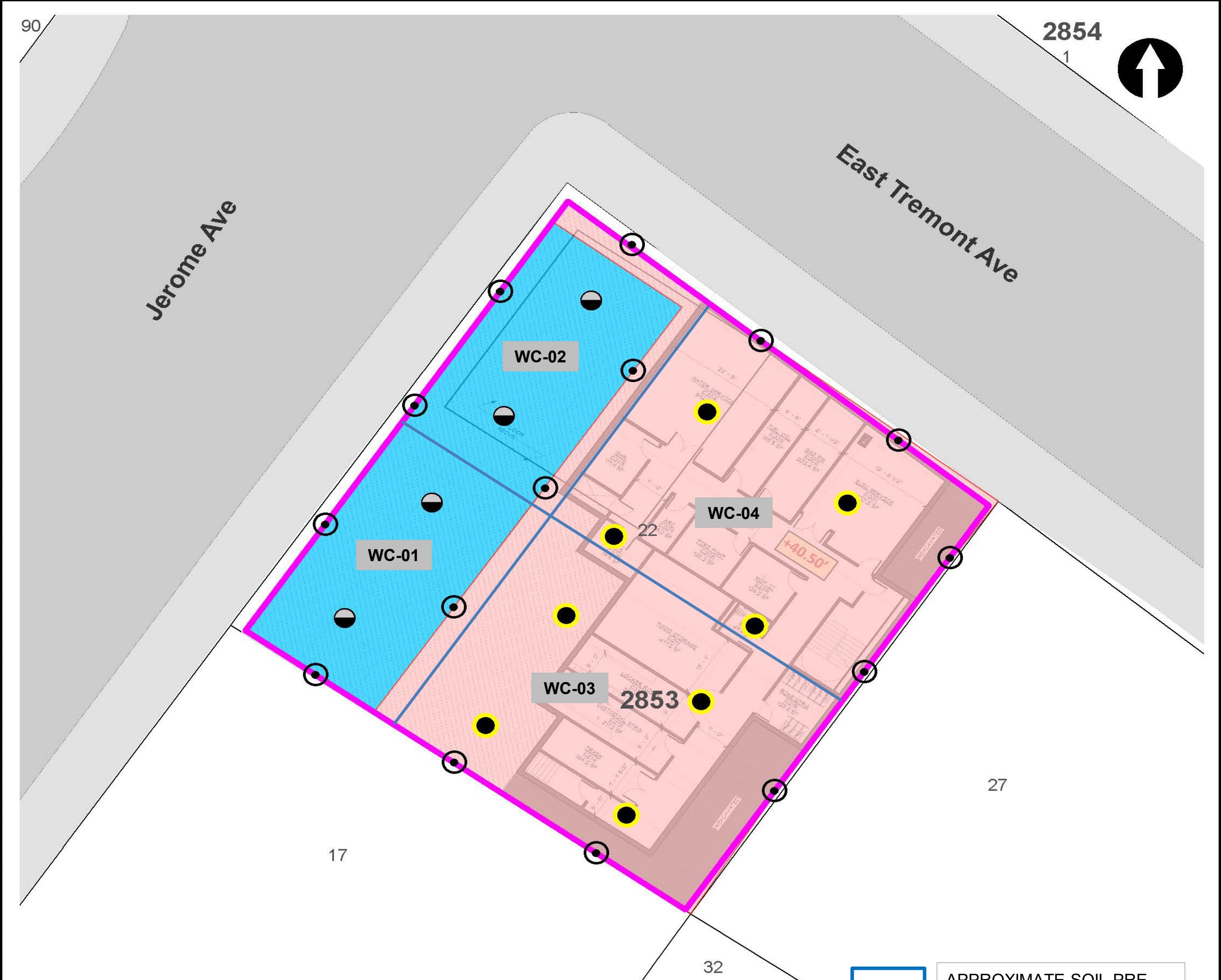

**LEGEND**

- PROJECT SITE BOUNDARY
- LOT BOUNDARY AND TAX LOT NUMBER
- 2853** BLOCK NUMBER
- REMEDIAL EXCAVATION TO APPROXIMATELY TWO FEET BELOW EXISTING GRADE
- REMEDIAL EXCAVATION TO GROUNDWATER (SOURCE AREA)

- CONFIRMATION DOCUMENTATION BOTTOM SAMPLE
- SOURCE AREA DOCUMENTATION BOTTOM SAMPLE
- DOCUMENTATION SIDEWALL SAMPLE

**NOTE**  
 REMEDIAL EXCAVATION WILL INCLUDE REMOVAL OF APPROXIMATELY 1,280 TONS (850 CUBIC YARDS) OF SOURCE MATERIAL ASSOCIATED WITH NYSDEC SPILL NO. 2103719 AND APPROXIMATELY 860 TONS (570 CUBIC YARDS) OF SOIL/FILL FROM THE UPPER 2 FEET SITE-WIDE.



APPROXIMATE SOIL PRE-CHARACTERIZATION GRID

Map Source:  
 NYCDOP (NYC Dept. of City Planning) GIS database

© 2021 AKRF. W:\Projects\210024 - 1956 JEROME AVENUE\Technical\GIS and Graphics\AR\RAW\210024 Figure 9 Proposed Remedial Excavation and Documentation Sample Location Plan.mxd 10/25/2021 2:03:38 PM iszalus



440 Park Avenue South, New York, NY 10016

**1956 Jerome Avenue**  
 Bronx, New York

**TRACK 4 CLEANUP AND DOCUMENTATION  
 SAMPLE LOCATION PLAN**

DATE  
**04/29/2022**

PROJECT NO.  
**210024**

FIGURE  
**11**

## Site Photographs

Photograph 1 -  
Plumbing installation  
in WC-01. View  
facing Southeast.



Photograph 2 -Site  
condition.  
Completed trench  
for SVE and SSDS  
installation. View  
facing Southeast.



Photograph 3 - Light  
excavation around  
piles and formwork  
construction in WC-  
02. View facing East.



**Upwind Station**

Time	Instaneous VOC (ppm)	Instaneous Mass Conc. Total (mg/m <sup>3</sup> )	Mass Conc. Total mg/m <sup>3</sup> AVG 15m (mg/m <sup>3</sup> )	Dust Exceedance	VOC ppm AVG 15m (ppm)	VOC Exceedance
6/28/2023 7:18	0	0.065	0.065	No	0	No
6/28/2023 7:19	0	0.066	0.0655	No	0	No
6/28/2023 7:20	0	0.062	0.0643	No	0	No
6/28/2023 7:21	0	0.057	0.0625	No	0	No
6/28/2023 7:22	0	0.059	0.0618	No	0	No
6/28/2023 7:23	0	0.058	0.0612	No	0	No
6/28/2023 7:24	0	0.058	0.0607	No	0	No
6/28/2023 7:25	0	0.062	0.0609	No	0	No
6/28/2023 7:26	0	0.061	0.0609	No	0	No
6/28/2023 7:27	0	0.059	0.0607	No	0	No
6/28/2023 7:28	0	0.059	0.0605	No	0	No
6/28/2023 7:29	0	0.061	0.0606	No	0	No
6/28/2023 7:30	0	0.066	0.061	No	0	No
6/28/2023 7:31	0	0.056	0.0606	No	0	No
6/28/2023 7:32	0	0.059	0.0605	No	0	No
6/28/2023 7:33	0	0.06	0.0602	No	0	No
6/28/2023 7:34	0	0.059	0.0597	No	0	No
6/28/2023 7:35	0	0.055	0.0593	No	0	No
6/28/2023 7:36	0	0.051	0.0589	No	0	No
6/28/2023 7:37	0	0.05	0.0583	No	0	No
6/28/2023 7:38	0	0.052	0.0579	No	0	No
6/28/2023 7:39	0	0.051	0.0574	No	0	No
6/28/2023 7:40	0	0.049	0.0565	No	0	No
6/28/2023 7:41	0	0.043	0.0553	No	0	No
6/28/2023 7:42	0	0.038	0.0539	No	0	No
6/28/2023 7:43	0	0.039	0.0526	No	0	No
6/28/2023 7:44	0	0.039	0.0511	No	0	No
6/28/2023 7:45	0	0.04	0.0494	No	0	No
6/28/2023 7:46	0	0.041	0.0484	No	0	No
6/28/2023 7:47	0	0.036	0.0469	No	0	No
6/28/2023 7:48	0	0.036	0.0453	No	0	No
6/28/2023 7:49	0	0.033	0.0435	No	0	No
6/28/2023 7:50	0	0.044	0.0428	No	0	No
6/28/2023 7:51	0	0.041	0.0421	No	0	No
6/28/2023 7:52	0	0.034	0.0411	No	0	No
6/28/2023 7:53	0	0.034	0.0399	No	0	No
6/28/2023 7:54	0	0.025	0.0381	No	0	No
6/28/2023 7:55	0	0.025	0.0365	No	0	No
6/28/2023 7:56	0	0.024	0.0353	No	0	No
6/28/2023 7:57	0	0.027	0.0345	No	0	No
6/28/2023 7:58	0	0.035	0.0343	No	0	No
6/28/2023 7:59	0	0.111	0.0391	No	0	No
6/28/2023 8:00	0	0.265	0.0541	No	0	No
6/28/2023 8:01	0	0.033	0.0535	No	0	No
6/28/2023 8:02	0	0.031	0.0532	No	0	No
6/28/2023 8:03	0	0.026	0.0525	No	0	No
6/28/2023 8:04	0	0.026	0.0521	No	0	No
6/28/2023 8:05	0	0.026	0.0509	No	0	No
6/28/2023 8:06	0	0.025	0.0498	No	0	No
6/28/2023 8:07	0	0.027	0.0493	No	0	No
6/28/2023 8:08	0	0.026	0.0488	No	0	No
6/28/2023 8:09	0	0.023	0.0487	No	0	No

Upwind Station						
Time	Instaneous VOC (ppm)	Instaneous Mass Conc. Total (mg/m <sup>3</sup> )	Mass Conc. Total mg/m <sup>3</sup> AVG 15m (mg/m <sup>3</sup> )	Dust Exceedance	VOC ppm AVG 15m (ppm)	VOC Exceedance
6/28/2023 8:10	0	0.022	0.0485	No	0	No
6/28/2023 8:11	0	0.022	0.0483	No	0	No
6/28/2023 8:12	0	0.024	0.0481	No	0	No
6/28/2023 8:13	0	0.031	0.0479	No	0	No
6/28/2023 8:14	0	0.023	0.042	No	0	No
6/28/2023 8:15	0	0.022	0.0258	No	0	No
6/28/2023 8:16	0	0.021	0.025	No	0	No
6/28/2023 8:17	0	0.02	0.0243	No	0	No
6/28/2023 8:18	0	0.021	0.0239	No	0	No
6/28/2023 8:19	0	0.02	0.0235	No	0	No
6/28/2023 8:20	0	0.021	0.0232	No	0	No
6/28/2023 8:21	0	0.023	0.0231	No	0	No
6/28/2023 8:22	0	0.025	0.0229	No	0	No
6/28/2023 8:23	0	0.023	0.0227	No	0	No
6/28/2023 8:24	0	0.021	0.0226	No	0	No
6/28/2023 8:25	0	0.022	0.0226	No	0	No
6/28/2023 8:26	0	0.021	0.0225	No	0	No
6/28/2023 8:27	0	0.027	0.0227	No	0	No
6/28/2023 8:28	0	0.034	0.0229	No	0	No
6/28/2023 8:29	0	0.112	0.0289	No	0	No
6/28/2023 8:30	0	0.028	0.0293	No	0	No
6/28/2023 8:31	0	0.026	0.0296	No	0	No
6/28/2023 8:32	0	0.024	0.0299	No	0	No
6/28/2023 8:33	0	0.026	0.0302	No	0	No
6/28/2023 8:34	0	0.03	0.0309	No	0	No
6/28/2023 8:35	0	0.028	0.0313	No	0	No
6/28/2023 8:36	0	0.025	0.0315	No	0	No
6/28/2023 8:37	0	0.026	0.0315	No	0	No
6/28/2023 8:38	0	0.032	0.0321	No	0	No
6/28/2023 8:39	0	0.026	0.0325	No	0	No
6/28/2023 8:40	0	0.026	0.0327	No	0	No
6/28/2023 8:41	0	0.025	0.033	No	0	No
6/28/2023 8:42	0	0.024	0.0328	No	0	No
6/28/2023 8:43	0	0.025	0.0322	No	0	No
6/28/2023 8:44	0	0.027	0.0265	No	0	No
6/28/2023 8:45	0	0.028	0.0265	No	0	No
6/28/2023 8:46	0	0.028	0.0267	No	0	No
6/28/2023 8:47	0	0.028	0.0269	No	0	No
6/28/2023 8:48	0	0.03	0.0272	No	0	No
6/28/2023 8:49	0	0.028	0.0271	No	0	No
6/28/2023 8:50	0	0.028	0.0271	No	0	No
6/28/2023 8:51	0	0.027	0.0272	No	0	No
6/28/2023 8:52	0	0.031	0.0275	No	0	No
6/28/2023 8:53	0	0.033	0.0276	No	0	No
6/28/2023 8:54	0	0.029	0.0278	No	0	No
6/28/2023 8:55	0	0.031	0.0281	No	0	No
6/28/2023 8:56	0	0.035	0.0288	No	0	No
6/28/2023 8:57	0	0.028	0.0291	No	0	No
6/28/2023 8:58	0	0.029	0.0293	No	0	No
6/28/2023 8:59	0	0.027	0.0293	No	0	No
6/28/2023 9:00	0	0.027	0.0293	No	0	No
6/28/2023 9:01	0	0.028	0.0293	No	0	No

Upwind Station						
Time	Instaneous VOC (ppm)	Instaneous Mass Conc. Total (mg/m <sup>3</sup> )	Mass Conc. Total mg/m <sup>3</sup> AVG 15m (mg/m <sup>3</sup> )	Dust Exceedance	VOC ppm AVG 15m (ppm)	VOC Exceedance
6/28/2023 9:02	0	0.028	0.0293	No	0	No
6/28/2023 9:03	0	0.026	0.029	No	0	No
6/28/2023 9:04	0	0.027	0.0289	No	0	No
6/28/2023 9:05	0	0.026	0.0288	No	0	No
6/28/2023 9:06	0	0.027	0.0288	No	0	No
6/28/2023 9:07	0	0.028	0.0286	No	0	No
6/28/2023 9:08	0	0.029	0.0283	No	0	No
6/28/2023 9:09	0	0.028	0.0283	No	0	No
6/28/2023 9:10	0	0.028	0.0281	No	0	No
6/28/2023 9:11	0	0.028	0.0276	No	0	No
6/28/2023 9:12	0	0.03	0.0277	No	0	No
6/28/2023 9:13	0	0.03	0.0278	No	0	No
6/28/2023 9:14	0	0.029	0.0279	No	0	No
6/28/2023 9:15	0	0.03	0.0281	No	0	No
6/28/2023 9:16	0	0.033	0.0285	No	0	No
6/28/2023 9:17	0	0.028	0.0285	No	0	No
6/28/2023 9:18	0	0.027	0.0285	No	0	No
6/28/2023 9:19	0	0.03	0.0287	No	0	No
6/28/2023 9:20	0	0.028	0.0289	No	0	No
6/28/2023 9:21	0	0.029	0.029	No	0	No
6/28/2023 9:22	0	0.032	0.0293	No	0	No
6/28/2023 9:23	0	0.03	0.0293	No	0	No
6/28/2023 9:24	0	0.028	0.0293	No	0	No
6/28/2023 9:25	0	0.027	0.0293	No	0	No
6/28/2023 9:26	0	0.028	0.0293	No	0	No
6/28/2023 9:27	0	0.032	0.0294	No	0	No
6/28/2023 9:28	0	0.035	0.0297	No	0	No
6/28/2023 9:29	0	0.03	0.0298	No	0	No
6/28/2023 9:30	0	0.03	0.0298	No	0	No
6/28/2023 9:31	0	0.031	0.0297	No	0	No
6/28/2023 9:32	0	0.029	0.0297	No	0	No
6/28/2023 9:33	0	0.028	0.0298	No	0	No
6/28/2023 9:34	0	0.028	0.0297	No	0	No
6/28/2023 9:35	0	0.029	0.0297	No	0	No
6/28/2023 9:36	0	0.032	0.0299	No	0	No
6/28/2023 9:37	0	0.031	0.0299	No	0	No
6/28/2023 9:38	0	0.029	0.0298	No	0	No
6/28/2023 9:39	0	0.033	0.0301	No	0	No
6/28/2023 9:40	0	0.032	0.0305	No	0	No
6/28/2023 9:41	0	0.029	0.0305	No	0	No
6/28/2023 9:42	0	0.028	0.0303	No	0	No
6/28/2023 9:43	0	0.031	0.03	No	0	No
6/28/2023 9:44	0	0.032	0.0301	No	0	No
6/28/2023 9:45	0	0.03	0.0301	No	0	No
6/28/2023 9:46	0	0.028	0.0299	No	0	No
6/28/2023 9:47	0	0.027	0.0298	No	0	No
6/28/2023 9:48	0	0.028	0.0298	No	0	No
6/28/2023 9:49	0	0.032	0.0301	No	0	No
6/28/2023 9:50	0	0.03	0.0301	No	0	No
6/28/2023 9:51	0	0.038	0.0305	No	0	No
6/28/2023 9:52	0	0.035	0.0308	No	0	No
6/28/2023 9:53	0	0.037	0.0313	No	0	No

**Upwind Station**

Time	Instantaneous VOC (ppm)	Instantaneous Mass Conc. Total (mg/m <sup>3</sup> )	Mass Conc. Total mg/m <sup>3</sup> AVG 15m (mg/m <sup>3</sup> )	Dust Exceedance	VOC ppm AVG 15m (ppm)	VOC Exceedance
6/28/2023 9:54	0	0.031	0.0312	No	0	No
6/28/2023 9:55	0	0.031	0.0311	No	0	No
6/28/2023 9:56	0	0.027	0.031	No	0	No
6/28/2023 9:57	0	0.025	0.0308	No	0	No
6/28/2023 9:58	0	0.024	0.0303	No	0	No
6/28/2023 9:59	0	0.025	0.0299	No	0	No
6/28/2023 10:00	0	0.03	0.0299	No	0	No
6/28/2023 10:01	0	0.027	0.0298	No	0	No
6/28/2023 10:02	0	0.025	0.0297	No	0	No
6/28/2023 10:03	0	0.027	0.0296	No	0	No
6/28/2023 10:04	0	0.025	0.0291	No	0	No
6/28/2023 10:05	0	0.025	0.0288	No	0	No
6/28/2023 10:06	0	0.026	0.028	No	0	No
6/28/2023 10:07	0	0.027	0.0275	No	0	No
6/28/2023 10:08	0	0.028	0.0269	No	0	No
6/28/2023 10:09	0	0.023	0.0263	No	0	No
6/28/2023 10:10	0	0.023	0.0258	No	0	No
6/28/2023 10:11	0	0.022	0.0255	No	0	No
6/28/2023 10:12	0	0.024	0.0254	No	0	No
6/28/2023 10:13	0	0.023	0.0253	No	0	No
6/28/2023 10:14	0	0.025	0.0253	No	0	No
6/28/2023 10:15	0	0.024	0.0249	No	0	No
6/28/2023 10:16	0	0.02	0.0245	No	0	No
6/28/2023 10:17	0	0.022	0.0243	No	0	No
6/28/2023 10:18	0	0.023	0.024	No	0	No
6/28/2023 10:19	0	0.021	0.0237	No	0	No
6/28/2023 10:20	0	0.022	0.0235	No	0	No
6/28/2023 10:21	0	0.027	0.0236	No	0	No
6/28/2023 10:22	0	0.029	0.0237	No	0	No
6/28/2023 10:23	0	0.027	0.0237	No	0	No
6/28/2023 10:24	0	0.023	0.0237	No	0	No
6/28/2023 10:25	0	0.022	0.0236	No	0	No
6/28/2023 10:26	0	0.021	0.0235	No	0	No
6/28/2023 10:27	0	0.023	0.0235	No	0	No
6/28/2023 10:28	0	0.021	0.0233	No	0	No
6/28/2023 10:29	0	0.022	0.0231	No	0	No
6/28/2023 10:30	0	0.025	0.0232	No	0	No
6/28/2023 10:31	0	0.021	0.0233	No	0	No
6/28/2023 10:32	0	0.022	0.0233	No	0	No
6/28/2023 10:33	0	0.024	0.0233	No	0	No
6/28/2023 10:34	0	0.022	0.0234	No	0	No
6/28/2023 10:35	0	0.036	0.0243	No	0	No
6/28/2023 10:36	0	0.031	0.0246	No	0	No
6/28/2023 10:37	0	0.025	0.0243	No	0	No
6/28/2023 10:38	0	0.021	0.0239	No	0	No
6/28/2023 10:39	0	0.023	0.0239	No	0	No
6/28/2023 10:40	0	0.024	0.0241	No	0	No
6/28/2023 10:41	0	0.022	0.0241	No	0	No
6/28/2023 10:42	0	0.023	0.0241	No	0	No
6/28/2023 10:43	0	0.032	0.0249	No	0	No
6/28/2023 10:44	0	0.025	0.0251	No	0	No
6/28/2023 10:45	0	0.023	0.0249	No	0	No

**Upwind Station**

Time	Instantaneous VOC (ppm)	Instantaneous Mass Conc. Total (mg/m <sup>3</sup> )	Mass Conc. Total mg/m <sup>3</sup> AVG 15m (mg/m <sup>3</sup> )	Dust Exceedance	VOC ppm AVG 15m (ppm)	VOC Exceedance
6/28/2023 10:46	0	0.024	0.0251	No	0	No
6/28/2023 10:47	0	0.025	0.0253	No	0	No
6/28/2023 10:48	0	0.025	0.0254	No	0	No
6/28/2023 10:49	0	0.024	0.0255	No	0	No
6/28/2023 10:50	0	0.024	0.0247	No	0	No
6/28/2023 10:51	0	0.024	0.0243	No	0	No
6/28/2023 10:52	0	0.023	0.0241	No	0	No
6/28/2023 10:53	0	0.023	0.0243	No	0	No
6/28/2023 10:54	0	0.023	0.0243	No	0	No
6/28/2023 10:55	0	0.025	0.0243	No	0	No
6/28/2023 10:56	0	0.024	0.0245	No	0	No
6/28/2023 10:57	0	0.024	0.0245	No	0	No
6/28/2023 10:58	0	0.025	0.0241	No	0	No
6/28/2023 10:59	0	0.026	0.0241	No	0	No
6/28/2023 11:00	0	0.025	0.0243	No	0	No
6/28/2023 11:01	0	0.024	0.0243	No	0	No
6/28/2023 11:02	0	0.023	0.0241	No	0	No
6/28/2023 11:03	0	0.023	0.024	No	0	No
6/28/2023 11:04	0	0.024	0.024	No	0	No
6/28/2023 11:05	0	0.023	0.0239	No	0	No
6/28/2023 11:06	0	0.023	0.0239	No	0	No
6/28/2023 11:07	0	0.023	0.0239	No	0	No
6/28/2023 11:08	0	0.024	0.0239	No	0	No
6/28/2023 11:09	0	0.024	0.024	No	0	No
6/28/2023 11:10	0	0.024	0.0239	No	0	No
6/28/2023 11:11	0	0.025	0.024	No	0	No
6/28/2023 11:12	0	0.024	0.024	No	0	No
6/28/2023 11:13	0	0.024	0.0239	No	0	No
6/28/2023 11:14	0	0.027	0.024	No	0	No
6/28/2023 11:15	0	0.025	0.024	No	0	No
6/28/2023 11:16	0	0.026	0.0241	No	0	No
6/28/2023 11:17	0	0.027	0.0244	No	0	No
6/28/2023 11:18	0	0.026	0.0246	No	0	No
6/28/2023 11:19	0	0.025	0.0247	No	0	No
6/28/2023 11:20	0	0.024	0.0247	No	0	No
6/28/2023 11:21	0	0.025	0.0249	No	0	No
6/28/2023 11:22	0	0.026	0.0251	No	0	No
6/28/2023 11:23	0	0.026	0.0252	No	0	No
6/28/2023 11:24	0	0.025	0.0253	No	0	No
6/28/2023 11:25	0	0.025	0.0253	No	0	No
6/28/2023 11:26	0	0.026	0.0254	No	0	No
6/28/2023 11:27	0	0.029	0.0257	No	0	No
6/28/2023 11:28	0	0.028	0.026	No	0	No
6/28/2023 11:29	0	0.068	0.0287	No	0	No
6/28/2023 11:30	0	0.04	0.0297	No	0	No
6/28/2023 11:31	0	0.058	0.0319	No	0	No
6/28/2023 11:32	0	0.035	0.0324	No	0	No
6/28/2023 11:33	0	0.03	0.0327	No	0	No
6/28/2023 11:34	0	0.026	0.0327	No	0	No
6/28/2023 11:35	0	0.19	0.0438	No	0	No
6/28/2023 11:36	0	0.055	0.0458	No	0	No
6/28/2023 11:37	0	0.03	0.0461	No	0	No



**Upwind Station**

Time	Instantaneous VOC (ppm)	Instantaneous Mass Conc. Total (mg/m <sup>3</sup> )	Mass Conc. Total mg/m <sup>3</sup> AVG 15m (mg/m <sup>3</sup> )	Dust Exceedance	VOC ppm AVG 15m (ppm)	VOC Exceedance
6/28/2023 11:38	0	0.026	0.0461	No	0	No
6/28/2023 11:39	0	0.031	0.0465	No	0	No
6/28/2023 11:40	0	0.038	0.0473	No	0	No
6/28/2023 11:41	0	0.024	0.0472	No	0	No
6/28/2023 11:42	0	0.122	0.0534	No	0	No
6/28/2023 11:43	0	0.098	0.0581	No	0	No
6/28/2023 11:44	0	0.046	0.0566	No	0	No
6/28/2023 11:45	0	0.056	0.0577	No	0	No
6/28/2023 11:46	0	0.068	0.0583	No	0	No
6/28/2023 11:47	0	0.04	0.0587	No	0	No
6/28/2023 11:48	0	0.098	0.0632	No	0	No
6/28/2023 11:49	0	0.089	0.0674	No	0	No
6/28/2023 11:50	0	0.048	0.0579	No	0	No
6/28/2023 11:51	0	0.039	0.0569	No	0	No
6/28/2023 11:52	0	0.025	0.0565	No	0	No
6/28/2023 11:53	0	0.025	0.0565	No	0	No
6/28/2023 11:54	0	0.038	0.0569	No	0	No
6/28/2023 11:55	0	0.055	0.0581	No	0	No
6/28/2023 11:56	0	0.027	0.0583	No	0	No
6/28/2023 11:57	0	0.058	0.054	No	0	No
6/28/2023 11:58	0	0.124	0.0557	No	0	No
6/28/2023 11:59	0	0.039	0.0553	No	0	No
6/28/2023 12:00	0	0.042	0.0543	No	0	No
6/28/2023 12:01	0	0.052	0.0533	No	0	No
6/28/2023 12:02	0	0.048	0.0538	No	0	No
6/28/2023 12:03	0	0.095	0.0536	No	0	No
6/28/2023 12:04	0	0.041	0.0504	No	0	No
6/28/2023 12:05	0	0.026	0.0489	No	0	No
6/28/2023 12:06	0	0.027	0.0481	No	0	No
6/28/2023 12:07	0	0.035	0.0488	No	0	No
6/28/2023 12:08	0	0.051	0.0505	No	0	No
6/28/2023 12:09	0	0.025	0.0497	No	0	No
6/28/2023 12:10	0	0.026	0.0477	No	0	No
6/28/2023 12:11	0	0.028	0.0478	No	0	No
6/28/2023 12:12	0	0.187	0.0564	No	0	No
6/28/2023 12:13	0	0.036	0.0505	No	0	No
6/28/2023 12:14	0	0.145	0.0576	No	0	No
6/28/2023 12:15	0	0.189	0.0674	No	0	No
6/28/2023 12:16	0	0.046	0.067	No	0	No
6/28/2023 12:17	0	0.027	0.0656	No	0	No
6/28/2023 12:18	0	0.026	0.061	No	0	No
6/28/2023 12:19	0	0.026	0.06	No	0	No
6/28/2023 12:20	0	0.027	0.0601	No	0	No
6/28/2023 12:21	0	0.024	0.0599	No	0	No
6/28/2023 12:22	0	0.024	0.0591	No	0	No
6/28/2023 12:23	0	0.091	0.0618	No	0	No
6/28/2023 12:24	0	0.163	0.071	No	0	No
6/28/2023 12:25	0	0.041	0.072	No	0	No
6/28/2023 12:26	0	0.091	0.0762	No	0	No
6/28/2023 12:27	0	0.026	0.0655	No	0	No
6/28/2023 12:28	0	0.048	0.0663	No	0	No
6/28/2023 12:29	0	0.073	0.0615	No	0	No

**Upwind Station**

Time	Instantaneous VOC (ppm)	Instantaneous Mass Conc. Total (mg/m <sup>3</sup> )	Mass Conc. Total mg/m <sup>3</sup> AVG 15m (mg/m <sup>3</sup> )	Dust Exceedance	VOC ppm AVG 15m (ppm)	VOC Exceedance
6/28/2023 12:30	0	0.117	0.0567	No	0	No
6/28/2023 12:31	0	0.07	0.0583	No	0	No
6/28/2023 12:32	0	0.048	0.0597	No	0	No
6/28/2023 12:33	0	0.045	0.0609	No	0	No
6/28/2023 12:34	0	0.023	0.0607	No	0	No
6/28/2023 12:35	0	0.066	0.0633	No	0	No
6/28/2023 12:36	0	0.166	0.0728	No	0	No
6/28/2023 12:37	0	0.095	0.0775	No	0	No
6/28/2023 12:38	0	0.049	0.0747	No	0	No
6/28/2023 12:39	0	0.024	0.0655	No	0	No
6/28/2023 12:40	0	0.025	0.0644	No	0	No
6/28/2023 12:41	0	0.023	0.0599	No	0	No
6/28/2023 12:42	0	0.031	0.0602	No	0	No
6/28/2023 12:43	0	0.034	0.0593	No	0	No
6/28/2023 12:44	0	0.028	0.0563	No	0	No
6/28/2023 12:45	0	0.027	0.0503	No	0	No
6/28/2023 12:46	0	0.029	0.0475	No	0	No
6/28/2023 12:47	0	0.09	0.0503	No	0	No
6/28/2023 12:48	0	0.09	0.0533	No	0	No
6/28/2023 12:49	0	0.046	0.0549	No	0	No
6/28/2023 12:50	0	0.051	0.0539	No	0	No
6/28/2023 12:51	0	0.053	0.0463	No	0	No
6/28/2023 12:52	0	0.14	0.0493	No	0	No
6/28/2023 12:53	0	0.032	0.0482	No	0	No
6/28/2023 12:54	0	0.036	0.049	No	0	No
6/28/2023 12:55	0	0.023	0.0489	No	0	No
6/28/2023 12:56	0	0.031	0.0494	No	0	No
6/28/2023 12:57	0	0.083	0.0529	No	0	No
6/28/2023 12:58	0	0.038	0.0531	No	0	No
6/28/2023 12:59	0	0.021	0.0527	No	0	No
6/28/2023 13:00	0	0.023	0.0524	No	0	No
6/28/2023 13:01	0	0.022	0.0519	No	0	No
6/28/2023 13:02	0	0.02	0.0473	No	0	No
6/28/2023 13:03	0	0.02	0.0426	No	0	No
6/28/2023 13:04	0	0.02	0.0409	No	0	No
6/28/2023 13:05	0	0.021	0.0389	No	0	No
6/28/2023 13:06	0	0.02	0.0367	No	0	No
6/28/2023 13:07	0	0.02	0.0287	No	0	No
6/28/2023 13:08	0	0.02	0.0279	No	0	No
6/28/2023 13:09	0	0.02	0.0268	No	0	No
6/28/2023 13:10	0	0.02	0.0266	No	0	No
6/28/2023 13:11	0	0.02	0.0259	No	0	No
6/28/2023 13:12	0	0.02	0.0217	No	0	No
6/28/2023 13:13	0	0.02	0.0205	No	0	No
6/28/2023 13:14	0	0.021	0.0205	No	0	No
6/28/2023 13:15	0	0.021	0.0203	No	0	No
6/28/2023 13:16	0	0.021	0.0203	No	0	No
6/28/2023 13:17	0	0.021	0.0203	No	0	No
6/28/2023 13:18	0	0.023	0.0205	No	0	No
6/28/2023 13:19	0	0.023	0.0207	No	0	No
6/28/2023 13:20	0	0.022	0.0208	No	0	No
6/28/2023 13:21	0	0.022	0.0209	No	0	No

**Upwind Station**

Time	Instantaneous VOC (ppm)	Instantaneous Mass Conc. Total (mg/m <sup>3</sup> )	Mass Conc. Total mg/m <sup>3</sup> AVG 15m (mg/m <sup>3</sup> )	Dust Exceedance	VOC ppm AVG 15m (ppm)	VOC Exceedance
6/28/2023 13:22	0	0.022	0.0211	No	0	No
6/28/2023 13:23	0	0.022	0.0212	No	0	No
6/28/2023 13:24	0	0.022	0.0213	No	0	No
6/28/2023 13:25	0	0.022	0.0215	No	0	No
6/28/2023 13:26	0	0.022	0.0216	No	0	No
6/28/2023 13:27	0	0.02	0.0216	No	0	No
6/28/2023 13:28	0	0.02	0.0216	No	0	No
6/28/2023 13:29	0	0.022	0.0217	No	0	No
6/28/2023 13:30	0	0.022	0.0217	No	0	No
6/28/2023 13:31	0	0.023	0.0219	No	0	No
6/28/2023 13:32	0	0.023	0.022	No	0	No
6/28/2023 13:33	0	0.023	0.022	No	0	No
6/28/2023 13:34	0	0.022	0.0219	No	0	No
6/28/2023 13:35	0	0.023	0.022	No	0	No
6/28/2023 13:36	0	0.021	0.0219	No	0	No
6/28/2023 13:37	0	0.021	0.0219	No	0	No
6/28/2023 13:38	0	0.02	0.0217	No	0	No
6/28/2023 13:39	0	0.023	0.0218	No	0	No
6/28/2023 13:40	0	0.031	0.0224	No	0	No
6/28/2023 13:41	0	0.021	0.0223	No	0	No
6/28/2023 13:42	0	0.043	0.0239	No	0	No
6/28/2023 13:43	0	0.025	0.0242	No	0	No
6/28/2023 13:44	0	0.027	0.0245	No	0	No
6/28/2023 13:45	0	0.025	0.0247	No	0	No
6/28/2023 13:46	0	0.027	0.025	No	0	No
6/28/2023 13:47	0	0.026	0.0252	No	0	No
6/28/2023 13:48	0	0.029	0.0256	No	0	No
6/28/2023 13:49	0	0.089	0.0301	No	0	No
6/28/2023 13:50	0	0.093	0.0347	No	0	No
6/28/2023 13:51	0	0.166	0.0444	No	0	No
6/28/2023 13:52	0	0.078	0.0482	No	0	No
6/28/2023 13:53	0	0.126	0.0553	No	0	No
6/28/2023 13:54	0	0.057	0.0575	No	0	No
6/28/2023 13:55	0	0.04	0.0581	No	0	No
6/28/2023 13:56	0	0.043	0.0596	No	0	No
6/28/2023 13:57	0	0.027	0.0585	No	0	No
6/28/2023 13:58	0	0.039	0.0595	No	0	No
6/28/2023 13:59	0	0.044	0.0606	No	0	No
6/28/2023 14:00	0	0.035	0.0613	No	0	No
6/28/2023 14:01	0	0.057	0.0633	No	0	No
6/28/2023 14:02	0	0.09	0.0675	No	0	No
6/28/2023 14:03	0	0.089	0.0715	No	0	No
6/28/2023 14:04	0	0.061	0.0697	No	0	No
6/28/2023 14:05	0	0.101	0.0702	No	0	No
6/28/2023 14:06	0	0.11	0.0665	No	0	No
6/28/2023 14:07	0	0.04	0.0639	No	0	No
6/28/2023 14:08	0	0.031	0.0576	No	0	No

Downwind Station						
Time	Instantaneous VOC (ppm)	Instantaneous Mass Conc. Total (mg/m <sup>3</sup> )	Mass Conc. Total mg/m <sup>3</sup> AVG 15m (mg/m <sup>3</sup> )	Dust Exceedance	VOC ppm AVG 15m (ppm)	VOC Exceedance
6/28/2023 7:19	0	0.047	0.047	No	0	No
6/28/2023 7:20	0	0.044	0.0455	No	0	No
6/28/2023 7:21	0	0.041	0.044	No	0	No
6/28/2023 7:22	0	0.04	0.043	No	0	No
6/28/2023 7:23	0	0.044	0.0432	No	0	No
6/28/2023 7:24	0	0.045	0.0435	No	0	No
6/28/2023 7:25	0	0.045	0.0437	No	0	No
6/28/2023 7:26	0	0.046	0.044	No	0	No
6/28/2023 7:27	0	0.043	0.0439	No	0	No
6/28/2023 7:28	0	0.046	0.0441	No	0	No
6/28/2023 7:29	0	0.047	0.0444	No	0	No
6/28/2023 7:30	0	0.048	0.0447	No	0	No
6/28/2023 7:31	0	0.049	0.045	No	0	No
6/28/2023 7:32	0	0.047	0.0451	No	0	No
6/28/2023 7:33	0	0.048	0.0453	No	0	No
6/28/2023 7:34	0	0.048	0.0454	No	0	No
6/28/2023 7:35	0	0.044	0.0454	No	0	No
6/28/2023 7:36	0	0.042	0.0455	No	0	No
6/28/2023 7:37	0	0.041	0.0455	No	0	No
6/28/2023 7:38	0	0.044	0.0455	No	0	No
6/28/2023 7:39	0	0.041	0.0453	No	0	No
6/28/2023 7:40	0	0.04	0.0449	No	0	No
6/28/2023 7:41	0	0.033	0.0441	No	0	No
6/28/2023 7:42	0	0.03	0.0432	No	0	No
6/28/2023 7:43	0	0.031	0.0422	No	0	No
6/28/2023 7:44	0	0.031	0.0411	No	0	No
6/28/2023 7:45	0	0.032	0.0401	No	0	No
6/28/2023 7:46	0	0.03	0.0388	No	0	No
6/28/2023 7:47	0	0.029	0.0376	No	0	No
6/28/2023 7:48	0	0.027	0.0362	No	0	No
6/28/2023 7:49	0	0.024	0.0346	No	0	No
6/28/2023 7:50	0	0.03	0.0337	No	0	No
6/28/2023 7:51	0	0.027	0.0327	No	0	No
6/28/2023 7:52	0	0.024	0.0315	No	0	No
6/28/2023 7:53	0	0.024	0.0302	No	0	No
6/28/2023 7:54	0	0.017	0.0286	No	0	No
6/28/2023 7:55	0	0.015	0.0269	No	0	No
6/28/2023 7:56	0	0.015	0.0257	No	0	No
6/28/2023 7:57	0	0.02	0.0251	No	0	No
6/28/2023 7:58	0	0.021	0.0244	No	0	No
6/28/2023 7:59	0	0.023	0.0239	No	0	No
6/28/2023 8:00	0	0.024	0.0233	No	0	No
6/28/2023 8:01	0	0.021	0.0227	No	0	No
6/28/2023 8:02	0	0.022	0.0223	No	0	No
6/28/2023 8:03	0	0.017	0.0216	No	0	No
6/28/2023 8:04	0	0.017	0.0211	No	0	No
6/28/2023 8:05	0	0.017	0.0203	No	0	No
6/28/2023 8:06	0	0.016	0.0195	No	0	No
6/28/2023 8:07	0	0.019	0.0192	No	0	No
6/28/2023 8:08	0	0.018	0.0188	No	0	No
6/28/2023 8:09	0	0.015	0.0187	No	0	No
6/28/2023 8:10	0	0.015	0.0187	No	0	No
6/28/2023 8:11	0	0.015	0.0187	No	0	No
6/28/2023 8:12	0	0.022	0.0188	No	0	No
6/28/2023 8:13	0	0.021	0.0188	No	0	No

Downwind Station						
Time	Instantaneous VOC (ppm)	Instantaneous Mass Conc. Total (mg/m <sup>3</sup> )	Mass Conc. Total mg/m <sup>3</sup> AVG 15m (mg/m <sup>3</sup> )	Dust Exceedance	VOC ppm AVG 15m (ppm)	VOC Exceedance
6/28/2023 8:14	0	0.017	0.0184	No	0	No
6/28/2023 8:15	0	0.016	0.0179	No	0	No
6/28/2023 8:16	0	0.015	0.0175	No	0	No
6/28/2023 8:17	0	0.014	0.0169	No	0	No
6/28/2023 8:18	0	0.016	0.0169	No	0	No
6/28/2023 8:19	0	0.013	0.0166	No	0	No
6/28/2023 8:20	0	0.015	0.0165	No	0	No
6/28/2023 8:21	0	0.016	0.0165	No	0	No
6/28/2023 8:22	0	0.017	0.0163	No	0	No
6/28/2023 8:23	0	0.015	0.0161	No	0	No
6/28/2023 8:24	0	0.017	0.0163	No	0	No
6/28/2023 8:25	0	0.016	0.0163	No	0	No
6/28/2023 8:26	0	0.015	0.0163	No	0	No
6/28/2023 8:27	0	0.014	0.0158	No	0	No
6/28/2023 8:28	0	0.015	0.0154	No	0	No
6/28/2023 8:29	0	0.069	0.0189	No	0	No
6/28/2023 8:30	0	0.026	0.0195	No	0	No
6/28/2023 8:31	0	0.018	0.0197	No	0	No
6/28/2023 8:32	0	0.017	0.0199	No	0	No
6/28/2023 8:33	0	0.023	0.0204	No	0	No
6/28/2023 8:34	0	0.024	0.0211	No	0	No
6/28/2023 8:35	0	0.019	0.0214	No	0	No
6/28/2023 8:36	0	0.017	0.0215	No	0	No
6/28/2023 8:37	0	0.022	0.0218	No	0	No
6/28/2023 8:38	0	0.027	0.0226	No	0	No
6/28/2023 8:39	0	0.02	0.0228	No	0	No
6/28/2023 8:40	0	0.021	0.0231	No	0	No
6/28/2023 8:41	0	0.019	0.0234	No	0	No
6/28/2023 8:42	0	0.02	0.0238	No	0	No
6/28/2023 8:43	0	0.022	0.0243	No	0	No
6/28/2023 8:44	0	0.023	0.0212	No	0	No
6/28/2023 8:45	0	0.022	0.0209	No	0	No
6/28/2023 8:46	0	0.026	0.0215	No	0	No
6/28/2023 8:47	0	0.022	0.0218	No	0	No
6/28/2023 8:48	0	0.021	0.0217	No	0	No
6/28/2023 8:49	0	0.024	0.0217	No	0	No
6/28/2023 8:50	0	0.026	0.0221	No	0	No
6/28/2023 8:51	0	0.022	0.0225	No	0	No
6/28/2023 8:52	0	0.024	0.0226	No	0	No
6/28/2023 8:53	0	0.026	0.0225	No	0	No
6/28/2023 8:54	0	0.024	0.0228	No	0	No
6/28/2023 8:55	0	0.025	0.0231	No	0	No
6/28/2023 8:56	0	0.027	0.0236	No	0	No
6/28/2023 8:57	0	0.025	0.0239	No	0	No
6/28/2023 8:58	0	0.024	0.0241	No	0	No
6/28/2023 8:59	0	0.024	0.0241	No	0	No
6/28/2023 9:00	0	0.024	0.0243	No	0	No
6/28/2023 9:01	0	0.023	0.0241	No	0	No
6/28/2023 9:02	0	0.023	0.0241	No	0	No
6/28/2023 9:03	0	0.022	0.0242	No	0	No
6/28/2023 9:04	0	0.023	0.0241	No	0	No
6/28/2023 9:05	0	0.023	0.0239	No	0	No
6/28/2023 9:06	0	0.023	0.024	No	0	No
6/28/2023 9:07	0	0.025	0.0241	No	0	No
6/28/2023 9:08	0	0.026	0.0241	No	0	No

Downwind Station						
Time	Instantaneous VOC (ppm)	Instantaneous Mass Conc. Total (mg/m <sup>3</sup> )	Mass Conc. Total mg/m <sup>3</sup> AVG 15m (mg/m <sup>3</sup> )	Dust Exceedance	VOC ppm AVG 15m (ppm)	VOC Exceedance
6/28/2023 9:09	0	0.025	0.0241	No	0	No
6/28/2023 9:10	0	0.025	0.0241	No	0	No
6/28/2023 9:11	0	0.025	0.024	No	0	No
6/28/2023 9:12	0	0.026	0.0241	No	0	No
6/28/2023 9:13	0	0.026	0.0242	No	0	No
6/28/2023 9:14	0	0.026	0.0243	No	0	No
6/28/2023 9:15	0	0.029	0.0247	No	0	No
6/28/2023 9:16	0	0.03	0.0251	No	0	No
6/28/2023 9:17	0	0.026	0.0253	No	0	No
6/28/2023 9:18	0	0.024	0.0255	No	0	No
6/28/2023 9:19	0	0.026	0.0257	No	0	No
6/28/2023 9:20	0	0.027	0.0259	No	0	No
6/28/2023 9:21	0	0.027	0.0262	No	0	No
6/28/2023 9:22	0	0.027	0.0263	No	0	No
6/28/2023 9:23	0	0.032	0.0267	No	0	No
6/28/2023 9:24	0	0.03	0.0271	No	0	No
6/28/2023 9:25	0	0.028	0.0273	No	0	No
6/28/2023 9:26	0	0.026	0.0273	No	0	No
6/28/2023 9:27	0	0.026	0.0273	No	0	No
6/28/2023 9:28	0	0.027	0.0274	No	0	No
6/28/2023 9:29	0	0.028	0.0275	No	0	No
6/28/2023 9:30	0	0.027	0.0274	No	0	No
6/28/2023 9:31	0	0.027	0.0272	No	0	No
6/28/2023 9:32	0	0.027	0.0273	No	0	No
6/28/2023 9:33	0	0.025	0.0273	No	0	No
6/28/2023 9:34	0	0.026	0.0273	No	0	No
6/28/2023 9:35	0	0.028	0.0274	No	0	No
6/28/2023 9:36	0	0.028	0.0275	No	0	No
6/28/2023 9:37	0	0.027	0.0275	No	0	No
6/28/2023 9:38	0	0.027	0.0271	No	0	No
6/28/2023 9:39	0	0.029	0.0271	No	0	No
6/28/2023 9:40	0	0.032	0.0273	No	0	No
6/28/2023 9:41	0	0.027	0.0274	No	0	No
6/28/2023 9:42	0	0.025	0.0273	No	0	No
6/28/2023 9:43	0	0.027	0.0273	No	0	No
6/28/2023 9:44	0	0.028	0.0273	No	0	No
6/28/2023 9:45	0	0.028	0.0274	No	0	No
6/28/2023 9:46	0	0.026	0.0273	No	0	No
6/28/2023 9:47	0	0.025	0.0272	No	0	No
6/28/2023 9:48	0	0.026	0.0273	No	0	No
6/28/2023 9:49	0	0.028	0.0274	No	0	No
6/28/2023 9:50	0	0.029	0.0275	No	0	No
6/28/2023 9:51	0	0.029	0.0275	No	0	No
6/28/2023 9:52	0	0.031	0.0278	No	0	No
6/28/2023 9:53	0	0.031	0.0281	No	0	No
6/28/2023 9:54	0	0.029	0.0281	No	0	No
6/28/2023 9:55	0	0.026	0.0277	No	0	No
6/28/2023 9:56	0	0.026	0.0276	No	0	No
6/28/2023 9:57	0	0.022	0.0274	No	0	No
6/28/2023 9:58	0	0.023	0.0271	No	0	No
6/28/2023 9:59	0	0.024	0.0269	No	0	No
6/28/2023 10:00	0	0.026	0.0267	No	0	No
6/28/2023 10:01	0	0.023	0.0265	No	0	No
6/28/2023 10:02	0	0.026	0.0266	No	0	No
6/28/2023 10:03	0	0.025	0.0265	No	0	No

Downwind Station						
Time	Instantaneous VOC (ppm)	Instantaneous Mass Conc. Total (mg/m <sup>3</sup> )	Mass Conc. Total mg/m <sup>3</sup> AVG 15m (mg/m <sup>3</sup> )	Dust Exceedance	VOC ppm AVG 15m (ppm)	VOC Exceedance
6/28/2023 10:04	0	0.024	0.0263	No	0	No
6/28/2023 10:05	0	0.025	0.026	No	0	No
6/28/2023 10:06	0	0.026	0.0258	No	0	No
6/28/2023 10:07	0	0.028	0.0256	No	0	No
6/28/2023 10:08	0	0.038	0.0261	No	0	No
6/28/2023 10:09	0	0.023	0.0257	No	0	No
6/28/2023 10:10	0	0.022	0.0254	No	0	No
6/28/2023 10:11	0	0.024	0.0253	No	0	No
6/28/2023 10:12	0	0.023	0.0253	No	0	No
6/28/2023 10:13	0	0.024	0.0254	No	0	No
6/28/2023 10:14	0	0.024	0.0254	No	0	No
6/28/2023 10:15	0	0.023	0.0252	No	0	No
6/28/2023 10:16	0	0.022	0.0251	No	0	No
6/28/2023 10:17	0	0.02	0.0247	No	0	No
6/28/2023 10:18	0	0.024	0.0247	No	0	No
6/28/2023 10:19	0	0.023	0.0246	No	0	No
6/28/2023 10:20	0	0.024	0.0245	No	0	No
6/28/2023 10:21	0	0.025	0.0245	No	0	No
6/28/2023 10:22	0	0.026	0.0243	No	0	No
6/28/2023 10:23	0	0.022	0.0233	No	0	No
6/28/2023 10:24	0	0.023	0.0233	No	0	No
6/28/2023 10:25	0	0.023	0.0233	No	0	No
6/28/2023 10:26	0	0.022	0.0232	No	0	No
6/28/2023 10:27	0	0.024	0.0233	No	0	No
6/28/2023 10:28	0	0.021	0.0231	No	0	No
6/28/2023 10:29	0	0.025	0.0231	No	0	No
6/28/2023 10:30	0	0.024	0.0232	No	0	No
6/28/2023 10:31	0	0.022	0.0232	No	0	No
6/28/2023 10:32	0	0.023	0.0234	No	0	No
6/28/2023 10:33	0	0.022	0.0233	No	0	No
6/28/2023 10:34	0	0.024	0.0233	No	0	No
6/28/2023 10:35	0	0.044	0.0247	No	0	No
6/28/2023 10:36	0	0.031	0.0251	No	0	No
6/28/2023 10:37	0	0.023	0.0249	No	0	No
6/28/2023 10:38	0	0.022	0.0249	No	0	No
6/28/2023 10:39	0	0.023	0.0249	No	0	No
6/28/2023 10:40	0	0.024	0.0249	No	0	No
6/28/2023 10:41	0	0.024	0.0251	No	0	No
6/28/2023 10:42	0	0.024	0.0251	No	0	No
6/28/2023 10:43	0	0.026	0.0254	No	0	No
6/28/2023 10:44	0	0.025	0.0254	No	0	No
6/28/2023 10:45	0	0.024	0.0254	No	0	No
6/28/2023 10:46	0	0.024	0.0255	No	0	No
6/28/2023 10:47	0	0.025	0.0257	No	0	No
6/28/2023 10:48	0	0.025	0.0259	No	0	No

Downwind Station						
Time	Instantaneous VOC (ppm)	Instantaneous Mass Conc. Total (mg/m <sup>3</sup> )	Mass Conc. Total mg/m <sup>3</sup> AVG 15m (mg/m <sup>3</sup> )	Dust Exceedance	VOC ppm AVG 15m (ppm)	VOC Exceedance
6/28/2023 10:49	0	0.025	0.0259	No	0	No
6/28/2023 10:50	0	0.025	0.0247	No	0	No
6/28/2023 10:51	0	0.026	0.0243	No	0	No
6/28/2023 10:52	0	0.025	0.0245	No	0	No
6/28/2023 10:53	0	0.024	0.0246	No	0	No
6/28/2023 10:54	0	0.025	0.0247	No	0	No
6/28/2023 10:55	0	0.027	0.0249	No	0	No
6/28/2023 10:56	0	0.025	0.025	No	0	No
6/28/2023 10:57	0	0.024	0.025	No	0	No
6/28/2023 10:58	0	0.026	0.025	No	0	No
6/28/2023 10:59	0	0.028	0.0252	No	0	No
6/28/2023 11:00	0	0.028	0.0255	No	0	No
6/28/2023 11:01	0	0.025	0.0255	No	0	No
6/28/2023 11:02	0	0.024	0.0255	No	0	No
6/28/2023 11:03	0	0.025	0.0255	No	0	No
6/28/2023 11:04	0	0.028	0.0257	No	0	No
6/28/2023 11:05	0	0.025	0.0257	No	0	No
6/28/2023 11:06	0	0.023	0.0255	No	0	No
6/28/2023 11:07	0	0.025	0.0255	No	0	No
6/28/2023 11:08	0	0.025	0.0255	No	0	No
6/28/2023 11:09	0	0.027	0.0257	No	0	No
6/28/2023 11:10	0	0.026	0.0256	No	0	No
6/28/2023 11:11	0	0.026	0.0257	No	0	No
6/28/2023 11:12	0	0.026	0.0258	No	0	No
6/28/2023 11:13	0	0.025	0.0257	No	0	No
6/28/2023 11:14	0	0.028	0.0257	No	0	No
6/28/2023 11:15	0	0.027	0.0257	No	0	No
6/28/2023 11:16	0	0.028	0.0259	No	0	No
6/28/2023 11:17	0	0.029	0.0262	No	0	No
6/28/2023 11:18	0	0.03	0.0265	No	0	No
6/28/2023 11:19	0	0.027	0.0265	No	0	No
6/28/2023 11:20	0	0.026	0.0265	No	0	No
6/28/2023 11:21	0	0.028	0.0269	No	0	No
6/28/2023 11:22	0	0.028	0.0271	No	0	No
6/28/2023 11:23	0	0.029	0.0273	No	0	No
6/28/2023 11:24	0	0.028	0.0274	No	0	No
6/28/2023 11:25	0	0.026	0.0274	No	0	No
6/28/2023 11:26	0	0.028	0.0275	No	0	No
6/28/2023 11:27	0	0.03	0.0278	No	0	No
6/28/2023 11:28	0	0.028	0.028	No	0	No
6/28/2023 11:29	0	0.045	0.0291	No	0	No
6/28/2023 11:30	0	0.036	0.0297	No	0	No
6/28/2023 11:31	0	0.069	0.0325	No	0	No
6/28/2023 11:32	0	0.034	0.0328	No	0	No
6/28/2023 11:33	0	0.032	0.0329	No	0	No
6/28/2023 11:34	0	0.029	0.0331	No	0	No
6/28/2023 11:35	0	0.066	0.0357	No	0	No
6/28/2023 11:36	0	0.06	0.0379	No	0	No
6/28/2023 11:37	0	0.032	0.0381	No	0	No
6/28/2023 11:38	0	0.03	0.0382	No	0	No
6/28/2023 11:39	0	0.034	0.0386	No	0	No
6/28/2023 11:40	0	0.034	0.0391	No	0	No
6/28/2023 11:41	0	0.028	0.0391	No	0	No
6/28/2023 11:42	0	0.062	0.0413	No	0	No
6/28/2023 11:43	0	0.076	0.0445	No	0	No



Downwind Station						
Time	Instantaneous VOC (ppm)	Instantaneous Mass Conc. Total (mg/m <sup>3</sup> )	Mass Conc. Total mg/m <sup>3</sup> AVG 15m (mg/m <sup>3</sup> )	Dust Exceedance	VOC ppm AVG 15m (ppm)	VOC Exceedance
6/28/2023 11:44	0	0.03	0.0435	No	0	No
6/28/2023 11:45	0	0.046	0.0441	No	0	No
6/28/2023 11:46	0	0.051	0.0429	No	0	No
6/28/2023 11:47	0	0.037	0.0431	No	0	No
6/28/2023 11:48	0	0.044	0.0439	No	0	No
6/28/2023 11:49	0	0.057	0.0458	No	0	No
6/28/2023 11:50	0	0.041	0.0441	No	0	No
6/28/2023 11:51	0	0.041	0.0429	No	0	No
6/28/2023 11:52	0	0.029	0.0427	No	0	No
6/28/2023 11:53	0	0.028	0.0425	No	0	No
6/28/2023 11:54	0	0.029	0.0422	No	0	No
6/28/2023 11:55	0	0.037	0.0424	No	0	No
6/28/2023 11:56	0	0.029	0.0425	No	0	No
6/28/2023 11:57	0	0.035	0.0407	No	0	No
6/28/2023 11:58	0	0.036	0.038	No	0	No
6/28/2023 11:59	0	0.034	0.0383	No	0	No
6/28/2023 12:00	0	0.032	0.0373	No	0	No
6/28/2023 12:01	0	0.062	0.0381	No	0	No
6/28/2023 12:02	0	0.051	0.039	No	0	No
6/28/2023 12:03	0	0.048	0.0393	No	0	No
6/28/2023 12:04	0	0.034	0.0377	No	0	No
6/28/2023 12:05	0	0.033	0.0372	No	0	No
6/28/2023 12:06	0	0.032	0.0366	No	0	No
6/28/2023 12:07	0	0.036	0.0371	No	0	No
6/28/2023 12:08	0	0.035	0.0375	No	0	No
6/28/2023 12:09	0	0.029	0.0375	No	0	No
6/28/2023 12:10	0	0.03	0.0371	No	0	No
6/28/2023 12:11	0	0.028	0.037	No	0	No
6/28/2023 12:12	0	0.054	0.0383	No	0	No
6/28/2023 12:13	0	0.034	0.0381	No	0	No
6/28/2023 12:14	0	0.047	0.039	No	0	No
6/28/2023 12:15	0	0.054	0.0405	No	0	No
6/28/2023 12:16	0	0.037	0.0388	No	0	No
6/28/2023 12:17	0	0.027	0.0372	No	0	No
6/28/2023 12:18	0	0.029	0.0359	No	0	No
6/28/2023 12:19	0	0.029	0.0356	No	0	No
6/28/2023 12:20	0	0.03	0.0354	No	0	No
6/28/2023 12:21	0	0.03	0.0353	No	0	No
6/28/2023 12:22	0	0.028	0.0347	No	0	No
6/28/2023 12:23	0	0.029	0.0343	No	0	No
6/28/2023 12:24	0	0.032	0.0345	No	0	No
6/28/2023 12:25	0	0.035	0.0349	No	0	No
6/28/2023 12:26	0	0.033	0.0352	No	0	No
6/28/2023 12:27	0	0.03	0.0336	No	0	No
6/28/2023 12:28	0	0.036	0.0337	No	0	No
6/28/2023 12:29	0	0.066	0.035	No	0	No
6/28/2023 12:30	0	0.083	0.0369	No	0	No
6/28/2023 12:31	0	0.047	0.0376	No	0	No
6/28/2023 12:32	0	0.038	0.0383	No	0	No
6/28/2023 12:33	0	0.032	0.0385	No	0	No
6/28/2023 12:34	0	0.03	0.0386	No	0	No
6/28/2023 12:35	0	0.029	0.0385	No	0	No
6/28/2023 12:36	0	0.04	0.0392	No	0	No
6/28/2023 12:37	0	0.077	0.0425	No	0	No
6/28/2023 12:38	0	0.039	0.0431	No	0	No

Downwind Station						
Time	Instaneous VOC (ppm)	Instaneous Mass Conc. Total (mg/m <sup>3</sup> )	Mass Conc. Total mg/m <sup>3</sup> AVG 15m (mg/m <sup>3</sup> )	Dust Exceedance	VOC ppm AVG 15m (ppm)	VOC Exceedance
6/28/2023 12:39	0	0.034	0.0433	No	0	No
6/28/2023 12:40	0	0.032	0.0431	No	0	No
6/28/2023 12:41	0	0.027	0.0427	No	0	No
6/28/2023 12:42	0	0.029	0.0426	No	0	No
6/28/2023 12:43	0	0.034	0.0425	No	0	No
6/28/2023 12:44	0	0.035	0.0404	No	0	No
6/28/2023 12:45	0	0.032	0.037	No	0	No
6/28/2023 12:46	0	0.037	0.0363	No	0	No
6/28/2023 12:47	0	0.037	0.0363	No	0	No
6/28/2023 12:48	0	0.065	0.0385	No	0	No
6/28/2023 12:49	0	0.034	0.0387	No	0	No
6/28/2023 12:50	0	0.035	0.0391	No	0	No
6/28/2023 12:51	0	0.033	0.0387	No	0	No
6/28/2023 12:52	0	0.043	0.0364	No	0	No
6/28/2023 12:53	0	0.033	0.036	No	0	No
6/28/2023 12:54	0	0.03	0.0357	No	0	No
6/28/2023 12:55	0	0.027	0.0354	No	0	No
6/28/2023 12:56	0	0.031	0.0357	No	0	No
6/28/2023 12:57	0	0.03	0.0357	No	0	No
6/28/2023 12:58	0	0.03	0.0355	No	0	No
6/28/2023 12:59	0	0.027	0.0349	No	0	No
6/28/2023 13:00	0	0.029	0.0347	No	0	No
6/28/2023 13:01	0	0.029	0.0342	No	0	No
6/28/2023 13:02	0	0.028	0.0336	No	0	No
6/28/2023 13:03	0	0.027	0.0311	No	0	No
6/28/2023 13:04	0	0.025	0.0305	No	0	No
6/28/2023 13:05	0	0.027	0.0299	No	0	No
6/28/2023 13:06	0	0.027	0.0295	No	0	No
6/28/2023 13:07	0	0.029	0.0286	No	0	No
6/28/2023 13:08	0	0.027	0.0282	No	0	No
6/28/2023 13:09	0	0.027	0.028	No	0	No
6/28/2023 13:10	0	0.027	0.028	No	0	No
6/28/2023 13:11	0	0.028	0.0278	No	0	No
6/28/2023 13:12	0	0.028	0.0277	No	0	No
6/28/2023 13:13	0	0.027	0.0275	No	0	No
6/28/2023 13:14	0	0.029	0.0276	No	0	No
6/28/2023 13:15	0	0.028	0.0275	No	0	No
6/28/2023 13:16	0	0.029	0.0275	No	0	No
6/28/2023 13:17	0	0.03	0.0277	No	0	No
6/28/2023 13:18	0	0.038	0.0284	No	0	No
6/28/2023 13:19	0	0.031	0.0288	No	0	No
6/28/2023 13:20	0	0.03	0.029	No	0	No
6/28/2023 13:21	0	0.029	0.0291	No	0	No
6/28/2023 13:22	0	0.03	0.0292	No	0	No
6/28/2023 13:23	0	0.03	0.0294	No	0	No
6/28/2023 13:24	0	0.03	0.0296	No	0	No
6/28/2023 13:25	0	0.031	0.0299	No	0	No
6/28/2023 13:26	0	0.03	0.03	No	0	No
6/28/2023 13:27	0	0.028	0.03	No	0	No
6/28/2023 13:28	0	0.029	0.0301	No	0	No
6/28/2023 13:29	0	0.03	0.0302	No	0	No
6/28/2023 13:30	0	0.031	0.0304	No	0	No
6/28/2023 13:31	0	0.032	0.0306	No	0	No
6/28/2023 13:32	0	0.032	0.0307	No	0	No
6/28/2023 13:33	0	0.033	0.0304	No	0	No

**Downwind Station**

Time	Instantaneous VOC (ppm)	Instantaneous Mass Conc. Total (mg/m <sup>3</sup> )	Mass Conc. Total mg/m <sup>3</sup> AVG 15m (mg/m <sup>3</sup> )	Dust Exceedance	VOC ppm AVG 15m (ppm)	VOC Exceedance
6/28/2023 13:34	0	0.031	0.0304	No	0	No
6/28/2023 13:35	0	0.031	0.0305	No	0	No
6/28/2023 13:36	0	0.031	0.0306	No	0	No
6/28/2023 13:37	0	0.03	0.0306	No	0	No
6/28/2023 13:38	0	0.031	0.0307	No	0	No
6/28/2023 13:39	0	0.032	0.0308	No	0	No
6/28/2023 13:40	0	0.032	0.0309	No	0	No
6/28/2023 13:41	0	0.032	0.031	No	0	No
6/28/2023 13:42	0	0.046	0.0322	No	0	No
6/28/2023 13:43	0	0.035	0.0326	No	0	No
6/28/2023 13:44	0	0.031	0.0327	No	0	No
6/28/2023 13:45	0	0.035	0.0329	No	0	No
6/28/2023 13:46	0	0.036	0.0332	No	0	No
6/28/2023 13:47	0	0.035	0.0334	No	0	No
6/28/2023 13:48	0	0.036	0.0336	No	0	No
6/28/2023 13:49	0	0.055	0.0352	No	0	No
6/28/2023 13:50	0	0.058	0.037	No	0	No
6/28/2023 13:51	0	0.088	0.0408	No	0	No
6/28/2023 13:52	0	0.049	0.0421	No	0	No
6/28/2023 13:53	0	0.054	0.0436	No	0	No
6/28/2023 13:54	0	0.044	0.0444	No	0	No
6/28/2023 13:55	0	0.039	0.0449	No	0	No
6/28/2023 13:56	0	0.039	0.0453	No	0	No
6/28/2023 13:57	0	0.035	0.0446	No	0	No
6/28/2023 13:58	0	0.041	0.045	No	0	No
6/28/2023 13:59	0	0.037	0.0454	No	0	No
6/28/2023 14:00	0	0.039	0.0457	No	0	No
6/28/2023 14:01	0	0.036	0.0457	No	0	No
6/28/2023 14:02	0	0.038	0.0459	No	0	No
6/28/2023 14:03	0	0.078	0.0487	No	0	No
6/28/2023 14:04	0	0.045	0.048	No	0	No
6/28/2023 14:05	0	0.061	0.0482	No	0	No
6/28/2023 14:06	0	0.039	0.0449	No	0	No
6/28/2023 14:07	0	0.046	0.0447	No	0	No