



## Daily Activity Report

Seton Brilla Charter School  
1956 Jerome Avenue, Bronx, NY  
BCP No. C203152

### General Site Information

Date:	Wednesday, June 14, 2023
Weather:	Sunny, Rain 59-78°
Wind Direction/Speed:	N @ 4 mph
AKRF Personnel on Site:	J. Kelleher-Ferguson
AKRF Equipment on Site:	Mini RAE 3000 Photoionization Detector [(PID) x1], Roving SidePak Particulate Monitor (1), 2 Fixed Air Monitoring Stations [DustTrak Aerosol Monitors (x2) & MiniRAE 3000 PIDs (x2)].
Visitors:	None

### Contractor Information

Contracting Company	Main Personnel	Equipment
Casino Construction	Carlos	Excavator and a mini-excavator

### Description and Location of Work Activities Performed

- 1) Concrete poured in grid WC-04.  
2.) Minor excavations in grids WC-01 and WC-02.

Destination Facility	Daily Trucks	Total Trucks	Daily Approx. Cubic Yds	Total Approx. Cubic Yds	Total Site Loads	Total Approximate Cubic Yards
Clean Earth Carteret	0	108	0	2,160	206	4,120
Clean Earth Southeastern Pennsylvania	0	67	0	1,340		
Clean Earth Bethlehem	0	31	0	620		
Concrete Disposal	0	27	0	540		
N/A	0	0	0	0		

### CAMP Air Monitoring Results

CAMP Station	UPWIND			DOWNWIND		
Odors:	None			None		
VOC Action Level Exceedance(s):	None.			None		
Particulate Action Level Exceedance(s):	None.			None		
Maximum VOC Level (15 min ppm):	0.011			0.12		
Maximum Particulate Level (15 min mg/m <sup>3</sup> ):	0.100			0.063		

Notes: CAMP monitoring was performed throughout the day, and no particulate or VOC exceedances were recorded. CAMP monitoring was suspended at approximately 1300 due to heavy precipitation in the afternoon.

### Additional Information

Planned Work Activity for Following Day/Week:	1) Continued installation of rebar in WC-02, WC-03, WC-04. 2) Waterproofing over rebar structures. 3) Grading gas permeable aggregate for SSDS installation. 4.) SSDS and SVE installation.
Comments:	

Site Map

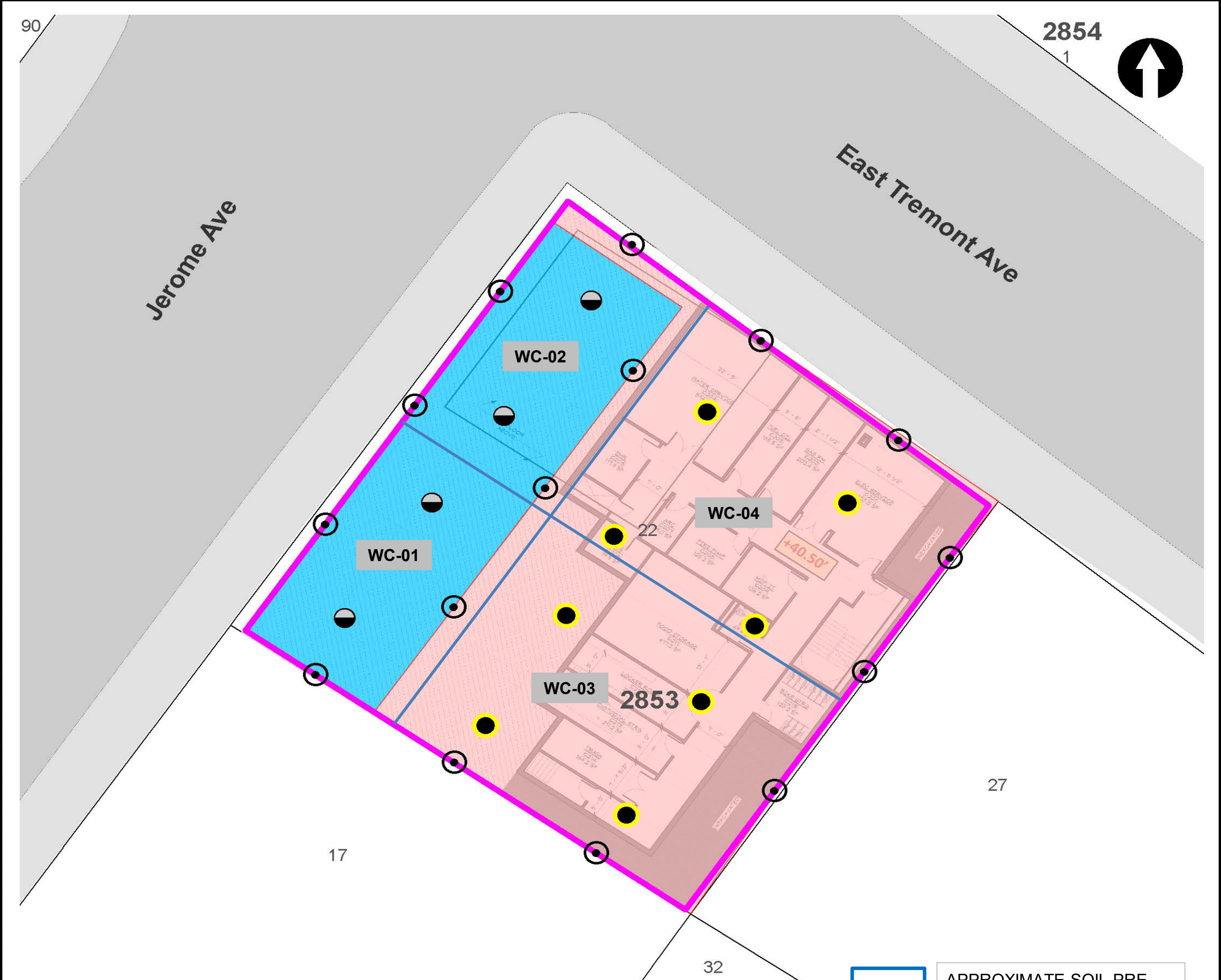

**LEGEND**

- PROJECT SITE BOUNDARY
- LOT BOUNDARY AND TAX LOT NUMBER
- 2853** BLOCK NUMBER
- REMEDIAL EXCAVATION TO APPROXIMATELY TWO FEET BELOW EXISTING GRADE
- REMEDIAL EXCAVATION TO GROUNDWATER (SOURCE AREA)

- CONFIRMATION DOCUMENTATION BOTTOM SAMPLE
- SOURCE AREA DOCUMENTATION BOTTOM SAMPLE
- DOCUMENTATION SIDEWALL SAMPLE

**NOTE**  
 REMEDIAL EXCAVATION WILL INCLUDE REMOVAL OF APPROXIMATELY 1,280 TONS (850 CUBIC YARDS) OF SOURCE MATERIAL ASSOCIATED WITH NYSDEC SPILL NO. 2103719 AND APPROXIMATELY 860 TONS (570 CUBIC YARDS) OF SOIL/FILL FROM THE UPPER 2 FEET SITE-WIDE.



APPROXIMATE SOIL PRE-CHARACTERIZATION GRID

Map Source:  
 NYCDOP (NYC Dept. of City Planning) GIS database

© 2021 AKRF. W:\Projects\210024 - 1956 JEROME AVENUE\Technical\GIS and Graphics\AR\RAW\210024 Figure 9 Proposed Remedial Excavation and Documentation Sample Location Plan.mxd 10/25/2021 2:03:38 PM iszalus



440 Park Avenue South, New York, NY 10016

**1956 Jerome Avenue**  
 Bronx, New York

**TRACK 4 CLEANUP AND DOCUMENTATION**  
**SAMPLE LOCATION PLAN**

DATE  
**04/29/2022**

PROJECT NO.  
**210024**

FIGURE  
**11**

Site Photographs

Photograph 1 -  
Casino staging  
materials on site  
prepping for  
concrete shipment.  
Facing northeast.



Photograph 2 -Minor  
excavation in grid  
WC-01. Facing south.



Photograph 3 -  
Casino pouring  
concrete for a pile  
cap WC-04. Facing  
southeast.



Upwind Station						
Time	Instaneous VOC (ppm)	Instaneous Mass Conc. Total (mg/m <sup>3</sup> )	Mass Conc. Total mg/m <sup>3</sup> AVG 15m (mg/m <sup>3</sup> )	Dust Exceedance	VOC ppm AVG 15m (ppm)	VOC Exceedance
6/14/2023 6:56	0	0.068	0.068	No	0	No
6/14/2023 6:57	0	0.042	0.055	No	0	No
6/14/2023 6:58	0	0.064	0.058	No	0	No
6/14/2023 6:59	0	0.04	0.0535	No	0	No
6/14/2023 7:00	0	0.036	0.05	No	0	No
6/14/2023 7:01	0	0.039	0.0482	No	0	No
6/14/2023 7:02	0	0.039	0.0469	No	0	No
6/14/2023 7:03	0	0.038	0.0457	No	0	No
6/14/2023 7:04	0	0.039	0.045	No	0	No
6/14/2023 7:05	0	0.045	0.045	No	0	No
6/14/2023 7:06	0	0.064	0.0467	No	0	No
6/14/2023 7:07	0	0.053	0.0472	No	0	No
6/14/2023 7:08	0	0.053	0.0477	No	0	No
6/14/2023 7:09	0	0.052	0.048	No	0	No
6/14/2023 7:10	0	0.039	0.0474	No	0	No
6/14/2023 7:11	0	0.038	0.0454	No	0	No
6/14/2023 7:12	0	0.039	0.0452	No	0	No
6/14/2023 7:13	0	0.257	0.0581	No	0	No
6/14/2023 7:14	0	0.386	0.0811	No	0	No
6/14/2023 7:15	0	0.039	0.0813	No	0	No
6/14/2023 7:16	0	0.042	0.0815	No	0	No
6/14/2023 7:17	0	0.033	0.0811	No	0	No
6/14/2023 7:18	0	0.035	0.0809	No	0	No
6/14/2023 7:19	0	0.035	0.0807	No	0	No
6/14/2023 7:20	0	0.037	0.0801	No	0	No
6/14/2023 7:21	0	0.042	0.0787	No	0	No
6/14/2023 7:22	0	0.042	0.0779	No	0	No
6/14/2023 7:23	0	0.036	0.0768	No	0	No
6/14/2023 7:24	0	0.033	0.0755	No	0	No
6/14/2023 7:25	0	0.031	0.075	No	0	No
6/14/2023 7:26	0	0.034	0.0747	No	0	No
6/14/2023 7:27	0	0.031	0.0742	No	0	No
6/14/2023 7:28	0	0.033	0.0593	No	0	No
6/14/2023 7:29	0	0.04	0.0362	No	0	No
6/14/2023 7:30	0	0.037	0.0361	No	0	No
6/14/2023 7:31	0	0.032	0.0354	No	0	No
6/14/2023 7:32	0	0.033	0.0354	No	0	No
6/14/2023 7:33	0	0.03	0.0351	No	0	No
6/14/2023 7:34	0	0.031	0.0348	No	0	No
6/14/2023 7:35	0	0.031	0.0344	No	0	No
6/14/2023 7:36	0	0.033	0.0338	No	0	No
6/14/2023 7:37	0	0.033	0.0332	No	0	No
6/14/2023 7:38	0	0.036	0.0332	No	0	No
6/14/2023 7:39	0	0.034	0.0333	No	0	No
6/14/2023 7:40	0	0.034	0.0335	No	0	No
6/14/2023 7:41	0	0.03	0.0332	No	0	No
6/14/2023 7:42	0	0.031	0.0332	No	0	No
6/14/2023 7:43	0	0.03	0.033	No	0	No
6/14/2023 7:44	0	0.03	0.0323	No	0	No
6/14/2023 7:45	0	0.031	0.0319	No	0	No
6/14/2023 7:46	0	0.03	0.0318	No	0	No
6/14/2023 7:47	0	0.031	0.0317	No	0	No

Upwind Station						
Time	Instaneous VOC (ppm)	Instaneous Mass Conc. Total (mg/m <sup>3</sup> )	Mass Conc. Total mg/m <sup>3</sup> AVG 15m (mg/m <sup>3</sup> )	Dust Exceedance	VOC ppm AVG 15m (ppm)	VOC Exceedance
6/14/2023 7:48	0	0.031	0.0317	No	0	No
6/14/2023 7:49	0	0.032	0.0318	No	0	No
6/14/2023 7:50	0	0.032	0.0319	No	0	No
6/14/2023 7:51	0	0.035	0.032	No	0	No
6/14/2023 7:52	0	0.032	0.0319	No	0	No
6/14/2023 7:53	0	0.037	0.032	No	0	No
6/14/2023 7:54	0	0.03	0.0317	No	0	No
6/14/2023 7:55	0	0.033	0.0317	No	0	No
6/14/2023 7:56	0	0.03	0.0317	No	0	No
6/14/2023 7:57	0	0.03	0.0316	No	0	No
6/14/2023 7:58	0	0.03	0.0316	No	0	No
6/14/2023 7:59	0	0.029	0.0315	No	0	No
6/14/2023 8:00	0	0.03	0.0315	No	0	No
6/14/2023 8:01	0	0.032	0.0316	No	0	No
6/14/2023 8:02	0	0.036	0.0319	No	0	No
6/14/2023 8:03	0	0.035	0.0322	No	0	No
6/14/2023 8:04	0	0.032	0.0322	No	0	No
6/14/2023 8:05	0	0.029	0.032	No	0	No
6/14/2023 8:06	0	0.042	0.0325	No	0	No
6/14/2023 8:07	0	0.045	0.0333	No	0	No
6/14/2023 8:08	0	0.033	0.0331	No	0	No
6/14/2023 8:09	0	0.03	0.0331	No	0	No
6/14/2023 8:10	0	0.031	0.0329	No	0	No
6/14/2023 8:11	0	0.033	0.0331	No	0	No
6/14/2023 8:12	0	0.045	0.0341	No	0	No
6/14/2023 8:13	0	0.035	0.0345	No	0	No
6/14/2023 8:14	0	0.03	0.0345	No	0	No
6/14/2023 8:15	0	0.029	0.0345	No	0	No
6/14/2023 8:16	0	0.033	0.0345	No	0	No
6/14/2023 8:17	0	0.031	0.0342	No	0	No
6/14/2023 8:18	0	0.031	0.0339	No	0	No
6/14/2023 8:19	0	0.045	0.0348	No	0	No
6/14/2023 8:20	0	0.043	0.0357	No	0	No
6/14/2023 8:21	0	0.037	0.0354	No	0	No
6/14/2023 8:22	0	0.043	0.0353	No	0	No
6/14/2023 8:23	0.105	0.035	0.0354	No	0.007	No
6/14/2023 8:24	0.03	0.034	0.0357	No	0.009	No
6/14/2023 8:25	0	0.069	0.0382	No	0.009	No
6/14/2023 8:26	0	0.046	0.0391	No	0.009	No
6/14/2023 8:27	0	0.045	0.0391	No	0.009	No
6/14/2023 8:28	0	0.035	0.0391	No	0.009	No
6/14/2023 8:29	0	0.044	0.04	No	0.009	No
6/14/2023 8:30	0	0.04	0.0407	No	0.009	No
6/14/2023 8:31	0.031	0.035	0.0409	No	0.0111	No
6/14/2023 8:32	0	0.049	0.0421	No	0.0111	No
6/14/2023 8:33	0	0.033	0.0422	No	0.0111	No
6/14/2023 8:34	0	0.063	0.0434	No	0.0111	No
6/14/2023 8:35	0	0.067	0.045	No	0.0111	No
6/14/2023 8:36	0	0.288	0.0617	No	0.0111	No
6/14/2023 8:37	0	0.045	0.0619	No	0.0111	No
6/14/2023 8:38	0	0.078	0.0647	No	0.0041	No
6/14/2023 8:39	0	0.224	0.0774	No	0.0021	No

Upwind Station						
Time	Instaneous VOC (ppm)	Instaneous Mass Conc. Total (mg/m <sup>3</sup> )	Mass Conc. Total mg/m <sup>3</sup> AVG 15m (mg/m <sup>3</sup> )	Dust Exceedance	VOC ppm AVG 15m (ppm)	VOC Exceedance
6/14/2023 8:40	0	0.004	0.0731	No	0.0021	No
6/14/2023 8:41	0	0.183	0.0822	No	0.0021	No
6/14/2023 8:42	0	0.007	0.0797	No	0.0021	No
6/14/2023 8:43	0	0.007	0.0778	No	0.0021	No
6/14/2023 8:44	0	0.045	0.0779	No	0.0021	No
6/14/2023 8:45	0	0.052	0.0787	No	0.0021	No
6/14/2023 8:46	0	0.033	0.0785	No	0	No
6/14/2023 8:47	0	0.372	0.1001	No	0	No
6/14/2023 8:48	0	0.031	0.0999	No	0	No
6/14/2023 8:49	0	0.042	0.0985	No	0	No
6/14/2023 8:50	0	0.042	0.0969	No	0	No
6/14/2023 8:51	0	0.034	0.0799	No	0	No
6/14/2023 8:52	0	0.036	0.0793	No	0	No
6/14/2023 8:53	0	0.044	0.0771	No	0	No
6/14/2023 8:54	0	0.036	0.0645	No	0	No
6/14/2023 8:55	0	0.032	0.0664	No	0	No
6/14/2023 8:56	0	0.036	0.0566	No	0	No
6/14/2023 8:57	0	0.032	0.0583	No	0	No
6/14/2023 8:58	0	0.034	0.0601	No	0	No
6/14/2023 8:59	0	0.038	0.0596	No	0	No
6/14/2023 9:00	0	0.033	0.0583	No	0	No
6/14/2023 9:01	0	0.035	0.0585	No	0	No
6/14/2023 9:02	0	0.034	0.0359	No	0	No
6/14/2023 9:03	0	0.035	0.0362	No	0	No
6/14/2023 9:04	0	0.031	0.0355	No	0	No
6/14/2023 9:05	0	0.031	0.0347	No	0	No
6/14/2023 9:06	0	0.031	0.0345	No	0	No
6/14/2023 9:07	0	0.03	0.0341	No	0	No
6/14/2023 9:08	0	0.031	0.0333	No	0	No
6/14/2023 9:09	0	0.041	0.0336	No	0	No
6/14/2023 9:10	0	0.029	0.0334	No	0	No
6/14/2023 9:11	0	0.03	0.033	No	0	No
6/14/2023 9:12	0	0.032	0.033	No	0	No
6/14/2023 9:13	0	0.031	0.0328	No	0	No
6/14/2023 9:14	0	0.031	0.0323	No	0	No
6/14/2023 9:15	0	0.032	0.0323	No	0	No
6/14/2023 9:16	0	0.031	0.032	No	0	No
6/14/2023 9:17	0	0.031	0.0318	No	0	No
6/14/2023 9:18	0	0.033	0.0317	No	0	No
6/14/2023 9:19	0	0.03	0.0316	No	0	No
6/14/2023 9:20	0	0.033	0.0317	No	0	No
6/14/2023 9:21	0	0.033	0.0319	No	0	No
6/14/2023 9:22	0	0.033	0.0321	No	0	No
6/14/2023 9:23	0	0.035	0.0323	No	0	No
6/14/2023 9:24	0	0.032	0.0317	No	0	No
6/14/2023 9:25	0	0.032	0.0319	No	0	No
6/14/2023 9:26	0	0.031	0.032	No	0	No
6/14/2023 9:27	0	0.03	0.0319	No	0	No
6/14/2023 9:28	0	0.03	0.0318	No	0	No
6/14/2023 9:29	0	0.03	0.0317	No	0	No
6/14/2023 9:30	0	0.033	0.0318	No	0	No
6/14/2023 9:31	0	0.035	0.0321	No	0	No

Upwind Station						
Time	Instaneous VOC (ppm)	Instaneous Mass Conc. Total (mg/m³)	Mass Conc. Total mg/m³ AVG 15m (mg/m³)	Dust Exceedance	VOC ppm AVG 15m (ppm)	VOC Exceedance
6/14/2023 9:32	0	0.034	0.0323	No	0	No
6/14/2023 9:33	0	0.033	0.0323	No	0	No
6/14/2023 9:34	0	0.03	0.0323	No	0	No
6/14/2023 9:35	0	0.03	0.0321	No	0	No
6/14/2023 9:36	0	0.031	0.0319	No	0	No
6/14/2023 9:37	0	0.03	0.0317	No	0	No
6/14/2023 9:38	0	0.029	0.0313	No	0	No
6/14/2023 9:39	0	0.033	0.0314	No	0	No
6/14/2023 9:40	0	0.035	0.0316	No	0	No
6/14/2023 9:41	0	0.037	0.032	No	0	No
6/14/2023 9:42	0	0.031	0.0321	No	0	No
6/14/2023 9:43	0	0.029	0.032	No	0	No
6/14/2023 9:44	0	0.082	0.0355	No	0	No
6/14/2023 9:45	0	0.03	0.0353	No	0	No
6/14/2023 9:46	0	0.03	0.0349	No	0	No
6/14/2023 9:47	0	0.033	0.0349	No	0	No
6/14/2023 9:48	0	0.033	0.0349	No	0	No
6/14/2023 9:49	0	0.033	0.0351	No	0	No
6/14/2023 9:50	0	0.032	0.0352	No	0	No
6/14/2023 9:51	0	0.033	0.0353	No	0	No
6/14/2023 9:52	0	0.031	0.0354	No	0	No
6/14/2023 9:53	0	0.031	0.0355	No	0	No
6/14/2023 9:54	0	0.031	0.0354	No	0	No
6/14/2023 9:55	0	0.03	0.0351	No	0	No
6/14/2023 9:56	0	0.032	0.0347	No	0	No
6/14/2023 9:57	0	0.044	0.0356	No	0	No
6/14/2023 9:58	0	0.031	0.0357	No	0	No
6/14/2023 9:59	0	0.032	0.0324	No	0	No
6/14/2023 10:00	0	0.032	0.0325	No	0	No
6/14/2023 10:01	0	0.032	0.0327	No	0	No
6/14/2023 10:02	0	0.03	0.0325	No	0	No
6/14/2023 10:03	0	0.031	0.0323	No	0	No
6/14/2023 10:04	0	0.031	0.0322	No	0	No
6/14/2023 10:05	0	0.031	0.0321	No	0	No
6/14/2023 10:06	0	0.031	0.032	No	0	No
6/14/2023 10:07	0	0.033	0.0321	No	0	No
6/14/2023 10:08	0	0.03	0.0321	No	0	No
6/14/2023 10:09	0	0.034	0.0323	No	0	No
6/14/2023 10:10	0	0.03	0.0323	No	0	No
6/14/2023 10:11	0	0.031	0.0322	No	0	No
6/14/2023 10:12	0	0.032	0.0314	No	0	No
6/14/2023 10:13	0	0.031	0.0314	No	0	No
6/14/2023 10:14	0	0.028	0.0311	No	0	No
6/14/2023 10:15	0	0.027	0.0308	No	0	No
6/14/2023 10:16	0	0.028	0.0305	No	0	No
6/14/2023 10:17	0	0.028	0.0304	No	0	No
6/14/2023 10:18	0	0.029	0.0303	No	0	No
6/14/2023 10:19	0	0.031	0.0303	No	0	No
6/14/2023 10:20	0	0.034	0.0305	No	0	No
6/14/2023 10:21	0	0.03	0.0304	No	0	No
6/14/2023 10:22	0	0.03	0.0302	No	0	No
6/14/2023 10:23	0	0.029	0.0301	No	0	No

Upwind Station						
Time	Instaneous VOC (ppm)	Instaneous Mass Conc. Total (mg/m <sup>3</sup> )	Mass Conc. Total mg/m <sup>3</sup> AVG 15m (mg/m <sup>3</sup> )	Dust Exceedance	VOC ppm AVG 15m (ppm)	VOC Exceedance
6/14/2023 10:24	0	0.036	0.0303	No	0	No
6/14/2023 10:25	0	0.032	0.0304	No	0	No
6/14/2023 10:26	0	0.03	0.0303	No	0	No
6/14/2023 10:27	0	0.071	0.0329	No	0	No
6/14/2023 10:28	0	0.097	0.0373	No	0	No
6/14/2023 10:29	0	0.044	0.0384	No	0	No
6/14/2023 10:30	0	0.041	0.0393	No	0	No
6/14/2023 10:31	0	0.029	0.0394	No	0	No
6/14/2023 10:32	0	0.084	0.0431	No	0	No
6/14/2023 10:33	0	0.127	0.0497	No	0	No
6/14/2023 10:34	0.01	0.036	0.05	No	0.001	No
6/14/2023 10:35	0	0.033	0.0499	No	0.001	No
6/14/2023 10:36	0	0.033	0.0501	No	0.001	No
6/14/2023 10:37	0	0.033	0.0503	No	0.001	No
6/14/2023 10:38	0	0.03	0.0504	No	0.001	No
6/14/2023 10:39	0	0.033	0.0502	No	0.001	No
6/14/2023 10:40	0	0.035	0.0504	No	0.001	No
6/14/2023 10:41	0	0.034	0.0507	No	0.001	No
6/14/2023 10:42	0	0.033	0.0481	No	0.001	No
6/14/2023 10:43	0	0.033	0.0439	No	0.001	No
6/14/2023 10:44	0	0.029	0.0429	No	0.001	No
6/14/2023 10:45	0	0.033	0.0423	No	0.001	No
6/14/2023 10:46	0	0.031	0.0425	No	0.001	No
6/14/2023 10:47	0	0.031	0.0389	No	0.001	No
6/14/2023 10:48	0	0.032	0.0326	No	0.001	No
6/14/2023 10:49	0	0.036	0.0326	No	0	No
6/14/2023 10:50	0	0.034	0.0327	No	0	No
6/14/2023 10:51	0	0.032	0.0326	No	0	No
6/14/2023 10:52	0	0.032	0.0325	No	0	No
6/14/2023 10:53	0	0.031	0.0326	No	0	No
6/14/2023 10:54	0	0.03	0.0324	No	0	No
6/14/2023 10:55	0	0.032	0.0322	No	0	No
6/14/2023 10:56	0	0.032	0.0321	No	0	No
6/14/2023 10:57	0	0.04	0.0325	No	0	No
6/14/2023 10:58	0	0.036	0.0327	No	0	No
6/14/2023 10:59	0	0.032	0.0329	No	0	No
6/14/2023 11:00	0	0.031	0.0328	No	0	No
6/14/2023 11:01	0	0.037	0.0332	No	0	No
6/14/2023 11:02	0	0.032	0.0333	No	0	No
6/14/2023 11:03	0	0.034	0.0334	No	0	No
6/14/2023 11:04	0	0.046	0.0341	No	0	No
6/14/2023 11:05	0	0.046	0.0349	No	0	No
6/14/2023 11:06	0	0.045	0.0357	No	0	No
6/14/2023 11:07	0	0.039	0.0362	No	0	No
6/14/2023 11:08	0	0.035	0.0365	No	0	No
6/14/2023 11:09	0	0.04	0.0371	No	0	No
6/14/2023 11:10	0.003	0.035	0.0373	No	0.0002	No
6/14/2023 11:11	0	0.032	0.0373	No	0.0002	No
6/14/2023 11:12	0	0.032	0.0368	No	0.0002	No
6/14/2023 11:13	0	0.032	0.0365	No	0.0002	No
6/14/2023 11:14	0	0.031	0.0365	No	0.0002	No
6/14/2023 11:15	0	0.03	0.0364	No	0.0002	No



Upwind Station						
Time	Instaneous VOC (ppm)	Instaneous Mass Conc. Total (mg/m <sup>3</sup> )	Mass Conc. Total mg/m <sup>3</sup> AVG 15m (mg/m <sup>3</sup> )	Dust Exceedance	VOC ppm AVG 15m (ppm)	VOC Exceedance
6/14/2023 11:16	0	0.03	0.0359	No	0.0002	No
6/14/2023 11:17	0	0.031	0.0359	No	0.0002	No
6/14/2023 11:18	0	0.03	0.0356	No	0.0002	No
6/14/2023 11:19	0	0.03	0.0345	No	0.0002	No
6/14/2023 11:20	0	0.031	0.0335	No	0.0002	No
6/14/2023 11:21	0	0.034	0.0328	No	0.0002	No
6/14/2023 11:22	0.017	0.033	0.0324	No	0.0013	No
6/14/2023 11:23	0	0.031	0.0321	No	0.0013	No
6/14/2023 11:24	0	0.029	0.0314	No	0.0013	No
6/14/2023 11:25	0	0.033	0.0313	No	0.0011	No
6/14/2023 11:26	0	0.033	0.0313	No	0.0011	No
6/14/2023 11:27	0	0.045	0.0322	No	0.0011	No
6/14/2023 11:28	0	0.037	0.0325	No	0.0011	No
6/14/2023 11:29	0	0.033	0.0327	No	0.0011	No
6/14/2023 11:30	0	0.04	0.0333	No	0.0011	No
6/14/2023 11:31	0	0.038	0.0339	No	0.0011	No
6/14/2023 11:32	0	0.049	0.0351	No	0.0011	No
6/14/2023 11:33	0	0.066	0.0375	No	0.0011	No
6/14/2023 11:34	0	0.032	0.0376	No	0.0011	No
6/14/2023 11:35	0	0.045	0.0385	No	0.0011	No
6/14/2023 11:36	0	0.037	0.0387	No	0.0011	No
6/14/2023 11:37	0	0.065	0.0409	No	0	No
6/14/2023 11:38	0	0.048	0.042	No	0	No
6/14/2023 11:39	0.001	0.084	0.0457	No	0.0001	No
6/14/2023 11:40	0	0.089	0.0494	No	0.0001	No
6/14/2023 11:41	0	0.043	0.0501	No	0.0001	No
6/14/2023 11:42	0	0.034	0.0493	No	0.0001	No
6/14/2023 11:43	0	0.033	0.0491	No	0.0001	No
6/14/2023 11:44	0	0.033	0.0491	No	0.0001	No
6/14/2023 11:45	0	0.034	0.0487	No	0.0001	No
6/14/2023 11:46	0	0.036	0.0485	No	0.0001	No
6/14/2023 11:47	0	0.045	0.0483	No	0.0001	No
6/14/2023 11:48	0	0.04	0.0465	No	0.0001	No
6/14/2023 11:49	0	0.04	0.0471	No	0.0001	No
6/14/2023 11:50	0	0.037	0.0465	No	0.0001	No
6/14/2023 11:51	0	0.035	0.0464	No	0.0001	No
6/14/2023 11:52	0	0.036	0.0445	No	0.0001	No
6/14/2023 11:53	0.004	0.036	0.0437	No	0.0003	No
6/14/2023 11:54	0	0.034	0.0403	No	0.0003	No
6/14/2023 11:55	0.003	0.035	0.0367	No	0.0005	No
6/14/2023 11:56	0.007	0.034	0.0361	No	0.0009	No
6/14/2023 11:57	0.007	0.037	0.0363	No	0.0014	No
6/14/2023 11:58	0	0.041	0.0369	No	0.0014	No
6/14/2023 11:59	0.005	0.04	0.0373	No	0.0017	No
6/14/2023 12:00	0.003	0.045	0.0381	No	0.0019	No
6/14/2023 12:01	0.007	0.044	0.0386	No	0.0024	No
6/14/2023 12:02	0.003	0.038	0.0381	No	0.0026	No
6/14/2023 12:03	0.002	0.038	0.038	No	0.0027	No
6/14/2023 12:04	0	0.038	0.0379	No	0.0027	No
6/14/2023 12:05	0.001	0.036	0.0378	No	0.0028	No
6/14/2023 12:06	0.004	0.043	0.0383	No	0.0031	No
6/14/2023 12:07	0.001	0.034	0.0382	No	0.0031	No

Upwind Station						
Time	Instaneous VOC (ppm)	Instaneous Mass Conc. Total (mg/m³)	Mass Conc. Total mg/m³ AVG 15m (mg/m³)	Dust Exceedance	VOC ppm AVG 15m (ppm)	VOC Exceedance
6/14/2023 12:08	0.005	0.034	0.0381	No	0.0032	No
6/14/2023 12:09	0.012	0.035	0.0381	No	0.004	No
6/14/2023 12:10	0.004	0.034	0.0381	No	0.0041	No
6/14/2023 12:11	0.03	0.035	0.0381	No	0.0056	No
6/14/2023 12:12	0.009	0.036	0.0381	No	0.0057	No
6/14/2023 12:13	0.002	0.037	0.0378	No	0.0059	No
6/14/2023 12:14	0.003	0.054	0.0387	No	0.0057	No
6/14/2023 12:15	0.002	0.041	0.0385	No	0.0057	No
6/14/2023 12:16	0.016	0.034	0.0378	No	0.0063	No
6/14/2023 12:17	0.013	0.034	0.0375	No	0.0069	No
6/14/2023 12:18	0	0.045	0.038	No	0.0068	No
6/14/2023 12:19	0.001	0.035	0.0378	No	0.0069	No
6/14/2023 12:20	0.001	0.035	0.0377	No	0.0069	No
6/14/2023 12:21	0.009	0.033	0.0371	No	0.0072	No
6/14/2023 12:22	0.005	0.037	0.0373	No	0.0075	No
6/14/2023 12:23	0.003	0.038	0.0375	No	0.0073	No
6/14/2023 12:24	0.002	0.035	0.0375	No	0.0067	No
6/14/2023 12:25	0	0.037	0.0377	No	0.0064	No
6/14/2023 12:26	0.005	0.034	0.0377	No	0.0047	No
6/14/2023 12:27	0.005	0.032	0.0374	No	0.0045	No
6/14/2023 12:28	0.004	0.033	0.0371	No	0.0046	No
6/14/2023 12:29	0.005	0.032	0.0357	No	0.0047	No
6/14/2023 12:30	0.014	0.032	0.0351	No	0.0055	No
6/14/2023 12:31	0.005	0.032	0.0349	No	0.0048	No
6/14/2023 12:32	0.027	0.035	0.035	No	0.0057	No
6/14/2023 12:33	0	0.032	0.0341	No	0.0057	No
6/14/2023 12:34	0.01	0.053	0.0353	No	0.0063	No
6/14/2023 12:35	0	0.032	0.0351	No	0.0063	No
6/14/2023 12:36	0	0.03	0.0349	No	0.0057	No
6/14/2023 12:37	0	0.031	0.0345	No	0.0053	No
6/14/2023 12:38	0.009	0.033	0.0342	No	0.0057	No
6/14/2023 12:39	0	0.031	0.0339	No	0.0056	No
6/14/2023 12:40	0	0.028	0.0333	No	0.0056	No
6/14/2023 12:41	0.031	0.029	0.033	No	0.0073	No
6/14/2023 12:42	0	0.095	0.0372	No	0.007	No
6/14/2023 12:43	0	0.287	0.0541	No	0.0067	No
6/14/2023 12:44	0	0.322	0.0735	No	0.0064	No
6/14/2023 12:45	0.002	0.036	0.0737	No	0.0056	No
6/14/2023 12:46	0	0.041	0.0743	No	0.0053	No
6/14/2023 12:47	0	0.034	0.0743	No	0.0035	No
6/14/2023 12:48	0	0.03	0.0741	No	0.0035	No
6/14/2023 12:49	0	0.036	0.073	No	0.0028	No
6/14/2023 12:50	0	0.039	0.0735	No	0.0028	No
6/14/2023 12:51	0	0.034	0.0737	No	0.0028	No
6/14/2023 12:52	0	0.03	0.0737	No	0.0028	No
6/14/2023 12:53	0	0.03	0.0735	No	0.0022	No
6/14/2023 12:54	0	0.03	0.0734	No	0.0022	No
6/14/2023 12:55	0	0.034	0.0738	No	0.0022	No
6/14/2023 12:56	0	0.03	0.0739	No	0.0001	No
6/14/2023 12:57	0	0.031	0.0696	No	0.0001	No
6/14/2023 12:58	0	0.034	0.0527	No	0.0001	No
6/14/2023 12:59	0	0.032	0.0334	No	0.0001	No

**Upwind Station**

Time	Instaneous VOC (ppm)	Instaneous Mass Conc. Total (mg/m <sup>3</sup> )	Mass Conc. Total mg/m <sup>3</sup> AVG 15m (mg/m <sup>3</sup> )	Dust Exceedance	VOC ppm AVG 15m (ppm)	VOC Exceedance
6/14/2023 13:00	0	0.036	0.0334	No	0	No
6/14/2023 13:01	0	0.035	0.033	No	0	No
6/14/2023 13:02	0	0.037	0.0332	No	0	No
6/14/2023 13:03	0	0.037	0.0337	No	0	No
6/14/2023 13:04	0	0.038	0.0338	No	0	No
6/14/2023 13:05	0	0.039	0.0338	No	0	No
6/14/2023 13:06	0	0.042	0.0343	No	0	No
6/14/2023 13:07	0	0.038	0.0349	No	0	No

Downwind Station						
Time	Instantaneous VOC (ppm)	Instantaneous Mass Conc. Total (mg/m <sup>3</sup> )	Mass Conc. Total mg/m <sup>3</sup> AVG 15m (mg/m <sup>3</sup> )	Dust Exceedance	VOC ppm AVG 15m (ppm)	VOC Exceedance
6/14/2023 6:54	0	0.045	0.045	No	0	No
6/14/2023 6:55	0	0.036	0.0405	No	0	No
6/14/2023 6:56	0	0.038	0.0397	No	0	No
6/14/2023 6:57	0	0.038	0.0393	No	0	No
6/14/2023 6:58	0	0.035	0.0384	No	0	No
6/14/2023 6:59	0	0.037	0.0382	No	0	No
6/14/2023 7:00	0	0.038	0.0381	No	0	No
6/14/2023 7:01	0	0.035	0.0378	No	0	No
6/14/2023 7:02	0	0.035	0.0374	No	0	No
6/14/2023 7:03	0	0.032	0.0369	No	0	No
6/14/2023 7:04	0	0.032	0.0365	No	0	No
6/14/2023 7:05	0	0.035	0.0363	No	0	No
6/14/2023 7:06	0	0.031	0.0359	No	0	No
6/14/2023 7:07	0	0.034	0.0358	No	0	No
6/14/2023 7:08	0	0.038	0.0359	No	0	No
6/14/2023 7:09	0	0.108	0.0401	No	0	No
6/14/2023 7:10	0	0.046	0.0408	No	0	No
6/14/2023 7:11	0	0.033	0.0405	No	0	No
6/14/2023 7:12	0	0.036	0.0403	No	0	No
6/14/2023 7:13	0	0.032	0.0401	No	0	No
6/14/2023 7:14	0	0.032	0.0398	No	0	No
6/14/2023 7:15	0	0.036	0.0397	No	0	No
6/14/2023 7:16	0	0.035	0.0397	No	0	No
6/14/2023 7:17	0	0.031	0.0394	No	0	No
6/14/2023 7:18	0	0.03	0.0393	No	0	No
6/14/2023 7:19	0	0.032	0.0393	No	0	No
6/14/2023 7:20	0	0.044	0.0399	No	0	No
6/14/2023 7:21	0	0.035	0.0401	No	0	No
6/14/2023 7:22	0	0.032	0.04	No	0	No
6/14/2023 7:23	0	0.032	0.0396	No	0	No
6/14/2023 7:24	0	0.032	0.0345	No	0	No
6/14/2023 7:25	0	0.031	0.0335	No	0	No
6/14/2023 7:26	0	0.031	0.0334	No	0	No
6/14/2023 7:27	0	0.031	0.0331	No	0	No
6/14/2023 7:28	0	0.032	0.0331	No	0	No
6/14/2023 7:29	0	0.032	0.0331	No	0	No
6/14/2023 7:30	0	0.033	0.0329	No	0	No
6/14/2023 7:31	0	0.03	0.0325	No	0	No
6/14/2023 7:32	0	0.031	0.0325	No	0	No
6/14/2023 7:33	0	0.029	0.0325	No	0	No
6/14/2023 7:34	0	0.036	0.0327	No	0	No
6/14/2023 7:35	0	0.037	0.0323	No	0	No
6/14/2023 7:36	0	0.035	0.0323	No	0	No
6/14/2023 7:37	0	0.032	0.0323	No	0	No
6/14/2023 7:38	0	0.031	0.0322	No	0	No
6/14/2023 7:39	0	0.037	0.0325	No	0	No
6/14/2023 7:40	0	0.044	0.0334	No	0	No
6/14/2023 7:41	0	0.036	0.0337	No	0	No
6/14/2023 7:42	0	0.035	0.034	No	0	No
6/14/2023 7:43	0	0.033	0.0341	No	0	No
6/14/2023 7:44	0	0.033	0.0341	No	0	No
6/14/2023 7:45	0	0.033	0.0341	No	0	No
6/14/2023 7:46	0	0.039	0.0347	No	0	No
6/14/2023 7:47	0	0.035	0.035	No	0	No
6/14/2023 7:48	0	0.032	0.0352	No	0	No

Downwind Station						
Time	Instantaneous VOC (ppm)	Instantaneous Mass Conc. Total (mg/m <sup>3</sup> )	Mass Conc. Total mg/m <sup>3</sup> AVG 15m (mg/m <sup>3</sup> )	Dust Exceedance	VOC ppm AVG 15m (ppm)	VOC Exceedance
6/14/2023 7:49	0	0.034	0.0351	No	0	No
6/14/2023 7:50	0	0.049	0.0359	No	0	No
6/14/2023 7:51	0	0.036	0.0359	No	0	No
6/14/2023 7:52	0	0.028	0.0357	No	0	No
6/14/2023 7:53	0	0.031	0.0357	No	0	No
6/14/2023 7:54	0	0.031	0.0353	No	0	No
6/14/2023 7:55	0	0.041	0.0351	No	0	No
6/14/2023 7:56	0	0.042	0.0355	No	0	No
6/14/2023 7:57	0	0.034	0.0354	No	0	No
6/14/2023 7:58	0	0.031	0.0353	No	0	No
6/14/2023 7:59	0	0.032	0.0352	No	0	No
6/14/2023 8:00	0	0.043	0.0359	No	0	No
6/14/2023 8:01	0	0.035	0.0356	No	0	No
6/14/2023 8:02	0	0.032	0.0354	No	0	No
6/14/2023 8:03	0	0.032	0.0354	No	0	No
6/14/2023 8:04	0	0.033	0.0353	No	0	No
6/14/2023 8:05	0	0.037	0.0345	No	0	No
6/14/2023 8:06	0	0.033	0.0343	No	0	No
6/14/2023 8:07	0	0.034	0.0347	No	0	No
6/14/2023 8:08	0	0.032	0.0348	No	0	No
6/14/2023 8:09	0	0.033	0.0349	No	0	No
6/14/2023 8:10	0	0.03	0.0342	No	0	No
6/14/2023 8:11	0	0.033	0.0336	No	0	No
6/14/2023 8:12	0	0.032	0.0335	No	0	No
6/14/2023 8:13	0	0.03	0.0334	No	0	No
6/14/2023 8:14	0	0.121	0.0393	No	0	No
6/14/2023 8:15	0	0.112	0.0439	No	0	No
6/14/2023 8:16	0	0.034	0.0439	No	0	No
6/14/2023 8:17	0	0.032	0.0439	No	0	No
6/14/2023 8:18	0	0.032	0.0439	No	0	No
6/14/2023 8:19	0	0.031	0.0437	No	0	No
6/14/2023 8:20	0	0.032	0.0434	No	0	No
6/14/2023 8:21	0	0.032	0.0433	No	0	No
6/14/2023 8:22	0	0.033	0.0433	No	0	No
6/14/2023 8:23	0	0.033	0.0433	No	0	No
6/14/2023 8:24	0	0.036	0.0435	No	0	No
6/14/2023 8:25	0	0.045	0.0445	No	0	No
6/14/2023 8:26	0	0.038	0.0449	No	0	No
6/14/2023 8:27	0	0.037	0.0452	No	0	No
6/14/2023 8:28	0	0.037	0.0457	No	0	No
6/14/2023 8:29	0	0.042	0.0404	No	0	No
6/14/2023 8:30	0	0.044	0.0359	No	0	No
6/14/2023 8:31	0	0.036	0.036	No	0	No
6/14/2023 8:32	0	0.041	0.0366	No	0	No
6/14/2023 8:33	0	0.042	0.0373	No	0	No
6/14/2023 8:34	0	0.036	0.0376	No	0	No
6/14/2023 8:35	0	0.033	0.0377	No	0	No
6/14/2023 8:36	0	0.032	0.0377	No	0	No
6/14/2023 8:37	0	0.044	0.0384	No	0	No
6/14/2023 8:38	0	0.042	0.039	No	0	No
6/14/2023 8:39	0	0.035	0.0389	No	0	No
6/14/2023 8:40	0	0.051	0.0393	No	0	No
6/14/2023 8:41	0	0.045	0.0398	No	0	No
6/14/2023 8:42	0	0.048	0.0405	No	0	No
6/14/2023 8:43	0	0.032	0.0402	No	0	No

Downwind Station						
Time	Instantaneous VOC (ppm)	Instantaneous Mass Conc. Total (mg/m <sup>3</sup> )	Mass Conc. Total mg/m <sup>3</sup> AVG 15m (mg/m <sup>3</sup> )	Dust Exceedance	VOC ppm AVG 15m (ppm)	VOC Exceedance
6/14/2023 8:44	0	0.032	0.0395	No	0	No
6/14/2023 8:45	0	0.033	0.0388	No	0	No
6/14/2023 8:46	0	0.037	0.0389	No	0	No
6/14/2023 8:47	0	0.091	0.0422	No	0	No
6/14/2023 8:48	0	0.034	0.0417	No	0	No
6/14/2023 8:49	0	0.037	0.0417	No	0	No
6/14/2023 8:50	0	0.038	0.0421	No	0	No
6/14/2023 8:51	0	0.038	0.0425	No	0	No
6/14/2023 8:52	0	0.039	0.0421	No	0	No
6/14/2023 8:53	0	0.048	0.0425	No	0	No
6/14/2023 8:54	0	0.058	0.0441	No	0	No
6/14/2023 8:55	0	0.047	0.0438	No	0	No
6/14/2023 8:56	0	0.052	0.0443	No	0	No
6/14/2023 8:57	0	0.048	0.0443	No	0	No
6/14/2023 8:58	0	0.041	0.0449	No	0	No
6/14/2023 8:59	0	0.043	0.0456	No	0	No
6/14/2023 9:00	0	0.037	0.0459	No	0	No
6/14/2023 9:01	0	0.042	0.0462	No	0	No
6/14/2023 9:02	0	0.039	0.0427	No	0	No
6/14/2023 9:03	0	0.036	0.0429	No	0	No
6/14/2023 9:04	0	0.036	0.0428	No	0	No
6/14/2023 9:05	0	0.04	0.0429	No	0	No
6/14/2023 9:06	0	0.048	0.0436	No	0	No
6/14/2023 9:07	0	0.041	0.0437	No	0	No
6/14/2023 9:08	0	0.056	0.0443	No	0	No
6/14/2023 9:09	0	0.043	0.0433	No	0	No
6/14/2023 9:10	0	0.046	0.0432	No	0	No
6/14/2023 9:11	0	0.038	0.0423	No	0	No
6/14/2023 9:12	0	0.053	0.0426	No	0	No
6/14/2023 9:13	0	0.048	0.0431	No	0	No
6/14/2023 9:14	0	0.041	0.0429	No	0	No
6/14/2023 9:15	0	0.037	0.0429	No	0	No
6/14/2023 9:16	0	0.042	0.0429	No	0	No
6/14/2023 9:17	0	0.069	0.0449	No	0	No
6/14/2023 9:18	0	0.036	0.0449	No	0	No
6/14/2023 9:19	0	0.036	0.0449	No	0	No
6/14/2023 9:20	0	0.039	0.0449	No	0	No
6/14/2023 9:21	0	0.04	0.0443	No	0	No
6/14/2023 9:22	0	0.045	0.0446	No	0	No
6/14/2023 9:23	0	0.041	0.0436	No	0	No
6/14/2023 9:24	0	0.041	0.0435	No	0	No
6/14/2023 9:25	0	0.054	0.044	No	0	No
6/14/2023 9:26	0	0.064	0.0457	No	0	No
6/14/2023 9:27	0	0.047	0.0453	No	0	No
6/14/2023 9:28	0	0.062	0.0463	No	0	No
6/14/2023 9:29	0	0.037	0.046	No	0	No
6/14/2023 9:30	0	0.038	0.0461	No	0	No
6/14/2023 9:31	0	0.046	0.0463	No	0	No
6/14/2023 9:32	0	0.05	0.0451	No	0	No
6/14/2023 9:33	0	0.064	0.0469	No	0	No
6/14/2023 9:34	0	0.036	0.0469	No	0	No
6/14/2023 9:35	0	0.04	0.047	No	0	No
6/14/2023 9:36	0	0.038	0.0469	No	0	No
6/14/2023 9:37	0	0.044	0.0468	No	0	No
6/14/2023 9:38	0	0.048	0.0473	No	0	No

**Downwind Station**

Time	Instantaneous VOC (ppm)	Instantaneous Mass Conc. Total (mg/m <sup>3</sup> )	Mass Conc. Total mg/m <sup>3</sup> AVG 15m (mg/m <sup>3</sup> )	Dust Exceedance	VOC ppm AVG 15m (ppm)	VOC Exceedance
6/14/2023 9:39	0	0.051	0.0479	No	0	No
6/14/2023 9:40	0	0.044	0.0473	No	0	No
6/14/2023 9:41	0	0.062	0.0471	No	0	No
6/14/2023 9:42	0	0.095	0.0503	No	0	No
6/14/2023 9:43	0	0.047	0.0493	No	0	No
6/14/2023 9:44	0	0.04	0.0495	No	0	No
6/14/2023 9:45	0	0.037	0.0495	No	0	No
6/14/2023 9:46	0	0.038	0.0489	No	0	No
6/14/2023 9:47	0	0.052	0.0491	No	0	No
6/14/2023 9:48	0	0.047	0.0479	No	0	No
6/14/2023 9:49	0	0.043	0.0484	No	0	No
6/14/2023 9:50	0	0.066	0.0501	No	0	No
6/14/2023 9:51	0	0.07	0.0523	No	0	No
6/14/2023 9:52	0	0.05	0.0527	No	0	No
6/14/2023 9:53	0	0.052	0.0529	No	0	No
6/14/2023 9:54	0	0.058	0.0534	No	0	No
6/14/2023 9:55	0	0.067	0.0549	No	0	No
6/14/2023 9:56	0	0.064	0.0551	No	0	No
6/14/2023 9:57	0	0.085	0.0544	No	0	No
6/14/2023 9:58	0	0.056	0.055	No	0	No
6/14/2023 9:59	0	0.046	0.0554	No	0	No
6/14/2023 10:00	0	0.065	0.0573	No	0	No
6/14/2023 10:01	0	0.079	0.06	No	0	No
6/14/2023 10:02	0	0.056	0.0603	No	0	No
6/14/2023 10:03	0	0.055	0.0608	No	0	No
6/14/2023 10:04	0	0.071	0.0627	No	0	No
6/14/2023 10:05	0	0.068	0.0628	No	0	No
6/14/2023 10:06	0	0.063	0.0623	No	0	No
6/14/2023 10:07	0	0.049	0.0623	No	0	No
6/14/2023 10:08	0	0.045	0.0618	No	0	No
6/14/2023 10:09	0	0.047	0.0611	No	0	No
6/14/2023 10:10	0	0.04	0.0593	No	0	No
6/14/2023 10:11	0	0.039	0.0576	No	0	No
6/14/2023 10:12	0	0.04	0.0546	No	0	No
6/14/2023 10:13	0	0.038	0.0534	No	0	No
6/14/2023 10:14	0	0.036	0.0527	No	0	No
6/14/2023 10:15	0	0.035	0.0507	No	0	No
6/14/2023 10:16	0	0.037	0.0479	No	0	No
6/14/2023 10:17	0	0.037	0.0467	No	0	No
6/14/2023 10:18	0	0.037	0.0455	No	0	No
6/14/2023 10:19	0	0.057	0.0445	No	0	No
6/14/2023 10:20	0	0.055	0.0437	No	0	No
6/14/2023 10:21	0	0.041	0.0422	No	0	No
6/14/2023 10:22	0	0.036	0.0413	No	0	No
6/14/2023 10:23	0	0.038	0.0409	No	0	No

Downwind Station						
Time	Instantaneous VOC (ppm)	Instantaneous Mass Conc. Total (mg/m <sup>3</sup> )	Mass Conc. Total mg/m <sup>3</sup> AVG 15m (mg/m <sup>3</sup> )	Dust Exceedance	VOC ppm AVG 15m (ppm)	VOC Exceedance
6/14/2023 10:24	0	0.04	0.0404	No	0	No
6/14/2023 10:25	0	0.038	0.0403	No	0	No
6/14/2023 10:26	0	0.035	0.04	No	0	No
6/14/2023 10:27	0	0.039	0.0399	No	0	No
6/14/2023 10:28	0	0.039	0.04	No	0	No
6/14/2023 10:29	0	0.04	0.0403	No	0	No
6/14/2023 10:30	0	0.038	0.0405	No	0	No
6/14/2023 10:31	0	0.037	0.0405	No	0	No
6/14/2023 10:32	0	0.038	0.0405	No	0	No
6/14/2023 10:33	0	0.037	0.0405	No	0	No
6/14/2023 10:34	0	0.039	0.0393	No	0	No
6/14/2023 10:35	0	0.038	0.0382	No	0	No
6/14/2023 10:36	0	0.038	0.038	No	0	No
6/14/2023 10:37	0	0.041	0.0383	No	0	No
6/14/2023 10:38	0	0.04	0.0385	No	0	No
6/14/2023 10:39	0	0.041	0.0385	No	0	No
6/14/2023 10:40	0	0.041	0.0387	No	0	No
6/14/2023 10:41	0	0.04	0.0391	No	0	No
6/14/2023 10:42	0	0.04	0.0391	No	0	No
6/14/2023 10:43	0	0.061	0.0406	No	0	No
6/14/2023 10:44	0	0.048	0.0411	No	0	No
6/14/2023 10:45	0	0.037	0.0411	No	0	No
6/14/2023 10:46	0	0.037	0.0411	No	0	No
6/14/2023 10:47	0	0.038	0.0411	No	0	No
6/14/2023 10:48	0	0.04	0.0413	No	0	No
6/14/2023 10:49	0	0.052	0.0421	No	0	No
6/14/2023 10:50	0	0.044	0.0425	No	0	No
6/14/2023 10:51	0	0.039	0.0426	No	0	No
6/14/2023 10:52	0	0.039	0.0425	No	0	No
6/14/2023 10:53	0	0.039	0.0424	No	0	No
6/14/2023 10:54	0	0.038	0.0422	No	0	No
6/14/2023 10:55	0	0.038	0.042	No	0	No
6/14/2023 10:56	0	0.042	0.0421	No	0	No
6/14/2023 10:57	0	0.04	0.0421	No	0	No
6/14/2023 10:58	0	0.039	0.0407	No	0	No
6/14/2023 10:59	0	0.038	0.04	No	0	No
6/14/2023 11:00	0	0.038	0.0401	No	0	No
6/14/2023 11:01	0	0.038	0.0401	No	0	No
6/14/2023 11:02	0	0.04	0.0403	No	0	No
6/14/2023 11:03	0	0.04	0.0403	No	0	No
6/14/2023 11:04	0	0.044	0.0397	No	0	No
6/14/2023 11:05	0	0.052	0.0403	No	0	No
6/14/2023 11:06	0	0.046	0.0407	No	0	No
6/14/2023 11:07	0	0.042	0.0409	No	0	No
6/14/2023 11:08	0	0.061	0.0424	No	0	No
6/14/2023 11:09	0	0.042	0.0427	No	0	No
6/14/2023 11:10	0	0.054	0.0437	No	0	No
6/14/2023 11:11	0	0.057	0.0447	No	0	No
6/14/2023 11:12	0	0.067	0.0465	No	0	No
6/14/2023 11:13	0	0.055	0.0476	No	0	No
6/14/2023 11:14	0	0.041	0.0478	No	0	No
6/14/2023 11:15	0	0.038	0.0478	No	0	No
6/14/2023 11:16	0	0.038	0.0478	No	0	No
6/14/2023 11:17	0	0.036	0.0475	No	0	No
6/14/2023 11:18	0	0.036	0.0473	No	0	No



Downwind Station						
Time	Instantaneous VOC (ppm)	Instantaneous Mass Conc. Total (mg/m <sup>3</sup> )	Mass Conc. Total mg/m <sup>3</sup> AVG 15m (mg/m <sup>3</sup> )	Dust Exceedance	VOC ppm AVG 15m (ppm)	VOC Exceedance
6/14/2023 11:19	0	0.036	0.0467	No	0	No
6/14/2023 11:20	0	0.039	0.0459	No	0	No
6/14/2023 11:21	0	0.039	0.0454	No	0	No
6/14/2023 11:22	0	0.049	0.0459	No	0	No
6/14/2023 11:23	0	0.04	0.0445	No	0	No
6/14/2023 11:24	0	0.039	0.0443	No	0	No
6/14/2023 11:25	0	0.046	0.0437	No	0	No
6/14/2023 11:26	0	0.044	0.0429	No	0	No
6/14/2023 11:27	0	0.043	0.0413	No	0	No
6/14/2023 11:28	0	0.064	0.0419	No	0	No
6/14/2023 11:29	0	0.05	0.0425	No	0	No
6/14/2023 11:30	0	0.073	0.0448	No	0	No
6/14/2023 11:31	0	0.044	0.0452	No	0	No
6/14/2023 11:32	0	0.042	0.0456	No	0	No
6/14/2023 11:33	0	0.048	0.0464	No	0	No
6/14/2023 11:34	0	0.078	0.0492	No	0	No
6/14/2023 11:35	0	0.061	0.0507	No	0	No
6/14/2023 11:36	0	0.087	0.0539	No	0	No
6/14/2023 11:37	0	0.059	0.0545	No	0	No
6/14/2023 11:38	0	0.058	0.0557	No	0	No
6/14/2023 11:39	0	0.046	0.0562	No	0	No
6/14/2023 11:40	0	0.046	0.0562	No	0	No
6/14/2023 11:41	0	0.042	0.0561	No	0	No
6/14/2023 11:42	0	0.045	0.0562	No	0	No
6/14/2023 11:43	0	0.042	0.0547	No	0	No
6/14/2023 11:44	0	0.041	0.0541	No	0	No
6/14/2023 11:45	0	0.042	0.0521	No	0	No
6/14/2023 11:46	0	0.048	0.0523	No	0	No
6/14/2023 11:47	0	0.051	0.0529	No	0	No
6/14/2023 11:48	0	0.05	0.0531	No	0	No
6/14/2023 11:49	0	0.047	0.051	No	0	No
6/14/2023 11:50	0	0.048	0.0501	No	0	No
6/14/2023 11:51	0	0.042	0.0471	No	0	No
6/14/2023 11:52	0	0.046	0.0463	No	0	No
6/14/2023 11:53	0	0.047	0.0455	No	0	No
6/14/2023 11:54	0	0.048	0.0457	No	0	No
6/14/2023 11:55	0	0.049	0.0459	No	0	No
6/14/2023 11:56	0	0.065	0.0474	No	0	No
6/14/2023 11:57	0	0.05	0.0477	No	0	No
6/14/2023 11:58	0	0.053	0.0485	No	0	No
6/14/2023 11:59	0	0.079	0.051	No	0	No
6/14/2023 12:00	0	0.061	0.0523	No	0	No
6/14/2023 12:01	0	0.048	0.0523	No	0	No
6/14/2023 12:02	0	0.045	0.0519	No	0	No
6/14/2023 12:03	0	0.05	0.0519	No	0	No
6/14/2023 12:04	0	0.049	0.052	No	0	No
6/14/2023 12:05	0	0.048	0.052	No	0	No
6/14/2023 12:06	0	0.044	0.0521	No	0	No
6/14/2023 12:07	0	0.042	0.0519	No	0	No
6/14/2023 12:08	0	0.042	0.0515	No	0	No
6/14/2023 12:09	0	0.042	0.0511	No	0	No
6/14/2023 12:10	0	0.043	0.0507	No	0	No
6/14/2023 12:11	0	0.043	0.0493	No	0	No
6/14/2023 12:12	0	0.045	0.0489	No	0	No
6/14/2023 12:13	0	0.045	0.0484	No	0	No

Downwind Station						
Time	Instaneous VOC (ppm)	Instaneous Mass Conc. Total (mg/m <sup>3</sup> )	Mass Conc. Total mg/m <sup>3</sup> AVG 15m (mg/m <sup>3</sup> )	Dust Exceedance	VOC ppm AVG 15m (ppm)	VOC Exceedance
6/14/2023 12:14	0	0.046	0.0462	No	0	No
6/14/2023 12:15	0	0.042	0.0449	No	0	No
6/14/2023 12:16	0	0.043	0.0446	No	0	No
6/14/2023 12:17	0	0.041	0.0443	No	0	No
6/14/2023 12:18	0	0.043	0.0439	No	0	No
6/14/2023 12:19	0	0.042	0.0434	No	0	No
6/14/2023 12:20	0	0.041	0.0429	No	0	No
6/14/2023 12:21	0	0.041	0.0427	No	0	No
6/14/2023 12:22	0	0.041	0.0427	No	0	No
6/14/2023 12:23	0	0.037	0.0423	No	0	No
6/14/2023 12:24	0	0.037	0.042	No	0	No
6/14/2023 12:25	0	0.038	0.0417	No	0	No
6/14/2023 12:26	0	0.039	0.0414	No	0	No
6/14/2023 12:27	0	0.039	0.041	No	0	No
6/14/2023 12:28	0	0.037	0.0405	No	0	No
6/14/2023 12:29	0	0.036	0.0398	No	0	No
6/14/2023 12:30	0	0.038	0.0395	No	0	No
6/14/2023 12:31	0	0.038	0.0392	No	0	No
6/14/2023 12:32	0	0.039	0.0391	No	0	No
6/14/2023 12:33	0	0.042	0.039	No	0	No
6/14/2023 12:34	0	0.036	0.0386	No	0	No
6/14/2023 12:35	0	0.044	0.0388	No	0	No
6/14/2023 12:36	0	0.042	0.0389	No	0	No
6/14/2023 12:37	0	0.037	0.0386	No	0	No
6/14/2023 12:38	0	0.036	0.0385	No	0	No
6/14/2023 12:39	0	0.036	0.0385	No	0	No
6/14/2023 12:40	0	0.035	0.0383	No	0	No
6/14/2023 12:41	0	0.037	0.0381	No	0	No
6/14/2023 12:42	0	0.042	0.0383	No	0	No
6/14/2023 12:43	0	0.037	0.0383	No	0	No
6/14/2023 12:44	0	0.036	0.0383	No	0	No
6/14/2023 12:45	0	0.036	0.0382	No	0	No
6/14/2023 12:46	0	0.035	0.038	No	0	No
6/14/2023 12:47	0	0.036	0.0378	No	0	No
6/14/2023 12:48	0	0.039	0.0376	No	0	No
6/14/2023 12:49	0	0.044	0.0381	No	0	No
6/14/2023 12:50	0	0.043	0.0381	No	0	No
6/14/2023 12:51	0	0.039	0.0379	No	0	No
6/14/2023 12:52	0	0.036	0.0378	No	0	No
6/14/2023 12:53	0	0.036	0.0378	No	0	No
6/14/2023 12:54	0	0.037	0.0379	No	0	No
6/14/2023 12:55	0	0.038	0.0381	No	0	No
6/14/2023 12:56	0	0.037	0.0381	No	0	No
6/14/2023 12:57	0	0.04	0.0379	No	0	No
6/14/2023 12:58	0	0.038	0.038	No	0	No
6/14/2023 12:59	0	0.038	0.0381	No	0	No
6/14/2023 13:00	0	0.04	0.0384	No	0	No
6/14/2023 13:01	0	0.04	0.0387	No	0	No
6/14/2023 13:02	0	0.049	0.0396	No	0	No
6/14/2023 13:03	0	0.043	0.0399	No	0	No
6/14/2023 13:04	0	0.045	0.0399	No	0	No
6/14/2023 13:05	0	0.061	0.0411	No	0	No
6/14/2023 13:06	0	0.042	0.0413	No	0	No
6/14/2023 13:07	0	0.036	0.0413	No	0	No
6/14/2023 13:08	0	0.048	0.0421	No	0	No