



Daily Activity Report

Seton Brilla Charter School
1956 Jerome Avenue, Bronx, NY
BCP No. C203152

General Site Information

Date:	Tuesday, May 9, 2023
Weather:	Partly cLoudy, 54-69°F
Wind Direction/Speed:	NE @ 2-7 mph
AKRF Personnel on Site:	Brian Quinn
AKRF Equipment on Site:	Mini RAE 3000 Photoionization Detector [(PID) x1], Roving SidePak Particulate Monitor (1), 2 Fixed Air Monitoring Stations [DustTrak Aerosol Monitors (x2) & MiniRAE 3000 PIDs (x2)].
Visitors:	None

Contractor Information

Contracting Company	Main Personnel	Equipment
Casino Construction	Carlos	Excavator and a mini-excavator

Description and Location of Work Activities Performed

- 1) Rebar installation and formwork construction continued in grids WC-03 and WC-04.
- 2) Excavation of soil and rock for foundation elements in grid WC-04.

Destination Facility	Daily Trucks	Total Trucks	Daily Approx. Cubic Yds	Total Approx. Cubic Yds	Total Site Loads	Total Approximate Cubic Yards
Clean Earth Carteret	0	108	0	2,160	206	4,120
Clean Earth Southeastern Pennsylvania	0	67	0	1,340		
Clean Earth Bethlehem	0	31	0	620		
Concrete Disposal	0	27	0	540		
N/A	0	0	0	0		

CAMP Air Monitoring Results

CAMP Station	UPWIND			DOWNWIND		
Odors:	None			None		
VOC Action Level Exceedance(s):	None			None		
Particulate Action Level Exceedance(s):	None			None		
Maximum VOC Level (15 min ppm):	1.95			0.113		
Maximum Particulate Level (15 min mg/m ³):	0.127			0.0709		

Notes: CAMP monitoring was performed throughout the day. No particulate or VOC exceedances were noted.

Additional Information

Planned Work Activity for Following Day/Week:	<ol style="list-style-type: none"> 1) Continued installation of rebar in WC-03 and WC-04. 2) Continued pile unearthing and removal in WC-04. 3) Grading of soil in WC-02. 4) Waterproofing and concrete pouring over rebar structures.
Comments:	

Site Map

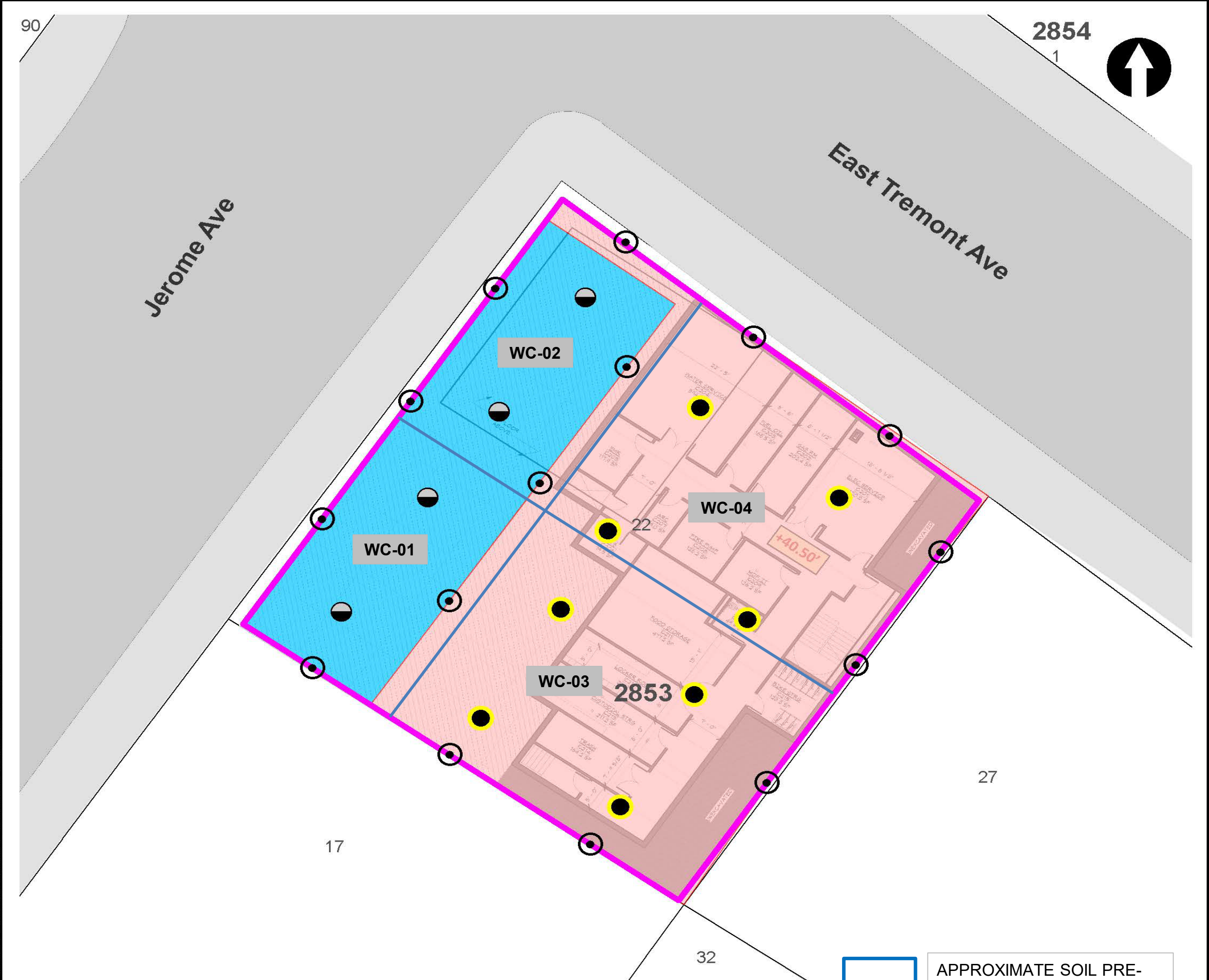

LEGEND

- PROJECT SITE BOUNDARY
- LOT BOUNDARY AND TAX LOT NUMBER
- 2853** BLOCK NUMBER
- REMEDIAL EXCAVATION TO APPROXIMATELY TWO FEET BELOW EXISTING GRADE
- REMEDIAL EXCAVATION TO GROUNDWATER (SOURCE AREA)

- CONFIRMATION DOCUMENTATION BOTTOM SAMPLE
- SOURCE AREA DOCUMENTATION BOTTOM SAMPLE
- DOCUMENTATION SIDEWALL SAMPLE

NOTE
 REMEDIAL EXCAVATION WILL INCLUDE REMOVAL OF APPROXIMATELY 1,280 TONS (850 CUBIC YARDS) OF SOURCE MATERIAL ASSOCIATED WITH NYSDEC SPILL NO. 2103719 AND APPROXIMATELY 860 TONS (570 CUBIC YARDS) OF SOIL/FILL FROM THE UPPER 2 FEET SITE-WIDE.



APPROXIMATE SOIL PRE-CHARACTERIZATION GRID

Map Source:
 NYCDOP (NYC Dept. of City Planning) GIS database

© 2021 AKRF. W:\Projects\210024 - 1956 JEROME AVENUE\Technical\GIS and Graphics\AR\RAW\210024 Figure 9 Proposed Remedial Excavation and Documentation Sample Location Plan.mxd 10/25/2021 2:03:38 PM iszalus



440 Park Avenue South, New York, NY 10016

1956 Jerome Avenue
 Bronx, New York

**TRACK 4 CLEANUP AND DOCUMENTATION
 SAMPLE LOCATION PLAN**

DATE
04/29/2022

PROJECT NO.
210024

FIGURE
11

Site Photographs

Photograph 1 -
General site
overview, view
facing east.



Photograph 2 -
Concrete pour for
building foundation.
View facing
southwest.



Photograph 3 -
Excavation near pit
and unearthing of
piles in grid WC-04.
View facing
southwest.



Upwind Station						
Time	Instaneous VOC (ppm)	Instaneous Mass Conc. Total (mg/m ³)	Mass Conc. Total mg/m ³ AVG 15m (mg/m ³)	Dust Exceedance	VOC ppm AVG 15m (ppm)	VOC Exceedance
5/9/2023 7:04	0.149			No	0.149	No
5/9/2023 7:05	0.135	0.02	0.02	No	0.142	No
5/9/2023 7:06	0.124	0.018	0.019	No	0.136	No
5/9/2023 7:07	0.126	0.015	0.0177	No	0.1335	No
5/9/2023 7:08	0.116	0.019	0.018	No	0.13	No
5/9/2023 7:09	0.12	0.017	0.0178	No	0.1283	No
5/9/2023 7:10	0.118	0.013	0.017	No	0.1269	No
5/9/2023 7:11	0.123	0.021	0.0176	No	0.1264	No
5/9/2023 7:12	0.115	0.022	0.0181	No	0.1251	No
5/9/2023 7:13	0.111	0.023	0.0187	No	0.1237	No
5/9/2023 7:14	0.108	0.017	0.0185	No	0.1223	No
5/9/2023 7:15	0.107	0.018	0.0185	No	0.121	No
5/9/2023 7:16	0.102	0.025	0.019	No	0.1195	No
5/9/2023 7:17	0.099	0.015	0.0187	No	0.1181	No
5/9/2023 7:18	0.114	0.015	0.0184	No	0.1178	No
5/9/2023 7:19	0.143	0.017	0.0183	No	0.1174	No
5/9/2023 7:20	0.117	0.014	0.0179	No	0.1162	No
5/9/2023 7:21	0.105	0.019	0.018	No	0.1149	No
5/9/2023 7:22	0.105	0.014	0.0179	No	0.1135	No
5/9/2023 7:23	0.109	0.018	0.0179	No	0.1131	No
5/9/2023 7:24	0.1	0.017	0.0179	No	0.1117	No
5/9/2023 7:25	0.107	0.031	0.0191	No	0.111	No
5/9/2023 7:26	0.105	0.025	0.0193	No	0.1098	No
5/9/2023 7:27	0.105	0.015	0.0189	No	0.1091	No
5/9/2023 7:28	0.098	0.014	0.0183	No	0.1083	No
5/9/2023 7:29	0.104	0.014	0.0181	No	0.108	No
5/9/2023 7:30	0.107	0.016	0.0179	No	0.108	No
5/9/2023 7:31	0.103	0.017	0.0174	No	0.1081	No
5/9/2023 7:32	0.105	0.02	0.0177	No	0.1085	No
5/9/2023 7:33	0.103	0.022	0.0182	No	0.1077	No
5/9/2023 7:34	0.109	0.023	0.0186	No	0.1055	No
5/9/2023 7:35	0.103	0.021	0.0191	No	0.1045	No
5/9/2023 7:36	0.105	0.032	0.0199	No	0.1045	No
5/9/2023 7:37	0.107	0.033	0.0212	No	0.1047	No
5/9/2023 7:38	0.106	0.025	0.0217	No	0.1045	No
5/9/2023 7:39	0.102	0.026	0.0223	No	0.1046	No
5/9/2023 7:40	0.109	0.043	0.0231	No	0.1047	No
5/9/2023 7:41	0.109	0.041	0.0241	No	0.105	No
5/9/2023 7:42	0.108	0.023	0.0247	No	0.1052	No
5/9/2023 7:43	0.099	0.023	0.0253	No	0.1053	No
5/9/2023 7:44	0.102	0.016	0.0254	No	0.1051	No
5/9/2023 7:45	0.101	0.017	0.0255	No	0.1047	No
5/9/2023 7:46	0.1	0.017	0.0255	No	0.1045	No
5/9/2023 7:47	0.102	0.014	0.0251	No	0.1043	No
5/9/2023 7:48	0.104	0.015	0.0246	No	0.1044	No
5/9/2023 7:49	0.105	0.014	0.024	No	0.1041	No
5/9/2023 7:50	0.108	0.015	0.0236	No	0.1045	No
5/9/2023 7:51	0.111	0.018	0.0227	No	0.1049	No
5/9/2023 7:52	0.12	0.021	0.0219	No	0.1057	No
5/9/2023 7:53	0.112	0.014	0.0211	No	0.1061	No
5/9/2023 7:54	0.111	0.016	0.0205	No	0.1067	No
5/9/2023 7:55	0.115	0.016	0.0187	No	0.1071	No

Upwind Station						
Time	Instaneous VOC (ppm)	Instaneous Mass Conc. Total (mg/m ³)	Mass Conc. Total mg/m ³ AVG 15m (mg/m ³)	Dust Exceedance	VOC ppm AVG 15m (ppm)	VOC Exceedance
5/9/2023 7:56	0.111	0.015	0.0169	No	0.1073	No
5/9/2023 7:57	0.121	0.016	0.0165	No	0.1081	No
5/9/2023 7:58	0.133	0.022	0.0164	No	0.1104	No
5/9/2023 7:59	0.116	0.015	0.0163	No	0.1113	No
5/9/2023 8:00	0.118	0.014	0.0161	No	0.1125	No
5/9/2023 8:01	0.116	0.016	0.0161	No	0.1135	No
5/9/2023 8:02	0.119	0.012	0.0159	No	0.1147	No
5/9/2023 8:03	0.107	0.016	0.016	No	0.1149	No
5/9/2023 8:04	0.111	0.028	0.0169	No	0.1153	No
5/9/2023 8:05	0.109	0.015	0.0169	No	0.1153	No
5/9/2023 8:06	0.109	0.012	0.0165	No	0.1152	No
5/9/2023 8:07	0.109	0.016	0.0162	No	0.1145	No
5/9/2023 8:08	0.108	0.014	0.0162	No	0.1142	No
5/9/2023 8:09	0.111	0.015	0.0161	No	0.1142	No
5/9/2023 8:10	0.109	0.013	0.0159	No	0.1138	No
5/9/2023 8:11	0.113	0.012	0.0157	No	0.1139	No
5/9/2023 8:12	0.116	0.013	0.0155	No	0.1136	No
5/9/2023 8:13	0.109	0.012	0.0149	No	0.112	No
5/9/2023 8:14	0.109	0.012	0.0147	No	0.1115	No
5/9/2023 8:15	0.113	0.014	0.0147	No	0.1112	No
5/9/2023 8:16	0.118	0.011	0.0143	No	0.1113	No
5/9/2023 8:17	0.117	0.012	0.0143	No	0.1112	No
5/9/2023 8:18	0.119	0.014	0.0142	No	0.112	No
5/9/2023 8:19	0.118	0.015	0.0133	No	0.1125	No
5/9/2023 8:20	0.117	0.015	0.0133	No	0.113	No
5/9/2023 8:21	0.122	0.025	0.0142	No	0.1139	No
5/9/2023 8:22	0.12	0.018	0.0143	No	0.1146	No
5/9/2023 8:23	0.112	0.012	0.0142	No	0.1149	No
5/9/2023 8:24	0.119	0.01	0.0139	No	0.1154	No
5/9/2023 8:25	0.116	0.011	0.0137	No	0.1159	No
5/9/2023 8:26	0.115	0.011	0.0137	No	0.116	No
5/9/2023 8:27	0.113	0.011	0.0135	No	0.1158	No
5/9/2023 8:28	0.118	0.01	0.0134	No	0.1164	No
5/9/2023 8:29	0.125	0.013	0.0135	No	0.1175	No
5/9/2023 8:30	0.128	0.014	0.0135	No	0.1185	No
5/9/2023 8:31	0.111	0.013	0.0136	No	0.118	No
5/9/2023 8:32	0.111	0.012	0.0136	No	0.1176	No
5/9/2023 8:33	0.113	0.01	0.0133	No	0.1172	No
5/9/2023 8:34	0.117	0.011	0.0131	No	0.1171	No
5/9/2023 8:35	0.119	0.012	0.0129	No	0.1173	No
5/9/2023 8:36	0.126	0.018	0.0124	No	0.1175	No
5/9/2023 8:37	0.115	0.014	0.0121	No	0.1172	No
5/9/2023 8:38	0.128	0.011	0.0121	No	0.1183	No
5/9/2023 8:39	0.195	0.01	0.0121	No	0.1233	No
5/9/2023 8:40	0.137	0.011	0.0121	No	0.1247	No
5/9/2023 8:41	0.12	0.011	0.0121	No	0.1251	No
5/9/2023 8:42	0.122	0.014	0.0123	No	0.1257	No
5/9/2023 8:43	0.125	0.013	0.0125	No	0.1261	No
5/9/2023 8:44	0.133	0.013	0.0125	No	0.1267	No
5/9/2023 8:45	0.133	0.012	0.0123	No	0.127	No
5/9/2023 8:46	0.127	0.013	0.0123	No	0.1281	No
5/9/2023 8:47	0.126	0.011	0.0123	No	0.1291	No

Upwind Station						
Time	Instaneous VOC (ppm)	Instaneous Mass Conc. Total (mg/m ³)	Mass Conc. Total mg/m ³ AVG 15m (mg/m ³)	Dust Exceedance	VOC ppm AVG 15m (ppm)	VOC Exceedance
5/9/2023 8:48	0.124	0.012	0.0124	No	0.1298	No
5/9/2023 8:49	0.125	0.011	0.0124	No	0.1303	No
5/9/2023 8:50	0.127	0.012	0.0124	No	0.1309	No
5/9/2023 8:51	0.194	0.012	0.012	No	0.1354	No
5/9/2023 8:52	0.131	0.012	0.0119	No	0.1365	No
5/9/2023 8:53	0.126	0.012	0.0119	No	0.1363	No
5/9/2023 8:54	0.136	0.014	0.0122	No	0.1324	No
5/9/2023 8:55	0.122	0.015	0.0125	No	0.1314	No
5/9/2023 8:56	0.125	0.015	0.0127	No	0.1317	No
5/9/2023 8:57	0.123	0.016	0.0129	No	0.1318	No
5/9/2023 8:58	0.135	0.014	0.0129	No	0.1325	No
5/9/2023 8:59	0.159	0.025	0.0137	No	0.1342	No
5/9/2023 9:00	0.138	0.017	0.0141	No	0.1345	No
5/9/2023 9:01	0.128	0.013	0.0141	No	0.1346	No
5/9/2023 9:02	0.131	0.016	0.0144	No	0.1349	No
5/9/2023 9:03	0.135	0.012	0.0144	No	0.1357	No
5/9/2023 9:04	0.129	0.013	0.0145	No	0.1359	No
5/9/2023 9:05	0.133	0.017	0.0149	No	0.1363	No
5/9/2023 9:06	0.132	0.012	0.0149	No	0.1322	No
5/9/2023 9:07	0.136	0.012	0.0149	No	0.1325	No
5/9/2023 9:08	0.136	0.013	0.0149	No	0.1332	No
5/9/2023 9:09	0.131	0.012	0.0148	No	0.1329	No
5/9/2023 9:10	0.139	0.011	0.0145	No	0.134	No
5/9/2023 9:11	0.136	0.011	0.0143	No	0.1347	No
5/9/2023 9:12	0.15	0.011	0.0139	No	0.1365	No
5/9/2023 9:13	0.142	0.012	0.0138	No	0.137	No
5/9/2023 9:14	0.145	0.01	0.0128	No	0.1361	No
5/9/2023 9:15	0.161	0.013	0.0125	No	0.1376	No
5/9/2023 9:16	0.156	0.015	0.0127	No	0.1395	No
5/9/2023 9:17	0.145	0.013	0.0125	No	0.1404	No
5/9/2023 9:18	0.157	0.01	0.0123	No	0.1419	No
5/9/2023 9:19	0.149	0.013	0.0123	No	0.1432	No
5/9/2023 9:20	0.157	0.012	0.012	No	0.1448	No
5/9/2023 9:21	0.155	0.011	0.0119	No	0.1463	No
5/9/2023 9:22	0.166	0.025	0.0128	No	0.1483	No
5/9/2023 9:23	0.16	0.012	0.0127	No	0.1499	No
5/9/2023 9:24	0.163	0.01	0.0126	No	0.1521	No
5/9/2023 9:25	0.174	0.011	0.0126	No	0.1544	No
5/9/2023 9:26	0.177	0.014	0.0128	No	0.1571	No
5/9/2023 9:27	0.173	0.015	0.0131	No	0.1587	No
5/9/2023 9:28	0.173	0.012	0.0131	No	0.1607	No
5/9/2023 9:29	0.176	0.009	0.013	No	0.1628	No
5/9/2023 9:30	0.172	0.013	0.013	No	0.1635	No
5/9/2023 9:31	0.174	0.012	0.0128	No	0.1647	No
5/9/2023 9:32	0.177	0.015	0.0129	No	0.1669	No
5/9/2023 9:33	0.178	0.015	0.0133	No	0.1683	No
5/9/2023 9:34	0.175	0.011	0.0131	No	0.17	No
5/9/2023 9:35	0.174	0.013	0.0132	No	0.1711	No
5/9/2023 9:36	0.169	0.01	0.0131	No	0.1721	No
5/9/2023 9:37	0.172	0.009	0.0121	No	0.1725	No
5/9/2023 9:38	0.174	0.009	0.0119	No	0.1734	No
5/9/2023 9:39	0.181	0.009	0.0118	No	0.1746	No

Upwind Station						
Time	Instaneous VOC (ppm)	Instaneous Mass Conc. Total (mg/m ³)	Mass Conc. Total mg/m ³ AVG 15m (mg/m ³)	Dust Exceedance	VOC ppm AVG 15m (ppm)	VOC Exceedance
5/9/2023 9:40	0.176	0.01	0.0117	No	0.1747	No
5/9/2023 9:41	0.176	0.01	0.0115	No	0.1747	No
5/9/2023 9:42	0.177	0.01	0.0111	No	0.1749	No
5/9/2023 9:43	0.178	0.011	0.0111	No	0.1753	No
5/9/2023 9:44	0.181	0.012	0.0113	No	0.1756	No
5/9/2023 9:45	0.18	0.011	0.0111	No	0.1761	No
5/9/2023 9:46	0.18	0.025	0.012	No	0.1765	No
5/9/2023 9:47	0.18	0.021	0.0124	No	0.1767	No
5/9/2023 9:48	0.184	0.012	0.0122	No	0.1771	No
5/9/2023 9:49	0.18	0.013	0.0123	No	0.1775	No
5/9/2023 9:50	0.189	0.012	0.0123	No	0.1785	No
5/9/2023 9:51	0.179	0.011	0.0123	No	0.1791	No
5/9/2023 9:52	0.182	0.011	0.0125	No	0.1798	No
5/9/2023 9:53	0.193	0.024	0.0135	No	0.1811	No
5/9/2023 9:54	0.191	0.028	0.0147	No	0.1817	No
5/9/2023 9:55	0.185	0.013	0.0149	No	0.1823	No
5/9/2023 9:56	0.188	0.009	0.0149	No	0.1831	No
5/9/2023 9:57	0.19	0.01	0.0149	No	0.184	No
5/9/2023 9:58	0.189	0.012	0.0149	No	0.1847	No
5/9/2023 9:59	0.188	0.012	0.0149	No	0.1852	No
5/9/2023 10:00	0.188	0.011	0.0149	No	0.1857	No
5/9/2023 10:01	0.185	0.011	0.014	No	0.1861	No
5/9/2023 10:02	0.182	0.011	0.0133	No	0.1862	No
5/9/2023 10:03	0.181	0.011	0.0133	No	0.186	No
5/9/2023 10:04	0.18	0.018	0.0136	No	0.186	No
5/9/2023 10:05	0.177	0.012	0.0136	No	0.1852	No
5/9/2023 10:06	0.174	0.011	0.0136	No	0.1849	No
5/9/2023 10:07	0.176	0.016	0.0139	No	0.1845	No
5/9/2023 10:08	0.177	0.014	0.0133	No	0.1834	No
5/9/2023 10:09	0.176	0.021	0.0128	No	0.1824	No
5/9/2023 10:10	0.171	0.01	0.0126	No	0.1815	No
5/9/2023 10:11	0.177	0.013	0.0129	No	0.1807	No
5/9/2023 10:12	0.177	0.015	0.0132	No	0.1799	No
5/9/2023 10:13	0.175	0.015	0.0134	No	0.1789	No
5/9/2023 10:14	0.174	0.009	0.0132	No	0.178	No
5/9/2023 10:15	0.165	0.011	0.0132	No	0.1765	No
5/9/2023 10:16	0.172	0.01	0.0131	No	0.1756	No
5/9/2023 10:17	0.168	0.012	0.0132	No	0.1747	No
5/9/2023 10:18	0.165	0.013	0.0133	No	0.1736	No
5/9/2023 10:19	0.166	0.01	0.0128	No	0.1727	No
5/9/2023 10:20	0.162	0.011	0.0127	No	0.1717	No
5/9/2023 10:21	0.169	0.014	0.0129	No	0.1713	No
5/9/2023 10:22	0.175	0.015	0.0129	No	0.1713	No
5/9/2023 10:23	0.166	0.014	0.0129	No	0.1705	No
5/9/2023 10:24	0.247	0.011	0.0122	No	0.1753	No
5/9/2023 10:25	0.193	0.01	0.0122	No	0.1767	No
5/9/2023 10:26	0.195	0.012	0.0121	No	0.1779	No
5/9/2023 10:27	0.166	0.013	0.012	No	0.1772	No
5/9/2023 10:28	0.165	0.012	0.0118	No	0.1765	No
5/9/2023 10:29	0.168	0.011	0.0119	No	0.1761	No
5/9/2023 10:30	0.165	0.012	0.012	No	0.1761	No
5/9/2023 10:31	0.16	0.013	0.0122	No	0.1753	No

Upwind Station						
Time	Instaneous VOC (ppm)	Instaneous Mass Conc. Total (mg/m ³)	Mass Conc. Total mg/m ³ AVG 15m (mg/m ³)	Dust Exceedance	VOC ppm AVG 15m (ppm)	VOC Exceedance
5/9/2023 10:32	0.167	0.032	0.0135	No	0.1753	No
5/9/2023 10:33	0.167	0.014	0.0136	No	0.1754	No
5/9/2023 10:34	0.169	0.02	0.0143	No	0.1756	No
5/9/2023 10:35	0.172	0.022	0.015	No	0.1763	No
5/9/2023 10:36	0.173	0.018	0.0153	No	0.1765	No
5/9/2023 10:37	0.166	0.021	0.0157	No	0.1759	No
5/9/2023 10:38	0.169	0.032	0.0169	No	0.1761	No
5/9/2023 10:39	0.166	0.018	0.0173	No	0.1707	No
5/9/2023 10:40	0.158	0.014	0.0176	No	0.1684	No
5/9/2023 10:41	0.162	0.01	0.0175	No	0.1662	No
5/9/2023 10:42	0.16	0.015	0.0176	No	0.1658	No
5/9/2023 10:43	0.157	0.009	0.0174	No	0.1653	No
5/9/2023 10:44	0.16	0.012	0.0175	No	0.1647	No
5/9/2023 10:45	0.159	0.015	0.0177	No	0.1643	No
5/9/2023 10:46	0.156	0.009	0.0174	No	0.1641	No
5/9/2023 10:47	0.158	0.01	0.0159	No	0.1635	No
5/9/2023 10:48	0.159	0.01	0.0157	No	0.1629	No
5/9/2023 10:49	0.161	0.016	0.0154	No	0.1624	No
5/9/2023 10:50	0.158	0.016	0.015	No	0.1615	No
5/9/2023 10:51	0.156	0.009	0.0144	No	0.1603	No
5/9/2023 10:52	0.157	0.014	0.0139	No	0.1597	No
5/9/2023 10:53	0.16	0.013	0.0127	No	0.1591	No
5/9/2023 10:54	0.161	0.045	0.0145	No	0.1588	No
5/9/2023 10:55	0.165	0.019	0.0148	No	0.1593	No
5/9/2023 10:56	0.162	0.02	0.0155	No	0.1593	No
5/9/2023 10:57	0.167	0.021	0.0159	No	0.1597	No
5/9/2023 10:58	0.161	0.013	0.0161	No	0.16	No
5/9/2023 10:59	0.165	0.011	0.0161	No	0.1603	No
5/9/2023 11:00	0.163	0.016	0.0161	No	0.1606	No
5/9/2023 11:01	0.167	0.01	0.0162	No	0.1613	No
5/9/2023 11:02	0.165	0.014	0.0165	No	0.1618	No
5/9/2023 11:03	0.167	0.011	0.0165	No	0.1623	No
5/9/2023 11:04	0.164	0.01	0.0161	No	0.1625	No
5/9/2023 11:05	0.165	0.01	0.0157	No	0.163	No
5/9/2023 11:06	0.164	0.01	0.0158	No	0.1635	No
5/9/2023 11:07	0.175	0.023	0.0164	No	0.1647	No
5/9/2023 11:08	0.329	0.012	0.0163	No	0.176	No
5/9/2023 11:09	0.17	0.01	0.014	No	0.1766	No
5/9/2023 11:10	0.17	0.011	0.0135	No	0.1769	No
5/9/2023 11:11	0.175	0.009	0.0127	No	0.1778	No
5/9/2023 11:12	0.176	0.01	0.012	No	0.1784	No
5/9/2023 11:13	0.174	0.008	0.0117	No	0.1793	No
5/9/2023 11:14	0.177	0.008	0.0115	No	0.1801	No
5/9/2023 11:15	0.179	0.009	0.011	No	0.1811	No
5/9/2023 11:16	0.181	0.01	0.011	No	0.1821	No
5/9/2023 11:17	0.175	0.009	0.0107	No	0.1827	No
5/9/2023 11:18	0.191	0.013	0.0108	No	0.1843	No
5/9/2023 11:19	0.179	0.019	0.0114	No	0.1853	No
5/9/2023 11:20	0.194	0.014	0.0117	No	0.1873	No
5/9/2023 11:21	0.191	0.01	0.0117	No	0.1891	No
5/9/2023 11:22	0.188	0.01	0.0108	No	0.1899	No
5/9/2023 11:23	0.201	0.024	0.0116	No	0.1814	No

Upwind Station						
Time	Instaneous VOC (ppm)	Instaneous Mass Conc. Total (mg/m ³)	Mass Conc. Total mg/m ³ AVG 15m (mg/m ³)	Dust Exceedance	VOC ppm AVG 15m (ppm)	VOC Exceedance
5/9/2023 11:24	0.208	0.012	0.0117	No	0.1839	No
5/9/2023 11:25	0.2	0.012	0.0118	No	0.1859	No
5/9/2023 11:26	0.197	0.013	0.0121	No	0.1874	No
5/9/2023 11:27	0.222	0.016	0.0125	No	0.1905	No
5/9/2023 11:28	0.207	0.009	0.0125	No	0.1927	No
5/9/2023 11:29	0.212	0.013	0.0129	No	0.195	No
5/9/2023 11:30	0.207	0.016	0.0133	No	0.1969	No
5/9/2023 11:31	0.219	0.024	0.0143	No	0.1994	No
5/9/2023 11:32	0.209	0.012	0.0145	No	0.2017	No
5/9/2023 11:33	0.21	0.008	0.0141	No	0.2029	No
5/9/2023 11:34	0.214	0.007	0.0133	No	0.2053	No
5/9/2023 11:35	0.217	0.008	0.0129	No	0.2068	No
5/9/2023 11:36	0.239	0.01	0.0129	No	0.21	No
5/9/2023 11:37	0.224	0.01	0.0129	No	0.2124	No
5/9/2023 11:38	0.218	0.009	0.0119	No	0.2135	No
5/9/2023 11:39	0.22	0.008	0.0117	No	0.2143	No
5/9/2023 11:40	0.242	0.008	0.0114	No	0.2171	No
5/9/2023 11:41	0.243	0.012	0.0113	No	0.2202	No
5/9/2023 11:42	0.238	0.01	0.0109	No	0.2213	No
5/9/2023 11:43	0.236	0.01	0.011	No	0.2232	No
5/9/2023 11:44	0.233	0.011	0.0109	No	0.2246	No
5/9/2023 11:45	0.232	0.014	0.0107	No	0.2263	No
5/9/2023 11:46	0.233	0.009	0.0097	No	0.2272	No
5/9/2023 11:47	0.236	0.009	0.0095	No	0.229	No
5/9/2023 11:48	0.236	0.01	0.0097	No	0.2307	No
5/9/2023 11:49	0.238	0.01	0.0099	No	0.2323	No
5/9/2023 11:50	0.232	0.012	0.0101	No	0.2333	No
5/9/2023 11:51	0.237	0.01	0.0101	No	0.2332	No
5/9/2023 11:52	0.992	0.018	0.0107	No	0.2844	No
5/9/2023 11:53	0.66	0.191	0.0228	No	0.3139	No
5/9/2023 11:54	0.673	0.103	0.0291	No	0.3441	No
5/9/2023 11:55	0.306	0.025	0.0303	No	0.3483	No
5/9/2023 11:56	0.262	0.01	0.0301	No	0.3496	No
5/9/2023 11:57	0.264	0.008	0.03	No	0.3513	No
5/9/2023 11:58	0.257	0.009	0.0299	No	0.3527	No
5/9/2023 11:59	0.258	0.015	0.0302	No	0.3544	No
5/9/2023 12:00	0.493	0.051	0.0327	No	0.3718	No
5/9/2023 12:01	16.327	0.634	0.0743	No	1.4447	No
5/9/2023 12:02	0.492	0.423	0.1019	No	1.4618	No
5/9/2023 12:03	2.761	0.018	0.1025	No	1.6301	No
5/9/2023 12:04	0.512	0.166	0.1129	No	1.6484	No
5/9/2023 12:05	0.316	0.011	0.1128	No	1.654	No
5/9/2023 12:06	0.303	0.009	0.1127	No	1.6584	No
5/9/2023 12:07	3.976	0.216	0.1259	No	1.8573	No
5/9/2023 12:08	0.595	0.204	0.1268	No	1.853	No
5/9/2023 12:09	1.688	0.05	0.1233	No	1.9207	No
5/9/2023 12:10	0.483	0.04	0.1243	No	1.9325	No
5/9/2023 12:11	0.372	0.019	0.1249	No	1.9398	No
5/9/2023 12:12	0.329	0.017	0.1255	No	1.9441	No
5/9/2023 12:13	0.309	0.012	0.1257	No	1.9476	No
5/9/2023 12:14	0.294	0.014	0.1256	No	1.95	No
5/9/2023 12:15	0.282	0.007	0.1227	No	1.9359	No

Upwind Station						
Time	Instaneous VOC (ppm)	Instaneous Mass Conc. Total (mg/m ³)	Mass Conc. Total mg/m ³ AVG 15m (mg/m ³)	Dust Exceedance	VOC ppm AVG 15m (ppm)	VOC Exceedance
5/9/2023 12:16	0.286	0.008	0.0809	No	0.8665	No
5/9/2023 12:17	0.307	0.009	0.0533	No	0.8542	No
5/9/2023 12:18	0.366	0.015	0.0531	No	0.6945	No
5/9/2023 12:19	0.293	0.012	0.0429	No	0.6799	No
5/9/2023 12:20	0.289	0.009	0.0427	No	0.6781	No
5/9/2023 12:21	0.299	0.014	0.0431	No	0.6779	No
5/9/2023 12:22	0.274	0.009	0.0293	No	0.4311	No
5/9/2023 12:23	0.271	0.008	0.0162	No	0.4095	No
5/9/2023 12:24	0.27	0.007	0.0133	No	0.3149	No
5/9/2023 12:25	0.273	0.008	0.0112	No	0.3009	No
5/9/2023 12:26	0.283	0.008	0.0105	No	0.295	No
5/9/2023 12:27	0.278	0.008	0.0099	No	0.2916	No
5/9/2023 12:28	0.258	0.008	0.0096	No	0.2882	No
5/9/2023 12:29	0.258	0.009	0.0093	No	0.2858	No
5/9/2023 12:30	0.289	0.008	0.0093	No	0.2863	No
5/9/2023 12:31	0.308	0.008	0.0093	No	0.2877	No
5/9/2023 12:32	0.301	0.013	0.0096	No	0.2873	No
5/9/2023 12:33	0.289	0.01	0.0093	No	0.2822	No
5/9/2023 12:34	0.277	0.011	0.0092	No	0.2811	No
5/9/2023 12:35	0.288	0.013	0.0095	No	0.2811	No
5/9/2023 12:36	0.292	0.011	0.0093	No	0.2806	No
5/9/2023 12:37	0.291	0.009	0.0093	No	0.2817	No
5/9/2023 12:38	0.307	0.015	0.0097	No	0.2841	No
5/9/2023 12:39	0.281	0.013	0.0101	No	0.2849	No
5/9/2023 12:40	0.285	0.008	0.0101	No	0.2857	No
5/9/2023 12:41	0.281	0.007	0.0101	No	0.2855	No
5/9/2023 12:42	0.27	0.008	0.0101	No	0.285	No
5/9/2023 12:43	0.283	0.008	0.0101	No	0.2867	No
5/9/2023 12:44	0.267	0.009	0.0101	No	0.2873	No
5/9/2023 12:45	0.268	0.011	0.0103	No	0.2859	No
5/9/2023 12:46	0.278	0.011	0.0105	No	0.2839	No
5/9/2023 12:47	0.274	0.009	0.0102	No	0.2821	No
5/9/2023 12:48	0.267	0.012	0.0103	No	0.2806	No
5/9/2023 12:49	0.278	0.011	0.0103	No	0.2807	No
5/9/2023 12:50	0.262	0.018	0.0107	No	0.2789	No
5/9/2023 12:51	0.252	0.007	0.0104	No	0.2763	No
5/9/2023 12:52	0.254	0.007	0.0103	No	0.2738	No
5/9/2023 12:53	0.241	0.006	0.0097	No	0.2694	No
5/9/2023 12:54	0.232	0.007	0.0093	No	0.2661	No
5/9/2023 12:55	0.229	0.012	0.0095	No	0.2624	No
5/9/2023 12:56	0.231	0.009	0.0097	No	0.2591	No
5/9/2023 12:57	0.223	0.008	0.0097	No	0.2559	No
5/9/2023 12:58	0.238	0.007	0.0096	No	0.2529	No
5/9/2023 12:59	0.224	0.009	0.0096	No	0.2501	No
5/9/2023 13:00	0.237	0.008	0.0094	No	0.248	No
5/9/2023 13:01	0.224	0.012	0.0095	No	0.2444	No
5/9/2023 13:02	0.225	0.013	0.0097	No	0.2411	No
5/9/2023 13:03	0.238	0.013	0.0098	No	0.2392	No
5/9/2023 13:04	0.234	0.011	0.0098	No	0.2363	No
5/9/2023 13:05	0.242	0.012	0.0094	No	0.2349	No
5/9/2023 13:06	0.231	0.015	0.0099	No	0.2335	No
5/9/2023 13:07	0.22	0.01	0.0101	No	0.2313	No

Upwind Station						
Time	Instaneous VOC (ppm)	Instaneous Mass Conc. Total (mg/m ³)	Mass Conc. Total mg/m ³ AVG 15m (mg/m ³)	Dust Exceedance	VOC ppm AVG 15m (ppm)	VOC Exceedance
5/9/2023 13:08	0.228	0.009	0.0103	No	0.2304	No
5/9/2023 13:09	0.207	0.008	0.0104	No	0.2287	No
5/9/2023 13:10	0.21	0.012	0.0104	No	0.2275	No
5/9/2023 13:11	0.213	0.013	0.0107	No	0.2263	No
5/9/2023 13:12	0.209	0.011	0.0109	No	0.2253	No
5/9/2023 13:13	0.222	0.011	0.0111	No	0.2243	No
5/9/2023 13:14	0.22	0.011	0.0113	No	0.224	No
5/9/2023 13:15	0.208	0.01	0.0114	No	0.2221	No
5/9/2023 13:16	0.219	0.008	0.0111	No	0.2217	No
5/9/2023 13:17	0.213	0.008	0.0108	No	0.2209	No
5/9/2023 13:18	0.23	0.028	0.0118	No	0.2204	No
5/9/2023 13:19	0.226	0.014	0.012	No	0.2199	No
5/9/2023 13:20	0.241	0.013	0.0121	No	0.2198	No
5/9/2023 13:21	0.227	0.019	0.0123	No	0.2195	No
5/9/2023 13:22	0.218	0.013	0.0125	No	0.2194	No
5/9/2023 13:23	0.211	0.012	0.0127	No	0.2183	No
5/9/2023 13:24	0.212	0.01	0.0129	No	0.2186	No
5/9/2023 13:25	0.208	0.018	0.0133	No	0.2185	No
5/9/2023 13:26	0.206	0.009	0.013	No	0.218	No
5/9/2023 13:27	0.217	0.01	0.0129	No	0.2185	No
5/9/2023 13:28	0.207	0.009	0.0128	No	0.2175	No
5/9/2023 13:29	0.198	0.011	0.0128	No	0.2161	No
5/9/2023 13:30	0.204	0.009	0.0127	No	0.2158	No
5/9/2023 13:31	0.206	0.009	0.0128	No	0.2149	No
5/9/2023 13:32	0.2	0.009	0.0129	No	0.2141	No
5/9/2023 13:33	0.209	0.011	0.0117	No	0.2127	No
5/9/2023 13:34	0.211	0.009	0.0114	No	0.2117	No
5/9/2023 13:35	0.213	0.013	0.0114	No	0.2098	No
5/9/2023 13:36	0.215	0.015	0.0111	No	0.209	No
5/9/2023 13:37	0.221	0.012	0.0111	No	0.2092	No
5/9/2023 13:38	0.214	0.011	0.011	No	0.2094	No
5/9/2023 13:39	0.219	0.021	0.0117	No	0.2099	No
5/9/2023 13:40	0.215	0.013	0.0114	No	0.2103	No
5/9/2023 13:41	0.207	0.009	0.0114	No	0.2104	No
5/9/2023 13:42	0.205	0.01	0.0114	No	0.2096	No
5/9/2023 13:43	0.202	0.008	0.0113	No	0.2093	No
5/9/2023 13:44	0.214	0.008	0.0111	No	0.2103	No
5/9/2023 13:45	0.202	0.008	0.0111	No	0.2102	No
5/9/2023 13:46	0.202	0.008	0.011	No	0.2099	No
5/9/2023 13:47	0.202	0.008	0.0109	No	0.2101	No
5/9/2023 13:48	0.215	0.01	0.0109	No	0.2105	No
5/9/2023 13:49	0.215	0.01	0.0109	No	0.2107	No
5/9/2023 13:50	0.221	0.01	0.0107	No	0.2113	No
5/9/2023 13:51	0.213	0.013	0.0106	No	0.2111	No
5/9/2023 13:52	0.208	0.01	0.0105	No	0.2103	No
5/9/2023 13:53	0.212	0.01	0.0104	No	0.2101	No
5/9/2023 13:54	0.21	0.012	0.0098	No	0.2095	No
5/9/2023 13:55	0.212	0.019	0.0102	No	0.2093	No
5/9/2023 13:56	0.218	0.012	0.0104	No	0.2101	No
5/9/2023 13:57	0.212	0.013	0.0106	No	0.2105	No
5/9/2023 13:58	0.218	0.012	0.0109	No	0.2116	No
5/9/2023 13:59	0.216	0.012	0.0111	No	0.2117	No

Upwind Station						
Time	Instaneous VOC (ppm)	Instaneous Mass Conc. Total (mg/m ³)	Mass Conc. Total mg/m ³ AVG 15m (mg/m ³)	Dust Exceedance	VOC ppm AVG 15m (ppm)	VOC Exceedance
5/9/2023 14:00	0.211	0.011	0.0113	No	0.2123	No
5/9/2023 14:01	0.206	0.01	0.0115	No	0.2126	No
5/9/2023 14:02	0.209	0.017	0.0121	No	0.2131	No
5/9/2023 14:03	0.206	0.011	0.0121	No	0.2125	No
5/9/2023 14:04	0.208	0.009	0.0121	No	0.212	No
5/9/2023 14:05	0.216	0.012	0.0122	No	0.2117	No
5/9/2023 14:06	0.22	0.014	0.0123	No	0.2121	No
5/9/2023 14:07	0.217	0.016	0.0127	No	0.2127	No
5/9/2023 14:08	0.208	0.017	0.0131	No	0.2125	No
5/9/2023 14:09	0.204	0.012	0.0131	No	0.2121	No
5/9/2023 14:10	0.217	0.013	0.0127	No	0.2124	No
5/9/2023 14:11	0.204	0.02	0.0133	No	0.2115	No
5/9/2023 14:12	0.203	0.011	0.0131	No	0.2109	No
5/9/2023 14:13	0.209	0.015	0.0133	No	0.2103	No
5/9/2023 14:14	0.201	0.011	0.0133	No	0.2093	No
5/9/2023 14:15	0.194	0.01	0.0132	No	0.2081	No
5/9/2023 14:16	0.202	0.01	0.0132	No	0.2079	No
5/9/2023 14:17	0.208	0.01	0.0127	No	0.2078	No
5/9/2023 14:18	0.196	0.009	0.0126	No	0.2071	No
5/9/2023 14:19	0.199	0.011	0.0127	No	0.2065	No
5/9/2023 14:20	0.218	0.016	0.013	No	0.2067	No
5/9/2023 14:21	0.207	0.015	0.0131	No	0.2058	No
5/9/2023 14:22	0.194	0.009	0.0126	No	0.2043	No
5/9/2023 14:23	0.198	0.011	0.0122	No	0.2036	No
5/9/2023 14:24	0.199	0.018	0.0126	No	0.2033	No
5/9/2023 14:25	0.193	0.015	0.0127	No	0.2017	No
5/9/2023 14:26	0.184	0.013	0.0123	No	0.2003	No
5/9/2023 14:27	0.191	0.016	0.0126	No	0.1995	No
5/9/2023 14:28	0.179	0.015	0.0126	No	0.1975	No
5/9/2023 14:29	0.179	0.015	0.0129	No	0.1961	No
5/9/2023 14:30	0.179	0.035	0.0145	No	0.1951	No
5/9/2023 14:31	0.181	0.009	0.0145	No	0.1937	No
5/9/2023 14:32	0.179	0.008	0.0143	No	0.1917	No
5/9/2023 14:33	0.174	0.007	0.0142	No	0.1903	No
5/9/2023 14:34	0.176	0.01	0.0141	No	0.1887	No
5/9/2023 14:35	0.18	0.013	0.0139	No	0.1862	No
5/9/2023 14:36	0.184	0.012	0.0137	No	0.1847	No
5/9/2023 14:37	0.183	0.011	0.0139	No	0.1839	No
5/9/2023 14:38	0.172	0.083	0.0187	No	0.1822	No
5/9/2023 14:39	0.174	0.012	0.0183	No	0.1805	No
5/9/2023 14:40	0.169	0.01	0.0179	No	0.1789	No
5/9/2023 14:41	0.166	0.007	0.0175	No	0.1777	No
5/9/2023 14:42	0.172	0.033	0.0187	No	0.1765	No
5/9/2023 14:43	0.17	0.035	0.02	No	0.1759	No
5/9/2023 14:44	0.174	0.008	0.0195	No	0.1755	No
5/9/2023 14:45	0.177	0.013	0.0181	No	0.1754	No
5/9/2023 14:46	0.174	0.019	0.0187	No	0.1749	No
5/9/2023 14:47	0.17	0.014	0.0191	No	0.1743	No
5/9/2023 14:48	0.171	0.007	0.0191	No	0.1741	No
5/9/2023 14:49	0.167	0.007	0.0189	No	0.1735	No
5/9/2023 14:50	0.167	0.008	0.0186	No	0.1727	No
5/9/2023 14:51	0.162	0.008	0.0183	No	0.1712	No

Upwind Station						
Time	Instaneous VOC (ppm)	Instaneous Mass Conc. Total (mg/m ³)	Mass Conc. Total mg/m ³ AVG 15m (mg/m ³)	Dust Exceedance	VOC ppm AVG 15m (ppm)	VOC Exceedance
5/9/2023 14:52	0.165	0.007	0.0181	No	0.17	No
5/9/2023 14:53	0.166	0.011	0.0133	No	0.1696	No
5/9/2023 14:54	0.168	0.013	0.0133	No	0.1692	No
5/9/2023 14:55	0.166	0.015	0.0137	No	0.169	No
5/9/2023 14:56	0.167	0.015	0.0142	No	0.1691	No
5/9/2023 14:57	0.165	0.011	0.0127	No	0.1686	No
5/9/2023 14:58	0.163	0.011	0.0111	No	0.1681	No
5/9/2023 14:59	0.171	0.01	0.0113	No	0.1679	No
5/9/2023 15:00	0.164	0.012	0.0112	No	0.1671	No
5/9/2023 15:01	0.16	0.017	0.0111	No	0.1661	No
5/9/2023 15:02	0.16	0.034	0.0124	No	0.1655	No
5/9/2023 15:03	0.157	0.03	0.0139	No	0.1645	No
5/9/2023 15:04	0.164	0.018	0.0147	No	0.1643	No
5/9/2023 15:05	0.171	0.016	0.0152	No	0.1646	No
5/9/2023 15:06	0.171	0.046	0.0177	No	0.1652	No
5/9/2023 15:07	0.181	0.033	0.0195	No	0.1663	No
5/9/2023 15:08	0.166	0.042	0.0215	No	0.1663	No
5/9/2023 15:09	0.161	0.045	0.0237	No	0.1658	No
5/9/2023 15:10	0.159	0.035	0.025	No	0.1653	No
5/9/2023 15:11	0.16	0.021	0.0254	No	0.1649	No
5/9/2023 15:12	0.156	0.023	0.0262	No	0.1643	No
5/9/2023 15:13	0.155	0.013	0.0263	No	0.1637	No
5/9/2023 15:14	0.158	0.02	0.027	No	0.1629	No
5/9/2023 15:15	0.157	0.023	0.0277	No	0.1624	No
5/9/2023 15:16	0.158	0.02	0.0279	No	0.1623	No
5/9/2023 15:17	0.165	0.023	0.0272	No	0.1626	No
5/9/2023 15:18	0.165	0.032	0.0273	No	0.1631	No
5/9/2023 15:19	0.167	0.023	0.0277	No	0.1633	No
5/9/2023 15:20	0.162	0.015	0.0276	No	0.1627	No
5/9/2023 15:21	0.161	0.016	0.0256	No	0.1621	No
5/9/2023 15:22	0.165	0.016	0.0245	No	0.161	No
5/9/2023 15:23	0.165	0.033	0.0239	No	0.1609	No
5/9/2023 15:24	0.162	0.026	0.0226	No	0.161	No
5/9/2023 15:25	0.168	0.019	0.0215	No	0.1616	No
5/9/2023 15:26	0.168	0.021	0.0215	No	0.1621	No
5/9/2023 15:27	0.162	0.027	0.0218	No	0.1625	No
5/9/2023 15:28	0.151	0.012	0.0217	No	0.1623	No
5/9/2023 15:29	0.155	0.013	0.0213	No	0.1621	No
5/9/2023 15:30	0.182	0.018	0.0209	No	0.1637	No
5/9/2023 15:31	0.198	0.031	0.0217	No	0.1664	No
5/9/2023 15:32	0.176	0.044	0.0231	No	0.1671	No
5/9/2023 15:33	0.167	0.18	0.0329	No	0.1673	No
5/9/2023 15:34	0.151	0.034	0.0337	No	0.1662	No
5/9/2023 15:35	0.148	0.022	0.0341	No	0.1653	No
5/9/2023 15:36	0.143	0.025	0.0347	No	0.1641	No
5/9/2023 15:37	0.147	0.016	0.0347	No	0.1629	No
5/9/2023 15:38	0.142	0.017	0.0337	No	0.1613	No
5/9/2023 15:39	0.143	0.024	0.0335	No	0.1601	No
5/9/2023 15:40	0.145	0.013	0.0331	No	0.1585	No
5/9/2023 15:41	0.149	0.014	0.0327	No	0.1573	No
5/9/2023 15:42	0.149	0.014	0.0318	No	0.1564	No
5/9/2023 15:43	0.154	0.014	0.0319	No	0.1566	No

Upwind Station						
Time	Instantaneous VOC (ppm)	Instantaneous Mass Conc. Total (mg/m ³)	Mass Conc. Total mg/m ³ AVG 15m (mg/m ³)	Dust Exceedance	VOC ppm AVG 15m (ppm)	VOC Exceedance
5/9/2023 15:44	0.145	0.012	0.0319	No	0.1559	No
5/9/2023 15:45	0.145	0.011	0.0314	No	0.1535	No
5/9/2023 15:46	0.146	0.014	0.0303	No	0.15	No
5/9/2023 15:47	0.147	0.018	0.0285	No	0.1481	No
5/9/2023 15:48	0.147	0.014	0.0175	No	0.1467	No
5/9/2023 15:49	0.14	0.011	0.0159	No	0.146	No
5/9/2023 15:50	0.171	0.011	0.0152	No	0.1475	No
5/9/2023 15:51	0.141	0.011	0.0143	No	0.1474	No
5/9/2023 15:52	0.131	0.013	0.0141	No	0.1463	No
5/9/2023 15:53	0.132	0.013	0.0138	No	0.1457	No
5/9/2023 15:54	0.142	0.013	0.0131	No	0.1456	No
5/9/2023 15:55	0.132	0.015	0.0132	No	0.1447	No
5/9/2023 15:56	0.131	0.018	0.0135	No	0.1435	No
5/9/2023 15:57	0.127	0.02	0.0139	No	0.1421	No
5/9/2023 15:58	0.134	0.016	0.014	No	0.1407	No
5/9/2023 15:59	0.133	0.014	0.0141	No	0.1399	No
5/9/2023 16:00	0.186	0.021	0.0148	No	0.1427	No
5/9/2023 16:01	0.165	0.015	0.0149	No	0.1439	No
5/9/2023 16:02	0.149	0.016	0.0147	No	0.1441	No
5/9/2023 16:03	0.141	0.018	0.015	No	0.1437	No
5/9/2023 16:04	0.13	0.015	0.0153	No	0.143	No
5/9/2023 16:05	0.134	0.014	0.0155	No	0.1405	No
5/9/2023 16:06	0.165	0.016	0.0158	No	0.1421	No
5/9/2023 16:07	0.141	0.014	0.0159	No	0.1428	No
5/9/2023 16:08	0.149	0.015	0.016	No	0.1439	No
5/9/2023 16:09	0.144	0.014	0.0161	No	0.1441	No
5/9/2023 16:10	0.149	0.012	0.0159	No	0.1452	No
5/9/2023 16:11	0.151	0.016	0.0157	No	0.1465	No
5/9/2023 16:12	0.156	0.013	0.0153	No	0.1485	No
5/9/2023 16:13	0.154	0.018	0.0154	No	0.1498	No
5/9/2023 16:14	0.168	0.019	0.0157	No	0.1521	No
5/9/2023 16:15	0.176	0.026	0.0161	No	0.1515	No
5/9/2023 16:16	0.154	0.019	0.0163	No	0.1507	No
5/9/2023 16:17	0.157	0.016	0.0163	No	0.1513	No
5/9/2023 16:18	0.153	0.013	0.016	No	0.1521	No
5/9/2023 16:19	0.153	0.013	0.0159	No	0.1536	No
5/9/2023 16:20	0.152	0.016	0.016	No	0.1548	No
5/9/2023 16:21	0.159	0.015	0.0159	No	0.1544	No
5/9/2023 16:22	0.161	0.017	0.0161	No	0.1557	No
5/9/2023 16:23	0.157	0.014	0.0161	No	0.1563	No
5/9/2023 16:24	0.147	0.012	0.0159	No	0.1565	No
5/9/2023 16:25	0.147	0.013	0.016	No	0.1563	No
5/9/2023 16:26	0.15	0.015	0.0159	No	0.1563	No
5/9/2023 16:27	0.148	0.013	0.0159	No	0.1557	No
5/9/2023 16:28	0.154	0.014	0.0157	No	0.1557	No
5/9/2023 16:29	0.151	0.012	0.0152	No	0.1546	No
5/9/2023 16:30	0.152	0.012	0.0143	No	0.153	No
5/9/2023 16:31	0.141	0.014	0.0139	No	0.1521	No
5/9/2023 16:32	0.147	0.013	0.0137	No	0.1515	No
5/9/2023 16:33	0.151	0.013	0.0137	No	0.1513	No
5/9/2023 16:34	0.141	0.012	0.0137	No	0.1505	No
5/9/2023 16:35	0.14	0.01	0.0133	No	0.1497	No

Upwind Station						
Time	Instaneous VOC (ppm)	Instaneous Mass Conc. Total (mg/m ³)	Mass Conc. Total mg/m ³ AVG 15m (mg/m ³)	Dust Exceedance	VOC ppm AVG 15m (ppm)	VOC Exceedance
5/9/2023 16:36	0.142	0.011	0.013	No	0.1486	No
5/9/2023 16:37	0.137	0.012	0.0127	No	0.147	No
5/9/2023 16:38	0.134	0.012	0.0125	No	0.1455	No
5/9/2023 16:39	0.137	0.011	0.0125	No	0.1448	No
5/9/2023 16:40	0.132	0.011	0.0123	No	0.1438	No
5/9/2023 16:41	0.131	0.011	0.0121	No	0.1425	No
5/9/2023 16:42	0.141	0.012	0.012	No	0.1421	No
5/9/2023 16:43	0.143	0.012	0.0119	No	0.1413	No
5/9/2023 16:44	0.137	0.012	0.0119	No	0.1404	No
5/9/2023 16:45	0.136	0.012	0.0119	No	0.1393	No
5/9/2023 16:46	0.133	0.013	0.0118	No	0.1388	No
5/9/2023 16:47	0.143	0.012	0.0117	No	0.1385	No
5/9/2023 16:48	0.15	0.013	0.0117	No	0.1385	No
5/9/2023 16:49	0.153	0.015	0.0119	No	0.1393	No
5/9/2023 16:50	0.148	0.014	0.0122	No	0.1398	No
5/9/2023 16:51	0.147	0.015	0.0125	No	0.1401	No
5/9/2023 16:52	0.152	0.015	0.0127	No	0.1411	No
5/9/2023 16:53	0.152	0.015	0.0129	No	0.1423	No
5/9/2023 16:54	0.152	0.013	0.013	No	0.1433	No
5/9/2023 16:55	0.143	0.013	0.0131	No	0.1441	No
5/9/2023 16:56	0.14	0.014	0.0133	No	0.1447	No
5/9/2023 16:57	0.138	0.013	0.0134	No	0.1445	No
5/9/2023 16:58	0.139	0.014	0.0135	No	0.1442	No
5/9/2023 16:59	0.141	0.013	0.0136	No	0.1445	No
5/9/2023 17:00	0.142	0.012	0.0136	No	0.1449	No
5/9/2023 17:01	0.132	0.012	0.0135	No	0.1448	No
5/9/2023 17:02	0.133	0.013	0.0136	No	0.1441	No
5/9/2023 17:03	0.129	0.012	0.0135	No	0.1427	No
5/9/2023 17:04	0.135	0.012	0.0133	No	0.1415	No
5/9/2023 17:05	0.135	0.011	0.0131	No	0.1407	No
5/9/2023 17:06	0.126	0.011	0.0129	No	0.1393	No
5/9/2023 17:07	0.133	0.012	0.0127	No	0.138	No
5/9/2023 17:08	0.133	0.013	0.0125	No	0.1367	No
5/9/2023 17:09	0.129	0.012	0.0125	No	0.1352	No
5/9/2023 17:10	0.129	0.011	0.0123	No	0.1343	No
5/9/2023 17:11	0.138	0.012	0.0122	No	0.1341	No
5/9/2023 17:12	0.128	0.013	0.0122	No	0.1335	No
5/9/2023 17:13	0.14	0.015	0.0123	No	0.1335	No
5/9/2023 17:14	0.135	0.011	0.0121	No	0.1331	No
5/9/2023 17:15	0.143	0.012	0.0121	No	0.1332	No
5/9/2023 17:16	0.133	0.018	0.0125	No	0.1333	No
5/9/2023 17:17	0.139	0.012	0.0125	No	0.1337	No
5/9/2023 17:18	0.13	0.017	0.0128	No	0.1337	No
5/9/2023 17:19	0.131	0.014	0.0129	No	0.1335	No
5/9/2023 17:20	0.128	0.013	0.0131	No	0.133	No
5/9/2023 17:21	0.135	0.012	0.0131	No	0.1336	No
5/9/2023 17:22	0.139	0.012	0.0131	No	0.134	No
5/9/2023 17:23	0.131	0.015	0.0133	No	0.1339	No
5/9/2023 17:24	0.134	0.011	0.0132	No	0.1342	No

Downwind Station						
Time	Instaneous VOC (ppm)	Instaneous Mass Conc. Total (mg/m ³)	Mass Conc. Total mg/m ³ AVG 15m (mg/m ³)	Dust Exceedance	VOC ppm AVG 15m (ppm)	VOC Exceedance
5/9/2023 7:08		0.013	0.013	No		No
5/9/2023 7:09		0.016	0.0145	No		No
5/9/2023 7:11	0.113	0.011	0.0133	No	0.113	No
5/9/2023 7:12	0.09	0.013	0.0132	No	0.1015	No
5/9/2023 7:13	0.081	0.015	0.0136	No	0.0947	No
5/9/2023 7:14	0.069	0.082	0.025	No	0.0883	No
5/9/2023 7:15	0.069	0.016	0.0237	No	0.0844	No
5/9/2023 7:16	0.068	0.014	0.0225	No	0.0817	No
5/9/2023 7:17	0.057	0.016	0.0218	No	0.0781	No
5/9/2023 7:18	0.067	0.016	0.0212	No	0.0768	No
5/9/2023 7:19	0.053	0.021	0.0212	No	0.0741	No
5/9/2023 7:20	0.056	0.025	0.0215	No	0.0723	No
5/9/2023 7:21	0.051	0.017	0.0212	No	0.0704	No
5/9/2023 7:22	0.053	0.017	0.0209	No	0.0689	No
5/9/2023 7:23	0.047	0.023	0.0216	No	0.0672	No
5/9/2023 7:24	0.04	0.02	0.0219	No	0.0653	No
5/9/2023 7:25	0.042	0.019	0.0217	No	0.0637	No
5/9/2023 7:26	0.038	0.018	0.0221	No	0.0587	No
5/9/2023 7:27	0.029	0.021	0.0227	No	0.0547	No
5/9/2023 7:28	0.03	0.021	0.0231	No	0.0513	No
5/9/2023 7:29	0.034	0.019	0.0189	No	0.0489	No
5/9/2023 7:30	0.021	0.018	0.019	No	0.0457	No
5/9/2023 7:31	0.03	0.029	0.02	No	0.0432	No
5/9/2023 7:32	0.004	0.025	0.0206	No	0.0397	No
5/9/2023 7:33	0.014	0.03	0.0215	No	0.0361	No
5/9/2023 7:34	0.013	0.025	0.0218	No	0.0335	No
5/9/2023 7:35	0.021	0.026	0.0219	No	0.0311	No
5/9/2023 7:36	0.019	0.033	0.0229	No	0.029	No
5/9/2023 7:37	0.026	0.033	0.024	No	0.0272	No
5/9/2023 7:38	0.025	0.031	0.0245	No	0.0257	No
5/9/2023 7:39	0.012	0.029	0.0251	No	0.0239	No
5/9/2023 7:40	0.019	0.026	0.0256	No	0.0223	No
5/9/2023 7:41	0.016	0.024	0.026	No	0.0209	No
5/9/2023 7:42	0.008	0.026	0.0263	No	0.0195	No
5/9/2023 7:43	0.014	0.028	0.0268	No	0.0184	No
5/9/2023 7:44	0.007	0.023	0.0271	No	0.0166	No
5/9/2023 7:45	0.011	0.023	0.0274	No	0.0159	No
5/9/2023 7:46	0.017	0.026	0.0272	No	0.0151	No
5/9/2023 7:47	0.013	0.025	0.0272	No	0.0157	No
5/9/2023 7:48	0.02	0.028	0.0271	No	0.0161	No
5/9/2023 7:49	0.021	0.021	0.0268	No	0.0166	No
5/9/2023 7:50	0.02	0.024	0.0267	No	0.0165	No
5/9/2023 7:51	0.037	0.021	0.0259	No	0.0177	No
5/9/2023 7:52	0.053	0.022	0.0251	No	0.0195	No
5/9/2023 7:53	0.038	0.021	0.0245	No	0.0204	No
5/9/2023 7:54	0.044	0.02	0.0239	No	0.0225	No
5/9/2023 7:55	0.02	0.021	0.0235	No	0.0226	No
5/9/2023 7:56	0.021	0.018	0.0231	No	0.0229	No
5/9/2023 7:57	0.061	0.02	0.0227	No	0.0265	No
5/9/2023 7:58	0.063	0.02	0.0222	No	0.0297	No
5/9/2023 7:59	0.051	0.022	0.0221	No	0.0327	No
5/9/2023 8:00	0.066	0.029	0.0225	No	0.0363	No
5/9/2023 8:01	0.037	0.022	0.0223	No	0.0377	No
5/9/2023 8:02	0.035	0.018	0.0218	No	0.0391	No
5/9/2023 8:03	0.041	0.018	0.0211	No	0.0405	No

Downwind Station

Time	Instantaneous VOC (ppm)	Instantaneous Mass Conc. Total (mg/m ³)	Mass Conc. Total mg/m ³ AVG 15m (mg/m ³)	Dust Exceedance	VOC ppm AVG 15m (ppm)	VOC Exceedance
5/9/2023 8:04	0.027	0.019	0.021	No	0.0409	No
5/9/2023 8:05	0.044	0.02	0.0207	No	0.0425	No
5/9/2023 8:06	0.044	0.019	0.0206	No	0.043	No
5/9/2023 8:07	0.039	0.016	0.0202	No	0.0421	No
5/9/2023 8:08	0.048	0.016	0.0199	No	0.0427	No
5/9/2023 8:09	0.056	0.016	0.0196	No	0.0435	No
5/9/2023 8:10	0.058	0.018	0.0194	No	0.0461	No
5/9/2023 8:11	0.056	0.018	0.0194	No	0.0484	No
5/9/2023 8:12	0.053	0.017	0.0192	No	0.0479	No
5/9/2023 8:13	0.053	0.019	0.0191	No	0.0472	No
5/9/2023 8:14	0.053	0.017	0.0188	No	0.0473	No
5/9/2023 8:15	0.067	0.018	0.0181	No	0.0474	No
5/9/2023 8:16	0.045	0.018	0.0178	No	0.0479	No
5/9/2023 8:17	0.051	0.016	0.0177	No	0.049	No
5/9/2023 8:18	0.056	0.017	0.0176	No	0.05	No
5/9/2023 8:19	0.058	0.017	0.0175	No	0.0521	No
5/9/2023 8:20	0.088	0.026	0.0179	No	0.055	No
5/9/2023 8:21	0.067	0.024	0.0182	No	0.0565	No
5/9/2023 8:22	0.077	0.021	0.0185	No	0.0591	No
5/9/2023 8:23	0.074	0.017	0.0186	No	0.0608	No
5/9/2023 8:24	0.059	0.017	0.0187	No	0.061	No
5/9/2023 8:25	0.053	0.016	0.0185	No	0.0607	No
5/9/2023 8:26	0.062	0.018	0.0185	No	0.0611	No
5/9/2023 8:27	0.059	0.016	0.0185	No	0.0615	No
5/9/2023 8:28	0.059	0.016	0.0183	No	0.0619	No
5/9/2023 8:29	0.081	0.037	0.0196	No	0.0637	No
5/9/2023 8:30	0.074	0.024	0.02	No	0.0642	No
5/9/2023 8:31	0.062	0.021	0.0202	No	0.0653	No
5/9/2023 8:32	0.053	0.019	0.0204	No	0.0655	No
5/9/2023 8:33	0.063	0.017	0.0204	No	0.0659	No
5/9/2023 8:34	0.067	0.019	0.0205	No	0.0665	No
5/9/2023 8:35	0.056	0.016	0.0199	No	0.0644	No
5/9/2023 8:36	0.054	0.016	0.0193	No	0.0635	No
5/9/2023 8:37	0.057	0.017	0.0191	No	0.0622	No
5/9/2023 8:38	0.067	0.017	0.0191	No	0.0617	No
5/9/2023 8:39	0.094	0.023	0.0195	No	0.0641	No
5/9/2023 8:40	0.068	0.018	0.0196	No	0.0651	No
5/9/2023 8:41	0.11	0.02	0.0197	No	0.0683	No
5/9/2023 8:42	0.071	0.031	0.0207	No	0.0691	No
5/9/2023 8:43	0.058	0.022	0.0211	No	0.069	No
5/9/2023 8:44	0.064	0.02	0.02	No	0.0679	No
5/9/2023 8:45	0.051	0.019	0.0197	No	0.0663	No
5/9/2023 8:46	0.057	0.02	0.0196	No	0.066	No
5/9/2023 8:47	0.059	0.019	0.0196	No	0.0664	No
5/9/2023 8:48	0.067	0.018	0.0197	No	0.0667	No
5/9/2023 8:49	0.053	0.02	0.0197	No	0.0657	No
5/9/2023 8:50	0.053	0.021	0.0201	No	0.0655	No
5/9/2023 8:51	0.055	0.019	0.0203	No	0.0656	No
5/9/2023 8:52	0.056	0.019	0.0204	No	0.0655	No
5/9/2023 8:53	0.059	0.022	0.0207	No	0.065	No
5/9/2023 8:54	0.054	0.02	0.0205	No	0.0623	No
5/9/2023 8:55	0.041	0.021	0.0207	No	0.0605	No
5/9/2023 8:56	0.051	0.024	0.021	No	0.0566	No
5/9/2023 8:57	0.045	0.023	0.0205	No	0.0549	No
5/9/2023 8:58	0.051	0.023	0.0205	No	0.0544	No

Downwind Station						
Time	Instantaneous VOC (ppm)	Instantaneous Mass Conc. Total (mg/m ³)	Mass Conc. Total mg/m ³ AVG 15m (mg/m ³)	Dust Exceedance	VOC ppm AVG 15m (ppm)	VOC Exceedance
5/9/2023 8:59	0.065	0.021	0.0206	No	0.0545	No
5/9/2023 9:00	0.048	0.02	0.0207	No	0.0543	No
5/9/2023 9:01	0.048	0.023	0.0209	No	0.0537	No
5/9/2023 9:02	0.049	0.023	0.0211	No	0.053	No
5/9/2023 9:03	0.03	0.018	0.0211	No	0.0505	No
5/9/2023 9:04	0.051	0.022	0.0213	No	0.0504	No
5/9/2023 9:05	0.038	0.02	0.0212	No	0.0494	No
5/9/2023 9:06	0.06	0.02	0.0213	No	0.0497	No
5/9/2023 9:07	0.061	0.019	0.0213	No	0.0501	No
5/9/2023 9:08	0.055	0.022	0.0213	No	0.0498	No
5/9/2023 9:09	0.048	0.019	0.0212	No	0.0494	No
5/9/2023 9:10	0.048	0.017	0.0209	No	0.0499	No
5/9/2023 9:11	0.05	0.02	0.0207	No	0.0498	No
5/9/2023 9:12	0.053	0.02	0.0205	No	0.0503	No
5/9/2023 9:13	0.049	0.019	0.0202	No	0.0502	No
5/9/2023 9:14	0.052	0.018	0.02	No	0.0493	No
5/9/2023 9:15	0.055	0.021	0.0201	No	0.0498	No
5/9/2023 9:16	0.06	0.024	0.0201	No	0.0506	No
5/9/2023 9:17	0.051	0.018	0.0198	No	0.0507	No
5/9/2023 9:18	0.065	0.017	0.0197	No	0.0531	No
5/9/2023 9:19	0.055	0.016	0.0193	No	0.0533	No
5/9/2023 9:20	0.053	0.017	0.0191	No	0.0543	No
5/9/2023 9:21	0.062	0.017	0.0189	No	0.0545	No
5/9/2023 9:22	0.052	0.016	0.0187	No	0.0539	No
5/9/2023 9:23	0.043	0.017	0.0184	No	0.0531	No
5/9/2023 9:24	0.048	0.02	0.0185	No	0.0531	No
5/9/2023 9:25	0.061	0.02	0.0187	No	0.0539	No
5/9/2023 9:26	0.061	0.02	0.0187	No	0.0547	No
5/9/2023 9:27	0.063	0.02	0.0187	No	0.0553	No
5/9/2023 9:28	0.056	0.019	0.0187	No	0.0558	No
5/9/2023 9:29	0.057	0.016	0.0185	No	0.0561	No
5/9/2023 9:30	0.058	0.016	0.0182	No	0.0563	No
5/9/2023 9:31	0.063	0.019	0.0179	No	0.0565	No
5/9/2023 9:32	0.059	0.024	0.0183	No	0.0571	No
5/9/2023 9:33	0.058	0.019	0.0184	No	0.0566	No
5/9/2023 9:34	0.044	0.019	0.0186	No	0.0559	No
5/9/2023 9:35	0.055	0.017	0.0186	No	0.056	No
5/9/2023 9:36	0.046	0.017	0.0186	No	0.0549	No
5/9/2023 9:37	0.067	0.017	0.0187	No	0.0559	No
5/9/2023 9:38	0.058	0.018	0.0187	No	0.0569	No
5/9/2023 9:39	0.047	0.017	0.0185	No	0.0569	No
5/9/2023 9:40	0.059	0.018	0.0184	No	0.0567	No
5/9/2023 9:41	0.056	0.016	0.0181	No	0.0564	No
5/9/2023 9:42	0.064	0.018	0.018	No	0.0565	No
5/9/2023 9:43	0.057	0.021	0.0181	No	0.0565	No
5/9/2023 9:44	0.063	0.02	0.0184	No	0.0569	No
5/9/2023 9:45	0.067	0.018	0.0185	No	0.0575	No
5/9/2023 9:46	0.058	0.016	0.0183	No	0.0572	No
5/9/2023 9:47	0.069	0.019	0.018	No	0.0579	No
5/9/2023 9:48	0.057	0.024	0.0183	No	0.0578	No
5/9/2023 9:49	0.067	0.018	0.0183	No	0.0593	No
5/9/2023 9:50	0.056	0.017	0.0183	No	0.0594	No
5/9/2023 9:51	0.059	0.017	0.0183	No	0.0603	No
5/9/2023 9:52	0.052	0.019	0.0184	No	0.0593	No
5/9/2023 9:53	0.056	0.016	0.0183	No	0.0591	No

Downwind Station						
Time	Instantaneous VOC (ppm)	Instantaneous Mass Conc. Total (mg/m ³)	Mass Conc. Total mg/m ³ AVG 15m (mg/m ³)	Dust Exceedance	VOC ppm AVG 15m (ppm)	VOC Exceedance
5/9/2023 9:54	0.059	0.017	0.0183	No	0.0599	No
5/9/2023 9:55	0.058	0.018	0.0183	No	0.0599	No
5/9/2023 9:56	0.056	0.016	0.0183	No	0.0599	No
5/9/2023 9:57	0.049	0.018	0.0183	No	0.0589	No
5/9/2023 9:58	0.054	0.018	0.0181	No	0.0587	No
5/9/2023 9:59	0.064	0.018	0.0179	No	0.0587	No
5/9/2023 10:00	0.064	0.018	0.0179	No	0.0585	No
5/9/2023 10:01	0.055	0.018	0.0181	No	0.0583	No
5/9/2023 10:02	0.059	0.019	0.0181	No	0.0577	No
5/9/2023 10:03	0.067	0.019	0.0177	No	0.0583	No
5/9/2023 10:04	0.062	0.019	0.0178	No	0.058	No
5/9/2023 10:05	0.054	0.02	0.018	No	0.0579	No
5/9/2023 10:06	0.066	0.019	0.0181	No	0.0583	No
5/9/2023 10:07	0.051	0.019	0.0181	No	0.0583	No
5/9/2023 10:08	0.052	0.021	0.0185	No	0.058	No
5/9/2023 10:09	0.055	0.02	0.0187	No	0.0577	No
5/9/2023 10:10	0.05	0.02	0.0188	No	0.0572	No
5/9/2023 10:11	0.051	0.018	0.0189	No	0.0569	No
5/9/2023 10:12	0.04	0.02	0.0191	No	0.0563	No
5/9/2023 10:13	0.057	0.017	0.019	No	0.0565	No
5/9/2023 10:14	0.059	0.039	0.0204	No	0.0561	No
5/9/2023 10:15	0.06	0.019	0.0205	No	0.0559	No
5/9/2023 10:16	0.059	0.018	0.0205	No	0.0561	No
5/9/2023 10:17	0.072	0.018	0.0204	No	0.057	No
5/9/2023 10:18	0.059	0.017	0.0203	No	0.0565	No
5/9/2023 10:19	0.05	0.02	0.0203	No	0.0557	No
5/9/2023 10:20	0.062	0.022	0.0205	No	0.0562	No
5/9/2023 10:21	0.057	0.022	0.0207	No	0.0556	No
5/9/2023 10:22	0.051	0.023	0.0209	No	0.0556	No
5/9/2023 10:23	0.056	0.019	0.0208	No	0.0559	No
5/9/2023 10:24	0.047	0.02	0.0208	No	0.0553	No
5/9/2023 10:25	0.057	0.02	0.0208	No	0.0558	No
5/9/2023 10:26	0.05	0.021	0.021	No	0.0557	No
5/9/2023 10:27	0.058	0.019	0.0209	No	0.0569	No
5/9/2023 10:28	0.067	0.02	0.0211	No	0.0576	No
5/9/2023 10:29	0.061	0.021	0.0199	No	0.0577	No
5/9/2023 10:30	0.057	0.023	0.0202	No	0.0575	No
5/9/2023 10:31	0.044	0.023	0.0205	No	0.0565	No
5/9/2023 10:32	0.039	0.023	0.0209	No	0.0543	No
5/9/2023 10:33	0.037	0.023	0.0213	No	0.0529	No
5/9/2023 10:34	0.05	0.024	0.0215	No	0.0529	No
5/9/2023 10:35	0.044	0.027	0.0219	No	0.0517	No
5/9/2023 10:36	0.044	0.022	0.0219	No	0.0508	No
5/9/2023 10:37	0.041	0.027	0.0221	No	0.0501	No
5/9/2023 10:38	0.041	0.025	0.0225	No	0.0491	No
5/9/2023 10:39	0.048	0.026	0.0229	No	0.0492	No
5/9/2023 10:40	0.041	0.025	0.0233	No	0.0481	No
5/9/2023 10:41	0.046	0.02	0.0232	No	0.0479	No
5/9/2023 10:42	0.041	0.022	0.0234	No	0.0467	No
5/9/2023 10:43	0.051	0.022	0.0235	No	0.0457	No
5/9/2023 10:44	0.042	0.019	0.0234	No	0.0444	No
5/9/2023 10:45	0.042	0.019	0.0231	No	0.0434	No
5/9/2023 10:46	0.049	0.021	0.023	No	0.0437	No
5/9/2023 10:47	0.041	0.019	0.0227	No	0.0439	No
5/9/2023 10:48	0.039	0.022	0.0227	No	0.044	No

Downwind Station

Time	Instantaneous VOC (ppm)	Instantaneous Mass Conc. Total (mg/m ³)	Mass Conc. Total mg/m ³ AVG 15m (mg/m ³)	Dust Exceedance	VOC ppm AVG 15m (ppm)	VOC Exceedance
5/9/2023 10:49	0.05	0.022	0.0225	No	0.044	No
5/9/2023 10:50	0.035	0.023	0.0223	No	0.0434	No
5/9/2023 10:51	0.049	0.021	0.0222	No	0.0437	No
5/9/2023 10:52	0.039	0.022	0.0219	No	0.0436	No
5/9/2023 10:53	0.032	0.02	0.0215	No	0.043	No
5/9/2023 10:54	0.043	0.019	0.0211	No	0.0427	No
5/9/2023 10:55	0.041	0.02	0.0207	No	0.0427	No
5/9/2023 10:56	0.042	0.025	0.0211	No	0.0424	No
5/9/2023 10:57	0.046	0.024	0.0212	No	0.0427	No

Downwind Station						
Time	Instantaneous VOC (ppm)	Instantaneous Mass Conc. Total (mg/m ³)	Mass Conc. Total mg/m ³ AVG 15m (mg/m ³)	Dust Exceedance	VOC ppm AVG 15m (ppm)	VOC Exceedance
5/9/2023 10:58	0.028	0.017	0.0209	No	0.0412	No
5/9/2023 10:59	0.033	0.017	0.0207	No	0.0406	No
5/9/2023 11:00	0.039	0.017	0.0206	No	0.0404	No
5/9/2023 11:01	0.052	0.018	0.0204	No	0.0406	No
5/9/2023 11:02	0.044	0.021	0.0205	No	0.0408	No
5/9/2023 11:03	0.049	0.019	0.0203	No	0.0415	No
5/9/2023 11:04	0.043	0.022	0.0203	No	0.041	No
5/9/2023 11:05	0.046	0.021	0.0202	No	0.0417	No
5/9/2023 11:06	0.057	0.023	0.0203	No	0.0423	No
5/9/2023 11:07	0.042	0.023	0.0204	No	0.0425	No
5/9/2023 11:08	0.049	0.019	0.0203	No	0.0436	No
5/9/2023 11:09	0.045	0.018	0.0203	No	0.0437	No
5/9/2023 11:10	0.042	0.02	0.0203	No	0.0438	No
5/9/2023 11:11	0.033	0.021	0.02	No	0.0432	No
5/9/2023 11:12	0.041	0.02	0.0197	No	0.0429	No
5/9/2023 11:13	0.042	0.019	0.0199	No	0.0438	No
5/9/2023 11:14	0.041	0.017	0.0199	No	0.0443	No
5/9/2023 11:15	0.047	0.019	0.02	No	0.0449	No
5/9/2023 11:16	0.037	0.018	0.02	No	0.0439	No
5/9/2023 11:17	0.043	0.017	0.0197	No	0.0438	No
5/9/2023 11:18	0.039	0.023	0.02	No	0.0431	No
5/9/2023 11:19	0.038	0.038	0.0211	No	0.0428	No
5/9/2023 11:20	0.032	0.027	0.0215	No	0.0419	No
5/9/2023 11:21	0.042	0.023	0.0215	No	0.0409	No
5/9/2023 11:22	0.034	0.019	0.0212	No	0.0403	No
5/9/2023 11:23	0.042	0.019	0.0212	No	0.0399	No
5/9/2023 11:24	0.047	0.02	0.0213	No	0.04	No
5/9/2023 11:25	0.054	0.019	0.0213	No	0.0408	No
5/9/2023 11:26	0.061	0.018	0.0211	No	0.0427	No
5/9/2023 11:27	0.068	0.019	0.021	No	0.0445	No
5/9/2023 11:28	0.056	0.021	0.0211	No	0.0454	No
5/9/2023 11:29	0.055	0.041	0.0227	No	0.0463	No
5/9/2023 11:30	0.056	0.028	0.0233	No	0.0469	No
5/9/2023 11:31	0.04	0.022	0.0236	No	0.0471	No
5/9/2023 11:32	0.058	0.027	0.0243	No	0.0481	No
5/9/2023 11:33	0.039	0.022	0.0242	No	0.0481	No
5/9/2023 11:34	0.038	0.018	0.0229	No	0.0481	No
5/9/2023 11:35	0.039	0.019	0.0223	No	0.0486	No
5/9/2023 11:36	0.04	0.02	0.0221	No	0.0485	No
5/9/2023 11:37	0.048	0.021	0.0223	No	0.0494	No
5/9/2023 11:38	0.04	0.023	0.0225	No	0.0493	No
5/9/2023 11:39	0.044	0.018	0.0224	No	0.0491	No
5/9/2023 11:40	0.048	0.019	0.0224	No	0.0487	No
5/9/2023 11:41	0.051	0.019	0.0225	No	0.048	No
5/9/2023 11:42	0.049	0.019	0.0225	No	0.0467	No
5/9/2023 11:43	0.047	0.019	0.0223	No	0.0461	No
5/9/2023 11:44	0.038	0.021	0.021	No	0.045	No
5/9/2023 11:45	0.039	0.021	0.0205	No	0.0439	No
5/9/2023 11:46	0.03	0.021	0.0205	No	0.0432	No
5/9/2023 11:47	0.039	0.02	0.02	No	0.0419	No
5/9/2023 11:48	0.047	0.023	0.0201	No	0.0425	No
5/9/2023 11:49	0.039	0.021	0.0203	No	0.0425	No
5/9/2023 11:50	0.04	0.02	0.0203	No	0.0426	No
5/9/2023 11:51	0.054	0.021	0.0204	No	0.0435	No
5/9/2023 11:52	0.041	0.021	0.0204	No	0.0431	No

Downwind Station						
Time	Instaneous VOC (ppm)	Instaneous Mass Conc. Total (mg/m ³)	Mass Conc. Total mg/m ³ AVG 15m (mg/m ³)	Dust Exceedance	VOC ppm AVG 15m (ppm)	VOC Exceedance
5/9/2023 11:53	0.049	0.02	0.0202	No	0.0437	No
5/9/2023 11:54	0.034	0.024	0.0206	No	0.043	No
5/9/2023 11:55	0.056	0.022	0.0208	No	0.0435	No
5/9/2023 11:56	0.039	0.022	0.021	No	0.0427	No
5/9/2023 11:57	0.049	0.022	0.0212	No	0.0427	No
5/9/2023 11:58	0.041	0.022	0.0214	No	0.0423	No
5/9/2023 11:59	0.042	0.02	0.0213	No	0.0426	No
5/9/2023 12:00	0.034	0.021	0.0213	No	0.0423	No
5/9/2023 12:01	0.032	0.02	0.0213	No	0.0424	No
5/9/2023 12:02	0.033	0.023	0.0215	No	0.042	No
5/9/2023 12:03	0.052	0.022	0.0214	No	0.0423	No
5/9/2023 12:04	0.04	0.021	0.0214	No	0.0424	No
5/9/2023 12:05	0.039	0.02	0.0214	No	0.0423	No
5/9/2023 12:06	0.044	0.019	0.0213	No	0.0417	No
5/9/2023 12:07	0.04	0.021	0.0213	No	0.0416	No
5/9/2023 12:08	0.042	0.021	0.0213	No	0.0411	No
5/9/2023 12:09	0.029	0.02	0.0211	No	0.0408	No
5/9/2023 12:10	0.027	0.021	0.021	No	0.0389	No
5/9/2023 12:11	0.031	0.022	0.021	No	0.0383	No
5/9/2023 12:12	0.025	0.021	0.0209	No	0.0367	No
5/9/2023 12:13	0.029	0.021	0.0209	No	0.0359	No
5/9/2023 12:14	0.038	0.023	0.0211	No	0.0357	No
5/9/2023 12:15	0.025	0.021	0.0211	No	0.0351	No
5/9/2023 12:16	0.013	0.019	0.021	No	0.0338	No
5/9/2023 12:17	0.025	0.02	0.0208	No	0.0333	No
5/9/2023 12:18	0.02	0.02	0.0207	No	0.0311	No
5/9/2023 12:19	0.03	0.022	0.0207	No	0.0305	No
5/9/2023 12:20	0.02	0.021	0.0208	No	0.0292	No
5/9/2023 12:21	0.018	0.022	0.021	No	0.0275	No
5/9/2023 12:22	0.019	0.021	0.021	No	0.0261	No
5/9/2023 12:23	0.013	0.021	0.021	No	0.0241	No
5/9/2023 12:24	0.013	0.02	0.021	No	0.0231	No
5/9/2023 12:25	0.003	0.021	0.021	No	0.0215	No
5/9/2023 12:26	0.016	0.021	0.0209	No	0.0205	No
5/9/2023 12:27	0.013	0.021	0.0209	No	0.0197	No
5/9/2023 12:28	0.002	0.022	0.021	No	0.0179	No
5/9/2023 12:29	0.002	0.021	0.0209	No	0.0155	No
5/9/2023 12:30	0.011	0.022	0.0209	No	0.0145	No
5/9/2023 12:31	0.006	0.021	0.0211	No	0.0141	No
5/9/2023 12:32	0	0.022	0.0212	No	0.0124	No
5/9/2023 12:33	0.003	0.022	0.0213	No	0.0113	No
5/9/2023 12:34	0.005	0.022	0.0213	No	0.0096	No
5/9/2023 12:35	0	0.021	0.0213	No	0.0083	No
5/9/2023 12:36	0	0.023	0.0214	No	0.0071	No
5/9/2023 12:37	0	0.023	0.0215	No	0.0058	No
5/9/2023 12:38	0	0.02	0.0215	No	0.0049	No
5/9/2023 12:39	0	0.02	0.0215	No	0.0041	No
5/9/2023 12:40	0	0.022	0.0215	No	0.0039	No
5/9/2023 12:41	0	0.022	0.0216	No	0.0028	No
5/9/2023 12:42	0	0.024	0.0218	No	0.0019	No
5/9/2023 12:43	0	0.021	0.0217	No	0.0018	No
5/9/2023 12:44	0	0.021	0.0217	No	0.0017	No
5/9/2023 12:45	0.007	0.022	0.0217	No	0.0014	No
5/9/2023 12:46	0	0.024	0.0219	No	0.001	No
5/9/2023 12:47	0	0.023	0.022	No	0.001	No

Downwind Station						
Time	Instantaneous VOC (ppm)	Instantaneous Mass Conc. Total (mg/m ³)	Mass Conc. Total mg/m ³ AVG 15m (mg/m ³)	Dust Exceedance	VOC ppm AVG 15m (ppm)	VOC Exceedance
5/9/2023 12:48	0	0.023	0.0221	No	0.0008	No
5/9/2023 12:49	0	0.021	0.022	No	0.0005	No
5/9/2023 12:50	0	0.023	0.0221	No	0.0005	No
5/9/2023 12:51	0	0.022	0.0221	No	0.0005	No
5/9/2023 12:52	0	0.021	0.0219	No	0.0005	No
5/9/2023 12:53	0	0.021	0.022	No	0.0005	No
5/9/2023 12:54	0	0.024	0.0223	No	0.0005	No
5/9/2023 12:55	0	0.029	0.0227	No	0.0005	No
5/9/2023 12:56	0	0.025	0.0229	No	0.0005	No
5/9/2023 12:57	0	0.021	0.0227	No	0.0005	No
5/9/2023 12:58	0	0.023	0.0229	No	0.0005	No
5/9/2023 12:59	0	0.026	0.0232	No	0.0005	No
5/9/2023 13:00	0	0.034	0.024	No	0	No
5/9/2023 13:01	0	0.059	0.0263	No	0	No
5/9/2023 13:02	0	0.027	0.0266	No	0	No
5/9/2023 13:03	0	0.026	0.0268	No	0	No
5/9/2023 13:04	0.003	0.025	0.0271	No	0.0002	No
5/9/2023 13:05	0	0.024	0.0271	No	0.0002	No
5/9/2023 13:06	0	0.023	0.0272	No	0.0002	No
5/9/2023 13:07	0	0.024	0.0274	No	0.0002	No
5/9/2023 13:08	0	0.025	0.0277	No	0.0002	No
5/9/2023 13:09	0	0.026	0.0278	No	0.0002	No
5/9/2023 13:10	0	0.033	0.0281	No	0.0002	No
5/9/2023 13:11	0	0.026	0.0281	No	0.0002	No
5/9/2023 13:12	0	0.026	0.0285	No	0.0002	No
5/9/2023 13:13	0	0.029	0.0289	No	0.0002	No
5/9/2023 13:14	0	0.028	0.029	No	0.0002	No
5/9/2023 13:15	0	0.024	0.0283	No	0.0002	No
5/9/2023 13:16	0	0.025	0.0261	No	0.0002	No
5/9/2023 13:17	0	0.024	0.0259	No	0.0002	No
5/9/2023 13:18	0	0.025	0.0258	No	0.0002	No
5/9/2023 13:19	0	0.023	0.0257	No	0	No
5/9/2023 13:20	0	0.025	0.0257	No	0	No
5/9/2023 13:21	0	0.028	0.0261	No	0	No
5/9/2023 13:22	0	0.026	0.0262	No	0	No
5/9/2023 13:23	0	0.024	0.0261	No	0	No
5/9/2023 13:24	0	0.024	0.026	No	0	No
5/9/2023 13:25	0	0.025	0.0255	No	0	No
5/9/2023 13:26	0	0.027	0.0255	No	0	No
5/9/2023 13:27	0	0.028	0.0257	No	0	No
5/9/2023 13:28	0	0.026	0.0255	No	0	No
5/9/2023 13:29	0	0.025	0.0253	No	0	No
5/9/2023 13:30	0	0.029	0.0256	No	0	No
5/9/2023 13:31	0	0.026	0.0257	No	0	No
5/9/2023 13:32	0	0.028	0.0259	No	0	No
5/9/2023 13:33	0	0.03	0.0263	No	0	No
5/9/2023 13:34	0	0.027	0.0265	No	0	No
5/9/2023 13:35	0	0.029	0.0268	No	0	No
5/9/2023 13:36	0	0.03	0.0269	No	0	No
5/9/2023 13:37	0	0.03	0.0272	No	0	No
5/9/2023 13:38	0	0.029	0.0275	No	0	No
5/9/2023 13:39	0	0.025	0.0276	No	0	No
5/9/2023 13:40	0	0.029	0.0279	No	0	No
5/9/2023 13:41	0	0.028	0.0279	No	0	No
5/9/2023 13:42	0	0.025	0.0277	No	0	No

Downwind Station						
Time	Instantaneous VOC (ppm)	Instantaneous Mass Conc. Total (mg/m ³)	Mass Conc. Total mg/m ³ AVG 15m (mg/m ³)	Dust Exceedance	VOC ppm AVG 15m (ppm)	VOC Exceedance
5/9/2023 13:43	0	0.028	0.0279	No	0	No
5/9/2023 13:44	0	0.024	0.0278	No	0	No
5/9/2023 13:45	0	0.025	0.0275	No	0	No
5/9/2023 13:46	0	0.025	0.0275	No	0	No
5/9/2023 13:47	0	0.03	0.0276	No	0	No
5/9/2023 13:48	0	0.037	0.0281	No	0	No
5/9/2023 13:49	0	0.036	0.0287	No	0	No
5/9/2023 13:50	0	0.041	0.0295	No	0	No
5/9/2023 13:51	0	0.035	0.0298	No	0	No
5/9/2023 13:52	0	0.045	0.0308	No	0	No
5/9/2023 13:53	0	0.032	0.031	No	0	No
5/9/2023 13:54	0	0.04	0.032	No	0	No
5/9/2023 13:55	0.032	0.04	0.0327	No	0.0021	No
5/9/2023 13:56	0.093	0.038	0.0334	No	0.0083	No
5/9/2023 13:57	0.032	0.049	0.035	No	0.0105	No
5/9/2023 13:58	0.075	0.039	0.0357	No	0.0155	No
5/9/2023 13:59	0	0.038	0.0367	No	0.0155	No
5/9/2023 14:00	0	0.034	0.0373	No	0.0155	No
5/9/2023 14:01	0.012	0.04	0.0383	No	0.0163	No
5/9/2023 14:02	0.068	0.04	0.0389	No	0.0208	No
5/9/2023 14:03	0	0.044	0.0394	No	0.0208	No
5/9/2023 14:04	0.002	0.032	0.0391	No	0.0209	No
5/9/2023 14:05	0	0.04	0.0391	No	0.0209	No
5/9/2023 14:06	0	0.037	0.0392	No	0.0209	No
5/9/2023 14:07	0	0.036	0.0386	No	0.0209	No
5/9/2023 14:08	0	0.037	0.0389	No	0.0209	No
5/9/2023 14:09	0	0.028	0.0381	No	0.0209	No
5/9/2023 14:10	0	0.036	0.0379	No	0.0188	No
5/9/2023 14:11	0	0.031	0.0374	No	0.0126	No
5/9/2023 14:12	0	0.026	0.0359	No	0.0105	No
5/9/2023 14:13	0	0.032	0.0354	No	0.0055	No
5/9/2023 14:14	0	0.031	0.0349	No	0.0055	No
5/9/2023 14:15	0	0.028	0.0345	No	0.0055	No
5/9/2023 14:16	0	0.028	0.0337	No	0.0047	No
5/9/2023 14:17	0	0.029	0.033	No	0.0001	No
5/9/2023 14:18	0	0.03	0.0321	No	0.0001	No
5/9/2023 14:19	0	0.029	0.0319	No	0	No
5/9/2023 14:20	0	0.03	0.0312	No	0	No
5/9/2023 14:21	0	0.029	0.0307	No	0	No
5/9/2023 14:22	0	0.029	0.0302	No	0	No
5/9/2023 14:23	0	0.035	0.0301	No	0	No
5/9/2023 14:24	0	0.027	0.03	No	0	No
5/9/2023 14:25	0	0.025	0.0293	No	0	No
5/9/2023 14:26	0	0.027	0.029	No	0	No
5/9/2023 14:27	0	0.031	0.0293	No	0	No
5/9/2023 14:28	0	0.034	0.0295	No	0	No
5/9/2023 14:29	0	0.026	0.0291	No	0	No
5/9/2023 14:30	0	0.024	0.0289	No	0	No
5/9/2023 14:31	0	0.025	0.0287	No	0	No
5/9/2023 14:32	0	0.025	0.0284	No	0	No
5/9/2023 14:33	0	0.025	0.0281	No	0	No
5/9/2023 14:34	0	0.023	0.0277	No	0	No
5/9/2023 14:35	0	0.022	0.0271	No	0	No
5/9/2023 14:36	0	0.028	0.0271	No	0	No
5/9/2023 14:37	0	0.025	0.0268	No	0	No

Downwind Station						
Time	Instantaneous VOC (ppm)	Instantaneous Mass Conc. Total (mg/m ³)	Mass Conc. Total mg/m ³ AVG 15m (mg/m ³)	Dust Exceedance	VOC ppm AVG 15m (ppm)	VOC Exceedance
5/9/2023 14:38	0	0.031	0.0265	No	0	No
5/9/2023 14:39	0	0.028	0.0266	No	0	No
5/9/2023 14:40	0	0.028	0.0268	No	0	No
5/9/2023 14:41	0	0.028	0.0269	No	0	No
5/9/2023 14:42	0	0.029	0.0267	No	0	No
5/9/2023 14:43	0	0.027	0.0263	No	0	No
5/9/2023 14:44	0	0.028	0.0264	No	0	No
5/9/2023 14:45	0	0.028	0.0267	No	0	No
5/9/2023 14:46	0	0.026	0.0267	No	0	No
5/9/2023 14:47	0	0.026	0.0268	No	0	No
5/9/2023 14:48	0	0.034	0.0274	No	0	No
5/9/2023 14:49	0	0.029	0.0278	No	0	No
5/9/2023 14:50	0	0.03	0.0283	No	0	No
5/9/2023 14:51	0	0.03	0.0285	No	0	No
5/9/2023 14:52	0	0.033	0.029	No	0	No
5/9/2023 14:53	0	0.044	0.0299	No	0	No
5/9/2023 14:54	0	0.034	0.0303	No	0	No
5/9/2023 14:55	0	0.03	0.0304	No	0	No
5/9/2023 14:56	0	0.038	0.0311	No	0	No
5/9/2023 14:57	0	0.028	0.031	No	0	No
5/9/2023 14:58	0	0.033	0.0314	No	0	No
5/9/2023 14:59	0	0.033	0.0317	No	0	No
5/9/2023 15:00	0	0.033	0.0321	No	0	No
5/9/2023 15:01	0	0.03	0.0323	No	0	No
5/9/2023 15:02	0	0.049	0.0339	No	0	No
5/9/2023 15:03	0	0.047	0.0347	No	0	No
5/9/2023 15:04	0	0.035	0.0351	No	0	No
5/9/2023 15:05	0	0.04	0.0358	No	0	No
5/9/2023 15:06	0	0.04	0.0365	No	0	No
5/9/2023 15:07	0	0.04	0.0369	No	0	No
5/9/2023 15:08	0	0.044	0.0369	No	0	No
5/9/2023 15:09	0	0.04	0.0373	No	0	No
5/9/2023 15:10	0	0.033	0.0375	No	0	No
5/9/2023 15:11	0	0.051	0.0384	No	0	No
5/9/2023 15:12	0	0.056	0.0403	No	0	No
5/9/2023 15:13	0	0.045	0.0411	No	0	No
5/9/2023 15:14	0	0.035	0.0412	No	0	No
5/9/2023 15:15	0.017	0.042	0.0418	No	0.0011	No
5/9/2023 15:16	0.015			No	0.0021	No
5/9/2023 15:17	0	0.139	0.0491	No	0.0021	No
5/9/2023 15:18	0	0.045	0.0489	No	0.0021	No
5/9/2023 15:19	0.003	0.057	0.0505	No	0.0023	No
5/9/2023 15:20	0.094	0.195	0.0616	No	0.0086	No
5/9/2023 15:21	0	0.068	0.0636	No	0.0086	No
5/9/2023 15:22	0.121	0.046	0.064	No	0.0167	No
5/9/2023 15:23	0.207	0.044	0.064	No	0.0305	No
5/9/2023 15:24	0.005	0.045	0.0644	No	0.0308	No
5/9/2023 15:25	0.015	0.053	0.0658	No	0.0318	No
5/9/2023 15:26	0	0.055	0.0661	No	0.0318	No
5/9/2023 15:27	0	0.06	0.0664	No	0.0318	No
5/9/2023 15:28	0	0.065	0.0678	No	0.0318	No
5/9/2023 15:29	0	0.078	0.0709	No	0.0318	No
5/9/2023 15:30	0	0.037	0.0705	No	0.0307	No
5/9/2023 15:31	0	0.04	0.0685	No	0.0297	No
5/9/2023 15:32	0	0.054	0.0628	No	0.0297	No

Downwind Station						
Time	Instantaneous VOC (ppm)	Instantaneous Mass Conc. Total (mg/m ³)	Mass Conc. Total mg/m ³ AVG 15m (mg/m ³)	Dust Exceedance	VOC ppm AVG 15m (ppm)	VOC Exceedance
5/9/2023 15:33	0	0.049	0.0631	No	0.0297	No
5/9/2023 15:34	0	0.037	0.0617	No	0.0295	No
5/9/2023 15:35	0	0.039	0.0513	No	0.0232	No
5/9/2023 15:36	0	0.038	0.0493	No	0.0232	No
5/9/2023 15:37	0	0.041	0.049	No	0.0151	No
5/9/2023 15:38	0	0.04	0.0487	No	0.0013	No
5/9/2023 15:39	0	0.059	0.0497	No	0.001	No
5/9/2023 15:40	0	0.06	0.0501	No	0	No
5/9/2023 15:41	0	0.07	0.0511	No	0	No
5/9/2023 15:42	0	0.05	0.0505	No	0	No
5/9/2023 15:43	0	0.052	0.0496	No	0	No
5/9/2023 15:44	0	0.046	0.0475	No	0	No
5/9/2023 15:45	0	0.037	0.0475	No	0	No
5/9/2023 15:46	0	0.04	0.0475	No	0	No
5/9/2023 15:47	0	0.049	0.0471	No	0	No
5/9/2023 15:48	0	0.039	0.0465	No	0	No
5/9/2023 15:49	0	0.033	0.0462	No	0	No
5/9/2023 15:50	0	0.03	0.0456	No	0	No
5/9/2023 15:51	0	0.03	0.0451	No	0	No
5/9/2023 15:52	0	0.033	0.0445	No	0	No
5/9/2023 15:53	0	0.031	0.0439	No	0	No
5/9/2023 15:54	0	0.035	0.0423	No	0	No
5/9/2023 15:55	0	0.036	0.0407	No	0	No
5/9/2023 15:56	0	0.047	0.0392	No	0	No
5/9/2023 15:57	0	0.038	0.0384	No	0	No
5/9/2023 15:58	0	0.032	0.0371	No	0	No
5/9/2023 15:59	0	0.035	0.0363	No	0	No
5/9/2023 16:00	0	0.038	0.0364	No	0	No
5/9/2023 16:01	0	0.04	0.0364	No	0	No
5/9/2023 16:02	0	0.032	0.0353	No	0	No
5/9/2023 16:03	0	0.031	0.0347	No	0	No
5/9/2023 16:04	0	0.031	0.0346	No	0	No
5/9/2023 16:05	0	0.04	0.0353	No	0	No
5/9/2023 16:06	0	0.03	0.0353	No	0	No
5/9/2023 16:07	0	0.03	0.0351	No	0	No
5/9/2023 16:08	0	0.031	0.0351	No	0	No
5/9/2023 16:09	0	0.03	0.0347	No	0	No
5/9/2023 16:10	0	0.03	0.0343	No	0	No
5/9/2023 16:11	0	0.029	0.0331	No	0	No
5/9/2023 16:12	0	0.033	0.0328	No	0	No
5/9/2023 16:13	0	0.033	0.0329	No	0	No
5/9/2023 16:14	0	0.033	0.0327	No	0	No
5/9/2023 16:15	0	0.037	0.0327	No	0	No
5/9/2023 16:16	0	0.032	0.0321	No	0	No
5/9/2023 16:17	0	0.031	0.0321	No	0	No
5/9/2023 16:18	0	0.033	0.0322	No	0	No
5/9/2023 16:19	0	0.029	0.0321	No	0	No
5/9/2023 16:20	0	0.028	0.0313	No	0	No
5/9/2023 16:21	0	0.03	0.0313	No	0	No
5/9/2023 16:22	0	0.033	0.0315	No	0	No
5/9/2023 16:23	0	0.032	0.0315	No	0	No
5/9/2023 16:24	0	0.029	0.0315	No	0	No
5/9/2023 16:25	0	0.031	0.0315	No	0	No
5/9/2023 16:26	0	0.034	0.0319	No	0	No
5/9/2023 16:27	0	0.032	0.0318	No	0	No

Downwind Station						
Time	Instantaneous VOC (ppm)	Instantaneous Mass Conc. Total (mg/m ³)	Mass Conc. Total mg/m ³ AVG 15m (mg/m ³)	Dust Exceedance	VOC ppm AVG 15m (ppm)	VOC Exceedance
5/9/2023 16:28	0	0.029	0.0315	No	0	No
5/9/2023 16:29	0	0.028	0.0312	No	0	No
5/9/2023 16:30	0	0.028	0.0306	No	0	No
5/9/2023 16:31	0	0.031	0.0305	No	0	No
5/9/2023 16:32	0	0.032	0.0306	No	0	No
5/9/2023 16:33	0	0.03	0.0304	No	0	No
5/9/2023 16:34	0	0.036	0.0309	No	0	No
5/9/2023 16:35	0	0.039	0.0316	No	0	No
5/9/2023 16:36	0	0.048	0.0328	No	0	No
5/9/2023 16:37	0	0.035	0.0329	No	0	No
5/9/2023 16:38	0	0.032	0.0329	No	0	No
5/9/2023 16:39	0	0.032	0.0331	No	0	No
5/9/2023 16:40	0	0.036	0.0335	No	0	No
5/9/2023 16:41	0	0.03	0.0332	No	0	No
5/9/2023 16:42	0	0.029	0.033	No	0	No
5/9/2023 16:43	0	0.028	0.0329	No	0	No
5/9/2023 16:44	0	0.028	0.0329	No	0	No
5/9/2023 16:45	0	0.027	0.0329	No	0	No
5/9/2023 16:46	0	0.034	0.0331	No	0	No
5/9/2023 16:47	0	0.031	0.033	No	0	No
5/9/2023 16:48	0	0.031	0.0331	No	0	No
5/9/2023 16:49	0	0.029	0.0326	No	0	No
5/9/2023 16:50	0	0.031	0.0321	No	0	No
5/9/2023 16:51	0	0.03	0.0309	No	0	No
5/9/2023 16:52	0	0.035	0.0309	No	0	No
5/9/2023 16:53	0	0.031	0.0308	No	0	No
5/9/2023 16:54	0	0.028	0.0305	No	0	No
5/9/2023 16:55	0	0.028	0.03	No	0	No
5/9/2023 16:56	0	0.034	0.0303	No	0	No
5/9/2023 16:57	0	0.032	0.0305	No	0	No
5/9/2023 16:58	0	0.029	0.0305	No	0	No
5/9/2023 16:59	0	0.029	0.0306	No	0	No
5/9/2023 17:00	0	0.027	0.0306	No	0	No
5/9/2023 17:01	0	0.026	0.0301	No	0	No
5/9/2023 17:02	0	0.027	0.0298	No	0	No
5/9/2023 17:03	0	0.027	0.0295	No	0	No
5/9/2023 17:04	0	0.028	0.0295	No	0	No
5/9/2023 17:05	0	0.027	0.0292	No	0	No
5/9/2023 17:06	0	0.025	0.0289	No	0	No
5/9/2023 17:07	0	0.026	0.0283	No	0	No
5/9/2023 17:08	0	0.034	0.0285	No	0	No
5/9/2023 17:09	0	0.027	0.0284	No	0	No
5/9/2023 17:10	0	0.03	0.0285	No	0	No
5/9/2023 17:11	0	0.029	0.0282	No	0	No
5/9/2023 17:12	0	0.027	0.0279	No	0	No
5/9/2023 17:13	0	0.027	0.0277	No	0	No
5/9/2023 17:14	0	0.027	0.0276	No	0	No
5/9/2023 17:15	0	0.025	0.0275	No	0	No
5/9/2023 17:16	0	0.029	0.0277	No	0	No
5/9/2023 17:17	0	0.027	0.0277	No	0	No
5/9/2023 17:18	0	0.028	0.0277	No	0	No
5/9/2023 17:19	0	0.025	0.0275	No	0	No
5/9/2023 17:20	0	0.025	0.0274	No	0	No
5/9/2023 17:21	0	0.029	0.0277	No	0	No
5/9/2023 17:22	0	0.023	0.0275	No	0	No

Downwind Station

Time	Instantaneous VOC (ppm)	Instantaneous Mass Conc. Total (mg/m ³)	Mass Conc. Total mg/m ³ AVG 15m (mg/m ³)	Dust Exceedance	VOC ppm AVG 15m (ppm)	VOC Exceedance
5/9/2023 17:23	0	0.026	0.0269	No	0	No
5/9/2023 17:24	0	0.027	0.0269	No	0	No
5/9/2023 17:25	0.003	0.027	0.0267	No	0.0002	No