



Daily Activity Report

Seton Brilla Charter School
1956 Jerome Avenue, Bronx, NY
BCP No. C203152

General Site Information

Date:	Monday, April 24, 2023
Weather:	Sunny, 43-60°F
Wind Direction/Speed:	NW @ 6 mph
AKRF Personnel on Site:	Lucas Belangia
AKRF Equipment on Site:	Mini RAE 3000 Photoionization Detector [(PID) x1], 2 Fixed Air Monitoring Stations [DustTrak Aerosol Monitors (x2) & MiniRAE 3000 PIDs (x2)], 1 Roving Set [MiniRAE 3000].
Visitors:	None

Contractor Information

Contracting Company	Main Personnel	Equipment
Casino Construction	Carlos	Excavator and a mini-excavator

Description and Location of Work Activities Performed

- 1) Soil/fill was excavated from grids WC-03 and WC-04, which was loaded onto 11 trucks and sent for off-site disposal at the Clean Earth - Bethlehem facility in Bethlehem, PA.
- 2) Rebar installation, formwork construction, and pile removal onsite continued.

Destination Facility	Daily Trucks	Total Trucks	Daily Approx. Cubic Yds	Total Approx. Cubic Yds	Total Site Loads	Total Approximate Cubic Yards
Clean Earth Carteret	0	108	0	2,160	186	3,720
Clean Earth Southeastern Pennsylvania	0	67	0	1,340		
Clean Earth Bethlehem	11	11	220	220		
Concrete Disposal	0	27	0	540		
N/A	0	0	0	0		

CAMP Air Monitoring Results

CAMP Station	UPWIND				DOWNWIND		
Odors:	None				None		
VOC Action Level Exceedance(s):	None				None		
Particulate Action Level Exceedance(s):	None				None		
Maximum VOC Level (15 min ppm):	0.06				0.171		
Maximum Particulate Level (15 min mg/m ³):	0.028				0.1015		

Notes: CAMP monitoring was performed throughout the day. No exceedances were reported.

Additional Information

Planned Work Activity for Following Day/Week:	1) Continued installation of rebar. 2) Continued export of soil to Clean Earth Bethlehem.
Comments:	

Site Map

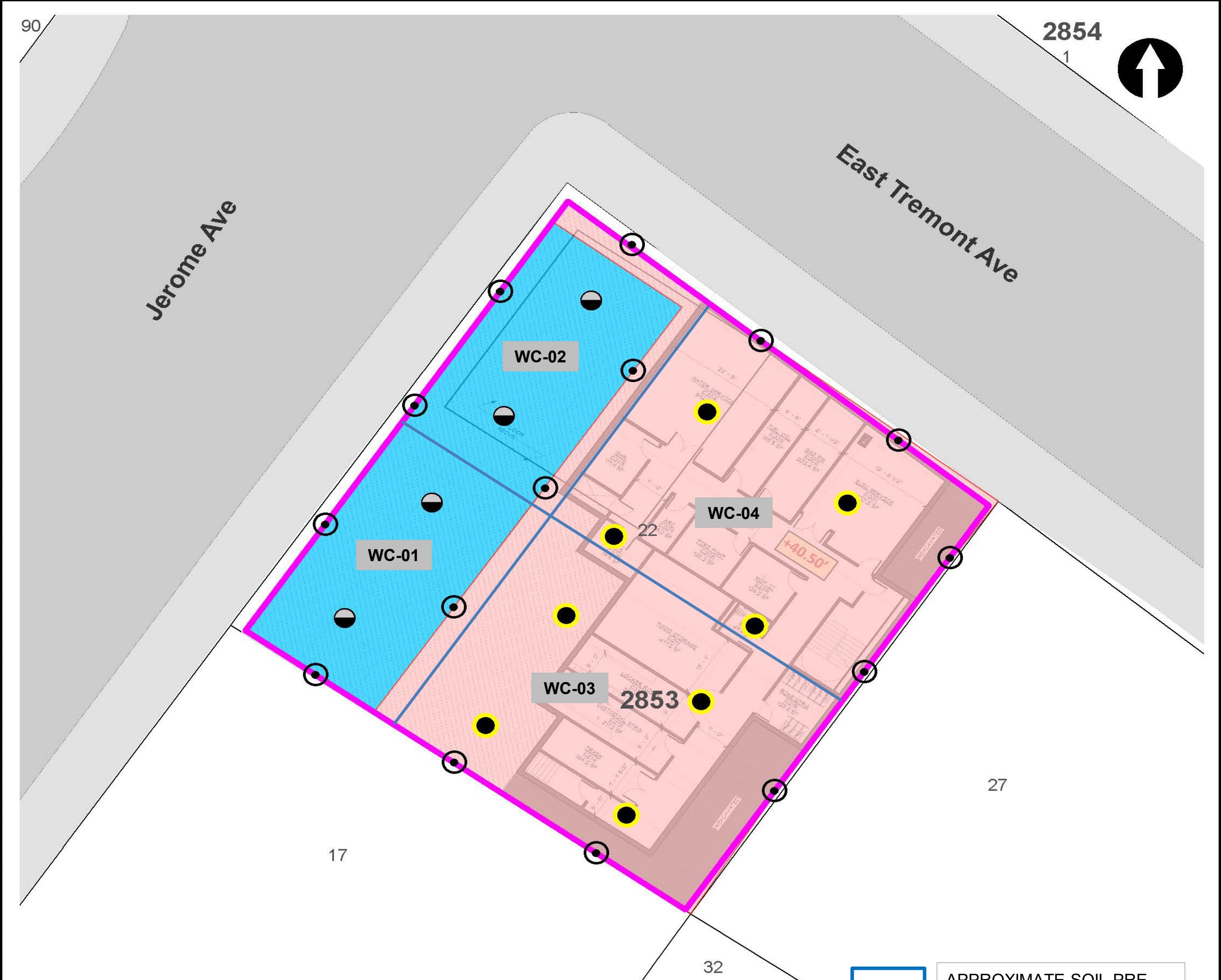

LEGEND

- PROJECT SITE BOUNDARY
- LOT BOUNDARY AND TAX LOT NUMBER
- 2853** BLOCK NUMBER
- REMEDIAL EXCAVATION TO APPROXIMATELY TWO FEET BELOW EXISTING GRADE
- REMEDIAL EXCAVATION TO GROUNDWATER (SOURCE AREA)

- CONFIRMATION DOCUMENTATION BOTTOM SAMPLE
- SOURCE AREA DOCUMENTATION BOTTOM SAMPLE
- DOCUMENTATION SIDEWALL SAMPLE

NOTE
 REMEDIAL EXCAVATION WILL INCLUDE REMOVAL OF APPROXIMATELY 1,280 TONS (850 CUBIC YARDS) OF SOURCE MATERIAL ASSOCIATED WITH NYSDEC SPILL NO. 2103719 AND APPROXIMATELY 860 TONS (570 CUBIC YARDS) OF SOIL/FILL FROM THE UPPER 2 FEET SITE-WIDE.



Map Source:
 NYCDOP (NYC Dept. of City Planning) GIS database

© 2021 AKRF. W:\Projects\210024 - 1956 JEROME AVENUE\Technical\GIS and Graphics\AR\RAW\210024 Figure 9 Proposed Remedial Excavation and Documentation Sample Location Plan.mxd 10/25/2021 2:03:38 PM iszalus



440 Park Avenue South, New York, NY 10016

1956 Jerome Avenue
 Bronx, New York

**TRACK 4 CLEANUP AND DOCUMENTATION
 SAMPLE LOCATION PLAN**

DATE
04/29/2022

PROJECT NO.
210024

FIGURE
11

Site Photographs

Photograph 1 - Form construction. View facing Southeast.



Photograph 2 - Rebar installation. View facing South.



Photograph 3 - Excavation around piles. General view of the site. View facing South.



Upwind Station						
Time	Instaneous VOC (ppm)	Instaneous Mass Conc. Total (mg/m ³)	Mass Conc. Total mg/m ³ AVG 15m (mg/m ³)	Dust Exceedance	VOC ppm AVG 15m (ppm)	VOC Exceedance
4/24/2023 7:17	0		0	No		No
4/24/2023 7:18	0.012	0.058	0.006	No	0.058	No
4/24/2023 7:19	0.045	0.023	0.019	No	0.0405	No
4/24/2023 7:20	0	0.015	0.0143	No	0.032	No
4/24/2023 7:21	0	0.015	0.0114	No	0.0278	No
4/24/2023 7:22	0	0.014	0.0095	No	0.025	No
4/24/2023 7:23	0	0.013	0.0081	No	0.023	No
4/24/2023 7:24	0	0.012	0.0071	No	0.0214	No
4/24/2023 7:25	0	0.013	0.0063	No	0.0204	No
4/24/2023 7:26	0	0.013	0.0057	No	0.0196	No
4/24/2023 7:27	0	0.014	0.0052	No	0.019	No
4/24/2023 7:28	0	0.015	0.0048	No	0.0186	No
4/24/2023 7:29	0	0.014	0.0044	No	0.0183	No
4/24/2023 7:30	0	0.014	0.0041	No	0.0179	No
4/24/2023 7:31	0	0.015	0.0038	No	0.0177	No
4/24/2023 7:32	0	0.014	0.0038	No	0.0175	No
4/24/2023 7:33	0	0.014	0.003	No	0.0145	No
4/24/2023 7:34	0	0.017	0	No	0.0141	No
4/24/2023 7:35	0	0.019	0	No	0.0144	No
4/24/2023 7:36	0	0.017	0	No	0.0145	No
4/24/2023 7:37	0	0.019	0	No	0.0149	No
4/24/2023 7:38	0	0.017	0	No	0.0151	No
4/24/2023 7:39	0	0.016	0	No	0.0154	No
4/24/2023 7:40	0	0.019	0	No	0.0158	No
4/24/2023 7:41	0	0.018	0	No	0.0161	No
4/24/2023 7:42	0	0.017	0	No	0.0163	No
4/24/2023 7:43	0	0.018	0	No	0.0165	No
4/24/2023 7:44	0	0.024	0	No	0.0172	No
4/24/2023 7:45	0	0.021	0	No	0.0177	No
4/24/2023 7:46	0	0.017	0	No	0.0178	No
4/24/2023 7:47	0	0.024	0	No	0.0185	No
4/24/2023 7:48	0	0.02	0	No	0.0189	No
4/24/2023 7:49	0	0.023	0	No	0.0193	No
4/24/2023 7:50	0	0.021	0	No	0.0194	No
4/24/2023 7:51	0	0.02	0	No	0.0196	No
4/24/2023 7:52	0	0.028	0	No	0.0202	No
4/24/2023 7:53	0	0.027	0	No	0.0209	No
4/24/2023 7:54	0	0.031	0	No	0.0219	No
4/24/2023 7:55	0	0.022	0	No	0.0221	No
4/24/2023 7:56	0	0.017	0	No	0.022	No
4/24/2023 7:57	0	0.017	0	No	0.022	No
4/24/2023 7:58	0	0.015	0	No	0.0218	No
4/24/2023 7:59	0	0.016	0	No	0.0213	No
4/24/2023 8:00	0	0.022	0	No	0.0213	No
4/24/2023 8:01	0	0.02	0	No	0.0215	No
4/24/2023 8:02	0	0.022	0	No	0.0214	No
4/24/2023 8:03	0.329	0.027	0.0219	No	0.0219	No
4/24/2023 8:04	0	0.019	0.0219	No	0.0216	No
4/24/2023 8:05	0	0.014	0.0219	No	0.0211	No
4/24/2023 8:06	0	0.017	0.0219	No	0.0209	No
4/24/2023 8:07	0	0.014	0.0219	No	0.02	No
4/24/2023 8:08	0	0.017	0.0219	No	0.0193	No

Upwind Station						
Time	Instaneous VOC (ppm)	Instaneous Mass Conc. Total (mg/m ³)	Mass Conc. Total mg/m ³ AVG 15m (mg/m ³)	Dust Exceedance	VOC ppm AVG 15m (ppm)	VOC Exceedance
4/24/2023 8:09	0	0.019	0.0219	No	0.0185	No
4/24/2023 8:10	0	0.075	0.0219	No	0.0221	No
4/24/2023 8:11	0	0.04	0.0219	No	0.0236	No
4/24/2023 8:12	0.013	0.031	0.0228	No	0.0245	No
4/24/2023 8:13	0	0.027	0.0228	No	0.0253	No
4/24/2023 8:14	0	0.023	0.0228	No	0.0258	No
4/24/2023 8:15	0	0.023	0.0228	No	0.0259	No
4/24/2023 8:16	0	0.02	0.0228	No	0.0259	No
4/24/2023 8:17	0	0.018	0.0228	No	0.0256	No
4/24/2023 8:18	0	0.024	0.0009	No	0.0254	No
4/24/2023 8:19	0	0.021	0.0009	No	0.0255	No
4/24/2023 8:20	0	0.016	0.0009	No	0.0257	No
4/24/2023 8:21	0	0.017	0.0009	No	0.0257	No
4/24/2023 8:22	0	0.02	0.0009	No	0.0261	No
4/24/2023 8:23	0	0.018	0.0009	No	0.0261	No
4/24/2023 8:24	0	0.017	0.0009	No	0.026	No
4/24/2023 8:25	0	0.017	0.0009	No	0.0221	No
4/24/2023 8:26	0	0.024	0.0009	No	0.0211	No
4/24/2023 8:27	0	0.017	0	No	0.0201	No
4/24/2023 8:28	0	0.016	0	No	0.0194	No
4/24/2023 8:29	0	0.016	0	No	0.0189	No
4/24/2023 8:30	0	0.016	0	No	0.0185	No
4/24/2023 8:31	0	0.015	0	No	0.0181	No
4/24/2023 8:32	0	0.016	0	No	0.018	No
4/24/2023 8:33	0	0.015	0	No	0.0174	No
4/24/2023 8:34	0	0.016	0	No	0.0171	No
4/24/2023 8:35	0	0.015	0	No	0.017	No
4/24/2023 8:36	0	0.015	0	No	0.0169	No
4/24/2023 8:37	0	0.021	0	No	0.0169	No
4/24/2023 8:38	0	0.018	0	No	0.0169	No
4/24/2023 8:39	0	0.016	0	No	0.0169	No
4/24/2023 8:40	0	0.016	0	No	0.0168	No
4/24/2023 8:41	0	0.016	0	No	0.0163	No
4/24/2023 8:42	0	0.02	0	No	0.0165	No
4/24/2023 8:43	0	0.02	0	No	0.0167	No
4/24/2023 8:44	0	0.022	0	No	0.0171	No
4/24/2023 8:45	0	0.02	0	No	0.0174	No
4/24/2023 8:46	0	0.018	0	No	0.0176	No
4/24/2023 8:47	0	0.018	0	No	0.0177	No
4/24/2023 8:48	0	0.015	0	No	0.0177	No
4/24/2023 8:49	0	0.019	0	No	0.0179	No
4/24/2023 8:50	0	0.017	0	No	0.0181	No
4/24/2023 8:51	0	0.017	0	No	0.0182	No
4/24/2023 8:52	0	0.015	0	No	0.0178	No
4/24/2023 8:53	0	0.016	0	No	0.0177	No
4/24/2023 8:54	0	0.017	0	No	0.0177	No
4/24/2023 8:55	0	0.016	0	No	0.0177	No
4/24/2023 8:56	0	0.017	0	No	0.0178	No
4/24/2023 8:57	0	0.014	0	No	0.0174	No
4/24/2023 8:58	0	0.016	0	No	0.0171	No
4/24/2023 8:59	0	0.015	0	No	0.0167	No
4/24/2023 9:00	0	0.021	0	No	0.0167	No

Upwind Station						
Time	Instaneous VOC (ppm)	Instaneous Mass Conc. Total (mg/m ³)	Mass Conc. Total mg/m ³ AVG 15m (mg/m ³)	Dust Exceedance	VOC ppm AVG 15m (ppm)	VOC Exceedance
4/24/2023 9:01	0	0.018	0	No	0.0167	No
4/24/2023 9:02	0	0.016	0	No	0.0166	No
4/24/2023 9:03	0	0.018	0	No	0.0168	No
4/24/2023 9:04	0	0.017	0	No	0.0167	No
4/24/2023 9:05	0	0.018	0	No	0.0167	No
4/24/2023 9:06	0	0.016	0	No	0.0167	No
4/24/2023 9:07	0	0.018	0	No	0.0169	No
4/24/2023 9:08	0	0.018	0	No	0.017	No
4/24/2023 9:09	0	0.017	0	No	0.017	No
4/24/2023 9:10	0	0.021	0	No	0.0173	No
4/24/2023 9:11	0	0.016	0	No	0.0173	No
4/24/2023 9:12	0	0.018	0	No	0.0175	No
4/24/2023 9:13	0	0.023	0	No	0.018	No
4/24/2023 9:14	0	0.021	0	No	0.0184	No
4/24/2023 9:15	0	0.02	0	No	0.0183	No
4/24/2023 9:16	0	0.019	0	No	0.0184	No
4/24/2023 9:17	0	0.015	0	No	0.0183	No
4/24/2023 9:18	0	0.014	0	No	0.0181	No
4/24/2023 9:19	0	0.015	0	No	0.0179	No
4/24/2023 9:20	0	0.015	0	No	0.0177	No
4/24/2023 9:21	0	0.016	0	No	0.0177	No
4/24/2023 9:22	0	0.021	0	No	0.0179	No
4/24/2023 9:23	0	0.023	0	No	0.0183	No
4/24/2023 9:24	0	0.022	0	No	0.0186	No
4/24/2023 9:25	0	0.021	0	No	0.0186	No
4/24/2023 9:26	0	0.024	0	No	0.0191	No
4/24/2023 9:27	0	0.017	0	No	0.0191	No
4/24/2023 9:28	0	0.016	0	No	0.0186	No
4/24/2023 9:29	0	0.017	0	No	0.0183	No
4/24/2023 9:30	0	0.034	0	No	0.0193	No
4/24/2023 9:31	0	0.018	0	No	0.0192	No
4/24/2023 9:32	0	0.014	0	No	0.0191	No
4/24/2023 9:33	0	0.015	0	No	0.0192	No
4/24/2023 9:34	0	0.015	0	No	0.0192	No
4/24/2023 9:35	0	0.016	0	No	0.0193	No
4/24/2023 9:36	0	0.018	0	No	0.0194	No
4/24/2023 9:37	0	0.018	0	No	0.0192	No
4/24/2023 9:38	0	0.016	0	No	0.0187	No
4/24/2023 9:39	0	0.015	0	No	0.0183	No
4/24/2023 9:40	0	0.014	0	No	0.0178	No
4/24/2023 9:41	0	0.017	0	No	0.0173	No
4/24/2023 9:42	0	0.016	0	No	0.0173	No
4/24/2023 9:43	0	0.015	0	No	0.0172	No
4/24/2023 9:44	0	0.022	0	No	0.0175	No
4/24/2023 9:45	0	0.026	0	No	0.017	No
4/24/2023 9:46	0	0.025	0	No	0.0175	No
4/24/2023 9:47	0	0.015	0	No	0.0175	No
4/24/2023 9:48	0	0.015	0	No	0.0175	No
4/24/2023 9:49	0	0.015	0	No	0.0175	No
4/24/2023 9:50	0	0.018	0	No	0.0177	No
4/24/2023 9:51	0	0.016	0	No	0.0175	No
4/24/2023 9:52	0	0.014	0	No	0.0173	No

Upwind Station						
Time	Instantaneous VOC (ppm)	Instantaneous Mass Conc. Total (mg/m ³)	Mass Conc. Total mg/m ³ AVG 15m (mg/m ³)	Dust Exceedance	VOC ppm AVG 15m (ppm)	VOC Exceedance
4/24/2023 9:53	0	0.017	0	No	0.0173	No
4/24/2023 9:54	0	0.015	0	No	0.0173	No
4/24/2023 9:55	0	0.016	0	No	0.0175	No
4/24/2023 9:56	0	0.019	0	No	0.0176	No
4/24/2023 9:57	0	0.023	0	No	0.0181	No
4/24/2023 9:58	0	0.015	0	No	0.0181	No
4/24/2023 9:59	0	0.018	0	No	0.0178	No
4/24/2023 10:00	0	0.015	0	No	0.0171	No
4/24/2023 10:01	0	0.014	0	No	0.0163	No
4/24/2023 10:02	0	0.015	0	No	0.0163	No
4/24/2023 10:03	0	0.014	0	No	0.0163	No
4/24/2023 10:04	0	0.016	0	No	0.0163	No
4/24/2023 10:05	0	0.017	0	No	0.0163	No
4/24/2023 10:06	0	0.016	0	No	0.0163	No
4/24/2023 10:07	0	0.014	0	No	0.0163	No
4/24/2023 10:08	0	0.014	0	No	0.0161	No
4/24/2023 10:09	0	0.014	0	No	0.016	No
4/24/2023 10:10	0	0.015	0	No	0.0159	No
4/24/2023 10:11	0	0.014	0	No	0.0156	No
4/24/2023 10:12	0	0.013	0	No	0.0149	No
4/24/2023 10:13	0	0.014	0	No	0.0149	No
4/24/2023 10:14	0	0.015	0	No	0.0147	No
4/24/2023 10:15	0	0.014	0	No	0.0146	No
4/24/2023 10:16	0	0.015	0	No	0.0147	No
4/24/2023 10:17	0	0.014	0	No	0.0146	No
4/24/2023 10:18	0	0.013	0	No	0.0145	No
4/24/2023 10:19	0	0.013	0	No	0.0143	No
4/24/2023 10:20	0	0.013	0	No	0.0141	No
4/24/2023 10:21	0	0.013	0	No	0.0139	No
4/24/2023 10:22	0	0.013	0	No	0.0138	No
4/24/2023 10:23	0	0.013	0	No	0.0137	No
4/24/2023 10:24	0	0.014	0	No	0.0137	No
4/24/2023 10:25	0	0.015	0	No	0.0137	No
4/24/2023 10:26	0	0.02	0	No	0.0141	No
4/24/2023 10:27	0	0.034	0	No	0.0155	No
4/24/2023 10:28	0	0.017	0	No	0.0157	No
4/24/2023 10:29	0	0.021	0	No	0.0161	No
4/24/2023 10:30	0	0.05	0	No	0.0185	No
4/24/2023 10:31	0	0.016	0	No	0.0186	No
4/24/2023 10:32	0	0.02	0	No	0.019	No
4/24/2023 10:33	0	0.017	0	No	0.0193	No
4/24/2023 10:34	0	0.016	0	No	0.0195	No
4/24/2023 10:35	0	0.015	0	No	0.0196	No
4/24/2023 10:36	0	0.019	0	No	0.02	No
4/24/2023 10:37	0	0.02	0	No	0.0205	No
4/24/2023 10:38	0	0.016	0	No	0.0207	No
4/24/2023 10:39	0	0.015	0	No	0.0207	No
4/24/2023 10:40	0	0.015	0	No	0.0207	No
4/24/2023 10:41	0	0.016	0	No	0.0205	No
4/24/2023 10:42	0	0.015	0	No	0.0192	No
4/24/2023 10:43	0	0.014	0	No	0.019	No
4/24/2023 10:44	0	0.016	0	No	0.0187	No

Upwind Station						
Time	Instaneous VOC (ppm)	Instaneous Mass Conc. Total (mg/m ³)	Mass Conc. Total mg/m ³ AVG 15m (mg/m ³)	Dust Exceedance	VOC ppm AVG 15m (ppm)	VOC Exceedance
4/24/2023 10:45	0	0.014	0	No	0.0163	No
4/24/2023 10:46	0	0.015	0	No	0.0162	No
4/24/2023 10:47	0	0.014	0	No	0.0158	No
4/24/2023 10:48	0	0.013	0	No	0.0155	No
4/24/2023 10:49	0	0.014	0	No	0.0154	No
4/24/2023 10:50	0	0.014	0	No	0.0153	No
4/24/2023 10:51	0	0.014	0	No	0.015	No
4/24/2023 10:52	0	0.015	0	No	0.0147	No
4/24/2023 10:53	0	0.015	0	No	0.0146	No
4/24/2023 10:54	0	0.015	0	No	0.0146	No
4/24/2023 10:55	0	0.015	0	No	0.0146	No
4/24/2023 10:56	0	0.016	0	No	0.0146	No
4/24/2023 10:57	0	0.015	0	No	0.0146	No
4/24/2023 10:58	0	0.014	0	No	0.0146	No
4/24/2023 10:59	0	0.019	0	No	0.0148	No
4/24/2023 11:00	0	0.017	0	No	0.015	No
4/24/2023 11:01	0	0.016	0	No	0.0151	No
4/24/2023 11:02	0	0.015	0	No	0.0151	No
4/24/2023 11:03	0	0.015	0	No	0.0153	No
4/24/2023 11:04	0	0.014	0	No	0.0153	No
4/24/2023 11:05	0	0.013	0	No	0.0152	No
4/24/2023 11:06	0	0.013	0	No	0.0151	No
4/24/2023 11:07	0	0.013	0	No	0.015	No
4/24/2023 11:08	0	0.015	0	No	0.015	No
4/24/2023 11:09	0	0.016	0	No	0.0151	No
4/24/2023 11:10	0	0.015	0	No	0.0151	No
4/24/2023 11:11	0	0.015	0	No	0.015	No
4/24/2023 11:12	0	0.015	0	No	0.015	No
4/24/2023 11:13	0	0.014	0	No	0.015	No
4/24/2023 11:14	0	0.014	0	No	0.0147	No
4/24/2023 11:15	0	0.014	0	No	0.0145	No
4/24/2023 11:16	0	0.014	0	No	0.0143	No
4/24/2023 11:17	0	0.015	0	No	0.0143	No
4/24/2023 11:18	0	0.015	0	No	0.0143	No
4/24/2023 11:19	0	0.027	0	No	0.0152	No
4/24/2023 11:20	0	0.015	0	No	0.0153	No
4/24/2023 11:21	0	0.013	0	No	0.0153	No
4/24/2023 11:22	0	0.016	0	No	0.0155	No
4/24/2023 11:23	0	0.016	0	No	0.0156	No
4/24/2023 11:24	0	0.015	0	No	0.0155	No
4/24/2023 11:25	0	0.017	0	No	0.0157	No
4/24/2023 11:26	0	0.015	0	No	0.0157	No
4/24/2023 11:27	0	0.014	0	No	0.0156	No
4/24/2023 11:28	0	0.02	0	No	0.016	No
4/24/2023 11:29	0	0.018	0	No	0.0163	No
4/24/2023 11:30	0	0.015	0	No	0.0163	No
4/24/2023 11:31	0	0.013	0	No	0.0163	No
4/24/2023 11:32	0	0.013	0	No	0.0161	No
4/24/2023 11:33	0	0.014	0	No	0.0161	No
4/24/2023 11:34	0	0.015	0	No	0.0153	No
4/24/2023 11:35	0	0.016	0	No	0.0153	No
4/24/2023 11:36	0	0.016	0	No	0.0155	No

Upwind Station						
Time	Instaneous VOC (ppm)	Instaneous Mass Conc. Total (mg/m ³)	Mass Conc. Total mg/m ³ AVG 15m (mg/m ³)	Dust Exceedance	VOC ppm AVG 15m (ppm)	VOC Exceedance
4/24/2023 11:37	0	0.022	0	No	0.0159	No
4/24/2023 11:38	0	0.02	0	No	0.0162	No
4/24/2023 11:39	0	0.017	0	No	0.0163	No
4/24/2023 11:40	0	0.015	0	No	0.0162	No
4/24/2023 11:41	0	0.014	0	No	0.0161	No
4/24/2023 11:42	0.056	0.019	0.0037	No	0.0165	No
4/24/2023 11:43	0.253	0.033	0.0206	No	0.0173	No
4/24/2023 11:44	0	0.03	0.0206	No	0.0181	No
4/24/2023 11:45	0	0.023	0.0206	No	0.0187	No
4/24/2023 11:46	0	0.016	0.0206	No	0.0189	No
4/24/2023 11:47	0	0.016	0.0206	No	0.0191	No
4/24/2023 11:48	0	0.015	0.0206	No	0.0191	No
4/24/2023 11:49	0	0.016	0.0206	No	0.0192	No
4/24/2023 11:50	0	0.021	0.0206	No	0.0195	No
4/24/2023 11:51	0	0.02	0.0206	No	0.0198	No
4/24/2023 11:52	0.047	0.031	0.0237	No	0.0204	No
4/24/2023 11:53	0	0.025	0.0237	No	0.0207	No
4/24/2023 11:54	0.033	0.022	0.0259	No	0.0211	No
4/24/2023 11:55	0	0.017	0.0259	No	0.0212	No
4/24/2023 11:56	0	0.016	0.0259	No	0.0213	No
4/24/2023 11:57	0	0.017	0.0222	No	0.0212	No
4/24/2023 11:58	0	0.018	0.0053	No	0.0202	No
4/24/2023 11:59	0	0.023	0.0053	No	0.0197	No
4/24/2023 12:00	0	0.013	0.0053	No	0.0191	No
4/24/2023 12:01	0	0.012	0.0053	No	0.0188	No
4/24/2023 12:02	0	0.015	0.0053	No	0.0187	No
4/24/2023 12:03	0	0.013	0.0053	No	0.0186	No
4/24/2023 12:04	0	0.012	0.0053	No	0.0183	No
4/24/2023 12:05	0	0.013	0.0053	No	0.0178	No
4/24/2023 12:06	0	0.024	0.0053	No	0.0181	No
4/24/2023 12:07	0	0.022	0.0022	No	0.0175	No
4/24/2023 12:08	0	0.016	0.0022	No	0.0169	No
4/24/2023 12:09	0	0.013	0	No	0.0163	No
4/24/2023 12:10	0	0.013	0	No	0.016	No
4/24/2023 12:11	0	0.013	0	No	0.0158	No
4/24/2023 12:12	0	0.014	0	No	0.0156	No
4/24/2023 12:13	0	0.014	0	No	0.0153	No
4/24/2023 12:14	0	0.012	0	No	0.0146	No
4/24/2023 12:15	0	0.013	0	No	0.0146	No
4/24/2023 12:16	0	0.015	0	No	0.0148	No
4/24/2023 12:17	0	0.014	0	No	0.0147	No
4/24/2023 12:18	0	0.037	0	No	0.0163	No
4/24/2023 12:19	0	0.017	0	No	0.0167	No
4/24/2023 12:20	0	0.015	0	No	0.0168	No
4/24/2023 12:21	0	0.011	0	No	0.0159	No
4/24/2023 12:22	0	0.012	0	No	0.0153	No
4/24/2023 12:23	0	0.014	0	No	0.0151	No
4/24/2023 12:24	0	0.016	0	No	0.0153	No
4/24/2023 12:25	0	0.014	0	No	0.0154	No
4/24/2023 12:26	0	0.014	0	No	0.0155	No
4/24/2023 12:27	0	0.013	0	No	0.0154	No
4/24/2023 12:28	0	0.013	0	No	0.0153	No

Upwind Station						
Time	Instaneous VOC (ppm)	Instaneous Mass Conc. Total (mg/m ³)	Mass Conc. Total mg/m ³ AVG 15m (mg/m ³)	Dust Exceedance	VOC ppm AVG 15m (ppm)	VOC Exceedance
4/24/2023 12:29	0	0.013	0	No	0.0154	No
4/24/2023 12:30	0	0.012	0	No	0.0153	No
4/24/2023 12:31	0	0.012	0	No	0.0151	No
4/24/2023 12:32	0	0.017	0	No	0.0153	No
4/24/2023 12:33	0	0.018	0	No	0.0141	No
4/24/2023 12:34	0	0.013	0	No	0.0138	No
4/24/2023 12:35	0	0.012	0	No	0.0136	No
4/24/2023 12:36	0	0.011	0	No	0.0136	No
4/24/2023 12:37	0	0.012	0	No	0.0136	No
4/24/2023 12:38	0	0.015	0	No	0.0137	No
4/24/2023 12:39	0	0.017	0	No	0.0137	No
4/24/2023 12:40	0	0.014	0	No	0.0137	No
4/24/2023 12:41	0	0.013	0	No	0.0137	No
4/24/2023 12:42	0	0.014	0	No	0.0137	No
4/24/2023 12:43	0	0.011	0	No	0.0136	No
4/24/2023 12:44	0	0.011	0	No	0.0135	No
4/24/2023 12:45	0	0.013	0	No	0.0135	No
4/24/2023 12:46	0	0.017	0	No	0.0139	No
4/24/2023 12:47	0	0.014	0	No	0.0137	No
4/24/2023 12:48	0	0.014	0	No	0.0134	No
4/24/2023 12:49	0	0.013	0	No	0.0134	No
4/24/2023 12:50	0	0.014	0	No	0.0135	No
4/24/2023 12:51	0	0.014	0	No	0.0137	No
4/24/2023 12:52	0	0.016	0	No	0.014	No
4/24/2023 12:53	0	0.015	0	No	0.014	No
4/24/2023 12:54	0	0.018	0	No	0.0141	No
4/24/2023 12:55	0	0.014	0	No	0.0141	No
4/24/2023 12:56	0	0.013	0	No	0.0141	No
4/24/2023 12:57	0	0.015	0	No	0.0141	No
4/24/2023 12:58	0	0.013	0	No	0.0143	No
4/24/2023 12:59	0	0.012	0	No	0.0143	No
4/24/2023 13:00	0	0.015	0	No	0.0145	No
4/24/2023 13:01	0	0.011	0	No	0.0141	No
4/24/2023 13:02	0	0.013	0	No	0.014	No
4/24/2023 13:03	0	0.013	0	No	0.0139	No
4/24/2023 13:04	0	0.013	0	No	0.0139	No
4/24/2023 13:05	0	0.019	0	No	0.0143	No
4/24/2023 13:06	0	0.011	0	No	0.0141	No
4/24/2023 13:07	0.012	0.013	0.0008	No	0.0139	No
4/24/2023 13:08	0	0.012	0.0008	No	0.0137	No
4/24/2023 13:09	0	0.012	0.0008	No	0.0133	No
4/24/2023 13:10	0	0.012	0.0008	No	0.0131	No
4/24/2023 13:11	0	0.011	0.0008	No	0.013	No
4/24/2023 13:12	0	0.011	0.0008	No	0.0127	No
4/24/2023 13:13	0	0.012	0.0008	No	0.0127	No
4/24/2023 13:14	0	0.012	0.0008	No	0.0127	No
4/24/2023 13:15	0	0.013	0.0008	No	0.0125	No
4/24/2023 13:16	0	0.011	0.0008	No	0.0125	No
4/24/2023 13:17	0	0.011	0.0008	No	0.0124	No
4/24/2023 13:18	0	0.012	0.0008	No	0.0123	No
4/24/2023 13:19	0	0.011	0.0008	No	0.0122	No
4/24/2023 13:20	0	0.013	0.0008	No	0.0118	No

Upwind Station						
Time	Instaneous VOC (ppm)	Instaneous Mass Conc. Total (mg/m ³)	Mass Conc. Total mg/m ³ AVG 15m (mg/m ³)	Dust Exceedance	VOC ppm AVG 15m (ppm)	VOC Exceedance
4/24/2023 13:21	0	0.011	0.0008	No	0.0118	No
4/24/2023 13:22	0	0.011	0	No	0.0117	No
4/24/2023 13:23	0	0.014	0	No	0.0118	No
4/24/2023 13:24	0	0.025	0	No	0.0127	No
4/24/2023 13:25	0	0.024	0	No	0.0135	No
4/24/2023 13:26	0	0.019	0	No	0.014	No
4/24/2023 13:27	0	0.012	0	No	0.0141	No
4/24/2023 13:28	0	0.014	0	No	0.0142	No
4/24/2023 13:29	0	0.016	0	No	0.0145	No
4/24/2023 13:30	0	0.013	0	No	0.0145	No
4/24/2023 13:31	0	0.011	0	No	0.0145	No
4/24/2023 13:32	0	0.02	0	No	0.0151	No
4/24/2023 13:33	0	0.018	0	No	0.0155	No
4/24/2023 13:34	0.42	0.015	0.028	No	0.0157	No
4/24/2023 13:35	0	0.011	0.028	No	0.0156	No
4/24/2023 13:36	0	0.04	0.028	No	0.0175	No
4/24/2023 13:37	0	0.011	0.028	No	0.0175	No
4/24/2023 13:38	0	0.012	0.028	No	0.0174	No
4/24/2023 13:39	0	0.016	0.028	No	0.0168	No
4/24/2023 13:40	0	0.014	0.028	No	0.0161	No
4/24/2023 13:41	0	0.014	0.028	No	0.0158	No
4/24/2023 13:42	0	0.011	0.028	No	0.0157	No
4/24/2023 13:43	0	0.014	0.028	No	0.0157	No
4/24/2023 13:44	0	0.019	0.028	No	0.0159	No
4/24/2023 13:45	0	0.033	0.028	No	0.0173	No
4/24/2023 13:46	0	0.018	0.028	No	0.0177	No
4/24/2023 13:47	0	0.013	0.028	No	0.0173	No
4/24/2023 13:48	0	0.016	0.028	No	0.0171	No
4/24/2023 13:49	0	0.014	0	No	0.0171	No
4/24/2023 13:50	0	0.014	0	No	0.0173	No
4/24/2023 13:51	0	0.012	0	No	0.0154	No
4/24/2023 13:52	0	0.012	0	No	0.0155	No
4/24/2023 13:53	0	0.015	0	No	0.0157	No
4/24/2023 13:54	0	0.016	0	No	0.0157	No
4/24/2023 13:55	0	0.02	0	No	0.0161	No
4/24/2023 13:56	0	0.021	0	No	0.0165	No
4/24/2023 13:57	0	0.032	0	No	0.0179	No
4/24/2023 13:58	0	0.018	0	No	0.0182	No
4/24/2023 13:59	0	0.016	0	No	0.018	No
4/24/2023 14:00	0	0.014	0	No	0.0167	No
4/24/2023 14:01	0	0.014	0	No	0.0165	No
4/24/2023 14:02	0	0.019	0	No	0.0169	No
4/24/2023 14:03	0	0.01	0	No	0.0165	No
4/24/2023 14:04	0	0.011	0	No	0.0163	No
4/24/2023 14:05	0	0.015	0	No	0.0163	No
4/24/2023 14:06	0	0.016	0	No	0.0166	No
4/24/2023 14:07	0	0.027	0	No	0.0176	No
4/24/2023 14:08	0	0.026	0	No	0.0183	No
4/24/2023 14:09	0	0.018	0	No	0.0185	No
4/24/2023 14:10	0	0.017	0	No	0.0183	No
4/24/2023 14:11	0	0.024	0	No	0.0185	No
4/24/2023 14:12	0	0.028	0	No	0.0182	No

Upwind Station						
Time	Instantaneous VOC (ppm)	Instantaneous Mass Conc. Total (mg/m ³)	Mass Conc. Total mg/m ³ AVG 15m (mg/m ³)	Dust Exceedance	VOC ppm AVG 15m (ppm)	VOC Exceedance
4/24/2023 14:13	0	0.014	0	No	0.0179	No
4/24/2023 14:14	0	0.014	0	No	0.0178	No
4/24/2023 14:15	0	0.01	0	No	0.0175	No
4/24/2023 14:16	0	0.01	0	No	0.0173	No
4/24/2023 14:17	0	0.012	0	No	0.0168	No
4/24/2023 14:18	0	0.012	0	No	0.0169	No
4/24/2023 14:19	0	0.012	0	No	0.017	No
4/24/2023 14:20	0	0.012	0	No	0.0168	No
4/24/2023 14:21	0	0.014	0	No	0.0167	No
4/24/2023 14:22	0	0.011	0	No	0.0156	No
4/24/2023 14:23	0	0.017	0	No	0.015	No
4/24/2023 14:24	0	0.014	0	No	0.0147	No
4/24/2023 14:25	0	0.026	0	No	0.0153	No
4/24/2023 14:26	0	0.038	0	No	0.0163	No
4/24/2023 14:27	0	0.014	0	No	0.0153	No
4/24/2023 14:28	0	0.013	0	No	0.0153	No
4/24/2023 14:29	0	0.028	0	No	0.0162	No
4/24/2023 14:30	0	0.012	0	No	0.0163	No
4/24/2023 14:31	0	0.011	0	No	0.0164	No
4/24/2023 14:32	0	0.015	0	No	0.0166	No
4/24/2023 14:33	0	0.012	0	No	0.0166	No
4/24/2023 14:34	0	0.01	0	No	0.0165	No
4/24/2023 14:35	0	0.009	0	No	0.0163	No
4/24/2023 14:36	0	0.009	0	No	0.0159	No
4/24/2023 14:37	0	0.01	0	No	0.0159	No
4/24/2023 14:38	0	0.012	0	No	0.0155	No
4/24/2023 14:39	0	0.01	0	No	0.0153	No
4/24/2023 14:40	0	0.013	0	No	0.0144	No
4/24/2023 14:41	0	0.009	0	No	0.0125	No
4/24/2023 14:42	0	0.011	0	No	0.0123	No
4/24/2023 14:43	0	0.013	0	No	0.0123	No
4/24/2023 14:44	0	0.013	0	No	0.0113	No
4/24/2023 14:45	0	0.018	0	No	0.0117	No
4/24/2023 14:46	0	0.014	0	No	0.0119	No
4/24/2023 14:47	0	0.011	0	No	0.0116	No
4/24/2023 14:48	0	0.009	0	No	0.0114	No
4/24/2023 14:49	0	0.008	0	No	0.0113	No
4/24/2023 14:50	0	0.01	0	No	0.0113	No
4/24/2023 14:51	0	0.012	0	No	0.0115	No
4/24/2023 14:52	0	0.009	0	No	0.0115	No
4/24/2023 14:53	0	0.009	0	No	0.0113	No
4/24/2023 14:54	0	0.008	0	No	0.0111	No
4/24/2023 14:55	0	0.009	0	No	0.0109	No
4/24/2023 14:56	0	0.008	0	No	0.0108	No
4/24/2023 14:57	0	0.008	0	No	0.0106	No
4/24/2023 14:58	0	0.009	0	No	0.0103	No
4/24/2023 14:59	0	0.008	0	No	0.01	No
4/24/2023 15:00	0	0.008	0	No	0.0093	No
4/24/2023 15:01	0	0.011	0	No	0.0091	No
4/24/2023 15:02	0	0.011	0	No	0.0091	No
4/24/2023 15:03	0	0.007	0	No	0.009	No
4/24/2023 15:04	0	0.009	0	No	0.0091	No

Upwind Station						
Time	Instaneous VOC (ppm)	Instaneous Mass Conc. Total (mg/m ³)	Mass Conc. Total mg/m ³ AVG 15m (mg/m ³)	Dust Exceedance	VOC ppm AVG 15m (ppm)	VOC Exceedance
4/24/2023 15:05	0	0.009	0	No	0.009	No
4/24/2023 15:06	0	0.008	0	No	0.0087	No
4/24/2023 15:07	0	0.008	0	No	0.0087	No
4/24/2023 15:08	0	0.009	0	No	0.0087	No
4/24/2023 15:09	0	0.01	0	No	0.0088	No
4/24/2023 15:10	0	0.009	0	No	0.0088	No
4/24/2023 15:11	0	0.01	0	No	0.0089	No
4/24/2023 15:12	0	0.013	0	No	0.0093	No
4/24/2023 15:13	0	0.01	0	No	0.0093	No
4/24/2023 15:14	0	0.011	0	No	0.0095	No
4/24/2023 15:15	0	0.009	0	No	0.0096	No
4/24/2023 15:16	0	0.009	0	No	0.0095	No
4/24/2023 15:17	0	0.007	0	No	0.0092	No
4/24/2023 15:18	0	0.008	0	No	0.0093	No
4/24/2023 15:19	0	0.013	0	No	0.0095	No
4/24/2023 15:20	0	0.009	0	No	0.0095	No
4/24/2023 15:21	0	0.01	0	No	0.0097	No
4/24/2023 15:22	0	0.013	0	No	0.01	No
4/24/2023 15:23	0	0.01	0	No	0.0101	No
4/24/2023 15:24	0	0.023	0	No	0.0109	No
4/24/2023 15:25	0	0.014	0	No	0.0113	No
4/24/2023 15:26	0	0.01	0	No	0.0113	No
4/24/2023 15:27	0	0.021	0	No	0.0118	No
4/24/2023 15:28	0	0.016	0	No	0.0122	No
4/24/2023 15:29	0	0.019	0	No	0.0127	No
4/24/2023 15:30	0	0.014	0	No	0.0131	No
4/24/2023 15:31	0	0.021	0	No	0.0139	No
4/24/2023 15:32	0	0.039	0	No	0.016	No
4/24/2023 15:33	0	0.038	0	No	0.018	No
4/24/2023 15:34	0	0.021	0	No	0.0185	No
4/24/2023 15:35	0	0.017	0	No	0.0191	No
4/24/2023 15:36	0	0.01	0	No	0.0191	No
4/24/2023 15:37	0	0.023	0	No	0.0197	No
4/24/2023 15:38	0	0.014	0	No	0.02	No
4/24/2023 15:39	0	0.012	0	No	0.0193	No
4/24/2023 15:40	0	0.01	0	No	0.019	No
4/24/2023 15:41	0	0.007	0	No	0.0188	No
4/24/2023 15:42	0	0.009	0	No	0.018	No
4/24/2023 15:43	0	0.009	0	No	0.0175	No
4/24/2023 15:44	0	0.012	0	No	0.0171	No
4/24/2023 15:45	0	0.011	0	No	0.0169	No
4/24/2023 15:46	0	0.009	0	No	0.0161	No
4/24/2023 15:47	0	0.009	0	No	0.0141	No
4/24/2023 15:48	0	0.009	0	No	0.0121	No
4/24/2023 15:49	0	0.009	0	No	0.0113	No
4/24/2023 15:50	0	0.009	0	No	0.0108	No
4/24/2023 15:51	0	0.008	0	No	0.0107	No
4/24/2023 15:52	0	0.008	0	No	0.0097	No
4/24/2023 15:53	0	0.008	0	No	0.0093	No
4/24/2023 15:54	0	0.01	0	No	0.0091	No
4/24/2023 15:55	0	0.01	0	No	0.0091	No
4/24/2023 15:56	0	0.01	0	No	0.0093	No

Upwind Station						
Time	Instaneous VOC (ppm)	Instaneous Mass Conc. Total (mg/m ³)	Mass Conc. Total mg/m ³ AVG 15m (mg/m ³)	Dust Exceedance	VOC ppm AVG 15m (ppm)	VOC Exceedance
4/24/2023 15:57	0	0.009	0	No	0.0093	No
4/24/2023 15:58	0	0.008	0	No	0.0093	No
4/24/2023 15:59	0	0.009	0	No	0.0091	No
4/24/2023 16:00	0	0.008	0	No	0.0089	No
4/24/2023 16:01	0	0.009	0	No	0.0089	No
4/24/2023 16:02	0	0.015	0	No	0.0093	No
4/24/2023 16:03	0	0.01	0	No	0.0093	No
4/24/2023 16:04	0	0.01	0	No	0.0094	No
4/24/2023 16:05	0	0.01	0	No	0.0095	No
4/24/2023 16:06	0	0.011	0	No	0.0097	No
4/24/2023 16:07	0	0.01	0	No	0.0098	No
4/24/2023 16:08	0	0.009	0	No	0.0099	No
4/24/2023 16:09	0	0.019	0	No	0.0105	No
4/24/2023 16:10	0	0.029	0	No	0.0117	No
4/24/2023 16:11	0	0.012	0	No	0.0119	No
4/24/2023 16:12	0	0.019	0	No	0.0125	No
4/24/2023 16:13	0	0.026	0	No	0.0137	No
4/24/2023 16:14	0	0.029	0	No	0.0151	No
4/24/2023 16:15	0	0.02	0	No	0.0159	No

Downwind Station						
Time	Instaneous VOC (ppm)	Instaneous Mass Conc. Total (mg/m ³)	Mass Conc. Total mg/m ³ AVG 15m (mg/m ³)	Dust Exceedance	VOC ppm AVG 15m (ppm)	VOC Exceedance
4/24/2023 7:13	0.03			No	0.03	No
4/24/2023 7:14	0	0.017	0.017	No	0.015	No
4/24/2023 7:15	0	0.023	0.02	No	0.01	No
4/24/2023 7:16	0	0.016	0.0187	No	0.008	No
4/24/2023 7:17	0	0.018	0.0185	No	0.006	No
4/24/2023 7:18	0	0.02	0.0188	No	0.005	No
4/24/2023 7:19	0.023	0.022	0.0193	No	0.0076	No
4/24/2023 7:20	0.071	0.022	0.0197	No	0.0155	No
4/24/2023 7:21	0.038	0.018	0.0195	No	0.018	No
4/24/2023 7:22	0	0.029	0.0206	No	0.0162	No
4/24/2023 7:23	0	0.046	0.0231	No	0.0147	No
4/24/2023 7:24	0	0.018	0.0226	No	0.0135	No
4/24/2023 7:25	0	0.017	0.0222	No	0.0125	No
4/24/2023 7:26	0	0.026	0.0225	No	0.0116	No
4/24/2023 7:27	0	0.021	0.0224	No	0.0108	No
4/24/2023 7:28	0	0.023	0.0224	No	0.0088	No
4/24/2023 7:29	0	0.027	0.0231	No	0.0088	No
4/24/2023 7:30	0	0.022	0.023	No	0.0088	No
4/24/2023 7:31	0	0.019	0.0232	No	0.0088	No
4/24/2023 7:32	0	0.023	0.0235	No	0.0088	No
4/24/2023 7:33	0.044	0.026	0.0239	No	0.0117	No
4/24/2023 7:34	0	0.036	0.0249	No	0.0102	No
4/24/2023 7:35	0	0.026	0.0251	No	0.0055	No
4/24/2023 7:36	0	0.016	0.025	No	0.0029	No
4/24/2023 7:37	0	0.017	0.0242	No	0.0029	No
4/24/2023 7:38	0	0.021	0.0225	No	0.0029	No
4/24/2023 7:39	0	0.018	0.0225	No	0.0029	No
4/24/2023 7:40	0	0.016	0.0225	No	0.0029	No
4/24/2023 7:41	0	0.016	0.0218	No	0.0029	No
4/24/2023 7:42	0	0.017	0.0215	No	0.0029	No
4/24/2023 7:43	0	0.018	0.0212	No	0.0029	No
4/24/2023 7:44	0	0.02	0.0207	No	0.0029	No
4/24/2023 7:45	0	0.022	0.0207	No	0.0029	No
4/24/2023 7:46	0	0.022	0.0209	No	0.0029	No
4/24/2023 7:47	0	0.023	0.0209	No	0.0029	No
4/24/2023 7:48	0	0.023	0.0207	No	0	No
4/24/2023 7:49	0	0.021	0.0197	No	0	No
4/24/2023 7:50	0	0.025	0.0197	No	0	No
4/24/2023 7:51	0	0.038	0.0211	No	0	No
4/24/2023 7:52	0	0.1	0.0267	No	0	No
4/24/2023 7:53	0	0.081	0.0307	No	0	No
4/24/2023 7:54	0	0.042	0.0323	No	0	No
4/24/2023 7:55	0.412	0.032	0.0333	No	0.0275	No
4/24/2023 7:56	0.378	0.028	0.0341	No	0.0527	No
4/24/2023 7:57	0.123	0.032	0.0351	No	0.0609	No
4/24/2023 7:58	0	0.025	0.0356	No	0.0609	No
4/24/2023 7:59	0.032	0.02	0.0356	No	0.063	No
4/24/2023 8:00	0.051	0.023	0.0357	No	0.0664	No
4/24/2023 8:01	0.244	0.018	0.0354	No	0.0827	No
4/24/2023 8:02	0.002	0.018	0.0351	No	0.0828	No
4/24/2023 8:03	0	0.018	0.0347	No	0.0828	No
4/24/2023 8:04	0	0.021	0.0347	No	0.0828	No
4/24/2023 8:05	0	0.019	0.0343	No	0.0828	No
4/24/2023 8:06	0	0.018	0.033	No	0.0828	No
4/24/2023 8:07	0	0.016	0.0274	No	0.0828	No

Downwind Station						
Time	Instaneous VOC (ppm)	Instaneous Mass Conc. Total (mg/m ³)	Mass Conc. Total mg/m ³ AVG 15m (mg/m ³)	Dust Exceedance	VOC ppm AVG 15m (ppm)	VOC Exceedance
4/24/2023 8:08	0	0.017	0.0231	No	0.0828	No
4/24/2023 8:09	0	0.016	0.0214	No	0.0828	No
4/24/2023 8:10	0	0.023	0.0208	No	0.0553	No
4/24/2023 8:11	0	0.024	0.0205	No	0.0301	No
4/24/2023 8:12	0.003	0.255	0.0354	No	0.0221	No
4/24/2023 8:13	0	0.07	0.0384	No	0.0221	No
4/24/2023 8:14	0	0.028	0.0389	No	0.02	No
4/24/2023 8:15	0	0.023	0.0389	No	0.0166	No
4/24/2023 8:16	0	0.03	0.0397	No	0.0003	No
4/24/2023 8:17	0	0.035	0.0409	No	0.0002	No
4/24/2023 8:18	0	0.02	0.041	No	0.0002	No
4/24/2023 8:19	0	0.022	0.0411	No	0.0002	No
4/24/2023 8:20	0	0.03	0.0418	No	0.0002	No
4/24/2023 8:21	0	0.019	0.0419	No	0.0002	No
4/24/2023 8:22	0	0.018	0.042	No	0.0002	No
4/24/2023 8:23	0	0.037	0.0433	No	0.0002	No
4/24/2023 8:24	0	0.031	0.0443	No	0.0002	No
4/24/2023 8:25	0	0.033	0.045	No	0.0002	No
4/24/2023 8:26	0	0.022	0.0449	No	0.0002	No
4/24/2023 8:27	0	0.023	0.0294	No	0	No
4/24/2023 8:28	0	0.02	0.0261	No	0	No
4/24/2023 8:29	0	0.019	0.0255	No	0	No
4/24/2023 8:30	0.205	0.023	0.0255	No	0.0137	No
4/24/2023 8:31	0.134	0.024	0.0251	No	0.0226	No
4/24/2023 8:32	0.011	0.02	0.0241	No	0.0233	No
4/24/2023 8:33	0	0.019	0.024	No	0.0233	No
4/24/2023 8:34	0.003	0.022	0.024	No	0.0235	No
4/24/2023 8:35	0.054	0.024	0.0236	No	0.0271	No
4/24/2023 8:36	0.056	0.021	0.0237	No	0.0309	No
4/24/2023 8:37	0	0.023	0.0241	No	0.0309	No
4/24/2023 8:38	0.016	0.022	0.0231	No	0.0319	No
4/24/2023 8:39	0.012	0.02	0.0223	No	0.0327	No
4/24/2023 8:40	0.059	0.021	0.0215	No	0.0367	No
4/24/2023 8:41	0	0.019	0.0213	No	0.0367	No
4/24/2023 8:42	0	0.017	0.0209	No	0.0367	No
4/24/2023 8:43	0	0.018	0.0208	No	0.0367	No
4/24/2023 8:44	0	0.019	0.0208	No	0.0367	No
4/24/2023 8:45	0	0.019	0.0205	No	0.023	No
4/24/2023 8:46	0.006	0.023	0.0205	No	0.0145	No
4/24/2023 8:47	0	0.026	0.0209	No	0.0137	No
4/24/2023 8:48	0	0.027	0.0214	No	0.0137	No
4/24/2023 8:49	0	0.018	0.0211	No	0.0135	No
4/24/2023 8:50	0.011	0.027	0.0213	No	0.0107	No
4/24/2023 8:51	0	0.028	0.0218	No	0.0069	No
4/24/2023 8:52	0	0.024	0.0219	No	0.0069	No
4/24/2023 8:53	0	0.027	0.0222	No	0.0059	No
4/24/2023 8:54	0	0.034	0.0231	No	0.0051	No
4/24/2023 8:55	0	0.021	0.0231	No	0.0011	No
4/24/2023 8:56	0	0.037	0.0243	No	0.0011	No
4/24/2023 8:57	0	0.022	0.0247	No	0.0011	No
4/24/2023 8:58	0	0.023	0.025	No	0.0011	No
4/24/2023 8:59	0	0.03	0.0257	No	0.0011	No
4/24/2023 9:00	0	0.02	0.0258	No	0.0011	No
4/24/2023 9:01	0	0.018	0.0255	No	0.0007	No
4/24/2023 9:02	0	0.033	0.0259	No	0.0007	No

Downwind Station						
Time	Instaneous VOC (ppm)	Instaneous Mass Conc. Total (mg/m ³)	Mass Conc. Total mg/m ³ AVG 15m (mg/m ³)	Dust Exceedance	VOC ppm AVG 15m (ppm)	VOC Exceedance
4/24/2023 9:03	0	0.03	0.0261	No	0.0007	No
4/24/2023 9:04	0	0.028	0.0268	No	0.0007	No
4/24/2023 9:05	0	0.026	0.0267	No	0	No
4/24/2023 9:06	0	0.021	0.0263	No	0	No
4/24/2023 9:07	0	0.02	0.026	No	0	No
4/24/2023 9:08	0	0.021	0.0256	No	0	No
4/24/2023 9:09	0	0.025	0.025	No	0	No
4/24/2023 9:10	0	0.025	0.0253	No	0	No
4/24/2023 9:11	0	0.048	0.026	No	0	No
4/24/2023 9:12	0	0.023	0.0261	No	0	No
4/24/2023 9:13	0	0.023	0.0261	No	0	No
4/24/2023 9:14	0	0.024	0.0257	No	0	No
4/24/2023 9:15	0	0.03	0.0263	No	0	No
4/24/2023 9:16	0	0.06	0.0291	No	0	No
4/24/2023 9:17	0.035	0.027	0.0287	No	0.0023	No
4/24/2023 9:18	0.044	0.037	0.0292	No	0.0053	No
4/24/2023 9:19	0.045	0.044	0.0303	No	0.0083	No
4/24/2023 9:20	0.01	0.033	0.0307	No	0.0089	No
4/24/2023 9:21	0.078	0.043	0.0322	No	0.0141	No
4/24/2023 9:22	0	0.026	0.0326	No	0.0141	No
4/24/2023 9:23	0.012	0.023	0.0327	No	0.0149	No
4/24/2023 9:24	0	0.029	0.033	No	0.0149	No
4/24/2023 9:25	0	0.021	0.0327	No	0.0149	No
4/24/2023 9:26	0	0.022	0.031	No	0.0149	No
4/24/2023 9:27	0.012	0.027	0.0313	No	0.0157	No
4/24/2023 9:28	0	0.033	0.0319	No	0.0157	No
4/24/2023 9:29	0	0.046	0.0334	No	0.0157	No
4/24/2023 9:30	0	0.04	0.0341	No	0.0157	No
4/24/2023 9:31	0	0.026	0.0318	No	0.0157	No
4/24/2023 9:32	0	0.02	0.0313	No	0.0134	No
4/24/2023 9:33	0	0.02	0.0302	No	0.0105	No
4/24/2023 9:34	0	0.02	0.0286	No	0.0075	No
4/24/2023 9:35	0.002	0.021	0.0278	No	0.0069	No
4/24/2023 9:36	0	0.019	0.0262	No	0.0017	No
4/24/2023 9:37	0	0.057	0.0283	No	0.0017	No
4/24/2023 9:38	0	0.042	0.0295	No	0.0009	No
4/24/2023 9:39	0	0.021	0.029	No	0.0009	No
4/24/2023 9:40	0	0.022	0.0291	No	0.0009	No
4/24/2023 9:41	0	0.019	0.0289	No	0.0009	No
4/24/2023 9:42	0	0.024	0.0287	No	0.0001	No
4/24/2023 9:43	0	0.117	0.0343	No	0.0001	No
4/24/2023 9:44	0	0.046	0.0343	No	0.0001	No
4/24/2023 9:45	0.003	0.034	0.0339	No	0.0003	No
4/24/2023 9:46	0	0.022	0.0336	No	0.0003	No
4/24/2023 9:47	0	0.028	0.0341	No	0.0003	No
4/24/2023 9:48	0	0.039	0.0354	No	0.0003	No
4/24/2023 9:49	0	0.024	0.0357	No	0.0003	No
4/24/2023 9:50	0	0.029	0.0362	No	0.0002	No
4/24/2023 9:51	0	0.034	0.0372	No	0.0002	No
4/24/2023 9:52	0.076	0.028	0.0353	No	0.0053	No
4/24/2023 9:53	0	0.043	0.0353	No	0.0053	No
4/24/2023 9:54	0	0.028	0.0358	No	0.0053	No
4/24/2023 9:55	0	0.023	0.0359	No	0.0053	No
4/24/2023 9:56	0	0.023	0.0361	No	0.0053	No
4/24/2023 9:57	0	0.023	0.0361	No	0.0053	No

Downwind Station						
Time	Instaneous VOC (ppm)	Instaneous Mass Conc. Total (mg/m ³)	Mass Conc. Total mg/m ³ AVG 15m (mg/m ³)	Dust Exceedance	VOC ppm AVG 15m (ppm)	VOC Exceedance
4/24/2023 9:58	0	0.021	0.0297	No	0.0053	No
4/24/2023 9:59	0	0.021	0.028	No	0.0053	No
4/24/2023 10:00	0	0.026	0.0275	No	0.0051	No
4/24/2023 10:01	0	0.02	0.0273	No	0.0051	No
4/24/2023 10:02	0	0.021	0.0269	No	0.0051	No
4/24/2023 10:03	0	0.021	0.0257	No	0.0051	No
4/24/2023 10:04	0	0.022	0.0255	No	0.0051	No
4/24/2023 10:05	0	0.02	0.0249	No	0.0051	No
4/24/2023 10:06	0	0.022	0.0241	No	0.0051	No
4/24/2023 10:07	0	0.019	0.0235	No	0	No
4/24/2023 10:08	0	0.02	0.022	No	0	No
4/24/2023 10:09	0	0.02	0.0215	No	0	No
4/24/2023 10:10	0	0.021	0.0213	No	0	No
4/24/2023 10:11	0	0.019	0.0211	No	0	No
4/24/2023 10:12	0	0.019	0.0208	No	0	No
4/24/2023 10:13	0	0.019	0.0207	No	0	No
4/24/2023 10:14	0	0.02	0.0206	No	0	No
4/24/2023 10:15	0	0.02	0.0202	No	0	No
4/24/2023 10:16	0	0.02	0.0202	No	0	No
4/24/2023 10:17	0	0.02	0.0201	No	0	No
4/24/2023 10:18	0	0.021	0.0201	No	0	No
4/24/2023 10:19	0	0.02	0.02	No	0	No
4/24/2023 10:20	0	0.02	0.02	No	0	No
4/24/2023 10:21	0	0.02	0.0199	No	0	No
4/24/2023 10:22	0	0.021	0.02	No	0	No
4/24/2023 10:23	0.038	0.059	0.0226	No	0.0025	No
4/24/2023 10:24	0.122	0.072	0.0261	No	0.0107	No
4/24/2023 10:25	0.035	0.084	0.0303	No	0.013	No
4/24/2023 10:26	0.289	0.231	0.0444	No	0.0323	No
4/24/2023 10:27	0.046	0.226	0.0582	No	0.0353	No
4/24/2023 10:28	0.581	0.135	0.0659	No	0.0741	No
4/24/2023 10:29	0.939	0.326	0.0863	No	0.1367	No
4/24/2023 10:30	0.221	0.126	0.0934	No	0.1514	No
4/24/2023 10:31	0.079	0.043	0.0949	No	0.1567	No
4/24/2023 10:32	0.132	0.037	0.0961	No	0.1655	No
4/24/2023 10:33	0.042	0.047	0.0978	No	0.1683	No
4/24/2023 10:34	0.01	0.034	0.0987	No	0.1689	No
4/24/2023 10:35	0.03	0.028	0.0993	No	0.1709	No
4/24/2023 10:36	0	0.042	0.1007	No	0.1709	No
4/24/2023 10:37	0	0.032	0.1015	No	0.1709	No
4/24/2023 10:38	0	0.023	0.0991	No	0.1684	No
4/24/2023 10:39	0	0.022	0.0957	No	0.1603	No
4/24/2023 10:40	0	0.022	0.0916	No	0.1579	No
4/24/2023 10:41	0	0.021	0.0776	No	0.1387	No
4/24/2023 10:42	0	0.023	0.0641	No	0.1356	No
4/24/2023 10:43	0	0.023	0.0566	No	0.0969	No
4/24/2023 10:44	0	0.025	0.0365	No	0.0343	No
4/24/2023 10:45	0	0.03	0.0301	No	0.0195	No
4/24/2023 10:46	0.29	0.032	0.0294	No	0.0336	No
4/24/2023 10:47	0.003	0.033	0.0291	No	0.025	No
4/24/2023 10:48	0	0.045	0.029	No	0.0222	No
4/24/2023 10:49	0.019	0.081	0.0321	No	0.0228	No
4/24/2023 10:50	0.586	0.042	0.0331	No	0.0599	No
4/24/2023 10:51	0.102	0.037	0.0327	No	0.0667	No
4/24/2023 10:52	0	0.031	0.0327	No	0.0667	No

Downwind Station						
Time	Instaneous VOC (ppm)	Instaneous Mass Conc. Total (mg/m ³)	Mass Conc. Total mg/m ³ AVG 15m (mg/m ³)	Dust Exceedance	VOC ppm AVG 15m (ppm)	VOC Exceedance
4/24/2023 10:53	0	0.053	0.0347	No	0.0667	No
4/24/2023 10:54	0.026	0.05	0.0365	No	0.0684	No
4/24/2023 10:55	0	0.038	0.0376	No	0.0684	No
4/24/2023 10:56	0.099	0.05	0.0395	No	0.075	No
4/24/2023 10:57	0	0.04	0.0407	No	0.075	No
4/24/2023 10:58	0	0.024	0.0407	No	0.075	No
4/24/2023 10:59	0.06	0.025	0.0407	No	0.079	No
4/24/2023 11:00	0	0.031	0.0408	No	0.079	No
4/24/2023 11:01	0	0.034	0.0409	No	0.0597	No
4/24/2023 11:02	0	0.029	0.0407	No	0.0595	No
4/24/2023 11:03	0	0.029	0.0396	No	0.0595	No
4/24/2023 11:04	0.005	0.03	0.0362	No	0.0585	No
4/24/2023 11:05	0.036	0.034	0.0357	No	0.0219	No
4/24/2023 11:06	0	0.027	0.035	No	0.0151	No
4/24/2023 11:07	0	0.026	0.0347	No	0.0151	No
4/24/2023 11:08	0	0.026	0.0329	No	0.0151	No
4/24/2023 11:09	0	0.027	0.0313	No	0.0133	No
4/24/2023 11:10	0	0.029	0.0307	No	0.0133	No
4/24/2023 11:11	0	0.038	0.0299	No	0.0067	No
4/24/2023 11:12	0	0.038	0.0298	No	0.0067	No
4/24/2023 11:13	0	0.026	0.0299	No	0.0067	No
4/24/2023 11:14	0	0.023	0.0298	No	0.0027	No
4/24/2023 11:15	0	0.029	0.0297	No	0.0027	No
4/24/2023 11:16	0	0.028	0.0293	No	0.0027	No
4/24/2023 11:17	0	0.062	0.0315	No	0.0027	No
4/24/2023 11:18	0	0.032	0.0317	No	0.0027	No
4/24/2023 11:19	0	0.087	0.0355	No	0.0024	No
4/24/2023 11:20	0	0.041	0.0359	No	0	No
4/24/2023 11:21	0	0.028	0.036	No	0	No
4/24/2023 11:22	0	0.036	0.0367	No	0	No
4/24/2023 11:23	0	0.024	0.0365	No	0	No
4/24/2023 11:24	0	0.026	0.0365	No	0	No
4/24/2023 11:25	0	0.046	0.0376	No	0	No
4/24/2023 11:26	0	0.023	0.0366	No	0	No
4/24/2023 11:27	0	0.036	0.0365	No	0	No
4/24/2023 11:28	0	0.181	0.0468	No	0	No
4/24/2023 11:29	0	0.061	0.0493	No	0	No
4/24/2023 11:30	0	0.051	0.0508	No	0	No
4/24/2023 11:31	0	0.027	0.0507	No	0	No
4/24/2023 11:32	0	0.044	0.0495	No	0	No
4/24/2023 11:33	0	0.038	0.0499	No	0	No
4/24/2023 11:34	0	0.03	0.0461	No	0	No
4/24/2023 11:35	0	0.026	0.0451	No	0	No
4/24/2023 11:36	0	0.047	0.0464	No	0	No
4/24/2023 11:37	0	0.037	0.0465	No	0	No
4/24/2023 11:38	0	0.054	0.0485	No	0	No
4/24/2023 11:39	0	0.034	0.049	No	0	No
4/24/2023 11:40	0	0.03	0.0479	No	0	No
4/24/2023 11:41	0	0.029	0.0483	No	0	No
4/24/2023 11:42	0	0.024	0.0475	No	0	No
4/24/2023 11:43	0	0.049	0.0387	No	0	No
4/24/2023 11:44	0	0.028	0.0365	No	0	No
4/24/2023 11:45	0	0.026	0.0349	No	0	No
4/24/2023 11:46	0	0.024	0.0347	No	0	No
4/24/2023 11:47	0.084	0.038	0.0343	No	0.0056	No

Downwind Station						
Time	Instantaneous VOC (ppm)	Instantaneous Mass Conc. Total (mg/m ³)	Mass Conc. Total mg/m ³ AVG 15m (mg/m ³)	Dust Exceedance	VOC ppm AVG 15m (ppm)	VOC Exceedance
4/24/2023 11:48	0	0.035	0.0341	No	0.0056	No
4/24/2023 11:49	0.035	0.034	0.0343	No	0.0079	No
4/24/2023 11:50	0	0.031	0.0347	No	0.0079	No
4/24/2023 11:51	0	0.03	0.0335	No	0.0079	No
4/24/2023 11:52	0.109	0.038	0.0336	No	0.0152	No
4/24/2023 11:53	0	0.052	0.0335	No	0.0152	No
4/24/2023 11:54	0	0.034	0.0335	No	0.0152	No
4/24/2023 11:55	0	0.059	0.0354	No	0.0152	No
4/24/2023 11:56	0	0.027	0.0353	No	0.0152	No
4/24/2023 11:57	0	0.027	0.0355	No	0.0152	No
4/24/2023 11:58	0	0.027	0.034	No	0.0152	No
4/24/2023 11:59	0	0.031	0.0342	No	0.0152	No
4/24/2023 12:00	0	0.03	0.0345	No	0.0152	No
4/24/2023 12:01	0	0.036	0.0353	No	0.0152	No
4/24/2023 12:02	0	0.034	0.035	No	0.0096	No
4/24/2023 12:03	0	0.044	0.0356	No	0.0096	No
4/24/2023 12:04	0	0.025	0.035	No	0.0073	No
4/24/2023 12:05	0	0.024	0.0345	No	0.0073	No
4/24/2023 12:06	0	0.043	0.0354	No	0.0073	No
4/24/2023 12:07	0	0.16	0.0435	No	0	No
4/24/2023 12:08	0	0.032	0.0422	No	0	No
4/24/2023 12:09	0	0.028	0.0418	No	0	No
4/24/2023 12:10	0	0.024	0.0395	No	0	No
4/24/2023 12:11	0	0.025	0.0393	No	0	No
4/24/2023 12:12	0	0.03	0.0395	No	0	No
4/24/2023 12:13	0	0.025	0.0394	No	0	No
4/24/2023 12:14	0	0.033	0.0395	No	0	No
4/24/2023 12:15	0	0.024	0.0391	No	0	No
4/24/2023 12:16	0	0.023	0.0383	No	0	No
4/24/2023 12:17	0	0.022	0.0375	No	0	No
4/24/2023 12:18	0	0.031	0.0366	No	0	No
4/24/2023 12:19	0	0.034	0.0372	No	0	No
4/24/2023 12:20	0	0.028	0.0375	No	0	No
4/24/2023 12:21	0	0.027	0.0364	No	0	No
4/24/2023 12:22	0	0.024	0.0273	No	0	No
4/24/2023 12:23	0	0.032	0.0273	No	0	No
4/24/2023 12:24	0	0.026	0.0272	No	0	No
4/24/2023 12:25	0	0.032	0.0277	No	0	No
4/24/2023 12:26	0	0.024	0.0277	No	0	No
4/24/2023 12:27	0	0.026	0.0274	No	0	No
4/24/2023 12:28	0	0.045	0.0287	No	0	No
4/24/2023 12:29	0	0.023	0.0281	No	0	No
4/24/2023 12:30	0	0.024	0.0281	No	0	No
4/24/2023 12:31	0	0.025	0.0282	No	0	No
4/24/2023 12:32	0	0.189	0.0393	No	0	No
4/24/2023 12:33	0	0.076	0.0423	No	0	No
4/24/2023 12:34	0	0.037	0.0425	No	0	No
4/24/2023 12:35	0	0.023	0.0422	No	0	No
4/24/2023 12:36	0	0.024	0.042	No	0	No
4/24/2023 12:37	0	0.033	0.0426	No	0	No
4/24/2023 12:38	0	0.026	0.0422	No	0	No
4/24/2023 12:39	0	0.025	0.0421	No	0	No
4/24/2023 12:40	0	0.025	0.0417	No	0	No
4/24/2023 12:41	0	0.029	0.042	No	0	No
4/24/2023 12:42	0	0.025	0.0419	No	0	No

Downwind Station						
Time	Instaneous VOC (ppm)	Instaneous Mass Conc. Total (mg/m ³)	Mass Conc. Total mg/m ³ AVG 15m (mg/m ³)	Dust Exceedance	VOC ppm AVG 15m (ppm)	VOC Exceedance
4/24/2023 12:43	0	0.025	0.0406	No	0	No
4/24/2023 12:44	0	0.027	0.0409	No	0	No
4/24/2023 12:45	0	0.024	0.0409	No	0	No
4/24/2023 12:46	0	0.024	0.0408	No	0	No
4/24/2023 12:47	0	0.023	0.0297	No	0	No
4/24/2023 12:48	0	0.026	0.0264	No	0	No
4/24/2023 12:49	0	0.027	0.0257	No	0	No
4/24/2023 12:50	0	0.026	0.0259	No	0	No
4/24/2023 12:51	0	0.032	0.0265	No	0	No
4/24/2023 12:52	0	0.031	0.0263	No	0	No
4/24/2023 12:53	0	0.025	0.0263	No	0	No
4/24/2023 12:54	0	0.034	0.0269	No	0	No
4/24/2023 12:55	0	0.034	0.0275	No	0	No
4/24/2023 12:56	0	0.033	0.0277	No	0	No
4/24/2023 12:57	0	0.029	0.028	No	0	No
4/24/2023 12:58	0	0.033	0.0285	No	0	No
4/24/2023 12:59	0	0.028	0.0286	No	0	No
4/24/2023 13:00	0	0.033	0.0292	No	0	No
4/24/2023 13:01	0.032	0.029	0.0295	No	0.0021	No
4/24/2023 13:02	0	0.031	0.0301	No	0.0021	No
4/24/2023 13:03	0	0.026	0.0301	No	0.0021	No
4/24/2023 13:04	0	0.028	0.0301	No	0.0021	No
4/24/2023 13:05	0	0.026	0.0301	No	0.0021	No
4/24/2023 13:06	0	0.023	0.0295	No	0.0021	No
4/24/2023 13:07	0	0.023	0.029	No	0.0021	No
4/24/2023 13:08	0	0.024	0.0289	No	0.0021	No
4/24/2023 13:09	0	0.028	0.0285	No	0.0021	No
4/24/2023 13:10	0	0.026	0.028	No	0.0021	No
4/24/2023 13:11	0	0.028	0.0277	No	0.0021	No
4/24/2023 13:12	0	0.03	0.0277	No	0.0021	No
4/24/2023 13:13	0	0.027	0.0273	No	0.0021	No
4/24/2023 13:14	0	0.027	0.0273	No	0.0021	No
4/24/2023 13:15	0	0.025	0.0267	No	0.0021	No
4/24/2023 13:16	0	0.026	0.0265	No	0	No
4/24/2023 13:17	0	0.023	0.026	No	0	No
4/24/2023 13:18	0	0.023	0.0258	No	0	No
4/24/2023 13:19	0	0.024	0.0255	No	0	No
4/24/2023 13:20	0	0.024	0.0254	No	0	No
4/24/2023 13:21	0	0.024	0.0255	No	0	No
4/24/2023 13:22	0	0.025	0.0256	No	0	No
4/24/2023 13:23	0	0.025	0.0257	No	0	No
4/24/2023 13:24	0	0.026	0.0255	No	0	No
4/24/2023 13:25	0	0.027	0.0256	No	0	No
4/24/2023 13:26	0	0.024	0.0253	No	0	No
4/24/2023 13:27	0	0.022	0.0248	No	0	No
4/24/2023 13:28	0	0.023	0.0245	No	0	No
4/24/2023 13:29	0	0.03	0.0247	No	0	No
4/24/2023 13:30	0	0.078	0.0283	No	0	No
4/24/2023 13:31	0	0.058	0.0304	No	0	No
4/24/2023 13:32	0	0.025	0.0305	No	0	No
4/24/2023 13:33	0	0.036	0.0314	No	0	No
4/24/2023 13:34	0	0.025	0.0315	No	0	No
4/24/2023 13:35	0	0.034	0.0321	No	0	No
4/24/2023 13:36	0	0.044	0.0335	No	0	No
4/24/2023 13:37	0	0.023	0.0333	No	0	No

Downwind Station						
Time	Instaneous VOC (ppm)	Instaneous Mass Conc. Total (mg/m ³)	Mass Conc. Total mg/m ³ AVG 15m (mg/m ³)	Dust Exceedance	VOC ppm AVG 15m (ppm)	VOC Exceedance
4/24/2023 13:38	0	0.037	0.0341	No	0	No
4/24/2023 13:39	0	0.032	0.0345	No	0	No
4/24/2023 13:40	0.008	0.045	0.0357	No	0.0005	No
4/24/2023 13:41	0	0.082	0.0396	No	0.0005	No
4/24/2023 13:42	0	0.023	0.0397	No	0.0005	No
4/24/2023 13:43	0	0.024	0.0397	No	0.0005	No
4/24/2023 13:44	0.007	0.042	0.0405	No	0.001	No
4/24/2023 13:45	0	0.028	0.0372	No	0.001	No
4/24/2023 13:46	0	0.026	0.0351	No	0.001	No
4/24/2023 13:47	0	0.023	0.0349	No	0.001	No
4/24/2023 13:48	0	0.027	0.0343	No	0.001	No
4/24/2023 13:49	0	0.027	0.0345	No	0.001	No
4/24/2023 13:50	0	0.034	0.0345	No	0.001	No
4/24/2023 13:51	0	0.04	0.0342	No	0.001	No
4/24/2023 13:52	0	0.045	0.0357	No	0.001	No
4/24/2023 13:53	0.001	0.063	0.0374	No	0.0011	No
4/24/2023 13:54	0	0.052	0.0387	No	0.0011	No
4/24/2023 13:55	0.006	0.041	0.0385	No	0.0009	No
4/24/2023 13:56	0	0.079	0.0383	No	0.0009	No
4/24/2023 13:57	0	0.367	0.0612	No	0.0009	No
4/24/2023 13:58	0	0.072	0.0644	No	0.0009	No
4/24/2023 13:59	0	0.04	0.0643	No	0.0005	No
4/24/2023 14:00	0	0.035	0.0647	No	0.0005	No
4/24/2023 14:01	0	0.032	0.0651	No	0.0005	No
4/24/2023 14:02	0	0.031	0.0657	No	0.0005	No
4/24/2023 14:03	0	0.066	0.0683	No	0.0005	No
4/24/2023 14:04	0	0.034	0.0687	No	0.0005	No
4/24/2023 14:05	0	0.027	0.0683	No	0.0005	No
4/24/2023 14:06	0.104	0.048	0.0688	No	0.0074	No
4/24/2023 14:07	0	0.047	0.0689	No	0.0074	No
4/24/2023 14:08	0	0.033	0.0669	No	0.0073	No
4/24/2023 14:09	0	0.03	0.0655	No	0.0073	No
4/24/2023 14:10	0	0.039	0.0653	No	0.0069	No
4/24/2023 14:11	0	0.057	0.0639	No	0.0069	No
4/24/2023 14:12	0	0.064	0.0437	No	0.0069	No
4/24/2023 14:13	0.036	0.054	0.0425	No	0.0093	No
4/24/2023 14:14	0.007	0.061	0.0439	No	0.0098	No
4/24/2023 14:15	0.099	0.066	0.0459	No	0.0164	No
4/24/2023 14:16	0	0.04	0.0465	No	0.0164	No
4/24/2023 14:17	0.01	0.066	0.0488	No	0.0171	No
4/24/2023 14:18	0	0.052	0.0479	No	0.0171	No
4/24/2023 14:19	0	0.071	0.0503	No	0.0171	No
4/24/2023 14:20	0	0.082	0.054	No	0.0171	No
4/24/2023 14:21	0	0.048	0.054	No	0.0101	No
4/24/2023 14:22	0	0.029	0.0528	No	0.0101	No
4/24/2023 14:23	0	0.025	0.0523	No	0.0101	No
4/24/2023 14:24	0	0.029	0.0522	No	0.0101	No
4/24/2023 14:25	0	0.025	0.0513	No	0.0101	No
4/24/2023 14:26	0	0.031	0.0495	No	0.0101	No
4/24/2023 14:27	0	0.031	0.0473	No	0.0101	No
4/24/2023 14:28	0	0.026	0.0455	No	0.0077	No
4/24/2023 14:29	0	0.024	0.043	No	0.0073	No
4/24/2023 14:30	0	0.026	0.0403	No	0.001	No
4/24/2023 14:31	0	0.023	0.0392	No	0.001	No
4/24/2023 14:32	0	0.025	0.0365	No	0	No

Downwind Station						
Time	Instaneous VOC (ppm)	Instaneous Mass Conc. Total (mg/m ³)	Mass Conc. Total mg/m ³ AVG 15m (mg/m ³)	Dust Exceedance	VOC ppm AVG 15m (ppm)	VOC Exceedance
4/24/2023 14:33	0	0.023	0.0345	No	0	No
4/24/2023 14:34	0	0.025	0.0315	No	0	No
4/24/2023 14:35	0	0.024	0.0276	No	0	No
4/24/2023 14:36	0	0.023	0.0259	No	0	No
4/24/2023 14:37	0	0.03	0.026	No	0	No
4/24/2023 14:38	0	0.034	0.0266	No	0	No
4/24/2023 14:39	0	0.025	0.0263	No	0	No
4/24/2023 14:40	0	0.035	0.027	No	0	No
4/24/2023 14:41	0	0.027	0.0267	No	0	No
4/24/2023 14:42	0	0.032	0.0268	No	0	No
4/24/2023 14:43	0	0.024	0.0267	No	0	No
4/24/2023 14:44	0	0.028	0.0269	No	0	No
4/24/2023 14:45	0	0.028	0.0271	No	0	No
4/24/2023 14:46	0	0.025	0.0272	No	0	No
4/24/2023 14:47	0	0.027	0.0273	No	0	No
4/24/2023 14:48	0	0.032	0.0279	No	0	No
4/24/2023 14:49	0	0.028	0.0281	No	0	No
4/24/2023 14:50	0	0.03	0.0285	No	0	No
4/24/2023 14:51	0	0.026	0.0287	No	0	No
4/24/2023 14:52	0	0.042	0.0295	No	0	No
4/24/2023 14:53	0	0.032	0.0294	No	0	No
4/24/2023 14:54	0	0.027	0.0295	No	0	No
4/24/2023 14:55	0	0.025	0.0289	No	0	No
4/24/2023 14:56	0	0.027	0.0289	No	0	No
4/24/2023 14:57	0	0.026	0.0285	No	0	No
4/24/2023 14:58	0	0.026	0.0286	No	0	No
4/24/2023 14:59	0	0.024	0.0283	No	0	No
4/24/2023 15:00	0	0.033	0.0287	No	0	No
4/24/2023 15:01	0	0.023	0.0285	No	0	No
4/24/2023 15:02	0	0.025	0.0284	No	0	No
4/24/2023 15:03	0	0.026	0.028	No	0	No
4/24/2023 15:04	0	0.028	0.028	No	0	No
4/24/2023 15:05	0	0.033	0.0282	No	0	No
4/24/2023 15:06	0	0.03	0.0285	No	0	No
4/24/2023 15:07	0	0.027	0.0275	No	0	No
4/24/2023 15:08	0	0.031	0.0274	No	0	No
4/24/2023 15:09	0	0.026	0.0273	No	0	No
4/24/2023 15:10	0	0.031	0.0277	No	0	No
4/24/2023 15:11	0	0.026	0.0277	No	0	No
4/24/2023 15:12	0	0.028	0.0278	No	0	No
4/24/2023 15:13	0	0.029	0.028	No	0	No
4/24/2023 15:14	0	0.03	0.0284	No	0	No
4/24/2023 15:15	0	0.026	0.0279	No	0	No
4/24/2023 15:16	0	0.028	0.0283	No	0	No
4/24/2023 15:17	0	0.024	0.0282	No	0	No
4/24/2023 15:18	0	0.026	0.0282	No	0	No
4/24/2023 15:19	0	0.026	0.0281	No	0	No
4/24/2023 15:20	0	0.024	0.0275	No	0	No
4/24/2023 15:21	0	0.024	0.0271	No	0	No
4/24/2023 15:22	0	0.024	0.0269	No	0	No
4/24/2023 15:23	0	0.024	0.0264	No	0	No
4/24/2023 15:24	0	0.026	0.0264	No	0	No
4/24/2023 15:25	0	0.025	0.026	No	0	No
4/24/2023 15:26	0	0.026	0.026	No	0	No
4/24/2023 15:27	0	0.032	0.0263	No	0	No

Downwind Station

Time	Instantaneous VOC (ppm)	Instantaneous Mass Conc. Total (mg/m ³)	Mass Conc. Total mg/m ³ AVG 15m (mg/m ³)	Dust Exceedance	VOC ppm AVG 15m (ppm)	VOC Exceedance
4/24/2023 15:28	0	0.027	0.0261	No	0	No
4/24/2023 15:29	0	0.026	0.0259	No	0	No
4/24/2023 15:30	0	0.034	0.0264	No	0	No
4/24/2023 15:31	0	0.05	0.0279	No	0	No
4/24/2023 15:32	0	0.058	0.0301	No	0	No
4/24/2023 15:33	0	0.04	0.0311	No	0	No
4/24/2023 15:34	0.09	0.031	0.0314	No	0.006	No
4/24/2023 15:35	0	0.028	0.0317	No	0.006	No
4/24/2023 15:36	0	0.032	0.0322	No	0.006	No
4/24/2023 15:37	0	0.032	0.0327	No	0.006	No
4/24/2023 15:38	0	0.026	0.0329	No	0.006	No
4/24/2023 15:39	0	0.028	0.033	No	0.006	No
4/24/2023 15:40	0	0.024	0.0329	No	0.006	No
4/24/2023 15:41	0	0.048	0.0344	No	0.006	No
4/24/2023 15:42	0	0.026	0.034	No	0.006	No
4/24/2023 15:43	0	0.022	0.0337	No	0.006	No
4/24/2023 15:44	0	0.023	0.0335	No	0.006	No
4/24/2023 15:45	0	0.027	0.033	No	0.006	No
4/24/2023 15:46	0	0.024	0.0313	No	0.006	No
4/24/2023 15:47	0	0.026	0.0291	No	0.006	No
4/24/2023 15:48	0	0.022	0.0279	No	0.006	No
4/24/2023 15:49	0	0.022	0.0273	No	0	No
4/24/2023 15:50	0	0.023	0.027	No	0	No
4/24/2023 15:51	0	0.022	0.0263	No	0	No
4/24/2023 15:52	0	0.022	0.0257	No	0	No
4/24/2023 15:53	0	0.023	0.0255	No	0	No
4/24/2023 15:54	0	0.022	0.0251	No	0	No
4/24/2023 15:55	0	0.022	0.0249	No	0	No
4/24/2023 15:56	0	0.023	0.0233	No	0	No
4/24/2023 15:57	0	0.022	0.023	No	0	No
4/24/2023 15:58	0	0.023	0.0231	No	0	No
4/24/2023 15:59	0	0.022	0.023	No	0	No
4/24/2023 16:00	0	0.025	0.0229	No	0	No
4/24/2023 16:01	0	0.024	0.0229	No	0	No
4/24/2023 16:02	0	0.025	0.0228	No	0	No
4/24/2023 16:03	0	0.025	0.023	No	0	No
4/24/2023 16:04	0	0.025	0.0232	No	0	No
4/24/2023 16:05	0	0.025	0.0233	No	0	No
4/24/2023 16:06	0	0.023	0.0234	No	0	No
4/24/2023 16:07	0	0.027	0.0237	No	0	No
4/24/2023 16:08	0	0.024	0.0238	No	0	No
4/24/2023 16:09	0	0.025	0.024	No	0	No
4/24/2023 16:10	0	0.025	0.0242	No	0	No
4/24/2023 16:11	0	0.024	0.0243	No	0	No
4/24/2023 16:12	0	0.023	0.0243	No	0	No
4/24/2023 16:13	0	0.034	0.0251	No	0	No
4/24/2023 16:14	0	0.028	0.0255	No	0	No
4/24/2023 16:15	0	0.023	0.0253	No	0	No
4/24/2023 16:16	0	0.023	0.0253	No	0	No
4/24/2023 16:17	0	0.025	0.0253	No	0	No