



Daily Activity Report

Seton Brilla Charter School
1956 Jerome Avenue, Bronx, NY
BCP No. C203152

General Site Information

Date:	Friday, March 31, 2023
Weather:	Partly cloudy, 32-53°F
Wind Direction/Speed:	N @ 3 mph
AKRF Personnel on Site:	Nicolette Cruz
AKRF Equipment on Site:	Mini RAE 3000 Photoionization Detector [(PID) x1], 2 Fixed Air Monitoring Stations [DustTrak
Visitors:	None.

Contractor Information

Contracting Company	Main Personnel	Equipment
Casino Construction	Carlos	Excavator

Description and Location of Work Activities Performed

- 1) Casino continued building wooden forms for foundation elements
- 2) Casino continued installation of waterproofing on exterior wall of northeast-adjacent building.
- 3) Old concrete foundation was broken into managable pieces with a jackhammer to remove off site at a later date.

Destination Facility	Daily Trucks	Total Trucks	Daily Approx. Cubic Yds	Total Approx. Cubic Yds	Total Site Loads	Total Approximate Cubic Yards
Clean Earth Carteret	3	92	60	1,840	186	3,720
Clean Earth Southeastern Pennsylvania	0	67	0	1,340		
Concrete Disposal	0	27	0	540		
N/A	0	0	0	0		
N/A	0	0	0	0		

CAMP Air Monitoring Results

CAMP Station	UPWIND				DOWNWIND		
Odors:	None.				None.		
VOC Action Level Exceedance(s):	None.				None.		
Particulate Action Level Exceedance(s):	None.				None.		
Maximum VOC Level (15 min ppm):	0.16				0.317		
Maximum Particulate Level (15 min mg/m ³):	0.106				0.067		

Notes: CAMP monitoring was performed throughout the day. VOC levels were not recorded from the downwind CAMP until approx. 08:14 due to software issue that troubleshot with the rental company. During this time, there were no odors and the upwind CAMP PID read well below action levels. At approx. 14:24, a crew member accidentally knocked over the downwind CAMP station, resulting in a broken omni-directional input and false particulate exceedances. This issue was not noticed until approx. 14:58, when onsite personel removed te broken piece and ceased dust monitoring from the downwind CAMP for the rest of the day. During this time the upwind CAMP read well below action levels, and Casino had switched focus primarily to waterproofing, resulting in little to no dust onsite.

Additional Information

Planned Work Activity for Following Day/Week:	<ol style="list-style-type: none"> 1) Excavation of soil/fill to uncover piles. 2) Cutting piles to final elevations 3) Exporting of soil off-site
Comments:	None.

Site Map

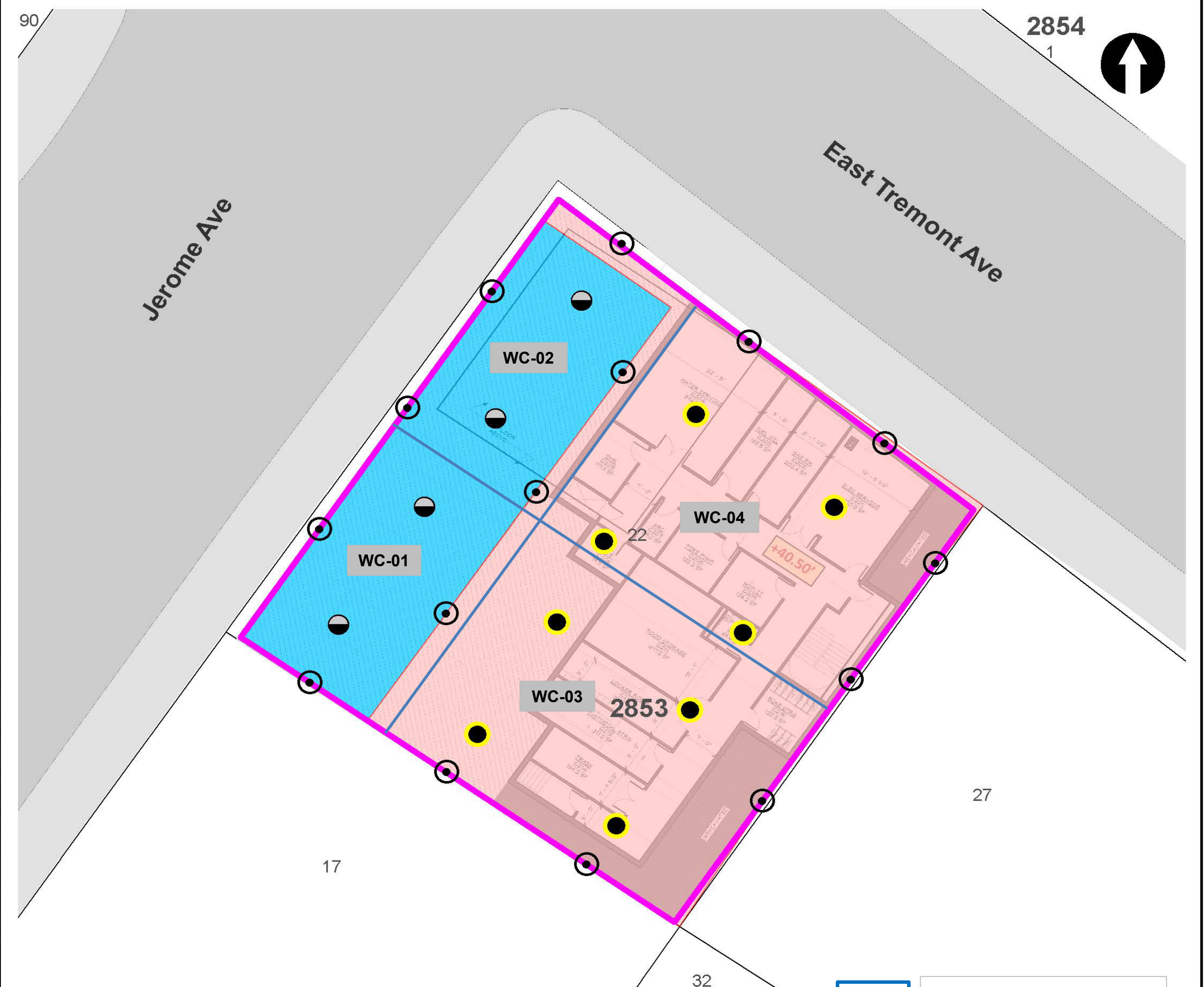

LEGEND

- PROJECT SITE BOUNDARY
- LOT BOUNDARY AND TAX LOT NUMBER
- 2853** BLOCK NUMBER
- REMEDIAL EXCAVATION TO APPROXIMATELY TWO FEET BELOW EXISTING GRADE
- REMEDIAL EXCAVATION TO GROUNDWATER (SOURCE AREA)

- CONFIRMATION DOCUMENTATION BOTTOM SAMPLE
- SOURCE AREA DOCUMENTATION BOTTOM SAMPLE
- DOCUMENTATION SIDEWALL SAMPLE

APPROXIMATE SOIL PRE-CHARACTERIZATION GRID



NOTE
 REMEDIAL EXCAVATION WILL INCLUDE REMOVAL OF APPROXIMATELY 1,280 TONS (850 CUBIC YARDS) OF SOURCE MATERIAL ASSOCIATED WITH NYSDEC SPILL NO. 2103719 AND APPROXIMATELY 860 TONS (570 CUBIC YARDS) OF SOIL/FILL FROM THE UPPER 2 FEET SITE-WIDE.

Map Source:
 NYCDP (NYC Dept. of City Planning) GIS database

© 2021 AKRF. W:\Projects\210024 - 1956 JEROME AVENUE\Technical\GIS and Graphics\AR\RAWP\210024 Figure 9 Proposed Remedial Excavation and Documentation Sample Location Plan.mxd 10/25/2021 2:03:38 PM iszalus



440 Park Avenue South, New York, NY 10016

1956 Jerome Avenue
 Bronx, New York

**TRACK 4 CLEANUP AND DOCUMENTATION
 SAMPLE LOCATION PLAN**

DATE
04/29/2022

PROJECT NO.
210024

FIGURE
11

Site Photographs

Photograph 1 -
Excavator leveling
soil pile to be
covered.



Photograph 2-
General site
overview of the Site,
facing south.



Photograph 3- Soil
piles that have been
covered and
weighed down facing
southeast.



Upwind Station						
Time	Instaneous VOC (ppm)	Instaneous Mass Conc. Total (mg/m ³)	Mass Conc. Total mg/m ³ AVG 15m (mg/m ³)	Dust Exceedance	VOC ppm AVG 15m (ppm)	VOC Exceedance
3/31/2023 8:47		0.041	0.041	No		No
3/31/2023 8:48		0.055	0.048	No		No
3/31/2023 8:49		0.043	0.0463	No		No
3/31/2023 8:50		0.059	0.0495	No		No
3/31/2023 8:51		0.06	0.0516	No		No
3/31/2023 8:52	0	0.043	0.0502	No	0	No
3/31/2023 8:53		0.049	0.05	No		No
3/31/2023 8:54		0.05	0.05	No		No
3/31/2023 8:55		0.049	0.0499	No		No
3/31/2023 8:56		0.048	0.0497	No		No
3/31/2023 8:57		0.104	0.0546	No		No
3/31/2023 8:58	0.301	0.042	0.0536	No	0.1505	No
3/31/2023 8:59	0.184	0.038	0.0524	No	0.1617	No
3/31/2023 9:00	0.142	0.041	0.0516	No	0.1568	No
3/31/2023 9:01	0.126	0.046	0.0512	No	0.1506	No
3/31/2023 9:02	0.118	0.045	0.0515	No	0.1452	No
3/31/2023 9:03	0.082	0.035	0.0501	No	0.1361	No
3/31/2023 9:04	0.076	0.037	0.0497	No	0.1286	No
3/31/2023 9:05	0.076	0.034	0.0481	No	0.1228	No
3/31/2023 9:06	0.055	0.033	0.0463	No	0.116	No
3/31/2023 9:07	0.065	0.029	0.0453	No	0.1225	No
3/31/2023 9:08	0.071	0.033	0.0443	No	0.1178	No
3/31/2023 9:09	0.047	0.03	0.0429	No	0.1119	No
3/31/2023 9:10	0.033	0.031	0.0417	No	0.1058	No
3/31/2023 9:11	0.041	0.038	0.0411	No	0.1012	No
3/31/2023 9:12	0.046	0.036	0.0365	No	0.0975	No
3/31/2023 9:13	0.029	0.033	0.0359	No	0.0794	No
3/31/2023 9:14	0.018	0.028	0.0353	No	0.0683	No
3/31/2023 9:15	0.023	0.027	0.0343	No	0.0604	No
3/31/2023 9:16	0.019	0.029	0.0332	No	0.0533	No
3/31/2023 9:17	0.013	0.027	0.032	No	0.0463	No
3/31/2023 9:18	0.007	0.029	0.0316	No	0.0413	No
3/31/2023 9:19	0.002	0.026	0.0309	No	0.0363	No
3/31/2023 9:20	0.007	0.025	0.0303	No	0.0317	No
3/31/2023 9:21	0.003	0.026	0.0298	No	0.0283	No
3/31/2023 9:22	0.004	0.026	0.0296	No	0.0242	No
3/31/2023 9:23	0.007	0.025	0.0291	No	0.0199	No
3/31/2023 9:24	0.001	0.029	0.029	No	0.0169	No
3/31/2023 9:25	0	0.025	0.0286	No	0.0147	No
3/31/2023 9:26	0	0.032	0.0282	No	0.0119	No
3/31/2023 9:27	0.001	0.037	0.0283	No	0.0089	No
3/31/2023 9:28	0	0.028	0.0279	No	0.007	No
3/31/2023 9:29	0.002	0.029	0.028	No	0.0059	No
3/31/2023 9:30	0.004	0.032	0.0283	No	0.0047	No
3/31/2023 9:31	0.004	0.029	0.0283	No	0.0037	No
3/31/2023 9:32	0.004	0.033	0.0287	No	0.0031	No
3/31/2023 9:33	0	0.031	0.0289	No	0.0026	No
3/31/2023 9:34	0	0.029	0.0291	No	0.0025	No
3/31/2023 9:35	0.005	0.03	0.0294	No	0.0023	No
3/31/2023 9:36	0.01	0.029	0.0296	No	0.0028	No
3/31/2023 9:37	0.001	0.033	0.0301	No	0.0026	No
3/31/2023 9:38	0.008	0.034	0.0307	No	0.0027	No

Upwind Station						
Time	Instaneous VOC (ppm)	Instaneous Mass Conc. Total (mg/m ³)	Mass Conc. Total mg/m ³ AVG 15m (mg/m ³)	Dust Exceedance	VOC ppm AVG 15m (ppm)	VOC Exceedance
3/31/2023 9:39	0.004	0.031	0.0308	No	0.0029	No
3/31/2023 9:40	0.01	0.029	0.0311	No	0.0035	No
3/31/2023 9:41	0.01	0.029	0.0309	No	0.0042	No
3/31/2023 9:42	0.005	0.028	0.0303	No	0.0045	No
3/31/2023 9:43	0.008	0.033	0.0306	No	0.005	No
3/31/2023 9:44	0.005	0.033	0.0309	No	0.0052	No
3/31/2023 9:45	0.008	0.04	0.0314	No	0.0055	No
3/31/2023 9:46	0.002	0.035	0.0318	No	0.0053	No
3/31/2023 9:47	0.014	0.033	0.0318	No	0.006	No
3/31/2023 9:48	0.012	0.032	0.0319	No	0.0068	No
3/31/2023 9:49	0.002	0.031	0.032	No	0.0069	No
3/31/2023 9:50	0.003	0.031	0.0321	No	0.0068	No
3/31/2023 9:51	0.003	0.03	0.0321	No	0.0063	No
3/31/2023 9:52	0.02	0.031	0.032	No	0.0076	No
3/31/2023 9:53	0.013	0.031	0.0318	No	0.0079	No
3/31/2023 9:54	0.044	0.03	0.0317	No	0.0106	No
3/31/2023 9:55	0.042	0.035	0.0321	No	0.0127	No
3/31/2023 9:56	0.023	0.033	0.0324	No	0.0136	No
3/31/2023 9:57	0.02	0.033	0.0327	No	0.0146	No
3/31/2023 9:58	0.022	0.03	0.0325	No	0.0155	No
3/31/2023 9:59	0.02	0.031	0.0324	No	0.0165	No
3/31/2023 10:00	0.034	0.036	0.0321	No	0.0183	No
3/31/2023 10:01	0.038	0.033	0.032	No	0.0207	No
3/31/2023 10:02	0.036	0.03	0.0318	No	0.0221	No
3/31/2023 10:03	0.048	0.029	0.0316	No	0.0245	No
3/31/2023 10:04	0.037	0.031	0.0316	No	0.0269	No
3/31/2023 10:05	0.047	0.03	0.0315	No	0.0298	No
3/31/2023 10:06	0.04	0.03	0.0315	No	0.0323	No
3/31/2023 10:07	0.037	0.032	0.0316	No	0.0334	No
3/31/2023 10:08	0.037	0.032	0.0317	No	0.035	No
3/31/2023 10:09	0.036	0.032	0.0318	No	0.0345	No
3/31/2023 10:10	0.051	0.031	0.0315	No	0.0351	No
3/31/2023 10:11	0.032	0.031	0.0314	No	0.0357	No
3/31/2023 10:12	0.049	0.03	0.0312	No	0.0376	No
3/31/2023 10:13	0.053	0.032	0.0313	No	0.0397	No
3/31/2023 10:14	0.042	0.033	0.0315	No	0.0411	No
3/31/2023 10:15	0.042	0.031	0.0311	No	0.0417	No
3/31/2023 10:16	0.038	0.029	0.0309	No	0.0417	No
3/31/2023 10:17	0.057	0.03	0.0309	No	0.0431	No
3/31/2023 10:18	0.043	0.034	0.0312	No	0.0427	No
3/31/2023 10:19	0.054	0.03	0.0311	No	0.0439	No
3/31/2023 10:20	0.042	0.032	0.0313	No	0.0435	No
3/31/2023 10:21	0.048	0.04	0.0319	No	0.0441	No
3/31/2023 10:22	0.059	0.031	0.0319	No	0.0455	No
3/31/2023 10:23	0.058	0.026	0.0315	No	0.0469	No
3/31/2023 10:24	0.065	0.025	0.031	No	0.0489	No
3/31/2023 10:25	0.065	0.025	0.0306	No	0.0498	No
3/31/2023 10:26	0.077	0.027	0.0303	No	0.0528	No
3/31/2023 10:27	0.078	0.03	0.0303	No	0.0547	No
3/31/2023 10:28	0.084	0.025	0.0299	No	0.0568	No
3/31/2023 10:29	0.073	0.027	0.0295	No	0.0589	No
3/31/2023 10:30	0.084	0.033	0.0296	No	0.0617	No

Upwind Station						
Time	Instaneous VOC (ppm)	Instaneous Mass Conc. Total (mg/m ³)	Mass Conc. Total mg/m ³ AVG 15m (mg/m ³)	Dust Exceedance	VOC ppm AVG 15m (ppm)	VOC Exceedance
3/31/2023 10:31	0.081	0.033	0.0299	No	0.0645	No
3/31/2023 10:32	0.072	0.031	0.0299	No	0.0655	No
3/31/2023 10:33	0.084	0.027	0.0295	No	0.0683	No
3/31/2023 10:34	0.083	0.026	0.0292	No	0.0702	No
3/31/2023 10:35	0.08	0.036	0.0295	No	0.0727	No
3/31/2023 10:36	0.078	0.033	0.029	No	0.0747	No
3/31/2023 10:37	0.088	0.031	0.029	No	0.0767	No
3/31/2023 10:38	0.093	0.099	0.0339	No	0.079	No
3/31/2023 10:39	0.09	0.051	0.0356	No	0.0807	No
3/31/2023 10:40	0.089	0.047	0.0371	No	0.0823	No
3/31/2023 10:41	0.081	0.036	0.0377	No	0.0825	No
3/31/2023 10:42	0.084	0.029	0.0376	No	0.0829	No
3/31/2023 10:43	0.083	0.027	0.0377	No	0.0829	No
3/31/2023 10:44	0.089	0.027	0.0377	No	0.0839	No
3/31/2023 10:45	0.114	0.029	0.0375	No	0.0859	No
3/31/2023 10:46	0.118	0.035	0.0376	No	0.0884	No
3/31/2023 10:47	0.103	0.052	0.039	No	0.0905	No
3/31/2023 10:48	0.098	0.077	0.0423	No	0.0914	No
3/31/2023 10:49	0.094	0.038	0.0431	No	0.0921	No
3/31/2023 10:50	0.095	0.228	0.0559	No	0.0931	No
3/31/2023 10:51	0.088	0.733	0.1026	No	0.0938	No
3/31/2023 10:52	0.103	0.052	0.104	No	0.0948	No
3/31/2023 10:53	0.109	0.055	0.1011	No	0.0959	No
3/31/2023 10:54	0.118	0.041	0.1004	No	0.0977	No
3/31/2023 10:55	0.111	0.039	0.0999	No	0.0992	No
3/31/2023 10:56	0.107	0.034	0.0997	No	0.1009	No
3/31/2023 10:57	0.125	0.027	0.0996	No	0.1037	No
3/31/2023 10:58	0.117	0.06	0.1018	No	0.1059	No
3/31/2023 10:59	0.109	0.031	0.1021	No	0.1073	No
3/31/2023 11:00	0.12	0.03	0.1021	No	0.1077	No
3/31/2023 11:01	0.111	0.033	0.102	No	0.1072	No
3/31/2023 11:02	0.122	0.051	0.1019	No	0.1085	No
3/31/2023 11:03	0.105	0.136	0.1059	No	0.1089	No
3/31/2023 11:04	0.099	0.029	0.1053	No	0.1093	No
3/31/2023 11:05	0.101	0.029	0.092	No	0.1097	No
3/31/2023 11:06	0.101	0.031	0.0452	No	0.1105	No
3/31/2023 11:07	0.1	0.029	0.0437	No	0.1103	No
3/31/2023 11:08	0.117	0.027	0.0418	No	0.1109	No
3/31/2023 11:09	0.113	0.036	0.0415	No	0.1105	No
3/31/2023 11:10	0.111	0.037	0.0413	No	0.1105	No
3/31/2023 11:11	0.096	0.034	0.0413	No	0.1098	No
3/31/2023 11:12	0.097	0.036	0.0419	No	0.1079	No
3/31/2023 11:13	0.083	0.031	0.04	No	0.1057	No
3/31/2023 11:14	0.093	0.028	0.0398	No	0.1046	No
3/31/2023 11:15	0.082	0.04	0.0405	No	0.1021	No
3/31/2023 11:16	0.09	0.038	0.0408	No	0.1007	No
3/31/2023 11:17	0.101	0.035	0.0397	No	0.0993	No
3/31/2023 11:18	0.092	0.032	0.0328	No	0.0984	No
3/31/2023 11:19	0.094	0.055	0.0345	No	0.0981	No
3/31/2023 11:20	0.091	0.032	0.0347	No	0.0974	No
3/31/2023 11:21	0.107	0.035	0.035	No	0.0978	No
3/31/2023 11:22	0.082	0.063	0.0373	No	0.0966	No

Upwind Station						
Time	Instaneous VOC (ppm)	Instaneous Mass Conc. Total (mg/m ³)	Mass Conc. Total mg/m ³ AVG 15m (mg/m ³)	Dust Exceedance	VOC ppm AVG 15m (ppm)	VOC Exceedance
3/31/2023 11:23	0.081	0.038	0.038	No	0.0942	No
3/31/2023 11:24	0.084	0.029	0.0375	No	0.0923	No
3/31/2023 11:25	0.094	0.032	0.0372	No	0.0911	No
3/31/2023 11:26	0.11	0.028	0.0368	No	0.0921	No
3/31/2023 11:27	0.095	0.032	0.0365	No	0.0919	No
3/31/2023 11:28	0.083	0.029	0.0364	No	0.0919	No
3/31/2023 11:29	0.075	0.027	0.0363	No	0.0907	No
3/31/2023 11:30	0.077	0.024	0.0353	No	0.0904	No
3/31/2023 11:31	0.087	0.024	0.0343	No	0.0902	No
3/31/2023 11:32	0.072	0.027	0.0338	No	0.0883	No
3/31/2023 11:33	0.073	0.029	0.0336	No	0.087	No
3/31/2023 11:34	0.08	0.032	0.0321	No	0.0861	No
3/31/2023 11:35	0.088	0.041	0.0327	No	0.0859	No
3/31/2023 11:36	0.089	0.026	0.0321	No	0.0847	No
3/31/2023 11:37	0.083	0.027	0.0297	No	0.0847	No
3/31/2023 11:38	0.072	0.027	0.0289	No	0.0841	No
3/31/2023 11:39	0.062	0.03	0.029	No	0.0827	No
3/31/2023 11:40	0.06	0.026	0.0286	No	0.0804	No
3/31/2023 11:41	0.063	0.027	0.0285	No	0.0773	No
3/31/2023 11:42	0.072	0.024	0.028	No	0.0757	No

Downwind Station						
Time	Instantaneous VOC (ppm)	Instantaneous Mass Conc. Total (mg/m ³)	Mass Conc. Total mg/m ³ AVG 15m (mg/m ³)	Dust Exceedance	VOC ppm AVG 15m (ppm)	VOC Exceedance
3/31/2023 7:09	0.019			No	0.019	No
3/31/2023 7:10	0.007	0.067	0.067	No	0.013	No
3/31/2023 7:11	0	0.036	0.0515	No	0.0087	No
3/31/2023 7:12	0.022	0.037	0.0467	No	0.012	No
3/31/2023 7:13	0	0.032	0.043	No	0.0096	No
3/31/2023 7:14	0.042	0.031	0.0406	No	0.015	No
3/31/2023 7:15	0.022	0.025	0.038	No	0.016	No
3/31/2023 7:16	0.041	0.029	0.0367	No	0.0191	No
3/31/2023 7:17	0.036	0.027	0.0355	No	0.021	No
3/31/2023 7:18	0.005	0.03	0.0349	No	0.0194	No
3/31/2023 7:19	0	0.029	0.0343	No	0.0176	No
3/31/2023 7:20	0.021	0.03	0.0339	No	0.0179	No
3/31/2023 7:21	0.094	0.031	0.0337	No	0.0238	No
3/31/2023 7:22	0.136	0.029	0.0333	No	0.0318	No
3/31/2023 7:23	0.163	0.032	0.0332	No	0.0405	No
3/31/2023 7:24	0.131	0.032	0.0331	No	0.048	No
3/31/2023 7:25	0.079	0.032	0.0308	No	0.0528	No
3/31/2023 7:26	0.044	0.031	0.0305	No	0.0557	No
3/31/2023 7:27	0.023	0.032	0.0301	No	0.0558	No
3/31/2023 7:28	0.025	0.031	0.0301	No	0.0575	No
3/31/2023 7:29	0.102	0.032	0.0301	No	0.0615	No
3/31/2023 7:30	0.238	0.03	0.0305	No	0.0759	No
3/31/2023 7:31	0.033	0.031	0.0306	No	0.0753	No
3/31/2023 7:32	0.018	0.03	0.0308	No	0.0741	No
3/31/2023 7:33	0.071	0.03	0.0308	No	0.0785	No
3/31/2023 7:34	0.036	0.029	0.0308	No	0.0809	No
3/31/2023 7:35	0.041	0.031	0.0309	No	0.0823	No
3/31/2023 7:36	0.035	0.031	0.0309	No	0.0783	No
3/31/2023 7:37	0.037	0.031	0.031	No	0.0717	No
3/31/2023 7:38	0.055	0.029	0.0308	No	0.0645	No
3/31/2023 7:39	0.095	0.027	0.0305	No	0.0621	No
3/31/2023 7:40	0.011	0.028	0.0302	No	0.0576	No
3/31/2023 7:41	0.171	0.029	0.0301	No	0.0661	No
3/31/2023 7:42	0.077	0.026	0.0297	No	0.0697	No
3/31/2023 7:43	0.08	0.025	0.0293	No	0.0733	No
3/31/2023 7:44	0.207	0.059	0.0311	No	0.0803	No
3/31/2023 7:45	0.174	0.061	0.0331	No	0.0761	No
3/31/2023 7:46	0.198	0.033	0.0333	No	0.0871	No
3/31/2023 7:47	0.174	0.028	0.0331	No	0.0975	No
3/31/2023 7:48	0.125	0.025	0.0328	No	0.1011	No
3/31/2023 7:49	0.159	0.024	0.0325	No	0.1093	No
3/31/2023 7:50	0.192	0.022	0.0319	No	0.1193	No
3/31/2023 7:51	0.195	0.024	0.0314	No	0.13	No
3/31/2023 7:52	0.185	0.023	0.0309	No	0.1399	No
3/31/2023 7:53	0.267	0.023	0.0305	No	0.154	No
3/31/2023 7:54	0.171	0.024	0.0303	No	0.1591	No
3/31/2023 7:55	0.285	0.021	0.0298	No	0.1773	No
3/31/2023 7:56	0.283	0.021	0.0293	No	0.1848	No
3/31/2023 7:57	0.335	0.023	0.0291	No	0.202	No
3/31/2023 7:58	0.339	0.022	0.0289	No	0.2193	No
3/31/2023 7:59	0.384	0.02	0.0263	No	0.2311	No
3/31/2023 8:00	0.271	0.02	0.0235	No	0.2375	No
3/31/2023 8:01	0.285	0.02	0.0227	No	0.2433	No
3/31/2023 8:02	0.294	0.02	0.0221	No	0.2513	No
3/31/2023 8:03	0.333	0.021	0.0219	No	0.2652	No

Downwind Station						
Time	Instantaneous VOC (ppm)	Instantaneous Mass Conc. Total (mg/m ³)	Mass Conc. Total mg/m ³ AVG 15m (mg/m ³)	Dust Exceedance	VOC ppm AVG 15m (ppm)	VOC Exceedance
3/31/2023 8:04	0.221	0.02	0.0216	No	0.2693	No
3/31/2023 8:05	0.237	0.019	0.0214	No	0.2723	No
3/31/2023 8:06	0.217	0.02	0.0211	No	0.2738	No
3/31/2023 8:07	0.235	0.019	0.0209	No	0.2771	No
3/31/2023 8:08	0.288	0.019	0.0206	No	0.2785	No
3/31/2023 8:09	0.214	0.021	0.0204	No	0.2814	No
3/31/2023 8:10	0.158	0.02	0.0203	No	0.2729	No
3/31/2023 8:11	0.32	0.021	0.0203	No	0.2754	No
3/31/2023 8:12	0.181	0.02	0.0201	No	0.2651	No
3/31/2023 8:13	0.186	0.02	0.02	No	0.2549	No
3/31/2023 8:14	0.171	0.019	0.0199	No	0.2407	No
3/31/2023 8:15	0.253	0.02	0.0199	No	0.2395	No
3/31/2023 8:16	0.236	0.022	0.0201	No	0.2363	No
3/31/2023 8:17	0.225	0.024	0.0203	No	0.2317	No
3/31/2023 8:18	0.234	0.023	0.0205	No	0.2251	No
3/31/2023 8:19	0.176	0.023	0.0207	No	0.2221	No
3/31/2023 8:20	0.205	0.022	0.0209	No	0.2199	No
3/31/2023 8:21	0.244	0.022	0.021	No	0.2217	No
3/31/2023 8:22	0.283	0.025	0.0214	No	0.2249	No
3/31/2023 8:23	0.15	0.021	0.0215	No	0.2157	No
3/31/2023 8:24	0.148	0.021	0.0215	No	0.2113	No
3/31/2023 8:25	0.172	0.02	0.0215	No	0.2123	No
3/31/2023 8:26	0.141	0.02	0.0215	No	0.2003	No
3/31/2023 8:27	0.2	0.02	0.0215	No	0.2016	No
3/31/2023 8:28	0.188	0.02	0.0215	No	0.2017	No
3/31/2023 8:29	0.162	0.019	0.0215	No	0.2011	No
3/31/2023 8:30	0.164	0.022	0.0216	No	0.1952	No
3/31/2023 8:31	0.216	0.021	0.0215	No	0.1939	No
3/31/2023 8:32	0.152	0.019	0.0212	No	0.189	No
3/31/2023 8:33	0.224	0.019	0.0209	No	0.1883	No
3/31/2023 8:34	0.199	0.02	0.0207	No	0.1899	No
3/31/2023 8:35	0.18	0.018	0.0205	No	0.1882	No
3/31/2023 8:36	0.141	0.018	0.0202	No	0.1813	No
3/31/2023 8:37	0.122	0.019	0.0198	No	0.1706	No
3/31/2023 8:38	0.181	0.019	0.0197	No	0.1727	No
3/31/2023 8:39	0.258	0.021	0.0197	No	0.18	No
3/31/2023 8:40	0.219	0.019	0.0196	No	0.1831	No
3/31/2023 8:41	0.178	0.019	0.0195	No	0.1856	No
3/31/2023 8:42	0.684	0.02	0.0195	No	0.2179	No
3/31/2023 8:43	0.399	0.019	0.0195	No	0.2319	No
3/31/2023 8:44	0.306	0.023	0.0197	No	0.2415	No
3/31/2023 8:45	0.208	0.023	0.0198	No	0.2445	No
3/31/2023 8:46	0.256	0.022	0.0199	No	0.2471	No
3/31/2023 8:47	0.244	0.023	0.0201	No	0.2533	No
3/31/2023 8:48	0.277	0.022	0.0203	No	0.2568	No
3/31/2023 8:48	0.26	0.018	0.0202	No	0.2609	No
3/31/2023 8:49	0.22	0.017	0.0201	No	0.2635	No
3/31/2023 8:50	0.21	0.017	0.0201	No	0.2681	No
3/31/2023 8:51	0.198	0.018	0.02	No	0.2732	No
3/31/2023 8:52	0.226	0.021	0.0201	No	0.2762	No
3/31/2023 8:53	0.403	0.028	0.0206	No	0.2859	No
3/31/2023 8:54	0.43	0.027	0.0211	No	0.2999	No
3/31/2023 8:55	0.321	0.025	0.0215	No	0.3095	No
3/31/2023 8:56	0.352	0.02	0.0215	No	0.2873	No
3/31/2023 8:57	0.514	0.021	0.0217	No	0.295	No

Downwind Station						
Time	Instantaneous VOC (ppm)	Instantaneous Mass Conc. Total (mg/m ³)	Mass Conc. Total mg/m ³ AVG 15m (mg/m ³)	Dust Exceedance	VOC ppm AVG 15m (ppm)	VOC Exceedance
3/31/2023 8:58	0.355	0.024	0.0217	No	0.2983	No
3/31/2023 8:59	0.294	0.025	0.0219	No	0.304	No
3/31/2023 9:00	0.293	0.026	0.0221	No	0.3065	No
3/31/2023 9:01	0.281	0.025	0.0223	No	0.3089	No
3/31/2023 9:02	0.316	0.027	0.0226	No	0.3115	No
3/31/2023 9:03	0.225	0.025	0.0231	No	0.3092	No
3/31/2023 9:04	0.233	0.026	0.0237	No	0.3101	No
3/31/2023 9:05	0.264	0.027	0.0243	No	0.3137	No
3/31/2023 9:06	0.231	0.026	0.0249	No	0.3159	No
3/31/2023 9:07	0.238	0.026	0.0252	No	0.3167	No
3/31/2023 9:08	0.241	0.027	0.0251	No	0.3059	No
3/31/2023 9:09	0.188	0.027	0.0251	No	0.2897	No
3/31/2023 9:10	0.204	0.028	0.0253	No	0.2819	No
3/31/2023 9:11	0.219	0.028	0.0259	No	0.2731	No
3/31/2023 9:12	0.269	0.027	0.0263	No	0.2567	No
3/31/2023 9:13	0.268	0.028	0.0265	No	0.2509	No
3/31/2023 9:14	0.22	0.027	0.0267	No	0.246	No
3/31/2023 9:15	0.292	0.029	0.0269	No	0.2459	No
3/31/2023 9:16	0.208	0.029	0.0271	No	0.2411	No
3/31/2023 9:17	0.237	0.028	0.0272	No	0.2358	No
3/31/2023 9:18	0.212	0.027	0.0273	No	0.2349	No
3/31/2023 9:19	0.237	0.028	0.0275	No	0.2352	No
3/31/2023 9:20	0.18	0.028	0.0275	No	0.2296	No
3/31/2023 9:21	0.19	0.027	0.0276	No	0.2269	No
3/31/2023 9:22	0.193	0.027	0.0277	No	0.2239	No
3/31/2023 9:23	0.231	0.026	0.0276	No	0.2232	No
3/31/2023 9:24	0.216	0.025	0.0275	No	0.2251	No
3/31/2023 9:25	0.225	0.025	0.0273	No	0.2265	No
3/31/2023 9:26	0.208	0.025	0.0271	No	0.2257	No
3/31/2023 9:27	0.179	0.026	0.027	No	0.2197	No
3/31/2023 9:28	0.222	0.026	0.0269	No	0.2167	No
3/31/2023 9:29	0.179	0.026	0.0268	No	0.2139	No
3/31/2023 9:30	0.268	0.026	0.0266	No	0.2123	No
3/31/2023 9:31	0.188	0.026	0.0264	No	0.211	No
3/31/2023 9:32	0.14	0.026	0.0263	No	0.2045	No
3/31/2023 9:33	0.218	0.026	0.0262	No	0.2049	No
3/31/2023 9:34	0.306	0.027	0.0261	No	0.2095	No
3/31/2023 9:35	0.227	0.026	0.026	No	0.2127	No
3/31/2023 9:36	0.302	0.026	0.0259	No	0.2201	No
3/31/2023 9:37	0.194	0.025	0.0258	No	0.2202	No
3/31/2023 9:38	0.284	0.025	0.0257	No	0.2237	No
3/31/2023 9:39	0.424	0.025	0.0257	No	0.2376	No
3/31/2023 9:40	0.185	0.025	0.0257	No	0.2349	No
3/31/2023 9:41	0.183	0.025	0.0257	No	0.2333	No
3/31/2023 9:42	0.213	0.024	0.0256	No	0.2355	No
3/31/2023 9:43	0.191	0.025	0.0255	No	0.2335	No
3/31/2023 9:44	0.272	0.024	0.0254	No	0.2397	No
3/31/2023 9:45	0.251	0.024	0.0253	No	0.2385	No
3/31/2023 9:46	0.176	0.025	0.0252	No	0.2377	No
3/31/2023 9:47	0.241	0.025	0.0251	No	0.2445	No
3/31/2023 9:48	0.475	0.025	0.0251	No	0.2616	No
3/31/2023 9:49	0.228	0.025	0.0249	No	0.2564	No
3/31/2023 9:50	0.288	0.025	0.0249	No	0.2605	No
3/31/2023 9:51	0.361	0.026	0.0249	No	0.2644	No
3/31/2023 9:52	0.243	0.026	0.0249	No	0.2677	No

Downwind Station						
Time	Instantaneous VOC (ppm)	Instantaneous Mass Conc. Total (mg/m ³)	Mass Conc. Total mg/m ³ AVG 15m (mg/m ³)	Dust Exceedance	VOC ppm AVG 15m (ppm)	VOC Exceedance
3/31/2023 9:53	0.308	0.027	0.0251	No	0.2693	No
3/31/2023 9:54	0.22	0.027	0.0252	No	0.2557	No
3/31/2023 9:55	0.167	0.027	0.0253	No	0.2545	No
3/31/2023 9:56	0.274	0.027	0.0255	No	0.2605	No
3/31/2023 9:57	0.213	0.026	0.0256	No	0.2605	No
3/31/2023 9:58	0.365	0.027	0.0257	No	0.2721	No
3/31/2023 9:59	0.276	0.027	0.0259	No	0.2724	No
3/31/2023 10:00	0.269	0.028	0.0262	No	0.2736	No
3/31/2023 10:01	0.243	0.028	0.0264	No	0.2781	No
3/31/2023 10:02	0.25	0.028	0.0266	No	0.2787	No
3/31/2023 10:03	0.277	0.028	0.0268	No	0.2655	No
3/31/2023 10:04	0.245	0.028	0.027	No	0.2666	No
3/31/2023 10:05	0.238	0.028	0.0272	No	0.2633	No
3/31/2023 10:06	0.204	0.028	0.0273	No	0.2528	No
3/31/2023 10:07	0.261	0.027	0.0274	No	0.254	No
3/31/2023 10:08	0.232	0.027	0.0274	No	0.2489	No
3/31/2023 10:09	0.175	0.026	0.0273	No	0.2459	No
3/31/2023 10:10	0.201	0.027	0.0273	No	0.2482	No
3/31/2023 10:11	0.198	0.027	0.0273	No	0.2431	No
3/31/2023 10:12	0.285	0.027	0.0274	No	0.2479	No
3/31/2023 10:13	0.25	0.027	0.0274	No	0.2403	No
3/31/2023 10:14	0.238	0.027	0.0274	No	0.2377	No
3/31/2023 10:15	0.231	0.025	0.0272	No	0.2352	No
3/31/2023 10:16	0.178	0.023	0.0269	No	0.2309	No
3/31/2023 10:17	0.172	0.023	0.0265	No	0.2257	No
3/31/2023 10:18	0.227	0.024	0.0263	No	0.2223	No
3/31/2023 10:19	0.239	0.024	0.026	No	0.2219	No
3/31/2023 10:20	0.194	0.021	0.0255	No	0.219	No
3/31/2023 10:21	0.18	0.021	0.0251	No	0.2174	No
3/31/2023 10:22	0.231	0.021	0.0247	No	0.2154	No
3/31/2023 10:23	0.326	0.021	0.0243	No	0.2217	No
3/31/2023 10:24	0.224	0.021	0.0239	No	0.2249	No
3/31/2023 10:25	0.279	0.022	0.0236	No	0.2301	No
3/31/2023 10:26	0.226	0.021	0.0232	No	0.232	No
3/31/2023 10:27	0.259	0.021	0.0228	No	0.2303	No
3/31/2023 10:28	0.148	0.02	0.0223	No	0.2235	No
3/31/2023 10:29	0.26	0.019	0.0218	No	0.2249	No
3/31/2023 10:30	0.249	0.017	0.0213	No	0.2261	No
3/31/2023 10:31	0.241	0.017	0.0209	No	0.2303	No
3/31/2023 10:32	0.242	0.018	0.0205	No	0.235	No
3/31/2023 10:33	0.218	0.019	0.0202	No	0.2344	No
3/31/2023 10:34	0.243	0.018	0.0198	No	0.2347	No
3/31/2023 10:35	0.232	0.017	0.0195	No	0.2372	No
3/31/2023 10:36	0.183	0.017	0.0193	No	0.2374	No
3/31/2023 10:37	0.245	0.018	0.0191	No	0.2383	No
3/31/2023 10:38	0.222	0.019	0.0189	No	0.2314	No
3/31/2023 10:39	0.283	0.021	0.0189	No	0.2353	No
3/31/2023 10:40	0.284	0.022	0.0189	No	0.2357	No
3/31/2023 10:41	0.262	0.022	0.019	No	0.2381	No
3/31/2023 10:42	0.235	0.022	0.0191	No	0.2365	No
3/31/2023 10:43	0.197	0.024	0.0193	No	0.2397	No
3/31/2023 10:44	0.299	0.025	0.0197	No	0.2423	No
3/31/2023 10:45	0.26	0.025	0.0203	No	0.2431	No
3/31/2023 10:46	0.206	0.025	0.0208	No	0.2407	No
3/31/2023 10:47	0.251	0.024	0.0212	No	0.2413	No

Downwind Station

Time	Instantaneous VOC (ppm)	Instantaneous Mass Conc. Total (mg/m ³)	Mass Conc. Total mg/m ³ AVG 15m (mg/m ³)	Dust Exceedance	VOC ppm AVG 15m (ppm)	VOC Exceedance
3/31/2023 10:48	0.207	0.026	0.0217	No	0.2406	No
3/31/2023 10:49	0.248	0.026	0.0222	No	0.2409	No
3/31/2023 10:50	0.238	0.026	0.0228	No	0.2413	No
3/31/2023 10:51	0.165	0.026	0.0234	No	0.2401	No
3/31/2023 10:52	0.241	0.027	0.024	No	0.2399	No
3/31/2023 10:53	0.216	0.027	0.0245	No	0.2395	No
3/31/2023 10:54	0.307	0.027	0.0249	No	0.2411	No
3/31/2023 10:55	0.185	0.027	0.0253	No	0.2345	No
3/31/2023 10:56	0.22	0.026	0.0255	No	0.2317	No
3/31/2023 10:57	0.238	0.027	0.0259	No	0.2319	No
3/31/2023 10:58	0.196	0.026	0.026	No	0.2318	No
3/31/2023 10:59	0.274	0.027	0.0261	No	0.2301	No
3/31/2023 11:00	0.265	0.027	0.0263	No	0.2305	No
3/31/2023 11:01	0.213	0.026	0.0263	No	0.2309	No
3/31/2023 11:02	0.166	0.025	0.0264	No	0.2253	No
3/31/2023 11:03	0.205	0.026	0.0264	No	0.2251	No
3/31/2023 11:04	0.248	0.025	0.0263	No	0.2251	No
3/31/2023 11:05	0.231	0.025	0.0263	No	0.2247	No
3/31/2023 11:06	0.179	0.024	0.0261	No	0.2256	No
3/31/2023 11:07	0.148	0.024	0.0259	No	0.2194	No
3/31/2023 11:08	0.174	0.024	0.0257	No	0.2166	No
3/31/2023 11:09	0.172	0.025	0.0256	No	0.2076	No
3/31/2023 11:10	0.17	0.024	0.0254	No	0.2066	No
3/31/2023 11:11	0.227	0.023	0.0252	No	0.2071	No
3/31/2023 11:12	0.145	0.022	0.0249	No	0.2009	No
3/31/2023 11:13	0.243	0.022	0.0246	No	0.204	No
3/31/2023 11:14	0.232	0.022	0.0243	No	0.2012	No
3/31/2023 11:15	0.16	0.021	0.0239	No	0.1942	No
3/31/2023 11:16	0.166	0.021	0.0235	No	0.1911	No
3/31/2023 11:17	0.192	0.019	0.0231	No	0.1928	No
3/31/2023 11:18	0.268	0.019	0.0227	No	0.197	No
3/31/2023 11:19	0.219	0.02	0.0223	No	0.1951	No
3/31/2023 11:20	0.3	0.018	0.0219	No	0.1997	No
3/31/2023 11:21	0.191	0.018	0.0215	No	0.2005	No
3/31/2023 11:22	0.194	0.018	0.0211	No	0.2035	No
3/31/2023 11:23	0.137	0.018	0.0207	No	0.2011	No
3/31/2023 11:24	0.192	0.019	0.0203	No	0.2024	No
3/31/2023 11:25	0.149	0.019	0.0199	No	0.201	No
3/31/2023 11:26	0.148	0.02	0.0197	No	0.1957	No
3/31/2023 11:27	0.177	0.021	0.0197	No	0.1979	No
3/31/2023 11:28	0.234	0.021	0.0196	No	0.1973	No
3/31/2023 11:29	0.141	0.02	0.0195	No	0.1912	No
3/31/2023 11:30	0.282	0.021	0.0195	No	0.1993	No
3/31/2023 11:31	0.158	0.02	0.0194	No	0.1988	No
3/31/2023 11:32	0.185	0.02	0.0195	No	0.1983	No
3/31/2023 11:33	0.239	0.02	0.0195	No	0.1964	No
3/31/2023 11:34	0.204	0.02	0.0195	No	0.1954	No
3/31/2023 11:35	0.292	0.02	0.0197	No	0.1949	No
3/31/2023 11:36	0.174	0.02	0.0198	No	0.1937	No
3/31/2023 11:37	0.259	0.02	0.0199	No	0.1981	No
3/31/2023 11:38	0.191	0.018	0.0199	No	0.2017	No
3/31/2023 11:39	0.165	0.019	0.0199	No	0.1999	No
3/31/2023 11:40	0.164	0.019	0.0199	No	0.2009	No
3/31/2023 11:41	0.175	0.134	0.0785	No	0.1387	No