



Daily Activity Report

Seton Brilla Charter School
1956 Jerome Avenue, Bronx, NY
BCP No. C203152

General Site Information

Date:	Tuesday, March 28, 2023
Weather:	Partly Cloudy/Rainy, 40-59°F
Wind Direction/Speed:	N @ 7 mph
AKRF Personnel on Site:	Lucas Belangia
AKRF Equipment on Site:	Mini RAE 3000 Photoionization Detector [(PID) x1], 2 Fixed Air Monitoring Stations [DustTrak
Visitors:	None.

Contractor Information

Contracting Company	Main Personnel	Equipment
Casino Construction	Carlos	Excavator

Description and Location of Work Activities Performed

- 1) Pile cap and grade beam construction activities continued.
- 2) One load of concrete was disposed and lumber imported for formwork surrounding piles.

Destination Facility	Daily Trucks	Total Trucks	Daily Approx. Cubic Yds	Total Approx. Cubic Yds	Total Site Loads	Total Approximate Cubic Yards
Clean Earth Carteret	0	89	0	1,780	183	3,660
Clean Earth Southeastern Pennsylvania	0	67	0	1,340		
Concrete Disposal	1	27	20	540		
N/A	0	0	0	0		
N/A	0	0	0	0		

CAMP Air Monitoring Results

CAMP Station	UPWIND				DOWNWIND		
Odors:	None.				None.		
VOC Action Level Exceedance(s):	Yes				Yes		
Particulate Action Level Exceedance(s):	Yes				Yes		
Maximum VOC Level (15 min ppm):	17.700				19.917		
Maximum Particulate Level (15 min mg/m ³):	0.049				0.191		

Notes: CAMP monitoring was performed throughout the morning, but were halted at approx. 1000 due to rain showers, which persisted throughout the rest of the day. VOC and particulate concentrations began to spike around 0945 due to excavation for pile cap construction in the southwest corner within the groundwater treatment area. However, the precipitation event that began at 1000 helped to return the particulate concentrations to background levels. Petroleum-like odors observed during excavation in the groundwater treatment area around 0945 also faded to background as a result of the precipitation event. If strong odors and PID concentrations are recorded during pile cap construction in that area going forward, the crew will be prepared to address with either plastic sheeting and/or foam suppressant.

Additional Information

Planned Work Activity for Following Day/Week:	1) Excavation of soil/fill to uncover piles. 2) Cutting piles to final elevations 3) Exporting of soil off-site
Comments:	None.

Site Map

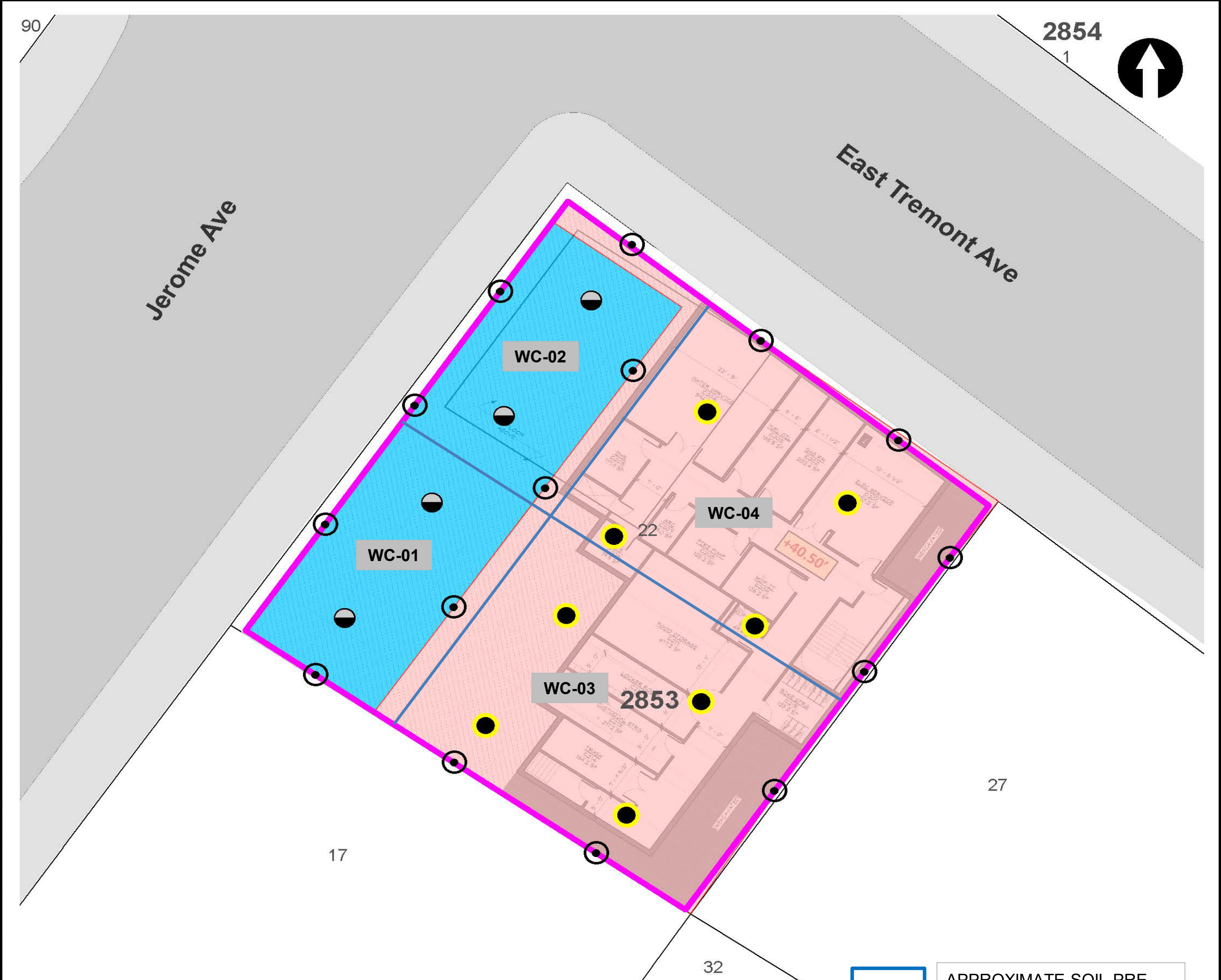

LEGEND

- PROJECT SITE BOUNDARY
- LOT BOUNDARY AND TAX LOT NUMBER
- 2853** BLOCK NUMBER
- REMEDIAL EXCAVATION TO APPROXIMATELY TWO FEET BELOW EXISTING GRADE
- REMEDIAL EXCAVATION TO GROUNDWATER (SOURCE AREA)

- CONFIRMATION DOCUMENTATION BOTTOM SAMPLE
- SOURCE AREA DOCUMENTATION BOTTOM SAMPLE
- DOCUMENTATION SIDEWALL SAMPLE

NOTE
 REMEDIAL EXCAVATION WILL INCLUDE REMOVAL OF APPROXIMATELY 1,280 TONS (850 CUBIC YARDS) OF SOURCE MATERIAL ASSOCIATED WITH NYSDEC SPILL NO. 2103719 AND APPROXIMATELY 860 TONS (570 CUBIC YARDS) OF SOIL/FILL FROM THE UPPER 2 FEET SITE-WIDE.

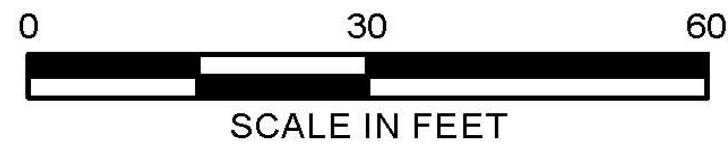

APPROXIMATE SOIL PRE-CHARACTERIZATION GRID

Map Source:
 NYCDOP (NYC Dept. of City Planning) GIS database

© 2021 AKRF. W:\Projects\210024 - 1956 JEROME AVENUE\Technical\GIS and Graphics\AR\RAW\210024 Figure 9 Proposed Remedial Excavation and Documentation Sample Location Plan.mxd 10/25/2021 2:03:38 PM iszalus



440 Park Avenue South, New York, NY 10016

1956 Jerome Avenue
 Bronx, New York

**TRACK 4 CLEANUP AND DOCUMENTATION
 SAMPLE LOCATION PLAN**

DATE
04/29/2022

PROJECT NO.
210024

FIGURE
11

Site Photographs

Photograph 1 -
Disposal of concrete



Photograph 2-
Jackhammering of
piles for removal.
Cause of Particulate
Action Exceedance.



Photograph 3-
Grading soil in grid
WC-04.



Upwind Station						
Time	Instaneous VOC (ppm)	Instaneous Mass Conc. Total (mg/m³)	Mass Conc. Total mg/m³ AVG 15m (mg/m³)	Dust Exceedance	VOC ppm AVG 15m (ppm)	VOC Exceedance
3/28/2023 7:11	0	0.017		No	0.000	No
3/28/2023 7:12	0	0.0175	0.049	No	0.000	No
3/28/2023 7:13	0	0.0173	0.0425	No	0.000	No
3/28/2023 7:14	0	0.017	0.041	No	0.000	No
3/28/2023 7:15	0	0.0168	0.0438	No	0.000	No
3/28/2023 7:16	0	0.0168	0.0448	No	0.000	No
3/28/2023 7:17	0	0.017	0.046	No	0.000	No
3/28/2023 7:18	0	0.0245	0.0463	No	0.000	No
3/28/2023 7:19	0	0.0247	0.0464	No	0.000	No
3/28/2023 7:20	0	0.0239	0.0462	No	0.000	No
3/28/2023 7:21	0	0.0234	0.0463	No	0.000	No
3/28/2023 7:22	0	0.0229	0.0457	No	0.000	No
3/28/2023 7:23	0	0.0224	0.0452	No	0.000	No
3/28/2023 7:24	0	0.022	0.0447	No	0.000	No
3/28/2023 7:25	0	0.0217	0.0439	No	0.000	No
3/28/2023 7:26	0	0.0216	0.0431	No	0.000	No
3/28/2023 7:27	0	0.0215	0.0421	No	0.000	No
3/28/2023 7:28	0	0.0215	0.0418	No	0.000	No
3/28/2023 7:29	0	0.0216	0.0413	No	0.000	No
3/28/2023 7:30	0	0.0217	0.04	No	0.000	No
3/28/2023 7:31	0.2812	0.0217	0.0391	No	0.019	No
3/28/2023 7:32	0.4292	0.0217	0.0378	No	0.047	No
3/28/2023 7:33	0.4878	0.0178	0.0369	No	0.080	No
3/28/2023 7:34	0.5364	0.0173	0.0359	No	0.116	No
3/28/2023 7:35	0.5619	0.0173	0.0353	No	0.153	No
3/28/2023 7:36	0.6043	0.0173	0.0346	No	0.193	No
3/28/2023 7:37	0.7329	0.0173	0.0349	No	0.242	No
3/28/2023 7:38	1.1522	0.0175	0.0366	No	0.319	No
3/28/2023 7:39	1.3481	0.0174	0.0363	No	0.409	No
3/28/2023 7:40	1.4211	0.0175	0.0364	No	0.504	No
3/28/2023 7:41	1.6793	0.0177	0.0371	No	0.616	No
3/28/2023 7:42	2.1383	0.0193	0.0373	No	0.758	No
3/28/2023 7:43	2.1818	0.0193	0.0372	No	0.904	No
3/28/2023 7:47	2.2438	0.0202	0.0371	No	1.053	No
3/28/2023 7:48	2.2729	0.0216	0.037	No	1.205	No
3/28/2023 7:49	2.0745	0.0234	0.0367	No	1.324	No
3/28/2023 7:50	2.0006	0.0233	0.0366	No	1.429	No
3/28/2023 7:51	2.0429	0.023	0.0363	No	1.533	No
3/28/2023 7:52	2.0396	0.0226	0.036	No	1.633	No
3/28/2023 7:53	2.0558	0.0223	0.0353	No	1.733	No
3/28/2023 7:54	2.0955	0.0222	0.0349	No	1.832	No
3/28/2023 7:55	1.987	0.0219	0.0349	No	1.916	No
3/28/2023 7:56	1.5976	0.0216	0.0332	No	1.945	No
3/28/2023 7:57	1.4428	0.0194	0.0329	No	1.952	No
3/28/2023 7:58	1.3841	0.019	0.0323	No	1.949	No
3/28/2023 7:59	1.2462	0.0185	0.0313	No	1.920	No
3/28/2023 8:00	0.8091	0.018	0.0304	No	1.832	No
3/28/2023 8:01	0.8789	0.0177	0.0302	No	1.745	No
3/28/2023 8:02	0.8887	0.0174	0.0301	No	1.654	No
3/28/2023 8:03	0.8927	0.016	0.03	No	1.562	No
3/28/2023 8:04	0.8527	0.0143	0.0295	No	1.481	No
3/28/2023 8:05	0.8189	0.0143	0.0291	No	1.402	No

Upwind Station						
Time	Instantaneous VOC (ppm)	Instantaneous Mass Conc. Total (mg/m ³)	Mass Conc. Total mg/m ³ AVG 15m (mg/m ³)	Dust Exceedance	VOC ppm AVG 15m (ppm)	VOC Exceedance
3/28/2023 8:06	0.7673	0.0143	0.0297	No	1.317	No
3/28/2023 8:07	0.7383	0.015	0.0304	No	1.230	No
3/28/2023 8:08	0.7119	0.017	0.0327	No	1.141	No
3/28/2023 8:09	0.6467	0.018	0.0366	No	1.044	No
3/28/2023 8:10	0.6366	0.0181	0.0366	No	0.954	No
3/28/2023 8:11	0.6236	0.0182	0.0358	No	0.889	No
3/28/2023 8:12	0.5957	0.0181	0.0358	No	0.833	No
3/28/2023 8:13	0.5983	0.018	0.0361	No	0.780	No
3/28/2023 8:14	0.4942	0.018	0.0407	No	0.730	No
3/28/2023 8:15	0.4797	0.02	0.0475	No	0.708	No
3/28/2023 8:16	0.3743	0.0199	0.0479	No	0.675	No
3/28/2023 8:17	0.311	0.0195	0.0478	No	0.636	No
3/28/2023 8:18	0.3007	0.0194	0.0475	No	0.597	No
3/28/2023 8:19	0.2858	0.0192	0.0474	No	0.559	No
3/28/2023 8:20	0.2568	0.0236	0.0471	No	0.521	No
3/28/2023 8:21	0.2507	0.0233	0.0461	No	0.487	No
3/28/2023 8:22	0.2549	0.0225	0.0453	No	0.455	No
3/28/2023 8:23	0.2544	0.0203	0.0431	No	0.424	No
3/28/2023 8:24	0.2455	0.019	0.0407	No	0.397	No
3/28/2023 8:25	0.2828	0.0188	0.0399	No	0.374	No
3/28/2023 8:26	0.2949	0.0185	0.04	No	0.352	No
3/28/2023 8:27	0.2943	0.0185	0.0397	No	0.332	No
3/28/2023 8:28	0.2834	0.0187	0.0389	No	0.311	No
3/28/2023 8:29	0.3038	0.0193	0.0345	No	0.298	No
3/28/2023 8:30	0.3181	0.0176	0.0294	No	0.287	No
3/28/2023 8:31	0.3292	0.0177	0.0309	No	0.284	No
3/28/2023 8:32	0.3614	0.0174	0.0363	No	0.288	No
3/28/2023 8:33	0.3845	0.0172	0.0385	No	0.293	No
3/28/2023 8:34	0.4021	0.0172	0.0409	No	0.301	No
3/28/2023 8:35	0.4065	0.0123	0.0475	No	0.311	No
3/28/2023 8:36	0.3725	0.0121	0.0477	No	0.319	No
3/28/2023 8:37	0.3992	0.0119	0.0479	No	0.329	No
3/28/2023 8:38	0.407	0.0118	0.0481	No	0.339	No
3/28/2023 8:39	0.4124	0.0117	0.047	No	0.350	No
3/28/2023 8:40	0.3817	0.0115	0.0468	No	0.357	No
3/28/2023 8:41	0.3588	0.0113	0.0466	No	0.361	No
3/28/2023 8:42	0.3542	0.0111	0.0469	No	0.365	No
3/28/2023 8:43	0.3556	0.0108	0.0475	No	0.370	No
3/28/2023 8:44	0.3461	0.01	0.0475	No	0.373	No
3/28/2023 8:45	0.3434	0.0095	0.0465	No	0.374	No
3/28/2023 8:46	0.3359	0.0093	0.0449	No	0.375	No
3/28/2023 8:47	0.3066	0.0093	0.0393	No	0.371	No
3/28/2023 8:48	0.2699	0.0093	0.0371	No	0.363	No
3/28/2023 8:49	0.3155	0.0091	0.0347	No	0.358	No
3/28/2023 8:50	0.4279	0.0091	0.0284	No	0.359	No
3/28/2023 8:51	0.4586	0.0091	0.0282	No	0.365	No
3/28/2023 8:52	0.4873	0.009	0.0278	No	0.371	No
3/28/2023 8:53	0.6414	0.009	0.0272	No	0.386	No
3/28/2023 8:54	0.686	0.0089	0.0262	No	0.405	No
3/28/2023 8:55	0.9443	0.0087	0.0258	No	0.442	No
3/28/2023 8:56	0.995	0.0087	0.0256	No	0.485	No
3/28/2023 8:57	1.0165	0.0086	0.0251	No	0.529	No

Upwind Station						
Time	Instaneous VOC (ppm)	Instaneous Mass Conc. Total (mg/m³)	Mass Conc. Total mg/m³ AVG 15m (mg/m³)	Dust Exceedance	VOC ppm AVG 15m (ppm)	VOC Exceedance
3/28/2023 8:58	1.0214	0.0085	0.0244	No	0.573	No
3/28/2023 8:59	1.0083	0.0085	0.0237	No	0.617	No
3/28/2023 9:00	1.0203	0.0085	0.0225	No	0.662	No
3/28/2023 9:01	1.0884	0.0086	0.0217	No	0.712	No
3/28/2023 9:02	1.2145	0.0085	0.0212	No	0.773	No
3/28/2023 9:03	1.3979	0.009	0.0209	No	0.848	No
3/28/2023 9:04	1.3579	0.0095	0.0208	No	0.918	No
3/28/2023 9:05	1.4481	0.0144	0.0203	No	0.986	No
3/28/2023 9:06	1.4478	0.0155	0.0198	No	1.052	No
3/28/2023 9:07	1.4522	0.0155	0.0195	No	1.116	No
3/28/2023 9:08	1.3365	0.0154	0.0192	No	1.162	No
3/28/2023 9:09	1.3272	0.0157	0.0187	No	1.205	No
3/28/2023 9:10	1.0799	0.0157	0.0183	No	1.214	No
3/28/2023 9:11	1.0927	0.0157	0.0177	No	1.221	No
3/28/2023 9:12	1.0923	0.0155	0.0172	No	1.226	No
3/28/2023 9:13	1.0999	0.0154	0.017	No	1.231	No
3/28/2023 9:14	1.104	0.0153	0.0165	No	1.237	No
3/28/2023 9:15	1.0839	0.0151	0.0161	No	1.242	No
3/28/2023 9:16	1.0547	0.0149	0.0157	No	1.239	No
3/28/2023 9:17	0.9327	0.0147	0.0153	No	1.221	No
3/28/2023 9:18	0.7573	0.0141	0.0148	No	1.178	No
3/28/2023 9:19	0.7211	0.0136	0.0141	No	1.135	No
3/28/2023 9:20	0.5128	0.0086	0.0139	No	1.073	No
3/28/2023 9:21	0.4895	0.0074	0.0135	No	1.009	No
3/28/2023 9:22	0.4737	0.0072	0.0129	No	0.944	No
3/28/2023 9:23	1.0863	0.007	0.0125	No	0.927	No
3/28/2023 9:24	1.0701	0.0066	0.0124	No	0.910	No
3/28/2023 9:25	1.0613	0.0064	0.012	No	0.909	No
3/28/2023 9:26	2.1787	0.0066	0.0119	No	0.981	No
3/28/2023 9:27	2.7919	0.0072	0.0119	No	1.095	No
3/28/2023 9:28	3.2136	0.0073	0.0127	No	1.235	No
3/28/2023 9:29	3.2993	0.0072	0.0126	No	1.382	No
3/28/2023 9:30	3.4249	0.0073	0.0125	No	1.538	No
3/28/2023 9:31	3.4533	0.0073	0.0123	No	1.698	No
3/28/2023 9:32	4.9815	0.0074	0.0141	No	1.968	No
3/28/2023 9:33	6.3122	0.0073	0.0189	No	2.338	No
3/28/2023 9:34	7.7581	0.0074	0.0192	No	2.807	No
3/28/2023 9:35	8.2859	0.0075	0.0191	No	3.325	No
3/28/2023 9:36	9.3396	0.0077	0.019	No	3.915	No
3/28/2023 9:37	10.329	0.008	0.0191	No	4.572	No
3/28/2023 9:38	9.8411	0.0081	0.0201	No	5.156	Yes
3/28/2023 9:39	10.162	0.0084	0.0203	No	5.762	Yes
3/28/2023 9:40	10.816	0.0089	0.0218	No	6.412	Yes
3/28/2023 9:41	10.128	0.0089	0.0235	No	6.942	Yes
3/28/2023 9:42	10.18	0.0085	0.0234	No	7.435	Yes
3/28/2023 9:43	10.129	0.0086	0.0223	No	7.896	Yes
3/28/2023 9:44	10.354	0.0087	0.0225	No	8.366	Yes
3/28/2023 9:45	20.79	0.009	0.0226	No	9.524	Yes
3/28/2023 9:46	22.478	0.0093	0.0229	No	10.792	Yes
3/28/2023 9:47	21.38	0.0097	0.0212	No	11.886	Yes
3/28/2023 9:48	20.777	0.0101	0.0167	No	12.850	Yes
3/28/2023 9:49	19.649	0.0099	0.0168	No	13.643	Yes

Upwind Station

Time	Instantaneous VOC (ppm)	Instantaneous Mass Conc. Total (mg/m ³)	Mass Conc. Total mg/m ³ AVG 15m (mg/m ³)	Dust Exceedance	VOC ppm AVG 15m (ppm)	VOC Exceedance
3/28/2023 9:50	19.581	0.0107	0.0174	No	14.396	Yes
3/28/2023 9:51	18.741	0.0131	0.018	No	15.022	Yes
3/28/2023 9:52	18.153	0.0148	0.0187	No	15.544	Yes
3/28/2023 9:53	18.485	0.0227	0.0192	No	16.120	Yes
3/28/2023 9:54	18.552	0.0265	0.0193	No	16.680	Yes
3/28/2023 9:55	18.189	0.0264	0.0203	No	17.171	Yes
3/28/2023 9:56	17.993	0.0263	0.0387	No	17.695	Yes

Downwind Station						
Time	Instaneous VOC (ppm)	Instaneous Mass Conc. Total (mg/m ³)	Mass Conc. Total mg/m ³ AVG 15m (mg/m ³)	Dust Exceedance	VOC ppm AVG 15m (ppm)	VOC Exceedance
3/28/2023 7:07	0			No	0	No
3/28/2023 7:08	0	0.049	0.049	No	0	No
3/28/2023 7:09	0	0.036	0.0425	No	0	No
3/28/2023 7:10	0	0.038	0.041	No	0	No
3/28/2023 7:11	0	0.052	0.0438	No	0	No
3/28/2023 7:12	0	0.049	0.0448	No	0	No
3/28/2023 7:13	0	0.052	0.046	No	0	No
3/28/2023 7:14	0	0.048	0.0463	No	0	No
3/28/2023 7:15	0	0.047	0.0464	No	0	No
3/28/2023 7:16	0	0.045	0.0462	No	0	No
3/28/2023 7:17	0	0.047	0.0463	No	0	No
3/28/2023 7:18	0	0.04	0.0457	No	0	No
3/28/2023 7:19	0	0.04	0.0452	No	0	No
3/28/2023 7:20	0	0.038	0.0447	No	0	No
3/28/2023 7:21	0	0.033	0.0439	No	0.000	No
3/28/2023 7:22	0	0.032	0.0431	No	0.000	No
3/28/2023 7:23	0	0.034	0.0421	No	0.000	No
3/28/2023 7:24	0	0.032	0.0418	No	0.000	No
3/28/2023 7:25	0	0.031	0.0413	No	0.000	No
3/28/2023 7:26	0	0.032	0.04	No	0.000	No
3/28/2023 7:27	0.2812	0.035	0.0391	No	0.019	No
3/28/2023 7:28	0.4292	0.033	0.0378	No	0.047	No
3/28/2023 7:29	0.4878	0.035	0.0369	No	0.080	No
3/28/2023 7:30	0.5364	0.031	0.0359	No	0.116	No
3/28/2023 7:31	0.5619	0.037	0.0353	No	0.153	No
3/28/2023 7:32	0.6043	0.036	0.0346	No	0.193	No
3/28/2023 7:33	0.7329	0.044	0.0349	No	0.242	No
3/28/2023 7:34	1.1522	0.066	0.0366	No	0.319	No
3/28/2023 7:35	1.3481	0.033	0.0363	No	0.409	No
3/28/2023 7:36	1.4211	0.035	0.0364	No	0.504	No
3/28/2023 7:37	1.6793	0.042	0.0371	No	0.616	No
3/28/2023 7:38	2.1383	0.038	0.0373	No	0.758	No
3/28/2023 7:39	2.1818	0.03	0.0372	No	0.904	No
3/28/2023 7:40	2.2438	0.03	0.0371	No	1.053	No
3/28/2023 7:41	2.2729	0.03	0.037	No	1.205	No
3/28/2023 7:42	2.0745	0.031	0.0367	No	1.324	No
3/28/2023 7:43	2.0006	0.031	0.0366	No	1.429	No
3/28/2023 7:44	2.0429	0.03	0.0363	No	1.533	No
3/28/2023 7:45	2.0396	0.027	0.036	No	1.633	No
3/28/2023 7:46	2.0558	0.027	0.0353	No	1.733	No
3/28/2023 7:47	2.0955	0.03	0.0349	No	1.832	No
3/28/2023 7:48	1.987	0.044	0.0349	No	1.916	No
3/28/2023 7:49	1.5976	0.04	0.0332	No	1.945	No
3/28/2023 7:50	1.4428	0.029	0.0329	No	1.952	No
3/28/2023 7:51	1.3841	0.026	0.0323	No	1.949	No
3/28/2023 7:52	1.2462	0.026	0.0313	No	1.920	No
3/28/2023 7:53	0.8091	0.025	0.0304	No	1.832	No
3/28/2023 7:54	0.8789	0.027	0.0302	No	1.745	No
3/28/2023 7:55	0.8887	0.029	0.0301	No	1.654	No
3/28/2023 7:56	0.8927	0.028	0.03	No	1.562	No
3/28/2023 7:57	0.8527	0.024	0.0295	No	1.481	No
3/28/2023 7:58	0.8189	0.024	0.0291	No	1.402	No
3/28/2023 7:59	0.7673	0.04	0.0297	No	1.317	No
3/28/2023 8:00	0.7383	0.037	0.0304	No	1.230	No
3/28/2023 8:01	0.7119	0.062	0.0327	No	1.141	No

Downwind Station						
Time	Instaneous VOC (ppm)	Instaneous Mass Conc. Total (mg/m ³)	Mass Conc. Total mg/m ³ AVG 15m (mg/m ³)	Dust Exceedance	VOC ppm AVG 15m (ppm)	VOC Exceedance
3/28/2023 8:02	0.6467	0.088	0.0366	No	1.044	No
3/28/2023 8:03	0.6366	0.044	0.0366	No	0.954	No
3/28/2023 8:04	0.6236	0.028	0.0358	No	0.889	No
3/28/2023 8:05	0.5957	0.029	0.0358	No	0.833	No
3/28/2023 8:06	0.5983	0.031	0.0361	No	0.780	No
3/28/2023 8:07	0.4942	0.094	0.0407	No	0.730	No
3/28/2023 8:08	0.4797	0.128	0.0475	No	0.708	No
3/28/2023 8:09	0.3743	0.032	0.0479	No	0.675	No
3/28/2023 8:10	0.311	0.028	0.0478	No	0.636	No
3/28/2023 8:11	0.3007	0.023	0.0475	No	0.597	No
3/28/2023 8:12	0.2858	0.023	0.0474	No	0.559	No
3/28/2023 8:13	0.2568	0.02	0.0471	No	0.521	No
3/28/2023 8:14	0.2507	0.024	0.0461	No	0.487	No
3/28/2023 8:15	0.2549	0.026	0.0453	No	0.455	No
3/28/2023 8:16	0.2544	0.028	0.0431	No	0.424	No
3/28/2023 8:17	0.2455	0.053	0.0407	No	0.397	No
3/28/2023 8:18	0.2828	0.032	0.0399	No	0.374	No
3/28/2023 8:19	0.2949	0.029	0.04	No	0.352	No
3/28/2023 8:20	0.2943	0.024	0.0397	No	0.332	No
3/28/2023 8:21	0.2834	0.02	0.0389	No	0.311	No
3/28/2023 8:22	0.3038	0.027	0.0345	No	0.298	No
3/28/2023 8:23	0.3181	0.052	0.0294	No	0.287	No
3/28/2023 8:24	0.3292	0.055	0.0309	No	0.284	No
3/28/2023 8:25	0.3614	0.108	0.0363	No	0.288	No
3/28/2023 8:26	0.3845	0.056	0.0385	No	0.293	No
3/28/2023 8:27	0.4021	0.06	0.0409	No	0.301	No
3/28/2023 8:28	0.4065	0.119	0.0475	No	0.311	No
3/28/2023 8:29	0.3725	0.026	0.0477	No	0.319	No
3/28/2023 8:30	0.3992	0.029	0.0479	No	0.329	No
3/28/2023 8:31	0.407	0.031	0.0481	No	0.339	No
3/28/2023 8:32	0.4124	0.037	0.047	No	0.350	No
3/28/2023 8:33	0.3817	0.029	0.0468	No	0.357	No
3/28/2023 8:34	0.3588	0.026	0.0466	No	0.361	No
3/28/2023 8:35	0.3542	0.029	0.0469	No	0.365	No
3/28/2023 8:36	0.3556	0.028	0.0475	No	0.370	No
3/28/2023 8:37	0.3461	0.028	0.0475	No	0.373	No
3/28/2023 8:38	0.3434	0.037	0.0465	No	0.374	No
3/28/2023 8:39	0.3359	0.03	0.0449	No	0.375	No
3/28/2023 8:40	0.3066	0.025	0.0393	No	0.371	No
3/28/2023 8:41	0.2699	0.023	0.0371	No	0.363	No
3/28/2023 8:42	0.3155	0.024	0.0347	No	0.358	No
3/28/2023 8:43	0.4279	0.024	0.0284	No	0.359	No
3/28/2023 8:44	0.4586	0.023	0.0282	No	0.365	No
3/28/2023 8:45	0.4873	0.023	0.0278	No	0.371	No
3/28/2023 8:46	0.6414	0.022	0.0272	No	0.386	No
3/28/2023 8:47	0.686	0.022	0.0262	No	0.405	No
3/28/2023 8:48	0.9443	0.023	0.0258	No	0.442	No
3/28/2023 8:49	0.995	0.023	0.0256	No	0.485	No
3/28/2023 8:50	1.0165	0.021	0.0251	No	0.529	No
3/28/2023 8:51	1.0214	0.018	0.0244	No	0.573	No
3/28/2023 8:52	1.0083	0.018	0.0237	No	0.617	No
3/28/2023 8:53	1.0203	0.019	0.0225	No	0.662	No
3/28/2023 8:54	1.0884	0.018	0.0217	No	0.712	No
3/28/2023 8:55	1.2145	0.017	0.0212	No	0.773	No
3/28/2023 8:56	1.3979	0.019	0.0209	No	0.848	No

Downwind Station						
Time	Instantaneous VOC (ppm)	Instantaneous Mass Conc. Total (mg/m ³)	Mass Conc. Total mg/m ³ AVG 15m (mg/m ³)	Dust Exceedance	VOC ppm AVG 15m (ppm)	VOC Exceedance
3/28/2023 8:57	1.3579	0.022	0.0208	No	0.918	No
3/28/2023 8:58	1.4481	0.016	0.0203	No	0.986	No
3/28/2023 8:59	1.4478	0.016	0.0198	No	1.052	No
3/28/2023 9:00	1.4522	0.019	0.0195	No	1.116	No
3/28/2023 9:01	1.3365	0.017	0.0192	No	1.162	No
3/28/2023 9:02	1.3272	0.015	0.0187	No	1.205	No
3/28/2023 9:03	1.0799	0.016	0.0183	No	1.214	No
3/28/2023 9:04	1.0927	0.014	0.0177	No	1.221	No
3/28/2023 9:05	1.0923	0.014	0.0172	No	1.226	No
3/28/2023 9:06	1.0999	0.015	0.017	No	1.231	No
3/28/2023 9:07	1.104	0.011	0.0165	No	1.237	No
3/28/2023 9:08	1.0839	0.012	0.0161	No	1.242	No
3/28/2023 9:09	1.0547	0.013	0.0157	No	1.239	No
3/28/2023 9:10	0.9327	0.011	0.0153	No	1.221	No
3/28/2023 9:11	0.7573	0.011	0.0148	No	1.178	No
3/28/2023 9:12	0.7211	0.011	0.0141	No	1.135	No
3/28/2023 9:13	0.5128	0.013	0.0139	No	1.073	No
3/28/2023 9:14	0.4895	0.01	0.0135	No	1.009	No
3/28/2023 9:15	0.4737	0.01	0.0129	No	0.944	No
3/28/2023 9:16	1.0863	0.011	0.0125	No	0.927	No
3/28/2023 9:17	1.0701	0.014	0.0124	No	0.910	No
3/28/2023 9:18	1.0613	0.01	0.012	No	0.909	No
3/28/2023 9:19	2.1787	0.013	0.0119	No	0.981	No
3/28/2023 9:20	2.7919	0.014	0.0119	No	1.095	No
3/28/2023 9:21	3.2136	0.027	0.0127	No	1.235	No
3/28/2023 9:22	3.2993	0.009	0.0126	No	1.382	No
3/28/2023 9:23	3.4249	0.011	0.0125	No	1.538	No
3/28/2023 9:24	3.4533	0.01	0.0123	No	1.698	No
3/28/2023 9:25	4.9815	0.038	0.0141	No	1.968	No
3/28/2023 9:26	6.3122	0.083	0.0189	No	2.338	No
3/28/2023 9:27	7.7581	0.015	0.0192	No	2.807	No
3/28/2023 9:28	8.2859	0.011	0.0191	No	3.325	No
3/28/2023 9:29	9.3396	0.009	0.019	No	3.915	No
3/28/2023 9:30	10.329	0.011	0.0191	No	4.572	No
3/28/2023 9:31	9.8411	0.027	0.0201	No	5.156	Yes
3/28/2023 9:32	10.162	0.017	0.0203	No	5.762	Yes
3/28/2023 9:33	10.816	0.032	0.0218	No	6.412	Yes
3/28/2023 9:34	10.128	0.039	0.0235	No	6.942	Yes
3/28/2023 9:35	10.18	0.012	0.0234	No	7.435	Yes
3/28/2023 9:36	10.129	0.011	0.0223	No	7.896	Yes
3/28/2023 9:37	10.354	0.011	0.0225	No	8.366	Yes
3/28/2023 9:38	20.79	0.013	0.0226	No	9.524	Yes
3/28/2023 9:39	22.478	0.014	0.0229	No	10.792	Yes
3/28/2023 9:40	21.38	0.013	0.0212	No	11.886	Yes
3/28/2023 9:41	20.777	0.015	0.0167	No	12.850	Yes
3/28/2023 9:42	19.649	0.017	0.0168	No	13.643	Yes
3/28/2023 9:43	19.581	0.02	0.0174	No	14.396	Yes
3/28/2023 9:44	18.741	0.018	0.018	No	15.022	Yes
3/28/2023 9:45	18.153	0.022	0.0187	No	15.544	Yes
3/28/2023 9:46	18.485	0.034	0.0192	No	16.120	Yes
3/28/2023 9:47	18.552	0.019	0.0193	No	16.680	Yes
3/28/2023 9:48	18.189	0.047	0.0203	No	17.171	Yes
3/28/2023 9:49	17.993	0.315	0.0387	No	17.695	Yes
3/28/2023 9:50	17.471	1.629	0.1465	No	18.181	Yes
3/28/2023 9:51	17.406	0.158	0.1563	Yes	18.667	Yes

Downwind Station

Time	Instantaneous VOC (ppm)	Instantaneous Mass Conc. Total (mg/m ³)	Mass Conc. Total mg/m ³ AVG 15m (mg/m ³)	Dust Exceedance	VOC ppm AVG 15m (ppm)	VOC Exceedance
3/28/2023 9:52	17.254	0.148	0.1655	Yes	19.127	Yes
3/28/2023 9:53	7.3623	0.084	0.1702	Yes	18.231	Yes
3/28/2023 9:54	5.9411	0.244	0.1855	Yes	17.129	Yes
3/28/2023 9:55	5.7137	0.029	0.1866	Yes	16.085	Yes
3/28/2023 9:56	5.2189	0.018	0.1868	Yes	15.047	Yes
3/28/2023 9:57	5.0423	0.035	0.188	Yes	14.074	Yes
3/28/2023 9:58	4.7855	0.075	0.1917	Yes	13.087	Yes