



Daily Activity Report

Seton Brilla Charter School
1956 Jerome Avenue, Bronx, NY
BCP No. C203152

General Site Information

| | |
|-------------------------|--|
| Date: | Monday, March 27, 2023 |
| Weather: | Mostly Clear, 39-58°F |
| Wind Direction/Speed: | NE @ 4 mph |
| AKRF Personnel on Site: | Lucas Belangia |
| AKRF Equipment on Site: | Mini RAE 3000 Photoionization Detector [(PID) x1], 2 Fixed Air Monitoring Stations [DustTrak |
| Visitors: | None. |

Contractor Information

| Contracting Company | Main Personnel | Equipment |
|---------------------|----------------|-----------|
| Casino Construction | Carlos | Excavator |

Description and Location of Work Activities Performed

1) Pile cap and grade beam construction activities continued.

| Destination Facility | Daily Trucks | Total Trucks | Daily Approx. Cubic Yds | Total Approx. Cubic Yds | Total Site Loads | Total Approximate Cubic Yards |
|---------------------------------------|--------------|--------------|-------------------------|-------------------------|------------------|-------------------------------|
| Clean Earth Carteret | 0 | 89 | 0 | 1,780 | 182 | 3,640 |
| Clean Earth Southeastern Pennsylvania | 0 | 67 | 0 | 1,340 | | |
| Concrete Disposal | 0 | 26 | 0 | 520 | | |
| N/A | 0 | 0 | 0 | 0 | | |
| N/A | 0 | 0 | 0 | 0 | | |

CAMP Air Monitoring Results

| CAMP Station | UPWIND | | | | DOWNWIND | | |
|--|--------|--|--|--|----------|--|--|
| Odors: | None. | | | | None. | | |
| VOC Action Level Exceedance(s): | None. | | | | None. | | |
| Particulate Action Level Exceedance(s): | None. | | | | 1 | | |
| Maximum VOC Level (15 min ppm): | 0.395 | | | | 0.196 | | |
| Maximum Particulate Level (15 min mg/m ³): | 0.042 | | | | 0.066 | | |

Notes: CAMP monitoring was performed throughout the day starting at approx. Due to a connection issue, the Upwind CAMP was not recording dust levels. This issue was resolved at approximately 09:40. No VOC or particulate exceedances were recorded.

Additional Information

| | |
|---|---|
| Planned Work Activity for Following Day/Week: | 1) Excavation of soil/fill to uncover piles. 2) Cutting piles to final elevations 3) Exporting of soil off-site |
| Comments: | None. |

Site Map

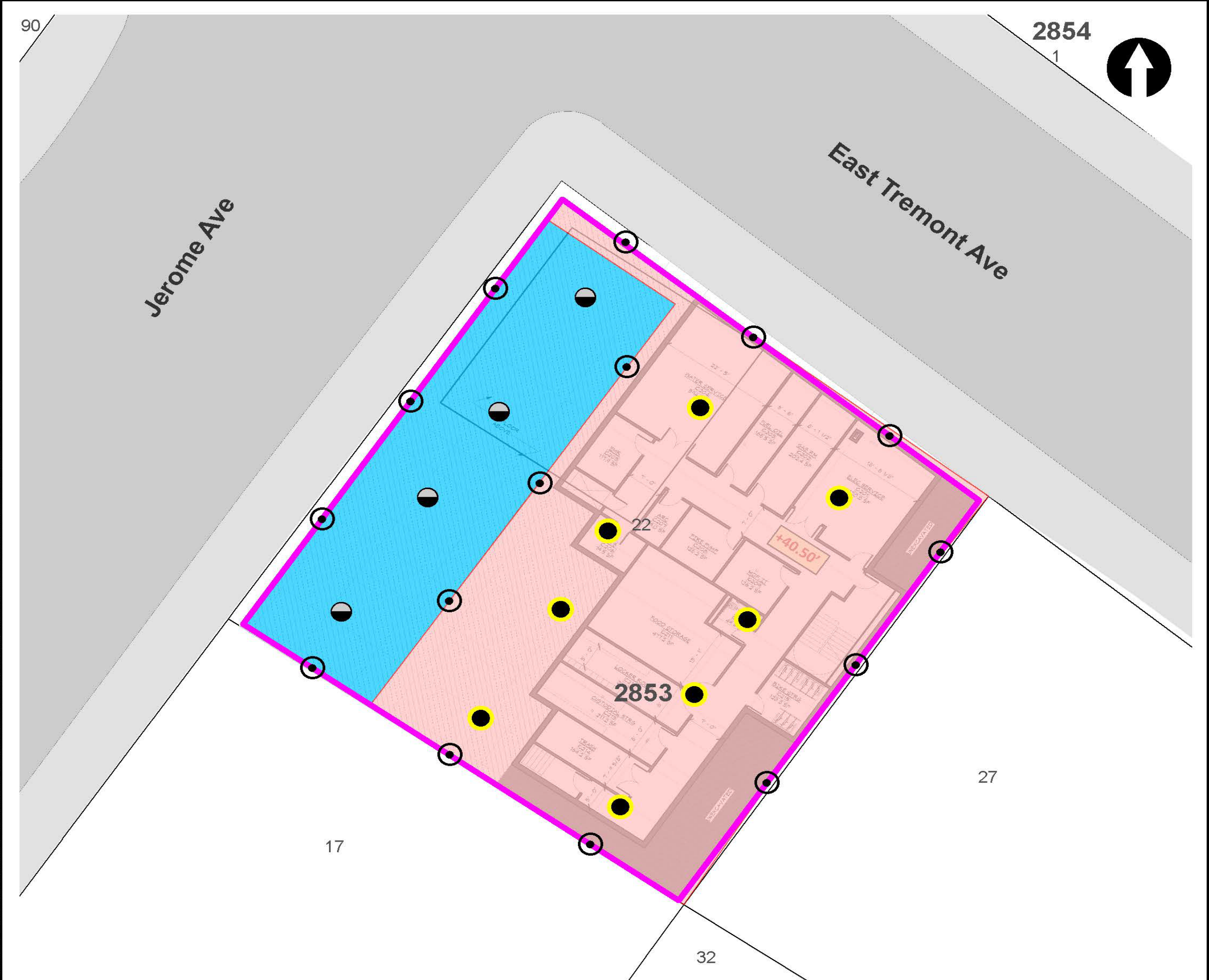

LEGEND

- PROJECT SITE BOUNDARY
- LOT BOUNDARY AND TAX LOT NUMBER
- 2853** BLOCK NUMBER
- REMEDIAL EXCAVATION TO APPROXIMATELY TWO FEET BELOW EXISTING GRADE
- REMEDIAL EXCAVATION TO GROUNDWATER (SOURCE AREA)

- CONFIRMATION DOCUMENTATION BOTTOM SAMPLE
- SOURCE AREA DOCUMENTATION BOTTOM SAMPLE
- DOCUMENTATION SIDEWALL SAMPLE

NOTE
 REMEDIAL EXCAVATION WILL INCLUDE REMOVAL OF APPROXIMATELY 1,280 TONS (850 CUBIC YARDS) OF SOURCE MATERIAL ASSOCIATED WITH NYSDEC SPILL NO. 2103719 AND APPROXIMATELY 860 TONS (570 CUBIC YARDS) OF SOIL/FILL FROM THE UPPER 2 FEET SITE-WIDE.



Map Source:
 NYCDP (NYC Dept. of City Planning) GIS database

© 2021 AKRF. W:\Projects\210024 - 1956 JEROME AVENUE\Technical\GIS and Graphics\AR\RAW\210024 Figure 9 Proposed Remedial Excavation and Documentation Sample Location Plan.mxd 10/25/2021 2:03:38 PM iszalus



440 Park Avenue South, New York, NY 10016

1956 Jerome Avenue
 Bronx, New York

**TRACK 4 CLEANUP AND DOCUMENTATION
 SAMPLE LOCATION PLAN**

DATE
04/29/2022

PROJECT NO.
210024

FIGURE
11

Site Photographs

Photograph 1 -
Removal of mini
excavator off site.



Photograph 2-
Casino installing
formwork into pile
excavation areas.



Photograph 3-
Grading soil and
prepping for
concrete disposal.



Upwind Station

| Time | Instaneous VOC (ppm) | Instaneous Mass Conc. Total (mg/m ³) | Mass Conc. Total mg/m ³ AVG 15m (mg/m ³) | Dust Exceedance | VOC ppm AVG 15m (ppm) | VOC Exceedance |
|----------------|----------------------|--|---|-----------------|-----------------------|----------------|
| 3/27/2023 7:12 | 0 | | | No | 0 | No |
| 3/27/2023 7:13 | 0 | | | No | 0 | No |
| 3/27/2023 7:14 | 0 | | | No | 0 | No |
| 3/27/2023 7:15 | 0 | | | No | 0 | No |
| 3/27/2023 7:16 | 0 | | | No | 0 | No |
| 3/27/2023 7:17 | 0 | | | No | 0 | No |
| 3/27/2023 7:18 | 0 | | | No | 0 | No |
| 3/27/2023 7:19 | 0 | | | No | 0 | No |
| 3/27/2023 7:20 | 0 | | | No | 0 | No |
| 3/27/2023 7:21 | 0 | | | No | 0 | No |
| 3/27/2023 7:22 | 0 | | | No | 0 | No |
| 3/27/2023 7:23 | 0 | | | No | 0 | No |
| 3/27/2023 7:24 | 0 | | | No | 0 | No |
| 3/27/2023 7:25 | 0 | | | No | 0 | No |
| 3/27/2023 7:26 | 0 | | | No | 0 | No |
| 3/27/2023 7:27 | 0 | | | No | 0 | No |
| 3/27/2023 7:28 | 0 | | | No | 0 | No |
| 3/27/2023 7:29 | 0 | | | No | 0 | No |
| 3/27/2023 7:30 | 0 | | | No | 0 | No |
| 3/27/2023 7:31 | 0 | | | No | 0 | No |
| 3/27/2023 7:32 | 0 | | | No | 0 | No |
| 3/27/2023 7:33 | 0 | | | No | 0 | No |
| 3/27/2023 7:34 | 0 | | | No | 0 | No |
| 3/27/2023 7:35 | 0 | | | No | 0 | No |
| 3/27/2023 7:36 | 0 | | | No | 0 | No |
| 3/27/2023 7:37 | 0 | | | No | 0 | No |
| 3/27/2023 7:38 | 0 | | | No | 0 | No |
| 3/27/2023 7:39 | 0 | | | No | 0 | No |
| 3/27/2023 7:40 | 0 | | | No | 0 | No |
| 3/27/2023 7:41 | 0 | | | No | 0 | No |
| 3/27/2023 7:42 | 0 | | | No | 0 | No |
| 3/27/2023 7:43 | 0 | | | No | 0 | No |
| 3/27/2023 7:44 | 0 | | | No | 0 | No |
| 3/27/2023 7:45 | 0 | | | No | 0 | No |
| 3/27/2023 7:46 | 0 | | | No | 0 | No |
| 3/27/2023 7:47 | 0 | | | No | 0 | No |
| 3/27/2023 7:48 | 0 | | | No | 0 | No |
| 3/27/2023 7:49 | 0 | | | No | 0 | No |
| 3/27/2023 7:50 | 0 | | | No | 0 | No |
| 3/27/2023 7:51 | 0 | | | No | 0 | No |
| 3/27/2023 7:52 | 0 | | | No | 0 | No |
| 3/27/2023 7:53 | 0 | | | No | 0 | No |
| 3/27/2023 7:54 | 0 | | | No | 0 | No |
| 3/27/2023 7:55 | 0 | | | No | 0 | No |
| 3/27/2023 7:56 | 0 | | | No | 0 | No |
| 3/27/2023 7:57 | 0 | | | No | 0 | No |
| 3/27/2023 7:58 | 0 | | | No | 0 | No |
| 3/27/2023 7:59 | 0 | | | No | 0 | No |
| 3/27/2023 8:00 | 0 | | | No | 0 | No |
| 3/27/2023 8:01 | 0 | | | No | 0 | No |
| 3/27/2023 8:02 | 0 | | | No | 0 | No |
| 3/27/2023 8:03 | 0 | | | No | 0 | No |

Upwind Station

| Time | Instantaneous VOC (ppm) | Instantaneous Mass Conc. Total (mg/m ³) | Mass Conc. Total mg/m ³ AVG 15m (mg/m ³) | Dust Exceedance | VOC ppm AVG 15m (ppm) | VOC Exceedance |
|----------------|-------------------------|---|---|-----------------|-----------------------|----------------|
| 3/27/2023 8:04 | 0 | | | No | 0 | No |
| 3/27/2023 8:05 | 0 | | | No | 0 | No |
| 3/27/2023 8:06 | 0 | | | No | 0 | No |
| 3/27/2023 8:07 | 0 | | | No | 0 | No |
| 3/27/2023 8:08 | 0 | | | No | 0 | No |
| 3/27/2023 8:09 | 0 | | | No | 0 | No |
| 3/27/2023 8:10 | 0 | | | No | 0 | No |
| 3/27/2023 8:11 | 0 | | | No | 0 | No |
| 3/27/2023 8:12 | 0 | | | No | 0 | No |
| 3/27/2023 8:13 | 0 | | | No | 0 | No |
| 3/27/2023 8:14 | 0 | | | No | 0 | No |
| 3/27/2023 8:15 | 0 | | | No | 0 | No |
| 3/27/2023 8:16 | 0 | | | No | 0 | No |
| 3/27/2023 8:17 | 0 | | | No | 0 | No |
| 3/27/2023 8:18 | 0 | | | No | 0 | No |
| 3/27/2023 8:19 | 0 | | | No | 0 | No |
| 3/27/2023 8:20 | 0 | | | No | 0 | No |
| 3/27/2023 8:21 | 0 | | | No | 0 | No |
| 3/27/2023 8:22 | 0 | | | No | 0 | No |
| 3/27/2023 8:23 | 0 | | | No | 0 | No |
| 3/27/2023 8:24 | 0 | | | No | 0 | No |
| 3/27/2023 8:25 | 0 | | | No | 0 | No |
| 3/27/2023 8:26 | 0 | | | No | 0 | No |
| 3/27/2023 8:27 | 0 | | | No | 0 | No |
| 3/27/2023 8:28 | 0 | | | No | 0 | No |
| 3/27/2023 8:29 | 0 | | | No | 0 | No |
| 3/27/2023 8:30 | 0 | | | No | 0 | No |
| 3/27/2023 8:31 | 0 | | | No | 0 | No |
| 3/27/2023 8:32 | 0 | | | No | 0 | No |
| 3/27/2023 8:33 | 0 | | | No | 0 | No |
| 3/27/2023 8:34 | 0 | | | No | 0 | No |
| 3/27/2023 8:35 | 0.012 | | | No | 0.0008 | No |
| 3/27/2023 8:36 | 0.011 | | | No | 0.0015 | No |
| 3/27/2023 8:37 | 0.038 | | | No | 0.0041 | No |
| 3/27/2023 8:38 | 0.019 | | | No | 0.0053 | No |
| 3/27/2023 8:39 | 0.038 | | | No | 0.0079 | No |
| 3/27/2023 8:40 | 0.031 | | | No | 0.0099 | No |
| 3/27/2023 8:41 | 0.013 | | | No | 0.0108 | No |
| 3/27/2023 8:42 | 0.015 | | | No | 0.0118 | No |
| 3/27/2023 8:43 | 0.029 | | | No | 0.0137 | No |
| 3/27/2023 8:44 | 0.039 | | | No | 0.0163 | No |
| 3/27/2023 8:45 | 0.02 | | | No | 0.0177 | No |
| 3/27/2023 8:46 | 0.022 | | | No | 0.0191 | No |
| 3/27/2023 8:47 | 0.021 | | | No | 0.0205 | No |
| 3/27/2023 8:48 | 0.052 | | | No | 0.024 | No |
| 3/27/2023 8:49 | 0.05 | | | No | 0.0273 | No |
| 3/27/2023 8:50 | 0.038 | | | No | 0.0291 | No |
| 3/27/2023 8:51 | 0.038 | | | No | 0.0309 | No |
| 3/27/2023 8:52 | 0.038 | | | No | 0.0309 | No |
| 3/27/2023 8:53 | 0.05 | | | No | 0.0329 | No |
| 3/27/2023 8:54 | 0.045 | | | No | 0.0334 | No |
| 3/27/2023 8:55 | 0.049 | | | No | 0.0346 | No |

| Upwind Station | | | | | | |
|----------------|-------------------------|---|---|-----------------|-----------------------|----------------|
| Time | Instantaneous VOC (ppm) | Instantaneous Mass Conc. Total (mg/m ³) | Mass Conc. Total mg/m ³ AVG 15m (mg/m ³) | Dust Exceedance | VOC ppm AVG 15m (ppm) | VOC Exceedance |
| 3/27/2023 8:56 | 0.047 | | | No | 0.0369 | No |
| 3/27/2023 8:57 | 0.057 | | | No | 0.0397 | No |
| 3/27/2023 8:58 | 0.057 | | | No | 0.0415 | No |
| 3/27/2023 8:59 | 0.062 | | | No | 0.0431 | No |
| 3/27/2023 9:00 | 0.059 | | | No | 0.0457 | No |
| 3/27/2023 9:01 | 0.063 | | | No | 0.0484 | No |
| 3/27/2023 9:02 | 0.075 | | | No | 0.052 | No |
| 3/27/2023 9:03 | 0.069 | | | No | 0.0531 | No |
| 3/27/2023 9:04 | 0.069 | | | No | 0.0544 | No |
| 3/27/2023 9:05 | 0.073 | | | No | 0.0567 | No |
| 3/27/2023 9:06 | 0.075 | | | No | 0.0592 | No |
| 3/27/2023 9:07 | 0.072 | | | No | 0.0615 | No |
| 3/27/2023 9:08 | 0.079 | | | No | 0.0634 | No |
| 3/27/2023 9:09 | 0.087 | | | No | 0.0662 | No |
| 3/27/2023 9:10 | 0.083 | | | No | 0.0685 | No |
| 3/27/2023 9:11 | 0.092 | | | No | 0.0715 | No |
| 3/27/2023 9:12 | 0.09 | | | No | 0.0737 | No |
| 3/27/2023 9:13 | 0.094 | | | No | 0.0761 | No |
| 3/27/2023 9:14 | 0.104 | | | No | 0.0789 | No |
| 3/27/2023 9:15 | 1.532 | | | No | 0.1771 | No |
| 3/27/2023 9:16 | 0.2 | | | No | 0.1863 | No |
| 3/27/2023 9:17 | 0.134 | | | No | 0.1902 | No |
| 3/27/2023 9:18 | 0.119 | | | No | 0.1935 | No |
| 3/27/2023 9:19 | 0.16 | | | No | 0.1996 | No |
| 3/27/2023 9:20 | 0.165 | | | No | 0.2057 | No |
| 3/27/2023 9:21 | 0.094 | | | No | 0.207 | No |
| 3/27/2023 9:22 | 0.089 | | | No | 0.2081 | No |
| 3/27/2023 9:23 | 0.088 | | | No | 0.2087 | No |
| 3/27/2023 9:24 | 0.09 | | | No | 0.2089 | No |
| 3/27/2023 9:25 | 0.11 | | | No | 0.2107 | No |
| 3/27/2023 9:26 | 0.122 | | | No | 0.2127 | No |
| 3/27/2023 9:27 | 0.085 | | | No | 0.2124 | No |
| 3/27/2023 9:28 | 0.092 | | | No | 0.2123 | No |
| 3/27/2023 9:29 | 0.111 | | | No | 0.2127 | No |
| 3/27/2023 9:30 | 0.108 | | | No | 0.1178 | No |
| 3/27/2023 9:31 | 0.107 | | | No | 0.1116 | No |
| 3/27/2023 9:32 | 0.109 | | | No | 0.1099 | No |
| 3/27/2023 9:33 | 0.115 | | | No | 0.1097 | No |
| 3/27/2023 9:34 | 0.113 | | | No | 0.1065 | No |
| 3/27/2023 9:35 | 0.11 | | | No | 0.1029 | No |
| 3/27/2023 9:36 | 0.12 | | | No | 0.1046 | No |
| 3/27/2023 9:37 | 0.124 | | | No | 0.1069 | No |
| 3/27/2023 9:38 | 0.126 | | | No | 0.1095 | No |
| 3/27/2023 9:39 | 0.128 | | | No | 0.112 | No |
| 3/27/2023 9:40 | 0.139 | | | No | 0.1139 | No |
| 3/27/2023 9:41 | 0.131 | 0.023 | 0.023 | No | 0.1145 | No |
| 3/27/2023 9:42 | 0.136 | 0.017 | 0.02 | No | 0.1179 | No |
| 3/27/2023 9:43 | 0.15 | 0.014 | 0.018 | No | 0.1218 | No |
| 3/27/2023 9:44 | 0.131 | 0.023 | 0.0193 | No | 0.1231 | No |
| 3/27/2023 9:45 | 0.128 | 0.021 | 0.0196 | No | 0.1245 | No |
| 3/27/2023 9:46 | 0.148 | 0.028 | 0.021 | No | 0.1272 | No |
| 3/27/2023 9:47 | 0.118 | 0.033 | 0.0227 | No | 0.1278 | No |

| Upwind Station | | | | | | |
|-----------------|----------------------|--|---|-----------------|-----------------------|----------------|
| Time | Instaneous VOC (ppm) | Instaneous Mass Conc. Total (mg/m ³) | Mass Conc. Total mg/m ³ AVG 15m (mg/m ³) | Dust Exceedance | VOC ppm AVG 15m (ppm) | VOC Exceedance |
| 3/27/2023 9:48 | 0.13 | 0.031 | 0.0238 | No | 0.1288 | No |
| 3/27/2023 9:49 | 0.138 | 0.033 | 0.0248 | No | 0.1305 | No |
| 3/27/2023 9:50 | 0.139 | 0.012 | 0.0235 | No | 0.1324 | No |
| 3/27/2023 9:51 | 0.142 | 0.012 | 0.0225 | No | 0.1339 | No |
| 3/27/2023 9:52 | 0.16 | 0.02 | 0.0223 | No | 0.1363 | No |
| 3/27/2023 9:53 | 0.131 | 0.022 | 0.0222 | No | 0.1366 | No |
| 3/27/2023 9:54 | 0.147 | 0.011 | 0.0214 | No | 0.1379 | No |
| 3/27/2023 9:55 | 0.15 | 0.011 | 0.0207 | No | 0.1386 | No |
| 3/27/2023 9:56 | 0.14 | 0.01 | 0.0199 | No | 0.1392 | No |
| 3/27/2023 9:57 | 0.144 | 0.015 | 0.0197 | No | 0.1397 | No |
| 3/27/2023 9:58 | 0.136 | 0.013 | 0.0197 | No | 0.1388 | No |
| 3/27/2023 9:59 | 0.132 | 0.011 | 0.0189 | No | 0.1389 | No |
| 3/27/2023 10:00 | 0.135 | 0.017 | 0.0186 | No | 0.1393 | No |
| 3/27/2023 10:01 | 0.143 | 0.031 | 0.0188 | No | 0.139 | No |
| 3/27/2023 10:02 | 0.148 | 0.016 | 0.0177 | No | 0.141 | No |
| 3/27/2023 10:03 | 0.138 | 0.013 | 0.0165 | No | 0.1415 | No |
| 3/27/2023 10:04 | 0.145 | 0.022 | 0.0157 | No | 0.142 | No |
| 3/27/2023 10:05 | 0.165 | 0.029 | 0.0169 | No | 0.1437 | No |
| 3/27/2023 10:06 | 0.126 | 0.02 | 0.0174 | No | 0.1427 | No |
| 3/27/2023 10:07 | 0.192 | 0.021 | 0.0175 | No | 0.1448 | No |
| 3/27/2023 10:08 | 0.141 | 0.03 | 0.018 | No | 0.1455 | No |
| 3/27/2023 10:09 | 0.153 | 0.016 | 0.0183 | No | 0.1459 | No |
| 3/27/2023 10:10 | 0.151 | 0.012 | 0.0184 | No | 0.1459 | No |
| 3/27/2023 10:11 | 0.153 | 0.014 | 0.0187 | No | 0.1468 | No |
| 3/27/2023 10:12 | 0.16 | 0.016 | 0.0187 | No | 0.1479 | No |
| 3/27/2023 10:13 | 0.152 | 0.019 | 0.0191 | No | 0.1489 | No |
| 3/27/2023 10:14 | 0.139 | 0.015 | 0.0194 | No | 0.1494 | No |
| 3/27/2023 10:15 | 0.154 | 0.016 | 0.0193 | No | 0.1507 | No |
| 3/27/2023 10:16 | 0.138 | 0.018 | 0.0185 | No | 0.1503 | No |
| 3/27/2023 10:17 | 0.139 | 0.01 | 0.0181 | No | 0.1497 | No |
| 3/27/2023 10:18 | 0.18 | 0.012 | 0.018 | No | 0.1525 | No |
| 3/27/2023 10:19 | 0.149 | 0.016 | 0.0176 | No | 0.1528 | No |
| 3/27/2023 10:20 | 0.151 | 0.012 | 0.0165 | No | 0.1519 | No |
| 3/27/2023 10:21 | 0.152 | 0.01 | 0.0158 | No | 0.1536 | No |
| 3/27/2023 10:22 | 0.163 | 0.012 | 0.0152 | No | 0.1517 | No |
| 3/27/2023 10:23 | 0.171 | 0.011 | 0.0139 | No | 0.1537 | No |
| 3/27/2023 10:24 | 0.174 | 0.02 | 0.0142 | No | 0.1551 | No |
| 3/27/2023 10:25 | 0.16 | 0.018 | 0.0146 | No | 0.1557 | No |
| 3/27/2023 10:26 | 0.17 | 0.013 | 0.0145 | No | 0.1568 | No |
| 3/27/2023 10:27 | 0.164 | 0.02 | 0.0148 | No | 0.1571 | No |
| 3/27/2023 10:28 | 0.196 | 0.017 | 0.0147 | No | 0.16 | No |
| 3/27/2023 10:29 | 0.176 | 0.021 | 0.0151 | No | 0.1625 | No |
| 3/27/2023 10:30 | 0.197 | 0.029 | 0.0159 | No | 0.1653 | No |
| 3/27/2023 10:31 | 0.164 | 0.023 | 0.0163 | No | 0.1671 | No |
| 3/27/2023 10:32 | 0.165 | 0.013 | 0.0165 | No | 0.1688 | No |
| 3/27/2023 10:33 | 0.176 | 0.017 | 0.0168 | No | 0.1685 | No |
| 3/27/2023 10:34 | 0.186 | 0.039 | 0.0183 | No | 0.171 | No |
| 3/27/2023 10:35 | 0.229 | 0.062 | 0.0217 | No | 0.1762 | No |
| 3/27/2023 10:36 | 0.19 | 0.03 | 0.023 | No | 0.1787 | No |
| 3/27/2023 10:37 | 0.178 | 0.015 | 0.0232 | No | 0.1797 | No |
| 3/27/2023 10:38 | 0.167 | 0.018 | 0.0237 | No | 0.1795 | No |
| 3/27/2023 10:39 | 0.192 | 0.011 | 0.0231 | No | 0.1807 | No |

| Upwind Station | | | | | | |
|-----------------|----------------------|--|---|-----------------|-----------------------|----------------|
| Time | Instaneous VOC (ppm) | Instaneous Mass Conc. Total (mg/m ³) | Mass Conc. Total mg/m ³ AVG 15m (mg/m ³) | Dust Exceedance | VOC ppm AVG 15m (ppm) | VOC Exceedance |
| 3/27/2023 10:40 | 0.182 | 0.011 | 0.0226 | No | 0.1821 | No |
| 3/27/2023 10:41 | 0.183 | 0.009 | 0.0223 | No | 0.183 | No |
| 3/27/2023 10:42 | 0.199 | 0.022 | 0.0225 | No | 0.1853 | No |
| 3/27/2023 10:43 | 0.16 | 0.021 | 0.0227 | No | 0.1829 | No |
| 3/27/2023 10:44 | 0.169 | 0.017 | 0.0225 | No | 0.1825 | No |
| 3/27/2023 10:45 | 0.199 | 0.012 | 0.0213 | No | 0.1826 | No |
| 3/27/2023 10:46 | 0.202 | 0.015 | 0.0208 | No | 0.1851 | No |
| 3/27/2023 10:47 | 0.184 | 0.027 | 0.0217 | No | 0.1864 | No |
| 3/27/2023 10:48 | 0.176 | 0.019 | 0.0219 | No | 0.1864 | No |
| 3/27/2023 10:49 | 0.184 | 0.024 | 0.0209 | No | 0.1863 | No |
| 3/27/2023 10:50 | 0.186 | 0.016 | 0.0178 | No | 0.1834 | No |
| 3/27/2023 10:51 | 0.205 | 0.021 | 0.0172 | No | 0.1844 | No |
| 3/27/2023 10:52 | 0.169 | 0.02 | 0.0175 | No | 0.1838 | No |
| 3/27/2023 10:53 | 0.213 | 0.011 | 0.0171 | No | 0.1869 | No |
| 3/27/2023 10:54 | 0.216 | 0.011 | 0.0171 | No | 0.1885 | No |
| 3/27/2023 10:55 | 0.217 | 0.044 | 0.0193 | No | 0.1908 | No |
| 3/27/2023 10:56 | 0.203 | 0.021 | 0.0201 | No | 0.1921 | No |
| 3/27/2023 10:57 | 0.22 | 0.009 | 0.0192 | No | 0.1935 | No |
| 3/27/2023 10:58 | 0.206 | 0.011 | 0.0185 | No | 0.1966 | No |
| 3/27/2023 10:59 | 0.217 | 0.047 | 0.0205 | No | 0.1998 | No |
| 3/27/2023 11:00 | 0.207 | 0.018 | 0.0209 | No | 0.2003 | No |
| 3/27/2023 11:01 | 0.2 | 0.037 | 0.0224 | No | 0.2002 | No |
| 3/27/2023 11:02 | 0.198 | 0.036 | 0.023 | No | 0.2011 | No |
| 3/27/2023 11:03 | 0.216 | 0.015 | 0.0227 | No | 0.2038 | No |
| 3/27/2023 11:04 | 0.197 | 0.031 | 0.0232 | No | 0.2047 | No |
| 3/27/2023 11:05 | 0.242 | 0.056 | 0.0259 | No | 0.2084 | No |
| 3/27/2023 11:06 | 0.208 | 0.132 | 0.0333 | No | 0.2086 | No |
| 3/27/2023 11:07 | 0.208 | 0.13 | 0.0406 | No | 0.2112 | No |
| 3/27/2023 11:08 | 0.196 | 0.03 | 0.0419 | No | 0.2101 | No |
| 3/27/2023 11:09 | 0.199 | 0.017 | 0.0423 | No | 0.2089 | No |
| 3/27/2023 11:10 | 0.194 | 0.016 | 0.0404 | No | 0.2074 | No |
| 3/27/2023 11:11 | 0.218 | 0.008 | 0.0395 | No | 0.2084 | No |
| 3/27/2023 11:12 | 0.225 | 0.014 | 0.0399 | No | 0.2087 | No |
| 3/27/2023 11:13 | 0.231 | 0.01 | 0.0398 | No | 0.2104 | No |
| 3/27/2023 11:14 | 0.238 | 0.012 | 0.0375 | No | 0.2118 | No |
| 3/27/2023 11:15 | 0.225 | 0.008 | 0.0368 | No | 0.213 | No |
| 3/27/2023 11:16 | 0.237 | 0.008 | 0.0349 | No | 0.2155 | No |
| 3/27/2023 11:17 | 0.253 | 0.012 | 0.0333 | No | 0.2191 | No |
| 3/27/2023 11:18 | 0.274 | 0.016 | 0.0333 | No | 0.223 | No |
| 3/27/2023 11:19 | 0.266 | 0.013 | 0.0321 | No | 0.2276 | No |
| 3/27/2023 11:20 | 0.259 | 0.011 | 0.0291 | No | 0.2287 | No |
| 3/27/2023 11:21 | 0.271 | 0.012 | 0.0211 | No | 0.2329 | No |
| 3/27/2023 11:22 | 0.264 | 0.009 | 0.0131 | No | 0.2367 | No |
| 3/27/2023 11:23 | 0.254 | 0.009 | 0.0117 | No | 0.2405 | No |
| 3/27/2023 11:24 | 0.252 | 0.013 | 0.0114 | No | 0.2441 | No |
| 3/27/2023 11:25 | 0.249 | 0.014 | 0.0113 | No | 0.2477 | No |
| 3/27/2023 11:26 | 0.259 | 0.017 | 0.0119 | No | 0.2505 | No |
| 3/27/2023 11:27 | 0.256 | 0.011 | 0.0117 | No | 0.2525 | No |
| 3/27/2023 11:28 | 0.258 | 0.013 | 0.0119 | No | 0.2543 | No |
| 3/27/2023 11:29 | 0.263 | 0.014 | 0.012 | No | 0.256 | No |
| 3/27/2023 11:30 | 0.275 | 0.016 | 0.0125 | No | 0.2593 | No |
| 3/27/2023 11:31 | 0.261 | 0.028 | 0.0139 | No | 0.2609 | No |

| Upwind Station | | | | | | |
|-----------------|----------------------|--|---|-----------------|-----------------------|----------------|
| Time | Instaneous VOC (ppm) | Instaneous Mass Conc. Total (mg/m ³) | Mass Conc. Total mg/m ³ AVG 15m (mg/m ³) | Dust Exceedance | VOC ppm AVG 15m (ppm) | VOC Exceedance |
| 3/27/2023 11:32 | 0.259 | 0.016 | 0.0141 | No | 0.2613 | No |
| 3/27/2023 11:33 | 0.265 | 0.014 | 0.014 | No | 0.2607 | No |
| 3/27/2023 11:34 | 0.274 | 0.012 | 0.0139 | No | 0.2613 | No |
| 3/27/2023 11:35 | 0.274 | 0.017 | 0.0143 | No | 0.2623 | No |
| 3/27/2023 11:36 | 0.263 | 0.022 | 0.015 | No | 0.2617 | No |
| 3/27/2023 11:37 | 0.268 | 0.013 | 0.0153 | No | 0.262 | No |
| 3/27/2023 11:38 | 0.256 | 0.009 | 0.0153 | No | 0.2621 | No |
| 3/27/2023 11:39 | 0.28 | 0.01 | 0.0151 | No | 0.264 | No |
| 3/27/2023 11:40 | 0.273 | 0.012 | 0.0149 | No | 0.2656 | No |
| 3/27/2023 11:41 | 0.279 | 0.013 | 0.0147 | No | 0.2669 | No |
| 3/27/2023 11:42 | 0.275 | 0.012 | 0.0147 | No | 0.2682 | No |
| 3/27/2023 11:43 | 0.262 | 0.023 | 0.0154 | No | 0.2685 | No |
| 3/27/2023 11:44 | 0.266 | 0.012 | 0.0153 | No | 0.2687 | No |
| 3/27/2023 11:45 | 0.265 | 0.007 | 0.0147 | No | 0.268 | No |
| 3/27/2023 11:46 | 0.283 | 0.013 | 0.0137 | No | 0.2695 | No |
| 3/27/2023 11:47 | 0.282 | 0.011 | 0.0133 | No | 0.271 | No |
| 3/27/2023 11:48 | 0.291 | 0.011 | 0.0131 | No | 0.2727 | No |
| 3/27/2023 11:49 | 0.279 | 0.019 | 0.0136 | No | 0.2731 | No |
| 3/27/2023 11:50 | 0.295 | 0.025 | 0.0141 | No | 0.2745 | No |
| 3/27/2023 11:51 | 0.288 | 0.019 | 0.0139 | No | 0.2761 | No |
| 3/27/2023 11:52 | 0.277 | 0.013 | 0.0139 | No | 0.2767 | No |
| 3/27/2023 11:53 | 0.265 | 0.01 | 0.014 | No | 0.2773 | No |
| 3/27/2023 11:54 | 0.277 | 0.01 | 0.014 | No | 0.2771 | No |
| 3/27/2023 11:55 | 0.3 | 0.013 | 0.0141 | No | 0.2789 | No |
| 3/27/2023 11:56 | 0.304 | 0.015 | 0.0142 | No | 0.2806 | No |
| 3/27/2023 11:57 | 0.293 | 0.009 | 0.014 | No | 0.2818 | No |
| 3/27/2023 11:58 | 0.29 | 0.021 | 0.0139 | No | 0.2837 | No |
| 3/27/2023 11:59 | 0.293 | 0.013 | 0.0139 | No | 0.2855 | No |
| 3/27/2023 12:00 | 0.309 | 0.017 | 0.0146 | No | 0.2884 | No |
| 3/27/2023 12:01 | 0.299 | 0.017 | 0.0149 | No | 0.2895 | No |
| 3/27/2023 12:02 | 0.288 | 0.011 | 0.0149 | No | 0.2899 | No |
| 3/27/2023 12:03 | 0.291 | 0.012 | 0.0149 | No | 0.2899 | No |
| 3/27/2023 12:04 | 0.31 | 0.013 | 0.0145 | No | 0.2919 | No |
| 3/27/2023 12:05 | 0.289 | 0.012 | 0.0137 | No | 0.2915 | No |
| 3/27/2023 12:06 | 0.302 | 0.015 | 0.0134 | No | 0.2925 | No |
| 3/27/2023 12:07 | 0.283 | 0.014 | 0.0135 | No | 0.2929 | No |
| 3/27/2023 12:08 | 0.306 | 0.016 | 0.0139 | No | 0.2956 | No |
| 3/27/2023 12:09 | 0.406 | 0.016 | 0.0143 | No | 0.3042 | No |
| 3/27/2023 12:10 | 0.306 | 0.012 | 0.0142 | No | 0.3046 | No |
| 3/27/2023 12:11 | 0.29 | 0.011 | 0.0139 | No | 0.3037 | No |
| 3/27/2023 12:12 | 0.316 | 0.012 | 0.0141 | No | 0.3052 | No |
| 3/27/2023 12:13 | 0.314 | 0.013 | 0.0136 | No | 0.3068 | No |
| 3/27/2023 12:14 | 0.319 | 0.015 | 0.0137 | No | 0.3085 | No |
| 3/27/2023 12:15 | 0.327 | 0.015 | 0.0136 | No | 0.3097 | No |
| 3/27/2023 12:16 | 0.295 | 0.015 | 0.0135 | No | 0.3095 | No |
| 3/27/2023 12:17 | 0.293 | 0.019 | 0.014 | No | 0.3098 | No |
| 3/27/2023 12:18 | 0.294 | 0.013 | 0.0141 | No | 0.31 | No |
| 3/27/2023 12:19 | 0.309 | 0.013 | 0.0141 | No | 0.3099 | No |
| 3/27/2023 12:20 | 0.325 | 0.014 | 0.0142 | No | 0.3123 | No |
| 3/27/2023 12:21 | 0.306 | 0.016 | 0.0143 | No | 0.3126 | No |
| 3/27/2023 12:22 | 0.312 | 0.015 | 0.0143 | No | 0.3145 | No |
| 3/27/2023 12:23 | 0.299 | 0.016 | 0.0143 | No | 0.3141 | No |

| Upwind Station | | | | | | |
|-----------------|----------------------|--|---|-----------------|-----------------------|----------------|
| Time | Instaneous VOC (ppm) | Instaneous Mass Conc. Total (mg/m ³) | Mass Conc. Total mg/m ³ AVG 15m (mg/m ³) | Dust Exceedance | VOC ppm AVG 15m (ppm) | VOC Exceedance |
| 3/27/2023 12:24 | 0.305 | 0.015 | 0.0143 | No | 0.3073 | No |
| 3/27/2023 12:25 | 0.308 | 0.013 | 0.0143 | No | 0.3075 | No |
| 3/27/2023 12:26 | 0.306 | 0.009 | 0.0142 | No | 0.3085 | No |
| 3/27/2023 12:27 | 0.32 | 0.008 | 0.0139 | No | 0.3088 | No |
| 3/27/2023 12:28 | 0.32 | 0.01 | 0.0137 | No | 0.3092 | No |
| 3/27/2023 12:29 | 0.335 | 0.028 | 0.0146 | No | 0.3103 | No |
| 3/27/2023 12:30 | 0.346 | 0.015 | 0.0146 | No | 0.3115 | No |
| 3/27/2023 12:31 | 0.326 | 0.016 | 0.0147 | No | 0.3136 | No |
| 3/27/2023 12:32 | 0.344 | 0.011 | 0.0141 | No | 0.317 | No |
| 3/27/2023 12:33 | 0.332 | 0.01 | 0.0139 | No | 0.3195 | No |
| 3/27/2023 12:34 | 0.349 | 0.011 | 0.0138 | No | 0.3222 | No |
| 3/27/2023 12:35 | 0.335 | 0.009 | 0.0135 | No | 0.3229 | No |
| 3/27/2023 12:36 | 0.362 | 0.01 | 0.0131 | No | 0.3266 | No |
| 3/27/2023 12:37 | 0.355 | 0.01 | 0.0127 | No | 0.3295 | No |
| 3/27/2023 12:38 | 0.355 | 0.009 | 0.0123 | No | 0.3332 | No |
| 3/27/2023 12:39 | 0.357 | 0.009 | 0.0119 | No | 0.3367 | No |
| 3/27/2023 12:40 | 0.349 | 0.008 | 0.0115 | No | 0.3394 | No |
| 3/27/2023 12:41 | 0.351 | 0.009 | 0.0115 | No | 0.3424 | No |
| 3/27/2023 12:42 | 0.36 | 0.013 | 0.0119 | No | 0.3451 | No |
| 3/27/2023 12:43 | 0.352 | 0.011 | 0.0119 | No | 0.3472 | No |
| 3/27/2023 12:44 | 0.358 | 0.016 | 0.0111 | No | 0.3487 | No |
| 3/27/2023 12:45 | 0.351 | 0.014 | 0.0111 | No | 0.3491 | No |
| 3/27/2023 12:46 | 0.359 | 0.013 | 0.0109 | No | 0.3513 | No |
| 3/27/2023 12:47 | 0.354 | 0.009 | 0.0107 | No | 0.3519 | No |
| 3/27/2023 12:48 | 0.374 | 0.009 | 0.0107 | No | 0.3547 | No |
| 3/27/2023 12:49 | 0.372 | 0.009 | 0.0105 | No | 0.3563 | No |
| 3/27/2023 12:50 | 0.362 | 0.009 | 0.0105 | No | 0.3581 | No |
| 3/27/2023 12:51 | 0.366 | 0.009 | 0.0105 | No | 0.3583 | No |
| 3/27/2023 12:52 | 0.377 | 0.009 | 0.0104 | No | 0.3598 | No |
| 3/27/2023 12:53 | 0.379 | 0.008 | 0.0103 | No | 0.3614 | No |
| 3/27/2023 12:54 | 0.384 | 0.008 | 0.0103 | No | 0.3632 | No |
| 3/27/2023 12:55 | 0.373 | 0.039 | 0.0123 | No | 0.3648 | No |
| 3/27/2023 12:56 | 0.383 | 0.019 | 0.013 | No | 0.3669 | No |
| 3/27/2023 12:57 | 0.369 | 0.016 | 0.0132 | No | 0.3675 | No |
| 3/27/2023 12:58 | 0.367 | 0.015 | 0.0135 | No | 0.3685 | No |
| 3/27/2023 12:59 | 0.372 | 0.015 | 0.0134 | No | 0.3695 | No |
| 3/27/2023 13:00 | 0.403 | 0.014 | 0.0134 | No | 0.3729 | No |
| 3/27/2023 13:01 | 0.355 | 0.036 | 0.0149 | No | 0.3727 | No |
| 3/27/2023 13:02 | 0.34 | 0.022 | 0.0158 | No | 0.3717 | No |
| 3/27/2023 13:03 | 0.336 | 0.014 | 0.0161 | No | 0.3692 | No |
| 3/27/2023 13:04 | 0.367 | 0.011 | 0.0163 | No | 0.3689 | No |
| 3/27/2023 13:05 | 0.357 | 0.014 | 0.0166 | No | 0.3685 | No |
| 3/27/2023 13:06 | 0.349 | 0.013 | 0.0169 | No | 0.3674 | No |
| 3/27/2023 13:07 | 0.359 | 0.01 | 0.0169 | No | 0.3662 | No |
| 3/27/2023 13:08 | 0.365 | 0.013 | 0.0173 | No | 0.3653 | No |
| 3/27/2023 13:09 | 0.336 | 0.03 | 0.0187 | No | 0.3621 | No |
| 3/27/2023 13:10 | 0.334 | 0.017 | 0.0173 | No | 0.3595 | No |
| 3/27/2023 13:11 | 0.351 | 0.011 | 0.0167 | No | 0.3573 | No |
| 3/27/2023 13:12 | 0.354 | 0.013 | 0.0165 | No | 0.3563 | No |
| 3/27/2023 13:13 | 0.36 | 0.013 | 0.0164 | No | 0.3559 | No |
| 3/27/2023 13:14 | 0.354 | 0.014 | 0.0163 | No | 0.3547 | No |
| 3/27/2023 13:15 | 0.356 | 0.012 | 0.0162 | No | 0.3515 | No |

| Upwind Station | | | | | | |
|-----------------|----------------------|--|---|-----------------|-----------------------|----------------|
| Time | Instaneous VOC (ppm) | Instaneous Mass Conc. Total (mg/m ³) | Mass Conc. Total mg/m ³ AVG 15m (mg/m ³) | Dust Exceedance | VOC ppm AVG 15m (ppm) | VOC Exceedance |
| 3/27/2023 13:16 | 0.37 | 0.01 | 0.0145 | No | 0.3525 | No |
| 3/27/2023 13:17 | 0.397 | 0.013 | 0.0139 | No | 0.3563 | No |
| 3/27/2023 13:18 | 0.393 | 0.011 | 0.0137 | No | 0.3601 | No |
| 3/27/2023 13:19 | 0.412 | 0.01 | 0.0136 | No | 0.3631 | No |
| 3/27/2023 13:20 | 0.427 | 0.011 | 0.0134 | No | 0.3678 | No |
| 3/27/2023 13:21 | 0.41 | 0.013 | 0.0134 | No | 0.3719 | No |
| 3/27/2023 13:22 | 0.401 | 0.011 | 0.0135 | No | 0.3747 | No |
| 3/27/2023 13:23 | 0.399 | 0.011 | 0.0133 | No | 0.3769 | No |
| 3/27/2023 13:24 | 0.393 | 0.013 | 0.0122 | No | 0.3807 | No |
| 3/27/2023 13:25 | 0.394 | 0.014 | 0.012 | No | 0.3847 | No |
| 3/27/2023 13:26 | 0.394 | 0.014 | 0.0122 | No | 0.3876 | No |
| 3/27/2023 13:27 | 0.392 | 0.017 | 0.0125 | No | 0.3901 | No |
| 3/27/2023 13:28 | 0.375 | 0.016 | 0.0127 | No | 0.3911 | No |
| 3/27/2023 13:29 | 0.365 | 0.016 | 0.0128 | No | 0.3919 | No |
| 3/27/2023 13:30 | 0.374 | 0.009 | 0.0126 | No | 0.3931 | No |
| 3/27/2023 13:31 | 0.392 | 0.014 | 0.0129 | No | 0.3945 | No |
| 3/27/2023 13:32 | 0.391 | 0.017 | 0.0131 | No | 0.3941 | No |
| 3/27/2023 13:33 | 0.396 | 0.013 | 0.0133 | No | 0.3943 | No |
| 3/27/2023 13:34 | 0.388 | 0.011 | 0.0133 | No | 0.3927 | No |
| 3/27/2023 13:35 | 0.389 | 0.012 | 0.0134 | No | 0.3902 | No |
| 3/27/2023 13:36 | 0.402 | 0.012 | 0.0133 | No | 0.3897 | No |
| 3/27/2023 13:37 | 0.391 | 0.014 | 0.0135 | No | 0.389 | No |
| 3/27/2023 13:38 | 0.391 | 0.011 | 0.0135 | No | 0.3885 | No |
| 3/27/2023 13:39 | 0.384 | 0.013 | 0.0135 | No | 0.3879 | No |
| 3/27/2023 13:40 | 0.385 | 0.011 | 0.0133 | No | 0.3873 | No |
| 3/27/2023 13:41 | 0.379 | 0.013 | 0.0133 | No | 0.3863 | No |
| 3/27/2023 13:42 | 0.38 | 0.011 | 0.0129 | No | 0.3855 | No |
| 3/27/2023 13:43 | 0.373 | 0.014 | 0.0127 | No | 0.3853 | No |
| 3/27/2023 13:44 | 0.366 | 0.011 | 0.0124 | No | 0.3854 | No |
| 3/27/2023 13:45 | 0.361 | 0.017 | 0.0129 | No | 0.3845 | No |
| 3/27/2023 13:46 | 0.379 | 0.014 | 0.0129 | No | 0.3837 | No |
| 3/27/2023 13:47 | 0.367 | 0.028 | 0.0137 | No | 0.3821 | No |
| 3/27/2023 13:48 | 0.373 | 0.024 | 0.0144 | No | 0.3805 | No |
| 3/27/2023 13:49 | 0.363 | 0.016 | 0.0147 | No | 0.3789 | No |
| 3/27/2023 13:50 | 0.372 | 0.011 | 0.0147 | No | 0.3777 | No |
| 3/27/2023 13:51 | 0.368 | 0.02 | 0.0152 | No | 0.3755 | No |
| 3/27/2023 13:52 | 0.362 | 0.037 | 0.0167 | No | 0.3735 | No |
| 3/27/2023 13:53 | 0.352 | 0.015 | 0.017 | No | 0.3709 | No |
| 3/27/2023 13:54 | 0.358 | 0.016 | 0.0172 | No | 0.3692 | No |
| 3/27/2023 13:55 | 0.371 | 0.014 | 0.0174 | No | 0.3683 | No |
| 3/27/2023 13:56 | 0.352 | 0.013 | 0.0174 | No | 0.3665 | No |
| 3/27/2023 13:57 | 0.377 | 0.013 | 0.0175 | No | 0.3663 | No |
| 3/27/2023 13:58 | 0.365 | 0.015 | 0.0176 | No | 0.3657 | No |
| 3/27/2023 13:59 | 0.371 | 0.014 | 0.0178 | No | 0.3661 | No |
| 3/27/2023 14:00 | 0.379 | 0.015 | 0.0177 | No | 0.3673 | No |
| 3/27/2023 14:01 | 0.359 | 0.014 | 0.0177 | No | 0.3659 | No |
| 3/27/2023 14:02 | 0.355 | 0.012 | 0.0166 | No | 0.3651 | No |
| 3/27/2023 14:03 | 0.344 | 0.012 | 0.0158 | No | 0.3632 | No |
| 3/27/2023 14:04 | 0.34 | 0.021 | 0.0161 | No | 0.3617 | No |
| 3/27/2023 14:05 | 0.336 | 0.025 | 0.0171 | No | 0.3593 | No |
| 3/27/2023 14:06 | 0.33 | 0.015 | 0.0167 | No | 0.3567 | No |
| 3/27/2023 14:07 | 0.33 | 0.012 | 0.0151 | No | 0.3546 | No |

| Upwind Station | | | | | | |
|-----------------|----------------------|--|---|-----------------|-----------------------|----------------|
| Time | Instaneous VOC (ppm) | Instaneous Mass Conc. Total (mg/m ³) | Mass Conc. Total mg/m ³ AVG 15m (mg/m ³) | Dust Exceedance | VOC ppm AVG 15m (ppm) | VOC Exceedance |
| 3/27/2023 14:08 | 0.326 | 0.011 | 0.0148 | No | 0.3529 | No |
| 3/27/2023 14:09 | 0.32 | 0.01 | 0.0144 | No | 0.3503 | No |
| 3/27/2023 14:10 | 0.324 | 0.014 | 0.0144 | No | 0.3472 | No |
| 3/27/2023 14:11 | 0.312 | 0.014 | 0.0145 | No | 0.3445 | No |
| 3/27/2023 14:12 | 0.324 | 0.014 | 0.0145 | No | 0.341 | No |
| 3/27/2023 14:13 | 0.339 | 0.013 | 0.0144 | No | 0.3393 | No |
| 3/27/2023 14:14 | 0.329 | 0.02 | 0.0148 | No | 0.3365 | No |
| 3/27/2023 14:15 | 0.324 | 0.02 | 0.0151 | No | 0.3328 | No |
| 3/27/2023 14:16 | 0.308 | 0.013 | 0.0151 | No | 0.3294 | No |
| 3/27/2023 14:17 | 0.315 | 0.012 | 0.0151 | No | 0.3267 | No |
| 3/27/2023 14:18 | 0.313 | 0.013 | 0.0151 | No | 0.3247 | No |
| 3/27/2023 14:19 | 0.312 | 0.014 | 0.0147 | No | 0.3228 | No |
| 3/27/2023 14:20 | 0.307 | 0.017 | 0.0141 | No | 0.3209 | No |
| 3/27/2023 14:21 | 0.307 | 0.016 | 0.0142 | No | 0.3193 | No |
| 3/27/2023 14:22 | 0.304 | 0.012 | 0.0142 | No | 0.3176 | No |
| 3/27/2023 14:23 | 0.291 | 0.013 | 0.0143 | No | 0.3153 | No |
| 3/27/2023 14:24 | 0.289 | 0.012 | 0.0145 | No | 0.3132 | No |
| 3/27/2023 14:25 | 0.287 | 0.012 | 0.0143 | No | 0.3107 | No |
| 3/27/2023 14:26 | 0.297 | 0.016 | 0.0145 | No | 0.3097 | No |
| 3/27/2023 14:27 | 0.297 | 0.014 | 0.0145 | No | 0.3079 | No |
| 3/27/2023 14:28 | 0.284 | 0.011 | 0.0143 | No | 0.3043 | No |
| 3/27/2023 14:29 | 0.281 | 0.011 | 0.0137 | No | 0.3011 | No |
| 3/27/2023 14:30 | 0.286 | 0.011 | 0.0131 | No | 0.2985 | No |
| 3/27/2023 14:31 | 0.266 | 0.012 | 0.0131 | No | 0.2957 | No |
| 3/27/2023 14:32 | 0.259 | 0.011 | 0.013 | No | 0.292 | No |
| 3/27/2023 14:33 | 0.27 | 0.011 | 0.0129 | No | 0.2891 | No |
| 3/27/2023 14:34 | 0.278 | 0.047 | 0.0151 | No | 0.2869 | No |
| 3/27/2023 14:35 | 0.28 | 0.033 | 0.0161 | No | 0.2851 | No |
| 3/27/2023 14:36 | 0.269 | 0.049 | 0.0183 | No | 0.2825 | No |
| 3/27/2023 14:37 | 0.268 | 0.013 | 0.0184 | No | 0.2801 | No |
| 3/27/2023 14:38 | 0.27 | 0.019 | 0.0188 | No | 0.2787 | No |
| 3/27/2023 14:39 | 0.273 | 0.047 | 0.0211 | No | 0.2777 | No |
| 3/27/2023 14:40 | 0.266 | 0.014 | 0.0213 | No | 0.2763 | No |
| 3/27/2023 14:41 | 0.267 | 0.071 | 0.0249 | No | 0.2743 | No |
| 3/27/2023 14:42 | 0.268 | 0.045 | 0.027 | No | 0.2723 | No |
| 3/27/2023 14:43 | 0.259 | 0.133 | 0.0351 | No | 0.2707 | No |
| 3/27/2023 14:44 | 0.251 | 0.074 | 0.0393 | No | 0.2687 | No |
| 3/27/2023 14:45 | 0.256 | 0.05 | 0.0419 | No | 0.2667 | No |
| 3/27/2023 14:46 | 0.256 | 0.012 | 0.0419 | No | 0.266 | No |
| 3/27/2023 14:47 | 0.242 | 0.011 | 0.0419 | No | 0.2649 | No |
| 3/27/2023 14:48 | 0.306 | 0.012 | 0.042 | No | 0.2673 | No |

| Downwind Station | | | | | | |
|------------------|-------------------------|---|---|-----------------|-----------------------|----------------|
| Time | Instantaneous VOC (ppm) | Instantaneous Mass Conc. Total (mg/m ³) | Mass Conc. Total mg/m ³ AVG 15m (mg/m ³) | Dust Exceedance | VOC ppm AVG 15m (ppm) | VOC Exceedance |
| 3/27/2023 7:32 | 0.196 | 0.034 | 0.034 | No | 0.196 | No |
| 3/27/2023 7:33 | 0 | 0.098 | 0.066 | No | 0.098 | No |
| 3/27/2023 7:34 | 0 | 0.048 | 0.06 | No | 0.0653 | No |
| 3/27/2023 7:35 | 0.309 | 0.044 | 0.056 | No | 0.1263 | No |
| 3/27/2023 7:36 | 0 | 0.051 | 0.055 | No | 0.101 | No |
| 3/27/2023 7:37 | 0 | 0.039 | 0.0523 | No | 0.0842 | No |
| 3/27/2023 7:38 | 0 | 0.033 | 0.0496 | No | 0.0721 | No |
| 3/27/2023 7:39 | 0 | 0.032 | 0.0474 | No | 0.0631 | No |
| 3/27/2023 7:40 | 0 | 0.031 | 0.0456 | No | 0.0561 | No |
| 3/27/2023 7:41 | 0 | 0.029 | 0.0439 | No | 0.0505 | No |
| 3/27/2023 7:42 | 0 | 0.028 | 0.0425 | No | 0.0459 | No |
| 3/27/2023 7:43 | 0 | 0.029 | 0.0413 | No | 0.0421 | No |
| 3/27/2023 7:44 | 0 | 0.03 | 0.0405 | No | 0.0388 | No |
| 3/27/2023 7:45 | 0 | 0.029 | 0.0396 | No | 0.0361 | No |
| 3/27/2023 7:46 | 0 | 0.028 | 0.0389 | No | 0.0337 | No |
| 3/27/2023 7:47 | 0 | 0.03 | 0.0386 | No | 0.0206 | No |
| 3/27/2023 7:48 | 0 | 0.028 | 0.0339 | No | 0.0206 | No |
| 3/27/2023 7:49 | 0 | 0.028 | 0.0326 | No | 0.0206 | No |
| 3/27/2023 7:50 | 0 | 0.028 | 0.0315 | No | 0 | No |
| 3/27/2023 7:51 | 0 | 0.035 | 0.0305 | No | 0 | No |
| 3/27/2023 7:52 | 0 | 0.029 | 0.0298 | No | 0 | No |
| 3/27/2023 7:53 | 0 | 0.025 | 0.0293 | No | 0 | No |
| 3/27/2023 7:54 | 0 | 0.026 | 0.0289 | No | 0 | No |
| 3/27/2023 7:55 | 0 | 0.026 | 0.0285 | No | 0 | No |
| 3/27/2023 7:56 | 0 | 0.025 | 0.0283 | No | 0 | No |
| 3/27/2023 7:57 | 0 | 0.024 | 0.028 | No | 0 | No |
| 3/27/2023 7:58 | 0 | 0.031 | 0.0281 | No | 0 | No |
| 3/27/2023 7:59 | 0 | 0.03 | 0.0281 | No | 0 | No |
| 3/27/2023 8:00 | 0 | 0.026 | 0.0279 | No | 0 | No |
| 3/27/2023 8:01 | 0 | 0.025 | 0.0277 | No | 0 | No |
| 3/27/2023 8:02 | 0 | 0.027 | 0.0275 | No | 0 | No |
| 3/27/2023 8:03 | 0 | 0.03 | 0.0277 | No | 0 | No |
| 3/27/2023 8:04 | 0 | 0.036 | 0.0282 | No | 0 | No |
| 3/27/2023 8:05 | 0 | 0.036 | 0.0287 | No | 0 | No |
| 3/27/2023 8:06 | 0 | 0.07 | 0.0311 | No | 0 | No |
| 3/27/2023 8:07 | 0 | 0.028 | 0.031 | No | 0 | No |
| 3/27/2023 8:08 | 0 | 0.031 | 0.0314 | No | 0 | No |
| 3/27/2023 8:09 | 0 | 0.029 | 0.0316 | No | 0 | No |
| 3/27/2023 8:10 | 0 | 0.021 | 0.0313 | No | 0 | No |
| 3/27/2023 8:11 | 0 | 0.021 | 0.031 | No | 0 | No |
| 3/27/2023 8:12 | 0 | 0.021 | 0.0308 | No | 0 | No |
| 3/27/2023 8:13 | 0 | 0.017 | 0.0299 | No | 0 | No |
| 3/27/2023 8:14 | 0 | 0.018 | 0.0291 | No | 0 | No |
| 3/27/2023 8:15 | 0 | 0.019 | 0.0286 | No | 0 | No |
| 3/27/2023 8:16 | 0 | 0.021 | 0.0283 | No | 0 | No |
| 3/27/2023 8:17 | 0 | 0.02 | 0.0279 | No | 0 | No |
| 3/27/2023 8:18 | 0 | 0.022 | 0.0273 | No | 0 | No |
| 3/27/2023 8:19 | 0 | 0.02 | 0.0263 | No | 0 | No |
| 3/27/2023 8:20 | 0 | 0.02 | 0.0252 | No | 0 | No |
| 3/27/2023 8:21 | 0 | 0.018 | 0.0217 | No | 0 | No |
| 3/27/2023 8:22 | 0 | 0.016 | 0.0209 | No | 0 | No |
| 3/27/2023 8:23 | 0 | 0.017 | 0.02 | No | 0 | No |
| 3/27/2023 8:24 | 0 | 0.014 | 0.019 | No | 0 | No |
| 3/27/2023 8:25 | 0 | 0.015 | 0.0186 | No | 0 | No |

| Downwind Station | | | | | | |
|------------------|----------------------|--|---|-----------------|-----------------------|----------------|
| Time | Instaneous VOC (ppm) | Instaneous Mass Conc. Total (mg/m ³) | Mass Conc. Total mg/m ³ AVG 15m (mg/m ³) | Dust Exceedance | VOC ppm AVG 15m (ppm) | VOC Exceedance |
| 3/27/2023 8:26 | 0 | 0.014 | 0.0181 | No | 0 | No |
| 3/27/2023 8:27 | 0 | 0.022 | 0.0182 | No | 0 | No |
| 3/27/2023 8:28 | 0 | 0.018 | 0.0183 | No | 0 | No |
| 3/27/2023 8:29 | 0 | 0.012 | 0.0179 | No | 0 | No |
| 3/27/2023 8:30 | 0 | 0.01 | 0.0173 | No | 0 | No |
| 3/27/2023 8:31 | 0 | 0.011 | 0.0166 | No | 0 | No |
| 3/27/2023 8:32 | 0 | 0.012 | 0.0161 | No | 0 | No |
| 3/27/2023 8:33 | 0 | 0.011 | 0.0153 | No | 0 | No |
| 3/27/2023 8:34 | 0 | 0.014 | 0.0149 | No | 0 | No |
| 3/27/2023 8:35 | 0 | 0.013 | 0.0145 | No | 0 | No |
| 3/27/2023 8:36 | 0 | 0.012 | 0.0141 | No | 0 | No |
| 3/27/2023 8:37 | 0 | 0.016 | 0.0141 | No | 0 | No |
| 3/27/2023 8:38 | 0 | 0.034 | 0.0152 | No | 0 | No |
| 3/27/2023 8:39 | 0 | 0.011 | 0.015 | No | 0 | No |
| 3/27/2023 8:40 | 0 | 0.008 | 0.0145 | No | 0 | No |
| 3/27/2023 8:41 | 0 | 0.009 | 0.0142 | No | 0 | No |
| 3/27/2023 8:42 | 0 | 0.007 | 0.0132 | No | 0 | No |
| 3/27/2023 8:43 | 0 | 0.008 | 0.0125 | No | 0 | No |
| 3/27/2023 8:44 | 0 | 0.009 | 0.0123 | No | 0 | No |
| 3/27/2023 8:45 | 0 | 0.011 | 0.0124 | No | 0 | No |
| 3/27/2023 8:46 | 0 | 0.013 | 0.0125 | No | 0 | No |
| 3/27/2023 8:47 | 0 | 0.013 | 0.0126 | No | 0 | No |
| 3/27/2023 8:48 | 0 | 0.007 | 0.0123 | No | 0 | No |
| 3/27/2023 8:49 | 0 | 0.007 | 0.0119 | No | 0 | No |
| 3/27/2023 8:50 | 0.039 | 0.007 | 0.0115 | No | 0.0026 | No |
| 3/27/2023 8:51 | 0 | 0.005 | 0.011 | No | 0.0026 | No |
| 3/27/2023 8:52 | 0 | 0.005 | 0.0103 | No | 0.0026 | No |
| 3/27/2023 8:53 | 0 | 0.003 | 0.0082 | No | 0.0026 | No |
| 3/27/2023 8:54 | 0 | 0.006 | 0.0079 | No | 0.0026 | No |
| 3/27/2023 8:55 | 0 | 0.008 | 0.0079 | No | 0.0026 | No |
| 3/27/2023 8:56 | 0 | 0.008 | 0.0078 | No | 0.0026 | No |
| 3/27/2023 8:57 | 0 | 0.007 | 0.0078 | No | 0.0026 | No |
| 3/27/2023 8:58 | 0 | 0.008 | 0.0078 | No | 0.0026 | No |
| 3/27/2023 8:59 | 0 | 0.003 | 0.0074 | No | 0.0026 | No |
| 3/27/2023 9:00 | 0 | 0.002 | 0.0068 | No | 0.0026 | No |
| 3/27/2023 9:01 | 0 | 0.002 | 0.0061 | No | 0.0026 | No |
| 3/27/2023 9:02 | 0 | 0.003 | 0.0054 | No | 0.0026 | No |
| 3/27/2023 9:03 | 0 | 0.007 | 0.0054 | No | 0.0026 | No |
| 3/27/2023 9:04 | 0 | 0.002 | 0.0051 | No | 0.0026 | No |
| 3/27/2023 9:05 | 0 | 0.005 | 0.0049 | No | 0 | No |
| 3/27/2023 9:06 | 0 | 0.006 | 0.005 | No | 0 | No |
| 3/27/2023 9:07 | 0 | 0.01 | 0.0053 | No | 0 | No |
| 3/27/2023 9:08 | 0 | 0.009 | 0.0057 | No | 0 | No |
| 3/27/2023 9:09 | 0 | 0.009 | 0.0059 | No | 0 | No |
| 3/27/2023 9:10 | 0 | 0.006 | 0.0058 | No | 0 | No |
| 3/27/2023 9:11 | 0.016 | 0.004 | 0.0055 | No | 0.0011 | No |
| 3/27/2023 9:12 | 0.004 | 0.005 | 0.0054 | No | 0.0013 | No |
| 3/27/2023 9:13 | 0.029 | 0.002 | 0.005 | No | 0.0033 | No |
| 3/27/2023 9:14 | 0.058 | 0.003 | 0.005 | No | 0.0071 | No |
| 3/27/2023 9:15 | 0.024 | 0.004 | 0.0051 | No | 0.0087 | No |
| 3/27/2023 9:16 | 0.003 | 0.007 | 0.0055 | No | 0.0089 | No |
| 3/27/2023 9:17 | 0.006 | 0.008 | 0.0058 | No | 0.0093 | No |
| 3/27/2023 9:18 | 0.01 | 0.005 | 0.0057 | No | 0.01 | No |
| 3/27/2023 9:19 | 0.012 | 0.003 | 0.0057 | No | 0.0108 | No |

| Downwind Station | | | | | | |
|------------------|-------------------------|---|---|-----------------|-----------------------|----------------|
| Time | Instantaneous VOC (ppm) | Instantaneous Mass Conc. Total (mg/m ³) | Mass Conc. Total mg/m ³ AVG 15m (mg/m ³) | Dust Exceedance | VOC ppm AVG 15m (ppm) | VOC Exceedance |
| 3/27/2023 9:20 | 0.021 | 0.006 | 0.0058 | No | 0.0122 | No |
| 3/27/2023 9:21 | 0.016 | 0.006 | 0.0058 | No | 0.0133 | No |
| 3/27/2023 9:22 | 0.054 | 0.008 | 0.0057 | No | 0.0169 | No |
| 3/27/2023 9:23 | 0.024 | 0.014 | 0.006 | No | 0.0185 | No |
| 3/27/2023 9:24 | 0.01 | 0.006 | 0.0058 | No | 0.0191 | No |
| 3/27/2023 9:25 | 0.002 | 0.005 | 0.0057 | No | 0.0193 | No |
| 3/27/2023 9:26 | 0.008 | 0.009 | 0.0061 | No | 0.0187 | No |
| 3/27/2023 9:27 | 0.022 | 0.045 | 0.0087 | No | 0.0199 | No |
| 3/27/2023 9:28 | 0.01 | 0.013 | 0.0095 | No | 0.0187 | No |
| 3/27/2023 9:29 | 0 | 0.014 | 0.0102 | No | 0.0148 | No |
| 3/27/2023 9:30 | 0.006 | 0.011 | 0.0107 | No | 0.0136 | No |
| 3/27/2023 9:31 | 0.006 | 0.015 | 0.0112 | No | 0.0138 | No |
| 3/27/2023 9:32 | 0.02 | 0.012 | 0.0115 | No | 0.0147 | No |
| 3/27/2023 9:33 | 0.023 | 0.021 | 0.0125 | No | 0.0156 | No |
| 3/27/2023 9:34 | 0 | 0.017 | 0.0135 | No | 0.0148 | No |
| 3/27/2023 9:35 | 0.024 | 0.009 | 0.0137 | No | 0.015 | No |
| 3/27/2023 9:36 | 0.047 | 0.015 | 0.0143 | No | 0.0171 | No |
| 3/27/2023 9:37 | 0.018 | 0.022 | 0.0152 | No | 0.0147 | No |
| 3/27/2023 9:38 | 0.019 | 0.017 | 0.0154 | No | 0.0143 | No |
| 3/27/2023 9:39 | 0.006 | 0.022 | 0.0165 | No | 0.0141 | No |
| 3/27/2023 9:40 | 0.06 | 0.015 | 0.0171 | No | 0.0179 | No |
| 3/27/2023 9:41 | 0 | 0.03 | 0.0185 | No | 0.0174 | No |
| 3/27/2023 9:42 | 0.007 | 0.018 | 0.0167 | No | 0.0164 | No |
| 3/27/2023 9:43 | 0.012 | 0.017 | 0.017 | No | 0.0165 | No |
| 3/27/2023 9:44 | 0 | 0.013 | 0.0169 | No | 0.0165 | No |
| 3/27/2023 9:45 | 0 | 0.024 | 0.0178 | No | 0.0161 | No |
| 3/27/2023 9:46 | 0.002 | 0.016 | 0.0179 | No | 0.0159 | No |
| 3/27/2023 9:47 | 0.034 | 0.013 | 0.0179 | No | 0.0168 | No |
| 3/27/2023 9:48 | 0.053 | 0.038 | 0.0191 | No | 0.0188 | No |
| 3/27/2023 9:49 | 0.04 | 0.049 | 0.0212 | No | 0.0215 | No |
| 3/27/2023 9:50 | 0.02 | 0.009 | 0.0212 | No | 0.0212 | No |
| 3/27/2023 9:51 | 0.021 | 0.015 | 0.0212 | No | 0.0195 | No |
| 3/27/2023 9:52 | 0.047 | 0.017 | 0.0209 | No | 0.0214 | No |
| 3/27/2023 9:53 | 0.057 | 0.009 | 0.0203 | No | 0.0239 | No |
| 3/27/2023 9:54 | 0.032 | 0.012 | 0.0197 | No | 0.0257 | No |
| 3/27/2023 9:55 | 0.024 | 0.008 | 0.0192 | No | 0.0233 | No |
| 3/27/2023 9:56 | 0.025 | 0.009 | 0.0178 | No | 0.0249 | No |
| 3/27/2023 9:57 | 0.039 | 0.005 | 0.0169 | No | 0.0271 | No |
| 3/27/2023 9:58 | 0.031 | 0.008 | 0.0163 | No | 0.0283 | No |
| 3/27/2023 9:59 | 0.034 | 0.01 | 0.0161 | No | 0.0306 | No |
| 3/27/2023 10:00 | 0.038 | 0.021 | 0.0159 | No | 0.0331 | No |
| 3/27/2023 10:01 | 0.028 | 0.017 | 0.016 | No | 0.0349 | No |
| 3/27/2023 10:02 | 0.052 | 0.011 | 0.0159 | No | 0.0361 | No |
| 3/27/2023 10:03 | 0.029 | 0.019 | 0.0146 | No | 0.0345 | No |
| 3/27/2023 10:04 | 0.038 | 0.014 | 0.0123 | No | 0.0343 | No |
| 3/27/2023 10:05 | 0.077 | 0.02 | 0.013 | No | 0.0381 | No |
| 3/27/2023 10:06 | 0.061 | 0.038 | 0.0145 | No | 0.0408 | No |
| 3/27/2023 10:07 | 0.035 | 0.021 | 0.0148 | No | 0.04 | No |
| 3/27/2023 10:08 | 0.056 | 0.032 | 0.0163 | No | 0.0399 | No |
| 3/27/2023 10:09 | 0.036 | 0.02 | 0.0169 | No | 0.0402 | No |
| 3/27/2023 10:10 | 0.025 | 0.019 | 0.0176 | No | 0.0403 | No |
| 3/27/2023 10:11 | 0.035 | 0.013 | 0.0179 | No | 0.0409 | No |
| 3/27/2023 10:12 | 0.041 | 0.022 | 0.019 | No | 0.0411 | No |
| 3/27/2023 10:13 | 0.033 | 0.031 | 0.0205 | No | 0.0412 | No |

| Downwind Station | | | | | | |
|------------------|----------------------|--|---|-----------------|-----------------------|----------------|
| Time | Instaneous VOC (ppm) | Instaneous Mass Conc. Total (mg/m ³) | Mass Conc. Total mg/m ³ AVG 15m (mg/m ³) | Dust Exceedance | VOC ppm AVG 15m (ppm) | VOC Exceedance |
| 3/27/2023 10:14 | 0.114 | 0.02 | 0.0212 | No | 0.0465 | No |
| 3/27/2023 10:15 | 0.067 | 0.031 | 0.0219 | No | 0.0485 | No |
| 3/27/2023 10:16 | 0.055 | 0.014 | 0.0217 | No | 0.0503 | No |
| 3/27/2023 10:17 | 0.047 | 0.011 | 0.0217 | No | 0.0499 | No |
| 3/27/2023 10:18 | 0.039 | 0.012 | 0.0212 | No | 0.0506 | No |
| 3/27/2023 10:19 | 0.026 | 0.011 | 0.021 | No | 0.0498 | No |
| 3/27/2023 10:20 | 0.05 | 0.011 | 0.0204 | No | 0.048 | No |
| 3/27/2023 10:21 | 0.059 | 0.026 | 0.0196 | No | 0.0479 | No |
| 3/27/2023 10:22 | 0.032 | 0.026 | 0.0199 | No | 0.0477 | No |
| 3/27/2023 10:23 | 0.035 | 0.012 | 0.0186 | No | 0.0463 | No |
| 3/27/2023 10:24 | 0.072 | 0.017 | 0.0184 | No | 0.0487 | No |
| 3/27/2023 10:25 | 0.089 | 0.016 | 0.0182 | No | 0.0529 | No |
| 3/27/2023 10:26 | 0.058 | 0.017 | 0.0185 | No | 0.0545 | No |
| 3/27/2023 10:27 | 0.117 | 0.142 | 0.0265 | No | 0.0595 | No |
| 3/27/2023 10:28 | 0.037 | 0.047 | 0.0275 | No | 0.0598 | No |
| 3/27/2023 10:29 | 0.035 | 0.037 | 0.0287 | No | 0.0545 | No |
| 3/27/2023 10:30 | 0.048 | 0.102 | 0.0334 | No | 0.0533 | No |
| 3/27/2023 10:31 | 0.108 | 0.037 | 0.0349 | No | 0.0568 | No |
| 3/27/2023 10:32 | 0.053 | 0.036 | 0.0366 | No | 0.0572 | No |
| 3/27/2023 10:33 | 0.077 | 0.025 | 0.0375 | No | 0.0597 | No |
| 3/27/2023 10:34 | 0.091 | 0.018 | 0.0379 | No | 0.0641 | No |
| 3/27/2023 10:35 | 0.06 | 0.018 | 0.0384 | No | 0.0647 | No |
| 3/27/2023 10:36 | 0.05 | 0.014 | 0.0376 | No | 0.0641 | No |
| 3/27/2023 10:37 | 0.061 | 0.023 | 0.0374 | No | 0.0661 | No |
| 3/27/2023 10:38 | 0.072 | 0.024 | 0.0382 | No | 0.0685 | No |
| 3/27/2023 10:39 | 0.055 | 0.047 | 0.0402 | No | 0.0674 | No |
| 3/27/2023 10:40 | 0.087 | 0.015 | 0.0401 | No | 0.0673 | No |
| 3/27/2023 10:41 | 0.075 | 0.019 | 0.0403 | No | 0.0684 | No |
| 3/27/2023 10:42 | 0.07 | 0.024 | 0.0324 | No | 0.0653 | No |
| 3/27/2023 10:43 | 0.069 | 0.017 | 0.0304 | No | 0.0674 | No |
| 3/27/2023 10:44 | 0.044 | 0.063 | 0.0321 | No | 0.068 | No |
| 3/27/2023 10:45 | 0.058 | 0.02 | 0.0267 | No | 0.0687 | No |
| 3/27/2023 10:46 | 0.057 | 0.019 | 0.0255 | No | 0.0653 | No |
| 3/27/2023 10:47 | 0.068 | 0.016 | 0.0241 | No | 0.0663 | No |
| 3/27/2023 10:48 | 0.354 | 0.013 | 0.0233 | No | 0.0847 | No |
| 3/27/2023 10:49 | 0.086 | 0.024 | 0.0237 | No | 0.0844 | No |
| 3/27/2023 10:50 | 0.06 | 0.047 | 0.0257 | No | 0.0844 | No |
| 3/27/2023 10:51 | 0.109 | 0.025 | 0.0264 | No | 0.0883 | No |
| 3/27/2023 10:52 | 0.077 | 0.033 | 0.0271 | No | 0.0894 | No |
| 3/27/2023 10:53 | 0.045 | 0.023 | 0.027 | No | 0.0876 | No |
| 3/27/2023 10:54 | 0.045 | 0.032 | 0.026 | No | 0.0869 | No |
| 3/27/2023 10:55 | 0.04 | 0.023 | 0.0265 | No | 0.0838 | No |
| 3/27/2023 10:56 | 0.034 | 0.02 | 0.0266 | No | 0.0811 | No |
| 3/27/2023 10:57 | 0.15 | 0.016 | 0.0261 | No | 0.0864 | No |
| 3/27/2023 10:58 | 0.154 | 0.015 | 0.0259 | No | 0.0921 | No |
| 3/27/2023 10:59 | 0.054 | 0.022 | 0.0232 | No | 0.0927 | No |
| 3/27/2023 11:00 | 0.042 | 0.015 | 0.0229 | No | 0.0917 | No |
| 3/27/2023 11:01 | 0.044 | 0.019 | 0.0229 | No | 0.0908 | No |
| 3/27/2023 11:02 | 0.042 | 0.017 | 0.0229 | No | 0.0891 | No |
| 3/27/2023 11:03 | 0.06 | 0.015 | 0.0231 | No | 0.0695 | No |
| 3/27/2023 11:04 | 0.065 | 0.015 | 0.0225 | No | 0.0681 | No |
| 3/27/2023 11:05 | 0.054 | 0.021 | 0.0207 | No | 0.0677 | No |
| 3/27/2023 11:06 | 0.059 | 0.059 | 0.023 | No | 0.0643 | No |
| 3/27/2023 11:07 | 0.063 | 0.027 | 0.0226 | No | 0.0634 | No |

| Downwind Station | | | | | | |
|------------------|----------------------|--|---|-----------------|-----------------------|----------------|
| Time | Instaneous VOC (ppm) | Instaneous Mass Conc. Total (mg/m ³) | Mass Conc. Total mg/m ³ AVG 15m (mg/m ³) | Dust Exceedance | VOC ppm AVG 15m (ppm) | VOC Exceedance |
| 3/27/2023 11:08 | 0.056 | 0.043 | 0.0239 | No | 0.0641 | No |
| 3/27/2023 11:09 | 0.056 | 0.019 | 0.0231 | No | 0.0649 | No |
| 3/27/2023 11:10 | 0.056 | 0.013 | 0.0224 | No | 0.0659 | No |
| 3/27/2023 11:11 | 0.061 | 0.006 | 0.0215 | No | 0.0677 | No |
| 3/27/2023 11:12 | 0.088 | 0.011 | 0.0211 | No | 0.0636 | No |
| 3/27/2023 11:13 | 0.063 | 0.008 | 0.0207 | No | 0.0575 | No |
| 3/27/2023 11:14 | 0.069 | 0.005 | 0.0195 | No | 0.0585 | No |
| 3/27/2023 11:15 | 0.117 | 0.005 | 0.0189 | No | 0.0635 | No |
| 3/27/2023 11:16 | 0.066 | 0.006 | 0.018 | No | 0.065 | No |
| 3/27/2023 11:17 | 0.068 | 0.014 | 0.0178 | No | 0.0667 | No |
| 3/27/2023 11:18 | 0.068 | 0.013 | 0.0177 | No | 0.0673 | No |
| 3/27/2023 11:19 | 0.07 | 0.007 | 0.0171 | No | 0.0676 | No |
| 3/27/2023 11:20 | 0.08 | 0.007 | 0.0162 | No | 0.0693 | No |
| 3/27/2023 11:21 | 0.083 | 0.008 | 0.0128 | No | 0.0709 | No |
| 3/27/2023 11:22 | 0.084 | 0.008 | 0.0115 | No | 0.0723 | No |
| 3/27/2023 11:23 | 0.116 | 0.007 | 0.0091 | No | 0.0763 | No |
| 3/27/2023 11:24 | 0.092 | 0.011 | 0.0086 | No | 0.0787 | No |
| 3/27/2023 11:25 | 0.088 | 0.009 | 0.0083 | No | 0.0809 | No |
| 3/27/2023 11:26 | 0.075 | 0.015 | 0.0089 | No | 0.0818 | No |
| 3/27/2023 11:27 | 0.073 | 0.011 | 0.0089 | No | 0.0808 | No |
| 3/27/2023 11:28 | 0.072 | 0.007 | 0.0089 | No | 0.0814 | No |
| 3/27/2023 11:29 | 0.068 | 0.006 | 0.0089 | No | 0.0813 | No |
| 3/27/2023 11:30 | 0.07 | 0.003 | 0.0088 | No | 0.0782 | No |
| 3/27/2023 11:31 | 0.085 | 0.009 | 0.009 | No | 0.0795 | No |
| 3/27/2023 11:32 | 0.107 | 0.011 | 0.0088 | No | 0.0821 | No |
| 3/27/2023 11:33 | 0.104 | 0.011 | 0.0087 | No | 0.0845 | No |
| 3/27/2023 11:34 | 0.112 | 0.006 | 0.0086 | No | 0.0873 | No |
| 3/27/2023 11:35 | 0.117 | 0.007 | 0.0086 | No | 0.0897 | No |
| 3/27/2023 11:36 | 0.107 | 0.007 | 0.0085 | No | 0.0913 | No |
| 3/27/2023 11:37 | 0.089 | 0.005 | 0.0083 | No | 0.0917 | No |
| 3/27/2023 11:38 | 0.084 | 0.006 | 0.0083 | No | 0.0895 | No |
| 3/27/2023 11:39 | 0.081 | 0.002 | 0.0077 | No | 0.0888 | No |
| 3/27/2023 11:40 | 0.097 | 0.001 | 0.0071 | No | 0.0894 | No |
| 3/27/2023 11:41 | 0.101 | 0.004 | 0.0064 | No | 0.0911 | No |
| 3/27/2023 11:42 | 0.103 | 0.007 | 0.0061 | No | 0.0931 | No |
| 3/27/2023 11:43 | 0.079 | 0.008 | 0.0062 | No | 0.0936 | No |
| 3/27/2023 11:44 | 0.135 | 0 | 0.0058 | No | 0.0981 | No |
| 3/27/2023 11:45 | 0.101 | 0.016 | 0.0067 | No | 0.1001 | No |
| 3/27/2023 11:46 | 0.081 | 0.002 | 0.0062 | No | 0.0999 | No |
| 3/27/2023 11:47 | 0.116 | 0.003 | 0.0057 | No | 0.1005 | No |
| 3/27/2023 11:48 | 0.081 | 0.02 | 0.0063 | No | 0.0989 | No |
| 3/27/2023 11:49 | 0.079 | 0.015 | 0.0069 | No | 0.0967 | No |
| 3/27/2023 11:50 | 0.09 | 0.002 | 0.0065 | No | 0.0949 | No |
| 3/27/2023 11:51 | 0.084 | 0.011 | 0.0068 | No | 0.0934 | No |
| 3/27/2023 11:52 | 0.113 | 0.007 | 0.0069 | No | 0.095 | No |
| 3/27/2023 11:53 | 0.091 | 0.007 | 0.007 | No | 0.0955 | No |
| 3/27/2023 11:54 | 0.106 | 0.005 | 0.0072 | No | 0.0971 | No |
| 3/27/2023 11:55 | 0.085 | 0.004 | 0.0074 | No | 0.0963 | No |
| 3/27/2023 11:56 | 0.073 | 0.003 | 0.0073 | No | 0.0945 | No |
| 3/27/2023 11:57 | 0.094 | 0.001 | 0.0069 | No | 0.0939 | No |
| 3/27/2023 11:58 | 0.078 | 0.001 | 0.0065 | No | 0.0938 | No |
| 3/27/2023 11:59 | 0.085 | 0.005 | 0.0068 | No | 0.0905 | No |
| 3/27/2023 12:00 | 0.093 | 0.004 | 0.006 | No | 0.0899 | No |
| 3/27/2023 12:01 | 0.072 | 0.002 | 0.006 | No | 0.0893 | No |

| Downwind Station | | | | | | |
|------------------|----------------------|--|---|-----------------|-----------------------|----------------|
| Time | Instaneous VOC (ppm) | Instaneous Mass Conc. Total (mg/m ³) | Mass Conc. Total mg/m ³ AVG 15m (mg/m ³) | Dust Exceedance | VOC ppm AVG 15m (ppm) | VOC Exceedance |
| 3/27/2023 12:02 | 0.09 | 0.002 | 0.0059 | No | 0.0876 | No |
| 3/27/2023 12:03 | 0.091 | 0.003 | 0.0048 | No | 0.0883 | No |
| 3/27/2023 12:04 | 0.09 | 0.004 | 0.0041 | No | 0.089 | No |
| 3/27/2023 12:05 | 0.095 | 0.007 | 0.0044 | No | 0.0893 | No |
| 3/27/2023 12:06 | 0.1 | 0.007 | 0.0041 | No | 0.0904 | No |
| 3/27/2023 12:07 | 0.2 | 0.006 | 0.0041 | No | 0.0962 | No |
| 3/27/2023 12:08 | 0.097 | 0.007 | 0.0041 | No | 0.0966 | No |
| 3/27/2023 12:09 | 0.082 | 0.005 | 0.0041 | No | 0.095 | No |
| 3/27/2023 12:10 | 0.085 | 0.002 | 0.0039 | No | 0.095 | No |
| 3/27/2023 12:11 | 0.092 | 0.003 | 0.0039 | No | 0.0963 | No |
| 3/27/2023 12:12 | 0.069 | 0.002 | 0.004 | No | 0.0946 | No |
| 3/27/2023 12:13 | 0.066 | 0.002 | 0.0041 | No | 0.0938 | No |
| 3/27/2023 12:14 | 0.074 | 0.004 | 0.004 | No | 0.0931 | No |
| 3/27/2023 12:15 | 0.098 | 0.004 | 0.004 | No | 0.0934 | No |
| 3/27/2023 12:16 | 0.087 | 0.004 | 0.0041 | No | 0.0944 | No |
| 3/27/2023 12:17 | 0.109 | 0.004 | 0.0043 | No | 0.0957 | No |
| 3/27/2023 12:18 | 0.057 | 0.002 | 0.0042 | No | 0.0934 | No |
| 3/27/2023 12:19 | 0.061 | 0.003 | 0.0041 | No | 0.0915 | No |
| 3/27/2023 12:20 | 0.119 | 0.003 | 0.0039 | No | 0.0931 | No |
| 3/27/2023 12:21 | 0.099 | 0.004 | 0.0037 | No | 0.093 | No |
| 3/27/2023 12:22 | 0.063 | 0.005 | 0.0036 | No | 0.0839 | No |
| 3/27/2023 12:23 | 0.071 | 0.005 | 0.0035 | No | 0.0821 | No |
| 3/27/2023 12:24 | 0.057 | 0.003 | 0.0033 | No | 0.0805 | No |
| 3/27/2023 12:25 | 0.056 | 0 | 0.0032 | No | 0.0785 | No |
| 3/27/2023 12:26 | 0.051 | 0 | 0.003 | No | 0.0758 | No |
| 3/27/2023 12:27 | 0.052 | 0.001 | 0.0029 | No | 0.0747 | No |
| 3/27/2023 12:28 | 0.054 | 0.002 | 0.0029 | No | 0.0739 | No |
| 3/27/2023 12:29 | 0.068 | 0 | 0.0027 | No | 0.0735 | No |
| 3/27/2023 12:30 | 0.044 | 0 | 0.0024 | No | 0.0699 | No |
| 3/27/2023 12:31 | 0.052 | 0.001 | 0.0022 | No | 0.0675 | No |
| 3/27/2023 12:32 | 0.063 | 0.002 | 0.0021 | No | 0.0645 | No |
| 3/27/2023 12:33 | 0.039 | 0.002 | 0.0021 | No | 0.0633 | No |
| 3/27/2023 12:34 | 0.035 | 0.002 | 0.002 | No | 0.0615 | No |
| 3/27/2023 12:35 | 0.035 | 0.001 | 0.0019 | No | 0.0559 | No |
| 3/27/2023 12:36 | 0.038 | 0.001 | 0.0017 | No | 0.0519 | No |
| 3/27/2023 12:37 | 0.029 | 0.002 | 0.0015 | No | 0.0496 | No |
| 3/27/2023 12:38 | 0.034 | 0 | 0.0011 | No | 0.0471 | No |
| 3/27/2023 12:39 | 0.036 | 0.002 | 0.0011 | No | 0.0457 | No |
| 3/27/2023 12:40 | 0.044 | 0 | 0.0011 | No | 0.0449 | No |
| 3/27/2023 12:41 | 0.037 | 0 | 0.0011 | No | 0.044 | No |
| 3/27/2023 12:42 | 0.027 | 0.002 | 0.0011 | No | 0.0423 | No |
| 3/27/2023 12:43 | 0.032 | 0.002 | 0.0011 | No | 0.0409 | No |
| 3/27/2023 12:44 | 0.037 | 0.001 | 0.0012 | No | 0.0388 | No |
| 3/27/2023 12:45 | 0.036 | 0.002 | 0.0013 | No | 0.0383 | No |
| 3/27/2023 12:46 | 0.056 | 0.002 | 0.0014 | No | 0.0385 | No |
| 3/27/2023 12:47 | 0.055 | 0.003 | 0.0015 | No | 0.038 | No |
| 3/27/2023 12:48 | 0.078 | 0.002 | 0.0015 | No | 0.0406 | No |
| 3/27/2023 12:49 | 0.038 | 0 | 0.0013 | No | 0.0408 | No |
| 3/27/2023 12:50 | 0.035 | 0.001 | 0.0013 | No | 0.0408 | No |
| 3/27/2023 12:51 | 0.041 | 0 | 0.0013 | No | 0.041 | No |
| 3/27/2023 12:52 | 0.041 | 0 | 0.0011 | No | 0.0418 | No |
| 3/27/2023 12:53 | 0.045 | 0 | 0.0011 | No | 0.0425 | No |
| 3/27/2023 12:54 | 0.033 | 0 | 0.001 | No | 0.0423 | No |
| 3/27/2023 12:55 | 0.075 | 0 | 0.001 | No | 0.0444 | No |

| Downwind Station | | | | | | |
|------------------|----------------------|--|---|-----------------|-----------------------|----------------|
| Time | Instaneous VOC (ppm) | Instaneous Mass Conc. Total (mg/m ³) | Mass Conc. Total mg/m ³ AVG 15m (mg/m ³) | Dust Exceedance | VOC ppm AVG 15m (ppm) | VOC Exceedance |
| 3/27/2023 12:56 | 0.098 | 0.001 | 0.0011 | No | 0.0485 | No |
| 3/27/2023 12:57 | 0.046 | 0.001 | 0.001 | No | 0.0497 | No |
| 3/27/2023 12:58 | 0.049 | 0.003 | 0.0011 | No | 0.0509 | No |
| 3/27/2023 12:59 | 0.074 | 0.019 | 0.0023 | No | 0.0533 | No |
| 3/27/2023 13:00 | 0.031 | 0.01 | 0.0028 | No | 0.053 | No |
| 3/27/2023 13:01 | 0.048 | 0.003 | 0.0029 | No | 0.0525 | No |
| 3/27/2023 13:02 | 0.084 | 0.008 | 0.0032 | No | 0.0544 | No |
| 3/27/2023 13:03 | 0.089 | 0.005 | 0.0034 | No | 0.0551 | No |
| 3/27/2023 13:04 | 0.033 | 0.005 | 0.0037 | No | 0.0548 | No |
| 3/27/2023 13:05 | 0.063 | 0.003 | 0.0039 | No | 0.0567 | No |
| 3/27/2023 13:06 | 0.042 | 0.002 | 0.004 | No | 0.0567 | No |
| 3/27/2023 13:07 | 0.045 | 0.004 | 0.0043 | No | 0.057 | No |
| 3/27/2023 13:08 | 0.041 | 0.003 | 0.0045 | No | 0.0567 | No |
| 3/27/2023 13:09 | 0.043 | 0.001 | 0.0045 | No | 0.0574 | No |
| 3/27/2023 13:10 | 0.061 | 0.006 | 0.0049 | No | 0.0565 | No |
| 3/27/2023 13:11 | 0.069 | 0.002 | 0.005 | No | 0.0545 | No |
| 3/27/2023 13:12 | 0.057 | 0.005 | 0.0053 | No | 0.0553 | No |
| 3/27/2023 13:13 | 0.057 | 0.006 | 0.0055 | No | 0.0558 | No |
| 3/27/2023 13:14 | 0.059 | 0.004 | 0.0045 | No | 0.0548 | No |
| 3/27/2023 13:15 | 0.046 | 0.001 | 0.0039 | No | 0.0558 | No |
| 3/27/2023 13:16 | 0.069 | 0.005 | 0.004 | No | 0.0572 | No |
| 3/27/2023 13:17 | 0.043 | 0.001 | 0.0035 | No | 0.0545 | No |
| 3/27/2023 13:18 | 0.045 | 0.001 | 0.0033 | No | 0.0515 | No |
| 3/27/2023 13:19 | 0.054 | 0.001 | 0.003 | No | 0.0529 | No |
| 3/27/2023 13:20 | 0.107 | 0.002 | 0.0029 | No | 0.0559 | No |
| 3/27/2023 13:21 | 0.049 | 0.002 | 0.0029 | No | 0.0563 | No |
| 3/27/2023 13:22 | 0.041 | 0.004 | 0.0029 | No | 0.0561 | No |
| 3/27/2023 13:23 | 0.034 | 0.002 | 0.0029 | No | 0.0556 | No |
| 3/27/2023 13:24 | 0.082 | 0.003 | 0.003 | No | 0.0582 | No |
| 3/27/2023 13:25 | 0.047 | 0.006 | 0.003 | No | 0.0573 | No |
| 3/27/2023 13:26 | 0.091 | 0.004 | 0.0031 | No | 0.0587 | No |
| 3/27/2023 13:27 | 0.052 | 0.007 | 0.0033 | No | 0.0584 | No |
| 3/27/2023 13:28 | 0.042 | 0.004 | 0.0031 | No | 0.0574 | No |
| 3/27/2023 13:29 | 0.034 | 0.003 | 0.0031 | No | 0.0557 | No |
| 3/27/2023 13:30 | 0.04 | 0 | 0.003 | No | 0.0553 | No |
| 3/27/2023 13:31 | 0.046 | 0.003 | 0.0029 | No | 0.0538 | No |
| 3/27/2023 13:32 | 0.055 | 0.004 | 0.0031 | No | 0.0546 | No |
| 3/27/2023 13:33 | 0.041 | 0.006 | 0.0034 | No | 0.0543 | No |
| 3/27/2023 13:34 | 0.076 | 0.004 | 0.0036 | No | 0.0558 | No |
| 3/27/2023 13:35 | 0.042 | 0.001 | 0.0035 | No | 0.0515 | No |
| 3/27/2023 13:36 | 0.048 | 0.001 | 0.0035 | No | 0.0514 | No |
| 3/27/2023 13:37 | 0.039 | 0.005 | 0.0035 | No | 0.0513 | No |
| 3/27/2023 13:38 | 0.049 | 0.012 | 0.0042 | No | 0.0523 | No |
| 3/27/2023 13:39 | 0.039 | 0.012 | 0.0048 | No | 0.0494 | No |
| 3/27/2023 13:40 | 0.033 | 0.006 | 0.0048 | No | 0.0485 | No |
| 3/27/2023 13:41 | 0.03 | 0.009 | 0.0051 | No | 0.0444 | No |
| 3/27/2023 13:42 | 0.024 | 0.007 | 0.0051 | No | 0.0425 | No |
| 3/27/2023 13:43 | 0.019 | 0.006 | 0.0053 | No | 0.041 | No |
| 3/27/2023 13:44 | 0.016 | 0.009 | 0.0057 | No | 0.0398 | No |
| 3/27/2023 13:45 | 0.014 | 0.007 | 0.0061 | No | 0.0381 | No |
| 3/27/2023 13:46 | 0.014 | 0.01 | 0.0066 | No | 0.0359 | No |
| 3/27/2023 13:47 | 0.024 | 0.053 | 0.0099 | No | 0.0339 | No |
| 3/27/2023 13:48 | 0.01 | 0.079 | 0.0147 | No | 0.0318 | No |
| 3/27/2023 13:49 | 0.078 | 0.009 | 0.0151 | No | 0.0319 | No |

| Downwind Station | | | | | | |
|------------------|-------------------------|---|---|-----------------|-----------------------|----------------|
| Time | Instantaneous VOC (ppm) | Instantaneous Mass Conc. Total (mg/m ³) | Mass Conc. Total mg/m ³ AVG 15m (mg/m ³) | Dust Exceedance | VOC ppm AVG 15m (ppm) | VOC Exceedance |
| 3/27/2023 13:50 | 0.031 | 0.024 | 0.0166 | No | 0.0312 | No |
| 3/27/2023 13:51 | 0.027 | 0.02 | 0.0179 | No | 0.0298 | No |
| 3/27/2023 13:52 | 0.023 | 0.006 | 0.0179 | No | 0.0287 | No |
| 3/27/2023 13:53 | 0.05 | 0.014 | 0.0181 | No | 0.0288 | No |
| 3/27/2023 13:54 | 0.172 | 0.005 | 0.0176 | No | 0.0377 | No |
| 3/27/2023 13:55 | 0.041 | 0.005 | 0.0175 | No | 0.0382 | No |
| 3/27/2023 13:56 | 0.021 | 0.004 | 0.0172 | No | 0.0376 | No |
| 3/27/2023 13:57 | 0.019 | 0.005 | 0.0171 | No | 0.0373 | No |
| 3/27/2023 13:58 | 0.088 | 0.009 | 0.0173 | No | 0.0419 | No |
| 3/27/2023 13:59 | 0.024 | 0.005 | 0.017 | No | 0.0424 | No |
| 3/27/2023 14:00 | 0.049 | 0.006 | 0.0169 | No | 0.0447 | No |
| 3/27/2023 14:01 | 0.025 | 0.009 | 0.0169 | No | 0.0455 | No |
| 3/27/2023 14:02 | 0.017 | 0.008 | 0.0139 | No | 0.045 | No |
| 3/27/2023 14:03 | 0.038 | 0.009 | 0.0092 | No | 0.0469 | No |
| 3/27/2023 14:04 | 0.01 | 0.013 | 0.0095 | No | 0.0423 | No |
| 3/27/2023 14:05 | 0.024 | 0.011 | 0.0086 | No | 0.0419 | No |
| 3/27/2023 14:06 | 0.014 | 0.006 | 0.0077 | No | 0.041 | No |
| 3/27/2023 14:07 | 0.007 | 0.003 | 0.0075 | No | 0.0399 | No |
| 3/27/2023 14:08 | 0.007 | 0.002 | 0.0067 | No | 0.0371 | No |
| 3/27/2023 14:09 | 0.026 | 0.004 | 0.0066 | No | 0.0273 | No |
| 3/27/2023 14:10 | 0.032 | 0.006 | 0.0067 | No | 0.0267 | No |
| 3/27/2023 14:11 | 0.004 | 0.005 | 0.0067 | No | 0.0256 | No |
| 3/27/2023 14:12 | 0.006 | 0.003 | 0.0066 | No | 0.0247 | No |
| 3/27/2023 14:13 | 0.003 | 0.006 | 0.0064 | No | 0.0191 | No |
| 3/27/2023 14:14 | 0.042 | 0.014 | 0.007 | No | 0.0203 | No |
| 3/27/2023 14:15 | 0.005 | 0.012 | 0.0074 | No | 0.0173 | No |
| 3/27/2023 14:16 | 0 | 0.011 | 0.0075 | No | 0.0157 | No |
| 3/27/2023 14:17 | 0.001 | 0.005 | 0.0073 | No | 0.0146 | No |
| 3/27/2023 14:18 | 0 | 0.006 | 0.0071 | No | 0.0121 | No |
| 3/27/2023 14:19 | 0 | 0.01 | 0.0069 | No | 0.0114 | No |
| 3/27/2023 14:20 | 0 | 0.005 | 0.0065 | No | 0.0098 | No |
| 3/27/2023 14:21 | 0 | 0.005 | 0.0065 | No | 0.0089 | No |
| 3/27/2023 14:22 | 0 | 0.007 | 0.0067 | No | 0.0084 | No |
| 3/27/2023 14:23 | 0 | 0.007 | 0.0071 | No | 0.0079 | No |
| 3/27/2023 14:24 | 0.014 | 0.006 | 0.0072 | No | 0.0071 | No |
| 3/27/2023 14:25 | 0 | 0.008 | 0.0073 | No | 0.005 | No |
| 3/27/2023 14:26 | 0 | 0.007 | 0.0075 | No | 0.0047 | No |
| 3/27/2023 14:27 | 0 | 0.008 | 0.0078 | No | 0.0043 | No |
| 3/27/2023 14:28 | 0 | 0.011 | 0.0081 | No | 0.0041 | No |
| 3/27/2023 14:29 | 0 | 0.01 | 0.0079 | No | 0.0013 | No |
| 3/27/2023 14:30 | 0.001 | 0.009 | 0.0077 | No | 0.0011 | No |
| 3/27/2023 14:31 | 0 | 0.01 | 0.0076 | No | 0.0011 | No |
| 3/27/2023 14:32 | 0 | 0.009 | 0.0079 | No | 0.001 | No |
| 3/27/2023 14:33 | 0.005 | 0.008 | 0.008 | No | 0.0013 | No |
| 3/27/2023 14:34 | 0 | 0.006 | 0.0077 | No | 0.0013 | No |
| 3/27/2023 14:35 | 0 | 0.009 | 0.008 | No | 0.0013 | No |
| 3/27/2023 14:36 | 0 | 0.006 | 0.0081 | No | 0.0013 | No |
| 3/27/2023 14:37 | 0 | 0.006 | 0.008 | No | 0.0013 | No |
| 3/27/2023 14:38 | 0 | 0.005 | 0.0079 | No | 0.0013 | No |
| 3/27/2023 14:39 | 0.001 | 0.007 | 0.0079 | No | 0.0005 | No |
| 3/27/2023 14:40 | 0 | 0.008 | 0.0079 | No | 0.0005 | No |
| 3/27/2023 14:41 | 0 | 0.012 | 0.0083 | No | 0.0005 | No |
| 3/27/2023 14:42 | 0.001 | 0.008 | 0.0083 | No | 0.0005 | No |
| 3/27/2023 14:43 | 0 | 0.006 | 0.0079 | No | 0.0005 | No |

Downwind Station

| Time | Instantaneous VOC (ppm) | Instantaneous Mass Conc. Total (mg/m ³) | Mass Conc. Total mg/m ³ AVG 15m (mg/m ³) | Dust Exceedance | VOC ppm AVG 15m (ppm) | VOC Exceedance |
|-----------------|-------------------------|---|---|-----------------|-----------------------|----------------|
| 3/27/2023 14:44 | 0 | 0.007 | 0.0077 | No | 0.0005 | No |
| 3/27/2023 14:45 | 0 | 0.006 | 0.0075 | No | 0.0005 | No |
| 3/27/2023 14:46 | 0.016 | 0.007 | 0.0073 | No | 0.0015 | No |
| 3/27/2023 14:47 | 0 | 0.01 | 0.0074 | No | 0.0015 | No |
| 3/27/2023 14:48 | 0 | 0.009 | 0.0075 | No | 0.0012 | No |
| 3/27/2023 14:49 | 0 | 0.013 | 0.0079 | No | 0.0012 | No |
| 3/27/2023 14:50 | 0 | 0.015 | 0.0083 | No | 0.0012 | No |