



Daily Activity Report

Seton Brilla Charter School
1956 Jerome Avenue, Bronx, NY
BCP No. C203152

General Site Information

Date:	Thursday, March 23, 2023
Weather:	Rainy, 40-59°F
Wind Direction/Speed:	SW @9 mph
AKRF Personnel on Site:	J. Kelleher-Ferguson
AKRF Equipment on Site:	Mini RAE 3000 Photoionization Detector [(PID) x1], 2 Fixed Air Monitoring Stations [DustTrak
Visitors:	None.

Contractor Information

Contracting Company	Main Personnel	Equipment
Casino Construction	Carlos	Excavator

Description and Location of Work Activities Performed

1) Pile cap and grade beam construction activities continued.

Destination Facility	Daily Trucks	Total Trucks	Daily Approx. Cubic Yds	Total Approx. Cubic Yds	Total Site Loads	Total Approximate Cubic Yards
Clean Earth Carteret	0	89	0	1,780	182	3,640
Clean Earth Southeastern Pennsylvania	0	67	0	1,340		
Concrete Disposal	0	26	0	520		
N/A	0	0	0	0		
N/A	0	0	0	0		

CAMP Air Monitoring Results

CAMP Station	UPWIND				DOWNWIND		
Odors:	None.				None.		
VOC Action Level Exceedance(s):	None.				None.		
Particulate Action Level Exceedance(s):	None.				1		
Maximum VOC Level (15 min ppm):	0.060				0.251		
Maximum Particulate Level (15 min mg/m ³):	0.080				0.364		

Notes: CAMP monitoring was performed throughout the day starting at approx. 800 due to scattered rain showers. CAMP then ended early around 1200 due to heavy rains in the afternoon. There was an exceedance on the downwind CAMP station at approx. 1100, which was due to concrete cutting on the sitewalk near the CAMP stations. AKRF requested that the contractor apply water during sawing to eliminate dust, and levels returned to acceptable.

Additional Information

Planned Work Activity for Following Day/Week:	<ol style="list-style-type: none"> 1) Excavation of soil/fill to uncover piles. 2) Cutting piles to final elevations 3) Exporting of soil off-site
Comments:	None.

Site Map

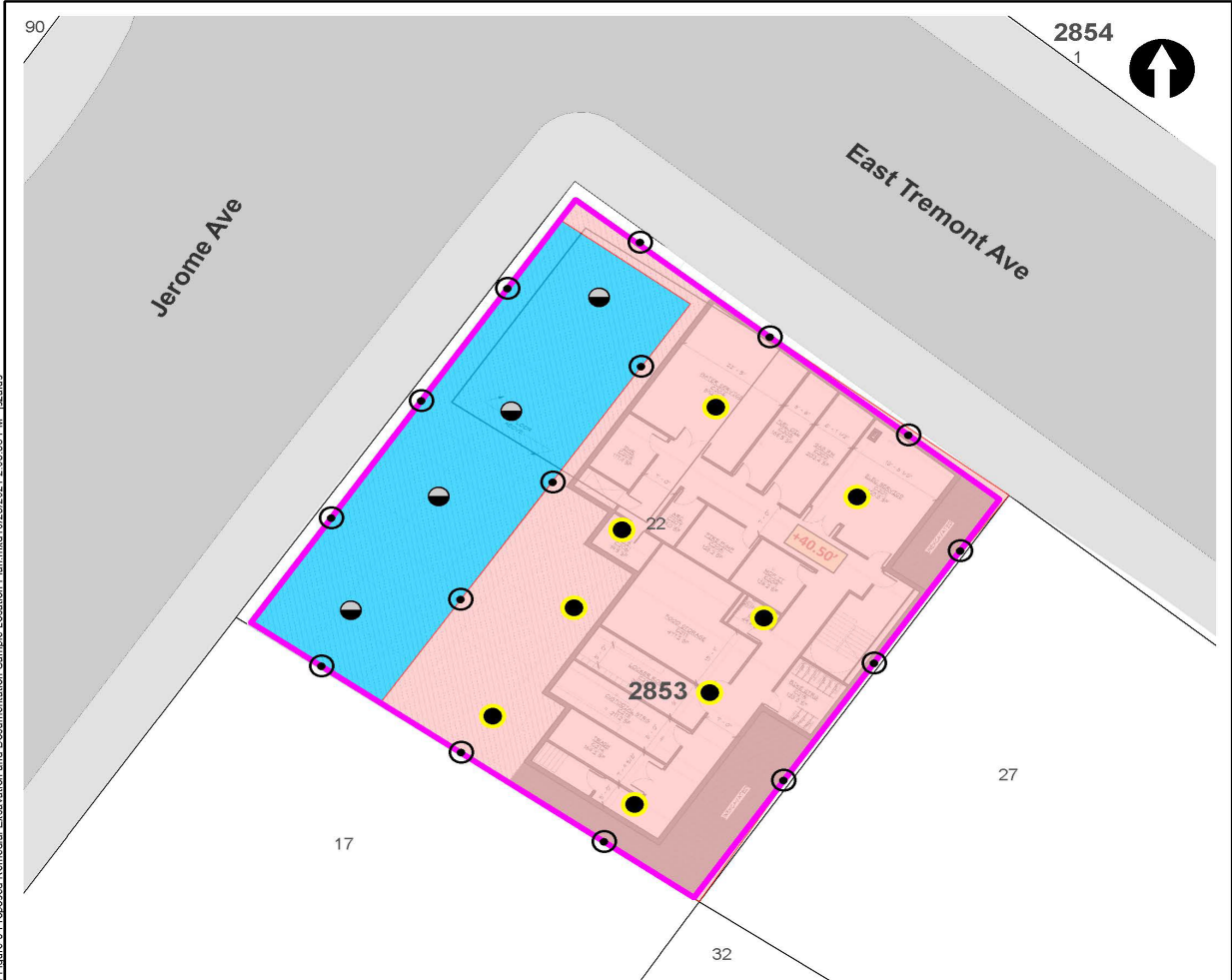

LEGEND

- PROJECT SITE BOUNDARY
- LOT BOUNDARY AND TAX LOT NUMBER
- 2853** BLOCK NUMBER
- REMEDIAL EXCAVATION TO APPROXIMATELY TWO FEET BELOW EXISTING GRADE
- REMEDIAL EXCAVATION TO GROUNDWATER (SOURCE AREA)

- CONFIRMATION DOCUMENTATION BOTTOM SAMPLE
- SOURCE AREA DOCUMENTATION BOTTOM SAMPLE
- DOCUMENTATION SIDEWALL SAMPLE

NOTE

REMEDIAL EXCAVATION WILL INCLUDE REMOVAL OF APPROXIMATELY 1,280 TONS (850 CUBIC YARDS) OF SOURCE MATERIAL ASSOCIATED WITH NYSDEC SPILL NO. 2103719 AND APPROXIMATELY 860 TONS (570 CUBIC YARDS) OF SOIL/FILL FROM THE UPPER 2 FEET SITE-WIDE.

Map Source:
NYC/DCP (NYC Dept. of City Planning) GIS database

© 2021 AKRF. W:\Projects\210024 - 1566 JEROME AVENUE\Technical\GIS and Graphics\SR\RAW\Fig210024_Figure 9 Proposed Remedial Excavation and Documentation Sample Location Plan.mxd 10/25/2021 2:05:38 PM iszslus



440 Park Avenue South, New York, NY 10016

1956 Jerome Avenue
Bronx, New York

**TRACK 4 CLEANUP AND DOCUMENTATION
SAMPLE LOCATION PLAN**

DATE	04/29/2022
PROJECT NO.	210024
FIGURE	11

Site Photographs

Photograph 1 -
Delivery of an empty
fuel tank which will
eventually service
the building.



Photograph 2-
Casino covering a soil
stockpile before the
rain begins.



Photograph 3-
Grading soil in grid
WC-04, view facing
east.



Upwind Station

Time	Instantaneous VOC (ppm)	Instantaneous Mass Conc. Total (mg/m ³)	Mass Conc. Total mg/m ³ AVG 15m (mg/m ³)	Dust Exceedance	VOC ppm AVG 15m (ppm)	VOC Exceedance
3/23/2023 8:15	0	0.074	0.074	No	0	No
3/23/2023 8:16	0	0.046	0.06	No	0	No
3/23/2023 8:17	0	0.059	0.0597	No	0	No
3/23/2023 8:18	0	0.051	0.0575	No	0	No
3/23/2023 8:19	0	0.048	0.0556	No	0	No
3/23/2023 8:20	0	0.09	0.0613	No	0	No
3/23/2023 8:21	0	0.048	0.0594	No	0	No
3/23/2023 8:22	0	0.049	0.0581	No	0	No
3/23/2023 8:23	0	0.044	0.0566	No	0	No
3/23/2023 8:24	0	0.044	0.0553	No	0	No
3/23/2023 8:25	0	0.045	0.0544	No	0	No
3/23/2023 8:26	0	0.048	0.0538	No	0	No
3/23/2023 8:27	0	0.042	0.0529	No	0	No
3/23/2023 8:28	0	0.042	0.0521	No	0	No
3/23/2023 8:29	0	0.044	0.0516	No	0	No
3/23/2023 8:30	0	0.045	0.0497	No	0	No
3/23/2023 8:31	0	0.044	0.0495	No	0	No
3/23/2023 8:32	0	0.045	0.0486	No	0	No
3/23/2023 8:33	0	0.046	0.0483	No	0	No
3/23/2023 8:34	0	0.045	0.0481	No	0	No
3/23/2023 8:35	0	0.043	0.0449	No	0	No
3/23/2023 8:36	0	0.043	0.0446	No	0	No
3/23/2023 8:37	0	0.043	0.0442	No	0	No
3/23/2023 8:38	0	0.046	0.0443	No	0	No
3/23/2023 8:39	0	0.047	0.0445	No	0	No
3/23/2023 8:40	0	0.043	0.0444	No	0	No
3/23/2023 8:41	0	0.043	0.0441	No	0	No
3/23/2023 8:42	0	0.042	0.0441	No	0	No
3/23/2023 8:43	0	0.044	0.0442	No	0	No
3/23/2023 8:44	0	0.045	0.0443	No	0	No
3/23/2023 8:45	0	0.045	0.0443	No	0	No
3/23/2023 8:46	0	0.047	0.0445	No	0	No
3/23/2023 8:47	0	0.048	0.0447	No	0	No
3/23/2023 8:48	0	0.047	0.0447	No	0	No
3/23/2023 8:49	0	0.048	0.0449	No	0	No
3/23/2023 8:50	0	0.051	0.0455	No	0	No
3/23/2023 8:51	0	0.059	0.0465	No	0	No
3/23/2023 8:52	0	0.049	0.0469	No	0	No
3/23/2023 8:53	0	0.049	0.0471	No	0	No
3/23/2023 8:54	0	0.044	0.0469	No	0	No
3/23/2023 8:55	0	0.046	0.0471	No	0	No
3/23/2023 8:56	0	0.068	0.0488	No	0	No
3/23/2023 8:57	0	0.043	0.0489	No	0	No
3/23/2023 8:58	0	0.044	0.0489	No	0	No
3/23/2023 8:59	0	0.044	0.0488	No	0	No
3/23/2023 9:00	0	0.048	0.049	No	0	No
3/23/2023 9:01	0	0.055	0.0495	No	0	No
3/23/2023 9:02	0	0.052	0.0498	No	0	No
3/23/2023 9:03	0	0.052	0.0501	No	0	No
3/23/2023 9:04	0	0.053	0.0505	No	0	No
3/23/2023 9:05	0	0.048	0.0503	No	0	No
3/23/2023 9:06	0	0.045	0.0493	No	0	No

Upwind Station

Time	Instantaneous VOC (ppm)	Instantaneous Mass Conc. Total (mg/m ³)	Mass Conc. Total mg/m ³ AVG 15m (mg/m ³)	Dust Exceedance	VOC ppm AVG 15m (ppm)	VOC Exceedance
3/23/2023 9:07	0	0.044	0.049	No	0	No
3/23/2023 9:08	0	0.043	0.0486	No	0	No
3/23/2023 9:09	0	0.048	0.0489	No	0	No
3/23/2023 9:10	0	0.041	0.0485	No	0	No
3/23/2023 9:11	0	0.041	0.0467	No	0	No
3/23/2023 9:12	0	0.047	0.047	No	0	No
3/23/2023 9:13	0	0.049	0.0473	No	0	No
3/23/2023 9:14	0	0.047	0.0475	No	0	No
3/23/2023 9:15	0	0.044	0.0473	No	0	No
3/23/2023 9:16	0	0.046	0.0467	No	0	No
3/23/2023 9:17	0	0.044	0.0461	No	0	No
3/23/2023 9:18	0	0.042	0.0455	No	0	No
3/23/2023 9:19	0	0.046	0.045	No	0	No
3/23/2023 9:20	0	0.057	0.0456	No	0	No
3/23/2023 9:21	0	0.051	0.046	No	0	No
3/23/2023 9:22	0	0.042	0.0459	No	0	No
3/23/2023 9:23	0	0.042	0.0458	No	0	No
3/23/2023 9:24	0	0.041	0.0453	No	0	No
3/23/2023 9:25	0	0.043	0.0455	No	0	No
3/23/2023 9:26	0	0.044	0.0457	No	0	No
3/23/2023 9:27	0	0.042	0.0453	No	0	No
3/23/2023 9:28	0	0.044	0.045	No	0	No
3/23/2023 9:29	0	0.046	0.0449	No	0	No
3/23/2023 9:30	0	0.046	0.0451	No	0	No
3/23/2023 9:31	0	0.047	0.0451	No	0	No
3/23/2023 9:32	0	0.044	0.0451	No	0	No
3/23/2023 9:33	0	0.045	0.0453	No	0	No
3/23/2023 9:34	0	0.042	0.0451	No	0	No
3/23/2023 9:35	0	0.042	0.0441	No	0	No
3/23/2023 9:36	0	0.041	0.0434	No	0	No
3/23/2023 9:37	0	0.045	0.0436	No	0	No
3/23/2023 9:38	0	0.044	0.0437	No	0	No
3/23/2023 9:39	0	0.044	0.0439	No	0	No
3/23/2023 9:40	0	0.043	0.0439	No	0	No
3/23/2023 9:41	0	0.044	0.0439	No	0	No
3/23/2023 9:42	0	0.051	0.0445	No	0	No
3/23/2023 9:43	0	0.046	0.0447	No	0	No
3/23/2023 9:44	0	0.044	0.0445	No	0	No
3/23/2023 9:45	0	0.049	0.0447	No	0	No
3/23/2023 9:46	0	0.048	0.0448	No	0	No
3/23/2023 9:47	0	0.047	0.045	No	0	No
3/23/2023 9:48	0	0.047	0.0451	No	0	No
3/23/2023 9:49	0	0.047	0.0455	No	0	No
3/23/2023 9:50	0	0.049	0.0459	No	0	No
3/23/2023 9:51	0.047	0.069	0.0478	No	0.0031	No
3/23/2023 9:52	0	0.072	0.0496	No	0.0031	No
3/23/2023 9:53	0	0.048	0.0499	No	0.0031	No
3/23/2023 9:54	0	0.048	0.0501	No	0.0031	No
3/23/2023 9:55	0	0.049	0.0505	No	0.0031	No
3/23/2023 9:56	0	0.046	0.0507	No	0.0031	No
3/23/2023 9:57	0	0.047	0.0504	No	0.0031	No
3/23/2023 9:58	0	0.051	0.0507	No	0.0031	No

Upwind Station

Time	Instantaneous VOC (ppm)	Instantaneous Mass Conc. Total (mg/m ³)	Mass Conc. Total mg/m ³ AVG 15m (mg/m ³)	Dust Exceedance	VOC ppm AVG 15m (ppm)	VOC Exceedance
3/23/2023 9:59	0	0.054	0.0514	No	0.0031	No
3/23/2023 10:00	0	0.051	0.0515	No	0.0031	No
3/23/2023 10:01	0	0.052	0.0518	No	0.0031	No
3/23/2023 10:02	0	0.05	0.052	No	0.0031	No
3/23/2023 10:03	0	0.048	0.0521	No	0.0031	No
3/23/2023 10:04	0	0.048	0.0521	No	0.0031	No
3/23/2023 10:05	0	0.049	0.0521	No	0.0031	No
3/23/2023 10:06	0	0.047	0.0507	No	0	No
3/23/2023 10:07	0	0.049	0.0491	No	0	No
3/23/2023 10:08	0	0.049	0.0492	No	0	No
3/23/2023 10:09	0	0.049	0.0493	No	0	No
3/23/2023 10:10	0	0.048	0.0492	No	0	No
3/23/2023 10:11	0	0.049	0.0494	No	0	No
3/23/2023 10:12	0	0.049	0.0495	No	0	No
3/23/2023 10:13	0	0.049	0.0494	No	0	No
3/23/2023 10:14	0	0.047	0.0489	No	0	No
3/23/2023 10:15	0	0.047	0.0487	No	0	No
3/23/2023 10:16	0	0.047	0.0483	No	0	No
3/23/2023 10:17	0	0.047	0.0481	No	0	No
3/23/2023 10:18	0	0.047	0.0481	No	0	No
3/23/2023 10:19	0	0.048	0.0481	No	0	No
3/23/2023 10:20	0	0.047	0.0479	No	0	No
3/23/2023 10:21	0	0.047	0.0479	No	0	No
3/23/2023 10:22	0	0.049	0.0479	No	0	No
3/23/2023 10:23	0	0.049	0.0479	No	0	No
3/23/2023 10:24	0	0.047	0.0478	No	0	No
3/23/2023 10:25	0	0.053	0.0481	No	0	No
3/23/2023 10:26	0.06	0.062	0.049	No	0.004	No
3/23/2023 10:27	0.139	0.066	0.0501	No	0.0133	No
3/23/2023 10:28	0.219	0.06	0.0509	No	0.0279	No
3/23/2023 10:29	0.029	0.064	0.052	No	0.0298	No
3/23/2023 10:30	0.066	0.054	0.0525	No	0.0342	No
3/23/2023 10:31	0.02	0.054	0.0529	No	0.0355	No
3/23/2023 10:32	0	0.051	0.0532	No	0.0355	No
3/23/2023 10:33	0.048	0.08	0.0554	No	0.0387	No
3/23/2023 10:34	0.011	0.069	0.0568	No	0.0395	No
3/23/2023 10:35	0.041	0.065	0.058	No	0.0422	No
3/23/2023 10:36	0	0.056	0.0586	No	0.0422	No
3/23/2023 10:37	0	0.056	0.0591	No	0.0422	No
3/23/2023 10:38	0	0.058	0.0597	No	0.0422	No
3/23/2023 10:39	0.008	0.069	0.0611	No	0.0427	No
3/23/2023 10:40	0	0.066	0.062	No	0.0427	No
3/23/2023 10:41	0	0.058	0.0617	No	0.0387	No
3/23/2023 10:42	0	0.073	0.0622	No	0.0295	No
3/23/2023 10:43	0	0.069	0.0628	No	0.0149	No
3/23/2023 10:44	0	0.064	0.0628	No	0.0129	No
3/23/2023 10:45	0.025	0.115	0.0669	No	0.0102	No
3/23/2023 10:46	0.107	0.11	0.0706	No	0.016	No
3/23/2023 10:47	0.073	0.09	0.0732	No	0.0209	No
3/23/2023 10:48	0.019	0.083	0.0734	No	0.0189	No
3/23/2023 10:49	0.011	0.093	0.075	No	0.0189	No
3/23/2023 10:50	0.086	0.081	0.0761	No	0.0219	No

Upwind Station						
Time	Instantaneous VOC (ppm)	Instantaneous Mass Conc. Total (mg/m ³)	Mass Conc. Total mg/m ³ AVG 15m (mg/m ³)	Dust Exceedance	VOC ppm AVG 15m (ppm)	VOC Exceedance
3/23/2023 10:51	0	0.084	0.0779	No	0.0219	No
3/23/2023 10:52	0	0.075	0.0792	No	0.0219	No
3/23/2023 10:53	0	0.054	0.0789	No	0.0219	No
3/23/2023 10:54	0.043	0.062	0.0785	No	0.0243	No
3/23/2023 10:55	0	0.078	0.0793	No	0.0243	No
3/23/2023 10:56	0	0.076	0.0805	No	0.0243	No
3/23/2023 10:57	0.015	0.062	0.0797	No	0.0253	No
3/23/2023 10:58	0	0.068	0.0797	No	0.0253	No
3/23/2023 10:59	0	0.072	0.0802	No	0.0253	No
3/23/2023 11:00	0.03	0.072	0.0773	No	0.0256	No
3/23/2023 11:01	0.031	0.066	0.0744	No	0.0205	No
3/23/2023 11:02	0.075	0.067	0.0729	No	0.0207	No
3/23/2023 11:03	0.001	0.05	0.0707	No	0.0195	No
3/23/2023 11:04	0	0.061	0.0685	No	0.0187	No
3/23/2023 11:05	0.002	0.055	0.0668	No	0.0131	No
3/23/2023 11:06	0.118	0.057	0.065	No	0.021	No
3/23/2023 11:07	0.058	0.064	0.0643	No	0.0249	No
3/23/2023 11:08	0	0.058	0.0645	No	0.0249	No
3/23/2023 11:09	0	0.044	0.0633	No	0.022	No
3/23/2023 11:10	0.008	0.044	0.0611	No	0.0225	No
3/23/2023 11:11	0.036	0.044	0.0589	No	0.0249	No
3/23/2023 11:12	0.008	0.044	0.0577	No	0.0245	No
3/23/2023 11:13	0.046	0.045	0.0562	No	0.0275	No
3/23/2023 11:14	0.011	0.044	0.0543	No	0.0283	No
3/23/2023 11:15	0.203	0.05	0.0529	No	0.0398	No
3/23/2023 11:16	0.06	0.051	0.0519	No	0.0417	No
3/23/2023 11:17	0.1	0.051	0.0508	No	0.0434	No
3/23/2023 11:18	0.088	0.052	0.0509	No	0.0492	No
3/23/2023 11:19	0.074	0.053	0.0504	No	0.0541	No
3/23/2023 11:20	0.065	0.057	0.0505	No	0.0583	No
3/23/2023 11:21	0.097	0.057	0.0505	No	0.0569	No
3/23/2023 11:22	0.033	0.054	0.0499	No	0.0553	No
3/23/2023 11:23	0.026	0.045	0.049	No	0.057	No
3/23/2023 11:24	0.046	0.053	0.0496	No	0.0601	No
3/23/2023 11:25	0.021	0.046	0.0497	No	0.0609	No
3/23/2023 11:26	0.029	0.047	0.0499	No	0.0605	No
3/23/2023 11:27	0.011	0.046	0.0501	No	0.0607	No
3/23/2023 11:28	0.023	0.046	0.0501	No	0.0591	No
3/23/2023 11:29	0.036	0.048	0.0504	No	0.0608	No
3/23/2023 11:30	0.036	0.049	0.0503	No	0.0497	No
3/23/2023 11:31	0.014	0.046	0.05	No	0.0466	No
3/23/2023 11:32	0.022	0.05	0.0499	No	0.0414	No
3/23/2023 11:33	0.025	0.058	0.0503	No	0.0372	No
3/23/2023 11:34	0.055	0.059	0.0507	No	0.0359	No
3/23/2023 11:35	0.055	0.068	0.0515	No	0.0353	No
3/23/2023 11:36	0.047	0.076	0.0527	No	0.0319	No
3/23/2023 11:37	0.122	0.056	0.0529	No	0.0379	No
3/23/2023 11:38	0.063	0.06	0.0539	No	0.0403	No
3/23/2023 11:39	0.028	0.056	0.0541	No	0.0391	No
3/23/2023 11:40	0.033	0.062	0.0551	No	0.0399	No
3/23/2023 11:41	0.011	0.068	0.0565	No	0.0387	No
3/23/2023 11:42	0.003	0.056	0.0572	No	0.0382	No

Downwind Station						
Time	Instantaneous VOC (ppm)	Instantaneous Mass Conc. Total (mg/m ³)	Mass Conc. Total mg/m ³ AVG 15m (mg/m ³)	Dust Exceedance	VOC ppm AVG 15m (ppm)	VOC Exceedance
3/23/2023 8:13	0			No	0	No
3/23/2023 8:14	0	0.065	0.065	No	0	No
3/23/2023 8:15	0	0.066	0.0655	No	0	No
3/23/2023 8:16	0.016	0.073	0.068	No	0.004	No
3/23/2023 8:17	0	0.021	0.0563	No	0.0032	No
3/23/2023 8:18	0	0.021	0.0492	No	0.0027	No
3/23/2023 8:19	0	0.122	0.0613	No	0.0023	No
3/23/2023 8:20	0	0.021	0.0556	No	0.002	No
3/23/2023 8:21	0	0.028	0.0521	No	0.0018	No
3/23/2023 8:22	0	0.024	0.049	No	0.0016	No
3/23/2023 8:23	0	0.024	0.0465	No	0.0015	No
3/23/2023 8:24	0	0.026	0.0446	No	0.0013	No
3/23/2023 8:25	0	0.022	0.0428	No	0.0012	No
3/23/2023 8:26	0	0.027	0.0415	No	0.0011	No
3/23/2023 8:27	0	0.029	0.0406	No	0.0011	No
3/23/2023 8:28	0	0.09	0.0439	No	0.0011	No
3/23/2023 8:29	0	0.022	0.0411	No	0.0011	No
3/23/2023 8:30	0	0.021	0.0381	No	0.0011	No
3/23/2023 8:31	0	0.021	0.0346	No	0	No
3/23/2023 8:32	0	0.019	0.0345	No	0	No
3/23/2023 8:33	0	0.02	0.0344	No	0	No
3/23/2023 8:34	0	0.024	0.0279	No	0	No
3/23/2023 8:35	0	0.027	0.0283	No	0	No
3/23/2023 8:36	0	0.016	0.0275	No	0	No
3/23/2023 8:37	0	0.017	0.027	No	0	No
3/23/2023 8:38	0	0.019	0.0267	No	0	No
3/23/2023 8:39	0	0.016	0.026	No	0	No
3/23/2023 8:40	0	0.016	0.0256	No	0	No
3/23/2023 8:41	0	0.018	0.025	No	0	No
3/23/2023 8:42	0	0.017	0.0242	No	0	No
3/23/2023 8:43	0	0.017	0.0193	No	0	No
3/23/2023 8:44	0	0.016	0.0189	No	0	No
3/23/2023 8:45	0	0.017	0.0187	No	0	No
3/23/2023 8:46	0	0.02	0.0186	No	0	No
3/23/2023 8:47	0	0.018	0.0185	No	0	No
3/23/2023 8:48	0	0.016	0.0183	No	0	No
3/23/2023 8:49	0	0.019	0.0179	No	0	No
3/23/2023 8:50	0	0.019	0.0174	No	0	No
3/23/2023 8:51	0	0.065	0.0207	No	0	No
3/23/2023 8:52	0	0.054	0.0231	No	0	No
3/23/2023 8:53	0	0.018	0.0231	No	0	No
3/23/2023 8:54	0	0.019	0.0233	No	0	No
3/23/2023 8:55	0	0.024	0.0238	No	0	No
3/23/2023 8:56	0	0.018	0.0238	No	0	No
3/23/2023 8:57	0	0.017	0.0238	No	0	No
3/23/2023 8:58	0.064	0.013	0.0235	No	0.0043	No
3/23/2023 8:59	0	0.014	0.0234	No	0.0043	No
3/23/2023 9:00	0.007	0.02	0.0236	No	0.0047	No
3/23/2023 9:01	0	0.021	0.0237	No	0.0047	No
3/23/2023 9:02	0	0.02	0.0238	No	0.0047	No
3/23/2023 9:03	0	0.016	0.0238	No	0.0047	No
3/23/2023 9:04	0	0.017	0.0237	No	0.0047	No
3/23/2023 9:05	0	0.016	0.0235	No	0.0047	No

Downwind Station						
Time	Instantaneous VOC (ppm)	Instantaneous Mass Conc. Total (mg/m ³)	Mass Conc. Total mg/m ³ AVG 15m (mg/m ³)	Dust Exceedance	VOC ppm AVG 15m (ppm)	VOC Exceedance
3/23/2023 9:06	0	0.013	0.02	No	0.0047	No
3/23/2023 9:07	0.003	0.015	0.0174	No	0.0049	No
3/23/2023 9:08	0	0.013	0.0171	No	0.0049	No
3/23/2023 9:09	0.004	0.007	0.0163	No	0.0052	No
3/23/2023 9:10	0.026	0.009	0.0153	No	0.0069	No
3/23/2023 9:11	0	0.009	0.0147	No	0.0069	No
3/23/2023 9:12	0	0.009	0.0141	No	0.0069	No
3/23/2023 9:13	0	0.005	0.0136	No	0.0027	No
3/23/2023 9:14	0.046	0.009	0.0133	No	0.0057	No
3/23/2023 9:15	0.067	0.013	0.0128	No	0.0097	No
3/23/2023 9:16	0.003	0.017	0.0125	No	0.0099	No
3/23/2023 9:17	0.011	0.01	0.0119	No	0.0107	No
3/23/2023 9:18	0.056	0.011	0.0115	No	0.0144	No
3/23/2023 9:19	0.025	0.013	0.0113	No	0.0161	No
3/23/2023 9:20	0.039	0.033	0.0124	No	0.0187	No
3/23/2023 9:21	0.06	0.026	0.0133	No	0.0227	No
3/23/2023 9:22	0	0.018	0.0135	No	0.0225	No
3/23/2023 9:23	0.005	0.01	0.0133	No	0.0228	No
3/23/2023 9:24	0.004	0.01	0.0135	No	0.0228	No
3/23/2023 9:25	0.016	0.009	0.0135	No	0.0221	No
3/23/2023 9:26	0	0.007	0.0133	No	0.0221	No
3/23/2023 9:27	0.002	0.007	0.0132	No	0.0223	No
3/23/2023 9:28	0	0.005	0.0132	No	0.0223	No
3/23/2023 9:29	0.027	0.008	0.0131	No	0.021	No
3/23/2023 9:30	0	0.005	0.0126	No	0.0165	No
3/23/2023 9:31	0.079	0.007	0.0119	No	0.0216	No
3/23/2023 9:32	0.036	0.004	0.0115	No	0.0233	No
3/23/2023 9:33	0.112	0.012	0.0116	No	0.027	No
3/23/2023 9:34	0.019	0.011	0.0115	No	0.0266	No
3/23/2023 9:35	0.008	0.008	0.0098	No	0.0245	No
3/23/2023 9:36	0.133	0.015	0.0091	No	0.0294	No
3/23/2023 9:37	0.19	0.009	0.0085	No	0.0421	No
3/23/2023 9:38	0.955	0.009	0.0084	No	0.1054	No
3/23/2023 9:39	0.562	0.015	0.0087	No	0.1426	No
3/23/2023 9:40	0.279	0.024	0.0097	No	0.1601	No
3/23/2023 9:41	0.217	0.016	0.0103	No	0.1746	No
3/23/2023 9:42	0.195	0.014	0.0108	No	0.1875	No
3/23/2023 9:43	0.074	0.006	0.0109	No	0.1924	No
3/23/2023 9:44	0.092	0.004	0.0106	No	0.1967	No
3/23/2023 9:45	0.026	0.004	0.0105	No	0.1985	No
3/23/2023 9:46	0.101	0.006	0.0105	No	0.1999	No
3/23/2023 9:47	0.062	0.008	0.0107	No	0.2017	No
3/23/2023 9:48	0.154	0.008	0.0105	No	0.2045	No
3/23/2023 9:49	0.294	0.019	0.011	No	0.2228	No
3/23/2023 9:50	0.21	0.018	0.0117	No	0.2363	No
3/23/2023 9:51	0.225	0.018	0.0119	No	0.2424	No
3/23/2023 9:52	0.206	0.017	0.0124	No	0.2435	No
3/23/2023 9:53	0.222	0.016	0.0129	No	0.1946	No
3/23/2023 9:54	0.243	0.015	0.0129	No	0.1733	No
3/23/2023 9:55	0.234	0.02	0.0126	No	0.1703	No
3/23/2023 9:56	0.116	0.012	0.0123	No	0.1636	No
3/23/2023 9:57	0.147	0.008	0.0119	No	0.1604	No
3/23/2023 9:58	0.097	0.017	0.0127	No	0.1619	No

Downwind Station						
Time	Instantaneous VOC (ppm)	Instantaneous Mass Conc. Total (mg/m ³)	Mass Conc. Total mg/m ³ AVG 15m (mg/m ³)	Dust Exceedance	VOC ppm AVG 15m (ppm)	VOC Exceedance
3/23/2023 9:59	0.147	0.021	0.0138	No	0.1656	No
3/23/2023 10:00	0.164	0.02	0.0149	No	0.1748	No
3/23/2023 10:01	0.155	0.026	0.0162	No	0.1784	No
3/23/2023 10:02	0.112	0.022	0.0171	No	0.1817	No
3/23/2023 10:03	0.078	0.017	0.0177	No	0.1767	No
3/23/2023 10:04	0.138	0.016	0.0175	No	0.1663	No
3/23/2023 10:07	0.114	0.056	0.0205	No	0.1513	No
3/23/2023 10:08	0.066	0.034	0.0218	No	0.1393	No
3/23/2023 10:09	0.019	0.017	0.022	No	0.1221	No
3/23/2023 10:10	0.214	0.013	0.0215	No	0.1205	No
3/23/2023 10:11	0.019	0.012	0.0215	No	0.1131	No
3/23/2023 10:12	0.005	0.019	0.0223	No	0.1022	No
3/23/2023 10:13	0.1	0.017	0.0223	No	0.1024	No
3/23/2023 10:14	0.065	0.015	0.0218	No	0.0961	No
3/23/2023 10:15	0.161	0.014	0.0214	No	0.0958	No
3/23/2023 10:16	0.049	0.013	0.0204	No	0.0877	No
3/23/2023 10:17	0.023	0.015	0.0198	No	0.0808	No
3/23/2023 10:18	0.077	0.013	0.0195	No	0.0808	No
3/23/2023 10:19	0.08	0.013	0.0193	No	0.0763	No
3/23/2023 10:20	0.125	0.012	0.0188	No	0.0798	No
3/23/2023 10:21	0.068	0.014	0.0185	No	0.079	No
3/23/2023 10:22	0.217	0.016	0.0158	No	0.0859	No
3/23/2023 10:23	0.181	0.023	0.0151	No	0.0935	No
3/23/2023 10:24	0.109	0.022	0.0154	No	0.0995	No
3/23/2023 10:25	0.03	0.024	0.0161	No	0.0873	No
3/23/2023 10:26	0.043	0.019	0.0166	No	0.0889	No
3/23/2023 10:27	0.234	0.017	0.0165	No	0.1041	No
3/23/2023 10:28	0.303	0.023	0.0169	No	0.1177	No
3/23/2023 10:29	0.403	0.046	0.0189	No	0.1402	No
3/23/2023 10:30	0.245	0.156	0.0284	No	0.1458	No
3/23/2023 10:31	0.22	0.057	0.0313	No	0.1572	No
3/23/2023 10:32	0.14	0.026	0.0321	No	0.165	No
3/23/2023 10:33	0.134	0.017	0.0323	No	0.1688	No
3/23/2023 10:34	0.212	0.038	0.034	No	0.1776	No
3/23/2023 10:35	0.189	0.079	0.0385	No	0.1819	No
3/23/2023 10:36	0.196	0.044	0.0405	No	0.1904	No
3/23/2023 10:37	0.117	0.018	0.0406	No	0.1837	No
3/23/2023 10:38	0.803	0.02	0.0404	No	0.2252	No
3/23/2023 10:39	0.161	0.046	0.042	No	0.2287	No
3/23/2023 10:40	0.135	0.175	0.0521	No	0.2357	No
3/23/2023 10:41	0.178	0.102	0.0576	No	0.2447	No
3/23/2023 10:42	0.335	0.077	0.0616	No	0.2514	No
3/23/2023 10:43	0.267	0.092	0.0662	No	0.249	No
3/23/2023 10:44	0.154	0.228	0.0783	No	0.2324	No
3/23/2023 10:45	0.132	0.601	0.108	No	0.2249	No
3/23/2023 10:46	0.277	0.616	0.1453	No	0.2287	No
3/23/2023 10:47	0.234	0.632	0.1857	Yes	0.2349	No
3/23/2023 10:48	0.218	0.645	0.2275	Yes	0.2405	No
3/23/2023 10:49	0.127	0.545	0.2613	Yes	0.2349	No
3/23/2023 10:50	0.116	0.53	0.2914	Yes	0.23	No
3/23/2023 10:51	0.358	0.479	0.3204	Yes	0.2408	No
3/23/2023 10:52	0.163	0.164	0.3301	Yes	0.2439	No
3/23/2023 10:53	0.166	0.18	0.3408	Yes	0.2014	No

Downwind Station						
Time	Instantaneous VOC (ppm)	Instantaneous Mass Conc. Total (mg/m³)	Mass Conc. Total mg/m³ AVG 15m (mg/m³)	Dust Exceedance	VOC ppm AVG 15m (ppm)	VOC Exceedance
3/23/2023 10:54	0.203	0.054	0.3413	Yes	0.2042	No
3/23/2023 10:55	0.19	0.129	0.3383	Yes	0.2079	No
3/23/2023 10:56	0.25	0.055	0.3351	Yes	0.2127	No
3/23/2023 10:57	0.192	0.082	0.3355	Yes	0.2031	No
3/23/2023 10:58	0.213	0.293	0.3489	Yes	0.1995	No
3/23/2023 10:59	0.296	0.459	0.3643	Yes	0.209	No
3/23/2023 11:00	0.291	0.289	0.3435	Yes	0.2196	No
3/23/2023 11:01	0.229	0.175	0.3141	Yes	0.2164	No
3/23/2023 11:02	0.088	0.057	0.2757	Yes	0.2067	No
3/23/2023 11:03	0.09	0.115	0.2404	Yes	0.1981	No
3/23/2023 11:04	0.167	0.355	0.2277	Yes	0.2008	No
3/23/2023 11:05	0.03	0.138	0.2016	Yes	0.1951	No
3/23/2023 11:06	0.323	0.022	0.1711	Yes	0.1927	No
3/23/2023 11:07	0.125	0.084	0.1658	Yes	0.1902	No
3/23/2023 11:08	0.172	0.081	0.1592	Yes	0.1906	No
3/23/2023 11:09	0.061	0.02	0.1569	Yes	0.1811	No
3/23/2023 11:10	0.407	0.013	0.1492	No	0.1956	No
3/23/2023 11:11	0.473	0.013	0.1464	No	0.2105	No
3/23/2023 11:12	0.132	0.014	0.1419	No	0.2065	No
3/23/2023 11:13	0.344	0.012	0.1231	No	0.2152	No
3/23/2023 11:14	0.132	0.011	0.0933	No	0.2043	No
3/23/2023 11:15	0.201	0.015	0.075	No	0.1983	No
3/23/2023 11:16	0.075	0.015	0.0643	No	0.188	No
3/23/2023 11:17	0.144	0.015	0.0615	No	0.1917	No
3/23/2023 11:18	0.216	0.015	0.0549	No	0.2001	No
3/23/2023 11:19	0.388	0.018	0.0324	No	0.2149	No
3/23/2023 11:20	0.444	0.021	0.0246	No	0.2425	No
3/23/2023 11:21	0.166	0.021	0.0245	No	0.232	No
3/23/2023 11:22	0.045	0.015	0.0199	No	0.2267	No
3/23/2023 11:23	0.045	0.012	0.0153	No	0.2182	No
3/23/2023 11:24	0.186	0.012	0.0148	No	0.2265	No
3/23/2023 11:25	0.083	0.009	0.0145	No	0.2049	No
3/23/2023 11:26	0.053	0.012	0.0145	No	0.1769	No
3/23/2023 11:27	0.019	0.016	0.0146	No	0.1694	No
3/23/2023 11:28	0.016	0.015	0.0148	No	0.1475	No
3/23/2023 11:29	0.046	0.017	0.0152	No	0.1418	No
3/23/2023 11:30	0.098	0.016	0.0153	No	0.1349	No
3/23/2023 11:31	0.13	0.055	0.0179	No	0.1386	No
3/23/2023 11:32	0.101	0.288	0.0361	No	0.1357	No
3/23/2023 11:33	0.067	0.801	0.0885	No	0.1258	No
3/23/2023 11:34	0.11	0.253	0.1042	No	0.1073	No
3/23/2023 11:35	0.035	0.275	0.1211	No	0.08	No
3/23/2023 11:36	0.051	0.341	0.1425	No	0.0723	No
3/23/2023 11:37	0.29	0.167	0.1526	Yes	0.0887	No
3/23/2023 11:38	0.236	0.056	0.1555	Yes	0.1014	No
3/23/2023 11:39	0.124	0.072	0.1595	Yes	0.0973	No
3/23/2023 11:40	0.09	0.233	0.1745	Yes	0.0977	No
3/23/2023 11:41	0.226	0.235	0.1893	Yes	0.1093	No
3/23/2023 11:42	0.068	0.071	0.193	Yes	0.1125	No