



Daily Activity Report

Seton Brilla Charter School
1956 Jerome Avenue, Bronx, NY
BCP No. C203152

General Site Information

Date:	Wednesday, March 22, 2023
Weather:	Cloudy, 40-59°F
Wind Direction/Speed:	SW @4 mph
AKRF Personnel on Site:	Lucas Belangia
AKRF Equipment on Site:	Mini RAE 3000 Photoionization Detector [(PID) x1], 2 Fixed Air Monitoring Stations [DustTrak
Visitors:	None.

Contractor Information

Contracting Company	Main Personnel	Equipment
Casino Construction	Carlos	Excavator

Description and Location of Work Activities Performed

1) Four truckloads of stockpiled soil from grids WC-03 and WC-04 were sent for off-site disposal at the Clean Earth - Carteret facility in Carteret, NJ. The remaining stockpiled soil was covered with plastic sheeting at the end the day.

2) Pile cap construction activities continued.

Destination Facility	Daily Trucks	Total Trucks	Daily Approx. Cubic Yds	Total Approx. Cubic Yds	Total Site Loads	Total Approximate Cubic Yards
Clean Earth Carteret	4	89	80	1,780	182	3,640
Clean Earth Southeastern Pennsylvania	0	67	0	1,340		
Concrete Disposal	0	26	0	520		
N/A	0	0	0	0		
N/A	0	0	0	0		

CAMP Air Monitoring Results

CAMP Station	UPWIND				DOWNWIND		
Odors:	None.				None.		
VOC Action Level Exceedance(s):	None.				None.		
Particulate Action Level Exceedance(s):	None.				None.		
Maximum VOC Level (15 min ppm):	0.504				0.295		
Maximum Particulate Level (15 min mg/m ³):	0.034				0.046		

Notes: CAMP monitoring was performed throughout the day. No exceedances were recorded.





Additional Information

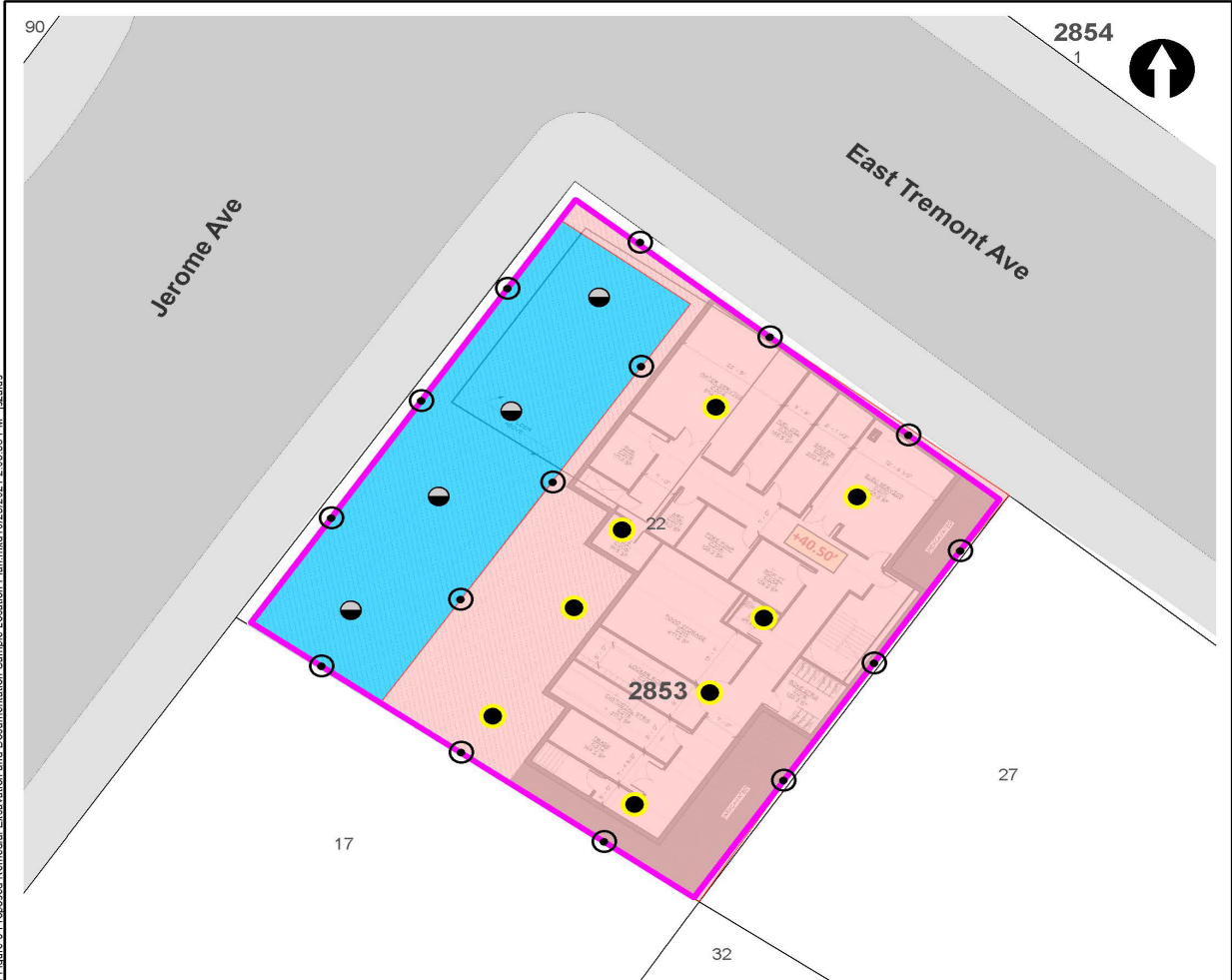

Planned Work Activity for Following Day/Week:	1) Excavation of soil/fill to uncover piles. 2) Cutting piles to final elevations 3) Exporting of soil off-site
Comments:	None.

Site Map



LEGEND

-  PROJECT SITE BOUNDARY
-  LOT BOUNDARY AND TAX LOT NUMBER
- 2853** BLOCK NUMBER
-  REMEDIAL EXCAVATION TO APPROXIMATELY TWO FEET BELOW EXISTING GRADE
-  REMEDIAL EXCAVATION TO GROUNDWATER (SOURCE AREA)

-  CONFIRMATION DOCUMENTATION BOTTOM SAMPLE
-  SOURCE AREA DOCUMENTATION BOTTOM SAMPLE
-  DOCUMENTATION SIDEWALL SAMPLE

NOTE

REMEDIAL EXCAVATION WILL INCLUDE REMOVAL OF APPROXIMATELY 1,280 TONS (850 CUBIC YARDS) OF SOURCE MATERIAL ASSOCIATED WITH NYSDEC SPILL NO. 2103719 AND APPROXIMATELY 860 TONS (570 CUBIC YARDS) OF SOIL/FILL FROM THE UPPER 2 FEET SITE-WIDE.



Map Source:
NYCDCP (NYC Dept. of City Planning) GIS database

© 2021 AKRF. W:\Projects\210024 - 1566 JEROME AVENUE\Technical\GIS and Graphics\SR\RAW\Fig210024_Figure 9 Proposed Remedial Excavation and Documentation Sample Location Plan.mxd 10/26/2021 2:05:38 PM iszslus



440 Park Avenue South, New York, NY 10016

1956 Jerome Avenue
Bronx, New York

**TRACK 4 CLEANUP AND DOCUMENTATION
SAMPLE LOCATION PLAN**

DATE	04/29/2022
PROJECT NO.	210024
FIGURE	11

Site Photographs

Photograph 1 -
Delivery of water
basin tank, which
was the focus of
today's work



Photograph 2-
Exporting of soil off-
site from WC-03/WC-
04



Photograph 3-
Grading soil in grid
WC-04, view facing
east.



Upwind Station

Time	Instantaneous VOC (ppm)	Instantaneous Mass Conc. Total (mg/m ³)	Mass Conc. Total mg/m ³ AVG 15m (mg/m ³)	Dust Exceedance	VOC ppm AVG 15m (ppm)	VOC Exceedance
3/20/2023 7:27	0.319	0.015	0.015	No	0	No
3/20/2023 7:28	0.225	0.016	0.0155	No	0	No
3/20/2023 7:29	0.198	0.066	0.0323	No	0.319	No
3/20/2023 7:30	0.18	0.018	0.0288	No	0.272	No
3/20/2023 7:31	0.166	0.027	0.0284	No	0.2473	No
3/20/2023 7:32	0.159	0.022	0.0273	No	0.2305	No
3/20/2023 7:33	0.147	0.016	0.0257	No	0.2176	No
3/20/2023 7:34	0.141	0.014	0.0243	No	0.2078	No
3/20/2023 7:35	0.16	0.015	0.0232	No	0.1991	No
3/20/2023 7:36	0.142	0.015	0.0224	No	0.1919	No
3/20/2023 7:37	0.142	0.026	0.0227	No	0.1883	No
3/20/2023 7:38	0.134	0.016	0.0222	No	0.1837	No
3/20/2023 7:39	0.133	0.015	0.0216	No	0.1799	No
3/20/2023 7:40	0.139	0.022	0.0216	No	0.1761	No
3/20/2023 7:41	0.137	0.02	0.0215	No	0.1728	No
3/20/2023 7:42	0.138	0.017	0.0217	No	0.1704	No
3/20/2023 7:43	0.14	0.026	0.0223	No	0.1681	No
3/20/2023 7:44	0.149	0.017	0.0191	No	0.1561	No
3/20/2023 7:45	0.156	0.016	0.0189	No	0.1504	No
3/20/2023 7:46	0.151	0.019	0.0184	No	0.1471	No
3/20/2023 7:47	0.144	0.022	0.0184	No	0.1455	No
3/20/2023 7:48	0.148	0.018	0.0185	No	0.1445	No
3/20/2023 7:49	0.138	0.017	0.0187	No	0.1435	No
3/20/2023 7:50	0.155	0.017	0.0189	No	0.1436	No
3/20/2023 7:51	0.138	0.017	0.019	No	0.1434	No
3/20/2023 7:52	0.14	0.017	0.0184	No	0.1431	No
3/20/2023 7:53	0.149	0.017	0.0185	No	0.1428	No
3/20/2023 7:54	0.142	0.018	0.0187	No	0.1427	No
3/20/2023 7:55	0.158	0.031	0.0193	No	0.1437	No
3/20/2023 7:56	0.159	0.033	0.0201	No	0.1443	No
3/20/2023 7:57	0.167	0.032	0.0211	No	0.1455	No
3/20/2023 7:58	0.157	0.024	0.021	No	0.147	No
3/20/2023 7:59	0.185	0.027	0.0217	No	0.1489	No
3/20/2023 8:00	0.167	0.061	0.0247	No	0.1501	No
3/20/2023 8:01	0.167	0.022	0.0249	No	0.1525	No
3/20/2023 8:02	0.162	0.019	0.0247	No	0.1532	No
3/20/2023 8:03	0.157	0.024	0.0251	No	0.1543	No
3/20/2023 8:04	0.167	0.021	0.0253	No	0.1555	No
3/20/2023 8:05	0.159	0.016	0.0253	No	0.1561	No
3/20/2023 8:06	0.174	0.022	0.0256	No	0.158	No
3/20/2023 8:07	0.173	0.024	0.0261	No	0.1583	No
3/20/2023 8:08	0.169	0.023	0.0265	No	0.1607	No
3/20/2023 8:09	0.169	0.02	0.0266	No	0.1629	No
3/20/2023 8:10	0.177	0.017	0.0257	No	0.1642	No
3/20/2023 8:11	0.176	0.017	0.0246	No	0.166	No
3/20/2023 8:12	0.18	0.019	0.0237	No	0.1673	No
3/20/2023 8:13	0.188	0.019	0.0234	No	0.1684	No
3/20/2023 8:14	0.194	0.02	0.0229	No	0.1693	No
3/20/2023 8:15	0.192	0.018	0.0201	No	0.1713	No
3/20/2023 8:16	0.202	0.032	0.0207	No	0.1719	No
3/20/2023 8:17	0.218	0.022	0.0209	No	0.1736	No
3/20/2023 8:18	0.201	0.021	0.0207	No	0.1759	No

Upwind Station

Time	Instantaneous VOC (ppm)	Instantaneous Mass Conc. Total (mg/m ³)	Mass Conc. Total mg/m ³ AVG 15m (mg/m ³)	Dust Exceedance	VOC ppm AVG 15m (ppm)	VOC Exceedance
3/20/2023 8:19	0.209	0.022	0.0208	No	0.1797	No
3/20/2023 8:20	0.215	0.021	0.0211	No	0.1826	No
3/20/2023 8:21	0.212	0.019	0.0209	No	0.1854	No
3/20/2023 8:22	0.217	0.023	0.0209	No	0.1891	No
3/20/2023 8:23	0.223	0.018	0.0205	No	0.1917	No
3/20/2023 8:24	0.222	0.038	0.0217	No	0.1946	No
3/20/2023 8:25	0.214	0.024	0.0222	No	0.1982	No
3/20/2023 8:26	0.222	0.02	0.0224	No	0.2017	No
3/20/2023 8:27	0.212	0.019	0.0224	No	0.2042	No
3/20/2023 8:28	0.222	0.053	0.0247	No	0.2073	No
3/20/2023 8:29	0.225	0.022	0.0248	No	0.2094	No
3/20/2023 8:30	0.224	0.02	0.0249	No	0.2117	No
3/20/2023 8:31	0.246	0.021	0.0242	No	0.2137	No
3/20/2023 8:32	0.235	0.034	0.025	No	0.2159	No
3/20/2023 8:33	0.236	0.023	0.0251	No	0.2188	No
3/20/2023 8:34	0.253	0.026	0.0254	No	0.2199	No
3/20/2023 8:35	0.25	0.028	0.0259	No	0.2223	No
3/20/2023 8:36	0.263	0.027	0.0264	No	0.2252	No
3/20/2023 8:37	0.289	0.027	0.0267	No	0.2275	No
3/20/2023 8:38	0.298	0.028	0.0273	No	0.2309	No
3/20/2023 8:39	0.278	0.028	0.0267	No	0.2357	No
3/20/2023 8:40	0.282	0.029	0.027	No	0.2407	No
3/20/2023 8:41	0.277	0.034	0.0279	No	0.2445	No
3/20/2023 8:42	0.267	0.032	0.0288	No	0.249	No
3/20/2023 8:43	0.289	0.032	0.0274	No	0.2527	No
3/20/2023 8:44	0.296	0.024	0.0275	No	0.2563	No
3/20/2023 8:45	0.38	0.029	0.0281	No	0.2608	No
3/20/2023 8:46	0.547	0.028	0.0286	No	0.2655	No
3/20/2023 8:47	0.344	0.029	0.0283	No	0.2759	No
3/20/2023 8:48	0.376	0.027	0.0285	No	0.296	No
3/20/2023 8:49	0.316	0.023	0.0283	No	0.3033	No
3/20/2023 8:50	0.378	0.029	0.0284	No	0.3126	No
3/20/2023 8:51	0.419	0.025	0.0283	No	0.3168	No
3/20/2023 8:52	0.389	0.029	0.0284	No	0.3253	No
3/20/2023 8:53	0.334	0.025	0.0282	No	0.3357	No
3/20/2023 8:54	0.358	0.022	0.0278	No	0.3424	No
3/20/2023 8:55	0.396	0.023	0.0274	No	0.3448	No
3/20/2023 8:56	0.412	0.022	0.0266	No	0.3501	No
3/20/2023 8:57	0.346	0.023	0.026	No	0.3577	No
3/20/2023 8:58	0.329	0.023	0.0254	No	0.3667	No
3/20/2023 8:59	0.415	0.028	0.0257	No	0.372	No
3/20/2023 9:00	0.423	0.031	0.0258	No	0.3747	No
3/20/2023 9:01	0.406	0.029	0.0259	No	0.3826	No
3/20/2023 9:02	0.375	0.022	0.0254	No	0.3855	No
3/20/2023 9:03	0.359	0.023	0.0251	No	0.3761	No
3/20/2023 9:04	0.362	0.023	0.0251	No	0.3781	No
3/20/2023 9:05	0.352	0.022	0.0247	No	0.377	No
3/20/2023 9:06	0.344	0.029	0.0249	No	0.3801	No
3/20/2023 9:07	0.342	0.02	0.0207	No	0.3783	No
3/20/2023 9:08	0.362	0.015	0.0203	No	0.3733	No
3/20/2023 9:09	0.334	0.021	0.0203	No	0.3702	No
3/20/2023 9:10	0.33	0.014	0.0196	No	0.3721	No

Upwind Station

Time	Instantaneous VOC (ppm)	Instantaneous Mass Conc. Total (mg/m ³)	Mass Conc. Total mg/m ³ AVG 15m (mg/m ³)	Dust Exceedance	VOC ppm AVG 15m (ppm)	VOC Exceedance
3/20/2023 9:11	0.331	0.013	0.018	No	0.3705	No
3/20/2023 9:12	0.324	0.018	0.017	No	0.3661	No
3/20/2023 9:13	0.324	0.015	0.0168	No	0.3607	No
3/20/2023 9:14	0.31	0.016	0.0168	No	0.3592	No
3/20/2023 9:15	0.303	0.014	0.0169	No	0.3589	No
3/20/2023 9:16	0.3	0.014	0.0165	No	0.3519	No
3/20/2023 9:17	0.299	0.012	0.0163	No	0.3439	No
3/20/2023 9:18	0.294	0.011	0.0159	No	0.3368	No
3/20/2023 9:19	0.288	0.01	0.0156	No	0.3317	No
3/20/2023 9:20	0.286	0.01	0.0151	No	0.3274	No
3/20/2023 9:21	0.271	0.012	0.0143	No	0.3225	No
3/20/2023 9:22	0.27	0.014	0.0139	No	0.3181	No
3/20/2023 9:23	0.27	0.013	0.0138	No	0.3132	No
3/20/2023 9:24	0.262	0.013	0.0133	No	0.3084	No
3/20/2023 9:25	0.253	0.013	0.0132	No	0.3023	No
3/20/2023 9:26	0.254	0.017	0.0135	No	0.2975	No
3/20/2023 9:27	0.251	0.013	0.0131	No	0.2923	No
3/20/2023 9:28	0.244	0.014	0.0131	No	0.2872	No
3/20/2023 9:29	0.298	0.012	0.0128	No	0.2823	No
3/20/2023 9:30	0.288	0.012	0.0127	No	0.277	No
3/20/2023 9:31	0.241	0.011	0.0125	No	0.2762	No
3/20/2023 9:32	0.244	0.009	0.0123	No	0.2752	No
3/20/2023 9:33	0.286	0.011	0.0123	No	0.2713	No
3/20/2023 9:34	0.242	0.011	0.0123	No	0.2676	No
3/20/2023 9:35	0.242	0.012	0.0125	No	0.2671	No
3/20/2023 9:36	0.278	0.012	0.0125	No	0.264	No
3/20/2023 9:37	0.266	0.01	0.0122	No	0.2611	No
3/20/2023 9:38	0.242	0.011	0.0121	No	0.2615	No
3/20/2023 9:39	0.287	0.012	0.012	No	0.2613	No
3/20/2023 9:40	0.254	0.012	0.0119	No	0.2594	No
3/20/2023 9:41	0.242	0.013	0.0117	No	0.2611	No
3/20/2023 9:42	0.233	0.012	0.0116	No	0.2611	No
3/20/2023 9:43	0.236	0.011	0.0114	No	0.2603	No
3/20/2023 9:44	0.255	0.014	0.0115	No	0.2591	No
3/20/2023 9:45	0.249	0.011	0.0115	No	0.2586	No
3/20/2023 9:46	0.243	0.011	0.0115	No	0.2557	No
3/20/2023 9:47	0.245	0.012	0.0117	No	0.2531	No
3/20/2023 9:48	0.244	0.012	0.0117	No	0.2533	No
3/20/2023 9:49	0.257	0.01	0.0117	No	0.2533	No
3/20/2023 9:50	0.237	0.012	0.0117	No	0.2505	No
3/20/2023 9:51	0.234	0.01	0.0115	No	0.2515	No
3/20/2023 9:52	0.238	0.011	0.0116	No	0.2512	No
3/20/2023 9:53	0.244	0.013	0.0117	No	0.2483	No
3/20/2023 9:54	0.246	0.01	0.0116	No	0.2464	No
3/20/2023 9:55	0.249	0.01	0.0115	No	0.2465	No
3/20/2023 9:56	0.254	0.01	0.0113	No	0.2438	No
3/20/2023 9:57	0.26	0.012	0.0113	No	0.2435	No
3/20/2023 9:58	0.27	0.012	0.0113	No	0.2443	No
3/20/2023 9:59	0.255	0.013	0.0113	No	0.2461	No
3/20/2023 10:00	0.26	0.015	0.0115	No	0.2483	No
3/20/2023 10:01	0.243	0.015	0.0118	No	0.2483	No
3/20/2023 10:02	0.254	0.011	0.0117	No	0.2491	No

Upwind Station

Time	Instantaneous VOC (ppm)	Instantaneous Mass Conc. Total (mg/m ³)	Mass Conc. Total mg/m ³ AVG 15m (mg/m ³)	Dust Exceedance	VOC ppm AVG 15m (ppm)	VOC Exceedance
3/20/2023 10:03	0.253	0.011	0.0117	No	0.2491	No
3/20/2023 10:04	0.25	0.011	0.0117	No	0.2497	No
3/20/2023 10:05	0.244	0.011	0.0117	No	0.2503	No
3/20/2023 10:06	0.247	0.012	0.0118	No	0.2498	No
3/20/2023 10:07	0.258	0.009	0.0117	No	0.2503	No
3/20/2023 10:08	0.277	0.009	0.0114	No	0.2511	No
3/20/2023 10:09	0.257	0.009	0.0113	No	0.2525	No
3/20/2023 10:10	0.25	0.008	0.0112	No	0.2547	No
3/20/2023 10:11	0.251	0.009	0.0111	No	0.2554	No
3/20/2023 10:12	0.251	0.01	0.011	No	0.2555	No
3/20/2023 10:13	0.254	0.011	0.0109	No	0.2553	No
3/20/2023 10:14	0.261	0.011	0.0108	No	0.2547	No
3/20/2023 10:15	0.266	0.013	0.0107	No	0.2536	No
3/20/2023 10:16	0.274	0.011	0.0104	No	0.254	No
3/20/2023 10:17	0.258	0.01	0.0103	No	0.2544	No
3/20/2023 10:18	0.259	0.011	0.0103	No	0.2565	No
3/20/2023 10:19	0.257	0.011	0.0103	No	0.2567	No
3/20/2023 10:20	0.259	0.01	0.0103	No	0.2571	No
3/20/2023 10:21	0.26	0.011	0.0102	No	0.2576	No
3/20/2023 10:22	0.259	0.01	0.0103	No	0.2586	No
3/20/2023 10:23	0.261	0.011	0.0104	No	0.2595	No
3/20/2023 10:24	0.248	0.013	0.0107	No	0.2595	No
3/20/2023 10:25	0.268	0.012	0.0109	No	0.2585	No
3/20/2023 10:26	0.268	0.013	0.0112	No	0.2579	No
3/20/2023 10:27	0.281	0.009	0.0111	No	0.2591	No
3/20/2023 10:28	0.285	0.01	0.0111	No	0.2602	No
3/20/2023 10:29	0.249	0.01	0.011	No	0.2622	No
3/20/2023 10:30	0.26	0.012	0.0109	No	0.2643	No
3/20/2023 10:31	0.263	0.011	0.0109	No	0.2635	No
3/20/2023 10:32	0.257	0.014	0.0112	No	0.2631	No
3/20/2023 10:33	0.261	0.012	0.0113	No	0.2623	No
3/20/2023 10:34	0.274	0.011	0.0113	No	0.2623	No
3/20/2023 10:35	0.266	0.012	0.0114	No	0.2624	No
3/20/2023 10:36	0.269	0.01	0.0113	No	0.2635	No
3/20/2023 10:37	0.267	0.01	0.0113	No	0.264	No
3/20/2023 10:38	0.27	0.009	0.0112	No	0.2646	No
3/20/2023 10:39	0.268	0.009	0.0109	No	0.2651	No
3/20/2023 10:40	0.27	0.009	0.0107	No	0.2657	No
3/20/2023 10:41	0.262	0.01	0.0105	No	0.2671	No
3/20/2023 10:42	0.268	0.011	0.0107	No	0.2672	No
3/20/2023 10:43	0.277	0.01	0.0107	No	0.2668	No
3/20/2023 10:44	0.276	0.01	0.0107	No	0.2659	No
3/20/2023 10:45	0.272	0.011	0.0106	No	0.2654	No
3/20/2023 10:46	0.278	0.011	0.0106	No	0.2672	No
3/20/2023 10:47	0.289	0.012	0.0105	No	0.268	No
3/20/2023 10:48	0.284	0.012	0.0105	No	0.269	No
3/20/2023 10:49	0.284	0.014	0.0107	No	0.2711	No
3/20/2023 10:50	0.283	0.013	0.0107	No	0.2727	No
3/20/2023 10:51	0.29	0.013	0.0109	No	0.2733	No
3/20/2023 10:52	0.292	0.012	0.0111	No	0.2745	No
3/20/2023 10:53	0.288	0.013	0.0113	No	0.2759	No
3/20/2023 10:54	0.283	0.015	0.0117	No	0.2775	No

Upwind Station

Time	Instantaneous VOC (ppm)	Instantaneous Mass Conc. Total (mg/m³)	Mass Conc. Total mg/m³ AVG 15m (mg/m³)	Dust Exceedance	VOC ppm AVG 15m (ppm)	VOC Exceedance
3/20/2023 10:55	0.289	0.013	0.012	No	0.2787	No
3/20/2023 10:56	0.301	0.012	0.0121	No	0.2797	No
3/20/2023 10:57	0.31	0.013	0.0123	No	0.281	No
3/20/2023 10:58	0.301	0.013	0.0125	No	0.2836	No
3/20/2023 10:59	0.297	0.015	0.0128	No	0.2864	No
3/20/2023 11:00	0.287	0.013	0.0129	No	0.288	No
3/20/2023 11:01	0.3	0.011	0.0129	No	0.2894	No
3/20/2023 11:02	0.292	0.011	0.0129	No	0.2904	No
3/20/2023 11:03	0.305	0.014	0.013	No	0.2919	No
3/20/2023 11:04	0.317	0.012	0.0129	No	0.2921	No
3/20/2023 11:05	0.345	0.012	0.0128	No	0.2935	No
3/20/2023 11:06	0.315	0.01	0.0126	No	0.2957	No
3/20/2023 11:07	0.306	0.013	0.0127	No	0.2998	No
3/20/2023 11:08	0.311	0.012	0.0126	No	0.3015	No
3/20/2023 11:09	0.312	0.014	0.0125	No	0.3024	No
3/20/2023 11:10	0.305	0.021	0.0131	No	0.3039	No
3/20/2023 11:11	0.321	0.012	0.0131	No	0.3059	No
3/20/2023 11:12	0.322	0.014	0.0131	No	0.3069	No
3/20/2023 11:13	0.317	0.014	0.0132	No	0.3083	No
3/20/2023 11:14	0.358	0.011	0.0129	No	0.3091	No
3/20/2023 11:15	0.341	0.011	0.0128	No	0.3101	No
3/20/2023 11:16	0.357	0.01	0.0127	No	0.3142	No
3/20/2023 11:17	0.354	0.011	0.0127	No	0.3178	No
3/20/2023 11:18	0.333	0.011	0.0125	No	0.3216	No
3/20/2023 11:19	0.326	0.01	0.0124	No	0.3257	No
3/20/2023 11:20	0.33	0.011	0.0123	No	0.3276	No
3/20/2023 11:21	0.331	0.014	0.0126	No	0.3282	No
3/20/2023 11:22	0.333	0.022	0.0132	No	0.3272	No
3/20/2023 11:23	0.33	0.024	0.014	No	0.3283	No
3/20/2023 11:24	0.329	0.014	0.014	No	0.3301	No
3/20/2023 11:25	0.345	0.011	0.0133	No	0.3313	No
3/20/2023 11:26	0.343	0.012	0.0133	No	0.3325	No
3/20/2023 11:27	0.331	0.013	0.0133	No	0.3351	No
3/20/2023 11:28	0.345	0.017	0.0135	No	0.3366	No
3/20/2023 11:29	0.326	0.024	0.0143	No	0.3372	No
3/20/2023 11:30	0.334	0.012	0.0144	No	0.3391	No
3/20/2023 11:31	0.342	0.011	0.0145	No	0.3369	No
3/20/2023 11:32	0.336	0.011	0.0145	No	0.3365	No
3/20/2023 11:33	0.341	0.011	0.0145	No	0.3355	No
3/20/2023 11:34	0.326	0.017	0.0149	No	0.3343	No
3/20/2023 11:35	0.342	0.014	0.0151	No	0.3348	No
3/20/2023 11:36	0.33	0.032	0.0163	No	0.3348	No
3/20/2023 11:37	0.361	0.056	0.0186	No	0.3356	No
3/20/2023 11:38	0.363	0.064	0.0213	No	0.3355	No
3/20/2023 11:39	0.346	0.055	0.024	No	0.3374	No
3/20/2023 11:40	0.339	0.043	0.0261	No	0.3396	No
3/20/2023 11:41	0.369	0.022	0.0268	No	0.3407	No
3/20/2023 11:42	0.348	0.026	0.0277	No	0.3403	No
3/20/2023 11:43	0.353	0.026	0.0283	No	0.3421	No
3/20/2023 11:44	0.348	0.053	0.0302	No	0.3432	No
3/20/2023 11:45	0.341	0.027	0.0312	No	0.3437	No
3/20/2023 11:46	0.353	0.018	0.0317	No	0.3452	No

Upwind Station

Time	Instantaneous VOC (ppm)	Instantaneous Mass Conc. Total (mg/m³)	Mass Conc. Total mg/m³ AVG 15m (mg/m³)	Dust Exceedance	VOC ppm AVG 15m (ppm)	VOC Exceedance
3/20/2023 11:47	0.345	0.01	0.0316	No	0.3457	No
3/20/2023 11:48	0.35	0.013	0.0317	No	0.3464	No
3/20/2023 11:49	0.342	0.021	0.032	No	0.347	No
3/20/2023 11:50	0.348	0.036	0.0335	No	0.3476	No
3/20/2023 11:51	0.349	0.032	0.0335	No	0.3487	No
3/20/2023 11:52	0.356	0.027	0.0315	No	0.3491	No
3/20/2023 11:53	0.354	0.033	0.0295	No	0.3503	No
3/20/2023 11:54	0.342	0.022	0.0273	No	0.35	No
3/20/2023 11:55	0.358	0.02	0.0257	No	0.3494	No
3/20/2023 11:56	0.367	0.02	0.0256	No	0.3491	No
3/20/2023 11:57	0.379	0.011	0.0246	No	0.3504	No
3/20/2023 11:58	0.372	0.017	0.024	No	0.3503	No
3/20/2023 11:59	0.366	0.013	0.0213	No	0.3523	No
3/20/2023 12:00	0.36	0.013	0.0204	No	0.3536	No
3/20/2023 12:01	0.354	0.015	0.0202	No	0.3548	No
3/20/2023 12:02	0.367	0.024	0.0211	No	0.3561	No
3/20/2023 12:03	0.372	0.023	0.0218	No	0.3561	No
3/20/2023 12:04	0.365	0.02	0.0217	No	0.3576	No
3/20/2023 12:05	0.369	0.018	0.0205	No	0.3591	No
3/20/2023 12:06	0.359	0.024	0.02	No	0.3606	No
3/20/2023 12:07	0.365	0.028	0.0201	No	0.362	No
3/20/2023 12:08	0.366	0.025	0.0195	No	0.3627	No
3/20/2023 12:09	0.367	0.013	0.0189	No	0.3633	No
3/20/2023 12:10	0.377	0.024	0.0192	No	0.3641	No
3/20/2023 12:11	0.377	0.019	0.0191	No	0.3657	No
3/20/2023 12:12	0.367	0.017	0.0195	No	0.367	No
3/20/2023 12:13	0.368	0.013	0.0193	No	0.3677	No
3/20/2023 12:14	0.377	0.011	0.0191	No	0.3669	No
3/20/2023 12:15	0.378	0.011	0.019	No	0.3666	No
3/20/2023 12:16	0.383	0.01	0.0187	No	0.3673	No
3/20/2023 12:17	0.39	0.012	0.0179	No	0.3685	No
3/20/2023 12:18	0.38	0.021	0.0177	No	0.3705	No
3/20/2023 12:19	0.404	0.017	0.0175	No	0.372	No
3/20/2023 12:20	0.395	0.015	0.0173	No	0.3725	No
3/20/2023 12:21	0.394	0.016	0.0168	No	0.3751	No
3/20/2023 12:22	0.395	0.015	0.0159	No	0.3769	No
3/20/2023 12:23	0.408	0.015	0.0153	No	0.3792	No
3/20/2023 12:24	0.411	0.015	0.0154	No	0.3812	No
3/20/2023 12:25	0.406	0.016	0.0149	No	0.384	No
3/20/2023 12:26	0.409	0.017	0.0147	No	0.3869	No
3/20/2023 12:27	0.411	0.011	0.0143	No	0.3889	No
3/20/2023 12:28	0.392	0.011	0.0142	No	0.391	No
3/20/2023 12:29	0.412	0.012	0.0143	No	0.3939	No
3/20/2023 12:30	0.42	0.013	0.0144	No	0.3955	No
3/20/2023 12:31	0.411	0.014	0.0147	No	0.3979	No
3/20/2023 12:32	0.414	0.012	0.0147	No	0.4007	No
3/20/2023 12:33	0.419	0.011	0.014	No	0.4025	No
3/20/2023 12:34	0.418	0.012	0.0137	No	0.4041	No
3/20/2023 12:35	0.435	0.023	0.0142	No	0.4067	No
3/20/2023 12:36	0.428	0.015	0.0141	No	0.4077	No
3/20/2023 12:37	0.424	0.014	0.0141	No	0.4103	No
3/20/2023 12:38	0.434	0.015	0.0141	No	0.4126	No

Upwind Station

Time	Instantaneous VOC (ppm)	Instantaneous Mass Conc. Total (mg/m ³)	Mass Conc. Total mg/m ³ AVG 15m (mg/m ³)	Dust Exceedance	VOC ppm AVG 15m (ppm)	VOC Exceedance
3/20/2023 12:39	0.442	0.013	0.0139	No	0.4145	No
3/20/2023 12:40	0.439	0.011	0.0136	No	0.4163	No
3/20/2023 12:41	0.438	0.014	0.0134	No	0.4183	No
3/20/2023 12:42	0.444	0.013	0.0135	No	0.4205	No
3/20/2023 12:43	0.436	0.02	0.0141	No	0.4225	No
3/20/2023 12:44	0.438	0.017	0.0145	No	0.4247	No
3/20/2023 12:45	0.447	0.012	0.0144	No	0.4276	No
3/20/2023 12:46	0.461	0.014	0.0144	No	0.4293	No
3/20/2023 12:47	0.462	0.013	0.0145	No	0.4311	No
3/20/2023 12:48	0.447	0.014	0.0147	No	0.4345	No
3/20/2023 12:49	0.455	0.015	0.0149	No	0.4377	No
3/20/2023 12:50	0.473	0.016	0.0144	No	0.4395	No
3/20/2023 12:51	0.458	0.016	0.0145	No	0.442	No
3/20/2023 12:52	0.464	0.012	0.0143	No	0.4445	No
3/20/2023 12:53	0.478	0.012	0.0141	No	0.4465	No
3/20/2023 12:54	0.469	0.013	0.0141	No	0.4492	No
3/20/2023 12:55	0.459	0.013	0.0143	No	0.4521	No
3/20/2023 12:56	0.467	0.012	0.0141	No	0.4539	No
3/20/2023 12:57	0.474	0.012	0.0141	No	0.4553	No
3/20/2023 12:58	0.46	0.012	0.0135	No	0.4572	No
3/20/2023 12:59	0.47	0.013	0.0133	No	0.4592	No
3/20/2023 13:00	0.462	0.013	0.0133	No	0.4608	No
3/20/2023 13:01	0.484	0.014	0.0133	No	0.4629	No
3/20/2023 13:02	0.459	0.015	0.0135	No	0.4639	No
3/20/2023 13:03	0.461	0.013	0.0134	No	0.4655	No
3/20/2023 13:04	0.472	0.024	0.014	No	0.4653	No
3/20/2023 13:05	0.47	0.015	0.0139	No	0.4662	No
3/20/2023 13:06	0.473	0.018	0.0141	No	0.4673	No
3/20/2023 13:07	0.476	0.016	0.0143	No	0.4671	No
3/20/2023 13:08	0.475	0.035	0.0159	No	0.4681	No
3/20/2023 13:09	0.476	0.018	0.0162	No	0.4689	No
3/20/2023 13:10	0.472	0.012	0.0161	No	0.4687	No
3/20/2023 13:11	0.473	0.017	0.0165	No	0.4692	No
3/20/2023 13:12	0.469	0.015	0.0167	No	0.4701	No
3/20/2023 13:13	0.475	0.01	0.0165	No	0.4705	No
3/20/2023 13:14	0.471	0.013	0.0165	No	0.4701	No
3/20/2023 13:15	0.478	0.011	0.0164	No	0.4711	No
3/20/2023 13:16	0.474	0.011	0.0162	No	0.4712	No
3/20/2023 13:17	0.473	0.014	0.0161	No	0.4723	No
3/20/2023 13:18	0.46	0.011	0.016	No	0.4716	No
3/20/2023 13:19	0.463	0.014	0.0153	No	0.4725	No
3/20/2023 13:20	0.473	0.019	0.0156	No	0.4725	No
3/20/2023 13:21	0.48	0.024	0.016	No	0.4719	No
3/20/2023 13:22	0.463	0.013	0.0158	No	0.4721	No
3/20/2023 13:23	0.465	0.013	0.0143	No	0.4725	No
3/20/2023 13:24	0.466	0.011	0.0139	No	0.4717	No
3/20/2023 13:25	0.473	0.012	0.0139	No	0.471	No
3/20/2023 13:26	0.471	0.013	0.0136	No	0.4703	No
3/20/2023 13:27	0.465	0.014	0.0135	No	0.4704	No
3/20/2023 13:28	0.471	0.016	0.0139	No	0.4703	No
3/20/2023 13:29	0.492	0.013	0.0139	No	0.47	No
3/20/2023 13:30	0.473	0.014	0.0141	No	0.4697	No

Upwind Station

Time	Instantaneous VOC (ppm)	Instantaneous Mass Conc. Total (mg/m ³)	Mass Conc. Total mg/m ³ AVG 15m (mg/m ³)	Dust Exceedance	VOC ppm AVG 15m (ppm)	VOC Exceedance
3/20/2023 13:31	0.478	0.013	0.0143	No	0.4711	No
3/20/2023 13:32	0.466	0.013	0.0142	No	0.4708	No
3/20/2023 13:33	0.487	0.017	0.0146	No	0.4711	No
3/20/2023 13:34	0.457	0.018	0.0149	No	0.4706	No
3/20/2023 13:35	0.463	0.02	0.0149	No	0.4724	No
3/20/2023 13:36	0.464	0.014	0.0143	No	0.472	No
3/20/2023 13:37	0.461	0.015	0.0144	No	0.4713	No
3/20/2023 13:38	0.464	0.016	0.0146	No	0.4703	No
3/20/2023 13:39	0.474	0.023	0.0154	No	0.4701	No
3/20/2023 13:40	0.462	0.018	0.0158	No	0.4701	No
3/20/2023 13:41	0.453	0.016	0.016	No	0.4706	No
3/20/2023 13:42	0.452	0.017	0.0162	No	0.4699	No
3/20/2023 13:43	0.476	0.014	0.0161	No	0.4687	No
3/20/2023 13:44	0.445	0.013	0.0161	No	0.4678	No
3/20/2023 13:45	0.453	0.017	0.0163	No	0.4681	No
3/20/2023 13:46	0.477	0.017	0.0165	No	0.465	No
3/20/2023 13:47	0.454	0.017	0.0168	No	0.4637	No
3/20/2023 13:48	0.438	0.017	0.0168	No	0.4636	No
3/20/2023 13:49	0.443	0.019	0.0169	No	0.4628	No
3/20/2023 13:50	0.45	0.022	0.017	No	0.4595	No
3/20/2023 13:51	0.442	0.016	0.0171	No	0.4586	No
3/20/2023 13:52	0.441	0.02	0.0175	No	0.4577	No
3/20/2023 13:53	0.44	0.017	0.0175	No	0.4563	No
3/20/2023 13:54	0.442	0.017	0.0171	No	0.4549	No
3/20/2023 13:55	0.435	0.031	0.018	No	0.4533	No
3/20/2023 13:56	0.446	0.024	0.0185	No	0.4512	No
3/20/2023 13:57	0.448	0.026	0.0191	No	0.4494	No
3/20/2023 13:58	0.451	0.019	0.0195	No	0.4489	No
3/20/2023 13:59	0.451	0.02	0.0199	No	0.4487	No
3/20/2023 14:00	0.45	0.028	0.0207	No	0.447	No
3/20/2023 14:01	0.456	0.027	0.0213	No	0.4474	No
3/20/2023 14:02	0.82	0.043	0.0231	No	0.4472	No
3/20/2023 14:03	0.555	0.016	0.023	No	0.4458	No
3/20/2023 14:04	0.493	0.033	0.0239	No	0.4702	No
3/20/2023 14:05	0.503	0.017	0.0236	No	0.478	No
3/20/2023 14:06	0.477	0.027	0.0243	No	0.4813	No
3/20/2023 14:07	0.471	0.034	0.0253	No	0.4849	No
3/20/2023 14:08	0.468	0.021	0.0255	No	0.4872	No
3/20/2023 14:09	0.47	0.023	0.0259	No	0.4892	No
3/20/2023 14:10	0.468	0.024	0.0255	No	0.4911	No
3/20/2023 14:11	0.479	0.014	0.0248	No	0.4929	No
3/20/2023 14:12	0.47	0.012	0.0239	No	0.4951	No
3/20/2023 14:13	0.478	0.013	0.0235	No	0.4973	No
3/20/2023 14:14	0.474	0.027	0.0239	No	0.4988	No
3/20/2023 14:15	0.464	0.02	0.0234	No	0.5006	No
3/20/2023 14:16	0.462	0.02	0.0229	No	0.5021	No
3/20/2023 14:17	0.475	0.038	0.0226	No	0.5031	No
3/20/2023 14:18	0.474	0.033	0.0237	No	0.5035	No
3/20/2023 14:19	0.475	0.032	0.0237	No	0.4805	No
3/20/2023 14:20	0.471	0.022	0.024	No	0.4751	No
3/20/2023 14:21	0.482	0.032	0.0243	No	0.4739	No
3/20/2023 14:22	0.486	0.033	0.0243	No	0.4717	No

Upwind Station

Time	Instantaneous VOC (ppm)	Instantaneous Mass Conc. Total (mg/m ³)	Mass Conc. Total mg/m ³ AVG 15m (mg/m ³)	Dust Exceedance	VOC ppm AVG 15m (ppm)	VOC Exceedance
3/20/2023 14:23	0.488	0.031	0.0249	No	0.4721	No
3/20/2023 14:24	0.469	0.035	0.0257	No	0.4731	No
3/20/2023 14:25	0.459	0.027	0.0259	No	0.4744	No
3/20/2023 14:26	0.437	0.017	0.0261	No	0.4743	No
3/20/2023 14:27	0.425	0.021	0.0267	No	0.4737	No
3/20/2023 14:28	0.39	0.015	0.0269	No	0.471	No
3/20/2023 14:29	0.378	0.015	0.0261	No	0.4672	No
3/20/2023 14:30	0.364	0.021	0.0261	No	0.4612	No
3/20/2023 14:31	0.374	0.048	0.028	No	0.4551	No
3/20/2023 14:32	0.367	0.031	0.0275	No	0.4481	No
3/20/2023 14:33	0.366	0.019	0.0266	No	0.4409	No
3/20/2023 14:34	0.382	0.031	0.0265	No	0.4332	No
3/20/2023 14:35	0.398	0.025	0.0267	No	0.4254	No
3/20/2023 14:36	0.378	0.015	0.0256	No	0.4191	No
3/20/2023 14:37	0.382	0.02	0.0247	No	0.4131	No
3/20/2023 14:38	0.392	0.029	0.0246	No	0.4054	No
3/20/2023 14:39	0.411	0.018	0.0235	No	0.3978	No
3/20/2023 14:40	0.417	0.019	0.0229	No	0.3923	No
3/20/2023 14:41	0.395	0.024	0.0234	No	0.3889	No
3/20/2023 14:42	0.397	0.026	0.0237	No	0.3907	No
3/20/2023 14:43	0.394	0.054	0.0263	No	0.3879	No
3/20/2023 14:44	0.407	0.029	0.0273	No	0.3861	No
3/20/2023 14:45	0.404	0.025	0.0275	No	0.3863	No
3/20/2023 14:46	0.408	0.028	0.0262	No	0.3883	No
3/20/2023 14:47	0.408	0.019	0.0254	No	0.3909	No
3/20/2023 14:48	0.42	0.022	0.0256	No	0.3932	No
3/20/2023 14:49	0.419	0.02	0.0249	No	0.3959	No
3/20/2023 14:50	0.426	0.035	0.0255	No	0.3995	No
3/20/2023 14:51	0.424	0.022	0.026	No	0.402	No
3/20/2023 14:52	0.432	0.023	0.0262	No	0.4039	No
3/20/2023 14:53	0.435	0.028	0.0261	No	0.4069	No
3/20/2023 14:54	0.436	0.019	0.0262	No	0.4103	No
3/20/2023 14:55	0.429	0.02	0.0263	No	0.4131	No
3/20/2023 14:56	0.431	0.04	0.0273	No	0.4148	No
3/20/2023 14:57	0.422	0.042	0.0284	No	0.4156	No
3/20/2023 14:58	0.432	0.025	0.0265	No	0.418	No
3/20/2023 14:59	0.447	0.026	0.0263	No	0.4197	No
3/20/2023 15:00	0.439	0.03	0.0266	No	0.4222	No
3/20/2023 15:01	0.438	0.028	0.0266	No	0.4249	No
3/20/2023 15:02	0.44	0.015	0.0263	No	0.4272	No
3/20/2023 15:03	0.446	0.018	0.0261	No	0.4292	No
3/20/2023 15:04	0.451	0.038	0.0273	No	0.4313	No
3/20/2023 15:05	0.442	0.032	0.0271	No	0.4331	No
3/20/2023 15:06	0.445	0.036	0.028	No	0.4352	No
3/20/2023 15:07	0.449	0.035	0.0288	No	0.4363	No
3/20/2023 15:08	0.454	0.029	0.0289	No	0.4377	No
3/20/2023 15:09	0.453	0.024	0.0292	No	0.4388	No
3/20/2023 15:10	0.449	0.042	0.0307	No	0.4401	No
3/20/2023 15:11	0.445	0.031	0.0301	No	0.4412	No
3/20/2023 15:12	0.427	0.02	0.0286	No	0.4425	No
3/20/2023 15:13	0.447	0.024	0.0285	No	0.4435	No
3/20/2023 15:14	0.446	0.021	0.0282	No	0.4438	No

Upwind Station

Time	Instantaneous VOC (ppm)	Instantaneous Mass Conc. Total (mg/m ³)	Mass Conc. Total mg/m ³ AVG 15m (mg/m ³)	Dust Exceedance	VOC ppm AVG 15m (ppm)	VOC Exceedance
3/20/2023 15:15	0.454	0.021	0.0276	No	0.4448	No
3/20/2023 15:16	0	0.042	0.0285	No	0.4447	No
3/20/2023 15:17	0.004	0.058	0.0314	No	0.4457	No
3/20/2023 15:18	0.029	0.036	0.0326	No	0.0551	No

Downwind Station						
Time	Instantaneous VOC (ppm)	Instantaneous Mass Conc. Total (mg/m ³)	Mass Conc. Total mg/m ³ AVG 15m (mg/m ³)	Dust Exceedance	VOC ppm AVG 15m (ppm)	VOC Exceedance
3/20/2023 7:32	0.046	-	-	No	0.046	No
3/20/2023 7:33	0.021	0.014	0.014	No	0.0335	No
3/20/2023 7:34	0.012	0.033	0.0235	No	0.0263	No
3/20/2023 7:35	0.003	0.022	0.023	No	0.0205	No
3/20/2023 7:36	0.004	0.017	0.0215	No	0.0172	No
3/20/2023 7:37	0	0.016	0.0204	No	0.0143	No
3/20/2023 7:38	0.015	0.016	0.0197	No	0.0144	No
3/20/2023 7:39	0.013	0.014	0.0189	No	0.0143	No
3/20/2023 7:40	0.016	0.011	0.0179	No	0.0144	No
3/20/2023 7:41	0.006	0.014	0.0174	No	0.0136	No
3/20/2023 7:42	0.012	0.014	0.0171	No	0.0135	No
3/20/2023 7:43	0.028	0.013	0.0167	No	0.0147	No
3/20/2023 7:44	0.012	0.011	0.0163	No	0.0145	No
3/20/2023 7:45	0.03	0.011	0.0158	No	0.0156	No
3/20/2023 7:46	0.035	0.02	0.0161	No	0.0169	No
3/20/2023 7:47	0.026	0.01	0.0157	No	0.0155	No
3/20/2023 7:48	0.025	0.009	0.0154	No	0.0158	No
3/20/2023 7:49	0.026	0.009	0.0138	No	0.0167	No
3/20/2023 7:50	0.038	0.011	0.0131	No	0.0191	No
3/20/2023 7:51	0.06	0.014	0.0129	No	0.0228	No
3/20/2023 7:52	0.069	0.016	0.0129	No	0.0274	No
3/20/2023 7:53	0.037	0.01	0.0125	No	0.0289	No
3/20/2023 7:54	0.033	0.009	0.0121	No	0.0302	No
3/20/2023 7:55	0.036	0.011	0.0121	No	0.0315	No
3/20/2023 7:56	0.04	0.011	0.0119	No	0.0338	No
3/20/2023 7:57	0.061	0.014	0.0119	No	0.0371	No
3/20/2023 7:58	0.07	0.02	0.0124	No	0.0399	No
3/20/2023 7:59	0.064	0.02	0.013	No	0.0433	No
3/20/2023 8:00	0.069	0.012	0.0131	No	0.0459	No
3/20/2023 8:01	0.177	0.009	0.0123	No	0.0554	No
3/20/2023 8:02	0.103	0.014	0.0126	No	0.0605	No
3/20/2023 8:03	0.11	0.012	0.0128	No	0.0662	No
3/20/2023 8:04	0.076	0.013	0.0131	No	0.0695	No
3/20/2023 8:05	0.068	0.005	0.0127	No	0.0715	No
3/20/2023 8:06	0.072	0.007	0.0122	No	0.0723	No
3/20/2023 8:07	0.065	0.011	0.0119	No	0.0721	No
3/20/2023 8:08	0.072	0.017	0.0123	No	0.0744	No
3/20/2023 8:09	0.084	0.012	0.0125	No	0.0778	No
3/20/2023 8:10	0.075	0.012	0.0126	No	0.0804	No
3/20/2023 8:11	0.084	0.011	0.0126	No	0.0833	No
3/20/2023 8:12	0.088	0.012	0.0125	No	0.0851	No
3/20/2023 8:13	0.096	0.039	0.0137	No	0.0869	No
3/20/2023 8:14	0.097	0.089	0.0183	No	0.0891	No
3/20/2023 8:15	0.095	0.045	0.0205	No	0.0908	No
3/20/2023 8:16	0.092	0.02	0.0213	No	0.0851	No
3/20/2023 8:17	0.095	0.009	0.0209	No	0.0846	No
3/20/2023 8:18	0.102	0.019	0.0214	No	0.0841	No
3/20/2023 8:19	0.096	0.009	0.0211	No	0.0854	No
3/20/2023 8:20	0.112	0.006	0.0212	No	0.0883	No
3/20/2023 8:21	0.122	0.008	0.0213	No	0.0917	No
3/20/2023 8:22	0.121	0.014	0.0215	No	0.0954	No
3/20/2023 8:23	0.106	0.009	0.0209	No	0.0977	No
3/20/2023 8:24	0.122	0.007	0.0206	No	0.1002	No

Downwind Station						
Time	Instantaneous VOC (ppm)	Instantaneous Mass Conc. Total (mg/m ³)	Mass Conc. Total mg/m ³ AVG 15m (mg/m ³)	Dust Exceedance	VOC ppm AVG 15m (ppm)	VOC Exceedance
3/20/2023 8:25	0.134	0.015	0.0208	No	0.1041	No
3/20/2023 8:26	0.127	0.011	0.0208	No	0.107	No
3/20/2023 8:27	0.116	0.01	0.0207	No	0.1089	No
3/20/2023 8:28	0.125	0.009	0.0187	No	0.1108	No
3/20/2023 8:29	0.115	0.01	0.0134	No	0.112	No
3/20/2023 8:30	0.124	0.013	0.0113	No	0.1139	No
3/20/2023 8:31	0.139	0.013	0.0108	No	0.1171	No
3/20/2023 8:32	0.143	0.02	0.0115	No	0.1203	No
3/20/2023 8:33	0.144	0.017	0.0114	No	0.1231	No
3/20/2023 8:34	0.155	0.018	0.012	No	0.127	No
3/20/2023 8:35	0.148	0.023	0.0131	No	0.1294	No
3/20/2023 8:36	0.185	0.023	0.0141	No	0.1336	No
3/20/2023 8:37	0.192	0.024	0.0148	No	0.1383	No
3/20/2023 8:38	0.397	0.024	0.0158	No	0.1577	No
3/20/2023 8:39	0.45	0.03	0.0173	No	0.1796	No
3/20/2023 8:40	0.305	0.023	0.0179	No	0.191	No
3/20/2023 8:41	0.304	0.04	0.0198	No	0.2028	No
3/20/2023 8:42	0.256	0.033	0.0213	No	0.2121	No
3/20/2023 8:43	0.244	0.029	0.0227	No	0.2201	No
3/20/2023 8:44	0.216	0.026	0.0237	No	0.2268	No
3/20/2023 8:45	0.233	0.026	0.0246	No	0.2341	No
3/20/2023 8:46	0.216	0.022	0.0252	No	0.2392	No
3/20/2023 8:47	0.208	0.017	0.025	No	0.2435	No
3/20/2023 8:48	0.225	0.019	0.0251	No	0.2489	No
3/20/2023 8:49	0.3	0.017	0.0251	No	0.2586	No
3/20/2023 8:50	0.228	0.015	0.0245	No	0.2639	No
3/20/2023 8:51	0.278	0.022	0.0245	No	0.2701	No
3/20/2023 8:52	0.27	0.029	0.0248	No	0.2753	No
3/20/2023 8:53	0.228	0.022	0.0247	No	0.2641	No
3/20/2023 8:54	0.272	0.02	0.024	No	0.2522	No
3/20/2023 8:55	0.264	0.017	0.0236	No	0.2495	No
3/20/2023 8:56	0.562	0.017	0.0221	No	0.2667	No
3/20/2023 8:57	0.283	0.019	0.0211	No	0.2685	No
3/20/2023 8:58	0.409	0.02	0.0205	No	0.2795	No
3/20/2023 8:59	0.285	0.023	0.0203	No	0.2841	No
3/20/2023 9:00	0.327	0.023	0.0201	No	0.2903	No
3/20/2023 9:01	0.219	0.032	0.0208	No	0.2905	No
3/20/2023 9:02	0.242	0.022	0.0211	No	0.2928	No
3/20/2023 9:03	0.205	0.021	0.0213	No	0.2915	No
3/20/2023 9:04	0.205	0.016	0.0212	No	0.2851	No
3/20/2023 9:05	0.208	0.015	0.0212	No	0.2838	No
3/20/2023 9:06	0.208	0.022	0.0212	No	0.2791	No
3/20/2023 9:07	0.232	0.025	0.0209	No	0.2766	No
3/20/2023 9:08	0.208	0.017	0.0206	No	0.2753	No
3/20/2023 9:09	0.215	0.019	0.0205	No	0.2715	No
3/20/2023 9:10	0.216	0.018	0.0206	No	0.2683	No
3/20/2023 9:11	0.2	0.016	0.0205	No	0.2441	No
3/20/2023 9:12	0.21	0.02	0.0206	No	0.2393	No
3/20/2023 9:13	0.217	0.027	0.0211	No	0.2265	No
3/20/2023 9:14	0.244	0.019	0.0208	No	0.2237	No
3/20/2023 9:15	0.223	0.021	0.0207	No	0.2168	No
3/20/2023 9:16	0.215	0.017	0.0197	No	0.2165	No
3/20/2023 9:17	0.221	0.018	0.0194	No	0.2151	No

Downwind Station						
Time	Instantaneous VOC (ppm)	Instantaneous Mass Conc. Total (mg/m ³)	Mass Conc. Total mg/m ³ AVG 15m (mg/m ³)	Dust Exceedance	VOC ppm AVG 15m (ppm)	VOC Exceedance
3/20/2023 9:18	0.221	0.015	0.019	No	0.2162	No
3/20/2023 9:19	0.226	0.015	0.0189	No	0.2176	No
3/20/2023 9:20	0.24	0.02	0.0193	No	0.2197	No
3/20/2023 9:21	0.218	0.019	0.0191	No	0.2204	No
3/20/2023 9:22	0.219	0.017	0.0185	No	0.2195	No
3/20/2023 9:23	0.24	0.025	0.0191	No	0.2217	No
3/20/2023 9:24	0.212	0.025	0.0195	No	0.2215	No
3/20/2023 9:25	0.238	0.018	0.0195	No	0.2229	No
3/20/2023 9:26	0.242	0.02	0.0197	No	0.2257	No
3/20/2023 9:27	0.222	0.022	0.0199	No	0.2265	No
3/20/2023 9:28	0.216	0.016	0.0191	No	0.2265	No
3/20/2023 9:29	0.212	0.015	0.0189	No	0.2243	No
3/20/2023 9:30	0.223	0.026	0.0192	No	0.2243	No
3/20/2023 9:31	0.229	0.03	0.0201	No	0.2253	No
3/20/2023 9:32	0.238	0.024	0.0205	No	0.2264	No
3/20/2023 9:33	0.228	0.013	0.0203	No	0.2269	No
3/20/2023 9:34	0.222	0.014	0.0203	No	0.2266	No
3/20/2023 9:35	0.271	0.018	0.0201	No	0.2287	No
3/20/2023 9:36	0.275	0.028	0.0207	No	0.2325	No
3/20/2023 9:37	0.495	0.032	0.0217	No	0.2509	No
3/20/2023 9:38	0.377	0.022	0.0215	No	0.26	No
3/20/2023 9:39	0.362	0.032	0.022	No	0.27	No
3/20/2023 9:40	0.359	0.026	0.0225	No	0.2781	No
3/20/2023 9:41	0.277	0.016	0.0223	No	0.2804	No
3/20/2023 9:42	0.241	0.015	0.0218	No	0.2817	No
3/20/2023 9:43	0.239	0.011	0.0215	No	0.2832	No
3/20/2023 9:44	0.238	0.014	0.0214	No	0.2849	No
3/20/2023 9:45	0.251	0.016	0.0207	No	0.2868	No
3/20/2023 9:46	0.246	0.098	0.0253	No	0.2879	No
3/20/2023 9:47	0.226	0.122	0.0318	No	0.2871	No
3/20/2023 9:48	0.238	0.023	0.0325	No	0.2878	No
3/20/2023 9:49	0.282	0.039	0.0341	No	0.2918	No
3/20/2023 9:50	0.301	0.124	0.0412	No	0.2938	No
3/20/2023 9:51	0.294	0.066	0.0437	No	0.2951	No
3/20/2023 9:52	0.227	0.035	0.0439	No	0.2772	No
3/20/2023 9:53	0.238	0.027	0.0443	No	0.2679	No
3/20/2023 9:54	0.237	0.027	0.0439	No	0.2596	No
3/20/2023 9:55	0.235	0.027	0.044	No	0.2513	No
3/20/2023 9:56	0.236	0.022	0.0444	No	0.2486	No
3/20/2023 9:57	0.243	0.016	0.0445	No	0.2487	No
3/20/2023 9:58	0.23	0.021	0.0451	No	0.2481	No
3/20/2023 9:59	0.232	0.021	0.0456	No	0.2477	No
3/20/2023 10:00	0.274	0.025	0.0462	No	0.2493	No
3/20/2023 10:01	0.258	0.035	0.042	No	0.2501	No
3/20/2023 10:02	0.253	0.029	0.0358	No	0.2519	No
3/20/2023 10:03	0.231	0.023	0.0358	No	0.2514	No
3/20/2023 10:04	0.197	0.013	0.0341	No	0.2457	No
3/20/2023 10:05	0.203	0.015	0.0268	No	0.2392	No
3/20/2023 10:06	0.206	0.016	0.0235	No	0.2333	No
3/20/2023 10:07	0.216	0.017	0.0223	No	0.2326	No
3/20/2023 10:08	0.215	0.017	0.0216	No	0.2311	No
3/20/2023 10:09	0.217	0.02	0.0211	No	0.2297	No
3/20/2023 10:10	0.237	0.021	0.0207	No	0.2299	No

Downwind Station						
Time	Instantaneous VOC (ppm)	Instantaneous Mass Conc. Total (mg/m ³)	Mass Conc. Total mg/m ³ AVG 15m (mg/m ³)	Dust Exceedance	VOC ppm AVG 15m (ppm)	VOC Exceedance
3/20/2023 10:11	0.251	0.026	0.021	No	0.2309	No
3/20/2023 10:12	0.208	0.029	0.0219	No	0.2285	No
3/20/2023 10:13	0.21	0.018	0.0217	No	0.2272	No
3/20/2023 10:14	0.192	0.013	0.0211	No	0.2245	No
3/20/2023 10:15	0.201	0.017	0.0206	No	0.2197	No
3/20/2023 10:16	0.231	0.019	0.0195	No	0.2179	No
3/20/2023 10:17	0.233	0.038	0.0201	No	0.2165	No
3/20/2023 10:18	1.014	0.028	0.0205	No	0.2687	No
3/20/2023 10:19	0.233	0.014	0.0205	No	0.2711	No
3/20/2023 10:20	0.243	0.012	0.0203	No	0.2738	No
3/20/2023 10:21	0.222	0.013	0.0201	No	0.2749	No
3/20/2023 10:22	0.22	0.012	0.0198	No	0.2751	No
3/20/2023 10:23	0.249	0.022	0.0201	No	0.2774	No
3/20/2023 10:24	0.221	0.021	0.0202	No	0.2777	No
3/20/2023 10:25	0.243	0.015	0.0198	No	0.2781	No
3/20/2023 10:26	0.209	0.02	0.0194	No	0.2753	No
3/20/2023 10:27	0.264	0.022	0.0189	No	0.279	No
3/20/2023 10:28	0.214	0.022	0.0192	No	0.2793	No
3/20/2023 10:29	0.221	0.052	0.0218	No	0.2812	No
3/20/2023 10:30	0.222	0.027	0.0225	No	0.2826	No
3/20/2023 10:31	0.214	0.018	0.0224	No	0.2815	No
3/20/2023 10:32	0.199	0.016	0.0209	No	0.2792	No
3/20/2023 10:33	0.22	0.028	0.0209	No	0.2263	No
3/20/2023 10:34	0.24	0.033	0.0222	No	0.2267	No
3/20/2023 10:35	0.217	0.031	0.0235	No	0.225	No
3/20/2023 10:36	0.183	0.019	0.0239	No	0.2224	No
3/20/2023 10:37	0.201	0.018	0.0243	No	0.2211	No
3/20/2023 10:38	0.189	0.02	0.0241	No	0.2171	No
3/20/2023 10:39	0.189	0.022	0.0242	No	0.215	No
3/20/2023 10:40	0.207	0.012	0.024	No	0.2126	No
3/20/2023 10:41	0.213	0.014	0.0236	No	0.2129	No
3/20/2023 10:42	0.208	0.02	0.0235	No	0.2091	No
3/20/2023 10:43	0.201	0.018	0.0232	No	0.2083	No
3/20/2023 10:44	0.186	0.024	0.0213	No	0.2059	No
3/20/2023 10:45	0.222	0.02	0.0209	No	0.2059	No
3/20/2023 10:46	0.179	0.014	0.0206	No	0.2036	No
3/20/2023 10:47	0.178	0.016	0.0206	No	0.2022	No
3/20/2023 10:48	0.165	0.017	0.0199	No	0.1985	No
3/20/2023 10:49	0.156	0.012	0.0185	No	0.1929	No
3/20/2023 10:50	0.168	0.011	0.0171	No	0.1897	No
3/20/2023 10:51	0.174	0.026	0.0176	No	0.1891	No
3/20/2023 10:52	0.209	0.024	0.018	No	0.1896	No
3/20/2023 10:53	0.182	0.014	0.0176	No	0.1891	No
3/20/2023 10:54	0.18	0.019	0.0174	No	0.1885	No
3/20/2023 10:55	0.18	0.018	0.0178	No	0.1867	No
3/20/2023 10:56	0.184	0.023	0.0184	No	0.1848	No
3/20/2023 10:57	0.193	0.023	0.0186	No	0.1838	No
3/20/2023 10:58	0.242	0.027	0.0192	No	0.1865	No
3/20/2023 10:59	0.218	0.031	0.0197	No	0.1887	No
3/20/2023 11:00	0.184	0.018	0.0195	No	0.1861	No
3/20/2023 11:01	0.19	0.015	0.0196	No	0.1869	No
3/20/2023 11:02	0.174	0.022	0.02	No	0.1866	No
3/20/2023 11:03	0.161	0.017	0.02	No	0.1863	No

Downwind Station						
Time	Instantaneous VOC (ppm)	Instantaneous Mass Conc. Total (mg/m ³)	Mass Conc. Total mg/m ³ AVG 15m (mg/m ³)	Dust Exceedance	VOC ppm AVG 15m (ppm)	VOC Exceedance
3/20/2023 11:04	0.155	0.015	0.0202	No	0.1863	No
3/20/2023 11:05	0.161	0.011	0.0202	No	0.1858	No
3/20/2023 11:06	0.181	0.01	0.0191	No	0.1863	No
3/20/2023 11:07	0.214	0.009	0.0181	No	0.1866	No
3/20/2023 11:08	0.197	0.01	0.0179	No	0.1876	No
3/20/2023 11:09	0.165	0.015	0.0176	No	0.1866	No
3/20/2023 11:10	0.167	0.02	0.0177	No	0.1857	No
3/20/2023 11:11	0.174	0.012	0.017	No	0.1851	No
3/20/2023 11:12	0.161	0.011	0.0162	No	0.1829	No
3/20/2023 11:13	0.18	0.01	0.0151	No	0.1788	No
3/20/2023 11:14	0.215	0.009	0.0136	No	0.1786	No
3/20/2023 11:15	0.23	0.016	0.0135	No	0.1817	No
3/20/2023 11:16	0.232	0.014	0.0134	No	0.1845	No
3/20/2023 11:17	0.202	0.016	0.013	No	0.1863	No
3/20/2023 11:18	0.294	0.017	0.013	No	0.1952	No
3/20/2023 11:19	0.282	0.019	0.0133	No	0.2037	No
3/20/2023 11:20	0.192	0.013	0.0134	No	0.2057	No
3/20/2023 11:21	0.183	0.016	0.0138	No	0.2059	No
3/20/2023 11:22	0.187	0.016	0.0143	No	0.2041	No
3/20/2023 11:23	0.183	0.016	0.0147	No	0.2031	No
3/20/2023 11:24	0.195	0.016	0.0147	No	0.2051	No
3/20/2023 11:25	0.168	0.011	0.0141	No	0.2052	No
3/20/2023 11:26	0.163	0.01	0.014	No	0.2045	No
3/20/2023 11:27	0.163	0.011	0.014	No	0.2046	No
3/20/2023 11:28	0.177	0.012	0.0141	No	0.2044	No
3/20/2023 11:29	0.165	0.017	0.0147	No	0.2011	No
3/20/2023 11:30	0.179	0.012	0.0144	No	0.1977	No
3/20/2023 11:31	0.182	0.015	0.0145	No	0.1943	No
3/20/2023 11:32	0.155	0.012	0.0142	No	0.1912	No
3/20/2023 11:33	0.169	0.013	0.0139	No	0.1829	No
3/20/2023 11:34	0.181	0.012	0.0135	No	0.1761	No
3/20/2023 11:35	0.165	0.011	0.0133	No	0.1743	No
3/20/2023 11:36	0.151	0.011	0.013	No	0.1722	No
3/20/2023 11:37	0.154	0.012	0.0127	No	0.17	No
3/20/2023 11:38	0.143	0.012	0.0125	No	0.1673	No
3/20/2023 11:39	0.185	0.025	0.0131	No	0.1667	No
3/20/2023 11:40	0.144	0.018	0.0135	No	0.1651	No
3/20/2023 11:41	0.144	0.022	0.0143	No	0.1638	No
3/20/2023 11:42	0.144	0.022	0.0151	No	0.1625	No
3/20/2023 11:43	0.157	0.018	0.0155	No	0.1612	No
3/20/2023 11:44	0.157	0.017	0.0155	No	0.1607	No
3/20/2023 11:45	0.145	0.016	0.0157	No	0.1584	No
3/20/2023 11:46	0.162	0.016	0.0158	No	0.1571	No
3/20/2023 11:47	0.144	0.014	0.0159	No	0.1563	No
3/20/2023 11:48	0.175	0.018	0.0163	No	0.1567	No
3/20/2023 11:49	0.197	0.018	0.0167	No	0.1578	No
3/20/2023 11:50	0.233	0.021	0.0173	No	0.1623	No
3/20/2023 11:51	0.212	0.018	0.0178	No	0.1664	No
3/20/2023 11:52	0.182	0.02	0.0183	No	0.1683	No
3/20/2023 11:53	0.224	0.03	0.0195	No	0.1737	No
3/20/2023 11:54	0.186	0.029	0.0198	No	0.1737	No
3/20/2023 11:55	0.22	0.034	0.0209	No	0.1788	No
3/20/2023 11:56	0.178	0.028	0.0213	No	0.1811	No

Downwind Station						
Time	Instantaneous VOC (ppm)	Instantaneous Mass Conc. Total (mg/m ³)	Mass Conc. Total mg/m ³ AVG 15m (mg/m ³)	Dust Exceedance	VOC ppm AVG 15m (ppm)	VOC Exceedance
3/20/2023 11:57	0.167	0.03	0.0218	No	0.1826	No
3/20/2023 11:58	0.171	0.025	0.0223	No	0.1835	No
3/20/2023 11:59	0.158	0.018	0.0223	No	0.1836	No
3/20/2023 12:00	0.183	0.023	0.0228	No	0.1861	No
3/20/2023 12:01	0.156	0.022	0.0232	No	0.1857	No
3/20/2023 12:02	0.174	0.02	0.0236	No	0.1877	No
3/20/2023 12:03	0.181	0.02	0.0237	No	0.1881	No
3/20/2023 12:04	0.186	0.02	0.0239	No	0.1874	No
3/20/2023 12:05	0.175	0.016	0.0235	No	0.1835	No
3/20/2023 12:06	0.149	0.014	0.0233	No	0.1793	No
3/20/2023 12:07	0.152	0.017	0.0231	No	0.1773	No
3/20/2023 12:08	0.154	0.015	0.0221	No	0.1727	No
3/20/2023 12:09	0.156	0.014	0.0211	No	0.1707	No
3/20/2023 12:10	0.178	0.018	0.02	No	0.1679	No
3/20/2023 12:11	0.156	0.019	0.0194	No	0.1664	No
3/20/2023 12:12	0.169	0.018	0.0186	No	0.1665	No
3/20/2023 12:13	0.169	0.021	0.0183	No	0.1664	No
3/20/2023 12:14	0.16	0.027	0.0189	No	0.1665	No
3/20/2023 12:15	0.154	0.031	0.0195	No	0.1646	No
3/20/2023 12:16	0.136	0.016	0.0191	No	0.1633	No
3/20/2023 12:17	0.132	0.013	0.0186	No	0.1605	No
3/20/2023 12:18	0.154	0.015	0.0183	No	0.1587	No
3/20/2023 12:19	0.157	0.014	0.0179	No	0.1567	No
3/20/2023 12:20	0.179	0.018	0.018	No	0.157	No
3/20/2023 12:21	0.186	0.025	0.0187	No	0.1595	No
3/20/2023 12:22	0.193	0.026	0.0193	No	0.1622	No
3/20/2023 12:23	0.161	0.02	0.0197	No	0.1627	No
3/20/2023 12:24	0.188	0.023	0.0203	No	0.1648	No
3/20/2023 12:25	0.16	0.027	0.0209	No	0.1636	No
3/20/2023 12:26	0.145	0.015	0.0206	No	0.1629	No
3/20/2023 12:27	0.169	0.017	0.0205	No	0.1629	No
3/20/2023 12:28	0.157	0.027	0.0209	No	0.1621	No
3/20/2023 12:29	0.157	0.018	0.0203	No	0.1619	No
3/20/2023 12:30	0.17	0.016	0.0193	No	0.1629	No
3/20/2023 12:31	0.156	0.019	0.0195	No	0.1643	No
3/20/2023 12:32	0.176	0.022	0.0201	No	0.1672	No
3/20/2023 12:33	0.184	0.024	0.0207	No	0.1692	No
3/20/2023 12:34	0.156	0.02	0.0211	No	0.1691	No
3/20/2023 12:35	0.175	0.015	0.0209	No	0.1689	No
3/20/2023 12:36	0.171	0.025	0.0209	No	0.1679	No
3/20/2023 12:37	0.159	0.017	0.0203	No	0.1656	No
3/20/2023 12:38	0.199	0.02	0.0203	No	0.1681	No
3/20/2023 12:39	0.166	0.038	0.0213	No	0.1667	No
3/20/2023 12:40	0.167	0.023	0.0211	No	0.1671	No
3/20/2023 12:41	0.167	0.016	0.0211	No	0.1686	No
3/20/2023 12:42	0.152	0.019	0.0213	No	0.1675	No
3/20/2023 12:43	0.155	0.026	0.0212	No	0.1673	No
3/20/2023 12:44	0.153	0.019	0.0213	No	0.1671	No
3/20/2023 12:45	0.159	0.021	0.0216	No	0.1663	No
3/20/2023 12:46	0.196	0.04	0.023	No	0.169	No
3/20/2023 12:47	0.207	0.046	0.0246	No	0.1711	No
3/20/2023 12:48	0.165	0.034	0.0253	No	0.1698	No
3/20/2023 12:49	0.17	0.017	0.0251	No	0.1707	No

Downwind Station						
Time	Instantaneous VOC (ppm)	Instantaneous Mass Conc. Total (mg/m ³)	Mass Conc. Total mg/m ³ AVG 15m (mg/m ³)	Dust Exceedance	VOC ppm AVG 15m (ppm)	VOC Exceedance
3/20/2023 12:50	0.172	0.018	0.0253	No	0.1705	No
3/20/2023 12:51	0.172	0.028	0.0255	No	0.1706	No
3/20/2023 12:52	0.169	0.045	0.0273	No	0.1713	No
3/20/2023 12:53	0.166	0.019	0.0273	No	0.1691	No
3/20/2023 12:54	0.194	0.032	0.0269	No	0.1709	No
3/20/2023 12:55	0.173	0.03	0.0273	No	0.1713	No
3/20/2023 12:56	0.157	0.017	0.0274	No	0.1707	No
3/20/2023 12:57	0.189	0.015	0.0271	No	0.1731	No
3/20/2023 12:58	0.181	0.032	0.0275	No	0.1749	No
3/20/2023 12:59	0.178	0.019	0.0275	No	0.1765	No
3/20/2023 13:00	0.175	0.016	0.0272	No	0.1776	No
3/20/2023 13:01	0.165	0.013	0.0254	No	0.1755	No
3/20/2023 13:02	0.18	0.016	0.0234	No	0.1737	No
3/20/2023 13:03	0.17	0.021	0.0225	No	0.1741	No
3/20/2023 13:04	0.175	0.02	0.0227	No	0.1744	No
3/20/2023 13:05	0.175	0.016	0.0226	No	0.1746	No
3/20/2023 13:06	0.18	0.014	0.0217	No	0.1751	No
3/20/2023 13:07	0.187	0.014	0.0196	No	0.1763	No
3/20/2023 13:08	0.194	0.015	0.0193	No	0.1782	No
3/20/2023 13:09	0.193	0.014	0.0181	No	0.1781	No
3/20/2023 13:10	0.171	0.012	0.0169	No	0.178	No
3/20/2023 13:11	0.179	0.012	0.0166	No	0.1795	No
3/20/2023 13:12	0.171	0.013	0.0165	No	0.1783	No
3/20/2023 13:13	0.184	0.018	0.0155	No	0.1785	No
3/20/2023 13:14	0.172	0.016	0.0153	No	0.1781	No
3/20/2023 13:15	0.187	0.013	0.0151	No	0.1789	No
3/20/2023 13:16	0.181	0.015	0.0153	No	0.1799	No
3/20/2023 13:17	0.183	0.014	0.0151	No	0.1801	No
3/20/2023 13:18	0.194	0.016	0.0148	No	0.1817	No
3/20/2023 13:19	0.178	0.016	0.0145	No	0.1819	No
3/20/2023 13:20	0.17	0.015	0.0145	No	0.1816	No
3/20/2023 13:21	0.166	0.019	0.0148	No	0.1807	No
3/20/2023 13:22	0.18	0.017	0.015	No	0.1802	No
3/20/2023 13:23	0.186	0.017	0.0151	No	0.1797	No
3/20/2023 13:24	0.194	0.019	0.0155	No	0.1797	No
3/20/2023 13:25	0.188	0.016	0.0157	No	0.1809	No
3/20/2023 13:26	0.171	0.013	0.0158	No	0.1803	No
3/20/2023 13:27	0.175	0.018	0.0161	No	0.1806	No
3/20/2023 13:28	0.186	0.012	0.0157	No	0.1807	No
3/20/2023 13:29	0.196	0.016	0.0157	No	0.1823	No
3/20/2023 13:30	0.169	0.014	0.0158	No	0.1811	No
3/20/2023 13:31	0.169	0.012	0.0156	No	0.1803	No
3/20/2023 13:32	0.176	0.012	0.0155	No	0.1799	No
3/20/2023 13:33	0.179	0.016	0.0155	No	0.1789	No
3/20/2023 13:34	0.182	0.016	0.0155	No	0.1791	No
3/20/2023 13:35	0.175	0.02	0.0158	No	0.1795	No
3/20/2023 13:36	0.173	0.016	0.0156	No	0.1799	No
3/20/2023 13:37	0.172	0.014	0.0154	No	0.1794	No
3/20/2023 13:38	0.171	0.018	0.0155	No	0.1784	No
3/20/2023 13:39	0.168	0.033	0.0164	No	0.1767	No
3/20/2023 13:40	0.189	0.068	0.0199	No	0.1767	No
3/20/2023 13:41	0.178	0.035	0.0213	No	0.1772	No
3/20/2023 13:42	0.183	0.033	0.0223	No	0.1777	No

Downwind Station						
Time	Instantaneous VOC (ppm)	Instantaneous Mass Conc. Total (mg/m ³)	Mass Conc. Total mg/m ³ AVG 15m (mg/m ³)	Dust Exceedance	VOC ppm AVG 15m (ppm)	VOC Exceedance
3/20/2023 13:43	0.212	0.022	0.023	No	0.1795	No
3/20/2023 13:44	0.201	0.019	0.0232	No	0.1798	No
3/20/2023 13:45	0.194	0.041	0.025	No	0.1815	No
3/20/2023 13:46	0.201	0.047	0.0273	No	0.1836	No
3/20/2023 13:47	0.186	0.068	0.0311	No	0.1843	No
3/20/2023 13:48	0.207	0.038	0.0325	No	0.1861	No
3/20/2023 13:49	0.205	0.043	0.0343	No	0.1877	No
3/20/2023 13:50	0.198	0.025	0.0347	No	0.1892	No
3/20/2023 13:51	0.179	0.029	0.0355	No	0.1896	No
3/20/2023 13:52	0.183	0.014	0.0355	No	0.1903	No
3/20/2023 13:53	0.187	0.019	0.0356	No	0.1914	No
3/20/2023 13:54	0.19	0.054	0.037	No	0.1929	No
3/20/2023 13:55	0.187	0.038	0.035	No	0.1927	No
3/20/2023 13:56	0.208	0.049	0.0359	No	0.1947	No
3/20/2023 13:57	0.191	0.027	0.0355	No	0.1953	No
3/20/2023 13:58	0.214	0.021	0.0355	No	0.1954	No
3/20/2023 13:59	0.188	0.021	0.0356	No	0.1945	No
3/20/2023 14:00	0.174	0.019	0.0341	No	0.1932	No
3/20/2023 14:01	0.171	0.02	0.0323	No	0.1912	No
3/20/2023 14:02	0.177	0.019	0.0291	No	0.1906	No
3/20/2023 14:03	0.181	0.02	0.0279	No	0.1889	No
3/20/2023 14:04	0.195	0.014	0.0259	No	0.1882	No
3/20/2023 14:05	0.222	0.027	0.0261	No	0.1898	No
3/20/2023 14:06	0.222	0.037	0.0266	No	0.1927	No
3/20/2023 14:07	0.212	0.024	0.0273	No	0.1946	No
3/20/2023 14:08	0.191	0.037	0.0285	No	0.1949	No
3/20/2023 14:09	0.195	0.027	0.0267	No	0.1952	No
3/20/2023 14:10	0.181	0.021	0.0255	No	0.1948	No
3/20/2023 14:11	0.175	0.017	0.0234	No	0.1926	No
3/20/2023 14:12	0.207	0.02	0.0229	No	0.1937	No
3/20/2023 14:13	0.243	0.023	0.0231	No	0.1956	No
3/20/2023 14:14	0.204	0.022	0.0231	No	0.1967	No
3/20/2023 14:15	0.216	0.018	0.0231	No	0.1995	No
3/20/2023 14:16	0.198	0.02	0.0231	No	0.2013	No
3/20/2023 14:17	0.188	0.015	0.0228	No	0.202	No
3/20/2023 14:18	0.196	0.015	0.0225	No	0.203	No
3/20/2023 14:19	0.195	0.015	0.0225	No	0.203	No
3/20/2023 14:20	0.202	0.015	0.0217	No	0.2017	No
3/20/2023 14:21	0.189	0.017	0.0204	No	0.1995	No
3/20/2023 14:22	0.194	0.015	0.0198	No	0.1983	No
3/20/2023 14:23	0.195	0.07	0.022	No	0.1985	No
3/20/2023 14:24	0.21	0.017	0.0213	No	0.1995	No
3/20/2023 14:25	0.201	0.016	0.021	No	0.2009	No
3/20/2023 14:26	0.216	0.021	0.0213	No	0.2036	No
3/20/2023 14:27	0.189	0.018	0.0211	No	0.2024	No
3/20/2023 14:28	0.209	0.018	0.0208	No	0.2001	No
3/20/2023 14:29	0.207	0.018	0.0205	No	0.2003	No
3/20/2023 14:30	0.208	0.023	0.0209	No	0.1998	No
3/20/2023 14:31	0.254	0.024	0.0211	No	0.2035	No
3/20/2023 14:32	0.209	0.023	0.0217	No	0.2049	No
3/20/2023 14:33	0.167	0.015	0.0217	No	0.203	No
3/20/2023 14:34	0.195	0.013	0.0215	No	0.203	No
3/20/2023 14:35	0.22	0.017	0.0217	No	0.2042	No

Downwind Station						
Time	Instantaneous VOC (ppm)	Instantaneous Mass Conc. Total (mg/m ³)	Mass Conc. Total mg/m ³ AVG 15m (mg/m ³)	Dust Exceedance	VOC ppm AVG 15m (ppm)	VOC Exceedance
3/20/2023 14:36	0.226	0.022	0.022	No	0.2067	No
3/20/2023 14:37	0.217	0.021	0.0224	No	0.2082	No
3/20/2023 14:38	0.219	0.017	0.0189	No	0.2098	No
3/20/2023 14:39	0.199	0.016	0.0188	No	0.2091	No
3/20/2023 14:40	0.232	0.046	0.0208	No	0.2111	No
3/20/2023 14:41	0.213	0.019	0.0207	No	0.2109	No
3/20/2023 14:42	0.188	0.014	0.0204	No	0.2109	No
3/20/2023 14:43	0.188	0.014	0.0201	No	0.2095	No
3/20/2023 14:44	0.192	0.014	0.0199	No	0.2085	No
3/20/2023 14:45	0.244	0.016	0.0194	No	0.2109	No
3/20/2023 14:46	0.221	0.024	0.0194	No	0.2087	No
3/20/2023 14:47	0.201	0.017	0.019	No	0.2081	No
3/20/2023 14:48	0.234	0.016	0.0191	No	0.2126	No
3/20/2023 14:49	0.202	0.014	0.0191	No	0.2131	No
3/20/2023 14:50	0.186	0.024	0.0196	No	0.2108	No
3/20/2023 14:51	0.193	0.012	0.0189	No	0.2086	No
3/20/2023 14:52	0.278	0.013	0.0184	No	0.2127	No
3/20/2023 14:53	0.222	0.016	0.0183	No	0.2129	No
3/20/2023 14:54	0.231	0.018	0.0185	No	0.215	No
3/20/2023 14:55	0.22	0.019	0.0167	No	0.2142	No
3/20/2023 14:56	0.197	0.016	0.0165	No	0.2131	No
3/20/2023 14:57	0.204	0.018	0.0167	No	0.2142	No
3/20/2023 14:58	0.418	0.018	0.017	No	0.2295	No
3/20/2023 14:59	0.201	0.019	0.0173	No	0.2301	No
3/20/2023 15:00	0.186	0.014	0.0172	No	0.2263	No
3/20/2023 15:01	0.196	0.024	0.0172	No	0.2246	No
3/20/2023 15:02	0.202	0.067	0.0205	No	0.2247	No
3/20/2023 15:03	0.208	0.017	0.0206	No	0.2229	No
3/20/2023 15:04	0.202	0.016	0.0207	No	0.2229	No
3/20/2023 15:05	0.192	0.016	0.0202	No	0.2233	No
3/20/2023 15:06	0.193	0.016	0.0205	No	0.2233	No
3/20/2023 15:07	0.187	0.017	0.0207	No	0.2173	No
3/20/2023 15:08	0.195	0.015	0.0207	No	0.2155	No
3/20/2023 15:09	0.192	0.015	0.0205	No	0.2129	No
3/20/2023 15:10	0.194	0.016	0.0203	No	0.2111	No
3/20/2023 15:11	0.208	0.017	0.0203	No	0.2119	No
3/20/2023 15:12	0.191	0.025	0.0208	No	0.211	No
3/20/2023 15:13	0.208	0.017	0.0207	No	0.197	No
3/20/2023 15:14	0.218	0.025	0.0211	No	0.1981	No
3/20/2023 15:15	0.226	0.017	0.0213	No	0.2008	No
3/20/2023 15:16	0.242	0.016	0.0208	No	0.2039	No
3/20/2023 15:17	0.446	0.023	0.0179	No	0.2201	No