



Daily Activity Report

Seton Brilla Charter School
1956 Jerome Avenue, Bronx, NY
BCP No. C203152

General Site Information

Date:	Thursday, March 16, 2023
Weather:	Sunny, 45°F
Wind Direction/Speed:	E @ 6 mph
AKRF Personnel on Site:	J. Kelleher-Ferguson
AKRF Equipment on Site:	Mini RAE 3000 Photoionization Detector [(PID) x1], 2 Fixed Air Monitoring Stations [DustTrak
Visitors:	None.

Contractor Information

Contracting Company	Main Personnel	Equipment
Casino Construction	Carlos	Excavator

Description and Location of Work Activities Performed

- 1) Soil grading and stockpile management in grids WC-03 and WC-04. Stockpiles were covered with plastic sheeting at the end of the day.
- 2) Pile cap construction activities continued.

Destination Facility	Daily Trucks	Total Trucks	Daily Approx. Cubic Yds	Total Approx. Cubic Yds	Total Site Loads	Total Approximate Cubic Yards
Clean Earth Carteret	0	79	0	1,580	172	3,440
Clean Earth Southeastern Pennsylvania	0	67	0	1,340		
Concrete Disposal	0	26	0	520		
N/A	0	0	0	0		
N/A	0	0	0	0		

CAMP Air Monitoring Results

CAMP Station	UPWIND				DOWNWIND		
Odors:	None.				None.		
VOC Action Level Exceedance(s):	None.				None.		
Particulate Action Level Exceedance(s):	None.				None.		
Maximum VOC Level (15 min ppm):	0.137				0.0780		
Maximum Particulate Level (15 min mg/m ³):	0.082				0.1940		

Notes: CAMP monitoring was performed throughout the day. A particulate exceedance was detected at the downwind station at approximately 0814 due to welding activities near the CAMP station. Concentrations returned to normal once the welding stopped.





Additional Information

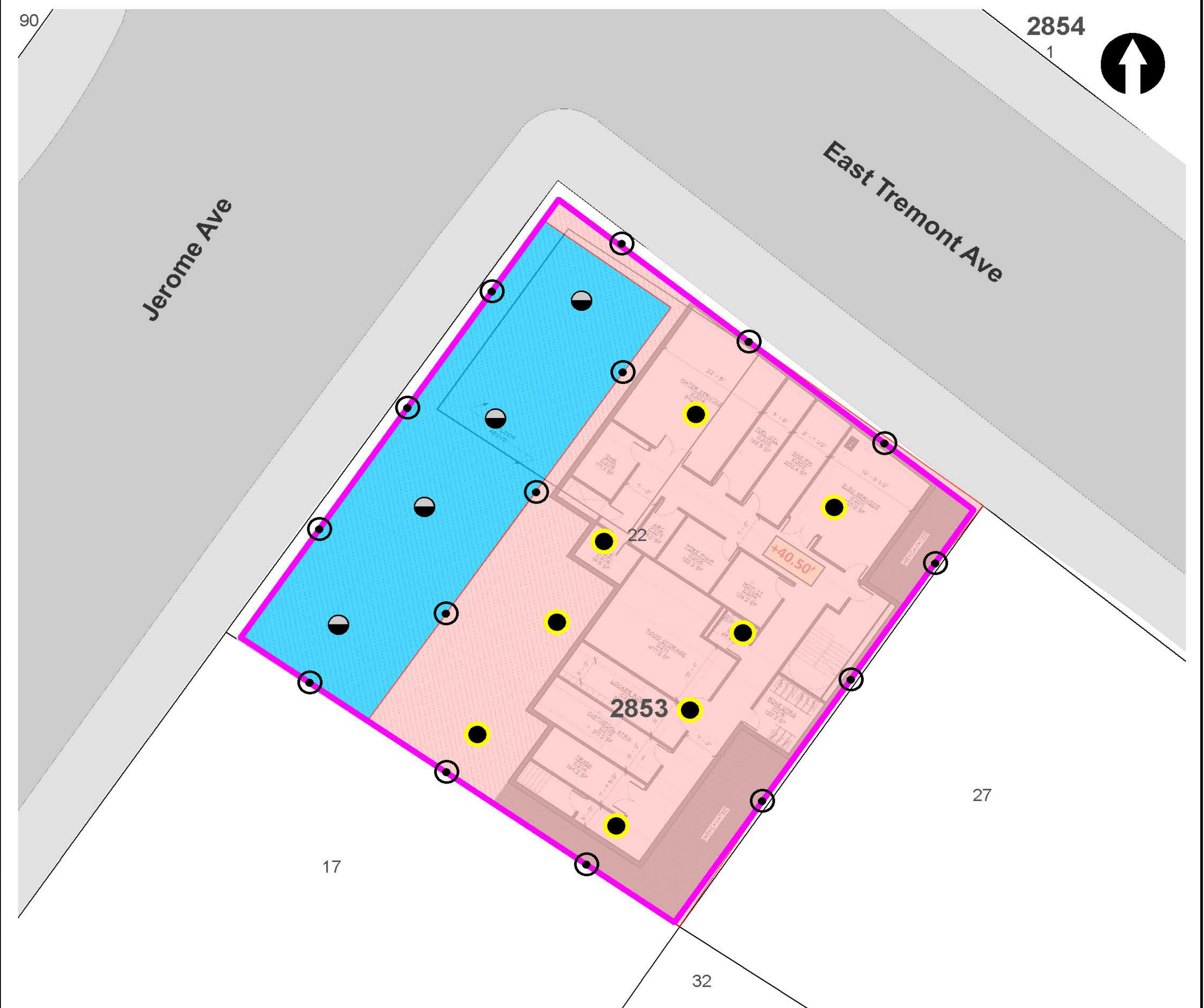

Planned Work Activity for Following Day/Week:	1) Excavation of soil/fill to uncover piles. 2) Cutting piles to final elevations
Comments:	None.

Site Map



LEGEND

-  PROJECT SITE BOUNDARY
-  LOT BOUNDARY AND TAX LOT NUMBER
- 2853** BLOCK NUMBER
-  REMEDIAL EXCAVATION TO APPROXIMATELY TWO FEET BELOW EXISTING GRADE
-  REMEDIAL EXCAVATION TO GROUNDWATER (SOURCE AREA)

-  CONFIRMATION DOCUMENTATION BOTTOM SAMPLE
-  SOURCE AREA DOCUMENTATION BOTTOM SAMPLE
-  DOCUMENTATION SIDEWALL SAMPLE

NOTE
 REMEDIAL EXCAVATION WILL INCLUDE REMOVAL OF APPROXIMATELY 1,280 TONS (850 CUBIC YARDS) OF SOURCE MATERIAL ASSOCIATED WITH NYSDEC SPILL NO. 2103719 AND APPROXIMATELY 860 TONS (570 CUBIC YARDS) OF SOIL/FILL FROM THE UPPER 2 FEET SITE-WIDE.



Map Source:
 NYCDP (NYC Dept. of City Planning) GIS database

© 2021 AKRF. W:\Projects\210024 - 1956 JEROME AVENUE\Technical\GIS and Graphics\AR\RAWP\210024 Figure 9 Proposed Remedial Excavation and Documentation Sample Location Plan.mxd 10/25/2021 2:03:38 PM iszalus



440 Park Avenue South, New York, NY 10016

1956 Jerome Avenue
 Bronx, New York

**TRACK 4 CLEANUP AND DOCUMENTATION
 SAMPLE LOCATION PLAN**

DATE
04/29/2022

PROJECT NO.
210024

FIGURE
11

Site Photographs

Photograph 1 -
Regrading and
managing stockpiles
of soil, view facing
east.



Photograph 2-
Preparing grid WC-
03 for pile cap
concrete pours, view
facing southeast.



Photograph 3-
Grading soil in grid
WC-03, view facing
east.



Upwind Station						
Time	Instaneous VOC (ppm)	Instaneous Mass Conc. Total (mg/m ³)	Mass Conc. Total mg/m ³ AVG 15m (mg/m ³)	Dust Exceedance	VOC ppm AVG 15m (ppm)	VOC Exceedance
3/16/2023 7:02	0			No	0	No
3/16/2023 7:03	0			No	0	No
3/16/2023 7:04	0			No	0	No
3/16/2023 7:05	0			No	0	No
3/16/2023 7:06	0			No	0	No
3/16/2023 7:07	0			No	0	No
3/16/2023 7:08	0			No	0	No
3/16/2023 7:09	0			No	0	No
3/16/2023 7:10	0	0.015	0.015	No	0	No
3/16/2023 7:11	0	0.043	0.029	No	0	No
3/16/2023 7:12	0			No	0	No
3/16/2023 7:13	0	0.128	0.062	No	0	No
3/16/2023 7:14	0	0.025	0.0528	No	0	No
3/16/2023 7:15	0	0.01	0.0442	No	0	No
3/16/2023 7:16	0	0.009	0.0383	No	0	No
3/16/2023 7:17	0	0.01	0.0343	No	0	No
3/16/2023 7:18	0	0.011	0.0314	No	0	No
3/16/2023 7:19	0	0.011	0.0291	No	0	No
3/16/2023 7:20	0	0.011	0.0273	No	0	No
3/16/2023 7:21	0	0.015	0.0262	No	0	No
3/16/2023 7:22	0	0.014	0.0252	No	0	No
3/16/2023 7:23	0	0.016	0.0245	No	0	No
3/16/2023 7:24	0	0.015	0.0238	No	0	No
3/16/2023 7:25	0	0.011	0.0235	No	0	No
3/16/2023 7:26	0	0.01	0.0211	No	0	No
3/16/2023 7:27	0	0.01	0.0204	No	0	No
3/16/2023 7:28	0	0.011	0.0126	No	0	No
3/16/2023 7:29	0	0.013	0.0118	No	0	No
3/16/2023 7:30	0	0.011	0.0119	No	0	No
3/16/2023 7:31	0	0.011	0.012	No	0	No
3/16/2023 7:32	0	0.011	0.0121	No	0	No
3/16/2023 7:33	0	0.011	0.0121	No	0	No
3/16/2023 7:34	0	0.019	0.0126	No	0	No
3/16/2023 7:35	0	0.014	0.0128	No	0	No
3/16/2023 7:36	0	0.011	0.0125	No	0	No
3/16/2023 7:37	0	0.01	0.0123	No	0	No
3/16/2023 7:38	0	0.015	0.0122	No	0	No
3/16/2023 7:39	0	0.124	0.0195	No	0	No
3/16/2023 7:40	0	0.08	0.0241	No	0	No
3/16/2023 7:41	0	0.043	0.0263	No	0	No
3/16/2023 7:42	0	0.044	0.0285	No	0	No
3/16/2023 7:43	0	0.172	0.0393	No	0	No
3/16/2023 7:44	0	0.044	0.0413	No	0	No
3/16/2023 7:45	0	0.021	0.042	No	0	No
3/16/2023 7:46	0	0.258	0.0585	No	0	No
3/16/2023 7:47	0	0.07	0.0624	No	0	No
3/16/2023 7:48	0	0.018	0.0629	No	0	No
3/16/2023 7:49	0	0.016	0.0627	No	0	No
3/16/2023 7:50	0	0.02	0.0631	No	0	No
3/16/2023 7:51	0	0.014	0.0633	No	0	No
3/16/2023 7:52	0	0.012	0.0634	No	0	No
3/16/2023 7:53	0	0.012	0.0632	No	0	No

Upwind Station						
Time	Instaneous VOC (ppm)	Instaneous Mass Conc. Total (mg/m ³)	Mass Conc. Total mg/m ³ AVG 15m (mg/m ³)	Dust Exceedance	VOC ppm AVG 15m (ppm)	VOC Exceedance
3/16/2023 7:54	0	0.052	0.0584	No	0	No
3/16/2023 7:55	0	0.03	0.0551	No	0	No
3/16/2023 7:56	0	0.066	0.0566	No	0	No
3/16/2023 7:57	0	0.102	0.0605	No	0	No
3/16/2023 7:58	0	0.081	0.0544	No	0	No
3/16/2023 7:59	0	0.044	0.0544	No	0	No
3/16/2023 8:00	0	0.134	0.0619	No	0	No
3/16/2023 8:01	0	0.203	0.0583	No	0	No
3/16/2023 8:02	0	0.111	0.061	No	0	No
3/16/2023 8:03	0	0.071	0.0645	No	0	No
3/16/2023 8:04	0	0.198	0.0767	No	0	No
3/16/2023 8:05	0	0.075	0.0803	No	0	No
3/16/2023 8:06	0	0.023	0.0809	No	0	No
3/16/2023 8:07	0	0.017	0.0813	No	0	No
3/16/2023 8:08	0	0.015	0.0815	No	0	No
3/16/2023 8:09	0	0.014	0.0789	No	0	No
3/16/2023 8:10	0	0.014	0.0779	No	0	No
3/16/2023 8:11	0	0.011	0.0742	No	0	No
3/16/2023 8:12	0	0.013	0.0683	No	0	No
3/16/2023 8:13	0	0.012	0.0637	No	0	No
3/16/2023 8:14	0	0.012	0.0615	No	0	No
3/16/2023 8:15	0	0.011	0.0533	No	0	No
3/16/2023 8:16	0	0.012	0.0406	No	0	No
3/16/2023 8:17	0	0.091	0.0393	No	0	No
3/16/2023 8:18	0	0.022	0.036	No	0	No
3/16/2023 8:19	0	0.011	0.0235	No	0	No
3/16/2023 8:20	0	0.011	0.0193	No	0	No
3/16/2023 8:21	0	0.01	0.0184	No	0	No
3/16/2023 8:22	0	0.019	0.0185	No	0	No
3/16/2023 8:23	0	0.015	0.0185	No	0	No
3/16/2023 8:24	0	0.019	0.0189	No	0	No
3/16/2023 8:25	0	0.017	0.0191	No	0	No
3/16/2023 8:26	0	0.014	0.0193	No	0	No
3/16/2023 8:27	0	0.018	0.0196	No	0	No
3/16/2023 8:28	0	0.022	0.0203	No	0	No
3/16/2023 8:29	0	0.021	0.0209	No	0	No
3/16/2023 8:30	0	0.024	0.0217	No	0	No
3/16/2023 8:31	0	0.037	0.0234	No	0	No
3/16/2023 8:32	0	0.033	0.0195	No	0	No
3/16/2023 8:33	0	0.018	0.0193	No	0	No
3/16/2023 8:34	0	0.016	0.0196	No	0	No
3/16/2023 8:35	0	0.013	0.0197	No	0	No
3/16/2023 8:36	0	0.019	0.0203	No	0	No
3/16/2023 8:37	0	0.016	0.0201	No	0	No
3/16/2023 8:38	0	0.016	0.0202	No	0	No
3/16/2023 8:39	0	0.015	0.0199	No	0	No
3/16/2023 8:40	0	0.018	0.02	No	0	No
3/16/2023 8:41	0	0.023	0.0206	No	0	No
3/16/2023 8:42	0	0.02	0.0207	No	0	No
3/16/2023 8:43	0	0.015	0.0203	No	0	No
3/16/2023 8:44	0	0.021	0.0203	No	0	No
3/16/2023 8:45	0	0.014	0.0196	No	0	No

Upwind Station						
Time	Instaneous VOC (ppm)	Instaneous Mass Conc. Total (mg/m ³)	Mass Conc. Total mg/m ³ AVG 15m (mg/m ³)	Dust Exceedance	VOC ppm AVG 15m (ppm)	VOC Exceedance
3/16/2023 8:46	0	0.013	0.018	No	0	No
3/16/2023 8:47	0	0.018	0.017	No	0	No
3/16/2023 8:48	0	0.015	0.0168	No	0	No
3/16/2023 8:49	0	0.016	0.0168	No	0	No
3/16/2023 8:50	0	0.014	0.0169	No	0	No
3/16/2023 8:51	0	0.014	0.0165	No	0	No
3/16/2023 8:52	0	0.012	0.0163	No	0	No
3/16/2023 8:53	0	0.011	0.0159	No	0	No
3/16/2023 8:54	0	0.01	0.0156	No	0	No
3/16/2023 8:55	0	0.01	0.0151	No	0	No
3/16/2023 8:56	0	0.012	0.0143	No	0	No
3/16/2023 8:57	0	0.014	0.0139	No	0	No
3/16/2023 8:58	0	0.013	0.0138	No	0	No
3/16/2023 8:59	0	0.013	0.0133	No	0	No
3/16/2023 9:00	0	0.013	0.0132	No	0	No
3/16/2023 9:01	0	0.017	0.0135	No	0	No
3/16/2023 9:02	0	0.013	0.0131	No	0	No
3/16/2023 9:03	0	0.014	0.0131	No	0	No
3/16/2023 9:04	0	0.012	0.0128	No	0	No
3/16/2023 9:05	0	0.012	0.0127	No	0	No
3/16/2023 9:06	0	0.011	0.0125	No	0	No
3/16/2023 9:07	0	0.009	0.0123	No	0	No
3/16/2023 9:08	0	0.011	0.0123	No	0	No
3/16/2023 9:09	0	0.011	0.0123	No	0	No
3/16/2023 9:10	0	0.012	0.0125	No	0	No
3/16/2023 9:11	0	0.012	0.0125	No	0	No
3/16/2023 9:12	0	0.01	0.0122	No	0	No
3/16/2023 9:13	0	0.011	0.0121	No	0	No
3/16/2023 9:14	0	0.012	0.012	No	0	No
3/16/2023 9:15	0	0.012	0.0119	No	0	No
3/16/2023 9:16	0	0.013	0.0117	No	0	No
3/16/2023 9:17	0	0.012	0.0116	No	0	No
3/16/2023 9:18	0	0.011	0.0114	No	0	No
3/16/2023 9:19	0	0.014	0.0115	No	0	No
3/16/2023 9:20	0	0.011	0.0115	No	0	No
3/16/2023 9:21	0	0.011	0.0115	No	0	No
3/16/2023 9:22	0	0.012	0.0117	No	0	No
3/16/2023 9:23	0	0.012	0.0117	No	0	No
3/16/2023 9:24	0	0.01	0.0117	No	0	No
3/16/2023 9:25	0	0.012	0.0117	No	0	No
3/16/2023 9:26	0	0.01	0.0115	No	0	No
3/16/2023 9:27	0	0.011	0.0116	No	0	No
3/16/2023 9:28	0	0.013	0.0117	No	0	No
3/16/2023 9:29	0	0.01	0.0116	No	0	No
3/16/2023 9:30	0	0.01	0.0115	No	0	No
3/16/2023 9:31	0	0.01	0.0113	No	0	No
3/16/2023 9:32	0	0.012	0.0113	No	0	No
3/16/2023 9:33	0	0.012	0.0113	No	0	No
3/16/2023 9:34	0	0.013	0.0113	No	0	No
3/16/2023 9:35	0	0.015	0.0115	No	0	No
3/16/2023 9:36	0	0.015	0.0118	No	0	No
3/16/2023 9:37	0	0.011	0.0117	No	0	No

Upwind Station

Time	Instaneous VOC (ppm)	Instaneous Mass Conc. Total (mg/m ³)	Mass Conc. Total mg/m ³ AVG 15m (mg/m ³)	Dust Exceedance	VOC ppm AVG 15m (ppm)	VOC Exceedance
3/16/2023 9:38	0	0.011	0.0117	No	0	No
3/16/2023 9:39	0	0.011	0.0117	No	0	No
3/16/2023 9:40	0	0.011	0.0117	No	0	No
3/16/2023 9:41	0	0.012	0.0118	No	0	No
3/16/2023 9:42	0	0.009	0.0117	No	0	No
3/16/2023 9:43	0	0.009	0.0114	No	0	No
3/16/2023 9:44	0	0.009	0.0113	No	0	No
3/16/2023 9:45	0	0.008	0.0112	No	0	No
3/16/2023 9:46	0	0.009	0.0111	No	0	No
3/16/2023 9:47	0	0.01	0.011	No	0	No
3/16/2023 9:48	0	0.011	0.0109	No	0	No
3/16/2023 9:49	0	0.011	0.0108	No	0	No
3/16/2023 9:50	0	0.013	0.0107	No	0	No
3/16/2023 9:51	0	0.011	0.0104	No	0	No
3/16/2023 9:52	0	0.01	0.0103	No	0	No
3/16/2023 9:53	0	0.011	0.0103	No	0	No
3/16/2023 9:54	0	0.011	0.0103	No	0	No
3/16/2023 9:55	0	0.01	0.0103	No	0	No
3/16/2023 9:56	0	0.011	0.0102	No	0	No
3/16/2023 9:57	0	0.01	0.0103	No	0	No
3/16/2023 9:58	0	0.011	0.0104	No	0	No
3/16/2023 9:59	0	0.013	0.0107	No	0	No
3/16/2023 10:00	0	0.012	0.0109	No	0	No
3/16/2023 10:01	0	0.013	0.0112	No	0	No
3/16/2023 10:02	0	0.009	0.0111	No	0	No
3/16/2023 10:03	0	0.01	0.0111	No	0	No
3/16/2023 10:04	0	0.01	0.011	No	0	No
3/16/2023 10:05	0	0.012	0.0109	No	0	No
3/16/2023 10:06	0	0.011	0.0109	No	0	No
3/16/2023 10:07	0	0.014	0.0112	No	0	No
3/16/2023 10:08	0	0.012	0.0113	No	0	No
3/16/2023 10:09	0	0.011	0.0113	No	0	No
3/16/2023 10:10	0	0.012	0.0114	No	0	No
3/16/2023 10:11	0	0.01	0.0113	No	0	No
3/16/2023 10:12	0	0.01	0.0113	No	0	No
3/16/2023 10:13	0	0.009	0.0112	No	0	No
3/16/2023 10:14	0	0.009	0.0109	No	0	No
3/16/2023 10:15	0	0.009	0.0107	No	0	No
3/16/2023 10:16	0	0.01	0.0105	No	0	No
3/16/2023 10:17	0	0.011	0.0107	No	0	No
3/16/2023 10:18	0	0.01	0.0107	No	0	No
3/16/2023 10:19	0	0.01	0.0107	No	0	No
3/16/2023 10:20	0	0.011	0.0106	No	0	No
3/16/2023 10:21	0	0.011	0.0106	No	0	No
3/16/2023 10:22	0	0.012	0.0105	No	0	No
3/16/2023 10:23	0	0.012	0.0105	No	0	No
3/16/2023 10:24	0	0.014	0.0107	No	0	No
3/16/2023 10:25	0	0.013	0.0107	No	0	No
3/16/2023 10:26	0	0.013	0.0109	No	0	No
3/16/2023 10:27	0	0.012	0.0111	No	0	No
3/16/2023 10:28	0	0.013	0.0113	No	0	No
3/16/2023 10:29	0	0.015	0.0117	No	0	No

Upwind Station						
Time	Instantaneous VOC (ppm)	Instantaneous Mass Conc. Total (mg/m ³)	Mass Conc. Total mg/m ³ AVG 15m (mg/m ³)	Dust Exceedance	VOC ppm AVG 15m (ppm)	VOC Exceedance
3/16/2023 10:30	0	0.013	0.012	No	0	No
3/16/2023 10:31	0	0.012	0.0121	No	0	No
3/16/2023 10:32	0	0.013	0.0123	No	0	No
3/16/2023 10:33	0	0.013	0.0125	No	0	No
3/16/2023 10:34	0	0.015	0.0128	No	0	No
3/16/2023 10:35	0	0.013	0.0129	No	0	No
3/16/2023 10:36	0	0.011	0.0129	No	0	No
3/16/2023 10:37	0	0.011	0.0129	No	0	No
3/16/2023 10:38	0	0.014	0.013	No	0	No
3/16/2023 10:39	0	0.012	0.0129	No	0	No
3/16/2023 10:40	0	0.012	0.0128	No	0	No
3/16/2023 10:41	0	0.01	0.0126	No	0	No
3/16/2023 10:42	0	0.013	0.0127	No	0	No
3/16/2023 10:43	0	0.012	0.0126	No	0	No
3/16/2023 10:44	0	0.014	0.0125	No	0	No
3/16/2023 10:45	0	0.021	0.0131	No	0	No
3/16/2023 10:46	0	0.012	0.0131	No	0	No
3/16/2023 10:47	0	0.014	0.0131	No	0	No
3/16/2023 10:48	0	0.014	0.0132	No	0	No
3/16/2023 10:49	0	0.011	0.0129	No	0	No
3/16/2023 10:50	0	0.011	0.0128	No	0	No
3/16/2023 10:51	0	0.01	0.0127	No	0	No
3/16/2023 10:52	0	0.011	0.0127	No	0	No
3/16/2023 10:53	0	0.011	0.0125	No	0	No
3/16/2023 10:54	0	0.01	0.0124	No	0	No
3/16/2023 10:55	0	0.011	0.0123	No	0	No
3/16/2023 10:56	0	0.014	0.0126	No	0	No
3/16/2023 10:57	0	0.022	0.0132	No	0	No
3/16/2023 10:58	0	0.024	0.014	No	0	No
3/16/2023 10:59	0	0.014	0.014	No	0	No
3/16/2023 11:00	0	0.011	0.0133	No	0	No
3/16/2023 11:01	0	0.012	0.0133	No	0	No
3/16/2023 11:02	0	0.013	0.0133	No	0	No
3/16/2023 11:03	0	0.017	0.0135	No	0	No
3/16/2023 11:04	0	0.024	0.0143	No	0	No
3/16/2023 11:05	0	0.012	0.0144	No	0	No
3/16/2023 11:06	0	0.011	0.0145	No	0	No
3/16/2023 11:07	0	0.011	0.0145	No	0	No
3/16/2023 11:08	0	0.011	0.0145	No	0	No
3/16/2023 11:09	0	0.017	0.0149	No	0	No
3/16/2023 11:10	0	0.014	0.0151	No	0	No
3/16/2023 11:11	0.098	0.032	0.0163	No	0.0065	No
3/16/2023 11:12	0.14	0.056	0.0186	No	0.0159	No
3/16/2023 11:13	0.338	0.064	0.0213	No	0.0384	No
3/16/2023 11:14	0.254	0.055	0.024	No	0.0553	No
3/16/2023 11:15	0.161	0.043	0.0261	No	0.0661	No
3/16/2023 11:16	0.072	0.022	0.0268	No	0.0709	No
3/16/2023 11:17	0	0.026	0.0277	No	0.0709	No
3/16/2023 11:18	0.227	0.026	0.0283	No	0.086	No
3/16/2023 11:19	0.446	0.053	0.0302	No	0.1157	No
3/16/2023 11:20	0.169	0.027	0.0312	No	0.127	No
3/16/2023 11:21	0.052	0.018	0.0317	No	0.1305	No

Upwind Station						
Time	Instaneous VOC (ppm)	Instaneous Mass Conc. Total (mg/m ³)	Mass Conc. Total mg/m ³ AVG 15m (mg/m ³)	Dust Exceedance	VOC ppm AVG 15m (ppm)	VOC Exceedance
3/16/2023 11:22	0.013	0.01	0.0316	No	0.1313	No
3/16/2023 11:23	0.01	0.013	0.0317	No	0.132	No
3/16/2023 11:24	0.074	0.021	0.032	No	0.1369	No
3/16/2023 11:25	0.007	0.036	0.0335	No	0.1374	No
3/16/2023 11:26	0.078	0.032	0.0335	No	0.1361	No
3/16/2023 11:27	0.133	0.027	0.0315	No	0.1356	No
3/16/2023 11:28	0.001	0.033	0.0295	No	0.1131	No
3/16/2023 11:29	0	0.022	0.0273	No	0.0962	No
3/16/2023 11:30	0	0.02	0.0257	No	0.0855	No
3/16/2023 11:31	0	0.02	0.0256	No	0.0807	No
3/16/2023 11:32	0	0.011	0.0246	No	0.0807	No
3/16/2023 11:33	0	0.017	0.024	No	0.0655	No
3/16/2023 11:34	0	0.013	0.0213	No	0.0358	No
3/16/2023 11:35	0	0.013	0.0204	No	0.0245	No
3/16/2023 11:36	0.017	0.015	0.0202	No	0.0222	No
3/16/2023 11:37	0.002	0.024	0.0211	No	0.0215	No
3/16/2023 11:38	0	0.023	0.0218	No	0.0208	No
3/16/2023 11:39	0	0.02	0.0217	No	0.0159	No
3/16/2023 11:40	0	0.018	0.0205	No	0.0154	No
3/16/2023 11:41	0	0.024	0.02	No	0.0102	No
3/16/2023 11:42	0	0.028	0.0201	No	0.0013	No
3/16/2023 11:43	0	0.025	0.0195	No	0.0013	No
3/16/2023 11:44	0	0.013	0.0189	No	0.0013	No
3/16/2023 11:45	0	0.024	0.0192	No	0.0013	No
3/16/2023 11:46	0	0.019	0.0191	No	0.0013	No
3/16/2023 11:47	0	0.017	0.0195	No	0.0013	No
3/16/2023 11:48	0	0.013	0.0193	No	0.0013	No
3/16/2023 11:49	0	0.011	0.0191	No	0.0013	No
3/16/2023 11:50	0	0.011	0.019	No	0.0013	No
3/16/2023 11:51	0	0.01	0.0187	No	0.0001	No
3/16/2023 11:52	0	0.012	0.0179	No	0	No
3/16/2023 11:53	0.036	0.021	0.0177	No	0.0024	No
3/16/2023 11:54	0	0.017	0.0175	No	0.0024	No
3/16/2023 11:55	0	0.015	0.0173	No	0.0024	No
3/16/2023 11:56	0	0.016	0.0168	No	0.0024	No
3/16/2023 11:57	0	0.015	0.0159	No	0.0024	No
3/16/2023 11:58	0	0.015	0.0153	No	0.0024	No
3/16/2023 11:59	0	0.015	0.0154	No	0.0024	No
3/16/2023 12:00	0	0.016	0.0149	No	0.0024	No
3/16/2023 12:01	0	0.017	0.0147	No	0.0024	No
3/16/2023 12:02	0	0.011	0.0143	No	0.0024	No
3/16/2023 12:03	0	0.011	0.0142	No	0.0024	No
3/16/2023 12:04	0	0.012	0.0143	No	0.0024	No
3/16/2023 12:05	0	0.013	0.0144	No	0.0024	No
3/16/2023 12:06	0	0.014	0.0147	No	0.0024	No
3/16/2023 12:07	0	0.012	0.0147	No	0.0024	No
3/16/2023 12:08	0	0.011	0.014	No	0	No
3/16/2023 12:09	0	0.012	0.0137	No	0	No
3/16/2023 12:10	0	0.023	0.0142	No	0	No
3/16/2023 12:11	0	0.015	0.0141	No	0	No
3/16/2023 12:12	0	0.014	0.0141	No	0	No
3/16/2023 12:13	0	0.015	0.0141	No	0	No

Upwind Station						
Time	Instaneous VOC (ppm)	Instaneous Mass Conc. Total (mg/m ³)	Mass Conc. Total mg/m ³ AVG 15m (mg/m ³)	Dust Exceedance	VOC ppm AVG 15m (ppm)	VOC Exceedance
3/16/2023 12:14	0	0.013	0.0139	No	0	No
3/16/2023 12:15	0	0.011	0.0136	No	0	No
3/16/2023 12:16	0	0.014	0.0134	No	0	No
3/16/2023 12:17	0	0.013	0.0135	No	0	No
3/16/2023 12:18	0	0.02	0.0141	No	0	No
3/16/2023 12:19	0	0.017	0.0145	No	0	No
3/16/2023 12:20	0	0.012	0.0144	No	0	No
3/16/2023 12:21	0	0.014	0.0144	No	0	No
3/16/2023 12:22	0	0.013	0.0145	No	0	No
3/16/2023 12:23	0	0.014	0.0147	No	0	No
3/16/2023 12:24	0	0.015	0.0149	No	0	No
3/16/2023 12:25	0	0.016	0.0144	No	0	No
3/16/2023 12:26	0	0.016	0.0145	No	0	No
3/16/2023 12:27	0	0.012	0.0143	No	0	No
3/16/2023 12:28	0	0.012	0.0141	No	0	No
3/16/2023 12:29	0	0.013	0.0141	No	0	No
3/16/2023 12:30	0	0.013	0.0143	No	0	No
3/16/2023 12:31	0	0.012	0.0141	No	0	No
3/16/2023 12:32	0	0.012	0.0141	No	0	No
3/16/2023 12:33	0	0.012	0.0135	No	0	No
3/16/2023 12:34	0	0.013	0.0133	No	0	No
3/16/2023 12:35	0	0.013	0.0133	No	0	No
3/16/2023 12:36	0	0.014	0.0133	No	0	No
3/16/2023 12:37	0	0.015	0.0135	No	0	No
3/16/2023 12:38	0	0.013	0.0134	No	0	No
3/16/2023 12:39	0	0.024	0.014	No	0	No
3/16/2023 12:40	0	0.015	0.0139	No	0	No
3/16/2023 12:41	0	0.018	0.0141	No	0	No
3/16/2023 12:42	0	0.016	0.0143	No	0	No
3/16/2023 12:43	0	0.035	0.0159	No	0	No
3/16/2023 12:44	0	0.018	0.0162	No	0	No
3/16/2023 12:45	0	0.012	0.0161	No	0	No
3/16/2023 12:46	0	0.017	0.0165	No	0	No
3/16/2023 12:47	0	0.015	0.0167	No	0	No
3/16/2023 12:48	0	0.01	0.0165	No	0	No
3/16/2023 12:49	0	0.013	0.0165	No	0	No
3/16/2023 12:50	0	0.011	0.0164	No	0	No
3/16/2023 12:51	0	0.011	0.0162	No	0	No
3/16/2023 12:52	0	0.014	0.0161	No	0	No
3/16/2023 12:53	0	0.011	0.016	No	0	No
3/16/2023 12:54	0	0.014	0.0153	No	0	No
3/16/2023 12:55	0	0.019	0.0156	No	0	No
3/16/2023 12:56	0	0.024	0.016	No	0	No
3/16/2023 12:57	0	0.013	0.0158	No	0	No
3/16/2023 12:58	0	0.013	0.0143	No	0	No
3/16/2023 12:59	0	0.011	0.0139	No	0	No
3/16/2023 13:00	0	0.012	0.0139	No	0	No
3/16/2023 13:01	0	0.013	0.0136	No	0	No
3/16/2023 13:02	0	0.014	0.0135	No	0	No
3/16/2023 13:03	0	0.016	0.0139	No	0	No
3/16/2023 13:04	0	0.013	0.0139	No	0	No
3/16/2023 13:05	0	0.014	0.0141	No	0	No

Upwind Station						
Time	Instaneous VOC (ppm)	Instaneous Mass Conc. Total (mg/m ³)	Mass Conc. Total mg/m ³ AVG 15m (mg/m ³)	Dust Exceedance	VOC ppm AVG 15m (ppm)	VOC Exceedance
3/16/2023 13:06	0	0.013	0.0143	No	0	No
3/16/2023 13:07	0	0.013	0.0142	No	0	No
3/16/2023 13:08	0	0.017	0.0146	No	0	No
3/16/2023 13:09	0	0.018	0.0149	No	0	No
3/16/2023 13:10	0	0.02	0.0149	No	0	No
3/16/2023 13:11	0	0.014	0.0143	No	0	No
3/16/2023 13:12	0	0.015	0.0144	No	0	No
3/16/2023 13:13	0	0.016	0.0146	No	0	No
3/16/2023 13:14	0	0.023	0.0154	No	0	No
3/16/2023 13:15	0	0.018	0.0158	No	0	No
3/16/2023 13:16	0	0.016	0.016	No	0	No
3/16/2023 13:17	0	0.017	0.0162	No	0	No
3/16/2023 13:18	0	0.014	0.0161	No	0	No
3/16/2023 13:19	0	0.013	0.0161	No	0	No
3/16/2023 13:20	0	0.017	0.0163	No	0	No
3/16/2023 13:21	0	0.017	0.0165	No	0	No
3/16/2023 13:22	0	0.017	0.0168	No	0	No
3/16/2023 13:23	0	0.017	0.0168	No	0	No
3/16/2023 13:24	0	0.019	0.0169	No	0	No
3/16/2023 13:25	0	0.022	0.017	No	0	No
3/16/2023 13:26	0	0.016	0.0171	No	0	No
3/16/2023 13:27	0	0.02	0.0175	No	0	No
3/16/2023 13:28	0	0.017	0.0175	No	0	No
3/16/2023 13:29	0	0.017	0.0171	No	0	No
3/16/2023 13:30	0	0.031	0.018	No	0	No
3/16/2023 13:31	0	0.024	0.0185	No	0	No
3/16/2023 13:32	0	0.026	0.0191	No	0	No
3/16/2023 13:33	0	0.019	0.0195	No	0	No
3/16/2023 13:34	0	0.02	0.0199	No	0	No
3/16/2023 13:35	0	0.028	0.0207	No	0	No
3/16/2023 13:36	0	0.027	0.0213	No	0	No
3/16/2023 13:37	0	0.043	0.0231	No	0	No
3/16/2023 13:38	0	0.016	0.023	No	0	No
3/16/2023 13:39	0	0.033	0.0239	No	0	No
3/16/2023 13:40	0	0.017	0.0236	No	0	No
3/16/2023 13:41	0	0.027	0.0243	No	0	No
3/16/2023 13:42	0	0.034	0.0253	No	0	No
3/16/2023 13:43	0	0.021	0.0255	No	0	No
3/16/2023 13:44	0	0.023	0.0259	No	0	No
3/16/2023 13:45	0	0.024	0.0255	No	0	No
3/16/2023 13:46	0	0.014	0.0248	No	0	No
3/16/2023 13:47	0	0.012	0.0239	No	0	No
3/16/2023 13:48	0	0.013	0.0235	No	0	No
3/16/2023 13:49	0	0.027	0.0239	No	0	No
3/16/2023 13:50	0	0.02	0.0234	No	0	No
3/16/2023 13:51	0	0.02	0.0229	No	0	No
3/16/2023 13:52	0	0.038	0.0226	No	0	No
3/16/2023 13:53	0	0.033	0.0237	No	0	No
3/16/2023 13:54	0	0.032	0.0237	No	0	No
3/16/2023 13:55	0	0.022	0.024	No	0	No
3/16/2023 13:56	0	0.032	0.0243	No	0	No
3/16/2023 13:57	0.058	0.033	0.0243	No	0.0039	No

Upwind Station						
Time	Instaneous VOC (ppm)	Instaneous Mass Conc. Total (mg/m ³)	Mass Conc. Total mg/m ³ AVG 15m (mg/m ³)	Dust Exceedance	VOC ppm AVG 15m (ppm)	VOC Exceedance
3/16/2023 13:58	0	0.031	0.0249	No	0.0039	No
3/16/2023 13:59	0	0.035	0.0257	No	0.0039	No
3/16/2023 14:00	0	0.027	0.0259	No	0.0039	No
3/16/2023 14:01	0	0.017	0.0261	No	0.0039	No
3/16/2023 14:02	0	0.021	0.0267	No	0.0039	No
3/16/2023 14:03	0	0.015	0.0269	No	0.0039	No
3/16/2023 14:04	0	0.015	0.0261	No	0.0039	No
3/16/2023 14:05	0	0.021	0.0261	No	0.0039	No
3/16/2023 14:06	0	0.048	0.028	No	0.0039	No
3/16/2023 14:07	0	0.031	0.0275	No	0.0039	No
3/16/2023 14:08	0	0.019	0.0266	No	0.0039	No
3/16/2023 14:09	0	0.031	0.0265	No	0.0039	No
3/16/2023 14:10	0	0.025	0.0267	No	0.0039	No
3/16/2023 14:11	0	0.015	0.0256	No	0.0039	No
3/16/2023 14:12	0	0.02	0.0247	No	0	No
3/16/2023 14:13	0	0.029	0.0246	No	0	No
3/16/2023 14:14	0	0.018	0.0235	No	0	No
3/16/2023 14:15	0	0.019	0.0229	No	0	No
3/16/2023 14:16	0	0.024	0.0234	No	0	No
3/16/2023 14:17	0	0.026	0.0237	No	0	No
3/16/2023 14:18	0.01	0.054	0.0263	No	0.001	No
3/16/2023 14:19	0.002	0.029	0.0273	No	0.0008	No
3/16/2023 14:20	0	0.025	0.0275	No	0.0008	No
3/16/2023 14:21	0	0.028	0.0262	No	0.0008	No
3/16/2023 14:22	0	0.019	0.0254	No	0.0008	No
3/16/2023 14:23	0	0.022	0.0256	No	0.0008	No
3/16/2023 14:24	0	0.02	0.0249	No	0.0008	No
3/16/2023 14:25	0	0.035	0.0255	No	0.0008	No
3/16/2023 14:26	0	0.022	0.026	No	0.0008	No
3/16/2023 14:27	0	0.023	0.0262	No	0.0008	No
3/16/2023 14:28	0	0.028	0.0261	No	0.0008	No
3/16/2023 14:29	0	0.019	0.0262	No	0.0008	No
3/16/2023 14:30	0	0.02	0.0263	No	0.0008	No
3/16/2023 14:31	0.167	0.04	0.0273	No	0.0119	No
3/16/2023 14:32	0.179	0.042	0.0284	No	0.0239	No
3/16/2023 14:33	0.063	0.025	0.0265	No	0.0274	No
3/16/2023 14:34	0.064	0.026	0.0263	No	0.0315	No
3/16/2023 14:35	0.088	0.03	0.0266	No	0.0374	No
3/16/2023 14:36	0	0.028	0.0266	No	0.0374	No
3/16/2023 14:37	0.035	0.015	0.0263	No	0.0397	No
3/16/2023 14:38	0.126	0.018	0.0261	No	0.0481	No
3/16/2023 14:39	0.128	0.038	0.0273	No	0.0567	No
3/16/2023 14:40	0.043	0.032	0.0271	No	0.0595	No
3/16/2023 14:41	0.063	0.036	0.028	No	0.0637	No
3/16/2023 14:42	0	0.035	0.0288	No	0.0637	No
3/16/2023 14:43	0	0.029	0.0289	No	0.0637	No
3/16/2023 14:44	0	0.024	0.0292	No	0.0637	No
3/16/2023 14:45	0.266	0.042	0.0307	No	0.0815	No
3/16/2023 14:46	0.135	0.031	0.0301	No	0.0793	No
3/16/2023 14:47	0.036	0.02	0.0286	No	0.0698	No
3/16/2023 14:48	0	0.024	0.0285	No	0.0656	No
3/16/2023 14:49	0	0.021	0.0282	No	0.0613	No

Upwind Station						
Time	Instaneous VOC (ppm)	Instaneous Mass Conc. Total (mg/m ³)	Mass Conc. Total mg/m ³ AVG 15m (mg/m ³)	Dust Exceedance	VOC ppm AVG 15m (ppm)	VOC Exceedance
3/16/2023 14:50	0	0.021	0.0276	No	0.0555	No
3/16/2023 14:51	0.156	0.042	0.0285	No	0.0659	No
3/16/2023 14:52	0	0.058	0.0314	No	0.0635	No
3/16/2023 14:53	0	0.036	0.0326	No	0.0551	No
3/16/2023 14:54	0.004	0.032	0.0322	No	0.0469	No
3/16/2023 14:55	0.029	0.039	0.0327	No	0.0459	No
3/16/2023 14:56	0	0.034	0.0325	No	0.0417	No
3/16/2023 14:57	0	0.021	0.0316	No	0.0417	No
3/16/2023 14:58	0	0.016	0.0307	No	0.0417	No
3/16/2023 14:59	0	0.018	0.0303	No	0.0417	No
3/16/2023 15:00	0	0.018	0.0287	No	0.024	No
3/16/2023 15:01	0.021	0.024	0.0283	No	0.0164	No
3/16/2023 15:02	0	0.018	0.0281	No	0.014	No
3/16/2023 15:03	0.064	0.019	0.0278	No	0.0183	No
3/16/2023 15:04	0.057	0.024	0.028	No	0.0221	No
3/16/2023 15:05	0.112	0.028	0.0285	No	0.0295	No
3/16/2023 15:06	0.014	0.029	0.0276	No	0.0201	No
3/16/2023 15:07	0.011	0.025	0.0254	No	0.0208	No
3/16/2023 15:08	0.004	0.025	0.0247	No	0.0211	No
3/16/2023 15:09	0	0.03	0.0245	No	0.0208	No
3/16/2023 15:10	0	0.023	0.0235	No	0.0189	No
3/16/2023 15:11	0	0.036	0.0236	No	0.0189	No
3/16/2023 15:12	0	0.04	0.0249	No	0.0189	No
3/16/2023 15:13	0.049	0.067	0.0283	No	0.0221	No
3/16/2023 15:14	0.125	0.192	0.0399	No	0.0305	No
3/16/2023 15:15	0.04	0.123	0.0469	No	0.0331	No
3/16/2023 15:16	0	0.034	0.0475	No	0.0317	No
3/16/2023 15:17	0.003	0.05	0.0497	No	0.0319	No
3/16/2023 15:18	0	0.05	0.0517	No	0.0277	No
3/16/2023 15:19	0	0.041	0.0529	No	0.0239	No
3/16/2023 15:20	0	0.046	0.0541	No	0.0164	No
3/16/2023 15:21	0.009	0.038	0.0547	No	0.0161	No
3/16/2023 15:22	0.01	0.059	0.0569	No	0.016	No
3/16/2023 15:23	0	0.047	0.0584	No	0.0157	No
3/16/2023 15:24	0	0.029	0.0583	No	0.0157	No
3/16/2023 15:25	0	0.031	0.0589	No	0.0157	No
3/16/2023 15:26	0	0.038	0.059	No	0.0157	No
3/16/2023 15:27	0	0.029	0.0583	No	0.0157	No
3/16/2023 15:28	0	0.04	0.0565	No	0.0125	No
3/16/2023 15:29	0	0.035	0.046	No	0.0041	No
3/16/2023 15:30	0	0.042	0.0406	No	0.0015	No
3/16/2023 15:31	0	0.037	0.0408	No	0.0015	No
3/16/2023 15:32	0	0.03	0.0395	No	0.0013	No
3/16/2023 15:33	0	0.025	0.0378	No	0.0013	No
3/16/2023 15:34	0	0.022	0.0365	No	0.0013	No
3/16/2023 15:35	0	0.024	0.0351	No	0.0013	No
3/16/2023 15:36	0	0.034	0.0348	No	0.001	No
3/16/2023 15:37	0	0.029	0.0328	No	0	No
3/16/2023 15:38	0	0.024	0.0313	No	0	No
3/16/2023 15:39	0	0.031	0.0314	No	0	No
3/16/2023 15:40	0	0.023	0.0309	No	0	No
3/16/2023 15:41	0	0.028	0.0302	No	0	No

Upwind Station

Time	Instantaneous VOC (ppm)	Instantaneous Mass Conc. Total (mg/m ³)	Mass Conc. Total mg/m ³ AVG 15m (mg/m ³)	Dust Exceedance	VOC ppm AVG 15m (ppm)	VOC Exceedance
3/16/2023 15:42	0	0.032	0.0304	No	0	No
3/16/2023 15:43	0	0.025	0.0294	No	0	No
3/16/2023 15:44	0	0.033	0.0293	No	0	No
3/16/2023 15:45	0	0.026	0.0282	No	0	No
3/16/2023 15:46	0	0.016	0.0268	No	0	No
3/16/2023 15:47	0	0.017	0.0259	No	0	No
3/16/2023 15:48	0	0.02	0.0256	No	0	No
3/16/2023 15:49	0	0.021	0.0255	No	0	No
3/16/2023 15:50	0	0.023	0.0255	No	0	No
3/16/2023 15:51	0	0.017	0.0243	No	0	No
3/16/2023 15:52	0	0.017	0.0235	No	0	No
3/16/2023 15:53	0	0.02	0.0233	No	0	No
3/16/2023 15:54	0	0.017	0.0223	No	0	No
3/16/2023 15:55	0	0.018	0.022	No	0	No
3/16/2023 15:56	0	0.02	0.0215	No	0	No
3/16/2023 15:57	0	0.021	0.0207	No	0	No
3/16/2023 15:58	0	0.018	0.0203	No	0	No
3/16/2023 15:59	0	0.021	0.0195	No	0	No
3/16/2023 16:00	0	0.014	0.0187	No	0	No

Downwind Station						
Time	Instaneous VOC (ppm)	Instaneous Mass Conc. Total (mg/m³)	Mass Conc. Total mg/m³ AVG 15m (mg/m³)	Dust Exceedance	VOC ppm AVG 15m (ppm)	VOC Exceedance
3/16/2023 7:06		0.071	0.071	No		No
3/16/2023 7:10		0.13	0.1005	No		No
3/16/2023 7:11		0.018	0.073	No		No
3/16/2023 7:12		0.034	0.0633	No		No
3/16/2023 7:13		0.024	0.0554	No		No
3/16/2023 7:14		0.023	0.05	No		No
3/16/2023 7:15		0.027	0.0467	No		No
3/16/2023 7:16		0.022	0.0436	No		No
3/16/2023 7:17		0.022	0.0412	No		No
3/16/2023 7:18		0.022	0.0393	No		No
3/16/2023 7:19		0.021	0.0376	No		No
3/16/2023 7:20		0.022	0.0363	No		No
3/16/2023 7:21		0.021	0.0322	No		No
3/16/2023 7:22		0.032	0.0322	No		No
3/16/2023 7:23		0.041	0.0328	No		No
3/16/2023 7:24		0.094	0.0369	No		No
3/16/2023 7:31	0	0.013	0.032	No	0	No
3/16/2023 7:32	0	0.015	0.0312	No	0	No
3/16/2023 7:33	0	0.018	0.0308	No	0	No
3/16/2023 7:34	0	0.018	0.0304	No	0	No
3/16/2023 7:35	0	0.017	0.0299	No	0	No
3/16/2023 7:36	0	0.016	0.0293	No	0	No
3/16/2023 7:37	0	0.013	0.0272	No	0	No
3/16/2023 7:38	0	0.012	0.024	No	0	No
3/16/2023 7:39	0	0.014	0.0151	No	0	No
3/16/2023 7:40	0	0.016	0.0152	No	0	No
3/16/2023 7:41	0	0.03	0.0165	No	0	No
3/16/2023 7:42	0	0.034	0.018	No	0	No
3/16/2023 7:43	0	0.025	0.0185	No	0	No
3/16/2023 7:44	0	0.023	0.0189	No	0	No
3/16/2023 7:45	0	0.016	0.0187	No	0	No
3/16/2023 7:46	0	0.031	0.0199	No	0	No
3/16/2023 7:47	0	0.025	0.0205	No	0	No
3/16/2023 7:48	0	0.02	0.0207	No	0	No
3/16/2023 7:49	0	0.022	0.0209	No	0	No
3/16/2023 7:50	0	0.019	0.0211	No	0	No
3/16/2023 7:51	0	0.021	0.0214	No	0	No
3/16/2023 7:52	0	0.017	0.0217	No	0	No
3/16/2023 7:53	0	0.014	0.0218	No	0	No
3/16/2023 7:54	0	0.014	0.0218	No	0	No
3/16/2023 7:55	0	0.018	0.0219	No	0	No
3/16/2023 7:56	0	0.021	0.0213	No	0	No
3/16/2023 7:57	0	0.027	0.0209	No	0	No
3/16/2023 7:58	0	0.045	0.0222	No	0	No
3/16/2023 7:59	0	0.027	0.0225	No	0	No
3/16/2023 8:00	0	0.027	0.0232	No	0	No
3/16/2023 8:01	0	0.029	0.0231	No	0	No
3/16/2023 8:02	0	0.038	0.0239	No	0	No
3/16/2023 8:03	0	0.019	0.0239	No	0	No
3/16/2023 8:04	0	0.02	0.0237	No	0	No
3/16/2023 8:05	0	0.026	0.0242	No	0	No
3/16/2023 8:06	0	0.02	0.0241	No	0	No
3/16/2023 8:07	0	0.022	0.0245	No	0	No
3/16/2023 8:08	0	0.017	0.0247	No	0	No

Downwind Station						
Time	Instaneous VOC (ppm)	Instaneous Mass Conc. Total (mg/m ³)	Mass Conc. Total mg/m ³ AVG 15m (mg/m ³)	Dust Exceedance	VOC ppm AVG 15m (ppm)	VOC Exceedance
3/16/2023 8:09	0	0.014	0.0247	No	0	No
3/16/2023 8:10	0	0.018	0.0247	No	0	No
3/16/2023 8:11	0	0.017	0.0244	No	0	No
3/16/2023 8:12	0	0.121	0.0307	No	0	No
3/16/2023 8:13	0	0.95	0.091	No	0	No
3/16/2023 8:14	0	0.438	0.1184	No	0	No
3/16/2023 8:15	0	0.708	0.1638	Yes	0	No
3/16/2023 8:16	0	0.458	0.1924	Yes	0	No
3/16/2023 8:17	0	0.06	0.1939	Yes	0	No
3/16/2023 8:18	0	0.027	0.1944	Yes	0	No
3/16/2023 8:19	0	0.013	0.1939	Yes	0	No
3/16/2023 8:20	0	0.01	0.1929	Yes	0	No
3/16/2023 8:21	0	0.009	0.1921	Yes	0	No
3/16/2023 8:22	0	0.011	0.1914	Yes	0	No
3/16/2023 8:23	0	0.012	0.1911	Yes	0	No
3/16/2023 8:24	0	0.011	0.1909	Yes	0	No
3/16/2023 8:25	0	0.01	0.1903	Yes	0	No
3/16/2023 8:26	0	0.009	0.1898	Yes	0	No
3/16/2023 8:27	0	0.009	0.1823	Yes	0	No
3/16/2023 8:28	0	0.01	0.1197	No	0	No
3/16/2023 8:29	0	0.009	0.0911	No	0	No
3/16/2023 8:30	0	0.01	0.0445	No	0	No
3/16/2023 8:31	0	0.012	0.0148	No	0	No
3/16/2023 8:32	0	0.011	0.0115	No	0	No
3/16/2023 8:33	0	0.012	0.0105	No	0	No
3/16/2023 8:34	0	0.013	0.0105	No	0	No
3/16/2023 8:35	0	0.011	0.0106	No	0	No
3/16/2023 8:36	0	0.01	0.0107	No	0	No
3/16/2023 8:37	0	0.011	0.0107	No	0	No
3/16/2023 8:38	0	0.011	0.0106	No	0	No
3/16/2023 8:39	0	0.02	0.0112	No	0	No
3/16/2023 8:40	0	0.011	0.0113	No	0	No
3/16/2023 8:41	0	0.011	0.0114	No	0	No
3/16/2023 8:42	0	0.013	0.0117	No	0	No
3/16/2023 8:43	0	0.016	0.0121	No	0	No
3/16/2023 8:44	0	0.013	0.0123	No	0	No
3/16/2023 8:45	0.043	0.01	0.0123	No	0.0029	No
3/16/2023 8:46	0	0.014	0.0125	No	0.0029	No
3/16/2023 8:47	0	0.014	0.0127	No	0.0029	No
3/16/2023 8:48	0.015	0.011	0.0126	No	0.0039	No
3/16/2023 8:49	0	0.009	0.0123	No	0.0039	No
3/16/2023 8:50	0	0.024	0.0132	No	0.0039	No
3/16/2023 8:51	0	0.018	0.0137	No	0.0039	No
3/16/2023 8:52	0	0.009	0.0136	No	0.0039	No
3/16/2023 8:53	0	0.009	0.0135	No	0.0039	No
3/16/2023 8:54	0	0.008	0.0127	No	0.0039	No
3/16/2023 8:55	0	0.008	0.0125	No	0.0039	No
3/16/2023 8:56	0	0.014	0.0127	No	0.0039	No
3/16/2023 8:57	0	0.009	0.0124	No	0.0039	No
3/16/2023 8:58	0	0.01	0.012	No	0.0039	No
3/16/2023 8:59	0	0.011	0.0119	No	0.0039	No
3/16/2023 9:00	0	0.012	0.012	No	0.001	No
3/16/2023 9:01	0	0.01	0.0117	No	0.001	No
3/16/2023 9:02	0	0.007	0.0113	No	0.001	No

Downwind Station						
Time	Instantaneous VOC (ppm)	Instantaneous Mass Conc. Total (mg/m ³)	Mass Conc. Total mg/m ³ AVG 15m (mg/m ³)	Dust Exceedance	VOC ppm AVG 15m (ppm)	VOC Exceedance
3/16/2023 9:03	0	0.008	0.0111	No	0	No
3/16/2023 9:04	0	0.008	0.011	No	0	No
3/16/2023 9:05	0	0.01	0.0101	No	0	No
3/16/2023 9:06	0	0.008	0.0094	No	0	No
3/16/2023 9:07	0	0.016	0.0099	No	0	No
3/16/2023 9:08	0	0.011	0.01	No	0	No
3/16/2023 9:09	0	0.01	0.0101	No	0	No
3/16/2023 9:10	0	0.011	0.0103	No	0	No
3/16/2023 9:11	0	0.018	0.0106	No	0	No
3/16/2023 9:12	0	0.011	0.0107	No	0	No
3/16/2023 9:13	0	0.01	0.0107	No	0	No
3/16/2023 9:14	0	0.01	0.0107	No	0	No
3/16/2023 9:15	0	0.009	0.0105	No	0	No
3/16/2023 9:16	0	0.011	0.0105	No	0	No
3/16/2023 9:17	0	0.008	0.0106	No	0	No
3/16/2023 9:18	0	0.01	0.0107	No	0	No
3/16/2023 9:19	0	0.01	0.0109	No	0	No
3/16/2023 9:20	0	0.009	0.0108	No	0	No
3/16/2023 9:21	0	0.008	0.0108	No	0	No
3/16/2023 9:22	0	0.009	0.0103	No	0	No
3/16/2023 9:23	0	0.008	0.0101	No	0	No
3/16/2023 9:24	0	0.01	0.0101	No	0	No
3/16/2023 9:25	0	0.007	0.0099	No	0	No
3/16/2023 9:26	0	0.009	0.0093	No	0	No
3/16/2023 9:27	0	0.012	0.0093	No	0	No
3/16/2023 9:28	0	0.013	0.0095	No	0	No
3/16/2023 9:29	0	0.011	0.0096	No	0	No
3/16/2023 9:30	0	0.01	0.0097	No	0	No
3/16/2023 9:31	0	0.009	0.0095	No	0	No
3/16/2023 9:32	0	0.01	0.0097	No	0	No
3/16/2023 9:33	0	0.008	0.0095	No	0	No
3/16/2023 9:34	0	0.009	0.0095	No	0	No
3/16/2023 9:35	0	0.032	0.011	No	0	No
3/16/2023 9:36	0	0.016	0.0115	No	0	No
3/16/2023 9:37	0	0.014	0.0119	No	0	No
3/16/2023 9:38	0	0.02	0.0127	No	0	No
3/16/2023 9:39	0	0.025	0.0137	No	0	No
3/16/2023 9:40	0	0.01	0.0139	No	0	No
3/16/2023 9:41	0	0.009	0.0139	No	0	No
3/16/2023 9:42	0	0.009	0.0137	No	0	No
3/16/2023 9:43	0	0.01	0.0135	No	0	No
3/16/2023 9:44	0	0.01	0.0134	No	0	No
3/16/2023 9:45	0	0.008	0.0133	No	0	No
3/16/2023 9:46	0	0.008	0.0132	No	0	No
3/16/2023 9:47	0	0.012	0.0133	No	0	No
3/16/2023 9:48	0	0.01	0.0135	No	0	No
3/16/2023 9:49	0	0.011	0.0136	No	0	No
3/16/2023 9:50	0	0.009	0.0121	No	0	No
3/16/2023 9:51	0	0.009	0.0116	No	0	No
3/16/2023 9:52	0	0.008	0.0112	No	0	No
3/16/2023 9:53	0	0.01	0.0105	No	0	No
3/16/2023 9:54	0	0.011	0.0096	No	0	No
3/16/2023 9:55	0	0.008	0.0095	No	0	No
3/16/2023 9:56	0	0.008	0.0094	No	0	No

Downwind Station						
Time	Instantaneous VOC (ppm)	Instantaneous Mass Conc. Total (mg/m ³)	Mass Conc. Total mg/m ³ AVG 15m (mg/m ³)	Dust Exceedance	VOC ppm AVG 15m (ppm)	VOC Exceedance
3/16/2023 9:57	0	0.01	0.0095	No	0	No
3/16/2023 9:58	0	0.037	0.0113	No	0	No
3/16/2023 9:59	0.013	0.02	0.0119	No	0.0009	No
3/16/2023 10:00	0	0.013	0.0123	No	0.0009	No
3/16/2023 10:01	0	0.012	0.0125	No	0.0009	No
3/16/2023 10:02	0	0.009	0.0123	No	0.0009	No
3/16/2023 10:03	0	0.008	0.0122	No	0.0009	No
3/16/2023 10:04	0	0.007	0.0119	No	0.0009	No
3/16/2023 10:05	0	0.008	0.0119	No	0.0009	No
3/16/2023 10:06	0	0.013	0.0121	No	0.0009	No
3/16/2023 10:07	0	0.012	0.0124	No	0.0009	No
3/16/2023 10:08	0	0.013	0.0126	No	0.0009	No
3/16/2023 10:09	0	0.009	0.0125	No	0.0009	No
3/16/2023 10:10	0	0.009	0.0125	No	0.0009	No
3/16/2023 10:11	0	0.008	0.0125	No	0.0009	No
3/16/2023 10:12	0	0.012	0.0127	No	0.0009	No
3/16/2023 10:13	0	0.009	0.0108	No	0.0009	No
3/16/2023 10:14	0	0.008	0.01	No	0	No
3/16/2023 10:15	0	0.025	0.0108	No	0	No
3/16/2023 10:16	0	0.029	0.0119	No	0	No
3/16/2023 10:17	0	0.026	0.0131	No	0	No
3/16/2023 10:18	0	0.058	0.0164	No	0	No
3/16/2023 10:19	0	0.022	0.0174	No	0	No
3/16/2023 10:20	0.003	0.014	0.0178	No	0.0002	No
3/16/2023 10:21	0.006	0.012	0.0177	No	0.0006	No
3/16/2023 10:22	0	0.011	0.0177	No	0.0006	No
3/16/2023 10:23	0	0.011	0.0175	No	0.0006	No
3/16/2023 10:24	0	0.012	0.0177	No	0.0006	No
3/16/2023 10:25	0	0.013	0.018	No	0.0006	No
3/16/2023 10:26	0	0.011	0.0182	No	0.0006	No
3/16/2023 10:27	0	0.011	0.0181	No	0.0006	No
3/16/2023 10:28	0	0.016	0.0186	No	0.0006	No
3/16/2023 10:29	0	0.017	0.0192	No	0.0006	No
3/16/2023 10:30	0	0.011	0.0183	No	0.0006	No
3/16/2023 10:31	0	0.012	0.0171	No	0.0006	No
3/16/2023 10:32	0	0.027	0.0172	No	0.0006	No
3/16/2023 10:33	0	0.024	0.0149	No	0.0006	No
3/16/2023 10:34	0	0.013	0.0143	No	0.0006	No
3/16/2023 10:35	0	0.021	0.0148	No	0.0004	No
3/16/2023 10:36	0	0.028	0.0159	No	0	No
3/16/2023 10:37	0	0.024	0.0167	No	0	No
3/16/2023 10:38	0	0.015	0.017	No	0	No
3/16/2023 10:39	0	0.017	0.0173	No	0	No
3/16/2023 10:40	0	0.022	0.0179	No	0	No
3/16/2023 10:41	0	0.016	0.0183	No	0	No
3/16/2023 10:42	0.001	0.013	0.0184	No	0.0001	No
3/16/2023 10:43	0.004	0.059	0.0213	No	0.0003	No
3/16/2023 10:44	0	0.639	0.0627	No	0.0003	No
3/16/2023 10:45	0	0.246	0.0784	No	0.0003	No
3/16/2023 10:46	0	0.015	0.0786	No	0.0003	No
3/16/2023 10:47	0	0.01	0.0775	No	0.0003	No
3/16/2023 10:48	0	0.012	0.0767	No	0.0003	No
3/16/2023 10:49	0	0.007	0.0763	No	0.0003	No
3/16/2023 10:50	0	0.006	0.0753	No	0.0003	No

Downwind Station						
Time	Instaneous VOC (ppm)	Instaneous Mass Conc. Total (mg/m ³)	Mass Conc. Total mg/m ³ AVG 15m (mg/m ³)	Dust Exceedance	VOC ppm AVG 15m (ppm)	VOC Exceedance
3/16/2023 10:51	0	0.007	0.0739	No	0.0003	No
3/16/2023 10:52	0	0.017	0.0734	No	0.0003	No
3/16/2023 10:53	0	0.007	0.0729	No	0.0003	No
3/16/2023 10:54	0	0.007	0.0722	No	0.0003	No
3/16/2023 10:55	0	0.008	0.0713	No	0.0003	No
3/16/2023 10:56	0	0.018	0.0714	No	0.0003	No
3/16/2023 10:57	0.012	0.017	0.0717	No	0.0011	No
3/16/2023 10:58	0.006	0.012	0.0685	No	0.0012	No
3/16/2023 10:59	0.02	0.01	0.0266	No	0.0025	No
3/16/2023 11:00	0	0.007	0.0107	No	0.0025	No
3/16/2023 11:01	0	0.008	0.0102	No	0.0025	No
3/16/2023 11:02	0	0.009	0.0101	No	0.0025	No
3/16/2023 11:03	0	0.012	0.0101	No	0.0025	No
3/16/2023 11:04	0	0.011	0.0104	No	0.0025	No
3/16/2023 11:05	0	0.01	0.0107	No	0.0025	No
3/16/2023 11:06	0	0.01	0.0109	No	0.0025	No
3/16/2023 11:07	0	0.021	0.0111	No	0.0025	No
3/16/2023 11:08	0	0.013	0.0115	No	0.0025	No
3/16/2023 11:09	0	0.01	0.0117	No	0.0025	No
3/16/2023 11:10	0	0.012	0.012	No	0.0025	No
3/16/2023 11:11	0.026	0.012	0.0116	No	0.0043	No
3/16/2023 11:12	0.33	0.029	0.0124	No	0.0255	No
3/16/2023 11:13	0.203	0.041	0.0143	No	0.0386	No
3/16/2023 11:14	0.205	0.042	0.0165	No	0.0509	No
3/16/2023 11:15	0.062	0.031	0.0181	No	0.0551	No
3/16/2023 11:16	0.01	0.012	0.0183	No	0.0557	No
3/16/2023 11:17	0	0.025	0.0194	No	0.0557	No
3/16/2023 11:18	0	0.01	0.0193	No	0.0557	No
3/16/2023 11:19	0.003	0.01	0.0192	No	0.0559	No
3/16/2023 11:20	0.008	0.014	0.0195	No	0.0565	No
3/16/2023 11:21	0	0.014	0.0197	No	0.0565	No
3/16/2023 11:22	0	0.008	0.0189	No	0.0565	No
3/16/2023 11:23	0	0.014	0.0189	No	0.0565	No
3/16/2023 11:24	0.088	0.016	0.0193	No	0.0623	No
3/16/2023 11:25	0.128	0.019	0.0198	No	0.0709	No
3/16/2023 11:26	0.138	0.018	0.0202	No	0.0783	No
3/16/2023 11:27	0.134	0.019	0.0195	No	0.0653	No
3/16/2023 11:28	0.035	0.014	0.0177	No	0.0541	No
3/16/2023 11:29	0.012	0.008	0.0155	No	0.0412	No
3/16/2023 11:30	0.009	0.01	0.0141	No	0.0377	No
3/16/2023 11:31	0	0.013	0.0141	No	0.037	No
3/16/2023 11:32	0	0.008	0.013	No	0.037	No
3/16/2023 11:33	0	0.014	0.0133	No	0.037	No
3/16/2023 11:34	0	0.011	0.0133	No	0.0368	No
3/16/2023 11:35	0	0.009	0.013	No	0.0363	No
3/16/2023 11:36	0.026	0.009	0.0127	No	0.038	No
3/16/2023 11:37	0.012	0.013	0.013	No	0.0388	No
3/16/2023 11:38	0.005	0.018	0.0133	No	0.0391	No
3/16/2023 11:39	0	0.01	0.0129	No	0.0333	No
3/16/2023 11:40	0	0.013	0.0125	No	0.0247	No
3/16/2023 11:41	0.004	0.018	0.0125	No	0.0158	No
3/16/2023 11:42	0.019	0.012	0.012	No	0.0081	No
3/16/2023 11:43	0.033	0.013	0.0119	No	0.008	No
3/16/2023 11:44	0.019	0.013	0.0123	No	0.0085	No

Downwind Station						
Time	Instaneous VOC (ppm)	Instaneous Mass Conc. Total (mg/m ³)	Mass Conc. Total mg/m ³ AVG 15m (mg/m ³)	Dust Exceedance	VOC ppm AVG 15m (ppm)	VOC Exceedance
3/16/2023 11:45	0	0.011	0.0123	No	0.0079	No
3/16/2023 11:46	0.004	0.011	0.0122	No	0.0081	No
3/16/2023 11:47	0	0.008	0.0122	No	0.0081	No
3/16/2023 11:48	0	0.012	0.0121	No	0.0081	No
3/16/2023 11:49	0	0.012	0.0121	No	0.0081	No
3/16/2023 11:50	0	0.009	0.0121	No	0.0081	No
3/16/2023 11:51	0.017	0.01	0.0122	No	0.0075	No
3/16/2023 11:52	0	0.012	0.0121	No	0.0067	No
3/16/2023 11:53	0	0.011	0.0117	No	0.0064	No
3/16/2023 11:54	0.033	0.018	0.0122	No	0.0086	No
3/16/2023 11:55	0	0.014	0.0123	No	0.0086	No
3/16/2023 11:56	0	0.057	0.0149	No	0.0083	No
3/16/2023 11:57	0.005	0.012	0.0149	No	0.0074	No
3/16/2023 11:58	0.014	0.012	0.0148	No	0.0061	No
3/16/2023 11:59	0.037	0.011	0.0147	No	0.0073	No
3/16/2023 12:00	0.01	0.014	0.0149	No	0.008	No
3/16/2023 12:01	0	0.012	0.0149	No	0.0077	No
3/16/2023 12:02	0	0.01	0.0151	No	0.0077	No
3/16/2023 12:03	0.038	0.012	0.0151	No	0.0103	No
3/16/2023 12:04	0	0.013	0.0151	No	0.0103	No
3/16/2023 12:05	0	0.014	0.0155	No	0.0103	No
3/16/2023 12:06	0.012	0.016	0.0159	No	0.0099	No
3/16/2023 12:07	0	0.017	0.0162	No	0.0099	No
3/16/2023 12:08	0	0.014	0.0164	No	0.0099	No
3/16/2023 12:09	0	0.012	0.016	No	0.0077	No
3/16/2023 12:10	0	0.013	0.0159	No	0.0077	No
3/16/2023 12:11	0	0.011	0.0129	No	0.0077	No
3/16/2023 12:12	0	0.01	0.0127	No	0.0074	No
3/16/2023 12:13	0	0.01	0.0126	No	0.0065	No
3/16/2023 12:14	0	0.01	0.0125	No	0.004	No
3/16/2023 12:15	0	0.012	0.0124	No	0.0033	No
3/16/2023 12:16	0	0.012	0.0124	No	0.0033	No
3/16/2023 12:17	0	0.012	0.0125	No	0.0033	No
3/16/2023 12:18	0.002	0.013	0.0126	No	0.0009	No
3/16/2023 12:19	0	0.013	0.0126	No	0.0009	No
3/16/2023 12:20	0	0.013	0.0125	No	0.0009	No
3/16/2023 12:21	0	0.015	0.0125	No	0.0001	No
3/16/2023 12:22	0	0.067	0.0158	No	0.0001	No
3/16/2023 12:23	0	0.028	0.0167	No	0.0001	No
3/16/2023 12:24	0	0.022	0.0174	No	0.0001	No
3/16/2023 12:25	0	0.021	0.0179	No	0.0001	No
3/16/2023 12:26	0	0.046	0.0203	No	0.0001	No
3/16/2023 12:27	0	0.021	0.021	No	0.0001	No
3/16/2023 12:28	0	0.026	0.0221	No	0.0001	No
3/16/2023 12:29	0	0.02	0.0227	No	0.0001	No
3/16/2023 12:30	0	0.019	0.0232	No	0.0001	No
3/16/2023 12:31	0	0.026	0.0241	No	0.0001	No
3/16/2023 12:32	0	0.019	0.0246	No	0.0001	No
3/16/2023 12:33	0	0.02	0.0251	No	0	No
3/16/2023 12:34	0	0.077	0.0293	No	0	No
3/16/2023 12:35	0	0.063	0.0327	No	0	No
3/16/2023 12:36	0	0.029	0.0336	No	0	No
3/16/2023 12:37	0	0.051	0.0325	No	0	No
3/16/2023 12:38	0	0.022	0.0321	No	0	No

Downwind Station						
Time	Instaneous VOC (ppm)	Instaneous Mass Conc. Total (mg/m ³)	Mass Conc. Total mg/m ³ AVG 15m (mg/m ³)	Dust Exceedance	VOC ppm AVG 15m (ppm)	VOC Exceedance
3/16/2023 12:39	0	0.027	0.0325	No	0	No
3/16/2023 12:40	0	0.023	0.0326	No	0	No
3/16/2023 12:41	0	0.024	0.0311	No	0	No
3/16/2023 12:42	0	0.032	0.0319	No	0	No
3/16/2023 12:43	0	0.028	0.032	No	0	No
3/16/2023 12:44	0	0.028	0.0325	No	0	No
3/16/2023 12:45	0	0.018	0.0325	No	0	No
3/16/2023 12:46	0	0.019	0.032	No	0	No
3/16/2023 12:47	0	0.026	0.0325	No	0	No
3/16/2023 12:48	0	0.016	0.0322	No	0	No
3/16/2023 12:49	0	0.015	0.0281	No	0	No
3/16/2023 12:50	0	0.017	0.025	No	0	No
3/16/2023 12:51	0.065	0.017	0.0242	No	0.0043	No
3/16/2023 12:52	0	0.018	0.022	No	0.0043	No
3/16/2023 12:53	0	0.019	0.0218	No	0.0043	No
3/16/2023 12:54	0	0.018	0.0212	No	0.0043	No
3/16/2023 12:55	0	0.021	0.0211	No	0.0043	No
3/16/2023 12:56	0	0.031	0.0215	No	0.0043	No
3/16/2023 12:57	0	0.023	0.0209	No	0.0043	No
3/16/2023 12:58	0	0.022	0.0205	No	0.0043	No
3/16/2023 12:59	0	0.021	0.0201	No	0.0043	No
3/16/2023 13:00	0	0.022	0.0203	No	0.0043	No
3/16/2023 13:01	0	0.021	0.0205	No	0.0043	No
3/16/2023 13:02	0	0.021	0.0201	No	0.0043	No
3/16/2023 13:03	0	0.024	0.0207	No	0.0043	No
3/16/2023 13:04	0	0.023	0.0212	No	0.0043	No
3/16/2023 13:05	0.167	0.123	0.0283	No	0.0155	No
3/16/2023 13:06	0.014	0.078	0.0323	No	0.0121	No
3/16/2023 13:07	0.003	0.022	0.0326	No	0.0123	No
3/16/2023 13:08	0.001	0.021	0.0327	No	0.0123	No
3/16/2023 13:09	0.021	0.022	0.033	No	0.0137	No
3/16/2023 13:10	0	0.018	0.0328	No	0.0137	No
3/16/2023 13:11	0	0.023	0.0323	No	0.0137	No
3/16/2023 13:12	0	0.038	0.0333	No	0.0137	No
3/16/2023 13:13	0	0.016	0.0329	No	0.0137	No
3/16/2023 13:14	0.007	0.025	0.0331	No	0.0142	No
3/16/2023 13:15	0	0.017	0.0328	No	0.0142	No
3/16/2023 13:16	0	0.016	0.0325	No	0.0142	No
3/16/2023 13:17	0	0.018	0.0323	No	0.0142	No
3/16/2023 13:18	0	0.017	0.0318	No	0.0142	No
3/16/2023 13:19	0	0.016	0.0313	No	0.0142	No
3/16/2023 13:20	0	0.016	0.0242	No	0.0031	No
3/16/2023 13:21	0	0.021	0.0204	No	0.0021	No
3/16/2023 13:22	0	0.019	0.0202	No	0.0019	No
3/16/2023 13:23	0	0.018	0.02	No	0.0019	No
3/16/2023 13:24	0	0.026	0.0203	No	0.0005	No
3/16/2023 13:25	0	0.018	0.0203	No	0.0005	No
3/16/2023 13:26	0	0.018	0.0199	No	0.0005	No
3/16/2023 13:27	0	0.02	0.0187	No	0.0005	No
3/16/2023 13:28	0	0.015	0.0187	No	0.0005	No
3/16/2023 13:29	0	0.014	0.0179	No	0	No
3/16/2023 13:30	0	0.018	0.018	No	0	No
3/16/2023 13:31	0	0.023	0.0185	No	0	No
3/16/2023 13:32	0	0.016	0.0183	No	0	No

Downwind Station						
Time	Instaneous VOC (ppm)	Instaneous Mass Conc. Total (mg/m ³)	Mass Conc. Total mg/m ³ AVG 15m (mg/m ³)	Dust Exceedance	VOC ppm AVG 15m (ppm)	VOC Exceedance
3/16/2023 13:33	0	0.015	0.0182	No	0	No
3/16/2023 13:34	0	0.015	0.0181	No	0	No
3/16/2023 13:35	0	0.02	0.0184	No	0	No
3/16/2023 13:36	0	0.02	0.0183	No	0	No
3/16/2023 13:37	0	0.02	0.0184	No	0	No
3/16/2023 13:38	0	0.015	0.0182	No	0	No
3/16/2023 13:39	0	0.135	0.0255	No	0	No
3/16/2023 13:40	0	0.018	0.0255	No	0	No
3/16/2023 13:41	0	0.021	0.0257	No	0	No
3/16/2023 13:42	0	0.015	0.0253	No	0	No
3/16/2023 13:43	0	0.018	0.0255	No	0	No
3/16/2023 13:44	0	0.017	0.0257	No	0	No
3/16/2023 13:45	0	0.017	0.0257	No	0	No
3/16/2023 13:46	0	0.015	0.0251	No	0	No
3/16/2023 13:47	0	0.016	0.0251	No	0	No
3/16/2023 13:48	0	0.025	0.0258	No	0	No
3/16/2023 13:49	0	0.022	0.0263	No	0	No
3/16/2023 13:50	0	0.019	0.0262	No	0	No
3/16/2023 13:51	0	0.019	0.0261	No	0	No
3/16/2023 13:52	0	0.017	0.0259	No	0	No
3/16/2023 13:53	0	0.016	0.026	No	0	No
3/16/2023 13:54	0	0.019	0.0183	No	0	No
3/16/2023 13:55	0.027	0.02	0.0184	No	0.0018	No
3/16/2023 13:56	0.008	0.019	0.0183	No	0.0023	No
3/16/2023 13:57	0	0.021	0.0187	No	0.0023	No
3/16/2023 13:58	0	0.022	0.0189	No	0.0023	No
3/16/2023 13:59	0.018	0.023	0.0193	No	0.0035	No
3/16/2023 14:00	0	0.022	0.0197	No	0.0035	No
3/16/2023 14:01	0	0.019	0.0199	No	0.0035	No
3/16/2023 14:02	0	0.02	0.0202	No	0.0035	No
3/16/2023 14:03	0	0.026	0.0203	No	0.0035	No
3/16/2023 14:04	0	0.025	0.0205	No	0.0035	No
3/16/2023 14:05	0	0.018	0.0204	No	0.0035	No
3/16/2023 14:06	0	0.018	0.0203	No	0.0035	No
3/16/2023 14:07	0	0.379	0.0445	No	0.0035	No
3/16/2023 14:08	0	0.427	0.0719	No	0.0035	No
3/16/2023 14:09	0	0.053	0.0741	No	0.0035	No
3/16/2023 14:10	0	1.403	0.1663	Yes	0.0017	No
3/16/2023 14:11	0	0.054	0.1687	Yes	0.0012	No
3/16/2023 14:12	0	0.094	0.1735	Yes	0.0012	No
3/16/2023 14:13	0	0.026	0.1738	Yes	0.0012	No
3/16/2023 14:14	0	0.023	0.1738	Yes	0	No
3/16/2023 14:15	0	0.021	0.1737	Yes	0	No
3/16/2023 14:16	0	0.02	0.1738	Yes	0	No
3/16/2023 14:17	0	0.024	0.1741	Yes	0	No
3/16/2023 14:18	0.014	0.028	0.1742	Yes	0.0009	No
3/16/2023 14:19	0	0.021	0.1739	Yes	0.0009	No
3/16/2023 14:20	0	0.02	0.1741	Yes	0.0009	No
3/16/2023 14:21	0	0.024	0.1745	Yes	0.0009	No
3/16/2023 14:22	0	0.022	0.1507	Yes	0.0009	No
3/16/2023 14:23	0	0.021	0.1236	No	0.0009	No
3/16/2023 14:24	0	0.027	0.1219	No	0.0009	No
3/16/2023 14:25	0	0.026	0.0301	No	0.0009	No
3/16/2023 14:26	0	0.031	0.0285	No	0.0009	No

Downwind Station						
Time	Instaneous VOC (ppm)	Instaneous Mass Conc. Total (mg/m ³)	Mass Conc. Total mg/m ³ AVG 15m (mg/m ³)	Dust Exceedance	VOC ppm AVG 15m (ppm)	VOC Exceedance
3/16/2023 14:27	0	0.047	0.0254	No	0.0009	No
3/16/2023 14:28	0.009	0.027	0.0255	No	0.0015	No
3/16/2023 14:29	0	0.024	0.0255	No	0.0015	No
3/16/2023 14:30	0	0.024	0.0257	No	0.0015	No
3/16/2023 14:31	0.024	0.031	0.0265	No	0.0031	No
3/16/2023 14:32	0	0.027	0.0267	No	0.0031	No
3/16/2023 14:33	0.002	0.023	0.0263	No	0.0023	No
3/16/2023 14:34	0.004	0.025	0.0266	No	0.0026	No
3/16/2023 14:35	0	0.025	0.0269	No	0.0026	No
3/16/2023 14:36	0	0.024	0.0269	No	0.0026	No
3/16/2023 14:37	0	0.023	0.027	No	0.0026	No
3/16/2023 14:38	0.13	0.024	0.0272	No	0.0113	No
3/16/2023 14:39	0.088	0.025	0.0271	No	0.0171	No
3/16/2023 14:40	0.017	0.027	0.0271	No	0.0183	No
3/16/2023 14:41	0.004	0.027	0.0269	No	0.0185	No
3/16/2023 14:42	0	0.025	0.0254	No	0.0185	No
3/16/2023 14:43	0	0.027	0.0254	No	0.0179	No
3/16/2023 14:44	0.075	0.025	0.0255	No	0.0229	No
3/16/2023 14:45	0.154	0.029	0.0258	No	0.0332	No
3/16/2023 14:46	0.079	0.031	0.0258	No	0.0369	No
3/16/2023 14:47	0	0.024	0.0256	No	0.0369	No
3/16/2023 14:48	0	0.021	0.0255	No	0.0367	No
3/16/2023 14:49	0	0.024	0.0254	No	0.0365	No
3/16/2023 14:50	0	0.022	0.0252	No	0.0365	No
3/16/2023 14:51	0.032	0.026	0.0253	No	0.0386	No
3/16/2023 14:52	0	0.025	0.0255	No	0.0386	No
3/16/2023 14:53	0.028	0.026	0.0256	No	0.0318	No
3/16/2023 14:54	0.014	0.025	0.0256	No	0.0269	No
3/16/2023 14:55	0.011	0.027	0.0256	No	0.0265	No
3/16/2023 14:56	0	0.024	0.0254	No	0.0262	No
3/16/2023 14:57	0	0.023	0.0253	No	0.0262	No
3/16/2023 14:58	0	0.025	0.0251	No	0.0262	No
3/16/2023 14:59	0	0.02	0.0248	No	0.0212	No
3/16/2023 15:00	0	0.021	0.0243	No	0.0109	No
3/16/2023 15:01	0.016	0.025	0.0239	No	0.0067	No
3/16/2023 15:02	0	0.023	0.0238	No	0.0067	No
3/16/2023 15:03	0	0.024	0.024	No	0.0067	No
3/16/2023 15:04	0.145	0.033	0.0246	No	0.0164	No
3/16/2023 15:05	0	0.03	0.0251	No	0.0164	No
3/16/2023 15:06	0	0.024	0.025	No	0.0143	No
3/16/2023 15:07	0.003	0.029	0.0253	No	0.0145	No
3/16/2023 15:08	0	0.025	0.0252	No	0.0126	No
3/16/2023 15:09	0	0.026	0.0253	No	0.0117	No
3/16/2023 15:10	0.004	0.027	0.0253	No	0.0112	No
3/16/2023 15:11	0	0.038	0.0262	No	0.0112	No
3/16/2023 15:12	0	0.029	0.0266	No	0.0112	No
3/16/2023 15:13	0.023	0.061	0.029	No	0.0127	No
3/16/2023 15:14	0.018	0.068	0.0322	No	0.0139	No
3/16/2023 15:15	0	0.071	0.0355	No	0.0139	No
3/16/2023 15:16	0	0.034	0.0361	No	0.0129	No
3/16/2023 15:17	0.024	0.072	0.0394	No	0.0145	No
3/16/2023 15:18	0	0.048	0.041	No	0.0145	No

Downwind Station						
Time	Instantaneous VOC (ppm)	Instantaneous Mass Conc. Total (mg/m ³)	Mass Conc. Total mg/m ³ AVG 15m (mg/m ³)	Dust Exceedance	VOC ppm AVG 15m (ppm)	VOC Exceedance
3/16/2023 15:19	0	0.038	0.0413	No	0.0048	No
3/16/2023 15:20	0	0.037	0.0418	No	0.0048	No
3/16/2023 15:21	0.038	0.081	0.0456	No	0.0073	No
3/16/2023 15:22	0.007	0.044	0.0466	No	0.0076	No
3/16/2023 15:23	0	0.032	0.0471	No	0.0076	No
3/16/2023 15:24	0	0.032	0.0475	No	0.0076	No
3/16/2023 15:25	0	0.038	0.0482	No	0.0073	No
3/16/2023 15:26	0	0.029	0.0476	No	0.0073	No
3/16/2023 15:27	0.076	0.032	0.0478	No	0.0124	No
3/16/2023 15:28	0	0.046	0.0468	No	0.0109	No
3/16/2023 15:29	0	0.035	0.0446	No	0.0097	No
3/16/2023 15:30	0	0.043	0.0427	No	0.0097	No
3/16/2023 15:31	0	0.027	0.0423	No	0.0097	No
3/16/2023 15:32	0	0.035	0.0398	No	0.0081	No
3/16/2023 15:33	0	0.029	0.0385	No	0.0081	No
3/16/2023 15:34	0	0.026	0.0377	No	0.0081	No
3/16/2023 15:35	0	0.03	0.0373	No	0.0081	No
3/16/2023 15:36	0	0.036	0.0343	No	0.0055	No
3/16/2023 15:37	0	0.032	0.0335	No	0.0051	No
3/16/2023 15:38	0	0.026	0.0331	No	0.0051	No
3/16/2023 15:39	0	0.025	0.0326	No	0.0051	No
3/16/2023 15:40	0	0.028	0.0319	No	0.0051	No
3/16/2023 15:41	0	0.024	0.0316	No	0.0051	No
3/16/2023 15:42	0	0.031	0.0315	No	0	No
3/16/2023 15:43	0	0.047	0.0316	No	0	No
3/16/2023 15:44	0	0.025	0.0309	No	0	No
3/16/2023 15:45	0	0.021	0.0295	No	0	No
3/16/2023 15:46	0	0.022	0.0291	No	0	No
3/16/2023 15:47	0	0.024	0.0284	No	0	No
3/16/2023 15:48	0	0.02	0.0278	No	0	No
3/16/2023 15:49	0	0.023	0.0276	No	0	No
3/16/2023 15:50	0	0.023	0.0271	No	0	No
3/16/2023 15:51	0	0.02	0.0261	No	0	No
3/16/2023 15:52	0	0.02	0.0253	No	0	No
3/16/2023 15:53	0	0.023	0.0251	No	0	No
3/16/2023 15:54	0	0.022	0.0249	No	0	No
3/16/2023 15:55	0	0.025	0.0247	No	0	No
3/16/2023 15:56	0	0.025	0.0247	No	0	No
3/16/2023 15:57	0	0.023	0.0242	No	0	No
3/16/2023 15:58	0	0.038	0.0236	No	0	No
3/16/2023 15:59	0	0.05	0.0253	No	0	No
3/16/2023 16:00	0	0.025	0.0255	No	0	No
3/16/2023 16:01	0	0.021	0.0255	No	0	No