



Daily Activity Report

Seton Brilla Charter School
1956 Jerome Avenue, Bronx, NY
BCP No. C203152

General Site Information

Date:	Friday March 17th, 2023
Weather:	Cloudy, 40-58°F
Wind Direction/Speed:	South @ 5 mph
AKRF Personnel on Site:	Nicolette Cruz
AKRF Equipment on Site:	Mini RAE 3000 Photoionization Detector [(PID) x1], 2 Fixed Air Monitoring Stations [DustTrak Aerosol Monitors (x2) & MiniRAE 3000 PIDs (x2)], 1 Roving Set [MiniRAE 3000].
Visitors:	None.

Contractor Information

Contracting Company	Main Personnel	Equipment
Casino Construction	Carlos	Excavator

Description and Location of Work Activities Performed

- 1) Soil grading and stockpile management in grids WC-03 and WC-04.
- 2) Four truckloads of soil from grids WC-03 and WC-04 were sent for off-site disposal at the CE -Carteret facility in Carteret, NJ.
- 3) Pile cap construction activities continued.

Destination Facility	Daily Trucks	Total Trucks	Daily Approx. Cubic Yds	Total Approx. Cubic Yds	Total Site Loads	Total Approximate Cubic Yards
Clean Earth Carteret	4	79	80	1,660	176	3,520
Clean Earth Southeastern Pennsylvania	0	67	0	1,340		
Concrete Disposal	0	26	0	520		
N/A	0	0	0	0		
N/A	0	0	0	0		

CAMP Air Monitoring Results

CAMP Station	UPWIND				DOWNWIND		
Odors:	None.				None.		
VOC Action Level Exceedance(s):	None.				None.		
Particulate Action Level Exceedance(s):	Yes				None.		
Maximum VOC Level (15 min ppm):	0.341				0.078		
Maximum Particulate Level (15 min mg/m ³):	0.440				0.194		

Notes: CAMP monitoring was performed throughout the day. A particulate exceedance was detected at the downwind station at approximately 0816 due to welding activities near the CAMP station and not site activities. Concentrations returned to normal once the welding operation was relocated. A particulate exceedance was detected at the upwind station at approximately 1030. Dust was not visible in the area and there were no exceedances at the downwind station; however, water was applied to the area as a precautionary measure. Instantaneous concentrations returned to background levels in 5 minutes and the 15-min TWA returned to background in approximately 10 minutes. No further exceedances were measured.





Additional Information

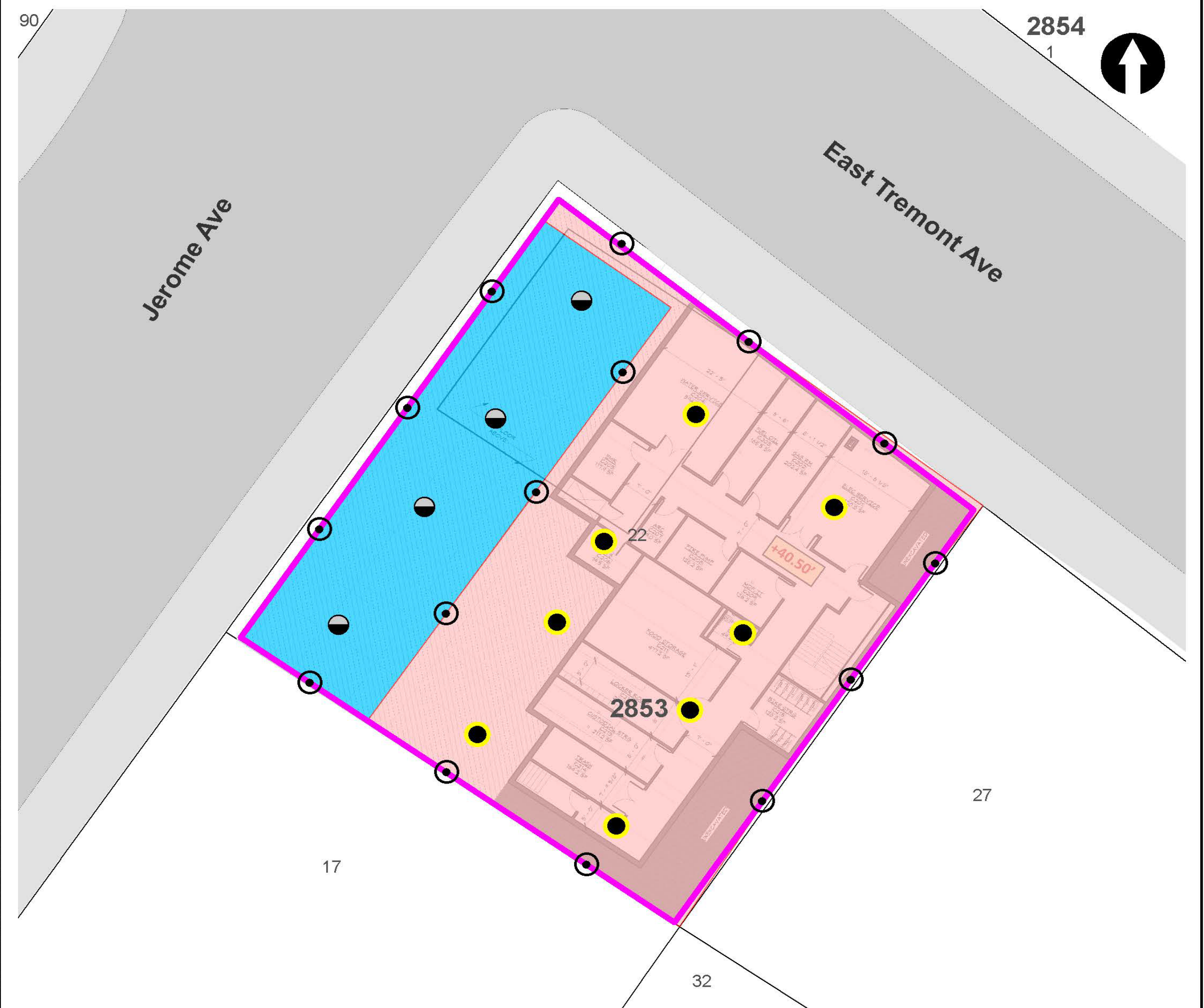

Planned Work Activity for Following Day/Week:	1) Excavation of soil/fill to uncover piles. 2) Cutting piles to final elevations
Comments:	None.

Site Map



LEGEND

-  PROJECT SITE BOUNDARY
-  LOT BOUNDARY AND TAX LOT NUMBER
- 2853** BLOCK NUMBER
-  REMEDIAL EXCAVATION TO APPROXIMATELY TWO FEET BELOW EXISTING GRADE
-  REMEDIAL EXCAVATION TO GROUNDWATER (SOURCE AREA)

-  CONFIRMATION DOCUMENTATION BOTTOM SAMPLE
-  SOURCE AREA DOCUMENTATION BOTTOM SAMPLE
-  DOCUMENTATION SIDEWALL SAMPLE

NOTE
 REMEDIAL EXCAVATION WILL INCLUDE REMOVAL OF APPROXIMATELY 1,280 TONS (850 CUBIC YARDS) OF SOURCE MATERIAL ASSOCIATED WITH NYSDEC SPILL NO. 2103719 AND APPROXIMATELY 860 TONS (570 CUBIC YARDS) OF SOIL/FILL FROM THE UPPER 2 FEET SITE-WIDE.



Map Source:
 NYCDP (NYC Dept. of City Planning) GIS database

© 2021 AKRF. W:\Projects\210024 - 1956 JEROME AVENUE\Technical\GIS and Graphics\AR\RAWP\210024 Figure 9 Proposed Remedial Excavation and Documentation Sample Location Plan.mxd 10/25/2021 2:03:38 PM iszalus



440 Park Avenue South, New York, NY 10016

1956 Jerome Avenue
 Bronx, New York

**TRACK 4 CLEANUP AND DOCUMENTATION
 SAMPLE LOCATION PLAN**

DATE
04/29/2022

PROJECT NO.
210024

FIGURE
11

Site Photographs

Photograph 1 -
Exporting of soil off
site from WC-03 and
WC-03 facing North



Photograph 2-
Excavation of site to
prep for further
construction in WC-
03



Photograph 3-
General site
overview while
grading of soil
continues



Upwind Station

Time	Instaneous VOC (ppm)	Instaneous Mass Conc. Total (mg/m ³)	Mass Conc. Total mg/m ³ AVG 15m (mg/m ³)	Dust Exceedance	VOC ppm AVG 15m (ppm)	VOC Exceedance
3/17/2023 7:22	0	0.038	0.038	No	0	No
3/17/2023 7:23	0	0.035	0.0365	No	0	No
3/17/2023 7:24	0	0.038	0.037	No	0	No
3/17/2023 7:25	0	0.038	0.0373	No	0	No
3/17/2023 7:26	0	0.037	0.0372	No	0	No
3/17/2023 7:27	0	0.036	0.037	No	0	No
3/17/2023 7:28	0	0.036	0.0369	No	0	No
3/17/2023 7:29	0	0.039	0.0371	No	0	No
3/17/2023 7:30	0	0.039	0.0373	No	0	No
3/17/2023 7:31	0	0.04	0.0376	No	0	No
3/17/2023 7:32	0	0.044	0.0382	No	0	No
3/17/2023 7:33	0	0.041	0.0384	No	0	No
3/17/2023 7:34	0	0.042	0.0387	No	0	No
3/17/2023 7:35	0	0.043	0.039	No	0	No
3/17/2023 7:36	0	0.042	0.0392	No	0	No
3/17/2023 7:37	0	0.042	0.0395	No	0	No
3/17/2023 7:38	0	0.044	0.0401	No	0	No
3/17/2023 7:39	0	0.042	0.0403	No	0	No
3/17/2023 7:40	0	0.039	0.0404	No	0	No
3/17/2023 7:41	0	0.038	0.0405	No	0	No
3/17/2023 7:42	0	0.037	0.0405	No	0	No
3/17/2023 7:43	0	0.038	0.0407	No	0	No
3/17/2023 7:44	0	0.036	0.0405	No	0	No
3/17/2023 7:45	0	0.036	0.0403	No	0	No
3/17/2023 7:46	0	0.035	0.0399	No	0	No
3/17/2023 7:47	0	0.035	0.0393	No	0	No
3/17/2023 7:48	0	0.038	0.0391	No	0	No
3/17/2023 7:49	0	0.041	0.0391	No	0	No
3/17/2023 7:50	0	0.039	0.0388	No	0	No
3/17/2023 7:51	0	0.035	0.0383	No	0	No
3/17/2023 7:52	0	0.036	0.0379	No	0	No
3/17/2023 7:53	0	0.036	0.0374	No	0	No
3/17/2023 7:54	0	0.039	0.0372	No	0	No
3/17/2023 7:55	0	0.038	0.0371	No	0	No
3/17/2023 7:56	0	0.04	0.0373	No	0	No
3/17/2023 7:57	0	0.04	0.0375	No	0	No
3/17/2023 7:58	0	0.046	0.038	No	0	No
3/17/2023 7:59	0	0.043	0.0385	No	0	No
3/17/2023 8:00	0	0.04	0.0387	No	0	No
3/17/2023 8:01	0	0.037	0.0389	No	0	No
3/17/2023 8:02	0	0.039	0.0391	No	0	No
3/17/2023 8:03	0	0.039	0.0392	No	0	No
3/17/2023 8:04	0	0.039	0.0391	No	0	No
3/17/2023 8:05	0	0.042	0.0393	No	0	No
3/17/2023 8:06	0	0.068	0.0415	No	0	No
3/17/2023 8:07	0	0.047	0.0422	No	0	No
3/17/2023 8:08	0	0.047	0.0429	No	0	No
3/17/2023 8:09	0	0.068	0.0449	No	0	No
3/17/2023 8:10	0	0.046	0.0454	No	0	No
3/17/2023 8:11	0	0.033	0.0449	No	0	No
3/17/2023 8:12	0	0.035	0.0446	No	0	No
3/17/2023 8:13	0	0.045	0.0445	No	0	No

Upwind Station						
Time	Instaneous VOC (ppm)	Instaneous Mass Conc. Total (mg/m ³)	Mass Conc. Total mg/m ³ AVG 15m (mg/m ³)	Dust Exceedance	VOC ppm AVG 15m (ppm)	VOC Exceedance
3/17/2023 8:14	0	0.043	0.0445	No	0	No
3/17/2023 8:15	0	0.036	0.0443	No	0	No
3/17/2023 8:16	0	0.043	0.0447	No	0	No
3/17/2023 8:17	0	0.038	0.0446	No	0	No
3/17/2023 8:18	0.042	0.042	0.0448	No	0.0028	No
3/17/2023 8:19	0.251	0.047	0.0453	No	0.0195	No
3/17/2023 8:20	0.304	0.036	0.0449	No	0.0398	No
3/17/2023 8:21	0.299	0.038	0.0429	No	0.0597	No
3/17/2023 8:22	0.207	0.054	0.0434	No	0.0735	No
3/17/2023 8:23	0	0.053	0.0438	No	0.0735	No
3/17/2023 8:24	0	0.055	0.0429	No	0.0735	No
3/17/2023 8:25	0	0.093	0.0461	No	0.0735	No
3/17/2023 8:26	0	0.07	0.0485	No	0.0735	No
3/17/2023 8:27	0	0.097	0.0527	No	0.0735	No
3/17/2023 8:28	0	0.116	0.0574	No	0.0735	No
3/17/2023 8:29	0	0.079	0.0598	No	0.0735	No
3/17/2023 8:30	0	0.084	0.063	No	0.0735	No
3/17/2023 8:31	0	0.073	0.065	No	0.0735	No
3/17/2023 8:32	0	0.059	0.0664	No	0.0735	No
3/17/2023 8:33	0	0.047	0.0667	No	0.0707	No
3/17/2023 8:34	0	0.036	0.066	No	0.054	No
3/17/2023 8:35	0	0.058	0.0675	No	0.0337	No
3/17/2023 8:36	0	0.045	0.0679	No	0.0138	No
3/17/2023 8:37	0	0.035	0.0667	No	0	No
3/17/2023 8:38	0	0.045	0.0661	No	0	No
3/17/2023 8:39	0	0.104	0.0694	No	0	No
3/17/2023 8:40	0	0.09	0.0692	No	0	No
3/17/2023 8:41	0	0.081	0.0699	No	0	No
3/17/2023 8:42	0	0.119	0.0714	No	0	No
3/17/2023 8:43	0	0.107	0.0708	No	0	No
3/17/2023 8:44	0	0.12	0.0735	No	0	No
3/17/2023 8:45	0	0.191	0.0807	No	0	No
3/17/2023 8:46	0	0.057	0.0796	No	0	No
3/17/2023 8:47	0	0.055	0.0793	No	0	No
3/17/2023 8:48	0	0.152	0.0863	No	0	No
3/17/2023 8:49	0	0.136	0.093	No	0	No
3/17/2023 8:50	0	0.233	0.1047	No	0	No
3/17/2023 8:51	0.042	0.104	0.1086	No	0.0028	No
3/17/2023 8:52	0.04	0.062	0.1104	No	0.0055	No
3/17/2023 8:53	0.015	0.04	0.1101	No	0.0065	No
3/17/2023 8:54	0.004	0.034	0.1054	No	0.0067	No
3/17/2023 8:55	0	0.032	0.1015	No	0.0067	No
3/17/2023 8:56	0	0.032	0.0983	No	0.0067	No
3/17/2023 8:57	0	0.033	0.0925	No	0.0067	No
3/17/2023 8:58	0	0.09	0.0914	No	0.0067	No
3/17/2023 8:59	0	0.137	0.0925	No	0.0067	No
3/17/2023 9:00	0	0.089	0.0857	No	0.0067	No
3/17/2023 9:01	0	0.105	0.0889	No	0.0067	No
3/17/2023 9:02	0.022	0.119	0.0932	No	0.0082	No
3/17/2023 9:03	0	0.144	0.0927	No	0.0082	No
3/17/2023 9:04	0	0.058	0.0875	No	0.0082	No
3/17/2023 9:05	0	0.037	0.0744	No	0.0082	No

Upwind Station						
Time	Instaneous VOC (ppm)	Instaneous Mass Conc. Total (mg/m ³)	Mass Conc. Total mg/m ³ AVG 15m (mg/m ³)	Dust Exceedance	VOC ppm AVG 15m (ppm)	VOC Exceedance
3/17/2023 9:06	0.022	0.061	0.0715	No	0.0069	No
3/17/2023 9:07	0	0.072	0.0722	No	0.0042	No
3/17/2023 9:08	0	0.057	0.0733	No	0.0032	No
3/17/2023 9:09	0	0.04	0.0737	No	0.0029	No
3/17/2023 9:10	0	0.053	0.0751	No	0.0029	No
3/17/2023 9:11	0	0.066	0.0774	No	0.0029	No
3/17/2023 9:12	0	0.06	0.0792	No	0.0029	No
3/17/2023 9:13	0	0.084	0.0788	No	0.0029	No
3/17/2023 9:14	0	0.05	0.073	No	0.0029	No
3/17/2023 9:15	0	0.071	0.0718	No	0.0029	No
3/17/2023 9:16	0	0.045	0.0678	No	0.0029	No
3/17/2023 9:17	0	0.053	0.0634	No	0.0015	No
3/17/2023 9:18	0	0.068	0.0583	No	0.0015	No
3/17/2023 9:19	0	0.058	0.0583	No	0.0015	No
3/17/2023 9:20	0	0.058	0.0597	No	0.0015	No
3/17/2023 9:21	0	0.047	0.0588	No	0	No
3/17/2023 9:22	0	0.046	0.0571	No	0	No
3/17/2023 9:23	0	0.043	0.0561	No	0	No
3/17/2023 9:24	0	0.042	0.0563	No	0	No
3/17/2023 9:25	0	0.039	0.0553	No	0	No
3/17/2023 9:26	0.001	0.036	0.0533	No	0.0001	No
3/17/2023 9:27	0	0.045	0.0523	No	0.0001	No
3/17/2023 9:28	0	0.038	0.0493	No	0.0001	No
3/17/2023 9:29	0	0.037	0.0484	No	0.0001	No
3/17/2023 9:30	0	0.036	0.0461	No	0.0001	No
3/17/2023 9:31	0	0.038	0.0456	No	0.0001	No
3/17/2023 9:32	0	0.035	0.0444	No	0.0001	No
3/17/2023 9:33	0	0.038	0.0424	No	0.0001	No
3/17/2023 9:34	0	0.048	0.0417	No	0.0001	No
3/17/2023 9:35	0	0.05	0.0412	No	0.0001	No
3/17/2023 9:36	0	0.053	0.0416	No	0.0001	No
3/17/2023 9:37	0	0.05	0.0419	No	0.0001	No
3/17/2023 9:38	0.001	0.068	0.0435	No	0.0001	No
3/17/2023 9:39	0	0.06	0.0447	No	0.0001	No
3/17/2023 9:40	0	0.045	0.0451	No	0.0001	No
3/17/2023 9:41	0	0.042	0.0455	No	0.0001	No
3/17/2023 9:42	0	0.042	0.0453	No	0.0001	No
3/17/2023 9:43	0	0.066	0.0472	No	0.0001	No
3/17/2023 9:44	0	0.056	0.0485	No	0.0001	No
3/17/2023 9:45	0	0.046	0.0491	No	0.0001	No
3/17/2023 9:46	0	0.044	0.0495	No	0.0001	No
3/17/2023 9:47	0	0.045	0.0502	No	0.0001	No
3/17/2023 9:48	0	0.047	0.0508	No	0.0001	No
3/17/2023 9:49	0	0.049	0.0509	No	0.0001	No
3/17/2023 9:50	0	0.054	0.0511	No	0.0001	No
3/17/2023 9:51	0	0.058	0.0515	No	0.0001	No
3/17/2023 9:52	0	0.053	0.0517	No	0.0001	No
3/17/2023 9:53	0	0.047	0.0503	No	0	No
3/17/2023 9:54	0	0.074	0.0512	No	0	No
3/17/2023 9:55	0	0.052	0.0517	No	0	No
3/17/2023 9:56	0	0.045	0.0519	No	0	No
3/17/2023 9:57	0	0.048	0.0523	No	0	No

Upwind Station						
Time	Instaneous VOC (ppm)	Instaneous Mass Conc. Total (mg/m ³)	Mass Conc. Total mg/m ³ AVG 15m (mg/m ³)	Dust Exceedance	VOC ppm AVG 15m (ppm)	VOC Exceedance
3/17/2023 9:58	0	0.045	0.0509	No	0	No
3/17/2023 9:59	0	0.045	0.0501	No	0	No
3/17/2023 10:00	0	0.043	0.0499	No	0	No
3/17/2023 10:01	0	0.043	0.0499	No	0	No
3/17/2023 10:02	0	0.043	0.0497	No	0	No
3/17/2023 10:03	0	0.042	0.0494	No	0	No
3/17/2023 10:04	0	0.04	0.0488	No	0	No
3/17/2023 10:05	0	0.042	0.048	No	0	No
3/17/2023 10:06	0	0.042	0.0469	No	0	No
3/17/2023 10:07	0.035	0.047	0.0465	No	0.0023	No
3/17/2023 10:08	0.013	0.043	0.0463	No	0.0032	No
3/17/2023 10:09	0.024	0.048	0.0445	No	0.0048	No
3/17/2023 10:10	0.016	0.045	0.0441	No	0.0059	No
3/17/2023 10:11	0.008	0.045	0.0441	No	0.0064	No
3/17/2023 10:12	0	0.044	0.0438	No	0.0064	No
3/17/2023 10:13	0	0.046	0.0439	No	0.0064	No
3/17/2023 10:14	0	0.045	0.0439	No	0.0064	No
3/17/2023 10:15	0	0.047	0.0441	No	0.0064	No
3/17/2023 10:16	0.006	0.045	0.0443	No	0.0068	No
3/17/2023 10:17	0.008	0.047	0.0445	No	0.0073	No
3/17/2023 10:18	0	0.047	0.0449	No	0.0073	No
3/17/2023 10:19	0.007	0.048	0.0454	No	0.0078	No
3/17/2023 10:20	0	0.046	0.0457	No	0.0078	No
3/17/2023 10:21	0.005	0.045	0.0459	No	0.0081	No
3/17/2023 10:22	0	0.045	0.0457	No	0.0058	No
3/17/2023 10:23	0	0.045	0.0459	No	0.0049	No
3/17/2023 10:24	0.001	0.046	0.0457	No	0.0034	No
3/17/2023 10:25	0.013	0.057	0.0465	No	0.0032	No
3/17/2023 10:26	0.129	0.085	0.0492	No	0.0113	No
3/17/2023 10:27	0.176	0.15	0.0563	No	0.023	No
3/17/2023 10:28	0.807	0.815	0.1075	No	0.0768	No
3/17/2023 10:29	0.62	1.369	0.1958	Yes	0.1181	No
3/17/2023 10:30	1.076	1.147	0.2691	Yes	0.1899	No
3/17/2023 10:31	0.473	0.743	0.3157	Yes	0.221	No
3/17/2023 10:32	0.455	0.753	0.3627	Yes	0.2508	No
3/17/2023 10:33	0.264	0.221	0.3743	Yes	0.2684	No
3/17/2023 10:34	0.217	0.182	0.3833	Yes	0.2824	No
3/17/2023 10:35	0.192	0.186	0.3926	Yes	0.2952	No
3/17/2023 10:36	0.231	0.351	0.413	Yes	0.3103	No
3/17/2023 10:37	0.191	0.231	0.4254	Yes	0.323	No
3/17/2023 10:38	0.155	0.218	0.4369	Yes	0.3333	No
3/17/2023 10:39	0.072	0.089	0.4398	Yes	0.3381	No
3/17/2023 10:40	0.057	0.049	0.4393	Yes	0.341	No
3/17/2023 10:41	0.042	0.046	0.4367	Yes	0.3352	No
3/17/2023 10:42	0.046	0.055	0.4303	Yes	0.3265	No
3/17/2023 10:43	0.053	0.123	0.3842	Yes	0.2763	No
3/17/2023 10:44	0.061	0.093	0.2991	Yes	0.239	No
3/17/2023 10:45	0.037	0.057	0.2265	Yes	0.1697	No
3/17/2023 10:46	0.024	0.048	0.1801	Yes	0.1398	No
3/17/2023 10:47	0.019	0.052	0.1334	No	0.1107	No
3/17/2023 10:48	0.024	0.063	0.1229	No	0.0947	No
3/17/2023 10:49	0.032	0.053	0.1143	No	0.0824	No

Upwind Station						
Time	Instaneous VOC (ppm)	Instaneous Mass Conc. Total (mg/m ³)	Mass Conc. Total mg/m ³ AVG 15m (mg/m ³)	Dust Exceedance	VOC ppm AVG 15m (ppm)	VOC Exceedance
3/17/2023 10:50	0.013	0.064	0.1061	No	0.0705	No
3/17/2023 10:51	0.009	0.053	0.0863	No	0.0557	No
3/17/2023 10:52	0.008	0.046	0.0739	No	0.0435	No
3/17/2023 10:53	0.019	0.044	0.0623	No	0.0344	No
3/17/2023 10:54	0.017	0.04	0.0591	No	0.0307	No
3/17/2023 10:55	0.002	0.044	0.0587	No	0.0271	No
3/17/2023 10:56	0.006	0.057	0.0595	No	0.0247	No
3/17/2023 10:57	0.004	0.078	0.061	No	0.0219	No
3/17/2023 10:58	0	0.088	0.0587	No	0.0183	No
3/17/2023 10:59	0	0.056	0.0562	No	0.0143	No
3/17/2023 11:00	0	0.06	0.0564	No	0.0118	No
3/17/2023 11:01	0	0.051	0.0566	No	0.0102	No
3/17/2023 11:02	0	0.064	0.0574	No	0.0089	No
3/17/2023 11:03	0	0.091	0.0593	No	0.0073	No
3/17/2023 11:04	0	0.057	0.0595	No	0.0052	No
3/17/2023 11:05	0	0.05	0.0586	No	0.0043	No
3/17/2023 11:06	0	0.045	0.0581	No	0.0037	No
3/17/2023 11:07	0	0.043	0.0579	No	0.0032	No
3/17/2023 11:08	0	0.045	0.0579	No	0.0019	No
3/17/2023 11:09	0	0.068	0.0598	No	0.0008	No
3/17/2023 11:10	0	0.069	0.0615	No	0.0007	No
3/17/2023 11:11	0	0.063	0.0619	No	0.0003	No
3/17/2023 11:12	0	0.055	0.0603	No	0	No
3/17/2023 11:13	0	0.042	0.0573	No	0	No
3/17/2023 11:14	0	0.046	0.0566	No	0	No
3/17/2023 11:15	0	0.054	0.0562	No	0	No
3/17/2023 11:16	0	0.05	0.0561	No	0	No
3/17/2023 11:17	0	0.048	0.0551	No	0	No
3/17/2023 11:18	0	0.046	0.0521	No	0	No
3/17/2023 11:19	0.02	0.044	0.0512	No	0.001	No
3/17/2023 11:20	0	0.075	0.0529	No	0.001	No
3/17/2023 11:21	0	0.045	0.0529	No	0.001	No
3/17/2023 11:22	0	0.044	0.0529	No	0.001	No
3/17/2023 11:23	0	0.047	0.0531	No	0.001	No
3/17/2023 11:24	0	0.079	0.0538	No	0.001	No
3/17/2023 11:25	0	0.045	0.0522	No	0.001	No
3/17/2023 11:26	0	0.045	0.051	No	0.001	No
3/17/2023 11:27	0	0.053	0.0509	No	0.001	No
3/17/2023 11:28	0	0.065	0.0524	No	0.001	No
3/17/2023 11:29	0	0.064	0.0536	No	0.001	No
3/17/2023 11:30	0	0.045	0.053	No	0.001	No
3/17/2023 11:31	0	0.041	0.0524	No	0.001	No
3/17/2023 11:32	0	0.041	0.0519	No	0.001	No
3/17/2023 11:33	0	0.042	0.0517	No	0.001	No
3/17/2023 11:34	0	0.04	0.0514	No	0	No
3/17/2023 11:35	0	0.062	0.0505	No	0	No
3/17/2023 11:36	0	0.067	0.052	No	0	No
3/17/2023 11:37	0	0.059	0.053	No	0	No
3/17/2023 11:38	0	0.044	0.0528	No	0	No
3/17/2023 11:39	0	0.038	0.0501	No	0	No
3/17/2023 11:40	0	0.041	0.0498	No	0	No
3/17/2023 11:41	0	0.047	0.0499	No	0	No

Upwind Station						
Time	Instaneous VOC (ppm)	Instaneous Mass Conc. Total (mg/m ³)	Mass Conc. Total mg/m ³ AVG 15m (mg/m ³)	Dust Exceedance	VOC ppm AVG 15m (ppm)	VOC Exceedance
3/17/2023 11:42	0	0.04	0.0491	No	0	No
3/17/2023 11:43	0	0.043	0.0476	No	0	No
3/17/2023 11:44	0	0.041	0.0461	No	0	No
3/17/2023 11:45	0	0.043	0.0459	No	0	No
3/17/2023 11:46	0	0.049	0.0465	No	0	No
3/17/2023 11:47	0	0.046	0.0468	No	0	No
3/17/2023 11:48	0	0.046	0.0471	No	0	No
3/17/2023 11:49	0	0.065	0.0487	No	0	No
3/17/2023 11:50	0	0.045	0.0476	No	0	No
3/17/2023 11:51	0	0.042	0.0459	No	0	No
3/17/2023 11:52	0	0.042	0.0448	No	0	No
3/17/2023 11:53	0	0.04	0.0445	No	0	No
3/17/2023 11:54	0	0.046	0.0451	No	0	No
3/17/2023 11:55	0	0.043	0.0452	No	0	No
3/17/2023 11:56	0	0.043	0.0449	No	0	No
3/17/2023 11:57	0	0.042	0.0451	No	0	No
3/17/2023 11:58	0	0.04	0.0449	No	0	No
3/17/2023 11:59	0	0.043	0.045	No	0	No
3/17/2023 12:00	0	0.042	0.0449	No	0	No
3/17/2023 12:01	0	0.04	0.0443	No	0	No
3/17/2023 12:02	0	0.039	0.0439	No	0	No
3/17/2023 12:03	0	0.038	0.0433	No	0	No
3/17/2023 12:04	0	0.041	0.0417	No	0	No
3/17/2023 12:05	0	0.039	0.0413	No	0	No
3/17/2023 12:06	0.033	0.045	0.0415	No	0.0022	No
3/17/2023 12:07	0	0.057	0.0425	No	0.0022	No
3/17/2023 12:08	0	0.048	0.0431	No	0.0022	No
3/17/2023 12:09	0	0.05	0.0433	No	0.0022	No
3/17/2023 12:10	0	0.053	0.044	No	0.0022	No
3/17/2023 12:11	0	0.05	0.0445	No	0.0022	No
3/17/2023 12:12	0	0.052	0.0451	No	0.0022	No
3/17/2023 12:13	0	0.044	0.0454	No	0.0022	No
3/17/2023 12:14	0	0.039	0.0451	No	0.0022	No
3/17/2023 12:15	0	0.036	0.0447	No	0.0022	No
3/17/2023 12:16	0	0.04	0.0447	No	0.0022	No
3/17/2023 12:17	0	0.04	0.0448	No	0.0022	No
3/17/2023 12:18	0	0.039	0.0449	No	0.0022	No
3/17/2023 12:19	0	0.041	0.0449	No	0.0022	No
3/17/2023 12:20	0	0.04	0.0449	No	0.0022	No
3/17/2023 12:21	0	0.037	0.0444	No	0	No
3/17/2023 12:22	0	0.036	0.043	No	0	No
3/17/2023 12:23	0	0.04	0.0425	No	0	No
3/17/2023 12:24	0	0.038	0.0417	No	0	No
3/17/2023 12:25	0	0.041	0.0409	No	0	No
3/17/2023 12:26	0	0.045	0.0405	No	0	No
3/17/2023 12:27	0	0.048	0.0403	No	0	No
3/17/2023 12:28	0	0.046	0.0404	No	0	No
3/17/2023 12:29	0	0.048	0.041	No	0	No
3/17/2023 12:30	0	0.042	0.0414	No	0	No
3/17/2023 12:31	0	0.038	0.0413	No	0	No
3/17/2023 12:32	0	0.04	0.0413	No	0	No
3/17/2023 12:33	0	0.039	0.0413	No	0	No

Upwind Station						
Time	Instaneous VOC (ppm)	Instaneous Mass Conc. Total (mg/m ³)	Mass Conc. Total mg/m ³ AVG 15m (mg/m ³)	Dust Exceedance	VOC ppm AVG 15m (ppm)	VOC Exceedance
3/17/2023 12:34	0	0.039	0.0411	No	0	No
3/17/2023 12:35	0	0.039	0.0411	No	0	No
3/17/2023 12:36	0	0.039	0.0412	No	0	No
3/17/2023 12:37	0	0.039	0.0414	No	0	No
3/17/2023 12:38	0	0.039	0.0413	No	0	No
3/17/2023 12:39	0	0.038	0.0413	No	0	No
3/17/2023 12:40	0	0.042	0.0414	No	0	No
3/17/2023 12:41	0	0.039	0.041	No	0	No
3/17/2023 12:42	0	0.039	0.0404	No	0	No
3/17/2023 12:43	0	0.043	0.0402	No	0	No
3/17/2023 12:44	0	0.043	0.0399	No	0	No
3/17/2023 12:45	0	0.041	0.0398	No	0	No
3/17/2023 12:46	0	0.04	0.0399	No	0	No
3/17/2023 12:47	0	0.041	0.04	No	0	No
3/17/2023 12:48	0	0.043	0.0403	No	0	No
3/17/2023 12:49	0	0.043	0.0405	No	0	No
3/17/2023 12:50	0	0.044	0.0409	No	0	No
3/17/2023 12:51	0	0.042	0.0411	No	0	No
3/17/2023 12:52	0	0.043	0.0413	No	0	No
3/17/2023 12:53	0	0.041	0.0415	No	0	No
3/17/2023 12:54	0	0.041	0.0417	No	0	No
3/17/2023 12:55	0	0.039	0.0415	No	0	No
3/17/2023 12:56	0	0.041	0.0416	No	0	No
3/17/2023 12:57	0	0.048	0.0422	No	0	No
3/17/2023 12:58	0	0.047	0.0425	No	0	No
3/17/2023 12:59	0	0.045	0.0426	No	0	No
3/17/2023 13:00	0	0.041	0.0426	No	0	No
3/17/2023 13:01	0	0.041	0.0427	No	0	No
3/17/2023 13:02	0	0.042	0.0427	No	0	No
3/17/2023 13:03	0	0.036	0.0423	No	0	No
3/17/2023 13:04	0	0.036	0.0418	No	0	No
3/17/2023 13:05	0	0.038	0.0414	No	0	No
3/17/2023 13:06	0	0.035	0.0409	No	0	No
3/17/2023 13:07	0	0.037	0.0405	No	0	No
3/17/2023 13:08	0	0.038	0.0403	No	0	No
3/17/2023 13:09	0	0.04	0.0403	No	0	No
3/17/2023 13:10	0	0.042	0.0405	No	0	No
3/17/2023 13:11	0	0.044	0.0407	No	0	No
3/17/2023 13:12	0	0.042	0.0403	No	0	No
3/17/2023 13:13	0	0.044	0.0401	No	0	No
3/17/2023 13:14	0	0.039	0.0397	No	0	No
3/17/2023 13:15	0	0.039	0.0395	No	0	No
3/17/2023 13:16	0	0.039	0.0394	No	0	No
3/17/2023 13:17	0	0.041	0.0393	No	0	No
3/17/2023 13:18	0	0.041	0.0397	No	0	No
3/17/2023 13:19	0	0.042	0.0401	No	0	No
3/17/2023 13:20	0	0.041	0.0403	No	0	No
3/17/2023 13:21	0	0.039	0.0405	No	0	No
3/17/2023 13:22	0	0.037	0.0405	No	0	No
3/17/2023 13:23	0	0.037	0.0405	No	0	No
3/17/2023 13:24	0	0.038	0.0403	No	0	No
3/17/2023 13:25	0	0.04	0.0402	No	0	No

Upwind Station

Time	Instantaneous VOC (ppm)	Instantaneous Mass Conc. Total (mg/m ³)	Mass Conc. Total mg/m ³ AVG 15m (mg/m ³)	Dust Exceedance	VOC ppm AVG 15m (ppm)	VOC Exceedance
3/17/2023 13:26	0	0.04	0.0399	No	0	No
3/17/2023 13:27	0	0.046	0.0402	No	0	No
3/17/2023 13:28	0	0.042	0.0401	No	0	No
3/17/2023 13:29	0	0.042	0.0403	No	0	No
3/17/2023 13:30	0	0.041	0.0404	No	0	No
3/17/2023 13:31	0	0.045	0.0408	No	0	No
3/17/2023 13:32	0	0.035	0.0404	No	0	No
3/17/2023 13:33	0	0.035	0.04	No	0	No
3/17/2023 13:34	0	0.038	0.0397	No	0	No
3/17/2023 13:35	0	0.035	0.0393	No	0	No
3/17/2023 13:36	0	0.034	0.039	No	0	No
3/17/2023 13:37	0	0.034	0.0388	No	0	No
3/17/2023 13:38	0	0.035	0.0387	No	0	No
3/17/2023 13:39	0	0.035	0.0385	No	0	No
3/17/2023 13:40	0	0.033	0.038	No	0	No
3/17/2023 13:41	0	0.037	0.0378	No	0	No
3/17/2023 13:42	0	0.041	0.0375	No	0	No
3/17/2023 13:43	0	0.034	0.0369	No	0	No
3/17/2023 13:44	0	0.033	0.0363	No	0	No
3/17/2023 13:45	0	0.034	0.0359	No	0	No
3/17/2023 13:46	0	0.036	0.0353	No	0	No
3/17/2023 13:47	0	0.036	0.0353	No	0	No
3/17/2023 13:48	0	0.034	0.0353	No	0	No
3/17/2023 13:49	0	0.037	0.0352	No	0	No
3/17/2023 13:50	0	0.037	0.0353	No	0	No
3/17/2023 13:51	0	0.044	0.036	No	0	No
3/17/2023 13:52	0	0.043	0.0366	No	0	No
3/17/2023 13:53	0	0.038	0.0368	No	0	No
3/17/2023 13:54	0	0.036	0.0369	No	0	No
3/17/2023 13:55	0	0.037	0.0371	No	0	No
3/17/2023 13:56	0	0.036	0.0371	No	0	No
3/17/2023 13:57	0	0.036	0.0367	No	0	No
3/17/2023 13:58	0	0.036	0.0369	No	0	No
3/17/2023 13:59	0	0.038	0.0372	No	0	No
3/17/2023 14:00	0	0.035	0.0373	No	0	No
3/17/2023 14:01	0	0.038	0.0374	No	0	No
3/17/2023 14:02	0	0.038	0.0375	No	0	No
3/17/2023 14:03	0	0.04	0.0379	No	0	No
3/17/2023 14:04	0	0.046	0.0385	No	0	No
3/17/2023 14:05	0	0.058	0.0399	No	0	No
3/17/2023 14:06	0	0.051	0.0404	No	0	No
3/17/2023 14:07	0	0.05	0.0409	No	0	No
3/17/2023 14:08	0	0.049	0.0416	No	0	No
3/17/2023 14:09	0	0.062	0.0433	No	0	No
3/17/2023 14:10	0	0.06	0.0449	No	0	No
3/17/2023 14:11	0	0.048	0.0457	No	0	No
3/17/2023 14:12	0	0.048	0.0465	No	0	No
3/17/2023 14:13	0	0.053	0.0476	No	0	No
3/17/2023 14:14	0	0.051	0.0485	No	0	No
3/17/2023 14:15	0	0.058	0.05	No	0	No
3/17/2023 14:16	0.023	0.053	0.051	No	0.0015	No
3/17/2023 14:17	0	0.05	0.0518	No	0.0015	No

Upwind Station						
Time	Instaneous VOC (ppm)	Instaneous Mass Conc. Total (mg/m ³)	Mass Conc. Total mg/m ³ AVG 15m (mg/m ³)	Dust Exceedance	VOC ppm AVG 15m (ppm)	VOC Exceedance
3/17/2023 14:18	0	0.048	0.0523	No	0.0015	No
3/17/2023 14:19	0.002	0.047	0.0524	No	0.0017	No
3/17/2023 14:20	0	0.05	0.0519	No	0.0017	No
3/17/2023 14:21	0	0.05	0.0518	No	0.0017	No
3/17/2023 14:22	0	0.049	0.0517	No	0.0017	No
3/17/2023 14:23	0	0.049	0.0517	No	0.0017	No
3/17/2023 14:24	0	0.047	0.0507	No	0.0017	No
3/17/2023 14:25	0	0.05	0.0501	No	0.0017	No
3/17/2023 14:26	0	0.049	0.0501	No	0.0017	No
3/17/2023 14:27	0	0.051	0.0503	No	0.0017	No
3/17/2023 14:28	0	0.05	0.0501	No	0.0017	No
3/17/2023 14:29	0	0.051	0.0501	No	0.0017	No
3/17/2023 14:30	0	0.049	0.0495	No	0.0017	No
3/17/2023 14:31	0	0.049	0.0493	No	0.0001	No
3/17/2023 14:32	0	0.053	0.0495	No	0.0001	No
3/17/2023 14:33	0	0.048	0.0495	No	0.0001	No
3/17/2023 14:34	0	0.052	0.0498	No	0	No
3/17/2023 14:35	0	0.05	0.0498	No	0	No
3/17/2023 14:36	0	0.051	0.0499	No	0	No
3/17/2023 14:37	0	0.05	0.0499	No	0	No
3/17/2023 14:38	0	0.058	0.0505	No	0	No
3/17/2023 14:39	0	0.05	0.0507	No	0	No
3/17/2023 14:40	0	0.05	0.0507	No	0	No
3/17/2023 14:41	0	0.051	0.0509	No	0	No
3/17/2023 14:42	0	0.053	0.051	No	0	No
3/17/2023 14:43	0	0.051	0.0511	No	0	No
3/17/2023 14:44	0	0.049	0.0509	No	0	No
3/17/2023 14:45	0	0.05	0.051	No	0	No
3/17/2023 14:46	0	0.048	0.0509	No	0	No
3/17/2023 14:47	0.025	0.052	0.0509	No	0.0017	No
3/17/2023 14:48	0.021	0.057	0.0515	No	0.0031	
3/17/2023 14:49	0.001	0.06	0.052	No	0.0031	No
3/17/2023 14:50	0	0.053	0.0522	No	0.0031	No
3/17/2023 14:51	0	0.05	0.0521	No	0.0031	No
3/17/2023 14:52	0	0.047	0.0519	No	0.0031	No
3/17/2023 14:53	0	0.047	0.0512	No	0.0031	No
3/17/2023 14:54	0	0.053	0.0514	No	0.0031	No
3/17/2023 14:55	0	0.051	0.0515	No	0.0031	No
3/17/2023 14:56	0	0.05	0.0514	No	0.0031	No
3/17/2023 14:57	0	0.053	0.0514	No	0.0031	No
3/17/2023 14:58	0	0.05	0.0513	No	0.0031	No
3/17/2023 14:59	0	0.051	0.0515	No	0.0031	No
3/17/2023 15:00	0	0.053	0.0517	No	0.0031	No
3/17/2023 15:01	0	0.054	0.0521	No	0.0031	No
3/17/2023 15:02	0	0.074	0.0535	No	0.0015	No
3/17/2023 15:03	0	0.024	0.0289	No	-	Yes
3/17/2023 15:04	0	-	0.0292	No	-	Yes

Downwind Station						
Time	Instaneous VOC (ppm)	Instaneous Mass Conc. Total (mg/m ³)	Mass Conc. Total mg/m ³ AVG 15m (mg/m ³)	Dust Exceedance	VOC ppm AVG 15m (ppm)	VOC Exceedance
3/16/2023 7:06		0.071	0.071	No		No
3/16/2023 7:10		0.13	0.1005	No		No
3/16/2023 7:11		0.018	0.073	No		No
3/16/2023 7:12		0.034	0.0633	No		No
3/16/2023 7:13		0.024	0.0554	No		No
3/16/2023 7:14		0.023	0.05	No		No
3/16/2023 7:15		0.027	0.0467	No		No
3/16/2023 7:16		0.022	0.0436	No		No
3/16/2023 7:17		0.022	0.0412	No		No
3/16/2023 7:18		0.022	0.0393	No		No
3/16/2023 7:19		0.021	0.0376	No		No
3/16/2023 7:20		0.022	0.0363	No		No
3/16/2023 7:21		0.021	0.0322	No		No
3/16/2023 7:22		0.032	0.0322	No		No
3/16/2023 7:23		0.041	0.0328	No		No
3/16/2023 7:24		0.094	0.0369	No		No
3/16/2023 7:31	0	0.013	0.032	No	0	No
3/16/2023 7:32	0	0.015	0.0312	No	0	No
3/16/2023 7:33	0	0.018	0.0308	No	0	No
3/16/2023 7:34	0	0.018	0.0304	No	0	No
3/16/2023 7:35	0	0.017	0.0299	No	0	No
3/16/2023 7:36	0	0.016	0.0293	No	0	No
3/16/2023 7:37	0	0.013	0.0272	No	0	No
3/16/2023 7:38	0	0.012	0.024	No	0	No
3/16/2023 7:39	0	0.014	0.0151	No	0	No
3/16/2023 7:40	0	0.016	0.0152	No	0	No
3/16/2023 7:41	0	0.03	0.0165	No	0	No
3/16/2023 7:42	0	0.034	0.018	No	0	No
3/16/2023 7:43	0	0.025	0.0185	No	0	No
3/16/2023 7:44	0	0.023	0.0189	No	0	No
3/16/2023 7:45	0	0.016	0.0187	No	0	No
3/16/2023 7:46	0	0.031	0.0199	No	0	No
3/16/2023 7:47	0	0.025	0.0205	No	0	No
3/16/2023 7:48	0	0.02	0.0207	No	0	No
3/16/2023 7:49	0	0.022	0.0209	No	0	No
3/16/2023 7:50	0	0.019	0.0211	No	0	No
3/16/2023 7:51	0	0.021	0.0214	No	0	No
3/16/2023 7:52	0	0.017	0.0217	No	0	No
3/16/2023 7:53	0	0.014	0.0218	No	0	No
3/16/2023 7:54	0	0.014	0.0218	No	0	No
3/16/2023 7:55	0	0.018	0.0219	No	0	No
3/16/2023 7:56	0	0.021	0.0213	No	0	No
3/16/2023 7:57	0	0.027	0.0209	No	0	No
3/16/2023 7:58	0	0.045	0.0222	No	0	No
3/16/2023 7:59	0	0.027	0.0225	No	0	No
3/16/2023 8:00	0	0.027	0.0232	No	0	No
3/16/2023 8:01	0	0.029	0.0231	No	0	No
3/16/2023 8:02	0	0.038	0.0239	No	0	No
3/16/2023 8:03	0	0.019	0.0239	No	0	No
3/16/2023 8:04	0	0.02	0.0237	No	0	No
3/16/2023 8:05	0	0.026	0.0242	No	0	No
3/16/2023 8:06	0	0.02	0.0241	No	0	No
3/16/2023 8:07	0	0.022	0.0245	No	0	No
3/16/2023 8:08	0	0.017	0.0247	No	0	No

Downwind Station						
Time	Instaneous VOC (ppm)	Instaneous Mass Conc. Total (mg/m ³)	Mass Conc. Total mg/m ³ AVG 15m (mg/m ³)	Dust Exceedance	VOC ppm AVG 15m (ppm)	VOC Exceedance
3/16/2023 8:09	0	0.014	0.0247	No	0	No
3/16/2023 8:10	0	0.018	0.0247	No	0	No
3/16/2023 8:11	0	0.017	0.0244	No	0	No
3/16/2023 8:12	0	0.121	0.0307	No	0	No
3/16/2023 8:13	0	0.95	0.091	No	0	No
3/16/2023 8:14	0	0.438	0.1184	No	0	No
3/16/2023 8:15	0	0.708	0.1638	Yes	0	No
3/16/2023 8:16	0	0.458	0.1924	Yes	0	No
3/16/2023 8:17	0	0.06	0.1939	Yes	0	No
3/16/2023 8:18	0	0.027	0.1944	Yes	0	No
3/16/2023 8:19	0	0.013	0.1939	Yes	0	No
3/16/2023 8:20	0	0.01	0.1929	Yes	0	No
3/16/2023 8:21	0	0.009	0.1921	Yes	0	No
3/16/2023 8:22	0	0.011	0.1914	Yes	0	No
3/16/2023 8:23	0	0.012	0.1911	Yes	0	No
3/16/2023 8:24	0	0.011	0.1909	Yes	0	No
3/16/2023 8:25	0	0.01	0.1903	Yes	0	No
3/16/2023 8:26	0	0.009	0.1898	Yes	0	No
3/16/2023 8:27	0	0.009	0.1823	Yes	0	No
3/16/2023 8:28	0	0.01	0.1197	No	0	No
3/16/2023 8:29	0	0.009	0.0911	No	0	No
3/16/2023 8:30	0	0.01	0.0445	No	0	No
3/16/2023 8:31	0	0.012	0.0148	No	0	No
3/16/2023 8:32	0	0.011	0.0115	No	0	No
3/16/2023 8:33	0	0.012	0.0105	No	0	No
3/16/2023 8:34	0	0.013	0.0105	No	0	No
3/16/2023 8:35	0	0.011	0.0106	No	0	No
3/16/2023 8:36	0	0.01	0.0107	No	0	No
3/16/2023 8:37	0	0.011	0.0107	No	0	No
3/16/2023 8:38	0	0.011	0.0106	No	0	No
3/16/2023 8:39	0	0.02	0.0112	No	0	No
3/16/2023 8:40	0	0.011	0.0113	No	0	No
3/16/2023 8:41	0	0.011	0.0114	No	0	No
3/16/2023 8:42	0	0.013	0.0117	No	0	No
3/16/2023 8:43	0	0.016	0.0121	No	0	No
3/16/2023 8:44	0	0.013	0.0123	No	0	No
3/16/2023 8:45	0.043	0.01	0.0123	No	0.0029	No
3/16/2023 8:46	0	0.014	0.0125	No	0.0029	No
3/16/2023 8:47	0	0.014	0.0127	No	0.0029	No
3/16/2023 8:48	0.015	0.011	0.0126	No	0.0039	No
3/16/2023 8:49	0	0.009	0.0123	No	0.0039	No
3/16/2023 8:50	0	0.024	0.0132	No	0.0039	No
3/16/2023 8:51	0	0.018	0.0137	No	0.0039	No
3/16/2023 8:52	0	0.009	0.0136	No	0.0039	No
3/16/2023 8:53	0	0.009	0.0135	No	0.0039	No
3/16/2023 8:54	0	0.008	0.0127	No	0.0039	No
3/16/2023 8:55	0	0.008	0.0125	No	0.0039	No
3/16/2023 8:56	0	0.014	0.0127	No	0.0039	No
3/16/2023 8:57	0	0.009	0.0124	No	0.0039	No
3/16/2023 8:58	0	0.01	0.012	No	0.0039	No
3/16/2023 8:59	0	0.011	0.0119	No	0.0039	No
3/16/2023 9:00	0	0.012	0.012	No	0.001	No
3/16/2023 9:01	0	0.01	0.0117	No	0.001	No
3/16/2023 9:02	0	0.007	0.0113	No	0.001	No

Downwind Station						
Time	Instantaneous VOC (ppm)	Instantaneous Mass Conc. Total (mg/m ³)	Mass Conc. Total mg/m ³ AVG 15m (mg/m ³)	Dust Exceedance	VOC ppm AVG 15m (ppm)	VOC Exceedance
3/16/2023 9:03	0	0.008	0.0111	No	0	No
3/16/2023 9:04	0	0.008	0.011	No	0	No
3/16/2023 9:05	0	0.01	0.0101	No	0	No
3/16/2023 9:06	0	0.008	0.0094	No	0	No
3/16/2023 9:07	0	0.016	0.0099	No	0	No
3/16/2023 9:08	0	0.011	0.01	No	0	No
3/16/2023 9:09	0	0.01	0.0101	No	0	No
3/16/2023 9:10	0	0.011	0.0103	No	0	No
3/16/2023 9:11	0	0.018	0.0106	No	0	No
3/16/2023 9:12	0	0.011	0.0107	No	0	No
3/16/2023 9:13	0	0.01	0.0107	No	0	No
3/16/2023 9:14	0	0.01	0.0107	No	0	No
3/16/2023 9:15	0	0.009	0.0105	No	0	No
3/16/2023 9:16	0	0.011	0.0105	No	0	No
3/16/2023 9:17	0	0.008	0.0106	No	0	No
3/16/2023 9:18	0	0.01	0.0107	No	0	No
3/16/2023 9:19	0	0.01	0.0109	No	0	No
3/16/2023 9:20	0	0.009	0.0108	No	0	No
3/16/2023 9:21	0	0.008	0.0108	No	0	No
3/16/2023 9:22	0	0.009	0.0103	No	0	No
3/16/2023 9:23	0	0.008	0.0101	No	0	No
3/16/2023 9:24	0	0.01	0.0101	No	0	No
3/16/2023 9:25	0	0.007	0.0099	No	0	No
3/16/2023 9:26	0	0.009	0.0093	No	0	No
3/16/2023 9:27	0	0.012	0.0093	No	0	No
3/16/2023 9:28	0	0.013	0.0095	No	0	No
3/16/2023 9:29	0	0.011	0.0096	No	0	No
3/16/2023 9:30	0	0.01	0.0097	No	0	No
3/16/2023 9:31	0	0.009	0.0095	No	0	No
3/16/2023 9:32	0	0.01	0.0097	No	0	No
3/16/2023 9:33	0	0.008	0.0095	No	0	No
3/16/2023 9:34	0	0.009	0.0095	No	0	No
3/16/2023 9:35	0	0.032	0.011	No	0	No
3/16/2023 9:36	0	0.016	0.0115	No	0	No
3/16/2023 9:37	0	0.014	0.0119	No	0	No
3/16/2023 9:38	0	0.02	0.0127	No	0	No
3/16/2023 9:39	0	0.025	0.0137	No	0	No
3/16/2023 9:40	0	0.01	0.0139	No	0	No
3/16/2023 9:41	0	0.009	0.0139	No	0	No
3/16/2023 9:42	0	0.009	0.0137	No	0	No
3/16/2023 9:43	0	0.01	0.0135	No	0	No
3/16/2023 9:44	0	0.01	0.0134	No	0	No
3/16/2023 9:45	0	0.008	0.0133	No	0	No
3/16/2023 9:46	0	0.008	0.0132	No	0	No
3/16/2023 9:47	0	0.012	0.0133	No	0	No
3/16/2023 9:48	0	0.01	0.0135	No	0	No
3/16/2023 9:49	0	0.011	0.0136	No	0	No
3/16/2023 9:50	0	0.009	0.0121	No	0	No
3/16/2023 9:51	0	0.009	0.0116	No	0	No
3/16/2023 9:52	0	0.008	0.0112	No	0	No
3/16/2023 9:53	0	0.01	0.0105	No	0	No
3/16/2023 9:54	0	0.011	0.0096	No	0	No
3/16/2023 9:55	0	0.008	0.0095	No	0	No
3/16/2023 9:56	0	0.008	0.0094	No	0	No

Downwind Station						
Time	Instantaneous VOC (ppm)	Instantaneous Mass Conc. Total (mg/m ³)	Mass Conc. Total mg/m ³ AVG 15m (mg/m ³)	Dust Exceedance	VOC ppm AVG 15m (ppm)	VOC Exceedance
3/16/2023 9:57	0	0.01	0.0095	No	0	No
3/16/2023 9:58	0	0.037	0.0113	No	0	No
3/16/2023 9:59	0.013	0.02	0.0119	No	0.0009	No
3/16/2023 10:00	0	0.013	0.0123	No	0.0009	No
3/16/2023 10:01	0	0.012	0.0125	No	0.0009	No
3/16/2023 10:02	0	0.009	0.0123	No	0.0009	No
3/16/2023 10:03	0	0.008	0.0122	No	0.0009	No
3/16/2023 10:04	0	0.007	0.0119	No	0.0009	No
3/16/2023 10:05	0	0.008	0.0119	No	0.0009	No
3/16/2023 10:06	0	0.013	0.0121	No	0.0009	No
3/16/2023 10:07	0	0.012	0.0124	No	0.0009	No
3/16/2023 10:08	0	0.013	0.0126	No	0.0009	No
3/16/2023 10:09	0	0.009	0.0125	No	0.0009	No
3/16/2023 10:10	0	0.009	0.0125	No	0.0009	No
3/16/2023 10:11	0	0.008	0.0125	No	0.0009	No
3/16/2023 10:12	0	0.012	0.0127	No	0.0009	No
3/16/2023 10:13	0	0.009	0.0108	No	0.0009	No
3/16/2023 10:14	0	0.008	0.01	No	0	No
3/16/2023 10:15	0	0.025	0.0108	No	0	No
3/16/2023 10:16	0	0.029	0.0119	No	0	No
3/16/2023 10:17	0	0.026	0.0131	No	0	No
3/16/2023 10:18	0	0.058	0.0164	No	0	No
3/16/2023 10:19	0	0.022	0.0174	No	0	No
3/16/2023 10:20	0.003	0.014	0.0178	No	0.0002	No
3/16/2023 10:21	0.006	0.012	0.0177	No	0.0006	No
3/16/2023 10:22	0	0.011	0.0177	No	0.0006	No
3/16/2023 10:23	0	0.011	0.0175	No	0.0006	No
3/16/2023 10:24	0	0.012	0.0177	No	0.0006	No
3/16/2023 10:25	0	0.013	0.018	No	0.0006	No
3/16/2023 10:26	0	0.011	0.0182	No	0.0006	No
3/16/2023 10:27	0	0.011	0.0181	No	0.0006	No
3/16/2023 10:28	0	0.016	0.0186	No	0.0006	No
3/16/2023 10:29	0	0.017	0.0192	No	0.0006	No
3/16/2023 10:30	0	0.011	0.0183	No	0.0006	No
3/16/2023 10:31	0	0.012	0.0171	No	0.0006	No
3/16/2023 10:32	0	0.027	0.0172	No	0.0006	No
3/16/2023 10:33	0	0.024	0.0149	No	0.0006	No
3/16/2023 10:34	0	0.013	0.0143	No	0.0006	No
3/16/2023 10:35	0	0.021	0.0148	No	0.0004	No
3/16/2023 10:36	0	0.028	0.0159	No	0	No
3/16/2023 10:37	0	0.024	0.0167	No	0	No
3/16/2023 10:38	0	0.015	0.017	No	0	No
3/16/2023 10:39	0	0.017	0.0173	No	0	No
3/16/2023 10:40	0	0.022	0.0179	No	0	No
3/16/2023 10:41	0	0.016	0.0183	No	0	No
3/16/2023 10:42	0.001	0.013	0.0184	No	0.0001	No
3/16/2023 10:43	0.004	0.059	0.0213	No	0.0003	No
3/16/2023 10:44	0	0.639	0.0627	No	0.0003	No
3/16/2023 10:45	0	0.246	0.0784	No	0.0003	No
3/16/2023 10:46	0	0.015	0.0786	No	0.0003	No
3/16/2023 10:47	0	0.01	0.0775	No	0.0003	No
3/16/2023 10:48	0	0.012	0.0767	No	0.0003	No
3/16/2023 10:49	0	0.007	0.0763	No	0.0003	No
3/16/2023 10:50	0	0.006	0.0753	No	0.0003	No

Downwind Station						
Time	Instaneous VOC (ppm)	Instaneous Mass Conc. Total (mg/m ³)	Mass Conc. Total mg/m ³ AVG 15m (mg/m ³)	Dust Exceedance	VOC ppm AVG 15m (ppm)	VOC Exceedance
3/16/2023 10:51	0	0.007	0.0739	No	0.0003	No
3/16/2023 10:52	0	0.017	0.0734	No	0.0003	No
3/16/2023 10:53	0	0.007	0.0729	No	0.0003	No
3/16/2023 10:54	0	0.007	0.0722	No	0.0003	No
3/16/2023 10:55	0	0.008	0.0713	No	0.0003	No
3/16/2023 10:56	0	0.018	0.0714	No	0.0003	No
3/16/2023 10:57	0.012	0.017	0.0717	No	0.0011	No
3/16/2023 10:58	0.006	0.012	0.0685	No	0.0012	No
3/16/2023 10:59	0.02	0.01	0.0266	No	0.0025	No
3/16/2023 11:00	0	0.007	0.0107	No	0.0025	No
3/16/2023 11:01	0	0.008	0.0102	No	0.0025	No
3/16/2023 11:02	0	0.009	0.0101	No	0.0025	No
3/16/2023 11:03	0	0.012	0.0101	No	0.0025	No
3/16/2023 11:04	0	0.011	0.0104	No	0.0025	No
3/16/2023 11:05	0	0.01	0.0107	No	0.0025	No
3/16/2023 11:06	0	0.01	0.0109	No	0.0025	No
3/16/2023 11:07	0	0.021	0.0111	No	0.0025	No
3/16/2023 11:08	0	0.013	0.0115	No	0.0025	No
3/16/2023 11:09	0	0.01	0.0117	No	0.0025	No
3/16/2023 11:10	0	0.012	0.012	No	0.0025	No
3/16/2023 11:11	0.026	0.012	0.0116	No	0.0043	No
3/16/2023 11:12	0.33	0.029	0.0124	No	0.0255	No
3/16/2023 11:13	0.203	0.041	0.0143	No	0.0386	No
3/16/2023 11:14	0.205	0.042	0.0165	No	0.0509	No
3/16/2023 11:15	0.062	0.031	0.0181	No	0.0551	No
3/16/2023 11:16	0.01	0.012	0.0183	No	0.0557	No
3/16/2023 11:17	0	0.025	0.0194	No	0.0557	No
3/16/2023 11:18	0	0.01	0.0193	No	0.0557	No
3/16/2023 11:19	0.003	0.01	0.0192	No	0.0559	No
3/16/2023 11:20	0.008	0.014	0.0195	No	0.0565	No
3/16/2023 11:21	0	0.014	0.0197	No	0.0565	No
3/16/2023 11:22	0	0.008	0.0189	No	0.0565	No
3/16/2023 11:23	0	0.014	0.0189	No	0.0565	No
3/16/2023 11:24	0.088	0.016	0.0193	No	0.0623	No
3/16/2023 11:25	0.128	0.019	0.0198	No	0.0709	No
3/16/2023 11:26	0.138	0.018	0.0202	No	0.0783	No
3/16/2023 11:27	0.134	0.019	0.0195	No	0.0653	No
3/16/2023 11:28	0.035	0.014	0.0177	No	0.0541	No
3/16/2023 11:29	0.012	0.008	0.0155	No	0.0412	No
3/16/2023 11:30	0.009	0.01	0.0141	No	0.0377	No
3/16/2023 11:31	0	0.013	0.0141	No	0.037	No
3/16/2023 11:32	0	0.008	0.013	No	0.037	No
3/16/2023 11:33	0	0.014	0.0133	No	0.037	No
3/16/2023 11:34	0	0.011	0.0133	No	0.0368	No
3/16/2023 11:35	0	0.009	0.013	No	0.0363	No
3/16/2023 11:36	0.026	0.009	0.0127	No	0.038	No
3/16/2023 11:37	0.012	0.013	0.013	No	0.0388	No
3/16/2023 11:38	0.005	0.018	0.0133	No	0.0391	No
3/16/2023 11:39	0	0.01	0.0129	No	0.0333	No
3/16/2023 11:40	0	0.013	0.0125	No	0.0247	No
3/16/2023 11:41	0.004	0.018	0.0125	No	0.0158	No
3/16/2023 11:42	0.019	0.012	0.012	No	0.0081	No
3/16/2023 11:43	0.033	0.013	0.0119	No	0.008	No
3/16/2023 11:44	0.019	0.013	0.0123	No	0.0085	No

Downwind Station						
Time	Instaneous VOC (ppm)	Instaneous Mass Conc. Total (mg/m ³)	Mass Conc. Total mg/m ³ AVG 15m (mg/m ³)	Dust Exceedance	VOC ppm AVG 15m (ppm)	VOC Exceedance
3/16/2023 11:45	0	0.011	0.0123	No	0.0079	No
3/16/2023 11:46	0.004	0.011	0.0122	No	0.0081	No
3/16/2023 11:47	0	0.008	0.0122	No	0.0081	No
3/16/2023 11:48	0	0.012	0.0121	No	0.0081	No
3/16/2023 11:49	0	0.012	0.0121	No	0.0081	No
3/16/2023 11:50	0	0.009	0.0121	No	0.0081	No
3/16/2023 11:51	0.017	0.01	0.0122	No	0.0075	No
3/16/2023 11:52	0	0.012	0.0121	No	0.0067	No
3/16/2023 11:53	0	0.011	0.0117	No	0.0064	No
3/16/2023 11:54	0.033	0.018	0.0122	No	0.0086	No
3/16/2023 11:55	0	0.014	0.0123	No	0.0086	No
3/16/2023 11:56	0	0.057	0.0149	No	0.0083	No
3/16/2023 11:57	0.005	0.012	0.0149	No	0.0074	No
3/16/2023 11:58	0.014	0.012	0.0148	No	0.0061	No
3/16/2023 11:59	0.037	0.011	0.0147	No	0.0073	No
3/16/2023 12:00	0.01	0.014	0.0149	No	0.008	No
3/16/2023 12:01	0	0.012	0.0149	No	0.0077	No
3/16/2023 12:02	0	0.01	0.0151	No	0.0077	No
3/16/2023 12:03	0.038	0.012	0.0151	No	0.0103	No
3/16/2023 12:04	0	0.013	0.0151	No	0.0103	No
3/16/2023 12:05	0	0.014	0.0155	No	0.0103	No
3/16/2023 12:06	0.012	0.016	0.0159	No	0.0099	No
3/16/2023 12:07	0	0.017	0.0162	No	0.0099	No
3/16/2023 12:08	0	0.014	0.0164	No	0.0099	No
3/16/2023 12:09	0	0.012	0.016	No	0.0077	No
3/16/2023 12:10	0	0.013	0.0159	No	0.0077	No
3/16/2023 12:11	0	0.011	0.0129	No	0.0077	No
3/16/2023 12:12	0	0.01	0.0127	No	0.0074	No
3/16/2023 12:13	0	0.01	0.0126	No	0.0065	No
3/16/2023 12:14	0	0.01	0.0125	No	0.004	No
3/16/2023 12:15	0	0.012	0.0124	No	0.0033	No
3/16/2023 12:16	0	0.012	0.0124	No	0.0033	No
3/16/2023 12:17	0	0.012	0.0125	No	0.0033	No
3/16/2023 12:18	0.002	0.013	0.0126	No	0.0009	No
3/16/2023 12:19	0	0.013	0.0126	No	0.0009	No
3/16/2023 12:20	0	0.013	0.0125	No	0.0009	No
3/16/2023 12:21	0	0.015	0.0125	No	0.0001	No
3/16/2023 12:22	0	0.067	0.0158	No	0.0001	No
3/16/2023 12:23	0	0.028	0.0167	No	0.0001	No
3/16/2023 12:24	0	0.022	0.0174	No	0.0001	No
3/16/2023 12:25	0	0.021	0.0179	No	0.0001	No
3/16/2023 12:26	0	0.046	0.0203	No	0.0001	No
3/16/2023 12:27	0	0.021	0.021	No	0.0001	No
3/16/2023 12:28	0	0.026	0.0221	No	0.0001	No
3/16/2023 12:29	0	0.02	0.0227	No	0.0001	No
3/16/2023 12:30	0	0.019	0.0232	No	0.0001	No
3/16/2023 12:31	0	0.026	0.0241	No	0.0001	No
3/16/2023 12:32	0	0.019	0.0246	No	0.0001	No
3/16/2023 12:33	0	0.02	0.0251	No	0	No
3/16/2023 12:34	0	0.077	0.0293	No	0	No
3/16/2023 12:35	0	0.063	0.0327	No	0	No
3/16/2023 12:36	0	0.029	0.0336	No	0	No
3/16/2023 12:37	0	0.051	0.0325	No	0	No
3/16/2023 12:38	0	0.022	0.0321	No	0	No

Downwind Station						
Time	Instantaneous VOC (ppm)	Instantaneous Mass Conc. Total (mg/m ³)	Mass Conc. Total mg/m ³ AVG 15m (mg/m ³)	Dust Exceedance	VOC ppm AVG 15m (ppm)	VOC Exceedance
3/16/2023 12:39	0	0.027	0.0325	No	0	No
3/16/2023 12:40	0	0.023	0.0326	No	0	No
3/16/2023 12:41	0	0.024	0.0311	No	0	No
3/16/2023 12:42	0	0.032	0.0319	No	0	No
3/16/2023 12:43	0	0.028	0.032	No	0	No
3/16/2023 12:44	0	0.028	0.0325	No	0	No
3/16/2023 12:45	0	0.018	0.0325	No	0	No
3/16/2023 12:46	0	0.019	0.032	No	0	No
3/16/2023 12:47	0	0.026	0.0325	No	0	No
3/16/2023 12:48	0	0.016	0.0322	No	0	No
3/16/2023 12:49	0	0.015	0.0281	No	0	No
3/16/2023 12:50	0	0.017	0.025	No	0	No
3/16/2023 12:51	0.065	0.017	0.0242	No	0.0043	No
3/16/2023 12:52	0	0.018	0.022	No	0.0043	No
3/16/2023 12:53	0	0.019	0.0218	No	0.0043	No
3/16/2023 12:54	0	0.018	0.0212	No	0.0043	No
3/16/2023 12:55	0	0.021	0.0211	No	0.0043	No
3/16/2023 12:56	0	0.031	0.0215	No	0.0043	No
3/16/2023 12:57	0	0.023	0.0209	No	0.0043	No
3/16/2023 12:58	0	0.022	0.0205	No	0.0043	No
3/16/2023 12:59	0	0.021	0.0201	No	0.0043	No
3/16/2023 13:00	0	0.022	0.0203	No	0.0043	No
3/16/2023 13:01	0	0.021	0.0205	No	0.0043	No
3/16/2023 13:02	0	0.021	0.0201	No	0.0043	No
3/16/2023 13:03	0	0.024	0.0207	No	0.0043	No
3/16/2023 13:04	0	0.023	0.0212	No	0.0043	No
3/16/2023 13:05	0.167	0.123	0.0283	No	0.0155	No
3/16/2023 13:06	0.014	0.078	0.0323	No	0.0121	No
3/16/2023 13:07	0.003	0.022	0.0326	No	0.0123	No
3/16/2023 13:08	0.001	0.021	0.0327	No	0.0123	No
3/16/2023 13:09	0.021	0.022	0.033	No	0.0137	No
3/16/2023 13:10	0	0.018	0.0328	No	0.0137	No
3/16/2023 13:11	0	0.023	0.0323	No	0.0137	No
3/16/2023 13:12	0	0.038	0.0333	No	0.0137	No
3/16/2023 13:13	0	0.016	0.0329	No	0.0137	No
3/16/2023 13:14	0.007	0.025	0.0331	No	0.0142	No
3/16/2023 13:15	0	0.017	0.0328	No	0.0142	No
3/16/2023 13:16	0	0.016	0.0325	No	0.0142	No
3/16/2023 13:17	0	0.018	0.0323	No	0.0142	No
3/16/2023 13:18	0	0.017	0.0318	No	0.0142	No
3/16/2023 13:19	0	0.016	0.0313	No	0.0142	No
3/16/2023 13:20	0	0.016	0.0242	No	0.0031	No
3/16/2023 13:21	0	0.021	0.0204	No	0.0021	No
3/16/2023 13:22	0	0.019	0.0202	No	0.0019	No
3/16/2023 13:23	0	0.018	0.02	No	0.0019	No
3/16/2023 13:24	0	0.026	0.0203	No	0.0005	No
3/16/2023 13:25	0	0.018	0.0203	No	0.0005	No
3/16/2023 13:26	0	0.018	0.0199	No	0.0005	No
3/16/2023 13:27	0	0.02	0.0187	No	0.0005	No
3/16/2023 13:28	0	0.015	0.0187	No	0.0005	No
3/16/2023 13:29	0	0.014	0.0179	No	0	No
3/16/2023 13:30	0	0.018	0.018	No	0	No
3/16/2023 13:31	0	0.023	0.0185	No	0	No
3/16/2023 13:32	0	0.016	0.0183	No	0	No

Downwind Station						
Time	Instantaneous VOC (ppm)	Instantaneous Mass Conc. Total (mg/m ³)	Mass Conc. Total mg/m ³ AVG 15m (mg/m ³)	Dust Exceedance	VOC ppm AVG 15m (ppm)	VOC Exceedance
3/16/2023 13:33	0	0.015	0.0182	No	0	No
3/16/2023 13:34	0	0.015	0.0181	No	0	No
3/16/2023 13:35	0	0.02	0.0184	No	0	No
3/16/2023 13:36	0	0.02	0.0183	No	0	No
3/16/2023 13:37	0	0.02	0.0184	No	0	No
3/16/2023 13:38	0	0.015	0.0182	No	0	No
3/16/2023 13:39	0	0.135	0.0255	No	0	No
3/16/2023 13:40	0	0.018	0.0255	No	0	No
3/16/2023 13:41	0	0.021	0.0257	No	0	No
3/16/2023 13:42	0	0.015	0.0253	No	0	No
3/16/2023 13:43	0	0.018	0.0255	No	0	No
3/16/2023 13:44	0	0.017	0.0257	No	0	No
3/16/2023 13:45	0	0.017	0.0257	No	0	No
3/16/2023 13:46	0	0.015	0.0251	No	0	No
3/16/2023 13:47	0	0.016	0.0251	No	0	No
3/16/2023 13:48	0	0.025	0.0258	No	0	No
3/16/2023 13:49	0	0.022	0.0263	No	0	No
3/16/2023 13:50	0	0.019	0.0262	No	0	No
3/16/2023 13:51	0	0.019	0.0261	No	0	No
3/16/2023 13:52	0	0.017	0.0259	No	0	No
3/16/2023 13:53	0	0.016	0.026	No	0	No
3/16/2023 13:54	0	0.019	0.0183	No	0	No
3/16/2023 13:55	0.027	0.02	0.0184	No	0.0018	No
3/16/2023 13:56	0.008	0.019	0.0183	No	0.0023	No
3/16/2023 13:57	0	0.021	0.0187	No	0.0023	No
3/16/2023 13:58	0	0.022	0.0189	No	0.0023	No
3/16/2023 13:59	0.018	0.023	0.0193	No	0.0035	No
3/16/2023 14:00	0	0.022	0.0197	No	0.0035	No
3/16/2023 14:01	0	0.019	0.0199	No	0.0035	No
3/16/2023 14:02	0	0.02	0.0202	No	0.0035	No
3/16/2023 14:03	0	0.026	0.0203	No	0.0035	No
3/16/2023 14:04	0	0.025	0.0205	No	0.0035	No
3/16/2023 14:05	0	0.018	0.0204	No	0.0035	No
3/16/2023 14:06	0	0.018	0.0203	No	0.0035	No
3/16/2023 14:07	0	0.379	0.0445	No	0.0035	No
3/16/2023 14:08	0	0.427	0.0719	No	0.0035	No
3/16/2023 14:09	0	0.053	0.0741	No	0.0035	No
3/16/2023 14:10	0	1.403	0.1663	Yes	0.0017	No
3/16/2023 14:11	0	0.054	0.1687	Yes	0.0012	No
3/16/2023 14:12	0	0.094	0.1735	Yes	0.0012	No
3/16/2023 14:13	0	0.026	0.1738	Yes	0.0012	No
3/16/2023 14:14	0	0.023	0.1738	Yes	0	No
3/16/2023 14:15	0	0.021	0.1737	Yes	0	No
3/16/2023 14:16	0	0.02	0.1738	Yes	0	No
3/16/2023 14:17	0	0.024	0.1741	Yes	0	No
3/16/2023 14:18	0.014	0.028	0.1742	Yes	0.0009	No
3/16/2023 14:19	0	0.021	0.1739	Yes	0.0009	No
3/16/2023 14:20	0	0.02	0.1741	Yes	0.0009	No
3/16/2023 14:21	0	0.024	0.1745	Yes	0.0009	No
3/16/2023 14:22	0	0.022	0.1507	Yes	0.0009	No
3/16/2023 14:23	0	0.021	0.1236	No	0.0009	No
3/16/2023 14:24	0	0.027	0.1219	No	0.0009	No
3/16/2023 14:25	0	0.026	0.0301	No	0.0009	No
3/16/2023 14:26	0	0.031	0.0285	No	0.0009	No

Downwind Station						
Time	Instaneous VOC (ppm)	Instaneous Mass Conc. Total (mg/m ³)	Mass Conc. Total mg/m ³ AVG 15m (mg/m ³)	Dust Exceedance	VOC ppm AVG 15m (ppm)	VOC Exceedance
3/16/2023 14:27	0	0.047	0.0254	No	0.0009	No
3/16/2023 14:28	0.009	0.027	0.0255	No	0.0015	No
3/16/2023 14:29	0	0.024	0.0255	No	0.0015	No
3/16/2023 14:30	0	0.024	0.0257	No	0.0015	No
3/16/2023 14:31	0.024	0.031	0.0265	No	0.0031	No
3/16/2023 14:32	0	0.027	0.0267	No	0.0031	No
3/16/2023 14:33	0.002	0.023	0.0263	No	0.0023	No
3/16/2023 14:34	0.004	0.025	0.0266	No	0.0026	No
3/16/2023 14:35	0	0.025	0.0269	No	0.0026	No
3/16/2023 14:36	0	0.024	0.0269	No	0.0026	No
3/16/2023 14:37	0	0.023	0.027	No	0.0026	No
3/16/2023 14:38	0.13	0.024	0.0272	No	0.0113	No
3/16/2023 14:39	0.088	0.025	0.0271	No	0.0171	No
3/16/2023 14:40	0.017	0.027	0.0271	No	0.0183	No
3/16/2023 14:41	0.004	0.027	0.0269	No	0.0185	No
3/16/2023 14:42	0	0.025	0.0254	No	0.0185	No
3/16/2023 14:43	0	0.027	0.0254	No	0.0179	No
3/16/2023 14:44	0.075	0.025	0.0255	No	0.0229	No
3/16/2023 14:45	0.154	0.029	0.0258	No	0.0332	No
3/16/2023 14:46	0.079	0.031	0.0258	No	0.0369	No
3/16/2023 14:47	0	0.024	0.0256	No	0.0369	No
3/16/2023 14:48	0	0.021	0.0255	No	0.0367	No
3/16/2023 14:49	0	0.024	0.0254	No	0.0365	No
3/16/2023 14:50	0	0.022	0.0252	No	0.0365	No
3/16/2023 14:51	0.032	0.026	0.0253	No	0.0386	No
3/16/2023 14:52	0	0.025	0.0255	No	0.0386	No
3/16/2023 14:53	0.028	0.026	0.0256	No	0.0318	No
3/16/2023 14:54	0.014	0.025	0.0256	No	0.0269	No
3/16/2023 14:55	0.011	0.027	0.0256	No	0.0265	No
3/16/2023 14:56	0	0.024	0.0254	No	0.0262	No
3/16/2023 14:57	0	0.023	0.0253	No	0.0262	No
3/16/2023 14:58	0	0.025	0.0251	No	0.0262	No
3/16/2023 14:59	0	0.02	0.0248	No	0.0212	No
3/16/2023 15:00	0	0.021	0.0243	No	0.0109	No
3/16/2023 15:01	0.016	0.025	0.0239	No	0.0067	No
3/16/2023 15:02	0	0.023	0.0238	No	0.0067	No
3/16/2023 15:03	0	0.024	0.024	No	0.0067	No
3/16/2023 15:04	0.145	0.033	0.0246	No	0.0164	No
3/16/2023 15:05	0	0.03	0.0251	No	0.0164	No
3/16/2023 15:06	0	0.024	0.025	No	0.0143	No
3/16/2023 15:07	0.003	0.029	0.0253	No	0.0145	No
3/16/2023 15:08	0	0.025	0.0252	No	0.0126	No
3/16/2023 15:09	0	0.026	0.0253	No	0.0117	No
3/16/2023 15:10	0.004	0.027	0.0253	No	0.0112	No
3/16/2023 15:11	0	0.038	0.0262	No	0.0112	No
3/16/2023 15:12	0	0.029	0.0266	No	0.0112	No
3/16/2023 15:13	0.023	0.061	0.029	No	0.0127	No
3/16/2023 15:14	0.018	0.068	0.0322	No	0.0139	No
3/16/2023 15:15	0	0.071	0.0355	No	0.0139	No
3/16/2023 15:16	0	0.034	0.0361	No	0.0129	No
3/16/2023 15:17	0.024	0.072	0.0394	No	0.0145	No
3/16/2023 15:18	0	0.048	0.041	No	0.0145	No

Downwind Station						
Time	Instantaneous VOC (ppm)	Instantaneous Mass Conc. Total (mg/m ³)	Mass Conc. Total mg/m ³ AVG 15m (mg/m ³)	Dust Exceedance	VOC ppm AVG 15m (ppm)	VOC Exceedance
3/16/2023 15:19	0	0.038	0.0413	No	0.0048	No
3/16/2023 15:20	0	0.037	0.0418	No	0.0048	No
3/16/2023 15:21	0.038	0.081	0.0456	No	0.0073	No
3/16/2023 15:22	0.007	0.044	0.0466	No	0.0076	No
3/16/2023 15:23	0	0.032	0.0471	No	0.0076	No
3/16/2023 15:24	0	0.032	0.0475	No	0.0076	No
3/16/2023 15:25	0	0.038	0.0482	No	0.0073	No
3/16/2023 15:26	0	0.029	0.0476	No	0.0073	No
3/16/2023 15:27	0.076	0.032	0.0478	No	0.0124	No
3/16/2023 15:28	0	0.046	0.0468	No	0.0109	No
3/16/2023 15:29	0	0.035	0.0446	No	0.0097	No
3/16/2023 15:30	0	0.043	0.0427	No	0.0097	No
3/16/2023 15:31	0	0.027	0.0423	No	0.0097	No
3/16/2023 15:32	0	0.035	0.0398	No	0.0081	No
3/16/2023 15:33	0	0.029	0.0385	No	0.0081	No
3/16/2023 15:34	0	0.026	0.0377	No	0.0081	No
3/16/2023 15:35	0	0.03	0.0373	No	0.0081	No
3/16/2023 15:36	0	0.036	0.0343	No	0.0055	No
3/16/2023 15:37	0	0.032	0.0335	No	0.0051	No
3/16/2023 15:38	0	0.026	0.0331	No	0.0051	No
3/16/2023 15:39	0	0.025	0.0326	No	0.0051	No
3/16/2023 15:40	0	0.028	0.0319	No	0.0051	No
3/16/2023 15:41	0	0.024	0.0316	No	0.0051	No
3/16/2023 15:42	0	0.031	0.0315	No	0	No
3/16/2023 15:43	0	0.047	0.0316	No	0	No
3/16/2023 15:44	0	0.025	0.0309	No	0	No
3/16/2023 15:45	0	0.021	0.0295	No	0	No
3/16/2023 15:46	0	0.022	0.0291	No	0	No
3/16/2023 15:47	0	0.024	0.0284	No	0	No
3/16/2023 15:48	0	0.02	0.0278	No	0	No
3/16/2023 15:49	0	0.023	0.0276	No	0	No
3/16/2023 15:50	0	0.023	0.0271	No	0	No
3/16/2023 15:51	0	0.02	0.0261	No	0	No
3/16/2023 15:52	0	0.02	0.0253	No	0	No
3/16/2023 15:53	0	0.023	0.0251	No	0	No
3/16/2023 15:54	0	0.022	0.0249	No	0	No
3/16/2023 15:55	0	0.025	0.0247	No	0	No
3/16/2023 15:56	0	0.025	0.0247	No	0	No
3/16/2023 15:57	0	0.023	0.0242	No	0	No
3/16/2023 15:58	0	0.038	0.0236	No	0	No
3/16/2023 15:59	0	0.05	0.0253	No	0	No
3/16/2023 16:00	0	0.025	0.0255	No	0	No
3/16/2023 16:01	0	0.021	0.0255	No	0	No