



Daily Activity Report

Seton Brilla Charter School
1956 Jerome Avenue, Bronx, NY
BCP No. C203152

General Site Information

Date:	Wednesday, March 15, 2023
Weather:	Sunny, 35°F
Wind Direction/Speed:	N @ 6 mph
AKRF Personnel on Site:	J. Kelleher-Ferguson
AKRF Equipment on Site:	Mini RAE 3000 Photoionization Detector [(PID) x1], 2 Fixed Air Monitoring Stations [DustTrak
Visitors:	None.

Contractor Information

Contracting Company	Main Personnel	Equipment
Casino Construction	Carlos	Excavator

Description and Location of Work Activities Performed

- 1) Two truckloads of soil/fill from grid WC-03 were sent for off-site disposal at the Clean Earth -Cartert facility in Carteret, NJ.
- 2) Pile cap construction activities continued.

Destination Facility	Daily Trucks	Total Trucks	Daily Approx. Cubic Yds	Total Approx. Cubic Yds	Total Site Loads	Total Approximate Cubic Yards
Clean Earth Carteret	2	75	40	1,500	168	3,360
Clean Earth Southeastern Pennsylvania	0	67	0	1,340		
Concrete Disposal	0	26	0	520		
N/A	0	0	0	0		
N/A	0	0	0	0		

CAMP Air Monitoring Results

CAMP Station	UPWIND				DOWNWIND		
Odors:	None.				None.		
VOC Action Level Exceedance(s):	None.				None.		
Particulate Action Level Exceedance(s):	None.				None.		
Maximum VOC Level (15 min ppm):	0.000				0.0021		
Maximum Particulate Level (15 min mg/m ³):	0.133				0.0187		

Notes: CAMP monitoring was performed throughout the day. No exceedances were reported.

Additional Information

Planned Work Activity for Following Day/Week:	1) Excavation of soil/fill to uncover piles. 2) Cutting piles to final elevations
Comments:	None.

Site Map

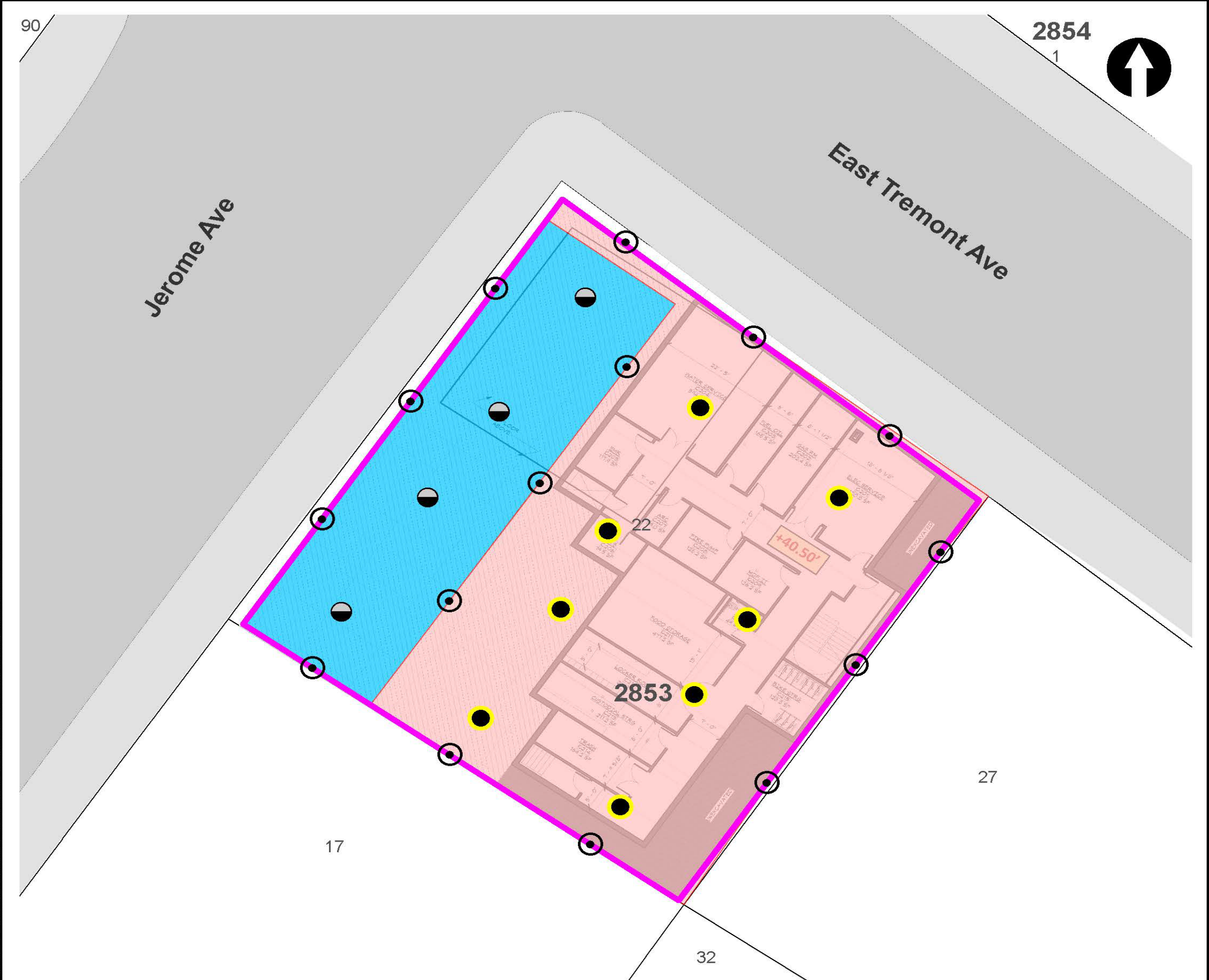

LEGEND

- PROJECT SITE BOUNDARY
- LOT BOUNDARY AND TAX LOT NUMBER
- 2853** BLOCK NUMBER
- REMEDIAL EXCAVATION TO APPROXIMATELY TWO FEET BELOW EXISTING GRADE
- REMEDIAL EXCAVATION TO GROUNDWATER (SOURCE AREA)

- CONFIRMATION DOCUMENTATION BOTTOM SAMPLE
- SOURCE AREA DOCUMENTATION BOTTOM SAMPLE
- DOCUMENTATION SIDEWALL SAMPLE

NOTE
 REMEDIAL EXCAVATION WILL INCLUDE REMOVAL OF APPROXIMATELY 1,280 TONS (850 CUBIC YARDS) OF SOURCE MATERIAL ASSOCIATED WITH NYSDEC SPILL NO. 2103719 AND APPROXIMATELY 860 TONS (570 CUBIC YARDS) OF SOIL/FILL FROM THE UPPER 2 FEET SITE-WIDE.



Map Source:
 NYCDP (NYC Dept. of City Planning) GIS database

© 2021 AKRF. W:\Projects\210024 - 1956 JEROME AVENUE\Technical\GIS and Graphics\AR\RAW\210024 Figure 9 Proposed Remedial Excavation and Documentation Sample Location Plan.mxd 10/25/2021 2:03:38 PM iszalus



440 Park Avenue South, New York, NY 10016

1956 Jerome Avenue
 Bronx, New York

**TRACK 4 CLEANUP AND DOCUMENTATION
 SAMPLE LOCATION PLAN**

DATE
04/29/2022

PROJECT NO.
210024

FIGURE
11

Site Photographs

Photograph 1 - Loading a truck for soil disposal off site, view facing east.



Photograph 2- Grading soil/fill around pile cap, view facing southeast.



Photograph 3- Stockpile of fill material covered with polyethylene sheeting, view facing east.



Upwind Station						
Time	Instaneous VOC (ppm)	Instaneous Mass Conc. Total (mg/m ³)	Mass Conc. Total mg/m ³ AVG 15m (mg/m ³)	Dust Exceedance	VOC ppm AVG 15m (ppm)	VOC Exceedance
3/15/2023 8:27	0			No	0	No
3/15/2023 8:28	0	0.003	0.003	No	0	No
3/15/2023 8:29	0	0.004	0.0035	No	0	No
3/15/2023 8:30	0	0.004	0.0037	No	0	No
3/15/2023 8:31	0	0.005	0.004	No	0	No
3/15/2023 8:32	0	0.004	0.004	No	0	No
3/15/2023 8:33	0	0.004	0.004	No	0	No
3/15/2023 8:34	0	0.004	0.004	No	0	No
3/15/2023 8:35	0	0.005	0.0041	No	0	No
3/15/2023 8:36	0	0.005	0.0042	No	0	No
3/15/2023 8:37	0	0.004	0.0042	No	0	No
3/15/2023 8:38	0	0.006	0.0044	No	0	No
3/15/2023 8:39	0	0.004	0.0043	No	0	No
3/15/2023 8:40	0	0.004	0.0043	No	0	No
3/15/2023 8:41	0	0.004	0.0043	No	0	No
3/15/2023 8:42	0	0.004	0.0043	No	0	No
3/15/2023 8:43	0	0.004	0.0043	No	0	No
3/15/2023 8:44	0	0.005	0.0044	No	0	No
3/15/2023 8:45	0	0.028	0.006	No	0	No
3/15/2023 8:46	0	0.008	0.0062	No	0	No
3/15/2023 8:47	0	0.005	0.0063	No	0	No
3/15/2023 8:48	0	0.003	0.0062	No	0	No
3/15/2023 8:49	0	0.004	0.0062	No	0	No
3/15/2023 8:50	0	0.007	0.0063	No	0	No
3/15/2023 8:51	0	0.005	0.0063	No	0	No
3/15/2023 8:52	0	0.006	0.0065	No	0	No
3/15/2023 8:53	0	0.006	0.0065	No	0	No
3/15/2023 8:54	0	0.005	0.0065	No	0	No
3/15/2023 8:55	0	0.004	0.0065	No	0	No
3/15/2023 8:56	0	0.004	0.0065	No	0	No
3/15/2023 8:57	0	0.005	0.0066	No	0	No
3/15/2023 8:58	0	0.005	0.0067	No	0	No
3/15/2023 8:59	0	0.005	0.0067	No	0	No
3/15/2023 9:00	0	0.005	0.0051	No	0	No
3/15/2023 9:01	0	0.004	0.0049	No	0	No
3/15/2023 9:02	0	0.006	0.0049	No	0	No
3/15/2023 9:03	0	0.005	0.0051	No	0	No
3/15/2023 9:04	0	0.005	0.0051	No	0	No
3/15/2023 9:05	0	0.005	0.005	No	0	No
3/15/2023 9:06	0	0.005	0.005	No	0	No
3/15/2023 9:07	0	0.005	0.0049	No	0	No
3/15/2023 9:08	0	0.006	0.0049	No	0	No
3/15/2023 9:09	0	0.005	0.0049	No	0	No
3/15/2023 9:10	0	0.013	0.0055	No	0	No
3/15/2023 9:11	0	0.004	0.0055	No	0	No
3/15/2023 9:12	0	0.004	0.0055	No	0	No
3/15/2023 9:13	0	0.004	0.0054	No	0	No
3/15/2023 9:14	0	0.004	0.0053	No	0	No
3/15/2023 9:15	0	0.005	0.0053	No	0	No
3/15/2023 9:16	0	0.003	0.0053	No	0	No
3/15/2023 9:17	0	0.005	0.0052	No	0	No
3/15/2023 9:18	0	0.003	0.0051	No	0	No

Upwind Station						
Time	Instaneous VOC (ppm)	Instaneous Mass Conc. Total (mg/m ³)	Mass Conc. Total mg/m ³ AVG 15m (mg/m ³)	Dust Exceedance	VOC ppm AVG 15m (ppm)	VOC Exceedance
3/15/2023 9:19	0	0.005	0.0051	No	0	No
3/15/2023 9:20	0	0.005	0.0051	No	0	No
3/15/2023 9:21	0	0.006	0.0051	No	0	No
3/15/2023 9:22	0	0.005	0.0051	No	0	No
3/15/2023 9:23	0	0.005	0.0051	No	0	No
3/15/2023 9:24	0	0.004	0.005	No	0	No
3/15/2023 9:25	0	0.005	0.0045	No	0	No
3/15/2023 9:26	0	0.006	0.0046	No	0	No
3/15/2023 9:27	0	0.005	0.0047	No	0	No
3/15/2023 9:28	0	0.005	0.0047	No	0	No
3/15/2023 9:29	0	0.004	0.0047	No	0	No
3/15/2023 9:30	0	0.004	0.0047	No	0	No
3/15/2023 9:31	0	0.006	0.0049	No	0	No
3/15/2023 9:32	0	0.006	0.0049	No	0	No
3/15/2023 9:33	0	0.006	0.0051	No	0	No
3/15/2023 9:34	0	0.008	0.0053	No	0	No
3/15/2023 9:35	0	0.006	0.0054	No	0	No
3/15/2023 9:36	0	0.01	0.0057	No	0	No
3/15/2023 9:37	0	0.015	0.0063	No	0	No
3/15/2023 9:38	0	0.006	0.0064	No	0	No
3/15/2023 9:39	0	0.004	0.0064	No	0	No
3/15/2023 9:40	0	0.004	0.0063	No	0	No
3/15/2023 9:41	0	0.004	0.0062	No	0	No
3/15/2023 9:42	0	0.004	0.0061	No	0	No
3/15/2023 9:43	0	0.005	0.0061	No	0	No
3/15/2023 9:44	0	0.008	0.0064	No	0	No
3/15/2023 9:45	0	0.004	0.0064	No	0	No
3/15/2023 9:46	0	0.004	0.0063	No	0	No
3/15/2023 9:47	0	0.006	0.0063	No	0	No
3/15/2023 9:48	0	0.005	0.0062	No	0	No
3/15/2023 9:49	0	0.005	0.006	No	0	No
3/15/2023 9:50	0	0.005	0.0059	No	0	No
3/15/2023 9:51	0	0.006	0.0057	No	0	No
3/15/2023 9:52	0	0.005	0.005	No	0	No
3/15/2023 9:53	0	0.005	0.0049	No	0	No
3/15/2023 9:54	0	0.009	0.0053	No	0	No
3/15/2023 9:55	0	0.005	0.0053	No	0	No
3/15/2023 9:56	0	0.005	0.0054	No	0	No
3/15/2023 9:57	0	0.004	0.0054	No	0	No
3/15/2023 9:58	0	0.011	0.0058	No	0	No
3/15/2023 9:59	0	0.003	0.0055	No	0	No
3/15/2023 10:00	0	0.004	0.0055	No	0	No
3/15/2023 10:01	0	0.003	0.0054	No	0	No
3/15/2023 10:02	0	0.003	0.0052	No	0	No
3/15/2023 10:03	0	0.004	0.0051	No	0	No
3/15/2023 10:04	0	0.003	0.005	No	0	No
3/15/2023 10:05	0	0.003	0.0049	No	0	No
3/15/2023 10:06	0	0.006	0.0049	No	0	No
3/15/2023 10:07	0	0.005	0.0049	No	0	No
3/15/2023 10:08	0	0.021	0.0059	No	0	No
3/15/2023 10:09	0	0.005	0.0057	No	0	No
3/15/2023 10:10	0	0.009	0.0059	No	0	No

Upwind Station						
Time	Instaneous VOC (ppm)	Instaneous Mass Conc. Total (mg/m ³)	Mass Conc. Total mg/m ³ AVG 15m (mg/m ³)	Dust Exceedance	VOC ppm AVG 15m (ppm)	VOC Exceedance
3/15/2023 10:11	0	0.009	0.0062	No	0	No
3/15/2023 10:12	0	0.006	0.0063	No	0	No
3/15/2023 10:13	0	0.006	0.006	No	0	No
3/15/2023 10:14	0	0.005	0.0061	No	0	No
3/15/2023 10:15	0	0.005	0.0062	No	0	No
3/15/2023 10:16	0	0.005	0.0063	No	0	No
3/15/2023 10:17	0	0.005	0.0065	No	0	No
3/15/2023 10:18	0	0.005	0.0065	No	0	No
3/15/2023 10:19	0	0.004	0.0066	No	0	No
3/15/2023 10:20	0	0.005	0.0067	No	0	No
3/15/2023 10:21	0	0.004	0.0066	No	0	No
3/15/2023 10:22	0	0.004	0.0065	No	0	No
3/15/2023 10:23	0	0.004	0.0054	No	0	No
3/15/2023 10:24	0	0.004	0.0053	No	0	No
3/15/2023 10:25	0	0.004	0.005	No	0	No
3/15/2023 10:26	0	0.006	0.0048	No	0	No
3/15/2023 10:27	0	0.004	0.0047	No	0	No
3/15/2023 10:28	0	0.006	0.0047	No	0	No
3/15/2023 10:29	0	0.004	0.0046	No	0	No
3/15/2023 10:30	0	0.005	0.0046	No	0	No
3/15/2023 10:31	0	0.008	0.0048	No	0	No
3/15/2023 10:32	0	0.004	0.0047	No	0	No
3/15/2023 10:33	0	0.005	0.0047	No	0	No
3/15/2023 10:34	0	0.007	0.0049	No	0	No
3/15/2023 10:35	0	0.004	0.0049	No	0	No
3/15/2023 10:36	0	0.116	0.0123	No	0	No
3/15/2023 10:37	0	0.433	0.0409	No	0	No
3/15/2023 10:38	0	0.003	0.0409	No	0	No
3/15/2023 10:39	0	0.004	0.0409	No	0	No
3/15/2023 10:40	0	0.016	0.0417	No	0	No
3/15/2023 10:41	0	0.001	0.0413	No	0	No
3/15/2023 10:42	0	0.003	0.0413	No	0	No
3/15/2023 10:43	0	0.003	0.0411	No	0	No
3/15/2023 10:44	0	0.003	0.041	No	0	No
3/15/2023 10:45	0	0.005	0.041	No	0	No
3/15/2023 10:46	0	0.003	0.0407	No	0	No
3/15/2023 10:47	0	0.004	0.0407	No	0	No
3/15/2023 10:48	0	0.005	0.0407	No	0	No
3/15/2023 10:49	0	0.004	0.0405	No	0	No
3/15/2023 10:50	0	0.006	0.0406	No	0	No
3/15/2023 10:51	0	0.011	0.0336	No	0	No
3/15/2023 10:52	0	0.007	0.0052	No	0	No
3/15/2023 10:53	0	0.005	0.0053	No	0	No
3/15/2023 10:54	0	0.003	0.0053	No	0	No
3/15/2023 10:55	0	0.004	0.0045	No	0	No
3/15/2023 10:56	0	0.003	0.0046	No	0	No
3/15/2023 10:57	0	0.003	0.0046	No	0	No
3/15/2023 10:58	0	0.004	0.0047	No	0	No
3/15/2023 10:59	0	0.061	0.0085	No	0	No
3/15/2023 11:00	0	0.003	0.0084	No	0	No
3/15/2023 11:01	0	0.004	0.0085	No	0	No
3/15/2023 11:02	0	0.006	0.0086	No	0	No

Upwind Station						
Time	Instaneous VOC (ppm)	Instaneous Mass Conc. Total (mg/m³)	Mass Conc. Total mg/m³ AVG 15m (mg/m³)	Dust Exceedance	VOC ppm AVG 15m (ppm)	VOC Exceedance
3/15/2023 11:03	0	0.004	0.0085	No	0	No
3/15/2023 11:04	0	0.007	0.0087	No	0	No
3/15/2023 11:05	0	0.007	0.0088	No	0	No
3/15/2023 11:06	0	0.005	0.0084	No	0	No
3/15/2023 11:07	0	0.005	0.0083	No	0	No
3/15/2023 11:08	0	0.004	0.0082	No	0	No
3/15/2023 11:09	0	0.004	0.0083	No	0	No
3/15/2023 11:10	0	0.004	0.0083	No	0	No
3/15/2023 11:11	0	0.003	0.0083	No	0	No
3/15/2023 11:12	0	0.004	0.0083	No	0	No
3/15/2023 11:13	0	0.003	0.0083	No	0	No
3/15/2023 11:14	0	0.005	0.0045	No	0	No
3/15/2023 11:15	0	0.004	0.0046	No	0	No
3/15/2023 11:16	0	0.003	0.0045	No	0	No
3/15/2023 11:17	0	0.003	0.0043	No	0	No
3/15/2023 11:18	0	0.004	0.0043	No	0	No
3/15/2023 11:19	0	0.005	0.0042	No	0	No
3/15/2023 11:20	0	0.005	0.0041	No	0	No
3/15/2023 11:21	0	0.004	0.004	No	0	No
3/15/2023 11:22	0	0.004	0.0039	No	0	No
3/15/2023 11:23	0	0.005	0.004	No	0	No
3/15/2023 11:24	0	0.004	0.004	No	0	No
3/15/2023 11:25	0	0.004	0.004	No	0	No
3/15/2023 11:26	0	0.004	0.0041	No	0	No
3/15/2023 11:27	0	0.004	0.0041	No	0	No
3/15/2023 11:28	0	0.004	0.0041	No	0	No
3/15/2023 11:29	0	0.004	0.0041	No	0	No
3/15/2023 11:30	0	0.005	0.0041	No	0	No
3/15/2023 11:31	0	0.007	0.0044	No	0	No
3/15/2023 11:32	0	0.006	0.0046	No	0	No
3/15/2023 11:33	0	0.006	0.0047	No	0	No
3/15/2023 11:34	0	0.006	0.0048	No	0	No
3/15/2023 11:35	0	0.005	0.0048	No	0	No
3/15/2023 11:36	0	0.004	0.0048	No	0	No
3/15/2023 11:37	0	0.004	0.0048	No	0	No
3/15/2023 11:38	0	0.005	0.0048	No	0	No
3/15/2023 11:39	0	0.007	0.005	No	0	No
3/15/2023 11:40	0	0.01	0.0054	No	0	No
3/15/2023 11:41	0	0.008	0.0057	No	0	No
3/15/2023 11:42	0	0.013	0.0063	No	0	No
3/15/2023 11:43	0	0.007	0.0065	No	0	No
3/15/2023 11:44	0	0.005	0.0065	No	0	No
3/15/2023 11:45	0	0.004	0.0065	No	0	No
3/15/2023 11:46	0	0.005	0.0063	No	0	No
3/15/2023 11:47	0	0.004	0.0062	No	0	No
3/15/2023 11:48	0	0.005	0.0061	No	0	No
3/15/2023 11:49	0	0.005	0.0061	No	0	No
3/15/2023 11:50	0	0.004	0.006	No	0	No
3/15/2023 11:51	0	0.004	0.006	No	0	No
3/15/2023 11:52	0	0.004	0.006	No	0	No
3/15/2023 11:53	0	0.006	0.0061	No	0	No
3/15/2023 11:54	0	0.006	0.006	No	0	No

Upwind Station						
Time	Instaneous VOC (ppm)	Instaneous Mass Conc. Total (mg/m ³)	Mass Conc. Total mg/m ³ AVG 15m (mg/m ³)	Dust Exceedance	VOC ppm AVG 15m (ppm)	VOC Exceedance
3/15/2023 11:55	0	0.004	0.0056	No	0	No
3/15/2023 11:56	0	0.006	0.0055	No	0	No
3/15/2023 11:57	0	0.005	0.0049	No	0	No
3/15/2023 11:58	0	0.006	0.0049	No	0	No
3/15/2023 11:59	0	0.008	0.0051	No	0	No
3/15/2023 12:00	0	0.003	0.005	No	0	No
3/15/2023 12:01	0	0.002	0.0048	No	0	No
3/15/2023 12:02	0	0.032	0.0067	No	0	No
3/15/2023 12:03	0	0.005	0.0067	No	0	No
3/15/2023 12:04	0	0.004	0.0066	No	0	No
3/15/2023 12:05	0	0.003	0.0065	No	0	No
3/15/2023 12:06	0	0.003	0.0065	No	0	No
3/15/2023 12:07	0	0.009	0.0068	No	0	No
3/15/2023 12:08	0	0.005	0.0067	No	0	No
3/15/2023 12:09	0	0.005	0.0067	No	0	No
3/15/2023 12:10	0	0.013	0.0073	No	0	No
3/15/2023 12:11	0	0.004	0.0071	No	0	No
3/15/2023 12:12	0	0.005	0.0071	No	0	No
3/15/2023 12:13	0	0.003	0.0069	No	0	No
3/15/2023 12:14	0	0.004	0.0067	No	0	No
3/15/2023 12:15	0	0.006	0.0069	No	0	No
3/15/2023 12:16	0	0.005	0.0071	No	0	No
3/15/2023 12:17	0	0.023	0.0065	No	0	No
3/15/2023 12:18	0	0.019	0.0074	No	0	No
3/15/2023 12:19	0	0.015	0.0081	No	0	No
3/15/2023 12:20	0	0.068	0.0125	No	0	No
3/15/2023 12:21	0	0.007	0.0127	No	0	No
3/15/2023 12:22	0	0.006	0.0125	No	0	No
3/15/2023 12:23	0	0.004	0.0125	No	0	No
3/15/2023 12:24	0	0.003	0.0123	No	0	No
3/15/2023 12:25	0	0.004	0.0117	No	0	No
3/15/2023 12:26	0	0.004	0.0117	No	0	No
3/15/2023 12:27	0	0.005	0.0117	No	0	No
3/15/2023 12:28	0	0.004	0.0118	No	0	No
3/15/2023 12:29	0	0.008	0.0121	No	0	No
3/15/2023 12:30	0	0.003	0.0119	No	0	No
3/15/2023 12:31	0	0.004	0.0118	No	0	No
3/15/2023 12:32	0	0.006	0.0107	No	0	No
3/15/2023 12:33	0	0.01	0.0101	No	0	No
3/15/2023 12:34	0	0.033	0.0113	No	0	No
3/15/2023 12:35	0	0.012	0.0075	No	0	No
3/15/2023 12:36	0	0.017	0.0082	No	0	No
3/15/2023 12:37	0	0.004	0.0081	No	0	No
3/15/2023 12:38	0	0.007	0.0083	No	0	No
3/15/2023 12:39	0	0.005	0.0084	No	0	No
3/15/2023 12:40	0	0.004	0.0084	No	0	No
3/15/2023 12:41	0	0.004	0.0084	No	0	No
3/15/2023 12:42	0	0.011	0.0088	No	0	No
3/15/2023 12:43	0	0.004	0.0088	No	0	No
3/15/2023 12:44	0	0.004	0.0085	No	0	No
3/15/2023 12:45	0	0.004	0.0086	No	0	No
3/15/2023 12:46	0	0.071	0.0131	No	0	No

Upwind Station						
Time	Instaneous VOC (ppm)	Instaneous Mass Conc. Total (mg/m ³)	Mass Conc. Total mg/m ³ AVG 15m (mg/m ³)	Dust Exceedance	VOC ppm AVG 15m (ppm)	VOC Exceedance
3/15/2023 12:47	0	0.009	0.0133	No	0	No
3/15/2023 12:48	0	0.006	0.013	No	0	No
3/15/2023 12:49	0	0.006	0.0112	No	0	No
3/15/2023 12:50	0	0.006	0.0108	No	0	No
3/15/2023 12:51	0	0.005	0.01	No	0	No
3/15/2023 12:52	0	0.008	0.0103	No	0	No
3/15/2023 12:53	0	0.532	0.0453	No	0	No
3/15/2023 12:54	0	0.725	0.0933	No	0	No
3/15/2023 12:55	0	0.157	0.1035	No	0	No
3/15/2023 12:56	0	0.245	0.1195	No	0	No
3/15/2023 12:57	0	0.014	0.1197	No	0	No
3/15/2023 12:58	0	0.006	0.1199	No	0	No
3/15/2023 12:59	0	0.004	0.1199	No	0	No
3/15/2023 13:00	0	0.01	0.1203	No	0	No
3/15/2023 13:01	0	0.007	0.116	No	0	No
3/15/2023 13:02	0	0.005	0.1157	No	0	No
3/15/2023 13:03	0	0.142	0.1248	No	0	No
3/15/2023 13:04	0	0.031	0.1265	No	0	No
3/15/2023 13:05	0	0.026	0.1278	No	0	No
3/15/2023 13:06	0	0.06	0.1315	No	0	No
3/15/2023 13:07	0	0.032	0.1331	No	0	No
3/15/2023 13:08	0	0.006	0.098	No	0	No
3/15/2023 13:09	0	0.007	0.0501	No	0	No
3/15/2023 13:10	0	0.005	0.04	No	0	No
3/15/2023 13:11	0	0.079	0.0289	No	0	No
3/15/2023 13:12	0	0.21	0.042	No	0	No
3/15/2023 13:13	0	0.01	0.0423	No	0	No
3/15/2023 13:14	0	0.007	0.0425	No	0	No
3/15/2023 13:15	0	0.006	0.0422	No	0	No
3/15/2023 13:16	0	0.005	0.0421	No	0	No
3/15/2023 13:17	0	0.005	0.0421	No	0	No
3/15/2023 13:18	0	0.006	0.033	No	0	No
3/15/2023 13:19	0	0.006	0.0313	No	0	No
3/15/2023 13:20	0	0.005	0.0299	No	0	No
3/15/2023 13:21	0	0.004	0.0262	No	0	No
3/15/2023 13:22	0	0.004	0.0243	No	0	No
3/15/2023 13:23	0	0.006	0.0243	No	0	No
3/15/2023 13:24	0	0.005	0.0242	No	0	No
3/15/2023 13:25	0	0.007	0.0243	No	0	No
3/15/2023 13:26	0	0.007	0.0195	No	0	No
3/15/2023 13:27	0	0.005	0.0059	No	0	No
3/15/2023 13:28	0	0.017	0.0063	No	0	No
3/15/2023 13:29	0	0.007	0.0063	No	0	No
3/15/2023 13:30	0	0.007	0.0064	No	0	No
3/15/2023 13:31	0	0.005	0.0064	No	0	No
3/15/2023 13:32	0	0.02	0.0074	No	0	No
3/15/2023 13:33	0	0.006	0.0074	No	0	No
3/15/2023 13:34	0	0.007	0.0075	No	0	No
3/15/2023 13:35	0	0.006	0.0075	No	0	No
3/15/2023 13:36	0	0.01	0.0079	No	0	No
3/15/2023 13:37	0	0.012	0.0085	No	0	No
3/15/2023 13:38	0	0.008	0.0086	No	0	No

Upwind Station						
Time	Instaneous VOC (ppm)	Instaneous Mass Conc. Total (mg/m³)	Mass Conc. Total mg/m³ AVG 15m (mg/m³)	Dust Exceedance	VOC ppm AVG 15m (ppm)	VOC Exceedance
3/15/2023 13:39	0	0.007	0.0087	No	0	No
3/15/2023 13:40	0	0.006	0.0087	No	0	No
3/15/2023 13:41	0	0.006	0.0086	No	0	No
3/15/2023 13:42	0	0.005	0.0086	No	0	No
3/15/2023 13:43	0	0.009	0.0081	No	0	No
3/15/2023 13:44	0	0.007	0.0081	No	0	No
3/15/2023 13:45	0	0.131	0.0163	No	0	No
3/15/2023 13:46	0	0.004	0.0163	No	0	No
3/15/2023 13:47	0	0.005	0.0153	No	0	No
3/15/2023 13:48	0	0.005	0.0152	No	0	No
3/15/2023 13:49	0	0.005	0.0151	No	0	No
3/15/2023 13:50	0	0.005	0.015	No	0	No
3/15/2023 13:51	0	0.043	0.0172	No	0	No
3/15/2023 13:52	0	0.285	0.0354	No	0	No
3/15/2023 13:53	0	0.005	0.0352	No	0	No
3/15/2023 13:54	0	0.011	0.0355	No	0	No
3/15/2023 13:55	0	0.019	0.0363	No	0	No
3/15/2023 13:56	0	0.01	0.0366	No	0	No
3/15/2023 13:57	0	0.012	0.0371	No	0	No
3/15/2023 13:58	0	0.005	0.0368	No	0	No
3/15/2023 13:59	0	0.006	0.0367	No	0	No
3/15/2023 14:00	0	0.005	0.0283	No	0	No
3/15/2023 14:01	0	0.005	0.0284	No	0	No
3/15/2023 14:02	0	0.012	0.0289	No	0	No
3/15/2023 14:03	0	0.096	0.0349	No	0	No
3/15/2023 14:04	0	0.008	0.0351	No	0	No
3/15/2023 14:05	0	0.053	0.0383	No	0	No
3/15/2023 14:06	0	0.035	0.0378	No	0	No
3/15/2023 14:07	0	0.005	0.0191	No	0	No
3/15/2023 14:08	0	0.007	0.0193	No	0	No
3/15/2023 14:09	0	0.07	0.0232	No	0	No
3/15/2023 14:10	0	0.006	0.0223	No	0	No
3/15/2023 14:11	0	0.012	0.0225	No	0	No
3/15/2023 14:12	0	0.005	0.022	No	0	No
3/15/2023 14:13	0	0.005	0.022	No	0	No
3/15/2023 14:14	0	0.005	0.0219	No	0	No
3/15/2023 14:15	0	0.006	0.022	No	0	No
3/15/2023 14:16	0	0.008	0.0222	No	0	No
3/15/2023 14:17	0	0.005	0.0217	No	0	No
3/15/2023 14:18	0	0.005	0.0157	No	0	No
3/15/2023 14:19	0	0.017	0.0163	No	0	No
3/15/2023 14:20	0	0.055	0.0164	No	0	No
3/15/2023 14:21	0	0.006	0.0145	No	0	No
3/15/2023 14:22	0	0.007	0.0146	No	0	No
3/15/2023 14:23	0	0.007	0.0146	No	0	No
3/15/2023 14:24	0	0.014	0.0109	No	0	No
3/15/2023 14:25	0	0.013	0.0113	No	0	No
3/15/2023 14:26	0	0.018	0.0117	No	0	No
3/15/2023 14:27	0	0.007	0.0119	No	0	No
3/15/2023 14:28	0	0.007	0.012	No	0	No
3/15/2023 14:29	0	0.009	0.0123	No	0	No
3/15/2023 14:30	0	0.009	0.0125	No	0	No

Upwind Station						
Time	Instaneous VOC (ppm)	Instaneous Mass Conc. Total (mg/m ³)	Mass Conc. Total mg/m ³ AVG 15m (mg/m ³)	Dust Exceedance	VOC ppm AVG 15m (ppm)	VOC Exceedance
3/15/2023 14:31	0	0.007	0.0124	No	0	No
3/15/2023 14:32	0	0.029	0.014	No	0	No
3/15/2023 14:33	0	0.009	0.0143	No	0	No
3/15/2023 14:34	0	0.005	0.0135	No	0	No
3/15/2023 14:35	0	0.005	0.0101	No	0	No
3/15/2023 14:36	0	0.005	0.0101	No	0	No
3/15/2023 14:37	0	0.021	0.011	No	0	No
3/15/2023 14:38	0	0.01	0.0112	No	0	No
3/15/2023 14:39	0	0.009	0.0109	No	0	No
3/15/2023 14:40	0	0.007	0.0105	No	0	No
3/15/2023 14:41	0	0.006	0.0097	No	0	No
3/15/2023 14:42	0	0.005	0.0095	No	0	No
3/15/2023 14:43	0	0.007	0.0095	No	0	No
3/15/2023 14:44	0	0.008	0.0095	No	0	No
3/15/2023 14:45	0	0.006	0.0093	No	0	No
3/15/2023 14:46	0	0.007	0.0093	No	0	No
3/15/2023 14:47	0	0.006	0.0077	No	0	No
3/15/2023 14:48	0	0.005	0.0075	No	0	No
3/15/2023 14:49	0	0.006	0.0075	No	0	No
3/15/2023 14:50	0	0.007	0.0077	No	0	No
3/15/2023 14:51	0	0.007	0.0078	No	0	No
3/15/2023 14:52	0	0.007	0.0069	No	0	No
3/15/2023 14:53	0	0.006	0.0066	No	0	No
3/15/2023 14:54	0	0.006	0.0064	No	0	No
3/15/2023 14:55	0	0.005	0.0063	No	0	No
3/15/2023 14:56	0	0.006	0.0063	No	0	No
3/15/2023 14:57	0	0.009	0.0065	No	0	No
3/15/2023 14:58	0	0.005	0.0064	No	0	No
3/15/2023 14:59	0	0.005	0.0062	No	0	No
3/15/2023 15:00	0	0.019	0.0071	No	0	No
3/15/2023 15:01	0	0.009	0.0072	No	0	No
3/15/2023 15:02	0	0.006	0.0072	No	0	No
3/15/2023 15:03	0	0.005	0.0072	No	0	No
3/15/2023 15:04	0	0.005	0.0071	No	0	No
3/15/2023 15:05	0	0.006	0.0071	No	0	No
3/15/2023 15:06	0	0.006	0.007	No	0	No
3/15/2023 15:07	0	0.006	0.0069	No	0	No
3/15/2023 15:08	0	0.006	0.0069	No	0	No
3/15/2023 15:09	0	0.006	0.0069	No	0	No
3/15/2023 15:10	0	0.007	0.0071	No	0	No
3/15/2023 15:11	0	0.008	0.0072	No	0	No
3/15/2023 15:12	0	0.007	0.0071	No	0	No
3/15/2023 15:13	0	0.006	0.0071	No	0	No
3/15/2023 15:14	0	0.01	0.0075	No	0	No
3/15/2023 15:15	0	0.006	0.0066	No	0	No
3/15/2023 15:16	0	0.01	0.0067	No	0	No
3/15/2023 15:17	0	0.005	0.0066	No	0	No
3/15/2023 15:18	0	0.006	0.0067	No	0	No
3/15/2023 15:19	0	0.019	0.0076	No	0	No
3/15/2023 15:20	0	0.018	0.0084	No	0	No
3/15/2023 15:21	0	0.006	0.0084	No	0	No
3/15/2023 15:22	0	0.005	0.0083	No	0	No

Upwind Station						
Time	Instaneous VOC (ppm)	Instaneous Mass Conc. Total (mg/m³)	Mass Conc. Total mg/m³ AVG 15m (mg/m³)	Dust Exceedance	VOC ppm AVG 15m (ppm)	VOC Exceedance
3/15/2023 15:23	0	0.005	0.0083	No	0	No
3/15/2023 15:24	0	0.005	0.0082	No	0	No
3/15/2023 15:25	0	0.005	0.0081	No	0	No
3/15/2023 15:26	0	0.007	0.008	No	0	No
3/15/2023 15:27	0	0.007	0.008	No	0	No
3/15/2023 15:28	0	0.005	0.0079	No	0	No
3/15/2023 15:29	0	0.005	0.0076	No	0	No
3/15/2023 15:30	0	0.007	0.0077	No	0	No
3/15/2023 15:31	0	0.005	0.0073	No	0	No
3/15/2023 15:32	0	0.012	0.0078	No	0	No
3/15/2023 15:33	0	0.013	0.0083	No	0	No
3/15/2023 15:34	0	0.006	0.0074	No	0	No
3/15/2023 15:35	0	0.009	0.0068	No	0	No
3/15/2023 15:36	0	0.008	0.0069	No	0	No
3/15/2023 15:37	0	0.006	0.007	No	0	No
3/15/2023 15:38	0	0.016	0.0077	No	0	No
3/15/2023 15:39	0	0.007	0.0079	No	0	No
3/15/2023 15:40	0	0.006	0.0079	No	0	No
3/15/2023 15:41	0	0.006	0.0079	No	0	No
3/15/2023 15:42	0	0.005	0.0077	No	0	No
3/15/2023 15:43	0	0.006	0.0078	No	0	No
3/15/2023 15:44	0	0.008	0.008	No	0	No
3/15/2023 15:45	0	0.007	0.008	No	0	No
3/15/2023 15:46	0	0.007	0.0081	No	0	No
3/15/2023 15:47	0	0.006	0.0077	No	0	No
3/15/2023 15:48	0	0.005	0.0072	No	0	No
3/15/2023 15:49	0	0.008	0.0073	No	0	No
3/15/2023 15:50	0	0.006	0.0071	No	0	No
3/15/2023 15:51	0	0.005	0.0069	No	0	No
3/15/2023 15:52	0	0.005	0.0069	No	0	No
3/15/2023 15:53	0	0.007	0.0063	No	0	No
3/15/2023 15:54	0	0.006	0.0062	No	0	No
3/15/2023 15:55	0	0.008	0.0063	No	0	No
3/15/2023 15:56	0	0.014	0.0069	No	0	No
3/15/2023 15:57	0	0.006	0.0069	No	0	No
3/15/2023 15:58	0	0.006	0.0069	No	0	No
3/15/2023 15:59	0	0.006	0.0068	No	0	No
3/15/2023 16:00	0	0.005	0.0067	No	0	No
3/15/2023 16:01	0	0.007	0.0067	No	0	No
3/15/2023 16:02	0	0.006	0.0067	No	0	No
3/15/2023 16:03	0	0.018	0.0075	No	0	No
3/15/2023 16:04	0	0.009	0.0076	No	0	No
3/15/2023 16:05	0	0.007	0.0077	No	0	No
3/15/2023 16:06	0	0.005	0.0077	No	0	No
3/15/2023 16:07	0	0.005	0.0077			
3/15/2023 16:08	0	0.005	0.0075			
3/15/2023 16:09	0	0.005	0.0075			
3/15/2023 16:10	0	0.005	0.0073			
3/15/2023 16:11	0	0.005	0.0067			
3/15/2023 16:12	0	0.031	0.0083			
3/15/2023 16:13	0	0.006	0.0083			
3/15/2023 16:14	0	0.006	0.0083			

Upwind Station						
Time	Instaneous VOC (ppm)	Instaneous Mass Conc. Total (mg/m ³)	Mass Conc. Total mg/m ³ AVG 15m (mg/m ³)	Dust Exceedance	VOC ppm AVG 15m (ppm)	VOC Exceedance
3/15/2023 16:15	0	0.006	0.0084			
3/15/2023 16:16	0	0.009	0.0085			
3/15/2023 16:17	0	0.006	0.0085			
3/15/2023 16:18	0	0.006	0.0077			
3/15/2023 16:19	0	0.01	0.0078			
3/15/2023 16:20	0	0.006	0.0077			
3/15/2023 16:21	0	0.006	0.0078			
3/15/2023 16:22	0	0.007	0.0079			
3/15/2023 16:23	0	0.005	0.0079			
3/15/2023 16:24	0	0.012	0.0084			
3/15/2023 16:25	0	0.007	0.0085			
3/15/2023 16:26	0	0.006	0.0086			
3/15/2023 16:27	0	0.005	0.0069			
3/15/2023 16:28	0	0.005	0.0068			
3/15/2023 16:29	0	0.005	0.0067			
3/15/2023 16:30	0	0.006	0.0067			
3/15/2023 16:31	0	0.008	0.0067			
3/15/2023 16:32	0	0.007	0.0067			
3/15/2023 16:33	0	0.354	0.0299			
3/15/2023 16:34	0	0.021	0.0307			
3/15/2023 16:35	0	0.005	0.0306			
3/15/2023 16:36	0	0.006	0.0306			
3/15/2023 16:37	0	0.005	0.0305			
3/15/2023 16:38	0	0.011	0.0309			
3/15/2023 16:39	0	0.008	0.0306			
3/15/2023 16:40	0	0.006	0.0305			
3/15/2023 16:41	0	0.006	0.0305			
3/15/2023 16:42	0	0.006	0.0306			
3/15/2023 16:43	0	0.006	0.0307			
3/15/2023 16:44	0	0.006	0.0307			
3/15/2023 16:45	0	0.01	0.031			
3/15/2023 16:46	0	0.03	0.0325			
3/15/2023 16:47	0	0.015	0.033			
3/15/2023 16:48	0	0.011	0.0101			
3/15/2023 16:49	0	0.014	0.0097			
3/15/2023 16:50	0	0.011	0.0101			
3/15/2023 16:51	0	0.006	0.0101			
3/15/2023 16:52	0	0.011	0.0105			
3/15/2023 16:53	0	0.01	0.0104			

Downwind Station						
Time	Instaneous VOC (ppm)	Instaneous Mass Conc. Total (mg/m ³)	Mass Conc. Total mg/m ³ AVG 15m (mg/m ³)	Dust Exceedance	VOC ppm AVG 15m (ppm)	VOC Exceedance
3/15/2023 8:28	0	0.006	0.006	No	0	No
3/15/2023 8:29	0	0.009	0.0075	No	0	No
3/15/2023 8:30	0	0.01	0.0083	No	0	No
3/15/2023 8:31	0	0.009	0.0085	No	0	No
3/15/2023 8:32	0	0.009	0.0086	No	0	No
3/15/2023 8:33	0	0.008	0.0085	No	0	No
3/15/2023 8:34	0	0.009	0.0086	No	0	No
3/15/2023 8:35	0	0.008	0.0085	No	0	No
3/15/2023 8:36	0	0.012	0.0089	No	0	No
3/15/2023 8:37	0	0.01	0.009	No	0	No
3/15/2023 8:38	0	0.01	0.0091	No	0	No
3/15/2023 8:39	0	0.01	0.0092	No	0	No
3/15/2023 8:40	0	0.01	0.0092	No	0	No
3/15/2023 8:41	0	0.009	0.0092	No	0	No
3/15/2023 8:42	0	0.01	0.0093	No	0	No
3/15/2023 8:43	0	0.01	0.0095	No	0	No
3/15/2023 8:44	0	0.008	0.0095	No	0	No
3/15/2023 8:45	0	0.01	0.0095	No	0	No
3/15/2023 8:46	0	0.009	0.0095	No	0	No
3/15/2023 8:47	0	0.009	0.0095	No	0	No
3/15/2023 8:48	0	0.016	0.01	No	0	No
3/15/2023 8:49	0	0.012	0.0102	No	0	No
3/15/2023 8:50	0	0.011	0.0104	No	0	No
3/15/2023 8:51	0	0.012	0.0104	No	0	No
3/15/2023 8:52	0	0.01	0.0104	No	0	No
3/15/2023 8:53	0	0.01	0.0104	No	0	No
3/15/2023 8:54	0	0.014	0.0107	No	0	No
3/15/2023 8:55	0	0.013	0.0109	No	0	No
3/15/2023 8:56	0	0.012	0.0111	No	0	No
3/15/2023 8:57	0	0.011	0.0111	No	0	No
3/15/2023 8:58	0	0.012	0.0113	No	0	No
3/15/2023 8:59	0	0.011	0.0115	No	0	No
3/15/2023 9:00	0	0.011	0.0115	No	0	No
3/15/2023 9:01	0	0.011	0.0117	No	0	No
3/15/2023 9:02	0	0.013	0.0119	No	0	No
3/15/2023 9:03	0	0.012	0.0117	No	0	No
3/15/2023 9:04	0	0.013	0.0117	No	0	No
3/15/2023 9:05	0	0.013	0.0119	No	0	No
3/15/2023 9:06	0	0.013	0.0119	No	0	No
3/15/2023 9:07	0	0.011	0.012	No	0	No
3/15/2023 9:08	0	0.011	0.0121	No	0	No
3/15/2023 9:09	0	0.016	0.0122	No	0	No
3/15/2023 9:10	0	0.012	0.0121	No	0	No
3/15/2023 9:11	0	0.013	0.0122	No	0	No
3/15/2023 9:12	0	0.018	0.0127	No	0	No
3/15/2023 9:13	0	0.012	0.0127	No	0	No
3/15/2023 9:14	0	0.012	0.0127	No	0	No
3/15/2023 9:15	0.028	0.014	0.0129	No	0.0019	No
3/15/2023 9:16	0.004	0.011	0.0129	No	0.0021	No
3/15/2023 9:17	0	0.012	0.0129	No	0.0021	No
3/15/2023 9:18	0	0.012	0.0129	No	0.0021	No
3/15/2023 9:19	0	0.012	0.0128	No	0.0021	No
3/15/2023 9:20	0	0.013	0.0128	No	0.0021	No
3/15/2023 9:21	0	0.016	0.013	No	0.0021	No

Downwind Station						
Time	Instaneous VOC (ppm)	Instaneous Mass Conc. Total (mg/m ³)	Mass Conc. Total mg/m ³ AVG 15m (mg/m ³)	Dust Exceedance	VOC ppm AVG 15m (ppm)	VOC Exceedance
3/15/2023 9:22	0	0.017	0.0134	No	0.0021	No
3/15/2023 9:23	0	0.013	0.0135	No	0.0021	No
3/15/2023 9:24	0	0.011	0.0132	No	0.0021	No
3/15/2023 9:25	0	0.011	0.0131	No	0.0021	No
3/15/2023 9:26	0	0.013	0.0131	No	0.0021	No
3/15/2023 9:27	0	0.014	0.0129	No	0.0021	No
3/15/2023 9:28	0	0.012	0.0129	No	0.0021	No
3/15/2023 9:29	0	0.01	0.0127	No	0.0021	No
3/15/2023 9:30	0	0.009	0.0124	No	0.0003	No
3/15/2023 9:31	0	0.011	0.0124	No	0	No
3/15/2023 9:32	0	0.01	0.0123	No	0	No
3/15/2023 9:33	0	0.011	0.0122	No	0	No
3/15/2023 9:34	0	0.01	0.0121	No	0	No
3/15/2023 9:35	0	0.012	0.012	No	0	No
3/15/2023 9:36	0	0.009	0.0115	No	0	No
3/15/2023 9:37	0	0.009	0.011	No	0	No
3/15/2023 9:38	0	0.009	0.0107	No	0	No
3/15/2023 9:39	0	0.013	0.0109	No	0	No
3/15/2023 9:40	0	0.01	0.0108	No	0	No
3/15/2023 9:41	0	0.011	0.0107	No	0	No
3/15/2023 9:42	0	0.009	0.0103	No	0	No
3/15/2023 9:43	0	0.009	0.0101	No	0	No
3/15/2023 9:44	0	0.011	0.0102	No	0	No
3/15/2023 9:45	0	0.009	0.0102	No	0	No
3/15/2023 9:46	0	0.009	0.0101	No	0	No
3/15/2023 9:47	0	0.011	0.0101	No	0	No
3/15/2023 9:48	0	0.011	0.0101	No	0	No
3/15/2023 9:49	0	0.012	0.0103	No	0	No
3/15/2023 9:50	0	0.012	0.0103	No	0	No
3/15/2023 9:51	0	0.016	0.0107	No	0	No
3/15/2023 9:52	0	0.012	0.0109	No	0	No
3/15/2023 9:53	0	0.012	0.0111	No	0	No
3/15/2023 9:54	0	0.01	0.0109	No	0	No
3/15/2023 9:55	0	0.011	0.011	No	0	No
3/15/2023 9:56	0	0.015	0.0113	No	0	No
3/15/2023 9:57	0	0.012	0.0115	No	0	No
3/15/2023 9:58	0	0.01	0.0115	No	0	No
3/15/2023 9:59	0	0.009	0.0114	No	0	No
3/15/2023 10:00	0	0.01	0.0115	No	0	No
3/15/2023 10:01	0	0.009	0.0115	No	0	No
3/15/2023 10:02	0	0.01	0.0114	No	0	No
3/15/2023 10:03	0	0.01	0.0113	No	0	No
3/15/2023 10:04	0	0.009	0.0111	No	0	No
3/15/2023 10:05	0	0.008	0.0109	No	0	No
3/15/2023 10:06	0	0.008	0.0103	No	0	No
3/15/2023 10:07	0	0.008	0.0101	No	0	No
3/15/2023 10:08	0	0.008	0.0098	No	0	No
3/15/2023 10:09	0	0.007	0.0096	No	0	No
3/15/2023 10:10	0	0.008	0.0094	No	0	No
3/15/2023 10:11	0	0.007	0.0089	No	0	No
3/15/2023 10:12	0	0.005	0.0084	No	0	No
3/15/2023 10:13	0	0.006	0.0081	No	0	No
3/15/2023 10:14	0	0.007	0.008	No	0	No
3/15/2023 10:15	0	0.008	0.0079	No	0	No

Downwind Station						
Time	Instantaneous VOC (ppm)	Instantaneous Mass Conc. Total (mg/m ³)	Mass Conc. Total mg/m ³ AVG 15m (mg/m ³)	Dust Exceedance	VOC ppm AVG 15m (ppm)	VOC Exceedance
3/15/2023 10:16	0	0.008	0.0078	No	0	No
3/15/2023 10:17	0	0.01	0.0078	No	0	No
3/15/2023 10:18	0	0.009	0.0077	No	0	No
3/15/2023 10:19	0	0.01	0.0078	No	0	No
3/15/2023 10:20	0	0.01	0.0079	No	0	No
3/15/2023 10:21	0	0.011	0.0081	No	0	No
3/15/2023 10:22	0	0.012	0.0084	No	0	No
3/15/2023 10:23	0	0.01	0.0085	No	0	No
3/15/2023 10:24	0	0.01	0.0087	No	0	No
3/15/2023 10:25	0	0.009	0.0088	No	0	No
3/15/2023 10:26	0	0.005	0.0087	No	0	No
3/15/2023 10:27	0	0.004	0.0086	No	0	No
3/15/2023 10:28	0	0.004	0.0085	No	0	No
3/15/2023 10:29	0	0.005	0.0083	No	0	No
3/15/2023 10:30	0	0.007	0.0083	No	0	No
3/15/2023 10:31	0	0.008	0.0083	No	0	No
3/15/2023 10:32	0	0.008	0.0081	No	0	No
3/15/2023 10:33	0	0.006	0.0079	No	0	No
3/15/2023 10:34	0	0.006	0.0077	No	0	No
3/15/2023 10:35	0	0.006	0.0074	No	0	No
3/15/2023 10:36	0	0.005	0.007	No	0	No
3/15/2023 10:37	0	0.005	0.0065	No	0	No
3/15/2023 10:38	0	0.007	0.0063	No	0	No
3/15/2023 10:39	0	0.007	0.0061	No	0	No
3/15/2023 10:40	0	0.01	0.0062	No	0	No
3/15/2023 10:41	0	0.006	0.0063	No	0	No
3/15/2023 10:42	0	0.006	0.0064	No	0	No
3/15/2023 10:43	0	0.007	0.0066	No	0	No
3/15/2023 10:44	0	0.007	0.0067	No	0	No
3/15/2023 10:45	0	0.009	0.0069	No	0	No
3/15/2023 10:46	0	0.01	0.007	No	0	No
3/15/2023 10:47	0	0.011	0.0072	No	0	No
3/15/2023 10:48	0	0.01	0.0075	No	0	No
3/15/2023 10:49	0	0.006	0.0075	No	0	No
3/15/2023 10:50	0	0.007	0.0075	No	0	No
3/15/2023 10:51	0	0.007	0.0077	No	0	No
3/15/2023 10:52	0	0.007	0.0078	No	0	No
3/15/2023 10:53	0	0.007	0.0078	No	0	No
3/15/2023 10:54	0	0.006	0.0077	No	0	No
3/15/2023 10:55	0	0.005	0.0074	No	0	No
3/15/2023 10:56	0	0.008	0.0075	No	0	No
3/15/2023 10:57	0	0.009	0.0077	No	0	No
3/15/2023 10:58	0	0.009	0.0079	No	0	No
3/15/2023 10:59	0	0.008	0.0079	No	0	No
3/15/2023 11:00	0	0.006	0.0077	No	0	No
3/15/2023 11:01	0	0.007	0.0075	No	0	No
3/15/2023 11:02	0	0.009	0.0074	No	0	No
3/15/2023 11:03	0	0.01	0.0074	No	0	No
3/15/2023 11:04	0	0.011	0.0077	No	0	No
3/15/2023 11:05	0	0.011	0.008	No	0	No
3/15/2023 11:06	0	0.009	0.0081	No	0	No
3/15/2023 11:07	0	0.009	0.0083	No	0	No
3/15/2023 11:08	0	0.008	0.0083	No	0	No
3/15/2023 11:09	0	0.007	0.0084	No	0	No

Downwind Station						
Time	Instaneous VOC (ppm)	Instaneous Mass Conc. Total (mg/m ³)	Mass Conc. Total mg/m ³ AVG 15m (mg/m ³)	Dust Exceedance	VOC ppm AVG 15m (ppm)	VOC Exceedance
3/15/2023 11:10	0	0.008	0.0086	No	0	No
3/15/2023 11:11	0	0.008	0.0086	No	0	No
3/15/2023 11:12	0	0.009	0.0086	No	0	No
3/15/2023 11:13	0	0.01	0.0087	No	0	No
3/15/2023 11:14	0	0.009	0.0087	No	0	No
3/15/2023 11:15	0	0.007	0.0088	No	0	No
3/15/2023 11:16	0	0.008	0.0089	No	0	No
3/15/2023 11:17	0	0.008	0.0088	No	0	No
3/15/2023 11:18	0	0.009	0.0087	No	0	No
3/15/2023 11:19	0	0.009	0.0086	No	0	No
3/15/2023 11:20	0	0.011	0.0086	No	0	No
3/15/2023 11:21	0	0.01	0.0087	No	0	No
3/15/2023 11:22	0	0.013	0.0089	No	0	No
3/15/2023 11:23	0	0.01	0.0091	No	0	No
3/15/2023 11:24	0	0.011	0.0093	No	0	No
3/15/2023 11:25	0	0.01	0.0095	No	0	No
3/15/2023 11:26	0	0.008	0.0095	No	0	No
3/15/2023 11:27	0	0.008	0.0094	No	0	No
3/15/2023 11:28	0	0.008	0.0093	No	0	No
3/15/2023 11:29	0	0.014	0.0096	No	0	No
3/15/2023 11:30	0	0.013	0.01	No	0	No
3/15/2023 11:31	0	0.011	0.0102	No	0	No
3/15/2023 11:32	0	0.012	0.0105	No	0	No
3/15/2023 11:33	0	0.018	0.0111	No	0	No
3/15/2023 11:34	0	0.013	0.0113	No	0	No
3/15/2023 11:35	0	0.016	0.0117	No	0	No
3/15/2023 11:36	0	0.013	0.0119	No	0	No
3/15/2023 11:37	0	0.016	0.0121	No	0	No
3/15/2023 11:38	0	0.019	0.0127	No	0	No
3/15/2023 11:39	0	0.015	0.0129	No	0	No
3/15/2023 11:40	0	0.014	0.0132	No	0	No
3/15/2023 11:41	0	0.018	0.0139	No	0	No
3/15/2023 11:42	0	0.016	0.0144	No	0	No
3/15/2023 11:43	0	0.014	0.0148	No	0	No
3/15/2023 11:44	0	0.016	0.0149	No	0	No
3/15/2023 11:45	0	0.015	0.0151	No	0	No
3/15/2023 11:46	0	0.015	0.0153	No	0	No
3/15/2023 11:47	0	0.016	0.0156	No	0	No
3/15/2023 11:48	0	0.023	0.0159	No	0	No
3/15/2023 11:49	0	0.014	0.016	No	0	No
3/15/2023 11:50	0	0.015	0.0159	No	0	No
3/15/2023 11:51	0	0.014	0.016	No	0	No
3/15/2023 11:52	0	0.017	0.0161	No	0	No
3/15/2023 11:53	0	0.015	0.0158	No	0	No
3/15/2023 11:54	0	0.016	0.0159	No	0	No
3/15/2023 11:55	0	0.017	0.0161	No	0	No
3/15/2023 11:56	0	0.013	0.0157	No	0	No
3/15/2023 11:57	0	0.014	0.0156	No	0	No
3/15/2023 11:58	0	0.014	0.0156	No	0	No
3/15/2023 11:59	0	0.014	0.0155	No	0	No
3/15/2023 12:00	0	0.014	0.0154	No	0	No
3/15/2023 12:01	0	0.014	0.0153	No	0	No
3/15/2023 12:02	0	0.017	0.0154	No	0	No
3/15/2023 12:03	0	0.015	0.0149	No	0	No

Downwind Station						
Time	Instaneous VOC (ppm)	Instaneous Mass Conc. Total (mg/m ³)	Mass Conc. Total mg/m ³ AVG 15m (mg/m ³)	Dust Exceedance	VOC ppm AVG 15m (ppm)	VOC Exceedance
3/15/2023 12:04	0	0.015	0.0149	No	0	No
3/15/2023 12:05	0	0.014	0.0149	No	0	No
3/15/2023 12:06	0	0.014	0.0149	No	0	No
3/15/2023 12:07	0	0.014	0.0147	No	0	No
3/15/2023 12:08	0	0.015	0.0147	No	0	No
3/15/2023 12:09	0	0.014	0.0145	No	0	No
3/15/2023 12:10	0	0.015	0.0144	No	0	No
3/15/2023 12:11	0	0.016	0.0146	No	0	No
3/15/2023 12:12	0	0.014	0.0146	No	0	No
3/15/2023 12:13	0	0.015	0.0147	No	0	No
3/15/2023 12:14	0	0.014	0.0147	No	0	No
3/15/2023 12:15	0	0.016	0.0148	No	0	No
3/15/2023 12:16	0	0.014	0.0148	No	0	No
3/15/2023 12:17	0	0.016	0.0147	No	0	No
3/15/2023 12:18	0	0.017	0.0149	No	0	No
3/15/2023 12:19	0	0.017	0.015	No	0	No
3/15/2023 12:20	0	0.017	0.0152	No	0	No
3/15/2023 12:21	0	0.022	0.0157	No	0	No
3/15/2023 12:22	0	0.015	0.0158	No	0	No
3/15/2023 12:23	0	0.014	0.0157	No	0	No
3/15/2023 12:24	0	0.012	0.0156	No	0	No
3/15/2023 12:25	0	0.014	0.0155	No	0	No
3/15/2023 12:26	0	0.013	0.0153	No	0	No
3/15/2023 12:27	0	0.014	0.0153	No	0	No
3/15/2023 12:28	0	0.014	0.0153	No	0	No
3/15/2023 12:29	0	0.014	0.0153	No	0	No
3/15/2023 12:30	0	0.015	0.0152	No	0	No
3/15/2023 12:31	0	0.016	0.0153	No	0	No
3/15/2023 12:32	0	0.017	0.0154	No	0	No
3/15/2023 12:33	0	0.017	0.0154	No	0	No
3/15/2023 12:34	0	0.016	0.0153	No	0	No
3/15/2023 12:35	0	0.013	0.0151	No	0	No
3/15/2023 12:36	0	0.013	0.0145	No	0	No
3/15/2023 12:37	0	0.014	0.0144	No	0	No
3/15/2023 12:38	0	0.016	0.0145	No	0	No
3/15/2023 12:39	0	0.014	0.0147	No	0	No
3/15/2023 12:40	0	0.013	0.0146	No	0	No
3/15/2023 12:41	0	0.014	0.0147	No	0	No
3/15/2023 12:42	0	0.013	0.0146	No	0	No
3/15/2023 12:43	0	0.013	0.0145	No	0	No
3/15/2023 12:44	0	0.013	0.0145	No	0	No
3/15/2023 12:45	0	0.014	0.0144	No	0	No
3/15/2023 12:46	0	0.015	0.0143	No	0	No
3/15/2023 12:47	0	0.013	0.0141	No	0	No
3/15/2023 12:48	0	0.014	0.0139	No	0	No
3/15/2023 12:49	0	0.016	0.0139	No	0	No
3/15/2023 12:50	0	0.013	0.0139	No	0	No
3/15/2023 12:51	0	0.013	0.0139	No	0	No
3/15/2023 12:52	0	0.014	0.0139	No	0	No
3/15/2023 12:53	0	0.023	0.0143	No	0	No
3/15/2023 12:54	0	0.019	0.0147	No	0	No
3/15/2023 12:55	0	0.017	0.0149	No	0	No
3/15/2023 12:56	0	0.02	0.0153	No	0	No
3/15/2023 12:57	0	0.02	0.0158	No	0	No

Downwind Station						
Time	Instaneous VOC (ppm)	Instaneous Mass Conc. Total (mg/m ³)	Mass Conc. Total mg/m ³ AVG 15m (mg/m ³)	Dust Exceedance	VOC ppm AVG 15m (ppm)	VOC Exceedance
3/15/2023 12:58	0	0.016	0.016	No	0	No
3/15/2023 12:59	0	0.016	0.0162	No	0	No
3/15/2023 13:00	0	0.015	0.0163	No	0	No
3/15/2023 13:01	0	0.016	0.0163	No	0	No
3/15/2023 13:02	0	0.015	0.0165	No	0	No
3/15/2023 13:03	0	0.016	0.0166	No	0	No
3/15/2023 13:04	0	0.015	0.0165	No	0	No
3/15/2023 13:05	0	0.014	0.0166	No	0	No
3/15/2023 13:06	0	0.014	0.0167	No	0	No
3/15/2023 13:07	0	0.013	0.0166	No	0	No
3/15/2023 13:08	0	0.014	0.016	No	0	No
3/15/2023 13:09	0	0.013	0.0156	No	0	No
3/15/2023 13:10	0	0.014	0.0154	No	0	No
3/15/2023 13:11	0	0.016	0.0151	No	0	No
3/15/2023 13:12	0	0.019	0.0151	No	0	No
3/15/2023 13:13	0	0.017	0.0151	No	0	No
3/15/2023 13:14	0	0.016	0.0151	No	0	No
3/15/2023 13:15	0	0.014	0.0151	No	0	No
3/15/2023 13:16	0	0.014	0.0149	No	0	No
3/15/2023 13:17	0	0.014	0.0149	No	0	No
3/15/2023 13:18	0	0.016	0.0149	No	0	No
3/15/2023 13:19	0	0.013	0.0147	No	0	No
3/15/2023 13:20	0	0.013	0.0147	No	0	No
3/15/2023 13:21	0	0.014	0.0147	No	0	No
3/15/2023 13:22	0	0.013	0.0147	No	0	No
3/15/2023 13:23	0	0.015	0.0147	No	0	No
3/15/2023 13:24	0	0.015	0.0149	No	0	No
3/15/2023 13:25	0	0.013	0.0148	No	0	No
3/15/2023 13:26	0	0.015	0.0147	No	0	No
3/15/2023 13:27	0	0.016	0.0145	No	0	No
3/15/2023 13:28	0	0.016	0.0145	No	0	No
3/15/2023 13:29	0	0.014	0.0143	No	0	No
3/15/2023 13:30	0	0.016	0.0145	No	0	No
3/15/2023 13:31	0	0.015	0.0145	No	0	No
3/15/2023 13:32	0.001	0.019	0.0149	No	0.0001	No
3/15/2023 13:33	0	0.015	0.0148	No	0.0001	No
3/15/2023 13:34	0	0.013	0.0148	No	0.0001	No
3/15/2023 13:35	0	0.013	0.0148	No	0.0001	No
3/15/2023 13:36	0	0.015	0.0149	No	0.0001	No
3/15/2023 13:37	0	0.016	0.0151	No	0.0001	No
3/15/2023 13:38	0	0.014	0.015	No	0.0001	No
3/15/2023 13:39	0	0.013	0.0149	No	0.0001	No
3/15/2023 13:40	0	0.015	0.015	No	0.0001	No
3/15/2023 13:41	0	0.014	0.0149	No	0.0001	No
3/15/2023 13:42	0	0.014	0.0148	No	0.0001	No
3/15/2023 13:43	0	0.015	0.0147	No	0.0001	No
3/15/2023 13:44	0	0.017	0.0149	No	0.0001	No
3/15/2023 13:45	0	0.018	0.0151	No	0.0001	No
3/15/2023 13:46	0	0.015	0.0151	No	0.0001	No
3/15/2023 13:47	0	0.02	0.0151	No	0	No
3/15/2023 13:48	0	0.015	0.0151	No	0	No
3/15/2023 13:49	0	0.019	0.0155	No	0	No
3/15/2023 13:50	0	0.031	0.0167	No	0	No
3/15/2023 13:51	0	0.038	0.0183	No	0	No

Downwind Station						
Time	Instaneous VOC (ppm)	Instaneous Mass Conc. Total (mg/m ³)	Mass Conc. Total mg/m ³ AVG 15m (mg/m ³)	Dust Exceedance	VOC ppm AVG 15m (ppm)	VOC Exceedance
3/15/2023 13:52	0	0.018	0.0184	No	0	No
3/15/2023 13:53	0	0.013	0.0183	No	0	No
3/15/2023 13:54	0	0.013	0.0183	No	0	No
3/15/2023 13:55	0	0.014	0.0183	No	0	No
3/15/2023 13:56	0	0.015	0.0183	No	0	No
3/15/2023 13:57	0	0.02	0.0187	No	0	No
3/15/2023 13:58	0	0.015	0.0187	No	0	No
3/15/2023 13:59	0	0.013	0.0185	No	0	No
3/15/2023 14:00	0	0.015	0.0183	No	0	No
3/15/2023 14:01	0	0.014	0.0182	No	0	No
3/15/2023 14:02	0	0.014	0.0178	No	0	No
3/15/2023 14:03	0	0.017	0.0179	No	0	No
3/15/2023 14:04	0	0.014	0.0176	No	0	No
3/15/2023 14:05	0	0.014	0.0165	No	0	No
3/15/2023 14:06	0	0.014	0.0149	No	0	No
3/15/2023 14:07	0	0.014	0.0146	No	0	No
3/15/2023 14:08	0	0.013	0.0146	No	0	No
3/15/2023 14:09	0	0.015	0.0147	No	0	No
3/15/2023 14:10	0	0.014	0.0147	No	0	No
3/15/2023 14:11	0	0.014	0.0147	No	0	No
3/15/2023 14:12	0	0.013	0.0142	No	0	No
3/15/2023 14:13	0	0.019	0.0145	No	0	No
3/15/2023 14:14	0	0.015	0.0146	No	0	No
3/15/2023 14:15	0	0.014	0.0145	No	0	No
3/15/2023 14:16	0	0.014	0.0145	No	0	No
3/15/2023 14:17	0	0.018	0.0148	No	0	No
3/15/2023 14:18	0	0.013	0.0145	No	0	No
3/15/2023 14:19	0	0.015	0.0146	No	0	No
3/15/2023 14:20	0	0.015	0.0147	No	0	No
3/15/2023 14:21	0	0.013	0.0146	No	0	No
3/15/2023 14:22	0	0.013	0.0145	No	0	No
3/15/2023 14:23	0	0.015	0.0147	No	0	No
3/15/2023 14:24	0	0.014	0.0146	No	0	No
3/15/2023 14:25	0	0.017	0.0148	No	0	No
3/15/2023 14:26	0	0.017	0.015	No	0	No
3/15/2023 14:27	0.001	0.016	0.0152	No	0.0001	No
3/15/2023 14:28	0	0.016	0.015	No	0.0001	No
3/15/2023 14:29	0	0.016	0.0151	No	0.0001	No
3/15/2023 14:30	0	0.015	0.0151	No	0.0001	No
3/15/2023 14:31	0	0.015	0.0152	No	0.0001	No
3/15/2023 14:32	0	0.014	0.0149	No	0.0001	No
3/15/2023 14:33	0	0.015	0.0151	No	0.0001	No
3/15/2023 14:34	0	0.013	0.0149	No	0.0001	No
3/15/2023 14:35	0	0.013	0.0148	No	0.0001	No
3/15/2023 14:36	0	0.013	0.0148	No	0.0001	No
3/15/2023 14:37	0	0.015	0.0149	No	0.0001	No
3/15/2023 14:38	0	0.016	0.015	No	0.0001	No
3/15/2023 14:39	0.005	0.017	0.0152	No	0.0004	No
3/15/2023 14:40	0	0.02	0.0154	No	0.0004	No
3/15/2023 14:41	0	0.014	0.0152	No	0.0004	No
3/15/2023 14:42	0	0.015	0.0151	No	0.0003	No
3/15/2023 14:43	0	0.014	0.015	No	0.0003	No
3/15/2023 14:44	0	0.016	0.015	No	0.0003	No
3/15/2023 14:45	0	0.02	0.0153	No	0.0003	No

Downwind Station						
Time	Instaneous VOC (ppm)	Instaneous Mass Conc. Total (mg/m ³)	Mass Conc. Total mg/m ³ AVG 15m (mg/m ³)	Dust Exceedance	VOC ppm AVG 15m (ppm)	VOC Exceedance
3/15/2023 14:46	0	0.013	0.0152	No	0.0003	No
3/15/2023 14:47	0	0.014	0.0152	No	0.0003	No
3/15/2023 14:48	0	0.015	0.0152	No	0.0003	No
3/15/2023 14:49	0	0.014	0.0153	No	0.0003	No
3/15/2023 14:50	0	0.014	0.0153	No	0.0003	No
3/15/2023 14:51	0	0.016	0.0155	No	0.0003	No
3/15/2023 14:52	0	0.014	0.0155	No	0.0003	No
3/15/2023 14:53	0	0.014	0.0153	No	0.0003	No
3/15/2023 14:54	0	0.015	0.0152	No	0	No
3/15/2023 14:55	0	0.014	0.0148	No	0	No
3/15/2023 14:56	0	0.017	0.015	No	0	No
3/15/2023 14:57	0	0.014	0.0149	No	0	No
3/15/2023 14:58	0	0.015	0.015	No	0	No
3/15/2023 14:59	0	0.053	0.0175	No	0	No
3/15/2023 15:00	0	0.013	0.017	No	0	No
3/15/2023 15:01	0	0.013	0.017	No	0	No
3/15/2023 15:02	0	0.012	0.0169	No	0	No
3/15/2023 15:03	0	0.011	0.0166	No	0	No
3/15/2023 15:04	0	0.012	0.0165	No	0	No
3/15/2023 15:05	0	0.011	0.0163	No	0	No
3/15/2023 15:06	0	0.011	0.0159	No	0	No
3/15/2023 15:07	0	0.012	0.0158	No	0	No
3/15/2023 15:08	0	0.013	0.0157	No	0	No
3/15/2023 15:09	0	0.012	0.0155	No	0	No
3/15/2023 15:10	0	0.011	0.0153	No	0	No
3/15/2023 15:11	0	0.011	0.0149	No	0	No
3/15/2023 15:12	0	0.013	0.0149	No	0	No
3/15/2023 15:13	0	0.013	0.0147	No	0	No
3/15/2023 15:14	0	0.013	0.0121	No	0	No
3/15/2023 15:15	0	0.01	0.0119	No	0	No
3/15/2023 15:16	0	0.012	0.0118	No	0	No
3/15/2023 15:17	0	0.011	0.0117	No	0	No
3/15/2023 15:18	0	0.011	0.0117	No	0	No
3/15/2023 15:19	0	0.009	0.0115	No	0	No
3/15/2023 15:20	0	0.01	0.0115	No	0	No
3/15/2023 15:21	0	0.011	0.0115	No	0	No
3/15/2023 15:22	0	0.012	0.0115	No	0	No
3/15/2023 15:23	0	0.011	0.0113	No	0	No
3/15/2023 15:24	0	0.011	0.0113	No	0	No
3/15/2023 15:25	0	0.01	0.0112	No	0	No
3/15/2023 15:26	0	0.009	0.0111	No	0	No
3/15/2023 15:27	0	0.008	0.0107	No	0	No
3/15/2023 15:28	0	0.009	0.0105	No	0	No
3/15/2023 15:29	0	0.01	0.0103	No	0	No
3/15/2023 15:30	0	0.01	0.0103	No	0	No
3/15/2023 15:31	0	0.009	0.0101	No	0	No
3/15/2023 15:32	0	0.022	0.0108	No	0	No
3/15/2023 15:33	0	0.009	0.0107	No	0	No
3/15/2023 15:34	0	0.009	0.0107	No	0	No
3/15/2023 15:35	0	0.009	0.0106	No	0	No
3/15/2023 15:36	0	0.01	0.0105	No	0	No
3/15/2023 15:37	0	0.009	0.0103	No	0	No
3/15/2023 15:38	0	0.01	0.0103	No	0	No
3/15/2023 15:39	0	0.01	0.0102	No	0	No

Downwind Station						
Time	Instaneous VOC (ppm)	Instaneous Mass Conc. Total (mg/m ³)	Mass Conc. Total mg/m ³ AVG 15m (mg/m ³)	Dust Exceedance	VOC ppm AVG 15m (ppm)	VOC Exceedance
3/15/2023 15:40	0	0.009	0.0101	No	0	No
3/15/2023 15:41	0	0.009	0.0101	No	0	No
3/15/2023 15:42	0	0.009	0.0102	No	0	No
3/15/2023 15:43	0	0.009	0.0102	No	0	No
3/15/2023 15:44	0	0.012	0.0103	No	0	No
3/15/2023 15:45	0	0.013	0.0105	No	0	No
3/15/2023 15:46	0	0.032	0.0121	No	0	No
3/15/2023 15:47	0	0.01	0.0113	No	0	No
3/15/2023 15:48	0	0.008	0.0112	No	0	No
3/15/2023 15:49	0	0.009	0.0112	No	0	No
3/15/2023 15:50	0	0.009	0.0112	No	0	No
3/15/2023 15:51	0	0.01	0.0112	No	0	No
3/15/2023 15:52	0	0.007	0.0111	No	0	No
3/15/2023 15:53	0	0.008	0.0109	No	0	No
3/15/2023 15:54	0	0.008	0.0108	No	0	No
3/15/2023 15:55	0	0.01	0.0109	No	0	No
3/15/2023 15:56	0	0.008	0.0108	No	0	No
3/15/2023 15:57	0	0.008	0.0107	No	0	No
3/15/2023 15:58	0	0.009	0.0107	No	0	No
3/15/2023 15:59	0	0.008	0.0105	No	0	No
3/15/2023 16:00	0	0.008	0.0101	No	0	No
3/15/2023 16:01	0	0.008	0.0085	No	0	No
3/15/2023 16:02	0	0.008	0.0084			
3/15/2023 16:03	0	0.008	0.0084			
3/15/2023 16:04	0	0.009	0.0084			
3/15/2023 16:05	0	0.008	0.0083			
3/15/2023 16:06	0	0.009	0.0083			
3/15/2023 16:07	0	0.01	0.0085			
3/15/2023 16:08	0	0.009	0.0085			
3/15/2023 16:09	0	0.008	0.0085			
3/15/2023 16:10	0	0.01	0.0085			
3/15/2023 16:11	0	0.009	0.0086			
3/15/2023 16:12	0	0.01	0.0087			
3/15/2023 16:13	0	0.008	0.0087			
3/15/2023 16:14	0	0.008	0.0087			
3/15/2023 16:15	0	0.009	0.0087			
3/15/2023 16:16	0	0.01	0.0089			
3/15/2023 16:17	0	0.01	0.009			
3/15/2023 16:18	0	0.009	0.0091			
3/15/2023 16:19	0	0.01	0.0091			
3/15/2023 16:20	0	0.01	0.0093			
3/15/2023 16:21	0	0.011	0.0094			
3/15/2023 16:22	0	0.01	0.0094			
3/15/2023 16:23	0	0.01	0.0095			
3/15/2023 16:24	0	0.011	0.0097			
3/15/2023 16:25	0	0.011	0.0097			
3/15/2023 16:26	0	0.009	0.0097			
3/15/2023 16:27	0	0.009	0.0097			
3/15/2023 16:28	0	0.009	0.0097			
3/15/2023 16:29	0	0.009	0.0098			
3/15/2023 16:30	0	0.007	0.0097			
3/15/2023 16:31	0	0.008	0.0095			
3/15/2023 16:32	0	0.008	0.0094			
3/15/2023 16:33	0	0.009	0.0094			

Downwind Station						
Time	Instantaneous VOC (ppm)	Instantaneous Mass Conc. Total (mg/m ³)	Mass Conc. Total mg/m ³ AVG 15m (mg/m ³)	Dust Exceedance	VOC ppm AVG 15m (ppm)	VOC Exceedance
3/15/2023 16:34	0	0.01	0.0094			
3/15/2023 16:35	0	0.009	0.0093			
3/15/2023 16:36	0	0.008	0.0091			
3/15/2023 16:37	0	0.007	0.0089			
3/15/2023 16:38	0	0.01	0.0089			
3/15/2023 16:39	0	0.011	0.0089			
3/15/2023 16:40	0	0.009	0.0088			
3/15/2023 16:41	0	0.01	0.0089			
3/15/2023 16:42	0	0.009	0.0089			
3/15/2023 16:43	0	0.007	0.0087			
3/15/2023 16:44	0	0.007	0.0086			
3/15/2023 16:45	0	0.009	0.0087			
3/15/2023 16:46	0	0.009	0.0088			
3/15/2023 16:47	0	0.01	0.0089			
3/15/2023 16:48	0	0.01	0.009			
3/15/2023 16:49	0	0.01	0.009			
3/15/2023 16:50	0	0.009	0.009			
3/15/2023 16:51	0	0.008	0.009			
3/15/2023 16:52	0	0.01	0.0092			