



Daily Activity Report

Seton Brilla Charter School
 1956 Jerome Avenue, Bronx, NY
 BCP No. C203152

General Site Information

Date:	Monday, March 13, 2023
Weather:	Rain, 35-45°F
Wind Direction/Speed:	NE @ 7mph
AKRF Personnel on Site:	Lucas Belangia
AKRF Equipment on Site:	Mini RAE 3000 Photoionization Detector [(PID) x1], 2 Fixed Air Monitoring Stations [DustTrak
Visitors:	None.

Contractor Information

Contracting Company	Main Personnel	Equipment
Casino Construction	Connor McGrory	Excavator, CFA Drill Rig

Description and Location of Work Activities Performed

- 1) Excavation for pile cap construction in grid WC-03.
- 2) Assembly of formwork for pile caps.

Destination Facility	Daily Trucks	Total Trucks	Daily Approx. Cubic Yds	Total Approx. Cubic Yds	Total Site Loads	Total Approximate Cubic Yards
Clean Earth Carteret	0	73	0	1,460	166	3,320
Clean Earth Southeastern Pennsylvania	0	67	0	1,340		
Concrete Disposal	0	26	0	520		
N/A	0	0	0	0		
N/A	0	0	0	0		

CAMP Air Monitoring Results

CAMP Station	UPWIND			DOWNWIND		
Odors:	None.			None.		
VOC Action Level Exceedance(s):	None.			None.		
Particulate Action Level Exceedance(s):	None.			None.		
Maximum VOC Level (15 min ppm):	N/A			N/A		
Maximum Particulate Level (15 min mg/m ³):	N/A			N/A		

Notes: No CAMP or roving air monitoring took place due to precipitation throughout the day. No work tomorrow (3/14/23) due to winter storm.

Additional Information

Planned Work Activity for Following Day/Week:	<ol style="list-style-type: none"> 1) Excavation of soil/fill to uncover piles. 2) Cutting piles to final elevations 3) Two trucks scheduled to remove soil and bring to Caterret (3/15/23)
Comments:	None.

Site Map

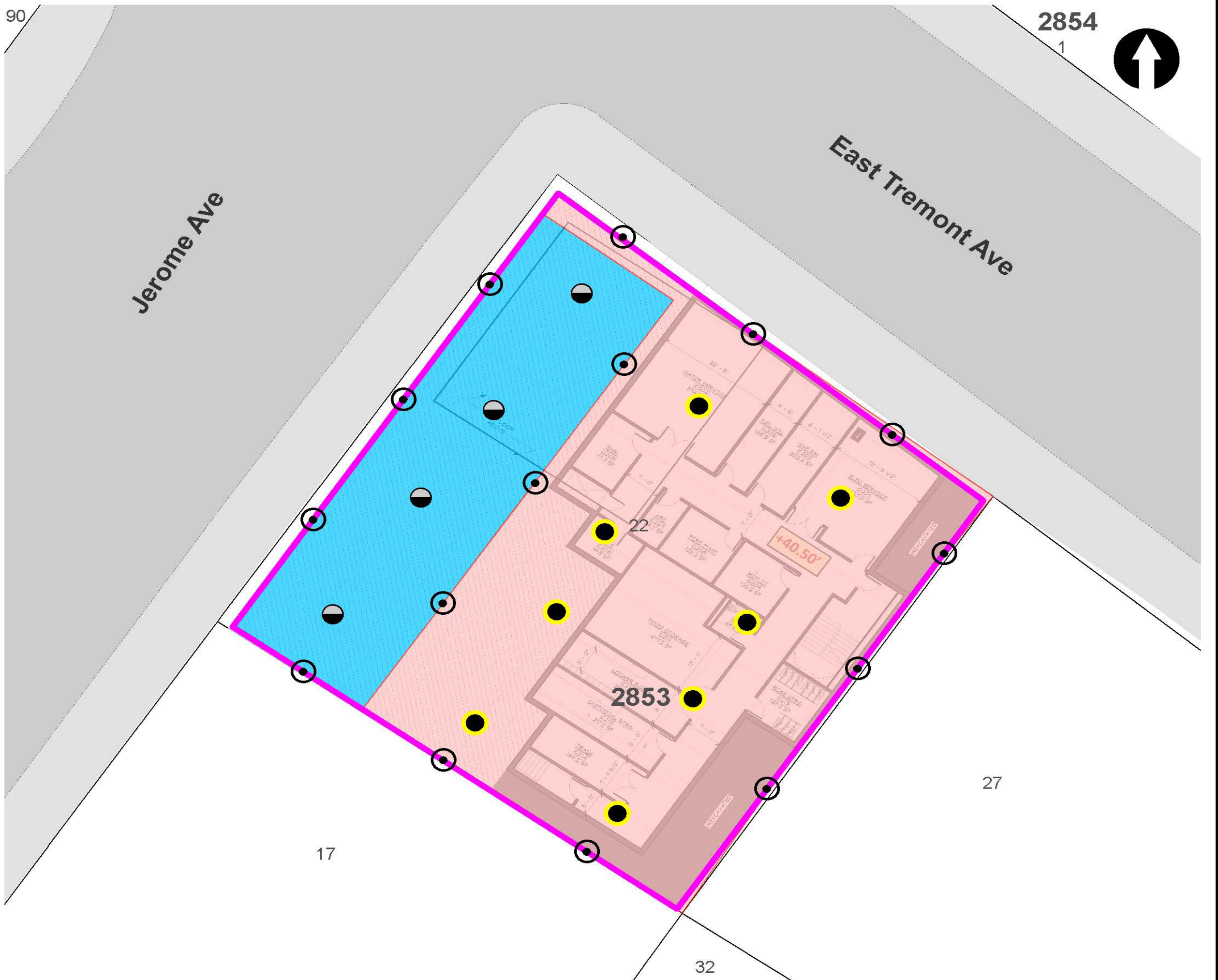

LEGEND

- PROJECT SITE BOUNDARY
- LOT BOUNDARY AND TAX LOT NUMBER
- 2853** BLOCK NUMBER
- REMEDIAL EXCAVATION TO APPROXIMATELY TWO FEET BELOW EXISTING GRADE
- REMEDIAL EXCAVATION TO GROUNDWATER (SOURCE AREA)

- CONFIRMATION DOCUMENTATION BOTTOM SAMPLE
- SOURCE AREA DOCUMENTATION BOTTOM SAMPLE
- DOCUMENTATION SIDEWALL SAMPLE

NOTE

REMEDIAL EXCAVATION WILL INCLUDE REMOVAL OF APPROXIMATELY 1,280 TONS (850 CUBIC YARDS) OF SOURCE MATERIAL ASSOCIATED WITH NYSDEC SPILL NO. 2103719 AND APPROXIMATELY 860 TONS (570 CUBIC YARDS) OF SOIL/FILL FROM THE UPPER 2 FEET SITE-WIDE.



Map Source:
NYCDP (NYC Dept. of City Planning) GIS database

© 2021 AKRF. W:\Projects\210024 - 1956 JEROME AVENUE\Technical\GIS and Graphics\AR\RAW\210024 Figure 9 Proposed Remedial Excavation and Documentation Sample Location Plan.mxd 10/25/2021 2:03:38 PM iszalus



440 Park Avenue South, New York, NY 10016

1956 Jerome Avenue
Bronx, New York

**TRACK 4 CLEANUP AND DOCUMENTATION
SAMPLE LOCATION PLAN**

DATE
04/29/2022

PROJECT NO.
210024

FIGURE
11

Site Photographs

Photograph 1 -
Assembled pile cap
formwork in SE
corner. View facing
South.



Photograph 2-
Excavation of soil for
pile cap
construction. View
facing North.



Photograph 3-
Excavation of soil for
pile cap
construction. View
facing South.

