



Daily Activity Report

Seton Brilla Charter School
1956 Jerome Avenue, Bronx, NY
BCP No. C203152

General Site Information

Date:	Friday, March 10, 2023
Weather:	Mostly Cloudy, 35°F
Wind Direction/Speed:	N @ 6 mph
AKRF Personnel on Site:	Antonio Cardenas
AKRF Equipment on Site:	Mini RAE 3000 Photoionization Detector [(PID) x1], 2 Fixed Air Monitoring Stations [DustTrak
Visitors:	None.

Contractor Information

Contracting Company	Main Personnel	Equipment
Casino Construction	Connor McGrory	Excavator, CFA Drill Rig

Description and Location of Work Activities Performed

- 1) Minor grading of soil/fill in grid WC-03.
- 2) Pile cap construction activities continued.

Destination Facility	Daily Trucks	Total Trucks	Daily Approx. Cubic Yds	Total Approx. Cubic Yds	Total Site Loads	Total Approximate Cubic Yards
Clean Earth Carteret	0	73	0	1,460	166	3,320
Clean Earth Southeastern Pennsylvania	0	67	0	1,340		
Concrete Disposal	0	26	0	520		
N/A	0	0	0	0		
N/A	0	0	0	0		

CAMP Air Monitoring Results

CAMP Station	UPWIND				DOWNWIND		
Odors:	None.				None.		
VOC Action Level Exceedance(s):	None.				None.		
Particulate Action Level Exceedance(s):	None.				None.		
Maximum VOC Level (15 min ppm):	0.0136				0.0132		
Maximum Particulate Level (15 min mg/m ³):	0.0283				0.0283		

Notes: CAMP monitoring was performed throughout the day. No exceedances were reported.

Additional Information

Planned Work Activity for Following Day/Week:	1) Excavation of soil/fill to uncover piles. 2) Cutting piles to final elevations
Comments:	None.

Site Map

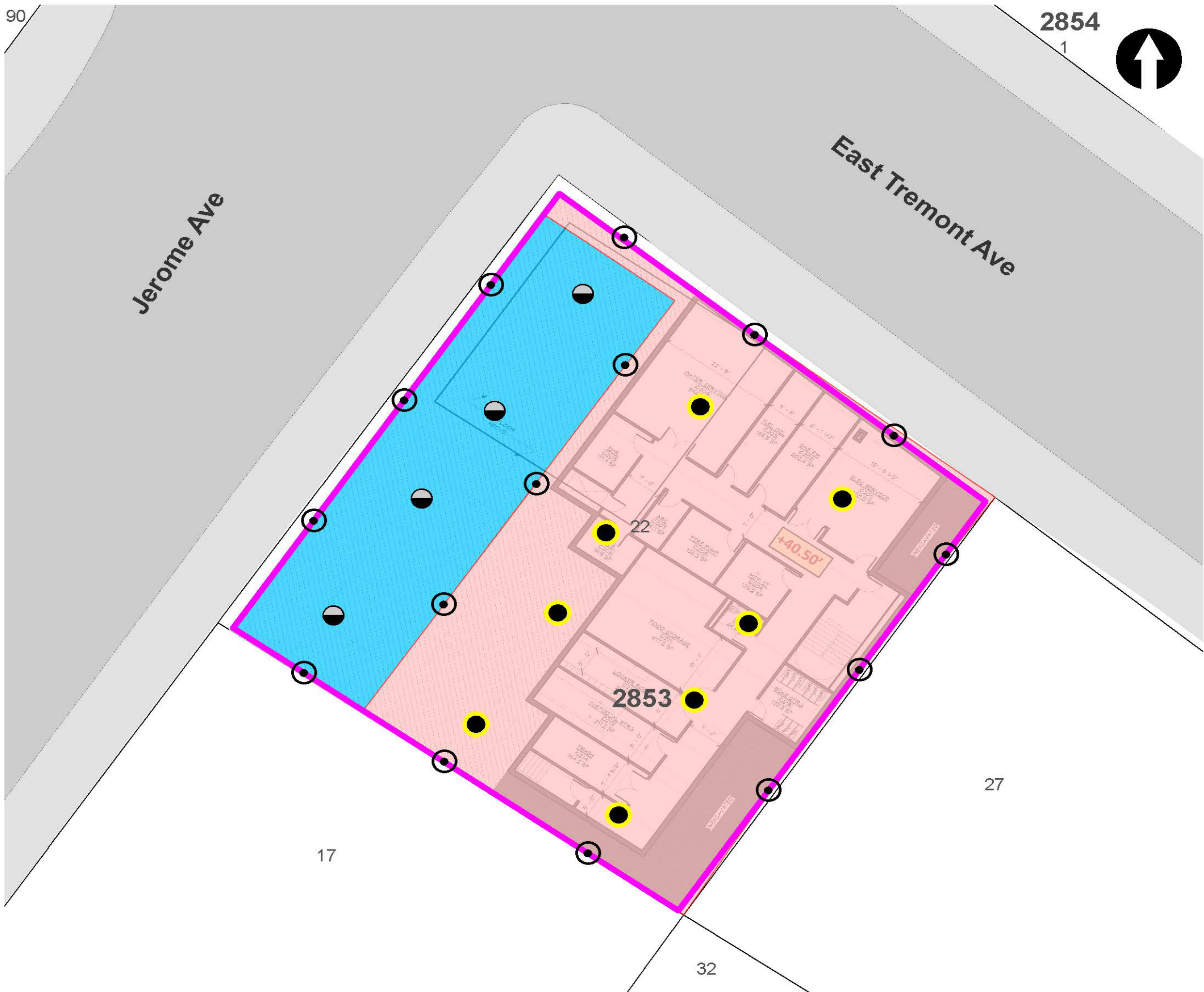

LEGEND

- PROJECT SITE BOUNDARY
- LOT BOUNDARY AND TAX LOT NUMBER
- 2853** BLOCK NUMBER
- REMEDIAL EXCAVATION TO APPROXIMATELY TWO FEET BELOW EXISTING GRADE
- REMEDIAL EXCAVATION TO GROUNDWATER (SOURCE AREA)

- CONFIRMATION DOCUMENTATION BOTTOM SAMPLE
- SOURCE AREA DOCUMENTATION BOTTOM SAMPLE
- DOCUMENTATION SIDEWALL SAMPLE

NOTE
 REMEDIAL EXCAVATION WILL INCLUDE REMOVAL OF APPROXIMATELY 1,280 TONS (850 CUBIC YARDS) OF SOURCE MATERIAL ASSOCIATED WITH NYSDEC SPILL NO. 2103719 AND APPROXIMATELY 860 TONS (570 CUBIC YARDS) OF SOIL/FILL FROM THE UPPER 2 FEET SITE-WIDE.



Map Source:
 NYCDP (NYC Dept. of City Planning) GIS database

© 2021 AKRF. W:\Projects\210024 - 1956 JEROME AVENUE\Technical\GIS and Graphics\AR\RAW\210024 Figure 9 Proposed Remedial Excavation and Documentation Sample Location Plan.mxd 10/25/2021 2:03:38 PM iszalus



440 Park Avenue South, New York, NY 10016

1956 Jerome Avenue
 Bronx, New York

**TRACK 4 CLEANUP AND DOCUMENTATION
 SAMPLE LOCATION PLAN**

DATE
04/29/2022

PROJECT NO.
210024

FIGURE
11

Site Photographs

Photograph 1 -
General site
conditions, view
facing east.



Photograph 2 -
Grading soil/fill
around pile cap, view
facing southeast.



Photograph 3 -
Stockpile of fill
material covered
with polyethylene
sheeting, view facing
east.



Upwind Station						
Time	Instaneous VOC (ppm)	Instaneous Mass Conc. Total (mg/m ³)	Mass Conc. Total mg/m ³ AVG 15m (mg/m ³)	Dust Exceedance	VOC ppm AVG 15m (ppm)	VOC Exceedance
3/10/2023 7:31	0			No	0	No
3/10/2023 7:32	0	0.016	0.016	No	0	No
3/10/2023 7:33	0	0.017	0.0165	No	0	No
3/10/2023 7:34	0	0.016	0.0163	No	0	No
3/10/2023 7:35	0	0.015	0.016	No	0	No
3/10/2023 7:36	0	0.014	0.0156	No	0	No
3/10/2023 7:37	0.008	0.014	0.0153	No	0.0011	No
3/10/2023 7:38	0	0.013	0.015	No	0.001	No
3/10/2023 7:39	0	0.013	0.0148	No	0.0009	No
3/10/2023 7:40	0	0.016	0.0149	No	0.0008	No
3/10/2023 7:41	0	0.017	0.0151	No	0.0007	No
3/10/2023 7:42	0	0.017	0.0153	No	0.0007	No
3/10/2023 7:43	0	0.016	0.0153	No	0.0006	No
3/10/2023 7:44	0	0.017	0.0155	No	0.0006	No
3/10/2023 7:45	0	0.016	0.0155	No	0.0005	No
3/10/2023 7:46	0	0.017	0.0156	No	0.0005	No
3/10/2023 7:47	0	0.017	0.0157	No	0.0005	No
3/10/2023 7:48	0	0.016	0.0156	No	0.0005	No
3/10/2023 7:49	0	0.016	0.0156	No	0.0005	No
3/10/2023 7:50	0	0.015	0.0156	No	0.0005	No
3/10/2023 7:51	0	0.017	0.0158	No	0.0005	No
3/10/2023 7:52	0	0.016	0.0159	No	0	No
3/10/2023 7:53	0	0.018	0.0163	No	0	No
3/10/2023 7:54	0	0.017	0.0165	No	0	No
3/10/2023 7:55	0	0.017	0.0166	No	0	No
3/10/2023 7:56	0	0.019	0.0167	No	0	No
3/10/2023 7:57	0	0.019	0.0169	No	0	No
3/10/2023 7:58	0	0.018	0.017	No	0	No
3/10/2023 7:59	0	0.015	0.0169	No	0	No
3/10/2023 8:00	0	0.015	0.0168	No	0	No
3/10/2023 8:01	0	0.014	0.0166	No	0	No
3/10/2023 8:02	0	0.014	0.0164	No	0	No
3/10/2023 8:03	0	0.014	0.0163	No	0	No
3/10/2023 8:04	0	0.015	0.0162	No	0	No
3/10/2023 8:05	0	0.016	0.0163	No	0	No
3/10/2023 8:06	0	0.014	0.0161	No	0	No
3/10/2023 8:07	0	0.014	0.0159	No	0	No
3/10/2023 8:08	0	0.014	0.0157	No	0	No
3/10/2023 8:09	0	0.014	0.0155	No	0	No
3/10/2023 8:10	0	0.014	0.0153	No	0	No
3/10/2023 8:11	0	0.015	0.015	No	0	No
3/10/2023 8:12	0	0.015	0.0147	No	0	No
3/10/2023 8:13	0	0.015	0.0145	No	0	No
3/10/2023 8:14	0	0.015	0.0145	No	0	No
3/10/2023 8:15	0	0.014	0.0145	No	0	No
3/10/2023 8:16	0	0.015	0.0145	No	0	No
3/10/2023 8:17	0	0.015	0.0146	No	0	No
3/10/2023 8:18	0	0.014	0.0146	No	0	No
3/10/2023 8:19	0	0.017	0.0147	No	0	No
3/10/2023 8:20	0	0.018	0.0149	No	0	No
3/10/2023 8:21	0	0.016	0.015	No	0	No
3/10/2023 8:22	0	0.018	0.0153	No	0	No

Upwind Station						
Time	Instaneous VOC (ppm)	Instaneous Mass Conc. Total (mg/m ³)	Mass Conc. Total mg/m ³ AVG 15m (mg/m ³)	Dust Exceedance	VOC ppm AVG 15m (ppm)	VOC Exceedance
3/10/2023 8:23	0	0.018	0.0155	No	0	No
3/10/2023 8:24	0	0.022	0.0161	No	0	No
3/10/2023 8:25	0	0.016	0.0162	No	0	No
3/10/2023 8:26	0	0.016	0.0163	No	0	No
3/10/2023 8:27	0	0.016	0.0163	No	0	No
3/10/2023 8:28	0	0.019	0.0166	No	0	No
3/10/2023 8:29	0	0.022	0.0171	No	0	No
3/10/2023 8:30	0	0.016	0.0172	No	0	No
3/10/2023 8:31	0	0.021	0.0176	No	0	No
3/10/2023 8:32	0	0.017	0.0177	No	0	No
3/10/2023 8:33	0	0.017	0.0179	No	0	No
3/10/2023 8:34	0	0.018	0.018	No	0	No
3/10/2023 8:35	0	0.015	0.0178	No	0	No
3/10/2023 8:36	0	0.017	0.0179	No	0	No
3/10/2023 8:37	0	0.016	0.0177	No	0	No
3/10/2023 8:38	0	0.016	0.0176	No	0	No
3/10/2023 8:39	0	0.018	0.0173	No	0	No
3/10/2023 8:40	0	0.019	0.0175	No	0	No
3/10/2023 8:41	0	0.023	0.018	No	0	No
3/10/2023 8:42	0	0.019	0.0182	No	0	No
3/10/2023 8:43	0	0.018	0.0181	No	0	No
3/10/2023 8:44	0	0.017	0.0178	No	0	No
3/10/2023 8:45	0	0.016	0.0178	No	0	No
3/10/2023 8:46	0	0.015	0.0174	No	0	No
3/10/2023 8:47	0	0.016	0.0173	No	0	No
3/10/2023 8:48	0	0.017	0.0173	No	0	No
3/10/2023 8:49	0	0.017	0.0173	No	0	No
3/10/2023 8:50	0	0.018	0.0175	No	0	No
3/10/2023 8:51	0	0.016	0.0174	No	0	No
3/10/2023 8:52	0	0.015	0.0173	No	0	No
3/10/2023 8:53	0	0.017	0.0174	No	0	No
3/10/2023 8:54	0	0.016	0.0173	No	0	No
3/10/2023 8:55	0	0.018	0.0172	No	0	No
3/10/2023 8:56	0	0.031	0.0177	No	0	No
3/10/2023 8:57	0	0.021	0.0179	No	0	No
3/10/2023 8:58	0	0.016	0.0177	No	0	No
3/10/2023 8:59	0	0.023	0.0181	No	0	No
3/10/2023 9:00	0	0.018	0.0183	No	0	No
3/10/2023 9:01	0	0.023	0.0188	No	0	No
3/10/2023 9:02	0	0.026	0.0195	No	0	No
3/10/2023 9:03	0	0.019	0.0196	No	0	No
3/10/2023 9:04	0	0.017	0.0196	No	0	No
3/10/2023 9:05	0	0.019	0.0197	No	0	No
3/10/2023 9:06	0	0.018	0.0198	No	0	No
3/10/2023 9:07	0	0.016	0.0199	No	0	No
3/10/2023 9:08	0	0.015	0.0197	No	0	No
3/10/2023 9:09	0	0.018	0.0199	No	0	No
3/10/2023 9:10	0	0.034	0.0209	No	0	No
3/10/2023 9:11	0	0.028	0.0207	No	0	No
3/10/2023 9:12	0	0.022	0.0208	No	0	No
3/10/2023 9:13	0	0.018	0.0209	No	0	No
3/10/2023 9:14	0	0.017	0.0205	No	0	No

Upwind Station						
Time	Instaneous VOC (ppm)	Instaneous Mass Conc. Total (mg/m³)	Mass Conc. Total mg/m³ AVG 15m (mg/m³)	Dust Exceedance	VOC ppm AVG 15m (ppm)	VOC Exceedance
3/10/2023 9:15	0	0.035	0.0217	No	0	No
3/10/2023 9:16	0	0.036	0.0225	No	0	No
3/10/2023 9:17	0	0.025	0.0225	No	0	No
3/10/2023 9:18	0	0.023	0.0227	No	0	No
3/10/2023 9:19	0	0.025	0.0233	No	0	No
3/10/2023 9:20	0	0.024	0.0236	No	0	No
3/10/2023 9:21	0	0.05	0.0257	No	0	No
3/10/2023 9:22	0	0.031	0.0267	No	0	No
3/10/2023 9:23	0	0.029	0.0277	No	0	No
3/10/2023 9:24	0	0.026	0.0282	No	0	No
3/10/2023 9:25	0	0.018	0.0271	No	0	No
3/10/2023 9:26	0	0.018	0.0265	No	0	No
3/10/2023 9:27	0	0.017	0.0261	No	0	No
3/10/2023 9:28	0	0.019	0.0262	No	0	No
3/10/2023 9:29	0	0.017	0.0262	No	0	No
3/10/2023 9:30	0	0.021	0.0253	No	0	No
3/10/2023 9:31	0	0.021	0.0243	No	0	No
3/10/2023 9:32	0	0.019	0.0239	No	0	No
3/10/2023 9:33	0	0.021	0.0237	No	0	No
3/10/2023 9:34	0	0.021	0.0235	No	0	No
3/10/2023 9:35	0	0.022	0.0233	No	0	No
3/10/2023 9:36	0	0.018	0.0212	No	0	No
3/10/2023 9:37	0	0.018	0.0203	No	0	No
3/10/2023 9:38	0	0.019	0.0197	No	0	No
3/10/2023 9:39	0	0.018	0.0191	No	0	No
3/10/2023 9:40	0	0.02	0.0193	No	0	No
3/10/2023 9:41	0	0.02	0.0194	No	0	No
3/10/2023 9:42	0	0.021	0.0197	No	0	No
3/10/2023 9:43	0	0.018	0.0196	No	0	No
3/10/2023 9:44	0	0.019	0.0197	No	0	No
3/10/2023 9:45	0	0.019	0.0196	No	0	No
3/10/2023 9:46	0	0.018	0.0194	No	0	No
3/10/2023 9:47	0	0.028	0.02	No	0	No
3/10/2023 9:48	0	0.042	0.0214	No	0	No
3/10/2023 9:49	0	0.027	0.0218	No	0	No
3/10/2023 9:50	0	0.019	0.0216	No	0	No
3/10/2023 9:51	0	0.018	0.0216	No	0	No
3/10/2023 9:52	0	0.019	0.0217	No	0	No
3/10/2023 9:53	0	0.017	0.0215	No	0	No
3/10/2023 9:54	0	0.11	0.0277	No	0	No
3/10/2023 9:55	0	0.025	0.028	No	0	No
3/10/2023 9:56	0	0.021	0.0281	No	0	No
3/10/2023 9:57	0.031	0.025	0.0283	No	0.0021	No
3/10/2023 9:58	0	0.018	0.0283	No	0.0021	No
3/10/2023 9:59	0	0.018	0.0283	No	0.0021	No
3/10/2023 10:00	0	0.014	0.0279	No	0.0021	No
3/10/2023 10:01	0	0.016	0.0278	No	0.0021	No
3/10/2023 10:02	0	0.016	0.027	No	0.0021	No
3/10/2023 10:03	0	0.016	0.0253	No	0.0021	No
3/10/2023 10:04	0	0.015	0.0245	No	0.0021	No
3/10/2023 10:05	0	0.015	0.0242	No	0.0021	No
3/10/2023 10:06	0	0.016	0.0241	No	0.0021	No

Upwind Station						
Time	Instaneous VOC (ppm)	Instaneous Mass Conc. Total (mg/m³)	Mass Conc. Total mg/m³ AVG 15m (mg/m³)	Dust Exceedance	VOC ppm AVG 15m (ppm)	VOC Exceedance
3/10/2023 10:07	0	0.014	0.0237	No	0.0021	No
3/10/2023 10:08	0	0.016	0.0237	No	0.0021	No
3/10/2023 10:09	0	0.013	0.0172	No	0.0021	No
3/10/2023 10:10	0	0.013	0.0164	No	0.0021	No
3/10/2023 10:11	0	0.014	0.0159	No	0.0021	No
3/10/2023 10:12	0	0.013	0.0151	No	0	No
3/10/2023 10:13	0	0.014	0.0149	No	0	No
3/10/2023 10:14	0	0.017	0.0148	No	0	No
3/10/2023 10:15	0	0.016	0.0149	No	0	No
3/10/2023 10:16	0	0.018	0.0151	No	0	No
3/10/2023 10:17	0	0.017	0.0151	No	0	No
3/10/2023 10:18	0	0.014	0.015	No	0	No
3/10/2023 10:19	0	0.015	0.015	No	0	No
3/10/2023 10:20	0.034	0.017	0.0151	No	0.0023	No
3/10/2023 10:21	0	0.019	0.0153	No	0.0023	No
3/10/2023 10:22	0	0.016	0.0155	No	0.0023	No
3/10/2023 10:23	0	0.015	0.0154	No	0.0023	No
3/10/2023 10:24	0	0.015	0.0155	No	0.0023	No
3/10/2023 10:25	0	0.015	0.0157	No	0.0023	No
3/10/2023 10:26	0	0.016	0.0158	No	0.0023	No
3/10/2023 10:27	0	0.017	0.0161	No	0.0023	No
3/10/2023 10:28	0	0.019	0.0164	No	0.0023	No
3/10/2023 10:29	0	0.019	0.0165	No	0.0023	No
3/10/2023 10:30	0	0.018	0.0167	No	0.0023	No
3/10/2023 10:31	0	0.016	0.0165	No	0.0023	No
3/10/2023 10:32	0	0.015	0.0164	No	0.0023	No
3/10/2023 10:33	0	0.031	0.0175	No	0.0023	No
3/10/2023 10:34	0	0.019	0.0178	No	0.0023	No
3/10/2023 10:35	0	0.02	0.018	No	0	No
3/10/2023 10:36	0	0.017	0.0179	No	0	No
3/10/2023 10:37	0.195	0.016	0.0179	No	0.013	No
3/10/2023 10:38	0	0.016	0.0179	No	0.013	No
3/10/2023 10:39	0	0.014	0.0179	No	0.013	No
3/10/2023 10:40	0	0.014	0.0178	No	0.013	No
3/10/2023 10:41	0	0.015	0.0177	No	0.013	No
3/10/2023 10:42	0	0.017	0.0177	No	0.013	No
3/10/2023 10:43	0	0.013	0.0173	No	0.013	No
3/10/2023 10:44	0	0.014	0.017	No	0.013	No
3/10/2023 10:45	0	0.013	0.0167	No	0.013	No
3/10/2023 10:46	0	0.013	0.0165	No	0.013	No
3/10/2023 10:47	0	0.013	0.0163	No	0.013	No
3/10/2023 10:48	0	0.016	0.0153	No	0.013	No
3/10/2023 10:49	0	0.017	0.0152	No	0.013	No
3/10/2023 10:50	0	0.014	0.0148	No	0.013	No
3/10/2023 10:51	0	0.015	0.0147	No	0.013	No
3/10/2023 10:52	0	0.015	0.0146	No	0	No
3/10/2023 10:53	0	0.013	0.0144	No	0	No
3/10/2023 10:54	0	0.016	0.0145	No	0	No
3/10/2023 10:55	0	0.015	0.0146	No	0	No
3/10/2023 10:56	0	0.016	0.0147	No	0	No
3/10/2023 10:57	0	0.015	0.0145	No	0	No
3/10/2023 10:58	0	0.014	0.0146	No	0	No

Upwind Station						
Time	Instaneous VOC (ppm)	Instaneous Mass Conc. Total (mg/m ³)	Mass Conc. Total mg/m ³ AVG 15m (mg/m ³)	Dust Exceedance	VOC ppm AVG 15m (ppm)	VOC Exceedance
3/10/2023 10:59	0	0.015	0.0147	No	0	No
3/10/2023 11:00	0	0.015	0.0148	No	0	No
3/10/2023 11:01	0	0.014	0.0149	No	0	No
3/10/2023 11:02	0	0.013	0.0149	No	0	No
3/10/2023 11:03	0	0.014	0.0147	No	0	No
3/10/2023 11:04	0	0.011	0.0143	No	0	No
3/10/2023 11:05	0	0.012	0.0142	No	0	No
3/10/2023 11:06	0	0.013	0.0141	No	0	No
3/10/2023 11:07	0	0.012	0.0139	No	0	No
3/10/2023 11:08	0	0.013	0.0139	No	0	No
3/10/2023 11:09	0	0.014	0.0137	No	0	No
3/10/2023 11:10	0	0.014	0.0137	No	0	No
3/10/2023 11:11	0	0.017	0.0137	No	0	No
3/10/2023 11:12	0.004	0.015	0.0137	No	0.0003	No
3/10/2023 11:13	0	0.018	0.014	No	0.0003	No
3/10/2023 11:14	0	0.019	0.0143	No	0.0003	No
3/10/2023 11:15	0	0.013	0.0141	No	0.0003	No
3/10/2023 11:16	0.045	0.015	0.0142	No	0.0033	No
3/10/2023 11:17	0.082	0.015	0.0143	No	0.0087	No
3/10/2023 11:18	0.025	0.015	0.0144	No	0.0104	No
3/10/2023 11:19	0	0.015	0.0147	No	0.0104	No
3/10/2023 11:20	0	0.015	0.0149	No	0.0104	No
3/10/2023 11:21	0	0.013	0.0149	No	0.0104	No
3/10/2023 11:22	0	0.017	0.0152	No	0.0104	No
3/10/2023 11:23	0.048	0.018	0.0155	No	0.0136	No
3/10/2023 11:24	0	0.018	0.0158	No	0.0136	No
3/10/2023 11:25	0	0.017	0.016	No	0.0136	No
3/10/2023 11:26	0	0.016	0.0159	No	0.0136	No
3/10/2023 11:27	0	0.016	0.016	No	0.0133	No
3/10/2023 11:28	0.001	0.019	0.0161	No	0.0134	No
3/10/2023 11:29	0	0.019	0.0161	No	0.0134	No
3/10/2023 11:30	0	0.02	0.0165	No	0.0134	No
3/10/2023 11:31	0	0.022	0.017	No	0.0104	No
3/10/2023 11:32	0	0.019	0.0173	No	0.0049	No
3/10/2023 11:33	0	0.015	0.0173	No	0.0033	No
3/10/2023 11:34	0	0.014	0.0172	No	0.0033	No
3/10/2023 11:35	0.036	0.013	0.0171	No	0.0057	No
3/10/2023 11:36	0	0.015	0.0172	No	0.0057	No
3/10/2023 11:37	0	0.015	0.0171	No	0.0057	No
3/10/2023 11:38	0	0.014	0.0168	No	0.0025	No
3/10/2023 11:39	0	0.014	0.0165	No	0.0025	No
3/10/2023 11:40	0	0.014	0.0163	No	0.0025	No
3/10/2023 11:41	0	0.016	0.0163	No	0.0025	No
3/10/2023 11:42	0	0.022	0.0167	No	0.0025	No
3/10/2023 11:43	0.157	0.025	0.0171	No	0.0129	No
3/10/2023 11:44	0	0.02	0.0172	No	0.0129	No
3/10/2023 11:45	0	0.016	0.0169	No	0.0129	No
3/10/2023 11:46	0.01	0.015	0.0165	No	0.0135	No
3/10/2023 11:47	0	0.015	0.0162	No	0.0135	No
3/10/2023 11:48	0	0.017	0.0163	No	0.0135	No
3/10/2023 11:49	0	0.017	0.0165	No	0.0135	No
3/10/2023 11:50	0	0.015	0.0167	No	0.0111	No

Upwind Station						
Time	Instaneous VOC (ppm)	Instaneous Mass Conc. Total (mg/m ³)	Mass Conc. Total mg/m ³ AVG 15m (mg/m ³)	Dust Exceedance	VOC ppm AVG 15m (ppm)	VOC Exceedance
3/10/2023 11:51	0	0.019	0.0169	No	0.0111	No
3/10/2023 11:52	0	0.019	0.0172	No	0.0111	No
3/10/2023 11:53	0	0.018	0.0175	No	0.0111	No
3/10/2023 11:54	0	0.015	0.0175	No	0.0111	No
3/10/2023 11:55	0	0.016	0.0177	No	0.0111	No
3/10/2023 11:56	0	0.015	0.0176	No	0.0111	No
3/10/2023 11:57	0	0.017	0.0173	No	0.0111	No
3/10/2023 11:58	0	0.016	0.0167	No	0.001	No
3/10/2023 11:59	0	0.021	0.0167	No	0.001	No
3/10/2023 12:00	0	0.019	0.0169	No	0.001	No
3/10/2023 12:01	0	0.017	0.0171	No	0	No
3/10/2023 12:02	0	0.023	0.0176	No	0	No
3/10/2023 12:03	0	0.019	0.0177	No	0	No
3/10/2023 12:04	0	0.018	0.0178	No	0	No
3/10/2023 12:05	0.023	0.017	0.0179	No	0.0015	No
3/10/2023 12:06	0	0.016	0.0177	No	0.0015	No
3/10/2023 12:07	0	0.016	0.0175	No	0.0015	No
3/10/2023 12:08	0	0.016	0.0174	No	0.0015	No
3/10/2023 12:09	0	0.016	0.0175	No	0.0015	No
3/10/2023 12:10	0	0.017	0.0175	No	0.0015	No
3/10/2023 12:11	0	0.016	0.0176	No	0.0015	No
3/10/2023 12:12	0	0.018	0.0177	No	0.0015	No
3/10/2023 12:13	0	0.017	0.0177	No	0.0015	No
3/10/2023 12:14	0	0.016	0.0174	No	0.0015	No
3/10/2023 12:15	0	0.016	0.0172	No	0.0015	No
3/10/2023 12:16	0	0.016	0.0171	No	0.0015	No
3/10/2023 12:17	0	0.015	0.0166	No	0.0015	No
3/10/2023 12:18	0	0.016	0.0164	No	0.0015	No
3/10/2023 12:19	0	0.017	0.0163	No	0.0015	No
3/10/2023 12:20	0	0.018	0.0164	No	0	No
3/10/2023 12:21	0	0.018	0.0165	No	0	No
3/10/2023 12:22	0	0.017	0.0166	No	0	No
3/10/2023 12:23	0	0.018	0.0167	No	0	No
3/10/2023 12:24	0	0.02	0.017	No	0	No
3/10/2023 12:25	0	0.022	0.0173	No	0	No
3/10/2023 12:26	0	0.02	0.0176	No	0	No
3/10/2023 12:27	0	0.021	0.0178	No	0	No
3/10/2023 12:28	0	0.02	0.018	No	0	No
3/10/2023 12:29	0	0.019	0.0182	No	0	No
3/10/2023 12:30	0	0.018	0.0183	No	0	No
3/10/2023 12:31	0	0.018	0.0185	No	0	No
3/10/2023 12:32	0	0.017	0.0186	No	0	No
3/10/2023 12:33	0	0.019	0.0188	No	0	No
3/10/2023 12:34	0	0.018	0.0189	No	0	No
3/10/2023 12:35	0	0.023	0.0192	No	0	No
3/10/2023 12:36	0.006	0.021	0.0194	No	0.0004	No
3/10/2023 12:37	0	0.019	0.0195	No	0.0004	No
3/10/2023 12:38	0	0.02	0.0197	No	0.0004	No
3/10/2023 12:39	0	0.019	0.0196	No	0.0004	No
3/10/2023 12:40	0	0.019	0.0194	No	0.0004	No
3/10/2023 12:41	0	0.02	0.0194	No	0.0004	No
3/10/2023 12:42	0	0.02	0.0193	No	0.0004	No

Upwind Station						
Time	Instaneous VOC (ppm)	Instaneous Mass Conc. Total (mg/m ³)	Mass Conc. Total mg/m ³ AVG 15m (mg/m ³)	Dust Exceedance	VOC ppm AVG 15m (ppm)	VOC Exceedance
3/10/2023 12:43	0.016	0.02	0.0193	No	0.0015	No
3/10/2023 12:44	0	0.019	0.0193	No	0.0015	No
3/10/2023 12:45	0	0.019	0.0194	No	0.0015	No
3/10/2023 12:46	0	0.02	0.0195	No	0.0015	No
3/10/2023 12:47	0	0.019	0.0197	No	0.0015	No
3/10/2023 12:48	0	0.02	0.0197	No	0.0015	No
3/10/2023 12:49	0	0.02	0.0199	No	0.0015	No
3/10/2023 12:50	0.057	0.019	0.0196	No	0.0053	No
3/10/2023 12:51	0	0.019	0.0195	No	0.0049	No
3/10/2023 12:52	0	0.02	0.0195	No	0.0049	No
3/10/2023 12:53	0	0.021	0.0196	No	0.0049	No
3/10/2023 12:54	0	0.019	0.0196	No	0.0049	No
3/10/2023 12:55	0	0.019	0.0196	No	0.0049	No
3/10/2023 12:56	0	0.019	0.0195	No	0.0049	No
3/10/2023 12:57	0	0.019	0.0195	No	0.0049	No
3/10/2023 12:58	0	0.019	0.0194	No	0.0038	No
3/10/2023 12:59	0	0.029	0.0201	No	0.0038	No
3/10/2023 13:00	0	0.029	0.0207	No	0.0038	No
3/10/2023 13:01	0	0.022	0.0209	No	0.0038	No
3/10/2023 13:02	0	0.023	0.0211	No	0.0038	No
3/10/2023 13:03	0	0.021	0.0212	No	0.0038	No
3/10/2023 13:04	0	0.019	0.0211	No	0.0038	No
3/10/2023 13:05	0	0.023	0.0214	No	0	No
3/10/2023 13:06	0	0.02	0.0215	No	0	No
3/10/2023 13:07	0	0.02	0.0215	No	0	No
3/10/2023 13:08	0	0.021	0.0215	No	0	No
3/10/2023 13:09	0	0.02	0.0215	No	0	No
3/10/2023 13:10	0	0.022	0.0217	No	0	No
3/10/2023 13:11	0	0.024	0.0221	No	0	No
3/10/2023 13:12	0	0.021	0.0222	No	0	No
3/10/2023 13:13	0	0.021	0.0223	No	0	No
3/10/2023 13:14	0	0.021	0.0218	No	0	No
3/10/2023 13:15	0	0.02	0.0212	No	0	No
3/10/2023 13:16	0	0.021	0.0211	No	0	No
3/10/2023 13:17	0	0.02	0.0209	No	0	No
3/10/2023 13:18	0	0.02	0.0209	No	0	No
3/10/2023 13:19	0	0.019	0.0209	No	0	No
3/10/2023 13:20	0	0.018	0.0205	No	0	No
3/10/2023 13:21	0	0.019	0.0205	No	0	No
3/10/2023 13:22	0	0.02	0.0205	No	0	No
3/10/2023 13:23	0	0.019	0.0203	No	0	No
3/10/2023 13:24	0	0.021	0.0204	No	0	No
3/10/2023 13:25	0	0.021	0.0203	No	0	No
3/10/2023 13:26	0	0.022	0.0202	No	0	No
3/10/2023 13:27	0	0.021	0.0202	No	0	No
3/10/2023 13:28	0	0.021	0.0202	No	0	No
3/10/2023 13:29	0	0.021	0.0202	No	0	No
3/10/2023 13:30	0	0.021	0.0203	No	0	No
3/10/2023 13:31	0	0.02	0.0202	No	0	No
3/10/2023 13:32	0	0.021	0.0203	No	0	No
3/10/2023 13:33	0	0.025	0.0206	No	0	No
3/10/2023 13:34	0	0.02	0.0207	No	0	No

Upwind Station						
Time	Instaneous VOC (ppm)	Instaneous Mass Conc. Total (mg/m ³)	Mass Conc. Total mg/m ³ AVG 15m (mg/m ³)	Dust Exceedance	VOC ppm AVG 15m (ppm)	VOC Exceedance
3/10/2023 13:35	0	0.02	0.0208	No	0	No
3/10/2023 13:36	0	0.02	0.0209	No	0	No
3/10/2023 13:37	0	0.021	0.0209	No	0	No
3/10/2023 13:38	0	0.019	0.0209	No	0	No
3/10/2023 13:39	0	0.019	0.0208	No	0	No
3/10/2023 13:40	0	0.019	0.0207	No	0	No
3/10/2023 13:41	0	0.019	0.0205	No	0	No
3/10/2023 13:42	0	0.02	0.0204	No	0	No
3/10/2023 13:43	0	0.02	0.0203	No	0	No
3/10/2023 13:44	0	0.019	0.0202	No	0	No
3/10/2023 13:45	0	0.02	0.0201	No	0	No
3/10/2023 13:46	0	0.019	0.0201	No	0	No
3/10/2023 13:47	0	0.019	0.0199	No	0	No
3/10/2023 13:48	0	0.019	0.0195	No	0	No
3/10/2023 13:49	0	0.019	0.0195	No	0	No
3/10/2023 13:50	0	0.02	0.0195	No	0	No
3/10/2023 13:51	0	0.02	0.0195	No	0	No
3/10/2023 13:52	0	0.022	0.0195	No	0	No
3/10/2023 13:53	0	0.02	0.0196	No	0	No
3/10/2023 13:54	0	0.02	0.0197	No	0	No
3/10/2023 13:55	0	0.019	0.0197	No	0	No
3/10/2023 13:56	0	0.019	0.0197	No	0	No
3/10/2023 13:57	0	0.021	0.0197	No	0	No
3/10/2023 13:58	0	0.021	0.0198	No	0	No
3/10/2023 13:59	0	0.022	0.02	No	0	No
3/10/2023 14:00	0	0.02	0.02	No	0	No
3/10/2023 14:01	0	0.025	0.0204	No	0	No
3/10/2023 14:02	0	0.019	0.0204	No	0	No
3/10/2023 14:03	0	0.018	0.0203	No	0	No
3/10/2023 14:04	0	0.018	0.0203	No	0	No
3/10/2023 14:05	0	0.017	0.0201	No	0	No
3/10/2023 14:06	0	0.018	0.0199	No	0	No
3/10/2023 14:07	0	0.018	0.0197	No	0	No
3/10/2023 14:08	0	0.017	0.0195	No	0	No
3/10/2023 14:09	0	0.017	0.0193	No	0	No
3/10/2023 14:10	0	0.017	0.0191	No	0	No
3/10/2023 14:11	0	0.019	0.0191	No	0	No
3/10/2023 14:12	0	0.021	0.0191	No	0	No
3/10/2023 14:13	0	0.021	0.0191	No	0	No
3/10/2023 14:14	0	0.021	0.0191	No	0	No
3/10/2023 14:15	0	0.023	0.0193	No	0	No
3/10/2023 14:16	0	0.021	0.019	No	0	No
3/10/2023 14:17	0	0.022	0.0192	No	0	No
3/10/2023 14:18	0	0.02	0.0193	No	0	No
3/10/2023 14:19	0	0.02	0.0195	No	0	No
3/10/2023 14:20	0	0.022	0.0198	No	0	No
3/10/2023 14:21	0	0.022	0.0201	No	0	No
3/10/2023 14:22	0	0.021	0.0203	No	0	No
3/10/2023 14:23	0	0.021	0.0205	No	0	No
3/10/2023 14:24	0	0.022	0.0209	No	0	No
3/10/2023 14:25	0	0.023	0.0213	No	0	No
3/10/2023 14:26	0	0.021	0.0214	No	0	No

Upwind Station						
Time	Instaneous VOC (ppm)	Instaneous Mass Conc. Total (mg/m ³)	Mass Conc. Total mg/m ³ AVG 15m (mg/m ³)	Dust Exceedance	VOC ppm AVG 15m (ppm)	VOC Exceedance
3/10/2023 14:27	0	0.027	0.0218	No	0	No
3/10/2023 14:28	0	0.021	0.0218	No	0	No
3/10/2023 14:29	0	0.019	0.0217	No	0	No
3/10/2023 14:30	0	0.02	0.0215	No	0	No
3/10/2023 14:31	0	0.02	0.0214	No	0	No
3/10/2023 14:32	0	0.021	0.0213	No	0	No
3/10/2023 14:33	0	0.022	0.0215	No	0	No
3/10/2023 14:34	0	0.024	0.0217	No	0	No
3/10/2023 14:35	0	0.024	0.0219	No	0	No
3/10/2023 14:36	0	0.021	0.0218	No	0	No
3/10/2023 14:37	0	0.019	0.0217	No	0	No
3/10/2023 14:38	0	0.021	0.0217	No	0	No
3/10/2023 14:39	0	0.039	0.0228	No	0	No
3/10/2023 14:40	0	0.028	0.0231	No	0	No
3/10/2023 14:41	0	0.021	0.0231	No	0	No
3/10/2023 14:42	0	0.02	0.0227	No	0	No
3/10/2023 14:43	0	0.02	0.0226	No	0	No
3/10/2023 14:44	0	0.021	0.0227	No	0	No
3/10/2023 14:45	0	0.021	0.0228	No	0	No
3/10/2023 14:46	0	0.02	0.0228	No	0	No
3/10/2023 14:47	0	0.018	0.0226	No	0	No
3/10/2023 14:48	0	0.018	0.0223	No	0	No
3/10/2023 14:49	0	0.019	0.022	No	0	No
3/10/2023 14:50	0	0.019	0.0217	No	0	No
3/10/2023 14:51	0	0.02	0.0216	No	0	No
3/10/2023 14:52	0	0.025	0.022	No	0	No
3/10/2023 14:53	0	0.023	0.0221	No	0	No
3/10/2023 14:54	0	0.023	0.0211	No	0	No
3/10/2023 14:55	0	0.023	0.0207	No	0	No
3/10/2023 14:56	0	0.023	0.0209	No	0	No
3/10/2023 14:57	0	0.024	0.0211	No	0	No
3/10/2023 14:58	0	0.022	0.0213	No	0	No
3/10/2023 14:59	0	0.02	0.0212	No	0	No
3/10/2023 15:00	0	0.022	0.0213	No	0	No
3/10/2023 15:01	0	0.02	0.0213	No	0	No
3/10/2023 15:02	0	0.02	0.0214	No	0	No
3/10/2023 15:03	0	0.02	0.0215	No	0	No
3/10/2023 15:04	0	0.019	0.0215	No	0	No
3/10/2023 15:05	0	0.021	0.0217	No	0	No
3/10/2023 15:06	0	0.024	0.0219	No	0	No
3/10/2023 15:07	0	0.022	0.0217	No	0	No
3/10/2023 15:08	0	0.027	0.022	No	0	No
3/10/2023 15:09	0	0.022	0.0219	No	0	No
3/10/2023 15:10	0	0.025	0.0221	No	0	No

Downwind Station						
Time	Instaneous VOC (ppm)	Instaneous Mass Conc. Total (mg/m ³)	Mass Conc. Total mg/m ³ AVG 15m (mg/m ³)	Dust Exceedance	VOC ppm AVG 15m (ppm)	VOC Exceedance
3/10/2023 7:35	0	0.015	0.015	No	0	No
3/10/2023 7:36	0	0.017	0.016	No	0	No
3/10/2023 7:37	0	0.015	0.0157	No	0	No
3/10/2023 7:38	0	0.015	0.0155	No	0	No
3/10/2023 7:39	0	0.017	0.0158	No	0	No
3/10/2023 7:40	0	0.019	0.0163	No	0	No
3/10/2023 7:41	0	0.019	0.0167	No	0	No
3/10/2023 7:42	0	0.018	0.0169	No	0	No
3/10/2023 7:43	0	0.017	0.0169	No	0	No
3/10/2023 7:44	0	0.018	0.017	No	0	No
3/10/2023 7:45	0	0.019	0.0172	No	0	No
3/10/2023 7:46	0	0.02	0.0174	No	0	No
3/10/2023 7:47	0	0.021	0.0177	No	0	No
3/10/2023 7:48	0	0.019	0.0178	No	0	No
3/10/2023 7:49	0	0.018	0.0178	No	0	No
3/10/2023 7:50	0	0.017	0.0179	No	0	No
3/10/2023 7:51	0	0.019	0.0181	No	0	No
3/10/2023 7:52	0	0.018	0.0183	No	0	No
3/10/2023 7:53	0	0.019	0.0185	No	0	No
3/10/2023 7:54	0	0.019	0.0187	No	0	No
3/10/2023 7:55	0	0.021	0.0188	No	0	No
3/10/2023 7:56	0	0.022	0.019	No	0	No
3/10/2023 7:57	0	0.019	0.0191	No	0	No
3/10/2023 7:58	0	0.018	0.0191	No	0	No
3/10/2023 7:59	0	0.017	0.0191	No	0	No
3/10/2023 8:00	0	0.017	0.0189	No	0	No
3/10/2023 8:01	0	0.016	0.0187	No	0	No
3/10/2023 8:02	0	0.016	0.0183	No	0	No
3/10/2023 8:03	0	0.017	0.0182	No	0	No
3/10/2023 8:04	0	0.016	0.0181	No	0	No
3/10/2023 8:05	0	0.016	0.018	No	0	No
3/10/2023 8:06	0	0.015	0.0177	No	0	No
3/10/2023 8:07	0	0.015	0.0175	No	0	No
3/10/2023 8:08	0	0.015	0.0173	No	0	No
3/10/2023 8:09	0	0.015	0.017	No	0	No
3/10/2023 8:10	0	0.015	0.0166	No	0	No
3/10/2023 8:11	0	0.016	0.0162	No	0	No
3/10/2023 8:12	0	0.015	0.0159	No	0	No
3/10/2023 8:13	0	0.015	0.0157	No	0	No
3/10/2023 8:14	0	0.014	0.0155	No	0	No
3/10/2023 8:15	0	0.015	0.0154	No	0	No
3/10/2023 8:16	0	0.014	0.0153	No	0	No
3/10/2023 8:17	0	0.015	0.0152	No	0	No
3/10/2023 8:18	0	0.016	0.0151	No	0	No
3/10/2023 8:19	0	0.015	0.0151	No	0	No
3/10/2023 8:20	0	0.017	0.0151	No	0	No
3/10/2023 8:21	0	0.016	0.0152	No	0	No
3/10/2023 8:22	0	0.017	0.0153	No	0	No
3/10/2023 8:23	0	0.016	0.0154	No	0	No
3/10/2023 8:24	0	0.018	0.0156	No	0	No
3/10/2023 8:25	0	0.016	0.0157	No	0	No
3/10/2023 8:26	0	0.014	0.0155	No	0	No
3/10/2023 8:27	0	0.017	0.0157	No	0	No
3/10/2023 8:28	0	0.019	0.0159	No	0	No

Downwind Station						
Time	Instantaneous VOC (ppm)	Instantaneous Mass Conc. Total (mg/m ³)	Mass Conc. Total mg/m ³ AVG 15m (mg/m ³)	Dust Exceedance	VOC ppm AVG 15m (ppm)	VOC Exceedance
3/10/2023 8:29	0	0.019	0.0163	No	0	No
3/10/2023 8:30	0	0.015	0.0163	No	0	No
3/10/2023 8:31	0	0.017	0.0165	No	0	No
3/10/2023 8:32	0	0.017	0.0166	No	0	No
3/10/2023 8:33	0	0.015	0.0165	No	0	No
3/10/2023 8:34	0	0.016	0.0166	No	0	No
3/10/2023 8:35	0	0.015	0.0165	No	0	No
3/10/2023 8:36	0	0.016	0.0165	No	0	No
3/10/2023 8:37	0	0.016	0.0164	No	0	No
3/10/2023 8:38	0	0.017	0.0165	No	0	No
3/10/2023 8:39	0	0.017	0.0164	No	0	No
3/10/2023 8:40	0	0.017	0.0165	No	0	No
3/10/2023 8:41	0	0.018	0.0167	No	0	No
3/10/2023 8:42	0	0.019	0.0169	No	0	No
3/10/2023 8:43	0	0.019	0.0169	No	0	No
3/10/2023 8:44	0	0.018	0.0168	No	0	No
3/10/2023 8:45	0	0.018	0.017	No	0	No
3/10/2023 8:46	0	0.024	0.0175	No	0	No
3/10/2023 8:47	0	0.017	0.0175	No	0	No
3/10/2023 8:48	0	0.018	0.0177	No	0	No
3/10/2023 8:49	0	0.017	0.0177	No	0	No
3/10/2023 8:50	0	0.017	0.0179	No	0	No
3/10/2023 8:51	0	0.016	0.0179	No	0	No
3/10/2023 8:52	0	0.016	0.0179	No	0	No
3/10/2023 8:53	0	0.016	0.0178	No	0	No
3/10/2023 8:54	0	0.016	0.0177	No	0	No
3/10/2023 8:55	0	0.016	0.0177	No	0	No
3/10/2023 8:56	0	0.02	0.0178	No	0	No
3/10/2023 8:57	0	0.022	0.018	No	0	No
3/10/2023 8:58	0	0.016	0.0178	No	0	No
3/10/2023 8:59	0	0.016	0.0177	No	0	No
3/10/2023 9:00	0	0.017	0.0176	No	0	No
3/10/2023 9:01	0	0.02	0.0173	No	0	No
3/10/2023 9:02	0	0.023	0.0177	No	0	No
3/10/2023 9:03	0	0.015	0.0175	No	0	No
3/10/2023 9:04	0	0.017	0.0175	No	0	No
3/10/2023 9:05	0	0.017	0.0175	No	0	No
3/10/2023 9:06	0	0.016	0.0175	No	0	No
3/10/2023 9:07	0	0.017	0.0176	No	0	No
3/10/2023 9:08	0	0.014	0.0175	No	0	No
3/10/2023 9:09	0	0.021	0.0178	No	0	No
3/10/2023 9:10	0	0.033	0.0189	No	0	No
3/10/2023 9:11	0	0.025	0.0193	No	0	No
3/10/2023 9:12	0	0.024	0.0194	No	0	No
3/10/2023 9:13	0	0.021	0.0197	No	0	No
3/10/2023 9:14	0	0.016	0.0197	No	0	No
3/10/2023 9:15	0	0.018	0.0198	No	0	No
3/10/2023 9:16	0	0.026	0.0202	No	0	No
3/10/2023 9:17	0	0.019	0.0199	No	0	No
3/10/2023 9:18	0	0.019	0.0202	No	0	No
3/10/2023 9:19	0	0.02	0.0204	No	0	No
3/10/2023 9:20	0	0.02	0.0206	No	0	No
3/10/2023 9:21	0	0.034	0.0218	No	0	No
3/10/2023 9:22	0	0.035	0.023	No	0	No

Downwind Station						
Time	Instaneous VOC (ppm)	Instaneous Mass Conc. Total (mg/m ³)	Mass Conc. Total mg/m ³ AVG 15m (mg/m ³)	Dust Exceedance	VOC ppm AVG 15m (ppm)	VOC Exceedance
3/10/2023 9:23	0	0.024	0.0237	No	0	No
3/10/2023 9:24	0	0.02	0.0236	No	0	No
3/10/2023 9:25	0	0.017	0.0225	No	0	No
3/10/2023 9:26	0	0.016	0.0219	No	0	No
3/10/2023 9:27	0	0.016	0.0214	No	0	No
3/10/2023 9:28	0	0.017	0.0211	No	0	No
3/10/2023 9:29	0	0.022	0.0215	No	0	No
3/10/2023 9:30	0	0.025	0.022	No	0	No
3/10/2023 9:31	0	0.018	0.0215	No	0	No
3/10/2023 9:32	0	0.017	0.0213	No	0	No
3/10/2023 9:33	0	0.018	0.0213	No	0	No
3/10/2023 9:34	0	0.019	0.0212	No	0	No
3/10/2023 9:35	0	0.017	0.021	No	0	No
3/10/2023 9:36	0	0.016	0.0198	No	0	No
3/10/2023 9:37	0	0.016	0.0185	No	0	No
3/10/2023 9:38	0	0.018	0.0181	No	0	No
3/10/2023 9:39	0	0.018	0.018	No	0	No
3/10/2023 9:40	0	0.019	0.0181	No	0	No
3/10/2023 9:41	0	0.019	0.0183	No	0	No
3/10/2023 9:42	0	0.019	0.0185	No	0	No
3/10/2023 9:43	0	0.019	0.0187	No	0	No
3/10/2023 9:44	0	0.018	0.0184	No	0	No
3/10/2023 9:45	0	0.018	0.0179	No	0	No
3/10/2023 9:46	0	0.016	0.0178	No	0	No
3/10/2023 9:47	0	0.023	0.0182	No	0	No
3/10/2023 9:48	0	0.023	0.0185	No	0	No
3/10/2023 9:49	0	0.021	0.0187	No	0	No
3/10/2023 9:50	0	0.019	0.0188	No	0	No
3/10/2023 9:51	0	0.018	0.0189	No	0	No
3/10/2023 9:52	0	0.019	0.0191	No	0	No
3/10/2023 9:53	0	0.016	0.019	No	0	No
3/10/2023 9:54	0	0.015	0.0188	No	0	No
3/10/2023 9:55	0	0.017	0.0187	No	0	No
3/10/2023 9:56	0	0.019	0.0187	No	0	No
3/10/2023 9:57	0	0.019	0.0187	No	0	No
3/10/2023 9:58	0	0.019	0.0187	No	0	No
3/10/2023 9:59	0	0.014	0.0184	No	0	No
3/10/2023 10:00	0	0.013	0.0181	No	0	No
3/10/2023 10:01	0	0.012	0.0178	No	0	No
3/10/2023 10:02	0	0.013	0.0171	No	0	No
3/10/2023 10:03	0	0.012	0.0164	No	0	No
3/10/2023 10:04	0	0.014	0.0159	No	0	No
3/10/2023 10:05	0	0.013	0.0155	No	0	No
3/10/2023 10:06	0	0.014	0.0153	No	0	No
3/10/2023 10:07	0	0.013	0.0149	No	0	No
3/10/2023 10:08	0	0.014	0.0147	No	0	No
3/10/2023 10:09	0	0.012	0.0145	No	0	No
3/10/2023 10:10	0	0.012	0.0142	No	0	No
3/10/2023 10:11	0	0.012	0.0137	No	0	No
3/10/2023 10:12	0	0.012	0.0133	No	0	No
3/10/2023 10:13	0	0.013	0.0129	No	0	No
3/10/2023 10:14	0	0.016	0.013	No	0	No
3/10/2023 10:15	0	0.015	0.0131	No	0	No
3/10/2023 10:16	0	0.018	0.0135	No	0	No

Downwind Station						
Time	Instantaneous VOC (ppm)	Instantaneous Mass Conc. Total (mg/m ³)	Mass Conc. Total mg/m ³ AVG 15m (mg/m ³)	Dust Exceedance	VOC ppm AVG 15m (ppm)	VOC Exceedance
3/10/2023 10:17	0	0.018	0.0139	No	0	No
3/10/2023 10:18	0	0.016	0.0141	No	0	No
3/10/2023 10:19	0	0.015	0.0142	No	0	No
3/10/2023 10:20	0	0.019	0.0146	No	0	No
3/10/2023 10:21	0	0.019	0.0149	No	0	No
3/10/2023 10:22	0	0.014	0.015	No	0	No
3/10/2023 10:23	0	0.013	0.0149	No	0	No
3/10/2023 10:24	0	0.013	0.015	No	0	No
3/10/2023 10:25	0	0.013	0.0151	No	0	No
3/10/2023 10:26	0	0.013	0.0151	No	0	No
3/10/2023 10:27	0	0.016	0.0154	No	0	No
3/10/2023 10:28	0	0.019	0.0158	No	0	No
3/10/2023 10:29	0	0.018	0.0159	No	0	No
3/10/2023 10:30	0	0.016	0.016	No	0	No
3/10/2023 10:31	0	0.018	0.016	No	0	No
3/10/2023 10:32	0	0.015	0.0158	No	0	No
3/10/2023 10:33	0.014	0.017	0.0159	No	0.0009	No
3/10/2023 10:34	0	0.018	0.0161	No	0.0009	No
3/10/2023 10:35	0	0.016	0.0159	No	0.0009	No
3/10/2023 10:36	0.068	0.018	0.0158	No	0.0055	No
3/10/2023 10:37	0.116	0.057	0.0187	No	0.0132	No
3/10/2023 10:38	0	0.028	0.0197	No	0.0132	No
3/10/2023 10:39	0	0.025	0.0205	No	0.0132	No
3/10/2023 10:40	0	0.035	0.0219	No	0.0132	No
3/10/2023 10:41	0	0.016	0.0221	No	0.0132	No
3/10/2023 10:42	0	0.016	0.0221	No	0.0132	No
3/10/2023 10:43	0	0.016	0.0219	No	0.0132	No
3/10/2023 10:44	0	0.018	0.0219	No	0.0132	No
3/10/2023 10:45	0	0.017	0.022	No	0.0132	No
3/10/2023 10:46	0	0.016	0.0219	No	0.0132	No
3/10/2023 10:47	0	0.017	0.022	No	0.0132	No
3/10/2023 10:48	0	0.017	0.022	No	0.0123	No
3/10/2023 10:49	0	0.017	0.0219	No	0.0123	No
3/10/2023 10:50	0	0.019	0.0221	No	0.0123	No
3/10/2023 10:51	0	0.017	0.0221	No	0.0077	No
3/10/2023 10:52	0	0.018	0.0195	No	0	No
3/10/2023 10:53	0	0.018	0.0188	No	0	No
3/10/2023 10:54	0	0.017	0.0183	No	0	No
3/10/2023 10:55	0	0.017	0.0171	No	0	No
3/10/2023 10:56	0	0.019	0.0173	No	0	No
3/10/2023 10:57	0	0.02	0.0175	No	0	No
3/10/2023 10:58	0.021	0.019	0.0177	No	0.0014	No
3/10/2023 10:59	0	0.02	0.0179	No	0.0014	No
3/10/2023 11:00	0	0.018	0.0179	No	0.0014	No
3/10/2023 11:01	0	0.019	0.0181	No	0.0014	No
3/10/2023 11:02	0	0.02	0.0183	No	0.0014	No
3/10/2023 11:03	0	0.019	0.0185	No	0.0014	No
3/10/2023 11:04	0	0.017	0.0185	No	0.0014	No
3/10/2023 11:05	0	0.017	0.0183	No	0.0014	No
3/10/2023 11:06	0	0.018	0.0184	No	0.0014	No
3/10/2023 11:07	0	0.017	0.0183	No	0.0014	No
3/10/2023 11:08	0	0.018	0.0183	No	0.0014	No
3/10/2023 11:09	0	0.018	0.0184	No	0.0014	No
3/10/2023 11:10	0	0.019	0.0185	No	0.0014	No

Downwind Station						
Time	Instaneous VOC (ppm)	Instaneous Mass Conc. Total (mg/m ³)	Mass Conc. Total mg/m ³ AVG 15m (mg/m ³)	Dust Exceedance	VOC ppm AVG 15m (ppm)	VOC Exceedance
3/10/2023 11:11	0	0.021	0.0187	No	0.0014	No
3/10/2023 11:12	0	0.021	0.0187	No	0.0014	No
3/10/2023 11:13	0	0.02	0.0188	No	0	No
3/10/2023 11:14	0	0.024	0.0191	No	0	No
3/10/2023 11:15	0	0.021	0.0193	No	0	No
3/10/2023 11:16	0	0.021	0.0194	No	0	No
3/10/2023 11:17	0	0.025	0.0197	No	0	No
3/10/2023 11:18	0.028	0.018	0.0197	No	0.0019	No
3/10/2023 11:19	0	0.018	0.0197	No	0.0019	No
3/10/2023 11:20	0	0.02	0.0199	No	0.0019	No
3/10/2023 11:21	0	0.018	0.0199	No	0.0019	No
3/10/2023 11:22	0	0.02	0.0201	No	0.0019	No
3/10/2023 11:23	0	0.023	0.0205	No	0.0019	No
3/10/2023 11:24	0	0.022	0.0207	No	0.0019	No
3/10/2023 11:25	0	0.021	0.0209	No	0.0019	No
3/10/2023 11:26	0	0.021	0.0209	No	0.0019	No
3/10/2023 11:27	0	0.02	0.0208	No	0.0019	No
3/10/2023 11:28	0	0.025	0.0211	No	0.0019	No
3/10/2023 11:29	0	0.028	0.0214	No	0.0019	No
3/10/2023 11:30	0	0.021	0.0214	No	0.0019	No
3/10/2023 11:31	0	0.022	0.0215	No	0.0019	No
3/10/2023 11:32	0	0.021	0.0212	No	0.0019	No
3/10/2023 11:33	0	0.019	0.0213	No	0	No
3/10/2023 11:34	0	0.017	0.0212	No	0	No
3/10/2023 11:35	0	0.016	0.0209	No	0	No
3/10/2023 11:36	0	0.018	0.0209	No	0	No
3/10/2023 11:37	0	0.019	0.0209	No	0	No
3/10/2023 11:38	0	0.018	0.0205	No	0	No
3/10/2023 11:39	0	0.018	0.0203	No	0	No
3/10/2023 11:40	0	0.018	0.0201	No	0	No
3/10/2023 11:41	0	0.018	0.0199	No	0	No
3/10/2023 11:42	0	0.02	0.0199	No	0	No
3/10/2023 11:43	0	0.021	0.0196	No	0	No
3/10/2023 11:44	0	0.029	0.0197	No	0	No
3/10/2023 11:45	0	0.02	0.0196	No	0	No
3/10/2023 11:46	0	0.018	0.0193	No	0	No
3/10/2023 11:47	0	0.016	0.019	No	0	No
3/10/2023 11:48	0	0.017	0.0189	No	0	No
3/10/2023 11:49	0	0.018	0.0189	No	0	No
3/10/2023 11:50	0	0.02	0.0192	No	0	No
3/10/2023 11:51	0	0.02	0.0193	No	0	No
3/10/2023 11:52	0	0.021	0.0195	No	0	No
3/10/2023 11:53	0	0.023	0.0198	No	0	No
3/10/2023 11:54	0	0.02	0.0199	No	0	No
3/10/2023 11:55	0	0.019	0.02	No	0	No
3/10/2023 11:56	0	0.02	0.0201	No	0	No
3/10/2023 11:57	0	0.02	0.0201	No	0	No
3/10/2023 11:58	0	0.021	0.0201	No	0	No
3/10/2023 11:59	0	0.023	0.0197	No	0	No
3/10/2023 12:00	0	0.023	0.0199	No	0	No
3/10/2023 12:01	0	0.022	0.0202	No	0	No
3/10/2023 12:02	0	0.019	0.0204	No	0	No
3/10/2023 12:03	0	0.021	0.0207	No	0	No
3/10/2023 12:04	0	0.019	0.0207	No	0	No

Downwind Station						
Time	Instaneous VOC (ppm)	Instaneous Mass Conc. Total (mg/m ³)	Mass Conc. Total mg/m ³ AVG 15m (mg/m ³)	Dust Exceedance	VOC ppm AVG 15m (ppm)	VOC Exceedance
3/10/2023 12:05	0	0.019	0.0207	No	0	No
3/10/2023 12:06	0	0.019	0.0206	No	0	No
3/10/2023 12:07	0	0.02	0.0205	No	0	No
3/10/2023 12:08	0	0.019	0.0203	No	0	No
3/10/2023 12:09	0	0.019	0.0202	No	0	No
3/10/2023 12:10	0	0.02	0.0203	No	0	No
3/10/2023 12:11	0	0.021	0.0203	No	0	No
3/10/2023 12:12	0	0.022	0.0205	No	0	No
3/10/2023 12:13	0	0.023	0.0206	No	0	No
3/10/2023 12:14	0	0.021	0.0205	No	0	No
3/10/2023 12:15	0	0.02	0.0203	No	0	No
3/10/2023 12:16	0	0.021	0.0202	No	0	No
3/10/2023 12:17	0	0.019	0.0202	No	0	No
3/10/2023 12:18	0	0.019	0.0201	No	0	No
3/10/2023 12:19	0	0.021	0.0202	No	0	No
3/10/2023 12:20	0	0.021	0.0203	No	0	No
3/10/2023 12:21	0	0.023	0.0206	No	0	No
3/10/2023 12:22	0	0.021	0.0207	No	0	No
3/10/2023 12:23	0	0.022	0.0209	No	0	No
3/10/2023 12:24	0	0.022	0.0211	No	0	No
3/10/2023 12:25	0	0.024	0.0213	No	0	No
3/10/2023 12:26	0	0.024	0.0215	No	0	No
3/10/2023 12:27	0	0.026	0.0218	No	0	No
3/10/2023 12:28	0	0.023	0.0218	No	0	No
3/10/2023 12:29	0	0.025	0.0221	No	0	No
3/10/2023 12:30	0	0.024	0.0223	No	0	No
3/10/2023 12:31	0	0.023	0.0225	No	0	No
3/10/2023 12:32	0	0.022	0.0227	No	0	No
3/10/2023 12:33	0	0.023	0.0229	No	0	No
3/10/2023 12:34	0	0.024	0.0231	No	0	No
3/10/2023 12:35	0	0.025	0.0234	No	0	No
3/10/2023 12:36	0	0.025	0.0235	No	0	No
3/10/2023 12:37	0	0.025	0.0238	No	0	No
3/10/2023 12:38	0	0.024	0.0239	No	0	No
3/10/2023 12:39	0	0.023	0.024	No	0	No
3/10/2023 12:40	0	0.023	0.0239	No	0	No
3/10/2023 12:41	0	0.023	0.0239	No	0	No
3/10/2023 12:42	0	0.023	0.0237	No	0	No
3/10/2023 12:43	0	0.023	0.0237	No	0	No
3/10/2023 12:44	0	0.025	0.0237	No	0	No
3/10/2023 12:45	0	0.024	0.0237	No	0	No
3/10/2023 12:46	0	0.023	0.0237	No	0	No
3/10/2023 12:47	0	0.025	0.0239	No	0	No
3/10/2023 12:48	0	0.025	0.024	No	0	No
3/10/2023 12:49	0	0.026	0.0241	No	0	No
3/10/2023 12:50	0	0.025	0.0241	No	0	No
3/10/2023 12:51	0	0.024	0.0241	No	0	No
3/10/2023 12:52	0	0.022	0.0239	No	0	No
3/10/2023 12:53	0	0.022	0.0237	No	0	No
3/10/2023 12:54	0	0.023	0.0237	No	0	No
3/10/2023 12:55	0	0.024	0.0238	No	0	No
3/10/2023 12:56	0	0.024	0.0239	No	0	No
3/10/2023 12:57	0	0.023	0.0239	No	0	No
3/10/2023 12:58	0	0.023	0.0239	No	0	No

Downwind Station						
Time	Instaneous VOC (ppm)	Instaneous Mass Conc. Total (mg/m ³)	Mass Conc. Total mg/m ³ AVG 15m (mg/m ³)	Dust Exceedance	VOC ppm AVG 15m (ppm)	VOC Exceedance
3/10/2023 12:59	0	0.023	0.0237	No	0	No
3/10/2023 13:00	0	0.026	0.0239	No	0	No
3/10/2023 13:01	0	0.027	0.0241	No	0	No
3/10/2023 13:02	0	0.027	0.0243	No	0	No
3/10/2023 13:03	0	0.026	0.0243	No	0	No
3/10/2023 13:04	0	0.026	0.0243	No	0	No
3/10/2023 13:05	0	0.025	0.0243	No	0	No
3/10/2023 13:06	0	0.025	0.0244	No	0	No
3/10/2023 13:07	0	0.025	0.0246	No	0	No
3/10/2023 13:08	0	0.026	0.0249	No	0	No
3/10/2023 13:09	0	0.027	0.0251	No	0	No
3/10/2023 13:10	0	0.03	0.0255	No	0	No
3/10/2023 13:11	0	0.036	0.0263	No	0	No
3/10/2023 13:12	0	0.03	0.0268	No	0	No
3/10/2023 13:13	0	0.031	0.0273	No	0	No
3/10/2023 13:14	0	0.027	0.0276	No	0	No
3/10/2023 13:15	0	0.023	0.0274	No	0	No
3/10/2023 13:16	0	0.024	0.0272	No	0	No
3/10/2023 13:17	0	0.024	0.027	No	0	No
3/10/2023 13:18	0	0.024	0.0269	No	0	No
3/10/2023 13:19	0	0.023	0.0267	No	0	No
3/10/2023 13:20	0	0.022	0.0265	No	0	No
3/10/2023 13:21	0	0.025	0.0265	No	0	No
3/10/2023 13:22	0	0.023	0.0263	No	0	No
3/10/2023 13:23	0	0.023	0.0261	No	0	No
3/10/2023 13:24	0	0.024	0.0259	No	0	No
3/10/2023 13:25	0	0.025	0.0256	No	0	No
3/10/2023 13:26	0	0.026	0.0249	No	0	No
3/10/2023 13:27	0	0.023	0.0245	No	0	No
3/10/2023 13:28	0	0.023	0.0239	No	0	No
3/10/2023 13:29	0	0.024	0.0237	No	0	No
3/10/2023 13:30	0	0.024	0.0238	No	0	No
3/10/2023 13:31	0	0.023	0.0237	No	0	No
3/10/2023 13:32	0	0.023	0.0237	No	0	No
3/10/2023 13:33	0	0.023	0.0236	No	0	No
3/10/2023 13:34	0	0.025	0.0237	No	0	No
3/10/2023 13:35	0	0.024	0.0239	No	0	No
3/10/2023 13:36	0	0.025	0.0239	No	0	No
3/10/2023 13:37	0	0.025	0.024	No	0	No
3/10/2023 13:38	0	0.023	0.024	No	0	No
3/10/2023 13:39	0	0.023	0.0239	No	0	No
3/10/2023 13:40	0	0.023	0.0238	No	0	No
3/10/2023 13:41	0	0.023	0.0236	No	0	No
3/10/2023 13:42	0	0.024	0.0237	No	0	No
3/10/2023 13:43	0	0.024	0.0237	No	0	No
3/10/2023 13:44	0	0.025	0.0238	No	0	No
3/10/2023 13:45	0	0.027	0.024	No	0	No
3/10/2023 13:46	0	0.026	0.0242	No	0	No
3/10/2023 13:47	0	0.025	0.0243	No	0	No
3/10/2023 13:48	0	0.025	0.0245	No	0	No
3/10/2023 13:49	0	0.024	0.0244	No	0	No
3/10/2023 13:50	0	0.026	0.0245	No	0	No
3/10/2023 13:51	0	0.025	0.0245	No	0	No
3/10/2023 13:52	0	0.024	0.0245	No	0	No

Downwind Station						
Time	Instantaneous VOC (ppm)	Instantaneous Mass Conc. Total (mg/m ³)	Mass Conc. Total mg/m ³ AVG 15m (mg/m ³)	Dust Exceedance	VOC ppm AVG 15m (ppm)	VOC Exceedance
3/10/2023 13:53	0	0.028	0.0248	No	0	No
3/10/2023 13:54	0	0.027	0.0251	No	0	No
3/10/2023 13:55	0	0.028	0.0254	No	0	No
3/10/2023 13:56	0	0.025	0.0255	No	0	No
3/10/2023 13:57	0	0.028	0.0258	No	0	No
3/10/2023 13:58	0	0.027	0.026	No	0	No
3/10/2023 13:59	0	0.026	0.0261	No	0	No
3/10/2023 14:00	0	0.024	0.0259	No	0	No
3/10/2023 14:01	0	0.025	0.0258	No	0	No
3/10/2023 14:02	0	0.025	0.0258	No	0	No
3/10/2023 14:03	0	0.024	0.0257	No	0	No
3/10/2023 14:04	0	0.023	0.0257	No	0	No
3/10/2023 14:05	0	0.023	0.0255	No	0	No
3/10/2023 14:06	0	0.023	0.0253	No	0	No
3/10/2023 14:07	0	0.023	0.0253	No	0	No
3/10/2023 14:08	0	0.023	0.0249	No	0	No
3/10/2023 14:09	0	0.022	0.0246	No	0	No
3/10/2023 14:10	0	0.023	0.0243	No	0	No
3/10/2023 14:11	0	0.025	0.0243	No	0	No
3/10/2023 14:12	0	0.025	0.0241	No	0	No
3/10/2023 14:13	0	0.026	0.024	No	0	No
3/10/2023 14:14	0	0.026	0.024	No	0	No
3/10/2023 14:15	0	0.026	0.0241	No	0	No
3/10/2023 14:16	0	0.027	0.0243	No	0	No
3/10/2023 14:17	0	0.026	0.0243	No	0	No
3/10/2023 14:18	0	0.027	0.0245	No	0	No
3/10/2023 14:19	0	0.025	0.0247	No	0	No
3/10/2023 14:20	0	0.027	0.0249	No	0	No
3/10/2023 14:21	0	0.027	0.0252	No	0	No
3/10/2023 14:22	0	0.027	0.0255	No	0	No
3/10/2023 14:23	0	0.026	0.0257	No	0	No
3/10/2023 14:24	0	0.026	0.0259	No	0	No
3/10/2023 14:25	0	0.024	0.026	No	0	No
3/10/2023 14:26	0	0.025	0.026	No	0	No
3/10/2023 14:27	0	0.03	0.0263	No	0	No
3/10/2023 14:28	0	0.029	0.0265	No	0	No
3/10/2023 14:29	0	0.026	0.0265	No	0	No
3/10/2023 14:30	0	0.027	0.0266	No	0	No
3/10/2023 14:31	0	0.024	0.0264	No	0	No
3/10/2023 14:32	0	0.03	0.0267	No	0	No
3/10/2023 14:33	0	0.027	0.0267	No	0	No
3/10/2023 14:34	0	0.028	0.0269	No	0	No
3/10/2023 14:35	0	0.029	0.027	No	0	No
3/10/2023 14:36	0	0.026	0.0269	No	0	No
3/10/2023 14:37	0	0.025	0.0268	No	0	No
3/10/2023 14:38	0	0.026	0.0268	No	0	No
3/10/2023 14:39	0	0.037	0.0275	No	0	No
3/10/2023 14:40	0	0.034	0.0282	No	0	No
3/10/2023 14:41	0	0.026	0.0283	No	0	No
3/10/2023 14:42	0	0.026	0.028	No	0	No
3/10/2023 14:43	0	0.025	0.0277	No	0	No
3/10/2023 14:44	0	0.025	0.0277	No	0	No
3/10/2023 14:45	0	0.027	0.0277	No	0	No
3/10/2023 14:46	0	0.027	0.0279	No	0	No

Downwind Station						
Time	Instantaneous VOC (ppm)	Instantaneous Mass Conc. Total (mg/m ³)	Mass Conc. Total mg/m ³ AVG 15m (mg/m ³)	Dust Exceedance	VOC ppm AVG 15m (ppm)	VOC Exceedance
3/10/2023 14:47	0	0.025	0.0275	No	0	No
3/10/2023 14:48	0	0.024	0.0273	No	0	No
3/10/2023 14:49	0	0.025	0.0271	No	0	No
3/10/2023 14:50	0	0.026	0.0269	No	0	No
3/10/2023 14:51	0	0.025	0.0269	No	0	No
3/10/2023 14:52	0	0.026	0.0269	No	0	No
3/10/2023 14:53	0	0.027	0.027	No	0	No
3/10/2023 14:54	0	0.028	0.0264	No	0	No
3/10/2023 14:55	0	0.03	0.0261	No	0	No
3/10/2023 14:56	0	0.028	0.0263	No	0	No
3/10/2023 14:57	0	0.029	0.0265	No	0	No
3/10/2023 14:58	0	0.026	0.0265	No	0	No
3/10/2023 14:59	0	0.026	0.0266	No	0	No
3/10/2023 15:00	0	0.027	0.0266	No	0	No
3/10/2023 15:01	0	0.025	0.0265	No	0	No
3/10/2023 15:02	0	0.025	0.0265	No	0	No
3/10/2023 15:03	0	0.026	0.0266	No	0	No
3/10/2023 15:04	0	0.027	0.0267	No	0	No
3/10/2023 15:05	0	0.028	0.0269	No	0	No
3/10/2023 15:06	0	0.031	0.0273	No	0	No
3/10/2023 15:07	0	0.03	0.0275	No	0	No
3/10/2023 15:08	0	0.031	0.0278	No	0	No