



Daily Activity Report

Seton Brilla Charter School
1956 Jerome Avenue, Bronx, NY
BCP No. C203152

General Site Information

Date:	Thursday, February 23, 2023
Weather:	Mostly Cloudy, 38-43°F
Wind Direction/Speed:	NE @ 5-10 mph
AKRF Personnel on Site:	Shannon Donohue
AKRF Equipment on Site:	Mini RAE 3000 Photoionization Detector [(PID) x1], 2 Fixed Air Monitoring Stations [DustTrak
Visitors:	None.

Contractor Information

Contracting Company	Main Personnel	Equipment
Casino Construction	Connor McGrory	Excavator, CFA Drill Rig

Description and Location of Work Activities Performed

- 1) Excavation of soil/fill around piles and SOE in grid WC-03
- 2) Installation of additional SOE along northern boundary of site in grid WC-03

Site Soil Disposal Tracking Information

Destination Facility	Daily Trucks	Total Trucks	Daily Approx. Cubic Yds	Total Approx. Cubic Yds	Total Site Loads	Total Approximate Cubic Yards
Clean Earth Carteret	0	73	0	1,460	165	3,300
Clean Earth Southeastern Pennsylvania	0	66	0	1,320		
Concrete Disposal	0	26	0	520		
N/A	0	0	0	0		
N/A	0	0	0	0		

CAMP Air Monitoring Results

CAMP Station	UPWIND				DOWNWIND		
Odors:	None.				None.		
VOC Action Level Exceedance(s):	None.				None.		
Particulate Action Level Exceedance(s):	None.				None.		
Maximum VOC Level (15 min ppm):	0.560				0.335		
Maximum Particulate Level (15 min mg/m ³):	0.0305				0.032		

Notes: CAMP monitoring was performed throughout the day.

Additional Information

Planned Work Activity for Following Day/Week:	1) Excavation of soil/fill to uncover piles.
Comments:	None.

Site Map

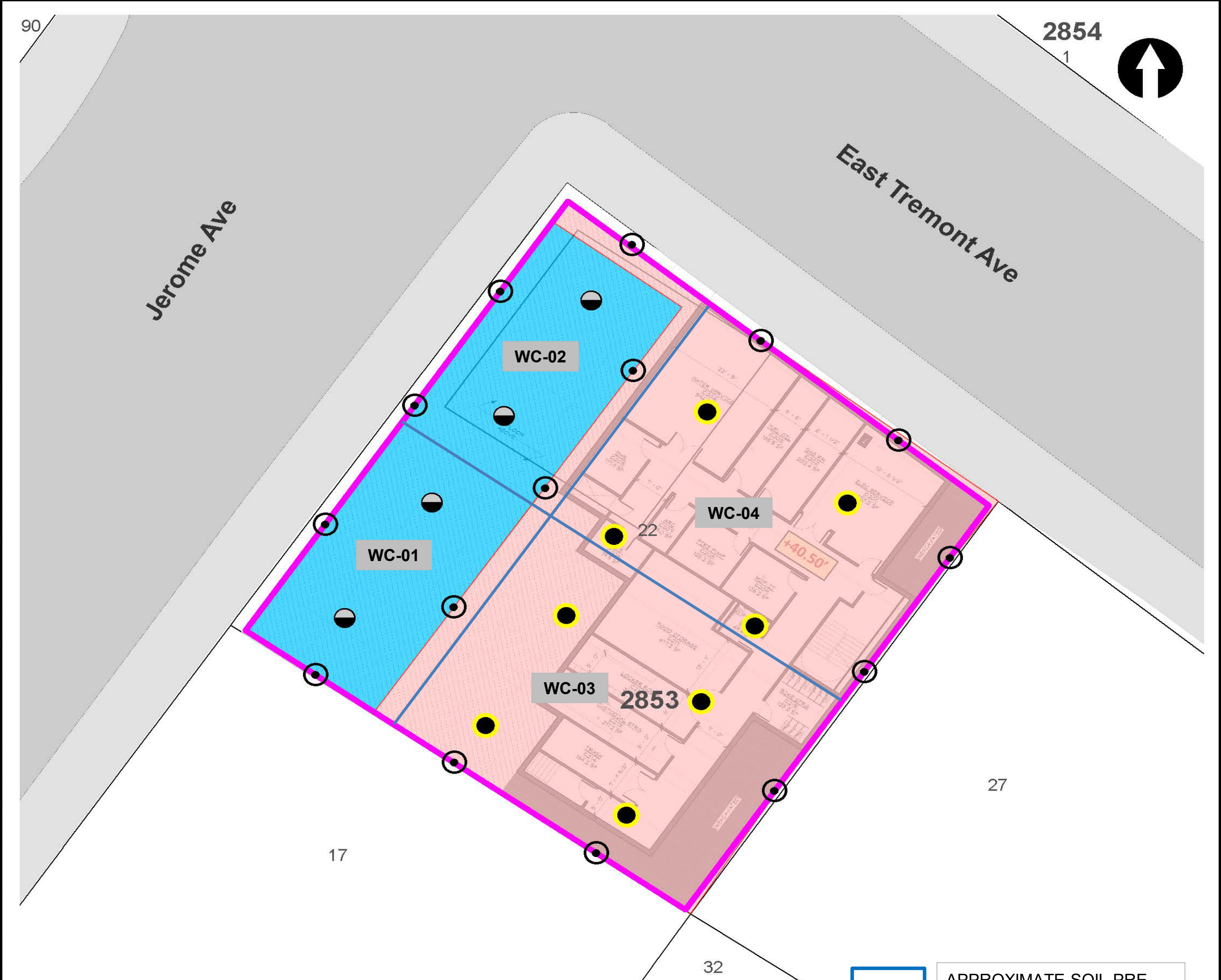

LEGEND

- PROJECT SITE BOUNDARY
- LOT BOUNDARY AND TAX LOT NUMBER
- 2853** BLOCK NUMBER
- REMEDIAL EXCAVATION TO APPROXIMATELY TWO FEET BELOW EXISTING GRADE
- REMEDIAL EXCAVATION TO GROUNDWATER (SOURCE AREA)

- CONFIRMATION DOCUMENTATION BOTTOM SAMPLE
- SOURCE AREA DOCUMENTATION BOTTOM SAMPLE
- DOCUMENTATION SIDEWALL SAMPLE

NOTE
 REMEDIAL EXCAVATION WILL INCLUDE REMOVAL OF APPROXIMATELY 1,280 TONS (850 CUBIC YARDS) OF SOURCE MATERIAL ASSOCIATED WITH NYSDEC SPILL NO. 2103719 AND APPROXIMATELY 860 TONS (570 CUBIC YARDS) OF SOIL/FILL FROM THE UPPER 2 FEET SITE-WIDE.



Map Source:
 NYCDOP (NYC Dept. of City Planning) GIS database

© 2021 AKRF. W:\Projects\210024 - 1956 JEROME AVENUE\Technical\GIS and Graphics\AR\RAW\210024 Figure 9 Proposed Remedial Excavation and Documentation Sample Location Plan.mxd 10/25/2021 2:03:38 PM iszalus



440 Park Avenue South, New York, NY 10016

1956 Jerome Avenue
 Bronx, New York

**TRACK 4 CLEANUP AND DOCUMENTATION
 SAMPLE LOCATION PLAN**

DATE
04/29/2022

PROJECT NO.
210024

FIGURE
11

Site Photographs

Photograph 1 -
Excavation in Grid
WC-03, view facing
east.



Photograph 2-
Excavating soil in grid
WC-03, view facing
east.



Photograph 3- Work
on SOE along
northeastern
boundary of grid WC-
03, view facing east



Upwind Station						
Time	Instaneous VOC (ppm)	Instaneous Mass Conc. Total (mg/m ³)	Mass Conc. Total mg/m ³ AVG 15m (mg/m ³)	Dust Exceedance	VOC ppm AVG 15m (ppm)	VOC Exceedance
2/23/2023 7:13	0	0.01	0.01	No	0	No
2/23/2023 7:14	0	0.009	0.0095	No	0	No
2/23/2023 7:15	0	0.009	0.0093	No	0	No
2/23/2023 7:16	0	0.009	0.0093	No	0	No
2/23/2023 7:17	0	0.011	0.0096	No	0	No
2/23/2023 7:18	0	0.01	0.0097	No	0	No
2/23/2023 7:19	0	0.011	0.0099	No	0	No
2/23/2023 7:20	0	0.011	0.01	No	0	No
2/23/2023 7:21	0	0.01	0.01	No	0	No
2/23/2023 7:22	0	0.011	0.0101	No	0	No
2/23/2023 7:23	0	0.009	0.01	No	0	No
2/23/2023 7:24	0	0.01	0.01	No	0	No
2/23/2023 7:25	0	0.01	0.01	No	0	No
2/23/2023 7:26	0	0.016	0.0104	No	0	No
2/23/2023 7:27	0	0.015	0.0107	No	0	No
2/23/2023 7:28	0	0.016	0.0111	No	0	No
2/23/2023 7:29	0	0.013	0.0114	No	0	No
2/23/2023 7:30	0	0.012	0.0116	No	0	No
2/23/2023 7:31	0	0.012	0.0118	No	0	No
2/23/2023 7:32	0	0.014	0.012	No	0	No
2/23/2023 7:33	0	0.019	0.0126	No	0	No
2/23/2023 7:34	0	0.021	0.0133	No	0	No
2/23/2023 7:35	0	0.015	0.0135	No	0	No
2/23/2023 7:36	0	0.019	0.0141	No	0	No
2/23/2023 7:37	0	0.018	0.0146	No	0	No
2/23/2023 7:38	0	0.014	0.0149	No	0	No
2/23/2023 7:39	0	0.016	0.0153	No	0	No
2/23/2023 7:40	0	0.014	0.0156	No	0	No
2/23/2023 7:41	0	0.014	0.0155	No	0	No
2/23/2023 7:42	0	0.014	0.0154	No	0	No
2/23/2023 7:43	0	0.016	0.0154	No	0	No
2/23/2023 7:44	0	0.014	0.0155	No	0	No
2/23/2023 7:45	0	0.014	0.0156	No	0	No
2/23/2023 7:46	0	0.014	0.0157	No	0	No
2/23/2023 7:47	0	0.012	0.0156	No	0	No
2/23/2023 7:48	0	0.013	0.0152	No	0	No
2/23/2023 7:49	0	0.012	0.0146	No	0	No
2/23/2023 7:50	0	0.013	0.0145	No	0	No
2/23/2023 7:51	0	0.015	0.0142	No	0	No
2/23/2023 7:52	0.012	0.015	0.014	No	0.0008	No
2/23/2023 7:53	0.016	0.016	0.0141	No	0.0019	No
2/23/2023 7:54	0.023	0.016	0.0141	No	0.0034	No
2/23/2023 7:55	0.043	0.014	0.0141	No	0.0063	No
2/23/2023 7:56	0.054	0.014	0.0141	No	0.0099	No
2/23/2023 7:57	0.043	0.014	0.0141	No	0.0127	No
2/23/2023 7:58	0.043	0.015	0.0141	No	0.0156	No
2/23/2023 7:59	0.044	0.015	0.0141	No	0.0185	No
2/23/2023 8:00	0.039	0.015	0.0142	No	0.0211	No
2/23/2023 8:01	0.045	0.015	0.0143	No	0.0241	No
2/23/2023 8:02	0.043	0.016	0.0145	No	0.027	No
2/23/2023 8:03	0.052	0.016	0.0147	No	0.0305	No
2/23/2023 8:04	0.063	0.015	0.0149	No	0.0347	No

Upwind Station						
Time	Instaneous VOC (ppm)	Instaneous Mass Conc. Total (mg/m³)	Mass Conc. Total mg/m³ AVG 15m (mg/m³)	Dust Exceedance	VOC ppm AVG 15m (ppm)	VOC Exceedance
2/23/2023 8:05	0.07	0.016	0.0151	No	0.0393	No
2/23/2023 8:06	0.062	0.016	0.0152	No	0.0435	No
2/23/2023 8:07	0.075	0.018	0.0154	No	0.0477	No
2/23/2023 8:08	0.074	0.017	0.0155	No	0.0515	No
2/23/2023 8:09	0.081	0.016	0.0155	No	0.0554	No
2/23/2023 8:10	0.084	0.016	0.0156	No	0.0581	No
2/23/2023 8:11	0.094	0.017	0.0158	No	0.0608	No
2/23/2023 8:12	0.083	0.016	0.0159	No	0.0635	No
2/23/2023 8:13	0.089	0.016	0.016	No	0.0665	No
2/23/2023 8:14	0.094	0.015	0.016	No	0.0699	No
2/23/2023 8:15	0.107	0.015	0.016	No	0.0744	No
2/23/2023 8:16	0.092	0.017	0.0161	No	0.0775	No
2/23/2023 8:17	0.12	0.017	0.0162	No	0.0827	No
2/23/2023 8:18	0.105	0.016	0.0162	No	0.0862	No
2/23/2023 8:19	0.115	0.017	0.0163	No	0.0897	No
2/23/2023 8:20	0.129	0.018	0.0165	No	0.0936	No
2/23/2023 8:21	0.138	0.018	0.0166	No	0.0987	No
2/23/2023 8:22	0.13	0.018	0.0166	No	0.1023	No
2/23/2023 8:23	0.129	0.018	0.0167	No	0.106	No
2/23/2023 8:24	0.131	0.018	0.0168	No	0.1093	No
2/23/2023 8:25	0.122	0.02	0.0171	No	0.1119	No
2/23/2023 8:26	0.143	0.019	0.0172	No	0.1151	No
2/23/2023 8:27	0.141	0.018	0.0173	No	0.119	No
2/23/2023 8:28	0.147	0.02	0.0176	No	0.1229	No
2/23/2023 8:29	0.152	0.024	0.0182	No	0.1267	No
2/23/2023 8:30	0.158	0.023	0.0187	No	0.1301	No
2/23/2023 8:31	0.152	0.024	0.0192	No	0.1341	No
2/23/2023 8:32	0.151	0.023	0.0196	No	0.1362	No
2/23/2023 8:33	0.159	0.019	0.0198	No	0.1398	No
2/23/2023 8:34	0.165	0.019	0.0199	No	0.1431	No
2/23/2023 8:35	0.167	0.018	0.0199	No	0.1457	No
2/23/2023 8:36	0.161	0.02	0.0201	No	0.1472	No
2/23/2023 8:37	0.172	0.022	0.0203	No	0.15	No
2/23/2023 8:38	0.181	0.02	0.0205	No	0.1535	No
2/23/2023 8:39	0.175	0.017	0.0204	No	0.1564	No
2/23/2023 8:40	0.184	0.017	0.0202	No	0.1605	No
2/23/2023 8:41	0.171	0.016	0.02	No	0.1624	No
2/23/2023 8:42	0.188	0.016	0.0199	No	0.1655	No
2/23/2023 8:43	0.183	0.016	0.0196	No	0.1679	No
2/23/2023 8:44	0.193	0.017	0.0191	No	0.1707	No
2/23/2023 8:45	0.193	0.017	0.0187	No	0.173	No
2/23/2023 8:46	0.187	0.017	0.0183	No	0.1753	No
2/23/2023 8:47	0.193	0.017	0.0179	No	0.1781	No
2/23/2023 8:48	0.202	0.017	0.0177	No	0.181	No
2/23/2023 8:49	0.203	0.018	0.0177	No	0.1835	No
2/23/2023 8:50	0.205	0.017	0.0176	No	0.1861	No
2/23/23 8:51	0.21	0.018	0.0175	No	0.1893	No
2/23/23 8:52	0.216	0.035	0.0183	No	0.1923	No
2/23/23 8:53	0.219	0.018	0.0182	No	0.1948	No
2/23/23 8:54	0.212	0.019	0.0183	No	0.1973	No
2/23/23 8:55	0.221	0.025	0.0189	No	0.1997	No
2/23/23 8:56	0.23	0.017	0.0189	No	0.2037	No

Upwind Station

Time	Instantaneous VOC (ppm)	Instantaneous Mass Conc. Total (mg/m ³)	Mass Conc. Total mg/m ³ AVG 15m (mg/m ³)	Dust Exceedance	VOC ppm AVG 15m (ppm)	VOC Exceedance
2/23/23 8:57	0.223	0.017	0.019	No	0.206	No
2/23/23 8:58	0.24	0.022	0.0194	No	0.2098	No
2/23/23 8:59	0.232	0.019	0.0195	No	0.2124	No
2/23/23 9:00	0.241	0.021	0.0198	No	0.2156	No
2/23/23 9:01	0.243	0.02	0.02	No	0.2193	No
2/23/23 9:02	0.241	0.019	0.0201	No	0.2225	No
2/23/23 9:03	0.239	0.019	0.0203	No	0.225	No
2/23/23 9:04	0.256	0.019	0.0203	No	0.2285	No
2/23/23 9:05	0.249	0.021	0.0206	No	0.2315	No
2/23/23 9:06	0.25	0.018	0.0206	No	0.2341	No
2/23/23 9:07	0.245	0.019	0.0195	No	0.2361	No
2/23/23 9:08	0.247	0.018	0.0195	No	0.2379	No
2/23/23 9:09	0.254	0.018	0.0195	No	0.2407	No
2/23/23 9:10	0.251	0.018	0.019	No	0.2427	No
2/23/23 9:11	0.26	0.02	0.0192	No	0.2447	No
2/23/23 9:12	0.253	0.023	0.0196	No	0.2467	No
2/23/23 9:13	0.273	0.03	0.0201	No	0.2489	No
2/23/23 9:14	0.275	0.022	0.0203	No	0.2518	No
2/23/23 9:15	0.274	0.019	0.0202	No	0.254	No
2/23/23 9:16	0.271	0.02	0.0202	No	0.2559	No
2/23/23 9:17	0.276	0.019	0.0202	No	0.2582	No
2/23/23 9:18	0.276	0.02	0.0203	No	0.2607	No
2/23/23 9:19	0.276	0.02	0.0203	No	0.262	No
2/23/23 9:20	0.287	0.019	0.0202	No	0.2645	No
2/23/23 9:21	0.283	0.021	0.0204	No	0.2667	No
2/23/23 9:22	0.296	0.023	0.0207	No	0.2701	No
2/23/23 9:23	0.297	0.021	0.0209	No	0.2735	No
2/23/23 9:24	0.298	0.02	0.021	No	0.2764	No
2/23/23 9:25	0.284	0.02	0.0211	No	0.2786	No
2/23/23 9:26	0.289	0.019	0.0211	No	0.2805	No
2/23/23 9:27	0.288	0.018	0.0207	No	0.2829	No
2/23/23 9:28	0.283	0.016	0.0198	No	0.2835	No
2/23/23 9:29	0.294	0.015	0.0193	No	0.2848	No
2/23/23 9:30	0.288	0.014	0.019	No	0.2857	No
2/23/23 9:31	0.299	0.016	0.0187	No	0.2876	No
2/23/23 9:32	0.296	0.015	0.0185	No	0.2889	No
2/23/23 9:33	0.303	0.014	0.0181	No	0.2907	No
2/23/23 9:34	0.3	0.014	0.0177	No	0.2923	No
2/23/23 9:35	0.309	0.014	0.0173	No	0.2938	No
2/23/23 9:36	0.302	0.015	0.0169	No	0.2951	No
2/23/23 9:37	0.293	0.014	0.0163	No	0.2949	No
2/23/23 9:38	0.312	0.015	0.0159	No	0.2959	No
2/23/23 9:39	0.308	0.015	0.0156	No	0.2965	No
2/23/23 9:40	0.305	0.018	0.0155	No	0.2979	No
2/23/23 9:41	0.313	0.018	0.0154	No	0.2995	No
2/23/23 9:42	0.324	0.016	0.0153	No	0.3019	No
2/23/23 9:43	0.327	0.016	0.0153	No	0.3049	No
2/23/23 9:44	0.321	0.017	0.0154	No	0.3067	No
2/23/23 9:45	0.328	0.017	0.0156	No	0.3093	No
2/23/23 9:46	0.332	0.016	0.0156	No	0.3115	No
2/23/23 9:47	0.33	0.016	0.0157	No	0.3138	No
2/23/23 9:48	0.334	0.017	0.0159	No	0.3159	No

Upwind Station						
Time	Instaneous VOC (ppm)	Instaneous Mass Conc. Total (mg/m ³)	Mass Conc. Total mg/m ³ AVG 15m (mg/m ³)	Dust Exceedance	VOC ppm AVG 15m (ppm)	VOC Exceedance
2/23/23 9:49	0.333	0.017	0.0161	No	0.3181	No
2/23/23 9:50	0.335	0.014	0.0161	No	0.3198	No
2/23/23 9:51	0.342	0.014	0.016	No	0.3225	No
2/23/23 9:52	0.342	0.013	0.0159	No	0.3257	No
2/23/23 9:53	0.334	0.014	0.0159	No	0.3272	No
2/23/23 9:54	0.343	0.014	0.0158	No	0.3295	No
2/23/23 9:55	0.35	0.013	0.0155	No	0.3325	No
2/23/23 9:56	0.343	0.014	0.0152	No	0.3345	No
2/23/23 9:57	0.357	0.014	0.0151	No	0.3367	No
2/23/23 9:58	0.349	0.015	0.015	No	0.3382	No
2/23/23 9:59	0.349	0.016	0.0149	No	0.3401	No
2/23/23 10:00	0.356	0.017	0.0149	No	0.3419	No
2/23/23 10:01	0.369	0.018	0.0151	No	0.3444	No
2/23/23 10:02	0.357	0.019	0.0153	No	0.3462	No
2/23/23 10:03	0.357	0.019	0.0154	No	0.3477	No
2/23/23 10:04	0.366	0.018	0.0155	No	0.3499	No
2/23/23 10:05	0.367	0.017	0.0157	No	0.3521	No
2/23/23 10:06	0.359	0.016	0.0158	No	0.3532	No
2/23/23 10:07	0.369	0.016	0.016	No	0.355	No
2/23/23 10:08	0.378	0.015	0.0161	No	0.3579	No
2/23/23 10:09	0.368	0.016	0.0162	No	0.3596	No
2/23/23 10:10	0.377	0.016	0.0164	No	0.3614	No
2/23/23 10:11	0.376	0.017	0.0166	No	0.3636	No
2/23/23 10:12	0.388	0.016	0.0167	No	0.3657	No
2/23/23 10:13	0.383	0.016	0.0168	No	0.3679	No
2/23/23 10:14	0.389	0.017	0.0169	No	0.3706	No
2/23/23 10:15	0.385	0.018	0.0169	No	0.3725	No
2/23/23 10:16	0.39	0.018	0.0169	No	0.3739	No
2/23/23 10:17	0.394	0.019	0.0169	No	0.3764	No
2/23/23 10:18	0.394	0.017	0.0168	No	0.3789	No
2/23/23 10:19	0.386	0.017	0.0167	No	0.3802	No
2/23/23 10:20	0.382	0.018	0.0168	No	0.3812	No
2/23/23 10:21	0.395	0.018	0.0169	No	0.3836	No
2/23/23 10:22	0.394	0.017	0.017	No	0.3853	No
2/23/23 10:23	0.401	0.016	0.0171	No	0.3868	No
2/23/23 10:24	0.403	0.019	0.0173	No	0.3891	No
2/23/23 10:25	0.404	0.021	0.0176	No	0.3909	No
2/23/23 10:26	0.399	0.021	0.0179	No	0.3925	No
2/23/23 10:27	0.402	0.019	0.0181	No	0.3934	No
2/23/23 10:28	0.396	0.02	0.0183	No	0.3943	No
2/23/23 10:29	0.404	0.017	0.0183	No	0.3953	No
2/23/23 10:30	0.407	0.017	0.0183	No	0.3967	No
2/23/23 10:31	0.405	0.018	0.0183	No	0.3977	No
2/23/23 10:32	0.407	0.019	0.0183	No	0.3986	No
2/23/23 10:33	0.414	0.019	0.0184	No	0.3999	No
2/23/23 10:34	0.414	0.018	0.0185	No	0.4018	No
2/23/23 10:35	0.413	0.016	0.0183	No	0.4039	No
2/23/23 10:36	0.415	0.017	0.0183	No	0.4052	No
2/23/23 10:37	0.425	0.016	0.0182	No	0.4073	No
2/23/23 10:38	0.418	0.015	0.0181	No	0.4084	No
2/23/23 10:39	0.419	0.014	0.0178	No	0.4095	No
2/23/23 10:40	0.407	0.014	0.0173	No	0.4097	No

Upwind Station						
Time	Instaneous VOC (ppm)	Instaneous Mass Conc. Total (mg/m ³)	Mass Conc. Total mg/m ³ AVG 15m (mg/m ³)	Dust Exceedance	VOC ppm AVG 15m (ppm)	VOC Exceedance
2/23/23 10:41	0.408	0.016	0.017	No	0.4103	No
2/23/23 10:42	0.425	0.017	0.0169	No	0.4118	No
2/23/23 10:43	0.423	0.017	0.0167	No	0.4136	No
2/23/23 10:44	0.431	0.016	0.0166	No	0.4154	No
2/23/23 10:45	0.441	0.015	0.0165	No	0.4177	No
2/23/23 10:46	0.428	0.015	0.0163	No	0.4192	No
2/23/23 10:47	0.44	0.015	0.016	No	0.4214	No
2/23/23 10:48	0.429	0.016	0.0158	No	0.4224	No
2/23/23 10:49	0.427	0.017	0.0157	No	0.4233	No
2/23/23 10:50	0.436	0.018	0.0159	No	0.4248	No
2/23/23 10:51	0.432	0.014	0.0157	No	0.4259	No
2/23/23 10:52	0.426	0.014	0.0155	No	0.426	No
2/23/23 10:53	0.433	0.012	0.0153	No	0.427	No
2/23/23 10:54	0.441	0.014	0.0153	No	0.4285	No
2/23/23 10:55	0.426	0.014	0.0153	No	0.4297	No
2/23/23 10:56	0.433	0.014	0.0152	No	0.4314	No
2/23/23 10:57	0.439	0.013	0.0149	No	0.4323	No
2/23/23 10:58	0.443	0.015	0.0148	No	0.4337	No
2/23/23 10:59	0.432	0.014	0.0147	No	0.4337	No
2/23/23 11:00	0.431	0.016	0.0147	No	0.4331	No
2/23/23 11:01	0.44	0.017	0.0149	No	0.4339	No
2/23/23 11:02	0.437	0.016	0.0149	No	0.4337	No
2/23/23 11:03	0.444	0.016	0.0149	No	0.4347	No
2/23/23 11:04	0.447	0.018	0.015	No	0.436	No
2/23/23 11:05	0.446	0.018	0.015	No	0.4367	No
2/23/23 11:06	0.446	0.017	0.0152	No	0.4376	No
2/23/23 11:07	0.452	0.017	0.0154	No	0.4393	No
2/23/23 11:08	0.441	0.014	0.0155	No	0.4399	No
2/23/23 11:09	0.446	0.013	0.0155	No	0.4402	No
2/23/23 11:10	0.452	0.015	0.0155	No	0.4419	No
2/23/23 11:11	0.451	0.017	0.0157	No	0.4431	No
2/23/23 11:12	0.45	0.019	0.0161	No	0.4439	No
2/23/23 11:13	0.462	0.015	0.0161	No	0.4451	No
2/23/23 11:14	0.465	0.015	0.0162	No	0.4473	No
2/23/23 11:15	0.462	0.016	0.0162	No	0.4494	No
2/23/23 11:16	0.456	0.016	0.0161	No	0.4505	No
2/23/23 11:17	0.449	0.016	0.0161	No	0.4513	No
2/23/23 11:18	0.448	0.017	0.0162	No	0.4515	No
2/23/23 11:19	0.457	0.018	0.0162	No	0.4522	No
2/23/23 11:20	0.462	0.018	0.0162	No	0.4533	No
2/23/23 11:21	0.465	0.022	0.0165	No	0.4545	No
2/23/23 11:22	0.472	0.023	0.0169	No	0.4559	No
2/23/23 11:23	0.462	0.026	0.0177	No	0.4573	No
2/23/23 11:24	0.466	0.031	0.0189	No	0.4586	No
2/23/23 11:25	0.473	0.027	0.0197	No	0.46	No
2/23/23 11:26	0.464	0.023	0.0201	No	0.4609	No
2/23/23 11:27	0.471	0.023	0.0204	No	0.4623	No
2/23/23 11:28	0.47	0.021	0.0208	No	0.4628	No
2/23/23 11:29	0.477	0.016	0.0209	No	0.4636	No
2/23/23 11:30	0.482	0.024	0.0214	No	0.4649	No
2/23/23 11:31	0.474	0.019	0.0216	No	0.4661	No
2/23/23 11:32	0.481	0.021	0.0219	No	0.4683	No

Upwind Station						
Time	Instaneous VOC (ppm)	Instaneous Mass Conc. Total (mg/m ³)	Mass Conc. Total mg/m ³ AVG 15m (mg/m ³)	Dust Exceedance	VOC ppm AVG 15m (ppm)	VOC Exceedance
2/23/23 11:33	0.477	0.02	0.0221	No	0.4702	No
2/23/23 11:34	0.474	0.019	0.0222	No	0.4713	No
2/23/23 11:35	0.478	0.019	0.0223	No	0.4724	No
2/23/23 11:36	0.474	0.022	0.0223	No	0.473	No
2/23/23 11:37	0.475	0.02	0.0221	No	0.4732	No
2/23/23 11:38	0.476	0.019	0.0216	No	0.4741	No
2/23/23 11:39	0.477	0.021	0.0209	No	0.4749	No
2/23/23 11:40	0.485	0.02	0.0205	No	0.4757	No
2/23/23 11:41	0.484	0.02	0.0203	No	0.477	No
2/23/23 11:42	0.49	0.021	0.0201	No	0.4783	No
2/23/23 11:43	0.48	0.02	0.0201	No	0.4789	No
2/23/23 11:44	0.489	0.019	0.0203	No	0.4797	No
2/23/23 11:45	0.474	0.019	0.0199	No	0.4792	No
2/23/23 11:46	0.487	0.018	0.0199	No	0.4801	No
2/23/23 11:47	0.488	0.026	0.0202	No	0.4805	No
2/23/23 11:48	0.48	0.02	0.0202	No	0.4807	No
2/23/23 11:49	0.481	0.021	0.0203	No	0.4812	No
2/23/23 11:50	0.486	0.02	0.0204	No	0.4817	No
2/23/23 11:51	0.5	0.022	0.0204	No	0.4835	No
2/23/23 11:52	0.496	0.02	0.0204	No	0.4849	No
2/23/23 11:53	0.49	0.018	0.0203	No	0.4858	No
2/23/23 11:54	0.489	0.015	0.0199	No	0.4866	No
2/23/23 11:55	0.487	0.016	0.0197	No	0.4867	No
2/23/23 11:56	0.491	0.021	0.0197	No	0.4872	No
2/23/23 11:57	0.488	0.022	0.0198	No	0.4871	No
2/23/23 11:58	0.482	0.018	0.0197	No	0.4872	No
2/23/23 11:59	0.485	0.021	0.0198	No	0.4869	No
2/23/23 12:00	0.488	0.021	0.0199	No	0.4879	No
2/23/23 12:01	0.493	0.022	0.0202	No	0.4883	No
2/23/23 12:02	0.495	0.023	0.02	No	0.4887	No
2/23/23 12:03	0.482	0.023	0.0202	No	0.4889	No
2/23/23 12:04	0.486	0.019	0.0201	No	0.4892	No
2/23/23 12:05	0.495	0.028	0.0206	No	0.4898	No
2/23/23 12:06	0.503	0.035	0.0215	No	0.49	No
2/23/23 12:07	0.504	0.027	0.0219	No	0.4905	No
2/23/23 12:08	0.496	0.029	0.0227	No	0.4909	No
2/23/23 12:09	0.5	0.026	0.0234	No	0.4917	No
2/23/23 12:10	0.507	0.026	0.0241	No	0.493	No
2/23/23 12:11	0.499	0.028	0.0245	No	0.4935	No
2/23/23 12:12	0.498	0.026	0.0248	No	0.4942	No
2/23/23 12:13	0.496	0.022	0.0251	No	0.4951	No
2/23/23 12:14	0.506	0.025	0.0253	No	0.4965	No
2/23/23 12:15	0.517	0.032	0.0261	No	0.4985	No
2/23/23 12:16	0.51	0.034	0.0269	No	0.4996	No
2/23/23 12:17	0.493	0.039	0.0279	No	0.4995	No
2/23/23 12:18	0.507	0.036	0.0288	No	0.5011	No
2/23/23 12:19	0.508	0.034	0.0298	No	0.5026	No
2/23/23 12:20	0.508	0.033	0.0301	No	0.5035	No
2/23/23 12:21	0.513	0.031	0.0299	No	0.5041	No
2/23/23 12:22	0.519	0.026	0.0298	No	0.5051	No
2/23/23 12:23	0.506	0.025	0.0295	No	0.5058	No
2/23/23 12:24	0.513	0.028	0.0297	No	0.5067	No

Upwind Station						
Time	Instaneous VOC (ppm)	Instaneous Mass Conc. Total (mg/m ³)	Mass Conc. Total mg/m ³ AVG 15m (mg/m ³)	Dust Exceedance	VOC ppm AVG 15m (ppm)	VOC Exceedance
2/23/23 12:25	0.519	0.03	0.0299	No	0.5075	No
2/23/23 12:26	0.526	0.032	0.0302	No	0.5093	No
2/23/23 12:27	0.519	0.027	0.0303	No	0.5107	No
2/23/23 12:28	0.513	0.024	0.0304	No	0.5118	No
2/23/23 12:29	0.513	0.026	0.0305	No	0.5123	No
2/23/23 12:30	0.51	0.029	0.0303	No	0.5118	No
2/23/23 12:31	0.515	0.029	0.0299	No	0.5121	No
2/23/23 12:32	0.52	0.022	0.0288	No	0.5139	No
2/23/23 12:33	0.517	0.021	0.0278	No	0.5146	No
2/23/23 12:34	0.515	0.022	0.027	No	0.5151	No
2/23/23 12:35	0.514	0.021	0.0262	No	0.5155	No
2/23/23 12:36	0.509	0.019	0.0254	No	0.5152	No
2/23/23 12:37	0.511	0.018	0.0249	No	0.5147	No
2/23/23 12:38	0.521	0.041	0.0259	No	0.5157	No
2/23/23 12:39	0.515	0.045	0.0271	No	0.5158	No
2/23/23 12:40	0.528	0.028	0.0269	No	0.5164	No
2/23/23 12:41	0.525	0.025	0.0265	No	0.5163	No
2/23/23 12:42	0.513	0.023	0.0262	No	0.5159	No
2/23/23 12:43	0.516	0.024	0.0262	No	0.5161	No
2/23/23 12:44	0.522	0.024	0.0261	No	0.5167	No
2/23/23 12:45	0.528	0.025	0.0258	No	0.5179	No
2/23/23 12:46	0.526	0.028	0.0257	No	0.5187	No
2/23/23 12:47	0.528	0.031	0.0263	No	0.5192	No
2/23/23 12:48	0.528	0.028	0.0268	No	0.5199	No
2/23/23 12:49	0.528	0.027	0.0271	No	0.5208	No
2/23/23 12:50	0.526	0.028	0.0276	No	0.5216	No
2/23/23 12:51	0.532	0.028	0.0282	No	0.5231	No
2/23/23 12:52	0.538	0.028	0.0289	No	0.5249	No
2/23/23 12:53	0.542	0.028	0.028	No	0.5263	No
2/23/23 12:54	0.541	0.035	0.0273	No	0.5281	No
2/23/23 12:55	0.536	0.028	0.0273	No	0.5286	No
2/23/23 12:56	0.537	0.026	0.0274	No	0.5294	No
2/23/23 12:57	0.54	0.026	0.0276	No	0.5312	No
2/23/23 12:58	0.536	0.029	0.0279	No	0.5325	No
2/23/23 12:59	0.529	0.03	0.0283	No	0.533	No
2/23/23 13:00	0.538	0.027	0.0285	No	0.5337	No
2/23/23 13:01	0.537	0.025	0.0283	No	0.5344	No
2/23/23 13:02	0.54	0.022	0.0277	No	0.5352	No
2/23/23 13:03	0.544	0.023	0.0273	No	0.5363	No
2/23/23 13:04	0.548	0.019	0.0268	No	0.5376	No
2/23/23 13:05	0.541	0.018	0.0261	No	0.5386	No
2/23/23 13:06	0.545	0.018	0.0255	No	0.5395	No
2/23/23 13:07	0.548	0.021	0.025	No	0.5401	No
2/23/23 13:08	0.549	0.023	0.0247	No	0.5406	No
2/23/23 13:09	0.548	0.017	0.0235	No	0.5411	No
2/23/23 13:10	0.549	0.015	0.0226	No	0.5419	No
2/23/23 13:11	0.542	0.015	0.0219	No	0.5423	No
2/23/23 13:12	0.542	0.014	0.0211	No	0.5424	No
2/23/23 13:13	0.544	0.017	0.0203	No	0.5429	No
2/23/23 13:14	0.552	0.037	0.0207	No	0.5445	No
2/23/23 13:15	0.549	0.034	0.0212	No	0.5452	No
2/23/23 13:16	0.552	0.024	0.0211	No	0.5462	No

Upwind Station						
Time	Instaneous VOC (ppm)	Instaneous Mass Conc. Total (mg/m ³)	Mass Conc. Total mg/m ³ AVG 15m (mg/m ³)	Dust Exceedance	VOC ppm AVG 15m (ppm)	VOC Exceedance
2/23/23 13:17	0.545	0.016	0.0207	No	0.5465	No
2/23/23 13:18	0.535	0.016	0.0203	No	0.5459	No
2/23/23 13:19	0.542	0.015	0.02	No	0.5455	No
2/23/23 13:20	0.529	0.016	0.0199	No	0.5447	No
2/23/23 13:21	0.539	0.016	0.0197	No	0.5443	No
2/23/23 13:22	0.534	0.019	0.0196	No	0.5434	No
2/23/23 13:23	0.541	0.022	0.0195	No	0.5429	No
2/23/23 13:24	0.538	0.021	0.0198	No	0.5422	No
2/23/23 13:25	0.548	0.021	0.0202	No	0.5421	No
2/23/23 13:26	0.547	0.02	0.0205	No	0.5425	No
2/23/23 13:27	0.549	0.019	0.0209	No	0.5429	No
2/23/23 13:28	0.538	0.019	0.021	No	0.5425	No
2/23/23 13:29	0.535	0.02	0.0199	No	0.5414	No
2/23/23 13:30	0.538	0.021	0.019	No	0.5407	No
2/23/23 13:31	0.531	0.022	0.0189	No	0.5393	No
2/23/23 13:32	0.532	0.019	0.0191	No	0.5384	No
2/23/23 13:33	0.538	0.017	0.0191	No	0.5386	No
2/23/23 13:34	0.544	0.019	0.0194	No	0.5387	No
2/23/23 13:35	0.552	0.022	0.0198	No	0.5403	No
2/23/23 13:36	0.545	0.019	0.02	No	0.5407	No
2/23/23 13:37	0.538	0.019	0.02	No	0.5409	No
2/23/23 13:38	0.555	0.019	0.0198	No	0.5419	No
2/23/23 13:39	0.547	0.018	0.0196	No	0.5425	No
2/23/23 13:40	0.545	0.019	0.0195	No	0.5423	No
2/23/23 13:41	0.549	0.02	0.0195	No	0.5424	No
2/23/23 13:42	0.554	0.018	0.0194	No	0.5427	No
2/23/23 13:43	0.542	0.018	0.0193	No	0.543	No
2/23/23 13:44	0.533	0.018	0.0192	No	0.5429	No
2/23/23 13:45	0.544	0.019	0.0191	No	0.5433	No
2/23/23 13:46	0.55	0.021	0.019	No	0.5445	No
2/23/23 13:47	0.533	0.017	0.0189	No	0.5446	No
2/23/23 13:48	0.549	0.017	0.0189	No	0.5453	No
2/23/23 13:49	0.535	0.016	0.0187	No	0.5447	No
2/23/23 13:50	0.531	0.014	0.0181	No	0.5433	No
2/23/23 13:51	0.533	0.017	0.018	No	0.5425	No
2/23/23 13:52	0.535	0.018	0.0179	No	0.5423	No
2/23/23 13:53	0.533	0.018	0.0179	No	0.5409	No
2/23/23 13:54	0.532	0.016	0.0177	No	0.5399	No
2/23/23 13:55	0.542	0.017	0.0176	No	0.5397	No
2/23/23 13:56	0.544	0.019	0.0175	No	0.5393	No
2/23/23 13:57	0.531	0.017	0.0175	No	0.5378	No
2/23/23 13:58	0.549	0.016	0.0173	No	0.5383	No
2/23/23 13:59	0.542	0.016	0.0172	No	0.5389	No
2/23/23 14:00	0.553	0.015	0.0169	No	0.5395	No
2/23/23 14:01	0.539	0.021	0.0169	No	0.5387	No
2/23/23 14:02	0.547	0.018	0.017	No	0.5397	No
2/23/23 14:03	0.56	0.019	0.0171	No	0.5404	No
2/23/23 14:04	0.532	0.018	0.0173	No	0.5402	No
2/23/23 14:05	0.539	0.019	0.0176	No	0.5407	No
2/23/23 14:06	0.543	0.019	0.0177	No	0.5414	No
2/23/23 14:07	0.55	0.02	0.0179	No	0.5424	No
2/23/23 14:08	0.547	0.019	0.0179	No	0.5433	No

Upwind Station						
Time	Instaneous VOC (ppm)	Instaneous Mass Conc. Total (mg/m ³)	Mass Conc. Total mg/m ³ AVG 15m (mg/m ³)	Dust Exceedance	VOC ppm AVG 15m (ppm)	VOC Exceedance
2/23/23 14:09	0.547	0.017	0.018	No	0.5443	No
2/23/23 14:10	0.543	0.018	0.0181	No	0.5444	No
2/23/23 14:11	0.55	0.018	0.018	No	0.5448	No
2/23/23 14:12	0.549	0.019	0.0181	No	0.546	No
2/23/23 14:13	0.548	0.02	0.0184	No	0.5459	No
2/23/23 14:14	0.543	0.019	0.0186	No	0.546	No
2/23/23 14:15	0.541	0.022	0.0191	No	0.5452	No
2/23/23 14:16	0.543	0.022	0.0191	No	0.5455	No
2/23/23 14:17	0.539	0.021	0.0193	No	0.5449	No
2/23/23 14:18	0.537	0.022	0.0195	No	0.5434	No
2/23/23 14:19	0.543	0.022	0.0198	No	0.5441	No
2/23/23 14:20	0.543	0.023	0.0201	No	0.5444	No
2/23/23 14:21	0.554	0.021	0.0202	No	0.5451	No
2/23/23 14:22	0.559	0.022	0.0203	No	0.5457	No
2/23/23 14:23	0.554	0.019	0.0203	No	0.5462	No
2/23/23 14:24	0.56	0.02	0.0205	No	0.5471	No
2/23/23 14:25	0.56	0.019	0.0206	No	0.5482	No
2/23/23 14:26	0.553	0.018	0.0206	No	0.5484	No
2/23/23 14:27	0.559	0.019	0.0206	No	0.5491	No
2/23/23 14:28	0.549	0.02	0.0206	No	0.5491	No
2/23/23 14:29	0.552	0.017	0.0205	No	0.5497	No
2/23/23 14:30	0.552	0.017	0.0201	No	0.5505	No
2/23/23 14:31	0.559	0.02	0.02	No	0.5515	No
2/23/23 14:32	0.557	0.021	0.02	No	0.5527	No
2/23/23 14:33	0.553	0.021	0.0199	No	0.5538	No
2/23/23 14:34	0.552	0.018	0.0197	No	0.5544	No
2/23/23 14:35	0.572	0.02	0.0195	No	0.5563	No
2/23/23 14:36	0.563	0.02	0.0194	No	0.5569	No
2/23/23 14:37	0.553	0.02	0.0193	No	0.5565	No
2/23/23 14:38	0.555	0.018	0.0192	No	0.5566	No
2/23/23 14:39	0.559	0.019	0.0191	No	0.5565	No
2/23/23 14:40	0.566	0.019	0.0191	No	0.5569	No
2/23/23 14:41	0.559	0.02	0.0193	No	0.5573	No
2/23/23 14:42	0.572	0.018	0.0192	No	0.5582	No
2/23/23 14:43	0.561	0.016	0.0189	No	0.559	No
2/23/23 14:44	0.559	0.016	0.0189	No	0.5595	No
2/23/23 14:45	0.558	0.013	0.0186	No	0.5599	No
2/23/23 14:46	0.551	0.014	0.0182	No	0.5593	No
2/23/23 14:47	0.547	0.015	0.0178	No	0.5587	No
2/23/23 14:48	0.551	0.016	0.0175	No	0.5585	No
2/23/23 14:49	0.559	0.016	0.0173	No	0.559	No
2/23/23 14:50	0.552	0.019	0.0173	No	0.5577	No
2/23/23 14:51	0.562	0.017	0.0171	No	0.5576	No
2/23/23 14:52	0.562	0.017	0.0169	No	0.5582	No
2/23/23 14:53	0.56	0.017	0.0168	No	0.5585	No
2/23/23 14:54	0.554	0.018	0.0167	No	0.5582	No
2/23/23 14:55	0.557	0.016	0.0165	No	0.5576	No
2/23/23 14:56	0.553	0.017	0.0163	No	0.5572	No
2/23/23 14:57	0.551	0.016	0.0162	No	0.5558	No
2/23/23 14:58	0.564	0.014	0.0161	No	0.556	No
2/23/23 14:59	0.555	0.016	0.0161	No	0.5557	No
2/23/23 15:00	0.557	0.017	0.0163	No	0.5557	No

Upwind Station

Time	Instaneous VOC (ppm)	Instaneous Mass Conc. Total (mg/m ³)	Mass Conc. Total mg/m ³ AVG 15m (mg/m ³)	Dust Exceedance	VOC ppm AVG 15m (ppm)	VOC Exceedance
2/23/23 15:01	0.559	0.017	0.0165	No	0.5562	No
2/23/23 15:02	0.554	0.019	0.0168	No	0.5567	No
2/23/23 15:03	0.557	0.016	0.0168	No	0.5571	No
2/23/23 15:04	0.556	0.017	0.0169	No	0.5569	No
2/23/23 15:05	0.548	0.017	0.0167	No	0.5566	No
2/23/23 15:06	0.557	0.017	0.0167	No	0.5563	No
2/23/23 15:07	0.565	0.023	0.0171	No	0.5565	No
2/23/23 15:08	0.567	0.027	0.0178	No	0.5569	No
2/23/23 15:09	0.581	0.024	0.0182	No	0.5587	No

Downwind Station						
Time	Instantaneous VOC (ppm)	Instantaneous Mass Conc. Total (mg/m ³)	Mass Conc. Total mg/m ³ AVG 15m (mg/m ³)	Dust Exceedance	VOC ppm AVG 15m (ppm)	VOC Exceedance
2/23/2023 7:12	0			No	0	No
2/23/2023 7:13	0	-0.007	-0.007	No	0	No
2/23/2023 7:14	0	-0.016	-0.0115	No	0	No
2/23/2023 7:15	0	-0.016	-0.013	No	0	No
2/23/2023 7:16	0	-0.015	-0.0135	No	0	No
2/23/2023 7:17	0	-0.015	-0.0138	No	0	No
2/23/2023 7:18	0	-0.015	-0.014	No	0	No
2/23/2023 7:19	0	-0.014	-0.014	No	0	No
2/23/2023 7:20	0	-0.014	-0.014	No	0	No
2/23/2023 7:21	0	-0.014	-0.014	No	0	No
2/23/2023 7:22	0	0.026	-0.01	No	0	No
2/23/2023 7:23	0	0.093	-0.0006	No	0	No
2/23/2023 7:24	0	0.093	0.0072	No	0	No
2/23/2023 7:25	0	0.02	0.0082	No	0	No
2/23/2023 7:26	0	0.03	0.0097	No	0	No
2/23/2023 7:27	0	0.019	0.0103	No	0	No
2/23/2023 7:28	0.012	0.031	0.0129	No	0.0008	No
2/23/2023 7:29	0.016	0.019	0.0152	No	0.0019	No
2/23/2023 7:30	0	0.02	0.0176	No	0.0019	No
2/23/2023 7:31	0.012	0.021	0.02	No	0.0027	No
2/23/2023 7:32	0.017	0.021	0.0224	No	0.0038	No
2/23/2023 7:33	0.037	0.022	0.0249	No	0.0063	No
2/23/2023 7:34	0.012	0.022	0.0273	No	0.0071	No
2/23/2023 7:35	0.009	0.022	0.0297	No	0.0077	No
2/23/2023 7:36	0.006	0.022	0.0321	No	0.0081	No
2/23/2023 7:37	0.037	0.022	0.0318	No	0.0105	No
2/23/2023 7:38	0.024	0.021	0.027	No	0.0121	No
2/23/2023 7:39	0.027	0.021	0.0222	No	0.0139	No
2/23/2023 7:40	0.037	0.02	0.0222	No	0.0164	No
2/23/2023 7:41	0.021	0.021	0.0216	No	0.0178	No
2/23/2023 7:42	0.036	0.02	0.0217	No	0.0202	No
2/23/2023 7:43	0.043	0.02	0.0209	No	0.0223	No
2/23/2023 7:44	0.035	0.021	0.0211	No	0.0235	No
2/23/2023 7:45	0.053	0.021	0.0211	No	0.0271	No
2/23/2023 7:46	0.043	0.019	0.021	No	0.0291	No
2/23/2023 7:47	0.04	0.019	0.0209	No	0.0307	No
2/23/2023 7:48	0.041	0.02	0.0207	No	0.0309	No
2/23/2023 7:49	0.047	0.02	0.0206	No	0.0333	No
2/23/2023 7:50	0.045	0.021	0.0205	No	0.0357	No
2/23/2023 7:51	0.056	0.022	0.0205	No	0.039	No
2/23/2023 7:52	0.069	0.022	0.0205	No	0.0411	No
2/23/2023 7:53	0.08	0.021	0.0205	No	0.0449	No
2/23/2023 7:54	0.085	0.022	0.0206	No	0.0487	No
2/23/2023 7:55	0.109	0.021	0.0207	No	0.0535	No
2/23/2023 7:56	0.145	0.021	0.0207	No	0.0618	No
2/23/2023 7:57	0.153	0.021	0.0207	No	0.0696	No
2/23/2023 7:58	0.088	0.024	0.021	No	0.0726	No
2/23/2023 7:59	0.076	0.023	0.0211	No	0.0753	No
2/23/2023 8:00	0.08	0.023	0.0213	No	0.0771	No
2/23/2023 8:01	0.084	0.021	0.0214	No	0.0799	No
2/23/2023 8:02	0.082	0.022	0.0216	No	0.0827	No
2/23/2023 8:03	0.09	0.023	0.0218	No	0.0859	No
2/23/2023 8:04	0.102	0.023	0.022	No	0.0896	No
2/23/2023 8:05	0.092	0.023	0.0221	No	0.0927	No

Downwind Station						
Time	Instaneous VOC (ppm)	Instaneous Mass Conc. Total (mg/m ³)	Mass Conc. Total mg/m ³ AVG 15m (mg/m ³)	Dust Exceedance	VOC ppm AVG 15m (ppm)	VOC Exceedance
2/23/2023 8:06	0.093	0.023	0.0222	No	0.0952	No
2/23/2023 8:07	0.097	0.025	0.0224	No	0.0971	No
2/23/2023 8:08	0.126	0.024	0.0226	No	0.1001	No
2/23/2023 8:09	0.105	0.023	0.0227	No	0.1015	No
2/23/2023 8:10	0.103	0.023	0.0228	No	0.1011	No
2/23/2023 8:11	0.097	0.024	0.023	No	0.0979	No
2/23/2023 8:12	0.095	0.023	0.0231	No	0.094	No
2/23/2023 8:13	0.094	0.024	0.0231	No	0.0944	No
2/23/2023 8:14	0.111	0.022	0.0231	No	0.0967	No
2/23/2023 8:15	0.121	0.022	0.023	No	0.0995	No
2/23/2023 8:16	0.108	0.026	0.0233	No	0.1011	No
2/23/2023 8:17	0.116	0.026	0.0236	No	0.1033	No
2/23/2023 8:18	0.128	0.025	0.0237	No	0.1059	No
2/23/2023 8:19	0.119	0.025	0.0239	No	0.107	No
2/23/2023 8:20	0.126	0.026	0.0241	No	0.1093	No
2/23/2023 8:21	0.151	0.027	0.0243	No	0.1131	No
2/23/2023 8:22	0.156	0.027	0.0245	No	0.1171	No
2/23/2023 8:23	0.135	0.027	0.0247	No	0.1177	No
2/23/2023 8:24	0.138	0.027	0.0249	No	0.1199	No
2/23/2023 8:25	0.129	0.033	0.0256	No	0.1216	No
2/23/2023 8:26	0.201	0.031	0.0261	No	0.1285	No
2/23/2023 8:27	0.143	0.031	0.0266	No	0.1317	No
2/23/2023 8:28	0.142	0.029	0.0269	No	0.1349	No
2/23/2023 8:29	0.147	0.029	0.0274	No	0.1373	No
2/23/2023 8:30	0.164	0.034	0.0282	No	0.1402	No
2/23/2023 8:31	0.189	0.035	0.0288	No	0.1456	No
2/23/2023 8:32	0.164	0.03	0.0291	No	0.1488	No
2/23/2023 8:33	0.173	0.026	0.0291	No	0.1518	No
2/23/2023 8:34	0.172	0.025	0.0291	No	0.1553	No
2/23/2023 8:35	0.161	0.025	0.0291	No	0.1577	No
2/23/2023 8:36	0.183	0.028	0.0291	No	0.1598	No
2/23/2023 8:37	0.177	0.027	0.0291	No	0.1612	No
2/23/2023 8:38	0.17	0.026	0.0291	No	0.1635	No
2/23/2023 8:39	0.183	0.022	0.0287	No	0.1665	No
2/23/2023 8:40	0.172	0.02	0.0279	No	0.1694	No
2/23/2023 8:41	0.172	0.019	0.0271	No	0.1675	No
2/23/2023 8:42	0.186	0.02	0.0263	No	0.1703	No
2/23/2023 8:43	0.175	0.019	0.0257	No	0.1725	No
2/23/2023 8:44	0.18	0.019	0.025	No	0.1747	No
2/23/2023 8:45	0.184	0.019	0.024	No	0.1761	No
2/23/2023 8:46	0.183	0.019	0.0229	No	0.1757	No
2/23/2023 8:47	0.182	0.02	0.0223	No	0.1769	No
2/23/2023 8:48	0.199	0.019	0.0218	No	0.1786	No
2/23/2023 8:49	0.193	0.018	0.0213	No	0.18	No
2/23/2023 8:50	0.187	0.018	0.0209	No	0.1817	No
2/23/23 8:51	0.193	0.017	0.0201	No	0.1824	No
2/23/23 8:52	0.197	0.018	0.0195	No	0.1837	No
2/23/23 8:53	0.205	0.018	0.019	No	0.1861	No
2/23/23 8:54	0.239	0.023	0.0191	No	0.1898	No
2/23/23 8:55	0.209	0.02	0.0191	No	0.1923	No
2/23/23 8:56	0.207	0.016	0.0189	No	0.1946	No
2/23/23 8:57	0.215	0.016	0.0186	No	0.1965	No
2/23/23 8:58	0.211	0.018	0.0185	No	0.1989	No
2/23/23 8:59	0.216	0.018	0.0185	No	0.2013	No

Downwind Station						
Time	Instaneous VOC (ppm)	Instaneous Mass Conc. Total (mg/m ³)	Mass Conc. Total mg/m ³ AVG 15m (mg/m ³)	Dust Exceedance	VOC ppm AVG 15m (ppm)	VOC Exceedance
2/23/23 9:00	0.213	0.021	0.0186	No	0.2033	No
2/23/23 9:01	0.198	0.018	0.0185	No	0.2043	No
2/23/23 9:02	0.201	0.017	0.0183	No	0.2055	No
2/23/23 9:03	0.215	0.018	0.0183	No	0.2066	No
2/23/23 9:04	0.253	0.019	0.0183	No	0.2106	No
2/23/23 9:05	0.243	0.02	0.0185	No	0.2143	No
2/23/23 9:06	0.212	0.018	0.0185	No	0.2156	No
2/23/23 9:07	0.212	0.02	0.0187	No	0.2166	No
2/23/23 9:08	0.214	0.019	0.0187	No	0.2172	No
2/23/23 9:09	0.226	0.018	0.0184	No	0.2163	No
2/23/23 9:10	0.238	0.024	0.0187	No	0.2183	No
2/23/23 9:11	0.233	0.02	0.0189	No	0.22	No
2/23/23 9:12	0.229	0.019	0.0191	No	0.2209	No
2/23/23 9:13	0.239	0.02	0.0193	No	0.2228	No
2/23/23 9:14	0.23	0.018	0.0193	No	0.2237	No
2/23/23 9:15	0.256	0.017	0.019	No	0.2266	No
2/23/23 9:16	0.243	0.018	0.019	No	0.2296	No
2/23/23 9:17	0.24	0.017	0.019	No	0.2322	No
2/23/23 9:18	0.283	0.016	0.0189	No	0.2367	No
2/23/23 9:19	0.25	0.018	0.0188	No	0.2365	No
2/23/23 9:20	0.275	0.017	0.0186	No	0.2387	No
2/23/23 9:21	0.256	0.017	0.0185	No	0.2416	No
2/23/23 9:22	0.26	0.018	0.0184	No	0.2448	No
2/23/23 9:23	0.234	0.018	0.0183	No	0.2461	No
2/23/23 9:24	0.24	0.017	0.0183	No	0.2471	No
2/23/23 9:25	0.238	0.017	0.0178	No	0.2471	No
2/23/23 9:26	0.235	0.017	0.0176	No	0.2472	No
2/23/23 9:27	0.232	0.016	0.0174	No	0.2474	No
2/23/23 9:28	0.253	0.016	0.0171	No	0.2483	No
2/23/23 9:29	0.251	0.015	0.0169	No	0.2497	No
2/23/23 9:30	0.271	0.015	0.0168	No	0.2507	No
2/23/23 9:31	0.259	0.013	0.0165	No	0.2518	No
2/23/23 9:32	0.245	0.012	0.0161	No	0.2521	No
2/23/23 9:33	0.241	0.012	0.0159	No	0.2493	No
2/23/23 9:34	0.243	0.013	0.0155	No	0.2489	No
2/23/23 9:35	0.277	0.013	0.0153	No	0.249	No
2/23/23 9:36	0.284	0.013	0.015	No	0.2509	No
2/23/23 9:37	0.25	0.012	0.0146	No	0.2502	No
2/23/23 9:38	0.26	0.013	0.0143	No	0.2519	No
2/23/23 9:39	0.259	0.012	0.0139	No	0.2532	No
2/23/23 9:40	0.249	0.013	0.0137	No	0.2539	No
2/23/23 9:41	0.249	0.013	0.0134	No	0.2549	No
2/23/23 9:42	0.248	0.013	0.0132	No	0.2559	No
2/23/23 9:43	0.252	0.012	0.0129	No	0.2559	No
2/23/23 9:44	0.255	0.012	0.0127	No	0.2561	No
2/23/23 9:45	0.275	0.011	0.0125	No	0.2564	No
2/23/23 9:46	0.256	0.01	0.0123	No	0.2562	No
2/23/23 9:47	0.255	0.01	0.0121	No	0.2569	No
2/23/23 9:48	0.273	0.009	0.0119	No	0.259	No
2/23/23 9:49	0.257	0.012	0.0119	No	0.2599	No
2/23/23 9:50	0.275	0.01	0.0117	No	0.2598	No
2/23/23 9:51	0.263	0.008	0.0113	No	0.2584	No
2/23/23 9:52	0.269	0.006	0.0109	No	0.2597	No
2/23/23 9:53	0.268	0.007	0.0105	No	0.2602	No

Downwind Station						
Time	Instaneous VOC (ppm)	Instaneous Mass Conc. Total (mg/m ³)	Mass Conc. Total mg/m ³ AVG 15m (mg/m ³)	Dust Exceedance	VOC ppm AVG 15m (ppm)	VOC Exceedance
2/23/23 9:54	0.261	0.007	0.0102	No	0.2603	No
2/23/23 9:55	0.265	0.007	0.0098	No	0.2614	No
2/23/23 9:56	0.278	0.007	0.0094	No	0.2633	No
2/23/23 9:57	0.275	0.008	0.0091	No	0.2651	No
2/23/23 9:58	0.285	0.006	0.0087	No	0.2673	No
2/23/23 9:59	0.276	0.006	0.0083	No	0.2687	No
2/23/23 10:00	0.286	0.007	0.008	No	0.2695	No
2/23/23 10:01	0.285	0.008	0.0079	No	0.2714	No
2/23/23 10:02	0.27	0.009	0.0078	No	0.2724	No
2/23/23 10:03	0.268	0.009	0.0078	No	0.2721	No
2/23/23 10:04	0.268	0.01	0.0077	No	0.2728	No
2/23/23 10:05	0.29	0.01	0.0077	No	0.2738	No
2/23/23 10:06	0.272	0.007	0.0076	No	0.2744	No
2/23/23 10:07	0.272	0.007	0.0077	No	0.2746	No
2/23/23 10:08	0.275	0.006	0.0076	No	0.2751	No
2/23/23 10:09	0.299	0.006	0.0075	No	0.2776	No
2/23/23 10:10	0.293	0.006	0.0075	No	0.2795	No
2/23/23 10:11	0.287	0.006	0.0074	No	0.2801	No
2/23/23 10:12	0.278	0.007	0.0073	No	0.2803	No
2/23/23 10:13	0.276	0.007	0.0074	No	0.2797	No
2/23/23 10:14	0.276	0.008	0.0075	No	0.2797	No
2/23/23 10:15	0.278	0.01	0.0077	No	0.2791	No
2/23/23 10:16	0.279	0.01	0.0079	No	0.2787	No
2/23/23 10:17	0.278	0.01	0.0079	No	0.2793	No
2/23/23 10:18	0.28	0.01	0.008	No	0.2801	No
2/23/23 10:19	0.279	0.01	0.008	No	0.2808	No
2/23/23 10:20	0.285	0.01	0.008	No	0.2805	No
2/23/23 10:21	0.309	0.014	0.0085	No	0.2829	No
2/23/23 10:22	0.278	0.008	0.0085	No	0.2833	No
2/23/23 10:23	0.282	0.007	0.0086	No	0.2838	No
2/23/23 10:24	0.28	0.009	0.0088	No	0.2825	No
2/23/23 10:25	0.292	0.011	0.0091	No	0.2825	No
2/23/23 10:26	0.286	0.011	0.0095	No	0.2824	No
2/23/23 10:27	0.297	0.009	0.0096	No	0.2837	No
2/23/23 10:28	0.281	0.008	0.0097	No	0.284	No
2/23/23 10:29	0.284	0.006	0.0095	No	0.2845	No
2/23/23 10:30	0.292	0.007	0.0093	No	0.2855	No
2/23/23 10:31	0.296	0.007	0.0091	No	0.2866	No
2/23/23 10:32	0.283	0.007	0.0089	No	0.2869	No
2/23/23 10:33	0.279	0.007	0.0087	No	0.2869	No
2/23/23 10:34	0.285	0.007	0.0085	No	0.2873	No
2/23/23 10:35	0.28	0.006	0.0083	No	0.2869	No
2/23/23 10:36	0.293	0.006	0.0077	No	0.2859	No
2/23/23 10:37	0.297	0.011	0.0079	No	0.2871	No
2/23/23 10:38	0.277	0.004	0.0077	No	0.2868	No
2/23/23 10:39	0.282	0.004	0.0074	No	0.2869	No
2/23/23 10:40	0.285	0.004	0.0069	No	0.2865	No
2/23/23 10:41	0.283	0.005	0.0065	No	0.2863	No
2/23/23 10:42	0.311	0.007	0.0064	No	0.2872	No
2/23/23 10:43	0.284	0.006	0.0063	No	0.2874	No
2/23/23 10:44	0.302	0.004	0.0061	No	0.2886	No
2/23/23 10:45	0.304	0.004	0.0059	No	0.2894	No
2/23/23 10:46	0.286	0.005	0.0058	No	0.2887	No
2/23/23 10:47	0.293	0.005	0.0057	No	0.2894	No

Downwind Station						
Time	Instaneous VOC (ppm)	Instaneous Mass Conc. Total (mg/m ³)	Mass Conc. Total mg/m ³ AVG 15m (mg/m ³)	Dust Exceedance	VOC ppm AVG 15m (ppm)	VOC Exceedance
2/23/23 10:48	0.306	0.007	0.0057	No	0.2912	No
2/23/23 10:49	0.302	0.009	0.0058	No	0.2923	No
2/23/23 10:50	0.319	0.006	0.0058	No	0.2949	No
2/23/23 10:51	0.301	0.004	0.0057	No	0.2955	No
2/23/23 10:52	0.295	0.002	0.0051	No	0.2953	No
2/23/23 10:53	0.3	0	0.0048	No	0.2969	No
2/23/23 10:54	0.301	0.003	0.0047	No	0.2981	No
2/23/23 10:55	0.3	0.002	0.0046	No	0.2991	No
2/23/23 10:56	0.294	0.002	0.0044	No	0.2999	No
2/23/23 10:57	0.293	0.003	0.0041	No	0.2987	No
2/23/23 10:58	0.299	0.003	0.0039	No	0.2997	No
2/23/23 10:59	0.286	0.001	0.0037	No	0.2986	No
2/23/23 11:00	0.288	0.005	0.0038	No	0.2975	No
2/23/23 11:01	0.29	0.004	0.0037	No	0.2978	No
2/23/23 11:02	0.296	0.004	0.0037	No	0.298	No
2/23/23 11:03	0.305	0.004	0.0035	No	0.2979	No
2/23/23 11:04	0.306	0.008	0.0034	No	0.2982	No
2/23/23 11:05	0.3	0.004	0.0033	No	0.2969	No
2/23/23 11:06	0.301	0.004	0.0033	No	0.2969	No
2/23/23 11:07	0.307	0.004	0.0034	No	0.2977	No
2/23/23 11:08	0.306	0.004	0.0037	No	0.2981	No
2/23/23 11:09	0.3	0.001	0.0035	No	0.2981	No
2/23/23 11:10	0.301	0.001	0.0035	No	0.2981	No
2/23/23 11:11	0.299	0.003	0.0035	No	0.2985	No
2/23/23 11:12	0.295	0.003	0.0035	No	0.2986	No
2/23/23 11:13	0.312	0.001	0.0034	No	0.2995	No
2/23/23 11:14	0.298	0.001	0.0034	No	0.3003	No
2/23/23 11:15	0.293	0.002	0.0032	No	0.3006	No
2/23/23 11:16	0.297	0.003	0.0031	No	0.3011	No
2/23/23 11:17	0.305	0.005	0.0032	No	0.3017	No
2/23/23 11:18	0.305	0.003	0.0031	No	0.3017	No
2/23/23 11:19	0.303	0.004	0.0029	No	0.3015	No
2/23/23 11:20	0.305	0.005	0.0029	No	0.3018	No
2/23/23 11:21	0.302	0.009	0.0033	No	0.3019	No
2/23/23 11:22	0.307	0.009	0.0036	No	0.3019	No
2/23/23 11:23	0.302	0.01	0.004	No	0.3016	No
2/23/23 11:24	0.31	0.017	0.0051	No	0.3023	No
2/23/23 11:25	0.329	0.014	0.0059	No	0.3041	No
2/23/23 11:26	0.321	0.011	0.0065	No	0.3056	No
2/23/23 11:27	0.306	0.007	0.0067	No	0.3063	No
2/23/23 11:28	0.304	0.012	0.0075	No	0.3058	No
2/23/23 11:29	0.326	0.009	0.008	No	0.3077	No
2/23/23 11:30	0.31	0.008	0.0084	No	0.3088	No
2/23/23 11:31	0.308	0.006	0.0086	No	0.3095	No
2/23/23 11:32	0.314	0.008	0.0088	No	0.3101	No
2/23/23 11:33	0.309	0.008	0.0091	No	0.3104	No
2/23/23 11:34	0.307	0.007	0.0093	No	0.3107	No
2/23/23 11:35	0.308	0.011	0.0097	No	0.3109	No
2/23/23 11:36	0.31	0.011	0.0099	No	0.3114	No
2/23/23 11:37	0.312	0.009	0.0099	No	0.3117	No
2/23/23 11:38	0.302	0.008	0.0097	No	0.3117	No
2/23/23 11:39	0.3	0.01	0.0093	No	0.3111	No
2/23/23 11:40	0.296	0.006	0.0087	No	0.3089	No
2/23/23 11:41	0.295	0.005	0.0083	No	0.3071	No

Downwind Station						
Time	Instaneous VOC (ppm)	Instaneous Mass Conc. Total (mg/m ³)	Mass Conc. Total mg/m ³ AVG 15m (mg/m ³)	Dust Exceedance	VOC ppm AVG 15m (ppm)	VOC Exceedance
2/23/23 11:42	0.302	0.005	0.0082	No	0.3069	No
2/23/23 11:43	0.305	0.006	0.0078	No	0.3069	No
2/23/23 11:44	0.299	0.005	0.0075	No	0.3051	No
2/23/23 11:45	0.302	0.002	0.0071	No	0.3046	No
2/23/23 11:46	0.307	0.004	0.007	No	0.3045	No
2/23/23 11:47	0.321	0.008	0.007	No	0.305	No
2/23/23 11:48	0.333	0.006	0.0069	No	0.3066	No
2/23/23 11:49	0.325	0.004	0.0067	No	0.3078	No
2/23/23 11:50	0.306	0.006	0.0063	No	0.3077	No
2/23/23 11:51	0.3	0.007	0.0061	No	0.307	No
2/23/23 11:52	0.3	0.007	0.0059	No	0.3062	No
2/23/23 11:53	0.305	0.008	0.0059	No	0.3064	No
2/23/23 11:54	0.3	0.001	0.0053	No	0.3064	No
2/23/23 11:55	0.309	0.002	0.0051	No	0.3073	No
2/23/23 11:56	0.302	0.01	0.0054	No	0.3077	No
2/23/23 11:57	0.306	0.006	0.0055	No	0.308	No
2/23/23 11:58	0.306	0.005	0.0054	No	0.3081	No
2/23/23 11:59	0.312	0.012	0.0059	No	0.3089	No
2/23/23 12:00	0.313	0.01	0.0064	No	0.3097	No
2/23/23 12:01	0.309	0.017	0.0073	No	0.3098	No
2/23/23 12:02	0.312	0.027	0.0085	No	0.3092	No
2/23/23 12:03	0.308	0.015	0.0091	No	0.3075	No
2/23/23 12:04	0.31	0.01	0.0095	No	0.3065	No
2/23/23 12:05	0.306	0.023	0.0107	No	0.3065	No
2/23/23 12:06	0.32	0.026	0.0119	No	0.3079	No
2/23/23 12:07	0.307	0.017	0.0126	No	0.3083	No
2/23/23 12:08	0.306	0.016	0.0131	No	0.3084	No
2/23/23 12:09	0.304	0.026	0.0148	No	0.3087	No
2/23/23 12:10	0.312	0.017	0.0158	No	0.3089	No
2/23/23 12:11	0.322	0.018	0.0163	No	0.3102	No
2/23/23 12:12	0.316	0.013	0.0168	No	0.3109	No
2/23/23 12:13	0.321	0.007	0.0169	No	0.3119	No
2/23/23 12:14	0.335	0.012	0.0169	No	0.3134	No
2/23/23 12:15	0.316	0.02	0.0176	No	0.3136	No
2/23/23 12:16	0.33	0.021	0.0179	No	0.315	No
2/23/23 12:17	0.317	0.022	0.0175	No	0.3153	No
2/23/23 12:18	0.319	0.018	0.0177	No	0.3161	No
2/23/23 12:19	0.317	0.016	0.0181	No	0.3165	No
2/23/23 12:20	0.318	0.016	0.0177	No	0.3173	No
2/23/23 12:21	0.309	0.01	0.0166	No	0.3166	No
2/23/23 12:22	0.312	0.009	0.0161	No	0.3169	No
2/23/23 12:23	0.321	0.007	0.0155	No	0.3179	No
2/23/23 12:24	0.313	0.01	0.0144	No	0.3185	No
2/23/23 12:25	0.329	0.013	0.0141	No	0.3197	No
2/23/23 12:26	0.308	0.016	0.014	No	0.3187	No
2/23/23 12:27	0.305	0.009	0.0137	No	0.318	No
2/23/23 12:28	0.308	0.01	0.0139	No	0.3171	No
2/23/23 12:29	0.308	0.008	0.0137	No	0.3153	No
2/23/23 12:30	0.311	0.012	0.0131	No	0.315	No
2/23/23 12:31	0.316	0.01	0.0124	No	0.3141	No
2/23/23 12:32	0.314	0.005	0.0113	No	0.3139	No
2/23/23 12:33	0.317	0.004	0.0103	No	0.3137	No
2/23/23 12:34	0.314	0.004	0.0095	No	0.3135	No
2/23/23 12:35	0.307	0.002	0.0086	No	0.3128	No

Downwind Station						
Time	Instaneous VOC (ppm)	Instaneous Mass Conc. Total (mg/m ³)	Mass Conc. Total mg/m ³ AVG 15m (mg/m ³)	Dust Exceedance	VOC ppm AVG 15m (ppm)	VOC Exceedance
2/23/23 12:36	0.32	0.002	0.0081	No	0.3135	No
2/23/23 12:37	0.316	0.001	0.0075	No	0.3138	No
2/23/23 12:38	0.308	0.003	0.0073	No	0.3129	No
2/23/23 12:39	0.319	0.006	0.007	No	0.3133	No
2/23/23 12:40	0.312	0.007	0.0066	No	0.3122	No
2/23/23 12:41	0.332	0.003	0.0057	No	0.3138	No
2/23/23 12:42	0.315	0.004	0.0054	No	0.3145	No
2/23/23 12:43	0.32	0.005	0.0051	No	0.3153	No
2/23/23 12:44	0.318	0.006	0.0049	No	0.3159	No
2/23/23 12:45	0.321	0.006	0.0045	No	0.3166	No
2/23/23 12:46	0.325	0.011	0.0046	No	0.3172	No
2/23/23 12:47	0.313	0.007	0.0047	No	0.3171	No
2/23/23 12:48	0.314	0.007	0.0049	No	0.3169	No
2/23/23 12:49	0.325	0.007	0.0051	No	0.3177	No
2/23/23 12:50	0.329	0.009	0.0056	No	0.3191	No
2/23/23 12:51	0.33	0.01	0.0061	No	0.3198	No
2/23/23 12:52	0.323	0.007	0.0065	No	0.3203	No
2/23/23 12:53	0.324	0.01	0.007	No	0.3213	No
2/23/23 12:54	0.317	0.013	0.0075	No	0.3212	No
2/23/23 12:55	0.322	0.011	0.0077	No	0.3219	No
2/23/23 12:56	0.32	0.009	0.0081	No	0.3211	No
2/23/23 12:57	0.325	0.011	0.0086	No	0.3217	No
2/23/23 12:58	0.314	0.014	0.0092	No	0.3213	No
2/23/23 12:59	0.324	0.014	0.0097	No	0.3217	No
2/23/23 13:00	0.317	0.009	0.0099	No	0.3215	No
2/23/23 13:01	0.319	0.006	0.0096	No	0.3211	No
2/23/23 13:02	0.331	0.005	0.0095	No	0.3223	No
2/23/23 13:03	0.323	0.007	0.0095	No	0.3229	No
2/23/23 13:04	0.312	0.001	0.0091	No	0.322	No
2/23/23 13:05	0.335	0	0.0085	No	0.3224	No
2/23/23 13:06	0.326	0	0.0078	No	0.3221	No
2/23/23 13:07	0.342	0.004	0.0076	No	0.3234	No
2/23/23 13:08	0.323	0.007	0.0074	No	0.3233	No
2/23/23 13:09	0.319	0.001	0.0066	No	0.3235	No
2/23/23 13:10	0.333	-0.002	0.0057	No	0.3242	No
2/23/23 13:11	0.315	-0.002	0.005	No	0.3239	No
2/23/23 13:12	0.326	-0.004	0.004	No	0.3239	No
2/23/23 13:13	0.314	-0.004	0.0028	No	0.3239	No
2/23/23 13:14	0.336	0.003	0.0021	No	0.3247	No
2/23/23 13:15	0.343	0.016	0.0025	No	0.3265	No
2/23/23 13:16	0.316	-0.004	0.0019	No	0.3263	No
2/23/23 13:17	0.333	-0.003	0.0013	No	0.3264	No
2/23/23 13:18	0.316	-0.002	0.0007	No	0.3259	No
2/23/23 13:19	0.317	-0.002	0.0005	No	0.3263	No
2/23/23 13:20	0.314	-0.002	0.0004	No	0.3249	No
2/23/23 13:21	0.322	-0.001	0.0003	No	0.3246	No
2/23/23 13:22	0.318	0.002	0.0002	No	0.323	No
2/23/23 13:23	0.34	0.002	-0.0001	No	0.3241	No
2/23/23 13:24	0.339	0.003	0	No	0.3255	No
2/23/23 13:25	0.325	0.001	0.0002	No	0.3249	No
2/23/23 13:26	0.328	0.001	0.0004	No	0.3258	No
2/23/23 13:27	0.32	0	0.0007	No	0.3254	No
2/23/23 13:28	0.321	0	0.0009	No	0.3259	No
2/23/23 13:29	0.32	0	0.0007	No	0.3248	No

Downwind Station						
Time	Instaneous VOC (ppm)	Instaneous Mass Conc. Total (mg/m ³)	Mass Conc. Total mg/m ³ AVG 15m (mg/m ³)	Dust Exceedance	VOC ppm AVG 15m (ppm)	VOC Exceedance
2/23/23 13:30	0.321	0	-0.0003	No	0.3233	No
2/23/23 13:31	0.337	0.001	0	No	0.3247	No
2/23/23 13:32	0.319	0	0.0002	No	0.3238	No
2/23/23 13:33	0.327	0	0.0003	No	0.3245	No
2/23/23 13:34	0.335	0	0.0005	No	0.3257	No
2/23/23 13:35	0.339	0.001	0.0007	No	0.3274	No
2/23/23 13:36	0.333	0.001	0.0008	No	0.3281	No
2/23/23 13:37	0.34	0.002	0.0008	No	0.3296	No
2/23/23 13:38	0.341	0.001	0.0007	No	0.3297	No
2/23/23 13:39	0.344	0	0.0005	No	0.33	No
2/23/23 13:40	0.33	0	0.0005	No	0.3303	No
2/23/23 13:41	0.335	0.002	0.0005	No	0.3308	No
2/23/23 13:42	0.338	0.001	0.0006	No	0.332	No
2/23/23 13:43	0.333	0.001	0.0007	No	0.3328	No
2/23/23 13:44	0.327	0.002	0.0008	No	0.3333	No
2/23/23 13:45	0.34	0.001	0.0009	No	0.3345	No
2/23/23 13:46	0.323	0	0.0008	No	0.3336	No
2/23/23 13:47	0.327	-0.001	0.0007	No	0.3341	No
2/23/23 13:48	0.322	-0.003	0.0005	No	0.3338	No
2/23/23 13:49	0.326	-0.002	0.0004	No	0.3332	No
2/23/23 13:50	0.323	-0.003	0.0001	No	0.3321	No
2/23/23 13:51	0.328	0	0.0001	No	0.3318	No
2/23/23 13:52	0.333	0	-0.0001	No	0.3313	No
2/23/23 13:53	0.331	0	-0.0001	No	0.3307	No
2/23/23 13:54	0.328	0.061	0.0039	No	0.3296	No
2/23/23 13:55	0.344	0.005	0.0043	No	0.3305	No
2/23/23 14:01	0.328			No	0.329	No
2/23/23 14:02	0.332	0.065	0.0137	No	0.3295	No
2/23/23 14:03	0.338	0.039	0.0183	No	0.3311	No
2/23/23 14:04	0.326	0.021	0.0209	No	0.3311	No
2/23/23 14:05	0.331	0.064	0.0283	No	0.3319	No
2/23/23 14:06	0.334	0.012	0.0297	No	0.3325	No
2/23/23 14:07	0.343	0.011	0.0309	No	0.3335	No
2/23/23 14:08	0.328	0.009	0.0319	No	0.3332	No
2/23/23 14:09	0.32	0.008	0.026	No	0.3324	No
2/23/23 14:10	0.325	0.008	0.0263	No	0.3305	No
2/23/23 14:11	0.344	0.006	0.0243	No	0.3317	No
2/23/23 14:12	0.336	0.008	0.0228	No	0.3321	No
2/23/23 14:13	0.326	0.007	0.0215	No	0.3316	No
2/23/23 14:14	0.322	0.007	0.0204	No	0.3309	No
2/23/23 14:15	0.333	0.01	0.0196	No	0.3311	No
2/23/23 14:16	0.327	0.01	0.019	No	0.331	No
2/23/23 14:17	0.32	0.012	0.0155	No	0.3302	No
2/23/23 14:18	0.322	0.013	0.0137	No	0.3291	No
2/23/23 14:19	0.318	0.008	0.0129	No	0.3286	No
2/23/23 14:20	0.323	0.014	0.0095	No	0.3281	No
2/23/23 14:21	0.335	0.012	0.0095	No	0.3281	No
2/23/23 14:22	0.325	0.007	0.0093	No	0.3269	No
2/23/23 14:23	0.326	0.005	0.009	No	0.3268	No
2/23/23 14:24	0.34	0.005	0.0088	No	0.3281	No
2/23/23 14:25	0.339	0.006	0.0087	No	0.3291	No
2/23/23 14:26	0.321	0.005	0.0086	No	0.3275	No
2/23/23 14:27	0.319	0.005	0.0084	No	0.3264	No
2/23/23 14:28	0.324	0.006	0.0083	No	0.3263	No

Downwind Station						
Time	Instantaneous VOC (ppm)	Instantaneous Mass Conc. Total (mg/m ³)	Mass Conc. Total mg/m ³ AVG 15m (mg/m ³)	Dust Exceedance	VOC ppm AVG 15m (ppm)	VOC Exceedance
2/23/23 14:29	0.321	0.004	0.0081	No	0.3262	No
2/23/23 14:30	0.352	0.005	0.0078	No	0.3275	No
2/23/23 14:31	0.331	0.006	0.0075	No	0.3277	No
2/23/23 14:32	0.339	0.01	0.0074	No	0.329	No
2/23/23 14:33	0.327	0.008	0.0071	No	0.3293	No
2/23/23 14:34	0.319	0.005	0.0069	No	0.3294	No
2/23/23 14:35	0.322	0.004	0.0062	No	0.3293	No
2/23/23 14:36	0.327	0.004	0.0057	No	0.3288	No
2/23/23 14:37	0.324	0.007	0.0057	No	0.3287	No
2/23/23 14:38	0.316	0.003	0.0055	No	0.3281	No
2/23/23 14:39	0.335	0.005	0.0055	No	0.3277	No
2/23/23 14:40	0.362	0.006	0.0055	No	0.3293	No
2/23/23 14:41	0.349	0.006	0.0056	No	0.3311	No
2/23/23 14:42	0.338	0.005	0.0056	No	0.3324	No
2/23/23 14:43	0.325	0.004	0.0055	No	0.3325	No
2/23/23 14:44	0.325	0.003	0.0054	No	0.3327	No
2/23/23 14:45	0.321	0	0.0051	No	0.3307	No
2/23/23 14:46	0.325	0	0.0047	No	0.3303	No
2/23/23 14:47	0.337	0.003	0.0042	No	0.3301	No
2/23/23 14:48	0.335	0.002	0.0038	No	0.3307	No
2/23/23 14:49	0.321	0.002	0.0036	No	0.3308	No
2/23/23 14:50	0.32	0.001	0.0034	No	0.3307	No
2/23/23 14:51	0.315	0.001	0.0032	No	0.3299	No
2/23/23 14:52	0.321	0.001	0.0028	No	0.3297	No
2/23/23 14:53	0.327	0.002	0.0027	No	0.3304	No
2/23/23 14:54	0.323	0.003	0.0026	No	0.3296	No
2/23/23 14:55	0.322	0.001	0.0023	No	0.3269	No
2/23/23 14:56	0.323	0.004	0.0021	No	0.3252	No
2/23/23 14:57	0.318	0.002	0.0019	No	0.3239	No
2/23/23 14:58	0.324	0	0.0017	No	0.3238	No
2/23/23 14:59	0.333	0	0.0015	No	0.3243	No
2/23/23 15:00	0.318	0.001	0.0015	No	0.3241	No
2/23/23 15:01	0.319	0.003	0.0017	No	0.3237	No
2/23/23 15:02	0.334	0.003	0.0017	No	0.3235	No
2/23/23 15:03	0.312	0.002	0.0017	No	0.322	No
2/23/23 15:04	0.315	0.003	0.0018	No	0.3216	No
2/23/23 15:05	0.322	0.002	0.0019	No	0.3217	No
2/23/23 15:06	0.327	0.002	0.0019	No	0.3225	No
2/23/23 15:07	0.324	0.004	0.0021	No	0.3227	No
2/23/23 15:08	0.316	0.005	0.0023	No	0.322	No
2/23/23 15:09	0.31	0.004	0.0024	No	0.3211	No
2/23/23 15:10	0.309	0.001	0.0024	No	0.3203	No