



Daily Activity Report

Seton Brilla Charter School
1956 Jerome Avenue, Bronx, NY
BCP No. C203152

General Site Information

Date:	Wednesday, February 22, 2023
Weather:	Mostly Cloudy, 33-42°F
Wind Direction/Speed:	SE @ 4 mph
AKRF Personnel on Site:	Celia Meyer
AKRF Equipment on Site:	Mini RAE 3000 Photoionization Detector [(PID) x1], 2 Fixed Air Monitoring Stations [DustTrak
Visitors:	None.

Contractor Information

Contracting Company	Main Personnel	Equipment
Casino Construction	Connor McGrory	Excavator, CFA Drill Rig

Description and Location of Work Activities Performed

1) Excavation of soil/fill around piles in grid WC-03 between 0700 and 0850. Soil disturbance activities were suspended for the day after 0850.

Site Soil Disposal Tracking Information

Destination Facility	Daily Trucks	Total Trucks	Daily Approx. Cubic Yds	Total Approx. Cubic Yds	Total Site Loads	Total Approximate Cubic Yards
Clean Earth Carteret	0	73	0	1,460	165	3,300
Clean Earth Southeastern Pennsylvania	0	66	0	1,320		
Concrete Disposal	0	26	0	520		
N/A	0	0	0	0		
N/A	0	0	0	0		

CAMP Air Monitoring Results

CAMP Station	UPWIND				DOWNWIND		
Odors:	None.				None.		
VOC Action Level Exceedance(s):	None.				None.		
Particulate Action Level Exceedance(s):	None.				None.		
Maximum VOC Level (15 min ppm):	0.111				0.071		
Maximum Particulate Level (15 min mg/m ³):	0.0269				0.050		

Notes: CAMP monitoring was performed throughout the day. CAMP activity ended at 08:50.

Additional Information

Planned Work Activity for Following Day/Week:	1) Excavation of soil/fill to uncover piles.
Comments:	None.

Site Map

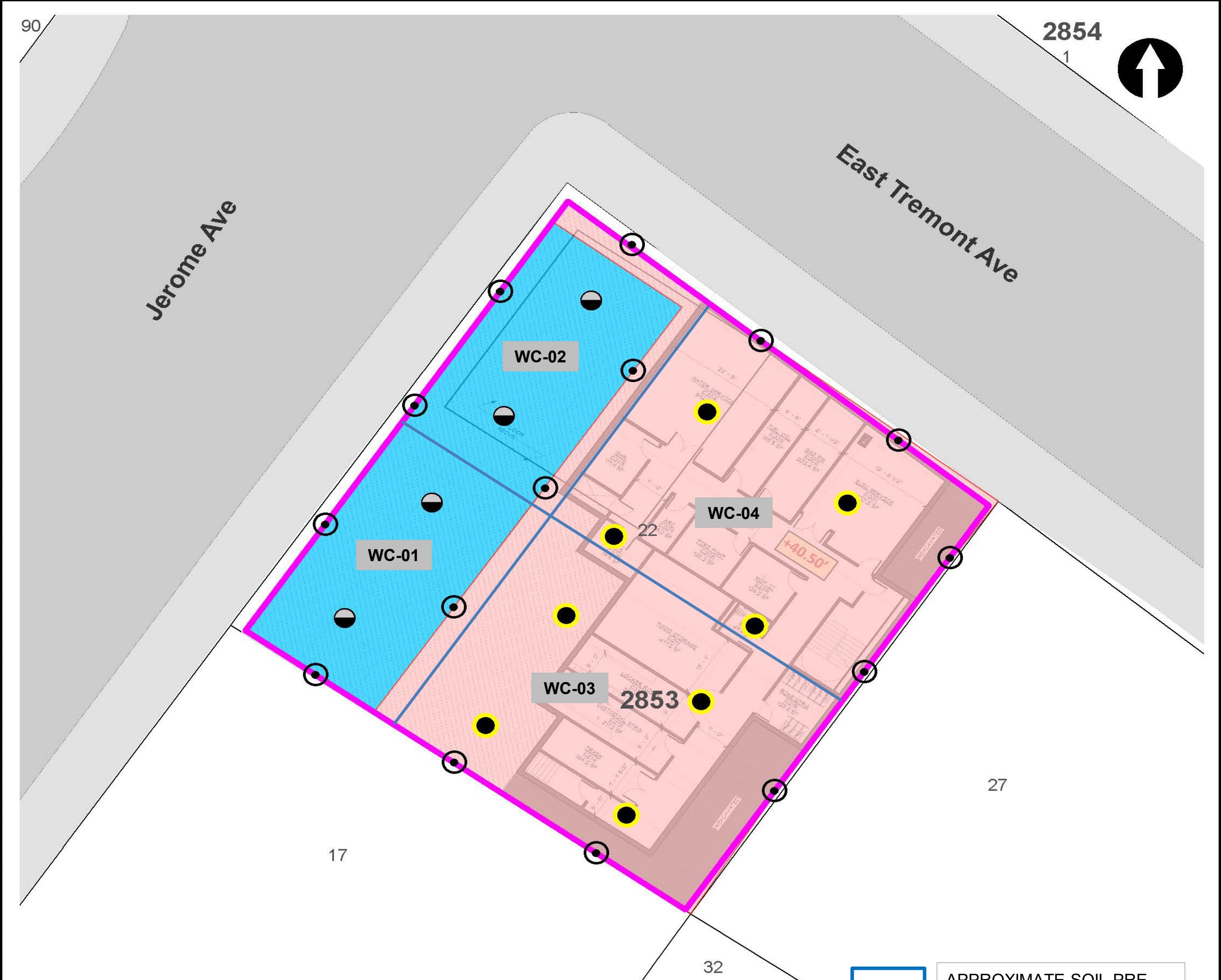

LEGEND

- PROJECT SITE BOUNDARY
- LOT BOUNDARY AND TAX LOT NUMBER
- 2853** BLOCK NUMBER
- REMEDIAL EXCAVATION TO APPROXIMATELY TWO FEET BELOW EXISTING GRADE
- REMEDIAL EXCAVATION TO GROUNDWATER (SOURCE AREA)

- CONFIRMATION DOCUMENTATION BOTTOM SAMPLE
- SOURCE AREA DOCUMENTATION BOTTOM SAMPLE
- DOCUMENTATION SIDEWALL SAMPLE

NOTE
 REMEDIAL EXCAVATION WILL INCLUDE REMOVAL OF APPROXIMATELY 1,280 TONS (850 CUBIC YARDS) OF SOURCE MATERIAL ASSOCIATED WITH NYSDEC SPILL NO. 2103719 AND APPROXIMATELY 860 TONS (570 CUBIC YARDS) OF SOIL/FILL FROM THE UPPER 2 FEET SITE-WIDE.



Map Source:
 NYCDOP (NYC Dept. of City Planning) GIS database

© 2021 AKRF. W:\Projects\210024 - 1956 JEROME AVENUE\Technical\GIS and Graphics\AR\RAW\210024 Figure 9 Proposed Remedial Excavation and Documentation Sample Location Plan.mxd 10/25/2021 2:03:38 PM iszalus



440 Park Avenue South, New York, NY 10016

1956 Jerome Avenue
 Bronx, New York

**TRACK 4 CLEANUP AND DOCUMENTATION
 SAMPLE LOCATION PLAN**

DATE
04/29/2022

PROJECT NO.
210024

FIGURE
11

Site Photographs

Photograph 1 -
Excavation in Grid
WC-03, view facing
east.



Upwind Station						
Time	Instaneous VOC (ppm)	Instaneous Mass Conc. Total (mg/m ³)	Mass Conc. Total mg/m ³ AVG 15m (mg/m ³)	Dust Exceedance	VOC ppm AVG 15m (ppm)	VOC Exceedance
2/22/2023 7:12	0	0.023	0.023	No	0	No
2/22/2023 7:13	0	0.02	0.0215	No	0	No
2/22/2023 7:14	0	0.021	0.0213	No	0	No
2/22/2023 7:15	0	0.025	0.0223	No	0	No
2/22/2023 7:16	0	0.034	0.0246	No	0	No
2/22/2023 7:17	0	0.032	0.0258	No	0	No
2/22/2023 7:18	0	0.033	0.0269	No	0	No
2/22/2023 7:19	0	0.023	0.0264	No	0	No
2/22/2023 7:20	0	0.025	0.0262	No	0	No
2/22/2023 7:21	0	0.024	0.026	No	0	No
2/22/2023 7:22	0	0.022	0.0256	No	0	No
2/22/2023 7:23	0	0.021	0.0253	No	0	No
2/22/2023 7:24	0	0.02	0.0248	No	0	No
2/22/2023 7:25	0	0.026	0.0249	No	0	No
2/22/2023 7:26	0	0.023	0.0248	No	0	No
2/22/2023 7:27	0	0.022	0.0247	No	0	No
2/22/2023 7:28	0	0.02	0.0247	No	0	No
2/22/2023 7:29	0	0.021	0.0247	No	0	No
2/22/2023 7:30	0	0.022	0.0245	No	0	No
2/22/2023 7:31	0	0.023	0.0238	No	0	No
2/22/2023 7:32	0	0.027	0.0235	No	0	No
2/22/2023 7:33	0	0.02	0.0226	No	0	No
2/22/2023 7:34	0	0.02	0.0224	No	0	No
2/22/2023 7:35	0	0.022	0.0222	No	0	No
2/22/2023 7:36	0	0.019	0.0219	No	0	No
2/22/2023 7:37	0	0.022	0.0219	No	0	No
2/22/2023 7:38	0	0.023	0.022	No	0	No
2/22/2023 7:39	0	0.022	0.0221	No	0	No
2/22/2023 7:40	0	0.022	0.0219	No	0	No
2/22/2023 7:41	0	0.026	0.0221	No	0	No
2/22/2023 7:42	0	0.025	0.0223	No	0	No
2/22/2023 7:43	0	0.033	0.0231	No	0	No
2/22/2023 7:44	0	0.024	0.0233	No	0	No
2/22/2023 7:45	0	0.021	0.0233	No	0	No
2/22/2023 7:46	0	0.027	0.0235	No	0	No
2/22/2023 7:47	0	0.026	0.0235	No	0	No
2/22/2023 7:48	0	0.025	0.0238	No	0	No
2/22/2023 7:49	0	0.028	0.0243	No	0	No
2/22/2023 7:50	0	0.027	0.0247	No	0	No
2/22/2023 7:51	0	0.022	0.0249	No	0	No
2/22/2023 7:52	0	0.02	0.0247	No	0	No
2/22/2023 7:53	0	0.02	0.0245	No	0	No
2/22/2023 7:54	0	0.021	0.0245	No	0	No
2/22/2023 7:55	0	0.034	0.0253	No	0	No
2/22/2023 7:56	0	0.033	0.0257	No	0	No
2/22/2023 7:57	0	0.024	0.0257	No	0	No
2/22/2023 7:58	0	0.02	0.0248	No	0	No
2/22/2023 7:59	0	0.019	0.0245	No	0	No
2/22/2023 8:00	0	0.021	0.0245	No	0	No
2/22/2023 8:01	0	0.021	0.0241	No	0	No
2/22/2023 8:02	0	0.02	0.0237	No	0	No
2/22/2023 8:03	0	0.02	0.0233	No	0	No

Upwind Station						
Time	Instantaneous VOC (ppm)	Instantaneous Mass Conc. Total (mg/m ³)	Mass Conc. Total mg/m ³ AVG 15m (mg/m ³)	Dust Exceedance	VOC ppm AVG 15m (ppm)	VOC Exceedance
2/22/2023 8:04	0	0.021	0.0229	No	0	No
2/22/2023 8:05	0	0.023	0.0226	No	0	No
2/22/2023 8:06	0	0.021	0.0225	No	0	No
2/22/2023 8:07	0	0.02	0.0225	No	0	No
2/22/2023 8:08	0	0.021	0.0226	No	0	No
2/22/2023 8:09	0	0.022	0.0227	No	0	No
2/22/2023 8:10	0	0.022	0.0219	No	0	No
2/22/2023 8:11	0	0.021	0.0211	No	0	No
2/22/2023 8:12	0	0.021	0.0209	No	0	No
2/22/2023 8:13	0.005	0.022	0.021	No	0.0003	No
2/22/2023 8:14	0.003	0.021	0.0211	No	0.0005	No
2/22/2023 8:15	0.01	0.021	0.0211	No	0.0012	No
2/22/2023 8:16	0.018	0.021	0.0211	No	0.0024	No
2/22/2023 8:17	0.018	0.023	0.0213	No	0.0036	No
2/22/2023 8:18	0.016	0.024	0.0216	No	0.0047	No
2/22/2023 8:19	0.025	0.024	0.0218	No	0.0063	No
2/22/2023 8:20	0.023	0.023	0.0218	No	0.0079	No
2/22/2023 8:21	0.034	0.022	0.0219	No	0.0101	No
2/22/2023 8:22	0.038	0.022	0.022	No	0.0127	No
2/22/2023 8:23	0.045	0.023	0.0221	No	0.0157	No
2/22/2023 8:24	0.046	0.023	0.0222	No	0.0187	No
2/22/2023 8:25	0.043	0.024	0.0223	No	0.0216	No
2/22/2023 8:26	0.041	0.023	0.0225	No	0.0243	No
2/22/2023 8:27	0.063	0.021	0.0225	No	0.0285	No
2/22/2023 8:28	0.055	0.02	0.0223	No	0.0319	No
2/22/2023 8:29	0.067	0.023	0.0225	No	0.0361	No
2/22/2023 8:30	0.068	0.02	0.0224	No	0.04	No
2/22/2023 8:31	0.071	0.022	0.0225	No	0.0435	No
2/22/2023 8:32	0.075	0.02	0.0223	No	0.0473	No
2/22/2023 8:33	0.065	0.019	0.0219	No	0.0506	No
2/22/2023 8:34	0.091	0.022	0.0218	No	0.055	No
2/22/2023 8:35	0.079	0.029	0.0222	No	0.0587	No
2/22/2023 8:36	0.083	0.019	0.022	No	0.062	No
2/22/2023 8:37	0.084	0.019	0.0218	No	0.0651	No
2/22/2023 8:38	0.086	0.018	0.0215	No	0.0678	No
2/22/2023 8:39	0.087	0.017	0.0211	No	0.0705	No
2/22/2023 8:40	0.094	0.017	0.0206	No	0.0739	No
2/22/2023 8:41	0.105	0.019	0.0203	No	0.0782	No
2/22/2023 8:42	0.107	0.021	0.0203	No	0.0811	No
2/22/2023 8:43	0.109	0.018	0.0202	No	0.0847	No
2/22/2023 8:44	0.118	0.022	0.0201	No	0.0881	No
2/22/2023 8:45	0.127	0.021	0.0202	No	0.0921	No
2/22/2023 8:46	0.139	0.02	0.0201	No	0.0966	No
2/22/2023 8:47	0.149	0.017	0.0199	No	0.1015	No
2/22/2023 8:48	0.139	0.018	0.0198	No	0.1065	No
2/22/2023 8:49	0.154	0.019	0.0196	No	0.1107	No

Downwind Station						
Time	Instantaneous VOC (ppm)	Instantaneous Mass Conc. Total (mg/m ³)	Mass Conc. Total mg/m ³ AVG 15m (mg/m ³)	Dust Exceedance	VOC ppm AVG 15m (ppm)	VOC Exceedance
2/22/2023 7:13	0			No	0	No
2/22/2023 7:14	0	0.043	0.043	No	0	No
2/22/2023 7:15	0	0.046	0.0445	No	0	No
2/22/2023 7:16	0	0.052	0.047	No	0	No
2/22/2023 7:17	0	0.053	0.0485	No	0	No
2/22/2023 7:18	0	0.049	0.0486	No	0	No
2/22/2023 7:19	0	0.04	0.0472	No	0	No
2/22/2023 7:20	0	0.039	0.046	No	0	No
2/22/2023 7:21	0	0.036	0.0447	No	0	No
2/22/2023 7:22	0	0.036	0.0438	No	0	No
2/22/2023 7:23	0	0.033	0.0427	No	0	No
2/22/2023 7:24	0	0.029	0.0415	No	0	No
2/22/2023 7:25	0	0.028	0.0403	No	0	No
2/22/2023 7:26	0	0.027	0.0393	No	0	No
2/22/2023 7:27	0	0.029	0.0386	No	0	No
2/22/2023 7:28	0	0.029	0.0379	No	0	No
2/22/2023 7:29	0	0.033	0.0373	No	0	No
2/22/2023 7:30	0	0.034	0.0365	No	0	No
2/22/2023 7:31	0	0.043	0.0359	No	0	No
2/22/2023 7:32	0	0.086	0.0381	No	0	No
2/22/2023 7:33	0	0.041	0.0375	No	0	No
2/22/2023 7:34	0	0.028	0.0367	No	0	No
2/22/2023 7:35	0	0.028	0.036	No	0	No
2/22/2023 7:36	0	0.033	0.0358	No	0	No
2/22/2023 7:37	0	0.03	0.0354	No	0	No
2/22/2023 7:38	0	0.035	0.0355	No	0	No
2/22/2023 7:39	0	0.039	0.0362	No	0	No
2/22/2023 7:40	0	0.027	0.0361	No	0	No
2/22/2023 7:41	0	0.031	0.0364	No	0	No
2/22/2023 7:42	0	0.04	0.0371	No	0	No
2/22/2023 7:43	0.031	0.033	0.0374	No	0.0021	No
2/22/2023 7:44	0	0.031	0.0373	No	0.0021	No
2/22/2023 7:45	0	0.067	0.0395	No	0.0021	No
2/22/2023 7:46	0	0.093	0.0428	No	0.0021	No
2/22/2023 7:47	0	0.032	0.0392	No	0.0021	No
2/22/2023 7:48	0	0.027	0.0383	No	0.0021	No
2/22/2023 7:49	0	0.025	0.0381	No	0.0021	No
2/22/2023 7:50	0	0.025	0.0379	No	0.0021	No
2/22/2023 7:51	0	0.027	0.0375	No	0.0021	No
2/22/2023 7:52	0	0.037	0.0379	No	0.0021	No
2/22/2023 7:53	0	0.035	0.0379	No	0.0021	No
2/22/2023 7:54	0	0.038	0.0379	No	0.0021	No
2/22/2023 7:55	0	0.167	0.0472	No	0.0021	No
2/22/2023 7:56	0	0.068	0.0497	No	0.0021	No
2/22/2023 7:57	0	0.026	0.0487	No	0.0021	No
2/22/2023 7:58	0.016	0.028	0.0484	No	0.0011	No
2/22/2023 7:59	0.005	0.028	0.0482	No	0.0014	No
2/22/2023 8:00	0.013	0.029	0.0457	No	0.0023	No
2/22/2023 8:01	0.018	0.028	0.0413	No	0.0035	No
2/22/2023 8:02	0.032	0.033	0.0414	No	0.0056	No
2/22/2023 8:03	0.007	0.034	0.0419	No	0.0061	No
2/22/2023 8:04	0	0.03	0.0422	No	0.0061	No
2/22/2023 8:05	0.013	0.03	0.0425	No	0.0069	No
2/22/2023 8:06	0.012	0.033	0.0429	No	0.0077	No

Downwind Station						
Time	Instantaneous VOC (ppm)	Instantaneous Mass Conc. Total (mg/m ³)	Mass Conc. Total mg/m ³ AVG 15m (mg/m ³)	Dust Exceedance	VOC ppm AVG 15m (ppm)	VOC Exceedance
2/22/2023 8:07	0.019	0.032	0.0426	No	0.009	No
2/22/2023 8:08	0.011	0.032	0.0424	No	0.0097	No
2/22/2023 8:09	0.022	0.031	0.0419	No	0.0112	No
2/22/2023 8:10	0.02	0.033	0.033	No	0.0125	No
2/22/2023 8:11	0.007	0.028	0.0303	No	0.013	No
2/22/2023 8:12	0.036	0.029	0.0305	No	0.0154	No
2/22/2023 8:13	0.017	0.028	0.0305	No	0.0155	No
2/22/2023 8:14	0.029	0.029	0.0306	No	0.0171	No
2/22/2023 8:15	0.059	0.03	0.0307	No	0.0201	No
2/22/2023 8:16	0.04	0.03	0.0308	No	0.0216	No
2/22/2023 8:17	0.039	0.032	0.0307	No	0.0221	No
2/22/2023 8:18	0.033	0.028	0.0303	No	0.0238	No
2/22/2023 8:19	0.029	0.029	0.0303	No	0.0257	No
2/22/2023 8:20	0.037	0.028	0.0301	No	0.0273	No
2/22/2023 8:21	0.044	0.029	0.0299	No	0.0295	No
2/22/2023 8:22	0.047	0.03	0.0297	No	0.0313	No
2/22/2023 8:23	0.049	0.029	0.0295	No	0.0339	No
2/22/2023 8:24	0.06	0.03	0.0295	No	0.0364	No
2/22/2023 8:25	0.069	0.033	0.0295	No	0.0397	No
2/22/2023 8:26	0.032	0.027	0.0294	No	0.0413	No
2/22/2023 8:27	0.056	0.021	0.0289	No	0.0427	No
2/22/2023 8:28	0.061	0.022	0.0285	No	0.0456	No
2/22/2023 8:29	0.054	0.023	0.0281	No	0.0473	No
2/22/2023 8:30	0.051	0.025	0.0277	No	0.0467	No
2/22/2023 8:31	0.051	0.024	0.0273	No	0.0475	No
2/22/2023 8:32	0.052	0.023	0.0267	No	0.0483	No
2/22/2023 8:33	0.05	0.022	0.0263	No	0.0495	No
2/22/2023 8:34	0.061	0.027	0.0262	No	0.0516	No
2/22/2023 8:35	0.06	0.03	0.0263	No	0.0531	No
2/22/2023 8:36	0.064	0.023	0.0259	No	0.0545	No
2/22/2023 8:37	0.065	0.026	0.0257	No	0.0557	No
2/22/2023 8:38	0.066	0.023	0.0253	No	0.0568	No
2/22/2023 8:39	0.064	0.028	0.0251	No	0.0571	No
2/22/2023 8:40	0.065	0.017	0.0241	No	0.0568	No
2/22/2023 8:41	0.062	0.019	0.0235	No	0.0588	No
2/22/2023 8:42	0.061	0.02	0.0235	No	0.0591	No
2/22/2023 8:43	0.062	0.019	0.0233	No	0.0592	No
2/22/2023 8:44	0.062	0.018	0.0229	No	0.0597	No
2/22/2023 8:45	0.077	0.02	0.0226	No	0.0615	No
2/22/2023 8:46	0.087	0.028	0.0229	No	0.0639	No
2/22/2023 8:47	0.083	0.018	0.0225	No	0.0659	No
2/22/2023 8:48	0.074	0.014	0.022	No	0.0675	No
2/22/2023 8:49	0.083	0.017	0.0213	No	0.069	No
2/22/2023 8:50	0.075	0.017	0.0205	No	0.07	No
2/22/2023 8:51	0.082	0.016	0.02	No	0.0712	No