



## Daily Activity Report

Seton Brilla Charter School  
1956 Jerome Avenue, Bronx, NY  
BCP No. C203152

### General Site Information

Date:	Tuesday, February 21, 2023
Weather:	Cloudy, 37-46°F
Wind Direction/Speed:	NSW @ 7 mph
AKRF Personnel on Site:	Celia Meyer
AKRF Equipment on Site:	Mini RAE 3000 Photoionization Detector [(PID) x1], 2 Fixed Air Monitoring Stations [DustTrak
Visitors:	None.

### Contractor Information

Contracting Company	Main Personnel	Equipment
Casino Construction	Connor McGrory	Excavator, CFA Drill Rig

### Description and Location of Work Activities Performed

- 1) JEL over-excavated the groundwater treatment area, and AKRF collected new sidewall sample nos. SW-06B\_8-10\_20230221, SW-10B\_8-10\_20230221, and SW-11B\_8-10\_20230221.
- 2) Excavation around pile caps along eastern and northern portion of site.
- 3) Two (2) truckloads of soil from Grid WC-01, which were excavated from the groundwater treatment area, were sent for off-site disposal at Clean Earth - Southeastern Pennsylvania.

### Site Soil Disposal Tracking Information

Destination Facility	Daily Trucks	Total Trucks	Daily Approx. Cubic Yds	Total Approx. Cubic Yds	Total Site Loads	Total Approximate Cubic Yards
Clean Earth Carteret	0	73	0	1,460	165	3,300
Clean Earth Southeastern Pennsylvania	2	66	40	1,320		
Concrete Disposal	0	26	0	520		
N/A	0	0	0	0		
N/A	0	0	0	0		

### CAMP Air Monitoring Results

CAMP Station	UPWIND				DOWNWIND		
Odors:	None.				None.		
VOC Action Level Exceedance(s):	None.				None.		
Particulate Action Level Exceedance(s):	None.				None.		
Maximum VOC Level (15 min ppm):	0.334				0.269		
Maximum Particulate Level (15 min mg/m <sup>3</sup> ):	0.0656				0.055		

Notes: CAMP monitoring was performed throughout the day. There were no VOC or particulate exceedances.

### Additional Information

Planned Work Activity for Following Day/Week:	1) Excavation of soil/fill to uncover piles.
Comments:	None.

Site Map

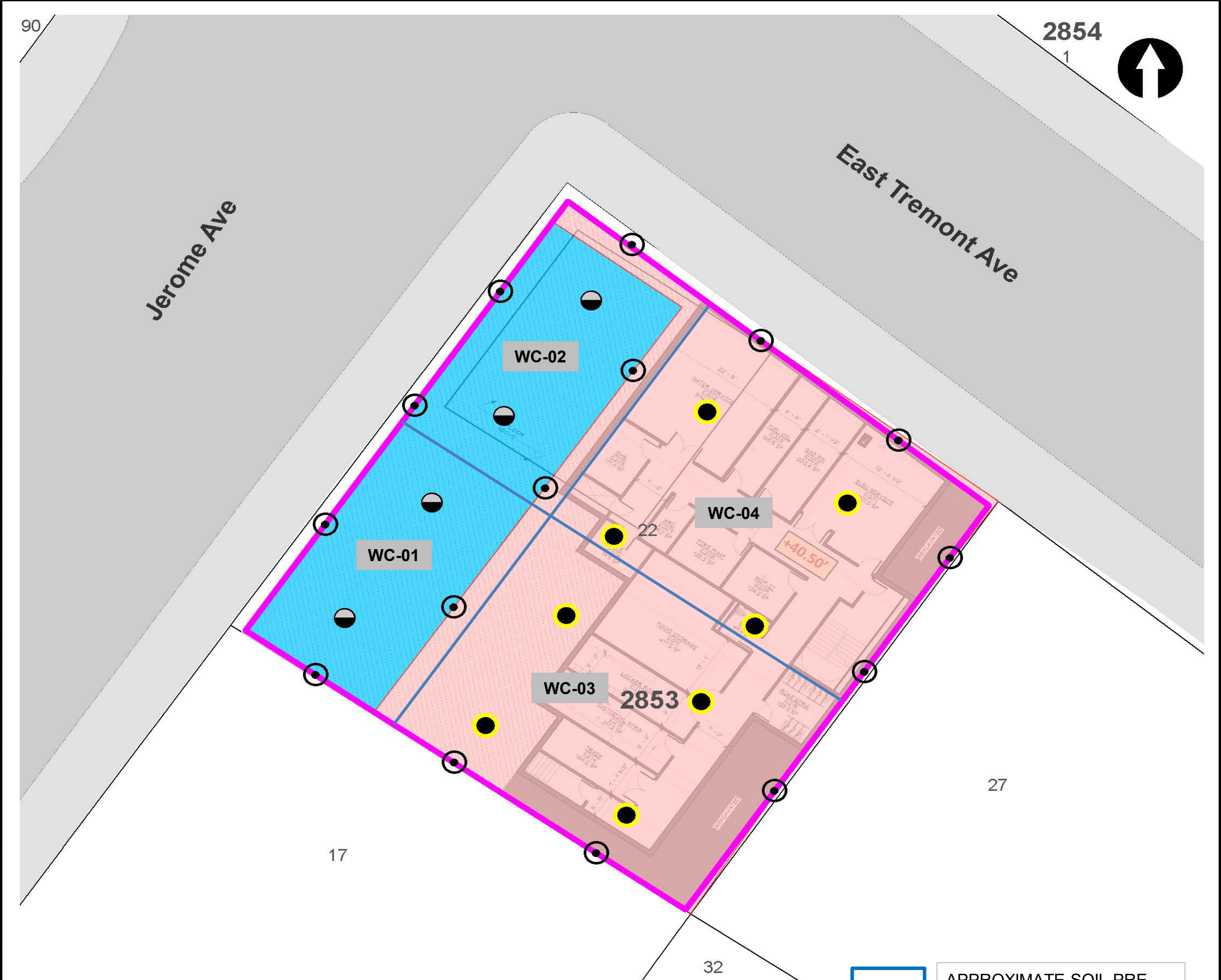

**LEGEND**

- PROJECT SITE BOUNDARY
- LOT BOUNDARY AND TAX LOT NUMBER
- 2853** BLOCK NUMBER
- REMEDIAL EXCAVATION TO APPROXIMATELY TWO FEET BELOW EXISTING GRADE
- REMEDIAL EXCAVATION TO GROUNDWATER (SOURCE AREA)

- CONFIRMATION DOCUMENTATION BOTTOM SAMPLE
- SOURCE AREA DOCUMENTATION BOTTOM SAMPLE
- DOCUMENTATION SIDEWALL SAMPLE

**NOTE**  
 REMEDIAL EXCAVATION WILL INCLUDE REMOVAL OF APPROXIMATELY 1,280 TONS (850 CUBIC YARDS) OF SOURCE MATERIAL ASSOCIATED WITH NYSDEC SPILL NO. 2103719 AND APPROXIMATELY 860 TONS (570 CUBIC YARDS) OF SOIL/FILL FROM THE UPPER 2 FEET SITE-WIDE.

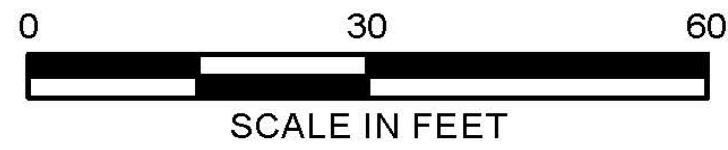

APPROXIMATE SOIL PRE-CHARACTERIZATION GRID

Map Source:  
 NYCDOP (NYC Dept. of City Planning) GIS database

© 2021 AKRF. W:\Projects\210024 - 1956 JEROME AVENUE\Technical\GIS and Graphics\AR\RAW\210024 Figure 9 Proposed Remedial Excavation and Documentation Sample Location Plan.mxd 10/25/2021 2:03:38 PM iszalus



440 Park Avenue South, New York, NY 10016

**1956 Jerome Avenue**  
 Bronx, New York

**TRACK 4 CLEANUP AND DOCUMENTATION  
 SAMPLE LOCATION PLAN**

DATE  
**04/29/2022**

PROJECT NO.  
**210024**

FIGURE  
**11**

Site Photographs

Photograph 1 -  
General Site  
overview, view  
facing northeast.



Photograph 2 -  
Import of stone to  
WC-01 for backfilling  
of excavated areas,  
view facing  
northeast.



Photograph 3 -  
Export of soil from  
WC-01 to Clean Earth  
Southeastern  
Pennsylvania, view  
facing northeast.



Upwind Station						
Time	Instaneous VOC (ppm)	Instaneous Mass Conc. Total (mg/m <sup>3</sup> )	Mass Conc. Total mg/m <sup>3</sup> AVG 15m (mg/m <sup>3</sup> )	Dust Exceedance	VOC ppm AVG 15m (ppm)	VOC Exceedance
2/21/2023 7:04	0	0.015	0.015	No	0	No
2/21/2023 7:05	0	0.016	0.0155	No	0	No
2/21/2023 7:06	0	0.017	0.016	No	0	No
2/21/2023 7:07	0	0.016	0.016	No	0	No
2/21/2023 7:08	0	0.016	0.016	No	0	No
2/21/2023 7:09	0	0.017	0.0162	No	0	No
2/21/2023 7:10	0	0.019	0.0166	No	0	No
2/21/2023 7:11	0	0.02	0.017	No	0	No
2/21/2023 7:12	0	0.02	0.0173	No	0	No
2/21/2023 7:13	0	0.018	0.0174	No	0	No
2/21/2023 7:14	0	0.017	0.0174	No	0	No
2/21/2023 7:15	0	0.018	0.0174	No	0	No
2/21/2023 7:16	0	0.018	0.0175	No	0	No
2/21/2023 7:17	0	0.018	0.0175	No	0	No
2/21/2023 7:18	0	0.019	0.0176	No	0	No
2/21/2023 7:19	0	0.018	0.0178	No	0	No
2/21/2023 7:20	0	0.019	0.018	No	0	No
2/21/2023 7:21	0	0.019	0.0181	No	0	No
2/21/2023 7:22	0	0.02	0.0184	No	0	No
2/21/2023 7:23	0	0.019	0.0186	No	0	No
2/21/2023 7:24	0	0.021	0.0189	No	0	No
2/21/2023 7:25	0	0.02	0.0189	No	0	No
2/21/2023 7:26	0	0.021	0.019	No	0	No
2/21/2023 7:27	0	0.028	0.0195	No	0	No
2/21/2023 7:28	0	0.035	0.0207	No	0	No
2/21/2023 7:29	0	0.043	0.0224	No	0	No
2/21/2023 7:30	0	0.033	0.0234	No	0	No
2/21/2023 7:31	0	0.045	0.0252	No	0	No
2/21/2023 7:32	0	0.023	0.0255	No	0	No
2/21/2023 7:33	0	0.019	0.0255	No	0	No
2/21/2023 7:34	0	0.02	0.0257	No	0	No
2/21/2023 7:35	0	0.021	0.0258	No	0	No
2/21/2023 7:36	0	0.022	0.026	No	0	No
2/21/2023 7:37	0	0.021	0.0261	No	0	No
2/21/2023 7:38	0	0.022	0.0263	No	0	No
2/21/2023 7:39	0	0.025	0.0265	No	0	No
2/21/2023 7:40	0	0.025	0.0269	No	0	No
2/21/2023 7:41	0	0.021	0.0269	No	0	No
2/21/2023 7:42	0	0.023	0.0265	No	0	No
2/21/2023 7:43	0	0.023	0.0257	No	0	No
2/21/2023 7:44	0	0.023	0.0244	No	0	No
2/21/2023 7:45	0	0.022	0.0237	No	0	No
2/21/2023 7:46	0	0.023	0.0222	No	0	No
2/21/2023 7:47	0	0.023	0.0222	No	0	No
2/21/2023 7:48	0	0.023	0.0225	No	0	No
2/21/2023 7:49	0	0.025	0.0228	No	0	No
2/21/2023 7:50	0	0.024	0.023	No	0	No
2/21/2023 7:51	0	0.026	0.0233	No	0	No
2/21/2023 7:52	0	0.028	0.0237	No	0	No
2/21/2023 7:53	0	0.034	0.0245	No	0	No
2/21/2023 7:54	0	0.035	0.0252	No	0	No
2/21/2023 7:55	0	0.028	0.0254	No	0	No

Upwind Station						
Time	Instaneous VOC (ppm)	Instaneous Mass Conc. Total (mg/m <sup>3</sup> )	Mass Conc. Total mg/m <sup>3</sup> AVG 15m (mg/m <sup>3</sup> )	Dust Exceedance	VOC ppm AVG 15m (ppm)	VOC Exceedance
2/21/2023 7:56	0	0.028	0.0259	No	0	No
2/21/2023 7:57	0	0.026	0.0261	No	0	No
2/21/2023 7:58	0	0.025	0.0262	No	0	No
2/21/2023 7:59	0	0.025	0.0263	No	0	No
2/21/2023 8:00	0	0.027	0.0267	No	0	No
2/21/2023 8:01	0	0.029	0.0271	No	0	No
2/21/2023 8:02	0	0.025	0.0272	No	0	No
2/21/2023 8:03	0	0.028	0.0275	No	0	No
2/21/2023 8:04	0	0.03	0.0279	No	0	No
2/21/2023 8:05	0	0.028	0.0281	No	0	No
2/21/2023 8:06	0	0.025	0.0281	No	0	No
2/21/2023 8:07	0	0.023	0.0277	No	0	No
2/21/2023 8:08	0	0.025	0.0271	No	0	No
2/21/2023 8:09	0	0.023	0.0263	No	0	No
2/21/2023 8:10	0.038	0.031	0.0265	No	0.0025	No
2/21/2023 8:11	0	0.032	0.0268	No	0.0025	No
2/21/2023 8:12	0	0.028	0.0269	No	0.0025	No
2/21/2023 8:13	0	0.025	0.0269	No	0.0025	No
2/21/2023 8:14	0	0.024	0.0269	No	0.0025	No
2/21/2023 8:15	0	0.026	0.0268	No	0.0025	No
2/21/2023 8:16	0	0.026	0.0266	No	0.0025	No
2/21/2023 8:17	0	0.03	0.0269	No	0.0025	No
2/21/2023 8:18	0	0.026	0.0268	No	0.0025	No
2/21/2023 8:19	0	0.026	0.0265	No	0.0025	No
2/21/2023 8:20	0	0.028	0.0265	No	0.0025	No
2/21/2023 8:21	0	0.028	0.0267	No	0.0025	No
2/21/2023 8:22	0	0.027	0.027	No	0.0025	No
2/21/2023 8:23	0.003	0.031	0.0274	No	0.0027	No
2/21/2023 8:24	0	0.026	0.0276	No	0.0027	No
2/21/2023 8:25	0	0.026	0.0273	No	0.0002	No
2/21/2023 8:26	0	0.034	0.0274	No	0.0002	No
2/21/2023 8:27	0.044	0.036	0.0279	No	0.0031	No
2/21/2023 8:28	0.07	0.035	0.0286	No	0.0078	No
2/21/2023 8:29	0.053	0.029	0.0289	No	0.0113	No
2/21/2023 8:30	0.051	0.033	0.0294	No	0.0147	No
2/21/2023 8:31	0.044	0.032	0.0298	No	0.0177	No
2/21/2023 8:32	0.042	0.026	0.0295	No	0.0205	No
2/21/2023 8:33	0.035	0.027	0.0296	No	0.0228	No
2/21/2023 8:34	0.03	0.039	0.0305	No	0.0248	No
2/21/2023 8:35	0.034	0.032	0.0307	No	0.0271	No
2/21/2023 8:36	0.021	0.028	0.0307	No	0.0285	No
2/21/2023 8:37	0.03	0.027	0.0307	No	0.0305	No
2/21/2023 8:38	0.033	0.03	0.0307	No	0.0325	No
2/21/2023 8:39	0.019	0.026	0.0307	No	0.0337	No
2/21/2023 8:40	0.029	0.024	0.0305	No	0.0357	No
2/21/2023 8:41	0.026	0.028	0.0301	No	0.0374	No
2/21/2023 8:42	0.025	0.026	0.0295	No	0.0361	No
2/21/2023 8:43	0.032	0.028	0.029	No	0.0336	No
2/21/2023 8:44	0.048	0.029	0.029	No	0.0333	No
2/21/2023 8:45	0.032	0.025	0.0285	No	0.032	No
2/21/2023 8:46	0.037	0.024	0.0279	No	0.0315	No
2/21/2023 8:47	0.042	0.025	0.0279	No	0.0315	No

Upwind Station						
Time	Instantaneous VOC (ppm)	Instantaneous Mass Conc. Total (mg/m <sup>3</sup> )	Mass Conc. Total mg/m <sup>3</sup> AVG 15m (mg/m <sup>3</sup> )	Dust Exceedance	VOC ppm AVG 15m (ppm)	VOC Exceedance
2/21/2023 8:48	0.04	0.027	0.0279	No	0.0319	No
2/21/2023 8:49	0.037	0.026	0.027	No	0.0323	No
2/21/2023 8:50	0.042	0.025	0.0265	No	0.0329	No
2/21/2023 8:51	0.05	0.027	0.0265	No	0.0348	No
2/21/2023 8:52	0.045	0.026	0.0264	No	0.0358	No
2/21/2023 8:53	0.05	0.027	0.0262	No	0.0369	No
2/21/2023 8:54	0.051	0.031	0.0265	No	0.0391	No
2/21/2023 8:55	0.056	0.027	0.0267	No	0.0409	No
2/21/2023 8:56	0.065	0.03	0.0269	No	0.0435	No
2/21/2023 8:57	0.07	0.031	0.0272	No	0.0465	No
2/21/2023 8:58	0.071	0.039	0.0279	No	0.0491	No
2/21/2023 8:59	0.068	0.036	0.0284	No	0.0504	No
2/21/2023 9:00	0.071	0.037	0.0292	No	0.053	No
2/21/2023 9:01	0.067	0.037	0.0301	No	0.055	No
2/21/2023 9:02	0.106	0.034	0.0307	No	0.0593	No
2/21/2023 9:03	0.101	0.032	0.031	No	0.0633	No
2/21/2023 9:04	0.557	0.031	0.0313	No	0.098	No
2/21/2023 9:05	0.395	0.03	0.0317	No	0.1215	No
2/21/2023 9:06	0.347	0.026	0.0316	No	0.1413	No
2/21/2023 9:07	0.311	0.028	0.0317	No	0.1591	No
2/21/2023 9:08	0.387	0.028	0.0318	No	0.1815	No
2/21/2023 9:09	0.315	0.029	0.0317	No	0.1991	No
2/21/2023 9:10	0.303	0.03	0.0319	No	0.2156	No
2/21/2023 9:11	0.268	0.029	0.0318	No	0.2291	No
2/21/2023 9:12	0.258	0.029	0.0317	No	0.2417	No
2/21/2023 9:13	0.247	0.029	0.031	No	0.2534	No
2/21/2023 9:14	0.228	0.025	0.0303	No	0.2641	No
2/21/2023 9:15	0.25	0.028	0.0297	No	0.276	No
2/21/2023 9:16	0.217	0.026	0.0289	No	0.286	No
2/21/2023 9:17	0.208	0.026	0.0284	No	0.2928	No
2/21/2023 9:18	0.207	0.029	0.0282	No	0.2999	No
2/21/2023 9:19	0.192	0.03	0.0281	No	0.2755	No
2/21/2023 9:20	0.191	0.027	0.0279	No	0.2619	No
2/21/2023 9:21	0.198	0.032	0.0283	No	0.252	No
2/21/2023 9:22	0.196	0.029	0.0284	No	0.2443	No
2/21/2023 9:23	0.189	0.027	0.0283	No	0.2311	No
2/21/2023 9:24	0.181	0.028	0.0283	No	0.2222	No
2/21/2023 9:25	0.183	0.028	0.0281	No	0.2142	No
2/21/2023 9:26	0.179	0.029	0.0281	No	0.2083	No
2/21/2023 9:27	0.172	0.028	0.0281	No	0.2025	No
2/21/2023 9:28	0.165	0.028	0.028	No	0.1971	No
2/21/2023 9:29	0.165	0.028	0.0282	No	0.1929	No
2/21/2023 9:30	0.164	0.03	0.0283	No	0.1871	No
2/21/2023 9:31	0.174	0.029	0.0285	No	0.1843	No
2/21/2023 9:32	0.151	0.028	0.0287	No	0.1805	No
2/21/2023 9:33	0.17	0.031	0.0288	No	0.178	No
2/21/2023 9:34	0.155	0.029	0.0287	No	0.1755	No
2/21/2023 9:35	0.161	0.029	0.0289	No	0.1735	No
2/21/2023 9:36	0.163	0.028	0.0286	No	0.1712	No
2/21/2023 9:37	0.164	0.03	0.0287	No	0.1691	No
2/21/2023 9:38	0.163	0.031	0.0289	No	0.1673	No
2/21/2023 9:39	0.15	0.029	0.029	No	0.1653	No

Upwind Station						
Time	Instaneous VOC (ppm)	Instaneous Mass Conc. Total (mg/m <sup>3</sup> )	Mass Conc. Total mg/m <sup>3</sup> AVG 15m (mg/m <sup>3</sup> )	Dust Exceedance	VOC ppm AVG 15m (ppm)	VOC Exceedance
2/21/2023 9:40	0.163	0.028	0.029	No	0.1639	No
2/21/2023 9:41	0.161	0.03	0.0291	No	0.1627	No
2/21/2023 9:42	0.169	0.032	0.0293	No	0.1625	No
2/21/2023 9:43	0.166	0.032	0.0296	No	0.1626	No
2/21/2023 9:44	0.181	0.033	0.0299	No	0.1637	No
2/21/2023 9:45	0.186	0.032	0.0301	No	0.1651	No
2/21/2023 9:46	0.173	0.03	0.0301	No	0.1651	No
2/21/2023 9:47	0.171	0.032	0.0304	No	0.1664	No
2/21/2023 9:48	0.171	0.029	0.0303	No	0.1665	No
2/21/2023 9:49	0.175	0.026	0.0301	No	0.1678	No
2/21/2023 9:50	0.165	0.025	0.0298	No	0.1681	No
2/21/2023 9:51	0.17	0.027	0.0297	No	0.1685	No
2/21/2023 9:52	0.172	0.027	0.0295	No	0.1691	No
2/21/2023 9:53	0.173	0.027	0.0293	No	0.1697	No
2/21/2023 9:54	0.177	0.031	0.0294	No	0.1715	No
2/21/2023 9:55	0.182	0.027	0.0293	No	0.1728	No
2/21/2023 9:56	0.181	0.028	0.0292	No	0.1741	No
2/21/2023 9:57	0.189	0.029	0.029	No	0.1755	No
2/21/2023 9:58	0.179	0.028	0.0287	No	0.1763	No
2/21/2023 9:59	0.184	0.029	0.0285	No	0.1765	No
2/21/2023 10:00	0.192	0.028	0.0282	No	0.1769	No
2/21/2023 10:01	0.191	0.026	0.0279	No	0.1781	No
2/21/2023 10:02	0.195	0.026	0.0275	No	0.1797	No
2/21/2023 10:03	0.192	0.027	0.0274	No	0.1811	No
2/21/2023 10:04	0.2	0.025	0.0273	No	0.1828	No
2/21/2023 10:05	0.189	0.025	0.0273	No	0.1844	No
2/21/2023 10:06	0.187	0.025	0.0272	No	0.1855	No
2/21/2023 10:07	0.186	0.026	0.0271	No	0.1865	No
2/21/2023 10:08	0.194	0.025	0.027	No	0.1879	No
2/21/2023 10:09	0.203	0.028	0.0268	No	0.1896	No
2/21/2023 10:10	0.201	0.029	0.0269	No	0.1909	No
2/21/2023 10:11	0.204	0.027	0.0269	No	0.1924	No
2/21/2023 10:12	0.201	0.025	0.0266	No	0.1932	No
2/21/2023 10:13	0.206	0.026	0.0265	No	0.195	No
2/21/2023 10:14	0.201	0.027	0.0263	No	0.1961	No
2/21/2023 10:15	0.198	0.031	0.0265	No	0.1965	No
2/21/2023 10:16	0.206	0.028	0.0267	No	0.1975	No
2/21/2023 10:17	0.208	0.027	0.0267	No	0.1984	No
2/21/2023 10:18	0.21	0.026	0.0267	No	0.1996	No
2/21/2023 10:19	0.21	0.026	0.0267	No	0.2003	No
2/21/2023 10:20	0.215	0.027	0.0269	No	0.202	No
2/21/2023 10:21	0.202	0.027	0.027	No	0.203	No
2/21/2023 10:22	0.2	0.027	0.0271	No	0.2039	No
2/21/2023 10:23	0.201	0.027	0.0272	No	0.2044	No
2/21/2023 10:24	0.199	0.027	0.0271	No	0.2041	No
2/21/2023 10:25	0.193	0.03	0.0272	No	0.2036	No
2/21/2023 10:26	0.193	0.028	0.0273	No	0.2029	No
2/21/2023 10:27	0.195	0.028	0.0275	No	0.2025	No
2/21/2023 10:28	0.198	0.028	0.0276	No	0.2019	No
2/21/2023 10:29	0.209	0.03	0.0278	No	0.2025	No
2/21/2023 10:30	0.202	0.027	0.0275	No	0.2027	No
2/21/2023 10:31	0.204	0.026	0.0274	No	0.2026	No

Upwind Station						
Time	Instaneous VOC (ppm)	Instaneous Mass Conc. Total (mg/m <sup>3</sup> )	Mass Conc. Total mg/m <sup>3</sup> AVG 15m (mg/m <sup>3</sup> )	Dust Exceedance	VOC ppm AVG 15m (ppm)	VOC Exceedance
2/21/2023 10:32	0.2	0.026	0.0273	No	0.2021	No
2/21/2023 10:33	0.205	0.026	0.0273	No	0.2017	No
2/21/2023 10:34	0.206	0.028	0.0275	No	0.2015	No
2/21/2023 10:35	0.209	0.029	0.0276	No	0.2011	No
2/21/2023 10:36	0.209	0.028	0.0277	No	0.2015	No
2/21/2023 10:37	0.217	0.028	0.0277	No	0.2027	No
2/21/2023 10:38	0.22	0.028	0.0278	No	0.2039	No
2/21/2023 10:39	0.234	0.029	0.0279	No	0.2063	No
2/21/2023 10:40	0.223	0.031	0.028	No	0.2083	No
2/21/2023 10:41	0.227	0.031	0.0282	No	0.2105	No
2/21/2023 10:42	0.226	0.036	0.0287	No	0.2126	No
2/21/2023 10:43	0.231	0.033	0.0291	No	0.2148	No
2/21/2023 10:44	0.23	0.031	0.0291	No	0.2162	No
2/21/2023 10:45	0.23	0.033	0.0295	No	0.2181	No
2/21/2023 10:46	0.239	0.033	0.03	No	0.2204	No
2/21/2023 10:47	0.232	0.031	0.0303	No	0.2225	No
2/21/2023 10:48	0.225	0.033	0.0308	No	0.2239	No
2/21/2023 10:49	0.223	0.037	0.0314	No	0.225	No
2/21/2023 10:50	0.22	0.033	0.0317	No	0.2257	No
2/21/2023 10:51	0.227	0.034	0.0321	No	0.2269	No
2/21/2023 10:52	0.217	0.034	0.0325	No	0.2269	No
2/21/2023 10:53	0.229	0.035	0.0329	No	0.2275	No
2/21/2023 10:54	0.227	0.035	0.0333	No	0.2271	No
2/21/2023 10:55	0.233	0.036	0.0337	No	0.2277	No
2/21/2023 10:56	0.246	0.039	0.0342	No	0.229	No
2/21/2023 10:57	0.246	0.037	0.0343	No	0.2303	No
2/21/2023 10:58	0.246	0.036	0.0345	No	0.2313	No
2/21/2023 10:59	0.238	0.037	0.0349	No	0.2319	No
2/21/2023 11:00	0.244	0.039	0.0353	No	0.2328	No
2/21/2023 11:01	0.25	0.042	0.0359	No	0.2335	No
2/21/2023 11:02	0.244	0.041	0.0365	No	0.2343	No
2/21/2023 11:03	0.253	0.04	0.037	No	0.2362	No
2/21/2023 11:04	0.255	0.04	0.0372	No	0.2383	No
2/21/2023 11:05	0.258	0.04	0.0377	No	0.2409	No
2/21/2023 11:06	0.254	0.045	0.0384	No	0.2427	No
2/21/2023 11:07	0.253	0.048	0.0393	No	0.2451	No
2/21/2023 11:08	0.247	0.045	0.04	No	0.2463	No
2/21/2023 11:09	0.258	0.043	0.0405	No	0.2483	No
2/21/2023 11:10	0.259	0.042	0.0409	No	0.2501	No
2/21/2023 11:11	0.262	0.039	0.0409	No	0.2511	No
2/21/2023 11:12	0.261	0.037	0.0409	No	0.2521	No
2/21/2023 11:13	0.272	0.038	0.0411	No	0.2539	No
2/21/2023 11:14	0.272	0.039	0.0412	No	0.2561	No
2/21/2023 11:15	0.267	0.039	0.0412	No	0.2577	No
2/21/2023 11:16	0.279	0.037	0.0409	No	0.2596	No
2/21/2023 11:17	0.274	0.038	0.0407	No	0.2616	No
2/21/2023 11:18	0.275	0.039	0.0406	No	0.2631	No
2/21/2023 11:19	0.277	0.039	0.0405	No	0.2645	No
2/21/2023 11:20	0.274	0.04	0.0405	No	0.2656	No
2/21/2023 11:21	0.279	0.04	0.0402	No	0.2673	No
2/21/2023 11:22	0.275	0.042	0.0398	No	0.2687	No
2/21/2023 11:23	0.287	0.042	0.0396	No	0.2714	No



Upwind Station						
Time	Instaneous VOC (ppm)	Instaneous Mass Conc. Total (mg/m <sup>3</sup> )	Mass Conc. Total mg/m <sup>3</sup> AVG 15m (mg/m <sup>3</sup> )	Dust Exceedance	VOC ppm AVG 15m (ppm)	VOC Exceedance
2/21/2023 11:24	0.28	0.041	0.0395	No	0.2729	No
2/21/2023 11:25	0.274	0.042	0.0395	No	0.2739	No
2/21/2023 11:26	0.279	0.044	0.0398	No	0.275	No
2/21/2023 11:27	0.28	0.044	0.0403	No	0.2763	No
2/21/2023 11:28	0.277	0.05	0.0411	No	0.2766	No
2/21/2023 11:29	0.274	0.072	0.0433	No	0.2767	No
2/21/2023 11:30	0.279	0.058	0.0445	No	0.2775	No
2/21/2023 11:31	0.283	0.05	0.0454	No	0.2778	No
2/21/2023 11:32	0.281	0.048	0.0461	No	0.2783	No
2/21/2023 11:33	0.277	0.046	0.0465	No	0.2784	No
2/21/2023 11:34	0.28	0.068	0.0485	No	0.2786	No
2/21/2023 11:35	0.283	0.053	0.0493	No	0.2792	No
2/21/2023 11:36	0.276	0.045	0.0497	No	0.279	No
2/21/2023 11:37	0.281	0.047	0.05	No	0.2794	No
2/21/2023 11:38	0.284	0.053	0.0507	No	0.2792	No
2/21/2023 11:39	0.282	0.046	0.0511	No	0.2793	No
2/21/2023 11:40	0.294	0.046	0.0513	No	0.2807	No
2/21/2023 11:41	0.289	0.049	0.0517	No	0.2813	No
2/21/2023 11:42	0.278	0.05	0.0521	No	0.2812	No
2/21/2023 11:43	0.277	0.048	0.0519	No	0.2812	No
2/21/2023 11:44	0.283	0.046	0.0502	No	0.2818	No
2/21/2023 11:45	0.283	0.047	0.0495	No	0.2821	No
2/21/2023 11:46	0.283	0.048	0.0493	No	0.2821	No
2/21/2023 11:47	0.296	0.049	0.0494	No	0.2831	No
2/21/2023 11:48	0.299	0.049	0.0496	No	0.2845	No
2/21/2023 11:49	0.293	0.048	0.0483	No	0.2854	No
2/21/2023 11:50	0.294	0.048	0.0479	No	0.2861	No
2/21/2023 11:51	0.291	0.048	0.0481	No	0.2871	No
2/21/2023 11:52	0.293	0.049	0.0483	No	0.2879	No
2/21/2023 11:53	0.298	0.051	0.0481	No	0.2889	No
2/21/2023 11:54	0.295	0.051	0.0485	No	0.2897	No
2/21/2023 11:55	0.295	0.053	0.0489	No	0.2898	No
2/21/2023 11:56	0.306	0.06	0.0497	No	0.2909	No
2/21/2023 11:57	0.307	0.054	0.0499	No	0.2929	No
2/21/2023 11:58	0.308	0.051	0.0501	No	0.2949	No
2/21/2023 11:59	0.31	0.052	0.0505	No	0.2967	No
2/21/2023 12:00	0.313	0.053	0.0509	No	0.2987	No
2/21/2023 12:01	0.325	0.054	0.0513	No	0.3015	No
2/21/2023 12:02	0.318	0.054	0.0517	No	0.303	No
2/21/2023 12:03	0.313	0.054	0.052	No	0.3039	No
2/21/2023 12:04	0.319	0.055	0.0525	No	0.3057	No
2/21/2023 12:05	0.328	0.055	0.0529	No	0.3079	No
2/21/2023 12:06	0.326	0.056	0.0535	No	0.3103	No
2/21/2023 12:07	0.327	0.057	0.054	No	0.3125	No
2/21/2023 12:08	0.333	0.057	0.0544	No	0.3149	No
2/21/2023 12:09	0.32	0.057	0.0548	No	0.3165	No
2/21/2023 12:10	0.334	0.057	0.0551	No	0.3191	No
2/21/2023 12:11	0.324	0.058	0.0549	No	0.3203	No
2/21/2023 12:12	0.334	0.056	0.0551	No	0.3221	No
2/21/2023 12:13	0.338	0.058	0.0555	No	0.3241	No
2/21/2023 12:14	0.338	0.071	0.0568	No	0.326	No
2/21/2023 12:15	0.339	0.064	0.0575	No	0.3277	No

Upwind Station						
Time	Instaneous VOC (ppm)	Instaneous Mass Conc. Total (mg/m <sup>3</sup> )	Mass Conc. Total mg/m <sup>3</sup> AVG 15m (mg/m <sup>3</sup> )	Dust Exceedance	VOC ppm AVG 15m (ppm)	VOC Exceedance
2/21/2023 12:16	0.332	0.057	0.0577	No	0.3282	No
2/21/2023 12:17	0.34	0.056	0.0579	No	0.3297	No
2/21/2023 12:18	0.34	0.053	0.0578	No	0.3315	No
2/21/2023 12:19	0.327	0.052	0.0576	No	0.332	No
2/21/2023 12:20	0.327	0.053	0.0575	No	0.3319	No
2/21/2023 12:21	0.321	0.052	0.0572	No	0.3316	No
2/21/2023 12:22	0.323	0.053	0.0569	No	0.3313	No
2/21/2023 12:23	0.327	0.053	0.0567	No	0.3309	No
2/21/2023 12:24	0.329	0.052	0.0563	No	0.3315	No
2/21/2023 12:25	0.323	0.053	0.0561	No	0.3308	No
2/21/2023 12:26	0.326	0.055	0.0559	No	0.3309	No
2/21/2023 12:27	0.323	0.058	0.056	No	0.3302	No
2/21/2023 12:28	0.329	0.058	0.056	No	0.3296	No
2/21/2023 12:29	0.34	0.059	0.0552	No	0.3297	No
2/21/2023 12:30	0.334	0.058	0.0548	No	0.3294	No
2/21/2023 12:31	0.328	0.057	0.0548	No	0.3291	No
2/21/2023 12:32	0.325	0.057	0.0549	No	0.3281	No
2/21/2023 12:33	0.325	0.057	0.0551	No	0.3271	No
2/21/2023 12:34	0.321	0.057	0.0555	No	0.3267	No
2/21/2023 12:35	0.325	0.058	0.0558	No	0.3266	No
2/21/2023 12:36	0.332	0.058	0.0562	No	0.3273	No
2/21/2023 12:37	0.32	0.058	0.0565	No	0.3271	No
2/21/2023 12:38	0.325	0.059	0.0569	No	0.327	No
2/21/2023 12:39	0.316	0.061	0.0575	No	0.3261	No
2/21/2023 12:40	0.329	0.061	0.0581	No	0.3265	No
2/21/2023 12:41	0.319	0.059	0.0583	No	0.3261	No
2/21/2023 12:42	0.317	0.059	0.0584	No	0.3257	No
2/21/2023 12:43	0.321	0.061	0.0586	No	0.3251	No
2/21/2023 12:44	0.311	0.061	0.0587	No	0.3232	No
2/21/2023 12:45	0.312	0.064	0.0591	No	0.3217	No
2/21/2023 12:46	0.32	0.062	0.0595	No	0.3212	No
2/21/2023 12:47	0.323	0.061	0.0597	No	0.3211	No
2/21/2023 12:48	0.325	0.062	0.0601	No	0.3211	No
2/21/2023 12:49	0.33	0.061	0.0603	No	0.3217	No
2/21/2023 12:50	0.327	0.059	0.0604	No	0.3218	No
2/21/2023 12:51	0.315	0.057	0.0603	No	0.3207	No
2/21/2023 12:52	0.322	0.058	0.0603	No	0.3208	No
2/21/2023 12:53	0.324	0.059	0.0603	No	0.3207	No
2/21/2023 12:54	0.333	0.06	0.0603	No	0.3219	No
2/21/2023 12:55	0.317	0.066	0.0606	No	0.3211	No
2/21/2023 12:56	0.312	0.047	0.0598	No	0.3206	No
2/21/2023 12:57	0.332	0.046	0.0589	No	0.3216	No
2/21/2023 12:58	0.324	0.045	0.0579	No	0.3218	No
2/21/2023 12:59	0.335	0.046	0.0569	No	0.3234	No
2/21/2023 13:00	0.326	0.043	0.0555	No	0.3243	No
2/21/2023 13:01	0.318	0.041	0.0541	No	0.3242	No
2/21/2023 13:02	0.322	0.042	0.0528	No	0.3241	No
2/21/2023 13:03	0.329	0.042	0.0515	No	0.3244	No
2/21/2023 13:04	0.328	0.044	0.0503	No	0.3243	No
2/21/2023 13:05	0.323	0.045	0.0494	No	0.324	No
2/21/2023 13:06	0.311	0.045	0.0486	No	0.3237	No
2/21/2023 13:07	0.313	0.045	0.0477	No	0.3231	No

Upwind Station						
Time	Instaneous VOC (ppm)	Instaneous Mass Conc. Total (mg/m <sup>3</sup> )	Mass Conc. Total mg/m <sup>3</sup> AVG 15m (mg/m <sup>3</sup> )	Dust Exceedance	VOC ppm AVG 15m (ppm)	VOC Exceedance
2/21/2023 13:08	0.325	0.048	0.047	No	0.3232	No
2/21/2023 13:09	0.319	0.044	0.0459	No	0.3223	No
2/21/2023 13:10	0.324	0.05	0.0449	No	0.3227	No
2/21/2023 13:11	0.311	0.047	0.0449	No	0.3227	No
2/21/2023 13:12	0.311	0.055	0.0455	No	0.3213	No
2/21/2023 13:13	0.316	0.049	0.0457	No	0.3207	No
2/21/2023 13:14	0.316	0.047	0.0458	No	0.3195	No
2/21/2023 13:15	0.315	0.048	0.0461	No	0.3187	No
2/21/2023 13:16	0.328	0.049	0.0467	No	0.3194	No
2/21/2023 13:17	0.321	0.049	0.0471	No	0.3193	No
2/21/2023 13:18	0.336	0.049	0.0476	No	0.3198	No
2/21/2023 13:19	0.322	0.046	0.0477	No	0.3194	No
2/21/2023 13:20	0.315	0.046	0.0478	No	0.3189	No
2/21/2023 13:21	0.319	0.045	0.0478	No	0.3194	No
2/21/2023 13:22	0.318	0.044	0.0477	No	0.3197	No
2/21/2023 13:23	0.307	0.044	0.0475	No	0.3185	No
2/21/2023 13:24	0.313	0.043	0.0474	No	0.3181	No
2/21/2023 13:25	0.314	0.043	0.0469	No	0.3175	No
2/21/2023 13:26	0.323	0.042	0.0466	No	0.3183	No
2/21/2023 13:27	0.314	0.044	0.0459	No	0.3185	No
2/21/2023 13:28	0.319	0.044	0.0455	No	0.3187	No
2/21/2023 13:29	0.319	0.042	0.0452	No	0.3189	No
2/21/2023 13:30	0.315	0.044	0.0449	No	0.3189	No
2/21/2023 13:31	0.309	0.042	0.0445	No	0.3176	No
2/21/2023 13:32	0.304	0.038	0.0437	No	0.3165	No
2/21/2023 13:33	0.308	0.039	0.0431	No	0.3146	No
2/21/2023 13:34	0.298	0.038	0.0425	No	0.313	No
2/21/2023 13:35	0.306	0.039	0.0421	No	0.3124	No
2/21/2023 13:36	0.299	0.045	0.0421	No	0.3111	No
2/21/2023 13:37	0.305	0.042	0.0419	No	0.3102	No
2/21/2023 13:38	0.301	0.042	0.0418	No	0.3098	No
2/21/2023 13:39	0.306	0.047	0.0421	No	0.3093	No
2/21/2023 13:40	0.301	0.042	0.042	No	0.3085	No
2/21/2023 13:41	0.3	0.048	0.0424	No	0.3069	No
2/21/2023 13:42	0.298	0.045	0.0425	No	0.3059	No
2/21/2023 13:43	0.295	0.041	0.0423	No	0.3043	No
2/21/2023 13:44	0.31	0.041	0.0422	No	0.3037	No
2/21/2023 13:45	0.306	0.041	0.042	No	0.3031	No
2/21/2023 13:46	0.31	0.041	0.0419	No	0.3031	No
2/21/2023 13:47	0.292	0.04	0.0421	No	0.3023	No
2/21/2023 13:48	0.303	0.039	0.0421	No	0.302	No
2/21/2023 13:49	0.314	0.041	0.0423	No	0.3031	No
2/21/2023 13:50	0.314	0.043	0.0425	No	0.3036	No
2/21/2023 13:51	0.306	0.045	0.0425	No	0.3041	No
2/21/2023 13:52	0.314	0.048	0.0429	No	0.3047	No
2/21/2023 13:53	0.308	0.048	0.0433	No	0.3051	No
2/21/2023 13:54	0.311	0.048	0.0434	No	0.3055	No
2/21/2023 13:55	0.313	0.051	0.044	No	0.3063	No
2/21/2023 13:56	0.313	0.051	0.0442	No	0.3071	No
2/21/2023 13:57	0.321	0.051	0.0446	No	0.3087	No
2/21/2023 13:58	0.321	0.052	0.0453	No	0.3104	No
2/21/2023 13:59	0.323	0.053	0.0461	No	0.3113	No

Upwind Station						
Time	Instaneous VOC (ppm)	Instaneous Mass Conc. Total (mg/m <sup>3</sup> )	Mass Conc. Total mg/m <sup>3</sup> AVG 15m (mg/m <sup>3</sup> )	Dust Exceedance	VOC ppm AVG 15m (ppm)	VOC Exceedance
2/21/2023 14:00	0.316	0.054	0.047	No	0.3119	No
2/21/2023 14:01	0.317	0.059	0.0482	No	0.3124	No
2/21/2023 14:02	0.323	0.062	0.0497	No	0.3145	No
2/21/2023 14:03	0.33	0.064	0.0513	No	0.3163	No
2/21/2023 14:04	0.321	0.064	0.0529	No	0.3167	No
2/21/2023 14:05	0.345	0.073	0.0549	No	0.3188	No
2/21/2023 14:06	0.334	0.065	0.0562	No	0.3207	No
2/21/2023 14:07	0.326	0.064	0.0573	No	0.3215	No
2/21/2023 14:08	0.333	0.072	0.0589	No	0.3231	No
2/21/2023 14:09	0.339	0.074	0.0606	No	0.325	No
2/21/2023 14:10	0.344	0.07	0.0619	No	0.3271	No
2/21/2023 14:11	0.342	0.066	0.0629	No	0.329	No
2/21/2023 14:12	0.336	0.066	0.0639	No	0.33	No
2/21/2023 14:13	0.33	0.063	0.0646	No	0.3306	No
2/21/2023 14:14	0.329	0.059	0.065	No	0.331	No
2/21/2023 14:15	0.328	0.061	0.0655	No	0.3318	No
2/21/2023 14:16	0.337	0.061	0.0656	No	0.3331	No
2/21/2023 14:17	0.336	0.062	0.0656	No	0.334	No
2/21/2023 14:18	0.336	0.064	0.0656	No	0.3344	No
2/21/2023 14:19	0.321	0.062	0.0655	No	0.3344	No
2/21/2023 14:20	0.331	0.065	0.0649	No	0.3335	No
2/21/2023 14:21	0.327	0.061	0.0647	No	0.333	No
2/21/2023 14:22	0.326	0.062	0.0645	No	0.333	No
2/21/2023 14:23	0.331	0.062	0.0639	No	0.3329	No

Downwind Station						
Time	Instaneous VOC (ppm)	Instaneous Mass Conc. Total (mg/m <sup>3</sup> )	Mass Conc. Total mg/m <sup>3</sup> AVG 15m (mg/m <sup>3</sup> )	Dust Exceedance	VOC ppm AVG 15m (ppm)	VOC Exceedance
2/21/2023 7:05		0.027	0.027	No		No
2/21/2023 7:06	0			No	0	No
2/21/2023 7:07	0	0.02	0.0235	No	0	No
2/21/2023 7:08	0	0.021	0.0227	No	0	No
2/21/2023 7:09	0	0.021	0.0223	No	0	No
2/21/2023 7:10	0	0.023	0.0224	No	0	No
2/21/2023 7:11	0	0.024	0.0227	No	0	No
2/21/2023 7:12	0	0.024	0.0229	No	0	No
2/21/2023 7:13	0	0.023	0.0229	No	0	No
2/21/2023 7:14	0	0.023	0.0229	No	0	No
2/21/2023 7:15	0	0.024	0.023	No	0	No
2/21/2023 7:16	0	0.023	0.023	No	0	No
2/21/2023 7:17	0	0.023	0.023	No	0	No
2/21/2023 7:18	0	0.024	0.0231	No	0	No
2/21/2023 7:19	0	0.024	0.0231	No	0	No
2/21/2023 7:20	0	0.024	0.0229	No	0	No
2/21/2023 7:21	0	0.023	0.0229	No	0	No
2/21/2023 7:22	0	0.024	0.0232	No	0	No
2/21/2023 7:23	0	0.025	0.0235	No	0	No
2/21/2023 7:24	0	0.029	0.024	No	0	No
2/21/2023 7:25	0	0.049	0.0257	No	0	No
2/21/2023 7:26	0	0.029	0.0261	No	0	No
2/21/2023 7:27	0	0.028	0.0263	No	0	No
2/21/2023 7:28	0	0.028	0.0267	No	0	No
2/21/2023 7:29	0	0.031	0.0272	No	0	No
2/21/2023 7:30	0	0.026	0.0273	No	0	No
2/21/2023 7:31	0	0.026	0.0275	No	0	No
2/21/2023 7:32	0	0.027	0.0278	No	0	No
2/21/2023 7:33	0	0.025	0.0279	No	0	No
2/21/2023 7:34	0	0.025	0.0279	No	0	No
2/21/2023 7:35	0	0.026	0.0281	No	0	No
2/21/2023 7:36	0	0.026	0.0283	No	0	No
2/21/2023 7:37	0	0.027	0.0285	No	0	No
2/21/2023 7:38	0	0.027	0.0286	No	0	No
2/21/2023 7:39	0	0.028	0.0285	No	0	No
2/21/2023 7:40	0	0.028	0.0271	No	0	No
2/21/2023 7:41	0	0.024	0.0268	No	0	No
2/21/2023 7:42	0	0.025	0.0266	No	0	No
2/21/2023 7:43	0	0.025	0.0264	No	0	No
2/21/2023 7:44	0	0.025	0.026	No	0	No
2/21/2023 7:45	0	0.025	0.0259	No	0	No
2/21/2023 7:46	0	0.025	0.0259	No	0	No
2/21/2023 7:47	0	0.024	0.0257	No	0	No
2/21/2023 7:48	0	0.023	0.0255	No	0	No
2/21/2023 7:49	0.002	0.024	0.0255	No	0.0001	No
2/21/2023 7:50	0.004	0.025	0.0254	No	0.0004	No
2/21/2023 7:51	0.005	0.035	0.026	No	0.0007	No
2/21/2023 7:52	0	0.028	0.0261	No	0.0007	No
2/21/2023 7:53	0.004	0.025	0.0259	No	0.001	No
2/21/2023 7:54	0.014	0.025	0.0257	No	0.0019	No
2/21/2023 7:55	0.024	0.031	0.0259	No	0.0035	No
2/21/2023 7:56	0.006	0.025	0.026	No	0.0039	No
2/21/2023 7:57	0.022	0.024	0.0259	No	0.0054	No
2/21/2023 7:58	0.014	0.024	0.0259	No	0.0063	No

Downwind Station						
Time	Instaneous VOC (ppm)	Instaneous Mass Conc. Total (mg/m <sup>3</sup> )	Mass Conc. Total mg/m <sup>3</sup> AVG 15m (mg/m <sup>3</sup> )	Dust Exceedance	VOC ppm AVG 15m (ppm)	VOC Exceedance
2/21/2023 7:59	0.031	0.023	0.0257	No	0.0084	No
2/21/2023 8:00	0.019	0.025	0.0257	No	0.0097	No
2/21/2023 8:01	0.04	0.026	0.0258	No	0.0123	No
2/21/2023 8:02	0.27	0.028	0.0261	No	0.0303	No
2/21/2023 8:03	0.069	0.031	0.0266	No	0.0349	No
2/21/2023 8:04	0.052	0.026	0.0267	No	0.0383	No
2/21/2023 8:05	0.423	0.028	0.0269	No	0.0662	No
2/21/2023 8:06	0.065	0.03	0.0266	No	0.0702	No
2/21/2023 8:07	0.133	0.027	0.0265	No	0.0791	No
2/21/2023 8:08	0.121	0.042	0.0277	No	0.0869	No
2/21/2023 8:09	0.265	0.041	0.0287	No	0.1036	No
2/21/2023 8:10	0.101	0.033	0.0289	No	0.1087	No
2/21/2023 8:11	0.1	0.034	0.0295	No	0.115	No
2/21/2023 8:12	0.081	0.033	0.0301	No	0.1189	No
2/21/2023 8:13	0.091	0.031	0.0305	No	0.1241	No
2/21/2023 8:14	0.107	0.032	0.0311	No	0.1291	No
2/21/2023 8:15	0.129	0.033	0.0317	No	0.1365	No
2/21/2023 8:16	0.095	0.031	0.032	No	0.1401	No
2/21/2023 8:17	0.075	0.032	0.0323	No	0.1271	No
2/21/2023 8:18	0.076	0.03	0.0322	No	0.1276	No
2/21/2023 8:19	0.074	0.03	0.0325	No	0.1291	No
2/21/2023 8:20	0.09	0.032	0.0327	No	0.1069	No
2/21/2023 8:21	0.102	0.032	0.0329	No	0.1093	No
2/21/2023 8:22	0.623	0.03	0.0331	No	0.142	No
2/21/2023 8:23	0.342	0.03	0.0323	No	0.1567	No
2/21/2023 8:24	0.306	0.03	0.0315	No	0.1595	No
2/21/2023 8:25	0.165	0.028	0.0312	No	0.1637	No
2/21/2023 8:26	0.32	0.028	0.0308	No	0.1784	No
2/21/2023 8:27	0.134	0.032	0.0307	No	0.1819	No
2/21/2023 8:28	0.117	0.03	0.0307	No	0.1837	No
2/21/2023 8:29	0.169	0.027	0.0303	No	0.1878	No
2/21/2023 8:30	0.11	0.03	0.0301	No	0.1865	No
2/21/2023 8:31	0.117	0.026	0.0298	No	0.188	No
2/21/2023 8:32	0.141	0.026	0.0294	No	0.1924	No
2/21/2023 8:33	0.136	0.026	0.0291	No	0.1964	No
2/21/2023 8:34	0.145	0.027	0.0289	No	0.2011	No
2/21/2023 8:35	0.121	0.028	0.0287	No	0.2032	No
2/21/2023 8:36	0.123	0.027	0.0283	No	0.2046	No
2/21/2023 8:37	0.139	0.029	0.0283	No	0.1723	No
2/21/2023 8:38	0.114	0.025	0.0279	No	0.1571	No
2/21/2023 8:39	0.143	0.024	0.0275	No	0.1463	No
2/21/2023 8:40	0.13	0.025	0.0273	No	0.1439	No
2/21/2023 8:41	0.121	0.025	0.0271	No	0.1307	No
2/21/2023 8:42	0.138	0.023	0.0265	No	0.1309	No
2/21/2023 8:43	0.127	0.023	0.0261	No	0.1316	No
2/21/2023 8:44	0.137	0.023	0.0258	No	0.1295	No
2/21/2023 8:45	0.165	0.026	0.0255	No	0.1331	No
2/21/2023 8:46	0.158	0.027	0.0256	No	0.1359	No
2/21/2023 8:47	0.137	0.025	0.0255	No	0.1356	No
2/21/2023 8:48	0.139	0.022	0.0253	No	0.1358	No
2/21/2023 8:49	0.137	0.024	0.0251	No	0.1353	No
2/21/2023 8:50	0.137	0.022	0.0247	No	0.1363	No
2/21/2023 8:51	0.136	0.023	0.0244	No	0.1372	No
2/21/2023 8:52	0.162	0.023	0.024	No	0.1387	No

Downwind Station						
Time	Instantaneous VOC (ppm)	Instantaneous Mass Conc. Total (mg/m <sup>3</sup> )	Mass Conc. Total mg/m <sup>3</sup> AVG 15m (mg/m <sup>3</sup> )	Dust Exceedance	VOC ppm AVG 15m (ppm)	VOC Exceedance
2/21/2023 8:53	0.142	0.027	0.0241	No	0.1406	No
2/21/2023 8:54	0.148	0.024	0.0241	No	0.1409	No
2/21/2023 8:55	0.148	0.023	0.024	No	0.1421	No
2/21/2023 8:56	0.187	0.028	0.0242	No	0.1465	No
2/21/2023 8:57	0.208	0.03	0.0247	No	0.1512	No
2/21/2023 8:58	0.172	0.029	0.0251	No	0.1542	No
2/21/2023 8:59	0.168	0.029	0.0255	No	0.1563	No
2/21/2023 9:00	0.169	0.028	0.0256	No	0.1565	No
2/21/2023 9:01	0.171	0.033	0.026	No	0.1574	No
2/21/2023 9:02	0.246	0.024	0.0259	No	0.1647	No
2/21/2023 9:03	0.19	0.021	0.0259	No	0.1681	No
2/21/2023 9:04	0.188	0.019	0.0255	No	0.1715	No
2/21/2023 9:05	0.24	0.019	0.0253	No	0.1783	No
2/21/2023 9:06	0.209	0.024	0.0254	No	0.1832	No
2/21/2023 9:07	0.187	0.022	0.0253	No	0.1849	No
2/21/2023 9:08	0.194	0.022	0.025	No	0.1883	No
2/21/2023 9:09	0.172	0.021	0.0248	No	0.1899	No
2/21/2023 9:10	0.463	0.022	0.0247	No	0.2109	No
2/21/2023 9:11	0.212	0.025	0.0245	No	0.2126	No
2/21/2023 9:12	0.219	0.022	0.024	No	0.2133	No
2/21/2023 9:13	0.187	0.021	0.0235	No	0.2143	No
2/21/2023 9:14	0.182	0.019	0.0228	No	0.2153	No
2/21/2023 9:15	0.187	0.019	0.0222	No	0.2165	No
2/21/2023 9:16	0.193	0.017	0.0211	No	0.2179	No
2/21/2023 9:17	0.184	0.018	0.0207	No	0.2138	No
2/21/2023 9:18	0.225	0.017	0.0205	No	0.2161	No
2/21/2023 9:19	0.223	0.02	0.0205	No	0.2185	No
2/21/2023 9:20	0.186	0.018	0.0205	No	0.2149	No
2/21/2023 9:21	0.197	0.017	0.02	No	0.2141	No
2/21/2023 9:22	0.188	0.017	0.0197	No	0.2141	No
2/21/2023 9:23	0.185	0.016	0.0193	No	0.2135	No
2/21/2023 9:24	0.185	0.016	0.0189	No	0.2144	No
2/21/2023 9:25	0.183	0.015	0.0185	No	0.1957	No
2/21/2023 9:26	0.185	0.016	0.0179	No	0.1939	No
2/21/2023 9:27	0.18	0.016	0.0175	No	0.1913	No
2/21/2023 9:28	0.182	0.017	0.0172	No	0.191	No
2/21/2023 9:29	0.184	0.017	0.0171	No	0.1911	No
2/21/2023 9:30	0.184	0.017	0.0169	No	0.1909	No
2/21/2023 9:31	0.18	0.017	0.0169	No	0.1901	No
2/21/2023 9:32	0.182	0.017	0.0169	No	0.1899	No
2/21/2023 9:33	0.194	0.019	0.017	No	0.1879	No
2/21/2023 9:34	0.194	0.015	0.0167	No	0.1859	No
2/21/2023 9:35	0.188	0.015	0.0165	No	0.1861	No
2/21/2023 9:36	0.192	0.015	0.0163	No	0.1857	No
2/21/2023 9:37	0.209	0.017	0.0163	No	0.1871	No
2/21/2023 9:38	0.191	0.016	0.0163	No	0.1875	No
2/21/2023 9:39	0.186	0.015	0.0163	No	0.1876	No
2/21/2023 9:40	0.194	0.015	0.0163	No	0.1883	No
2/21/2023 9:41	0.198	0.016	0.0163	No	0.1892	No
2/21/2023 9:42	0.194	0.016	0.0163	No	0.1901	No
2/21/2023 9:43	0.19	0.017	0.0163	No	0.1907	No
2/21/2023 9:44	0.201	0.017	0.0163	No	0.1918	No
2/21/2023 9:45	0.206	0.017	0.0163	No	0.1933	No
2/21/2023 9:46	0.203	0.014	0.0161	No	0.1948	No

Downwind Station						
Time	Instaneous VOC (ppm)	Instaneous Mass Conc. Total (mg/m <sup>3</sup> )	Mass Conc. Total mg/m <sup>3</sup> AVG 15m (mg/m <sup>3</sup> )	Dust Exceedance	VOC ppm AVG 15m (ppm)	VOC Exceedance
2/21/2023 9:47	0.206	0.016	0.016	No	0.1964	No
2/21/2023 9:48	0.196	0.013	0.0156	No	0.1965	No
2/21/2023 9:49	0.191	0.01	0.0153	No	0.1963	No
2/21/2023 9:50	0.19	0.011	0.015	No	0.1965	No
2/21/2023 9:51	0.202	0.011	0.0147	No	0.1971	No
2/21/2023 9:52	0.215	0.011	0.0143	No	0.1975	No
2/21/2023 9:53	0.199	0.016	0.0143	No	0.1981	No
2/21/2023 9:54	0.198	0.016	0.0144	No	0.1989	No
2/21/2023 9:55	0.197	0.011	0.0141	No	0.1991	No
2/21/2023 9:56	0.196	0.012	0.0139	No	0.1989	No
2/21/2023 9:57	0.2	0.011	0.0135	No	0.1993	No
2/21/2023 9:58	0.206	0.01	0.0131	No	0.2004	No
2/21/2023 9:59	0.206	0.011	0.0127	No	0.2007	No
2/21/2023 10:00	0.204	0.011	0.0123	No	0.2006	No
2/21/2023 10:01	0.206	0.011	0.0121	No	0.2008	No
2/21/2023 10:02	0.207	0.011	0.0117	No	0.2009	No
2/21/2023 10:03	0.202	0.01	0.0115	No	0.2013	No
2/21/2023 10:04	0.203	0.01	0.0115	No	0.2021	No
2/21/2023 10:05	0.219	0.01	0.0115	No	0.204	No
2/21/2023 10:06	0.207	0.01	0.0114	No	0.2043	No
2/21/2023 10:07	0.204	0.01	0.0113	No	0.2036	No
2/21/2023 10:08	0.211	0.01	0.0109	No	0.2044	No
2/21/2023 10:09	0.219	0.01	0.0105	No	0.2058	No
2/21/2023 10:10	0.216	0.011	0.0105	No	0.2071	No
2/21/2023 10:11	0.235	0.012	0.0105	No	0.2097	No
2/21/2023 10:12	0.22	0.011	0.0105	No	0.211	No
2/21/2023 10:13	0.219	0.01	0.0105	No	0.2119	No
2/21/2023 10:14	0.224	0.01	0.0105	No	0.2131	No
2/21/2023 10:15	0.226	0.013	0.0106	No	0.2145	No
2/21/2023 10:16	0.213	0.012	0.0107	No	0.215	No
2/21/2023 10:17	0.212	0.011	0.0107	No	0.2153	No
2/21/2023 10:18	0.224	0.011	0.0107	No	0.2168	No
2/21/2023 10:19	0.217	0.011	0.0108	No	0.2177	No
2/21/2023 10:20	0.215	0.011	0.0109	No	0.2175	No
2/21/2023 10:21	0.213	0.011	0.0109	No	0.2179	No
2/21/2023 10:22	0.219	0.012	0.0111	No	0.2189	No
2/21/2023 10:23	0.22	0.012	0.0112	No	0.2195	No
2/21/2023 10:24	0.214	0.012	0.0113	No	0.2191	No
2/21/2023 10:25	0.21	0.012	0.0114	No	0.2187	No
2/21/2023 10:26	0.214	0.013	0.0115	No	0.2173	No
2/21/2023 10:27	0.214	0.013	0.0116	No	0.2169	No
2/21/2023 10:28	0.213	0.013	0.0118	No	0.2165	No
2/21/2023 10:29	0.213	0.012	0.0119	No	0.2158	No
2/21/2023 10:30	0.218	0.012	0.0119	No	0.2153	No
2/21/2023 10:31	0.214	0.012	0.0119	No	0.2153	No
2/21/2023 10:32	0.215	0.012	0.0119	No	0.2155	No
2/21/2023 10:33	0.22	0.012	0.012	No	0.2153	No
2/21/2023 10:34	0.23	0.012	0.0121	No	0.2161	No
2/21/2023 10:35	0.224	0.013	0.0122	No	0.2167	No
2/21/2023 10:36	0.22	0.012	0.0123	No	0.2172	No
2/21/2023 10:37	0.219	0.013	0.0123	No	0.2172	No
2/21/2023 10:38	0.225	0.017	0.0127	No	0.2175	No
2/21/2023 10:39	0.221	0.017	0.013	No	0.218	No
2/21/2023 10:40	0.216	0.016	0.0133	No	0.2184	No



Downwind Station						
Time	Instaneous VOC (ppm)	Instaneous Mass Conc. Total (mg/m <sup>3</sup> )	Mass Conc. Total mg/m <sup>3</sup> AVG 15m (mg/m <sup>3</sup> )	Dust Exceedance	VOC ppm AVG 15m (ppm)	VOC Exceedance
2/21/2023 10:41	0.261	0.016	0.0135	No	0.2215	No
2/21/2023 10:42	0.245	0.017	0.0137	No	0.2236	No
2/21/2023 10:43	0.25	0.016	0.0139	No	0.2261	No
2/21/2023 10:44	0.232	0.017	0.0143	No	0.2273	No
2/21/2023 10:45	0.224	0.018	0.0147	No	0.2277	No
2/21/2023 10:46	0.217	0.018	0.0151	No	0.2279	No
2/21/2023 10:47	0.213	0.018	0.0155	No	0.2278	No
2/21/2023 10:48	0.212	0.018	0.0159	No	0.2273	No
2/21/2023 10:49	0.214	0.02	0.0164	No	0.2262	No
2/21/2023 10:50	0.217	0.02	0.0169	No	0.2257	No
2/21/2023 10:51	0.242	0.02	0.0174	No	0.2272	No
2/21/2023 10:52	0.224	0.02	0.0179	No	0.2275	No
2/21/2023 10:53	0.225	0.02	0.0181	No	0.2275	No
2/21/2023 10:54	0.218	0.02	0.0183	No	0.2273	No
2/21/2023 10:55	0.226	0.021	0.0186	No	0.228	No
2/21/2023 10:56	0.254	0.025	0.0192	No	0.2275	No
2/21/2023 10:57	0.248	0.027	0.0199	No	0.2277	No
2/21/2023 10:58	0.221	0.027	0.0206	No	0.2258	No
2/21/2023 10:59	0.22	0.026	0.0212	No	0.225	No
2/21/2023 11:00	0.222	0.025	0.0217	No	0.2249	No
2/21/2023 11:01	0.219	0.025	0.0221	No	0.225	No
2/21/2023 11:02	0.219	0.025	0.0226	No	0.2254	No
2/21/2023 11:03	0.224	0.025	0.0231	No	0.2262	No
2/21/2023 11:04	0.235	0.025	0.0234	No	0.2276	No
2/21/2023 11:05	0.246	0.025	0.0237	No	0.2295	No
2/21/2023 11:06	0.227	0.028	0.0243	No	0.2285	No
2/21/2023 11:07	0.224	0.029	0.0249	No	0.2285	No
2/21/2023 11:08	0.232	0.03	0.0255	No	0.229	No
2/21/2023 11:09	0.241	0.029	0.0261	No	0.2305	No
2/21/2023 11:10	0.231	0.027	0.0265	No	0.2309	No
2/21/2023 11:11	0.224	0.023	0.0264	No	0.2289	No
2/21/2023 11:12	0.224	0.022	0.0261	No	0.2273	No
2/21/2023 11:13	0.232	0.022	0.0257	No	0.228	No
2/21/2023 11:14	0.232	0.022	0.0255	No	0.2288	No
2/21/2023 11:15	0.241	0.022	0.0253	No	0.2301	No
2/21/2023 11:16	0.234	0.023	0.0251	No	0.2311	No
2/21/2023 11:17	0.227	0.024	0.0251	No	0.2316	No
2/21/2023 11:18	0.222	0.025	0.0251	No	0.2315	No
2/21/2023 11:19	0.218	0.025	0.0251	No	0.2303	No
2/21/2023 11:20	0.219	0.026	0.0251	No	0.2285	No
2/21/2023 11:21	0.223	0.027	0.0251	No	0.2283	No
2/21/2023 11:22	0.224	0.029	0.0251	No	0.2283	No
2/21/2023 11:23	0.228	0.03	0.0251	No	0.228	No
2/21/2023 11:24	0.222	0.027	0.0249	No	0.2267	No
2/21/2023 11:25	0.227	0.028	0.025	No	0.2265	No
2/21/2023 11:26	0.227	0.029	0.0254	No	0.2267	No
2/21/2023 11:27	0.23	0.029	0.0259	No	0.2271	No
2/21/2023 11:28	0.223	0.029	0.0263	No	0.2265	No
2/21/2023 11:29	0.236	0.031	0.0269	No	0.2267	No
2/21/2023 11:30	0.238	0.035	0.0278	No	0.2265	No
2/21/2023 11:31	0.236	0.032	0.0284	No	0.2267	No
2/21/2023 11:32	0.229	0.03	0.0288	No	0.2268	No
2/21/2023 11:33	0.235	0.031	0.0292	No	0.2277	No
2/21/2023 11:34	0.231	0.03	0.0295	No	0.2285	No

Downwind Station						
Time	Instaneous VOC (ppm)	Instaneous Mass Conc. Total (mg/m <sup>3</sup> )	Mass Conc. Total mg/m <sup>3</sup> AVG 15m (mg/m <sup>3</sup> )	Dust Exceedance	VOC ppm AVG 15m (ppm)	VOC Exceedance
2/21/2023 11:35	0.223	0.031	0.0299	No	0.2288	No
2/21/2023 11:36	0.225	0.031	0.0301	No	0.2289	No
2/21/2023 11:37	0.232	0.031	0.0303	No	0.2295	No
2/21/2023 11:38	0.226	0.033	0.0305	No	0.2293	No
2/21/2023 11:39	0.228	0.033	0.0309	No	0.2297	No
2/21/2023 11:40	0.223	0.034	0.0313	No	0.2295	No
2/21/2023 11:41	0.226	0.033	0.0315	No	0.2294	No
2/21/2023 11:42	0.224	0.035	0.0319	No	0.229	No
2/21/2023 11:43	0.246	0.035	0.0323	No	0.2305	No
2/21/2023 11:44	0.243	0.034	0.0325	No	0.231	No
2/21/2023 11:45	0.238	0.034	0.0325	No	0.231	No
2/21/2023 11:46	0.241	0.036	0.0327	No	0.2313	No
2/21/2023 11:47	0.231	0.036	0.0331	No	0.2315	No
2/21/2023 11:48	0.227	0.036	0.0335	No	0.2309	No
2/21/2023 11:49	0.242	0.035	0.0338	No	0.2317	No
2/21/2023 11:50	0.232	0.036	0.0341	No	0.2323	No
2/21/2023 11:51	0.221	0.036	0.0345	No	0.232	No
2/21/2023 11:52	0.23	0.036	0.0348	No	0.2319	No
2/21/2023 11:53	0.232	0.043	0.0355	No	0.2323	No
2/21/2023 11:54	0.233	0.04	0.0359	No	0.2326	No
2/21/2023 11:55	0.392	0.041	0.0364	No	0.2439	No
2/21/2023 11:56	0.443	0.05	0.0375	No	0.2583	No
2/21/2023 11:57	0.277	0.04	0.0379	No	0.2619	No
2/21/2023 11:58	0.272	0.038	0.0381	No	0.2636	No
2/21/2023 11:59	0.258	0.04	0.0385	No	0.2646	No
2/21/2023 12:00	0.248	0.04	0.0389	No	0.2653	No
2/21/2023 12:01	0.243	0.04	0.0391	No	0.2654	No
2/21/2023 12:02	0.236	0.04	0.0394	No	0.2657	No
2/21/2023 12:03	0.237	0.041	0.0397	No	0.2664	No
2/21/2023 12:04	0.234	0.042	0.0402	No	0.2659	No
2/21/2023 12:05	0.233	0.043	0.0407	No	0.2659	No
2/21/2023 12:06	0.246	0.044	0.0412	No	0.2676	No
2/21/2023 12:07	0.242	0.043	0.0417	No	0.2684	No
2/21/2023 12:08	0.24	0.043	0.0417	No	0.2689	No
2/21/2023 12:09	0.238	0.043	0.0419	No	0.2693	No
2/21/2023 12:10	0.257	0.045	0.0421	No	0.2603	No
2/21/2023 12:11	0.243	0.044	0.0417	No	0.2469	No
2/21/2023 12:12	0.244	0.044	0.042	No	0.2447	No
2/21/2023 12:13	0.246	0.044	0.0424	No	0.243	No
2/21/2023 12:14	0.254	0.045	0.0427	No	0.2427	No
2/21/2023 12:15	0.248	0.045	0.0431	No	0.2427	No
2/21/2023 12:16	0.265	0.049	0.0437	No	0.2442	No
2/21/2023 12:17	0.245	0.043	0.0439	No	0.2448	No
2/21/2023 12:18	0.242	0.042	0.0439	No	0.2451	No
2/21/2023 12:19	0.241	0.041	0.0439	No	0.2456	No
2/21/2023 12:20	0.233	0.041	0.0437	No	0.2456	No
2/21/2023 12:21	0.237	0.04	0.0435	No	0.245	No
2/21/2023 12:22	0.236	0.041	0.0433	No	0.2446	No
2/21/2023 12:23	0.243	0.043	0.0433	No	0.2448	No
2/21/2023 12:24	0.242	0.043	0.0433	No	0.2451	No
2/21/2023 12:25	0.238	0.043	0.0432	No	0.2438	No
2/21/2023 12:26	0.233	0.044	0.0432	No	0.2431	No
2/21/2023 12:27	0.237	0.048	0.0435	No	0.2427	No
2/21/2023 12:28	0.238	0.049	0.0438	No	0.2421	No

Downwind Station						
Time	Instaneous VOC (ppm)	Instaneous Mass Conc. Total (mg/m <sup>3</sup> )	Mass Conc. Total mg/m <sup>3</sup> AVG 15m (mg/m <sup>3</sup> )	Dust Exceedance	VOC ppm AVG 15m (ppm)	VOC Exceedance
2/21/2023 12:29	0.24	0.052	0.0443	No	0.2412	No
2/21/2023 12:30	0.227	0.048	0.0445	No	0.2398	No
2/21/2023 12:31	0.237	0.05	0.0445	No	0.2379	No
2/21/2023 12:32	0.235	0.048	0.0449	No	0.2373	No
2/21/2023 12:33	0.231	0.048	0.0453	No	0.2365	No
2/21/2023 12:34	0.228	0.047	0.0457	No	0.2357	No
2/21/2023 12:35	0.229	0.047	0.0461	No	0.2354	No
2/21/2023 12:36	0.249	0.048	0.0466	No	0.2362	No
2/21/2023 12:37	0.233	0.049	0.0471	No	0.236	No
2/21/2023 12:38	0.238	0.049	0.0475	No	0.2357	No
2/21/2023 12:39	0.232	0.05	0.048	No	0.235	No
2/21/2023 12:40	0.224	0.052	0.0486	No	0.2341	No
2/21/2023 12:41	0.216	0.05	0.049	No	0.2329	No
2/21/2023 12:42	0.216	0.05	0.0491	No	0.2315	No
2/21/2023 12:43	0.215	0.053	0.0494	No	0.23	No
2/21/2023 12:44	0.226	0.053	0.0495	No	0.2291	No
2/21/2023 12:45	0.223	0.053	0.0498	No	0.2288	No
2/21/2023 12:46	0.226	0.054	0.0501	No	0.2281	No
2/21/2023 12:47	0.23	0.053	0.0504	No	0.2277	No
2/21/2023 12:48	0.228	0.052	0.0507	No	0.2275	No
2/21/2023 12:49	0.217	0.052	0.051	No	0.2268	No
2/21/2023 12:50	0.215	0.051	0.0513	No	0.2259	No
2/21/2023 12:51	0.224	0.048	0.0513	No	0.2242	No
2/21/2023 12:52	0.219	0.049	0.0513	No	0.2233	No
2/21/2023 12:53	0.214	0.05	0.0513	No	0.2217	No
2/21/2023 12:54	0.222	0.049	0.0513	No	0.221	No
2/21/2023 12:55	0.218	0.048	0.051	No	0.2206	No
2/21/2023 12:56	0.222	0.038	0.0502	No	0.221	No
2/21/2023 12:57	0.225	0.039	0.0495	No	0.2216	No
2/21/2023 12:58	0.233	0.036	0.0483	No	0.2228	No
2/21/2023 12:59	0.227	0.036	0.0472	No	0.2229	No
2/21/2023 13:00	0.223	0.034	0.0459	No	0.2229	No
2/21/2023 13:01	0.216	0.031	0.0444	No	0.2222	No
2/21/2023 13:02	0.22	0.032	0.043	No	0.2215	No
2/21/2023 13:03	0.221	0.033	0.0417	No	0.2211	No
2/21/2023 13:04	0.214	0.034	0.0405	No	0.2209	No
2/21/2023 13:05	0.213	0.035	0.0395	No	0.2207	No
2/21/2023 13:06	0.218	0.036	0.0387	No	0.2203	No
2/21/2023 13:07	0.215	0.037	0.0379	No	0.2201	No
2/21/2023 13:08	0.221	0.036	0.0369	No	0.2205	No
2/21/2023 13:09	0.208	0.034	0.0359	No	0.2196	No
2/21/2023 13:10	0.208	0.031	0.0348	No	0.2189	No
2/21/2023 13:11	0.216	0.035	0.0346	No	0.2185	No
2/21/2023 13:12	0.206	0.037	0.0345	No	0.2173	No
2/21/2023 13:13	0.234	0.036	0.0345	No	0.2173	No
2/21/2023 13:14	0.243	0.04	0.0347	No	0.2184	No
2/21/2023 13:15	0.228	0.043	0.0353	No	0.2187	No
2/21/2023 13:16	0.224	0.041	0.036	No	0.2193	No
2/21/2023 13:17	0.242	0.04	0.0365	No	0.2207	No
2/21/2023 13:18	0.269	0.045	0.0373	No	0.2239	No
2/21/2023 13:19	0.258	0.063	0.0393	No	0.2269	No
2/21/2023 13:20	0.229	0.047	0.0401	No	0.2279	No
2/21/2023 13:21	0.302	0.043	0.0405	No	0.2335	No
2/21/2023 13:22	0.267	0.04	0.0407	No	0.237	No

Downwind Station						
Time	Instaneous VOC (ppm)	Instaneous Mass Conc. Total (mg/m <sup>3</sup> )	Mass Conc. Total mg/m <sup>3</sup> AVG 15m (mg/m <sup>3</sup> )	Dust Exceedance	VOC ppm AVG 15m (ppm)	VOC Exceedance
2/21/2023 13:23	0.252	0.038	0.0409	No	0.2391	No
2/21/2023 13:24	0.252	0.038	0.0411	No	0.242	No
2/21/2023 13:25	0.251	0.039	0.0417	No	0.2449	No
2/21/2023 13:26	0.226	0.033	0.0415	No	0.2455	No
2/21/2023 13:27	0.213	0.03	0.0411	No	0.246	No
2/21/2023 13:28	0.214	0.03	0.0407	No	0.2447	No
2/21/2023 13:29	0.233	0.032	0.0401	No	0.244	No
2/21/2023 13:30	0.215	0.033	0.0395	No	0.2431	No
2/21/2023 13:31	0.214	0.04	0.0394	No	0.2425	No
2/21/2023 13:32	0.242	0.032	0.0389	No	0.2425	No
2/21/2023 13:33	0.21	0.029	0.0378	No	0.2385	No
2/21/2023 13:34	0.214	0.028	0.0355	No	0.2356	No
2/21/2023 13:35	0.21	0.029	0.0343	No	0.2343	No
2/21/2023 13:36	0.212	0.029	0.0333	No	0.2283	No
2/21/2023 13:37	0.208	0.031	0.0327	No	0.2244	No
2/21/2023 13:38	0.218	0.033	0.0324	No	0.2221	No
2/21/2023 13:39	0.206	0.036	0.0323	No	0.2191	No
2/21/2023 13:40	0.207	0.032	0.0318	No	0.2161	No
2/21/2023 13:41	0.213	0.033	0.0318	No	0.2153	No
2/21/2023 13:42	0.218	0.035	0.0321	No	0.2156	No
2/21/2023 13:43	0.215	0.033	0.0323	No	0.2157	No
2/21/2023 13:44	0.216	0.032	0.0323	No	0.2145	No
2/21/2023 13:45	0.217	0.031	0.0322	No	0.2147	No
2/21/2023 13:46	0.212	0.03	0.0315	No	0.2145	No
2/21/2023 13:47	0.209	0.03	0.0314	No	0.2123	No
2/21/2023 13:48	0.213	0.029	0.0314	No	0.2125	No
2/21/2023 13:49	0.233	0.033	0.0317	No	0.2138	No
2/21/2023 13:50	0.23	0.033	0.032	No	0.2151	No
2/21/2023 13:51	0.225	0.034	0.0323	No	0.216	No
2/21/2023 13:52	0.224	0.037	0.0327	No	0.2171	No
2/21/2023 13:53	0.212	0.037	0.033	No	0.2167	No
2/21/2023 13:54	0.214	0.038	0.0331	No	0.2172	No
2/21/2023 13:55	0.216	0.04	0.0337	No	0.2178	No
2/21/2023 13:56	0.24	0.041	0.0342	No	0.2196	No
2/21/2023 13:57	0.224	0.042	0.0347	No	0.22	No
2/21/2023 13:58	0.221	0.041	0.0352	No	0.2204	No
2/21/2023 13:59	0.221	0.041	0.0358	No	0.2207	No
2/21/2023 14:00	0.221	0.043	0.0366	No	0.221	No
2/21/2023 14:01	0.228	0.048	0.0378	No	0.2221	No
2/21/2023 14:02	0.222	0.053	0.0393	No	0.2229	No
2/21/2023 14:03	0.216	0.055	0.0411	No	0.2231	No
2/21/2023 14:04	0.22	0.052	0.0423	No	0.2223	No
2/21/2023 14:05	0.259	0.055	0.0438	No	0.2242	No
2/21/2023 14:06	0.232	0.059	0.0455	No	0.2247	No
2/21/2023 14:07	0.218	0.054	0.0466	No	0.2243	No
2/21/2023 14:08	0.222	0.064	0.0484	No	0.2249	No
2/21/2023 14:09	0.22	0.061	0.0499	No	0.2253	No
2/21/2023 14:10	0.225	0.058	0.0511	No	0.2259	No
2/21/2023 14:11	0.218	0.056	0.0521	No	0.2245	No
2/21/2023 14:12	0.218	0.055	0.053	No	0.2241	No
2/21/2023 14:13	0.219	0.053	0.0538	No	0.2239	No
2/21/2023 14:14	0.214	0.049	0.0543	No	0.2235	No
2/21/2023 14:15	0.213	0.05	0.0548	No	0.2229	No
2/21/2023 14:16	0.218	0.05	0.0549	No	0.2223	No

**Downwind Station**

Time	Instantaneous VOC (ppm)	Instantaneous Mass Conc. Total (mg/m <sup>3</sup> )	Mass Conc. Total mg/m <sup>3</sup> AVG 15m (mg/m <sup>3</sup> )	Dust Exceedance	VOC ppm AVG 15m (ppm)	VOC Exceedance
2/21/2023 14:17	0.234	0.052	0.0549	No	0.2231	No
2/21/2023 14:18	0.232	0.053	0.0547	No	0.2241	No
2/21/2023 14:19	0.219	0.052	0.0547	No	0.2241	No
2/21/2023 14:20	0.228	0.054	0.0547	No	0.222	No
2/21/2023 14:21	0.214	0.052	0.0542	No	0.2208	No