	Daily Activity Report					
	Seton Brilla Charter School					
	1956 Jerome Avenue, Bronx, NY					
	BCP No. C203152					
General Site Information						
Date:	Thursday, February 16, 2023					
Weather:	Mostly Clousy/Rain, 52-64°F					
Wind Direction/Speed:	SE @ 4 mph					
AKRF Personnel on Site:	Celia Meyer					
AKRF Equipment on Site:	Mini RAE 3000 Photoionization Detector [(PID) x1], 2 Fixed Air Monitoring Stations [DustTrak					
Visitors:	None.					
Contractor Information						
Contracting Company		Main Personnel			Equipment	
Casino Construction		Connor McGrory			Excavator, CFA Drill Rig	
Description and Location of Work Activities Performed						
<p>1) Work continued along the eastern boundary of the site to underpin the adjacent building.</p> <p>2) Equipment was delivered to the site, and other general housekeeping was performed.</p> <p>3)The crew grouted behind lagging on southern portion of eastern wall</p> <p>4) Excavation around pile caps along southern portion of site</p>						
Site Soil Disposal Tracking Information						
Destination Facility	Daily Trucks	Total Trucks	Daily Approx. Cubic Yds	Total Approx. Cubic Yds	Total Site Loads	Total Approximate Cubic Yards
Clean Earth Carteret	0	73	0	1,460	163	3,260
Clean Earth Southeastern Pennsylvania	0	64	0	1,280		
Concrete Disposal	0	26	0	520		
N/A	0	0	0	0		
N/A	0	0	0	0		
CAMP Air Monitoring Results						
CAMP Station	UPWIND			DOWNWIND		
Odors:	None.				None.	
VOC Action Level Exceedance(s):	None.				None.	
Particulate Action Level Exceedance(s):	None.				None.	
Maximum VOC Level (15 min ppm):	0.464				0.450	
Maximum Particulate Level (15 min mg/m ³):	0.0449				0.064	
Notes: CAMP monitoring was performed throughout the day. CAMPS were turned off at 14:15 due to rain.						
Additional Information						
Planned Work Activity for Following Day/Week:	<p>1) Excavation of soil/fill to uncover piles.</p> <p>2) Installation of underpinnings.</p> <p>3) Grouting of wall on southeastern boundary of the site</p>					
Comments:	None.					

Site Map

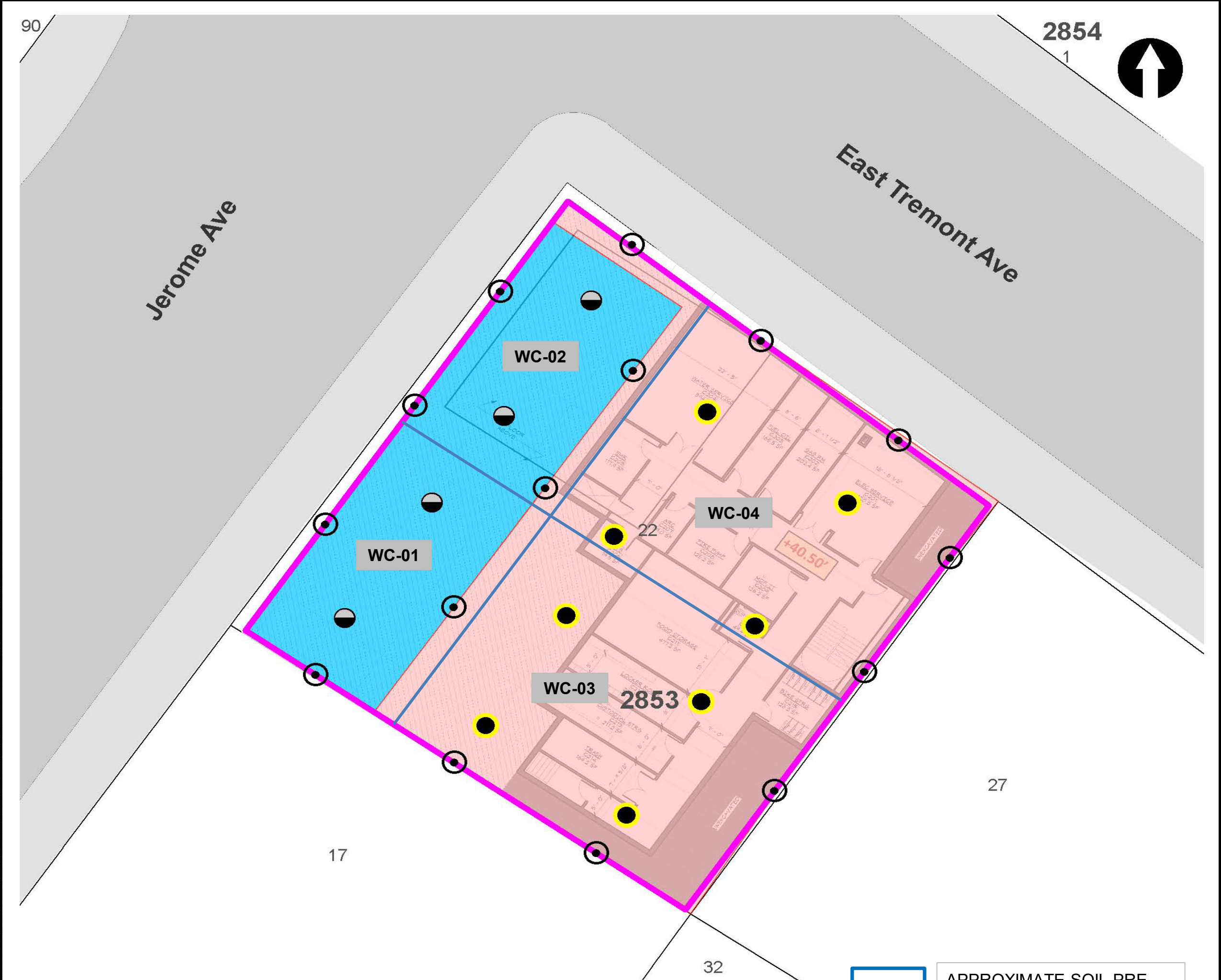

LEGEND

- PROJECT SITE BOUNDARY
- LOT BOUNDARY AND TAX LOT NUMBER
- 2853** BLOCK NUMBER
- REMEDIAL EXCAVATION TO APPROXIMATELY TWO FEET BELOW EXISTING GRADE
- REMEDIAL EXCAVATION TO GROUNDWATER (SOURCE AREA)

- CONFIRMATION DOCUMENTATION BOTTOM SAMPLE
- SOURCE AREA DOCUMENTATION BOTTOM SAMPLE
- DOCUMENTATION SIDEWALL SAMPLE

NOTE
 REMEDIAL EXCAVATION WILL INCLUDE REMOVAL OF APPROXIMATELY 1,280 TONS (850 CUBIC YARDS) OF SOURCE MATERIAL ASSOCIATED WITH NYSDEC SPILL NO. 2103719 AND APPROXIMATELY 860 TONS (570 CUBIC YARDS) OF SOIL/FILL FROM THE UPPER 2 FEET SITE-WIDE.



APPROXIMATE SOIL PRE-CHARACTERIZATION GRID

Map Source:
 NYCDOP (NYC Dept. of City Planning) GIS database

© 2021 AKRF. W:\Projects\210024 - 1956 JEROME AVENUE\Technical\GIS and Graphics\AR\RAW\210024 Figure 9 Proposed Remedial Excavation and Documentation Sample Location Plan.mxd 10/25/2021 2:03:38 PM iszalus



440 Park Avenue South, New York, NY 10016

1956 Jerome Avenue
 Bronx, New York

**TRACK 4 CLEANUP AND DOCUMENTATION
 SAMPLE LOCATION PLAN**

DATE
04/29/2022

PROJECT NO.
210024

FIGURE
11

Site Photographs

Photograph 1 -
General Site
overview, view
facing north.



Photograph 2 -
Excavation in Grid
WC-04, view facing
east.



Photograph 3 -
Excavation in Grid
WC-03, view facing
northeast.



Upwind Station						
Time	Instaneous VOC (ppm)	Instaneous Mass Conc. Total (mg/m ³)	Mass Conc. Total mg/m ³ AVG 15m (mg/m ³)	Dust Exceedance	VOC ppm AVG 15m (ppm)	VOC Exceedance
2/16/2023 7:16	0	0.025	0.025	No	0	No
2/16/2023 7:17	0	0.038	0.0315	No	0	No
2/16/2023 7:18	0	0.026	0.0297	No	0	No
2/16/2023 7:19	0	0.024	0.0283	No	0	No
2/16/2023 7:20	0	0.024	0.0274	No	0	No
2/16/2023 7:21	0	0.029	0.0277	No	0	No
2/16/2023 7:22	0	0.032	0.0283	No	0	No
2/16/2023 7:23	0	0.032	0.0288	No	0	No
2/16/2023 7:24	0	0.026	0.0284	No	0	No
2/16/2023 7:25	0	0.027	0.0283	No	0	No
2/16/2023 7:26	0	0.027	0.0282	No	0	No
2/16/2023 7:27	0	0.025	0.0279	No	0	No
2/16/2023 7:28	0	0.024	0.0276	No	0	No
2/16/2023 7:29	0	0.032	0.0279	No	0	No
2/16/2023 7:30	0	0.025	0.0277	No	0	No
2/16/2023 7:31	0	0.024	0.0277	No	0	No
2/16/2023 7:32	0	0.026	0.0269	No	0	No
2/16/2023 7:33	0	0.024	0.0267	No	0	No
2/16/2023 7:34	0	0.025	0.0268	No	0	No
2/16/2023 7:35	0	0.024	0.0268	No	0	No
2/16/2023 7:36	0	0.023	0.0264	No	0	No
2/16/2023 7:37	0	0.025	0.0259	No	0	No
2/16/2023 7:38	0	0.026	0.0255	No	0	No
2/16/2023 7:39	0	0.027	0.0256	No	0	No
2/16/2023 7:40	0	0.027	0.0256	No	0	No
2/16/2023 7:41	0	0.026	0.0255	No	0	No
2/16/2023 7:42	0	0.026	0.0256	No	0	No
2/16/2023 7:43	0	0.025	0.0257	No	0	No
2/16/2023 7:44	0	0.027	0.0253	No	0	No
2/16/2023 7:45	0	0.026	0.0254	No	0	No
2/16/2023 7:46	0	0.025	0.0255	No	0	No
2/16/2023 7:47	0	0.025	0.0254	No	0	No
2/16/2023 7:48	0	0.025	0.0255	No	0	No
2/16/2023 7:49	0	0.025	0.0255	No	0	No
2/16/2023 7:50	0	0.025	0.0255	No	0	No
2/16/2023 7:51	0	0.026	0.0257	No	0	No
2/16/2023 7:52	0	0.026	0.0258	No	0	No
2/16/2023 7:53	0	0.026	0.0258	No	0	No
2/16/2023 7:54	0	0.027	0.0258	No	0	No
2/16/2023 7:55	0	0.026	0.0257	No	0	No
2/16/2023 7:56	0	0.027	0.0258	No	0	No
2/16/2023 7:57	0	0.026	0.0258	No	0	No
2/16/2023 7:58	0	0.025	0.0258	No	0	No
2/16/2023 7:59	0	0.028	0.0259	No	0	No
2/16/2023 8:00	0	0.029	0.0261	No	0	No
2/16/2023 8:01	0	0.038	0.0269	No	0	No
2/16/2023 8:02	0	0.031	0.0273	No	0	No
2/16/2023 8:03	0	0.032	0.0278	No	0	No
2/16/2023 8:04	0	0.034	0.0284	No	0	No
2/16/2023 8:05	0	0.031	0.0288	No	0	No
2/16/2023 8:06	0	0.035	0.0294	No	0	No
2/16/2023 8:07	0	0.033	0.0299	No	0	No

Upwind Station						
Time	Instaneous VOC (ppm)	Instaneous Mass Conc. Total (mg/m³)	Mass Conc. Total mg/m³ AVG 15m (mg/m³)	Dust Exceedance	VOC ppm AVG 15m (ppm)	VOC Exceedance
2/16/2023 8:08	0	0.028	0.03	No	0	No
2/16/2023 8:09	0	0.027	0.03	No	0	No
2/16/2023 8:10	0	0.03	0.0303	No	0	No
2/16/2023 8:11	0	0.026	0.0302	No	0	No
2/16/2023 8:12	0	0.027	0.0303	No	0	No
2/16/2023 8:13	0	0.028	0.0305	No	0	No
2/16/2023 8:14	0	0.031	0.0307	No	0	No
2/16/2023 8:15	0	0.027	0.0305	No	0	No
2/16/2023 8:16	0	0.031	0.0301	No	0	No
2/16/2023 8:17	0	0.026	0.0297	No	0	No
2/16/2023 8:18	0	0.024	0.0292	No	0	No
2/16/2023 8:19	0	0.026	0.0287	No	0	No
2/16/2023 8:20	0	0.025	0.0283	No	0	No
2/16/2023 8:21	0	0.026	0.0277	No	0	No
2/16/2023 8:22	0	0.024	0.0271	No	0	No
2/16/2023 8:23	0	0.025	0.0269	No	0	No
2/16/2023 8:24	0	0.025	0.0267	No	0	No
2/16/2023 8:25	0	0.023	0.0263	No	0	No
2/16/2023 8:26	0.003	0.023	0.0261	No	0.0002	No
2/16/2023 8:27	0	0.026	0.026	No	0.0002	No
2/16/2023 8:28	0.008	0.036	0.0265	No	0.0007	No
2/16/2023 8:29	0.009	0.025	0.0261	No	0.0013	No
2/16/2023 8:30	0.007	0.024	0.0259	No	0.0018	No
2/16/2023 8:31	0.003	0.024	0.0255	No	0.002	No
2/16/2023 8:32	0.019	0.025	0.0254	No	0.0033	No
2/16/2023 8:33	0.018	0.025	0.0255	No	0.0045	No
2/16/2023 8:34	0.021	0.026	0.0255	No	0.0059	No
2/16/2023 8:35	0.028	0.027	0.0256	No	0.0077	No
2/16/2023 8:36	0.04	0.026	0.0256	No	0.0104	No
2/16/2023 8:37	0.044	0.026	0.0257	No	0.0133	No
2/16/2023 8:38	0.045	0.028	0.0259	No	0.0163	No
2/16/2023 8:39	0.048	0.028	0.0261	No	0.0195	No
2/16/2023 8:40	0.049	0.026	0.0263	No	0.0228	No
2/16/2023 8:41	0.048	0.025	0.0265	No	0.0258	No
2/16/2023 8:42	0.053	0.023	0.0263	No	0.0293	No
2/16/2023 8:43	0.064	0.028	0.0257	No	0.0331	No
2/16/2023 8:44	0.056	0.028	0.0259	No	0.0362	No
2/16/2023 8:45	0.051	0.024	0.0259	No	0.0391	No
2/16/2023 8:46	0.055	0.023	0.0259	No	0.0426	No
2/16/2023 8:47	0.068	0.027	0.026	No	0.0459	No
2/16/2023 8:48	0.075	0.077	0.0295	No	0.0497	No
2/16/2023 8:49	0.082	0.042	0.0305	No	0.0537	No
2/16/2023 8:50	0.073	0.03	0.0307	No	0.0567	No
2/16/2023 8:51	0.071	0.023	0.0305	No	0.0588	No
2/16/2023 8:52	0.074	0.028	0.0307	No	0.0608	No
2/16/2023 8:53	0.075	0.022	0.0303	No	0.0628	No
2/16/2023 8:54	0.08	0.023	0.0299	No	0.0649	No
2/16/2023 8:55	0.083	0.022	0.0297	No	0.0672	No
2/16/2023 8:56	0.086	0.023	0.0295	No	0.0697	No
2/16/2023 8:57	0.093	0.023	0.0295	No	0.0724	No
2/16/2023 8:58	0.097	0.024	0.0293	No	0.0746	No
2/16/2023 8:59	0.093	0.026	0.0291	No	0.0771	No

Upwind Station						
Time	Instaneous VOC (ppm)	Instaneous Mass Conc. Total (mg/m ³)	Mass Conc. Total mg/m ³ AVG 15m (mg/m ³)	Dust Exceedance	VOC ppm AVG 15m (ppm)	VOC Exceedance
2/16/2023 9:00	0.094	0.027	0.0293	No	0.0799	No
2/16/2023 9:01	0.104	0.026	0.0295	No	0.0832	No
2/16/2023 9:02	0.103	0.027	0.0295	No	0.0855	No
2/16/2023 9:03	0.105	0.029	0.0263	No	0.0875	No
2/16/2023 9:04	0.104	0.034	0.0258	No	0.089	No
2/16/2023 9:05	0.103	0.031	0.0259	No	0.091	No
2/16/2023 9:06	0.105	0.029	0.0263	No	0.0933	No
2/16/2023 9:07	0.103	0.036	0.0268	No	0.0952	No
2/16/2023 9:08	0.112	0.035	0.0277	No	0.0977	No
2/16/2023 9:09	0.108	0.04	0.0288	No	0.0995	No
2/16/2023 9:10	0.122	0.04	0.03	No	0.1021	No
2/16/2023 9:11	0.116	0.04	0.0311	No	0.1041	No
2/16/2023 9:12	0.114	0.035	0.0319	No	0.1055	No
2/16/2023 9:13	0.113	0.033	0.0325	No	0.1066	No
2/16/2023 9:14	0.126	0.027	0.0326	No	0.1088	No
2/16/2023 9:15	0.12	0.03	0.0328	No	0.1105	No
2/16/2023 9:16	0.128	0.027	0.0329	No	0.1121	No
2/16/2023 9:17	0.126	0.028	0.0329	No	0.1137	No
2/16/2023 9:18	0.125	0.032	0.0331	No	0.115	No
2/16/2023 9:19	0.129	0.034	0.0331	No	0.1167	No
2/16/2023 9:20	0.138	0.03	0.0331	No	0.119	No
2/16/2023 9:21	0.138	0.024	0.0327	No	0.1212	No
2/16/2023 9:22	0.133	0.027	0.0321	No	0.1232	No
2/16/2023 9:23	0.138	0.028	0.0317	No	0.1249	No
2/16/2023 9:24	0.138	0.026	0.0307	No	0.1269	No
2/16/2023 9:25	0.132	0.026	0.0298	No	0.1276	No
2/16/2023 9:26	0.14	0.025	0.0288	No	0.1292	No
2/16/2023 9:27	0.145	0.033	0.0287	No	0.1313	No
2/16/2023 9:28	0.142	0.024	0.0281	No	0.1332	No
2/16/2023 9:29	0.142	0.024	0.0279	No	0.1343	No
2/16/2023 9:30	0.144	0.024	0.0275	No	0.1359	No
2/16/2023 9:31	0.143	0.025	0.0273	No	0.1369	No
2/16/2023 9:32	0.146	0.023	0.027	No	0.1382	No
2/16/2023 9:33	0.145	0.022	0.0263	No	0.1395	No
2/16/2023 9:34	0.151	0.021	0.0255	No	0.141	No
2/16/2023 9:35	0.155	0.021	0.0249	No	0.1421	No
2/16/2023 9:36	0.167	0.022	0.0247	No	0.1441	No
2/16/2023 9:37	0.168	0.023	0.0245	No	0.1464	No
2/16/2023 9:38	0.171	0.033	0.0248	No	0.1486	No
2/16/2023 9:39	0.179	0.041	0.0258	No	0.1513	No
2/16/2023 9:40	0.176	0.084	0.0297	No	0.1543	No
2/16/2023 9:41	0.181	0.034	0.0303	No	0.157	No
2/16/2023 9:42	0.175	0.026	0.0298	No	0.159	No
2/16/2023 9:43	0.173	0.026	0.0299	No	0.1611	No
2/16/2023 9:44	0.166	0.028	0.0302	No	0.1627	No
2/16/2023 9:45	0.169	0.04	0.0313	No	0.1643	No
2/16/2023 9:46	0.168	0.032	0.0317	No	0.166	No
2/16/2023 9:47	0.175	0.034	0.0325	No	0.1679	No
2/16/2023 9:48	0.177	0.032	0.0331	No	0.1701	No
2/16/2023 9:49	0.184	0.057	0.0355	No	0.1723	No
2/16/2023 9:50	0.178	0.023	0.0357	No	0.1738	No
2/16/2023 9:51	0.182	0.024	0.0358	No	0.1748	No

Upwind Station						
Time	Instaneous VOC (ppm)	Instaneous Mass Conc. Total (mg/m ³)	Mass Conc. Total mg/m ³ AVG 15m (mg/m ³)	Dust Exceedance	VOC ppm AVG 15m (ppm)	VOC Exceedance
2/16/2023 9:52	0.183	0.022	0.0357	No	0.1758	No
2/16/2023 9:53	0.183	0.021	0.0349	No	0.1766	No
2/16/2023 9:54	0.199	0.024	0.0338	No	0.1779	No
2/16/2023 9:55	0.198	0.022	0.0297	No	0.1794	No
2/16/2023 9:56	0.191	0.023	0.0289	No	0.1801	No
2/16/2023 9:57	0.188	0.022	0.0287	No	0.1809	No
2/16/2023 9:58	0.187	0.022	0.0284	No	0.1819	No
2/16/2023 9:59	0.189	0.022	0.028	No	0.1834	No
2/16/2023 10:00	0.194	0.026	0.0271	No	0.1851	No
2/16/2023 10:01	0.204	0.024	0.0265	No	0.1875	No
2/16/2023 10:02	0.198	0.023	0.0258	No	0.189	No
2/16/2023 10:03	0.202	0.023	0.0252	No	0.1907	No
2/16/2023 10:04	0.216	0.024	0.023	No	0.1928	No
2/16/2023 10:05	0.211	0.038	0.024	No	0.195	No
2/16/2023 10:06	0.214	0.022	0.0239	No	0.1971	No
2/16/2023 10:07	0.223	0.022	0.0239	No	0.1998	No
2/16/2023 10:08	0.226	0.025	0.0241	No	0.2027	No
2/16/2023 10:09	0.23	0.021	0.0239	No	0.2047	No
2/16/2023 10:10	0.243	0.022	0.0239	No	0.2077	No
2/16/2023 10:11	0.235	0.024	0.024	No	0.2107	No
2/16/2023 10:12	0.228	0.024	0.0241	No	0.2133	No
2/16/2023 10:13	0.231	0.032	0.0248	No	0.2163	No
2/16/2023 10:14	0.239	0.043	0.0262	No	0.2196	No
2/16/2023 10:15	0.231	0.026	0.0262	No	0.2221	No
2/16/2023 10:16	0.24	0.028	0.0265	No	0.2245	No
2/16/2023 10:17	0.241	0.047	0.0281	No	0.2273	No
2/16/2023 10:18	0.233	0.04	0.0292	No	0.2294	No
2/16/2023 10:19	0.236	0.03	0.0296	No	0.2307	No
2/16/2023 10:20	0.248	0.029	0.029	No	0.2332	No
2/16/2023 10:21	0.252	0.035	0.0299	No	0.2357	No
2/16/2023 10:22	0.258	0.022	0.0299	No	0.2381	No
2/16/2023 10:23	0.26	0.024	0.0298	No	0.2403	No
2/16/2023 10:24	0.269	0.023	0.0299	No	0.2429	No
2/16/2023 10:25	0.281	0.021	0.0299	No	0.2455	No
2/16/2023 10:26	0.29	0.028	0.0301	No	0.2491	No
2/16/2023 10:27	0.298	0.062	0.0327	No	0.2538	No
2/16/2023 10:28	0.307	0.042	0.0333	No	0.2589	No
2/16/2023 10:29	0.322	0.025	0.0321	No	0.2644	No
2/16/2023 10:30	0.321	0.025	0.0321	No	0.2704	No
2/16/2023 10:31	0.327	0.022	0.0317	No	0.2762	No
2/16/2023 10:32	0.334	0.03	0.0305	No	0.2824	No
2/16/2023 10:33	0.338	0.023	0.0294	No	0.2894	No
2/16/2023 10:34	0.341	0.028	0.0293	No	0.2964	No
2/16/2023 10:35	0.348	0.027	0.0291	No	0.3031	No
2/16/2023 10:36	0.347	0.021	0.0282	No	0.3094	No
2/16/2023 10:37	0.334	0.017	0.0279	No	0.3145	No
2/16/2023 10:38	0.335	0.019	0.0275	No	0.3195	No
2/16/2023 10:39	0.349	0.023	0.0275	No	0.3248	No
2/16/2023 10:40	0.342	0.039	0.0287	No	0.3289	No
2/16/2023 10:41	0.351	0.024	0.0285	No	0.3329	No
2/16/2023 10:42	0.358	0.027	0.0261	No	0.3369	No
2/16/2023 10:43	0.358	0.036	0.0257	No	0.3403	No

Upwind Station						
Time	Instaneous VOC (ppm)	Instaneous Mass Conc. Total (mg/m ³)	Mass Conc. Total mg/m ³ AVG 15m (mg/m ³)	Dust Exceedance	VOC ppm AVG 15m (ppm)	VOC Exceedance
2/16/2023 10:44	0.369	0.14	0.0334	No	0.3435	No
2/16/2023 10:45	0.359	0.037	0.0342	No	0.346	No
2/16/2023 10:46	0.361	0.022	0.0342	No	0.3483	No
2/16/2023 10:47	0.356	0.026	0.0339	No	0.3497	No
2/16/2023 10:48	0.358	0.097	0.0389	No	0.3511	No
2/16/2023 10:49	0.358	0.046	0.0401	No	0.3522	No
2/16/2023 10:50	0.356	0.035	0.0406	No	0.3527	No
2/16/2023 10:51	0.368	0.019	0.0405	No	0.3541	No
2/16/2023 10:52	0.37	0.025	0.041	No	0.3565	No
2/16/2023 10:53	0.37	0.02	0.0411	No	0.3589	No
2/16/2023 10:54	0.363	0.022	0.041	No	0.3598	No
2/16/2023 10:55	0.371	0.041	0.0411	No	0.3617	No
2/16/2023 10:56	0.386	0.034	0.0418	No	0.3641	No
2/16/2023 10:57	0.397	0.024	0.0416	No	0.3667	No
2/16/2023 10:58	0.389	0.023	0.0407	No	0.3687	No
2/16/2023 10:59	0.392	0.022	0.0329	No	0.3703	No
2/16/2023 11:00	0.381	0.019	0.0317	No	0.3717	No
2/16/2023 11:01	0.381	0.021	0.0316	No	0.3731	No
2/16/2023 11:02	0.384	0.026	0.0316	No	0.3749	No
2/16/2023 11:03	0.384	0.021	0.0265	No	0.3767	No
2/16/2023 11:04	0.394	0.021	0.0249	No	0.3791	No
2/16/2023 11:05	0.408	0.037	0.025	No	0.3825	No
2/16/2023 11:06	0.409	0.028	0.0256	No	0.3853	No
2/16/2023 11:07	0.381	0.061	0.028	No	0.386	No
2/16/2023 11:08	0.384	0.029	0.0286	No	0.3869	No
2/16/2023 11:09	0.372	0.041	0.0299	No	0.3875	No
2/16/2023 11:10	0.358	0.056	0.0309	No	0.3867	No
2/16/2023 11:11	0.349	0.048	0.0318	No	0.3842	No
2/16/2023 11:12	0.35	0.073	0.0351	No	0.3811	No
2/16/2023 11:13	0.347	0.029	0.0355	No	0.3783	No
2/16/2023 11:14	0.359	0.026	0.0357	No	0.3761	No
2/16/2023 11:15	0.357	0.025	0.0361	No	0.3745	No
2/16/2023 11:16	0.36	0.021	0.0361	No	0.3731	No
2/16/2023 11:17	0.363	0.02	0.0357	No	0.3717	No
2/16/2023 11:18	0.363	0.021	0.0357	No	0.3703	No
2/16/2023 11:19	0.356	0.02	0.0357	No	0.3677	No
2/16/2023 11:20	0.349	0.022	0.0347	No	0.3638	No
2/16/2023 11:21	0.36	0.023	0.0343	No	0.3605	No
2/16/2023 11:22	0.371	0.03	0.0323	No	0.3599	No
2/16/2023 11:23	0.367	0.058	0.0342	No	0.3587	No
2/16/2023 11:24	0.364	0.021	0.0329	No	0.3582	No
2/16/2023 11:25	0.37	0.031	0.0312	No	0.359	No
2/16/2023 11:26	0.37	0.041	0.0307	No	0.3604	No
2/16/2023 11:27	0.369	0.042	0.0287	No	0.3617	No
2/16/2023 11:28	0.375	0.047	0.0299	No	0.3635	No
2/16/2023 11:29	0.371	0.041	0.0309	No	0.3643	No
2/16/2023 11:30	0.38	0.052	0.0327	No	0.3659	No
2/16/2023 11:31	0.379	0.025	0.0329	No	0.3671	No
2/16/2023 11:32	0.374	0.025	0.0333	No	0.3679	No
2/16/2023 11:33	0.385	0.03	0.0339	No	0.3693	No
2/16/2023 11:34	0.393	0.031	0.0346	No	0.3718	No
2/16/2023 11:35	0.402	0.033	0.0353	No	0.3753	No

Upwind Station						
Time	Instaneous VOC (ppm)	Instaneous Mass Conc. Total (mg/m ³)	Mass Conc. Total mg/m ³ AVG 15m (mg/m ³)	Dust Exceedance	VOC ppm AVG 15m (ppm)	VOC Exceedance
2/16/2023 11:36	0.404	0.05	0.0371	No	0.3783	No
2/16/2023 11:37	0.406	0.034	0.0374	No	0.3806	No
2/16/2023 11:38	0.414	0.033	0.0357	No	0.3837	No
2/16/2023 11:39	0.407	0.028	0.0362	No	0.3866	No
2/16/2023 11:40	0.406	0.031	0.0362	No	0.389	No
2/16/2023 11:41	0.413	0.033	0.0357	No	0.3919	No
2/16/2023 11:42	0.409	0.031	0.0349	No	0.3945	No
2/16/2023 11:43	0.417	0.027	0.0336	No	0.3973	No
2/16/2023 11:44	0.412	0.029	0.0328	No	0.4001	No
2/16/2023 11:45	0.414	0.026	0.0311	No	0.4023	No
2/16/2023 11:46	0.398	0.025	0.0311	No	0.4036	No
2/16/2023 11:47	0.398	0.027	0.0312	No	0.4052	No
2/16/2023 11:48	0.395	0.034	0.0315	No	0.4059	No
2/16/2023 11:49	0.387	0.052	0.0329	No	0.4055	No
2/16/2023 11:50	0.385	0.04	0.0333	No	0.4043	No
2/16/2023 11:51	0.373	0.032	0.0321	No	0.4023	No
2/16/2023 11:52	0.356	0.035	0.0322	No	0.3989	No
2/16/2023 11:53	0.337	0.027	0.0318	No	0.3938	No
2/16/2023 11:54	0.338	0.026	0.0317	No	0.3892	No
2/16/2023 11:55	0.342	0.025	0.0313	No	0.3849	No
2/16/2023 11:56	0.339	0.024	0.0307	No	0.38	No
2/16/2023 11:57	0.354	0.028	0.0305	No	0.3763	No
2/16/2023 11:58	0.354	0.025	0.0303	No	0.3721	No
2/16/2023 11:59	0.341	0.026	0.0301	No	0.3674	No
2/16/2023 12:00	0.344	0.023	0.0299	No	0.3627	No
2/16/2023 12:01	0.352	0.026	0.03	No	0.3597	No
2/16/2023 12:02	0.364	0.025	0.0299	No	0.3574	No
2/16/2023 12:03	0.377	0.039	0.0302	No	0.3562	No
2/16/2023 12:04	0.389	0.056	0.0305	No	0.3563	No
2/16/2023 12:05	0.388	0.04	0.0305	No	0.3565	No
2/16/2023 12:06	0.379	0.028	0.0302	No	0.3569	No
2/16/2023 12:07	0.369	0.025	0.0295	No	0.3578	No
2/16/2023 12:08	0.368	0.023	0.0293	No	0.3599	No
2/16/2023 12:09	0.451	0.03	0.0295	No	0.3674	No
2/16/2023 12:10	0.443	0.026	0.0296	No	0.3741	No
2/16/2023 12:11	0.412	0.026	0.0297	No	0.379	No
2/16/2023 12:12	0.402	0.024	0.0295	No	0.3822	No
2/16/2023 12:13	0.403	0.027	0.0296	No	0.3855	No
2/16/2023 12:14	0.402	0.025	0.0295	No	0.3895	No
2/16/2023 12:15	0.402	0.025	0.0297	No	0.3934	No
2/16/2023 12:16	0.408	0.028	0.0298	No	0.3971	No
2/16/2023 12:17	0.401	0.026	0.0299	No	0.3996	No
2/16/2023 12:18	0.397	0.024	0.0289	No	0.4009	No
2/16/2023 12:19	0.394	0.024	0.0267	No	0.4013	No
2/16/2023 12:20	0.391	0.031	0.0261	No	0.4015	No
2/16/2023 12:21	0.379	0.03	0.0263	No	0.4015	No
2/16/2023 12:22	0.382	0.024	0.0262	No	0.4023	No
2/16/2023 12:23	0.408	0.056	0.0284	No	0.405	No
2/16/2023 12:24	0.414	0.028	0.0283	No	0.4025	No
2/16/2023 12:25	0.408	0.022	0.028	No	0.4002	No
2/16/2023 12:26	0.398	0.022	0.0277	No	0.3993	No
2/16/2023 12:27	0.398	0.043	0.029	No	0.399	No

Upwind Station						
Time	Instaneous VOC (ppm)	Instaneous Mass Conc. Total (mg/m ³)	Mass Conc. Total mg/m ³ AVG 15m (mg/m ³)	Dust Exceedance	VOC ppm AVG 15m (ppm)	VOC Exceedance
2/16/2023 12:28	0.407	0.031	0.0293	No	0.3993	No
2/16/2023 12:29	0.415	0.024	0.0292	No	0.4001	No
2/16/2023 12:30	0.409	0.031	0.0296	No	0.4006	No
2/16/2023 12:31	0.41	0.043	0.0306	No	0.4007	No
2/16/2023 12:32	0.41	0.033	0.0311	No	0.4013	No
2/16/2023 12:33	0.401	0.049	0.0327	No	0.4016	No
2/16/2023 12:34	0.406	0.032	0.0333	No	0.4024	No
2/16/2023 12:35	0.42	0.029	0.0331	No	0.4043	No
2/16/2023 12:36	0.419	0.027	0.0329	No	0.407	No
2/16/2023 12:37	0.429	0.037	0.0338	No	0.4101	No
2/16/2023 12:38	0.439	0.039	0.0327	No	0.4122	No
2/16/2023 12:39	0.438	0.037	0.0333	No	0.4138	No
2/16/2023 12:40	0.426	0.03	0.0338	No	0.415	No
2/16/2023 12:41	0.436	0.029	0.0343	No	0.4175	No
2/16/2023 12:42	0.449	0.05	0.0347	No	0.4209	No
2/16/2023 12:43	0.455	0.041	0.0354	No	0.4241	No
2/16/2023 12:44	0.439	0.028	0.0357	No	0.4257	No
2/16/2023 12:45	0.419	0.025	0.0353	No	0.4264	No
2/16/2023 12:46	0.406	0.024	0.034	No	0.4261	No
2/16/2023 12:47	0.403	0.025	0.0335	No	0.4257	No
2/16/2023 12:48	0.402	0.024	0.0318	No	0.4257	No
2/16/2023 12:49	0.396	0.027	0.0315	No	0.4251	No
2/16/2023 12:50	0.392	0.025	0.0312	No	0.4232	No
2/16/2023 12:51	0.394	0.025	0.0311	No	0.4215	No
2/16/2023 12:52	0.385	0.026	0.0303	No	0.4186	No
2/16/2023 12:53	0.388	0.026	0.0295	No	0.4152	No
2/16/2023 12:54	0.388	0.025	0.0287	No	0.4119	No
2/16/2023 12:55	0.384	0.024	0.0283	No	0.4091	No
2/16/2023 12:56	0.384	0.024	0.0279	No	0.4056	No
2/16/2023 12:57	0.383	0.022	0.0261	No	0.4012	No
2/16/2023 12:58	0.383	0.024	0.0249	No	0.3964	No
2/16/2023 12:59	0.397	0.038	0.0256	No	0.3936	No
2/16/2023 13:00	0.39	0.027	0.0257	No	0.3917	No
2/16/2023 13:01	0.402	0.024	0.0257	No	0.3914	No
2/16/2023 13:02	0.402	0.025	0.0257	No	0.3913	No
2/16/2023 13:03	0.404	0.029	0.0261	No	0.3915	No
2/16/2023 13:04	0.403	0.028	0.0261	No	0.3919	No
2/16/2023 13:05	0.41	0.036	0.0269	No	0.3931	No
2/16/2023 13:06	0.399	0.031	0.0273	No	0.3935	No
2/16/2023 13:07	0.409	0.026	0.0273	No	0.3951	No
2/16/2023 13:08	0.405	0.025	0.0272	No	0.3962	No
2/16/2023 13:09	0.398	0.026	0.0273	No	0.3969	No
2/16/2023 13:10	0.412	0.023	0.0272	No	0.3987	No
2/16/2023 13:11	0.408	0.027	0.0274	No	0.4003	No
2/16/2023 13:12	0.417	0.028	0.0278	No	0.4026	No
2/16/2023 13:13	0.418	0.028	0.0281	No	0.4049	No
2/16/2023 13:14	0.406	0.028	0.0274	No	0.4055	No
2/16/2023 13:15	0.41	0.032	0.0277	No	0.4069	No
2/16/2023 13:16	0.408	0.031	0.0282	No	0.4073	No
2/16/2023 13:17	0.401	0.028	0.0284	No	0.4072	No
2/16/2023 13:18	0.401	0.028	0.0283	No	0.407	No
2/16/2023 13:19	0.406	0.034	0.0287	No	0.4072	No

Upwind Station						
Time	Instaneous VOC (ppm)	Instaneous Mass Conc. Total (mg/m ³)	Mass Conc. Total mg/m ³ AVG 15m (mg/m ³)	Dust Exceedance	VOC ppm AVG 15m (ppm)	VOC Exceedance
2/16/2023 13:20	0.408	0.042	0.0291	No	0.4071	No
2/16/2023 13:21	0.394	0.094	0.0333	No	0.4067	No
2/16/2023 13:22	0.4	0.096	0.038	No	0.4061	No
2/16/2023 13:23	0.405	0.033	0.0385	No	0.4061	No
2/16/2023 13:24	0.404	0.028	0.0387	No	0.4065	No
2/16/2023 13:25	0.407	0.029	0.0391	No	0.4062	No
2/16/2023 13:26	0.404	0.03	0.0393	No	0.4059	No
2/16/2023 13:27	0.414	0.027	0.0392	No	0.4057	No
2/16/2023 13:28	0.404	0.028	0.0392	No	0.4048	No
2/16/2023 13:29	0.402	0.031	0.0394	No	0.4045	No
2/16/2023 13:30	0.397	0.027	0.0391	No	0.4037	No
2/16/2023 13:31	0.396	0.03	0.039	No	0.4029	No
2/16/2023 13:32	0.405	0.034	0.0394	No	0.4031	No
2/16/2023 13:33	0.404	0.043	0.0404	No	0.4033	No
2/16/2023 13:34	0.4	0.059	0.0421	No	0.4029	No
2/16/2023 13:35	0.405	0.032	0.0414	No	0.4027	No
2/16/2023 13:36	0.405	0.029	0.0371	No	0.4035	No
2/16/2023 13:37	0.426	0.03	0.0327	No	0.4052	No
2/16/2023 13:38	0.406	0.026	0.0322	No	0.4053	No
2/16/2023 13:39	0.391	0.031	0.0324	No	0.4044	No
2/16/2023 13:40	0.393	0.037	0.0329	No	0.4035	No
2/16/2023 13:41	0.405	0.031	0.033	No	0.4035	No
2/16/2023 13:42	0.41	0.031	0.0333	No	0.4033	No
2/16/2023 13:43	0.42	0.04	0.0341	No	0.4043	No
2/16/2023 13:44	0.423	0.05	0.0353	No	0.4057	No
2/16/2023 13:45	0.423	0.03	0.0355	No	0.4075	No
2/16/2023 13:46	0.43	0.032	0.0357	No	0.4097	No
2/16/2023 13:47	0.535	0.03	0.0354	No	0.4184	No
2/16/2023 13:48	0.511	0.04	0.0352	No	0.4255	No
2/16/2023 13:49	0.497	0.032	0.0334	No	0.432	No
2/16/2023 13:50	0.507	0.035	0.0336	No	0.4388	No
2/16/2023 13:51	0.466	0.032	0.0338	No	0.4429	No
2/16/2023 13:52	0.464	0.031	0.0339	No	0.4454	No
2/16/2023 13:53	0.461	0.033	0.0343	No	0.4491	No
2/16/2023 13:54	0.457	0.033	0.0345	No	0.4535	No
2/16/2023 13:55	0.456	0.037	0.0345	No	0.4577	No
2/16/2023 13:56	0.448	0.035	0.0347	No	0.4605	No
2/16/2023 13:57	0.437	0.041	0.0354	No	0.4623	No
2/16/2023 13:58	0.439	0.051	0.0361	No	0.4636	No
2/16/2023 13:59	0.415	0.055	0.0365	No	0.4631	No
2/16/2023 14:00	0.411	0.04	0.0371	No	0.4623	No
2/16/2023 14:01	0.404	0.039	0.0376	No	0.4605	No
2/16/2023 14:02	0.395	0.03	0.0376	No	0.4512	No
2/16/2023 14:03	0.404	0.035	0.0373	No	0.4441	No
2/16/2023 14:04	0.397	0.038	0.0377	No	0.4374	No
2/16/2023 14:05	0.387	0.032	0.0375	No	0.4294	No
2/16/2023 14:06	0.395	0.033	0.0375	No	0.4247	No
2/16/2023 14:07	0.392	0.039	0.0381	No	0.4199	No
2/16/2023 14:08	0.387	0.038	0.0384	No	0.4149	No
2/16/2023 14:09	0.396	0.042	0.039	No	0.4109	No
2/16/2023 14:10	0.391	0.05	0.0399	No	0.4065	No
2/16/2023 14:11	0.389	0.05	0.0409	No	0.4026	No

Upwind Station

Time	Instantaneous VOC (ppm)	Instantaneous Mass Conc. Total (mg/m ³)	Mass Conc. Total mg/m ³ AVG 15m (mg/m ³)	Dust Exceedance	VOC ppm AVG 15m (ppm)	VOC Exceedance
2/16/2023 14:12	0.384	0.057	0.0419	No	0.3991	No
2/16/2023 14:13	0.376	0.051	0.0419	No	0.3949	No
2/16/2023 14:14	0.37	0.082	0.0437	No	0.3919	No
2/16/2023 14:15	0.351	0.057	0.0449	No	0.3879	No

Downwind Station						
Time	Instaneous VOC (ppm)	Instaneous Mass Conc. Total (mg/m ³)	Mass Conc. Total mg/m ³ AVG 15m (mg/m ³)	Dust Exceedance	VOC ppm AVG 15m (ppm)	VOC Exceedance
2/16/2023 7:12	0	0.01	0.01	No	0	No
2/16/2023 7:13	0	0	0.005	No	0	No
2/16/2023 7:14	0	-0.004	0.002	No	0	No
2/16/2023 7:15	0	-0.005	0.0003	No	0	No
2/16/2023 7:16	0	-0.007	-0.0012	No	0	No
2/16/2023 7:17	0	-0.006	-0.002	No	0	No
2/16/2023 7:18	0.034	-0.005	-0.0024	No	0.0049	No
2/16/2023 7:19	0	-0.004	-0.0026	No	0.0043	No
2/16/2023 7:20	0	-0.004	-0.0028	No	0.0038	No
2/16/2023 7:21	0	0.026	0.0001	No	0.0034	No
2/16/2023 7:22	0.048	0.122	0.0112	No	0.0075	No
2/16/2023 7:23	0.024	0.073	0.0163	No	0.0088	No
2/16/2023 7:24	0.008	0.06	0.0197	No	0.0088	No
2/16/2023 7:25	0	0.06	0.0226	No	0.0081	No
2/16/2023 7:26	0	0.036	0.0235	No	0.0076	No
2/16/2023 7:27	0	0.03	0.0248	No	0.0076	No
2/16/2023 7:28	0	0.027	0.0266	No	0.0076	No
2/16/2023 7:29	0.005	0.026	0.0286	No	0.0079	No
2/16/2023 7:30	0.005	0.026	0.0307	No	0.0083	No
2/16/2023 7:31	0.012	0.027	0.0329	No	0.0091	No
2/16/2023 7:32	0.018	0.027	0.0351	No	0.0103	No
2/16/2023 7:33	0.017	0.027	0.0373	No	0.0091	No
2/16/2023 7:34	0.016	0.026	0.0393	No	0.0102	No
2/16/2023 7:35	0.031	0.026	0.0413	No	0.0123	No
2/16/2023 7:36	0.017	0.025	0.0412	No	0.0134	No
2/16/2023 7:37	0.02	0.026	0.0348	No	0.0115	No
2/16/2023 7:38	0.023	0.025	0.0316	No	0.0115	No
2/16/2023 7:39	0.026	0.026	0.0293	No	0.0127	No
2/16/2023 7:40	0.025	0.031	0.0274	No	0.0143	No
2/16/2023 7:41	0.03	0.031	0.0271	No	0.0163	No
2/16/2023 7:42	0.029	0.035	0.0274	No	0.0183	No
2/16/2023 7:43	0.034	0.03	0.0276	No	0.0205	No
2/16/2023 7:44	0.039	0.028	0.0277	No	0.0228	No
2/16/2023 7:45	0.036	0.029	0.0279	No	0.0249	No
2/16/2023 7:46	0.039	0.027	0.0279	No	0.0267	No
2/16/2023 7:47	0.043	0.031	0.0282	No	0.0283	No
2/16/2023 7:48	0.053	0.044	0.0293	No	0.0307	No
2/16/2023 7:49	0.057	0.036	0.03	No	0.0335	No
2/16/2023 7:50	0.056	0.03	0.0303	No	0.0351	No
2/16/2023 7:51	0.061	0.029	0.0305	No	0.0381	No
2/16/2023 7:52	0.053	0.032	0.0309	No	0.0403	No
2/16/2023 7:53	0.053	0.033	0.0315	No	0.0423	No
2/16/2023 7:54	0.059	0.028	0.0316	No	0.0445	No
2/16/2023 7:55	0.07	0.028	0.0314	No	0.0475	No
2/16/2023 7:56	0.067	0.03	0.0313	No	0.0499	No
2/16/2023 7:57	0.067	0.039	0.0316	No	0.0525	No
2/16/2023 7:58	0.068	0.042	0.0324	No	0.0547	No
2/16/2023 7:59	0.07	0.034	0.0328	No	0.0568	No
2/16/2023 8:00	0.066	0.041	0.0336	No	0.0588	No
2/16/2023 8:01	0.074	0.052	0.0353	No	0.0611	No
2/16/2023 8:02	0.084	0.039	0.0358	No	0.0639	No
2/16/2023 8:03	0.087	0.043	0.0357	No	0.0661	No
2/16/2023 8:04	0.087	0.039	0.0359	No	0.0681	No
2/16/2023 8:05	0.095	0.042	0.0367	No	0.0707	No

Downwind Station						
Time	Instaneous VOC (ppm)	Instaneous Mass Conc. Total (mg/m ³)	Mass Conc. Total mg/m ³ AVG 15m (mg/m ³)	Dust Exceedance	VOC ppm AVG 15m (ppm)	VOC Exceedance
2/16/2023 8:06	0.112	0.079	0.0401	No	0.0741	No
2/16/2023 8:07	0.1	0.068	0.0425	No	0.0773	No
2/16/2023 8:08	0.096	0.048	0.0435	No	0.0801	No
2/16/2023 8:09	0.092	0.032	0.0437	No	0.0823	No
2/16/2023 8:10	0.099	0.031	0.0439	No	0.0843	No
2/16/2023 8:11	0.1	0.029	0.0439	No	0.0865	No
2/16/2023 8:12	0.109	0.032	0.0434	No	0.0893	No
2/16/2023 8:13	0.104	0.03	0.0426	No	0.0917	No
2/16/2023 8:14	0.092	0.027	0.0421	No	0.0931	No
2/16/2023 8:15	0.103	0.026	0.0411	No	0.0956	No
2/16/2023 8:16	0.153	0.029	0.0396	No	0.1009	No
2/16/2023 8:17	0.117	0.029	0.0389	No	0.1031	No
2/16/2023 8:18	0.121	0.025	0.0377	No	0.1053	No
2/16/2023 8:19	0.178	0.027	0.0369	No	0.1114	No
2/16/2023 8:20	0.312	0.026	0.0359	No	0.1259	No
2/16/2023 8:21	1.006	0.028	0.0325	No	0.1855	No
2/16/2023 8:22	0.677	0.028	0.0298	No	0.2239	No
2/16/2023 8:23	0.615	0.027	0.0284	No	0.2585	No
2/16/2023 8:24	0.42	0.027	0.0281	No	0.2804	No
2/16/2023 8:25	0.253	0.028	0.0279	No	0.2907	No
2/16/2023 8:26	0.203	0.026	0.0277	No	0.2975	No
2/16/2023 8:27	0.182	0.025	0.0272	No	0.3024	No
2/16/2023 8:28	0.183	0.028	0.0271	No	0.3077	No
2/16/2023 8:29	0.158	0.024	0.0269	No	0.3121	No
2/16/2023 8:30	0.154	0.024	0.0267	No	0.3155	No
2/16/2023 8:31	0.137	0.024	0.0264	No	0.3144	No
2/16/2023 8:32	0.132	0.023	0.026	No	0.3154	No
2/16/2023 8:33	0.138	0.022	0.0258	No	0.3165	No
2/16/2023 8:34	0.164	0.022	0.0255	No	0.3156	No
2/16/2023 8:35	0.173	0.023	0.0253	No	0.3063	No
2/16/2023 8:36	0.163	0.023	0.0249	No	0.2501	No
2/16/2023 8:37	0.158	0.023	0.0246	No	0.2155	No
2/16/2023 8:38	0.16	0.025	0.0245	No	0.1852	No
2/16/2023 8:39	0.154	0.024	0.0243	No	0.1675	No
2/16/2023 8:40	0.149	0.023	0.0239	No	0.1605	No
2/16/2023 8:41	0.14	0.023	0.0237	No	0.1563	No
2/16/2023 8:42	0.135	0.022	0.0235	No	0.1532	No
2/16/2023 8:43	0.142	0.019	0.0229	No	0.1505	No
2/16/2023 8:44	0.147	0.022	0.0228	No	0.1497	No
2/16/2023 8:45	0.136	0.021	0.0226	No	0.1485	No
2/16/2023 8:46	0.287	0.021	0.0224	No	0.1585	No
2/16/2023 8:47	0.169	0.059	0.0248	No	0.161	No
2/16/2023 8:48	0.15	0.053	0.0269	No	0.1618	No
2/16/2023 8:49	0.139	0.024	0.027	No	0.1601	No
2/16/2023 8:50	0.138	0.024	0.0271	No	0.1578	No
2/16/2023 8:51	0.139	0.023	0.0271	No	0.1562	No
2/16/2023 8:52	0.138	0.021	0.0269	No	0.1549	No
2/16/2023 8:53	0.129	0.022	0.0267	No	0.1528	No
2/16/2023 8:54	0.146	0.023	0.0267	No	0.1523	No
2/16/2023 8:55	0.154	0.023	0.0267	No	0.1526	No
2/16/2023 8:56	0.15	0.021	0.0265	No	0.1533	No
2/16/2023 8:57	0.142	0.021	0.0265	No	0.1537	No
2/16/2023 8:58	0.133	0.023	0.0267	No	0.1531	No
2/16/2023 8:59	0.127	0.028	0.0271	No	0.1518	No

Downwind Station						
Time	Instaneous VOC (ppm)	Instaneous Mass Conc. Total (mg/m ³)	Mass Conc. Total mg/m ³ AVG 15m (mg/m ³)	Dust Exceedance	VOC ppm AVG 15m (ppm)	VOC Exceedance
2/16/2023 9:00	0.125	0.045	0.0287	No	0.1511	No
2/16/2023 9:01	0.136	0.029	0.0293	No	0.141	No
2/16/2023 9:02	0.137	0.024	0.0269	No	0.1389	No
2/16/2023 9:03	0.134	0.037	0.0259	No	0.1378	No
2/16/2023 9:04	0.131	0.031	0.0263	No	0.1373	No
2/16/2023 9:05	0.129	0.027	0.0265	No	0.1367	No
2/16/2023 9:06	0.131	0.03	0.027	No	0.1361	No
2/16/2023 9:07	0.13	0.031	0.0277	No	0.1356	No
2/16/2023 9:08	0.141	0.034	0.0285	No	0.1364	No
2/16/2023 9:09	0.145	0.037	0.0294	No	0.1363	No
2/16/2023 9:10	0.136	0.047	0.031	No	0.1351	No
2/16/2023 9:11	0.137	0.039	0.0322	No	0.1343	No
2/16/2023 9:12	0.138	0.04	0.0335	No	0.134	No
2/16/2023 9:13	0.141	0.035	0.0343	No	0.1345	No
2/16/2023 9:14	0.13	0.027	0.0342	No	0.1347	No
2/16/2023 9:15	0.137	0.03	0.0332	No	0.1355	No
2/16/2023 9:16	0.139	0.023	0.0328	No	0.1357	No
2/16/2023 9:17	0.147	0.028	0.0331	No	0.1364	No
2/16/2023 9:18	0.133	0.028	0.0325	No	0.1363	No
2/16/2023 9:19	0.126	0.027	0.0322	No	0.136	No
2/16/2023 9:20	0.138	0.024	0.032	No	0.1366	No
2/16/2023 9:21	0.128	0.02	0.0313	No	0.1364	No
2/16/2023 9:22	0.133	0.022	0.0307	No	0.1366	No
2/16/2023 9:23	0.139	0.023	0.03	No	0.1365	No
2/16/2023 9:24	0.136	0.027	0.0293	No	0.1359	No
2/16/2023 9:25	0.134	0.022	0.0277	No	0.1357	No
2/16/2023 9:26	0.149	0.023	0.0266	No	0.1365	No
2/16/2023 9:27	0.129	0.023	0.0255	No	0.1359	No
2/16/2023 9:28	0.13	0.019	0.0244	No	0.1352	No
2/16/2023 9:29	0.139	0.019	0.0239	No	0.1358	No
2/16/2023 9:30	0.143	0.022	0.0233	No	0.1362	No
2/16/2023 9:31	0.127	0.027	0.0236	No	0.1354	No
2/16/2023 9:32	0.127	0.018	0.0229	No	0.1341	No
2/16/2023 9:33	0.145	0.026	0.0228	No	0.1349	No
2/16/2023 9:34	0.194	0.025	0.0227	No	0.1394	No
2/16/2023 9:35	0.141	0.036	0.0235	No	0.1396	No
2/16/2023 9:36	0.156	0.025	0.0238	No	0.1415	No
2/16/2023 9:37	0.163	0.025	0.024	No	0.1435	No
2/16/2023 9:38	0.139	0.027	0.0243	No	0.1435	No
2/16/2023 9:39	0.142	0.019	0.0237	No	0.1439	No
2/16/2023 9:40	0.175	0.023	0.0238	No	0.1466	No
2/16/2023 9:41	0.147	0.03	0.0243	No	0.1465	No
2/16/2023 9:42	0.159	0.034	0.025	No	0.1485	No
2/16/2023 9:43	0.152	0.028	0.0256	No	0.1499	No
2/16/2023 9:44	0.151	0.033	0.0265	No	0.1507	No
2/16/2023 9:45	0.16	0.068	0.0296	No	0.1519	No
2/16/2023 9:46	0.125	0.042	0.0306	No	0.1517	No
2/16/2023 9:47	0.134	0.032	0.0315	No	0.1522	No
2/16/2023 9:48	0.141	0.033	0.032	No	0.1519	No
2/16/2023 9:49	0.137	0.033	0.0325	No	0.1481	No
2/16/2023 9:50	0.143	0.036	0.0325	No	0.1483	No
2/16/2023 9:51	0.134	0.023	0.0324	No	0.1468	No
2/16/2023 9:52	0.136	0.02	0.0321	No	0.145	No
2/16/2023 9:53	0.138	0.022	0.0317	No	0.1449	No

Downwind Station						
Time	Instaneous VOC (ppm)	Instaneous Mass Conc. Total (mg/m ³)	Mass Conc. Total mg/m ³ AVG 15m (mg/m ³)	Dust Exceedance	VOC ppm AVG 15m (ppm)	VOC Exceedance
2/16/2023 9:54	0.148	0.023	0.032	No	0.1453	No
2/16/2023 9:55	0.141	0.021	0.0319	No	0.1431	No
2/16/2023 9:56	0.133	0.018	0.0311	No	0.1421	No
2/16/2023 9:57	0.128	0.018	0.03	No	0.1401	No
2/16/2023 9:58	0.133	0.019	0.0294	No	0.1388	No
2/16/2023 9:59	0.154	0.019	0.0285	No	0.139	No
2/16/2023 10:00	0.144	0.02	0.0253	No	0.1379	No
2/16/2023 10:01	0.143	0.02	0.0238	No	0.1391	No
2/16/2023 10:02	0.142	0.018	0.0229	No	0.1397	No
2/16/2023 10:03	0.138	0.019	0.0219	No	0.1395	No
2/16/2023 10:04	0.141	0.02	0.0211	No	0.1397	No
2/16/2023 10:05	0.135	0.037	0.0211	No	0.1392	No
2/16/2023 10:06	0.147	0.055	0.0233	No	0.1401	No
2/16/2023 10:07	0.141	0.022	0.0234	No	0.1404	No
2/16/2023 10:08	0.142	0.019	0.0232	No	0.1407	No
2/16/2023 10:09	0.141	0.021	0.0231	No	0.1402	No
2/16/2023 10:10	0.136	0.018	0.0229	No	0.1399	No
2/16/2023 10:11	0.142	0.019	0.0229	No	0.1405	No
2/16/2023 10:12	0.163	0.021	0.0231	No	0.1428	No
2/16/2023 10:13	0.153	0.02	0.0232	No	0.1441	No
2/16/2023 10:14	0.143	0.026	0.0237	No	0.1434	No
2/16/2023 10:15	0.148	0.023	0.0239	No	0.1437	No
2/16/2023 10:16	0.137	0.021	0.0239	No	0.1433	No
2/16/2023 10:17	0.147	0.02	0.0241	No	0.1436	No
2/16/2023 10:18	0.146	0.024	0.0244	No	0.1441	No
2/16/2023 10:19	0.138	0.037	0.0255	No	0.1439	No
2/16/2023 10:20	0.134	0.021	0.0245	No	0.1439	No
2/16/2023 10:21	0.145	0.027	0.0226	No	0.1437	No
2/16/2023 10:22	0.151	0.022	0.0226	No	0.1444	No
2/16/2023 10:23	0.145	0.026	0.0231	No	0.1446	No
2/16/2023 10:24	0.144	0.034	0.0239	No	0.1448	No
2/16/2023 10:25	0.18	0.022	0.0242	No	0.1477	No
2/16/2023 10:26	0.185	0.034	0.0252	No	0.1506	No
2/16/2023 10:27	0.196	0.022	0.0253	No	0.1528	No
2/16/2023 10:28	0.161	0.025	0.0256	No	0.1533	No
2/16/2023 10:29	0.198	0.034	0.0261	No	0.157	No
2/16/2023 10:30	0.155	0.033	0.0268	No	0.1575	No
2/16/2023 10:31	0.172	0.021	0.0268	No	0.1598	No
2/16/2023 10:32	0.158	0.027	0.0273	No	0.1605	No
2/16/2023 10:33	0.161	0.025	0.0273	No	0.1615	No
2/16/2023 10:34	0.159	0.022	0.0263	No	0.1629	No
2/16/2023 10:35	0.14	0.021	0.0263	No	0.1633	No
2/16/2023 10:36	0.135	0.017	0.0257	No	0.1627	No
2/16/2023 10:37	0.137	0.017	0.0253	No	0.1617	No
2/16/2023 10:38	0.133	0.02	0.0249	No	0.1609	No
2/16/2023 10:39	0.138	0.019	0.0239	No	0.1605	No
2/16/2023 10:40	0.167	0.018	0.0237	No	0.1597	No
2/16/2023 10:41	0.151	0.019	0.0227	No	0.1574	No
2/16/2023 10:42	0.152	0.016	0.0223	No	0.1545	No
2/16/2023 10:43	0.18	0.02	0.0219	No	0.1557	No
2/16/2023 10:44	0.176	0.022	0.0211	No	0.1543	No
2/16/2023 10:45	0.2	0.024	0.0205	No	0.1573	No
2/16/2023 10:46	0.193	0.023	0.0207	No	0.1587	No
2/16/2023 10:47	0.216	0.021	0.0203	No	0.1625	No

Downwind Station						
Time	Instaneous VOC (ppm)	Instaneous Mass Conc. Total (mg/m ³)	Mass Conc. Total mg/m ³ AVG 15m (mg/m ³)	Dust Exceedance	VOC ppm AVG 15m (ppm)	VOC Exceedance
2/16/2023 10:48	0.192	0.02	0.0199	No	0.1646	No
2/16/2023 10:49	0.196	0.024	0.0201	No	0.1671	No
2/16/2023 10:50	0.186	0.026	0.0204	No	0.1701	No
2/16/2023 10:51	0.158	0.021	0.0207	No	0.1717	No
2/16/2023 10:52	0.17	0.016	0.0206	No	0.1739	No
2/16/2023 10:53	0.162	0.016	0.0203	No	0.1758	No
2/16/2023 10:54	0.205	0.018	0.0203	No	0.1803	No
2/16/2023 10:55	0.19	0.021	0.0205	No	0.1818	No
2/16/2023 10:56	0.167	0.02	0.0205	No	0.1829	No
2/16/2023 10:57	0.169	0.038	0.022	No	0.184	No
2/16/2023 10:58	0.184	0.028	0.0225	No	0.1843	No
2/16/2023 10:59	0.17	0.034	0.0233	No	0.1839	No
2/16/2023 11:00	0.179	0.033	0.0239	No	0.1825	No
2/16/2023 11:01	0.173	0.022	0.0239	No	0.1811	No
2/16/2023 11:02	0.187	0.029	0.0244	No	0.1792	No
2/16/2023 11:03	0.181	0.03	0.0251	No	0.1785	No
2/16/2023 11:04	0.2	0.022	0.0249	No	0.1787	No
2/16/2023 11:05	0.181	0.022	0.0247	No	0.1784	No
2/16/2023 11:06	0.182	0.018	0.0245	No	0.18	No
2/16/2023 11:07	0.183	0.025	0.0251	No	0.1809	No
2/16/2023 11:08	0.189	0.024	0.0256	No	0.1827	No
2/16/2023 11:09	0.231	0.027	0.0262	No	0.1844	No
2/16/2023 11:10	0.232	0.021	0.0262	No	0.1872	No
2/16/2023 11:11	0.216	0.021	0.0263	No	0.1905	No
2/16/2023 11:12	0.204	0.029	0.0257	No	0.1928	No
2/16/2023 11:13	0.205	0.047	0.0269	No	0.1942	No
2/16/2023 11:14	0.205	0.03	0.0267	No	0.1965	No
2/16/2023 11:15	0.176	0.019	0.0257	No	0.1963	No
2/16/2023 11:16	0.182	0.019	0.0255	No	0.1969	No
2/16/2023 11:17	0.174	0.02	0.0249	No	0.1961	No
2/16/2023 11:18	0.184	0.025	0.0246	No	0.1963	No
2/16/2023 11:19	0.176	0.025	0.0248	No	0.1947	No
2/16/2023 11:20	0.188	0.021	0.0247	No	0.1951	No
2/16/2023 11:21	0.174	0.02	0.0249	No	0.1946	No
2/16/2023 11:22	0.185	0.022	0.0247	No	0.1947	No
2/16/2023 11:23	0.167	0.42	0.0511	No	0.1933	No
2/16/2023 11:24	0.174	0.096	0.0557	No	0.1895	No
2/16/2023 11:25	0.175	0.034	0.0565	No	0.1857	No
2/16/2023 11:26	0.17	0.064	0.0594	No	0.1826	No
2/16/2023 11:27	0.163	0.036	0.0599	No	0.1799	No
2/16/2023 11:28	0.168	0.031	0.0588	No	0.1774	No
2/16/2023 11:29	0.18	0.03	0.0588	No	0.1757	No
2/16/2023 11:30	0.163	0.023	0.0591	No	0.1749	No
2/16/2023 11:31	0.166	0.022	0.0593	No	0.1738	No
2/16/2023 11:32	0.17	0.025	0.0596	No	0.1735	No
2/16/2023 11:33	0.193	0.025	0.0596	No	0.1741	No
2/16/2023 11:34	0.302	0.025	0.0596	No	0.1825	No
2/16/2023 11:35	0.316	0.029	0.0601	No	0.1911	No
2/16/2023 11:36	0.293	0.055	0.0625	No	0.199	No
2/16/2023 11:37	0.261	0.048	0.0642	No	0.2041	No
2/16/2023 11:38	0.249	0.044	0.0391	No	0.2095	No
2/16/2023 11:39	0.306	0.043	0.0356	No	0.2183	No
2/16/2023 11:40	0.229	0.031	0.0354	No	0.2219	No
2/16/2023 11:41	0.223	0.046	0.0342	No	0.2255	No

Downwind Station						
Time	Instaneous VOC (ppm)	Instaneous Mass Conc. Total (mg/m ³)	Mass Conc. Total mg/m ³ AVG 15m (mg/m ³)	Dust Exceedance	VOC ppm AVG 15m (ppm)	VOC Exceedance
2/16/2023 11:42	0.234	0.025	0.0335	No	0.2302	No
2/16/2023 11:43	0.237	0.025	0.0331	No	0.2348	No
2/16/2023 11:44	0.275	0.025	0.0327	No	0.2411	No
2/16/2023 11:45	0.273	0.023	0.0327	No	0.2485	No
2/16/2023 11:46	0.238	0.026	0.033	No	0.2533	No
2/16/2023 11:47	0.26	0.032	0.0335	No	0.2593	No
2/16/2023 11:48	0.256	0.076	0.0369	No	0.2635	No
2/16/2023 11:49	0.249	0.074	0.0401	No	0.2599	No
2/16/2023 11:50	0.25	0.053	0.0417	No	0.2555	No
2/16/2023 11:51	0.214	0.04	0.0407	No	0.2503	No
2/16/2023 11:52	0.203	0.026	0.0393	No	0.2464	No
2/16/2023 11:53	0.195	0.023	0.0379	No	0.2428	No
2/16/2023 11:54	0.202	0.02	0.0363	No	0.2359	No
2/16/2023 11:55	0.184	0.019	0.0355	No	0.2329	No
2/16/2023 11:56	0.202	0.017	0.0336	No	0.2315	No
2/16/2023 11:57	0.251	0.023	0.0335	No	0.2326	No
2/16/2023 11:58	0.244	0.03	0.0338	No	0.2331	No
2/16/2023 11:59	0.239	0.025	0.0338	No	0.2307	No
2/16/2023 12:00	0.211	0.024	0.0339	No	0.2265	No
2/16/2023 12:01	0.214	0.022	0.0336	No	0.2249	No
2/16/2023 12:02	0.22	0.022	0.0329	No	0.2223	No
2/16/2023 12:03	0.39	0.036	0.0303	No	0.2312	No
2/16/2023 12:04	0.466	0.081	0.0307	No	0.2457	No
2/16/2023 12:05	0.454	0.064	0.0315	No	0.2593	No
2/16/2023 12:06	0.348	0.059	0.0327	No	0.2682	No
2/16/2023 12:07	0.328	0.076	0.0361	No	0.2765	No
2/16/2023 12:08	0.491	0.025	0.0362	No	0.2963	No
2/16/2023 12:09	1.675	0.026	0.0366	No	0.3945	No
2/16/2023 12:10	0.54	0.031	0.0374	No	0.4182	No
2/16/2023 12:11	0.415	0.025	0.0379	No	0.4324	No
2/16/2023 12:12	0.253	0.021	0.0378	No	0.4325	No
2/16/2023 12:13	0.233	0.019	0.0371	No	0.4318	No
2/16/2023 12:14	0.226	0.019	0.0367	No	0.4309	No
2/16/2023 12:15	0.245	0.019	0.0363	No	0.4332	No
2/16/2023 12:16	0.363	0.02	0.0362	No	0.4431	No
2/16/2023 12:17	0.297	0.019	0.036	No	0.4483	No
2/16/2023 12:18	0.255	0.019	0.0349	No	0.4393	No
2/16/2023 12:19	0.249	0.019	0.0307	No	0.4248	No
2/16/2023 12:20	0.242	0.02	0.0278	No	0.4107	No
2/16/2023 12:21	0.269	0.023	0.0254	No	0.4054	No
2/16/2023 12:22	1.002	0.022	0.0218	No	0.4503	No
2/16/2023 12:23	0.407	0.019	0.0214	No	0.4447	No
2/16/2023 12:24	0.281	0.022	0.0211	No	0.3518	No
2/16/2023 12:25	0.212	0.015	0.0201	No	0.3299	No
2/16/2023 12:26	0.344	0.017	0.0195	No	0.3252	No
2/16/2023 12:27	0.284	0.084	0.0237	No	0.3273	No
2/16/2023 12:28	0.231	0.041	0.0252	No	0.3271	No
2/16/2023 12:29	0.294	0.022	0.0254	No	0.3317	No
2/16/2023 12:30	0.322	0.023	0.0257	No	0.3368	No
2/16/2023 12:31	0.246	0.019	0.0256	No	0.329	No
2/16/2023 12:32	0.204	0.018	0.0255	No	0.3228	No
2/16/2023 12:33	0.221	0.029	0.0262	No	0.3205	No
2/16/2023 12:34	0.213	0.029	0.0269	No	0.3181	No
2/16/2023 12:35	0.312	0.029	0.0275	No	0.3228	No

Downwind Station						
Time	Instantaneous VOC (ppm)	Instantaneous Mass Conc. Total (mg/m ³)	Mass Conc. Total mg/m ³ AVG 15m (mg/m ³)	Dust Exceedance	VOC ppm AVG 15m (ppm)	VOC Exceedance
2/16/2023 12:36	0.315	0.026	0.0277	No	0.3259	No
2/16/2023 12:37	0.836	0.032	0.0283	No	0.3148	No
2/16/2023 12:38	0.757	0.033	0.0293	No	0.3381	No
2/16/2023 12:39	0.562	0.027	0.0296	No	0.3569	No
2/16/2023 12:40	0.351	0.023	0.0301	No	0.3661	No
2/16/2023 12:41	0.251	0.018	0.0302	No	0.3599	No
2/16/2023 12:42	0.449	0.019	0.0259	No	0.3709	No
2/16/2023 12:43	0.425	0.029	0.0251	No	0.3839	No
2/16/2023 12:44	0.36	0.041	0.0263	No	0.3883	No
2/16/2023 12:45	0.412	0.031	0.0269	No	0.3943	No
2/16/2023 12:46	0.471	0.035	0.0279	No	0.4093	No
2/16/2023 12:47	0.321	0.036	0.0291	No	0.4171	No
2/16/2023 12:48	0.304	0.024	0.0288	No	0.4226	No
2/16/2023 12:49	0.294	0.028	0.0287	No	0.428	No
2/16/2023 12:50	0.231	0.025	0.0285	No	0.4226	No
2/16/2023 12:51	0.22	0.017	0.0279	No	0.4163	No
2/16/2023 12:52	0.203	0.016	0.0268	No	0.3741	No
2/16/2023 12:53	0.201	0.018	0.0258	No	0.337	No
2/16/2023 12:54	0.239	0.019	0.0253	No	0.3155	No
2/16/2023 12:55	0.264	0.027	0.0255	No	0.3097	No
2/16/2023 12:56	0.206	0.029	0.0263	No	0.3067	No
2/16/2023 12:57	0.208	0.018	0.0262	No	0.2906	No
2/16/2023 12:58	0.271	0.041	0.027	No	0.2803	No
2/16/2023 12:59	0.247	0.064	0.0285	No	0.2728	No
2/16/2023 13:00	0.207	0.032	0.0286	No	0.2591	No
2/16/2023 13:01	0.18	0.017	0.0274	No	0.2397	No
2/16/2023 13:02	0.182	0.013	0.0259	No	0.2305	No
2/16/2023 13:03	0.204	0.014	0.0252	No	0.2238	No
2/16/2023 13:04	0.208	0.014	0.0243	No	0.2181	No
2/16/2023 13:05	0.197	0.013	0.0235	No	0.2158	No
2/16/2023 13:06	0.197	0.014	0.0233	No	0.2143	No
2/16/2023 13:07	0.201	0.013	0.0231	No	0.2141	No
2/16/2023 13:08	0.225	0.014	0.0228	No	0.2157	No
2/16/2023 13:09	0.208	0.013	0.0224	No	0.2137	No
2/16/2023 13:10	0.225	0.013	0.0215	No	0.2111	No
2/16/2023 13:11	0.247	0.015	0.0205	No	0.2138	No
2/16/2023 13:12	0.276	0.016	0.0204	No	0.2183	No
2/16/2023 13:13	0.265	0.017	0.0188	No	0.2179	No
2/16/2023 13:14	0.258	0.026	0.0163	No	0.2187	No
2/16/2023 13:15	0.296	0.039	0.0167	No	0.2246	No
2/16/2023 13:16	0.292	0.031	0.0177	No	0.2321	No
2/16/2023 13:17	0.256	0.023	0.0183	No	0.237	No
2/16/2023 13:18	0.244	0.025	0.0191	No	0.2397	No
2/16/2023 13:19	0.257	0.025	0.0198	No	0.2429	No
2/16/2023 13:20	0.208	0.023	0.0205	No	0.2437	No
2/16/2023 13:21	0.217	0.018	0.0207	No	0.245	No
2/16/2023 13:22	0.233	0.019	0.0211	No	0.2471	No
2/16/2023 13:23	0.22	0.023	0.0217	No	0.2468	No
2/16/2023 13:24	0.228	0.024	0.0225	No	0.2481	No
2/16/2023 13:25	0.219	0.02	0.0229	No	0.2477	No
2/16/2023 13:26	0.221	0.019	0.0232	No	0.246	No
2/16/2023 13:27	0.204	0.031	0.0242	No	0.2412	No
2/16/2023 13:28	0.172	0.025	0.0247	No	0.235	No
2/16/2023 13:29	0.172	0.014	0.0239	No	0.2293	No

Downwind Station						
Time	Instantaneous VOC (ppm)	Instantaneous Mass Conc. Total (mg/m ³)	Mass Conc. Total mg/m ³ AVG 15m (mg/m ³)	Dust Exceedance	VOC ppm AVG 15m (ppm)	VOC Exceedance
2/16/2023 13:30	0.175	0.019	0.0226	No	0.2212	No
2/16/2023 13:31	0.175	0.026	0.0223	No	0.2134	No
2/16/2023 13:32	0.184	0.032	0.0229	No	0.2086	No
2/16/2023 13:33	0.181	0.025	0.0229	No	0.2044	No
2/16/2023 13:34	0.183	0.024	0.0228	No	0.1995	No
2/16/2023 13:35	0.204	0.021	0.0227	No	0.1992	No
2/16/2023 13:36	0.289	0.027	0.0233	No	0.204	No
2/16/2023 13:37	0.304	0.024	0.0236	No	0.2087	No
2/16/2023 13:38	0.224	0.021	0.0235	No	0.209	No
2/16/2023 13:39	0.19	0.02	0.0232	No	0.2065	No
2/16/2023 13:40	0.202	0.017	0.023	No	0.2053	No
2/16/2023 13:41	0.232	0.02	0.0231	No	0.2061	No
2/16/2023 13:42	0.277	0.018	0.0222	No	0.2109	No
2/16/2023 13:43	0.238	0.02	0.0219	No	0.2153	No
2/16/2023 13:44	0.265	0.017	0.0221	No	0.2215	No
2/16/2023 13:45	0.204	0.016	0.0219	No	0.2235	No
2/16/2023 13:46	0.203	0.016	0.0212	No	0.2253	No
2/16/2023 13:47	0.197	0.02	0.0204	No	0.2262	No
2/16/2023 13:48	0.223	0.017	0.0199	No	0.229	No
2/16/2023 13:49	0.214	0.017	0.0194	No	0.2311	No
2/16/2023 13:50	0.188	0.016	0.0191	No	0.23	No
2/16/2023 13:51	0.19	0.018	0.0185	No	0.2234	No
2/16/2023 13:52	0.186	0.044	0.0198	No	0.2155	No
2/16/2023 13:53	0.185	0.022	0.0199	No	0.2129	No
2/16/2023 13:54	0.169	0.017	0.0197	No	0.2115	No
2/16/2023 13:55	0.167	0.021	0.0199	No	0.2092	No
2/16/2023 13:56	0.167	0.02	0.0199	No	0.2049	No
2/16/2023 13:57	0.183	0.02	0.0201	No	0.1986	No
2/16/2023 13:58	0.171	0.04	0.0214	No	0.1941	No
2/16/2023 13:59	0.187	0.051	0.0237	No	0.1889	No
2/16/2023 14:00	0.168	0.023	0.0241	No	0.1865	No
2/16/2023 14:01	0.162	0.019	0.0243	No	0.1838	No
2/16/2023 14:02	0.166	0.019	0.0243	No	0.1817	No
2/16/2023 14:03	0.164	0.019	0.0244	No	0.1778	No
2/16/2023 14:04	0.164	0.02	0.0246	No	0.1745	No
2/16/2023 14:05	0.163	0.024	0.0251	No	0.1728	No
2/16/2023 14:06	0.16	0.02	0.0253	No	0.1708	No
2/16/2023 14:07	0.191	0.021	0.0237	No	0.1711	No
2/16/2023 14:08	0.212	0.023	0.0238	No	0.1729	No
2/16/2023 14:09	0.327	0.029	0.0246	No	0.1835	No
2/16/2023 14:10	0.252	0.044	0.0261	No	0.1891	No
2/16/2023 14:11	0.24	0.043	0.0277	No	0.194	No
2/16/2023 14:12	0.228	0.036	0.0287	No	0.197	No
2/16/2023 14:13	0.21	0.029	0.028	No	0.1996	No
2/16/2023 14:14	0.215	0.039	0.0272	No	0.2015	No
2/16/2023 14:15	0.19	0.046	0.0287	No	0.2029	No

Downwind Station

Time	Instantaneous VOC (ppm)	Instantaneous Mass Conc. Total (mg/m ³)	Mass Conc. Total mg/m ³ AVG 15m (mg/m ³)	Dust Exceedance	VOC ppm AVG 15m (ppm)	VOC Exceedance
2/16/2023 14:16	0.212	0.035	0.0298	No	0.2063	No
2/16/2023 14:17	0.203	0.033	0.0307	No	0.2087	No