



Daily Activity Report

Seton Brilla Charter School
1956 Jerome Avenue, Bronx, NY
BCP No. C203152

General Site Information

Date:	Tuesday, February 14, 2023
Weather:	Sunny, 42-53°F
Wind Direction/Speed:	NW @ 10-15 mph
AKRF Personnel on Site:	Shannon Donohue
AKRF Equipment on Site:	Mini RAE 3000 Photoionization Detector [(PID) x1], 2 Fixed Air Monitoring Stations [DustTrak
Visitors:	None.

Contractor Information

Contracting Company	Main Personnel	Equipment
Casino Construction	Connor McGrory	Excavator, CFA Drill Rig

Description and Location of Work Activities Performed

- 1) Work continued along the eastern boundary of the site to underpin the adjacent building.
- 2) Equipment was removed from the site along with other general housekeeping

Site Soil Disposal Tracking Information

Destination Facility	Daily Trucks	Total Trucks	Daily Approx. Cubic Yds	Total Approx. Cubic Yds	Total Site Loads	Total Approximate Cubic Yards
Clean Earth Carteret	0	73	0	1,460	163	3,260
Clean Earth Southeastern Pennsylvania	0	64	0	1,280		
Concrete Disposal	0	26	0	520		
N/A	0	0	0	0		
N/A	0	0	0	0		

CAMP Air Monitoring Results

CAMP Station	UPWIND				DOWNWIND		
Odors:	None.				None.		
VOC Action Level Exceedance(s):	None.				None.		
Particulate Action Level Exceedance(s):	None.				None.		
Maximum VOC Level (15 min ppm):	0.434				0.352		
Maximum Particulate Level (15 min mg/m ³):	0.063				0.042		

Notes: CAMP monitoring was performed throughout the day.

Additional Information

Planned Work Activity for Following Day/Week:	1) Excavation of soil/fill to uncover piles. 2) Installation of underpinnings.
Comments:	None.

Site Map

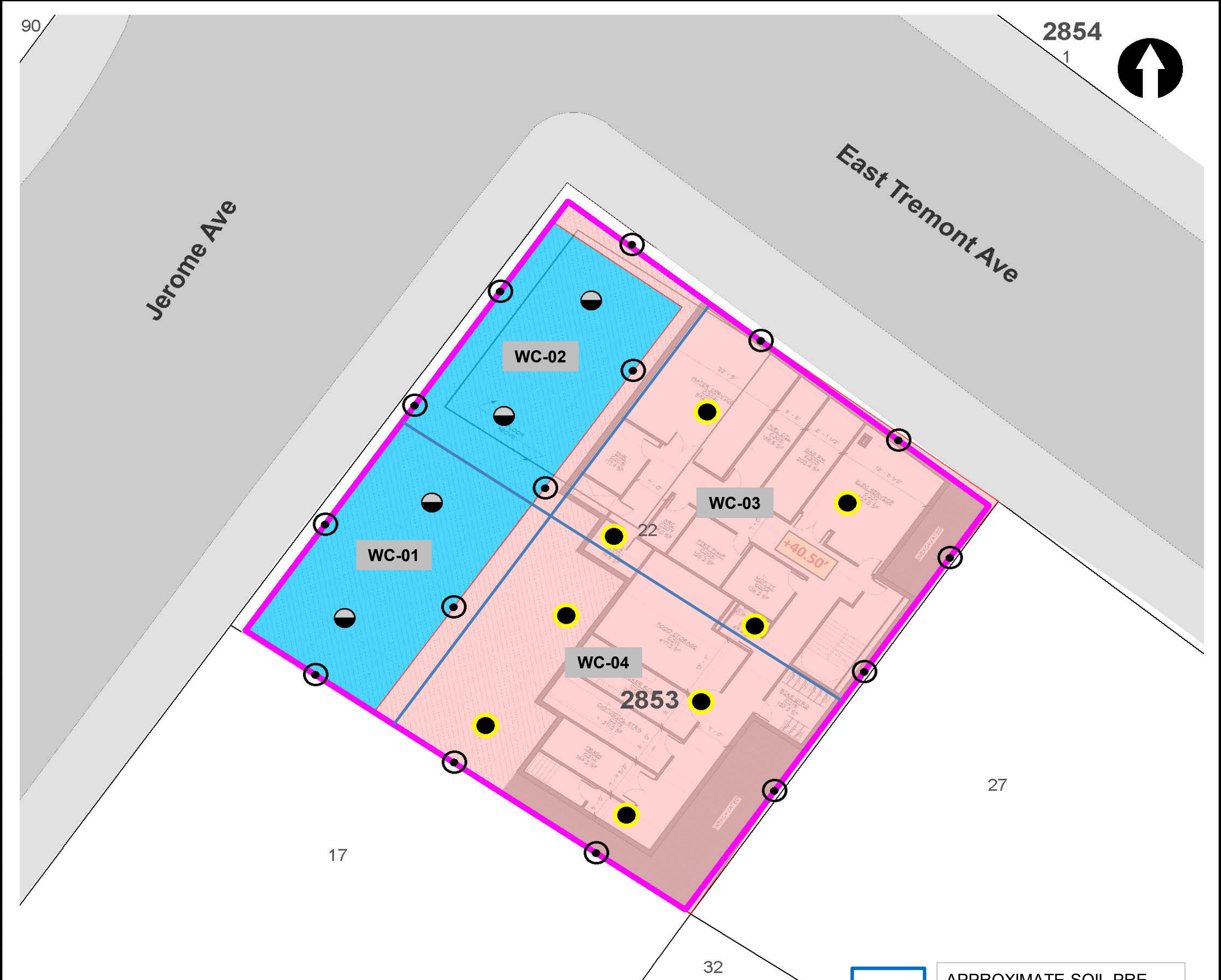

LEGEND

- PROJECT SITE BOUNDARY
- LOT BOUNDARY AND TAX LOT NUMBER
- 2853** BLOCK NUMBER
- REMEDIAL EXCAVATION TO APPROXIMATELY TWO FEET BELOW EXISTING GRADE
- REMEDIAL EXCAVATION TO GROUNDWATER (SOURCE AREA)

- CONFIRMATION DOCUMENTATION BOTTOM SAMPLE
- SOURCE AREA DOCUMENTATION BOTTOM SAMPLE
- DOCUMENTATION SIDEWALL SAMPLE

NOTE
 REMEDIAL EXCAVATION WILL INCLUDE REMOVAL OF APPROXIMATELY 1,280 TONS (850 CUBIC YARDS) OF SOURCE MATERIAL ASSOCIATED WITH NYSDEC SPILL NO. 2103719 AND APPROXIMATELY 860 TONS (570 CUBIC YARDS) OF SOIL/FILL FROM THE UPPER 2 FEET SITE-WIDE.



APPROXIMATE SOIL PRE-CHARACTERIZATION GRID

Map Source:
 NYCDOP (NYC Dept. of City Planning) GIS database

© 2021 AKRF. W:\Projects\210024 - 1956 JEROME AVENUE\Technical\GIS and Graphics\AR\RAW\210024 Figure 9 Proposed Remedial Excavation and Documentation Sample Location Plan.mxd 10/25/2021 2:03:38 PM iszalus



440 Park Avenue South, New York, NY 10016

1956 Jerome Avenue
 Bronx, New York

**TRACK 4 CLEANUP AND DOCUMENTATION
 SAMPLE LOCATION PLAN**

DATE
04/29/2022

PROJECT NO.
210024

FIGURE
11

Site Photographs

Photograph 1 -
Removal of
equipment from the
site, view facing
southwest.



Photograph 2 -
Excavating soil in grid
WC-02, view facing
northeast.



Photograph 3 -
Installation of
underpinnings in
Grid WC-03, view
facing east.



Upwind Station						
Time	Instaneous VOC (ppm)	Instaneous Mass Conc. Total (mg/m ³)	Mass Conc. Total mg/m ³ AVG 15m (mg/m ³)	Dust Exceedance	VOC ppm AVG 15m (ppm)	VOC Exceedance
2/14/23 7:11	0.026	0.055	0.055	No	0.026	No
2/14/23 7:12	0	0.011	0.033	No	0.013	No
2/14/23 7:13	0	0.012	0.026	No	0.0087	No
2/14/23 7:14	0	0.011	0.0223	No	0.0065	No
2/14/23 7:14		0.011		No		No
2/14/23 7:15	0			No	0.0052	No
2/14/23 7:16	0	0.015	0.0208	No	0.0043	No
2/14/23 7:17	0	0.026	0.0217	No	0.0037	No
2/14/23 7:18	0	0.011	0.0201	No	0.0033	No
2/14/23 7:19	0	0.011	0.019	No	0.0029	No
2/14/23 7:20	0	0.012	0.0182	No	0.0026	No
2/14/23 7:21	0	0.02	0.0184	No	0.0024	No
2/14/23 7:22	0	0.019	0.0185	No	0.0022	No
2/14/23 7:23	0	0.015	0.0182	No	0.002	No
2/14/23 7:24	0	0.014	0.0178	No	0.0019	No
2/14/23 7:25	0	0.013	0.0175	No	0.0017	No
2/14/23 7:26	0	0.017	0.0148	No	0	No
2/14/23 7:27	0	0.022	0.0156	No	0	No
2/14/23 7:28	0	0.013	0.0156	No	0	No
2/14/23 7:29	0	0.013	0.0158	No	0	No
2/14/23 7:30	0	0.018	0.0159	No	0	No
2/14/23 7:31	0	0.014	0.0159	No	0	No
2/14/23 7:32	0	0.017	0.0153	No	0	No
2/14/23 7:33	0	0.011	0.0153	No	0	No
2/14/23 7:34	0	0.01	0.0152	No	0	No
2/14/23 7:35	0	0.012	0.0152	No	0	No
2/14/23 7:36	0	0.017	0.015	No	0	No
2/14/23 7:37	0	0.022	0.0152	No	0	No
2/14/23 7:38	0	0.016	0.0153	No	0	No
2/14/23 7:39	0	0.02	0.0157	No	0	No
2/14/23 7:40	0	0.016	0.0159	No	0	No
2/14/23 7:41	0	0.016	0.0158	No	0	No
2/14/23 7:42	0	0.05	0.0177	No	0	No
2/14/23 7:43	0	0.015	0.0178	No	0	No
2/14/23 7:44	0	0.012	0.0177	No	0	No
2/14/23 7:45	0	0.014	0.0175	No	0	No
2/14/23 7:46	0	0.013	0.0174	No	0	No
2/14/23 7:47	0	0.02	0.0176	No	0	No
2/14/23 7:48	0.292	0.026	0.0186	No	0.0195	No
2/14/23 7:49	0.389	0.015	0.0189	No	0.0454	No
2/14/23 7:50	0.353	0.014	0.0191	No	0.0689	No
2/14/23 7:51	0.245	0.018	0.0191	No	0.0853	No
2/14/23 7:52	0.224	0.015	0.0187	No	0.1002	No
2/14/23 7:53	0.206	0.014	0.0185	No	0.1139	No
2/14/23 7:54	0.156	0.017	0.0183	No	0.1243	No
2/14/23 7:55	0.147	0.019	0.0185	No	0.1341	No
2/14/23 7:56	0.132	0.019	0.0187	No	0.1429	No
2/14/23 7:57	0.117	0.019	0.0167	No	0.1507	No
2/14/23 7:58	0.115	0.023	0.0172	No	0.1584	No
2/14/23 7:59	0.119	0.015	0.0174	No	0.1663	No
2/14/23 8:00	0.118	0.02	0.0178	No	0.1742	No
2/14/23 8:01	0.107	0.015	0.0179	No	0.1813	No

Upwind Station						
Time	Instaneous VOC (ppm)	Instaneous Mass Conc. Total (mg/m ³)	Mass Conc. Total mg/m ³ AVG 15m (mg/m ³)	Dust Exceedance	VOC ppm AVG 15m (ppm)	VOC Exceedance
2/14/23 8:02	0.099	0.013	0.0175	No	0.1879	No
2/14/23 8:03	0.112	0.018	0.0169	No	0.1759	No
2/14/23 8:04	0.113	0.094	0.0222	No	0.1575	No
2/14/23 8:05	0.109	0.032	0.0234	No	0.1413	No
2/14/23 8:06	0.105	0.022	0.0237	No	0.1319	No
2/14/23 8:07	0.1	0.189	0.0353	No	0.1237	No
2/14/23 8:08	0.093	0.032	0.0365	No	0.1161	No
2/14/23 8:09	0.089	0.017	0.0365	No	0.1117	No
2/14/23 8:10	0.084	0.04	0.0379	No	0.1075	No
2/14/23 8:11	0.092	0.045	0.0396	No	0.1048	No
2/14/23 8:12	0.091	0.051	0.0417	No	0.1031	No
2/14/23 8:13	0.092	0.032	0.0423	No	0.1015	No
2/14/23 8:14	0.091	0.02	0.0427	No	0.0997	No
2/14/23 8:15	0.084	0.014	0.0423	No	0.0974	No
2/14/23 8:16	0.082	0.028	0.0431	No	0.0957	No
2/14/23 8:17	0.084	0.018	0.0435	No	0.0947	No
2/14/23 8:18	0.076	0.015	0.0433	No	0.0923	No
2/14/23 8:19	0.081	0.019	0.0383	No	0.0902	No
2/14/23 8:20	0.074	0.029	0.0381	No	0.0879	No
2/14/23 8:21	0.061	0.025	0.0383	No	0.0849	No
2/14/23 8:22	0.056	0.016	0.0267	No	0.082	No
2/14/23 8:23	0.06	0.017	0.0257	No	0.0798	No
2/14/23 8:24	0.078	0.024	0.0262	No	0.0791	No
2/14/23 8:25	0.075	0.022	0.025	No	0.0785	No
2/14/23 8:26	0.079	0.018	0.0232	No	0.0776	No
2/14/23 8:27	0.087	0.012	0.0206	No	0.0773	No
2/14/23 8:28	0.088	0.014	0.0194	No	0.0771	No
2/14/23 8:29	0.099	0.013	0.0189	No	0.0776	No
2/14/23 8:30	0.094	0.02	0.0193	No	0.0783	No
2/14/23 8:31	0.113	0.016	0.0185	No	0.0803	No
2/14/23 8:32	0.115	0.014	0.0183	No	0.0824	No
2/14/23 8:33	0.109	0.017	0.0184	No	0.0846	No
2/14/23 8:34	0.123	0.02	0.0185	No	0.0874	No
2/14/23 8:35	0.12	0.013	0.0174	No	0.0905	No
2/14/23 8:36	0.125	0.012	0.0165	No	0.0947	No
2/14/23 8:37	0.125	0.014	0.0164	No	0.0993	No
2/14/23 8:38	0.137	0.013	0.0161	No	0.1045	No
2/14/23 8:39	0.145	0.014	0.0155	No	0.1089	No
2/14/23 8:40	0.14	0.013	0.0149	No	0.1133	No
2/14/23 8:41	0.148	0.012	0.0145	No	0.1179	No
2/14/23 8:42	0.159	0.011	0.0144	No	0.1227	No
2/14/23 8:43	0.159	0.015	0.0145	No	0.1274	No
2/14/23 8:44	0.154	0.012	0.0144	No	0.1311	No
2/14/23 8:45	0.15	0.012	0.0139	No	0.1348	No
2/14/23 8:46	0.167	0.012	0.0136	No	0.1384	No
2/14/23 8:47	0.165	0.013	0.0135	No	0.1417	No
2/14/23 8:48	0.167	0.012	0.0132	No	0.1456	No
2/14/23 8:49	0.181	0.013	0.0127	No	0.1495	No
2/14/23 8:50	0.174	0.012	0.0127	No	0.1531	No
2/14/23 8:51	0.178	0.017	0.013	No	0.1566	No
2/14/23 8:52	0.183	0.013	0.0129	No	0.1605	No
2/14/23 8:53	0.184	0.012	0.0129	No	0.1636	No

Upwind Station						
Time	Instaneous VOC (ppm)	Instaneous Mass Conc. Total (mg/m ³)	Mass Conc. Total mg/m ³ AVG 15m (mg/m ³)	Dust Exceedance	VOC ppm AVG 15m (ppm)	VOC Exceedance
2/14/23 8:54	0.194	0.012	0.0127	No	0.1669	No
2/14/23 8:55	0.203	0.011	0.0126	No	0.1711	No
2/14/23 8:56	0.2	0.011	0.0125	No	0.1745	No
2/14/23 8:57	0.206	0.011	0.0125	No	0.1777	No
2/14/23 8:58	0.206	0.012	0.0123	No	0.1808	No
2/14/23 8:59	0.212	0.012	0.0123	No	0.1847	No
2/14/23 9:00	0.195	0.016	0.0126	No	0.1877	No
2/14/23 9:01	0.205	0.014	0.0127	No	0.1902	No
2/14/23 9:02	0.213	0.015	0.0129	No	0.1934	No
2/14/23 9:03	0.213	0.024	0.0137	No	0.1965	No
2/14/23 9:04	0.214	0.018	0.014	No	0.1987	No
2/14/23 9:05	0.216	0.016	0.0143	No	0.2015	No
2/14/23 9:06	0.223	0.015	0.0141	No	0.2045	No
2/14/23 9:07	0.218	0.016	0.0143	No	0.2068	No
2/14/23 9:08	0.218	0.014	0.0145	No	0.2091	No
2/14/23 9:09	0.211	0.021	0.0151	No	0.2102	No
2/14/23 9:10	0.223	0.011	0.0151	No	0.2115	No
2/14/23 9:11	0.219	0.013	0.0152	No	0.2128	No
2/14/23 9:12	0.227	0.022	0.0159	No	0.2142	No
2/14/23 9:13	0.22	0.019	0.0164	No	0.2151	No
2/14/23 9:14	0.223	0.058	0.0195	No	0.2159	No
2/14/23 9:15	0.226	0.046	0.0215	No	0.2179	No
2/14/23 9:16	0.228	0.04	0.0232	No	0.2195	No
2/14/23 9:17	0.234	0.048	0.0254	No	0.2209	No
2/14/23 9:18	0.237	0.035	0.0261	No	0.2225	No
2/14/23 9:19	0.242	0.015	0.0259	No	0.2243	No
2/14/23 9:20	0.24	0.024	0.0265	No	0.2259	No
2/14/23 9:21	0.25	0.089	0.0314	No	0.2277	No
2/14/23 9:22	0.254	0.063	0.0345	No	0.2301	No
2/14/23 9:23	0.259	0.051	0.037	No	0.2329	No
2/14/23 9:24	0.254	0.037	0.0381	No	0.2357	No
2/14/23 9:25	0.254	0.018	0.0385	No	0.2378	No
2/14/23 9:26	0.282	0.035	0.04	No	0.242	No
2/14/23 9:27	0.263	0.052	0.042	No	0.2444	No
2/14/23 9:28	0.255	0.026	0.0425	No	0.2467	No
2/14/23 9:29	0.266	0.037	0.0411	No	0.2496	No
2/14/23 9:30	0.272	0.016	0.0391	No	0.2527	No
2/14/23 9:31	0.269	0.018	0.0376	No	0.2554	No
2/14/23 9:32	0.275	0.019	0.0357	No	0.2581	No
2/14/23 9:33	0.272	0.021	0.0347	No	0.2605	No
2/14/23 9:34	0.276	0.019	0.035	No	0.2627	No
2/14/23 9:35	0.274	0.013	0.0343	No	0.265	No
2/14/23 9:36	0.278	0.018	0.0295	No	0.2669	No
2/14/23 9:37	0.277	0.016	0.0264	No	0.2684	No
2/14/23 9:38	0.286	0.017	0.0241	No	0.2702	No
2/14/23 9:39	0.304	0.014	0.0226	No	0.2735	No
2/14/23 9:40	0.284	0.018	0.0226	No	0.2755	No
2/14/23 9:41	0.289	0.019	0.0215	No	0.276	No
2/14/23 9:42	0.29	0.018	0.0193	No	0.2778	No
2/14/23 9:43	0.286	0.016	0.0186	No	0.2799	No
2/14/23 9:44	0.294	0.018	0.0173	No	0.2817	No
2/14/23 9:45	0.295	0.016	0.0173	No	0.2833	No

Upwind Station

Time	Instaneous VOC (ppm)	Instaneous Mass Conc. Total (mg/m ³)	Mass Conc. Total mg/m ³ AVG 15m (mg/m ³)	Dust Exceedance	VOC ppm AVG 15m (ppm)	VOC Exceedance
2/14/23 9:46	0.291	0.025	0.0178	No	0.2847	No
2/14/23 9:47	0.288	0.019	0.0178	No	0.2856	No
2/14/23 9:48	0.295	0.014	0.0173	No	0.2871	No
2/14/23 9:49	0.294	0.022	0.0175	No	0.2883	No
2/14/23 9:50	0.297	0.058	0.0205	No	0.2899	No
2/14/23 9:51	0.297	0.026	0.0211	No	0.2911	No
2/14/23 9:52	0.289	0.018	0.0212	No	0.2919	No
2/14/23 9:53	0.29	0.013	0.0209	No	0.2922	No
2/14/23 9:54	0.296	0.012	0.0208	No	0.2917	No
2/14/23 9:55	0.293	0.024	0.0212	No	0.2923	No
2/14/23 9:56	0.301	0.016	0.021	No	0.2931	No
2/14/23 9:57	0.288	0.018	0.021	No	0.2929	No
2/14/23 9:58	0.293	0.017	0.0211	No	0.2934	No
2/14/23 9:59	0.288	0.036	0.0223	No	0.293	No
2/14/23 10:00	0.277	0.018	0.0224	No	0.2918	No
2/14/23 10:01	0.285	0.03	0.0227	No	0.2914	No
2/14/23 10:02	0.289	0.083	0.027	No	0.2915	No
2/14/23 10:03	0.29	0.028	0.0279	No	0.2911	No
2/14/23 10:04	0.28	0.067	0.0309	No	0.2902	No
2/14/23 10:05	0.284	0.018	0.0283	No	0.2893	No
2/14/23 10:06	0.284	0.01	0.0272	No	0.2885	No
2/14/23 10:07	0.294	0.016	0.0271	No	0.2888	No
2/14/23 10:08	0.286	0.023	0.0277	No	0.2885	No
2/14/23 10:09	0.287	0.017	0.0281	No	0.2879	No
2/14/23 10:10	0.277	0.02	0.0278	No	0.2869	No
2/14/23 10:11	0.274	0.03	0.0287	No	0.2851	No
2/14/23 10:12	0.269	0.059	0.0315	No	0.2838	No
2/14/23 10:13	0.269	0.059	0.0343	No	0.2822	No
2/14/23 10:14	0.267	0.021	0.0333	No	0.2808	No
2/14/23 10:15	0.263	0.015	0.0331	No	0.2799	No
2/14/23 10:16	0.269	0.007	0.0315	No	0.2788	No
2/14/23 10:17	0.274	0.01	0.0267	No	0.2778	No
2/14/23 10:18	0.276	0.023	0.0263	No	0.2769	No
2/14/23 10:19	0.275	0.028	0.0237	No	0.2765	No
2/14/23 10:20	0.275	0.057	0.0263	No	0.2759	No
2/14/23 10:21	0.279	0.017	0.0268	No	0.2756	No
2/14/23 10:22	0.28	0.017	0.0269	No	0.2747	No
2/14/23 10:23	0.285	0.039	0.0279	No	0.2746	No
2/14/23 10:24	0.289	0.024	0.0284	No	0.2747	No
2/14/23 10:25	0.282	0.02	0.0284	No	0.2751	No
2/14/23 10:26	0.277	0.022	0.0279	No	0.2753	No
2/14/23 10:27	0.276	0.016	0.025	No	0.2757	No
2/14/23 10:28	0.283	0.058	0.0249	No	0.2767	No
2/14/23 10:29	0.289	0.028	0.0254	No	0.2781	No
2/14/23 10:30	0.271	0.032	0.0265	No	0.2787	No
2/14/23 10:31	0.27	0.019	0.0273	No	0.2787	No
2/14/23 10:32	0.27	0.012	0.0275	No	0.2785	No
2/14/23 10:33	0.283	0.008	0.0265	No	0.2789	No
2/14/23 10:34	0.286	0.01	0.0253	No	0.2797	No
2/14/23 10:35	0.283	0.025	0.0231	No	0.2802	No
2/14/23 10:36	0.288	0.026	0.0237	No	0.2808	No
2/14/23 10:37	0.28	0.033	0.0248	No	0.2808	No

Upwind Station						
Time	Instaneous VOC (ppm)	Instaneous Mass Conc. Total (mg/m ³)	Mass Conc. Total mg/m ³ AVG 15m (mg/m ³)	Dust Exceedance	VOC ppm AVG 15m (ppm)	VOC Exceedance
2/14/23 10:38	0.287	0.032	0.0243	No	0.2809	No
2/14/23 10:39	0.294	0.034	0.025	No	0.2813	No
2/14/23 10:40	0.285	0.023	0.0252	No	0.2815	No
2/14/23 10:41	0.299	0.013	0.0246	No	0.2829	No
2/14/23 10:42	0.288	0.012	0.0243	No	0.2837	No
2/14/23 10:43	0.286	0.015	0.0215	No	0.2839	No
2/14/23 10:44	0.288	0.012	0.0204	No	0.2839	No
2/14/23 10:45	0.291	0.019	0.0195	No	0.2852	No
2/14/23 10:46	0.284	0.013	0.0191	No	0.2861	No
2/14/23 10:47	0.272	0.031	0.0204	No	0.2863	No
2/14/23 10:48	0.278	0.012	0.0207	No	0.2859	No
2/14/23 10:49	0.285	0.015	0.021	No	0.2859	No
2/14/23 10:50	0.282	0.033	0.0215	No	0.2858	No
2/14/23 10:51	0.278	0.104	0.0267	No	0.2851	No
2/14/23 10:52	0.281	0.016	0.0256	No	0.2852	No
2/14/23 10:53	0.271	0.089	0.0294	No	0.2841	No
2/14/23 10:54	0.278	0.055	0.0308	No	0.2831	No
2/14/23 10:55	0.287	0.011	0.03	No	0.2832	No
2/14/23 10:56	0.294	0.007	0.0296	No	0.2829	No
2/14/23 10:57	0.302	0.006	0.0292	No	0.2838	No
2/14/23 10:58	0.302	0.014	0.0291	No	0.2849	No
2/14/23 10:59	0.308	0.1	0.035	No	0.2862	No
2/14/23 11:00	0.311	0.37	0.0584	No	0.2875	No
2/14/23 11:01	0.305	0.011	0.0583	No	0.2889	No
2/14/23 11:02	0.317	0.015	0.0572	No	0.2919	No
2/14/23 11:03	0.295	0.011	0.0571	No	0.2931	No
2/14/23 11:04	0.295	0.017	0.0573	No	0.2937	No
2/14/23 11:05	0.298	0.013	0.0559	No	0.2948	No
2/14/23 11:06	0.306	0.007	0.0495	No	0.2967	No
2/14/23 11:07	0.306	0.027	0.0502	No	0.2983	No
2/14/23 11:08	0.302	0.019	0.0455	No	0.3004	No
2/14/23 11:09	0.301	0.018	0.0431	No	0.3019	No
2/14/23 11:10	0.302	0.009	0.0429	No	0.3029	No
2/14/23 11:11	0.302	0.007	0.0429	No	0.3035	No
2/14/23 11:12	0.302	0.01	0.0432	No	0.3035	No
2/14/23 11:13	0.295	0.01	0.0429	No	0.303	No
2/14/23 11:14	0.294	0.011	0.037	No	0.3021	No
2/14/23 11:15	0.304	0.007	0.0128	No	0.3016	No
2/14/23 11:16	0.31	0.01	0.0127	No	0.3019	No
2/14/23 11:17	0.317	0.013	0.0126	No	0.3019	No
2/14/23 11:18	0.321	0.008	0.0124	No	0.3037	No
2/14/23 11:19	0.331	0.007	0.0117	No	0.3061	No
2/14/23 11:20	0.332	0.011	0.0116	No	0.3083	No
2/14/23 11:21	0.331	0.009	0.0117	No	0.31	No
2/14/23 11:22	0.334	0.006	0.0103	No	0.3119	No
2/14/23 11:23	0.337	0.008	0.0096	No	0.3142	No
2/14/23 11:24	0.329	0.008	0.0089	No	0.3161	No
2/14/23 11:25	0.342	0.006	0.0087	No	0.3187	No
2/14/23 11:26	0.332	0.009	0.0089	No	0.3207	No
2/14/23 11:27	0.333	0.006	0.0086	No	0.3228	No
2/14/23 11:28	0.333	0.009	0.0085	No	0.3253	No
2/14/23 11:29	0.331	0.009	0.0084	No	0.3278	No

Upwind Station

Time	Instantaneous VOC (ppm)	Instantaneous Mass Conc. Total (mg/m ³)	Mass Conc. Total mg/m ³ AVG 15m (mg/m ³)	Dust Exceedance	VOC ppm AVG 15m (ppm)	VOC Exceedance
2/14/23 11:30	0.332	0.01	0.0086	No	0.3297	No
2/14/23 11:31	0.336	0.014	0.0089	No	0.3314	No
2/14/23 11:32	0.324	0.018	0.0092	No	0.3319	No
2/14/23 11:33	0.329	0.009	0.0093	No	0.3324	No
2/14/23 11:34	0.324	0.015	0.0098	No	0.3319	No
2/14/23 11:35	0.299	0.01	0.0097	No	0.3297	No
2/14/23 11:36	0.301	0.01	0.0098	No	0.3277	No
2/14/23 11:37	0.296	0.006	0.0098	No	0.3252	No
2/14/23 11:38	0.308	0.008	0.0098	No	0.3233	No
2/14/23 11:39	0.306	0.014	0.0102	No	0.3217	No
2/14/23 11:40	0.306	0.014	0.0107	No	0.3193	No
2/14/23 11:41	0.31	0.011	0.0109	No	0.3179	No
2/14/23 11:42	0.307	0.009	0.0111	No	0.3161	No
2/14/23 11:43	0.309	0.025	0.0121	No	0.3145	No
2/14/23 11:44	0.309	0.014	0.0125	No	0.3131	No
2/14/23 11:45	0.304	0.013	0.0127	No	0.3112	No
2/14/23 11:46	0.305	0.008	0.0123	No	0.3091	No
2/14/23 11:47	0.306	0.009	0.0117	No	0.3079	No
2/14/23 11:48	0.316	0.01	0.0117	No	0.3071	No
2/14/23 11:49	0.317	0.02	0.0121	No	0.3066	No
2/14/23 11:50	0.321	0.016	0.0125	No	0.3081	No
2/14/23 11:51	0.32	0.022	0.0133	No	0.3093	No
2/14/23 11:52	0.326	0.01	0.0135	No	0.3113	No
2/14/23 11:53	0.327	0.011	0.0137	No	0.3126	No
2/14/23 11:54	0.32	0.02	0.0141	No	0.3135	No
2/14/23 11:55	0.313	0.017	0.0143	No	0.314	No
2/14/23 11:56	0.308	0.016	0.0147	No	0.3139	No
2/14/23 11:57	0.319	0.012	0.0149	No	0.3147	No
2/14/23 11:58	0.321	0.012	0.014	No	0.3155	No
2/14/23 11:59	0.32	0.016	0.0141	No	0.3162	No
2/14/23 12:00	0.315	0.009	0.0139	No	0.3169	No
2/14/23 12:01	0.319	0.012	0.0141	No	0.3179	No
2/14/23 12:02	0.319	0.009	0.0141	No	0.3187	No
2/14/23 12:03	0.326	0.007	0.0139	No	0.3194	No
2/14/23 12:04	0.333	0.014	0.0135	No	0.3205	No
2/14/23 12:05	0.336	0.005	0.0128	No	0.3215	No
2/14/23 12:06	0.34	0.014	0.0123	No	0.3228	No
2/14/23 12:07	0.346	0.011	0.0123	No	0.3241	No
2/14/23 12:08	0.344	0.012	0.0124	No	0.3253	No
2/14/23 12:09	0.344	0.014	0.012	No	0.3269	No
2/14/23 12:10	0.332	0.007	0.0113	No	0.3281	No
2/14/23 12:11	0.339	0.009	0.0109	No	0.3302	No
2/14/23 12:12	0.331	0.01	0.0107	No	0.331	No
2/14/23 12:13	0.336	0.008	0.0105	No	0.332	No
2/14/23 12:14	0.338	0.01	0.0101	No	0.3332	No
2/14/23 12:15	0.336	0.011	0.0102	No	0.3346	No
2/14/23 12:16	0.338	0.008	0.0099	No	0.3359	No
2/14/23 12:17	0.34	0.008	0.0099	No	0.3373	No
2/14/23 12:18	0.341	0.012	0.0102	No	0.3383	No
2/14/23 12:19	0.356	0.008	0.0098	No	0.3398	No
2/14/23 12:20	0.349	0.006	0.0099	No	0.3407	No
2/14/23 12:21	0.352	0.007	0.0094	No	0.3415	No

Upwind Station

Time	Instantaneous VOC (ppm)	Instantaneous Mass Conc. Total (mg/m ³)	Mass Conc. Total mg/m ³ AVG 15m (mg/m ³)	Dust Exceedance	VOC ppm AVG 15m (ppm)	VOC Exceedance
2/14/23 12:22	0.358	0.008	0.0092	No	0.3423	No
2/14/23 12:23	0.348	0.009	0.009	No	0.3425	No
2/14/23 12:24	0.35	0.014	0.009	No	0.3429	No
2/14/23 12:25	0.34	0.006	0.0089	No	0.3435	No
2/14/23 12:26	0.356	0.009	0.0089	No	0.3446	No
2/14/23 12:27	0.347	0.011	0.009	No	0.3457	No
2/14/23 12:28	0.351	0.007	0.0089	No	0.3467	No
2/14/23 12:29	0.358	0.011	0.009	No	0.348	No
2/14/23 12:30	0.362	0.01	0.0089	No	0.3497	No
2/14/23 12:31	0.362	0.005	0.0087	No	0.3513	No
2/14/23 12:32	0.355	0.011	0.0089	No	0.3523	No
2/14/23 12:33	0.346	0.024	0.0097	No	0.3527	No
2/14/23 12:34	0.339	0.008	0.0097	No	0.3515	No
2/14/23 12:35	0.332	0.006	0.0097	No	0.3504	No
2/14/23 12:36	0.346	0.008	0.0098	No	0.35	No
2/14/23 12:37	0.347	0.009	0.0099	No	0.3493	No
2/14/23 12:38	0.355	0.02	0.0106	No	0.3497	No
2/14/23 12:39	0.354	0.012	0.0105	No	0.35	No
2/14/23 12:40	0.36	0.013	0.0109	No	0.3513	No
2/14/23 12:41	0.354	0.007	0.0108	No	0.3512	No
2/14/23 12:42	0.367	0.006	0.0105	No	0.3525	No
2/14/23 12:43	0.36	0.008	0.0105	No	0.3531	No
2/14/23 12:44	0.362	0.011	0.0105	No	0.3534	No
2/14/23 12:45	0.367	0.01	0.0105	No	0.3537	No
2/14/23 12:46	0.378	0.005	0.0105	No	0.3548	No
2/14/23 12:47	0.372	0.01	0.0105	No	0.3559	No
2/14/23 12:48	0.372	0.008	0.0094	No	0.3577	No
2/14/23 12:49	0.362	0.011	0.0096	No	0.3592	No
2/14/23 12:50	0.365	0.009	0.0098	No	0.3614	No
2/14/23 12:51	0.36	0.011	0.01	No	0.3623	No
2/14/23 12:52	0.353	0.024	0.011	No	0.3627	No
2/14/23 12:53	0.362	0.011	0.0104	No	0.3632	No
2/14/23 12:54	0.358	0.019	0.0109	No	0.3635	No
2/14/23 12:55	0.368	0.006	0.0104	No	0.364	No
2/14/23 12:56	0.374	0.008	0.0105	No	0.3653	No
2/14/23 12:57	0.376	0.007	0.0105	No	0.3659	No
2/14/23 12:58	0.373	0.025	0.0117	No	0.3668	No
2/14/23 12:59	0.377	0.007	0.0114	No	0.3678	No
2/14/23 13:00	0.375	0.008	0.0113	No	0.3683	No
2/14/23 13:01	0.375	0.008	0.0115	No	0.3681	No
2/14/23 13:02	0.381	0.019	0.0121	No	0.3687	No
2/14/23 13:03	0.392	0.011	0.0123	No	0.3701	No
2/14/23 13:04	0.39	0.007	0.012	No	0.3719	No
2/14/23 13:05	0.39	0.01	0.0121	No	0.3736	No
2/14/23 13:06	0.396	0.011	0.0121	No	0.376	No
2/14/23 13:07	0.397	0.014	0.0114	No	0.3789	No
2/14/23 13:08	0.404	0.006	0.0111	No	0.3817	No
2/14/23 13:09	0.4	0.01	0.0105	No	0.3845	No
2/14/23 13:10	0.396	0.009	0.0107	No	0.3864	No
2/14/23 13:11	0.4	0.005	0.0105	No	0.3881	No
2/14/23 13:12	0.398	0.006	0.0104	No	0.3896	No
2/14/23 13:13	0.408	0.008	0.0093	No	0.3919	No

Upwind Station						
Time	Instaneous VOC (ppm)	Instaneous Mass Conc. Total (mg/m ³)	Mass Conc. Total mg/m ³ AVG 15m (mg/m ³)	Dust Exceedance	VOC ppm AVG 15m (ppm)	VOC Exceedance
2/14/23 13:14	0.403	0.007	0.0093	No	0.3937	No
2/14/23 13:15	0.406	0.009	0.0093	No	0.3957	No
2/14/23 13:16	0.415	0.006	0.0092	No	0.3984	No
2/14/23 13:17	0.405	0.01	0.0086	No	0.4	No
2/14/23 13:18	0.415	0.014	0.0088	No	0.4015	No
2/14/23 13:19	0.41	0.006	0.0087	No	0.4029	No
2/14/23 13:20	0.416	0.009	0.0087	No	0.4046	No
2/14/23 13:21	0.428	0.008	0.0085	No	0.4067	No
2/14/23 13:22	0.422	0.01	0.0082	No	0.4084	No
2/14/23 13:23	0.429	0.009	0.0084	No	0.4101	No
2/14/23 13:24	0.429	0.007	0.0082	No	0.412	No
2/14/23 13:25	0.432	0.005	0.0079	No	0.4144	No
2/14/23 13:26	0.424	0.006	0.008	No	0.416	No
2/14/23 13:27	0.426	0.006	0.008	No	0.4179	No
2/14/23 13:28	0.427	0.008	0.008	No	0.4191	No
2/14/23 13:29	0.425	0.008	0.0081	No	0.4206	No
2/14/23 13:30	0.432	0.007	0.0079	No	0.4223	No
2/14/23 13:31	0.428	0.006	0.0079	No	0.4232	No
2/14/23 13:32	0.43	0.005	0.0076	No	0.4249	No
2/14/23 13:33	0.432	0.006	0.0071	No	0.426	No
2/14/23 13:34	0.436	0.007	0.0071	No	0.4277	No
2/14/23 13:35	0.422	0.007	0.007	No	0.4281	No
2/14/23 13:36	0.43	0.01	0.0071	No	0.4283	No
2/14/23 13:37	0.434	0.007	0.0069	No	0.4291	No
2/14/23 13:38	0.428	0.009	0.0069	No	0.429	No
2/14/23 13:39	0.436	0.011	0.0072	No	0.4295	No
2/14/23 13:40	0.434	0.066	0.0113	No	0.4296	No
2/14/23 13:41	0.433	0.011	0.0116	No	0.4302	No
2/14/23 13:42	0.433	0.013	0.0121	No	0.4307	No
2/14/23 13:43	0.438	0.01	0.0122	No	0.4314	No
2/14/23 13:44	0.433	0.008	0.0122	No	0.4319	No
2/14/23 13:45	0.434	0.008	0.0123	No	0.4321	No
2/14/23 13:46	0.434	0.01	0.0125	No	0.4325	No
2/14/23 13:47	0.442	0.014	0.0131	No	0.4333	No
2/14/23 13:48	0.434	0.012	0.0135	No	0.4334	No
2/14/23 13:49	0.421	0.013	0.0139	No	0.4324	No
2/14/23 13:50	0.434	0.011	0.0142	No	0.4332	No
2/14/23 13:51	0.438	0.011	0.0143	No	0.4337	No
2/14/23 13:52	0.44	0.013	0.0147	No	0.4341	No
2/14/23 13:53	0.426	0.013	0.0149	No	0.434	No
2/14/23 13:54	0.42	0.009	0.0148	No	0.4329	No
2/14/23 13:55	0.421	0.011	0.0111	No	0.4321	No
2/14/23 13:56	0.421	0.017	0.0115	No	0.4313	No
2/14/23 13:57	0.433	0.01	0.0113	No	0.4313	No
2/14/23 13:58	0.438	0.01	0.0113	No	0.4313	No
2/14/23 13:59	0.444	0.01	0.0115	No	0.432	No
2/14/23 14:00	0.427	0.009	0.0115	No	0.4315	No
2/14/23 14:01	0.429	0.008	0.0114	No	0.4312	No
2/14/23 14:02	0.433	0.014	0.0114	No	0.4306	No
2/14/23 14:03	0.433	0.01	0.0113	No	0.4305	No
2/14/23 14:04	0.428	0.007	0.0109	No	0.431	No
2/14/23 14:05	0.421	0.007	0.0106	No	0.4301	No

Upwind Station						
Time	Instaneous VOC (ppm)	Instaneous Mass Conc. Total (mg/m ³)	Mass Conc. Total mg/m ³ AVG 15m (mg/m ³)	Dust Exceedance	VOC ppm AVG 15m (ppm)	VOC Exceedance
2/14/23 14:06	0.418	0.017	0.011	No	0.4288	No
2/14/23 14:07	0.424	0.012	0.0109	No	0.4277	No
2/14/23 14:08	0.435	0.008	0.0106	No	0.4283	No
2/14/23 14:09	0.421	0.014	0.0109	No	0.4284	No
2/14/23 14:10	0.422	0.012	0.011	No	0.4285	No
2/14/23 14:11	0.418	0.012	0.0107	No	0.4283	No
2/14/23 14:12	0.411	0.014	0.0109	No	0.4268	No
2/14/23 14:13	0.413	0.007	0.0107	No	0.4251	No
2/14/23 14:14	0.41	0.006	0.0105	No	0.4229	No
2/14/23 14:15	0.407	0.008	0.0104	No	0.4215	No
2/14/23 14:16	0.402	0.008	0.0104	No	0.4197	No
2/14/23 14:17	0.399	0.008	0.01	No	0.4175	No
2/14/23 14:18	0.416	0.009	0.0099	No	0.4163	No
2/14/23 14:19	0.43	0.009	0.0101	No	0.4165	No
2/14/23 14:20	0.418	0.008	0.0101	No	0.4163	No
2/14/23 14:21	0.418	0.011	0.0097	No	0.4163	No
2/14/23 14:22	0.418	0.007	0.0094	No	0.4159	No
2/14/23 14:23	0.416	0.008	0.0094	No	0.4146	No
2/14/23 14:24	0.423	0.007	0.0089	No	0.4147	No
2/14/23 14:25	0.415	0.007	0.0086	No	0.4143	No
2/14/23 14:26	0.423	0.01	0.0085	No	0.4146	No
2/14/23 14:27	0.42	0.007	0.008	No	0.4152	No
2/14/23 14:28	0.42	0.037	0.01	No	0.4157	No
2/14/23 14:29	0.42	0.012	0.0104	No	0.4163	No
2/14/23 14:30	0.412	0.019	0.0111	No	0.4167	No
2/14/23 14:31	0.415	0.008	0.0111	No	0.4175	No
2/14/23 14:32	0.412	0.006	0.011	No	0.4184	No
2/14/23 14:33	0.419	0.042	0.0132	No	0.4186	No
2/14/23 14:34	0.417	0.049	0.0159	No	0.4177	No
2/14/23 14:35	0.413	0.196	0.0284	No	0.4174	No
2/14/23 14:36	0.407	0.023	0.0292	No	0.4167	No
2/14/23 14:37	0.403	0.016	0.0298	No	0.4157	No
2/14/23 14:38	0.404	0.031	0.0313	No	0.4149	No
2/14/23 14:39	0.411	0.035	0.0332	No	0.4141	No
2/14/23 14:40	0.414	0.017	0.0339	No	0.414	No
2/14/23 14:41	0.397	0.009	0.0338	No	0.4123	No
2/14/23 14:42	0.393	0.02	0.0347	No	0.4105	No
2/14/23 14:43	0.393	0.072	0.037	No	0.4087	No
2/14/23 14:44	0.39	0.041	0.0389	No	0.4067	No
2/14/23 14:45	0.389	0.042	0.0405	No	0.4051	No
2/14/23 14:46	0.38	0.033	0.0421	No	0.4028	No
2/14/23 14:47	0.375	0.013	0.0426	No	0.4003	No
2/14/23 14:48	0.376	0.123	0.048	No	0.3975	No
2/14/23 14:49	0.364	0.272	0.0629	No	0.3939	No
2/14/23 14:50	0.349	0.029	0.0517	No	0.3897	No
2/14/23 14:51	0.346	0.013	0.0511	No	0.3856	No
2/14/23 14:52	0.351	0.007	0.0505	No	0.3821	No
2/14/23 14:53	0.351	0.011	0.0491	No	0.3786	No

Downwind Station						
Time	Instaneous VOC (ppm)	Instaneous Mass Conc. Total (mg/m ³)	Mass Conc. Total mg/m ³ AVG 15m (mg/m ³)	Dust Exceedance	VOC ppm AVG 15m (ppm)	VOC Exceedance
2/14/2023 7:07	0.024	0.042	0.042	No	0.024	No
2/14/2023 7:08	0.003	0.003	0.0225	No	0.0135	No
2/14/2023 7:09	0	0.003	0.016	No	0.009	No
2/14/2023 7:10	0	0.002	0.0125	No	0.0068	No
2/14/2023 7:11	0	0.002	0.0104	No	0.0054	No
2/14/2023 7:12	0	0.002	0.009	No	0.0045	No
2/14/2023 7:13	0	0.005	0.0084	No	0.0039	No
2/14/2023 7:14	0	0.003	0.0078	No	0.0034	No
2/14/2023 7:15	0	0.002	0.0071	No	0.003	No
2/14/2023 7:16	0	0.002	0.0066	No	0.0027	No
2/14/2023 7:17	0	0.002	0.0062	No	0.0025	No
2/14/2023 7:18	0	0.003	0.0059	No	0.0023	No
2/14/2023 7:19	0	0.003	0.0057	No	0.0021	No
2/14/2023 7:20	0	0.003	0.0055	No	0.0019	No
2/14/2023 7:21	0.002	0.004	0.0054	No	0.0019	No
2/14/2023 7:22	0.01	0.006	0.003	No	0.001	No
2/14/2023 7:23	0	0.016	0.0039	No	0.0008	No
2/14/2023 7:24	0.003	0.008	0.0042	No	0.001	No
2/14/2023 7:25	0.005	0.006	0.0045	No	0.0013	No
2/14/2023 7:26	0.003	0.007	0.0048	No	0.0015	No
2/14/2023 7:27	0.017	0.013	0.0055	No	0.0027	No
2/14/2023 7:28	0.01	0.015	0.0062	No	0.0033	No
2/14/2023 7:29	0.007	0.009	0.0066	No	0.0038	No
2/14/2023 7:30	0.013	0.005	0.0068	No	0.0047	No
2/14/2023 7:31	0.018	0.006	0.0071	No	0.0059	No
2/14/2023 7:32	0.016	0.005	0.0073	No	0.0069	No
2/14/2023 7:33	0.017	0.004	0.0073	No	0.0081	No
2/14/2023 7:34	0.021	0.004	0.0074	No	0.0095	No
2/14/2023 7:35	0.023	0.004	0.0075	No	0.011	No
2/14/2023 7:36	0.038	0.01	0.0079	No	0.0134	No
2/14/2023 7:37	0.028	0.006	0.0079	No	0.0146	No
2/14/2023 7:38	0.028	0.005	0.0071	No	0.0165	No
2/14/2023 7:39	0.033	0.006	0.007	No	0.0185	No
2/14/2023 7:40	0.032	0.007	0.0071	No	0.0203	No
2/14/2023 7:41	0.041	0.018	0.0078	No	0.0228	No
2/14/2023 7:42	0.033	0.013	0.0078	No	0.0239	No
2/14/2023 7:43	0.039	0.008	0.0073	No	0.0258	No
2/14/2023 7:44	0.033	0.007	0.0072	No	0.0275	No
2/14/2023 7:45	0.038	0.009	0.0075	No	0.0292	No
2/14/2023 7:46	0.042	0.008	0.0076	No	0.0308	No
2/14/2023 7:47	0.042	0.006	0.0077	No	0.0325	No
2/14/2023 7:48	0.042	0.006	0.0078	No	0.0342	No
2/14/2023 7:49	0.044	0.005	0.0079	No	0.0357	No
2/14/2023 7:50	0.046	0.007	0.0081	No	0.0373	No
2/14/2023 7:51	0.095	0.007	0.0079	No	0.0411	No
2/14/2023 7:52	0.059	0.008	0.008	No	0.0431	No
2/14/2023 7:53	0.136	0.007	0.0081	No	0.0503	No
2/14/2023 7:54	0.096	0.007	0.0082	No	0.0545	No
2/14/2023 7:55	0.093	0.007	0.0082	No	0.0586	No
2/14/2023 7:56	0.067	0.009	0.0076	No	0.0603	No
2/14/2023 7:57	0.066	0.008	0.0073	No	0.0625	No
2/14/2023 7:58	0.07	0.009	0.0073	No	0.0646	No
2/14/2023 7:59	0.062	0.009	0.0075	No	0.0665	No
2/14/2023 8:00	0.06	0.008	0.0074	No	0.068	No

Downwind Station						
Time	Instaneous VOC (ppm)	Instaneous Mass Conc. Total (mg/m ³)	Mass Conc. Total mg/m ³ AVG 15m (mg/m ³)	Dust Exceedance	VOC ppm AVG 15m (ppm)	VOC Exceedance
2/14/2023 8:01	0.067	0.009	0.0075	No	0.0697	No
2/14/2023 8:02	0.067	0.017	0.0082	No	0.0713	No
2/14/2023 8:03	0.114	0.012	0.0086	No	0.0761	No
2/14/2023 8:04	0.126	0.013	0.0091	No	0.0816	No
2/14/2023 8:05	0.158	0.02	0.01	No	0.0891	No
2/14/2023 8:06	0.117	0.03	0.0115	No	0.0905	No
2/14/2023 8:07	0.098	0.029	0.0129	No	0.0931	No
2/14/2023 8:08	0.098	0.022	0.0139	No	0.0906	No
2/14/2023 8:09	0.171	0.019	0.0147	No	0.0956	No
2/14/2023 8:10	0.148	0.012	0.0151	No	0.0993	No
2/14/2023 8:11	0.127	0.013	0.0153	No	0.1033	No
2/14/2023 8:12	0.129	0.015	0.0158	No	0.1075	No
2/14/2023 8:13	0.121	0.016	0.0163	No	0.1109	No
2/14/2023 8:14	0.109	0.015	0.0167	No	0.114	No
2/14/2023 8:15	0.117	0.016	0.0172	No	0.1178	No
2/14/2023 8:16	0.115	0.015	0.0176	No	0.121	No
2/14/2023 8:17	0.104	0.014	0.0174	No	0.1235	No
2/14/2023 8:18	0.109	0.012	0.0174	No	0.1231	No
2/14/2023 8:19	0.118	0.013	0.0174	No	0.1226	No
2/14/2023 8:20	0.143	0.016	0.0171	No	0.1216	No
2/14/2023 8:21	0.114	0.017	0.0163	No	0.1214	No
2/14/2023 8:22	0.176	0.016	0.0154	No	0.1266	No
2/14/2023 8:23	0.178	0.018	0.0151	No	0.1319	No
2/14/2023 8:24	0.223	0.033	0.0161	No	0.1354	No
2/14/2023 8:25	0.298	0.013	0.0161	No	0.1454	No
2/14/2023 8:26	0.297	0.016	0.0163	No	0.1567	No
2/14/2023 8:27	0.381	0.01	0.016	No	0.1735	No
2/14/2023 8:28	0.29	0.008	0.0155	No	0.1848	No
2/14/2023 8:29	0.27	0.009	0.0151	No	0.1955	No
2/14/2023 8:30	0.245	0.01	0.0147	No	0.2041	No
2/14/2023 8:31	0.257	0.01	0.0143	No	0.2135	No
2/14/2023 8:32	0.276	0.008	0.0139	No	0.225	No
2/14/2023 8:33	0.378	0.008	0.0137	No	0.2429	No
2/14/2023 8:34	0.617	0.014	0.0137	No	0.2762	No
2/14/2023 8:35	0.361	0.017	0.0138	No	0.2907	No
2/14/2023 8:36	0.338	0.009	0.0133	No	0.3057	No
2/14/2023 8:37	0.371	0.01	0.0129	No	0.3187	No
2/14/2023 8:38	0.321	0.012	0.0125	No	0.3282	No
2/14/2023 8:39	0.364	0.01	0.0109	No	0.3376	No
2/14/2023 8:40	0.306	0.01	0.0107	No	0.3381	No
2/14/2023 8:41	0.31	0.008	0.0102	No	0.339	No
2/14/2023 8:42	0.281	0.008	0.0101	No	0.3323	No
2/14/2023 8:43	0.318	0.01	0.0102	No	0.3342	No
2/14/2023 8:44	0.275	0.008	0.0101	No	0.3345	No
2/14/2023 8:45	0.296	0.007	0.0099	No	0.3379	No
2/14/2023 8:46	0.354	0.008	0.0098	No	0.3444	No
2/14/2023 8:47	0.391	0.006	0.0097	No	0.3521	No
2/14/2023 8:48	0.372	0.007	0.0096	No	0.3517	No
2/14/2023 8:49	0.308	0.006	0.0091	No	0.3311	No
2/14/2023 8:50	0.377	0.005	0.0083	No	0.3321	No
2/14/2023 8:51	0.361	0.007	0.0081	No	0.3337	No
2/14/2023 8:52	0.313	0.006	0.0079	No	0.3298	No
2/14/2023 8:53	0.314	0.006	0.0075	No	0.3293	No
2/14/2023 8:54	0.287	0.005	0.0071	No	0.3242	No

Downwind Station						
Time	Instaneous VOC (ppm)	Instaneous Mass Conc. Total (mg/m ³)	Mass Conc. Total mg/m ³ AVG 15m (mg/m ³)	Dust Exceedance	VOC ppm AVG 15m (ppm)	VOC Exceedance
2/14/2023 8:55	0.262	0.004	0.0067	No	0.3213	No
2/14/2023 8:56	0.27	0.004	0.0065	No	0.3186	No
2/14/2023 8:57	0.268	0.003	0.0061	No	0.3177	No
2/14/2023 8:58	0.273	0.004	0.0057	No	0.3147	No
2/14/2023 8:59	0.38	0.004	0.0055	No	0.3217	No
2/14/2023 9:00	0.277	0.005	0.0053	No	0.3205	No
2/14/2023 9:01	0.251	0.007	0.0053	No	0.3136	No
2/14/2023 9:02	0.32	0.005	0.0052	No	0.3089	No
2/14/2023 9:03	0.359	0.005	0.0051	No	0.308	No
2/14/2023 9:04	0.287	0.014	0.0056	No	0.3066	No
2/14/2023 9:05	0.294	0.006	0.0057	No	0.3011	No
2/14/2023 9:06	0.28	0.011	0.0059	No	0.2957	No
2/14/2023 9:07	0.3	0.008	0.0061	No	0.2948	No
2/14/2023 9:08	0.298	0.006	0.0061	No	0.2937	No
2/14/2023 9:09	0.269	0.01	0.0064	No	0.2925	No
2/14/2023 9:10	0.311	0.004	0.0064	No	0.2958	No
2/14/2023 9:11	0.299	0.006	0.0065	No	0.2977	No
2/14/2023 9:12	0.373	0.005	0.0067	No	0.3047	No
2/14/2023 9:13	0.289	0.009	0.007	No	0.3058	No
2/14/2023 9:14	0.262	0.018	0.0079	No	0.2979	No
2/14/2023 9:15	0.242	0.022	0.0091	No	0.2956	No
2/14/2023 9:16	0.246	0.034	0.0109	No	0.2953	No
2/14/2023 9:17	0.302	0.013	0.0114	No	0.2941	No
2/14/2023 9:18	0.262	0.009	0.0117	No	0.2876	No
2/14/2023 9:19	0.33	0.007	0.0112	No	0.2905	No
2/14/2023 9:20	0.311	0.018	0.012	No	0.2916	No
2/14/2023 9:21	0.338	0.012	0.0121	No	0.2955	No
2/14/2023 9:22	0.328	0.024	0.0131	No	0.2973	No
2/14/2023 9:23	0.323	0.021	0.0141	No	0.299	No
2/14/2023 9:24	0.28	0.022	0.0149	No	0.2997	No
2/14/2023 9:25	0.241	0.011	0.0154	No	0.2951	No
2/14/2023 9:26	0.259	0.045	0.018	No	0.2924	No
2/14/2023 9:27	0.227	0.023	0.0192	No	0.2827	No
2/14/2023 9:28	0.219	0.013	0.0195	No	0.278	No
2/14/2023 9:29	0.232	0.03	0.0203	No	0.276	No
2/14/2023 9:30	0.246	0.027	0.0206	No	0.2763	No
2/14/2023 9:31	0.234	0.024	0.0199	No	0.2755	No
2/14/2023 9:32	0.272	0.007	0.0195	No	0.2735	No
2/14/2023 9:33	0.266	0.009	0.0195	No	0.2737	No
2/14/2023 9:34	0.33	0.008	0.0196	No	0.2737	No
2/14/2023 9:35	0.281	0.011	0.0191	No	0.2717	No
2/14/2023 9:36	0.275	0.01	0.019	No	0.2675	No
2/14/2023 9:37	0.28	0.015	0.0184	No	0.2643	No
2/14/2023 9:38	0.252	0.013	0.0179	No	0.2596	No
2/14/2023 9:39	0.226	0.006	0.0168	No	0.256	No
2/14/2023 9:40	0.217	0.006	0.0165	No	0.2544	No
2/14/2023 9:41	0.216	0.012	0.0143	No	0.2515	No
2/14/2023 9:42	0.197	0.005	0.0131	No	0.2495	No
2/14/2023 9:43	0.199	0.006	0.0126	No	0.2482	No
2/14/2023 9:44	0.192	0.005	0.0109	No	0.2455	No
2/14/2023 9:45	0.187	0.004	0.0094	No	0.2416	No
2/14/2023 9:46	0.195	0.008	0.0083	No	0.239	No
2/14/2023 9:47	0.188	0.012	0.0087	No	0.2334	No
2/14/2023 9:48	0.185	0.005	0.0084	No	0.228	No

Downwind Station						
Time	Instaneous VOC (ppm)	Instaneous Mass Conc. Total (mg/m ³)	Mass Conc. Total mg/m ³ AVG 15m (mg/m ³)	Dust Exceedance	VOC ppm AVG 15m (ppm)	VOC Exceedance
2/14/2023 9:49	0.185	0.003	0.0081	No	0.2183	No
2/14/2023 9:50	0.193	0.004	0.0076	No	0.2125	No
2/14/2023 9:51	0.193	0.007	0.0074	No	0.207	No
2/14/2023 9:52	0.196	0.009	0.007	No	0.2014	No
2/14/2023 9:53	0.217	0.011	0.0069	No	0.1991	No
2/14/2023 9:54	0.194	0.012	0.0073	No	0.1969	No
2/14/2023 9:55	0.191	0.01	0.0075	No	0.1952	No
2/14/2023 9:56	0.195	0.008	0.0073	No	0.1938	No
2/14/2023 9:57	0.184	0.007	0.0074	No	0.1929	No
2/14/2023 9:58	0.18	0.01	0.0077	No	0.1917	No
2/14/2023 9:59	0.177	0.007	0.0078	No	0.1907	No
2/14/2023 10:00	0.182	0.04	0.0102	No	0.1903	No
2/14/2023 10:01	0.179	0.009	0.0103	No	0.1893	No
2/14/2023 10:02	0.183	0.01	0.0101	No	0.1889	No
2/14/2023 10:03	0.178	0.008	0.0103	No	0.1885	No
2/14/2023 10:04	0.197	0.018	0.0113	No	0.1893	No
2/14/2023 10:05	0.189	0.011	0.0118	No	0.189	No
2/14/2023 10:06	0.202	0.02	0.0127	No	0.1896	No
2/14/2023 10:07	0.182	0.014	0.013	No	0.1887	No
2/14/2023 10:08	0.177	0.011	0.013	No	0.186	No
2/14/2023 10:09	0.185	0.02	0.0135	No	0.1854	No
2/14/2023 10:10	0.175	0.029	0.0148	No	0.1843	No
2/14/2023 10:11	0.186	0.02	0.0156	No	0.1837	No
2/14/2023 10:12	0.18	0.007	0.0156	No	0.1835	No
2/14/2023 10:13	0.176	0.011	0.0157	No	0.1832	No
2/14/2023 10:14	0.179	0.011	0.0159	No	0.1833	No
2/14/2023 10:15	0.179	0.012	0.0141	No	0.1831	No
2/14/2023 10:16	0.176	0.005	0.0138	No	0.1829	No
2/14/2023 10:17	0.174	0.003	0.0133	No	0.1823	No
2/14/2023 10:18	0.175	0.008	0.0133	No	0.1821	No
2/14/2023 10:19	0.171	0.006	0.0125	No	0.1804	No
2/14/2023 10:20	0.178	0.006	0.0122	No	0.1797	No
2/14/2023 10:21	0.18	0.011	0.0116	No	0.1782	No
2/14/2023 10:22	0.18	0.006	0.0111	No	0.1781	No
2/14/2023 10:23	0.189	0.014	0.0113	No	0.1789	No
2/14/2023 10:24	0.176	0.008	0.0105	No	0.1783	No
2/14/2023 10:25	0.182	0.006	0.0089	No	0.1787	No
2/14/2023 10:26	0.183	0.007	0.0081	No	0.1785	No
2/14/2023 10:27	0.193	0.018	0.0088	No	0.1794	No
2/14/2023 10:28	0.182	0.012	0.0089	No	0.1798	No
2/14/2023 10:29	0.214	0.015	0.0091	No	0.1821	No
2/14/2023 10:30	0.202	0.035	0.0107	No	0.1837	No
2/14/2023 10:31	0.181	0.048	0.0135	No	0.184	No
2/14/2023 10:32	0.186	0.017	0.0145	No	0.1848	No
2/14/2023 10:33	0.182	0.005	0.0143	No	0.1853	No
2/14/2023 10:34	0.194	0.031	0.0159	No	0.1868	No
2/14/2023 10:35	0.189	0.005	0.0159	No	0.1875	No
2/14/2023 10:36	0.181	0.005	0.0155	No	0.1876	No
2/14/2023 10:37	0.181	0.01	0.0157	No	0.1877	No
2/14/2023 10:38	0.188	0.019	0.0161	No	0.1876	No
2/14/2023 10:39	0.174	0.019	0.0168	No	0.1875	No
2/14/2023 10:40	0.181	0.005	0.0167	No	0.1874	No
2/14/2023 10:41	0.179	0.004	0.0165	No	0.1871	No
2/14/2023 10:42	0.198	0.006	0.0157	No	0.1875	No

Downwind Station						
Time	Instaneous VOC (ppm)	Instaneous Mass Conc. Total (mg/m ³)	Mass Conc. Total mg/m ³ AVG 15m (mg/m ³)	Dust Exceedance	VOC ppm AVG 15m (ppm)	VOC Exceedance
2/14/2023 10:43	0.178	0.009	0.0155	No	0.1872	No
2/14/2023 10:44	0.197	0.009	0.0151	No	0.1861	No
2/14/2023 10:45	0.175	0.012	0.0136	No	0.1843	No
2/14/2023 10:46	0.182	0.004	0.0107	No	0.1843	No
2/14/2023 10:47	0.169	0.014	0.0105	No	0.1832	No
2/14/2023 10:48	0.179	0.004	0.0104	No	0.183	No
2/14/2023 10:49	0.173	0.011	0.0091	No	0.1816	No
2/14/2023 10:50	0.181	0.01	0.0094	No	0.1811	No
2/14/2023 10:51	0.176	0.033	0.0113	No	0.1807	No
2/14/2023 10:52	0.173	0.005	0.0109	No	0.1802	No
2/14/2023 10:53	0.182	0.016	0.0107	No	0.1798	No
2/14/2023 10:54	0.176	0.025	0.0111	No	0.1799	No
2/14/2023 10:55	0.181	0.004	0.0111	No	0.1799	No
2/14/2023 10:56	0.192	0.003	0.011	No	0.1808	No
2/14/2023 10:57	0.183	0.003	0.0108	No	0.1798	No
2/14/2023 10:58	0.185	0.002	0.0103	No	0.1803	No
2/14/2023 10:59	0.185	0.003	0.0099	No	0.1795	No
2/14/2023 11:00	0.187	0.01	0.0098	No	0.1803	No
2/14/2023 11:01	0.187	0.019	0.0108	No	0.1806	No
2/14/2023 11:02	0.19	0.005	0.0102	No	0.182	No
2/14/2023 11:03	0.182	0.005	0.0103	No	0.1822	No
2/14/2023 11:04	0.178	0.005	0.0099	No	0.1825	No
2/14/2023 11:05	0.183	0.004	0.0095	No	0.1827	No
2/14/2023 11:06	0.186	0.008	0.0078	No	0.1833	No
2/14/2023 11:07	0.193	0.016	0.0085	No	0.1847	No
2/14/2023 11:08	0.194	0.021	0.0089	No	0.1855	No
2/14/2023 11:09	0.184	0.015	0.0082	No	0.186	No
2/14/2023 11:10	0.189	0.007	0.0084	No	0.1865	No
2/14/2023 11:11	0.192	0.009	0.0088	No	0.1865	No
2/14/2023 11:12	0.181	0.013	0.0095	No	0.1864	No
2/14/2023 11:13	0.179	0.008	0.0099	No	0.186	No
2/14/2023 11:14	0.185	0.011	0.0104	No	0.186	No
2/14/2023 11:15	0.178	0.007	0.0102	No	0.1854	No
2/14/2023 11:16	0.18	0.008	0.0095	No	0.1849	No
2/14/2023 11:17	0.174	0.005	0.0095	No	0.1839	No
2/14/2023 11:18	0.18	0.002	0.0093	No	0.1837	No
2/14/2023 11:19	0.188	0.029	0.0109	No	0.1844	No
2/14/2023 11:20	0.177	0.018	0.0118	No	0.184	No
2/14/2023 11:21	0.181	0.005	0.0116	No	0.1837	No
2/14/2023 11:22	0.176	0.003	0.0107	No	0.1825	No
2/14/2023 11:23	0.182	0.018	0.0105	No	0.1817	No
2/14/2023 11:24	0.183	0.007	0.01	No	0.1817	No
2/14/2023 11:25	0.184	0.004	0.0098	No	0.1813	No
2/14/2023 11:26	0.2	0.008	0.0097	No	0.1819	No
2/14/2023 11:27	0.181	0.012	0.0097	No	0.1819	No
2/14/2023 11:28	0.187	0.012	0.0099	No	0.1824	No
2/14/2023 11:29	0.185	0.006	0.0096	No	0.1824	No
2/14/2023 11:30	0.181	0.003	0.0093	No	0.1826	No
2/14/2023 11:31	0.183	0.018	0.01	No	0.1828	No
2/14/2023 11:32	0.178	0.01	0.0103	No	0.1831	No
2/14/2023 11:33	0.185	0.003	0.0104	No	0.1834	No
2/14/2023 11:34	0.205	0.011	0.0092	No	0.1845	No
2/14/2023 11:35	0.183	0.012	0.0088	No	0.1849	No
2/14/2023 11:36	0.176	0.015	0.0095	No	0.1846	No

Downwind Station						
Time	Instaneous VOC (ppm)	Instaneous Mass Conc. Total (mg/m ³)	Mass Conc. Total mg/m ³ AVG 15m (mg/m ³)	Dust Exceedance	VOC ppm AVG 15m (ppm)	VOC Exceedance
2/14/2023 11:37	0.178	0.005	0.0096	No	0.1847	No
2/14/2023 11:38	0.182	0.007	0.0089	No	0.1847	No
2/14/2023 11:39	0.184	0.006	0.0088	No	0.1848	No
2/14/2023 11:40	0.187	0.005	0.0089	No	0.185	No
2/14/2023 11:41	0.184	0.006	0.0087	No	0.1839	No
2/14/2023 11:42	0.187	0.006	0.0083	No	0.1843	No
2/14/2023 11:43	0.187	0.008	0.0081	No	0.1843	No
2/14/2023 11:44	0.179	0.016	0.0087	No	0.1839	No
2/14/2023 11:45	0.181	0.008	0.0091	No	0.1839	No
2/14/2023 11:46	0.18	0.014	0.0088	No	0.1837	No
2/14/2023 11:47	0.181	0.008	0.0087	No	0.1839	No
2/14/2023 11:48	0.19	0.006	0.0089	No	0.1843	No
2/14/2023 11:49	0.184	0.012	0.0089	No	0.1829	No
2/14/2023 11:50	0.189	0.014	0.0091	No	0.1833	No
2/14/2023 11:51	0.194	0.013	0.0089	No	0.1845	No
2/14/2023 11:52	0.195	0.019	0.0099	No	0.1856	No
2/14/2023 11:53	0.183	0.009	0.01	No	0.1857	No
2/14/2023 11:54	0.195	0.01	0.0103	No	0.1864	No
2/14/2023 11:55	0.186	0.015	0.0109	No	0.1863	No
2/14/2023 11:56	0.188	0.01	0.0112	No	0.1866	No
2/14/2023 11:57	0.176	0.017	0.0119	No	0.1859	No
2/14/2023 11:58	0.177	0.006	0.0118	No	0.1852	No
2/14/2023 11:59	0.19	0.01	0.0114	No	0.1859	No
2/14/2023 12:00	0.192	0.018	0.0121	No	0.1867	No
2/14/2023 12:01	0.197	0.013	0.012	No	0.1878	No
2/14/2023 12:02	0.19	0.009	0.0121	No	0.1884	No
2/14/2023 12:03	0.22	0.009	0.0123	No	0.1904	No
2/14/2023 12:04	0.194	0.007	0.0119	No	0.1911	No
2/14/2023 12:05	0.187	0.005	0.0113	No	0.1909	No
2/14/2023 12:06	0.191	0.004	0.0107	No	0.1907	No
2/14/2023 12:07	0.194	0.012	0.0103	No	0.1907	No
2/14/2023 12:08	0.195	0.008	0.0102	No	0.1915	No
2/14/2023 12:09	0.214	0.005	0.0099	No	0.1927	No
2/14/2023 12:10	0.19	0.004	0.0091	No	0.193	No
2/14/2023 12:11	0.186	0.005	0.0088	No	0.1929	No
2/14/2023 12:12	0.186	0.01	0.0083	No	0.1935	No
2/14/2023 12:13	0.186	0.004	0.0082	No	0.1941	No
2/14/2023 12:14	0.186	0.006	0.0079	No	0.1939	No
2/14/2023 12:15	0.196	0.008	0.0073	No	0.1941	No
2/14/2023 12:16	0.2	0.007	0.0069	No	0.1943	No
2/14/2023 12:17	0.193	0.007	0.0067	No	0.1945	No
2/14/2023 12:18	0.199	0.014	0.0071	No	0.1931	No
2/14/2023 12:19	0.198	0.011	0.0073	No	0.1934	No
2/14/2023 12:20	0.197	0.004	0.0073	No	0.1941	No
2/14/2023 12:21	0.199	0.004	0.0073	No	0.1946	No
2/14/2023 12:22	0.203	0.006	0.0069	No	0.1952	No
2/14/2023 12:23	0.193	0.014	0.0073	No	0.1951	No
2/14/2023 12:24	0.186	0.009	0.0075	No	0.1932	No
2/14/2023 12:25	0.185	0.005	0.0076	No	0.1929	No
2/14/2023 12:26	0.186	0.007	0.0077	No	0.1929	No
2/14/2023 12:27	0.185	0.005	0.0074	No	0.1928	No
2/14/2023 12:28	0.188	0.004	0.0074	No	0.1929	No
2/14/2023 12:29	0.195	0.009	0.0076	No	0.1935	No
2/14/2023 12:30	0.191	0.007	0.0075	No	0.1932	No

Downwind Station						
Time	Instaneous VOC (ppm)	Instaneous Mass Conc. Total (mg/m ³)	Mass Conc. Total mg/m ³ AVG 15m (mg/m ³)	Dust Exceedance	VOC ppm AVG 15m (ppm)	VOC Exceedance
2/14/2023 12:31	0.188	0.002	0.0072	No	0.1924	No
2/14/2023 12:32	0.188	0.003	0.0069	No	0.1921	No
2/14/2023 12:33	0.187	0.003	0.0062	No	0.1913	No
2/14/2023 12:34	0.184	0.003	0.0057	No	0.1903	No
2/14/2023 12:35	0.183	0.005	0.0057	No	0.1894	No
2/14/2023 12:36	0.189	0.012	0.0063	No	0.1887	No
2/14/2023 12:37	0.188	0.008	0.0064	No	0.1877	No
2/14/2023 12:38	0.179	0.008	0.006	No	0.1868	No
2/14/2023 12:39	0.188	0.002	0.0055	No	0.1869	No
2/14/2023 12:40	0.19	0.001	0.0053	No	0.1873	No
2/14/2023 12:41	0.209	0	0.0048	No	0.1888	No
2/14/2023 12:42	0.19	0.003	0.0047	No	0.1891	No
2/14/2023 12:43	0.19	0.006	0.0048	No	0.1893	No
2/14/2023 12:44	0.281	0.01	0.0049	No	0.195	No
2/14/2023 12:45	0.199	0.004	0.0047	No	0.1955	No
2/14/2023 12:46	0.19	0	0.0045	No	0.1957	No
2/14/2023 12:47	0.188	0.001	0.0044	No	0.1957	No
2/14/2023 12:48	0.195	0.001	0.0043	No	0.1962	No
2/14/2023 12:49	0.192	0.003	0.0043	No	0.1967	No
2/14/2023 12:50	0.192	0.004	0.0042	No	0.1973	No
2/14/2023 12:51	0.193	0.008	0.0039	No	0.1976	No
2/14/2023 12:52	0.192	0.003	0.0036	No	0.1979	No
2/14/2023 12:53	0.198	0.004	0.0033	No	0.1991	No
2/14/2023 12:54	0.196	0.009	0.0038	No	0.1997	No
2/14/2023 12:55	0.181	0.001	0.0038	No	0.1991	No
2/14/2023 12:56	0.192	0	0.0038	No	0.1979	No
2/14/2023 12:57	0.201	0.002	0.0037	No	0.1987	No
2/14/2023 12:58	0.192	0.013	0.0042	No	0.1988	No
2/14/2023 12:59	0.193	0.006	0.0039	No	0.1929	No
2/14/2023 13:00	0.188	0.013	0.0045	No	0.1922	No
2/14/2023 13:01	0.189	0.005	0.0049	No	0.1921	No
2/14/2023 13:02	0.201	0.005	0.0051	No	0.193	No
2/14/2023 13:03	0.195	0.005	0.0054	No	0.193	No
2/14/2023 13:04	0.186	0	0.0052	No	0.1926	No
2/14/2023 13:05	0.186	0.002	0.0051	No	0.1922	No
2/14/2023 13:06	0.19	0	0.0045	No	0.192	No
2/14/2023 13:07	0.186	0	0.0043	No	0.1916	No
2/14/2023 13:08	0.189	0.001	0.0041	No	0.191	No
2/14/2023 13:09	0.189	0.005	0.0039	No	0.1905	No
2/14/2023 13:10	0.191	0	0.0038	No	0.1912	No
2/14/2023 13:11	0.19	0	0.0038	No	0.1911	No
2/14/2023 13:12	0.192	0.008	0.0042	No	0.1905	No
2/14/2023 13:13	0.194	0.012	0.0041	No	0.1906	No
2/14/2023 13:14	0.191	0.006	0.0041	No	0.1905	No
2/14/2023 13:15	0.19	0	0.0033	No	0.1906	No
2/14/2023 13:16	0.185	0	0.0029	No	0.1903	No
2/14/2023 13:17	0.187	0	0.0026	No	0.1894	No
2/14/2023 13:18	0.185	0	0.0023	No	0.1887	No
2/14/2023 13:19	0.199	0	0.0023	No	0.1896	No
2/14/2023 13:20	0.197	0.001	0.0022	No	0.1903	No
2/14/2023 13:21	0.203	0.003	0.0024	No	0.1912	No
2/14/2023 13:22	0.202	0.005	0.0027	No	0.1923	No
2/14/2023 13:23	0.196	0.003	0.0029	No	0.1927	No
2/14/2023 13:24	0.188	0.002	0.0027	No	0.1927	No

Downwind Station						
Time	Instantaneous VOC (ppm)	Instantaneous Mass Conc. Total (mg/m ³)	Mass Conc. Total mg/m ³ AVG 15m (mg/m ³)	Dust Exceedance	VOC ppm AVG 15m (ppm)	VOC Exceedance
2/14/2023 13:25	0.187	0.001	0.0027	No	0.1924	No
2/14/2023 13:26	0.186	0.002	0.0029	No	0.1921	No
2/14/2023 13:27	0.21	0.003	0.0025	No	0.1933	No
2/14/2023 13:28	0.217	0.007	0.0022	No	0.1949	No
2/14/2023 13:29	0.206	0.013	0.0027	No	0.1959	No
2/14/2023 13:30	0.205	0.007	0.0031	No	0.1969	No
2/14/2023 13:31	0.205	0.003	0.0033	No	0.1982	No
2/14/2023 13:32	0.197	0.001	0.0034	No	0.1989	No
2/14/2023 13:33	0.196	0.002	0.0035	No	0.1996	No
2/14/2023 13:34	0.199	0.001	0.0036	No	0.1996	No
2/14/2023 13:35	0.192	0.003	0.0037	No	0.1993	No
2/14/2023 13:36	0.193	0.003	0.0037	No	0.1986	No
2/14/2023 13:37	0.189	0.004	0.0037	No	0.1977	No
2/14/2023 13:38	0.2	0.005	0.0038	No	0.198	No
2/14/2023 13:39	0.199	0.007	0.0041	No	0.1987	No
2/14/2023 13:40	0.201	0.005	0.0044	No	0.1997	No
2/14/2023 13:41	0.208	0.007	0.0047	No	0.2011	No
2/14/2023 13:42	0.198	0.008	0.0051	No	0.2003	No
2/14/2023 13:43	0.192	0.008	0.0051	No	0.1987	No
2/14/2023 13:44	0.192	0.004	0.0045	No	0.1977	No
2/14/2023 13:45	0.208	0.005	0.0044	No	0.1979	No
2/14/2023 13:46	0.228	0.007	0.0047	No	0.1995	No
2/14/2023 13:47	0.219	0.015	0.0056	No	0.2009	No
2/14/2023 13:48	0.214	0.015	0.0065	No	0.2021	No
2/14/2023 13:49	0.203	0.012	0.0072	No	0.2024	No
2/14/2023 13:50	0.233	0.012	0.0078	No	0.2051	No
2/14/2023 13:51	0.249	0.021	0.009	No	0.2089	No
2/14/2023 13:52	0.224	0.011	0.0095	No	0.2112	No
2/14/2023 13:53	0.215	0.012	0.0099	No	0.2122	No
2/14/2023 13:54	0.22	0.013	0.0103	No	0.2136	No
2/14/2023 13:55	0.225	0.016	0.0111	No	0.2152	No
2/14/2023 13:56	0.225	0.027	0.0124	No	0.2163	No
2/14/2023 13:57	0.295	0.01	0.0125	No	0.2228	No
2/14/2023 13:58	0.295	0.009	0.0126	No	0.2297	No
2/14/2023 13:59	0.24	0.006	0.0127	No	0.2329	No
2/14/2023 14:00	0.212	0.004	0.0127	No	0.2331	No
2/14/2023 14:01	0.202	0.004	0.0125	No	0.2314	No
2/14/2023 14:02	0.205	0.004	0.0117	No	0.2305	No
2/14/2023 14:03	0.209	0.003	0.0109	No	0.2301	No
2/14/2023 14:04	0.226	0.003	0.0103	No	0.2317	No
2/14/2023 14:05	0.232	0.003	0.0097	No	0.2316	No
2/14/2023 14:06	0.314	0.007	0.0088	No	0.2359	No
2/14/2023 14:07	0.255	0.013	0.0089	No	0.238	No
2/14/2023 14:08	0.27	0.003	0.0083	No	0.2417	No
2/14/2023 14:09	0.224	0.004	0.0077	No	0.2419	No
2/14/2023 14:10	0.201	0.001	0.0067	No	0.2403	No

Downwind Station						
Time	Instantaneous VOC (ppm)	Instantaneous Mass Conc. Total (mg/m ³)	Mass Conc. Total mg/m ³ AVG 15m (mg/m ³)	Dust Exceedance	VOC ppm AVG 15m (ppm)	VOC Exceedance
2/14/2023 14:11	0.2	0	0.0049	No	0.2387	No
2/14/2023 14:12	0.197	0	0.0043	No	0.2321	No
2/14/2023 14:13	0.193	0.001	0.0037	No	0.2253	No
2/14/2023 14:14	0.214	0	0.0033	No	0.2236	No
2/14/2023 14:15	0.2	0.001	0.0031	No	0.2228	No
2/14/2023 14:16	0.194	0.001	0.0029	No	0.2223	No
2/14/2023 14:17	0.193	0.001	0.0027	No	0.2215	No
2/14/2023 14:18	0.246	0.002	0.0027	No	0.2239	No
2/14/2023 14:19	0.292	0.003	0.0027	No	0.2283	No
2/14/2023 14:20	0.215	0.003	0.0027	No	0.2272	No
2/14/2023 14:21	0.231	0.003	0.0024	No	0.2217	No
2/14/2023 14:22	0.198	0	0.0015	No	0.2179	No
2/14/2023 14:23	0.217	0	0.0013	No	0.2143	No
2/14/2023 14:24	0.196	0	0.0011	No	0.2125	No
2/14/2023 14:25	0.202	0	0.001	No	0.2125	No
2/14/2023 14:26	0.203	0	0.001	No	0.2127	No
2/14/2023 14:27	0.222	0.004	0.0013	No	0.2144	No
2/14/2023 14:28	0.288	0.009	0.0018	No	0.2207	No
2/14/2023 14:29	0.227	0.006	0.0022	No	0.2216	No
2/14/2023 14:30	0.194	0.003	0.0023	No	0.2212	No
2/14/2023 14:31	0.194	0.003	0.0025	No	0.2212	No
2/14/2023 14:32	0.194	0.001	0.0025	No	0.2213	No
2/14/2023 14:33	0.214	0.04	0.005	No	0.2191	No
2/14/2023 14:34	0.207	0.029	0.0067	No	0.2135	No
2/14/2023 14:35	0.235	0.008	0.0071	No	0.2148	No
2/14/2023 14:36	0.22	0.013	0.0077	No	0.2141	No
2/14/2023 14:37	0.2	0.001	0.0078	No	0.2142	No
2/14/2023 14:38	0.213	0	0.0078	No	0.2139	No
2/14/2023 14:39	0.206	0	0.0078	No	0.2146	No
2/14/2023 14:40	0.266	0.003	0.008	No	0.2189	No
2/14/2023 14:41	0.218	0.015	0.009	No	0.2199	No
2/14/2023 14:42	0.221	0.009	0.0093	No	0.2198	No
2/14/2023 14:43	0.186	0.027	0.0105	No	0.213	No
2/14/2023 14:44	0.214	0.003	0.0103	No	0.2121	No
2/14/2023 14:45	0.205	0.007	0.0106	No	0.2129	No
2/14/2023 14:46	0.188	0.014	0.0113	No	0.2125	No
2/14/2023 14:47	0.191	0.007	0.0117	No	0.2123	No
2/14/2023 14:48	0.19	0.01	0.0097	No	0.2107	No
2/14/2023 14:49	0.187	0.017	0.0089	No	0.2093	No
2/14/2023 14:50	0.194	0.017	0.0095	No	0.2066	No
2/14/2023 14:51	0.178	0.008	0.0092	No	0.2038	No
2/14/2023 14:52	0.179	0.003	0.0093	No	0.2024	No
2/14/2023 14:53	0.183	0.007	0.0098	No	0.2004	No
2/14/2023 14:54	0.183	0.01	0.0105	No	0.1989	No