



Daily Activity Report

Seton Brilla Charter School
1956 Jerome Avenue, Bronx, NY
BCP No. C203152

General Site Information

Date:	Monday, February 13, 2023
Weather:	Partly Cloudy, 38-51°F
Wind Direction/Speed:	NW @ 10-15 mph
AKRF Personnel on Site:	Shannon Donohue
AKRF Equipment on Site:	Mini RAE 3000 Photoionization Detector [(PID) x1], 2 Fixed Air Monitoring Stations [DustTrak
Visitors:	None.

Contractor Information

Contracting Company	Main Personnel	Equipment
Casino Construction	Connor McGrory	Excavator, CFA Drill Rig

Description and Location of Work Activities Performed

- 1) Excavation in grids WC-03 and WC-04 to uncover piles as part of pile cap construction.
- 2) Work continued along the eastern boundary of the site to underpin the adjacent building.

Site Soil Disposal Tracking Information

Destination Facility	Daily Trucks	Total Trucks	Daily Approx. Cubic Yds	Total Approx. Cubic Yds	Total Site Loads	Total Approximate Cubic Yards
Clean Earth Carteret	0	73	0	1,460	163	3,260
Clean Earth Southeastern Pennsylvania	0	64	0	1,280		
Concrete Disposal	0	26	0	520		
N/A	0	0	0	0		
N/A	0	0	0	0		

CAMP Air Monitoring Results

CAMP Station	UPWIND				DOWNWIND		
Odors:	None.				None.		
VOC Action Level Exceedance(s):	None.				None.		
Particulate Action Level Exceedance(s):	None.				None.		
Maximum VOC Level (15 min ppm):	0.665				0.225		
Maximum Particulate Level (15 min mg/m ³):	0.1025				0.084		

Notes: CAMP monitoring was performed throughout the day.





Additional Information

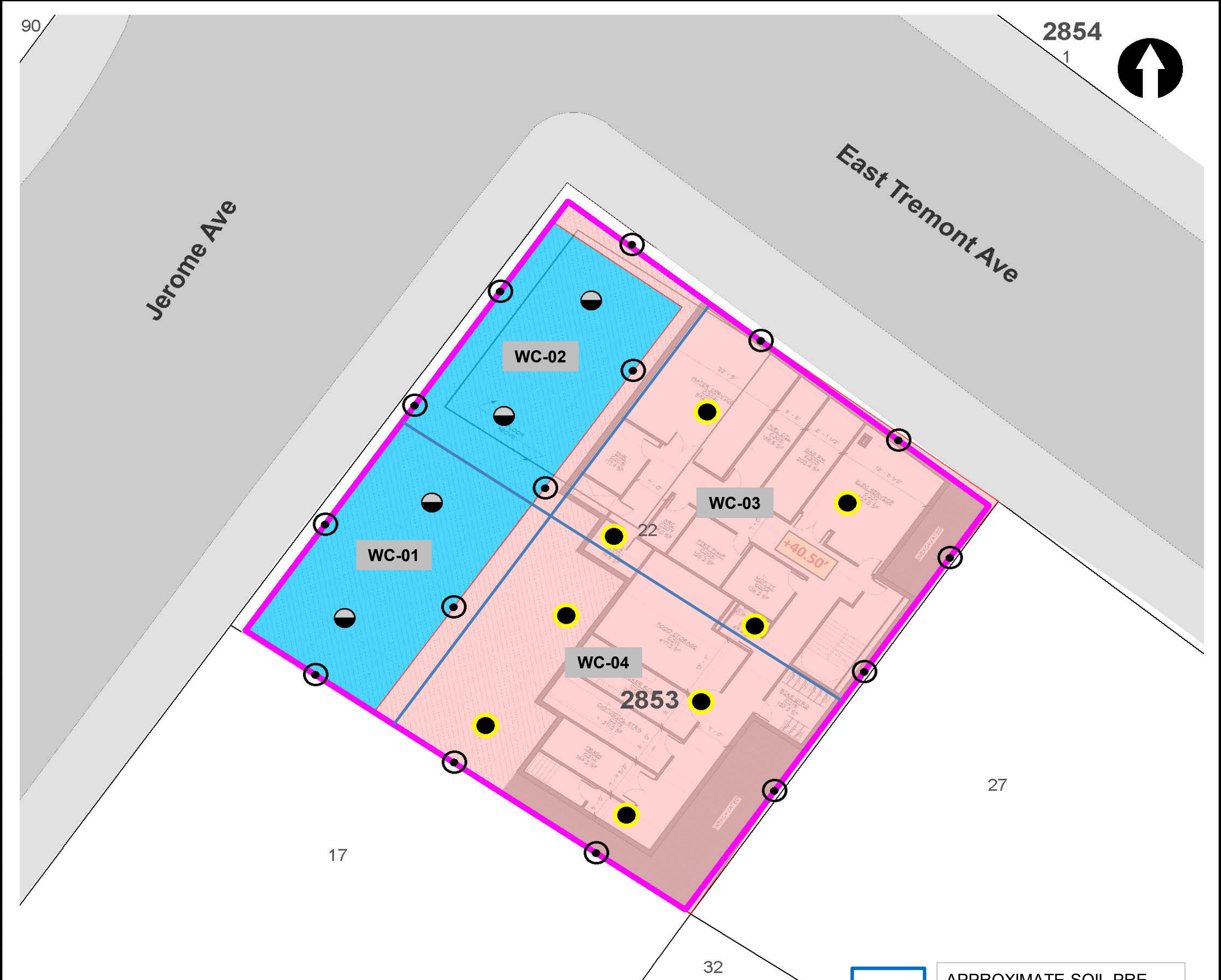

Planned Work Activity for Following Day/Week:	1) Excavation of soil/fill to uncover piles. 2) Installation of underpinnings.
Comments:	None.

Site Map



LEGEND

-  PROJECT SITE BOUNDARY
-  LOT BOUNDARY AND TAX LOT NUMBER
- 2853** BLOCK NUMBER
-  REMEDIAL EXCAVATION TO APPROXIMATELY TWO FEET BELOW EXISTING GRADE
-  REMEDIAL EXCAVATION TO GROUNDWATER (SOURCE AREA)

-  CONFIRMATION DOCUMENTATION BOTTOM SAMPLE
-  SOURCE AREA DOCUMENTATION BOTTOM SAMPLE
-  DOCUMENTATION SIDEWALL SAMPLE

 APPROXIMATE SOIL PRE-CHARACTERIZATION GRID

NOTE
 REMEDIAL EXCAVATION WILL INCLUDE REMOVAL OF APPROXIMATELY 1,280 TONS (850 CUBIC YARDS) OF SOURCE MATERIAL ASSOCIATED WITH NYSDEC SPILL NO. 2103719 AND APPROXIMATELY 860 TONS (570 CUBIC YARDS) OF SOIL/FILL FROM THE UPPER 2 FEET SITE-WIDE.



Map Source:
 NYCDOP (NYC Dept. of City Planning) GIS database

© 2021 AKRF. W:\Projects\210024 - 1956 JEROME AVENUE\Technical\GIS and Graphics\AR\RAW\210024 Figure 9 Proposed Remedial Excavation and Documentation Sample Location Plan.mxd 10/25/2021 2:03:38 PM iszalus



440 Park Avenue South, New York, NY 10016

1956 Jerome Avenue
 Bronx, New York

**TRACK 4 CLEANUP AND DOCUMENTATION
 SAMPLE LOCATION PLAN**

DATE
04/29/2022

PROJECT NO.
210024

FIGURE
11

Site Photographs

Photograph 1 -
Excavating soil in grid
WC-03, view facing
east.



Photograph 2 -
Concrete pour for
underpinning in grid
WC-03, view facing
southwest.



Photograph 3 -
Installation of
underpinnings in
Grid WC-03, view
facing east.



Upwind Station						
Time	Instaneous VOC (ppm)	Instaneous Mass Conc. Total (mg/m ³)	Mass Conc. Total mg/m ³ AVG 15m (mg/m ³)	Dust Exceedance	VOC ppm AVG 15m (ppm)	VOC Exceedance
2/13/23 7:02	0			No	0	No
2/13/23 7:03	0.002	0.022	0.022	No	0.001	No
2/13/23 7:04	0	0.032	0.027	No	0.0007	No
2/13/23 7:05	0	0.02	0.0247	No	0.0005	No
2/13/23 7:06	0	0.028	0.0255	No	0.0004	No
2/13/23 7:07	0	0.038	0.028	No	0.0003	No
2/13/23 7:08	0	0.023	0.0272	No	0.0003	No
2/13/23 7:09	0	0.022	0.0264	No	0.0003	No
2/13/23 7:10	0	0.017	0.0252	No	0.0002	No
2/13/23 7:11	0	0.025	0.0252	No	0.0002	No
2/13/23 7:12	0	0.021	0.0248	No	0.0002	No
2/13/23 7:13	0	0.029	0.0252	No	0.0002	No
2/13/23 7:14	0	0.022	0.0249	No	0.0002	No
2/13/23 7:15	0	0.016	0.0242	No	0.0001	No
2/13/23 7:16	0	0.014	0.0235	No	0.0001	No
2/13/23 7:17	0	0.032	0.0241	No	0.0001	No
2/13/23 7:18	0	0.034	0.0249	No	0	No
2/13/23 7:19	0	0.029	0.0247	No	0	No
2/13/23 7:20	0.001	0.024	0.0249	No	0.0001	No
2/13/23 7:21	0	0.022	0.0245	No	0.0001	No
2/13/23 7:22	0	0.023	0.0235	No	0.0001	No
2/13/23 7:23	0.002	0.017	0.0231	No	0.0002	No
2/13/23 7:24	0.004	0.021	0.0231	No	0.0005	No
2/13/23 7:25	0.005	0.02	0.0233	No	0.0008	No
2/13/23 7:26	0.005	0.019	0.0229	No	0.0011	No
2/13/23 7:27	0.005	0.017	0.0226	No	0.0015	No
2/13/23 7:28	0.025	0.017	0.0218	No	0.0031	No
2/13/23 7:29	0.022	0.019	0.0216	No	0.0046	No
2/13/23 7:30	0.025	0.02	0.0219	No	0.0063	No
2/13/23 7:31	0.025	0.017	0.0221	No	0.0079	No
2/13/23 7:32	0.044	0.021	0.0213	No	0.0109	No
2/13/23 7:33	0.03	0.02	0.0204	No	0.0129	No
2/13/23 7:34	0.035	0.021	0.0199	No	0.0152	No
2/13/23 7:35	0.042	0.019	0.0195	No	0.0179	No
2/13/23 7:36	0.052	0.024	0.0197	No	0.0214	No
2/13/23 7:37	0.11	0.026	0.0199	No	0.0287	No
2/13/23 7:38	0.109	0.027	0.0205	No	0.0359	No
2/13/23 7:39	0.135	0.032	0.0213	No	0.0446	No
2/13/23 7:40	0.109	0.016	0.021	No	0.0515	No
2/13/23 7:41	0.122	0.017	0.0209	No	0.0593	No
2/13/23 7:42	0.111	0.02	0.0211	No	0.0664	No
2/13/23 7:43	0.113	0.018	0.0211	No	0.0723	No
2/13/23 7:44	0.116	0.022	0.0213	No	0.0785	No
2/13/23 7:45	0.115	0.022	0.0215	No	0.0845	No
2/13/23 7:46	0.114	0.017	0.0215	No	0.0905	No
2/13/23 7:47	0.117	0.016	0.0211	No	0.0953	No
2/13/23 7:48	0.14	0.018	0.021	No	0.1027	No
2/13/23 7:49	0.133	0.022	0.0211	No	0.1092	No
2/13/23 7:50	0.138	0.018	0.021	No	0.1156	No
2/13/23 7:51	0.14	0.017	0.0205	No	0.1215	No
2/13/23 7:52	0.136	0.016	0.0199	No	0.1232	No
2/13/23 7:53	0.154	0.02	0.0194	No	0.1262	No

Upwind Station						
Time	Instaneous VOC (ppm)	Instaneous Mass Conc. Total (mg/m ³)	Mass Conc. Total mg/m ³ AVG 15m (mg/m ³)	Dust Exceedance	VOC ppm AVG 15m (ppm)	VOC Exceedance
2/13/23 7:54	0.181	0.018	0.0185	No	0.1293	No
2/13/23 7:55	0.166	0.016	0.0185	No	0.1331	No
2/13/23 7:56	0.174	0.015	0.0183	No	0.1365	No
2/13/23 7:57	0.171	0.016	0.0181	No	0.1405	No
2/13/23 7:58	0.174	0.016	0.0179	No	0.1446	No
2/13/23 7:59	0.181	0.634	0.0587	No	0.1489	No
2/13/23 8:00	0.176	0.284	0.0762	No	0.153	No
2/13/23 8:01	0.188	0.116	0.0828	No	0.1579	No
2/13/23 8:02	0.183	0.041	0.0845	No	0.1623	No
2/13/23 8:03	0.196	0.017	0.0844	No	0.1661	No
2/13/23 8:04	0.191	0.137	0.0921	No	0.1699	No
2/13/23 8:05	0.187	0.145	0.1005	No	0.1732	No
2/13/23 8:06	0.185	0.044	0.1023	No	0.1762	No
2/13/23 8:07	0.188	0.016	0.1023	No	0.1797	No
2/13/23 8:08	0.194	0.015	0.102	No	0.1823	No
2/13/23 8:09	0.192	0.018	0.102	No	0.1831	No
2/13/23 8:10	0.2	0.015	0.1019	No	0.1853	No
2/13/23 8:11	0.207	0.018	0.1021	No	0.1875	No
2/13/23 8:12	0.215	0.019	0.1023	No	0.1905	No
2/13/23 8:13	0.211	0.019	0.1025	No	0.1929	No
2/13/23 8:14	0.218	0.031	0.0623	No	0.1954	No
2/13/23 8:15	0.218	0.025	0.0451	No	0.1982	No
2/13/23 8:16	0.225	0.024	0.0389	No	0.2007	No
2/13/23 8:17	0.226	0.023	0.0377	No	0.2035	No
2/13/23 8:18	0.234	0.022	0.0381	No	0.2061	No
2/13/23 8:19	0.228	0.024	0.0305	No	0.2085	No
2/13/23 8:20	0.227	0.019	0.0221	No	0.2112	No
2/13/23 8:21	0.233	0.017	0.0203	No	0.2144	No
2/13/23 8:22	0.235	0.017	0.0204	No	0.2175	No
2/13/23 8:23	0.244	0.017	0.0205	No	0.2209	No
2/13/23 8:24	0.292	0.021	0.0207	No	0.2275	No
2/13/23 8:25	0.282	0.015	0.0207	No	0.233	No
2/13/23 8:26	0.363	0.018	0.0207	No	0.2434	No
2/13/23 8:27	0.35	0.016	0.0205	No	0.2524	No
2/13/23 8:28	0.397	0.017	0.0204	No	0.2648	No
2/13/23 8:29	0.351	0.017	0.0195	No	0.2737	No
2/13/23 8:30	0.338	0.015	0.0188	No	0.2817	No
2/13/23 8:31	0.36	0.016	0.0183	No	0.2907	No
2/13/23 8:32	0.374	0.017	0.0179	No	0.3005	No
2/13/23 8:33	0.384	0.016	0.0175	No	0.3105	No
2/13/23 8:34	0.38	0.016	0.0169	No	0.3207	No
2/13/23 8:35	0.375	0.017	0.0168	No	0.3305	No
2/13/23 8:36	0.358	0.018	0.0169	No	0.3389	No
2/13/23 8:37	0.346	0.018	0.0169	No	0.3463	No
2/13/23 8:38	0.352	0.016	0.0169	No	0.3535	No
2/13/23 8:39	0.353	0.04	0.0181	No	0.3575	No
2/13/23 8:40	0.347	0.017	0.0183	No	0.3619	No
2/13/23 8:41	0.352	0.015	0.0181	No	0.3611	No
2/13/23 8:42	0.351	0.017	0.0181	No	0.3612	No
2/13/23 8:43	0.348	0.014	0.0179	No	0.3579	No
2/13/23 8:44	0.352	0.014	0.0177	No	0.358	No
2/13/23 8:45	0.44	0.019	0.018	No	0.3648	No

Upwind Station						
Time	Instaneous VOC (ppm)	Instaneous Mass Conc. Total (mg/m ³)	Mass Conc. Total mg/m ³ AVG 15m (mg/m ³)	Dust Exceedance	VOC ppm AVG 15m (ppm)	VOC Exceedance
2/13/23 8:46	0.39	0.025	0.0186	No	0.3668	No
2/13/23 8:47	0.381	0.018	0.0187	No	0.3673	No
2/13/23 8:48	0.373	0.014	0.0185	No	0.3665	No
2/13/23 8:49	0.371	0.014	0.0184	No	0.3659	No
2/13/23 8:50	0.392	0.016	0.0183	No	0.3671	No
2/13/23 8:51	0.401	0.025	0.0188	No	0.3699	No
2/13/23 8:52	0.394	0.016	0.0187	No	0.3731	No
2/13/23 8:53	0.392	0.016	0.0187	No	0.3758	No
2/13/23 8:54	0.388	0.015	0.017	No	0.3781	No
2/13/23 8:55	0.388	0.015	0.0169	No	0.3809	No
2/13/23 8:56	0.395	0.016	0.0169	No	0.3837	No
2/13/23 8:57	0.392	0.016	0.0169	No	0.3865	No
2/13/23 8:58	0.383	0.017	0.0171	No	0.3888	No
2/13/23 8:59	0.391	0.017	0.0173	No	0.3914	No
2/13/23 9:00	0.385	0.014	0.0169	No	0.3877	No
2/13/23 9:01	0.39	0.014	0.0162	No	0.3877	No
2/13/23 9:02	0.388	0.014	0.0159	No	0.3882	No
2/13/23 9:03	0.401	0.013	0.0159	No	0.3901	No
2/13/23 9:04	0.392	0.015	0.0159	No	0.3915	No
2/13/23 9:05	0.397	0.02	0.0162	No	0.3918	No
2/13/23 9:06	0.45	0.013	0.0154	No	0.3951	No
2/13/23 9:07	0.423	0.014	0.0153	No	0.397	No
2/13/23 9:08	0.411	0.027	0.016	No	0.3983	No
2/13/23 9:09	0.407	0.015	0.016	No	0.3995	No
2/13/23 9:10	0.409	0.016	0.0161	No	0.4009	No
2/13/23 9:11	0.415	0.016	0.0161	No	0.4023	No
2/13/23 9:12	0.407	0.015	0.016	No	0.4033	No
2/13/23 9:13	0.413	0.015	0.0159	No	0.4053	No
2/13/23 9:14	0.418	0.015	0.0157	No	0.4071	No
2/13/23 9:15	0.408	0.018	0.016	No	0.4086	No
2/13/23 9:16	0.416	0.03	0.0171	No	0.4103	No
2/13/23 9:17	0.394	0.025	0.0178	No	0.4107	No
2/13/23 9:18	0.415	0.024	0.0185	No	0.4117	No
2/13/23 9:19	0.483	0.025	0.0192	No	0.4177	No
2/13/23 9:20	0.42	0.028	0.0197	No	0.4193	No
2/13/23 9:21	0.409	0.022	0.0203	No	0.4165	No
2/13/23 9:22	0.396	0.019	0.0207	No	0.4147	No
2/13/23 9:23	0.399	0.013	0.0197	No	0.4139	No
2/13/23 9:24	0.395	0.019	0.02	No	0.4131	No
2/13/23 9:25	0.401	0.021	0.0203	No	0.4126	No
2/13/23 9:26	0.401	0.02	0.0206	No	0.4117	No
2/13/23 9:27	0.458	0.029	0.0215	No	0.4151	No
2/13/23 9:28	0.41	0.027	0.0223	No	0.4149	No
2/13/23 9:29	0.405	0.029	0.0233	No	0.414	No
2/13/23 9:30	0.398	0.023	0.0236	No	0.4133	No
2/13/23 9:31	0.412	0.014	0.0225	No	0.4131	No
2/13/23 9:32	0.443	0.03	0.0229	No	0.4163	No
2/13/23 9:33	0.402	0.016	0.0223	No	0.4155	No
2/13/23 9:34	0.412	0.013	0.0215	No	0.4107	No
2/13/23 9:35	0.408	0.015	0.0207	No	0.4099	No
2/13/23 9:36	0.416	0.02	0.0205	No	0.4104	No
2/13/23 9:37	0.419	0.019	0.0205	No	0.4119	No

Upwind Station						
Time	Instaneous VOC (ppm)	Instaneous Mass Conc. Total (mg/m ³)	Mass Conc. Total mg/m ³ AVG 15m (mg/m ³)	Dust Exceedance	VOC ppm AVG 15m (ppm)	VOC Exceedance
2/13/23 9:38	0.412	0.034	0.0219	No	0.4128	No
2/13/23 9:39	0.419	0.023	0.0222	No	0.4144	No
2/13/23 9:40	0.419	0.019	0.0221	No	0.4156	No
2/13/23 9:41	0.423	0.045	0.0237	No	0.4171	No
2/13/23 9:42	0.429	0.028	0.0237	No	0.4151	No
2/13/23 9:43	0.425	0.026	0.0236	No	0.4161	No
2/13/23 9:44	0.421	0.022	0.0231	No	0.4172	No
2/13/23 9:45	0.432	0.02	0.0229	No	0.4195	No
2/13/23 9:46	0.428	0.014	0.0229	No	0.4205	No
2/13/23 9:47	0.426	0.012	0.0217	No	0.4194	No
2/13/23 9:48	0.432	0.035	0.023	No	0.4214	No
2/13/23 9:49	0.441	0.018	0.0233	No	0.4233	No
2/13/23 9:50	0.457	0.017	0.0235	No	0.4266	No
2/13/23 9:51	0.454	0.013	0.023	No	0.4291	No
2/13/23 9:52	0.654	0.023	0.0233	No	0.4448	No
2/13/23 9:53	0.525	0.013	0.0219	No	0.4523	No
2/13/23 9:54	0.503	0.014	0.0213	No	0.4579	No
2/13/23 9:55	0.488	0.014	0.0209	No	0.4625	No
2/13/23 9:56	0.487	0.019	0.0192	No	0.4668	No
2/13/23 9:57	0.473	0.018	0.0185	No	0.4697	No
2/13/23 9:58	0.493	0.017	0.0179	No	0.4743	No
2/13/23 9:59	0.485	0.026	0.0182	No	0.4785	No
2/13/23 10:00	0.471	0.036	0.0193	No	0.4811	No
2/13/23 10:01	0.477	0.023	0.0199	No	0.4844	No
2/13/23 10:02	0.461	0.019	0.0203	No	0.4867	No
2/13/23 10:03	0.468	0.017	0.0191	No	0.4891	No
2/13/23 10:04	0.466	0.019	0.0192	No	0.4908	No
2/13/23 10:05	0.451	0.019	0.0193	No	0.4904	No
2/13/23 10:06	0.453	0.016	0.0195	No	0.4903	No
2/13/23 10:07	0.454	0.013	0.0189	No	0.477	No
2/13/23 10:08	0.456	0.016	0.0191	No	0.4724	No
2/13/23 10:09	0.463	0.018	0.0193	No	0.4697	No
2/13/23 10:10	0.462	0.014	0.0193	No	0.468	No
2/13/23 10:11	0.457	0.014	0.019	No	0.466	No
2/13/23 10:12	0.457	0.012	0.0186	No	0.4649	No
2/13/23 10:13	0.456	0.013	0.0183	No	0.4625	No
2/13/23 10:14	0.46	0.013	0.0175	No	0.4608	No
2/13/23 10:15	0.461	0.015	0.0161	No	0.4601	No
2/13/23 10:16	0.454	0.016	0.0156	No	0.4586	No
2/13/23 10:17	0.468	0.016	0.0154	No	0.4591	No
2/13/23 10:18	0.463	0.054	0.0179	No	0.4587	No
2/13/23 10:19	0.46	0.019	0.0179	No	0.4583	No
2/13/23 10:20	0.465	0.027	0.0184	No	0.4593	No
2/13/23 10:21	0.457	0.015	0.0183	No	0.4595	No
2/13/23 10:22	0.47	0.012	0.0183	No	0.4606	No
2/13/23 10:23	0.468	0.013	0.0181	No	0.4614	No
2/13/23 10:24	0.464	0.021	0.0183	No	0.4615	No
2/13/23 10:25	0.456	0.019	0.0186	No	0.4611	No
2/13/23 10:26	0.459	0.021	0.0191	No	0.4612	No
2/13/23 10:27	0.458	0.062	0.0224	No	0.4613	No
2/13/23 10:28	0.456	0.073	0.0264	No	0.4613	No
2/13/23 10:29	0.453	0.041	0.0283	No	0.4608	No

Upwind Station						
Time	Instaneous VOC (ppm)	Instaneous Mass Conc. Total (mg/m ³)	Mass Conc. Total mg/m ³ AVG 15m (mg/m ³)	Dust Exceedance	VOC ppm AVG 15m (ppm)	VOC Exceedance
2/13/23 10:30	0.455	0.035	0.0296	No	0.4604	No
2/13/23 10:31	0.439	0.046	0.0316	No	0.4594	No
2/13/23 10:32	0.432	0.014	0.0315	No	0.457	No
2/13/23 10:33	0.427	0.012	0.0287	No	0.4546	No
2/13/23 10:34	0.463	0.013	0.0283	No	0.4548	No
2/13/23 10:35	0.456	0.012	0.0273	No	0.4542	No
2/13/23 10:36	0.453	0.014	0.0272	No	0.4539	No
2/13/23 10:37	0.453	0.012	0.0272	No	0.4528	No
2/13/23 10:38	0.454	0.011	0.0271	No	0.4519	No
2/13/23 10:39	0.459	0.01	0.0263	No	0.4515	No
2/13/23 10:40	0.464	0.01	0.0257	No	0.4521	No
2/13/23 10:41	0.472	0.011	0.0251	No	0.4529	No
2/13/23 10:42	0.477	0.016	0.022	No	0.4542	No
2/13/23 10:43	0.58	0.013	0.018	No	0.4625	No
2/13/23 10:44	0.587	0.012	0.0161	No	0.4714	No
2/13/23 10:45	0.577	0.012	0.0145	No	0.4795	No
2/13/23 10:46	0.59	0.012	0.0123	No	0.4896	No
2/13/23 10:47	0.597	0.011	0.0121	No	0.5006	No
2/13/23 10:48	0.571	0.011	0.012	No	0.5102	No
2/13/23 10:49	0.578	0.01	0.0118	No	0.5179	No
2/13/23 10:50	0.574	0.012	0.0118	No	0.5257	No
2/13/23 10:51	0.568	0.011	0.0116	No	0.5334	No
2/13/23 10:52	0.579	0.015	0.0118	No	0.5418	No
2/13/23 10:53	0.552	0.012	0.0119	No	0.5483	No
2/13/23 10:54	0.528	0.017	0.0123	No	0.5529	No
2/13/23 10:55	0.533	0.01	0.0123	No	0.5575	No
2/13/23 10:56	0.533	0.011	0.0123	No	0.5616	No
2/13/23 10:57	0.526	0.029	0.0132	No	0.5649	No
2/13/23 10:58	0.513	0.015	0.0133	No	0.5604	No
2/13/23 10:59	0.509	0.009	0.0131	No	0.5552	No
2/13/23 11:00	0.515	0.011	0.0131	No	0.5511	No
2/13/23 11:01	0.513	0.01	0.0129	No	0.5459	No
2/13/23 11:02	0.513	0.01	0.0129	No	0.5403	No
2/13/23 11:03	0.494	0.012	0.0129	No	0.5352	No
2/13/23 11:04	0.486	0.01	0.0129	No	0.5291	No
2/13/23 11:05	0.492	0.011	0.0129	No	0.5236	No
2/13/23 11:06	0.496	0.01	0.0128	No	0.5188	No
2/13/23 11:07	0.492	0.009	0.0124	No	0.513	No
2/13/23 11:08	0.486	0.01	0.0123	No	0.5086	No
2/13/23 11:09	0.501	0.009	0.0117	No	0.5068	No
2/13/23 11:10	0.506	0.012	0.0119	No	0.505	No
2/13/23 11:11	0.508	0.013	0.012	No	0.5033	No
2/13/23 11:12	0.51	0.071	0.0148	No	0.5023	No
2/13/23 11:13	0.511	0.35	0.0371	No	0.5021	No
2/13/23 11:14	0.52	0.014	0.0375	No	0.5029	No
2/13/23 11:15	0.526	0.017	0.0379	No	0.5036	No
2/13/23 11:16	0.527	0.026	0.0389	No	0.5045	No
2/13/23 11:17	0.524	0.029	0.0402	No	0.5053	No
2/13/23 11:18	0.517	0.021	0.0408	No	0.5068	No
2/13/23 11:19	0.521	0.016	0.0412	No	0.5091	No
2/13/23 11:20	0.515	0.018	0.0417	No	0.5107	No
2/13/23 11:21	0.532	0.028	0.0429	No	0.5131	No

Upwind Station						
Time	Instaneous VOC (ppm)	Instaneous Mass Conc. Total (mg/m ³)	Mass Conc. Total mg/m ³ AVG 15m (mg/m ³)	Dust Exceedance	VOC ppm AVG 15m (ppm)	VOC Exceedance
2/13/23 11:22	0.519	0.043	0.0451	No	0.5149	No
2/13/23 11:23	0.521	0.028	0.0463	No	0.5172	No
2/13/23 11:24	0.524	0.011	0.0465	No	0.5187	No
2/13/23 11:25	0.525	0.015	0.0467	No	0.52	No
2/13/23 11:26	0.532	0.027	0.0476	No	0.5216	No
2/13/23 11:27	0.538	0.018	0.0441	No	0.5235	No
2/13/23 11:28	0.54	0.017	0.0219	No	0.5254	No
2/13/23 11:29	0.53	0.025	0.0226	No	0.5261	No
2/13/23 11:30	0.53	0.013	0.0223	No	0.5263	No
2/13/23 11:31	0.533	0.011	0.0213	No	0.5267	No
2/13/23 11:32	0.541	0.012	0.0202	No	0.5279	No
2/13/23 11:33	0.536	0.011	0.0195	No	0.5291	No
2/13/23 11:34	0.524	0.024	0.0201	No	0.5293	No
2/13/23 11:35	0.524	0.017	0.02	No	0.5299	No
2/13/23 11:36	0.523	0.026	0.0199	No	0.5293	No
2/13/23 11:37	0.515	0.045	0.02	No	0.5291	No
2/13/23 11:38	0.502	0.016	0.0192	No	0.5278	No
2/13/23 11:39	0.496	0.012	0.0193	No	0.5259	No
2/13/23 11:40	0.493	0.013	0.0191	No	0.5238	No
2/13/23 11:41	0.502	0.017	0.0185	No	0.5218	No
2/13/23 11:42	0.512	0.013	0.0181	No	0.5201	No
2/13/23 11:43	0.512	0.016	0.0181	No	0.5182	No
2/13/23 11:44	0.504	0.015	0.0174	No	0.5165	No
2/13/23 11:45	0.51	0.057	0.0203	No	0.5151	No
2/13/23 11:46	0.507	0.025	0.0213	No	0.5134	No
2/13/23 11:47	0.506	0.012	0.0213	No	0.5111	No
2/13/23 11:48	0.509	0.011	0.0213	No	0.5093	No
2/13/23 11:49	0.511	0.01	0.0203	No	0.5084	No
2/13/23 11:50	0.521	0.009	0.0198	No	0.5082	No
2/13/23 11:51	0.527	0.008	0.0186	No	0.5085	No
2/13/23 11:52	0.525	0.009	0.0162	No	0.5091	No
2/13/23 11:53	0.535	0.008	0.0157	No	0.5113	No
2/13/23 11:54	0.538	0.009	0.0155	No	0.5141	No
2/13/23 11:55	0.546	0.01	0.0153	No	0.5177	No
2/13/23 11:56	0.542	0.008	0.0147	No	0.5203	No
2/13/23 11:57	0.546	0.009	0.0144	No	0.5226	No
2/13/23 11:58	0.552	0.008	0.0139	No	0.5253	No
2/13/23 11:59	0.55	0.008	0.0134	No	0.5283	No
2/13/23 12:00	0.555	0.008	0.0101	No	0.5313	No
2/13/23 12:01	0.565	0.009	0.0091	No	0.5352	No
2/13/23 12:02	0.564	0.008	0.0088	No	0.5391	No
2/13/23 12:03	0.566	0.008	0.0086	No	0.5429	No
2/13/23 12:04	0.566	0.011	0.0087	No	0.5465	No
2/13/23 12:05	0.575	0.009	0.0087	No	0.5501	No
2/13/23 12:06	0.578	0.012	0.0089	No	0.5535	No
2/13/23 12:07	0.579	0.01	0.009	No	0.5571	No
2/13/23 12:08	0.576	0.01	0.0091	No	0.5599	No
2/13/23 12:09	0.586	0.009	0.0091	No	0.5631	No
2/13/23 12:10	0.591	0.011	0.0092	No	0.5661	No
2/13/23 12:11	0.592	0.011	0.0094	No	0.5694	No
2/13/23 12:12	0.597	0.009	0.0094	No	0.5728	No
2/13/23 12:13	0.601	0.014	0.0098	No	0.5761	No

Upwind Station						
Time	Instaneous VOC (ppm)	Instaneous Mass Conc. Total (mg/m ³)	Mass Conc. Total mg/m ³ AVG 15m (mg/m ³)	Dust Exceedance	VOC ppm AVG 15m (ppm)	VOC Exceedance
2/13/23 12:14	0.597	0.011	0.01	No	0.5792	No
2/13/23 12:15	0.6	0.018	0.0107	No	0.5822	No
2/13/23 12:16	0.616	0.012	0.0109	No	0.5856	No
2/13/23 12:17	0.61	0.009	0.0109	No	0.5887	No
2/13/23 12:18	0.612	0.008	0.0109	No	0.5917	No
2/13/23 12:19	0.614	0.009	0.0108	No	0.5949	No
2/13/23 12:20	0.618	0.008	0.0107	No	0.5978	No
2/13/23 12:21	0.62	0.013	0.0108	No	0.6006	No
2/13/23 12:22	0.624	0.016	0.0112	No	0.6036	No
2/13/23 12:23	0.626	0.018	0.0117	No	0.6069	No
2/13/23 12:24	0.633	0.008	0.0117	No	0.6101	No
2/13/23 12:25	0.636	0.007	0.0114	No	0.6131	No
2/13/23 12:26	0.629	0.007	0.0111	No	0.6155	No
2/13/23 12:27	0.628	0.007	0.011	No	0.6176	No
2/13/23 12:28	0.63	0.008	0.0106	No	0.6195	No
2/13/23 12:29	0.631	0.007	0.0103	No	0.6218	No
2/13/23 12:30	0.633	0.007	0.0096	No	0.624	No
2/13/23 12:31	0.626	0.008	0.0093	No	0.6247	No
2/13/23 12:32	0.658	0.009	0.0093	No	0.6279	No
2/13/23 12:33	0.639	0.011	0.0095	No	0.6297	No
2/13/23 12:34	0.646	0.012	0.0097	No	0.6318	No
2/13/23 12:35	0.643	0.009	0.0098	No	0.6335	No
2/13/23 12:36	0.646	0.008	0.0095	No	0.6352	No
2/13/23 12:37	0.641	0.008	0.0089	No	0.6363	No
2/13/23 12:38	0.653	0.009	0.0083	No	0.6381	No
2/13/23 12:39	0.651	0.009	0.0084	No	0.6393	No
2/13/23 12:40	0.651	0.052	0.0114	No	0.6403	No
2/13/23 12:41	0.641	0.01	0.0116	No	0.6411	No
2/13/23 12:42	0.636	0.012	0.0119	No	0.6417	No
2/13/23 12:43	0.651	0.009	0.012	No	0.6431	No
2/13/23 12:44	0.657	0.01	0.0122	No	0.6448	No
2/13/23 12:45	0.653	0.009	0.0123	No	0.6461	No
2/13/23 12:46	0.652	0.009	0.0124	No	0.6479	No
2/13/23 12:47	0.647	0.008	0.0123	No	0.6471	No
2/13/23 12:48	0.649	0.018	0.0128	No	0.6478	No
2/13/23 12:49	0.645	0.008	0.0125	No	0.6477	No
2/13/23 12:50	0.658	0.009	0.0125	No	0.6487	No
2/13/23 12:51	0.649	0.015	0.013	No	0.6489	No
2/13/23 12:52	0.658	0.01	0.0131	No	0.6501	No
2/13/23 12:53	0.661	0.01	0.0132	No	0.6506	No
2/13/23 12:54	0.655	0.013	0.0135	No	0.6509	No
2/13/23 12:55	0.654	0.011	0.0107	No	0.6511	No
2/13/23 12:56	0.654	0.011	0.0108	No	0.6519	No
2/13/23 12:57	0.653	0.013	0.0109	No	0.6531	No
2/13/23 12:58	0.655	0.037	0.0127	No	0.6533	No
2/13/23 12:59	0.702	0.018	0.0133	No	0.6563	No
2/13/23 13:00	0.686	0.027	0.0145	No	0.6585	No
2/13/23 13:01	0.672	0.01	0.0145	No	0.6599	No
2/13/23 13:02	0.66	0.011	0.0147	No	0.6607	No
2/13/23 13:03	0.655	0.011	0.0143	No	0.6611	No
2/13/23 13:04	0.654	0.009	0.0143	No	0.6617	No
2/13/23 13:05	0.655	0.01	0.0144	No	0.6615	No

Upwind Station						
Time	Instaneous VOC (ppm)	Instaneous Mass Conc. Total (mg/m ³)	Mass Conc. Total mg/m ³ AVG 15m (mg/m ³)	Dust Exceedance	VOC ppm AVG 15m (ppm)	VOC Exceedance
2/13/23 13:06	0.664	0.01	0.0141	No	0.6625	No
2/13/23 13:07	0.667	0.01	0.0141	No	0.6631	No
2/13/23 13:08	0.664	0.011	0.0141	No	0.6633	No
2/13/23 13:09	0.657	0.012	0.0141	No	0.6635	No
2/13/23 13:10	0.652	0.01	0.014	No	0.6633	No
2/13/23 13:11	0.658	0.009	0.0139	No	0.6636	No
2/13/23 13:12	0.665	0.009	0.0136	No	0.6644	No
2/13/23 13:13	0.66	0.01	0.0118	No	0.6647	No
2/13/23 13:14	0.654	0.011	0.0113	No	0.6615	No
2/13/23 13:15	0.659	0.016	0.0106	No	0.6597	No
2/13/23 13:16	0.671	0.011	0.0107	No	0.6597	No
2/13/23 13:17	0.651	0.01	0.0106	No	0.6591	No
2/13/23 13:18	0.659	0.01	0.0105	No	0.6593	No
2/13/23 13:19	0.655	0.009	0.0105	No	0.6594	No
2/13/23 13:20	0.655	0.01	0.0105	No	0.6594	No
2/13/23 13:21	0.655	0.03	0.0119	No	0.6588	No
2/13/23 13:22	0.647	0.056	0.0149	No	0.6575	No
2/13/23 13:23	0.643	0.031	0.0163	No	0.6561	No
2/13/23 13:24	0.636	0.032	0.0176	No	0.6547	No
2/13/23 13:25	0.635	0.011	0.0177	No	0.6535	No
2/13/23 13:26	0.646	0.038	0.0196	No	0.6527	No
2/13/23 13:27	0.633	0.028	0.0209	No	0.6506	No
2/13/23 13:28	0.647	0.019	0.0215	No	0.6497	No
2/13/23 13:29	0.638	0.031	0.0228	No	0.6487	No
2/13/23 13:30	0.639	0.021	0.0231	No	0.6473	No
2/13/23 13:31	0.645	0.025	0.0241	No	0.6456	No
2/13/23 13:32	0.633	0.057	0.0272	No	0.6444	No
2/13/23 13:33	0.629	0.024	0.0281	No	0.6424	No
2/13/23 13:34	0.631	0.039	0.0301	No	0.6408	No
2/13/23 13:35	0.626	0.026	0.0312	No	0.6389	No
2/13/23 13:36	0.652	0.026	0.0309	No	0.6387	No
2/13/23 13:37	0.634	0.077	0.0323	No	0.6378	No
2/13/23 13:38	0.631	0.045	0.0333	No	0.637	No
2/13/23 13:39	0.626	0.046	0.0342	No	0.6363	No
2/13/23 13:40	0.623	0.032	0.0356	No	0.6355	No
2/13/23 13:41	0.625	0.018	0.0343	No	0.6341	No
2/13/23 13:42	0.625	0.011	0.0331	No	0.6336	No
2/13/23 13:43	0.627	0.025	0.0335	No	0.6323	No
2/13/23 13:44	0.623	0.033	0.0337	No	0.6313	No
2/13/23 13:45	0.622	0.015	0.0333	No	0.6301	No
2/13/23 13:46	0.642	0.031	0.0337	No	0.6299	No
2/13/23 13:47	0.621	0.048	0.0331	No	0.6291	No
2/13/23 13:48	0.624	0.021	0.0329	No	0.6288	No
2/13/23 13:49	0.623	0.013	0.0311	No	0.6283	No
2/13/23 13:50	0.633	0.01	0.0301	No	0.6287	No
2/13/23 13:51	0.631	0.027	0.0301	No	0.6273	No
2/13/23 13:52	0.627	0.059	0.0289	No	0.6269	No
2/13/23 13:53	0.622	0.035	0.0283	No	0.6263	No
2/13/23 13:54	0.615	0.017	0.0263	No	0.6255	No
2/13/23 13:55	0.617	0.017	0.0253	No	0.6251	No
2/13/23 13:56	0.614	0.028	0.026	No	0.6244	No
2/13/23 13:57	0.6	0.062	0.0294	No	0.6227	No

Upwind Station						
Time	Instaneous VOC (ppm)	Instaneous Mass Conc. Total (mg/m ³)	Mass Conc. Total mg/m ³ AVG 15m (mg/m ³)	Dust Exceedance	VOC ppm AVG 15m (ppm)	VOC Exceedance
2/13/23 13:58	0.608	0.046	0.0308	No	0.6215	No
2/13/23 13:59	0.609	0.026	0.0303	No	0.6205	No
2/13/23 14:00	0.608	0.056	0.0331	No	0.6196	No
2/13/23 14:01	0.592	0.069	0.0356	No	0.6163	No
2/13/23 14:02	0.582	0.038	0.0349	No	0.6137	No
2/13/23 14:03	0.586	0.03	0.0355	No	0.6111	No
2/13/23 14:04	0.583	0.019	0.0359	No	0.6085	No
2/13/23 14:05	0.59	0.015	0.0363	No	0.6056	No
2/13/23 14:06	0.583	0.014	0.0354	No	0.6024	No
2/13/23 14:07	0.595	0.01	0.0321	No	0.6003	No
2/13/23 14:08	0.591	0.011	0.0305	No	0.5982	No
2/13/23 14:09	0.603	0.016	0.0305	No	0.5974	No
2/13/23 14:10	0.599	0.123	0.0375	No	0.5962	No
2/13/23 14:11	0.603	0.038	0.0382	No	0.5955	No
2/13/23 14:12	0.594	0.033	0.0363	No	0.5951	No
2/13/23 14:13	0.596	0.061	0.0373	No	0.5943	No
2/13/23 14:14	0.592	0.015	0.0365	No	0.5931	No
2/13/23 14:15	0.6	0.01	0.0335	No	0.5926	No
2/13/23 14:16	0.596	0.011	0.0296	No	0.5929	No
2/13/23 14:17	0.61	0.011	0.0278	No	0.5947	No
2/13/23 14:18	0.599	0.071	0.0305	No	0.5956	No
2/13/23 14:19	0.607	0.028	0.0311	No	0.5972	No
2/13/23 14:20	0.597	0.013	0.031	No	0.5977	No
2/13/23 14:21	0.595	0.023	0.0316	No	0.5985	No
2/13/23 14:22	0.588	0.02	0.0323	No	0.598	No
2/13/23 14:23	0.597	0.018	0.0327	No	0.5984	No
2/13/23 14:24	0.601	0.01	0.0323	No	0.5983	No
2/13/23 14:25	0.609	0.014	0.0251	No	0.5989	No
2/13/23 14:26	0.607	0.01	0.0232	No	0.5992	No
2/13/23 14:27	0.609	0.019	0.0223	No	0.6002	No
2/13/23 14:28	0.601	0.015	0.0192	No	0.6005	No
2/13/23 14:29	0.594	0.016	0.0193	No	0.6007	No
2/13/23 14:30	0.583	0.206	0.0323	No	0.5995	No
2/13/23 14:31	0.589	0.052	0.0351	No	0.5991	No
2/13/23 14:32	0.614	0.023	0.0359	No	0.5993	No
2/13/23 14:33	0.591	0.018	0.0323	No	0.5988	No
2/13/23 14:34	0.583	0.01	0.0311	No	0.5972	No
2/13/23 14:35	0.581	0.012	0.0311	No	0.5961	No
2/13/23 14:36	0.582	0.009	0.0301	No	0.5953	No
2/13/23 14:37	0.593	0.009	0.0294	No	0.5956	No
2/13/23 14:38	0.602	0.017	0.0293	No	0.5959	No
2/13/23 14:39	0.605	0.02	0.03	No	0.5962	No
2/13/23 14:40	0.596	0.016	0.0301	No	0.5953	No
2/13/23 14:41	0.589	0.016	0.0305	No	0.5941	No
2/13/23 14:42	0.584	0.029	0.0312	No	0.5925	No
2/13/23 14:43	0.594	0.015	0.0312	No	0.592	No
2/13/23 14:44	0.589	0.013	0.031	No	0.5917	No
2/13/23 14:45	0.587	0.043	0.0201	No	0.5919	No
2/13/23 14:46	0.594	0.022	0.0181	No	0.5923	No
2/13/23 14:47	0.591	0.09	0.0226	No	0.5907	No
2/13/23 14:48	0.582	0.048	0.0246	No	0.5901	No
2/13/23 14:49	0.585	0.017	0.0251	No	0.5903	No

Upwind Station

Time	Instaneous VOC (ppm)	Instaneous Mass Conc. Total (mg/m ³)	Mass Conc. Total mg/m ³ AVG 15m (mg/m ³)	Dust Exceedance	VOC ppm AVG 15m (ppm)	VOC Exceedance
2/13/23 14:50	0.582	0.012	0.0251	No	0.5903	No
2/13/23 14:51	0.582	0.013	0.0253	No	0.5903	No
2/13/23 14:52	0.594	0.012	0.0255	No	0.5904	No
2/13/23 14:53	0.596	0.01	0.0251	No	0.59	No
2/13/23 14:54	0.606	0.011	0.0245	No	0.5901	No
2/13/23 14:55	0.608	0.011	0.0241	No	0.5909	No
2/13/23 14:56	0.605	0.014	0.024	No	0.5919	No
2/13/23 14:57	0.627	0.014	0.023	No	0.5948	No

Downwind Station						
Time	Instaneous VOC (ppm)	Instaneous Mass Conc. Total (mg/m ³)	Mass Conc. Total mg/m ³ AVG 15m (mg/m ³)	Dust Exceedance	VOC ppm AVG 15m (ppm)	VOC Exceedance
2/13/2023 7:01	0			No	0	No
2/13/2023 7:02	0	0.024	0.024	No	0	No
2/13/2023 7:03	0	0.019	0.0215	No	0	No
2/13/2023 7:04	0	0.022	0.0217	No	0	No
2/13/2023 7:05	0	0.036	0.0253	No	0	No
2/13/2023 7:06	0	0.024	0.025	No	0	No
2/13/2023 7:07	0	0.016	0.0235	No	0	No
2/13/2023 7:08	0	0.01	0.0216	No	0	No
2/13/2023 7:09	0	0.013	0.0205	No	0	No
2/13/2023 7:10	0	0.013	0.0197	No	0	No
2/13/2023 7:11	0	0.009	0.0186	No	0	No
2/13/2023 7:12	0	0.008	0.0176	No	0	No
2/13/2023 7:13	0	0.011	0.0171	No	0	No
2/13/2023 7:14	0	0.013	0.0168	No	0	No
2/13/2023 7:15	0.004	0.009	0.0162	No	0.0003	No
2/13/2023 7:16	0.018	0.023	0.0167	No	0.0015	No
2/13/2023 7:17	0.033	0.019	0.0163	No	0.0037	No
2/13/2023 7:18	0.003	0.022	0.0165	No	0.0039	No
2/13/2023 7:19	0	0.009	0.0157	No	0.0039	No
2/13/2023 7:20	0.002	0.008	0.0138	No	0.004	No
2/13/2023 7:21	0.004	0.017	0.0133	No	0.0043	No
2/13/2023 7:22	0.011	0.019	0.0135	No	0.005	No
2/13/2023 7:23	0	0.008	0.0134	No	0.005	No
2/13/2023 7:24	0.001	0.004	0.0128	No	0.0051	No
2/13/2023 7:25	0.003	0.004	0.0122	No	0.0053	No
2/13/2023 7:26	0.002	0.002	0.0117	No	0.0054	No
2/13/2023 7:27	0.008	0.003	0.0114	No	0.0059	No
2/13/2023 7:28	0.004	0.004	0.0109	No	0.0062	No
2/13/2023 7:29	0.009	0.003	0.0103	No	0.0068	No
2/13/2023 7:30	0.01	0.003	0.0099	No	0.0072	No
2/13/2023 7:31	0.007	0.006	0.0087	No	0.0065	No
2/13/2023 7:32	0.017	0.006	0.0079	No	0.0054	No
2/13/2023 7:33	0.016	0.003	0.0066	No	0.0063	No
2/13/2023 7:34	0.025	0.006	0.0064	No	0.0079	No
2/13/2023 7:35	0.031	0.006	0.0063	No	0.0099	No
2/13/2023 7:36	0.022	0.001	0.0052	No	0.0111	No
2/13/2023 7:37	0.129	0.003	0.0041	No	0.0189	No
2/13/2023 7:38	0.042	0.009	0.0042	No	0.0217	No
2/13/2023 7:39	0.04	0.018	0.0051	No	0.0243	No
2/13/2023 7:40	0.031	0.004	0.0051	No	0.0262	No
2/13/2023 7:41	0.101	0.003	0.0052	No	0.0328	No
2/13/2023 7:42	0.047	0.003	0.0052	No	0.0354	No
2/13/2023 7:43	0.054	0.007	0.0054	No	0.0387	No
2/13/2023 7:44	0.05	0.005	0.0055	No	0.0415	No
2/13/2023 7:45	0.044	0.004	0.0056	No	0.0437	No
2/13/2023 7:46	0.043	0.004	0.0055	No	0.0461	No
2/13/2023 7:47	0.043	0.004	0.0053	No	0.0479	No
2/13/2023 7:48	0.052	0.005	0.0055	No	0.0503	No
2/13/2023 7:49	0.078	0.004	0.0053	No	0.0538	No
2/13/2023 7:50	0.062	0.004	0.0052	No	0.0559	No
2/13/2023 7:51	0.054	0.004	0.0054	No	0.058	No
2/13/2023 7:52	0.056	0.005	0.0055	No	0.0531	No
2/13/2023 7:53	0.105	0.006	0.0053	No	0.0573	No
2/13/2023 7:54	0.068	0.004	0.0044	No	0.0592	No

Downwind Station						
Time	Instaneous VOC (ppm)	Instaneous Mass Conc. Total (mg/m ³)	Mass Conc. Total mg/m ³ AVG 15m (mg/m ³)	Dust Exceedance	VOC ppm AVG 15m (ppm)	VOC Exceedance
2/13/2023 7:55	0.09	0.004	0.0044	No	0.0631	No
2/13/2023 7:56	0.066	0.004	0.0045	No	0.0608	No
2/13/2023 7:57	0.072	0.006	0.0047	No	0.0625	No
2/13/2023 7:58	0.073	0.007	0.0047	No	0.0637	No
2/13/2023 7:59	0.084	0.007	0.0048	No	0.066	No
2/13/2023 8:00	0.073	0.02	0.0059	No	0.0679	No
2/13/2023 8:01	0.079	0.018	0.0068	No	0.0703	No
2/13/2023 8:02	0.078	0.012	0.0073	No	0.0727	No
2/13/2023 8:03	0.073	0.007	0.0075	No	0.0741	No
2/13/2023 8:04	0.074	0.014	0.0081	No	0.0738	No
2/13/2023 8:05	0.071	0.025	0.0095	No	0.0744	No
2/13/2023 8:06	0.098	0.232	0.0247	No	0.0773	No
2/13/2023 8:07	0.069	0.289	0.0437	No	0.0782	No
2/13/2023 8:08	0.081	0.051	0.0467	No	0.0766	No
2/13/2023 8:09	0.069	0.007	0.0469	No	0.0767	No
2/13/2023 8:10	0.077	0.007	0.0471	No	0.0758	No
2/13/2023 8:11	0.075	0.006	0.0472	No	0.0764	No
2/13/2023 8:12	0.093	0.006	0.0472	No	0.0778	No
2/13/2023 8:13	0.078	0.014	0.0477	No	0.0781	No
2/13/2023 8:14	0.097	0.012	0.048	No	0.079	No
2/13/2023 8:15	0.086	0.017	0.0478	No	0.0799	No
2/13/2023 8:16	0.094	0.007	0.0471	No	0.0809	No
2/13/2023 8:17	0.114	0.299	0.0662	No	0.0833	No
2/13/2023 8:18	0.108	0.263	0.0833	No	0.0856	No
2/13/2023 8:19	0.104	0.021	0.0837	No	0.0876	No
2/13/2023 8:20	0.099	0.01	0.0827	No	0.0895	No
2/13/2023 8:21	0.092	0.006	0.0677	No	0.0891	No
2/13/2023 8:22	0.096	0.007	0.0489	No	0.0909	No
2/13/2023 8:23	0.104	0.006	0.0459	No	0.0924	No
2/13/2023 8:24	0.119	0.005	0.0457	No	0.0957	No
2/13/2023 8:25	0.145	0.005	0.0456	No	0.1003	No
2/13/2023 8:26	0.198	0.007	0.0457	No	0.1085	No
2/13/2023 8:27	0.235	0.005	0.0456	No	0.1179	No
2/13/2023 8:28	0.258	0.007	0.0451	No	0.1299	No
2/13/2023 8:29	0.166	0.007	0.0448	No	0.1345	No
2/13/2023 8:30	0.146	0.005	0.044	No	0.1385	No
2/13/2023 8:31	0.175	0.004	0.0438	No	0.1439	No
2/13/2023 8:32	0.202	0.006	0.0243	No	0.1498	No
2/13/2023 8:33	0.192	0.005	0.0071	No	0.1554	No
2/13/2023 8:34	0.194	0.005	0.006	No	0.1614	No
2/13/2023 8:35	0.163	0.007	0.0058	No	0.1657	No
2/13/2023 8:36	0.136	0.006	0.0058	No	0.1686	No
2/13/2023 8:37	0.159	0.013	0.0062	No	0.1728	No
2/13/2023 8:38	0.149	0.006	0.0062	No	0.1758	No
2/13/2023 8:39	0.158	0.005	0.0062	No	0.1784	No
2/13/2023 8:40	0.151	0.005	0.0062	No	0.1788	No
2/13/2023 8:41	0.147	0.006	0.0061	No	0.1754	No
2/13/2023 8:42	0.144	0.009	0.0064	No	0.1693	No
2/13/2023 8:43	0.147	0.006	0.0063	No	0.1619	No
2/13/2023 8:44	0.147	0.003	0.0061	No	0.1607	No
2/13/2023 8:45	0.196	0.131	0.0145	No	0.164	No
2/13/2023 8:46	0.173	0.008	0.0147	No	0.1639	No
2/13/2023 8:47	0.182	0.017	0.0155	No	0.1625	No
2/13/2023 8:48	0.184	0.005	0.0155	No	0.162	No

Downwind Station						
Time	Instaneous VOC (ppm)	Instaneous Mass Conc. Total (mg/m ³)	Mass Conc. Total mg/m ³ AVG 15m (mg/m ³)	Dust Exceedance	VOC ppm AVG 15m (ppm)	VOC Exceedance
2/13/2023 8:49	0.163	0.003	0.0153	No	0.1599	No
2/13/2023 8:50	0.155	0.006	0.0153	No	0.1594	No
2/13/2023 8:51	0.16	0.008	0.0154	No	0.161	No
2/13/2023 8:52	0.167	0.006	0.0149	No	0.1615	No
2/13/2023 8:53	0.15	0.004	0.0148	No	0.1616	No
2/13/2023 8:54	0.144	0.004	0.0147	No	0.1607	No
2/13/2023 8:55	0.154	0.004	0.0147	No	0.1609	No
2/13/2023 8:56	0.162	0.005	0.0146	No	0.1619	No
2/13/2023 8:57	0.152	0.005	0.0143	No	0.1624	No
2/13/2023 8:58	0.143	0.004	0.0142	No	0.1621	No
2/13/2023 8:59	0.16	0.004	0.0143	No	0.163	No
2/13/2023 9:00	0.15	0.005	0.0059	No	0.1599	No
2/13/2023 9:01	0.156	0.003	0.0055	No	0.1588	No
2/13/2023 9:02	0.154	0.004	0.0047	No	0.1569	No
2/13/2023 9:03	0.134	0.003	0.0045	No	0.1536	No
2/13/2023 9:04	0.158	0.002	0.0045	No	0.1533	No
2/13/2023 9:05	0.143	0.004	0.0043	No	0.1525	No
2/13/2023 9:06	0.19	0.002	0.0039	No	0.1545	No
2/13/2023 9:07	0.195	0.002	0.0037	No	0.1563	No
2/13/2023 9:08	0.168	0.011	0.0041	No	0.1575	No
2/13/2023 9:09	0.144	0.005	0.0042	No	0.1575	No
2/13/2023 9:10	0.159	0.004	0.0042	No	0.1579	No
2/13/2023 9:11	0.157	0.005	0.0042	No	0.1575	No
2/13/2023 9:12	0.168	0.006	0.0043	No	0.1586	No
2/13/2023 9:13	0.14	0.003	0.0042	No	0.1584	No
2/13/2023 9:14	0.134	0.002	0.0041	No	0.1567	No
2/13/2023 9:15	0.144	0.005	0.0041	No	0.1563	No
2/13/2023 9:16	0.149	0.008	0.0044	No	0.1558	No
2/13/2023 9:17	0.153	0.008	0.0047	No	0.1557	No
2/13/2023 9:18	0.151	0.006	0.0049	No	0.1569	No
2/13/2023 9:19	0.158	0.006	0.0051	No	0.1569	No
2/13/2023 9:20	0.134	0.012	0.0057	No	0.1563	No
2/13/2023 9:21	0.134	0.007	0.006	No	0.1525	No
2/13/2023 9:22	0.138	0.007	0.0063	No	0.1487	No
2/13/2023 9:23	0.13	0.005	0.0059	No	0.1462	No
2/13/2023 9:24	0.156	0.004	0.0059	No	0.147	No
2/13/2023 9:25	0.136	0.007	0.0061	No	0.1455	No
2/13/2023 9:26	0.142	0.005	0.0061	No	0.1445	No
2/13/2023 9:27	0.157	0.009	0.0063	No	0.1437	No
2/13/2023 9:28	0.145	0.007	0.0065	No	0.1441	No
2/13/2023 9:29	0.149	0.007	0.0069	No	0.1451	No
2/13/2023 9:30	0.134	0.007	0.007	No	0.1444	No
2/13/2023 9:31	0.152	0.005	0.0068	No	0.1446	No
2/13/2023 9:32	0.154	0.005	0.0066	No	0.1447	No
2/13/2023 9:33	0.144	0.006	0.0066	No	0.1442	No
2/13/2023 9:34	0.143	0.006	0.0066	No	0.1432	No
2/13/2023 9:35	0.153	0.007	0.0063	No	0.1445	No
2/13/2023 9:36	0.137	0.008	0.0063	No	0.1447	No
2/13/2023 9:37	0.148	0.006	0.0063	No	0.1453	No
2/13/2023 9:38	0.144	0.008	0.0065	No	0.1463	No
2/13/2023 9:39	0.145	0.006	0.0066	No	0.1455	No
2/13/2023 9:40	0.143	0.005	0.0065	No	0.146	No
2/13/2023 9:41	0.146	0.007	0.0066	No	0.1463	No
2/13/2023 9:42	0.152	0.007	0.0065	No	0.1459	No

Downwind Station						
Time	Instaneous VOC (ppm)	Instaneous Mass Conc. Total (mg/m ³)	Mass Conc. Total mg/m ³ AVG 15m (mg/m ³)	Dust Exceedance	VOC ppm AVG 15m (ppm)	VOC Exceedance
2/13/2023 9:43	0.144	0.006	0.0064	No	0.1459	No
2/13/2023 9:44	0.145	0.006	0.0063	No	0.1456	No
2/13/2023 9:45	0.147	0.005	0.0062	No	0.1465	No
2/13/2023 9:46	0.145	0.006	0.0063	No	0.146	No
2/13/2023 9:47	0.148	0.004	0.0062	No	0.1456	No
2/13/2023 9:48	0.148	0.008	0.0063	No	0.1459	No
2/13/2023 9:49	0.154	0.012	0.0067	No	0.1466	No
2/13/2023 9:50	0.161	0.006	0.0067	No	0.1471	No
2/13/2023 9:51	0.151	0.006	0.0065	No	0.1481	No
2/13/2023 9:52	0.185	0.006	0.0065	No	0.1505	No
2/13/2023 9:53	0.165	0.006	0.0064	No	0.1519	No
2/13/2023 9:54	0.163	0.008	0.0065	No	0.1531	No
2/13/2023 9:55	0.163	0.008	0.0067	No	0.1545	No
2/13/2023 9:56	0.159	0.007	0.0067	No	0.1553	No
2/13/2023 9:57	0.159	0.007	0.0067	No	0.1558	No
2/13/2023 9:58	0.17	0.01	0.007	No	0.1575	No
2/13/2023 9:59	0.166	0.008	0.0071	No	0.1589	No
2/13/2023 10:00	0.176	0.009	0.0074	No	0.1609	No
2/13/2023 10:01	0.155	0.011	0.0077	No	0.1615	No
2/13/2023 10:02	0.156	0.007	0.0079	No	0.1621	No
2/13/2023 10:03	0.158	0.009	0.008	No	0.1627	No
2/13/2023 10:04	0.163	0.005	0.0075	No	0.1633	No
2/13/2023 10:05	0.161	0.005	0.0075	No	0.1633	No
2/13/2023 10:06	0.163	0.006	0.0075	No	0.1641	No
2/13/2023 10:07	0.193	0.005	0.0074	No	0.1647	No
2/13/2023 10:08	0.167	0.006	0.0074	No	0.1648	No
2/13/2023 10:09	0.171	0.007	0.0073	No	0.1653	No
2/13/2023 10:10	0.169	0.006	0.0072	No	0.1657	No
2/13/2023 10:11	0.164	0.005	0.0071	No	0.1661	No
2/13/2023 10:12	0.165	0.005	0.0069	No	0.1665	No
2/13/2023 10:13	0.17	0.004	0.0065	No	0.1665	No
2/13/2023 10:14	0.167	0.005	0.0063	No	0.1665	No
2/13/2023 10:15	0.168	0.006	0.0061	No	0.166	No
2/13/2023 10:16	0.166	0.006	0.0058	No	0.1667	No
2/13/2023 10:17	0.166	0.008	0.0059	No	0.1674	No
2/13/2023 10:18	0.165	0.004	0.0055	No	0.1679	No
2/13/2023 10:19	0.171	0.004	0.0055	No	0.1684	No
2/13/2023 10:20	0.164	0.01	0.0058	No	0.1686	No
2/13/2023 10:21	0.176	0.018	0.0066	No	0.1695	No
2/13/2023 10:22	0.179	0.009	0.0069	No	0.1685	No
2/13/2023 10:23	0.177	0.01	0.0071	No	0.1692	No
2/13/2023 10:24	0.232	0.009	0.0073	No	0.1733	No
2/13/2023 10:25	0.196	0.009	0.0075	No	0.1751	No
2/13/2023 10:26	0.189	0.009	0.0077	No	0.1767	No
2/13/2023 10:27	0.18	0.017	0.0085	No	0.1777	No
2/13/2023 10:28	0.172	0.024	0.0099	No	0.1779	No
2/13/2023 10:29	0.172	0.008	0.0101	No	0.1782	No
2/13/2023 10:30	0.173	0.012	0.0105	No	0.1785	No
2/13/2023 10:31	0.185	0.008	0.0106	No	0.1798	No
2/13/2023 10:32	0.176	0.009	0.0107	No	0.1805	No
2/13/2023 10:33	0.18	0.006	0.0108	No	0.1815	No
2/13/2023 10:34	0.178	0.006	0.0109	No	0.1819	No
2/13/2023 10:35	0.189	0.006	0.0107	No	0.1836	No
2/13/2023 10:36	0.173	0.006	0.0099	No	0.1834	No

Downwind Station						
Time	Instaneous VOC (ppm)	Instaneous Mass Conc. Total (mg/m ³)	Mass Conc. Total mg/m ³ AVG 15m (mg/m ³)	Dust Exceedance	VOC ppm AVG 15m (ppm)	VOC Exceedance
2/13/2023 10:37	0.189	0.004	0.0095	No	0.1841	No
2/13/2023 10:38	0.19	0.004	0.0091	No	0.1849	No
2/13/2023 10:39	0.187	0.004	0.0088	No	0.1819	No
2/13/2023 10:40	0.179	0.005	0.0085	No	0.1808	No
2/13/2023 10:41	0.183	0.005	0.0083	No	0.1804	No
2/13/2023 10:42	0.183	0.004	0.0074	No	0.1806	No
2/13/2023 10:43	0.192	0.005	0.0061	No	0.1819	No
2/13/2023 10:44	0.197	0.005	0.0059	No	0.1836	No
2/13/2023 10:45	0.192	0.006	0.0055	No	0.1849	No
2/13/2023 10:46	0.193	0.005	0.0053	No	0.1854	No
2/13/2023 10:47	0.205	0.007	0.0052	No	0.1873	No
2/13/2023 10:48	0.187	0.006	0.0052	No	0.1878	No
2/13/2023 10:49	0.189	0.005	0.0051	No	0.1885	No
2/13/2023 10:50	0.183	0.006	0.0051	No	0.1881	No
2/13/2023 10:51	0.193	0.009	0.0053	No	0.1895	No
2/13/2023 10:52	0.183	0.006	0.0055	No	0.1891	No
2/13/2023 10:53	0.204	0.006	0.0056	No	0.19	No
2/13/2023 10:54	0.19	0.006	0.0057	No	0.1902	No
2/13/2023 10:55	0.187	0.006	0.0058	No	0.1907	No
2/13/2023 10:56	0.184	0.005	0.0058	No	0.1908	No
2/13/2023 10:57	0.191	0.008	0.0061	No	0.1913	No
2/13/2023 10:58	0.187	0.006	0.0061	No	0.191	No
2/13/2023 10:59	0.176	0.005	0.0061	No	0.1896	No
2/13/2023 11:00	0.186	0.005	0.0061	No	0.1892	No
2/13/2023 11:01	0.177	0.005	0.0061	No	0.1881	No
2/13/2023 11:02	0.186	0.005	0.0059	No	0.1869	No
2/13/2023 11:03	0.186	0.006	0.0059	No	0.1868	No
2/13/2023 11:04	0.185	0.006	0.006	No	0.1865	No
2/13/2023 11:05	0.176	0.006	0.006	No	0.1861	No
2/13/2023 11:06	0.178	0.005	0.0057	No	0.1851	No
2/13/2023 11:07	0.182	0.005	0.0057	No	0.185	No
2/13/2023 11:08	0.185	0.005	0.0056	No	0.1837	No
2/13/2023 11:09	0.182	0.005	0.0055	No	0.1832	No
2/13/2023 11:10	0.191	0.005	0.0055	No	0.1835	No
2/13/2023 11:11	0.188	0.005	0.0055	No	0.1837	No
2/13/2023 11:12	0.179	0.007	0.0054	No	0.1829	No
2/13/2023 11:13	0.188	0.007	0.0055	No	0.183	No
2/13/2023 11:14	0.197	0.007	0.0056	No	0.1844	No
2/13/2023 11:15	0.207	0.008	0.0058	No	0.1858	No
2/13/2023 11:16	0.186	0.029	0.0074	No	0.1864	No
2/13/2023 11:17	0.182	0.014	0.008	No	0.1861	No
2/13/2023 11:18	0.184	0.012	0.0084	No	0.186	No
2/13/2023 11:19	0.181	0.008	0.0085	No	0.1857	No
2/13/2023 11:20	0.18	0.006	0.0085	No	0.186	No
2/13/2023 11:21	0.177	0.005	0.0085	No	0.1859	No
2/13/2023 11:22	0.184	0.008	0.0087	No	0.1861	No
2/13/2023 11:23	0.193	0.017	0.0095	No	0.1866	No
2/13/2023 11:24	0.182	0.011	0.0099	No	0.1866	No
2/13/2023 11:25	0.176	0.007	0.0101	No	0.1856	No
2/13/2023 11:26	0.18	0.005	0.0101	No	0.1851	No
2/13/2023 11:27	0.178	0.008	0.0101	No	0.185	No
2/13/2023 11:28	0.182	0.006	0.0101	No	0.1846	No
2/13/2023 11:29	0.192	0.006	0.01	No	0.1843	No
2/13/2023 11:30	0.192	0.011	0.0102	No	0.1833	No

Downwind Station						
Time	Instaneous VOC (ppm)	Instaneous Mass Conc. Total (mg/m ³)	Mass Conc. Total mg/m ³ AVG 15m (mg/m ³)	Dust Exceedance	VOC ppm AVG 15m (ppm)	VOC Exceedance
2/13/2023 11:31	0.188	0.006	0.0087	No	0.1834	No
2/13/2023 11:32	0.19	0.005	0.0081	No	0.1839	No
2/13/2023 11:33	0.191	0.006	0.0077	No	0.1844	No
2/13/2023 11:34	0.198	0.024	0.0087	No	0.1855	No
2/13/2023 11:35	0.189	0.013	0.0092	No	0.1861	No
2/13/2023 11:36	0.203	0.009	0.0095	No	0.1879	No
2/13/2023 11:37	0.181	0.018	0.0101	No	0.1877	No
2/13/2023 11:38	0.176	0.008	0.0095	No	0.1865	No
2/13/2023 11:39	0.192	0.011	0.0095	No	0.1872	No
2/13/2023 11:40	0.184	0.009	0.0097	No	0.1877	No
2/13/2023 11:41	0.175	0.009	0.0099	No	0.1874	No
2/13/2023 11:42	0.175	0.008	0.0099	No	0.1872	No
2/13/2023 11:43	0.173	0.006	0.0099	No	0.1866	No
2/13/2023 11:44	0.189	0.015	0.0105	No	0.1864	No
2/13/2023 11:45	0.183	0.021	0.0112	No	0.1858	No
2/13/2023 11:46	0.173	0.021	0.0122	No	0.1848	No
2/13/2023 11:47	0.171	0.022	0.0133	No	0.1835	No
2/13/2023 11:48	0.173	0.011	0.0137	No	0.1823	No
2/13/2023 11:49	0.182	0.005	0.0124	No	0.1813	No
2/13/2023 11:50	0.184	0.006	0.0119	No	0.1809	No
2/13/2023 11:51	0.179	0.007	0.0118	No	0.1793	No
2/13/2023 11:52	0.18	0.005	0.0109	No	0.1793	No
2/13/2023 11:53	0.18	0.005	0.0107	No	0.1795	No
2/13/2023 11:54	0.188	0.006	0.0104	No	0.1793	No
2/13/2023 11:55	0.198	0.009	0.0104	No	0.1802	No
2/13/2023 11:56	0.183	0.006	0.0102	No	0.1807	No
2/13/2023 11:57	0.181	0.005	0.01	No	0.1811	No
2/13/2023 11:58	0.185	0.005	0.0099	No	0.1819	No
2/13/2023 11:59	0.184	0.004	0.0092	No	0.1816	No
2/13/2023 12:00	0.188	0.004	0.0081	No	0.1819	No
2/13/2023 12:01	0.192	0.005	0.007	No	0.1832	No
2/13/2023 12:02	0.19	0.005	0.0059	No	0.1845	No
2/13/2023 12:03	0.184	0.004	0.0054	No	0.1852	No
2/13/2023 12:04	0.185	0.004	0.0053	No	0.1854	No
2/13/2023 12:05	0.185	0.004	0.0052	No	0.1855	No
2/13/2023 12:06	0.216	0.005	0.0051	No	0.1879	No
2/13/2023 12:07	0.19	0.005	0.0051	No	0.1886	No
2/13/2023 12:08	0.186	0.003	0.0049	No	0.189	No
2/13/2023 12:09	0.23	0.007	0.005	No	0.1918	No
2/13/2023 12:10	0.232	0.007	0.0049	No	0.1941	No
2/13/2023 12:11	0.208	0.007	0.0049	No	0.1957	No
2/13/2023 12:12	0.202	0.005	0.0049	No	0.1971	No
2/13/2023 12:13	0.202	0.005	0.0049	No	0.1983	No
2/13/2023 12:14	0.205	0.005	0.005	No	0.1997	No
2/13/2023 12:15	0.219	0.005	0.0051	No	0.2017	No
2/13/2023 12:16	0.205	0.005	0.0051	No	0.2026	No
2/13/2023 12:17	0.199	0.006	0.0051	No	0.2032	No
2/13/2023 12:18	0.189	0.004	0.0051	No	0.2035	No
2/13/2023 12:19	0.193	0.004	0.0051	No	0.2041	No
2/13/2023 12:20	0.206	0.004	0.0051	No	0.2055	No
2/13/2023 12:21	0.197	0.003	0.005	No	0.2042	No
2/13/2023 12:22	0.198	0.003	0.0049	No	0.2047	No
2/13/2023 12:23	0.211	0.003	0.0049	No	0.2064	No
2/13/2023 12:24	0.205	0.004	0.0047	No	0.2047	No

Downwind Station						
Time	Instaneous VOC (ppm)	Instaneous Mass Conc. Total (mg/m ³)	Mass Conc. Total mg/m ³ AVG 15m (mg/m ³)	Dust Exceedance	VOC ppm AVG 15m (ppm)	VOC Exceedance
2/13/2023 12:25	0.202	0.002	0.0043	No	0.2027	No
2/13/2023 12:26	0.2	0.002	0.004	No	0.2022	No
2/13/2023 12:27	0.196	0.002	0.0038	No	0.2018	No
2/13/2023 12:28	0.197	0.002	0.0036	No	0.2015	No
2/13/2023 12:29	0.191	0.002	0.0034	No	0.2005	No
2/13/2023 12:30	0.215	0.004	0.0033	No	0.2003	No
2/13/2023 12:31	0.198	0.006	0.0034	No	0.1998	No
2/13/2023 12:32	0.204	0.001	0.0031	No	0.2001	No
2/13/2023 12:33	0.215	0.002	0.0029	No	0.2019	No
2/13/2023 12:34	0.21	0.001	0.0027	No	0.203	No
2/13/2023 12:35	0.208	0.002	0.0026	No	0.2031	No
2/13/2023 12:36	0.199	0.001	0.0025	No	0.2033	No
2/13/2023 12:37	0.21	0.002	0.0024	No	0.2041	No
2/13/2023 12:38	0.217	0.003	0.0024	No	0.2045	No
2/13/2023 12:39	0.21	0.001	0.0022	No	0.2048	No
2/13/2023 12:40	0.218	0.004	0.0023	No	0.2059	No
2/13/2023 12:41	0.213	0.003	0.0024	No	0.2067	No
2/13/2023 12:42	0.205	0.004	0.0025	No	0.2073	No
2/13/2023 12:43	0.198	0.002	0.0025	No	0.2074	No
2/13/2023 12:44	0.222	0.001	0.0025	No	0.2095	No
2/13/2023 12:45	0.214	0.001	0.0023	No	0.2094	No
2/13/2023 12:46	0.209	0.001	0.0019	No	0.2101	No
2/13/2023 12:47	0.199	0	0.0019	No	0.2098	No
2/13/2023 12:48	0.205	0.001	0.0018	No	0.2091	No
2/13/2023 12:49	0.202	0.001	0.0018	No	0.2086	No
2/13/2023 12:50	0.239	0.002	0.0018	No	0.2107	No
2/13/2023 12:51	0.229	0.002	0.0019	No	0.2127	No
2/13/2023 12:52	0.216	0.001	0.0018	No	0.2131	No
2/13/2023 12:53	0.22	0.002	0.0017	No	0.2133	No
2/13/2023 12:54	0.204	0.001	0.0017	No	0.2129	No
2/13/2023 12:55	0.204	0.001	0.0015	No	0.2119	No
2/13/2023 12:56	0.199	0.001	0.0014	No	0.211	No
2/13/2023 12:57	0.203	0.001	0.0012	No	0.2109	No
2/13/2023 12:58	0.209	0.002	0.0012	No	0.2116	No
2/13/2023 12:59	0.211	0.004	0.0014	No	0.2109	No
2/13/2023 13:00	0.222	0.002	0.0015	No	0.2114	No
2/13/2023 13:01	0.227	0.004	0.0017	No	0.2126	No
2/13/2023 13:02	0.238	0.004	0.0019	No	0.2152	No
2/13/2023 13:03	0.225	0.003	0.0021	No	0.2165	No
2/13/2023 13:04	0.219	0.001	0.0021	No	0.2177	No
2/13/2023 13:05	0.215	0.002	0.0021	No	0.2161	No
2/13/2023 13:06	0.235	0.004	0.0022	No	0.2165	No
2/13/2023 13:07	0.243	0.004	0.0024	No	0.2183	No
2/13/2023 13:08	0.236	0.004	0.0025	No	0.2193	No
2/13/2023 13:09	0.221	0.003	0.0027	No	0.2205	No
2/13/2023 13:10	0.215	0.002	0.0027	No	0.2212	No
2/13/2023 13:11	0.22	0.002	0.0028	No	0.2226	No
2/13/2023 13:12	0.221	0.002	0.0029	No	0.2238	No
2/13/2023 13:13	0.225	0.004	0.003	No	0.2249	No
2/13/2023 13:14	0.217	0.004	0.003	No	0.2253	No
2/13/2023 13:15	0.214	0.004	0.0031	No	0.2247	No
2/13/2023 13:16	0.217	0.004	0.0031	No	0.2241	No
2/13/2023 13:17	0.222	0.004	0.0031	No	0.223	No
2/13/2023 13:18	0.215	0.003	0.0031	No	0.2223	No

Downwind Station						
Time	Instaneous VOC (ppm)	Instaneous Mass Conc. Total (mg/m ³)	Mass Conc. Total mg/m ³ AVG 15m (mg/m ³)	Dust Exceedance	VOC ppm AVG 15m (ppm)	VOC Exceedance
2/13/2023 13:19	0.21	0.004	0.0033	No	0.2217	No
2/13/2023 13:20	0.213	0.003	0.0034	No	0.2216	No
2/13/2023 13:21	0.217	0.003	0.0033	No	0.2204	No
2/13/2023 13:22	0.223	0.007	0.0035	No	0.2191	No
2/13/2023 13:23	0.229	0.02	0.0046	No	0.2186	No
2/13/2023 13:24	0.209	0.011	0.0051	No	0.2178	No
2/13/2023 13:25	0.214	0.004	0.0053	No	0.2177	No
2/13/2023 13:26	0.211	0.004	0.0054	No	0.2171	No
2/13/2023 13:27	0.208	0.006	0.0057	No	0.2163	No
2/13/2023 13:28	0.208	0.006	0.0058	No	0.2151	No
2/13/2023 13:29	0.207	0.006	0.0059	No	0.2145	No
2/13/2023 13:30	0.204	0.006	0.0061	No	0.2138	No
2/13/2023 13:31	0.206	0.005	0.0061	No	0.2131	No
2/13/2023 13:32	0.206	0.005	0.0062	No	0.212	No
2/13/2023 13:33	0.209	0.004	0.0063	No	0.2116	No
2/13/2023 13:34	0.21	0.004	0.0063	No	0.2116	No
2/13/2023 13:35	0.21	0.005	0.0064	No	0.2114	No
2/13/2023 13:36	0.223	0.004	0.0065	No	0.2118	No
2/13/2023 13:37	0.214	0.008	0.0065	No	0.2112	No
2/13/2023 13:38	0.218	0.005	0.0055	No	0.2105	No
2/13/2023 13:39	0.215	0.006	0.0052	No	0.2109	No
2/13/2023 13:40	0.219	0.006	0.0053	No	0.2112	No
2/13/2023 13:41	0.213	0.005	0.0054	No	0.2113	No
2/13/2023 13:42	0.223	0.003	0.0052	No	0.2123	No
2/13/2023 13:43	0.21	0.001	0.0049	No	0.2125	No
2/13/2023 13:44	0.209	0.005	0.0048	No	0.2126	No
2/13/2023 13:45	0.209	0.007	0.0049	No	0.2129	No
2/13/2023 13:46	0.213	0.003	0.0047	No	0.2134	No
2/13/2023 13:47	0.207	0.001	0.0045	No	0.2135	No
2/13/2023 13:48	0.216	0.042	0.007	No	0.2139	No
2/13/2023 13:49	0.212	0.016	0.0078	No	0.2141	No
2/13/2023 13:50	0.217	0.022	0.0089	No	0.2145	No
2/13/2023 13:51	0.248	0.029	0.0106	No	0.2162	No
2/13/2023 13:52	0.226	0.019	0.0113	No	0.217	No
2/13/2023 13:53	0.208	0.023	0.0125	No	0.2163	No
2/13/2023 13:54	0.22	0.018	0.0133	No	0.2167	No
2/13/2023 13:55	0.206	0.022	0.0144	No	0.2158	No
2/13/2023 13:56	0.209	0.029	0.016	No	0.2155	No
2/13/2023 13:57	0.203	0.029	0.0177	No	0.2142	No
2/13/2023 13:58	0.202	0.019	0.0189	No	0.2137	No
2/13/2023 13:59	0.193	0.009	0.0192	No	0.2126	No
2/13/2023 14:00	0.205	0.011	0.0195	No	0.2123	No
2/13/2023 14:01	0.209	0.008	0.0198	No	0.2121	No
2/13/2023 14:02	0.194	0.011	0.0205	No	0.2112	No
2/13/2023 14:03	0.196	0.007	0.0181	No	0.2099	No
2/13/2023 14:04	0.2	0.007	0.0175	No	0.2091	No

Downwind Station						
Time	Instaneous VOC (ppm)	Instaneous Mass Conc. Total (mg/m ³)	Mass Conc. Total mg/m ³ AVG 15m (mg/m ³)	Dust Exceedance	VOC ppm AVG 15m (ppm)	VOC Exceedance
2/13/2023 14:05	0.2	0.006	0.0165	No	0.2079	No
2/13/2023 14:06	0.204	0.006	0.0149	No	0.205	No
2/13/2023 14:07	0.215	0.008	0.0142	No	0.2043	No
2/13/2023 14:08	0.209	0.003	0.0129	No	0.2043	No
2/13/2023 14:09	0.205	0.003	0.0119	No	0.2033	No
2/13/2023 14:10	0.22	0.002	0.0105	No	0.2043	No
2/13/2023 14:11	0.216	0.003	0.0088	No	0.2047	No
2/13/2023 14:12	0.209	0.001	0.0069	No	0.2051	No
2/13/2023 14:13	0.209	0.001	0.0057	No	0.2056	No
2/13/2023 14:14	0.208	0.001	0.0052	No	0.2066	No
2/13/2023 14:15	0.219	0.003	0.0047	No	0.2075	No
2/13/2023 14:16	0.231	0.004	0.0044	No	0.209	No
2/13/2023 14:17	0.249	0.005	0.004	No	0.2127	No
2/13/2023 14:18	0.229	0.008	0.0041	No	0.2149	No
2/13/2023 14:19	0.227	0.003	0.0038	No	0.2167	No
2/13/2023 14:20	0.226	0.002	0.0035	No	0.2184	No
2/13/2023 14:21	0.226	0.001	0.0032	No	0.2199	No
2/13/2023 14:22	0.224	0.001	0.0027	No	0.2205	No
2/13/2023 14:23	0.221	0.001	0.0026	No	0.2213	No
2/13/2023 14:24	0.22	0.002	0.0025	No	0.2223	No
2/13/2023 14:25	0.233	0.002	0.0025	No	0.2231	No
2/13/2023 14:26	0.222	0.003	0.0025	No	0.2235	No
2/13/2023 14:27	0.214	0.002	0.0026	No	0.2239	No
2/13/2023 14:28	0.224	0	0.0025	No	0.2249	No
2/13/2023 14:29	0.21	0.002	0.0026	No	0.225	No
2/13/2023 14:30	0.202	0.002	0.0025	No	0.2239	No
2/13/2023 14:31	0.212	0.006	0.0027	No	0.2226	No
2/13/2023 14:32	0.212	0.003	0.0025	No	0.2201	No
2/13/2023 14:33	0.215	0.01	0.0027	No	0.2192	No
2/13/2023 14:34	0.201	0.001	0.0025	No	0.2175	No
2/13/2023 14:35	0.198	0	0.0024	No	0.2156	No
2/13/2023 14:36	0.2	-0.001	0.0023	No	0.2139	No
2/13/2023 14:37	0.203	0	0.0022	No	0.2125	No
2/13/2023 14:38	0.199	0	0.0021	No	0.211	No
2/13/2023 14:39	0.208	0	0.002	No	0.2102	No
2/13/2023 14:40	0.212	0.001	0.0019	No	0.2088	No
2/13/2023 14:41	0.198	0.006	0.0021	No	0.2072	No
2/13/2023 14:42	0.197	0.002	0.0021	No	0.2061	No
2/13/2023 14:43	0.199	0.001	0.0022	No	0.2044	No
2/13/2023 14:44	0.194	0	0.0021	No	0.2033	No
2/13/2023 14:45	0.193	-0.001	0.0019	No	0.2027	No
2/13/2023 14:46	0.19	0.001	0.0015	No	0.2013	No
2/13/2023 14:47	0.197	0.012	0.0021	No	0.2003	No
2/13/2023 14:48	0.2	0.012	0.0023	No	0.1993	No
2/13/2023 14:49	0.21	0.007	0.0027	No	0.1999	No
2/13/2023 14:50	0.206	0.001	0.0027	No	0.2004	No
2/13/2023 14:51	0.199	0	0.0028	No	0.2003	No
2/13/2023 14:52	0.204	0	0.0028	No	0.2004	No
2/13/2023 14:53	0.205	0	0.0028	No	0.2008	No
2/13/2023 14:54	0.199	-0.001	0.0027	No	0.2002	No
2/13/2023 14:55	0.2	0	0.0027	No	0.1994	No

Downwind Station

Time	Instantaneous VOC (ppm)	Instantaneous Mass Conc. Total (mg/m ³)	Mass Conc. Total mg/m ³ AVG 15m (mg/m ³)	Dust Exceedance	VOC ppm AVG 15m (ppm)	VOC Exceedance
2/13/2023 14:56	0.208	0	0.0023	No	0.2001	No
2/13/2023 14:57	0.265	0.003	0.0023	No	0.2046	No
2/13/2023 14:58	0.251	0.007	0.0027	No	0.2081	No
2/13/2023 14:59	0.245	0.024	0.0043	No	0.2115	No