



Daily Activity Report

Seton Brilla Charter School
 1956 Jerome Avenue, Bronx, NY
 BCP No. C203152

General Site Information

Date:	Friday, October 21, 2022
Weather:	Sunny, 55°F
Wind Direction/Speed:	SW @ 5 mph
AKRF Personnel on Site:	J. Kelleher-Ferguson
AKRF Equipment on Site:	Mini RAE 3000 Photoionization Detector [(PID) x1], 2 Fixed Air Monitoring Stations
Visitors:	None.

Contractor Information

Contracting Company	Main Personnel	Equipment
Casino Construction	Connor McGrory	Excavator
Core Carpenters	-	Hand Tools

Description and Location of Work Activities Performed

1) Casino continued pile installation on the south side of the Site.

Site Soil Disposal Tracking Information

Destination Facility	Daily Trucks	Total Trucks	Daily Approx. Cubic Yds	Total Approx. Cubic Yds	Total Site Loads	Total Approximate Cubic Yards
N/A	-	-	0	0	0	0
N/A	-	-	0	0		
N/A	-	-	0	0		
N/A	-	-	0	0		
N/A	-	-	0	0		

CAMP Air Monitoring Results

CAMP Station	UPWIND				DOWNWIND		
Odors:	None.				None.		
VOC Action Level Exceedance(s):	None.				None.		
Particulate Action Level Exceedance(s):	None.				None.		
Maximum VOC Level (ppm):	0.000				0.497		
Maximum Particulate Level (mg/m ³):	0.048				0.13		

Notes: CAMP was performed throughout the day.

Additional Information

Planned Work Activity for Following Day/Week:	1) Installation of foundation piles.
Comments:	None.

Site Map

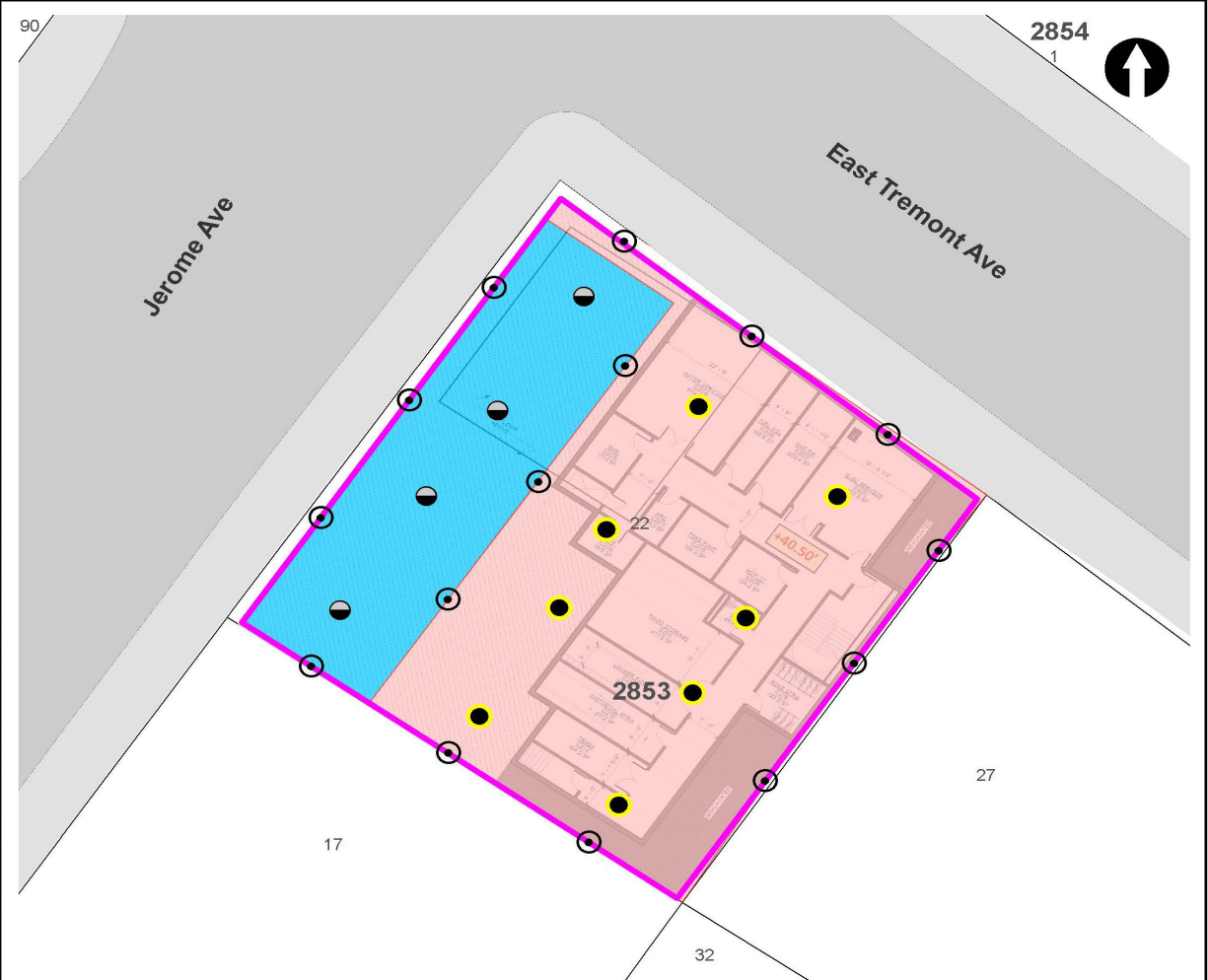

LEGEND

- PROJECT SITE BOUNDARY
- LOT BOUNDARY AND TAX LOT NUMBER
- 2853** BLOCK NUMBER
- REMEDIAL EXCAVATION TO APPROXIMATELY TWO FEET BELOW EXISTING GRADE
- REMEDIAL EXCAVATION TO GROUNDWATER (SOURCE AREA)
- CONFIRMATION DOCUMENTATION BOTTOM SAMPLE
- SOURCE AREA DOCUMENTATION BOTTOM SAMPLE
- DOCUMENTATION SIDEWALL SAMPLE

NOTE
 REMEDIAL EXCAVATION WILL INCLUDE REMOVAL OF APPROXIMATELY 1,280 TONS (850 CUBIC YARDS) OF SOURCE MATERIAL ASSOCIATED WITH NYSDEC SPILL NO. 2103719 AND APPROXIMATELY 860 TONS (570 CUBIC YARDS) OF SOIL/FILL FROM THE UPPER 2 FEET SITE-WIDE.



Map Source:
 NYCDCP (NYC Dept. of City Planning) GIS database

© 2024 AKRF. All Projects 10024 - 156 JEROME AVENUE Technical GIS and Graphics SAR/PA/PP/10024 Figure 9 Proposed Remedial Excavation and Documentation Sample Location Plan.mxd 10/25/2021 2:08:38 PM iszallis

440 Park Avenue South, New York, NY 10016

156 Jerome Avenue
 Bronx, New York

TRACK 4 CLEANUP AND DOCUMENTATION
SAMPLE LOCATION PLAN

DATE	04/29/2022
PROJECT NO.	210024
FIGURE	11

Site Photographs

Photograph 1 -
Caisson drilling along
the eastern property
boundary, view
facing southeast.



Photograph 2 -
Grading the site
along the southern
property boundary
to support caisson
installation. View
facing east.



Photograph 3 -
Grouting a caisson,
view facing
northeast.



Upwind Station						
Time	Instantaneous VOC (ppm)	Instantaneous Mass Conc. Total (mg/m ³)	Mass Conc. Total mg/m ³ AVG 15m (mg/m ³)	Dust Exceedance	VOC ppm AVG 15m (ppm)	VOC Exceedance
10/21/2022 7:10	0	0.021	0.021	No	0	No
10/21/2022 7:11	0	0.025	0.023	No	0	No
10/21/2022 7:12	0	0.033	0.0263	No	0	No
10/21/2022 7:13	0	0.02	0.0248	No	0	No
10/21/2022 7:14	0	0.02	0.0238	No	0	No
10/21/2022 7:15	0	0.041	0.0267	No	0	No
10/21/2022 7:16	0	0.038	0.0283	No	0	No
10/21/2022 7:17	0	0.022	0.0275	No	0	No
10/21/2022 7:18	0	0.018	0.0264	No	0	No
10/21/2022 7:19	0	0.019	0.0257	No	0	No
10/21/2022 7:20	0	0.02	0.0252	No	0	No
10/21/2022 7:21	0	0.022	0.0249	No	0	No
10/21/2022 7:22	0	0.023	0.0248	No	0	No
10/21/2022 7:23	0	0.024	0.0247	No	0	No
10/21/2022 7:24	0	0.023	0.0246	No	0	No
10/21/2022 7:25	0	0.029	0.0251	No	0	No
10/21/2022 7:26	0	0.028	0.0253	No	0	No
10/21/2022 7:27	0	0.025	0.0248	No	0	No
10/21/2022 7:28	0	0.023	0.025	No	0	No
10/21/2022 7:29	0	0.024	0.0253	No	0	No
10/21/2022 7:30	0	0.023	0.0241	No	0	No
10/21/2022 7:31	0	0.022	0.023	No	0	No
10/21/2022 7:32	0	0.023	0.0231	No	0	No
10/21/2022 7:33	0	0.034	0.0241	No	0	No
10/21/2022 7:34	0	0.023	0.0244	No	0	No
10/21/2022 7:35	0	0.023	0.0246	No	0	No
10/21/2022 7:36	0	0.025	0.0248	No	0	No
10/21/2022 7:37	0	0.027	0.0251	No	0	No
10/21/2022 7:38	0	0.037	0.0259	No	0	No
10/21/2022 7:39	0	0.033	0.0266	No	0	No
10/21/2022 7:40	0	0.027	0.0265	No	0	No
10/21/2022 7:41	0	0.026	0.0263	No	0	No
10/21/2022 7:42	0	0.024	0.0263	No	0	No
10/21/2022 7:43	0	0.022	0.0262	No	0	No
10/21/2022 7:44	0	0.021	0.026	No	0	No
10/21/2022 7:45	0	0.022	0.0259	No	0	No
10/21/2022 7:46	0	0.023	0.026	No	0	No
10/21/2022 7:47	0	0.023	0.026	No	0	No
10/21/2022 7:48	0	0.021	0.0251	No	0	No
10/21/2022 7:49	0	0.023	0.0251	No	0	No
10/21/2022 7:50	0	0.024	0.0252	No	0	No
10/21/2022 7:51	0	0.024	0.0251	No	0	No
10/21/2022 7:52	0	0.023	0.0249	No	0	No
10/21/2022 7:53	0	0.024	0.024	No	0	No
10/21/2022 7:54	0	0.026	0.0235	No	0	No
10/21/2022 7:55	0	0.024	0.0233	No	0	No
10/21/2022 7:56	0	0.025	0.0233	No	0	No
10/21/2022 7:57	0	0.024	0.0233	No	0	No
10/21/2022 7:58	0	0.024	0.0234	No	0	No
10/21/2022 7:59	0	0.025	0.0237	No	0	No
10/21/2022 8:00	0	0.023	0.0237	No	0	No

Upwind Station						
Time	Instantaneous VOC (ppm)	Instantaneous Mass Conc. Total (mg/m ³)	Mass Conc. Total mg/m ³ AVG 15m (mg/m ³)	Dust Exceedance	VOC ppm AVG 15m (ppm)	VOC Exceedance
10/21/2022 8:01	0	0.024	0.0238	No	0	No
10/21/2022 8:02	0	0.03	0.0243	No	0	No
10/21/2022 8:03	0	0.032	0.025	No	0	No
10/21/2022 8:04	0	0.027	0.0253	No	0	No
10/21/2022 8:05	0	0.023	0.0252	No	0	No
10/21/2022 8:06	0	0.023	0.0251	No	0	No
10/21/2022 8:07	0	0.022	0.0251	No	0	No
10/21/2022 8:08	0	0.021	0.0249	No	0	No
10/21/2022 8:09	0	0.021	0.0245	No	0	No
10/21/2022 8:10	0	0.022	0.0244	No	0	No
10/21/2022 8:11	0	0.022	0.0242	No	0	No
10/21/2022 8:12	0	0.023	0.0241	No	0	No
10/21/2022 8:13	0	0.024	0.0241	No	0	No
10/21/2022 8:14	0	0.025	0.0241	No	0	No
10/21/2022 8:15	0	0.023	0.0241	No	0	No
10/21/2022 8:16	0	0.023	0.0241	No	0	No
10/21/2022 8:17	0	0.023	0.0236	No	0	No
10/21/2022 8:18	0	0.023	0.023	No	0	No
10/21/2022 8:19	0	0.024	0.0228	No	0	No
10/21/2022 8:20	0	0.023	0.0228	No	0	No
10/21/2022 8:21	0	0.022	0.0227	No	0	No
10/21/2022 8:22	0	0.023	0.0228	No	0	No
10/21/2022 8:23	0	0.023	0.0229	No	0	No
10/21/2022 8:24	0	0.023	0.0231	No	0	No
10/21/2022 8:25	0	0.025	0.0233	No	0	No
10/21/2022 8:26	0	0.029	0.0237	No	0	No
10/21/2022 8:27	0	0.026	0.0239	No	0	No
10/21/2022 8:28	0	0.028	0.0242	No	0	No
10/21/2022 8:29	0	0.032	0.0247	No	0	No
10/21/2022 8:30	0	0.028	0.025	No	0	No
10/21/2022 8:31	0	0.027	0.0253	No	0	No
10/21/2022 8:32	0	0.025	0.0254	No	0	No
10/21/2022 8:33	0	0.027	0.0257	No	0	No
10/21/2022 8:34	0	0.026	0.0258	No	0	No
10/21/2022 8:35	0	0.026	0.026	No	0	No
10/21/2022 8:36	0	0.025	0.0262	No	0	No
10/21/2022 8:37	0	0.027	0.0265	No	0	No
10/21/2022 8:38	0	0.032	0.0271	No	0	No
10/21/2022 8:39	0	0.032	0.0277	No	0	No
10/21/2022 8:40	0	0.03	0.028	No	0	No
10/21/2022 8:41	0	0.028	0.0279	No	0	No
10/21/2022 8:42	0	0.03	0.0282	No	0	No
10/21/2022 8:43	0	0.03	0.0283	No	0	No
10/21/2022 8:44	0	0.028	0.0281	No	0	No
10/21/2022 8:45	0	0.029	0.0281	No	0	No
10/21/2022 8:46	0	0.031	0.0284	No	0	No
10/21/2022 8:47	0	0.032	0.0289	No	0	No
10/21/2022 8:48	0	0.033	0.0293	No	0	No
10/21/2022 8:49	0	0.037	0.03	No	0	No
10/21/2022 8:50	0	0.034	0.0305	No	0	No
10/21/2022 8:51	0	0.032	0.031	No	0	No

Upwind Station						
Time	Instantaneous VOC (ppm)	Instantaneous Mass Conc. Total (mg/m ³)	Mass Conc. Total mg/m ³ AVG 15m (mg/m ³)	Dust Exceedance	VOC ppm AVG 15m (ppm)	VOC Exceedance
10/21/2022 8:52	0	0.031	0.0313	No	0	No
10/21/2022 8:53	0	0.03	0.0311	No	0	No
10/21/2022 8:54	0	0.029	0.0309	No	0	No
10/21/2022 8:55	0	0.029	0.0309	No	0	No
10/21/2022 8:56	0	0.028	0.0309	No	0	No
10/21/2022 8:57	0	0.025	0.0305	No	0	No
10/21/2022 8:58	0	0.025	0.0302	No	0	No
10/21/2022 8:59	0	0.025	0.03	No	0	No
10/21/2022 9:00	0	0.031	0.0301	No	0	No
10/21/2022 9:01	0	0.025	0.0297	No	0	No
10/21/2022 9:02	0	0.027	0.0294	No	0	No
10/21/2022 9:03	0	0.023	0.0287	No	0	No
10/21/2022 9:04	0	0.037	0.0287	No	0	No
10/21/2022 9:05	0	0.051	0.0299	No	0	No
10/21/2022 9:06	0	0.025	0.0294	No	0	No
10/21/2022 9:07	0	0.025	0.029	No	0	No
10/21/2022 9:08	0	0.032	0.0291	No	0	No
10/21/2022 9:09	0	0.035	0.0295	No	0	No
10/21/2022 9:10	0	0.038	0.0301	No	0	No
10/21/2022 9:11	0	0.042	0.0311	No	0	No
10/21/2022 9:12	0	0.057	0.0332	No	0	No
10/21/2022 9:13	0	0.037	0.034	No	0	No
10/21/2022 9:14	0	0.041	0.0351	No	0	No
10/21/2022 9:15	0	0.034	0.0353	No	0	No
10/21/2022 9:16	0	0.039	0.0362	No	0	No
10/21/2022 9:17	0	0.032	0.0365	No	0	No
10/21/2022 9:18	0	0.028	0.0369	No	0	No
10/21/2022 9:19	0	0.029	0.0363	No	0	No
10/21/2022 9:20	0	0.029	0.0349	No	0	No
10/21/2022 9:21	0	0.053	0.0367	No	0	No
10/21/2022 9:22	0	0.054	0.0387	No	0	No
10/21/2022 9:23	0	0.041	0.0393	No	0	No
10/21/2022 9:24	0	0.035	0.0393	No	0	No
10/21/2022 9:25	0	0.033	0.0389	No	0	No
10/21/2022 9:26	0	0.03	0.0381	No	0	No
10/21/2022 9:27	0	0.03	0.0363	No	0	No
10/21/2022 9:28	0	0.033	0.0361	No	0	No
10/21/2022 9:29	0	0.03	0.0353	No	0	No
10/21/2022 9:30	0	0.037	0.0355	No	0	No
10/21/2022 9:31	0	0.037	0.0354	No	0	No
10/21/2022 9:32	0	0.026	0.035	No	0	No
10/21/2022 9:33	0	0.028	0.035	No	0	No
10/21/2022 9:34	0	0.027	0.0349	No	0	No
10/21/2022 9:35	0	0.039	0.0355	No	0	No
10/21/2022 9:36	0	0.034	0.0343	No	0	No
10/21/2022 9:37	0	0.035	0.033	No	0	No
10/21/2022 9:38	0	0.039	0.0329	No	0	No
10/21/2022 9:39	0	0.034	0.0328	No	0	No
10/21/2022 9:40	0	0.035	0.0329	No	0	No
10/21/2022 9:41	0	0.038	0.0335	No	0	No
10/21/2022 9:42	0	0.031	0.0335	No	0	No

Upwind Station						
Time	Instantaneous VOC (ppm)	Instantaneous Mass Conc. Total (mg/m ³)	Mass Conc. Total mg/m ³ AVG 15m (mg/m ³)	Dust Exceedance	VOC ppm AVG 15m (ppm)	VOC Exceedance
10/21/2022 9:43	0	0.033	0.0335	No	0	No
10/21/2022 9:44	0	0.031	0.0336	No	0	No
10/21/2022 9:45	0	0.031	0.0332	No	0	No
10/21/2022 9:46	0	0.03	0.0327	No	0	No
10/21/2022 9:47	0	0.03	0.033	No	0	No
10/21/2022 9:48	0	0.031	0.0332	No	0	No
10/21/2022 9:49	0	0.031	0.0335	No	0	No
10/21/2022 9:50	0	0.031	0.0329	No	0	No
10/21/2022 9:51	0	0.032	0.0328	No	0	No
10/21/2022 9:52	0	0.032	0.0326	No	0	No
10/21/2022 9:53	0	0.033	0.0322	No	0	No
10/21/2022 9:54	0	0.031	0.032	No	0	No
10/21/2022 9:55	0	0.032	0.0318	No	0	No
10/21/2022 9:56	0	0.033	0.0315	No	0	No
10/21/2022 9:57	0	0.037	0.0319	No	0	No
10/21/2022 9:58	0	0.032	0.0318	No	0	No
10/21/2022 9:59	0	0.036	0.0321	No	0	No
10/21/2022 10:00	0	0.034	0.0323	No	0	No
10/21/2022 10:01	0	0.032	0.0325	No	0	No
10/21/2022 10:02	0	0.031	0.0325	No	0	No
10/21/2022 10:03	0	0.031	0.0325	No	0	No
10/21/2022 10:04	0	0.03	0.0325	No	0	No
10/21/2022 10:05	0	0.03	0.0324	No	0	No
10/21/2022 10:06	0	0.031	0.0323	No	0	No
10/21/2022 10:07	0	0.034	0.0325	No	0	No
10/21/2022 10:08	0	0.032	0.0324	No	0	No
10/21/2022 10:09	0	0.03	0.0323	No	0	No
10/21/2022 10:10	0	0.028	0.0321	No	0	No
10/21/2022 10:11	0	0.029	0.0318	No	0	No
10/21/2022 10:12	0	0.029	0.0313	No	0	No
10/21/2022 10:13	0	0.029	0.0311	No	0	No
10/21/2022 10:14	0	0.032	0.0308	No	0	No
10/21/2022 10:15	0	0.03	0.0305	No	0	No
10/21/2022 10:16	0	0.029	0.0303	No	0	No
10/21/2022 10:17	0	0.029	0.0302	No	0	No
10/21/2022 10:18	0	0.03	0.0301	No	0	No
10/21/2022 10:19	0	0.046	0.0312	No	0	No
10/21/2022 10:20	0	0.036	0.0316	No	0	No
10/21/2022 10:21	0	0.029	0.0315	No	0	No
10/21/2022 10:22	0	0.03	0.0312	No	0	No
10/21/2022 10:23	0	0.029	0.031	No	0	No
10/21/2022 10:24	0	0.03	0.031	No	0	No
10/21/2022 10:25	0	0.031	0.0312	No	0	No
10/21/2022 10:26	0	0.033	0.0315	No	0	No
10/21/2022 10:27	0	0.029	0.0315	No	0	No
10/21/2022 10:28	0	0.042	0.0323	No	0	No
10/21/2022 10:29	0	0.033	0.0324	No	0	No
10/21/2022 10:30	0	0.03	0.0324	No	0	No
10/21/2022 10:31	0	0.031	0.0325	No	0	No
10/21/2022 10:32	0	0.031	0.0327	No	0	No
10/21/2022 10:33	0	0.034	0.0329	No	0	No

Upwind Station						
Time	Instantaneous VOC (ppm)	Instantaneous Mass Conc. Total (mg/m ³)	Mass Conc. Total mg/m ³ AVG 15m (mg/m ³)	Dust Exceedance	VOC ppm AVG 15m (ppm)	VOC Exceedance
10/21/2022 10:34	0	0.036	0.0323	No	0	No
10/21/2022 10:35	0	0.075	0.0349	No	0	No
10/21/2022 10:36	0	0.034	0.0352	No	0	No
10/21/2022 10:37	0	0.035	0.0355	No	0	No
10/21/2022 10:38	0	0.031	0.0357	No	0	No
10/21/2022 10:39	0	0.033	0.0359	No	0	No
10/21/2022 10:40	0	0.032	0.0359	No	0	No
10/21/2022 10:41	0	0.031	0.0358	No	0	No
10/21/2022 10:42	0	0.03	0.0359	No	0	No
10/21/2022 10:43	0	0.032	0.0352	No	0	No
10/21/2022 10:44	0	0.031	0.0351	No	0	No
10/21/2022 10:45	0	0.032	0.0352	No	0	No
10/21/2022 10:46	0	0.031	0.0352	No	0	No
10/21/2022 10:47	0	0.034	0.0354	No	0	No
10/21/2022 10:48	0	0.032	0.0353	No	0	No
10/21/2022 10:49	0	0.032	0.035	No	0	No
10/21/2022 10:50	0	0.032	0.0321	No	0	No
10/21/2022 10:51	0	0.03	0.0319	No	0	No
10/21/2022 10:52	0	0.038	0.0321	No	0	No
10/21/2022 10:53	0	0.046	0.0331	No	0	No
10/21/2022 10:54	0	0.038	0.0334	No	0	No
10/21/2022 10:55	0	0.043	0.0341	No	0	No
10/21/2022 10:56	0	0.066	0.0365	No	0	No
10/21/2022 10:57	0	0.05	0.0378	No	0	No
10/21/2022 10:58	0	0.03	0.0377	No	0	No
10/21/2022 10:59	0	0.066	0.04	No	0	No
10/21/2022 11:00	0	0.039	0.0405	No	0	No
10/21/2022 11:01	0	0.025	0.0401	No	0	No
10/21/2022 11:02	0	0.028	0.0397	No	0	No
10/21/2022 11:03	0	0.028	0.0394	No	0	No
10/21/2022 11:04	0	0.032	0.0393	No	0	No
10/21/2022 11:04	0	0.03		No		No
10/21/2022 11:05	0			No	0	No
10/21/2022 11:06	0	0.041	0.0406	No	0	No
10/21/2022 11:07	0	0.032	0.0401	No	0	No
10/21/2022 11:08	0	0.039	0.0396	No	0	No
10/21/2022 11:09	0	0.106	0.0445	No	0	No
10/21/2022 11:10	0	0.027	0.0434	No	0	No
10/21/2022 11:11	0	0.028	0.0406	No	0	No
10/21/2022 11:12	0	0.058	0.0412	No	0	No
10/21/2022 11:13	0	0.052	0.0428	No	0	No
10/21/2022 11:14	0	0.029	0.0401	No	0	No
10/21/2022 11:15	0	0.043	0.0404	No	0	No
10/21/2022 11:16	0	0.042	0.0416	No	0	No
10/21/2022 11:17	0	0.043	0.0427	No	0	No
10/21/2022 11:18	0	0.082	0.0466	No	0	No
10/21/2022 11:19	0	0.045	0.0476	No	0	No
10/21/2022 11:20	0	0.025	0.0461	No	0	No
10/21/2022 11:21	0	0.027	0.0452	No	0	No
10/21/2022 11:22	0	0.033	0.0453	No	0	No
10/21/2022 11:23	0	0.059	0.0466	No	0	No

Upwind Station						
Time	Instantaneous VOC (ppm)	Instantaneous Mass Conc. Total (mg/m ³)	Mass Conc. Total mg/m ³ AVG 15m (mg/m ³)	Dust Exceedance	VOC ppm AVG 15m (ppm)	VOC Exceedance
10/21/2022 11:24	0	0.032	0.0417	No	0	No
10/21/2022 11:25	0	0.031	0.0419	No	0	No
10/21/2022 11:26	0	0.03	0.0421	No	0	No
10/21/2022 11:27	0	0.029	0.0401	No	0	No
10/21/2022 11:28	0	0.035	0.039	No	0	No
10/21/2022 11:29	0	0.024	0.0387	No	0	No
10/21/2022 11:30	0	0.023	0.0373	No	0	No
10/21/2022 11:31	0	0.024	0.0361	No	0	No
10/21/2022 11:32	0	0.025	0.0349	No	0	No
10/21/2022 11:33	0	0.024	0.0311	No	0	No
10/21/2022 11:34	0	0.025	0.0297	No	0	No
10/21/2022 11:35	0	0.025	0.0297	No	0	No
10/21/2022 11:36	0	0.026	0.0297	No	0	No
10/21/2022 11:37	0	0.026	0.0292	No	0	No
10/21/2022 11:38	0	0.027	0.0271	No	0	No
10/21/2022 11:39	0	0.028	0.0268	No	0	No
10/21/2022 11:40	0	0.027	0.0265	No	0	No
10/21/2022 11:41	0	0.026	0.0263	No	0	No
10/21/2022 11:42	0	0.026	0.0261	No	0	No
10/21/2022 11:43	0	0.032	0.0259	No	0	No
10/21/2022 11:44	0	0.036	0.0267	No	0	No
10/21/2022 11:45	0	0.029	0.0271	No	0	No
10/21/2022 11:46	0	0.033	0.0277	No	0	No
10/21/2022 11:47	0	0.031	0.0281	No	0	No
10/21/2022 11:48	0	0.028	0.0283	No	0	No
10/21/2022 11:49	0	0.028	0.0285	No	0	No
10/21/2022 11:50	0	0.032	0.029	No	0	No
10/21/2022 11:51	0	0.041	0.03	No	0	No
10/21/2022 11:52	0	0.05	0.0316	No	0	No
10/21/2022 11:53	0	0.047	0.0329	No	0	No
10/21/2022 11:54	0	0.049	0.0343	No	0	No
10/21/2022 11:55	0	0.041	0.0353	No	0	No
10/21/2022 11:56	0	0.047	0.0367	No	0	No
10/21/2022 11:57	0	0.058	0.0388	No	0	No
10/21/2022 11:58	0	0.057	0.0405	No	0	No
10/21/2022 11:59	0	0.032	0.0402	No	0	No
10/21/2022 12:00	0	0.033	0.0405	No	0	No
10/21/2022 12:01	0	0.026	0.04	No	0	No
10/21/2022 12:02	0	0.022	0.0394	No	0	No
10/21/2022 12:03	0	0.027	0.0393	No	0	No
10/21/2022 12:04	0	0.032	0.0396	No	0	No
10/21/2022 12:05	0	0.029	0.0394	No	0	No
10/21/2022 12:06	0	0.023	0.0382	No	0	No
10/21/2022 12:07	0	0.023	0.0364	No	0	No
10/21/2022 12:08	0	0.034	0.0355	No	0	No
10/21/2022 12:09	0	0.028	0.0341	No	0	No
10/21/2022 12:10	0	0.022	0.0329	No	0	No
10/21/2022 12:11	0	0.016	0.0308	No	0	No
10/21/2022 12:12	0	0.023	0.0285	No	0	No
10/21/2022 12:13	0	0.022	0.0261	No	0	No
10/21/2022 12:14	0	0.013	0.0249	No	0	No

Upwind Station						
Time	Instantaneous VOC (ppm)	Instantaneous Mass Conc. Total (mg/m ³)	Mass Conc. Total mg/m ³ AVG 15m (mg/m ³)	Dust Exceedance	VOC ppm AVG 15m (ppm)	VOC Exceedance
10/21/2022 12:15	0	0.013	0.0235	No	0	No
10/21/2022 12:16	0	0.017	0.0229	No	0	No
10/21/2022 12:17	0	0.02	0.0228	No	0	No
10/21/2022 12:18	0	0.02	0.0223	No	0	No
10/21/2022 12:19	0	0.026	0.0219	No	0	No
10/21/2022 12:20	0	0.022	0.0215	No	0	No
10/21/2022 12:21	0	0.029	0.0219	No	0	No
10/21/2022 12:22	0	0.034	0.0226	No	0	No
10/21/2022 12:23	0	0.032	0.0225	No	0	No
10/21/2022 12:24	0	0.021	0.022	No	0	No
10/21/2022 12:25	0	0.026	0.0223	No	0	No
10/21/2022 12:26	0	0.025	0.0229	No	0	No
10/21/2022 12:27	0	0.018	0.0225	No	0	No
10/21/2022 12:28	0	0.021	0.0225	No	0	No
10/21/2022 12:29	0	0.023	0.0231	No	0	No
10/21/2022 12:30	0	0.023	0.0238	No	0	No
10/21/2022 12:31	0	0.037	0.0251	No	0	No
10/21/2022 12:32	0	0.026	0.0255	No	0	No
10/21/2022 12:33	0	0.022	0.0257	No	0	No
10/21/2022 12:34	0	0.022	0.0254	No	0	No
10/21/2022 12:35	0	0.016	0.025	No	0	No
10/21/2022 12:36	0	0.017	0.0242	No	0	No
10/21/2022 12:37	0	0.018	0.0231	No	0	No
10/21/2022 12:38	0	0.02	0.0223	No	0	No
10/21/2022 12:39	0	0.03	0.0229	No	0	No
10/21/2022 12:40	0	0.032	0.0233	No	0	No
10/21/2022 12:41	0	0.028	0.0235	No	0	No
10/21/2022 12:42	0	0.017	0.0235	No	0	No
10/21/2022 12:43	0	0.023	0.0236	No	0	No
10/21/2022 12:44	0	0.027	0.0239	No	0	No
10/21/2022 12:45	0	0.025	0.024	No	0	No
10/21/2022 12:46	0	0.019	0.0228	No	0	No
10/21/2022 12:47	0	0.02	0.0224	No	0	No
10/21/2022 12:48	0	0.027	0.0227	No	0	No
10/21/2022 12:49	0	0.051	0.0247	No	0	No
10/21/2022 12:50	0	0.035	0.0259	No	0	No
10/21/2022 12:51	0	0.024	0.0264	No	0	No
10/21/2022 12:52	0	0.037	0.0277	No	0	No
10/21/2022 12:53	0	0.043	0.0292	No	0	No
10/21/2022 12:54	0	0.042	0.03	No	0	No
10/21/2022 12:55	0	0.033	0.0301	No	0	No
10/21/2022 12:56	0	0.021	0.0296	No	0	No
10/21/2022 12:57	0	0.022	0.0299	No	0	No
10/21/2022 12:58	0	0.023	0.0299	No	0	No
10/21/2022 12:59	0	0.021	0.0295	No	0	No
10/21/2022 13:00	0	0.03	0.0299	No	0	No
10/21/2022 13:01	0	0.024	0.0302	No	0	No
10/21/2022 13:02	0	0.026	0.0306	No	0	No
10/21/2022 13:03	0	0.024	0.0304	No	0	No
10/21/2022 13:04	0	0.022	0.0285	No	0	No
10/21/2022 13:05	0	0.022	0.0276	No	0	No

Upwind Station						
Time	Instantaneous VOC (ppm)	Instantaneous Mass Conc. Total (mg/m ³)	Mass Conc. Total mg/m ³ AVG 15m (mg/m ³)	Dust Exceedance	VOC ppm AVG 15m (ppm)	VOC Exceedance
10/21/2022 13:06	0	0.025	0.0277	No	0	No
10/21/2022 13:07	0	0.026	0.0269	No	0	No
10/21/2022 13:08	0	0.027	0.0259	No	0	No
10/21/2022 13:09	0	0.022	0.0245	No	0	No
10/21/2022 13:10	0	0.026	0.0241	No	0	No
10/21/2022 13:11	0	0.025	0.0243	No	0	No
10/21/2022 13:12	0	0.03	0.0249	No	0	No
10/21/2022 13:13	0	0.033	0.0255	No	0	No
10/21/2022 13:14	0	0.028	0.026	No	0	No
10/21/2022 13:15	0	0.03	0.026	No	0	No
10/21/2022 13:16	0	0.024	0.026	No	0	No
10/21/2022 13:17	0	0.026	0.026	No	0	No
10/21/2022 13:18	0	0.026	0.0261	No	0	No
10/21/2022 13:19	0	0.023	0.0262	No	0	No
10/21/2022 13:20	0	0.027	0.0265	No	0	No
10/21/2022 13:21	0	0.023	0.0264	No	0	No
10/21/2022 13:22	0	0.037	0.0271	No	0	No
10/21/2022 13:23	0	0.045	0.0283	No	0	No
10/21/2022 13:24	0	0.058	0.0307	No	0	No
10/21/2022 13:25	0	0.036	0.0314	No	0	No
10/21/2022 13:26	0	0.044	0.0327	No	0	No
10/21/2022 13:27	0	0.034	0.0329	No	0	No
10/21/2022 13:28	0	0.025	0.0324	No	0	No
10/21/2022 13:29	0	0.033	0.0327	No	0	No
10/21/2022 13:30	0	0.027	0.0325	No	0	No
10/21/2022 13:31	0	0.025	0.0326	No	0	No
10/21/2022 13:32	0	0.027	0.0327	No	0	No
10/21/2022 13:33	0	0.037	0.0334	No	0	No
10/21/2022 13:34	0	0.042	0.0347	No	0	No
10/21/2022 13:35	0	0.041	0.0356	No	0	No
10/21/2022 13:36	0	0.051	0.0375	No	0	No
10/21/2022 13:37	0	0.039	0.0376	No	0	No
10/21/2022 13:38	0	0.028	0.0365	No	0	No
10/21/2022 13:39	0	0.03	0.0346	No	0	No
10/21/2022 13:40	0	0.03	0.0342	No	0	No
10/21/2022 13:41	0	0.03	0.0333	No	0	No
10/21/2022 13:42	0	0.027	0.0328	No	0	No
10/21/2022 13:43	0	0.031	0.0332	No	0	No
10/21/2022 13:44	0	0.03	0.033	No	0	No
10/21/2022 13:45	0	0.039	0.0338	No	0	No
10/21/2022 13:46	0	0.027	0.0339	No	0	No
10/21/2022 13:47	0	0.028	0.034	No	0	No
10/21/2022 13:48	0	0.031	0.0336	No	0	No
10/21/2022 13:49	0	0.031	0.0329	No	0	No
10/21/2022 13:50	0	0.029	0.0321	No	0	No
10/21/2022 13:51	0	0.027	0.0305	No	0	No
10/21/2022 13:52	0	0.032	0.03	No	0	No
10/21/2022 13:53	0	0.029	0.0301	No	0	No
10/21/2022 13:54	0	0.031	0.0301	No	0	No
10/21/2022 13:55	0	0.041	0.0309	No	0	No
10/21/2022 13:56	0	0.039	0.0315	No	0	No

Upwind Station

Time	Instantaneous VOC (ppm)	Instantaneous Mass Conc. Total (mg/m ³)	Mass Conc. Total mg/m ³ AVG 15m (mg/m ³)	Dust Exceedance	VOC ppm AVG 15m (ppm)	VOC Exceedance
10/21/2022 13:57	0	0.028	0.0315	No	0	No
10/21/2022 13:58	0	0.027	0.0313	No	0	No
10/21/2022 13:59	0	0.036	0.0317	No	0	No
10/21/2022 14:00	0	0.03	0.0311	No	0	No
10/21/2022 14:01	0	0.028	0.0311	No	0	No
10/21/2022 14:02	0	0.026	0.031	No	0	No
10/21/2022 14:03	0	0.028	0.0308	No	0	No
10/21/2022 14:04	0	0.025	0.0304	No	0	No
10/21/2022 14:05	0	0.029	0.0304	No	0	No
10/21/2022 14:06	0	0.029	0.0305	No	0	No
10/21/2022 14:07	0	0.028	0.0303	No	0	No
10/21/2022 14:08	0	0.037	0.0308	No	0	No
10/21/2022 14:09	0	0.024	0.0303	No	0	No
10/21/2022 14:10	0	0.026	0.0293	No	0	No
10/21/2022 14:11	0	0.027	0.0285	No	0	No
10/21/2022 14:12	0	0.03	0.0287	No	0	No

Downwind Station

Time	Instantaneous VOC (ppm)	Instantaneous Mass Conc. Total (mg/m ³)	Mass Conc. Total mg/m ³ AVG 15m (mg/m ³)	Dust Exceedance	VOC ppm AVG 15m (ppm)	VOC Exceedance
10/21/2022 7:11	0			No	0	No
10/21/2022 7:12	0	0.033	0.033	No	0	No
10/21/2022 7:13	0	0.033	0.033	No	0	No
10/21/2022 7:14	0	0.034	0.0333	No	0	No
10/21/2022 7:15	0	0.051	0.0378	No	0	No
10/21/2022 7:16	0	0.057	0.0416	No	0	No
10/21/2022 7:17	0	0.05	0.043	No	0	No
10/21/2022 7:18	0	0.071	0.047	No	0	No
10/21/2022 7:19	0	0.049	0.0473	No	0	No
10/21/2022 7:20	0	0.044	0.0469	No	0	No
10/21/2022 7:21	0	0.041	0.0463	No	0	No
10/21/2022 7:22	0	0.04	0.0457	No	0	No
10/21/2022 7:23	0	0.039	0.0452	No	0	No
10/21/2022 7:24	0	0.036	0.0445	No	0	No
10/21/2022 7:25	0	0.034	0.0437	No	0	No
10/21/2022 7:26	0	0.038	0.0433	No	0	No
10/21/2022 7:27	0	0.038	0.0437	No	0	No
10/21/2022 7:28	0	0.037	0.0439	No	0	No
10/21/2022 7:29	0	0.035	0.044	No	0	No
10/21/2022 7:30	0	0.035	0.0429	No	0	No
10/21/2022 7:31	0	0.035	0.0415	No	0	No
10/21/2022 7:32	0	0.08	0.0435	No	0	No
10/21/2022 7:33	0	0.081	0.0441	No	0	No
10/21/2022 7:34	0	0.047	0.044	No	0	No
10/21/2022 7:35	0	0.047	0.0442	No	0	No
10/21/2022 7:36	0	0.047	0.0446	No	0	No
10/21/2022 7:37	0	0.039	0.0445	No	0	No
10/21/2022 7:38	0	0.054	0.0455	No	0	No
10/21/2022 7:39	0	0.044	0.0461	No	0	No
10/21/2022 7:40	0	0.045	0.0468	No	0	No
10/21/2022 7:41	0	0.053	0.0478	No	0	No
10/21/2022 7:42	0	0.038	0.0478	No	0	No
10/21/2022 7:43	0	0.046	0.0484	No	0	No
10/21/2022 7:44	0	0.052	0.0495	No	0	No
10/21/2022 7:45	0	0.048	0.0504	No	0	No
10/21/2022 7:46	0	0.065	0.0524	No	0	No
10/21/2022 7:47	0	0.042	0.0499	No	0	No
10/21/2022 7:48	0	0.038	0.047	No	0	No
10/21/2022 7:49	0	0.055	0.0475	No	0	No
10/21/2022 7:50	0	0.043	0.0473	No	0	No
10/21/2022 7:51	0	0.038	0.0467	No	0	No
10/21/2022 7:52	0	0.04	0.0467	No	0	No
10/21/2022 7:53	0	0.041	0.0459	No	0	No
10/21/2022 7:54	0	0.041	0.0457	No	0	No
10/21/2022 7:55	0	0.043	0.0455	No	0	No
10/21/2022 7:56	0	0.043	0.0449	No	0	No
10/21/2022 7:57	0	0.04	0.045	No	0	No
10/21/2022 7:58	0	0.044	0.0449	No	0	No
10/21/2022 7:59	0	0.064	0.0457	No	0	No
10/21/2022 8:00	0	0.041	0.0452	No	0	No
10/21/2022 8:01	0	0.039	0.0435	No	0	No
10/21/2022 8:02	0	0.038	0.0432	No	0	No
10/21/2022 8:03	0	0.04	0.0433	No	0	No
10/21/2022 8:04	0	0.038	0.0422	No	0	No
10/21/2022 8:05	0	0.038	0.0419	No	0	No

Downwind Station

Time	Instantaneous VOC (ppm)	Instantaneous Mass Conc. Total (mg/m ³)	Mass Conc. Total mg/m ³ AVG 15m (mg/m ³)	Dust Exceedance	VOC ppm AVG 15m (ppm)	VOC Exceedance
10/21/2022 8:06	0	0.035	0.0417	No	0	No
10/21/2022 8:07	0	0.036	0.0414	No	0	No
10/21/2022 8:08	0	0.038	0.0412	No	0	No
10/21/2022 8:09	0	0.035	0.0408	No	0	No
10/21/2022 8:10	0	0.036	0.0403	No	0	No
10/21/2022 8:11	0	0.041	0.0402	No	0	No
10/21/2022 8:12	0	0.04	0.0402	No	0	No
10/21/2022 8:13	0	0.047	0.0404	No	0	No
10/21/2022 8:14	0	0.041	0.0389	No	0	No
10/21/2022 8:15	0	0.038	0.0387	No	0	No
10/21/2022 8:16	0	0.04	0.0387	No	0	No
10/21/2022 8:17	0	0.04	0.0389	No	0	No
10/21/2022 8:18	0	0.036	0.0386	No	0	No
10/21/2022 8:19	0	0.035	0.0384	No	0	No
10/21/2022 8:20	0	0.035	0.0382	No	0	No
10/21/2022 8:21	0	0.041	0.0386	No	0	No
10/21/2022 8:22	0	0.038	0.0387	No	0	No
10/21/2022 8:23	0	0.038	0.0387	No	0	No
10/21/2022 8:24	0	0.034	0.0387	No	0	No
10/21/2022 8:25	0	0.034	0.0385	No	0	No
10/21/2022 8:26	0	0.035	0.0381	No	0	No
10/21/2022 8:27	0	0.037	0.0379	No	0	No
10/21/2022 8:28	0.069	0.479	0.0667	No	0.0046	No
10/21/2022 8:29	0	0.454	0.0943	No	0.0046	No
10/21/2022 8:31	0			No	0.0049	No
10/21/2022 8:34	0			No	0.0058	No
10/21/2022 8:35	0	0.042	0.1232	No	0.0058	No
10/21/2022 8:36	0	0.042	0.1233	No	0.0058	No
10/21/2022 8:37	0	0.04	0.1235	No	0.0058	No
10/21/2022 8:38	0	0.046	0.1243	No	0.0058	No
10/21/2022 8:39	0	0.05	0.1259	No	0.0058	No
10/21/2022 8:40	0	0.052	0.1277	No	0.0058	No
10/21/2022 8:41	0	0.046	0.1288	No	0.0058	No
10/21/2022 8:42	0	0.045	0.1296	No	0.0058	No
10/21/2022 8:43	0	0.052	0.0869	No	0	No
10/21/2022 8:44	0	0.044	0.0459	No	0	No
10/21/2022 8:45	0	0.045	0.0458	No	0	No
10/21/2022 8:46	0	0.045	0.0457	No	0	No
10/21/2022 8:47	0	0.047	0.0458	No	0	No
10/21/2022 8:48	0	0.047	0.0459	No	0	No
10/21/2022 8:49	0	0.046	0.0459	No	0	No
10/21/2022 8:50	0	0.049	0.0464	No	0	No
10/21/2022 8:51	0	0.045	0.0466	No	0	No
10/21/2022 8:52	0	0.046	0.047	No	0	No
10/21/2022 8:53	0	0.046	0.047	No	0	No
10/21/2022 8:54	0	0.043	0.0465	No	0	No
10/21/2022 8:55	0	0.041	0.0458	No	0	No
10/21/2022 8:56	0	0.043	0.0456	No	0	No
10/21/2022 8:57	0	0.04	0.0453	No	0	No
10/21/2022 8:58	0	0.037	0.0443	No	0	No
10/21/2022 8:59	0	0.04	0.044	No	0	No
10/21/2022 9:00	0	0.054	0.0446	No	0	No
10/21/2022 9:01	0	0.044	0.0445	No	0	No
10/21/2022 9:02	0	0.04	0.0441	No	0	No
10/21/2022 9:03	0	0.041	0.0437	No	0	No

Downwind Station

Time	Instantaneous VOC (ppm)	Instantaneous Mass Conc. Total (mg/m ³)	Mass Conc. Total mg/m ³ AVG 15m (mg/m ³)	Dust Exceedance	VOC ppm AVG 15m (ppm)	VOC Exceedance
10/21/2022 9:04	0	0.039	0.0432	No	0	No
10/21/2022 9:05	0	0.05	0.0433	No	0	No
10/21/2022 9:06	0	0.037	0.0427	No	0	No
10/21/2022 9:07	0	0.041	0.0424	No	0	No
10/21/2022 9:08	0	0.051	0.0427	No	0	No
10/21/2022 9:09	0	0.043	0.0427	No	0	No
10/21/2022 9:10	0	0.042	0.0428	No	0	No
10/21/2022 9:11	0	0.047	0.0431	No	0	No
10/21/2022 9:12	0	0.044	0.0433	No	0	No
10/21/2022 9:13	0	0.043	0.0437	No	0	No
10/21/2022 9:14	0	0.043	0.0439	No	0	No
10/21/2022 9:15	0	0.042	0.0431	No	0	No
10/21/2022 9:16	0	0.046	0.0433	No	0	No
10/21/2022 9:17	0	0.044	0.0435	No	0	No
10/21/2022 9:18	0	0.042	0.0436	No	0	No
10/21/2022 9:19	0	0.04	0.0437	No	0	No
10/21/2022 9:20	0	0.038	0.0429	No	0	No
10/21/2022 9:21	0	0.037	0.0429	No	0	No
10/21/2022 9:22	0	0.037	0.0426	No	0	No
10/21/2022 9:23	0	0.037	0.0417	No	0	No
10/21/2022 9:24	0	0.037	0.0413	No	0	No
10/21/2022 9:25	0	0.036	0.0409	No	0	No
10/21/2022 9:26	0	0.048	0.0409	No	0	No
10/21/2022 9:27	0	0.046	0.0411	No	0	No
10/21/2022 9:28	0	0.044	0.0411	No	0	No
10/21/2022 9:29	0	0.04	0.0409	No	0	No
10/21/2022 9:30	0	0.043	0.041	No	0	No
10/21/2022 9:31	0	0.048	0.0411	No	0	No
10/21/2022 9:32	0	0.04	0.0409	No	0	No
10/21/2022 9:33	0.012	0.037	0.0405	No	0.0008	No
10/21/2022 9:34	0	0.039	0.0405	No	0.0008	No
10/21/2022 9:35	0	0.04	0.0406	No	0.0008	No
10/21/2022 9:36	0	0.039	0.0407	No	0.0008	No
10/21/2022 9:37	0	0.038	0.0408	No	0.0008	No
10/21/2022 9:38	0	0.041	0.0411	No	0.0008	No
10/21/2022 9:39	0	0.043	0.0415	No	0.0008	No
10/21/2022 9:40	0	0.046	0.0421	No	0.0008	No
10/21/2022 9:41	0	0.038	0.0415	No	0.0008	No
10/21/2022 9:42	0	0.039	0.041	No	0.0008	No
10/21/2022 9:43	0	0.04	0.0407	No	0.0008	No
10/21/2022 9:44	0	0.041	0.0408	No	0.0008	No
10/21/2022 9:45	0	0.045	0.0409	No	0.0008	No
10/21/2022 9:46	0	0.044	0.0407	No	0.0008	No
10/21/2022 9:47	0	0.04	0.0407	No	0.0008	No
10/21/2022 9:48	0	0.039	0.0408	No	0	No
10/21/2022 9:49	0	0.039	0.0408	No	0	No
10/21/2022 9:50	0	0.039	0.0407	No	0	No
10/21/2022 9:51	0	0.04	0.0408	No	0	No
10/21/2022 9:52	0	0.041	0.041	No	0	No
10/21/2022 9:53	0	0.041	0.041	No	0	No
10/21/2022 9:54	0	0.041	0.0409	No	0	No
10/21/2022 9:55	0	0.043	0.0407	No	0	No
10/21/2022 9:56	0	0.044	0.0411	No	0	No
10/21/2022 9:57	0	0.047	0.0416	No	0	No
10/21/2022 9:58	0	0.045	0.0419	No	0	No

Downwind Station

Time	Instantaneous VOC (ppm)	Instantaneous Mass Conc. Total (mg/m ³)	Mass Conc. Total mg/m ³ AVG 15m (mg/m ³)	Dust Exceedance	VOC ppm AVG 15m (ppm)	VOC Exceedance
10/21/2022 9:59	0	0.044	0.0421	No	0	No
10/21/2022 10:00	0	0.044	0.0421	No	0	No
10/21/2022 10:01	0	0.043	0.042	No	0	No
10/21/2022 10:02	0	0.042	0.0421	No	0	No
10/21/2022 10:03	0	0.04	0.0422	No	0	No
10/21/2022 10:04	0	0.041	0.0423	No	0	No
10/21/2022 10:05	0	0.041	0.0425	No	0	No
10/21/2022 10:06	0	0.041	0.0425	No	0	No
10/21/2022 10:07	0	0.037	0.0423	No	0	No
10/21/2022 10:08	0.009	0.037	0.042	No	0.0006	No
10/21/2022 10:09	0	0.039	0.0419	No	0.0006	No
10/21/2022 10:10	0	0.039	0.0416	No	0.0006	No
10/21/2022 10:11	0	0.041	0.0414	No	0.0006	No
10/21/2022 10:12	0	0.041	0.041	No	0.0006	No
10/21/2022 10:13	0	0.041	0.0407	No	0.0006	No
10/21/2022 10:14	0	0.04	0.0405	No	0.0006	No
10/21/2022 10:15	0	0.041	0.0403	No	0.0006	No
10/21/2022 10:16	0	0.04	0.0401	No	0.0006	No
10/21/2022 10:17	0	0.045	0.0403	No	0.0006	No
10/21/2022 10:18	0	0.046	0.0407	No	0.0006	No
10/21/2022 10:19	0	0.042	0.0407	No	0.0006	No
10/21/2022 10:20	0	0.04	0.0407	No	0.0006	No
10/21/2022 10:21	0	0.04	0.0406	No	0.0006	No
10/21/2022 10:22	0	0.041	0.0409	No	0.0006	No
10/21/2022 10:23	0	0.039	0.041	No	0	No
10/21/2022 10:24	0	0.04	0.0411	No	0	No
10/21/2022 10:25	0	0.039	0.0411	No	0	No
10/21/2022 10:26	0	0.039	0.0409	No	0	No
10/21/2022 10:27	0	0.039	0.0408	No	0	No
10/21/2022 10:28	0	0.039	0.0407	No	0	No
10/21/2022 10:29	0	0.041	0.0407	No	0	No
10/21/2022 10:30	0	0.04	0.0407	No	0	No
10/21/2022 10:31	0	0.041	0.0407	No	0	No
10/21/2022 10:32	0	0.042	0.0405	No	0	No
10/21/2022 10:33	0	0.044	0.0404	No	0	No
10/21/2022 10:34	0	0.044	0.0405	No	0	No
10/21/2022 10:35	0	0.044	0.0408	No	0	No
10/21/2022 10:36	0	0.043	0.041	No	0	No
10/21/2022 10:37	0	0.043	0.0411	No	0	No
10/21/2022 10:38	0	0.043	0.0414	No	0	No
10/21/2022 10:39	0	0.041	0.0415	No	0	No
10/21/2022 10:40	0	0.041	0.0416	No	0	No
10/21/2022 10:41	0	0.042	0.0418	No	0	No
10/21/2022 10:42	0	0.042	0.042	No	0	No
10/21/2022 10:43	0	0.041	0.0421	No	0	No
10/21/2022 10:44	0	0.042	0.0422	No	0	No
10/21/2022 10:45	0	0.044	0.0425	No	0	No
10/21/2022 10:46	0	0.044	0.0427	No	0	No
10/21/2022 10:47	0	0.043	0.0427	No	0	No
10/21/2022 10:48	0	0.04	0.0425	No	0	No
10/21/2022 10:49	0	0.042	0.0423	No	0	No
10/21/2022 10:50	0	0.043	0.0423	No	0	No
10/21/2022 10:51	0	0.042	0.0422	No	0	No
10/21/2022 10:52	0	0.043	0.0422	No	0	No
10/21/2022 10:53	0	0.04	0.042	No	0	No

Downwind Station

Time	Instantaneous VOC (ppm)	Instantaneous Mass Conc. Total (mg/m³)	Mass Conc. Total mg/m³ AVG 15m (mg/m³)	Dust Exceedance	VOC ppm AVG 15m (ppm)	VOC Exceedance
10/21/2022 10:54	0	0.037	0.0417	No	0	No
10/21/2022 10:55	0	0.037	0.0415	No	0	No
10/21/2022 10:56	0	0.037	0.0411	No	0	No
10/21/2022 10:57	0	0.037	0.0408	No	0	No
10/21/2022 10:58	0	0.036	0.0405	No	0	No
10/21/2022 10:59	0	0.036	0.0401	No	0	No
10/21/2022 11:00	0	0.036	0.0395	No	0	No
10/21/2022 11:01	0	0.036	0.039	No	0	No
10/21/2022 11:02	0	0.038	0.0387	No	0	No
10/21/2022 11:03	0	0.039	0.0386	No	0	No
10/21/2022 11:04	0	0.039	0.0384	No	0	No
10/21/2022 11:05	0	0.038	0.0381	No	0	No
10/21/2022 11:06	0	0.037	0.0377	No	0	No
10/21/2022 11:07	0	0.037	0.0373	No	0	No
10/21/2022 11:08	0	0.046	0.0377	No	0	No
10/21/2022 11:09	0	0.036	0.0377	No	0	No
10/21/2022 11:10	0	0.036	0.0376	No	0	No
10/21/2022 11:11	0	0.035	0.0375	No	0	No
10/21/2022 11:12	0	0.036	0.0374	No	0	No
10/21/2022 11:13	0	0.035	0.0373	No	0	No
10/21/2022 11:14	0	0.035	0.0373	No	0	No
10/21/2022 11:15	0	0.036	0.0373	No	0	No
10/21/2022 11:16	0	0.038	0.0374	No	0	No
10/21/2022 11:17	0	0.037	0.0373	No	0	No
10/21/2022 11:18	0	0.036	0.0371	No	0	No
10/21/2022 11:19	0	0.036	0.0369	No	0	No
10/21/2022 11:20	0	0.037	0.0369	No	0	No
10/21/2022 11:21	0	0.037	0.0369	No	0	No
10/21/2022 11:22	0	0.038	0.0369	No	0	No
10/21/2022 11:23	0	0.038	0.0364	No	0	No
10/21/2022 11:24	0	0.04	0.0367	No	0	No
10/21/2022 11:25	0	0.037	0.0367	No	0	No
10/21/2022 11:26	0	0.038	0.0369	No	0	No
10/21/2022 11:27	0	0.04	0.0372	No	0	No
10/21/2022 11:28	0	0.036	0.0373	No	0	No
10/21/2022 11:29	0	0.036	0.0373	No	0	No
10/21/2022 11:30	0	0.037	0.0374	No	0	No
10/21/2022 11:31	0	0.039	0.0375	No	0	No
10/21/2022 11:32	0	0.041	0.0377	No	0	No
10/21/2022 11:33	0	0.053	0.0389	No	0	No
10/21/2022 11:34	0	0.04	0.0391	No	0	No
10/21/2022 11:35	0	0.041	0.0394	No	0	No
10/21/2022 11:36	0	0.038	0.0395	No	0	No
10/21/2022 11:37	0	0.041	0.0397	No	0	No
10/21/2022 11:38	0	0.039	0.0397	No	0	No
10/21/2022 11:39	0	0.041	0.0398	No	0	No
10/21/2022 11:40	0	0.039	0.0399	No	0	No
10/21/2022 11:41	0	0.038	0.0399	No	0	No
10/21/2022 11:42	0	0.043	0.0401	No	0	No
10/21/2022 11:43	0	0.047	0.0409	No	0	No
10/21/2022 11:44	0	0.049	0.0417	No	0	No
10/21/2022 11:45	0	0.044	0.0422	No	0	No
10/21/2022 11:46	0	0.041	0.0423	No	0	No
10/21/2022 11:47	0	0.04	0.0423	No	0	No
10/21/2022 11:48	0	0.042	0.0415	No	0	No

Downwind Station

Time	Instantaneous VOC (ppm)	Instantaneous Mass Conc. Total (mg/m ³)	Mass Conc. Total mg/m ³ AVG 15m (mg/m ³)	Dust Exceedance	VOC ppm AVG 15m (ppm)	VOC Exceedance
10/21/2022 11:49	0	0.044	0.0418	No	0	No
10/21/2022 11:50	0	0.04	0.0417	No	0	No
10/21/2022 11:51	0	0.042	0.042	No	0	No
10/21/2022 11:52	0	0.043	0.0421	No	0	No
10/21/2022 11:53	0	0.041	0.0423	No	0	No
10/21/2022 11:54	0	0.047	0.0427	No	0	No
10/21/2022 11:55	0	0.046	0.0431	No	0	No
10/21/2022 11:56	0	0.043	0.0435	No	0	No
10/21/2022 11:57	0	0.044	0.0435	No	0	No
10/21/2022 11:58	0	0.046	0.0435	No	0	No
10/21/2022 11:59	0	0.062	0.0443	No	0	No
10/21/2022 12:00	0	0.053	0.0449	No	0	No
10/21/2022 12:01	0	0.046	0.0453	No	0	No
10/21/2022 12:02	0	0.041	0.0453	No	0	No
10/21/2022 12:03	0	0.063	0.0467	No	0	No
10/21/2022 12:04	0	0.038	0.0463	No	0	No
10/21/2022 12:05	0	0.032	0.0458	No	0	No
10/21/2022 12:06	0	0.03	0.045	No	0	No
10/21/2022 12:07	0	0.033	0.0443	No	0	No
10/21/2022 12:08	0	0.033	0.0438	No	0	No
10/21/2022 12:09	0	0.029	0.0426	No	0	No
10/21/2022 12:10	0	0.03	0.0415	No	0	No
10/21/2022 12:11	0	0.032	0.0408	No	0	No
10/21/2022 12:12	0	0.031	0.0399	No	0	No
10/21/2022 12:13	0	0.027	0.0387	No	0	No
10/21/2022 12:14	0	0.031	0.0366	No	0	No
10/21/2022 12:15	0	0.032	0.0352	No	0	No
10/21/2022 12:16	0	0.032	0.0343	No	0	No
10/21/2022 12:17	0	0.028	0.0334	No	0	No
10/21/2022 12:18	0	0.031	0.0313	No	0	No
10/21/2022 12:19	0	0.041	0.0315	No	0	No
10/21/2022 12:20	0	0.035	0.0317	No	0	No
10/21/2022 12:21	0	0.035	0.032	No	0	No
10/21/2022 12:22	0	0.035	0.0321	No	0	No
10/21/2022 12:23	0	0.031	0.032	No	0	No
10/21/2022 12:24	0	0.031	0.0321	No	0	No
10/21/2022 12:25	0	0.034	0.0324	No	0	No
10/21/2022 12:26	0	0.038	0.0328	No	0	No
10/21/2022 12:27	0	0.034	0.033	No	0	No
10/21/2022 12:28	0	0.041	0.0339	No	0	No
10/21/2022 12:29	0	0.036	0.0343	No	0	No
10/21/2022 12:30	0	0.038	0.0347	No	0	No
10/21/2022 12:31	0	0.034	0.0348	No	0	No
10/21/2022 12:32	0	0.031	0.035	No	0	No
10/21/2022 12:33	0	0.033	0.0351	No	0	No
10/21/2022 12:34	0	0.033	0.0346	No	0	No
10/21/2022 12:35	0	0.044	0.0352	No	0	No
10/21/2022 12:36	0	0.051	0.0363	No	0	No
10/21/2022 12:37	0	0.056	0.0377	No	0	No
10/21/2022 12:38	0	0.053	0.0391	No	0	No
10/21/2022 12:39	0	0.043	0.0399	No	0	No
10/21/2022 12:40	0	0.033	0.0399	No	0	No
10/21/2022 12:41	0	0.031	0.0394	No	0	No
10/21/2022 12:42	0	0.034	0.0394	No	0	No
10/21/2022 12:43	0	0.031	0.0387	No	0	No

Downwind Station

Time	Instantaneous VOC (ppm)	Instantaneous Mass Conc. Total (mg/m³)	Mass Conc. Total mg/m³ AVG 15m (mg/m³)	Dust Exceedance	VOC ppm AVG 15m (ppm)	VOC Exceedance
10/21/2022 12:44	0	0.041	0.0391	No	0	No
10/21/2022 12:45	0	0.03	0.0385	No	0	No
10/21/2022 12:46	0	0.03	0.0383	No	0	No
10/21/2022 12:47	0	0.03	0.0382	No	0	No
10/21/2022 12:48	0	0.031	0.0381	No	0	No
10/21/2022 12:49	0	0.04	0.0385	No	0	No
10/21/2022 12:50	0	0.039	0.0382	No	0	No
10/21/2022 12:51	0	0.034	0.0371	No	0	No
10/21/2022 12:52	0	0.038	0.0359	No	0	No
10/21/2022 12:53	0	0.047	0.0355	No	0	No
10/21/2022 12:54	0	0.035	0.0349	No	0	No
10/21/2022 12:55	0	0.035	0.0351	No	0	No
10/21/2022 12:56	0	0.035	0.0353	No	0	No
10/21/2022 12:57	0	0.035	0.0354	No	0	No
10/21/2022 12:58	0	0.037	0.0358	No	0	No
10/21/2022 12:59	0	0.039	0.0357	No	0	No
10/21/2022 13:00	0	0.04	0.0363	No	0	No
10/21/2022 13:01	0	0.043	0.0372	No	0	No
10/21/2022 13:02	0	0.042	0.038	No	0	No
10/21/2022 13:03	0	0.039	0.0385	No	0	No
10/21/2022 13:04	0	0.039	0.0385	No	0	No
10/21/2022 13:05	0	0.041	0.0386	No	0	No
10/21/2022 13:06	0	0.04	0.039	No	0	No
10/21/2022 13:07	0	0.041	0.0392	No	0	No
10/21/2022 13:08	0	0.058	0.0399	No	0	No
10/21/2022 13:09	0	0.04	0.0403	No	0	No
10/21/2022 13:10	0	0.04	0.0406	No	0	No
10/21/2022 13:11	0	0.039	0.0409	No	0	No
10/21/2022 13:12	0	0.039	0.0411	No	0	No
10/21/2022 13:13	0	0.04	0.0413	No	0	No
10/21/2022 13:14	0	0.04	0.0414	No	0	No
10/21/2022 13:15	0.027	0.043	0.0416	No	0.0018	No
10/21/2022 13:16	0	0.04	0.0414	No	0.0018	No
10/21/2022 13:17	0	0.043	0.0415	No	0.0018	No
10/21/2022 13:18	0	0.066	0.0433	No	0.0018	No
10/21/2022 13:19	0	0.07	0.0453	No	0.0018	No
10/21/2022 13:20	0.214	0.055	0.0463	No	0.0161	No
10/21/2022 13:21	0	0.081	0.049	No	0.0161	No
10/21/2022 13:22	0.63			No	0.0581	No
10/21/2022 13:23	0	0.096	0.0523	No	0.0581	No
10/21/2022 13:24	0.032			No	0.0602	No
10/21/2022 13:49	0			No	0	No
10/21/2022 13:50	0			No	0	No
10/21/2022 13:51	0	0.021	0.021	No	0	No
10/21/2022 13:52	0	0.02	0.0205	No	0	No
10/21/2022 13:53	0	0.019	0.02	No	0	No
10/21/2022 13:54	0	0.03	0.0225	No	0	No
10/21/2022 13:55	0	0.024	0.0228	No	0	No
10/21/2022 13:56	0	0.025	0.0232	No	0	No
10/21/2022 13:57	0	0.028	0.0239	No	0	No
10/21/2022 13:58	0	0.028	0.0244	No	0	No