



Daily Activity Report

Seton Brilla Charter School
 1956 Jerome Avenue, Bronx, NY
 BCP No. C203152

General Site Information

Date:	Friday, October 14, 2022
Weather:	Sunny, 65°F
Wind Direction/Speed:	SW @ 4 mph
AKRF Personnel on Site:	J. Kelleher-Ferguson
AKRF Equipment on Site:	Mini RAE 3000 Photoionization Detector [(PID) x1], 2 Fixed Air Monitoring Stations
Visitors:	None.

Contractor Information

Contracting Company	Main Personnel	Equipment
Casino Construction Core Carpenters	Connor McGrory -	Excavator Hand Tools

Description and Location of Work Activities Performed

1) Casino continued pile installation on the south side of the Site.

Site Soil Disposal Tracking Information

Destination Facility	Daily Trucks	Total Trucks	Daily Approx. Cubic Yds	Total Approx. Cubic Yds	Total Site Loads	Total Approximate Cubic Yards
N/A	-	-	0	0	0	0
N/A	-	-	0	0		
N/A	-	-	0	0		
N/A	-	-	0	0		
N/A	-	-	0	0		

CAMP Air Monitoring Results

CAMP Station	UPWIND				DOWNWIND		
Odors:	None.				None.		
VOC Action Level Exceedance(s):	None.				None.		
Particulate Action Level Exceedance(s):	None.				None.		
Maximum VOC Level (ppm):	NA				4.550		
Maximum Particulate Level (mg/m ³):	0.05				0.049		

Notes: The data for the upwind CAMP station PID did not transmit due to a problem with the connection that was discovered (and repaired) at the end of the day. No dust was observed exiting the Site at the upwind site boundary.

Additional Information

Planned Work Activity for Following Day/Week:	1) Installation of foundation piles.
Comments:	None.

Site Map

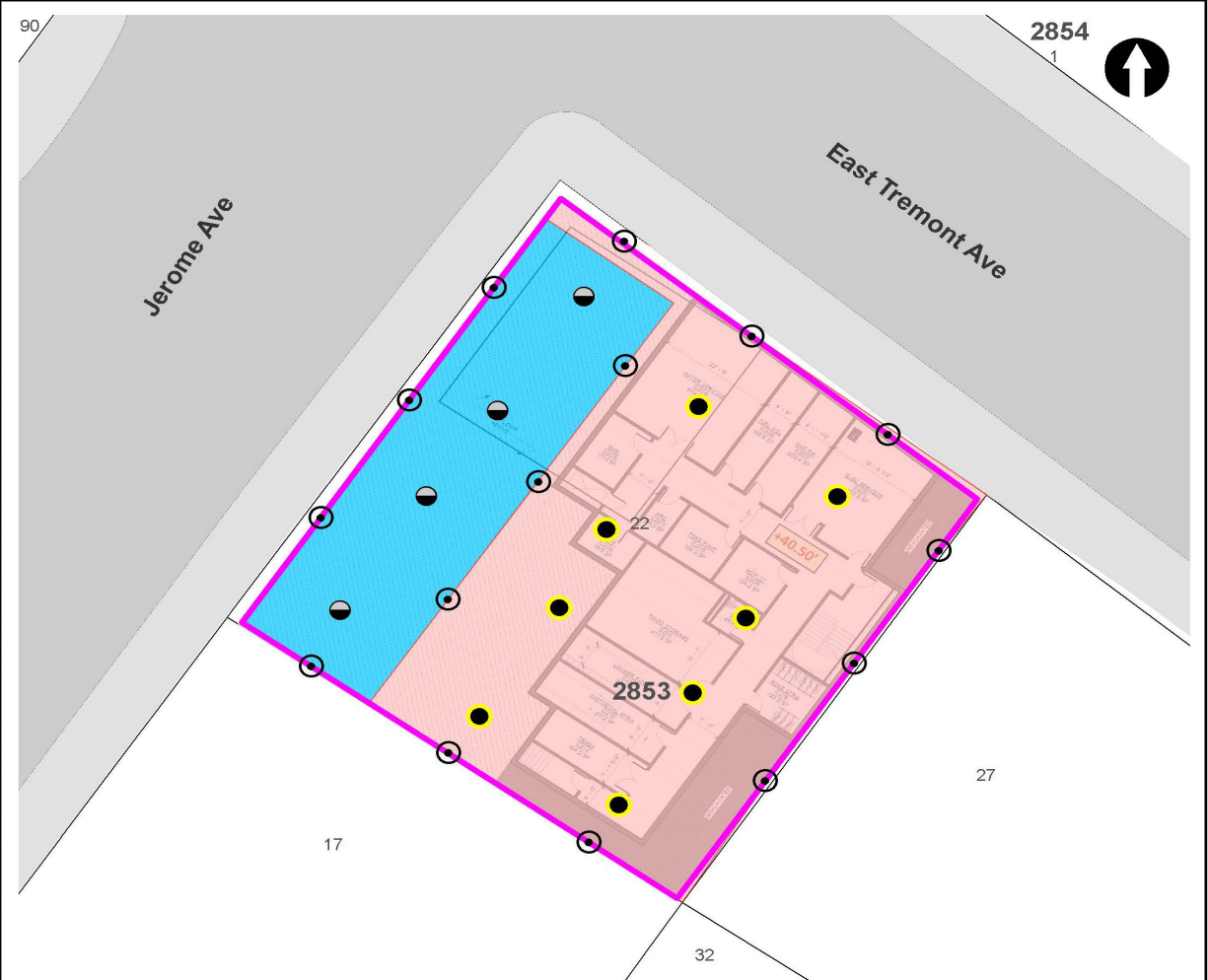

LEGEND

- PROJECT SITE BOUNDARY
- LOT BOUNDARY AND TAX LOT NUMBER
- 2853** BLOCK NUMBER
- REMEDIAL EXCAVATION TO APPROXIMATELY TWO FEET BELOW EXISTING GRADE
- REMEDIAL EXCAVATION TO GROUNDWATER (SOURCE AREA)

- CONFIRMATION DOCUMENTATION BOTTOM SAMPLE
- SOURCE AREA DOCUMENTATION BOTTOM SAMPLE
- DOCUMENTATION SIDEWALL SAMPLE

NOTE
 REMEDIAL EXCAVATION WILL INCLUDE REMOVAL OF APPROXIMATELY 1,280 TONS (850 CUBIC YARDS) OF SOURCE MATERIAL ASSOCIATED WITH NYSDEC SPILL NO. 2103719 AND APPROXIMATELY 860 TONS (570 CUBIC YARDS) OF SOIL/FILL FROM THE UPPER 2 FEET SITE-WIDE.



Map Source:
 NYCDCP (NYC Dept. of City Planning) GIS database

© 2024 AKRF. All Projects 10024 - 156 JEROME AVENUE Technical GIS and Graphics SAR/PA/PP/10024 Figure 9 Proposed Remedial Excavation and Documentation Sample Location Plan.mxd 10/25/2021 2:08:38 PM iszallis

440 Park Avenue South, New York, NY 10016

156 Jerome Avenue
 Bronx, New York

TRACK 4 CLEANUP AND DOCUMENTATION
SAMPLE LOCATION PLAN

DATE	04/29/2022
PROJECT NO.	210024
FIGURE	11

Site Photographs

Photograph 1 -
Caisson drilling along
the southern
property boundary,
view facing
southeast.



Photograph 2 -
Installing lagging
along the East
Tremont site
boundary. View
facing northeast.



Photograph 3 -
Grouting a caisson,
view facing
northeast.



Upwind Station

Time	Instaneous VOC (ppm)	Instaneous Mass Conc. Total (mg/m³)	Mass Conc. Total mg/m³ AVG 15m (mg/m³)	Dust Exceedance	VOC ppm AVG 15m (ppm)	VOC Exceedance
10/14/2022 7:03		0.042	0.042	No		No
10/14/2022 7:04		0.058	0.05	No		No
10/14/2022 7:05		0.042	0.0473	No		No
10/14/2022 7:06		0.022	0.041	No		No
10/14/2022 7:07		0.021	0.037	No		No
10/14/2022 7:08		0.024	0.0348	No		No
10/14/2022 7:09		0.023	0.0331	No		No
10/14/2022 7:10		0.015	0.0309	No		No
10/14/2022 7:11		0.01	0.0286	No		No
10/14/2022 7:12		0.009	0.0266	No		No
10/14/2022 7:13		0.009	0.025	No		No
10/14/2022 7:14		0.009	0.0237	No		No
10/14/2022 7:15		0.01	0.0226	No		No
10/14/2022 7:16		0.01	0.0217	No		No
10/14/2022 7:17		0.011	0.021	No		No
10/14/2022 7:18		0.011	0.0189	No		No
10/14/2022 7:19		0.012	0.0159	No		No
10/14/2022 7:20		0.012	0.0139	No		No
10/14/2022 7:21		0.018	0.0136	No		No
10/14/2022 7:22		0.014	0.0131	No		No
10/14/2022 7:23		0.011	0.0123	No		No
10/14/2022 7:24		0.013	0.0116	No		No
10/14/2022 7:25		0.025	0.0123	No		No
10/14/2022 7:26		0.036	0.014	No		No
10/14/2022 7:27		0.028	0.0153	No		No
10/14/2022 7:28		0.016	0.0157	No		No
10/14/2022 7:29		0.029	0.0171	No		No
10/14/2022 7:30		0.049	0.0197	No		No
10/14/2022 7:31		0.023	0.0205	No		No
10/14/2022 7:32		0.016	0.0209	No		No
10/14/2022 7:33		0.017	0.0213	No		No
10/14/2022 7:34		0.031	0.0225	No		No
10/14/2022 7:35		0.022	0.0232	No		No
10/14/2022 7:36		0.021	0.0234	No		No
10/14/2022 7:37		0.018	0.0237	No		No
10/14/2022 7:38		0.016	0.024	No		No
10/14/2022 7:39		0.015	0.0241	No		No
10/14/2022 7:40		0.012	0.0233	No		No
10/14/2022 7:41		0.015	0.0219	No		No
10/14/2022 7:42		0.024	0.0216	No		No
10/14/2022 7:43		0.012	0.0213	No		No
10/14/2022 7:44		0.015	0.0204	No		No
10/14/2022 7:45		0.01	0.0178	No		No
10/14/2022 7:46		0.007	0.0167	No		No
10/14/2022 7:47		0.009	0.0163	No		No
10/14/2022 7:48		0.008	0.0157	No		No
10/14/2022 7:49		0.01	0.0143	No		No
10/14/2022 7:50		0.014	0.0137	No		No
10/14/2022 7:51		0.014	0.0133	No		No
10/14/2022 7:52		0.017	0.0132	No		No
10/14/2022 7:53		0.019	0.0134	No		No

Upwind Station

Time	Instaneous VOC (ppm)	Instaneous Mass Conc. Total (mg/m³)	Mass Conc. Total mg/m³ AVG 15m (mg/m³)	Dust Exceedance	VOC ppm AVG 15m (ppm)	VOC Exceedance
10/14/2022 7:54		0.014	0.0133	No		No
10/14/2022 7:55		0.01	0.0132	No		No
10/14/2022 7:56		0.019	0.0135	No		No
10/14/2022 7:57		0.014	0.0128	No		No
10/14/2022 7:58		0.01	0.0127	No		No
10/14/2022 7:59		0.008	0.0122	No		No
10/14/2022 8:00		0.01	0.0122	No		No
10/14/2022 8:01		0.009	0.0123	No		No
10/14/2022 8:02		0.009	0.0123	No		No
10/14/2022 8:03		0.009	0.0124	No		No
10/14/2022 8:04		0.009	0.0123	No		No
10/14/2022 8:05		0.009	0.012	No		No
10/14/2022 8:06		0.012	0.0119	No		No
10/14/2022 8:07		0.009	0.0113	No		No
10/14/2022 8:08		0.018	0.0113	No		No
10/14/2022 8:09		0.014	0.0113	No		No
10/14/2022 8:10		0.011	0.0113	No		No
10/14/2022 8:11		0.018	0.0113	No		No
10/14/2022 8:12		0.014	0.0113	No		No
10/14/2022 8:13		0.009	0.0112	No		No
10/14/2022 8:14		0.011	0.0114	No		No
10/14/2022 8:15		0.01	0.0114	No		No
10/14/2022 8:16		0.011	0.0115	No		No
10/14/2022 8:17		0.021	0.0123	No		No
10/14/2022 8:18		0.01	0.0124	No		No
10/14/2022 8:19		0.01	0.0125	No		No
10/14/2022 8:20		0.013	0.0127	No		No
10/14/2022 8:21		0.012	0.0127	No		No
10/14/2022 8:22		0.015	0.0131	No		No
10/14/2022 8:23		0.013	0.0128	No		No
10/14/2022 8:24		0.01	0.0125	No		No
10/14/2022 8:25		0.01	0.0125	No		No
10/14/2022 8:26		0.016	0.0123	No		No
10/14/2022 8:27		0.008	0.0119	No		No
10/14/2022 8:28		0.009	0.0119	No		No
10/14/2022 8:29		0.011	0.0119	No		No
10/14/2022 8:30		0.02	0.0126	No		No
10/14/2022 8:31		0.012	0.0127	No		No
10/14/2022 8:32		0.009	0.0119	No		No
10/14/2022 8:33		0.011	0.0119	No		No
10/14/2022 8:34		0.01	0.0119	No		No
10/14/2022 8:35		0.014	0.012	No		No
10/14/2022 8:36		0.008	0.0117	No		No
10/14/2022 8:37		0.008	0.0113	No		No
10/14/2022 8:38		0.009	0.011	No		No
10/14/2022 8:39		0.009	0.0109	No		No
10/14/2022 8:40		0.01	0.0109	No		No
10/14/2022 8:41		0.011	0.0106	No		No
10/14/2022 8:42		0.011	0.0108	No		No
10/14/2022 8:43		0.009	0.0108	No		No
10/14/2022 8:44		0.01	0.0107	No		No

Upwind Station

Time	Instaneous VOC (ppm)	Instaneous Mass Conc. Total (mg/m³)	Mass Conc. Total mg/m³ AVG 15m (mg/m³)	Dust Exceedance	VOC ppm AVG 15m (ppm)	VOC Exceedance
10/14/2022 8:45		0.01	0.0101	No		No
10/14/2022 8:46		0.008	0.0098	No		No
10/14/2022 8:47		0.01	0.0099	No		No
10/14/2022 8:48		0.011	0.0099	No		No
10/14/2022 8:49		0.009	0.0098	No		No
10/14/2022 8:50		0.011	0.0096	No		No
10/14/2022 8:51		0.011	0.0098	No		No
10/14/2022 8:52		0.018	0.0105	No		No
10/14/2022 8:53		0.009	0.0105	No		No
10/14/2022 8:54		0.025	0.0115	No		No
10/14/2022 8:55		0.056	0.0146	No		No
10/14/2022 8:56		0.026	0.0156	No		No
10/14/2022 8:57		0.015	0.0159	No		No
10/14/2022 8:58		0.011	0.016	No		No
10/14/2022 8:59		0.01	0.016	No		No
10/14/2022 9:00		0.009	0.0159	No		No
10/14/2022 9:01		0.008	0.0159	No		No
10/14/2022 9:02		0.009	0.0159	No		No
10/14/2022 9:03		0.007	0.0156	No		No
10/14/2022 9:04		0.009	0.0156	No		No
10/14/2022 9:05		0.009	0.0155	No		No
10/14/2022 9:06		0.01	0.0154	No		No
10/14/2022 9:07		0.013	0.0151	No		No
10/14/2022 9:08		0.012	0.0153	No		No
10/14/2022 9:09		0.01	0.0143	No		No
10/14/2022 9:10		0.009	0.0111	No		No
10/14/2022 9:11		0.009	0.01	No		No
10/14/2022 9:12		0.01	0.0097	No		No
10/14/2022 9:13		0.009	0.0095	No		No
10/14/2022 9:14		0.008	0.0094	No		No
10/14/2022 9:15		0.012	0.0096	No		No
10/14/2022 9:16		0.009	0.0097	No		No
10/14/2022 9:17		0.009	0.0097	No		No
10/14/2022 9:18		0.009	0.0098	No		No
10/14/2022 9:19		0.01	0.0099	No		No
10/14/2022 9:20		0.011	0.01	No		No
10/14/2022 9:21		0.014	0.0103	No		No
10/14/2022 9:22		0.011	0.0101	No		No
10/14/2022 9:23		0.013	0.0102	No		No
10/14/2022 9:24		0.02	0.0109	No		No
10/14/2022 9:25		0.014	0.0112	No		No
10/14/2022 9:26		0.012	0.0114	No		No
10/14/2022 9:27		0.015	0.0117	No		No
10/14/2022 9:28		0.01	0.0118	No		No
10/14/2022 9:29		0.009	0.0119	No		No
10/14/2022 9:30		0.01	0.0117	No		No
10/14/2022 9:31		0.014	0.0121	No		No
10/14/2022 9:32		0.013	0.0123	No		No
10/14/2022 9:33		0.019	0.013	No		No
10/14/2022 9:34		0.035	0.0147	No		No
10/14/2022 9:35		0.018	0.0151	No		No

Upwind Station

Time	Instantaneous VOC (ppm)	Instantaneous Mass Conc. Total (mg/m ³)	Mass Conc. Total mg/m ³ AVG 15m (mg/m ³)	Dust Exceedance	VOC ppm AVG 15m (ppm)	VOC Exceedance
10/14/2022 9:36		0.012	0.015	No		No
10/14/2022 9:37		0.007	0.0147	No		No
10/14/2022 9:38		0.01	0.0145	No		No
10/14/2022 9:39		0.009	0.0138	No		No
10/14/2022 9:40		0.011	0.0136	No		No
10/14/2022 9:41		0.007	0.0133	No		No
10/14/2022 9:42		0.008	0.0128	No		No
10/14/2022 9:43		0.007	0.0126	No		No
10/14/2022 9:44		0.008	0.0125	No		No
10/14/2022 9:45		0.01	0.0125	No		No
10/14/2022 9:46		0.008	0.0121	No		No
10/14/2022 9:47		0.009	0.0119	No		No
10/14/2022 9:48		0.01	0.0113	No		No
10/14/2022 9:49		0.017	0.0101	No		No
10/14/2022 9:50		0.006	0.0093	No		No
10/14/2022 9:51		0.01	0.0091	No		No
10/14/2022 9:52		0.02	0.01	No		No
10/14/2022 9:53		0.016	0.0104	No		No
10/14/2022 9:54		0.007	0.0103	No		No
10/14/2022 9:55		0.006	0.0099	No		No
10/14/2022 9:56		0.006	0.0099	No		No
10/14/2022 9:57		0.007	0.0098	No		No
10/14/2022 9:58		0.023	0.0109	No		No
10/14/2022 9:59		0.024	0.0119	No		No
10/14/2022 10:00		0.035	0.0136	No		No
10/14/2022 10:01		0.017	0.0142	No		No
10/14/2022 10:02		0.021	0.015	No		No
10/14/2022 10:03		0.007	0.0148	No		No
10/14/2022 10:04		0.016	0.0147	No		No
10/14/2022 10:05		0.017	0.0155	No		No
10/14/2022 10:06		0.016	0.0159	No		No
10/14/2022 10:07		0.011	0.0153	No		No
10/14/2022 10:08		0.006	0.0146	No		No
10/14/2022 10:09		0.008	0.0147	No		No
10/14/2022 10:10		0.007	0.0147	No		No
10/14/2022 10:11		0.006	0.0147	No		No
10/14/2022 10:12		0.006	0.0147	No		No
10/14/2022 10:13		0.007	0.0136	No		No
10/14/2022 10:14		0.006	0.0124	No		No
10/14/2022 10:15		0.006	0.0105	No		No
10/14/2022 10:16		0.007	0.0098	No		No
10/14/2022 10:17		0.007	0.0089	No		No
10/14/2022 10:18		0.009	0.009	No		No
10/14/2022 10:19		0.01	0.0086	No		No
10/14/2022 10:20		0.009	0.0081	No		No
10/14/2022 10:21		0.01	0.0077	No		No
10/14/2022 10:22		0.011	0.0077	No		No
10/14/2022 10:23		0.013	0.0081	No		No
10/14/2022 10:24		0.013	0.0085	No		No
10/14/2022 10:25		0.02	0.0093	No		No
10/14/2022 10:26		0.014	0.0099	No		No

Upwind Station

Time	Instantaneous VOC (ppm)	Instantaneous Mass Conc. Total (mg/m ³)	Mass Conc. Total mg/m ³ AVG 15m (mg/m ³)	Dust Exceedance	VOC ppm AVG 15m (ppm)	VOC Exceedance
10/14/2022 10:27		0.012	0.0103	No		No
10/14/2022 10:28		0.009	0.0104	No		No
10/14/2022 10:29		0.007	0.0105	No		No
10/14/2022 10:30		0.013	0.0109	No		No
10/14/2022 10:31		0.017	0.0116	No		No
10/14/2022 10:32		0.009	0.0117	No		No
10/14/2022 10:33		0.013	0.012	No		No
10/14/2022 10:34		0.012	0.0121	No		No
10/14/2022 10:35		0.009	0.0121	No		No
10/14/2022 10:36		0.005	0.0118	No		No
10/14/2022 10:37		0.016	0.0121	No		No
10/14/2022 10:38		0.007	0.0117	No		No
10/14/2022 10:39		0.008	0.0114	No		No
10/14/2022 10:40		0.007	0.0105	No		No
10/14/2022 10:41		0.008	0.0101	No		No
10/14/2022 10:42		0.008	0.0099	No		No
10/14/2022 10:43		0.009	0.0099	No		No
10/14/2022 10:44		0.009	0.01	No		No
10/14/2022 10:45		0.01	0.0098	No		No
10/14/2022 10:46		0.011	0.0094	No		No
10/14/2022 10:47		0.01	0.0095	No		No
10/14/2022 10:48		0.006	0.009	No		No
10/14/2022 10:49		0.006	0.0086	No		No
10/14/2022 10:50		0.007	0.0085	No		No
10/14/2022 10:51		0.005	0.0085	No		No
10/14/2022 10:52		0.008	0.0079	No		No
10/14/2022 10:53		0.006	0.0079	No		No
10/14/2022 10:54		0.004	0.0076	No		No
10/14/2022 10:55		0.006	0.0075	No		No
10/14/2022 10:56		0.011	0.0077	No		No
10/14/2022 10:57		0.009	0.0078	No		No
10/14/2022 10:58		0.006	0.0076	No		No
10/14/2022 10:59		0.007	0.0075	No		No
10/14/2022 11:00		0.005	0.0071	No		No
10/14/2022 11:01		0.008	0.0069	No		No
10/14/2022 11:02		0.006	0.0067	No		No
10/14/2022 11:03		0.007	0.0067	No		No
10/14/2022 11:04		0.007	0.0068	No		No
10/14/2022 11:05		0.011	0.0071	No		No
10/14/2022 11:06		0.007	0.0072	No		No
10/14/2022 11:07		0.004	0.0069	No		No
10/14/2022 11:08		0.004	0.0068	No		No
10/14/2022 11:09		0.005	0.0069	No		No
10/14/2022 11:10		0.007	0.0069	No		No
10/14/2022 11:11		0.008	0.0067	No		No
10/14/2022 11:12		0.018	0.0073	No		No
10/14/2022 11:13		0.006	0.0073	No		No
10/14/2022 11:14		0.013	0.0077	No		No
10/14/2022 11:15		0.014	0.0083	No		No
10/14/2022 11:16		0.007	0.0083	No		No
10/14/2022 11:17		0.005	0.0082	No		No

Upwind Station

Time	Instantaneous VOC (ppm)	Instantaneous Mass Conc. Total (mg/m ³)	Mass Conc. Total mg/m ³ AVG 15m (mg/m ³)	Dust Exceedance	VOC ppm AVG 15m (ppm)	VOC Exceedance
10/14/2022 11:18		0.006	0.0081	No		No
10/14/2022 11:19		0.007	0.0081	No		No
10/14/2022 11:20		0.01	0.0081	No		No
10/14/2022 11:21		0.009	0.0082	No		No
10/14/2022 11:22		0.008	0.0085	No		No
10/14/2022 11:23		0.006	0.0086	No		No
10/14/2022 11:24		0.005	0.0086	No		No
10/14/2022 11:25		0.005	0.0085	No		No
10/14/2022 11:26		0.007	0.0084	No		No
10/14/2022 11:27		0.006	0.0076	No		No
10/14/2022 11:28		0.006	0.0076	No		No
10/14/2022 11:29		0.008	0.0073	No		No
10/14/2022 11:30		0.011	0.0071	No		No
10/14/2022 11:31		0.008	0.0071	No		No
10/14/2022 11:32		0.008	0.0073	No		No
10/14/2022 11:33		0.006	0.0073	No		No
10/14/2022 11:34		0.01	0.0075	No		No
10/14/2022 11:35		0.008	0.0074	No		No
10/14/2022 11:36		0.008	0.0073	No		No
10/14/2022 11:37		0.006	0.0072	No		No
10/14/2022 11:38		0.01	0.0075	No		No
10/14/2022 11:39		0.012	0.0079	No		No
10/14/2022 11:40		0.01	0.0083	No		No
10/14/2022 11:41		0.012	0.0086	No		No
10/14/2022 11:42		0.007	0.0087	No		No
10/14/2022 11:43		0.006	0.0087	No		No
10/14/2022 11:44		0.007	0.0086	No		No
10/14/2022 11:45		0.008	0.0084	No		No
10/14/2022 11:46		0.012	0.0087	No		No
10/14/2022 11:47		0.022	0.0096	No		No
10/14/2022 11:48		0.011	0.0099	No		No
10/14/2022 11:49		0.011	0.01	No		No
10/14/2022 11:50		0.012	0.0103	No		No
10/14/2022 11:51		0.006	0.0101	No		No
10/14/2022 11:52		0.007	0.0102	No		No
10/14/2022 11:53		0.009	0.0101	No		No
10/14/2022 11:54		0.01	0.01	No		No
10/14/2022 11:55		0.008	0.0099	No		No
10/14/2022 11:56		0.008	0.0096	No		No
10/14/2022 11:57		0.012	0.0099	No		No
10/14/2022 11:58		0.009	0.0101	No		No
10/14/2022 11:59		0.005	0.01	No		No
10/14/2022 12:00		0.006	0.0099	No		No
10/14/2022 12:01		0.006	0.0095	No		No
10/14/2022 12:02		0.008	0.0085	No		No
10/14/2022 12:03		0.006	0.0082	No		No
10/14/2022 12:04		0.006	0.0079	No		No
10/14/2022 12:05		0.005	0.0074	No		No
10/14/2022 12:06		0.006	0.0074	No		No
10/14/2022 12:07		0.005	0.0073	No		No
10/14/2022 12:08		0.004	0.0069	No		No

Upwind Station

Time	Instantaneous VOC (ppm)	Instantaneous Mass Conc. Total (mg/m ³)	Mass Conc. Total mg/m ³ AVG 15m (mg/m ³)	Dust Exceedance	VOC ppm AVG 15m (ppm)	VOC Exceedance
10/14/2022 12:09		0.006	0.0067	No		No
10/14/2022 12:10		0.005	0.0065	No		No
10/14/2022 12:11		0.007	0.0064	No		No
10/14/2022 12:12		0.007	0.0061	No		No
10/14/2022 12:13		0.008	0.006	No		No
10/14/2022 12:14		0.006	0.0061	No		No
10/14/2022 12:15		0.005	0.006	No		No
10/14/2022 12:16		0.006	0.006	No		No
10/14/2022 12:17		0.007	0.0059	No		No
10/14/2022 12:18		0.008	0.0061	No		No
10/14/2022 12:19		0.005	0.006	No		No
10/14/2022 12:20		0.005	0.006	No		No
10/14/2022 12:21		0.006	0.006	No		No
10/14/2022 12:22		0.009	0.0063	No		No
10/14/2022 12:23		0.007	0.0065	No		No
10/14/2022 12:24		0.007	0.0065	No		No
10/14/2022 12:25		0.008	0.0067	No		No
10/14/2022 12:26		0.008	0.0068	No		No
10/14/2022 12:27		0.01	0.007	No		No
10/14/2022 12:28		0.009	0.0071	No		No
10/14/2022 12:29		0.006	0.0071	No		No
10/14/2022 12:30		0.006	0.0071	No		No
10/14/2022 12:31		0.007	0.0072	No		No
10/14/2022 12:32		0.007	0.0072	No		No
10/14/2022 12:33		0.005	0.007	No		No
10/14/2022 12:34		0.005	0.007	No		No
10/14/2022 12:35		0.014	0.0076	No		No
10/14/2022 12:36		0.013	0.0081	No		No
10/14/2022 12:37		0.014	0.0084	No		No
10/14/2022 12:38		0.012	0.0087	No		No
10/14/2022 12:39		0.008	0.0088	No		No
10/14/2022 12:40		0.013	0.0091	No		No
10/14/2022 12:41		0.013	0.0095	No		No
10/14/2022 12:42		0.01	0.0095	No		No
10/14/2022 12:43		0.012	0.0097	No		No
10/14/2022 12:44		0.012	0.0101	No		No
10/14/2022 12:45		0.008	0.0102	No		No
10/14/2022 12:46		0.019	0.011	No		No
10/14/2022 12:47		0.008	0.0111	No		No
10/14/2022 12:48		0.009	0.0113	No		No
10/14/2022 12:49		0.006	0.0114	No		No
10/14/2022 12:50		0.016	0.0115	No		No
10/14/2022 12:51		0.01	0.0113	No		No
10/14/2022 12:52		0.006	0.0108	No		No
10/14/2022 12:53		0.009	0.0106	No		No
10/14/2022 12:54		0.028	0.0119	No		No
10/14/2022 12:55		0.03	0.0131	No		No
10/14/2022 12:56		0.011	0.0129	No		No
10/14/2022 12:57		0.011	0.013	No		No
10/14/2022 12:58		0.026	0.0139	No		No
10/14/2022 12:59		0.017	0.0143	No		No

Upwind Station

Time	Instantaneous VOC (ppm)	Instantaneous Mass Conc. Total (mg/m³)	Mass Conc. Total mg/m³ AVG 15m (mg/m³)	Dust Exceedance	VOC ppm AVG 15m (ppm)	VOC Exceedance
10/14/2022 13:00		0.008	0.0143	No		No
10/14/2022 13:01		0.012	0.0138	No		No
10/14/2022 13:02		0.009	0.0139	No		No
10/14/2022 13:03		0.008	0.0138	No		No
10/14/2022 13:04		0.007	0.0139	No		No
10/14/2022 13:05		0.029	0.0147	No		No
10/14/2022 13:06		0.015	0.0151	No		No
10/14/2022 13:07		0.007	0.0151	No		No
10/14/2022 13:08		0.017	0.0157	No		No
10/14/2022 13:09		0.023	0.0153	No		No
10/14/2022 13:10		0.008	0.0139	No		No
10/14/2022 13:11		0.015	0.0141	No		No
10/14/2022 13:12		0.017	0.0145	No		No
10/14/2022 13:13		0.011	0.0135	No		No
10/14/2022 13:14		0.01	0.0131	No		No
10/14/2022 13:15		0.011	0.0133	No		No
10/14/2022 13:16		0.012	0.0133	No		No
10/14/2022 13:17		0.01	0.0133	No		No
10/14/2022 13:18		0.004	0.0131	No		No
10/14/2022 13:19		0.013	0.0135	No		No
10/14/2022 13:20		0.009	0.0121	No		No
10/14/2022 13:21		0.013	0.012	No		No
10/14/2022 13:22		0.019	0.0128	No		No
10/14/2022 13:23		0.013	0.0125	No		No
10/14/2022 13:24		0.019	0.0123	No		No
10/14/2022 13:25		0.008	0.0123	No		No
10/14/2022 13:26		0.009	0.0119	No		No
10/14/2022 13:27		0.007	0.0112	No		No
10/14/2022 13:28		0.008	0.011	No		No
10/14/2022 13:29		0.005	0.0107	No		No
10/14/2022 13:30		0.007	0.0104	No		No
10/14/2022 13:31		0.006	0.01	No		No
10/14/2022 13:32		0.01	0.01	No		No
10/14/2022 13:33		0.007	0.0102	No		No
10/14/2022 13:34		0.005	0.0097	No		No
10/14/2022 13:35		0.006	0.0095	No		No
10/14/2022 13:36		0.007	0.0091	No		No
10/14/2022 13:37		0.005	0.0081	No		No
10/14/2022 13:38		0.005	0.0076	No		No
10/14/2022 13:39		0.011	0.0071	No		No
10/14/2022 13:40		0.008	0.0071	No		No
10/14/2022 13:41		0.005	0.0068	No		No
10/14/2022 13:42		0.009	0.0069	No		No
10/14/2022 13:43		0.01	0.0071	No		No
10/14/2022 13:44		0.017	0.0079	No		No
10/14/2022 13:45		0.01	0.0081	No		No
10/14/2022 13:46		0.01	0.0083	No		No
10/14/2022 13:47		0.004	0.0079	No		No
10/14/2022 13:48		0.004	0.0077	No		No
10/14/2022 13:49		0.013	0.0083	No		No
10/14/2022 13:50		0.012	0.0087	No		No

Upwind Station

Time	Instantaneous VOC (ppm)	Instantaneous Mass Conc. Total (mg/m ³)	Mass Conc. Total mg/m ³ AVG 15m (mg/m ³)	Dust Exceedance	VOC ppm AVG 15m (ppm)	VOC Exceedance
10/14/2022 13:51		0.011	0.0089	No		No
10/14/2022 13:52		0.008	0.0091	No		No
10/14/2022 13:53		0.005	0.0091	No		No
10/14/2022 13:54		0.012	0.0092	No		No
10/14/2022 13:55		0.009	0.0093	No		No
10/14/2022 13:56		0.012	0.0097	No		No
10/14/2022 13:57		0.006	0.0095	No		No
10/14/2022 13:58		0.011	0.0096	No		No
10/14/2022 13:59		0.013	0.0093	No		No
10/14/2022 14:00		0.041	0.0114	No		No
10/14/2022 14:01		0.007	0.0112	No		No
10/14/2022 14:02		0.013	0.0118	No		No
10/14/2022 14:03		0.039	0.0141	No		No
10/14/2022 14:04		0.015	0.0143	No		No
10/14/2022 14:05		0.01	0.0141	No		No
10/14/2022 14:06		0.012	0.0142	No		No
10/14/2022 14:07		0.007	0.0141	No		No
10/14/2022 14:08		0.007	0.0143	No		No
10/14/2022 14:09		0.007	0.0139	No		No
10/14/2022 14:10		0.009	0.0139	No		No
10/14/2022 14:11		0.008	0.0137	No		No
10/14/2022 14:12		0.008	0.0138	No		No
10/14/2022 14:13		0.011	0.0138	No		No
10/14/2022 14:14		0.02	0.0143	No		No
10/14/2022 14:15		0.024	0.0131	No		No
10/14/2022 14:16		0.023	0.0142	No		No
10/14/2022 14:17		0.01	0.014	No		No
10/14/2022 14:18		0.014	0.0123	No		No
10/14/2022 14:19		0.01	0.012	No		No
10/14/2022 14:20		0.009	0.0119	No		No
10/14/2022 14:21		0.008	0.0117	No		No
10/14/2022 14:22		0.017	0.0123	No		No
10/14/2022 14:23		0.016	0.0129	No		No
10/14/2022 14:24		0.009	0.0131	No		No
10/14/2022 14:25		0.009	0.0131	No		No
10/14/2022 14:26		0.007	0.013	No		No
10/14/2022 14:27		0.008	0.013	No		No
10/14/2022 14:28		0.008	0.0128	No		No
10/14/2022 14:29		0.01	0.0121	No		No
10/14/2022 14:30		0.009	0.0111	No		No
10/14/2022 14:31		0.009	0.0102	No		No
10/14/2022 14:32		0.011	0.0103	No		No
10/14/2022 14:33		0.015	0.0103	No		No
10/14/2022 14:34		0.01	0.0103	No		No
10/14/2022 14:35		0.009	0.0103	No		No
10/14/2022 14:36		0.012	0.0106	No		No
10/14/2022 14:37		0.011	0.0102	No		No
10/14/2022 14:38		0.011	0.0099	No		No
10/14/2022 14:39		0.017	0.0104	No		No
10/14/2022 14:40		0.012	0.0106	No		No
10/14/2022 14:41		0.013	0.011	No		No

Upwind Station

Time	Instaneous VOC (ppm)	Instaneous Mass Conc. Total (mg/m ³)	Mass Conc. Total mg/m ³ AVG 15m (mg/m ³)	Dust Exceedance	VOC ppm AVG 15m (ppm)	VOC Exceedance
10/14/2022 14:42		0.017	0.0116	No		No
10/14/2022 14:43		0.01	0.0117	No		No
10/14/2022 14:44		0.013	0.0119	No		No
10/14/2022 14:45		0.017	0.0125	No		No
10/14/2022 14:46		0.023	0.0134	No		No
10/14/2022 14:47		0.021	0.0141	No		No
10/14/2022 14:48		0.017	0.0142	No		No
10/14/2022 14:49		0.011	0.0143	No		No
10/14/2022 14:50		0.014	0.0146	No		No
10/14/2022 14:51		0.015	0.0148	No		No
10/14/2022 14:52		0.017	0.0152	No		No
10/14/2022 14:53		0.019	0.0157	No		No
10/14/2022 14:54		0.012	0.0154	No		No
10/14/2022 14:55		0.013	0.0155	No		No
10/14/2022 14:56		0.018	0.0158	No		No
10/14/2022 14:57		0.011	0.0154	No		No

Downwind Station						
Time	Instantaneous VOC (ppm)	Instantaneous Mass Conc. Total (mg/m ³)	Mass Conc. Total mg/m ³ AVG 15m (mg/m ³)	Dust Exceedance	VOC ppm AVG 15m (ppm)	VOC Exceedance
10/14/2022 6:59	0			No	0	No
10/14/2022 7:00	0	0.045	0.045	No	0	No
10/14/2022 7:01	0	0.044	0.0445	No	0	No
10/14/2022 7:02	0	0.056	0.0483	No	0	No
10/14/2022 7:03	0	0.051	0.049	No	0	No
10/14/2022 7:04	0	0.042	0.0476	No	0	No
10/14/2022 7:05	0	0.048	0.0477	No	0	No
10/14/2022 7:06	0	0.042	0.0469	No	0	No
10/14/2022 7:07	0	0.031	0.0449	No	0	No
10/14/2022 7:08	0	0.036	0.0439	No	0	No
10/14/2022 7:09	0	0.027	0.0422	No	0	No
10/14/2022 7:10	0	0.027	0.0408	No	0	No
10/14/2022 7:11	0	0.018	0.0389	No	0	No
10/14/2022 7:12	0	0.013	0.0369	No	0	No
10/14/2022 7:13	0	0.017	0.0355	No	0	No
10/14/2022 7:14	0	0.015	0.0341	No	0	No
10/14/2022 7:15	0	0.013	0.032	No	0	No
10/14/2022 7:16	0	0.013	0.0299	No	0	No
10/14/2022 7:17	0	0.013	0.0271	No	0	No
10/14/2022 7:18	0	0.015	0.0247	No	0	No
10/14/2022 7:19	0	0.017	0.023	No	0	No
10/14/2022 7:20	0	0.014	0.0207	No	0	No
10/14/2022 7:21	0	0.01	0.0186	No	0	No
10/14/2022 7:22	0	0.009	0.0171	No	0	No
10/14/2022 7:23	0	0.009	0.0153	No	0	No
10/14/2022 7:24	0	0.008	0.0141	No	0	No
10/14/2022 7:25	0	0.009	0.0129	No	0	No
10/14/2022 7:26	0	0.01	0.0123	No	0	No
10/14/2022 7:27	0	0.012	0.0123	No	0	No
10/14/2022 7:28	0	0.008	0.0117	No	0	No
10/14/2022 7:29	0	0.014	0.0116	No	0	No
10/14/2022 7:30	0	0.01	0.0114	No	0	No
10/14/2022 7:31	0	0.011	0.0113	No	0	No
10/14/2022 7:32	0	0.015	0.0114	No	0	No
10/14/2022 7:33	0	0.023	0.0119	No	0	No
10/14/2022 7:34	0	0.02	0.0121	No	0	No
10/14/2022 7:35	0.246	0.021	0.0126	No	0.0164	No
10/14/2022 7:36	0.098	0.012	0.0127	No	0.0229	No
10/14/2022 7:37	0.001	0.013	0.013	No	0.023	No
10/14/2022 7:38	0	0.017	0.0135	No	0.023	No
10/14/2022 7:39	0	0.016	0.0141	No	0.023	No
10/14/2022 7:40	0	0.01	0.0141	No	0.023	No
10/14/2022 7:41	0	0.014	0.0144	No	0.023	No
10/14/2022 7:42	0	0.026	0.0153	No	0.023	No
10/14/2022 7:43	0	0.021	0.0162	No	0.023	No
10/14/2022 7:44	0	0.015	0.0163	No	0.023	No
10/14/2022 7:45	0	0.031	0.0177	No	0.023	No
10/14/2022 7:46	0	0.016	0.018	No	0.023	No
10/14/2022 7:47	0	0.012	0.0178	No	0.023	No
10/14/2022 7:48	0	0.011	0.017	No	0.023	No
10/14/2022 7:49	0	0.01	0.0163	No	0.023	No
10/14/2022 7:50	0	0.01	0.0156	No	0.0066	No
10/14/2022 7:51	0	0.011	0.0155	No	0.0001	No
10/14/2022 7:52	0	0.009	0.0153	No	0	No
10/14/2022 7:53	0	0.01	0.0148	No	0	No

Downwind Station

Time	Instantaneous VOC (ppm)	Instantaneous Mass Conc. Total (mg/m ³)	Mass Conc. Total mg/m ³ AVG 15m (mg/m ³)	Dust Exceedance	VOC ppm AVG 15m (ppm)	VOC Exceedance
10/14/2022 7:54	0	0.009	0.0143	No	0	No
10/14/2022 7:55	0	0.014	0.0146	No	0	No
10/14/2022 7:56	0	0.022	0.0151	No	0	No
10/14/2022 7:57	0	0.013	0.0143	No	0	No
10/14/2022 7:58	0	0.015	0.0139	No	0	No
10/14/2022 7:59	0	0.015	0.0139	No	0	No
10/14/2022 8:00	0	0.012	0.0126	No	0	No
10/14/2022 8:01	0	0.011	0.0123	No	0	No
10/14/2022 8:02	0	0.013	0.0123	No	0	No
10/14/2022 8:03	0	0.016	0.0127	No	0	No
10/14/2022 8:04	0	0.016	0.0131	No	0	No
10/14/2022 8:05	0	0.014	0.0133	No	0	No
10/14/2022 8:06	0.009	0.011	0.0133	No	0.0006	No
10/14/2022 8:07	0	0.01	0.0134	No	0.0006	No
10/14/2022 8:08	0	0.009	0.0133	No	0.0006	No
10/14/2022 8:09	0	0.01	0.0134	No	0.0006	No
10/14/2022 8:10	0	0.011	0.0132	No	0.0006	No
10/14/2022 8:11	0	0.011	0.0125	No	0.0006	No
10/14/2022 8:12	0	0.013	0.0125	No	0.0006	No
10/14/2022 8:13	3.798	0.02	0.0128	No	0.2538	No
10/14/2022 8:14	0.396	0.015	0.0128	No	0.2802	No
10/14/2022 8:15	3.518	0.012	0.0128	No	0.5147	No
10/14/2022 8:16	3.281	0.025	0.0137	No	0.7335	No
10/14/2022 8:17	2.577	0.016	0.0139	No	0.9053	No
10/14/2022 8:18	5.716	0.014	0.0138	No	1.2863	No
10/14/2022 8:19	0.681	0.014	0.0137	No	1.3317	No
10/14/2022 8:20	4.454	0.02	0.0141	No	1.6287	No
10/14/2022 8:21	3.054	0.017	0.0145	No	1.8317	No
10/14/2022 8:22	0.825	0.018	0.015	No	1.8867	No
10/14/2022 8:23	13.835	0.026	0.0161	No	2.809	No
10/14/2022 8:24	3.768	0.014	0.0164	No	3.0602	No
10/14/2022 8:25	1.8	0.015	0.0167	No	3.1802	No
10/14/2022 8:26	1.148	0.011	0.0167	No	3.2567	No
10/14/2022 8:27	4.538	0.01	0.0165	No	3.5593	No
10/14/2022 8:28	7.043	0.017	0.0163	No	3.7756	No
10/14/2022 8:29	1.695	0.013	0.0161	No	3.8622	No
10/14/2022 8:30	2.066	0.031	0.0174	No	3.7654	No
10/14/2022 8:31	10.435	0.012	0.0165	No	4.2423	No
10/14/2022 8:32	5.058	0.017	0.0166	No	4.4077	No
10/14/2022 8:33	5.47	0.014	0.0166	No	4.3913	No
10/14/2022 8:34	1.374	0.021	0.0171	No	4.4375	No
10/14/2022 8:35	1.311	0.015	0.0167	No	4.228	No
10/14/2022 8:36	4.852	0.012	0.0164	No	4.3479	No
10/14/2022 8:37	3.918	0.013	0.0161	No	4.5541	No
10/14/2022 8:38	4.664	0.015	0.0153	No	3.9427	No
10/14/2022 8:39	3.007	0.015	0.0154	No	3.8919	No
10/14/2022 8:40	1.914	0.015	0.0154	No	3.8995	No
10/14/2022 8:41	6.161	0.011	0.0154	No	4.2337	No
10/14/2022 8:42	2.084	0.01	0.0154	No	4.0701	No
10/14/2022 8:43	3.069	0.01	0.0149	No	3.8052	No
10/14/2022 8:44	0.801	0.011	0.0148	No	3.7456	No
10/14/2022 8:45	1.364	0.012	0.0135	No	3.6988	No
10/14/2022 8:46	1.4	0.015	0.0137	No	3.0965	No
10/14/2022 8:47	0.834	0.021	0.014	No	2.8149	No
10/14/2022 8:48	2.598	0.013	0.0139	No	2.6234	No

Downwind Station

Time	Instantaneous VOC (ppm)	Instantaneous Mass Conc. Total (mg/m³)	Mass Conc. Total mg/m³ AVG 15m (mg/m³)	Dust Exceedance	VOC ppm AVG 15m (ppm)	VOC Exceedance
10/14/2022 8:49	1.602	0.019	0.0138	No	2.6386	No
10/14/2022 8:50	1.603	0.012	0.0136	No	2.6581	No
10/14/2022 8:51	0.621	0.019	0.0141	No	2.376	No
10/14/2022 8:52	0.407	0.022	0.0147	No	2.1419	No
10/14/2022 8:53	0.981	0.013	0.0145	No	1.8964	No
10/14/2022 8:54	0.562	0.017	0.0147	No	1.7334	No
10/14/2022 8:55	0.663	0.063	0.0179	No	1.65	No
10/14/2022 8:56	2.35	0.037	0.0196	No	1.3959	No
10/14/2022 8:57	1.713	0.019	0.0202	No	1.3712	No
10/14/2022 8:58	0.683	0.023	0.0211	No	1.2121	No
10/14/2022 8:59	0.732	0.016	0.0214	No	1.2075	No
10/14/2022 9:00	0.39	0.018	0.0218	No	1.1426	No
10/14/2022 9:01	1.324	0.012	0.0216	No	1.1375	No
10/14/2022 9:02	0.309	0.012	0.021	No	1.1025	No
10/14/2022 9:03	0.651	0.009	0.0207	No	0.9727	No
10/14/2022 9:04	0.407	0.012	0.0203	No	0.8931	No
10/14/2022 9:05	0.218	0.014	0.0204	No	0.8007	No
10/14/2022 9:06	0.866	0.015	0.0201	No	0.8171	No
10/14/2022 9:07	0.671	0.02	0.02	No	0.8347	No
10/14/2022 9:08	0.326	0.016	0.0202	No	0.791	No
10/14/2022 9:09	0.28	0.019	0.0203	No	0.7722	No
10/14/2022 9:10	0.246	0.016	0.0172	No	0.7444	No
10/14/2022 9:11	0.157	0.021	0.0161	No	0.5982	No
10/14/2022 9:12	0.235	0.018	0.0161	No	0.4997	No
10/14/2022 9:13	0.344	0.011	0.0153	No	0.4771	No
10/14/2022 9:14	1.208	0.008	0.0147	No	0.5088	No
10/14/2022 9:15	0.28	0.014	0.0145	No	0.5015	No
10/14/2022 9:16	1.638	0.015	0.0147	No	0.5224	No
10/14/2022 9:17	0.273	0.01	0.0145	No	0.52	No
10/14/2022 9:18	0.699	0.015	0.0149	No	0.5232	No
10/14/2022 9:19	0.346	0.022	0.0156	No	0.5191	No
10/14/2022 9:20	1.792	0.021	0.0161	No	0.6241	No
10/14/2022 9:21	0.706	0.014	0.016	No	0.6134	No
10/14/2022 9:22	0.572	0.013	0.0155	No	0.6068	No
10/14/2022 9:23	0.919	0.013	0.0153	No	0.6463	No
10/14/2022 9:24	0.707	0.014	0.015	No	0.6748	No
10/14/2022 9:25	0.676	0.018	0.0151	No	0.7035	No
10/14/2022 9:26	0.37	0.015	0.0147	No	0.7177	No
10/14/2022 9:27	0.37	0.012	0.0143	No	0.7267	No
10/14/2022 9:28	0.535	0.01	0.0143	No	0.7394	No
10/14/2022 9:29	0.24	0.015	0.0147	No	0.6749	No
10/14/2022 9:30	0.317	0.021	0.0152	No	0.6773	No
10/14/2022 9:31	0.245	0.032	0.0163	No	0.5845	No
10/14/2022 9:32	0.318	0.032	0.0178	No	0.5875	No
10/14/2022 9:33	0.303	0.009	0.0174	No	0.5611	No
10/14/2022 9:34	0.672	0.01	0.0166	No	0.5828	No
10/14/2022 9:35	0.414	0.018	0.0164	No	0.4909	No
10/14/2022 9:36	1.161	0.023	0.017	No	0.5213	No
10/14/2022 9:37	0.604	0.029	0.0181	No	0.5234	No
10/14/2022 9:38	0.525	0.016	0.0183	No	0.4971	No
10/14/2022 9:39	0.487	0.019	0.0186	No	0.4825	No
10/14/2022 9:40	0.303	0.016	0.0185	No	0.4576	No
10/14/2022 9:41	0.362	0.017	0.0186	No	0.4571	No
10/14/2022 9:42	0.333	0.014	0.0187	No	0.4546	No
10/14/2022 9:43	0.185	0.025	0.0197	No	0.4313	No

Downwind Station

Time	Instantaneous VOC (ppm)	Instantaneous Mass Conc. Total (mg/m ³)	Mass Conc. Total mg/m ³ AVG 15m (mg/m ³)	Dust Exceedance	VOC ppm AVG 15m (ppm)	VOC Exceedance
10/14/2022 9:44	0.406	0.03	0.0207	No	0.4423	No
10/14/2022 9:45	0.359	0.024	0.0209	No	0.4451	No
10/14/2022 9:46	0.317	0.021	0.0202	No	0.4499	No
10/14/2022 9:47	0.16	0.037	0.0205	No	0.4394	No
10/14/2022 9:48	0.198	0.04	0.0226	No	0.4324	No
10/14/2022 9:49	0.181	0.014	0.0229	No	0.3997	No
10/14/2022 9:50	0.197	0.009	0.0223	No	0.3852	No
10/14/2022 9:51	0.23	0.017	0.0219	No	0.3231	No
10/14/2022 9:52	0.392	0.031	0.022	No	0.309	No
10/14/2022 9:53	0.21	0.021	0.0223	No	0.288	No
10/14/2022 9:54	0.174	0.016	0.0221	No	0.2671	No
10/14/2022 9:55	0.105	0.016	0.0221	No	0.2539	No
10/14/2022 9:56	0.165	0.007	0.0215	No	0.2408	No
10/14/2022 9:57	0.245	0.009	0.0211	No	0.2349	No
10/14/2022 9:58	0.377	0.011	0.0202	No	0.2477	No
10/14/2022 9:59	0.247	0.01	0.0189	No	0.2371	No
10/14/2022 10:00	0.196	0.007	0.0177	No	0.2263	No
10/14/2022 10:01	0.349	0.014	0.0173	No	0.2284	No
10/14/2022 10:02	0.436	0.018	0.016	No	0.2468	No
10/14/2022 10:03	0.337	0.015	0.0143	No	0.2561	No
10/14/2022 10:04	0.195	0.011	0.0141	No	0.257	No
10/14/2022 10:05	0.19	0.036	0.0159	No	0.2565	No
10/14/2022 10:06	0.164	0.035	0.0171	No	0.2521	No
10/14/2022 10:07	0.063	0.012	0.0159	No	0.2302	No
10/14/2022 10:08	0.333	0.013	0.0153	No	0.2384	No
10/14/2022 10:09	0.179	0.016	0.0153	No	0.2387	No
10/14/2022 10:10	0.084	0.01	0.0149	No	0.2373	No
10/14/2022 10:11	0.048	0.007	0.0149	No	0.2295	No
10/14/2022 10:12	0.117	0.012	0.0151	No	0.221	No
10/14/2022 10:13	0.097	0.016	0.0155	No	0.2023	No
10/14/2022 10:14	0.033	0.014	0.0157	No	0.1881	No
10/14/2022 10:15	0.116	0.012	0.0161	No	0.1827	No
10/14/2022 10:16	0.171	0.015	0.0161	No	0.1709	No
10/14/2022 10:17	0.405	0.009	0.0155	No	0.1688	No
10/14/2022 10:18	0.105	0.012	0.0153	No	0.1533	No
10/14/2022 10:19	0.111	0.008	0.0151	No	0.1477	No
10/14/2022 10:20	0.216	0.01	0.0134	No	0.1495	No
10/14/2022 10:21	0.081	0.012	0.0119	No	0.1439	No
10/14/2022 10:22	0.11	0.012	0.0119	No	0.1471	No
10/14/2022 10:23	0.125	0.011	0.0117	No	0.1332	No
10/14/2022 10:24	0.119	0.012	0.0115	No	0.1292	No
10/14/2022 10:25	0.038	0.011	0.0115	No	0.1261	No
10/14/2022 10:26	0.097	0.014	0.012	No	0.1294	No
10/14/2022 10:27	0.018	0.009	0.0118	No	0.1228	No
10/14/2022 10:28	0.047	0.009	0.0113	No	0.1195	No
10/14/2022 10:29	0.13	0.006	0.0108	No	0.1259	No
10/14/2022 10:30	0.078	0.009	0.0106	No	0.1234	No
10/14/2022 10:31	0.145	0.025	0.0113	No	0.1217	No
10/14/2022 10:32	0.079	0.011	0.0114	No	0.0999	No
10/14/2022 10:33	0.14	0.013	0.0115	No	0.1023	No
10/14/2022 10:34	0.051	0.009	0.0115	No	0.0983	No
10/14/2022 10:35	0.227	0.01	0.0115	No	0.099	No
10/14/2022 10:36	0.017	0.009	0.0113	No	0.0947	No
10/14/2022 10:37	0.033	0.009	0.0111	No	0.0896	No
10/14/2022 10:38	0.04	0.012	0.0112	No	0.0839	No

Downwind Station

Time	Instantaneous VOC (ppm)	Instantaneous Mass Conc. Total (mg/m ³)	Mass Conc. Total mg/m ³ AVG 15m (mg/m ³)	Dust Exceedance	VOC ppm AVG 15m (ppm)	VOC Exceedance
10/14/2022 10:39	0	0.011	0.0111	No	0.076	No
10/14/2022 10:40	0.086	0.007	0.0109	No	0.0792	No
10/14/2022 10:41	0.002	0.012	0.0107	No	0.0729	No
10/14/2022 10:42	0	0.014	0.0111	No	0.0717	No
10/14/2022 10:43	0.085	0.011	0.0112	No	0.0742	No
10/14/2022 10:44	0	0.013	0.0117	No	0.0655	No
10/14/2022 10:45	0.052	0.012	0.0119	No	0.0638	No
10/14/2022 10:46	0.082	0.012	0.011	No	0.0596	No
10/14/2022 10:47	0.007	0.01	0.0109	No	0.0548	No
10/14/2022 10:48	0.464	0.01	0.0107	No	0.0764	No
10/14/2022 10:49	0.132	0.006	0.0105	No	0.0818	No
10/14/2022 10:50	0.133	0.013	0.0107	No	0.0755	No
10/14/2022 10:51	0.301	0.007	0.0106	No	0.0945	No
10/14/2022 10:52	0.172	0.009	0.0106	No	0.1037	No
10/14/2022 10:53	0.045	0.008	0.0103	No	0.1041	No
10/14/2022 10:54	0.413	0.006	0.01	No	0.1316	No
10/14/2022 10:55	0.724	0.009	0.0101	No	0.1741	No
10/14/2022 10:56	0.279	0.016	0.0104	No	0.1926	No
10/14/2022 10:57	0.172	0.012	0.0103	No	0.2041	No
10/14/2022 10:58	0.163	0.017	0.0107	No	0.2093	No
10/14/2022 10:59	0.324	0.011	0.0105	No	0.2309	No
10/14/2022 11:00	0.428	0.007	0.0102	No	0.2559	No
10/14/2022 11:01	0.297	0.01	0.0101	No	0.2703	No
10/14/2022 11:02	0.16	0.012	0.0102	No	0.2805	No
10/14/2022 11:03	0.318	0.008	0.0101	No	0.2707	No
10/14/2022 11:04	0.267	0.01	0.0103	No	0.2797	No
10/14/2022 11:05	0.321	0.013	0.0103	No	0.2923	No
10/14/2022 11:06	0.335	0.014	0.0108	No	0.2945	No
10/14/2022 11:07	0.172	0.009	0.0108	No	0.2945	No
10/14/2022 11:08	0.241	0.01	0.0109	No	0.3076	No
10/14/2022 11:09	0.231	0.009	0.0111	No	0.2955	No
10/14/2022 11:10	0.29	0.009	0.0111	No	0.2665	No
10/14/2022 11:11	0.211	0.009	0.0107	No	0.262	No
10/14/2022 11:12	0.286	0.042	0.0127	No	0.2696	No
10/14/2022 11:13	0.402	0.009	0.0121	No	0.2855	No
10/14/2022 11:14	0.151	0.015	0.0124	No	0.274	No
10/14/2022 11:15	0.147	0.018	0.0131	No	0.2553	No
10/14/2022 11:16	0.041	0.008	0.013	No	0.2382	No
10/14/2022 11:17	0.037	0.007	0.0127	No	0.23	No
10/14/2022 11:18	0.249	0.007	0.0126	No	0.2254	No
10/14/2022 11:19	0.082	0.008	0.0125	No	0.2131	No
10/14/2022 11:20	0.125	0.008	0.0121	No	0.2	No
10/14/2022 11:21	0.223	0.01	0.0119	No	0.1925	No
10/14/2022 11:22	0.166	0.011	0.012	No	0.1921	No
10/14/2022 11:23	0.09	0.008	0.0119	No	0.1821	No
10/14/2022 11:24	0.072	0.009	0.0119	No	0.1715	No
10/14/2022 11:25	0.035	0.007	0.0117	No	0.1545	No
10/14/2022 11:26	0.086	0.007	0.0116	No	0.1461	No
10/14/2022 11:27	0.101	0.008	0.0093	No	0.1338	No
10/14/2022 11:28	0.108	0.009	0.0093	No	0.1142	No
10/14/2022 11:29	0.169	0.083	0.0139	No	0.1154	No
10/14/2022 11:30	0.154	0.029	0.0146	No	0.1159	No
10/14/2022 11:31	0.108	0.01	0.0147	No	0.1203	No
10/14/2022 11:32	0.111	0.009	0.0149	No	0.1253	No
10/14/2022 11:33	0.202	0.01	0.0151	No	0.1221	No

Downwind Station

Time	Instantaneous VOC (ppm)	Instantaneous Mass Conc. Total (mg/m ³)	Mass Conc. Total mg/m ³ AVG 15m (mg/m ³)	Dust Exceedance	VOC ppm AVG 15m (ppm)	VOC Exceedance
10/14/2022 11:34	0.241	0.014	0.0155	No	0.1327	No
10/14/2022 11:35	0.251	0.019	0.0162	No	0.1411	No
10/14/2022 11:36	0.179	0.012	0.0163	No	0.1382	No
10/14/2022 11:37	0.259	0.012	0.0164	No	0.1444	No
10/14/2022 11:38	0.263	0.012	0.0167	No	0.1559	No
10/14/2022 11:39	0.137	0.012	0.0169	No	0.1603	No
10/14/2022 11:40	0.092	0.009	0.017	No	0.1641	No
10/14/2022 11:41	0.148	0.012	0.0173	No	0.1682	No
10/14/2022 11:42	0.092	0.007	0.0173	No	0.1676	No
10/14/2022 11:43	0.068	0.007	0.0171	No	0.1649	No
10/14/2022 11:44	0.179	0.008	0.0121	No	0.1656	No
10/14/2022 11:45	0.146	0.012	0.011	No	0.1651	No
10/14/2022 11:46	0.105	0.017	0.0115	No	0.1649	No
10/14/2022 11:47	0.154	0.01	0.0115	No	0.1677	No
10/14/2022 11:48	0.098	0.012	0.0117	No	0.1608	No
10/14/2022 11:49	0.064	0.014	0.0117	No	0.149	No
10/14/2022 11:50	0.039	0.011	0.0111	No	0.1349	No
10/14/2022 11:51	0.035	0.01	0.011	No	0.1253	No
10/14/2022 11:52	0.039	0.009	0.0108	No	0.1106	No
10/14/2022 11:53	0.174	0.01	0.0107	No	0.1047	No
10/14/2022 11:54	0.051	0.009	0.0105	No	0.0989	No
10/14/2022 11:55	0.078	0.011	0.0106	No	0.098	No
10/14/2022 11:56	0.115	0.01	0.0105	No	0.0958	No
10/14/2022 11:57	0.188	0.011	0.0107	No	0.1022	No
10/14/2022 11:58	0.082	0.01	0.0109	No	0.1031	No
10/14/2022 11:59	0.065	0.007	0.0109	No	0.0955	No
10/14/2022 12:00	0.071	0.007	0.0105	No	0.0905	No
10/14/2022 12:01	0.079	0.007	0.0099	No	0.0888	No
10/14/2022 12:02	0.057	0.007	0.0097	No	0.0823	No
10/14/2022 12:03	0.099	0.011	0.0096	No	0.0824	No
10/14/2022 12:04	0.154	0.019	0.0099	No	0.0884	No
10/14/2022 12:05	0.058	0.01	0.0099	No	0.0897	No
10/14/2022 12:06	0.033	0.008	0.0097	No	0.0895	No
10/14/2022 12:07	0.044	0.012	0.0099	No	0.0899	No
10/14/2022 12:08	0.087	0.007	0.0097	No	0.0841	No
10/14/2022 12:09	0.059	0.008	0.0097	No	0.0846	No
10/14/2022 12:10	0.04	0.011	0.0097	No	0.0821	No
10/14/2022 12:11	0.054	0.008	0.0095	No	0.078	No
10/14/2022 12:12	0.026	0.012	0.0096	No	0.0672	No
10/14/2022 12:13	0.024	0.01	0.0096	No	0.0633	No
10/14/2022 12:14	0.12	0.009	0.0097	No	0.067	No
10/14/2022 12:15	0.04	0.012	0.0101	No	0.0649	No
10/14/2022 12:16	0.137	0.009	0.0102	No	0.0688	No
10/14/2022 12:17	0.125	0.009	0.0103	No	0.0733	No
10/14/2022 12:18	0.067	0.008	0.0101	No	0.0712	No
10/14/2022 12:19	0.041	0.006	0.0093	No	0.0637	No
10/14/2022 12:20	0.047	0.007	0.0091	No	0.0629	No
10/14/2022 12:21	0.063	0.014	0.0095	No	0.0649	No
10/14/2022 12:22	0.118	0.01	0.0093	No	0.0699	No
10/14/2022 12:23	0.061	0.012	0.0097	No	0.0681	No
10/14/2022 12:24	0.097	0.024	0.0107	No	0.0707	No
10/14/2022 12:25	0.025	0.013	0.0109	No	0.0697	No
10/14/2022 12:26	0.089	0.01	0.011	No	0.072	No
10/14/2022 12:27	0.129	0.013	0.0111	No	0.0789	No
10/14/2022 12:28	0.105	0.016	0.0115	No	0.0843	No

Downwind Station

Time	Instantaneous VOC (ppm)	Instantaneous Mass Conc. Total (mg/m ³)	Mass Conc. Total mg/m ³ AVG 15m (mg/m ³)	Dust Exceedance	VOC ppm AVG 15m (ppm)	VOC Exceedance
10/14/2022 12:29	0.038	0.01	0.0115	No	0.0788	No
10/14/2022 12:30	0.036	0.014	0.0117	No	0.0785	No
10/14/2022 12:31	0.099	0.012	0.0119	No	0.076	No
10/14/2022 12:32	0.143	0.013	0.0121	No	0.0772	No
10/14/2022 12:33	0.089	0.011	0.0123	No	0.0787	No
10/14/2022 12:34	0.068	0.014	0.0129	No	0.0805	No
10/14/2022 12:35	0.125	0.026	0.0141	No	0.0857	No
10/14/2022 12:36	0.188	0.015	0.0142	No	0.094	No
10/14/2022 12:37	0.139	0.014	0.0145	No	0.0954	No
10/14/2022 12:38	0.128	0.018	0.0149	No	0.0999	No
10/14/2022 12:39	0.138	0.021	0.0147	No	0.1026	No
10/14/2022 12:40	0.164	0.019	0.0151	No	0.1119	No
10/14/2022 12:41	0.101	0.029	0.0163	No	0.1127	No
10/14/2022 12:42	0.161	0.032	0.0176	No	0.1148	No
10/14/2022 12:43	0.133	0.021	0.0179	No	0.1167	No
10/14/2022 12:44	0.176	0.02	0.0186	No	0.1259	No
10/14/2022 12:45	0.155	0.022	0.0191	No	0.1338	No
10/14/2022 12:46	0.175	0.017	0.0195	No	0.1389	No
10/14/2022 12:47	0.133	0.018	0.0198	No	0.1382	No
10/14/2022 12:48	0.122	0.032	0.0212	No	0.1404	No
10/14/2022 12:49	0.15	0.031	0.0223	No	0.1459	No
10/14/2022 12:50	0.097	0.064	0.0249	No	0.144	No
10/14/2022 12:51	0.086	0.041	0.0266	No	0.1372	No
10/14/2022 12:52	0.093	0.021	0.0271	No	0.1341	No
10/14/2022 12:53	0.178	0.021	0.0273	No	0.1375	No
10/14/2022 12:54	0.114	0.022	0.0273	No	0.1359	No
10/14/2022 12:55	0.117	0.031	0.0281	No	0.1327	No
10/14/2022 12:56	0.082	0.097	0.0327	No	0.1315	No
10/14/2022 12:57	0.138	0.094	0.0368	No	0.1299	No
10/14/2022 12:58	0.109	0.017	0.0365	No	0.1283	No
10/14/2022 12:59	0.107	0.024	0.0368	No	0.1237	No
10/14/2022 13:00	0.15	0.04	0.038	No	0.1234	No
10/14/2022 13:01	0.129	0.031	0.0389	No	0.1203	No
10/14/2022 13:02	0.097	0.023	0.0393	No	0.1179	No
10/14/2022 13:03	0.074	0.016	0.0382	No	0.1147	No
10/14/2022 13:04	0.118	0.026	0.0379	No	0.1126	No
10/14/2022 13:05	0.12	0.014	0.0345	No	0.1141	No
10/14/2022 13:06	0.095	0.013	0.0327	No	0.1147	No
10/14/2022 13:07	0.11	0.022	0.0327	No	0.1159	No
10/14/2022 13:08	0.102	0.015	0.0323	No	0.1108	No
10/14/2022 13:09	0.096	0.02	0.0322	No	0.1096	No
10/14/2022 13:10	0.117	0.023	0.0317	No	0.1096	No
10/14/2022 13:11	0.096	0.019	0.0265	No	0.1105	No
10/14/2022 13:12	0.123	0.019	0.0215	No	0.1095	No
10/14/2022 13:13	0.066	0.016	0.0214	No	0.1067	No
10/14/2022 13:14	0.112	0.024	0.0214	No	0.107	No
10/14/2022 13:15	0.113	0.037	0.0212	No	0.1045	No
10/14/2022 13:16	0.096	0.028	0.021	No	0.1023	No
10/14/2022 13:17	0.062	0.019	0.0207	No	0.1	No
10/14/2022 13:18	0.151	0.027	0.0215	No	0.1051	No
10/14/2022 13:19	0.072	0.02	0.0211	No	0.1021	No
10/14/2022 13:20	0.058	0.01	0.0208	No	0.0979	No
10/14/2022 13:21	0.088	0.017	0.0211	No	0.0975	No
10/14/2022 13:22	0.088	0.016	0.0207	No	0.096	No
10/14/2022 13:23	0.041	0.027	0.0215	No	0.0919	No

Downwind Station

Time	Instantaneous VOC (ppm)	Instantaneous Mass Conc. Total (mg/m ³)	Mass Conc. Total mg/m ³ AVG 15m (mg/m ³)	Dust Exceedance	VOC ppm AVG 15m (ppm)	VOC Exceedance
10/14/2022 13:24	0.066	0.034	0.0224	No	0.0899	No
10/14/2022 13:25	0.064	0.034	0.0231	No	0.0864	No
10/14/2022 13:26	0.118	0.025	0.0235	No	0.0879	No
10/14/2022 13:27	0.107	0.026	0.024	No	0.0868	No
10/14/2022 13:28	0.04	0.023	0.0245	No	0.0851	No
10/14/2022 13:29	0.053	0.018	0.0241	No	0.0811	No
10/14/2022 13:30	0.094	0.025	0.0233	No	0.0799	No
10/14/2022 13:31	0.05	0.014	0.0223	No	0.0768	No
10/14/2022 13:32	0.118	0.026	0.0228	No	0.0805	No
10/14/2022 13:33	0.065	0.036	0.0234	No	0.0748	No
10/14/2022 13:34	0.069	0.016	0.0231	No	0.0746	No
10/14/2022 13:35	0.129	0.02	0.0238	No	0.0793	No
10/14/2022 13:36	0.075	0.031	0.0247	No	0.0785	No
10/14/2022 13:37	0.068	0.024	0.0253	No	0.0771	No
10/14/2022 13:38	0.091	0.013	0.0243	No	0.0805	No
10/14/2022 13:39	0.059	0.011	0.0228	No	0.08	No
10/14/2022 13:40	0.133	0.012	0.0213	No	0.0846	No
10/14/2022 13:41	0.081	0.015	0.0207	No	0.0821	No
10/14/2022 13:42	0.061	0.009	0.0195	No	0.0791	No
10/14/2022 13:43	0.055	0.007	0.0185	No	0.0801	No
10/14/2022 13:44	0.073	0.017	0.0184	No	0.0814	No
10/14/2022 13:45	0.079	0.022	0.0182	No	0.0804	No
10/14/2022 13:46	0.131	0.038	0.0198	No	0.0858	No
10/14/2022 13:47	0.051	0.02	0.0194	No	0.0813	No
10/14/2022 13:48	0.084	0.02	0.0183	No	0.0826	No
10/14/2022 13:49	0.293	0.023	0.0188	No	0.0975	No
10/14/2022 13:50	0.124	0.021	0.0189	No	0.0972	No
10/14/2022 13:51	0.061	0.013	0.0177	No	0.0963	No
10/14/2022 13:52	0.032	0.024	0.0177	No	0.0939	No
10/14/2022 13:53	0.052	0.013	0.0177	No	0.0913	No
10/14/2022 13:54	0.09	0.012	0.0177	No	0.0933	No
10/14/2022 13:55	0.057	0.013	0.0178	No	0.0883	No
10/14/2022 13:56	0.052	0.013	0.0177	No	0.0863	No
10/14/2022 13:57	0.035	0.023	0.0186	No	0.0846	No
10/14/2022 13:58	0.085	0.021	0.0195	No	0.0866	No
10/14/2022 13:59	0.093	0.017	0.0195	No	0.0879	No
10/14/2022 14:00	0.068	0.065	0.0224	No	0.0872	No
10/14/2022 14:01	0.12	0.121	0.0279	No	0.0865	No
10/14/2022 14:02	0.084	0.184	0.0389	No	0.0887	No
10/14/2022 14:03	0.089	0.02	0.0389	No	0.089	No
10/14/2022 14:04	0.151	0.015	0.0383	No	0.0795	No
10/14/2022 14:05	0.109	0.019	0.0382	No	0.0785	No
10/14/2022 14:06	0.104	0.021	0.0387	No	0.0814	No
10/14/2022 14:07	0.092	0.029	0.0391	No	0.0854	No
10/14/2022 14:08	0.093	0.022	0.0397	No	0.0881	No
10/14/2022 14:09	0.114	0.031	0.0409	No	0.0897	No
10/14/2022 14:10	0.077	0.023	0.0416	No	0.0911	No
10/14/2022 14:11	0.09	0.015	0.0417	No	0.0936	No
10/14/2022 14:12	0.058	0.012	0.041	No	0.0951	No
10/14/2022 14:13	0.063	0.012	0.0404	No	0.0937	No
10/14/2022 14:14	0.08	0.015	0.0403	No	0.0928	No
10/14/2022 14:15	0.117	0.039	0.0385	No	0.0961	No
10/14/2022 14:16	0.057	0.032	0.0326	No	0.0919	No
10/14/2022 14:17	0.058	0.02	0.0217	No	0.0901	No
10/14/2022 14:18	0.091	0.013	0.0212	No	0.0903	No

Downwind Station

Time	Instantaneous VOC (ppm)	Instantaneous Mass Conc. Total (mg/m ³)	Mass Conc. Total mg/m ³ AVG 15m (mg/m ³)	Dust Exceedance	VOC ppm AVG 15m (ppm)	VOC Exceedance
10/14/2022 14:19	0.072	0.015	0.0212	No	0.085	No
10/14/2022 14:20	0.079	0.016	0.021	No	0.083	No
10/14/2022 14:21	0.053	0.022	0.0211	No	0.0796	No
10/14/2022 14:22	0.104	0.018	0.0203	No	0.0804	No
10/14/2022 14:23	0.086	0.02	0.0202	No	0.0799	No
10/14/2022 14:24	0.066	0.014	0.0191	No	0.0767	No
10/14/2022 14:25	0.066	0.013	0.0184	No	0.076	No
10/14/2022 14:26	0.065	0.014	0.0183	No	0.0743	No
10/14/2022 14:27	0.061	0.013	0.0184	No	0.0745	No
10/14/2022 14:28	0.12	0.01	0.0183	No	0.0783	No
10/14/2022 14:29	0.068	0.012	0.0181	No	0.0775	No
10/14/2022 14:30	0.098	0.022	0.0169	No	0.0763	No
10/14/2022 14:31	0.066	0.019	0.0161	No	0.0769	No
10/14/2022 14:32	0.069	0.017	0.0159	No	0.0776	No
10/14/2022 14:33	0.126	0.021	0.0164	No	0.0799	No
10/14/2022 14:34	0.135	0.019	0.0167	No	0.0841	No
10/14/2022 14:35	0.11	0.015	0.0166	No	0.0862	No
10/14/2022 14:36	0.088	0.012	0.0159	No	0.0885	No
10/14/2022 14:37	0.082	0.016	0.0158	No	0.0871	No
10/14/2022 14:38	0.151	0.014	0.0154	No	0.0914	No
10/14/2022 14:39	1.157	0.016	0.0155	No	0.1641	No
10/14/2022 14:40	7.362	0.017	0.0158	No	0.6505	No
10/14/2022 14:41	1.13	0.017	0.016	No	0.7215	No
10/14/2022 14:42	0.669	0.019	0.0164	No	0.7621	No
10/14/2022 14:43	0.43	0.017	0.0169	No	0.7827	No
10/14/2022 14:44	0.593	0.016	0.0171	No	0.8177	No
10/14/2022 14:45	1.286	0.02	0.017	No	0.8969	No
10/14/2022 14:46	0.638	0.016	0.0168	No	0.9351	No
10/14/2022 14:47	0.273	0.013	0.0165	No	0.9487	No
10/14/2022 14:48	0.691	0.016	0.0162	No	0.9863	No
10/14/2022 14:49	0.497	0.017	0.0161	No	1.0105	No
10/14/2022 14:50	0.258	0.015	0.0161	No	1.0203	No
10/14/2022 14:51	1.136	0.016	0.0163	No	1.0902	No
10/14/2022 14:52	7.266	0.022	0.0167	No	1.5691	No