



# Daily Activity Report

Seton Brilla Charter School  
 1956 Jerome Avenue, Bronx, NY  
 BCP No. C203152

## General Site Information

Date:	Thursday, October 13, 2022
Weather:	Rainy, 65°F
Wind Direction/Speed:	SW @ 7 mph
AKRF Personnel on Site:	J. Kelleher-Ferguson
AKRF Equipment on Site:	Mini RAE 3000 Photoionization Detector [(PID) x1], 2 Fixed Air Monitoring Stations
Visitors:	None.

## Contractor Information

Contracting Company	Main Personnel	Equipment
Casino Construction	Connor McGrory	Excavator
Core Carpenters	-	Hand Tools

## Description and Location of Work Activities Performed

1) Casino continued pile installation on the south side of the Site.

## Site Soil Disposal Tracking Information

Destination Facility	Daily Trucks	Total Trucks	Daily Approx. Cubic Yds	Total Approx. Cubic Yds	Total Site Loads	Total Approximate Cubic Yards
N/A	-	-	0	0	0	0
N/A	-	-	0	0		
N/A	-	-	0	0		
N/A	-	-	0	0		
N/A	-	-	0	0		

## CAMP Air Monitoring Results

CAMP Station	UPWIND			DOWNWIND		
Odors:	None.			None.		
VOC Action Level Exceedance(s):	None.			None.		
Particulate Action Level Exceedance(s):	None.			None.		
Maximum VOC Level (ppm):	0.000			0.000		
Maximum Particulate Level (mg/m <sup>3</sup> ):	0.039			0.101		

Notes: Due to scattered precipitation throughout the day, CAMP monitoring was only performed between 0800 - 1200.





## Additional Information

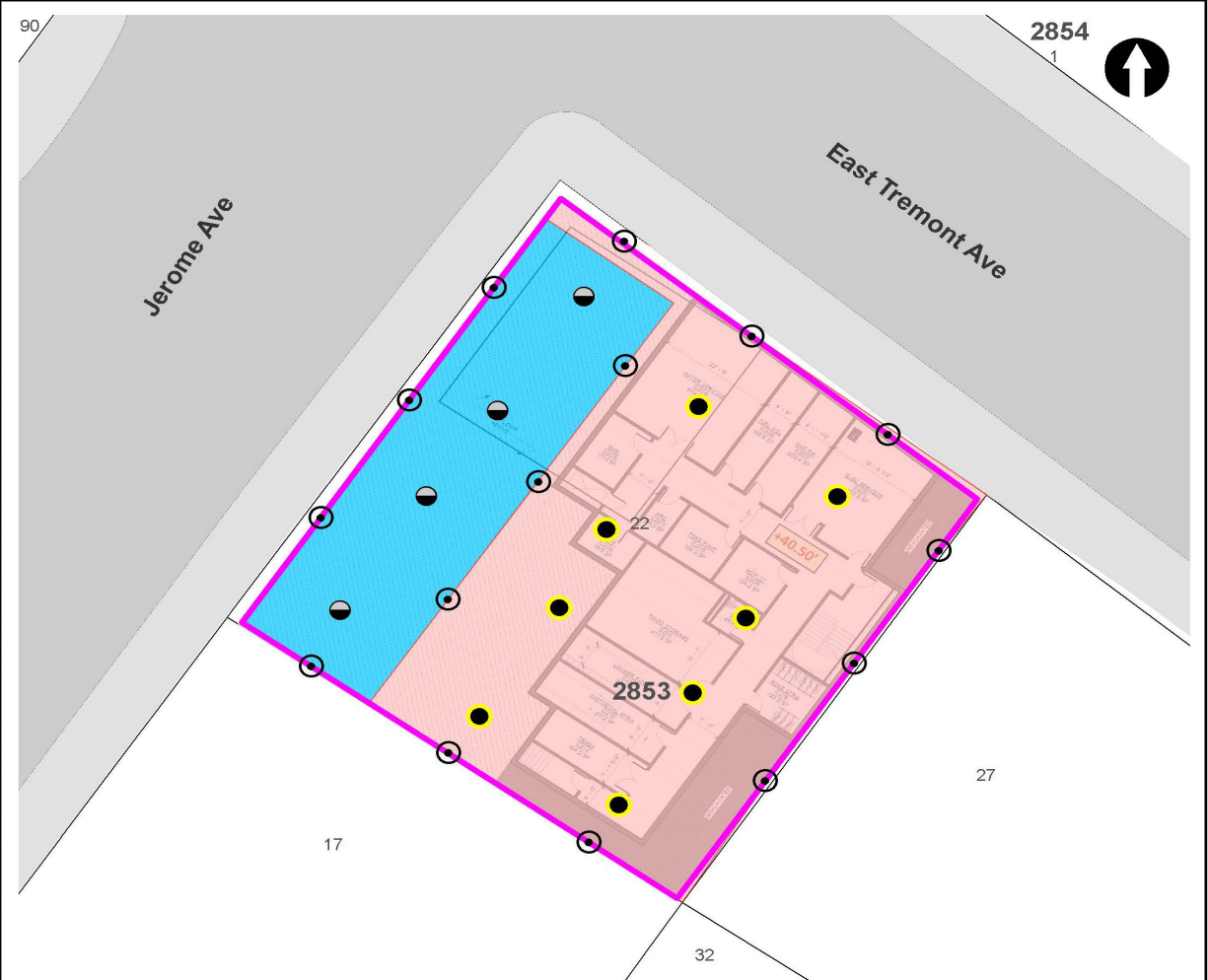

Planned Work Activity for Following Day/Week:	1) Installation of foundation piles.
Comments:	None.

Site Map



**LEGEND**

-  PROJECT SITE BOUNDARY
-  LOT BOUNDARY AND TAX LOT NUMBER
- 2853** BLOCK NUMBER
-  REMEDIAL EXCAVATION TO APPROXIMATELY TWO FEET BELOW EXISTING GRADE
-  REMEDIAL EXCAVATION TO GROUNDWATER (SOURCE AREA)

-  CONFIRMATION DOCUMENTATION BOTTOM SAMPLE
-  SOURCE AREA DOCUMENTATION BOTTOM SAMPLE
-  DOCUMENTATION SIDEWALL SAMPLE

**NOTE**  
 REMEDIAL EXCAVATION WILL INCLUDE REMOVAL OF APPROXIMATELY 1,280 TONS (850 CUBIC YARDS) OF SOURCE MATERIAL ASSOCIATED WITH NYSDEC SPILL NO. 2103719 AND APPROXIMATELY 860 TONS (570 CUBIC YARDS) OF SOIL/FILL FROM THE UPPER 2 FEET SITE-WIDE.



Map Source:  
 NYCDCP (NYC Dept. of City Planning) GIS database

© 2024 AKRF. All Projects 10024 - 156 JEROME AVENUE Technical GIS and Graphics SAR/PA/VP/10024 Figure 9 Proposed Remedial Excavation and Documentation Sample Location Plan.mxd 10/25/2021 2:08:38 PM iszallis

 440 Park Avenue South, New York, NY 10016	<b>156 Jerome Avenue</b> Bronx, New York	DATE <b>04/29/2022</b>
	<b>TRACK 4 CLEANUP AND DOCUMENTATION</b> <b>SAMPLE LOCATION PLAN</b>	PROJECT NO. <b>210024</b>
		FIGURE <b>11</b>

Site Photographs

Photograph 1 -  
Assembling the new  
drill rig, view facing  
southeast.



Photograph 2 -  
Installing lagging  
along the East  
Tremont site  
boundary. View  
facing northeast.



Photograph 3 -  
Equipment delivery,  
view facing  
northeast.



Upwind Station						
Time	Instantaneous VOC (ppm)	Instantaneous Mass Conc. Total (mg/m <sup>3</sup> )	Mass Conc. Total mg/m <sup>3</sup> AVG 15m (mg/m <sup>3</sup> )	Dust Exceedance	VOC ppm AVG 15m (ppm)	VOC Exceedance
10/13/2022 8:44	0			No	0	No
10/13/2022 8:45	0	0.023	0.023	No	0	No
10/13/2022 8:46	0	0.02	0.0215	No	0	No
10/13/2022 8:47	0	0.038	0.027	No	0	No
10/13/2022 8:48	0	0.031	0.028	No	0	No
10/13/2022 8:49	0	0.036	0.0296	No	0	No
10/13/2022 8:50	0	0.043	0.0318	No	0	No
10/13/2022 8:51	0	0.026	0.031	No	0	No
10/13/2022 8:52	0	0.042	0.0324	No	0	No
10/13/2022 8:53	0	0.049	0.0342	No	0	No
10/13/2022 8:54	0	0.038	0.0346	No	0	No
10/13/2022 8:55	0	0.037	0.0348	No	0	No
10/13/2022 8:56	0	0.043	0.0355	No	0	No
10/13/2022 8:57	0	0.068	0.038	No	0	No
10/13/2022 8:58	0	0.046	0.0386	No	0	No
10/13/2022 8:59	0	0.034	0.0383	No	0	No
10/13/2022 9:00	0	0.025	0.0384	No	0	No
10/13/2022 9:01	0	0.031	0.0391	No	0	No
10/13/2022 9:02	0	0.031	0.0387	No	0	No
10/13/2022 9:03	0	0.027	0.0384	No	0	No
10/13/2022 9:04	0	0.027	0.0378	No	0	No
10/13/2022 9:05	0	0.036	0.0373	No	0	No
10/13/2022 9:06	0	0.028	0.0375	No	0	No
10/13/2022 9:07	0	0.018	0.0359	No	0	No
10/13/2022 9:08	0	0.019	0.0339	No	0	No
10/13/2022 9:09	0	0.045	0.0343	No	0	No
10/13/2022 9:10	0	0.035	0.0342	No	0	No
10/13/2022 9:11	0	0.03	0.0333	No	0	No
10/13/2022 9:12	0	0.013	0.0297	No	0	No
10/13/2022 9:13	0	0.013	0.0275	No	0	No
10/13/2022 9:14	0	0.013	0.0261	No	0	No
10/13/2022 9:15	0	0.015	0.0254	No	0	No
10/13/2022 9:16	0	0.012	0.0241	No	0	No
10/13/2022 9:17	0	0.012	0.0229	No	0	No
10/13/2022 9:18	0	0.012	0.0219	No	0	No
10/13/2022 9:19	0	0.013	0.0209	No	0	No
10/13/2022 9:20	0	0.014	0.0195	No	0	No
10/13/2022 9:21	0	0.013	0.0185	No	0	No
10/13/2022 9:22	0	0.013	0.0181	No	0	No
10/13/2022 9:23	0	0.012	0.0177	No	0	No
10/13/2022 9:24	0	0.013	0.0155	No	0	No
10/13/2022 9:25	0	0.014	0.0141	No	0	No
10/13/2022 9:26	0	0.012	0.0129	No	0	No
10/13/2022 9:27	0	0.014	0.013	No	0	No
10/13/2022 9:28	0	0.019	0.0134	No	0	No
10/13/2022 9:29	0	0.019	0.0138	No	0	No
10/13/2022 9:30	0	0.019	0.0141	No	0	No
10/13/2022 9:31	0	0.018	0.0145	No	0	No
10/13/2022 9:32	0	0.017	0.0148	No	0	No
10/13/2022 9:33	0	0.013	0.0149	No	0	No
10/13/2022 9:34	0	0.012	0.0148	No	0	No

**Upwind Station**

Time	Instantaneous VOC (ppm)	Instantaneous Mass Conc. Total (mg/m <sup>3</sup> )	Mass Conc. Total mg/m <sup>3</sup> AVG 15m (mg/m <sup>3</sup> )	Dust Exceedance	VOC ppm AVG 15m (ppm)	VOC Exceedance
10/13/2022 9:35	0	0.021	0.0153	No	0	No
10/13/2022 9:36	0	0.015	0.0154	No	0	No
10/13/2022 9:37	0	0.014	0.0155	No	0	No
10/13/2022 9:38	0	0.014	0.0156	No	0	No
10/13/2022 9:39	0	0.012	0.0155	No	0	No
10/13/2022 9:40	0	0.011	0.0153	No	0	No
10/13/2022 9:41	0	0.012	0.0153	No	0	No
10/13/2022 9:42	0	0.012	0.0152	No	0	No
10/13/2022 9:43	0	0.012	0.0147	No	0	No
10/13/2022 9:44	0	0.012	0.0143	No	0	No
10/13/2022 9:45	0	0.012	0.0138	No	0	No
10/13/2022 9:46	0	0.012	0.0134	No	0	No
10/13/2022 9:47	0	0.012	0.0131	No	0	No
10/13/2022 9:48	0	0.012	0.013	No	0	No
10/13/2022 9:49	0	0.011	0.0129	No	0	No
10/13/2022 9:50	0	0.013	0.0124	No	0	No
10/13/2022 9:51	0	0.012	0.0122	No	0	No
10/13/2022 9:52	0	0.012	0.0121	No	0	No
10/13/2022 9:53	0	0.012	0.0119	No	0	No
10/13/2022 9:54	0	0.011	0.0119	No	0	No
10/13/2022 9:55	0	0.011	0.0119	No	0	No
10/13/2022 9:56	0	0.011	0.0118	No	0	No
10/13/2022 9:57	0	0.011	0.0117	No	0	No
10/13/2022 9:58	0	0.012	0.0117	No	0	No
10/13/2022 9:59	0	0.013	0.0118	No	0	No
10/13/2022 10:00	0	0.017	0.0121	No	0	No
10/13/2022 10:01	0	0.013	0.0122	No	0	No
10/13/2022 10:02	0	0.024	0.013	No	0	No
10/13/2022 10:03	0	0.015	0.0132	No	0	No
10/13/2022 10:04	0	0.03	0.0145	No	0	No
10/13/2022 10:05	0	0.057	0.0174	No	0	No
10/13/2022 10:06	0	0.016	0.0177	No	0	No
10/13/2022 10:07	0	0.016	0.0179	No	0	No
10/13/2022 10:08	0	0.016	0.0182	No	0	No
10/13/2022 10:09	0	0.035	0.0198	No	0	No
10/13/2022 10:10	0	0.037	0.0215	No	0	No
10/13/2022 10:11	0	0.031	0.0229	No	0	No
10/13/2022 10:12	0	0.033	0.0243	No	0	No
10/13/2022 10:13	0	0.029	0.0255	No	0	No
10/13/2022 10:14	0	0.027	0.0264	No	0	No
10/13/2022 10:15	0	0.019	0.0265	No	0	No
10/13/2022 10:16	0	0.013	0.0265	No	0	No
10/13/2022 10:17	0	0.016	0.026	No	0	No
10/13/2022 10:18	0	0.033	0.0272	No	0	No
10/13/2022 10:19	0	0.042	0.028	No	0	No
10/13/2022 10:20	0	0.019	0.0255	No	0	No
10/13/2022 10:21	0	0.016	0.0255	No	0	No
10/13/2022 10:22	0	0.031	0.0265	No	0	No
10/13/2022 10:23	0	0.018	0.0266	No	0	No
10/13/2022 10:24	0	0.029	0.0262	No	0	No
10/13/2022 10:25	0	0.013	0.0246	No	0	No

Upwind Station						
Time	Instantaneous VOC (ppm)	Instantaneous Mass Conc. Total (mg/m <sup>3</sup> )	Mass Conc. Total mg/m <sup>3</sup> AVG 15m (mg/m <sup>3</sup> )	Dust Exceedance	VOC ppm AVG 15m (ppm)	VOC Exceedance
10/13/2022 10:26	0	0.016	0.0236	No	0	No
10/13/2022 10:27	0	0.032	0.0235	No	0	No
10/13/2022 10:28	0	0.016	0.0227	No	0	No
10/13/2022 10:29	0	0.017	0.022	No	0	No
10/13/2022 10:30	0	0.013	0.0216	No	0	No
10/13/2022 10:31	0	0.016	0.0218	No	0	No
10/13/2022 10:32	0	0.022	0.0222	No	0	No
10/13/2022 10:33	0	0.024	0.0216	No	0	No
10/13/2022 10:34	0	0.018	0.02	No	0	No
10/13/2022 10:35	0	0.015	0.0197	No	0	No
10/13/2022 10:36	0	0.02	0.02	No	0	No
10/13/2022 10:37	0	0.02	0.0193	No	0	No
10/13/2022 10:38	0	0.077	0.0232	No	0	No
10/13/2022 10:39	0	0.023	0.0228	No	0	No
10/13/2022 10:40	0	0.015	0.0229	No	0	No
10/13/2022 10:41	0	0.031	0.0239	No	0	No
10/13/2022 10:42	0	0.026	0.0235	No	0	No
10/13/2022 10:43	0	0.016	0.0235	No	0	No
10/13/2022 10:44	0	0.019	0.0237	No	0	No
10/13/2022 10:45	0	0.021	0.0242	No	0	No
10/13/2022 10:46	0	0.038	0.0257	No	0	No
10/13/2022 10:47	0	0.021	0.0256	No	0	No
10/13/2022 10:48	0	0.021	0.0254	No	0	No
10/13/2022 10:49	0	0.032	0.0263	No	0	No
10/13/2022 10:50	0	0.017	0.0265	No	0	No
10/13/2022 10:51	0	0.015	0.0261	No	0	No
10/13/2022 10:52	0	0.014	0.0257	No	0	No
10/13/2022 10:53	0	0.019	0.0219	No	0	No
10/13/2022 10:54	0	0.016	0.0214	No	0	No
10/13/2022 10:55	0	0.027	0.0222	No	0	No
10/13/2022 10:56	0	0.025	0.0218	No	0	No
10/13/2022 10:57	0	0.015	0.0211	No	0	No
10/13/2022 10:58	0	0.019	0.0213	No	0	No
10/13/2022 10:59	0	0.013	0.0209	No	0	No
10/13/2022 11:00	0	0.026	0.0212	No	0	No
10/13/2022 11:01	0	0.014	0.0196	No	0	No
10/13/2022 11:02	0	0.068	0.0227	No	0	No
10/13/2022 11:03	0	0.013	0.0222	No	0	No
10/13/2022 11:04	0	0.027	0.0219	No	0	No
10/13/2022 11:05	0	0.014	0.0217	No	0	No
10/13/2022 11:06	0	0.013	0.0215	No	0	No
10/13/2022 11:07	0	0.031	0.0227	No	0	No
10/13/2022 11:08	0	0.026	0.0231	No	0	No
10/13/2022 11:09	0	0.017	0.0232	No	0	No
10/13/2022 11:10	0	0.021	0.0228	No	0	No
10/13/2022 11:11	0	0.026	0.0229	No	0	No
10/13/2022 11:12	0	0.018	0.0231	No	0	No
10/13/2022 11:13	0	0.033	0.024	No	0	No
10/13/2022 11:14	0	0.044	0.0261	No	0	No
10/13/2022 11:15	0	0.033	0.0265	No	0	No
10/13/2022 11:16	0	0.023	0.0271	No	0	No

**Upwind Station**

Time	Instaneous VOC (ppm)	Instaneous Mass Conc. Total (mg/m³)	Mass Conc. Total mg/m³ AVG 15m (mg/m³)	Dust Exceedance	VOC ppm AVG 15m (ppm)	VOC Exceedance
10/13/2022 11:17	0	0.027	0.0244	No	0	No
10/13/2022 11:18	0	0.021	0.0249	No	0	No
10/13/2022 11:19	0	0.037	0.0256	No	0	No
10/13/2022 11:20	0	0.023	0.0262	No	0	No
10/13/2022 11:21	0	0.052	0.0288	No	0	No
10/13/2022 11:22	0	0.042	0.0295	No	0	No
10/13/2022 11:23	0	0.023	0.0293	No	0	No
10/13/2022 11:24	0	0.014	0.0291	No	0	No
10/13/2022 11:25	0	0.028	0.0296	No	0	No
10/13/2022 11:26	0	0.015	0.0289	No	0	No
10/13/2022 11:27	0	0.018	0.0289	No	0	No
10/13/2022 11:28	0	0.011	0.0274	No	0	No
10/13/2022 11:29	0	0.018	0.0257	No	0	No
10/13/2022 11:30	0	0.026	0.0252	No	0	No
10/13/2022 11:31	0	0.017	0.0248	No	0	No
10/13/2022 11:32	0	0.024	0.0246	No	0	No
10/13/2022 11:33	0	0.014	0.0241	No	0	No
10/13/2022 11:34	0	0.015	0.0227	No	0	No
10/13/2022 11:35	0	0.029	0.0231	No	0	No

**Downwind Station**

Time	Instantaneous VOC (ppm)	Instantaneous Mass Conc. Total (mg/m <sup>3</sup> )	Mass Conc. Total mg/m <sup>3</sup> AVG 15m (mg/m <sup>3</sup> )	Dust Exceedance	VOC ppm AVG 15m (ppm)	VOC Exceedance
10/13/2022 8:45	0			No	0	No
10/13/2022 8:46	0	0.101	0.101	No	0	No
10/13/2022 8:47	0	0.038	0.0695	No	0	No
10/13/2022 8:48	0	0.022	0.0537	No	0	No
10/13/2022 8:49	0	0.017	0.0445	No	0	No
10/13/2022 8:50	0	0.018	0.0392	No	0	No
10/13/2022 8:51	0	0.03	0.0377	No	0	No
10/13/2022 8:52	0	0.021	0.0353	No	0	No
10/13/2022 8:53	0	0.041	0.036	No	0	No
10/13/2022 8:54	0	0.034	0.0358	No	0	No
10/13/2022 8:55	0	0.027	0.0349	No	0	No
10/13/2022 8:56	0	0.034	0.0348	No	0	No
10/13/2022 8:57	0	0.041	0.0353	No	0	No
10/13/2022 8:58	0	0.037	0.0355	No	0	No
10/13/2022 8:59	0	0.028	0.0349	No	0	No
10/13/2022 9:00	0	0.061	0.0367	No	0	No
10/13/2022 9:01	0	0.033	0.0321	No	0	No
10/13/2022 9:02	0	0.02	0.0309	No	0	No
10/13/2022 9:03	0	0.024	0.0311	No	0	No
10/13/2022 9:04	0	0.022	0.0314	No	0	No
10/13/2022 9:05	0	0.017	0.0313	No	0	No
10/13/2022 9:06	0	0.019	0.0306	No	0	No
10/13/2022 9:07	0	0.018	0.0304	No	0	No
10/13/2022 9:08	0	0.016	0.0287	No	0	No
10/13/2022 9:09	0	0.041	0.0292	No	0	No
10/13/2022 9:10	0	0.042	0.0302	No	0	No
10/13/2022 9:11	0	0.03	0.0299	No	0	No
10/13/2022 9:12	0	0.017	0.0283	No	0	No
10/13/2022 9:13	0	0.017	0.027	No	0	No
10/13/2022 9:14	0	0.019	0.0264	No	0	No
10/13/2022 9:15	0	0.017	0.0235	No	0	No
10/13/2022 9:16	0	0.016	0.0223	No	0	No
10/13/2022 9:17	0	0.017	0.0221	No	0	No
10/13/2022 9:18	0	0.015	0.0215	No	0	No
10/13/2022 9:19	0	0.017	0.0212	No	0	No
10/13/2022 9:20	0	0.016	0.0211	No	0	No
10/13/2022 9:21	0	0.015	0.0209	No	0	No
10/13/2022 9:22	0	0.017	0.0208	No	0	No
10/13/2022 9:23	0	0.015	0.0207	No	0	No
10/13/2022 9:24	0	0.016	0.0191	No	0	No
10/13/2022 9:25	0	0.017	0.0174	No	0	No
10/13/2022 9:26	0	0.016	0.0165	No	0	No
10/13/2022 9:27	0	0.016	0.0164	No	0	No
10/13/2022 9:28	0	0.017	0.0164	No	0	No
10/13/2022 9:29	0	0.018	0.0163	No	0	No
10/13/2022 9:30	0	0.017	0.0163	No	0	No
10/13/2022 9:31	0	0.015	0.0163	No	0	No
10/13/2022 9:32	0	0.016	0.0162	No	0	No
10/13/2022 9:33	0	0.016	0.0163	No	0	No
10/13/2022 9:34	0	0.018	0.0163	No	0	No
10/13/2022 9:35	0	0.017	0.0164	No	0	No
10/13/2022 9:36	0	0.016	0.0165	No	0	No
10/13/2022 9:37	0	0.016	0.0164	No	0	No
10/13/2022 9:38	0	0.018	0.0166	No	0	No
10/13/2022 9:39	0	0.017	0.0167	No	0	No



**Downwind Station**

Time	Instantaneous VOC (ppm)	Instantaneous Mass Conc. Total (mg/m <sup>3</sup> )	Mass Conc. Total mg/m <sup>3</sup> AVG 15m (mg/m <sup>3</sup> )	Dust Exceedance	VOC ppm AVG 15m (ppm)	VOC Exceedance
10/13/2022 9:40	0	0.014	0.0165	No	0	No
10/13/2022 9:41	0	0.015	0.0164	No	0	No
10/13/2022 9:42	0	0.015	0.0163	No	0	No
10/13/2022 9:43	0	0.014	0.0161	No	0	No
10/13/2022 9:44	0	0.015	0.0159	No	0	No
10/13/2022 9:45	0	0.014	0.0157	No	0	No
10/13/2022 9:46	0	0.016	0.0158	No	0	No
10/13/2022 9:47	0	0.014	0.0157	No	0	No
10/13/2022 9:48	0	0.015	0.0156	No	0	No
10/13/2022 9:49	0	0.014	0.0153	No	0	No
10/13/2022 9:50	0	0.013	0.0151	No	0	No
10/13/2022 9:51	0	0.014	0.0149	No	0	No
10/13/2022 9:52	0	0.013	0.0147	No	0	No
10/13/2022 9:53	0	0.013	0.0144	No	0	No
10/13/2022 9:54	0	0.013	0.0141	No	0	No
10/13/2022 9:55	0	0.013	0.0141	No	0	No
10/13/2022 9:56	0	0.014	0.014	No	0	No
10/13/2022 9:57	0	0.014	0.0139	No	0	No
10/13/2022 9:58	0	0.014	0.0139	No	0	No
10/13/2022 9:59	0	0.014	0.0139	No	0	No
10/13/2022 10:00	0	0.014	0.0139	No	0	No
10/13/2022 10:01	0	0.018	0.014	No	0	No
10/13/2022 10:02	0	0.015	0.0141	No	0	No
10/13/2022 10:03	0	0.019	0.0143	No	0	No
10/13/2022 10:04	0	0.015	0.0144	No	0	No
10/13/2022 10:05	0	0.015	0.0145	No	0	No
10/13/2022 10:06	0	0.015	0.0146	No	0	No
10/13/2022 10:07	0	0.015	0.0147	No	0	No
10/13/2022 10:08	0	0.017	0.015	No	0	No
10/13/2022 10:09	0	0.039	0.0167	No	0	No
10/13/2022 10:10	0	0.045	0.0189	No	0	No
10/13/2022 10:11	0	0.033	0.0201	No	0	No
10/13/2022 10:12	0	0.037	0.0217	No	0	No
10/13/2022 10:13	0	0.027	0.0225	No	0	No
10/13/2022 10:14	0	0.029	0.0235	No	0	No
10/13/2022 10:15	0	0.017	0.0237	No	0	No
10/13/2022 10:16	0	0.015	0.0235	No	0	No
10/13/2022 10:17	0	0.016	0.0236	No	0	No
10/13/2022 10:18	0	0.022	0.0238	No	0	No
10/13/2022 10:19	0	0.032	0.0249	No	0	No
10/13/2022 10:20	0	0.027	0.0257	No	0	No
10/13/2022 10:21	0	0.017	0.0259	No	0	No
10/13/2022 10:22	0	0.023	0.0264	No	0	No
10/13/2022 10:23	0	0.018	0.0265	No	0	No
10/13/2022 10:24	0	0.017	0.025	No	0	No
10/13/2022 10:25	0	0.017	0.0231	No	0	No
10/13/2022 10:26	0	0.02	0.0223	No	0	No
10/13/2022 10:27	0	0.013	0.0207	No	0	No
10/13/2022 10:28	0	0.016	0.0199	No	0	No
10/13/2022 10:29	0	0.016	0.0191	No	0	No
10/13/2022 10:30	0	0.03	0.0199	No	0	No
10/13/2022 10:31	0	0.017	0.0201	No	0	No
10/13/2022 10:32	0	0.016	0.0201	No	0	No
10/13/2022 10:33	0	0.022	0.0201	No	0	No
10/13/2022 10:34	0	0.025	0.0196	No	0	No

**Downwind Station**

Time	Instantaneous VOC (ppm)	Instantaneous Mass Conc. Total (mg/m <sup>3</sup> )	Mass Conc. Total mg/m <sup>3</sup> AVG 15m (mg/m <sup>3</sup> )	Dust Exceedance	VOC ppm AVG 15m (ppm)	VOC Exceedance
10/13/2022 10:35	0	0.021	0.0192	No	0	No
10/13/2022 10:36	0	0.04	0.0207	No	0	No
10/13/2022 10:37	0	0.02	0.0205	No	0	No
10/13/2022 10:38	0	0.056	0.0231	No	0	No
10/13/2022 10:39	0	0.085	0.0276	No	0	No
10/13/2022 10:40	0	0.014	0.0274	No	0	No
10/13/2022 10:41	0	0.013	0.0269	No	0	No
10/13/2022 10:42	0	0.02	0.0274	No	0	No
10/13/2022 10:43	0	0.057	0.0301	No	0	No
10/13/2022 10:44	0	0.029	0.031	No	0	No
10/13/2022 10:45	0	0.014	0.0299	No	0	No
10/13/2022 10:46	0	0.021	0.0302	No	0	No
10/13/2022 10:47	0	0.022	0.0306	No	0	No
10/13/2022 10:48	0	0.015	0.0301	No	0	No
10/13/2022 10:49	0	0.025	0.0301	No	0	No
10/13/2022 10:50	0	0.028	0.0306	No	0	No
10/13/2022 10:51	0	0.018	0.0291	No	0	No
10/13/2022 10:52	0	0.016	0.0289	No	0	No
10/13/2022 10:53	0	0.021	0.0265	No	0	No
10/13/2022 10:54	0	0.029	0.0228	No	0	No
10/13/2022 10:55	0	0.02	0.0232	No	0	No
10/13/2022 10:56	0	0.028	0.0242	No	0	No
10/13/2022 10:57	0	0.028	0.0247	No	0	No
10/13/2022 10:58	0	0.013	0.0218	No	0	No
10/13/2022 10:59	0	0.02	0.0212	No	0	No
10/13/2022 11:00	0	0.013	0.0211	No	0	No
10/13/2022 11:01	0	0.014	0.0207	No	0	No
10/13/2022 11:02	0	0.021	0.0206	No	0	No
10/13/2022 11:03	0	0.032	0.0217	No	0	No
10/13/2022 11:04	0	0.021	0.0215	No	0	No
10/13/2022 11:05	0	0.039	0.0222	No	0	No
10/13/2022 11:06	0	0.023	0.0225	No	0	No
10/13/2022 11:07	0	0.021	0.0229	No	0	No
10/13/2022 11:08	0	0.013	0.0223	No	0	No
10/13/2022 11:09	0	0.027	0.0222	No	0	No
10/13/2022 11:10	0	0.016	0.0219	No	0	No
10/13/2022 11:11	0	0.014	0.021	No	0	No
10/13/2022 11:12	0	0.032	0.0213	No	0	No
10/13/2022 11:13	0	0.034	0.0227	No	0	No
10/13/2022 11:14	0	0.051	0.0247	No	0	No
10/13/2022 11:15	0	0.039	0.0265	No	0	No
10/13/2022 11:16	0	0.019	0.0268	No	0	No
10/13/2022 11:17	0	0.017	0.0265	No	0	No
10/13/2022 11:18	0	0.024	0.026	No	0	No
10/13/2022 11:19	0	0.11	0.0319	No	0	No
10/13/2022 11:20	0	0.245	0.0457	No	0	No
10/13/2022 11:21	0	0.056	0.0479	No	0	No
10/13/2022 11:22	0	0.023	0.048	No	0	No
10/13/2022 11:23	0	0.025	0.0488	No	0	No
10/13/2022 11:24	0	0.203	0.0605	No	0	No
10/13/2022 11:25	0	0.046	0.0625	No	0	No
10/13/2022 11:26	0	0.019	0.0629	No	0	No
10/13/2022 11:27	0	0.02	0.0621	No	0	No
10/13/2022 11:28	0	0.021	0.0612	No	0	No
10/13/2022 11:29	0	0.017	0.0589	No	0	No

**Downwind Station**

Time	Instantaneous VOC (ppm)	Instantaneous Mass Conc. Total (mg/m <sup>3</sup> )	Mass Conc. Total mg/m <sup>3</sup> AVG 15m (mg/m <sup>3</sup> )	Dust Exceedance	VOC ppm AVG 15m (ppm)	VOC Exceedance
10/13/2022 11:30	0	0.022	0.0578	No	0	No
10/13/2022 11:31	0	0.017	0.0577	No	0	No
10/13/2022 11:32	0	0.016	0.0576	No	0	No
10/13/2022 11:33	0	0.015	0.057	No	0	No
10/13/2022 11:34	0	0.021	0.0511	No	0	No