



Daily Activity Report

Seton Brilla Charter School
 1956 Jerome Avenue, Bronx, NY
 BCP No. C203152

General Site Information

Date:	Tuesday, October 11, 2022
Weather:	Sunny, 60°F
Wind Direction/Speed:	SW @ 6 mph
AKRF Personnel on Site:	J. Kelleher-Ferguson
AKRF Equipment on Site:	Mini RAE 3000 Photoionization Detector [(PID) x1], 2 Fixed Air Monitoring Stations
Visitors:	None.

Contractor Information

Contracting Company	Main Personnel	Equipment
Casino Construction Core Carpenters	Connor McGrory -	Excavator Hand Tools

Description and Location of Work Activities Performed

1) Casino continued pile installation on the south side of the Site.

Site Soil Disposal Tracking Information

Destination Facility	Daily Trucks	Total Trucks	Daily Approx. Cubic Yds	Total Approx. Cubic Yds	Total Site Loads	Total Approximate Cubic Yards
N/A	-	-	0	0	0	0
N/A	-	-	0	0		
N/A	-	-	0	0		
N/A	-	-	0	0		
N/A	-	-	0	0		

CAMP Air Monitoring Results

CAMP Station	UPWIND			DOWNWIND		
Odors:	None.			None.		
VOC Action Level Exceedance(s):	None.			None.		
Particulate Action Level Exceedance(s):	None.			None.		
Maximum VOC Level (ppm):	0.003			0.000		
Maximum Particulate Level (mg/m ³):	0.031			0.041		

Notes: CAMP was performed throughout the day.

Additional Information

Planned Work Activity for Following Day/Week:	1) Installation of foundation piles.
Comments:	None.

Site Map

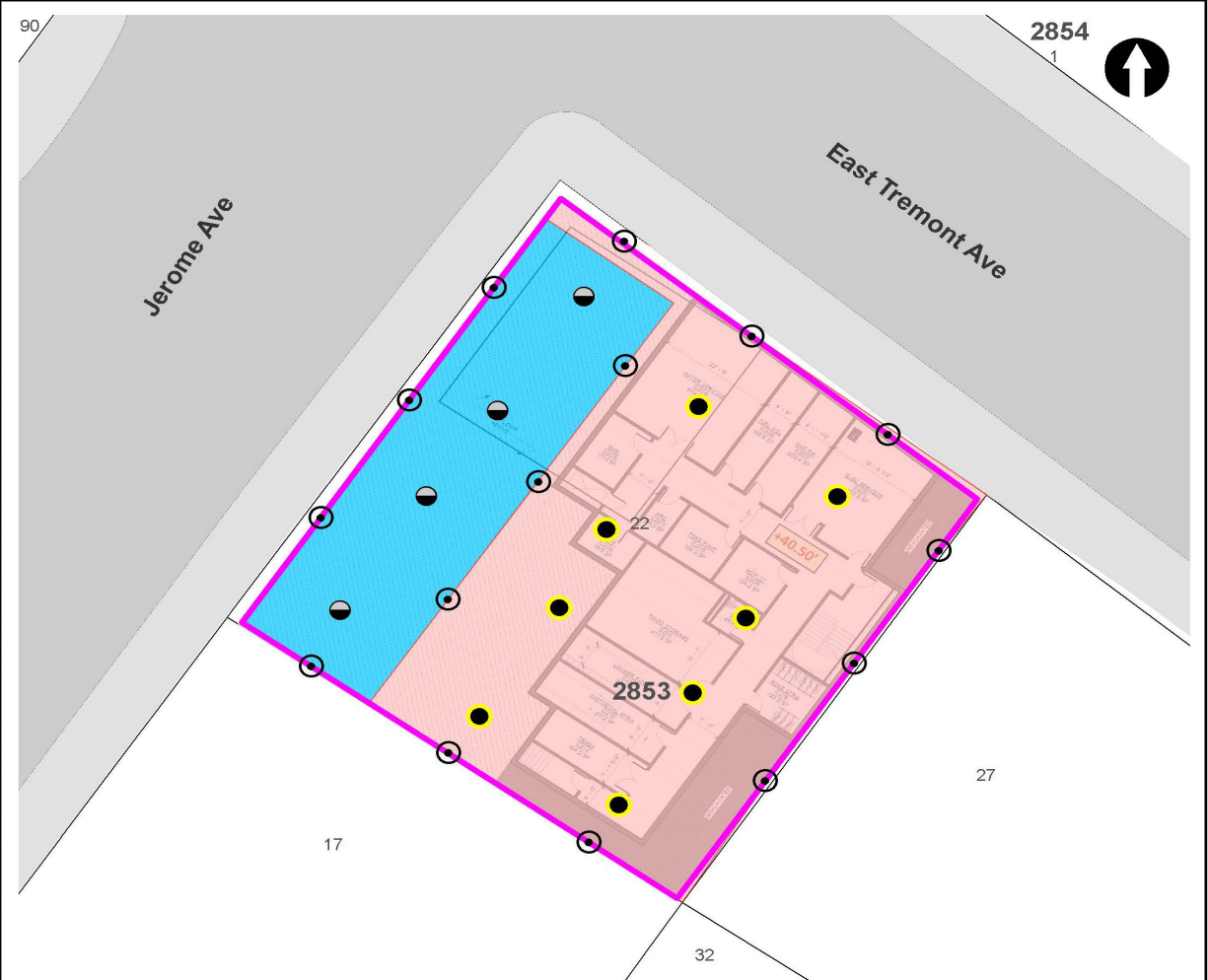

LEGEND

- PROJECT SITE BOUNDARY
- LOT BOUNDARY AND TAX LOT NUMBER
- 2853** BLOCK NUMBER
- REMEDIAL EXCAVATION TO APPROXIMATELY TWO FEET BELOW EXISTING GRADE
- REMEDIAL EXCAVATION TO GROUNDWATER (SOURCE AREA)
- CONFIRMATION DOCUMENTATION BOTTOM SAMPLE
- SOURCE AREA DOCUMENTATION BOTTOM SAMPLE
- DOCUMENTATION SIDEWALL SAMPLE



NOTE
REMEDIAL EXCAVATION WILL INCLUDE REMOVAL OF APPROXIMATELY 1,280 TONS (850 CUBIC YARDS) OF SOURCE MATERIAL ASSOCIATED WITH NYSDEC SPILL NO. 2103719 AND APPROXIMATELY 860 TONS (570 CUBIC YARDS) OF SOIL/FILL FROM THE UPPER 2 FEET SITE-WIDE.

Map Source:
NYC DCP (NYC Dept. of City Planning) GIS database

© 2024 AKRF. All Projects 10024 - 156 JEROME AVENUE Technical GIS and Graphics SAR/PA/VP/10024 Figure 9 Proposed Remedial Excavation and Documentation Sample Location Plan.mxd 10/25/2024 2:08:38 PM iszallis

<p>440 Park Avenue South, New York, NY 10016</p>	<p>156 Jerome Avenue Bronx, New York</p>	<p>DATE 04/29/2022</p>
	<p>TRACK 4 CLEANUP AND DOCUMENTATION SAMPLE LOCATION PLAN</p>	<p>PROJECT NO. 210024</p>
		<p>FIGURE 11</p>

Site Photographs

Photograph 1 - Pile driving on Site, view facing southeast.



Photograph 2 - Casino grouting piles. View facing east.



Photograph 3 - Site overview facing south.



Upwind Station						
Time	Instantaneous VOC (ppm)	Instantaneous Mass Conc. Total (mg/m ³)	Mass Conc. Total mg/m ³ AVG 15m (mg/m ³)	Dust Exceedance	VOC ppm AVG 15m (ppm)	VOC Exceedance
10/11/2022 7:10	0	0.024	0.024	No	0	No
10/11/2022 7:11	0	0.023	0.0235	No	0	No
10/11/2022 7:12	0	0.023	0.0233	No	0	No
10/11/2022 7:13	0	0.022	0.023	No	0	No
10/11/2022 7:14	0	0.022	0.0228	No	0	No
10/11/2022 7:15	0	0.023	0.0228	No	0	No
10/11/2022 7:16	0	0.023	0.0229	No	0	No
10/11/2022 7:17	0	0.023	0.0229	No	0	No
10/11/2022 7:18	0	0.025	0.0231	No	0	No
10/11/2022 7:19	0	0.027	0.0235	No	0	No
10/11/2022 7:20	0	0.025	0.0236	No	0	No
10/11/2022 7:21	0	0.025	0.0237	No	0	No
10/11/2022 7:22	0	0.024	0.0238	No	0	No
10/11/2022 7:23	0	0.039	0.0249	No	0	No
10/11/2022 7:24	0	0.026	0.0249	No	0	No
10/11/2022 7:25	0	0.025	0.025	No	0	No
10/11/2022 7:26	0	0.032	0.0256	No	0	No
10/11/2022 7:27	0	0.03	0.0261	No	0	No
10/11/2022 7:28	0	0.025	0.0263	No	0	No
10/11/2022 7:29	0	0.025	0.0265	No	0	No
10/11/2022 7:30	0	0.03	0.0269	No	0	No
10/11/2022 7:31	0	0.026	0.0271	No	0	No
10/11/2022 7:32	0	0.026	0.0273	No	0	No
10/11/2022 7:33	0	0.027	0.0275	No	0	No
10/11/2022 7:34	0	0.027	0.0275	No	0	No
10/11/2022 7:35	0	0.028	0.0277	No	0	No
10/11/2022 7:36	0	0.027	0.0278	No	0	No
10/11/2022 7:37	0	0.029	0.0281	No	0	No
10/11/2022 7:38	0	0.031	0.0276	No	0	No
10/11/2022 7:39	0	0.032	0.028	No	0	No
10/11/2022 7:40	0	0.03	0.0283	No	0	No
10/11/2022 7:41	0	0.03	0.0282	No	0	No
10/11/2022 7:42	0	0.03	0.0282	No	0	No
10/11/2022 7:43	0	0.028	0.0284	No	0	No
10/11/2022 7:44	0	0.028	0.0286	No	0	No
10/11/2022 7:45	0	0.03	0.0286	No	0	No
10/11/2022 7:46	0	0.029	0.0288	No	0	No
10/11/2022 7:47	0	0.029	0.029	No	0	No
10/11/2022 7:48	0	0.03	0.0292	No	0	No
10/11/2022 7:49	0	0.032	0.0295	No	0	No
10/11/2022 7:50	0	0.029	0.0296	No	0	No
10/11/2022 7:51	0	0.031	0.0299	No	0	No
10/11/2022 7:52	0	0.029	0.0299	No	0	No
10/11/2022 7:53	0	0.03	0.0298	No	0	No
10/11/2022 7:54	0	0.03	0.0297	No	0	No
10/11/2022 7:55	0	0.029	0.0296	No	0	No
10/11/2022 7:56	0	0.028	0.0295	No	0	No
10/11/2022 7:57	0	0.028	0.0293	No	0	No
10/11/2022 7:58	0	0.026	0.0292	No	0	No
10/11/2022 7:59	0	0.029	0.0293	No	0	No
10/11/2022 8:00	0	0.031	0.0293	No	0	No

Upwind Station						
Time	Instantaneous VOC (ppm)	Instantaneous Mass Conc. Total (mg/m ³)	Mass Conc. Total mg/m ³ AVG 15m (mg/m ³)	Dust Exceedance	VOC ppm AVG 15m (ppm)	VOC Exceedance
10/11/2022 8:01	0	0.034	0.0297	No	0	No
10/11/2022 8:02	0	0.029	0.0297	No	0	No
10/11/2022 8:03	0	0.033	0.0299	No	0	No
10/11/2022 8:04	0	0.031	0.0298	No	0	No
10/11/2022 8:05	0	0.028	0.0297	No	0	No
10/11/2022 8:06	0	0.03	0.0297	No	0	No
10/11/2022 8:07	0	0.032	0.0299	No	0	No
10/11/2022 8:08	0	0.036	0.0303	No	0	No
10/11/2022 8:09	0	0.041	0.031	No	0	No
10/11/2022 8:10	0	0.034	0.0313	No	0	No
10/11/2022 8:11	0	0.035	0.0318	No	0	No
10/11/2022 8:12	0	0.04	0.0326	No	0	No
10/11/2022 8:13	0	0.041	0.0336	No	0	No
10/11/2022 8:14	0	0.028	0.0335	No	0	No
10/11/2022 8:15	0	0.026	0.0332	No	0	No
10/11/2022 8:16	0	0.025	0.0326	No	0	No
10/11/2022 8:17	0	0.026	0.0324	No	0	No
10/11/2022 8:18	0	0.025	0.0319	No	0	No
10/11/2022 8:19	0	0.025	0.0315	No	0	No
10/11/2022 8:20	0	0.024	0.0312	No	0	No
10/11/2022 8:21	0	0.025	0.0309	No	0	No
10/11/2022 8:22	0	0.03	0.0307	No	0	No
10/11/2022 8:23	0	0.041	0.0311	No	0	No
10/11/2022 8:24	0	0.035	0.0307	No	0	No
10/11/2022 8:25	0	0.028	0.0303	No	0	No
10/11/2022 8:26	0	0.026	0.0297	No	0	No
10/11/2022 8:27	0	0.027	0.0288	No	0	No
10/11/2022 8:28	0	0.026	0.0278	No	0	No
10/11/2022 8:29	0	0.025	0.0276	No	0	No
10/11/2022 8:30	0	0.025	0.0275	No	0	No
10/11/2022 8:31	0	0.03	0.0279	No	0	No
10/11/2022 8:32	0	0.035	0.0285	No	0	No
10/11/2022 8:33	0	0.062	0.0309	No	0	No
10/11/2022 8:34	0	0.036	0.0317	No	0	No
10/11/2022 8:35	0	0.047	0.0332	No	0	No
10/11/2022 8:36	0	0.041	0.0343	No	0	No
10/11/2022 8:37	0	0.036	0.0347	No	0	No
10/11/2022 8:38	0	0.04	0.0346	No	0	No
10/11/2022 8:39	0	0.032	0.0344	No	0	No
10/11/2022 8:40	0	0.047	0.0357	No	0	No
10/11/2022 8:41	0	0.05	0.0373	No	0	No
10/11/2022 8:42	0	0.036	0.0379	No	0	No
10/11/2022 8:43	0	0.04	0.0388	No	0	No
10/11/2022 8:44	0	0.039	0.0397	No	0	No
10/11/2022 8:45	0	0.042	0.0409	No	0	No
10/11/2022 8:46	0	0.024	0.0405	No	0	No
10/11/2022 8:47	0	0.027	0.0399	No	0	No
10/11/2022 8:48	0	0.03	0.0378	No	0	No
10/11/2022 8:49	0	0.028	0.0373	No	0	No
10/11/2022 8:50	0	0.027	0.0359	No	0	No
10/11/2022 8:51	0	0.028	0.0351	No	0	No

Upwind Station						
Time	Instantaneous VOC (ppm)	Instantaneous Mass Conc. Total (mg/m ³)	Mass Conc. Total mg/m ³ AVG 15m (mg/m ³)	Dust Exceedance	VOC ppm AVG 15m (ppm)	VOC Exceedance
10/11/2022 8:52	0	0.037	0.0351	No	0	No
10/11/2022 8:53	0	0.038	0.035	No	0	No
10/11/2022 8:54	0	0.031	0.0349	No	0	No
10/11/2022 8:55	0	0.024	0.0334	No	0	No
10/11/2022 8:56	0	0.023	0.0316	No	0	No
10/11/2022 8:57	0	0.024	0.0308	No	0	No
10/11/2022 8:58	0	0.027	0.0299	No	0	No
10/11/2022 8:59	0	0.029	0.0293	No	0	No
10/11/2022 9:00	0	0.03	0.0285	No	0	No
10/11/2022 9:01	0	0.038	0.0294	No	0	No
10/11/2022 9:02	0	0.031	0.0297	No	0	No
10/11/2022 9:03	0	0.028	0.0295	No	0	No
10/11/2022 9:04	0	0.041	0.0304	No	0	No
10/11/2022 9:05	0	0.036	0.031	No	0	No
10/11/2022 9:06	0	0.028	0.031	No	0	No
10/11/2022 9:07	0	0.031	0.0306	No	0	No
10/11/2022 9:08	0	0.029	0.03	No	0	No
10/11/2022 9:09	0	0.025	0.0296	No	0	No
10/11/2022 9:10	0	0.029	0.0299	No	0	No
10/11/2022 9:11	0	0.034	0.0307	No	0	No
10/11/2022 9:12	0	0.031	0.0311	No	0	No
10/11/2022 9:13	0	0.034	0.0316	No	0	No
10/11/2022 9:14	0	0.037	0.0321	No	0	No
10/11/2022 9:15	0	0.033	0.0323	No	0	No
10/11/2022 9:16	0	0.036	0.0322	No	0	No
10/11/2022 9:17	0	0.047	0.0333	No	0	No
10/11/2022 9:18	0	0.025	0.0331	No	0	No
10/11/2022 9:19	0	0.025	0.032	No	0	No
10/11/2022 9:20	0	0.026	0.0313	No	0	No
10/11/2022 9:21	0	0.028	0.0313	No	0	No
10/11/2022 9:22	0	0.029	0.0312	No	0	No
10/11/2022 9:23	0	0.037	0.0317	No	0	No
10/11/2022 9:24	0	0.031	0.0321	No	0	No
10/11/2022 9:25	0	0.033	0.0324	No	0	No
10/11/2022 9:26	0	0.033	0.0323	No	0	No
10/11/2022 9:27	0	0.024	0.0319	No	0	No
10/11/2022 9:28	0	0.022	0.0311	No	0	No
10/11/2022 9:29	0	0.018	0.0298	No	0	No
10/11/2022 9:30	0	0.026	0.0293	No	0	No
10/11/2022 9:31	0	0.027	0.0287	No	0	No
10/11/2022 9:32	0	0.02	0.0269	No	0	No
10/11/2022 9:33	0	0.023	0.0268	No	0	No
10/11/2022 9:34	0	0.052	0.0286	No	0	No
10/11/2022 9:35	0	0.029	0.0288	No	0	No
10/11/2022 9:36	0	0.032	0.0291	No	0	No
10/11/2022 9:37	0	0.033	0.0293	No	0	No
10/11/2022 9:38	0	0.03	0.0289	No	0	No
10/11/2022 9:39	0	0.027	0.0286	No	0	No
10/11/2022 9:40	0	0.024	0.028	No	0	No
10/11/2022 9:41	0	0.031	0.0279	No	0	No
10/11/2022 9:42	0	0.028	0.0281	No	0	No

Upwind Station						
Time	Instantaneous VOC (ppm)	Instantaneous Mass Conc. Total (mg/m ³)	Mass Conc. Total mg/m ³ AVG 15m (mg/m ³)	Dust Exceedance	VOC ppm AVG 15m (ppm)	VOC Exceedance
10/11/2022 9:43	0	0.027	0.0285	No	0	No
10/11/2022 9:44	0	0.023	0.0288	No	0	No
10/11/2022 9:45	0	0.028	0.0289	No	0	No
10/11/2022 9:46	0	0.027	0.0289	No	0	No
10/11/2022 9:47	0	0.018	0.0288	No	0	No
10/11/2022 9:48	0	0.025	0.0289	No	0	No
10/11/2022 9:49	0	0.019	0.0267	No	0	No
10/11/2022 9:50	0	0.023	0.0263	No	0	No
10/11/2022 9:51	0	0.028	0.0261	No	0	No
10/11/2022 9:52	0	0.033	0.0261	No	0	No
10/11/2022 9:53	0	0.03	0.0261	No	0	No
10/11/2022 9:54	0	0.044	0.0272	No	0	No
10/11/2022 9:55	0	0.035	0.0279	No	0	No
10/11/2022 9:56	0	0.031	0.0279	No	0	No
10/11/2022 9:57	0	0.038	0.0286	No	0	No
10/11/2022 9:58	0	0.034	0.0291	No	0	No
10/11/2022 9:59	0	0.028	0.0294	No	0	No
10/11/2022 10:00	0	0.025	0.0292	No	0	No
10/11/2022 10:01	0	0.025	0.0291	No	0	No
10/11/2022 10:02	0	0.023	0.0294	No	0	No
10/11/2022 10:03	0	0.019	0.029	No	0	No
10/11/2022 10:04	0	0.021	0.0295	No	0	No
10/11/2022 10:04	0	0.027		No	0	No
10/11/2022 10:05	0			No	0	No
10/11/2022 10:06	0	0.018	0.0293	No	0	No
10/11/2022 10:07	0	0.021	0.0284	No	0	No
10/11/2022 10:08	0	0.022	0.0279	No	0	No
10/11/2022 10:09	0	0.024	0.0264	No	0	No
10/11/2022 10:10	0	0.021	0.0254	No	0	No
10/11/2022 10:11	0	0.019	0.0246	No	0	No
10/11/2022 10:12	0	0.017	0.0231	No	0	No
10/11/2022 10:13	0	0.017	0.0219	No	0	No
10/11/2022 10:14	0	0.018	0.0211	No	0	No
10/11/2022 10:15	0	0.033	0.0217	No	0	No
10/11/2022 10:16	0	0.021	0.0214	No	0	No
10/11/2022 10:17	0	0.03	0.0219	No	0	No
10/11/2022 10:18	0	0.024	0.0223	No	0	No
10/11/2022 10:19	0	0.019	0.0217	No	0	No
10/11/2022 10:20	0	0.027	0.0221	No	0	No
10/11/2022 10:21	0	0.035	0.0232	No	0	No
10/11/2022 10:22	0	0.026	0.0235	No	0	No
10/11/2022 10:23	0	0.028	0.0239	No	0	No
10/11/2022 10:24	0	0.034	0.0246	No	0	No
10/11/2022 10:25	0	0.026	0.0249	No	0	No
10/11/2022 10:26	0	0.02	0.025	No	0	No
10/11/2022 10:27	0	0.037	0.0263	No	0	No
10/11/2022 10:28	0	0.023	0.0267	No	0	No
10/11/2022 10:29	0	0.031	0.0276	No	0	No
10/11/2022 10:30	0	0.032	0.0275	No	0	No
10/11/2022 10:31	0	0.025	0.0278	No	0	No
10/11/2022 10:32	0	0.025	0.0275	No	0	No

Upwind Station						
Time	Instantaneous VOC (ppm)	Instantaneous Mass Conc. Total (mg/m ³)	Mass Conc. Total mg/m ³ AVG 15m (mg/m ³)	Dust Exceedance	VOC ppm AVG 15m (ppm)	VOC Exceedance
10/11/2022 10:33	0	0.023	0.0274	No	0	No
10/11/2022 10:34	0	0.018	0.0273	No	0	No
10/11/2022 10:35	0.086	0.025	0.0272	No	0	No
10/11/2022 10:36	0	0.028	0.0267	No	0	No
10/11/2022 10:37	0	0.018	0.0262	No	0	No
10/11/2022 10:38	0	0.018	0.0255	No	0	No
10/11/2022 10:39	0	0.027	0.0251	No	0	No
10/11/2022 10:40	0	0.025	0.025	No	0	No
10/11/2022 10:41	0.014	0.028	0.0255	No	0	No
10/11/2022 10:42	0	0.036	0.0255	No	0	No
10/11/2022 10:43	0	0.036	0.0263	No	0	No
10/11/2022 10:44	0	0.029	0.0262	No	0	No
10/11/2022 10:45	0	0.043	0.0269	No	0	No
10/11/2022 10:46	0	0.025	0.0269	No	0	No
10/11/2022 10:47	0	0.025	0.0269	No	0	No
10/11/2022 10:48	0	0.025	0.0271	No	0	No
10/11/2022 10:49	0	0.037	0.0283	No	0	No
10/11/2022 10:50	0	0.028	0.0285	No	0	No
10/11/2022 10:51	0.026	0.042	0.0295	No	0	No
10/11/2022 10:52	0.044	0.036	0.0307	No	0	No
10/11/2022 10:53	0.127	0.124	0.0377	No	0	No
10/11/2022 10:54	0	0.432	0.0647	No	0	No
10/11/2022 10:55	0	0.049	0.0663	No	0	No
10/11/2022 10:56	0	0.163	0.0753	No	0	No
10/11/2022 10:57	0	0.075	0.0779	No	0	No
10/11/2022 10:58	0	0.036	0.0779	No	0	No
10/11/2022 10:59	0	0.019	0.0773	No	0	No
10/11/2022 11:00	0	0.019	0.0757	No	0	No
10/11/2022 11:01	0	0.017	0.0751	No	0	No
10/11/2022 11:02	0	0.017	0.0746	No	0	No
10/11/2022 11:03	0	0.029	0.0749	No	0	No
10/11/2022 11:04	0	0.027	0.0742	No	0	No
10/11/2022 11:05	0	0.021	0.0737	No	0	No
10/11/2022 11:06	0	0.019	0.0722	No	0	No
10/11/2022 11:07	0	0.044	0.0727	No	0	No
10/11/2022 11:08	0	0.046	0.0675	No	0	No
10/11/2022 11:09	0	0.144	0.0483	No	0	No
10/11/2022 11:10	0	0.131	0.0538	No	0	No
10/11/2022 11:11	0	0.031	0.045	No	0	No
10/11/2022 11:12	0	0.02	0.0413	No	0	No
10/11/2022 11:13	0	0.036	0.0413	No	0	No
10/11/2022 11:14	0	0.024	0.0417	No	0	No
10/11/2022 11:15	0	0.023	0.0419	No	0	No
10/11/2022 11:16	0	0.017	0.0419	No	0	No
10/11/2022 11:17	0	0.018	0.042	No	0	No
10/11/2022 11:18	0	0.086	0.0458	No	0	No
10/11/2022 11:19	0.034	0.072	0.0488	No	0	No
10/11/2022 11:20	0	0.051	0.0508	No	0	No
10/11/2022 11:21	0	0.044	0.0525	No	0	No
10/11/2022 11:22	0	0.046	0.0526	No	0	No
10/11/2022 11:23	0	0.066	0.0539	No	0	No

Upwind Station

Time	Instantaneous VOC (ppm)	Instantaneous Mass Conc. Total (mg/m ³)	Mass Conc. Total mg/m ³ AVG 15m (mg/m ³)	Dust Exceedance	VOC ppm AVG 15m (ppm)	VOC Exceedance
10/11/2022 11:24	0	0.025	0.046	No	0	No
10/11/2022 11:25	0.008	0.063	0.0415	No	0	No
10/11/2022 11:26	0.014	0.147	0.0492	No	0	No
10/11/2022 11:27	0	0.06	0.0519	No	0	No
10/11/2022 11:28	0.005	0.039	0.0521	No	0	No
10/11/2022 11:29	0.054	0.099	0.0571	No	0	No
10/11/2022 11:30	0	0.039	0.0581	No	0	No
10/11/2022 11:31	0	0.242	0.0731	No	0	No
10/11/2022 11:32	0	0.1	0.0786	No	0	No
10/11/2022 11:33	0	0.099	0.0795	No	0	No
10/11/2022 11:34	0	0.059	0.0786	No	0	No
10/11/2022 11:35	0	0.045	0.0782	No	0	No
10/11/2022 11:36	0	0.092	0.0814	No	0	No
10/11/2022 11:37	0	0.025	0.08	No	0	No
10/11/2022 11:38	0	0.019	0.0769	No	0	No
10/11/2022 11:39	0	0.023	0.0767	No	0	No
10/11/2022 11:40	0	0.026	0.0743	No	0	No
10/11/2022 11:41	0.026	0.022	0.0659	No	0	No
10/11/2022 11:42	0	0.023	0.0635	No	0	No
10/11/2022 11:43	0	0.015	0.0619	No	0	No
10/11/2022 11:44	0	0.02	0.0566	No	0	No
10/11/2022 11:45	0	0.026	0.0557	No	0	No
10/11/2022 11:46	0.01	0.026	0.0413	No	0	No
10/11/2022 11:47	0	0.022	0.0361	No	0	No
10/11/2022 11:48	0	0.016	0.0306	No	0	No
10/11/2022 11:49	0	0.022	0.0281	No	0	No
10/11/2022 11:50	0	0.026	0.0269	No	0	No
10/11/2022 11:51	0	0.018	0.0219	No	0	No
10/11/2022 11:52	0	0.017	0.0214	No	0	No
10/11/2022 11:53	0	0.022	0.0216	No	0	No
10/11/2022 11:54	0	0.019	0.0213	No	0	No
10/11/2022 11:55	0	0.033	0.0218	No	0	No
10/11/2022 11:56	0	0.026	0.0221	No	0	No
10/11/2022 11:57	0	0.021	0.0219	No	0	No
10/11/2022 11:58	0	0.02	0.0223	No	0	No
10/11/2022 11:59	0	0.018	0.0221	No	0	No
10/11/2022 12:00	0	0.019	0.0217	No	0	No
10/11/2022 12:01	0	0.018	0.0211	No	0	No
10/11/2022 12:02	0	0.016	0.0207	No	0	No
10/11/2022 12:03	0	0.016	0.0207	No	0	No
10/11/2022 12:04	0	0.015	0.0203	No	0	No
10/11/2022 12:05	0	0.015	0.0195	No	0	No
10/11/2022 12:06	0	0.015	0.0193	No	0	No
10/11/2022 12:07	0	0.015	0.0192	No	0	No
10/11/2022 12:08	0	0.021	0.0191	No	0	No
10/11/2022 12:09	0	0.037	0.0203	No	0	No
10/11/2022 12:10	0	0.028	0.02	No	0	No
10/11/2022 12:11	0	0.018	0.0195	No	0	No
10/11/2022 12:12	0	0.025	0.0197	No	0	No
10/11/2022 12:13	0	0.025	0.0201	No	0	No
10/11/2022 12:14	0	0.02	0.0202	No	0	No

Upwind Station						
Time	Instantaneous VOC (ppm)	Instantaneous Mass Conc. Total (mg/m ³)	Mass Conc. Total mg/m ³ AVG 15m (mg/m ³)	Dust Exceedance	VOC ppm AVG 15m (ppm)	VOC Exceedance
10/11/2022 12:15	0	0.015	0.0199	No	0	No
10/11/2022 12:16	0	0.016	0.0198	No	0	No
10/11/2022 12:17	0	0.017	0.0199	No	0	No
10/11/2022 12:18	0	0.017	0.0199	No	0	No
10/11/2022 12:19	0	0.017	0.0201	No	0	No
10/11/2022 12:20	0	0.015	0.0201	No	0	No
10/11/2022 12:21	0	0.014	0.02	No	0	No
10/11/2022 12:22	0	0.014	0.0199	No	0	No
10/11/2022 12:23	0	0.016	0.0196	No	0	No
10/11/2022 12:24	0	0.021	0.0185	No	0	No
10/11/2022 12:25	0	0.016	0.0177	No	0	No
10/11/2022 12:26	0	0.015	0.0175	No	0	No
10/11/2022 12:27	0	0.014	0.0168	No	0	No
10/11/2022 12:28	0	0.012	0.0159	No	0	No
10/11/2022 12:29	0	0.014	0.0155	No	0	No
10/11/2022 12:30	0	0.018	0.0157	No	0	No
10/11/2022 12:31	0	0.015	0.0157	No	0	No
10/11/2022 12:32	0	0.012	0.0153	No	0	No
10/11/2022 12:33	0	0.012	0.015	No	0	No
10/11/2022 12:34	0	0.015	0.0149	No	0	No
10/11/2022 12:35	0	0.014	0.0148	No	0	No
10/11/2022 12:36	0	0.013	0.0147	No	0	No
10/11/2022 12:37	0	0.015	0.0148	No	0	No
10/11/2022 12:38	0	0.014	0.0147	No	0	No
10/11/2022 12:39	0	0.07	0.0179	No	0	No
10/11/2022 12:40	0	0.07	0.0215	No	0	No
10/11/2022 12:41	0	0.13	0.0292	No	0	No
10/11/2022 12:42	0	0.042	0.0311	No	0	No
10/11/2022 12:43	0	0.03	0.0323	No	0	No
10/11/2022 12:44	0	0.069	0.0359	No	0	No
10/11/2022 12:45	0	0.026	0.0365	No	0	No
10/11/2022 12:46	0	0.032	0.0376	No	0	No
10/11/2022 12:47	0	0.038	0.0393	No	0	No
10/11/2022 12:48	0	0.014	0.0395	No	0	No
10/11/2022 12:49	0	0.019	0.0397	No	0	No
10/11/2022 12:50	0	0.024	0.0404	No	0	No
10/11/2022 12:51	0	0.017	0.0407	No	0	No
10/11/2022 12:52	0	0.017	0.0408	No	0	No
10/11/2022 12:53	0	0.019	0.0411	No	0	No
10/11/2022 12:54	0	0.021	0.0379	No	0	No
10/11/2022 12:55	0	0.017	0.0343	No	0	No
10/11/2022 12:56	0	0.017	0.0268	No	0	No
10/11/2022 12:57	0	0.019	0.0253	No	0	No
10/11/2022 12:58	0	0.021	0.0247	No	0	No
10/11/2022 12:59	0	0.02	0.0214	No	0	No
10/11/2022 13:00	0	0.017	0.0208	No	0	No
10/11/2022 13:01	0	0.025	0.0203	No	0	No
10/11/2022 13:02	0.119	0.019	0.0191	No	0	No
10/11/2022 13:03	0	0.017	0.0193	No	0	No
10/11/2022 13:04	0	0.025	0.0197	No	0	No
10/11/2022 13:05	0	0.022	0.0195	No	0	No

Upwind Station						
Time	Instantaneous VOC (ppm)	Instantaneous Mass Conc. Total (mg/m³)	Mass Conc. Total mg/m³ AVG 15m (mg/m³)	Dust Exceedance	VOC ppm AVG 15m (ppm)	VOC Exceedance
10/11/2022 13:06	0	0.025	0.0201	No	0	No
10/11/2022 13:07	0	0.029	0.0209	No	0	No
10/11/2022 13:08	0	0.025	0.0213	No	0	No
10/11/2022 13:09	0	0.015	0.0209	No	0	No
10/11/2022 13:10	0	0.02	0.0211	No	0	No
10/11/2022 13:11	0.016	0.016	0.021	No	0	No
10/11/2022 13:12	0	0.024	0.0213	No	0	No
10/11/2022 13:13	0	0.024	0.0215	No	0	No
10/11/2022 13:14	0	0.016	0.0213	No	0	No
10/11/2022 13:15	0	0.014	0.0211	No	0	No
10/11/2022 13:16	0	0.014	0.0203	No	0	No
10/11/2022 13:17	0	0.014	0.02	No	0	No
10/11/2022 13:18	0	0.017	0.02	No	0	No
10/11/2022 13:19	0	0.015	0.0193	No	0	No
10/11/2022 13:20	0	0.015	0.0189	No	0	No
10/11/2022 13:21	0	0.016	0.0183	No	0	No
10/11/2022 13:22	0	0.016	0.0174	No	0	No
10/11/2022 13:23	0	0.018	0.0169	No	0	No
10/11/2022 13:24	0	0.024	0.0175	No	0	No
10/11/2022 13:25	0	0.017	0.0173	No	0	No
10/11/2022 13:26	0	0.018	0.0175	No	0	No
10/11/2022 13:27	0	0.033	0.0181	No	0	No
10/11/2022 13:28	0	0.046	0.0195	No	0	No
10/11/2022 13:29	0	0.03	0.0205	No	0	No
10/11/2022 13:30	0	0.032	0.0217	No	0	No
10/11/2022 13:31	0	0.048	0.0239	No	0	No
10/11/2022 13:32	0	0.027	0.0248	No	0	No
10/11/2022 13:33	0	0.021	0.0251	No	0	No
10/11/2022 13:34	0	0.026	0.0258	No	0	No
10/11/2022 13:35	0	0.042	0.0276	No	0	No
10/11/2022 13:36	0	0.04	0.0292	No	0	No
10/11/2022 13:37	0	0.046	0.0312	No	0	No
10/11/2022 13:38	0	0.038	0.0325	No	0	No
10/11/2022 13:39	0	0.03	0.0329	No	0	No
10/11/2022 13:40	0	0.033	0.034	No	0	No
10/11/2022 13:41	0	0.021	0.0342	No	0	No
10/11/2022 13:42	0	0.023	0.0335	No	0	No
10/11/2022 13:43	0	0.018	0.0317	No	0	No
10/11/2022 13:44	0	0.017	0.0308	No	0	No
10/11/2022 13:45	0	0.017	0.0298	No	0	No
10/11/2022 13:46	0	0.019	0.0279	No	0	No
10/11/2022 13:47	0	0.022	0.0275	No	0	No
10/11/2022 13:48	0	0.018	0.0273	No	0	No
10/11/2022 13:49	0	0.019	0.0269	No	0	No
10/11/2022 13:50	0	0.024	0.0257	No	0	No
10/11/2022 13:51	0	0.018	0.0242	No	0	No
10/11/2022 13:52	0	0.018	0.0223	No	0	No
10/11/2022 13:53	0	0.025	0.0215	No	0	No
10/11/2022 13:54	0	0.029	0.0214	No	0	No
10/11/2022 13:55	0	0.025	0.0209	No	0	No
10/11/2022 13:56	0	0.017	0.0206	No	0	No

Upwind Station						
Time	Instantaneous VOC (ppm)	Instantaneous Mass Conc. Total (mg/m³)	Mass Conc. Total mg/m³ AVG 15m (mg/m³)	Dust Exceedance	VOC ppm AVG 15m (ppm)	VOC Exceedance
10/11/2022 13:57	0	0.018	0.0203	No	0	No
10/11/2022 13:58	0	0.036	0.0215	No	0	No
10/11/2022 13:59	0	0.023	0.0219	No	0	No
10/11/2022 14:00	0	0.023	0.0223	No	0	No
10/11/2022 14:01	0	0.023	0.0225	No	0	No
10/11/2022 14:02	0	0.022	0.0225	No	0	No
10/11/2022 14:03	0	0.021	0.0227	No	0	No
10/11/2022 14:04	0	0.031	0.0235	No	0	No
10/11/2022 14:05	0	0.019	0.0232	No	0	No
10/11/2022 14:06	0	0.02	0.0233	No	0	No
10/11/2022 14:07	0	0.02	0.0235	No	0	No
10/11/2022 14:08	0	0.019	0.0231	No	0	No
10/11/2022 14:09	0	0.019	0.0224	No	0	No
10/11/2022 14:10	0	0.029	0.0227	No	0	No
10/11/2022 14:11	0	0.022	0.023	No	0	No
10/11/2022 14:12	0	0.021	0.0232	No	0	No
10/11/2022 14:13	0	0.018	0.022	No	0	No
10/11/2022 14:14	0	0.023	0.022	No	0	No
10/11/2022 14:15	0	0.022	0.0219	No	0	No
10/11/2022 14:16	0	0.021	0.0218	No	0	No
10/11/2022 14:17	0	0.023	0.0219	No	0	No
10/11/2022 14:18	0	0.025	0.0221	No	0	No
10/11/2022 14:19	0	0.035	0.0224	No	0	No
10/11/2022 14:20	0	0.045	0.0241	No	0	No
10/11/2022 14:21	0	0.026	0.0245	No	0	No
10/11/2022 14:22	0	0.025	0.0249	No	0	No
10/11/2022 14:23	0	0.058	0.0275	No	0	No
10/11/2022 14:24	0	0.033	0.0284	No	0	No
10/11/2022 14:25	0	0.032	0.0286	No	0	No
10/11/2022 14:26	0	0.026	0.0289	No	0	No
10/11/2022 14:27	0	0.03	0.0295	No	0	No
10/11/2022 14:28	0	0.021	0.0297	No	0	No
10/11/2022 14:29	0	0.143	0.0377	No	0	No
10/11/2022 14:30	0	0.068	0.0407	No	0	No
10/11/2022 14:31	0	0.025	0.041	No	0	No
10/11/2022 14:32	0	0.016	0.0405	No	0	No
10/11/2022 14:33	0	0.025	0.0405	No	0	No
10/11/2022 14:34	0	0.028	0.0401	No	0	No
10/11/2022 14:35	0	0.031	0.0391	No	0	No
10/11/2022 14:36	0	0.028	0.0393	No	0	No
10/11/2022 14:37	0	0.021	0.039	No	0	No
10/11/2022 14:38	0	0.033	0.0373	No	0	No
10/11/2022 14:39	0	0.024	0.0367	No	0	No
10/11/2022 14:40	0	0.021	0.036	No	0	No
10/11/2022 14:41	0	0.017	0.0354	No	0	No
10/11/2022 14:42	0	0.016	0.0345	No	0	No
10/11/2022 14:43	0	0.017	0.0342	No	0	No
10/11/2022 14:44	0	0.019	0.0259	No	0	No
10/11/2022 14:45	0	0.021	0.0228	No	0	No
10/11/2022 14:46	0	0.021	0.0225	No	0	No
10/11/2022 14:47	0	0.024	0.0231	No	0	No

Upwind Station

Time	Instaneous VOC (ppm)	Instaneous Mass Conc. Total (mg/m³)	Mass Conc. Total mg/m³ AVG 15m (mg/m³)	Dust Exceedance	VOC ppm AVG 15m (ppm)	VOC Exceedance
10/11/2022 14:48	0	0.02	0.0227	No	0	No
10/11/2022 14:49	0	0.021	0.0223	No	0	No
10/11/2022 14:50	0	0.028	0.0221	No	0	No
10/11/2022 14:51	0	0.024	0.0218	No	0	No
10/11/2022 14:52	0	0.017	0.0215	No	0	No
10/11/2022 14:53	0	0.016	0.0204	No	0	No
10/11/2022 14:54	0	0.027	0.0206	No	0	No
10/11/2022 14:55	0	0.029	0.0211	No	0	No
10/11/2022 14:56	0	0.022	0.0215	No	0	No
10/11/2022 14:57	0	0.02	0.0217	No	0	No
10/11/2022 14:58	0	0.018	0.0218	No	0	No
10/11/2022 14:59	0	0.016	0.0216	No	0	No
10/11/2022 15:00	0	0.017	0.0213	No	0	No
10/11/2022 15:01	0	0.019	0.0212	No	0	No
10/11/2022 15:02	0	0.028	0.0215	No	0	No
10/11/2022 15:03	0	0.022	0.0216	No	0	No
10/11/2022 15:04	0	0.028	0.0221	No	0	No
10/11/2022 15:05	0	0.035	0.0225	No	0	No
10/11/2022 15:06	0	0.036	0.0233	No	0	No
10/11/2022 15:07	0	0.031	0.0243	No	0	No
10/11/2022 15:08	0	0.023	0.0247	No	0	No
10/11/2022 15:09	0	0.019	0.0242	No	0	No
10/11/2022 15:10	0	0.025	0.0239	No	0	No
10/11/2022 15:11	0	0.022	0.0239	No	0	No
10/11/2022 15:12	0	0.024	0.0242	No	0	No
10/11/2022 15:13	0	0.02	0.0243	No	0	No
10/11/2022 15:14	0	0.019	0.0245	No	0	No
10/11/2022 15:15	0	0.029	0.0253	No	0	No
10/11/2022 15:16	0	0.042	0.0269	No	0	No
10/11/2022 15:17	0	0.03	0.027	No	0	No
10/11/2022 15:18	0	0.034	0.0278	No	0	No

Downwind Station

Time	Instantaneous VOC (ppm)	Instantaneous Mass Conc. Total (mg/m ³)	Mass Conc. Total mg/m ³ AVG 15m (mg/m ³)	Dust Exceedance	VOC ppm AVG 15m (ppm)	VOC Exceedance
10/11/2022 7:10	0			No	0	No
10/11/2022 7:11	0	0.021	0.021	No	0	No
10/11/2022 7:12	0	0.02	0.0205	No	0	No
10/11/2022 7:13	0	0.02	0.0203	No	0	No
10/11/2022 7:14	0	0.021	0.0205	No	0	No
10/11/2022 7:15	0	0.02	0.0204	No	0	No
10/11/2022 7:16	0	0.021	0.0205	No	0	No
10/11/2022 7:17	0	0.021	0.0206	No	0	No
10/11/2022 7:18	0	0.02	0.0205	No	0	No
10/11/2022 7:19	0	0.022	0.0207	No	0	No
10/11/2022 7:20	0	0.022	0.0208	No	0	No
10/11/2022 7:21	0	0.026	0.0213	No	0	No
10/11/2022 7:22	0	0.022	0.0213	No	0	No
10/11/2022 7:23	0	0.02	0.0212	No	0	No
10/11/2022 7:24	0	0.02	0.0211	No	0	No
10/11/2022 7:25	0	0.022	0.0212	No	0	No
10/11/2022 7:26	0	0.027	0.0216	No	0	No
10/11/2022 7:27	0	0.023	0.0218	No	0	No
10/11/2022 7:28	0	0.025	0.0221	No	0	No
10/11/2022 7:29	0	0.024	0.0223	No	0	No
10/11/2022 7:30	0	0.032	0.0231	No	0	No
10/11/2022 7:31	0	0.023	0.0233	No	0	No
10/11/2022 7:32	0	0.027	0.0237	No	0	No
10/11/2022 7:33	0	0.025	0.024	No	0	No
10/11/2022 7:34	0	0.025	0.0242	No	0	No
10/11/2022 7:35	0	0.026	0.0245	No	0	No
10/11/2022 7:36	0	0.025	0.0244	No	0	No
10/11/2022 7:37	0	0.026	0.0247	No	0	No
10/11/2022 7:38	0	0.025	0.025	No	0	No
10/11/2022 7:39	0	0.025	0.0253	No	0	No
10/11/2022 7:40	0	0.029	0.0258	No	0	No
10/11/2022 7:41	0	0.037	0.0265	No	0	No
10/11/2022 7:42	0	0.036	0.0273	No	0	No
10/11/2022 7:43	0	0.027	0.0275	No	0	No
10/11/2022 7:44	0	0.025	0.0275	No	0	No
10/11/2022 7:45	0	0.025	0.0271	No	0	No
10/11/2022 7:46	0	0.025	0.0272	No	0	No
10/11/2022 7:47	0	0.026	0.0271	No	0	No
10/11/2022 7:48	0	0.028	0.0273	No	0	No
10/11/2022 7:49	0	0.027	0.0275	No	0	No
10/11/2022 7:50	0	0.027	0.0275	No	0	No
10/11/2022 7:51	0	0.028	0.0277	No	0	No
10/11/2022 7:52	0	0.027	0.0278	No	0	No
10/11/2022 7:53	0	0.026	0.0279	No	0	No
10/11/2022 7:54	0	0.027	0.028	No	0	No
10/11/2022 7:55	0	0.026	0.0278	No	0	No
10/11/2022 7:56	0	0.026	0.0271	No	0	No
10/11/2022 7:57	0	0.024	0.0263	No	0	No
10/11/2022 7:58	0	0.023	0.026	No	0	No
10/11/2022 7:59	0	0.025	0.026	No	0	No
10/11/2022 8:00	0	0.026	0.0261	No	0	No
10/11/2022 8:01	0	0.025	0.0261	No	0	No
10/11/2022 8:02	0	0.029	0.0263	No	0	No
10/11/2022 8:03	0	0.025	0.0261	No	0	No
10/11/2022 8:04	0	0.026	0.026	No	0	No

Downwind Station

Time	Instantaneous VOC (ppm)	Instantaneous Mass Conc. Total (mg/m ³)	Mass Conc. Total mg/m ³ AVG 15m (mg/m ³)	Dust Exceedance	VOC ppm AVG 15m (ppm)	VOC Exceedance
10/11/2022 8:05	0	0.028	0.0261	No	0	No
10/11/2022 8:06	0	0.027	0.026	No	0	No
10/11/2022 8:07	0	0.046	0.0273	No	0	No
10/11/2022 8:08	0	0.037	0.028	No	0	No
10/11/2022 8:09	0	0.039	0.0288	No	0	No
10/11/2022 8:10	0	0.029	0.029	No	0	No
10/11/2022 8:11	0	0.029	0.0292	No	0	No
10/11/2022 8:12	0	0.031	0.0297	No	0	No
10/11/2022 8:13	0	0.029	0.0301	No	0	No
10/11/2022 8:14	0	0.023	0.0299	No	0	No
10/11/2022 8:15	0	0.023	0.0297	No	0	No
10/11/2022 8:16	0	0.025	0.0297	No	0	No
10/11/2022 8:17	0	0.023	0.0293	No	0	No
10/11/2022 8:18	0	0.023	0.0292	No	0	No
10/11/2022 8:19	0	0.022	0.0289	No	0	No
10/11/2022 8:20	0	0.022	0.0285	No	0	No
10/11/2022 8:21	0	0.022	0.0282	No	0	No
10/11/2022 8:22	0	0.024	0.0267	No	0	No
10/11/2022 8:23	0	0.024	0.0259	No	0	No
10/11/2022 8:24	0	0.026	0.025	No	0	No
10/11/2022 8:25	0	0.023	0.0246	No	0	No
10/11/2022 8:26	0	0.023	0.0242	No	0	No
10/11/2022 8:27	0	0.023	0.0237	No	0	No
10/11/2022 8:28	0	0.023	0.0233	No	0	No
10/11/2022 8:29	0	0.023	0.0233	No	0	No
10/11/2022 8:30	0	0.024	0.0233	No	0	No
10/11/2022 8:31	0	0.027	0.0235	No	0	No
10/11/2022 8:32	0	0.035	0.0243	No	0	No
10/11/2022 8:33	0	0.026	0.0245	No	0	No
10/11/2022 8:34	0	0.03	0.025	No	0	No
10/11/2022 8:35	0	0.028	0.0254	No	0	No
10/11/2022 8:36	0	0.027	0.0257	No	0	No
10/11/2022 8:37	0	0.028	0.026	No	0	No
10/11/2022 8:38	0	0.028	0.0263	No	0	No
10/11/2022 8:39	0	0.026	0.0263	No	0	No
10/11/2022 8:40	0	0.029	0.0267	No	0	No
10/11/2022 8:41	0	0.044	0.0281	No	0	No
10/11/2022 8:42	0	0.028	0.0284	No	0	No
10/11/2022 8:43	0	0.025	0.0285	No	0	No
10/11/2022 8:44	0	0.033	0.0292	No	0	No
10/11/2022 8:45	0	0.032	0.0297	No	0	No
10/11/2022 8:46	0	0.025	0.0296	No	0	No
10/11/2022 8:47	0	0.026	0.029	No	0	No
10/11/2022 8:48	0	0.022	0.0287	No	0	No
10/11/2022 8:49	0	0.022	0.0282	No	0	No
10/11/2022 8:50	0	0.022	0.0278	No	0	No
10/11/2022 8:51	0	0.024	0.0276	No	0	No
10/11/2022 8:52	0	0.023	0.0273	No	0	No
10/11/2022 8:53	0	0.024	0.027	No	0	No
10/11/2022 8:54	0	0.023	0.0268	No	0	No
10/11/2022 8:55	0	0.024	0.0265	No	0	No
10/11/2022 8:56	0	0.022	0.025	No	0	No
10/11/2022 8:57	0	0.022	0.0246	No	0	No
10/11/2022 8:58	0	0.023	0.0245	No	0	No
10/11/2022 8:59	0	0.022	0.0237	No	0	No

Downwind Station

Time	Instantaneous VOC (ppm)	Instantaneous Mass Conc. Total (mg/m ³)	Mass Conc. Total mg/m ³ AVG 15m (mg/m ³)	Dust Exceedance	VOC ppm AVG 15m (ppm)	VOC Exceedance
10/11/2022 9:00	0	0.022	0.0231	No	0	No
10/11/2022 9:01	0	0.028	0.0233	No	0	No
10/11/2022 9:02	0	0.025	0.0232	No	0	No
10/11/2022 9:03	0	0.026	0.0235	No	0	No
10/11/2022 9:04	0	0.022	0.0235	No	0	No
10/11/2022 9:05	0	0.022	0.0235	No	0	No
10/11/2022 9:06	0	0.022	0.0233	No	0	No
10/11/2022 9:07	0	0.032	0.0239	No	0	No
10/11/2022 9:08	0	0.025	0.024	No	0	No
10/11/2022 9:09	0	0.021	0.0239	No	0	No
10/11/2022 9:10	0	0.022	0.0237	No	0	No
10/11/2022 9:11	0	0.022	0.0237	No	0	No
10/11/2022 9:12	0	0.022	0.0237	No	0	No
10/11/2022 9:13	0	0.028	0.0241	No	0	No
10/11/2022 9:14	0	0.022	0.0241	No	0	No
10/11/2022 9:15	0	0.024	0.0242	No	0	No
10/11/2022 9:16	0	0.025	0.024	No	0	No
10/11/2022 9:17	0	0.025	0.024	No	0	No
10/11/2022 9:18	0	0.022	0.0237	No	0	No
10/11/2022 9:19	0	0.02	0.0236	No	0	No
10/11/2022 9:20	0	0.019	0.0234	No	0	No
10/11/2022 9:21	0	0.017	0.0231	No	0	No
10/11/2022 9:22	0	0.023	0.0225	No	0	No
10/11/2022 9:23	0	0.031	0.0229	No	0	No
10/11/2022 9:24	0	0.021	0.0229	No	0	No
10/11/2022 9:25	0	0.036	0.0238	No	0	No
10/11/2022 9:26	0	0.029	0.0243	No	0	No
10/11/2022 9:27	0	0.023	0.0243	No	0	No
10/11/2022 9:28	0	0.018	0.0237	No	0	No
10/11/2022 9:29	0	0.016	0.0233	No	0	No
10/11/2022 9:30	0	0.018	0.0229	No	0	No
10/11/2022 9:31	0	0.02	0.0225	No	0	No
10/11/2022 9:32	0	0.016	0.0219	No	0	No
10/11/2022 9:33	0	0.014	0.0214	No	0	No
10/11/2022 9:34	0	0.018	0.0213	No	0	No
10/11/2022 9:35	0	0.019	0.0213	No	0	No
10/11/2022 9:36	0	0.03	0.0221	No	0	No
10/11/2022 9:37	0	0.029	0.0225	No	0	No
10/11/2022 9:38	0	0.024	0.0221	No	0	No
10/11/2022 9:39	0	0.027	0.0225	No	0	No
10/11/2022 9:40	0	0.017	0.0212	No	0	No
10/11/2022 9:41	0	0.024	0.0209	No	0	No
10/11/2022 9:42	0	0.03	0.0213	No	0	No
10/11/2022 9:43	0	0.017	0.0213	No	0	No
10/11/2022 9:44	0	0.018	0.0214	No	0	No
10/11/2022 9:45	0	0.018	0.0214	No	0	No
10/11/2022 9:46	0	0.016	0.0211	No	0	No
10/11/2022 9:47	0	0.019	0.0213	No	0	No
10/11/2022 9:48	0	0.016	0.0215	No	0	No
10/11/2022 9:49	0	0.015	0.0213	No	0	No
10/11/2022 9:50	0	0.017	0.0211	No	0	No
10/11/2022 9:51	0	0.019	0.0204	No	0	No
10/11/2022 9:52	0	0.02	0.0198	No	0	No
10/11/2022 9:53	0	0.018	0.0194	No	0	No
10/11/2022 9:54	0	0.018	0.0188	No	0	No

Downwind Station

Time	Instantaneous VOC (ppm)	Instantaneous Mass Conc. Total (mg/m ³)	Mass Conc. Total mg/m ³ AVG 15m (mg/m ³)	Dust Exceedance	VOC ppm AVG 15m (ppm)	VOC Exceedance
10/11/2022 9:55	0	0.017	0.0188	No	0	No
10/11/2022 9:56	0	0.02	0.0185	No	0	No
10/11/2022 9:57	0	0.018	0.0177	No	0	No
10/11/2022 9:58	0	0.019	0.0179	No	0	No
10/11/2022 9:59	0	0.018	0.0179	No	0	No
10/11/2022 10:00	0	0.018	0.0179	No	0	No
10/11/2022 10:01	0	0.027	0.0186	No	0	No
10/11/2022 10:02	0	0.018	0.0185	No	0	No
10/11/2022 10:03	0	0.017	0.0186	No	0	No
10/11/2022 10:04	0	0.018	0.0188	No	0	No
10/11/2022 10:05	0	0.019	0.0189	No	0	No
10/11/2022 10:06	0	0.015	0.0187	No	0	No
10/11/2022 10:07	0	0.016	0.0184	No	0	No
10/11/2022 10:08	0	0.02	0.0185	No	0	No
10/11/2022 10:09	0	0.018	0.0185	No	0	No
10/11/2022 10:10	0	0.02	0.0187	No	0	No
10/11/2022 10:11	0	0.016	0.0185	No	0	No
10/11/2022 10:12	0	0.015	0.0183	No	0	No
10/11/2022 10:13	0	0.014	0.0179	No	0	No
10/11/2022 10:14	0	0.015	0.0177	No	0	No
10/11/2022 10:15	0	0.013	0.0174	No	0	No
10/11/2022 10:16	0	0.017	0.0167	No	0	No
10/11/2022 10:17	0	0.037	0.018	No	0	No
10/11/2022 10:18	0	0.025	0.0185	No	0	No
10/11/2022 10:19	0	0.038	0.0199	No	0	No
10/11/2022 10:20	0	0.038	0.0211	No	0	No
10/11/2022 10:21	0	0.036	0.0225	No	0	No
10/11/2022 10:22	0	0.019	0.0227	No	0	No
10/11/2022 10:23	0	0.018	0.0226	No	0	No
10/11/2022 10:24	0	0.021	0.0228	No	0	No
10/11/2022 10:25	0	0.017	0.0226	No	0	No
10/11/2022 10:26	0	0.017	0.0227	No	0	No
10/11/2022 10:27	0	0.016	0.0227	No	0	No
10/11/2022 10:28	0	0.016	0.0229	No	0	No
10/11/2022 10:29	0	0.022	0.0233	No	0	No
10/11/2022 10:30	0	0.02	0.0238	No	0	No
10/11/2022 10:31	0	0.019	0.0239	No	0	No
10/11/2022 10:32	0	0.02	0.0228	No	0	No
10/11/2022 10:33	0	0.018	0.0223	No	0	No
10/11/2022 10:34	0	0.017	0.0209	No	0	No
10/11/2022 10:35	0	0.017	0.0195	No	0	No
10/11/2022 10:36	0	0.016	0.0182	No	0	No
10/11/2022 10:37	0	0.015	0.0179	No	0	No
10/11/2022 10:38	0	0.015	0.0177	No	0	No
10/11/2022 10:39	0	0.016	0.0174	No	0	No
10/11/2022 10:40	0	0.017	0.0174	No	0	No
10/11/2022 10:41	0	0.019	0.0175	No	0	No
10/11/2022 10:42	0	0.03	0.0185	No	0	No
10/11/2022 10:43	0	0.035	0.0197	No	0	No
10/11/2022 10:44	0	0.029	0.0202	No	0	No
10/11/2022 10:45	0	0.017	0.02	No	0	No
10/11/2022 10:46	0	0.017	0.0199	No	0	No
10/11/2022 10:47	0	0.019	0.0198	No	0	No
10/11/2022 10:48	0	0.015	0.0196	No	0	No
10/11/2022 10:49	0	0.018	0.0197	No	0	No

Downwind Station

Time	Instantaneous VOC (ppm)	Instantaneous Mass Conc. Total (mg/m³)	Mass Conc. Total mg/m³ AVG 15m (mg/m³)	Dust Exceedance	VOC ppm AVG 15m (ppm)	VOC Exceedance
10/11/2022 10:50	0	0.024	0.0201	No	0	No
10/11/2022 10:51	0	0.022	0.0205	No	0	No
10/11/2022 10:52	0	0.025	0.0212	No	0	No
10/11/2022 10:53	0	0.027	0.022	No	0	No
10/11/2022 10:54	0	0.02	0.0223	No	0	No
10/11/2022 10:55	0	0.045	0.0241	No	0	No
10/11/2022 10:56	0	0.037	0.0253	No	0	No
10/11/2022 10:57	0	0.03	0.0253	No	0	No
10/11/2022 10:58	0	0.016	0.0241	No	0	No
10/11/2022 10:59	0	0.016	0.0232	No	0	No
10/11/2022 11:00	0	0.016	0.0231	No	0	No
10/11/2022 11:01	0	0.015	0.023	No	0	No
10/11/2022 11:02	0	0.015	0.0227	No	0	No
10/11/2022 11:03	0	0.018	0.0229	No	0	No
10/11/2022 11:04	0	0.017	0.0229	No	0	No
10/11/2022 11:05	0	0.016	0.0223	No	0	No
10/11/2022 11:06	0	0.017	0.022	No	0	No
10/11/2022 11:07	0	0.016	0.0214	No	0	No
10/11/2022 11:08	0	0.02	0.0209	No	0	No
10/11/2022 11:09	0	0.031	0.0217	No	0	No
10/11/2022 11:10	0	0.05	0.022	No	0	No
10/11/2022 11:11	0	0.018	0.0207	No	0	No
10/11/2022 11:12	0	0.017	0.0199	No	0	No
10/11/2022 11:13	0	0.023	0.0203	No	0	No
10/11/2022 11:14	0	0.048	0.0225	No	0	No
10/11/2022 11:15	0	0.023	0.0229	No	0	No
10/11/2022 11:16	0	0.015	0.0229	No	0	No
10/11/2022 11:17	0	0.016	0.023	No	0	No
10/11/2022 11:18	0	0.037	0.0243	No	0	No
10/11/2022 11:19	0	0.019	0.0244	No	0	No
10/11/2022 11:20	0	0.018	0.0245	No	0	No
10/11/2022 11:21	0	0.029	0.0253	No	0	No
10/11/2022 11:22	0	0.017	0.0254	No	0	No
10/11/2022 11:23	0	0.016	0.0251	No	0	No
10/11/2022 11:24	0	0.025	0.0247	No	0	No
10/11/2022 11:25	0	0.027	0.0232	No	0	No
10/11/2022 11:26	0	0.144	0.0316	No	0	No
10/11/2022 11:27	0	0.024	0.0321	No	0	No
10/11/2022 11:28	0	0.017	0.0317	No	0	No
10/11/2022 11:29	0	0.03	0.0305	No	0	No
10/11/2022 11:30	0	0.02	0.0303	No	0	No
10/11/2022 11:31	0	0.015	0.0303	No	0	No
10/11/2022 11:32	0	0.022	0.0307	No	0	No
10/11/2022 11:33	0	0.03	0.0302	No	0	No
10/11/2022 11:34	0	0.034	0.0312	No	0	No
10/11/2022 11:35	0	0.02	0.0313	No	0	No
10/11/2022 11:36	0	0.063	0.0336	No	0	No
10/11/2022 11:37	0	0.021	0.0339	No	0	No
10/11/2022 11:38	0	0.015	0.0338	No	0	No
10/11/2022 11:39	0	0.015	0.0331	No	0	No
10/11/2022 11:40	0	0.029	0.0333	No	0	No
10/11/2022 11:41	0	0.017	0.0248	No	0	No
10/11/2022 11:42	0	0.014	0.0241	No	0	No
10/11/2022 11:43	0	0.013	0.0239	No	0	No
10/11/2022 11:44	0	0.025	0.0235	No	0	No

Downwind Station

Time	Instantaneous VOC (ppm)	Instantaneous Mass Conc. Total (mg/m ³)	Mass Conc. Total mg/m ³ AVG 15m (mg/m ³)	Dust Exceedance	VOC ppm AVG 15m (ppm)	VOC Exceedance
10/11/2022 11:45	0	0.026	0.0239	No	0	No
10/11/2022 11:46	0	0.017	0.0241	No	0	No
10/11/2022 11:47	0	0.016	0.0237	No	0	No
10/11/2022 11:48	0	0.019	0.0229	No	0	No
10/11/2022 11:49	0	0.015	0.0217	No	0	No
10/11/2022 11:50	0	0.014	0.0213	No	0	No
10/11/2022 11:51	0	0.015	0.0181	No	0	No
10/11/2022 11:52	0	0.018	0.0179	No	0	No
10/11/2022 11:53	0	0.02	0.0182	No	0	No
10/11/2022 11:54	0	0.016	0.0183	No	0	No
10/11/2022 11:55	0	0.04	0.019	No	0	No
10/11/2022 11:56	0	0.018	0.0191	No	0	No
10/11/2022 11:57	0	0.017	0.0193	No	0	No
10/11/2022 11:58	0	0.013	0.0193	No	0	No
10/11/2022 11:59	0	0.015	0.0186	No	0	No
10/11/2022 12:00	0	0.015	0.0179	No	0	No
10/11/2022 12:01	0	0.014	0.0177	No	0	No
10/11/2022 12:02	0	0.014	0.0175	No	0	No
10/11/2022 12:03	0	0.014	0.0172	No	0	No
10/11/2022 12:04	0	0.013	0.0171	No	0	No
10/11/2022 12:05	0	0.014	0.0171	No	0	No
10/11/2022 12:06	0	0.026	0.0178	No	0	No
10/11/2022 12:07	0	0.014	0.0175	No	0	No
10/11/2022 12:08	0	0.019	0.0175	No	0	No
10/11/2022 12:09	0	0.029	0.0183	No	0	No
10/11/2022 12:10	0	0.028	0.0175	No	0	No
10/11/2022 12:11	0	0.015	0.0173	No	0	No
10/11/2022 12:12	0	0.018	0.0174	No	0	No
10/11/2022 12:13	0	0.016	0.0176	No	0	No
10/11/2022 12:14	0	0.014	0.0175	No	0	No
10/11/2022 12:15	0	0.013	0.0174	No	0	No
10/11/2022 12:16	0	0.014	0.0174	No	0	No
10/11/2022 12:17	0	0.015	0.0175	No	0	No
10/11/2022 12:18	0	0.015	0.0175	No	0	No
10/11/2022 12:19	0	0.013	0.0175	No	0	No
10/11/2022 12:20	0	0.013	0.0175	No	0	No
10/11/2022 12:21	0	0.013	0.0166	No	0	No
10/11/2022 12:22	0	0.012	0.0165	No	0	No
10/11/2022 12:23	0	0.013	0.0161	No	0	No
10/11/2022 12:24	0	0.013	0.015	No	0	No
10/11/2022 12:25	0	0.018	0.0143	No	0	No
10/11/2022 12:26	0	0.014	0.0143	No	0	No
10/11/2022 12:27	0	0.012	0.0139	No	0	No
10/11/2022 12:28	0	0.01	0.0135	No	0	No
10/11/2022 12:29	0	0.011	0.0133	No	0	No
10/11/2022 12:30	0	0.016	0.0135	No	0	No
10/11/2022 12:31	0	0.012	0.0133	No	0	No
10/11/2022 12:32	0	0.01	0.013	No	0	No
10/11/2022 12:33	0	0.012	0.0128	No	0	No
10/11/2022 12:34	0	0.012	0.0127	No	0	No
10/11/2022 12:35	0	0.012	0.0127	No	0	No
10/11/2022 12:36	0	0.013	0.0127	No	0	No
10/11/2022 12:37	0	0.012	0.0127	No	0	No
10/11/2022 12:38	0	0.011	0.0125	No	0	No
10/11/2022 12:39	0	0.013	0.0125	No	0	No

Downwind Station

Time	Instantaneous VOC (ppm)	Instantaneous Mass Conc. Total (mg/m³)	Mass Conc. Total mg/m³ AVG 15m (mg/m³)	Dust Exceedance	VOC ppm AVG 15m (ppm)	VOC Exceedance
10/11/2022 12:40	0	0.024	0.0129	No	0	No
10/11/2022 12:41	0	0.043	0.0149	No	0	No
10/11/2022 12:42	0	0.014	0.015	No	0	No
10/11/2022 12:43	0	0.014	0.0153	No	0	No
10/11/2022 12:44	0	0.014	0.0155	No	0	No
10/11/2022 12:45	0	0.107	0.0215	No	0	No
10/11/2022 12:46	0	0.039	0.0233	No	0	No
10/11/2022 12:47	0	0.017	0.0238	No	0	No
10/11/2022 12:48	0	0.012	0.0238	No	0	No
10/11/2022 12:49	0.049	0.019	0.0243	No	0.0033	No
10/11/2022 12:50	0	0.019	0.0247	No	0.0033	No
10/11/2022 12:51	0	0.013	0.0247	No	0.0033	No
10/11/2022 12:52	0	0.018	0.0251	No	0.0033	No
10/11/2022 12:53	0	0.025	0.0261	No	0.0033	No
10/11/2022 12:54	0	0.025	0.0269	No	0.0033	No
10/11/2022 12:55	0	0.017	0.0264	No	0.0033	No
10/11/2022 12:56	0	0.017	0.0247	No	0.0033	No
10/11/2022 12:57	0	0.041	0.0265	No	0.0033	No
10/11/2022 12:58	0	0.015	0.0265	No	0.0033	No
10/11/2022 12:59	0	0.014	0.0265	No	0.0033	No
10/11/2022 13:00	0	0.015	0.0204	No	0.0033	No
10/11/2022 13:01	0	0.03	0.0198	No	0.0033	No
10/11/2022 13:02	0	0.015	0.0197	No	0.0033	No
10/11/2022 13:03	0	0.015	0.0199	No	0.0033	No
10/11/2022 13:04	0	0.021	0.02	No	0	No
10/11/2022 13:05	0	0.024	0.0203	No	0	No
10/11/2022 13:06	0	0.024	0.0211	No	0	No
10/11/2022 13:07	0	0.014	0.0208	No	0	No
10/11/2022 13:08	0	0.013	0.02	No	0	No
10/11/2022 13:09	0	0.017	0.0195	No	0	No
10/11/2022 13:10	0	0.015	0.0193	No	0	No
10/11/2022 13:11	0	0.024	0.0198	No	0	No
10/11/2022 13:12	0	0.015	0.0181	No	0	No
10/11/2022 13:13	0	0.018	0.0183	No	0	No
10/11/2022 13:14	0	0.017	0.0185	No	0	No
10/11/2022 13:15	0	0.013	0.0183	No	0	No
10/11/2022 13:16	0	0.013	0.0172	No	0	No
10/11/2022 13:17	0	0.013	0.0171	No	0	No
10/11/2022 13:18	0	0.015	0.0171	No	0	No
10/11/2022 13:19	0	0.014	0.0166	No	0	No
10/11/2022 13:20	0	0.014	0.0159	No	0	No
10/11/2022 13:21	0	0.015	0.0153	No	0	No
10/11/2022 13:22	0	0.014	0.0153	No	0	No
10/11/2022 13:23	0	0.015	0.0155	No	0	No
10/11/2022 13:24	0	0.019	0.0156	No	0	No
10/11/2022 13:25	0	0.015	0.0156	No	0	No
10/11/2022 13:26	0	0.025	0.0157	No	0	No
10/11/2022 13:27	0	0.034	0.0169	No	0	No
10/11/2022 13:28	0	0.019	0.017	No	0	No
10/11/2022 13:29	0	0.016	0.0169	No	0	No
10/11/2022 13:30	0	0.035	0.0184	No	0	No
10/11/2022 13:31	0	0.023	0.0191	No	0	No
10/11/2022 13:32	0	0.02	0.0195	No	0	No
10/11/2022 13:33	0	0.022	0.02	No	0	No
10/11/2022 13:34	0	0.044	0.022	No	0	No

Downwind Station

Time	Instantaneous VOC (ppm)	Instantaneous Mass Conc. Total (mg/m ³)	Mass Conc. Total mg/m ³ AVG 15m (mg/m ³)	Dust Exceedance	VOC ppm AVG 15m (ppm)	VOC Exceedance
10/11/2022 13:35	0	0.045	0.0241	No	0	No
10/11/2022 13:36	0	0.032	0.0252	No	0	No
10/11/2022 13:37	0	0.021	0.0257	No	0	No
10/11/2022 13:38	0	0.019	0.0259	No	0	No
10/11/2022 13:39	0	0.02	0.026	No	0	No
10/11/2022 13:40	0	0.018	0.0262	No	0	No
10/11/2022 13:41	0	0.019	0.0258	No	0	No
10/11/2022 13:42	0	0.019	0.0248	No	0	No
10/11/2022 13:43	0	0.016	0.0246	No	0	No
10/11/2022 13:44	0	0.016	0.0246	No	0	No
10/11/2022 13:45	0	0.016	0.0233	No	0	No
10/11/2022 13:46	0	0.018	0.023	No	0	No
10/11/2022 13:47	0	0.026	0.0234	No	0	No
10/11/2022 13:48	0	0.018	0.0231	No	0	No
10/11/2022 13:49	0	0.046	0.0233	No	0	No
10/11/2022 13:50	0	0.018	0.0215	No	0	No
10/11/2022 13:51	0	0.021	0.0207	No	0	No
10/11/2022 13:52	0	0.022	0.0208	No	0	No
10/11/2022 13:53	0	0.038	0.0221	No	0	No
10/11/2022 13:54	0	0.033	0.0229	No	0	No
10/11/2022 13:55	0	0.018	0.0229	No	0	No
10/11/2022 13:56	0	0.016	0.0227	No	0	No
10/11/2022 13:57	0	0.018	0.0227	No	0	No
10/11/2022 13:58	0	0.047	0.0247	No	0	No
10/11/2022 13:59	0	0.032	0.0258	No	0	No
10/11/2022 14:00	0	0.032	0.0269	No	0	No
10/11/2022 14:01	0	0.039	0.0283	No	0	No
10/11/2022 14:02	0	0.04	0.0292	No	0	No
10/11/2022 14:03	0	0.027	0.0298	No	0	No
10/11/2022 14:04	0	0.029	0.0287	No	0	No
10/11/2022 14:05	0	0.037	0.0299	No	0	No
10/11/2022 14:06	0	0.029	0.0305	No	0	No
10/11/2022 14:07	0	0.026	0.0307	No	0	No
10/11/2022 14:08	0	0.018	0.0294	No	0	No
10/11/2022 14:09	0	0.021	0.0286	No	0	No
10/11/2022 14:10	0	0.026	0.0291	No	0	No
10/11/2022 14:11	0	0.023	0.0296	No	0	No
10/11/2022 14:12	0	0.019	0.0297	No	0	No
10/11/2022 14:13	0	0.019	0.0278	No	0	No
10/11/2022 14:14	0	0.03	0.0277	No	0	No
10/11/2022 14:15	0	0.04	0.0282	No	0	No
10/11/2022 14:16	0	0.024	0.0272	No	0	No
10/11/2022 14:17	0	0.026	0.0263	No	0	No
10/11/2022 14:18	0	0.028	0.0263	No	0	No
10/11/2022 14:19	0	0.044	0.0273	No	0	No
10/11/2022 14:20	0	0.043	0.0277	No	0	No
10/11/2022 14:21	0	0.036	0.0282	No	0	No
10/11/2022 14:22	0	0.021	0.0279	No	0	No
10/11/2022 14:23	0	0.02	0.028	No	0	No
10/11/2022 14:24	0	0.017	0.0277	No	0	No
10/11/2022 14:25	0	0.02	0.0273	No	0	No
10/11/2022 14:26	0	0.042	0.0286	No	0	No
10/11/2022 14:27	0	0.024	0.0289	No	0	No
10/11/2022 14:28	0	0.021	0.0291	No	0	No
10/11/2022 14:29	0	0.05	0.0304	No	0	No

Downwind Station

Time	Instantaneous VOC (ppm)	Instantaneous Mass Conc. Total (mg/m ³)	Mass Conc. Total mg/m ³ AVG 15m (mg/m ³)	Dust Exceedance	VOC ppm AVG 15m (ppm)	VOC Exceedance
10/11/2022 14:30	0	0.049	0.031	No	0	No
10/11/2022 14:31	0	0.017	0.0305	No	0	No
10/11/2022 14:32	0	0.016	0.0299	No	0	No
10/11/2022 14:33	0	0.018	0.0292	No	0	No
10/11/2022 14:34	0	0.023	0.0278	No	0	No
10/11/2022 14:35	0	0.027	0.0267	No	0	No
10/11/2022 14:36	0	0.018	0.0255	No	0	No
10/11/2022 14:37	0	0.015	0.0251	No	0	No
10/11/2022 14:38	0	0.028	0.0257	No	0	No
10/11/2022 14:39	0	0.018	0.0257	No	0	No
10/11/2022 14:40	0	0.017	0.0255	No	0	No
10/11/2022 14:41	0	0.016	0.0238	No	0	No
10/11/2022 14:42	0	0.016	0.0233	No	0	No
10/11/2022 14:43	0	0.02	0.0232	No	0	No
10/11/2022 14:44	0	0.029	0.0218	No	0	No
10/11/2022 14:45	0	0.023	0.0201	No	0	No
10/11/2022 14:46	0	0.022	0.0204	No	0	No
10/11/2022 14:47	0	0.031	0.0214	No	0	No
10/11/2022 14:48	0	0.04	0.0229	No	0	No
10/11/2022 14:49	0	0.022	0.0228	No	0	No
10/11/2022 14:50	0	0.029	0.0229	No	0	No
10/11/2022 14:51	0	0.031	0.0238	No	0	No
10/11/2022 14:52	0	0.023	0.0243	No	0	No
10/11/2022 14:53	0	0.017	0.0236	No	0	No
10/11/2022 14:54	0	0.026	0.0241	No	0	No
10/11/2022 14:55	0	0.026	0.0247	No	0	No
10/11/2022 14:56	0	0.031	0.0257	No	0	No
10/11/2022 14:57	0	0.042	0.0275	No	0	No
10/11/2022 14:58	0	0.018	0.0273	No	0	No
10/11/2022 14:59	0	0.017	0.0265	No	0	No
10/11/2022 15:00	0	0.019	0.0263	No	0	No
10/11/2022 15:01	0	0.028	0.0267	No	0	No
10/11/2022 15:02	0	0.058	0.0285	No	0	No
10/11/2022 15:03	0	0.031	0.0279	No	0	No
10/11/2022 15:04	0	0.021	0.0278	No	0	No
10/11/2022 15:05	0	0.021	0.0273	No	0	No
10/11/2022 15:06	0	0.023	0.0267	No	0	No
10/11/2022 15:07	0	0.027	0.027	No	0	No
10/11/2022 15:08	0	0.019	0.0271	No	0	No
10/11/2022 15:09	0	0.021	0.0268	No	0	No
10/11/2022 15:10	0	0.022	0.0265	No	0	No
10/11/2022 15:11	0	0.022	0.0259	No	0	No
10/11/2022 15:12	0	0.022	0.0246	No	0	No
10/11/2022 15:13	0	0.017	0.0245	No	0	No
10/11/2022 15:14	0	0.019	0.0247	No	0	No
10/11/2022 15:15	0	0.019	0.0247	No	0	No
10/11/2022 15:16	0	0.023	0.0243	No	0	No