



Daily Activity Report

Seton Brilla Charter School
 1956 Jerome Avenue, Bronx, NY
 BCP No. C203152

General Site Information

Date:	Monday, October 10, 2022
Weather:	Sunny, 60°F
Wind Direction/Speed:	SW @ 4 mph
AKRF Personnel on Site:	J. Kelleher-Ferguson
AKRF Equipment on Site:	Mini RAE 3000 Photoionization Detector [(PID) x1], 2 Fixed Air Monitoring Stations
Visitors:	None.

Contractor Information

Contracting Company	Main Personnel	Equipment
Casino Construction Core Carpenters	Connor McGrory -	Excavator Hand Tools

Description and Location of Work Activities Performed

1) Casino continued pile installation on the south side of the Site.

Site Soil Disposal Tracking Information

Destination Facility	Daily Trucks	Total Trucks	Daily Approx. Cubic Yds	Total Approx. Cubic Yds	Total Site Loads	Total Approximate Cubic Yards
N/A	-	-	0	0	0	0
N/A	-	-	0	0		
N/A	-	-	0	0		
N/A	-	-	0	0		
N/A	-	-	0	0		

CAMP Air Monitoring Results

CAMP Station	UPWIND			DOWNWIND		
Odors:	None.			None.		
VOC Action Level Exceedance(s):	None.			None.		
Particulate Action Level Exceedance(s):	None.			0.4106		
Maximum VOC Level (ppm):	0.000			0.516		
Maximum Particulate Level (mg/m ³):	0.043			0.652		

Notes: CAMP was performed throughout the day. There was a particulate exceedance at the downwind station at 11:00, which was caused by a truck on site dropping off supplies right next to the station, and due to soil movement activities. The station was relocated, and the particulate concentrations returned to background levels.

Additional Information

Planned Work Activity for Following Day/Week:	1) Installation of foundation piles.
Comments:	None.

Site Map

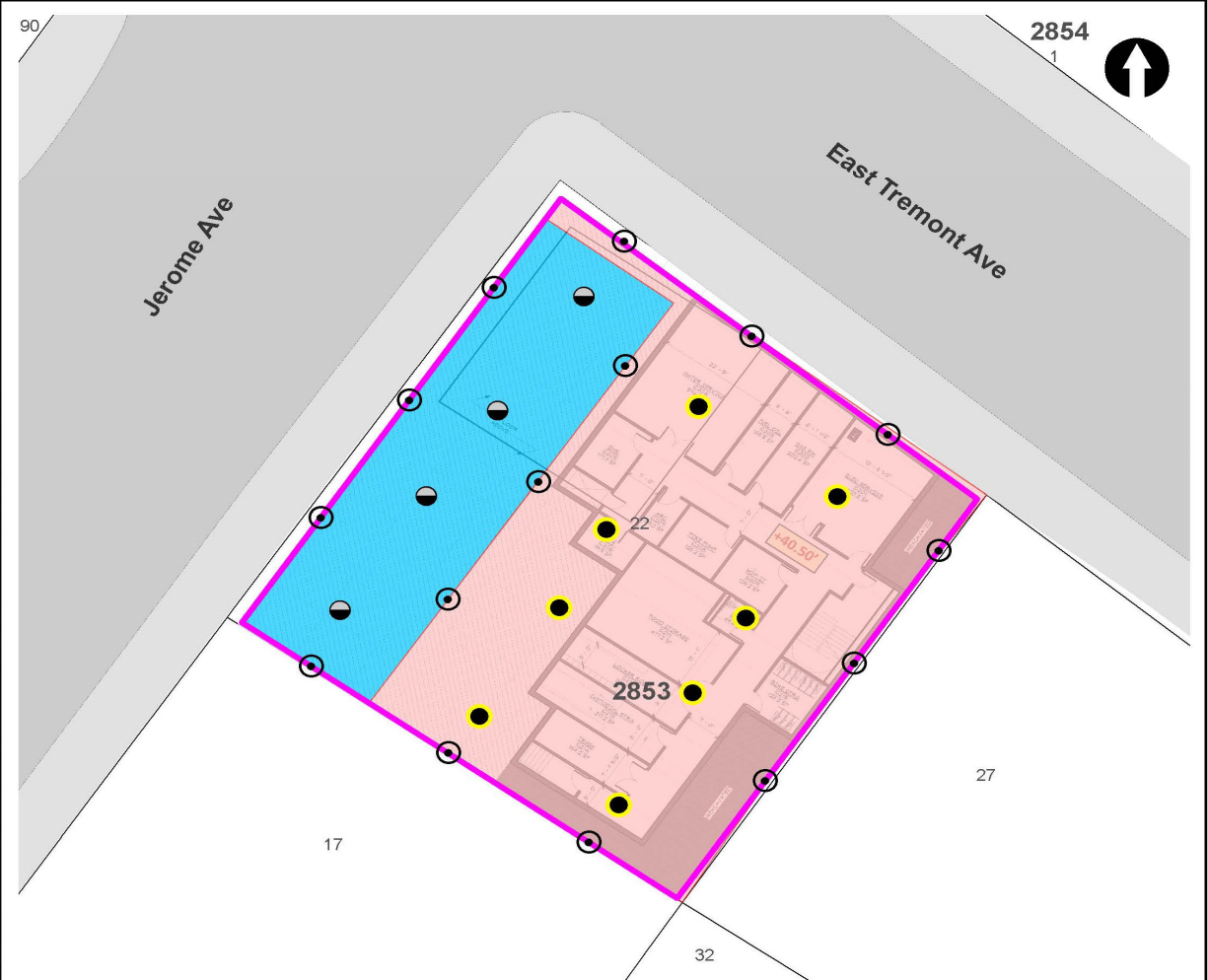

LEGEND

- PROJECT SITE BOUNDARY
- LOT BOUNDARY AND TAX LOT NUMBER
- 2853** BLOCK NUMBER
- REMEDIAL EXCAVATION TO APPROXIMATELY TWO FEET BELOW EXISTING GRADE
- REMEDIAL EXCAVATION TO GROUNDWATER (SOURCE AREA)
- CONFIRMATION DOCUMENTATION BOTTOM SAMPLE
- SOURCE AREA DOCUMENTATION BOTTOM SAMPLE
- DOCUMENTATION SIDEWALL SAMPLE



NOTE
 REMEDIAL EXCAVATION WILL INCLUDE REMOVAL OF APPROXIMATELY 1,280 TONS (850 CUBIC YARDS) OF SOURCE MATERIAL ASSOCIATED WITH NYSDEC SPILL NO. 2103719 AND APPROXIMATELY 860 TONS (570 CUBIC YARDS) OF SOIL/FILL FROM THE UPPER 2 FEET SITE-WIDE.

Map Source:
 NYCDCP (NYC Dept. of City Planning) GIS database

© 2024 AKRF. All Projects 10024 - 156 JEROME AVENUE Technical GIS and Graphics SAR/PA/PP/10024 Figure 9 Proposed Remedial Excavation and Documentation Sample Location Plan.mxd 10/25/2024 2:08:38 PM iszallis

<p>440 Park Avenue South, New York, NY 10016</p>	<p>156 Jerome Avenue Bronx, New York</p>	<p>DATE 04/29/2022</p>
	<p>TRACK 4 CLEANUP AND DOCUMENTATION SAMPLE LOCATION PLAN</p>	<p>PROJECT NO. 210024</p>
		<p>FIGURE 11</p>

Site Photographs

Photograph 1 - Pile driving on Site, view facing southeast.



Photograph 2 - Casino grouting already drilled piles using bags of cement. View facing east.



Photograph 3 - Supply dropoff. View facing north.



Upwind Station						
Time	Instantaneous VOC (ppm)	Instantaneous Mass Conc. Total (mg/m ³)	Mass Conc. Total mg/m ³ AVG 15m (mg/m ³)	Dust Exceedance	VOC ppm AVG 15m (ppm)	VOC Exceedance
10/10/2022 7:04	0	0.022	0.022	No	0	No
10/10/2022 7:05	0	0.016	0.019	No	0	No
10/10/2022 7:06	0	0.016	0.018	No	0	No
10/10/2022 7:07	0	0.017	0.0178	No	0	No
10/10/2022 7:08	0	0.017	0.0176	No	0	No
10/10/2022 7:09	0	0.018	0.0177	No	0	No
10/10/2022 7:10	0	0.018	0.0177	No	0	No
10/10/2022 7:11	0	0.016	0.0175	No	0	No
10/10/2022 7:12	0	0.017	0.0174	No	0	No
10/10/2022 7:13	0	0.017	0.0174	No	0	No
10/10/2022 7:14	0	0.017	0.0174	No	0	No
10/10/2022 7:15	0	0.021	0.0177	No	0	No
10/10/2022 7:16	0	0.019	0.0178	No	0	No
10/10/2022 7:17	0	0.02	0.0179	No	0	No
10/10/2022 7:18	0	0.022	0.0182	No	0	No
10/10/2022 7:19	0	0.019	0.018	No	0	No
10/10/2022 7:20	0	0.017	0.0181	No	0	No
10/10/2022 7:21	0	0.019	0.0183	No	0	No
10/10/2022 7:22	0	0.019	0.0184	No	0	No
10/10/2022 7:23	0	0.036	0.0197	No	0	No
10/10/2022 7:24	0	0.022	0.0199	No	0	No
10/10/2022 7:25	0	0.023	0.0203	No	0	No
10/10/2022 7:26	0	0.03	0.0212	No	0	No
10/10/2022 7:27	0	0.052	0.0235	No	0	No
10/10/2022 7:28	0	0.035	0.0247	No	0	No
10/10/2022 7:29	0	0.024	0.0252	No	0	No
10/10/2022 7:30	0	0.023	0.0253	No	0	No
10/10/2022 7:31	0	0.029	0.026	No	0	No
10/10/2022 7:32	0	0.033	0.0269	No	0	No
10/10/2022 7:33	0	0.03	0.0274	No	0	No
10/10/2022 7:34	0	0.035	0.0285	No	0	No
10/10/2022 7:35	0	0.024	0.0289	No	0	No
10/10/2022 7:36	0	0.025	0.0293	No	0	No
10/10/2022 7:37	0	0.023	0.0296	No	0	No
10/10/2022 7:38	0	0.022	0.0287	No	0	No
10/10/2022 7:39	0	0.02	0.0285	No	0	No
10/10/2022 7:40	0	0.017	0.0281	No	0	No
10/10/2022 7:41	0	0.017	0.0273	No	0	No
10/10/2022 7:42	0	0.017	0.0249	No	0	No
10/10/2022 7:43	0	0.018	0.0238	No	0	No
10/10/2022 7:44	0	0.021	0.0236	No	0	No
10/10/2022 7:45	0	0.021	0.0235	No	0	No
10/10/2022 7:46	0	0.021	0.0229	No	0	No
10/10/2022 7:47	0	0.02	0.0221	No	0	No
10/10/2022 7:48	0	0.019	0.0213	No	0	No
10/10/2022 7:49	0	0.021	0.0204	No	0	No
10/10/2022 7:50	0	0.019	0.0201	No	0	No
10/10/2022 7:51	0	0.027	0.0202	No	0	No
10/10/2022 7:52	0	0.021	0.0201	No	0	No
10/10/2022 7:53	0	0.027	0.0204	No	0	No
10/10/2022 7:54	0	0.018	0.0203	No	0	No

Upwind Station						
Time	Instantaneous VOC (ppm)	Instantaneous Mass Conc. Total (mg/m ³)	Mass Conc. Total mg/m ³ AVG 15m (mg/m ³)	Dust Exceedance	VOC ppm AVG 15m (ppm)	VOC Exceedance
10/10/2022 7:55	0	0.018	0.0203	No	0	No
10/10/2022 7:56	0	0.025	0.0209	No	0	No
10/10/2022 7:57	0	0.023	0.0213	No	0	No
10/10/2022 7:58	0	0.021	0.0215	No	0	No
10/10/2022 7:59	0	0.018	0.0213	No	0	No
10/10/2022 8:00	0	0.017	0.021	No	0	No
10/10/2022 8:01	0	0.02	0.0209	No	0	No
10/10/2022 8:02	0	0.024	0.0212	No	0	No
10/10/2022 8:03	0	0.018	0.0211	No	0	No
10/10/2022 8:04	0	0.019	0.021	No	0	No
10/10/2022 8:05	0	0.021	0.0211	No	0	No
10/10/2022 8:06	0	0.023	0.0209	No	0	No
10/10/2022 8:07	0	0.019	0.0207	No	0	No
10/10/2022 8:08	0	0.024	0.0205	No	0	No
10/10/2022 8:09	0	0.022	0.0208	No	0	No
10/10/2022 8:10	0	0.027	0.0214	No	0	No
10/10/2022 8:11	0	0.021	0.0211	No	0	No
10/10/2022 8:12	0	0.021	0.021	No	0	No
10/10/2022 8:13	0	0.024	0.0212	No	0	No
10/10/2022 8:14	0	0.028	0.0219	No	0	No
10/10/2022 8:15	0	0.022	0.0222	No	0	No
10/10/2022 8:16	0	0.023	0.0224	No	0	No
10/10/2022 8:17	0	0.023	0.0223	No	0	No
10/10/2022 8:18	0	0.022	0.0226	No	0	No
10/10/2022 8:19	0	0.038	0.0239	No	0	No
10/10/2022 8:20	0	0.027	0.0243	No	0	No
10/10/2022 8:21	0	0.025	0.0244	No	0	No
10/10/2022 8:22	0	0.026	0.0249	No	0	No
10/10/2022 8:23	0	0.026	0.025	No	0	No
10/10/2022 8:24	0	0.023	0.0251	No	0	No
10/10/2022 8:25	0	0.029	0.0252	No	0	No
10/10/2022 8:26	0	0.024	0.0254	No	0	No
10/10/2022 8:27	0	0.022	0.0255	No	0	No
10/10/2022 8:28	0	0.025	0.0255	No	0	No
10/10/2022 8:29	0	0.037	0.0261	No	0	No
10/10/2022 8:30	0	0.035	0.027	No	0	No
10/10/2022 8:31	0	0.032	0.0276	No	0	No
10/10/2022 8:32	0	0.031	0.0281	No	0	No
10/10/2022 8:33	0	0.027	0.0285	No	0	No
10/10/2022 8:34	0	0.023	0.0275	No	0	No
10/10/2022 8:35	0	0.034	0.0279	No	0	No
10/10/2022 8:36	0	0.026	0.028	No	0	No
10/10/2022 8:37	0	0.022	0.0277	No	0	No
10/10/2022 8:38	0	0.025	0.0277	No	0	No
10/10/2022 8:39	0	0.023	0.0277	No	0	No
10/10/2022 8:40	0	0.02	0.0271	No	0	No
10/10/2022 8:41	0	0.021	0.0269	No	0	No
10/10/2022 8:42	0	0.022	0.0269	No	0	No
10/10/2022 8:43	0	0.024	0.0268	No	0	No
10/10/2022 8:44	0	0.025	0.026	No	0	No
10/10/2022 8:45	0	0.026	0.0254	No	0	No

Upwind Station						
Time	Instantaneous VOC (ppm)	Instantaneous Mass Conc. Total (mg/m ³)	Mass Conc. Total mg/m ³ AVG 15m (mg/m ³)	Dust Exceedance	VOC ppm AVG 15m (ppm)	VOC Exceedance
10/10/2022 8:46	0	0.028	0.0251	No	0	No
10/10/2022 8:47	0	0.025	0.0247	No	0	No
10/10/2022 8:48	0	0.023	0.0245	No	0	No
10/10/2022 8:49	0	0.03	0.0249	No	0	No
10/10/2022 8:50	0	0.028	0.0245	No	0	No
10/10/2022 8:51	0	0.026	0.0245	No	0	No
10/10/2022 8:52	0	0.024	0.0247	No	0	No
10/10/2022 8:53	0	0.028	0.0249	No	0	No
10/10/2022 8:54	0	0.025	0.025	No	0	No
10/10/2022 8:55	0	0.029	0.0256	No	0	No
10/10/2022 8:56	0	0.025	0.0259	No	0	No
10/10/2022 8:57	0	0.027	0.0262	No	0	No
10/10/2022 8:58	0	0.032	0.0267	No	0	No
10/10/2022 8:59	0	0.029	0.027	No	0	No
10/10/2022 9:00	0	0.045	0.0283	No	0	No
10/10/2022 9:01	0	0.042	0.0292	No	0	No
10/10/2022 9:02	0	0.041	0.0303	No	0	No
10/10/2022 9:03	0	0.025	0.0304	No	0	No
10/10/2022 9:04	0	0.032	0.0305	No	0	No
10/10/2022 9:05	0	0.027	0.0305	No	0	No
10/10/2022 9:06	0	0.03	0.0307	No	0	No
10/10/2022 9:07	0	0.02	0.0305	No	0	No
10/10/2022 9:08	0	0.023	0.0301	No	0	No
10/10/2022 9:09	0	0.022	0.0299	No	0	No
10/10/2022 9:10	0	0.026	0.0297	No	0	No
10/10/2022 9:11	0	0.02	0.0294	No	0	No
10/10/2022 9:12	0	0.022	0.0291	No	0	No
10/10/2022 9:13	0	0.024	0.0285	No	0	No
10/10/2022 9:14	0	0.041	0.0293	No	0	No
10/10/2022 9:15	0	0.037	0.0288	No	0	No
10/10/2022 9:16	0	0.022	0.0275	No	0	No
10/10/2022 9:17	0	0.025	0.0264	No	0	No
10/10/2022 9:18	0	0.023	0.0263	No	0	No
10/10/2022 9:19	0	0.023	0.0257	No	0	No
10/10/2022 9:20	0	0.024	0.0255	No	0	No
10/10/2022 9:21	0	0.019	0.0247	No	0	No
10/10/2022 9:22	0	0.022	0.0249	No	0	No
10/10/2022 9:23	0	0.023	0.0249	No	0	No
10/10/2022 9:24	0	0.022	0.0249	No	0	No
10/10/2022 9:25	0	0.026	0.0249	No	0	No
10/10/2022 9:26	0	0.029	0.0255	No	0	No
10/10/2022 9:27	0	0.021	0.0254	No	0	No
10/10/2022 9:28	0	0.026	0.0255	No	0	No
10/10/2022 9:29	0	0.022	0.0243	No	0	No
10/10/2022 9:30	0	0.02	0.0231	No	0	No
10/10/2022 9:31	0	0.028	0.0235	No	0	No
10/10/2022 9:32	0	0.031	0.0239	No	0	No
10/10/2022 9:33	0	0.029	0.0243	No	0	No
10/10/2022 9:34	0	0.03	0.0248	No	0	No
10/10/2022 9:35	0	0.022	0.0247	No	0	No
10/10/2022 9:36	0	0.025	0.0251	No	0	No

Upwind Station						
Time	Instantaneous VOC (ppm)	Instantaneous Mass Conc. Total (mg/m ³)	Mass Conc. Total mg/m ³ AVG 15m (mg/m ³)	Dust Exceedance	VOC ppm AVG 15m (ppm)	VOC Exceedance
10/10/2022 9:37	0	0.022	0.0251	No	0	No
10/10/2022 9:38	0	0.029	0.0255	No	0	No
10/10/2022 9:39	0	0.019	0.0253	No	0	No
10/10/2022 9:40	0	0.02	0.0249	No	0	No
10/10/2022 9:41	0	0.02	0.0243	No	0	No
10/10/2022 9:42	0	0.02	0.0242	No	0	No
10/10/2022 9:43	0	0.018	0.0237	No	0	No
10/10/2022 9:44	0	0.019	0.0235	No	0	No
10/10/2022 9:45	0	0.02	0.0235	No	0	No
10/10/2022 9:46	0	0.019	0.0229	No	0	No
10/10/2022 9:47	0	0.02	0.0221	No	0	No
10/10/2022 9:48	0	0.02	0.0215	No	0	No
10/10/2022 9:49	0	0.02	0.0209	No	0	No
10/10/2022 9:50	0	0.019	0.0207	No	0	No
10/10/2022 9:51	0	0.021	0.0204	No	0	No
10/10/2022 9:52	0	0.031	0.021	No	0	No
10/10/2022 9:53	0	0.02	0.0204	No	0	No
10/10/2022 9:54	0	0.021	0.0205	No	0	No
10/10/2022 9:55	0	0.024	0.0208	No	0	No
10/10/2022 9:56	0	0.021	0.0209	No	0	No
10/10/2022 9:57	0	0.017	0.0207	No	0	No
10/10/2022 9:58	0	0.018	0.0207	No	0	No
10/10/2022 9:59	0	0.019	0.0207	No	0	No
10/10/2022 10:00	0	0.019	0.0206	No	0	No
10/10/2022 10:01	0	0.069	0.0239	No	0	No
10/10/2022 10:02	0	0.033	0.0248	No	0	No
10/10/2022 10:03	0	0.028	0.0253	No	0	No
10/10/2022 10:04	0	0.019	0.0253	No	0	No
10/10/2022 10:05	0	0.028	0.0259	No	0	No
10/10/2022 10:06	0	0.023	0.026	No	0	No
10/10/2022 10:07	0	0.037	0.0264	No	0	No
10/10/2022 10:08	0	0.038	0.0276	No	0	No
10/10/2022 10:09	0	0.032	0.0283	No	0	No
10/10/2022 10:10	0	0.023	0.0283	No	0	No
10/10/2022 10:11	0	0.036	0.0293	No	0	No
10/10/2022 10:12	0	0.024	0.0297	No	0	No
10/10/2022 10:13	0	0.024	0.0301	No	0	No
10/10/2022 10:14	0	0.02	0.0302	No	0	No
10/10/2022 10:15	0	0.025	0.0306	No	0	No
10/10/2022 10:16	0	0.041	0.0287	No	0	No
10/10/2022 10:17	0	0.106	0.0336	No	0	No
10/10/2022 10:18	0	0.025	0.0334	No	0	No
10/10/2022 10:19	0	0.025	0.0338	No	0	No
10/10/2022 10:20	0	0.031	0.034	No	0	No
10/10/2022 10:21	0	0.047	0.0356	No	0	No
10/10/2022 10:22	0	0.051	0.0365	No	0	No
10/10/2022 10:23	0	0.037	0.0365	No	0	No
10/10/2022 10:24	0	0.032	0.0365	No	0	No
10/10/2022 10:25	0	0.042	0.0377	No	0	No
10/10/2022 10:26	0	0.024	0.0369	No	0	No
10/10/2022 10:27	0	0.025	0.037	No	0	No

Upwind Station						
Time	Instantaneous VOC (ppm)	Instantaneous Mass Conc. Total (mg/m ³)	Mass Conc. Total mg/m ³ AVG 15m (mg/m ³)	Dust Exceedance	VOC ppm AVG 15m (ppm)	VOC Exceedance
10/10/2022 10:28	0	0.022	0.0369	No	0	No
10/10/2022 10:29	0	0.025	0.0372	No	0	No
10/10/2022 10:30	0	0.025	0.0372	No	0	No
10/10/2022 10:31	0	0.027	0.0363	No	0	No
10/10/2022 10:32	0	0.023	0.0307	No	0	No
10/10/2022 10:33	0	0.024	0.0307	No	0	No
10/10/2022 10:34	0	0.025	0.0307	No	0	No
10/10/2022 10:35	0	0.022	0.0301	No	0	No
10/10/2022 10:36	0	0.023	0.0285	No	0	No
10/10/2022 10:37	0	0.031	0.0271	No	0	No
10/10/2022 10:38	0	0.031	0.0267	No	0	No
10/10/2022 10:39	0	0.027	0.0264	No	0	No
10/10/2022 10:40	0	0.028	0.0255	No	0	No
10/10/2022 10:41	0	0.026	0.0256	No	0	No
10/10/2022 10:42	0	0.024	0.0255	No	0	No
10/10/2022 10:43	0	0.026	0.0258	No	0	No
10/10/2022 10:44	0	0.026	0.0259	No	0	No
10/10/2022 10:45	0	0.031	0.0263	No	0	No
10/10/2022 10:46	0	0.028	0.0263	No	0	No
10/10/2022 10:47	0	0.027	0.0266	No	0	No
10/10/2022 10:48	0	0.022	0.0265	No	0	No
10/10/2022 10:49	0	0.032	0.0269	No	0	No
10/10/2022 10:50	0	0.038	0.028	No	0	No
10/10/2022 10:51	0	0.036	0.0289	No	0	No
10/10/2022 10:52	0	0.051	0.0302	No	0	No
10/10/2022 10:53	0	0.032	0.0303	No	0	No
10/10/2022 10:54	0	0.04	0.0311	No	0	No
10/10/2022 10:55	0	0.021	0.0307	No	0	No
10/10/2022 10:56	0	0.024	0.0305	No	0	No
10/10/2022 10:57	0	0.046	0.032	No	0	No
10/10/2022 10:58	0	0.057	0.0341	No	0	No
10/10/2022 10:59	0	0.057	0.0361	No	0	No
10/10/2022 11:00	0	0.034	0.0363	No	0	No
10/10/2022 11:01	0	0.032	0.0366	No	0	No
10/10/2022 11:02	0	0.045	0.0378	No	0	No
10/10/2022 11:03	0	0.039	0.0389	No	0	No
10/10/2022 11:04	0	0.03	0.0388	No	0	No
10/10/2022 11:05	0	0.056	0.04	No	0	No
10/10/2022 11:06	0	0.037	0.0401	No	0	No
10/10/2022 11:07	0	0.03	0.0387	No	0	No
10/10/2022 11:08	0	0.033	0.0387	No	0	No
10/10/2022 11:09	0	0.021	0.0375	No	0	No
10/10/2022 11:10	0	0.025	0.0377	No	0	No
10/10/2022 11:11	0	0.031	0.0382	No	0	No
10/10/2022 11:12	0	0.027	0.0369	No	0	No
10/10/2022 11:13	0	0.027	0.0349	No	0	No
10/10/2022 11:14	0	0.045	0.0341	No	0	No
10/10/2022 11:15	0	0.023	0.0334	No	0	No
10/10/2022 11:16	0	0.039	0.0339	No	0	No
10/10/2022 11:17	0	0.043	0.0337	No	0	No
10/10/2022 11:18	0	0.041	0.0339	No	0	No

Upwind Station						
Time	Instantaneous VOC (ppm)	Instantaneous Mass Conc. Total (mg/m ³)	Mass Conc. Total mg/m ³ AVG 15m (mg/m ³)	Dust Exceedance	VOC ppm AVG 15m (ppm)	VOC Exceedance
10/10/2022 11:19	0	0.026	0.0336	No	0	No
10/10/2022 11:20	0	0.042	0.0327	No	0	No
10/10/2022 11:21	0.003	0.068	0.0347	No	0.0002	No
10/10/2022 11:22	0	0.047	0.0359	No	0.0002	No
10/10/2022 11:23	0	0.035	0.036	No	0.0002	No
10/10/2022 11:24	0	0.033	0.0368	No	0.0002	No
10/10/2022 11:25	0	0.059	0.0391	No	0.0002	No
10/10/2022 11:26	0	0.047	0.0401	No	0.0002	No
10/10/2022 11:27	0	0.031	0.0404	No	0.0002	No
10/10/2022 11:28	0	0.028	0.0405	No	0.0002	No
10/10/2022 11:29	0	0.044	0.0404	No	0.0002	No
10/10/2022 11:30	0	0.031	0.0409	No	0.0002	No
10/10/2022 11:31	0	0.049	0.0416	No	0.0002	No
10/10/2022 11:32	0	0.026	0.0405	No	0.0002	No
10/10/2022 11:33	0	0.024	0.0393	No	0.0002	No
10/10/2022 11:34	0	0.06	0.0416	No	0.0002	No
10/10/2022 11:35	0	0.06	0.0428	No	0.0002	No
10/10/2022 11:36	0	0.036	0.0407	No	0	No
10/10/2022 11:37	0	0.051	0.0409	No	0	No
10/10/2022 11:38	0	0.045	0.0416	No	0	No
10/10/2022 11:39	0	0.037	0.0419	No	0	No
10/10/2022 11:40	0	0.035	0.0403	No	0	No
10/10/2022 11:41	0	0.034	0.0394	No	0	No
10/10/2022 11:42	0	0.032	0.0395	No	0	No
10/10/2022 11:43	0	0.065	0.0419	No	0	No
10/10/2022 11:44	0	0.051	0.0424	No	0	No
10/10/2022 11:45	0	0.027	0.0421	No	0	No
10/10/2022 11:46	0	0.033	0.0411	No	0	No
10/10/2022 11:47	0	0.049	0.0426	No	0	No
10/10/2022 11:48	0	0.033	0.0432	No	0	No
10/10/2022 11:49	0	0.054	0.0428	No	0	No
10/10/2022 11:50	0	0.038	0.0413	No	0	No
10/10/2022 11:51	0	0.056	0.0427	No	0	No
10/10/2022 11:52	0	0.026	0.041	No	0	No
10/10/2022 11:53	0	0.027	0.0398	No	0	No
10/10/2022 11:54	0	0.029	0.0393	No	0	No
10/10/2022 11:55	0	0.033	0.0391	No	0	No
10/10/2022 11:56	0	0.044	0.0398	No	0	No
10/10/2022 11:57	0	0.02	0.039	No	0	No
10/10/2022 11:58	0	0.065	0.039	No	0	No
10/10/2022 11:59	0	0.022	0.0371	No	0	No
10/10/2022 12:00	0	0.033	0.0375	No	0	No
10/10/2022 12:01	0	0.038	0.0378	No	0	No
10/10/2022 12:02	0	0.019	0.0358	No	0	No
10/10/2022 12:03	0	0.018	0.0348	No	0	No
10/10/2022 12:04	0	0.017	0.0323	No	0	No
10/10/2022 12:05	0	0.016	0.0309	No	0	No
10/10/2022 12:06	0	0.019	0.0284	No	0	No
10/10/2022 12:07	0	0.018	0.0279	No	0	No
10/10/2022 12:08	0	0.016	0.0271	No	0	No
10/10/2022 12:09	0	0.018	0.0264	No	0	No

Upwind Station						
Time	Instantaneous VOC (ppm)	Instantaneous Mass Conc. Total (mg/m ³)	Mass Conc. Total mg/m ³ AVG 15m (mg/m ³)	Dust Exceedance	VOC ppm AVG 15m (ppm)	VOC Exceedance
10/10/2022 12:10	0	0.029	0.0261	No	0	No
10/10/2022 12:11	0	0.027	0.025	No	0	No
10/10/2022 12:12	0	0.043	0.0265	No	0	No
10/10/2022 12:13	0	0.026	0.0239	No	0	No
10/10/2022 12:14	0	0.022	0.0239	No	0	No
10/10/2022 12:15	0	0.021	0.0231	No	0	No
10/10/2022 12:16	0	0.02	0.0219	No	0	No
10/10/2022 12:17	0	0.022	0.0221	No	0	No
10/10/2022 12:18	0	0.019	0.0222	No	0	No
10/10/2022 12:19	0	0.021	0.0225	No	0	No
10/10/2022 12:20	0	0.049	0.0247	No	0	No
10/10/2022 12:21	0	0.025	0.0251	No	0	No
10/10/2022 12:22	0	0.022	0.0253	No	0	No
10/10/2022 12:23	0	0.02	0.0256	No	0	No
10/10/2022 12:24	0	0.022	0.0259	No	0	No
10/10/2022 12:25	0	0.026	0.0257	No	0	No
10/10/2022 12:26	0	0.024	0.0255	No	0	No
10/10/2022 12:27	0	0.108	0.0298	No	0	No
10/10/2022 12:28	0	0.036	0.0305	No	0	No
10/10/2022 12:29	0	0.019	0.0303	No	0	No
10/10/2022 12:30	0	0.018	0.0301	No	0	No
10/10/2022 12:31	0	0.024	0.0303	No	0	No
10/10/2022 12:32	0	0.019	0.0301	No	0	No
10/10/2022 12:33	0	0.021	0.0303	No	0	No
10/10/2022 12:34	0	0.024	0.0305	No	0	No
10/10/2022 12:35	0	0.059	0.0311	No	0	No
10/10/2022 12:36	0	0.045	0.0325	No	0	No
10/10/2022 12:37	0	0.038	0.0335	No	0	No
10/10/2022 12:38	0	0.032	0.0343	No	0	No
10/10/2022 12:39	0	0.033	0.0351	No	0	No
10/10/2022 12:40	0	0.023	0.0349	No	0	No
10/10/2022 12:41	0	0.022	0.0347	No	0	No
10/10/2022 12:42	0	0.029	0.0295	No	0	No
10/10/2022 12:43	0	0.015	0.0281	No	0	No
10/10/2022 12:44	0	0.016	0.0279	No	0	No
10/10/2022 12:45	0	0.018	0.0279	No	0	No
10/10/2022 12:46	0	0.021	0.0277	No	0	No
10/10/2022 12:47	0	0.021	0.0278	No	0	No
10/10/2022 12:48	0	0.019	0.0277	No	0	No
10/10/2022 12:49	0	0.021	0.0275	No	0	No
10/10/2022 12:50	0	0.019	0.0248	No	0	No
10/10/2022 12:51	0	0.024	0.0234	No	0	No
10/10/2022 12:52	0	0.017	0.022	No	0	No
10/10/2022 12:53	0	0.02	0.0212	No	0	No
10/10/2022 12:54	0	0.018	0.0202	No	0	No
10/10/2022 12:55	0	0.018	0.0199	No	0	No
10/10/2022 12:56	0	0.03	0.0204	No	0	No
10/10/2022 12:57	0	0.019	0.0197	No	0	No
10/10/2022 12:58	0	0.02	0.0201	No	0	No
10/10/2022 12:59	0	0.022	0.0205	No	0	No
10/10/2022 13:00	0	0.023	0.0208	No	0	No

Upwind Station						
Time	Instantaneous VOC (ppm)	Instantaneous Mass Conc. Total (mg/m ³)	Mass Conc. Total mg/m ³ AVG 15m (mg/m ³)	Dust Exceedance	VOC ppm AVG 15m (ppm)	VOC Exceedance
10/10/2022 13:01	0	0.023	0.0209	No	0	No
10/10/2022 13:02	0	0.023	0.0211	No	0	No
10/10/2022 13:03	0	0.017	0.0209	No	0	No
10/10/2022 13:04	0	0.018	0.0207	No	0	No
10/10/2022 13:05	0	0.02	0.0208	No	0	No
10/10/2022 13:06	0	0.019	0.0205	No	0	No
10/10/2022 13:07	0	0.016	0.0204	No	0	No
10/10/2022 13:08	0	0.02	0.0204	No	0	No
10/10/2022 13:09	0	0.017	0.0203	No	0	No
10/10/2022 13:10	0	0.018	0.0203	No	0	No
10/10/2022 13:11	0	0.029	0.0203	No	0	No
10/10/2022 13:12	0	0.045	0.022	No	0	No
10/10/2022 13:13	0	0.022	0.0221	No	0	No
10/10/2022 13:14	0	0.02	0.022	No	0	No
10/10/2022 13:15	0	0.021	0.0219	No	0	No
10/10/2022 13:16	0	0.024	0.0219	No	0	No
10/10/2022 13:17	0	0.061	0.0245	No	0	No
10/10/2022 13:18	0	0.058	0.0272	No	0	No
10/10/2022 13:19	0	0.034	0.0283	No	0	No
10/10/2022 13:20	0	0.077	0.0321	No	0	No
10/10/2022 13:21	0	0.04	0.0335	No	0	No
10/10/2022 13:22	0	0.04	0.0351	No	0	No
10/10/2022 13:23	0	0.054	0.0373	No	0	No
10/10/2022 13:24	0	0.03	0.0382	No	0	No
10/10/2022 13:25	0	0.018	0.0382	No	0	No
10/10/2022 13:26	0	0.019	0.0375	No	0	No
10/10/2022 13:27	0	0.026	0.0363	No	0	No
10/10/2022 13:28	0	0.064	0.0391	No	0	No
10/10/2022 13:29	0	0.03	0.0397	No	0	No
10/10/2022 13:30	0	0.022	0.0398	No	0	No
10/10/2022 13:31	0	0.025	0.0399	No	0	No
10/10/2022 13:32	0	0.018	0.037	No	0	No
10/10/2022 13:33	0	0.013	0.034	No	0	No
10/10/2022 13:34	0	0.013	0.0326	No	0	No
10/10/2022 13:35	0	0.019	0.0287	No	0	No
10/10/2022 13:36	0	0.042	0.0289	No	0	No
10/10/2022 13:37	0	0.014	0.0271	No	0	No
10/10/2022 13:38	0	0.018	0.0247	No	0	No
10/10/2022 13:39	0	0.021	0.0241	No	0	No
10/10/2022 13:40	0	0.021	0.0243	No	0	No
10/10/2022 13:41	0	0.015	0.0241	No	0	No
10/10/2022 13:42	0	0.019	0.0236	No	0	No
10/10/2022 13:43	0	0.02	0.0207	No	0	No
10/10/2022 13:44	0	0.019	0.0199	No	0	No
10/10/2022 13:45	0	0.016	0.0195	No	0	No
10/10/2022 13:46	0	0.014	0.0188	No	0	No
10/10/2022 13:47	0	0.012	0.0184	No	0	No
10/10/2022 13:48	0	0.016	0.0186	No	0	No
10/10/2022 13:49	0	0.014	0.0187	No	0	No
10/10/2022 13:50	0	0.026	0.0191	No	0	No
10/10/2022 13:51	0	0.015	0.0173	No	0	No

Upwind Station						
Time	Instantaneous VOC (ppm)	Instantaneous Mass Conc. Total (mg/m ³)	Mass Conc. Total mg/m ³ AVG 15m (mg/m ³)	Dust Exceedance	VOC ppm AVG 15m (ppm)	VOC Exceedance
10/10/2022 13:52	0	0.017	0.0175	No	0	No
10/10/2022 13:53	0	0.014	0.0173	No	0	No
10/10/2022 13:54	0	0.016	0.0169	No	0	No
10/10/2022 13:55	0	0.014	0.0165	No	0	No
10/10/2022 13:56	0	0.015	0.0165	No	0	No
10/10/2022 13:57	0	0.021	0.0166	No	0	No
10/10/2022 13:58	0	0.015	0.0163	No	0	No
10/10/2022 13:59	0	0.014	0.0159	No	0	No
10/10/2022 14:00	0	0.012	0.0157	No	0	No
10/10/2022 14:01	0	0.013	0.0156	No	0	No
10/10/2022 14:02	0	0.012	0.0156	No	0	No
10/10/2022 14:03	0	0.012	0.0153	No	0	No
10/10/2022 14:04	0	0.012	0.0152	No	0	No
10/10/2022 14:05	0	0.015	0.0145	No	0	No
10/10/2022 14:06	0	0.016	0.0145	No	0	No
10/10/2022 14:07	0	0.03	0.0154	No	0	No
10/10/2022 14:08	0	0.021	0.0159	No	0	No
10/10/2022 14:09	0	0.013	0.0157	No	0	No
10/10/2022 14:10	0	0.016	0.0158	No	0	No
10/10/2022 14:11	0	0.017	0.0159	No	0	No
10/10/2022 14:12	0	0.026	0.0163	No	0	No
10/10/2022 14:13	0	0.017	0.0164	No	0	No
10/10/2022 14:14	0	0.018	0.0167	No	0	No
10/10/2022 14:15	0	0.013	0.0167	No	0	No
10/10/2022 14:16	0	0.018	0.0171	No	0	No
10/10/2022 14:17	0	0.013	0.0171	No	0	No
10/10/2022 14:18	0	0.019	0.0176	No	0	No
10/10/2022 14:19	0	0.029	0.0187	No	0	No
10/10/2022 14:20	0	0.02	0.0191	No	0	No
10/10/2022 14:21	0	0.021	0.0194	No	0	No
10/10/2022 14:22	0	0.016	0.0185	No	0	No
10/10/2022 14:23	0	0.019	0.0183	No	0	No
10/10/2022 14:24	0	0.012	0.0183	No	0	No
10/10/2022 14:25	0	0.018	0.0184	No	0	No
10/10/2022 14:26	0	0.033	0.0195	No	0	No
10/10/2022 14:27	0	0.021	0.0191	No	0	No
10/10/2022 14:28	0	0.045	0.021	No	0	No
10/10/2022 14:29	0	0.036	0.0222	No	0	No
10/10/2022 14:30	0	0.012	0.0221	No	0	No
10/10/2022 14:31	0	0.011	0.0217	No	0	No
10/10/2022 14:32	0	0.012	0.0216	No	0	No
10/10/2022 14:33	0	0.013	0.0212	No	0	No
10/10/2022 14:34	0	0.011	0.02	No	0	No
10/10/2022 14:35	0	0.013	0.0195	No	0	No
10/10/2022 14:36	0	0.012	0.0189	No	0	No
10/10/2022 14:37	0	0.013	0.0187	No	0	No
10/10/2022 14:38	0	0.013	0.0183	No	0	No
10/10/2022 14:39	0	0.011	0.0183	No	0	No
10/10/2022 14:40	0	0.012	0.0179	No	0	No
10/10/2022 14:41	0	0.012	0.0165	No	0	No
10/10/2022 14:42	0	0.012	0.0159	No	0	No

Upwind Station

Time	Instaneous VOC (ppm)	Instaneous Mass Conc. Total (mg/m ³)	Mass Conc. Total mg/m ³ AVG 15m (mg/m ³)	Dust Exceedance	VOC ppm AVG 15m (ppm)	VOC Exceedance
10/10/2022 14:43	0	0.012	0.0137	No	0	No
10/10/2022 14:44	0	0.013	0.0121	No	0	No
10/10/2022 14:45	0	0.013	0.0122	No	0	No
10/10/2022 14:46	0	0.013	0.0123	No	0	No
10/10/2022 14:47	0	0.013	0.0124	No	0	No
10/10/2022 14:48	0	0.013	0.0124	No	0	No
10/10/2022 14:49	0	0.015	0.0127	No	0	No
10/10/2022 14:50	0	0.012	0.0126	No	0	No
10/10/2022 14:51	0	0.012	0.0126	No	0	No
10/10/2022 14:52	0	0.011	0.0125	No	0	No
10/10/2022 14:53	0	0.011	0.0123	No	0	No
10/10/2022 14:54	0	0.011	0.0123	No	0	No
10/10/2022 14:55	0	0.012	0.0123	No	0	No
10/10/2022 14:56	0	0.014	0.0125	No	0	No
10/10/2022 14:57	0	0.015	0.0127	No	0	No
10/10/2022 14:58	0	0.014	0.0128	No	0	No
10/10/2022 14:59	0	0.012	0.0127	No	0	No
10/10/2022 15:00	0	0.014	0.0128	No	0	No
10/10/2022 15:01	0	0.013	0.0128	No	0	No
10/10/2022 15:02	0	0.013	0.0128	No	0	No
10/10/2022 15:03	0	0.014	0.0129	No	0	No
10/10/2022 15:04	0	0.014	0.0128	No	0	No
10/10/2022 15:05	0	0.013	0.0129	No	0	No
10/10/2022 15:06	0	0.013	0.0129	No	0	No
10/10/2022 15:07	0	0.015	0.0132	No	0	No
10/10/2022 15:08	0	0.019	0.0137	No	0	No
10/10/2022 15:09	0	0.013	0.0139	No	0	No
10/10/2022 15:10	0	0.012	0.0139	No	0	No
10/10/2022 15:11	0	0.011	0.0137	No	0	No

Downwind Station

Time	Instantaneous VOC (ppm)	Instantaneous Mass Conc. Total (mg/m ³)	Mass Conc. Total mg/m ³ AVG 15m (mg/m ³)	Dust Exceedance	VOC ppm AVG 15m (ppm)	VOC Exceedance
10/10/2022 7:05	0	0.018	0.018	No	0	No
10/10/2022 7:06	0	0.016	0.017	No	0	No
10/10/2022 7:07	0	0.016	0.0167	No	0	No
10/10/2022 7:08	0	0.016	0.0165	No	0	No
10/10/2022 7:09	0	0.016	0.0164	No	0	No
10/10/2022 7:10	0	0.017	0.0165	No	0	No
10/10/2022 7:11	0	0.017	0.0166	No	0	No
10/10/2022 7:12	0	0.017	0.0166	No	0	No
10/10/2022 7:13	0	0.017	0.0167	No	0	No
10/10/2022 7:14	0	0.017	0.0167	No	0	No
10/10/2022 7:15	0	0.017	0.0167	No	0	No
10/10/2022 7:16	0	0.018	0.0168	No	0	No
10/10/2022 7:17	0	0.017	0.0168	No	0	No
10/10/2022 7:18	0	0.017	0.0169	No	0	No
10/10/2022 7:19	0	0.018	0.0169	No	0	No
10/10/2022 7:20	0	0.016	0.0168	No	0	No
10/10/2022 7:21	0	0.017	0.0169	No	0	No
10/10/2022 7:22	0	0.016	0.0169	No	0	No
10/10/2022 7:23	0	0.024	0.0174	No	0	No
10/10/2022 7:24	0	0.032	0.0185	No	0	No
10/10/2022 7:25	0	0.023	0.0189	No	0	No
10/10/2022 7:26	0	0.041	0.0205	No	0	No
10/10/2022 7:27	0	0.034	0.0216	No	0	No
10/10/2022 7:28	0.821	0.025	0.0221	No	0.0547	No
10/10/2022 7:29	0.187	0.071	0.0257	No	0.0672	No
10/10/2022 7:30	0	0.027	0.0264	No	0.0672	No
10/10/2022 7:31	0	0.039	0.0278	No	0.0672	No
10/10/2022 7:32	0	0.03	0.0287	No	0.0672	No
10/10/2022 7:33	0	0.031	0.0296	No	0.0672	No
10/10/2022 7:34	0	0.034	0.0307	No	0.0672	No
10/10/2022 7:35	0	0.046	0.0327	No	0.0672	No
10/10/2022 7:36	0	0.024	0.0331	No	0.0672	No
10/10/2022 7:37	0	0.022	0.0335	No	0.0672	No
10/10/2022 7:38	0	0.025	0.0336	No	0.0672	No
10/10/2022 7:39	0	0.022	0.0329	No	0.0672	No
10/10/2022 7:40	0	0.022	0.0329	No	0.0672	No
10/10/2022 7:41	0	0.017	0.0313	No	0.0672	No
10/10/2022 7:42	0	0.018	0.0302	No	0.0672	No
10/10/2022 7:43	0	0.017	0.0297	No	0.0125	No
10/10/2022 7:44	0	0.018	0.0261	No	0	No
10/10/2022 7:45	0	0.019	0.0256	No	0	No
10/10/2022 7:46	0	0.021	0.0244	No	0	No
10/10/2022 7:47	0	0.018	0.0236	No	0	No
10/10/2022 7:48	0	0.033	0.0237	No	0	No
10/10/2022 7:49	0	0.019	0.0227	No	0	No
10/10/2022 7:50	0	0.021	0.0211	No	0	No
10/10/2022 7:51	0	0.019	0.0207	No	0	No
10/10/2022 7:52	0	0.027	0.0211	No	0	No
10/10/2022 7:53	0	0.021	0.0208	No	0	No
10/10/2022 7:54	0	0.02	0.0207	No	0	No
10/10/2022 7:55	0	0.02	0.0205	No	0	No
10/10/2022 7:56	0	0.019	0.0207	No	0	No
10/10/2022 7:57	0	0.034	0.0217	No	0	No
10/10/2022 7:58	0	0.019	0.0219	No	0	No
10/10/2022 7:59	0	0.022	0.0221	No	0	No

Downwind Station

Time	Instantaneous VOC (ppm)	Instantaneous Mass Conc. Total (mg/m ³)	Mass Conc. Total mg/m ³ AVG 15m (mg/m ³)	Dust Exceedance	VOC ppm AVG 15m (ppm)	VOC Exceedance
10/10/2022 8:00	0	0.023	0.0224	No	0	No
10/10/2022 8:01	0	0.059	0.0249	No	0	No
10/10/2022 8:02	0	0.03	0.0257	No	0	No
10/10/2022 8:03	0	0.018	0.0247	No	0	No
10/10/2022 8:04	0	0.036	0.0259	No	0	No
10/10/2022 8:05	0	0.022	0.0259	No	0	No
10/10/2022 8:06	0	0.022	0.0261	No	0	No
10/10/2022 8:07	0	0.02	0.0257	No	0	No
10/10/2022 8:08	0	0.021	0.0257	No	0	No
10/10/2022 8:09	0	0.022	0.0258	No	0	No
10/10/2022 8:10	0	0.019	0.0257	No	0	No
10/10/2022 8:11	0	0.018	0.0257	No	0	No
10/10/2022 8:12	0	0.018	0.0246	No	0	No
10/10/2022 8:13	0	0.02	0.0247	No	0	No
10/10/2022 8:14	0	0.021	0.0246	No	0	No
10/10/2022 8:15	0	0.022	0.0245	No	0	No
10/10/2022 8:16	0	0.019	0.0219	No	0	No
10/10/2022 8:17	0	0.028	0.0217	No	0	No
10/10/2022 8:18	0	0.063	0.0247	No	0	No
10/10/2022 8:19	0	0.033	0.0245	No	0	No
10/10/2022 8:20	0	0.035	0.0254	No	0	No
10/10/2022 8:21	0	0.032	0.0261	No	0	No
10/10/2022 8:22	0	0.023	0.0263	No	0	No
10/10/2022 8:23	0	0.025	0.0265	No	0	No
10/10/2022 8:24	0	0.024	0.0267	No	0	No
10/10/2022 8:25	0	0.025	0.0271	No	0	No
10/10/2022 8:26	0	0.023	0.0274	No	0	No
10/10/2022 8:27	0	0.022	0.0277	No	0	No
10/10/2022 8:28	0	0.024	0.0279	No	0	No
10/10/2022 8:29	0	0.024	0.0281	No	0	No
10/10/2022 8:30	0	0.028	0.0285	No	0	No
10/10/2022 8:31	0	0.036	0.0297	No	0	No
10/10/2022 8:32	0	0.04	0.0305	No	0	No
10/10/2022 8:33	0	0.039	0.0289	No	0	No
10/10/2022 8:34	0	0.026	0.0284	No	0	No
10/10/2022 8:35	0	0.032	0.0282	No	0	No
10/10/2022 8:36	0	0.032	0.0282	No	0	No
10/10/2022 8:37	0	0.033	0.0289	No	0	No
10/10/2022 8:38	0	0.029	0.0291	No	0	No
10/10/2022 8:39	0	0.027	0.0293	No	0	No
10/10/2022 8:40	0	0.022	0.0291	No	0	No
10/10/2022 8:41	0	0.025	0.0293	No	0	No
10/10/2022 8:42	0	0.023	0.0293	No	0	No
10/10/2022 8:43	0.173	0.027	0.0295	No	0.0115	No
10/10/2022 8:44	0	0.157	0.0384	No	0.0115	No
10/10/2022 8:45	0	0.028	0.0384	No	0.0115	No
10/10/2022 8:46	0	0.025	0.0377	No	0.0115	No
10/10/2022 8:47	0	0.024	0.0366	No	0.0115	No
10/10/2022 8:48	0	0.026	0.0357	No	0.0115	No
10/10/2022 8:49	0	0.025	0.0357	No	0.0115	No
10/10/2022 8:50	0	0.024	0.0351	No	0.0115	No
10/10/2022 8:51	0	0.037	0.0355	No	0.0115	No
10/10/2022 8:52	0	0.024	0.0349	No	0.0115	No
10/10/2022 8:53	0	0.027	0.0347	No	0.0115	No
10/10/2022 8:54	0	0.032	0.0351	No	0.0115	No

Downwind Station

Time	Instantaneous VOC (ppm)	Instantaneous Mass Conc. Total (mg/m ³)	Mass Conc. Total mg/m ³ AVG 15m (mg/m ³)	Dust Exceedance	VOC ppm AVG 15m (ppm)	VOC Exceedance
10/10/2022 8:55	0	0.032	0.0357	No	0.0115	No
10/10/2022 8:56	0	0.028	0.0359	No	0.0115	No
10/10/2022 8:57	0	0.03	0.0364	No	0.0115	No
10/10/2022 8:58	0	0.04	0.0373	No	0	No
10/10/2022 8:59	0	0.039	0.0294	No	0	No
10/10/2022 9:00	0	0.041	0.0303	No	0	No
10/10/2022 9:01	0	0.039	0.0312	No	0	No
10/10/2022 9:02	0	0.03	0.0316	No	0	No
10/10/2022 9:03	0	0.028	0.0317	No	0	No
10/10/2022 9:04	0	0.028	0.0319	No	0	No
10/10/2022 9:05	0	0.024	0.0319	No	0	No
10/10/2022 9:06	0	0.022	0.0309	No	0	No
10/10/2022 9:07	0	0.022	0.0308	No	0	No
10/10/2022 9:08	0	0.022	0.0305	No	0	No
10/10/2022 9:09	0	0.021	0.0297	No	0	No
10/10/2022 9:10	0	0.02	0.0289	No	0	No
10/10/2022 9:11	0	0.027	0.0289	No	0	No
10/10/2022 9:12	0	0.026	0.0286	No	0	No
10/10/2022 9:13	0	0.024	0.0275	No	0	No
10/10/2022 9:14	0	0.028	0.0268	No	0	No
10/10/2022 9:15	0	0.047	0.0272	No	0	No
10/10/2022 9:16	0	0.018	0.0258	No	0	No
10/10/2022 9:17	0	0.024	0.0254	No	0	No
10/10/2022 9:18	0	0.024	0.0251	No	0	No
10/10/2022 9:19	0	0.026	0.025	No	0	No
10/10/2022 9:20	0	0.024	0.025	No	0	No
10/10/2022 9:21	0	0.027	0.0253	No	0	No
10/10/2022 9:22	0	0.02	0.0252	No	0	No
10/10/2022 9:23	0	0.021	0.0251	No	0	No
10/10/2022 9:24	0	0.023	0.0253	No	0	No
10/10/2022 9:25	0	0.021	0.0253	No	0	No
10/10/2022 9:26	0	0.028	0.0254	No	0	No
10/10/2022 9:27	0	0.025	0.0253	No	0	No
10/10/2022 9:28	0	0.02	0.0251	No	0	No
10/10/2022 9:29	0	0.019	0.0245	No	0	No
10/10/2022 9:30	0	0.019	0.0226	No	0	No
10/10/2022 9:31	0	0.021	0.0228	No	0	No
10/10/2022 9:32	0	0.021	0.0226	No	0	No
10/10/2022 9:33	0	0.022	0.0225	No	0	No
10/10/2022 9:34	0	0.036	0.0231	No	0	No
10/10/2022 9:35	0	0.028	0.0234	No	0	No
10/10/2022 9:36	0	0.023	0.0231	No	0	No
10/10/2022 9:37	0	0.024	0.0234	No	0	No
10/10/2022 9:38	0	0.024	0.0236	No	0	No
10/10/2022 9:39	0	0.02	0.0234	No	0	No
10/10/2022 9:40	0	0.021	0.0234	No	0	No
10/10/2022 9:41	0	0.027	0.0233	No	0	No
10/10/2022 9:42	0	0.023	0.0232	No	0	No
10/10/2022 9:43	0	0.027	0.0237	No	0	No
10/10/2022 9:44	0	0.024	0.024	No	0	No
10/10/2022 9:45	0	0.019	0.024	No	0	No
10/10/2022 9:46	0	0.019	0.0239	No	0	No
10/10/2022 9:47	0	0.023	0.024	No	0	No
10/10/2022 9:48	0	0.025	0.0242	No	0	No
10/10/2022 9:49	0	0.021	0.0232	No	0	No

Downwind Station

Time	Instantaneous VOC (ppm)	Instantaneous Mass Conc. Total (mg/m³)	Mass Conc. Total mg/m³ AVG 15m (mg/m³)	Dust Exceedance	VOC ppm AVG 15m (ppm)	VOC Exceedance
10/10/2022 9:50	0	0.019	0.0226	No	0	No
10/10/2022 9:51	0	0.024	0.0227	No	0	No
10/10/2022 9:52	0	0.031	0.0231	No	0	No
10/10/2022 9:53	0	0.024	0.0231	No	0	No
10/10/2022 9:54	0	0.022	0.0233	No	0	No
10/10/2022 9:55	0	0.024	0.0235	No	0	No
10/10/2022 9:56	0	0.024	0.0233	No	0	No
10/10/2022 9:57	0	0.019	0.023	No	0	No
10/10/2022 9:58	0	0.02	0.0225	No	0	No
10/10/2022 9:59	0	0.019	0.0222	No	0	No
10/10/2022 10:00	0	0.018	0.0221	No	0	No
10/10/2022 10:01	0	0.034	0.0231	No	0	No
10/10/2022 10:02	0	0.026	0.0233	No	0	No
10/10/2022 10:03	0	0.026	0.0234	No	0	No
10/10/2022 10:04	0	0.019	0.0233	No	0	No
10/10/2022 10:05	0	0.023	0.0235	No	0	No
10/10/2022 10:06	0	0.021	0.0233	No	0	No
10/10/2022 10:07	0	0.02	0.0226	No	0	No
10/10/2022 10:08	0	0.06	0.025	No	0	No
10/10/2022 10:09	0	0.029	0.0255	No	0	No
10/10/2022 10:10	0	0.031	0.0259	No	0	No
10/10/2022 10:11	0	0.024	0.0259	No	0	No
10/10/2022 10:12	0	0.019	0.0259	No	0	No
10/10/2022 10:13	0	0.019	0.0259	No	0	No
10/10/2022 10:14	0	0.019	0.0259	No	0	No
10/10/2022 10:15	0	0.024	0.0263	No	0	No
10/10/2022 10:16	0	0.023	0.0255	No	0	No
10/10/2022 10:17	0	0.035	0.0261	No	0	No
10/10/2022 10:18	0	0.027	0.0262	No	0	No
10/10/2022 10:19	0	0.02	0.0263	No	0	No
10/10/2022 10:20	0	0.033	0.0269	No	0	No
10/10/2022 10:21	0	0.031	0.0276	No	0	No
10/10/2022 10:22	0	0.046	0.0293	No	0	No
10/10/2022 10:23	0	0.027	0.0271	No	0	No
10/10/2022 10:24	0	0.025	0.0269	No	0	No
10/10/2022 10:25	0	0.019	0.0261	No	0	No
10/10/2022 10:26	0	0.021	0.0259	No	0	No
10/10/2022 10:27	0	0.02	0.0259	No	0	No
10/10/2022 10:28	0	0.021	0.0261	No	0	No
10/10/2022 10:29	0	0.027	0.0266	No	0	No
10/10/2022 10:30	0	0.023	0.0265	No	0	No
10/10/2022 10:31	0	0.02	0.0263	No	0	No
10/10/2022 10:32	0	0.021	0.0254	No	0	No
10/10/2022 10:33	0	0.025	0.0253	No	0	No
10/10/2022 10:34	0	0.023	0.0255	No	0	No
10/10/2022 10:35	0	0.024	0.0249	No	0	No
10/10/2022 10:36	0	0.022	0.0243	No	0	No
10/10/2022 10:37	0	0.029	0.0231	No	0	No
10/10/2022 10:38	0	0.03	0.0233	No	0	No
10/10/2022 10:39	0.724	0.063	0.0259	No	0.0483	No
10/10/2022 10:40	0.008	0.054	0.0282	No	0.0488	No
10/10/2022 10:41	0	0.032	0.0289	No	0.0488	No
10/10/2022 10:42	0	0.028	0.0295	No	0.0488	No
10/10/2022 10:43	0	0.087	0.0339	No	0.0488	No
10/10/2022 10:44	0	0.045	0.0351	No	0.0488	No

Downwind Station

Time	Instantaneous VOC (ppm)	Instantaneous Mass Conc. Total (mg/m ³)	Mass Conc. Total mg/m ³ AVG 15m (mg/m ³)	Dust Exceedance	VOC ppm AVG 15m (ppm)	VOC Exceedance
10/10/2022 10:45	0	0.026	0.0353	No	0.0488	No
10/10/2022 10:46	0	0.022	0.0354	No	0.0488	No
10/10/2022 10:47	0	0.028	0.0359	No	0.0488	No
10/10/2022 10:48	0	0.022	0.0357	No	0.0488	No
10/10/2022 10:49	0	0.024	0.0357	No	0.0488	No
10/10/2022 10:50	0	0.075	0.0391	No	0.0488	No
10/10/2022 10:51	0	0.216	0.0521	No	0.0488	No
10/10/2022 10:52	0.019	0.154	0.0604	No	0.0501	No
10/10/2022 10:53	0	0.093	0.0646	No	0.0501	No
10/10/2022 10:54	0	0.034	0.0627	No	0.0018	No
10/10/2022 10:55	0	0.028	0.0609	No	0.0013	No
10/10/2022 10:56	0	0.028	0.0607	No	0.0013	No
10/10/2022 10:57	0	0.037	0.0613	No	0.0013	No
10/10/2022 10:58	0.136	0.07	0.0601	No	0.0103	No
10/10/2022 10:59	0	0.156	0.0675	No	0.0103	No
10/10/2022 11:00	0	0.29	0.0851	No	0.0103	No
10/10/2022 11:01	0	0.088	0.0895	No	0.0103	No
10/10/2022 11:02	0.879	1.201	0.1677	No	0.0689	No
10/10/2022 11:03	0.11	0.755	0.2166	Yes	0.0763	No
10/10/2022 11:04	0.004	0.077	0.2201	Yes	0.0765	No
10/10/2022 11:05	0	0.025	0.2168	Yes	0.0765	No
10/10/2022 11:06	0	0.023	0.2039	Yes	0.0765	No
10/10/2022 11:07	0	0.025	0.1953	Yes	0.0753	No
10/10/2022 11:08	0	0.027	0.1909	Yes	0.0753	No
10/10/2022 11:09	0	0.023	0.1902	Yes	0.0753	No
10/10/2022 11:10	0	0.036	0.1907	Yes	0.0753	No
10/10/2022 11:11	0	0.033	0.1911	Yes	0.0753	No
10/10/2022 11:12	0	0.034	0.1909	Yes	0.0753	No
10/10/2022 11:13	0	0.029	0.1881	Yes	0.0662	No
10/10/2022 11:14	0	0.02	0.1791	Yes	0.0662	No
10/10/2022 11:15	0	0.022	0.1612	Yes	0.0662	No
10/10/2022 11:16	0	0.027	0.1571	Yes	0.0662	No
10/10/2022 11:17	0	0.042	0.0799	Yes	0.0076	No
10/10/2022 11:18	7.175	3.291	0.2489	No	0.4786	No
10/10/2022 11:19	0.225	5.549	0.6137	Yes	0.4933	No
10/10/2022 11:20	0.176	0.188	0.6246	Yes	0.5051	No
10/10/2022 11:21	0.032	0.03	0.6251	Yes	0.5072	No
10/10/2022 11:22	0.02	0.026	0.6251	Yes	0.5085	No
10/10/2022 11:23	0	0.032	0.6255	Yes	0.5085	No
10/10/2022 11:24	0	0.026	0.6257	Yes	0.5085	No
10/10/2022 11:25	0	0.034	0.6255	Yes	0.5085	No
10/10/2022 11:26	0	0.04	0.626	Yes	0.5085	No
10/10/2022 11:27	0.116	0.032	0.6259	Yes	0.5163	No
10/10/2022 11:28	0	0.037	0.6264	Yes	0.5163	No
10/10/2022 11:29	0	0.034	0.6273	Yes	0.5163	No
10/10/2022 11:30	0	0.034	0.6281	Yes	0.5163	No
10/10/2022 11:31	0	0.042	0.6291	Yes	0.5163	No
10/10/2022 11:32	0	0.03	0.6283	Yes	0.5163	No
10/10/2022 11:33	0	0.025	0.4106	Yes	0.0379	No
10/10/2022 11:34	0	0.027	0.0425	Yes	0.0229	No
10/10/2022 11:35	0	0.026	0.0317	No	0.0112	No
10/10/2022 11:36	0.006	0.039	0.0323	No	0.0095	No
10/10/2022 11:37	0	0.21	0.0445	No	0.0081	No
10/10/2022 11:38	0	0.132	0.0512	No	0.0081	No
10/10/2022 11:39	0	0.068	0.054	No	0.0081	No

Downwind Station

Time	Instantaneous VOC (ppm)	Instantaneous Mass Conc. Total (mg/m ³)	Mass Conc. Total mg/m ³ AVG 15m (mg/m ³)	Dust Exceedance	VOC ppm AVG 15m (ppm)	VOC Exceedance
10/10/2022 11:40	0.028	0.053	0.0553	No	0.01	No
10/10/2022 11:41	0	0.076	0.0577	No	0.01	No
10/10/2022 11:42	0	0.027	0.0573	No	0.0023	No
10/10/2022 11:43	0.003	0.111	0.0623	No	0.0025	No
10/10/2022 11:44	0	0.037	0.0625	No	0.0025	No
10/10/2022 11:45	0	0.033	0.0624	No	0.0025	No
10/10/2022 11:46	0	0.026	0.0613	No	0.0025	No
10/10/2022 11:47	0.11	0.022	0.0608	No	0.0098	No
10/10/2022 11:48	0	0.199	0.0724	No	0.0098	No
10/10/2022 11:49	0	0.077	0.0757	No	0.0098	No
10/10/2022 11:50	0	0.032	0.0761	No	0.0098	No
10/10/2022 11:51	0	0.034	0.0758	No	0.0094	No
10/10/2022 11:52	0	0.032	0.0639	No	0.0094	No
10/10/2022 11:53	0	0.078	0.0603	No	0.0094	No
10/10/2022 11:54	0	0.033	0.058	No	0.0094	No
10/10/2022 11:55	0	0.034	0.0567	No	0.0075	No
10/10/2022 11:56	0	0.023	0.0532	No	0.0075	No
10/10/2022 11:57	0	0.018	0.0526	No	0.0075	No
10/10/2022 11:58	0	0.027	0.047	No	0.007	No
10/10/2022 11:59	0	0.019	0.0458	No	0.007	No
10/10/2022 12:00	0	0.018	0.0448	No	0.007	No
10/10/2022 12:01	0	0.055	0.0467	No	0.007	No
10/10/2022 12:02	0	0.047	0.0484	No	0	No
10/10/2022 12:03	0	0.018	0.0363	No	0	No
10/10/2022 12:04	0	0.019	0.0325	No	0	No
10/10/2022 12:05	0	0.016	0.0314	No	0	No
10/10/2022 12:06	0	0.019	0.0304	No	0	No
10/10/2022 12:07	0	0.019	0.0295	No	0	No
10/10/2022 12:08	0	0.017	0.0255	No	0	No
10/10/2022 12:09	0	0.025	0.0249	No	0	No
10/10/2022 12:10	0	0.037	0.0251	No	0	No
10/10/2022 12:11	0	0.029	0.0255	No	0	No
10/10/2022 12:12	0	0.025	0.026	No	0	No
10/10/2022 12:13	0	0.028	0.0261	No	0	No
10/10/2022 12:14	0	0.027	0.0266	No	0	No
10/10/2022 12:15	0	0.026	0.0271	No	0	No
10/10/2022 12:16	0	0.033	0.0257	No	0	No
10/10/2022 12:17	0	0.026	0.0243	No	0	No
10/10/2022 12:18	0	0.021	0.0245	No	0	No
10/10/2022 12:19	0	0.025	0.0249	No	0	No
10/10/2022 12:20	0	0.031	0.0259	No	0	No
10/10/2022 12:21	0.002	0.036	0.027	No	0.0001	No
10/10/2022 12:22	0	0.027	0.0275	No	0.0001	No
10/10/2022 12:23	0	0.023	0.0279	No	0.0001	No
10/10/2022 12:24	0	0.035	0.0286	No	0.0001	No
10/10/2022 12:25	0.034	0.048	0.0293	No	0.0024	No
10/10/2022 12:26	0	0.035	0.0297	No	0.0024	No
10/10/2022 12:27	0	0.026	0.0298	No	0.0024	No
10/10/2022 12:28	0	0.024	0.0295	No	0.0024	No
10/10/2022 12:29	0	0.025	0.0294	No	0.0024	No
10/10/2022 12:30	0	0.02	0.029	No	0.0024	No
10/10/2022 12:31	0.042	0.024	0.0284	No	0.0052	No
10/10/2022 12:32	0	0.023	0.0282	No	0.0052	No
10/10/2022 12:33	0	0.026	0.0285	No	0.0052	No
10/10/2022 12:34	0	0.028	0.0287	No	0.0052	No

Downwind Station

Time	Instantaneous VOC (ppm)	Instantaneous Mass Conc. Total (mg/m ³)	Mass Conc. Total mg/m ³ AVG 15m (mg/m ³)	Dust Exceedance	VOC ppm AVG 15m (ppm)	VOC Exceedance
10/10/2022 12:35	0	0.04	0.0293	No	0.0052	No
10/10/2022 12:36	0	0.048	0.0301	No	0.0051	No
10/10/2022 12:37	0	0.052	0.0318	No	0.0051	No
10/10/2022 12:38	0	0.051	0.0337	No	0.0051	No
10/10/2022 12:39	0	0.032	0.0335	No	0.0051	No
10/10/2022 12:40	0	0.041	0.033	No	0.0028	No
10/10/2022 12:41	0	0.031	0.0327	No	0.0028	No
10/10/2022 12:42	0	0.039	0.0336	No	0.0028	No
10/10/2022 12:43	0	0.02	0.0333	No	0.0028	No
10/10/2022 12:44	0	0.017	0.0328	No	0.0028	No
10/10/2022 12:45	0	0.024	0.0331	No	0.0028	No
10/10/2022 12:46	0	0.021	0.0329	No	0	No
10/10/2022 12:47	0	0.021	0.0327	No	0	No
10/10/2022 12:48	0	0.021	0.0324	No	0	No
10/10/2022 12:49	0	0.021	0.0319	No	0	No
10/10/2022 12:50	0	0.02	0.0306	No	0	No
10/10/2022 12:51	0	0.031	0.0295	No	0	No
10/10/2022 12:52	0	0.023	0.0275	No	0	No
10/10/2022 12:53	0	0.022	0.0256	No	0	No
10/10/2022 12:54	0	0.021	0.0249	No	0	No
10/10/2022 12:55	0	0.024	0.0237	No	0	No
10/10/2022 12:56	0	0.032	0.0238	No	0	No
10/10/2022 12:57	0	0.029	0.0231	No	0	No
10/10/2022 12:58	0	0.025	0.0235	No	0	No
10/10/2022 12:59	0	0.024	0.0239	No	0	No
10/10/2022 13:00	0	0.021	0.0237	No	0	No
10/10/2022 13:01	0	0.028	0.0242	No	0	No
10/10/2022 13:02	0	0.022	0.0243	No	0	No
10/10/2022 13:03	0	0.027	0.0247	No	0	No
10/10/2022 13:04	0	0.025	0.0249	No	0	No
10/10/2022 13:05	0	0.025	0.0253	No	0	No
10/10/2022 13:06	0	0.018	0.0244	No	0	No
10/10/2022 13:07	0	0.019	0.0241	No	0	No
10/10/2022 13:08	0	0.026	0.0244	No	0	No
10/10/2022 13:09	0	0.017	0.0241	No	0	No
10/10/2022 13:10	0	0.029	0.0245	No	0	No
10/10/2022 13:11	0	0.065	0.0267	No	0	No
10/10/2022 13:12	0	0.138	0.0339	No	0	No
10/10/2022 13:13	0.064	0.028	0.0341	No	0.0043	No
10/10/2022 13:14	0	0.036	0.0349	No	0.0043	No
10/10/2022 13:15	0	0.041	0.0363	No	0.0043	No
10/10/2022 13:16	0	0.02	0.0357	No	0.0043	No
10/10/2022 13:17	0.015	0.061	0.0383	No	0.0053	No
10/10/2022 13:18	0	0.11	0.0439	No	0.0053	No
10/10/2022 13:19	0	0.066	0.0466	No	0.0053	No
10/10/2022 13:20	0	0.166	0.056	No	0.0053	No
10/10/2022 13:21	0	0.059	0.0587	No	0.0053	No
10/10/2022 13:22	0	0.074	0.0624	No	0.0053	No
10/10/2022 13:23	0.038	0.047	0.0638	No	0.0078	No
10/10/2022 13:24	0	0.042	0.0655	No	0.0078	No
10/10/2022 13:25	0.03	0.022	0.065	No	0.0098	No
10/10/2022 13:26	0	0.025	0.0623	No	0.0098	No
10/10/2022 13:27	0	0.048	0.0563	No	0.0098	No
10/10/2022 13:28	0	0.191	0.0672	No	0.0055	No
10/10/2022 13:29	0	0.063	0.069	No	0.0055	No

Downwind Station

Time	Instantaneous VOC (ppm)	Instantaneous Mass Conc. Total (mg/m ³)	Mass Conc. Total mg/m ³ AVG 15m (mg/m ³)	Dust Exceedance	VOC ppm AVG 15m (ppm)	VOC Exceedance
10/10/2022 13:30	0	0.059	0.0702	No	0.0055	No
10/10/2022 13:31	0	0.057	0.0727	No	0.0055	No
10/10/2022 13:32	0	0.032	0.0707	No	0.0045	No
10/10/2022 13:33	0	0.025	0.0651	No	0.0045	No
10/10/2022 13:34	0	0.016	0.0617	No	0.0045	No
10/10/2022 13:35	0	0.02	0.052	No	0.0045	No
10/10/2022 13:36	0	0.136	0.0571	No	0.0045	No
10/10/2022 13:37	0	0.018	0.0534	No	0.0045	No
10/10/2022 13:38	0	0.021	0.0517	No	0.002	No
10/10/2022 13:39	0	0.025	0.0505	No	0.002	No
10/10/2022 13:40	0	0.022	0.0505	No	0	No
10/10/2022 13:41	0	0.017	0.05	No	0	No
10/10/2022 13:42	0	0.019	0.0481	No	0	No
10/10/2022 13:43	0	0.019	0.0366	No	0	No
10/10/2022 13:44	0	0.025	0.0341	No	0	No
10/10/2022 13:45	0	0.018	0.0313	No	0	No
10/10/2022 13:46	0	0.017	0.0287	No	0	No
10/10/2022 13:47	0	0.013	0.0274	No	0	No
10/10/2022 13:48	0	0.013	0.0266	No	0	No
10/10/2022 13:49	0	0.013	0.0264	No	0	No
10/10/2022 13:50	0	0.019	0.0263	No	0	No
10/10/2022 13:51	0	0.014	0.0182	No	0	No
10/10/2022 13:52	0	0.014	0.0179	No	0	No
10/10/2022 13:53	0	0.014	0.0175	No	0	No
10/10/2022 13:54	0	0.023	0.0173	No	0	No
10/10/2022 13:55	0	0.024	0.0175	No	0	No
10/10/2022 13:56	0	0.019	0.0176	No	0	No
10/10/2022 13:57	0	0.027	0.0181	No	0	No
10/10/2022 13:58	0	0.027	0.0187	No	0	No
10/10/2022 13:59	0	0.015	0.018	No	0	No
10/10/2022 14:00	0	0.012	0.0176	No	0	No
10/10/2022 14:01	0	0.014	0.0174	No	0	No
10/10/2022 14:02	0	0.026	0.0183	No	0	No
10/10/2022 14:03	0	0.026	0.0191	No	0	No
10/10/2022 14:04	0.043	0.02	0.0196	No	0.0029	No
10/10/2022 14:05	0	0.024	0.0199	No	0.0029	No
10/10/2022 14:06	0	0.021	0.0204	No	0.0029	No
10/10/2022 14:07	0	0.022	0.0209	No	0.0029	No
10/10/2022 14:08	0	0.021	0.0214	No	0.0029	No
10/10/2022 14:09	0	0.016	0.0209	No	0.0029	No
10/10/2022 14:10	0	0.032	0.0215	No	0.0029	No
10/10/2022 14:11	0	0.019	0.0215	No	0.0029	No
10/10/2022 14:12	0	0.023	0.0212	No	0.0029	No
10/10/2022 14:13	0	0.032	0.0215	No	0.0029	No
10/10/2022 14:14	0	0.023	0.0221	No	0.0029	No
10/10/2022 14:15	0	0.015	0.0223	No	0.0029	No
10/10/2022 14:16	0	0.019	0.0226	No	0.0029	No
10/10/2022 14:17	0	0.015	0.0219	No	0.0029	No
10/10/2022 14:18	0	0.024	0.0217	No	0.0029	No
10/10/2022 14:19	0	0.019	0.0217	No	0	No
10/10/2022 14:20	0	0.019	0.0213	No	0	No
10/10/2022 14:21	0	0.021	0.0213	No	0	No
10/10/2022 14:22	0	0.018	0.0211	No	0	No
10/10/2022 14:23	0	0.018	0.0209	No	0	No
10/10/2022 14:24	0	0.012	0.0206	No	0	No

Downwind Station

Time	Instantaneous VOC (ppm)	Instantaneous Mass Conc. Total (mg/m³)	Mass Conc. Total mg/m³ AVG 15m (mg/m³)	Dust Exceedance	VOC ppm AVG 15m (ppm)	VOC Exceedance
10/10/2022 14:25	0	0.023	0.02	No	0	No
10/10/2022 14:26	0	0.024	0.0203	No	0	No
10/10/2022 14:27	0	0.021	0.0202	No	0	No
10/10/2022 14:28	0	0.02	0.0194	No	0	No
10/10/2022 14:29	0	0.028	0.0197	No	0	No
10/10/2022 14:30	0	0.016	0.0198	No	0	No
10/10/2022 14:31	0	0.013	0.0194	No	0	No
10/10/2022 14:32	0	0.012	0.0192	No	0	No
10/10/2022 14:33	0	0.016	0.0187	No	0	No
10/10/2022 14:34	0	0.013	0.0183	No	0	No
10/10/2022 14:35	0	0.013	0.0179	No	0	No
10/10/2022 14:36	0	0.014	0.0174	No	0	No
10/10/2022 14:37	0	0.013	0.0171	No	0	No
10/10/2022 14:38	0	0.014	0.0168	No	0	No
10/10/2022 14:39	0	0.012	0.0168	No	0	No
10/10/2022 14:40	0	0.012	0.0161	No	0	No
10/10/2022 14:41	0	0.012	0.0153	No	0	No
10/10/2022 14:42	0	0.014	0.0148	No	0	No
10/10/2022 14:43	0	0.013	0.0143	No	0	No
10/10/2022 14:44	0	0.012	0.0133	No	0	No
10/10/2022 14:45	0	0.013	0.0131	No	0	No
10/10/2022 14:46	0	0.016	0.0133	No	0	No
10/10/2022 14:47	0	0.012	0.0133	No	0	No
10/10/2022 14:48	0	0.016	0.0133	No	0	No
10/10/2022 14:49	0	0.014	0.0133	No	0	No
10/10/2022 14:50	0	0.013	0.0133	No	0	No
10/10/2022 14:51	0	0.014	0.0133	No	0	No
10/10/2022 14:52	0	0.013	0.0133	No	0	No
10/10/2022 14:53	0	0.012	0.0132	No	0	No
10/10/2022 14:54	0	0.012	0.0132	No	0	No
10/10/2022 14:55	0	0.012	0.0132	No	0	No
10/10/2022 14:56	0	0.014	0.0133	No	0	No
10/10/2022 14:57	0	0.018	0.0136	No	0	No
10/10/2022 14:58	0	0.015	0.0137	No	0	No
10/10/2022 14:59	0	0.013	0.0138	No	0	No
10/10/2022 15:00	0	0.013	0.0138	No	0	No
10/10/2022 15:01	0	0.013	0.0136	No	0	No
10/10/2022 15:02	0	0.014	0.0137	No	0	No
10/10/2022 15:03	0	0.019	0.0139	No	0	No
10/10/2022 15:04	0	0.015	0.014	No	0	No
10/10/2022 15:05	0	0.015	0.0141	No	0	No
10/10/2022 15:06	0	0.013	0.0141	No	0	No
10/10/2022 15:07	0	0.014	0.0141	No	0	No
10/10/2022 15:08	0	0.014	0.0143	No	0	No
10/10/2022 15:09	0	0.013	0.0143	No	0	No
10/10/2022 15:10	0	0.012	0.0143	No	0	No
10/10/2022 15:11	0	0.024	0.015	No	0	No
10/10/2022 15:12	0	0.012	0.0146	No	0	No
10/10/2022 15:13	0	0.013	0.0145	No	0	No
10/10/2022 15:14	0	0.014	0.0145	No	0	No