

MJK



6 December 2001

Mr. Michael Resh
Manager of Environmental Remediation
BOC Gases
100 Mountain Avenue
Murray Hill, New Jersey 07974

RECEIVED

DEC 07 2001

NYSDEC - REG. 9
FOIL
 REL UNREL

RE: Third Quarter Year 2001 Monitoring Event Letter Report, Site No. 932001,
Aircro Properties Inc., Witmer Road Landfill, Niagara Falls, New York
EA Project No. 12040.69

Dear Mr. Hinton:

EA Engineering, P.C. and its affiliate EA Engineering, Science, and Technology are pleased to provide three copies of the Third Quarter Year 2001 Monitoring Event Letter Report. During December 2000, the post-closure monitoring and facility maintenance program was initiated at the Witmer Road Landfill located in Niagara Falls, New York. Post-closure monitoring and facility maintenance is required by New York State Solid Waste Management Facilities Regulations (6 NYCRR Part 360-2.15[k][4]) and stipulated in Order on Consent No. B9-0470-94-12. The purpose of this monitoring event letter report is to summarize the analytical results of the third quarter Year 2001 ground-water monitoring event that was completed at this site in September 2001.

OBJECTIVES

In accordance with the Revised Final Post-Closure Monitoring and Facility Maintenance Plan (EA 2001a)¹, environmental monitoring points will be maintained and sampled during the post-closure monitoring period. This includes collection of ground-water, surface water, and leachate samples. The Revised Final Post-Closure Monitoring and Facility Maintenance Plan (EA 2001, Appendix A) documents sampling locations and sampling parameters and methods, in addition to other required maintenance activities, such as landfill cap inspections. It is anticipated that within 5 years of the start of post-closure monitoring, this Plan will be re-evaluated based on the data collected at the site so that the Plan will be focused to address site-specific issues that may be identified.

The objectives of the Post-Closure Monitoring and Facility Maintenance Program are to:

- Collect representative ground-water and surface water samples in order to monitor any potential leachate migration from the landfill, and to document the effectiveness of the recently installed landfill capping system.

1. EA Engineering, Science, and Technology. 2001. Interim Remedial Measure Report Documenting Closure of the Witmer Road Landfill, Niagara Falls, New York. January.

- Evaluate these data to determine whether any potential impacts may be occurring that could affect human health or the environment
- Provide this information to the BOC Group and the New York State Department of Environmental Conservation (NYSDEC).

As noted in the Revised Final Post-Closure Monitoring and Facility Maintenance Plan (EA 2001a), the results of the quarterly sampling events will be summarized in a letter report detailing the findings of the environmental sampling. Monitoring event letter reports will be limited to documenting the results of each sampling event. This letter report summarizes the findings of the fourth post-closure monitoring event completed at this site. Beginning with calendar year 2001, an annual report will be issued that will provide an assessment of site analytical data trends, other findings, conclusions, and recommendations. No annual report for 2000 was prepared as only one round of data was collected for post-closure monitoring during 2000. Therefore, the first annual report will document findings for quarterly monitoring events during the 2001 calendar year, plus the one sampling event conducted in December 2000.

BACKGROUND

The Witmer Road Landfill is part of the Vanadium Corporation of America site that is located in the Town of Niagara Falls, New York (Figure 1). The Vanadium site covers approximately 150 acres and is comprised of smaller parcels. This quarterly sampling event focused on the 25-acre Airco parcel operated by the BOC Group on which the Witmer Road Landfill is located. The site contains waste material from the operation of onsite and nearby production facilities.

An Immediate Investigative Work Assignment was conducted by NYSDEC for a portion of the 150-acre parcel in August 1997. Approximately 70 acres from the Niagara Mohawk Power Corporation and New York Power Authority parcel were investigated. During the investigation, NYSDEC determined that the site had been used by Vanadium Corporation of America (the owners of the site from 1924 to 1964) to dispose of wood, brick, ash, lime slag, ferrochromium silicon slag, and ferrochromium silicon dust. According to the Immediate Investigative Work Assignment, much of the surface material consisted of fill, including fly ash, dust, slag, and cinder materials.

Analysis of site ground water during the Immediate Investigative Work Assignment indicated that surface water and ground-water standards were exceeded for hexavalent chromium and pH. Based on the Immediate Investigative Work Assignment and other investigations, the facility has been listed as a Class 2 Hazardous Waste Site in the New York State Registry of Inactive Hazardous Waste Sites (Site No. 932001). A Class 2 listing indicates a significant threat to public health and the environment, and requires remedial action.

Interim remedial measures were completed at the Witmer Road Landfill during 2000, which included completion of an impermeable cap and leachate relief system. A complete description of the history of the site, and the construction details of the landfill capping system, can be found in the Interim Remedial Measure Report (EA 2001).

MONITORING EVENT FIELD ACTIVITIES

The third quarter 2001 monitoring event included the following activities:

- Relief pipe flow monitoring
- Monitoring well gauging
- Ground-water sampling
- Leachate sampling
- Landfill engineering inspection.

No surface water sampling was conducted during the monitoring event as surface water sampling locations were dry during this event. Further detail on the above activities is discussed below.

Relief Pipe Flow Monitoring

On 1 August 2001, EA personnel installed flow monitoring equipment onto the relief pipe to assess the flow rate of the discharge from the relief pipe. The equipment logged flow data every 30 minutes from 1 August to 24 October 2001. The equipment was removed at that time to prevent potential damage due to inclement weather. Presentation and discussion of the data will be included in the annual report. Flow monitoring will commence in Spring 2002 to obtain additional flow data prior to preparation of final conclusions.

Monitoring Well Gauging

The site monitoring wells (MW-1B through MW-8B) were gauged on 18 September 2001 prior to sampling. The depth to water ranged from 7.17 ft at MW-6B to 17.40 ft at MW-2B. Gauging data are summarized in the table below:

Well ID	Gauging Date	Depth to Water (ft MSL)	Well Elevation (ft above MSL)	Water Elevation (ft MSL)
MW-1B	18 SEP 01	16.42	617.77	601.35
MW-2B	18 SEP 01	17.40	615.88	598.48
MW-3B	18 SEP 01	13.48	611.22	597.74
MW-4B	18 SEP 01	14.36	606.68	592.32
MW-5B	18 SEP 01	13.48	605.48	592.00
MW-6B	18 SEP 01	7.17	603.47	596.30
MW-7B	18 SEP 01	12.67	609.48	596.81
MW-8B	18 SEP 01	10.73	611.62	600.89

NOTE: MSL = Mean sea level.

Figure 2 provides the interpreted ground-water potentiometric surface contour map based on gauging data collected on 18 September 2001.

Ground-Water and Leachate Sampling Procedures

Monitoring wells were sampled on 19 September 2001. Six ground-water samples were collected from the site monitoring wells. Two of the monitoring wells (MW-4B and MW-5B) contained less than 1 ft of standing water each, and this could not produce sufficient water to enable purging and

sampling. Monitoring wells MW-3B, MW-7B, and MW-8B were purged using dedicated bailers due to low recharge and well volume. These wells were bailed dry at least once and allowed to recharge prior to sample collection. Monitoring wells MW-1B, MW-2B, and MW-6B yielded adequate recharge rates; consequently, 4 well volumes were purged and water quality indicator parameters allowed to stabilize prior to sample collection. One leachate sample was also collected. Although no flow was observed from the relief pipe, the sample was collected from inside the riser pipe. Samples were submitted to Environmental Laboratory Services of North Syracuse, New York for analysis of phenolics by U.S. Environmental Protection Agency (EPA) Method 420.2, sulfate by EPA Method 375.3, ammonia (expressed as nitrogen) by EPA Method 350.2, and Target Analyte List metals by EPA Series 6010/6020, including hexavalent chromium.

Ground-water sampling results were compared to NYSDEC Ambient Water Quality Standards (AWQS) (NYSDEC 1999)² and guidance values for GA waters. Leachate samples were compared to NYSDEC AWQS for Class D waters. If no Class D standards were applicable for a particular analyte, analytical results were compared to the more stringent Class C standards. Analytical results are summarized on the table provided in Attachment A. Copies of the field notebook, including the results for well gauging, purging, and sampling, are provided in Attachment B. Laboratory chain-of-custody records are provided in Attachment C. Laboratory Form I analytical results are included in Attachment D.

ANALYTICAL RESULTS

Based on the analytical results collected during the Fourth Quarter 2000 and First Quarter 2001, NYSDEC has approved a reduction in the sampling requirements for the remaining 2001 sampling event. As per a letter to NYSDEC dated 5 June 2000, samples will be analyzed for water quality parameters; ammonia, phenolics, and sulfate, and total (unfiltered) metals.

Summary tables listing analytical results compared to applicable NYSDEC AWQS are included in Attachment A. Notable results of chemical analyses are as follows.

Metals

Unfiltered metals samples were collected from each of the six site monitoring wells sampled. Notable results included the following:

- Chromium, hexavalent chromium, iron, lead, magnesium, manganese, selenium, and sodium were detected in one or more of the ground-water samples at concentrations in excess of NYSDEC AWQS.
- Hexavalent chromium was detected in excess of the NYSDEC AWQS in the leachate sample. However, no discharge was observed from this location at the time of sample collection.

2. New York State Department of Environmental Conservation. 1999. Water Quality Regulations – Surface Water and Ground-Water Classifications and Standards, New York State Codes, Rules, and Regulations Title 6, Chapter, X, Parts 700-706.

Water Quality Parameters

Water quality parameters, including ammonia (expressed as N), phenolics, and sulfate, were also analyzed. Notable results included the following:

- Phenolics were detected above AWQS in the sample collected from monitoring well MW-2B.
- Sulfate was detected in excess of AWQS in samples collected from monitoring wells MW-6B and the associated duplicate, and MW-8B.

LANDFILL INSPECTION

A landfill cap inspection was conducted on 18 September 2001. The Landfill Cap Inspection Checklist is provided as Attachment E. No deterioration or damage to the landfill, cap, drainage swales, or access roads was noted during the engineering inspection.

If you have any questions regarding the results of this Third Quarter 2001 Monitoring Event, please do not hesitate to contact Charles McLeod at (845) 565-8100.

Sincerely,

EA ENGINEERING, P.C.

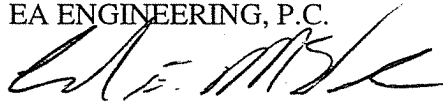

Charles E. McLeod, Jr., P.E.
Vice President

EA ENGINEERING, SCIENCE,
AND TECHNOLOGY

Scott Graham/mlg
Scott Graham
Project Geologist

CEM/caw
Attachments

cc: M. Hinton (NYSDEC)
D. Hettrick (NYSDOH)
Town of Niagara Falls (Town Clerk)

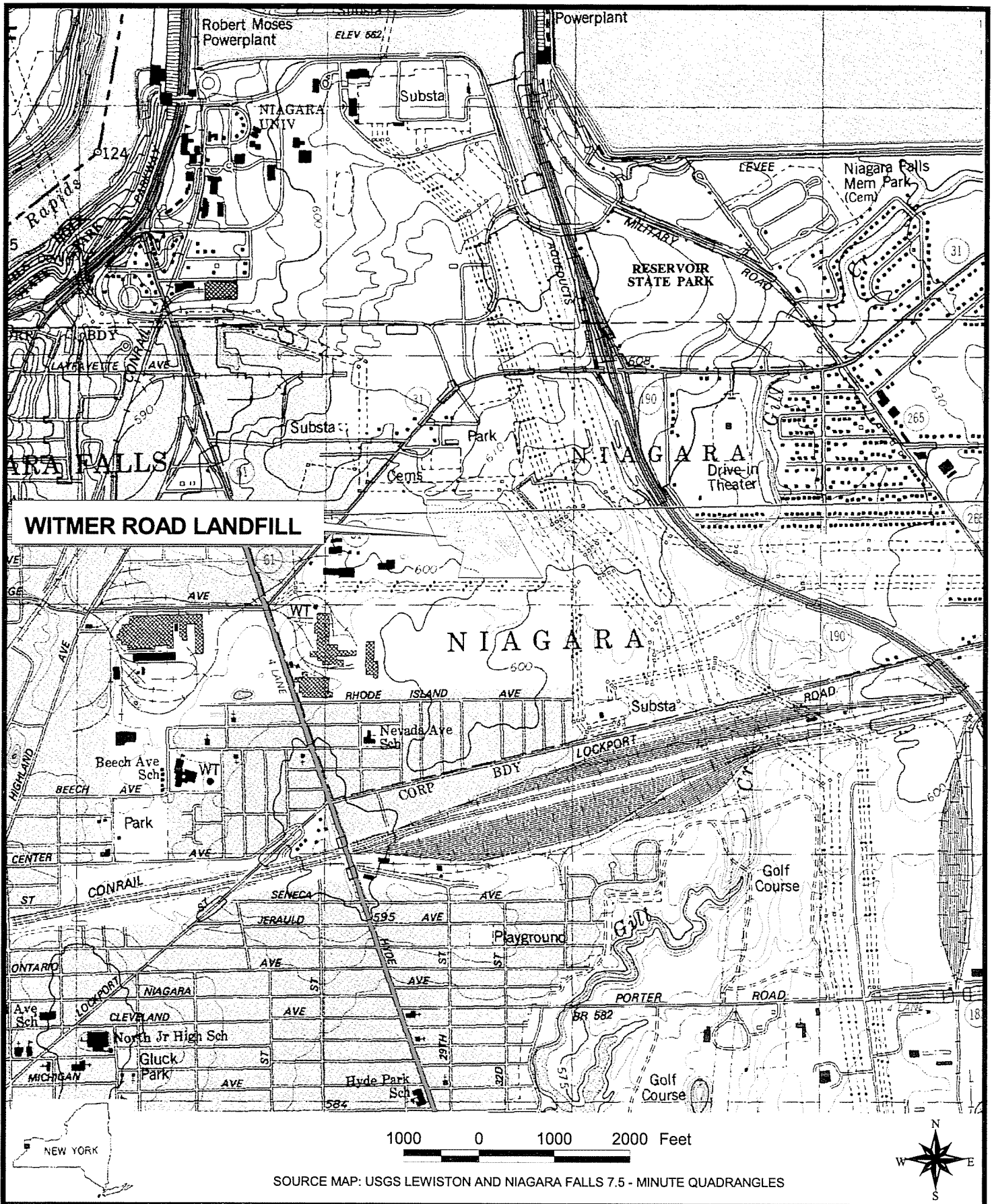

EA ENGINEERING,
SCIENCE, AND
TECHNOLOGY

WITMER ROAD LANDFILL
NIAGARA FALLS, NEW YORK

FIGURE I
SITE LOCATION MAP

PROJECT MGR	DESIGNED BY	DRAWN BY	CHECKED BY	SCALE	DATE	PROJECT No	FILE No
CEM	BT	BT	CEM	AS SHOWN	24 JULY 2001	12040.69	I:\BOC-NIAGARA-GIS\BOC.APR

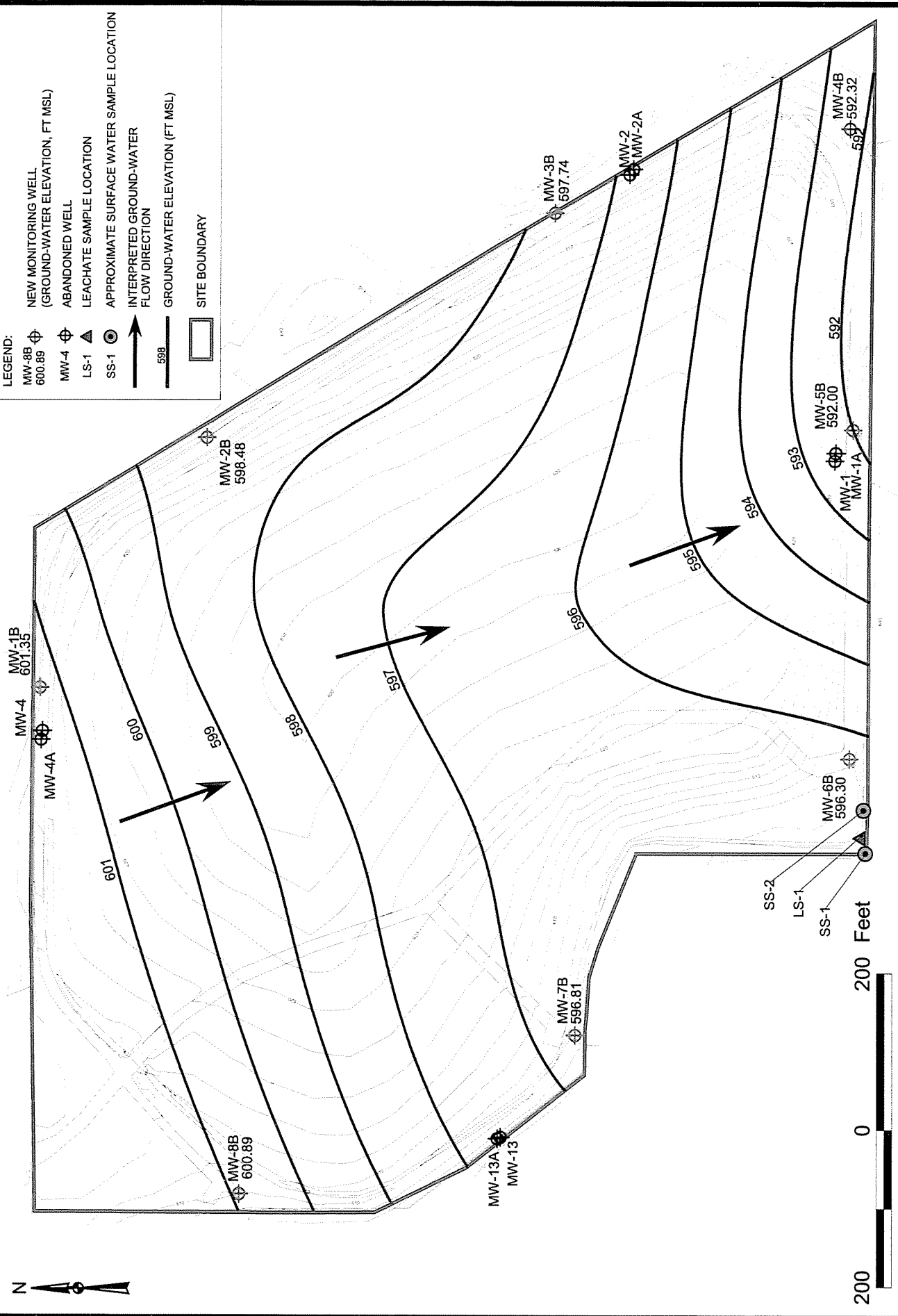

EA ENGINEERING,
SCIENCE, AND
TECHNOLOGY

WITMER ROAD LANDFILL
NIAGARA FALLS, NEW YORK

FIGURE 2
GROUND-WATER CONTOUR MAP
SEPTEMBER 2001

PROJECT MGR CEM	DESIGNED BY BT	DRAWN BY BT	CHECKED BY GMC	SCALE AS SHOWN	DATE 4 DECEMBER 2001	PROJECT No 12040.69	FILE No I:\BOC-NIAGARA-GIS\ BOC.APR
--------------------	-------------------	----------------	-------------------	-------------------	-------------------------	------------------------	---

Attachment A

Summary of Analytical Data

ATTACHMENT A SUMMARY OF ANALYTICAL RESULTS OF GROUND-WATER, SURFACE WATER,
AND LEACHATE SAMPLES COLLECTED 19-20 SEPTEMBER 2001,
WITMER ROAD LANDFILL, NIAGARA FALLS, NEW YORK

Ground Water

Baseline Metals by EPA Method 6010/6020 (mg/L)

Total (Unfiltered)

		WRL MW1B	WRL MW2B	WRL MW3B	WRL MW6B	WRL MW6B (Dup)	WRL MW7B	WRL MW8B
Compound/Element	AWQS							
Chromium	0.05	0.011	0.333	(<0.005U)	0.007	(<0.005U)	0.231	0.136
Chromium, Hexavalent	0.05	(<0.01U)	0.299	(<0.01U)	(<0.01U)	(<0.01U)	0.18	0.146
Iron	0.3	3.4	0.98	0.26	0.186	0.103	6	1.3
Lead	0.025	0.015	0.039	(<0.005U)	(<0.005U)	(<0.005U)	(<0.005U)	(<0.005U)
Magnesium	35*	61.3	1.4	10.9	69.2	67.6	10.4	62.1
Manganese	0.3	0.672	0.03	0.008	0.079	0.067	0.151	0.19
Selenium	0.01	(<0.005U)	0.008	(<0.005U)	(<0.005U)	(<0.005U)	(<0.005U)	0.125
Silica	---	21	2.91	13.4	12.1	12.3	19.1	15.3
Sodium	20	137	57.1	44.9	66.8	65.2	56.8	174
Zinc	2*	0.27	0.023	(<0.005U)	(<0.005U)	(<0.005U)	0.011	0.021

Water Quality Parameters (mg/L)

		WRL MW1B	WRL MW2B	WRL MW3B	WRL MW6B	WRL MW6B (Dup)	WRL MW7B	WRL MW8B
Compound/Element	AWQS							
Ammonia (expressed as N)	2	(<1U)	2	(<1U)	(<1U)	(<1U)	(<1U)	(<1U)
Phenolics	1	(<2U)	13.6	(<2U)	(<2U)	(<2U)	(<2U)	(<2U)
Sulfate	250	209	13.9	23.1	252	270	37	419

Leachate

Baseline Metals by EPA Method 6010/6020 (mg/L)

Total (Unfiltered)

		WRL L1
Compound/Element	AWQS	
Chromium	---	0.413
Chromium, Hexavalent	0.016	0.448
Iron	0.3	0.044
Lead	---	(<0.005U)
Magnesium	---	(<1U)
Manganese	---	(<0.005U)
Selenium	---	0.022
Silica	---	0.77
Sodium	---	79.2
Zinc	---	(<0.005U)

Water Quality Parameters (mg/L)

		WRL L1
Compound/Element	AWQS	
Ammonia (expressed as N)	---	4.9
Phenolics	---	109
Sulfate	---	14.1

ATTACHMENT A (CONTINUED)

QA/QC

Baseline Metals by EPA Method 6010/6020 (mg/L)

Total (Unfiltered)

Compound/Element	AWQS	Rinse Blank	Source Water Blank
Chromium	---	(<0.005U)	(<0.005U)
Chromium, Hexavalent	---	(<0.01U)	(<0.01U)
Iron	---	(<0.025U)	(<0.025U)
Lead	---	(<0.005U)	(<0.005U)
Magnesium	---	(<1U)	(<1U)
Manganese	---	(<0.005U)	(<0.005U)
Selenium	---	(<0.005U)	(<0.005U)
Silica	---	(<0.21U)	(<0.21U)
Sodium	---	(<1U)	(<1U)
Zinc	---	(<0.005U)	(<0.005U)

Water Quality Parameters (mg/L)

Compound/Element	AWQS	Rinse Blank	Source Water Blank
Ammonia (expressed as N)	---	(<1U)	(<1U)
Phenolics	---	(<2U)	(<2U)
Sulfate	---	(<2U)	(<2U)

Attachment B

**Field Monitoring and
Sampling Notes**

W19 SEP01

ONSITE @ 0900 (J. HAYWARD, J. CLARK)

SUNNY 70°

- UNLOCK MMS, SET UP TO SAMPLE

- MEET JOHN @ 1030

- MW-3, 7, 8 → BALL

- MW-1, 2, 6 → PUMP

- MW-4, 5 = DRY ∴ NO SAMPLES

W19 SEP01

WATER QUALITY AND SAMPLING DATA

MW-1B

DTW: 16.42 TIME: 1130

PARAM	UNIT	1	2	3	4
TIME	11:30	11:34	11:30	11:42	11:46
PH	8.57	7.90	7.62	7.62	7.63
TEMP	12.26	12.10	12.20	12.54	12.73
COND	1.25	1.34	1.37	1.42	1.43
DO	5.62	4.63	3.66	3.18	3.16
TURB	500.0	114.6	73.2	27.0	23.9
SAL	0.1	0.1	0.1	0.1	0.1
DTW	16.17	-	16.94	16.97	-
RATE	0.25/m	-	-	-	-

WRL-MW1B-0901 COLLECTED @ 1155

WATER QUALITY AND SAMPLING DATA

MW-7B

DTW: 12:42 TIME: 12:30

PARAM	INITIAL	1	2	3	4
TIME	12:30	12:44	12:58	13:12	13:26
PH	13.37	13.55	13.57	13.50	13.46
TEMP	13.24	13.55	13.86	13.33	13.36
COND	4.70	4.55	4.44	4.45	4.43
DO	5.39	2.86	2.96	3.19	3.22
TURB	62.3	30.0	22.7	27.4	21.6
SAL	0.7	0.2	0.2	0.2	0.2
DTW	-	20.75	-	-	-
RATE	0.254m	-	-	-	-

WRL- MW7B-0901 COLLECTED @ 12:55

WATER QUALITY AND SAMPLING DATA

MW-3B

DTW: 13:48 TIME: 11:05

PARAM	INIT	1	2	3	4
TIME	11:00	12:20			
PH	9.74	10.26			
TEMP	12.47	19.92			
COND	0.511	0.459			
DO	5.62	5.39			
TURB	0	15.1			
SAL	0	0			
DTW	-	13.80			
RATE		3.82			

WRL- MW3B-0901 COLLECTED @ 11:05

SEE 2850P

NOTE

WATER QUALITY AND SAMPLING DATA

MW-6B

DWS# 717 TIME: 1320

	1	2	3	4
TIME	1321	1320	1332	1338
PH	8.26	8.09	8.09	8.03
TEMP	13.98	16.00	17.12	17.68
COND	1.06	1.05	1.02	1.05
DO	6.56	3.78	2.68	2.67
TURB	110.0	73.0	61.4	42.4
SAL	0	0	0	0

WRL - MW 6B - 090110 @ 1345

WATER QUALITY AND SAMPLING DATA

MW-7B

DWS# 1267 TIME: 1150

PARAM	INT.	1	2	3	4
TIME	1150				
PH	9.52				
TEMP	18.11				
COND	0.371				
DO	6.10				
TURB	14.1				
SAL	0.0				

BAILED DRY @ 1245, ~ 3gal
" @ 1430, ~ 2gal

NOTE:

SAMPLE TO BE COLLECTED TOMORROW

W19501

WATER QUALITY AND SAMPLING DATA

MW-8B

DIV: 10-73 TIME 1140

PARAM	INIT.	1	2	3	4
TIME	1140	1220			
PH	8.32				
TEMP	20.0				
COND	154				
DO	7.39				
TURB	17.7				
SAL	0.1				

BAILED DRY @ 1250, ~3gal
 BAILED DRY @ 1445, ~2gal

NOTE: SAMPLE TO BE COLLECTED TOMORROW

13.0 FT @ 1250

R20501

WEATHER: 70°, CLOUDY
 PERSONNEL: J. CLARK

ON SITE @ 0745 TO COLLECT SAMPLES FROM MW7B, MW7B, MW08B. ALSO TO COLLECT LEACHATE, RINSATE AND SOURCE WATER SAMPLES.

- WRL-MW08B-0901 COLLECTED @ 0800
- WRL-MW7B-0901 COLLECTED @ 0820
- WRL-MW08B-0901 COLLECTED @ 0840
- WAL-L1-0901 COLLECTED @ 0855
- WAL-RB-0901 COLLECTED @ 0915
- WAL-SWB-0901 COLLECTED @ 0930

LEACHATE WATER QUALITY

PH: 13.64
 TEMP: 18.47
 COND: 2.26
 DO: 10.78
 TURB: 19.6
 SAL: 0.1

*NO SURFACE H2O AVAIL. FOR SAMPLING

R205EPC1

INTERMEDIATE FLOW LOGGER @ 0950.

- DRAINAGE PIPE COMPLETELY DRY
- NO H₂O BEING DISCHARGED
- LOGGER INDICATE 0 gpd
OF H₂O DISCHARGED SINCE
LAST INTERROGATION → OK
- CHECK DESSICANTS → OK
- CHECK BATTERIES → OK

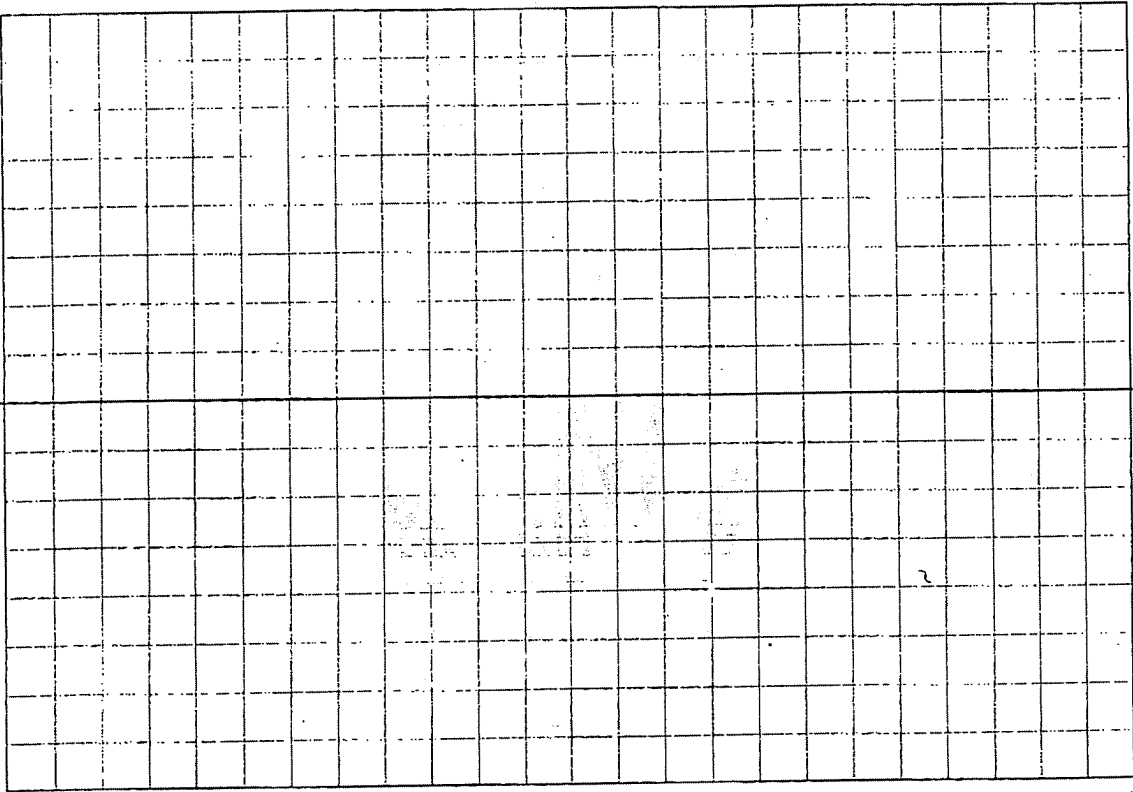

230AUG01

T 18 SEP 01

FLOW

WATER

RAINAGE

DN

ARD

MS

SDRES

VS

TH

WEATHER: 75° SUN
 PERSONNEL: J. HAYWARD

ONSITE FOR LANDFILL INSPECTION

- ARRIVE @ 1315, GATES LOCKED

- GAUGE ALL MWS DTB

MW 1B	16.42	(27.90)
2B	17.10	(27.58)
3B	13.48	(18.35)
4B	14.36	(19.09)
5B	13.48	(14.17)
6B	7.17	(22.98)
7B	12.67	(21.72)
8B	10.73	(15.60)

1530 LOCK UP, GO TO KMART FOR SUPPLIES

[Signature]
 9/18/01

Attachment C

**Laboratory Chain-of-Custody
Documents**



Environmental LABORATORY SERVICES
 7280 Caswell Street, Hancock Air Park North Syracuse, NY 13212
 (315) 458-8033 FAX (315) 458-0249 (800) 843-8265

CHAIN OF CUSTODY RECORD and Authorization for Analysis

Name	Title	Container Type/Preservative								Analyses Required, Remarks, and/or Special Instructions		
		Plastic/No Preservatives	Plastic/HNO ₃	Plastic/H ₂ SO ₄	Plastic/NaOH+Ascorbic Acid	Plastic/NaOH+Zinc Acetate	Glass/No Preservative	Glass/Sodium Thiosulfate	Amber Glass/No Pres.		Amber Glass/H ₂ SO ₄	Other: (specify)
The following services may result in additional charges: <input type="checkbox"/> Telephone Results Telephone No. 433 4280 <input type="checkbox"/> Fax Results Fax No. _____ Express Service <input type="checkbox"/> 1 Week <input type="checkbox"/> 48 Hour												
To be completed by Sampler. Please remember to record this information on the container label.												
ELS Number	*Date	*Time	*Comp.	*Grab	*Matrix	*Sampling Location	Number of Containers					
214770	1/15/01	1155		X		WRL-MNLB-0401	1	Amber Glass/H ₂ SO ₄			Phosphate	
214771	↓	↓					1	Plastic/H ₂ SO ₄			NIL N	
214772	↓	↓					1	Plastic/NaOH			Cadmium/Ascorbic Acid	
214773	↓	↓					1	Plastic/NaOH			Sulfate	
							Containers Dispensed by:				Date	Time
							Relinquished by:				Date	Time
							Relinquished by:				Date	Time
							Relinquished by:				Date	Time
							Received at Lab by: [Signature]				Date 1/17/01	Time 17:58



CHAIN OF CUSTODY RECORD
and Authorization for Analysis

Name Scott Graham

Company E.A. Engineering

Address 737 Fly Rd.

City, State, Zip East Syracuse, NY 13057

Title _____

Dept. _____

Job/PO No. _____

Telephone Results Telephone No. 414-4280

Fax Results Fax No. _____

Express Service

Advance Agreement Required

1 Week 48 Hour

The following services may result in additional charges:

To be completed by Sampler. Please remember to record this information on the container label.

Number of Containers _____

ELS Number _____

Date 1/15/01 **Time** 11:55 ***Comp.** _____ ***Grab** X ***Matrix** _____ ***Sampling Location** WRL-MAIN/B-0901

Container Type/Preservative

Plastic/No Preservatives	Plastic/HNO ₃	Plastic/H ₂ SO ₄	Plastic/NaOH+Ascorbic Acid	Plastic/NaOH+Zinc Acetate	Glass/No Preservative	Glass/Sodium Thiosulfate	Amber Glass/No Pres.	Amber Glass/H ₂ SO ₄	Other: (specify)
									Analyses Required, Remarks, and/or Special Instructions
									Hexavalent Chromium

Containers Dispensed by: _____ **Date** _____ **Time** _____

Containers Received by: _____ **Date** _____ **Time** _____

Relinquished by: _____ **Date** _____ **Time** _____

Relinquished by: _____ **Date** _____ **Time** _____

Relinquished by: _____ **Date** _____ **Time** _____

Relinquished by: _____ **Date** _____ **Time** _____

White - LABORATORY _____ **Time** 1:50

Canary - ACCOMPANIES RESULTS _____ **Time** _____

Pink - CLIENT _____ **Time** _____

Your signature authorizes ELS to analyze the sample(s) as indicated.

Sampler Signature: _____ **Date:** _____

White - LABORATORY _____ **Date:** 1/19/01 **Time:** 1:50

Canary - ACCOMPANIES RESULTS _____ **Date:** _____ **Time:** _____

Pink - CLIENT _____ **Date:** _____ **Time:** _____



Environmental LABORATORY SERVICES
 7280 Caswell Street, Hancock Air Park North Syracuse, NY 13212
 (315) 458-8033 FAX (315) 458-0249 (800) 843-8265

CHAIN OF CUSTODY RECORD
 and Authorization for Analysis

Name: Scott Graham Title: _____
 Company: E.A. Engineering Dept.: _____
 Address: 707 Fly Rd. Job/PO No.: _____
 City, State, Zip: East Syracuse, NY 13057

The following services may result in additional charges:
 Telephone Results Telephone No. 431-4280
 Fax Results Fax No. _____
 Express Service Advance Agreement Required
 1 Week 48 Hour

To be completed by Sampler. Please remember to record this information on the container label.

ELS Number	*Date	*Time	*Comp.	*Grab	*Matrix	*Sampling Location	Number of Containers	Container Type/Preservative	Analyses Required, Remarks, and/or Special Instructions
214775	209801	0800			X	WRL - MW3A - 0701	1	Amber Glass/H2SO4	Phenolics
214776							1	Plastic/H2SO4	NH3-N
214777							1	Plastic/NaOH+Ascorbic Acid	Cd/Cr/Fe/Pb/Hg/Mn/Si/Se/SS/TSS
214778							1	Plastic/NaOH+Zinc Acetate	Sulfate

Containers Dispensed by: _____ Date: _____ Time: _____
 Containers Received by: _____ Date: _____ Time: _____

Relinquished by: _____ Date: _____ Time: _____
 Relinquished by: _____ Date: _____ Time: _____

Relinquished by: _____ Date: _____ Time: _____
 Relinquished by: _____ Date: _____ Time: _____

Relinquished by: _____ Date: _____ Time: _____



Environmental
LABORATORY SERVICES
7280 Caswell Street, Hancock Air Park North Syracuse, NY 13212
(315) 458-8033 FAX (315) 458-0249 (800) 843-8265

CHAIN OF CUSTODY RECORD
and Authorization for Analysis

Name Scott Graham Company E.A. Engineering Address 737 Fly Rd. City, State, Zip East Syracuse, NY 13057	Title Dept. Job/PO No. 	Container Type/Preservative <table border="1" style="width:100%; border-collapse: collapse; text-align: center;"> <tr> <td>Plastic/No Preservatives</td> <td>Plastic/HNO₃</td> <td>Plastic/H₂SO₄</td> <td>Plastic/NaOH+Ascorbic Acid</td> <td>Plastic/NaOH+Zinc Acetate</td> <td>Glass/No Preservative</td> <td>Glass/Sodium Thiosulfate</td> <td>Amber Glass/No Pres.</td> <td>Amber Glass/H₂SO₄</td> <td>Other: (specify)</td> </tr> <tr> <td></td> <td>Plastic/HCl</td> <td></td> <td></td> <td></td> <td></td> <td></td> <td></td> <td></td> <td></td> </tr> <tr> <td></td> <td></td> <td></td> <td></td> <td></td> <td></td> <td></td> <td></td> <td></td> <td></td> </tr> <tr> <td></td> <td></td> <td></td> <td></td> <td></td> <td></td> <td></td> <td></td> <td></td> <td></td> </tr> <tr> <td></td> <td></td> <td></td> <td></td> <td></td> <td></td> <td></td> <td></td> <td></td> <td></td> </tr> <tr> <td></td> <td></td> <td></td> <td></td> <td></td> <td></td> <td></td> <td></td> <td></td> <td></td> </tr> <tr> <td></td> <td></td> <td></td> <td></td> <td></td> <td></td> <td></td> <td></td> <td></td> <td></td> </tr> <tr> <td></td> <td></td> <td></td> <td></td> <td></td> <td></td> <td></td> <td></td> <td></td> <td></td> </tr> <tr> <td></td> <td></td> <td></td> <td></td> <td></td> <td></td> <td></td> <td></td> <td></td> <td></td> </tr> <tr> <td></td> <td></td> <td></td> <td></td> <td></td> <td></td> <td></td> <td></td> <td></td> <td></td> </tr> <tr> <td></td> <td></td> <td></td> <td></td> <td></td> <td></td> <td></td> <td></td> <td></td> <td></td> </tr> <tr> <td></td> <td></td> <td></td> <td></td> <td></td> <td></td> <td></td> <td></td> <td></td> <td></td> </tr> <tr> <td></td> <td></td> <td></td> <td></td> <td></td> <td></td> <td></td> <td></td> <td></td> <td></td> </tr> <tr> <td></td> <td></td> <td></td> <td></td> <td></td> <td></td> <td></td> <td></td> <td></td> <td></td> </tr> <tr> <td></td> <td></td> <td></td> <td></td> <td></td> <td></td> <td></td> <td></td> <td></td> <td></td> </tr> <tr> <td></td> <td></td> <td></td> <td></td> <td></td> <td></td> <td></td> <td></td> <td></td> <td></td> </tr> <tr> <td></td> <td></td> <td></td> <td></td> <td></td> <td></td> <td></td> <td></td> <td></td> <td></td> </tr> <tr> <td></td> <td></td> <td></td> <td></td> <td></td> <td></td> <td></td> <td></td> <td></td> <td></td> </tr> <tr> <td></td> <td></td> <td></td> <td></td> <td></td> <td></td> <td></td> <td></td> <td></td> <td></td> </tr> <tr> <td></td> <td></td> <td></td> <td></td> <td></td> <td></td> <td></td> <td></td> <td></td> <td></td> </tr> <tr> <td></td> <td></td> <td></td> <td></td> <td></td> <td></td> <td></td> <td></td> <td></td> <td></td> </tr> <tr> <td></td> <td></td> <td></td> <td></td> <td></td> <td></td> <td></td> <td></td> <td></td> <td></td> </tr> <tr> <td></td> <td></td> <td></td> <td></td> <td></td> <td></td> <td></td> <td></td> <td></td> <td></td> </tr> </table>										Plastic/No Preservatives	Plastic/HNO ₃	Plastic/H ₂ SO ₄	Plastic/NaOH+Ascorbic Acid	Plastic/NaOH+Zinc Acetate	Glass/No Preservative	Glass/Sodium Thiosulfate	Amber Glass/No Pres.	Amber Glass/H ₂ SO ₄	Other: (specify)		Plastic/HCl																																																																																																																																																																																																																										
Plastic/No Preservatives	Plastic/HNO ₃	Plastic/H ₂ SO ₄	Plastic/NaOH+Ascorbic Acid	Plastic/NaOH+Zinc Acetate	Glass/No Preservative	Glass/Sodium Thiosulfate	Amber Glass/No Pres.	Amber Glass/H ₂ SO ₄	Other: (specify)																																																																																																																																																																																																																																								
	Plastic/HCl																																																																																																																																																																																																																																																
Number of Containers 1		Analytes Required, Remarks, and/or Special Instructions Hexavalent Chromium																																																																																																																																																																																																																																															
To be completed by Sampler. Please remember to record this information on the container label.																																																																																																																																																																																																																																																	
ELS Number	*Date	*Time	*Comp.	*Grab	*Matrix	*Sampling Location	Express Service <input type="checkbox"/> Advance Agreement Required <input type="checkbox"/> 1 Week <input type="checkbox"/> 48 Hour																																																																																																																																																																																																																																										
111779	202001	0800		X		WAL-MW35-0701																																																																																																																																																																																																																																											

Containers Dispensed by: [Signature]
Relinquished by: [Signature] 2/20/01
Relinquished by: [Signature]
Relinquished by: [Signature]
 Your signature authorizes ELS to analyze the sample(s) as indicated.

Containers Received by: [Signature] 2/20/01
Received by: [Signature] 2/20/01
Received by: [Signature]
Received at Lab by: [Signature] 2/20/01

Time
Time 1:30
Time
Time
Time

Date
2/20/01
Date
Date
Date

White - LABORATORY
 Use re-usable sample and all sample containers to Environmental Laboratory Services

Pink - CLIENT
 2217.E.L.S., 202.9310



Environmental
LABORATORY SERVICES
 7280 Caswell Street, Hancock Air Park North Syracuse, NY 13212
 (315) 458-8033 FAX (315) 458-0249 (800) 843-8265

CHAIN OF CUSTODY RECORD
 and Authorization for Analysis

Name Scott Graham Title Company E.A. Engineering Dept. Address 737 Fly Rd. Job/PO No. City, State, Zip East Syracuse, NY 13057		Express Service <input type="checkbox"/> Telephone Results Telephone No. 431-4280 <input type="checkbox"/> Fax Results Fax No.		Advance Agreement Required <input type="checkbox"/> 1 Week <input type="checkbox"/> 48 Hour		Number of Containers		Analyses Required, Remarks, and/or Special Instructions									
ELS Number		*Date	*Time	*Comp.	*Grab	*Matrix	*Sampling Location	Plastic/No Preservatives	Plastic/HNO ₃	Plastic/H ₂ SO ₄	Plastic/NaOH+Ascorbic Acid	Plastic/NaOH+Zinc Acetate	Glass/No Preservative	Glass/Sodium Thiosulfate	Amber Glass/No Pres.	Amber Glass/H ₂ SO ₄	Other: (specify)
214780	20SEP01	0020			X		WRL-MW73-0901	1	Amber Glass/H ₂ SO ₄								Phenol
214781								1	Plastic/NaOH+Ascorbic Acid								NH ₄ N
214782								1	Plastic/NaOH+Ascorbic Acid								CDCTEAPBHAMC
214783								1	Plastic/NaOH+Ascorbic Acid								sulfate
Containers Dispensed by:		Date	Time	Container(s) Received by:		Date	Time										
Relinquished by:		Date	Time	Received by:		Date	Time										
Relinquished by:		Date	Time	Received by:		Date	Time										
Relinquished by:		Date	Time	Received by:		Date	Time										
Relinquished by:		Date	Time	Received at Lab by:		Date	Time										
Your signature authorizes ELS to analyze the sample(s) as indicated. Relinquished by:																	
Sampler Signature:																	



Environmental
LABORATORY SERVICES
 7200 Caswell Street, Hancock Air Park North Syracuse, NY 13212
 (315) 458-8033 FAX (315) 458-0249 (800) 843-8265

CHAIN OF CUSTODY RECORD
 and Authorization for Analysis

Name: Scott Graham Title: _____
 Company: E.A. Engineering Dept: _____
 Address: 737 Fly Rd. Job/PO No.: _____
 City, State, Zip: East Syracuse, NY 13057

The following services may result in additional charges:
 Telephone Results Telephone No. 431-4280 Advance Agreement Required
 Fax Results Fax No. _____ 1 Week 48 Hour Express Service

To be completed by Sampler. Please remember to record this information on the container label.
 ELS Number *Date *Time *Comp. *Grab *Matrix *Sampling Location *Number of Containers

ELS Number	*Date	*Time	*Comp.	*Grab	*Matrix	*Sampling Location	*Number of Containers
214785	205071	0840		X		WRRL-MW05-CAD1	1
214786	↓	↓		↓			1
214787	↓	↓		↓			1
214788	↓	↓		↓			1

Containers Dispensed by:	Date	Time	Container(s) Received by:	Date	Time
Relinquished by: <u>[Signature]</u>	205071	Time 1305	Received by:		
Relinquished by:	Date	Time	Received by:	Date	Time
Relinquished by:	Date	Time	Received by:	Date	Time
Relinquished by:	Date	Time	Received at Lab by:	Date	Time
Your signature authorizes ELS to analyze the sample(s) as indicated.					
Sampler Signature: _____					

White - LABORATORY Please return completed form and all sample containers to Environmental Laboratory Services.
 Canary - ACCOMPANIES RESULTS
 Pink - CLIENT
 2217.ELS.,202.93.10



Environmental
LABORATORY SERVICES
 7280 Caswell Street, Hancock Air Park North Syracuse, NY 13212
 (315) 458-8033 FAX (315) 458-0249 (800) 843-8265

CHAIN OF CUSTODY RECORD
 and Authorization for Analysis

Name: <u>Scott Graham</u>		Title:																
Company: <u>E.A. Engineering</u>		Dept.:																
Address: <u>707 Fly Rd.</u>		Job/PO No.:																
City, State, Zip: <u>East Syracuse, NY 13057</u>																		
The following services may result in additional charges: <input type="checkbox"/> Telephone Results Telephone No. <u>431-4280</u> Advance Agreement Required <input type="checkbox"/> Fax Results Fax No. <input type="checkbox"/> 1 Week <input type="checkbox"/> 48 Hour Express Service																		
To be completed by Sampler. Please remember to record this information on the container label.																		
ELS Number	*Date	*Time	*Comp.	*Grab	*Matrix	*Sampling Location	Number of Containers	Plastic/No Preservatives	Plastic/H ₂ SO ₄	Plastic/NaOH+Ascorbic Acid	Plastic/NaOH+Zinc Acetate	Glass/No Preservative	Glass/Sodium Thiosulfate	Amber Glass/No Pres.	Amber Glass/H ₂ SO ₄	Other: (specify)	Analyses Required, Remarks, and/or Special Instructions	
<u>214789</u>	<u>2/25/01</u>	<u>08:40</u>		<u>X</u>		<u>WRL - MW88-001</u>	<u>1</u>	<u>Plastic/No Pres</u>										<u>Hexavalent Chromium</u>

Containers Dispensed by: _____ Date: _____ Time: _____ Received by: _____ Date: _____ Time: _____
 Relinquished by: [Signature] Date: 2/25/01 Time: 12:05
 Relinquished by: _____ Date: _____ Time: _____ Received by: _____ Date: _____ Time: _____
 Relinquished by: _____ Date: _____ Time: _____ Received by: _____ Date: _____ Time: _____
 Relinquished by: _____ Date: _____ Time: _____ Received at Lab by: _____ Date: 2/20/01 Time: 1:05

Your signature authorizes ELS to analyze the sample(s) as indicated.

Sampler Signature: _____

White - LABORATORY Please return completed form and all sample containers to Environmental Laboratory Services
 Canary - ACCOMPANIES RESULTS
 Pink - CLIENT
 2217.EI.S.202.9310



Environmental
LABORATORY SERVICES
 7280 Caswell Street, Hancock Air Park North Syracuse, NY 13212
 (815) 458-8033 FAX (315) 458-0249 (800) 843-8265

CHAIN OF CUSTODY RECORD
 and Authorization for Analysis

Name Scott Graham		Title																
Company E.A. Engineering		Dept.																
Address 797 Fly Rd.		Job/PO No.																
City, State, Zip East Syracuse, NY 13057																		
The following services may result in additional charges: <input type="checkbox"/> Telephone Results Telephone No. 431 4280 Express Service <input type="checkbox"/> Fax Results Fax No. <input type="checkbox"/> 1 Week <input type="checkbox"/> 48 Hour Advance Agreement Required																		
To be completed by Sampler. Please remember to record this information on the container label.																		
ELS Number	*Date	*Time	*Comp.	*Grab	*Matrix	*Sampling Location	Number of Containers	Plastic/No Preservatives	Plastic/HNO ₃	Plastic/H ₂ SO ₄	Plastic/NaOH+Ascorbic Acid	Plastic/NaOH+Zinc Acetate	Glass/No Preservative	Glass/Sodium Thiosulfate	Amber Glass/No Pres.	Amber Glass/H ₂ SO ₄	Other: (specify)	Analyses Required, Remarks, and/or Special Instructions
214790	19SEP01	X		X		WAL-RVP-0901	1	Amber Glass/H ₂ SO ₄									Phenolics	
214791	↓			↓			1	Plastic/H ₂ SO ₄									HNS H	
214792	↓			↓			1	Plastic/HNO ₃									Order of Priority: HNS, Sulfate	
214793	↓			↓			1	Plastic/No Pres									Sulfate	
Containers Dispensed by: _____ Date _____ Time _____ Container(s) Received by: _____ Date _____ Time _____																		
Relinquished by: _____ Date _____ Time _____ Received by: _____ Date _____ Time _____																		
Relinquished by: _____ Date _____ Time _____ Received by: _____ Date _____ Time _____																		
Relinquished by: _____ Date _____ Time _____ Received by: _____ Date _____ Time _____																		
Relinquished by: _____ Date _____ Time _____ Received at Lab by: _____ Date _____ Time _____																		
Your signature authorizes ELS to analyze the sample(s) as indicated. Relinquished by: <i>[Signature]</i> Date 9/19 Time 1750 Received at Lab by: <i>[Signature]</i> Date 9/19 Time 1750																		
Sampler Signature: _____																		

Name	Scott Graham	Title	
Company	E.A. Engineering	Dept.	
Address	737 Fly Rd.		
City, State, Zip	East Syracuse, NY 13057		

The following services may result in additional charges:

Telephone Results Telephone No. 431 4280 Express Service

Fax Results Fax No. _____ Advance Agreement Required

1 Week 48 Hour

To be completed by Sampler. Please remember to record this information on the container label.

ELS Number	*Date	*Time	*Comp.	*Grab	*Matrix	*Sampling Location	Number of Containers
24795	1998/01	1345		X		WRL - MW6B-D201	1
24796							1
24797							1
24798							1

Container Type/Preservative	Analyses Required, Remarks, and/or Special Instructions									
	Plastic/No Preservatives	Plastic/HNO ₃	Plastic/H ₂ SO ₄	Plastic/NaOH+Ascorbic Acid	Plastic/NaOH+Zinc Acetate	Glass/No Preservative	Glass/Sodium Thiosulfate	Amber Glass/No Pres.	Amber Glass/H ₂ SO ₄	Other: (specify)
Plastic/No Preservatives	Amber Glass/H ₂ SO ₄									Phenolics
Plastic/No Preservatives	Plastic/HNO ₃	Plastic/H ₂ SO ₄	Plastic/NaOH+Ascorbic Acid	Plastic/NaOH+Zinc Acetate	Glass/No Preservative	Glass/Sodium Thiosulfate	Amber Glass/No Pres.	Amber Glass/H ₂ SO ₄		NH ₃ -N
Plastic/No Preservatives	Plastic/HNO ₃	Plastic/H ₂ SO ₄	Plastic/NaOH+Ascorbic Acid	Plastic/NaOH+Zinc Acetate	Glass/No Preservative	Glass/Sodium Thiosulfate	Amber Glass/No Pres.	Amber Glass/H ₂ SO ₄		OrthoPhthalic Acid
Plastic/No Preservatives	Plastic/HNO ₃	Plastic/H ₂ SO ₄	Plastic/NaOH+Ascorbic Acid	Plastic/NaOH+Zinc Acetate	Glass/No Preservative	Glass/Sodium Thiosulfate	Amber Glass/No Pres.	Amber Glass/H ₂ SO ₄		Sulfate

Containers Dispensed by:	Date	Time	Container(s) Received by:	Date	Time
Relinquished by:	Date	Time	Received by:	Date	Time
Relinquished by:	Date	Time	Received by:	Date	Time
Relinquished by:	Date	Time	Received by:	Date	Time
Relinquished by:	Date	Time	Received at Lab by:	Date	Time

White - LABORATORY
Please return completed form and all sample containers to Environmental Laboratory Services.

Canary - ACCOMPANIES RESULTS
Pink - CLIENT



Environmental
LABORATORY SERVICES
7280 Caswell Street, Hancock Air Park North Syracuse, NY 13212
(315) 458-8033 FAX (315) 458-0249 (800) 843-8265

CHAIN OF CUSTODY RECORD
and Authorization for Analysis

Name: Scott Graham Title: _____
 Company: E.A. Engineering Dept: _____
 Address: 737 Fly Rd. Job/PO No.: _____
 City, State, Zip: East Syracuse, NY 13057

The following services may result in additional charges:
 Telephone Results Telephone No. 431-4280 Express Service
 Fax Results Fax No. _____ Advance Agreement Required
 1 Week 48 Hour

To be completed by Sampler. Please remember to record this information on the container label.

ELS Number	*Date	*Time	*Comp.	*Grab	*Matrix	*Sampling Location	Number of Containers	Container Type/Preservative								Analyses Required, Remarks, and/or Special Instructions
								Plastic/HNO ₃	Plastic/H ₂ SO ₄	Plastic/NaOH+Ascorbic Acid	Plastic/NaOH+Zinc Acetate	Glass/No Preservative	Glass/Sodium Thiosulfate	Glass/No Pres./Amber Glass/H ₂ SO ₄	Amber Glass/H ₂ SO ₄	
214300	198801	1255		X		WRL - MW2B-0901	1	Amber Glass/H ₂ SO ₄								Phenolics
214301	1	1		1			1	Plastic/H ₂ SO ₄								HHS-R
214302	1	1		1			1	Plastic/HNO ₃								Carbonic Brightness Indicator
214303	1	1		1			1	Plastic/No Pres.								Sulfate

Containers Dispensed by: _____ Date: _____ Time: _____ Container(s) Received by: _____ Date: _____ Time: _____
 Relinquished by: _____ Date: _____ Time: _____ Received by: _____ Date: _____ Time: _____
 Relinquished by: _____ Date: _____ Time: _____ Received by: _____ Date: _____ Time: _____
 Relinquished by: _____ Date: _____ Time: _____ Received by: _____ Date: _____ Time: _____
 Your signature authorizes ELS to analyze the sample(s) as indicated.
 Relinquished by: [Signature] Date: 9/19 Time: 1750 Received at Lab by: [Signature] Date: 9/19/98 Time: 1750
 Sampler Signature: _____

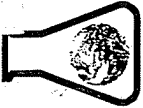

Environmental
LABORATORY SERVICES
7280 Caswell Street, Hancock Air Park North Syracuse, NY 13212
(315) 458-8033 FAX (315) 458-0249 (800) 843-8265

CHAIN OF CUSTODY RECORD
and Authorization for Analysis

Name: <u>Scott Graham</u>		Title: _____																	
Company: <u>E.A. Engineering</u>		Dept: _____																	
Address: <u>737 Fly Rd.</u>		Job/PO No: _____																	
City, State, Zip: <u>East Syracuse, NY 13057</u>																			
The following services may result in additional charges: <input type="checkbox"/> Telephone Results Telephone No. <u>431 4280</u> Advance Agreement Required <input type="checkbox"/> Fax Results Fax No. _____ <input type="checkbox"/> 1 Week <input type="checkbox"/> 48 Hour Express Service																			
To be completed by Sampler. Please remember to record this information on the container label.																			
ELS Number	*Date	*Time	*Comp.	*Grab	*Matrix	*Sampling Location	Number of Containers	Plastic/No Preservatives	Plastic/HNO ₃	Plastic/H ₂ SO ₄	Plastic/NaOH+Ascorbic Acid	Plastic/NaOH+Zinc Acetate	Glass/No Preservative	Glass/Sodium Thiosulfate	Glass/NaOH+H ₂ SO ₄	Amber Glass/No Pres.	Amber Glass/H ₂ SO ₄	Other: (specify)	Analyses Required, Remarks, and/or Special Instructions
214510	200801	0915		X		WAL-AD-0901	1	Amber Glass/H ₂ SO ₄											Phenolics
214511	↓	↓		↓			1	Plastic/H ₂ SO ₄											NH ₃ -N
214512	↓	↓		↓			1	Plastic/HNO ₃											Cd/Cr/Fe/Pb/Hg/As/Se/Al
214513	↓	↓		↓			1	Plastic/No Pres											Sulfate
Containers Dispensed by: _____ Date _____ Time _____ Container(s) Received by: _____																			
Relinquished by: <u>[Signature]</u> Date <u>200801</u> Time <u>1305</u> Received by: _____																			
Relinquished by: _____ Date _____ Time _____ Received by: _____																			
Relinquished by: _____ Date _____ Time _____ Received by: _____																			
Relinquished by: _____ Date _____ Time _____ Received at Lab by: _____																			
White - LABORATORY										Pink - CLIENT									
Please return completed form and all sample containers to Environmental Laboratory Services, 2217 ELS, 202.03.10																			



Environmental
LABORATORY SERVICES
 7280 Caswell Street, Hancock Air Park North Syracuse, NY 13212
 (315) 458-8033 FAX (315) 458-0249 (800) 849-8265

CHAIN OF CUSTODY RECORD and Authorization for Analysis

Name		Title		Company		Address		City, State, Zip		Job/PO No.							
Scott Graham		E.A. Engineering		737 Fly Rd.		East Syracuse, NY 13057											
The following services may result in additional charges: <input type="checkbox"/> Telephone Results Telephone No. 431-4280 Advance Agreement Required <input type="checkbox"/> Fax Results Fax No. <input type="checkbox"/> 1 Week <input type="checkbox"/> 48 Hour Express Service																	
To be completed by Sampler. Please remember to record this information on the container label. Number of Containers: 1																	
ELS Number	*Date	*Time	*Comp.	*Grab	*Matrix	*Sampling Location	Plastic/HNO ₃	Plastic/H ₂ SO ₄	Plastic/NaOH+Ascorbic Acid	Plastic/NaOH+Zinc Acetate	Glass/No Preservative	Glass/Sodium Thiosulfate	Glass/No Pres.	Amber Glass/H ₂ SO ₄	Amber Glass/No Pres.	Other: (specify)	Analyses Required, Remarks, and/or Special Instructions
214314	2/28/01	0915		X		WRL-AB-0901	Plastic/No Pres										
Containers Dispensed by: [Signature] Date: 2/28/01 Time: 13:05 Relinquished by: [Signature] Date: 2/28/01 Time: 13:05 Relinquished by: [Signature] Date: [] Time: [] Relinquished by: [Signature] Date: [] Time: [] Relinquished by: [Signature] Date: [] Time: []																	
Containers Received by: [Signature] Date: [] Time: [] Relinquished by: [Signature] Date: [] Time: [] Relinquished by: [Signature] Date: [] Time: [] Relinquished by: [Signature] Date: [] Time: []																	

White - LABORATORY se rel mple n anc mple iners Ironmetal Laboratory Services Pink - CLIENT
 2217 E. S. 202.93.00



**Environmental
LABORATORY SERVICES**
7280 Caswell Street, Hancock Air Park North Syracuse, NY 13212
(315) 458-8033 FAX (315) 458-0249 (800) 843-8265

**GAIN OF CUSTODY, RECORD
and Authorization for Analysis**

Name Scott Graham		Title		Company C.A. Engineering		Dept.		Job/PO No.		
City, State, Zip East Syracuse, NY 13057		Address 737 Fly Rd.		Telephone No. 431-4280		Advance Agreement Required <input type="checkbox"/> 1 Week <input type="checkbox"/> 48 Hour		Express Service		
City, State, Zip		Address		Telephone No.		Advance Agreement Required		Express Service		
<input type="checkbox"/> Telephone Results <input type="checkbox"/> Fax Results		Telephone No. 431-4280 Fax No. _____		<input type="checkbox"/> 1 Week <input type="checkbox"/> 48 Hour		Advance Agreement Required		Express Service		
To be completed by Sampler. Please remember to record this information on the container label.										
ELS Number	*Date	*Time	*Comp.	*Grab	*Matrix	*Sampling Location	Number of Containers	Container Type/Preservative		
214815	2/25/01	0930	X			MRL - SWB-0901	1	Plastic/HNO ₃	Plastic/NaOH+Ascorbic Acid	Analyses Required, Remarks, and/or Special Instructions
214816	↓	↓					1	Plastic/H ₂ SO ₄	Plastic/NaOH+Zinc Acetate	
214817	↓	↓					1	Plastic/H ₂ SO ₄	Glass/No Preservative	
214818	↓	↓					1	Plastic/NaOH+Ascorbic Acid	Glass/Sodium Thiosulfate	
								Plastic/HNO ₃	Amber Glass/H ₂ SO ₄	
								Plastic/H ₂ SO ₄	Amber Glass/H ₂ SO ₄	
								Plastic/NaOH+Ascorbic Acid	Amber Glass/H ₂ SO ₄	
								Plastic/NaOH+Zinc Acetate	Amber Glass/H ₂ SO ₄	
								Glass/No Preservative	Amber Glass/H ₂ SO ₄	
								Glass/Sodium Thiosulfate	Amber Glass/H ₂ SO ₄	
								Amber Glass/H ₂ SO ₄	Amber Glass/H ₂ SO ₄	
								Plastic/NaOH+Ascorbic Acid	Amber Glass/H ₂ SO ₄	
								Plastic/HNO ₃	Amber Glass/H ₂ SO ₄	
								Plastic/H ₂ SO ₄	Amber Glass/H ₂ SO ₄	
Containers Dispensed by:		Date	Time	Container(s) Received by:		Date	Time			
Relinquished by:		Date	Time	Received by:		Date	Time			
Relinquished by:		Date	Time	Received by:		Date	Time			
Relinquished by:		Date	Time	Received by:		Date	Time			
Relinquished by:		Date	Time	Received at Lab by:		Date	Time			
Relinquished by:		Date	Time	Received by:		Date	Time			

White - LABORATORY
Please return completed form and all sample containers to Environmental Laboratory Services.
2217.ELS..202.9310

Canary - ACCOMPANIES RESULTS

Pink - CLIENT



CHAIN OF CUSTODY RECORD and Authorization for Analysis

Environmental LABORATORY SERVICES
 7290 Caswell Street, Hancock Air Park North Syracuse, NY 13212
 (315) 458-8033 FAX (315) 458-0249 (800) 843-8265

Name	Scott Graham
Company	E.A. Engineering
Address	737 Fly Rd.
City, State, Zip	East Syracuse, NY 13057

The following services may result in additional charges:
 Telephone Results Telephone No. 431-4260
 Fax Results Fax No. _____
 1 Week Express Service
 48 Hour Advance Agreement Required

To be completed by Sampler. Please remember to record this information on the container label.
 Express Service
 Telephone No. 431-4260
 Fax No. _____
 1 Week
 48 Hour Advance Agreement Required

ELN Number	*Date	*Time	*Comp.	*Grab	*Matrix	*Sampling Location	Number of Containers	Container Type/Preservative								Analyses Required, Remarks, and/or Special Instructions			
								Plastic/No Preservatives	Plastic/HNO ₃	Plastic/H ₂ SO ₄	Plastic/NaOH+Ascorbic Acid	Plastic/NaOH+Zinc Acetate	Glass/No Preservative	Glass/Sodium Thiosulfate	Amber Glass/No Pres.		Amber Glass/H ₂ SO ₄	Other: (specify)	
214819	200501	0930		X		WAL JWS-0901	1	Plastic/No Preservatives	Plastic/HNO ₃	Plastic/H ₂ SO ₄	Plastic/NaOH+Ascorbic Acid	Plastic/NaOH+Zinc Acetate	Glass/No Preservative	Glass/Sodium Thiosulfate	Amber Glass/No Pres.	Amber Glass/H ₂ SO ₄	Other: (specify)	None	

Containers Dispersed by: _____ Date _____ Time _____
 Relinquished by: [Signature] Date 2/1/05 Time 1305
 Relinquished by: _____ Date _____ Time _____
 Relinquished by: _____ Date _____ Time _____
 Relinquished by: _____ Date _____ Time _____
 Sampler Signature: _____ Date 2/20/05 Time 1305



Environmental
LABORATORY SERVICES
7280 Caswell Street, Hancock Air Park North Syracuse, NY 13212
(315) 458-8033 FAX (315) 458-0249 (800) 843-8265

GAIN OF CUSIODI RECORD
and Authorization for Analysis

Name: Scott Graham Title: _____
 Company: E.A. Engineering Dept.: _____
 Address: 737 Fly Rd. Job/PO No.: _____
 City, State, Zip: East Syracuse, NY 13057

The following services may result in additional charges:
 Telephone Results Telephone No. 431-4280 Advance Agreement Required
 Fax Results Fax No. _____ 1 Week 48 Hour
 Express Service

To be completed by Sampler. Please remember to record this information on the container label.

ELS Number	*Date	*Time	*Comp.	*Grab	*Matrix	*Sampling Location	Number of Containers	Container Type/Preservative								Analyses Required, Remarks, and/or Special Instructions			
								Plastic/NaOH+Ascorbic Acid	Plastic/NaOH+Zinc Acetate	Plastic/NaOH+Ascorbic Acid	Glass/No Preservative	Glass/Sodium Thiosulfate	Amber Glass/No Pres.	Amber Glass/H ₂ SO ₄	Other: (specify)				
214825	2/25/01	0855		X		WRL - L1 - 0901	1	Plastic/HNO ₃	Amber Glass/H ₂ SO ₄										Phenolics
214826	↓	↓		↓		↓	1	Plastic/HNO ₃	Plastic/H ₂ SO ₄										NIP H
214827	↓	↓		↓		↓	1	Plastic/NaOH											Cd, Cr, Pb, Hg, Ni, Cu, Zn, Ni
214828	↓	↓		↓		↓	1	Plastic/NaOH	Plastic/NaOH Pres										Sulfate

Containers Dispensed by: _____ Date _____ Time _____
 Relinquished by: Scott Graham Date 2/25/01 Time 10:11
 Relinquished by: _____ Date _____ Time _____
 Relinquished by: _____ Date _____ Time _____

Your Signature authorizes ELS to analyze the sample(s) as indicated.
 Relinquished by: _____
 Sampler Signature: _____
 Received at Lab by: _____ Date 2/25/01 Time 1:05

Name: Scott Graham Title: _____ Company: E.A. Engineering Dept.: _____ Address: 707 Fly Rd. Job/PO No.: _____ City, State, Zip: East Syracuse, NY 13057	Express Service Telephone Results: Telephone No. 431-4280 Advance Agreement Required <input type="checkbox"/> 1 Week <input type="checkbox"/> 48 Hour Fax Results: Fax No. _____	Number of Containers 1	*Date 20080120 *Time 0855 *Comp. *Grab X *Matrix *Sampling Location WRL - LI - 0901	To be completed by Sampler. Please remember to record this information on the container label. Plastic/HNO ₃ Plastic/H ₂ SO ₄ Plastic/NaOH+Ascorbic Acid Plastic/NaOH+Zinc Acetate Glass/No Preservative Glass/Sodium Thiosulfate Amber Glass/No Pres. Amber Glass/H ₂ SO ₄ Other: (specify) Hexavalent Chromium	Analyses Required, Remarks, and/or Special Instructions
Containers Dispensed by: [Signature] Date: 20080120 Time: 0855				Container(s) Received by:	
Relinquished by: [Signature] Date: 20080120 Time: 0855				Received by:	
Relinquished by:				Received by:	
Relinquished by:				Received by:	
Relinquished by:				Received at Lab by:	

Sampler Signature: _____

White - LABORATORY _____ e ret. _____
 Pink - CLIENT _____

Canary - ACCOMPANIES RESULTS
 Environmental Laboratories
 2217 F.L.S., 202.93.10

Attachment D

Laboratory Form I Documents

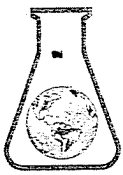

Environmental
LABORATORY SERVICES

7280 Caswell Street, Hancock Air Park, North Syracuse, NY 13212
(315) 458-8033, FAX (315) 458-0249, (800) 842-4667

- Certified in:
- Connecticut
 - Delaware
 - Maryland
 - Massachusetts
 - New Hampshire
 - New Jersey
 - New York
 - Pennsylvania
 - Rhode Island

E.A. ENGINEERING & SCIENCE TECHNOLOGY
737 FLY RD.

PROJECT #: 997629
RECEIVED: 09/20/01

EAST SYRACUSE NY 13057
ATTN: MR. SCOTT GRAHAM

P.O. #
CLIENT JOB NUMBER:

RECEIVED NOV 1 8 2001

TEST PERFORMED	RESULTS	UNITS	DATE PERFORMED	METHOD NUMBER	PERFORMED BY
SAMPLE #: 214770	CLIENT SAMPLE ID: WRL-MW1B-0901			DATE SAMPLED: 09/19/01	
PHENOLICS	<2	UG/L	09/20/01	EPA 420.2	DMP
SAMPLE #: 214771	CLIENT SAMPLE ID: WRL-MW1B-0901			DATE SAMPLED: 09/19/01	
NITROGEN, AMMONIA	<1	MG/L	09/24/01	EPA 350.2	DMP
SAMPLE #: 214772	CLIENT SAMPLE ID: WRL-MW1B-0901			DATE SAMPLED: 09/19/01	
CADMIUM	<0.005	MG/L	09/28/01	EPA 6020	NS
CHROMIUM	0.011	MG/L	09/28/01	EPA 6020	NS
IRON	3.4	MG/L	09/25/01	EPA 6010	NS
LEAD	0.015	MG/L	09/28/01	EPA 6020	NS
MAGNESIUM	61.3	MG/L	09/25/01	EPA 6010	NS
MANGANESE	0.672	MG/L	09/28/01	EPA 6020	NS
METALS DIGESTION	YES		09/21/01	EPA 3005	BRD
SELENIUM	<0.005	MG/L	09/28/01	EPA 6020	NS
SILICA	21.0	MG/L	11/01/01	EPA 200.7	25-067 (NY)
SODIUM	137	MG/L	09/25/01	EPA 6010	NS
THALLIUM	<0.005	MG/L	09/28/01	EPA 6020	NS
ZINC	0.270	MG/L	09/28/01	EPA 6020	NS

E.A. ENGINEERING & SCIENCE TECHNOLOGY
737 FLY RD.

PROJECT #: 997629
RECEIVED: 09/20/01

EAST SYRACUSE NY 13057
ATTN: MR. SCOTT GRAHAM

P.O. #
CLIENT JOB NUMBER:

TEST PERFORMED	RESULTS	UNITS	DATE PERFORMED	METHOD NUMBER	PERFORMED BY
SAMPLE #: 214773	CLIENT SAMPLE ID: WRL-MW1B-0901			DATE SAMPLED: 09/19/01	
SULFATE	209	MG/L	10/03/01	EPA 375.2	DMP
SAMPLE #: 214774	CLIENT SAMPLE ID: WRL-MW1B-0901			DATE SAMPLED: 09/19/01	
CHROMIUM, HEXAVALENT	<10	UG/L @ 10:30	09/20/01	SM18 3500-CR D	DMP
SAMPLE #: 214775	CLIENT SAMPLE ID: WRL-MW3B-0901			DATE SAMPLED: 09/20/01	
PHENOLICS	<2	UG/L	09/20/01	EPA 420.2	DMP
SAMPLE #: 214776	CLIENT SAMPLE ID: WRL-MW3B-0901			DATE SAMPLED: 09/20/01	
NITROGEN, AMMONIA	<1	MG/L	09/24/01	EPA 350.2	DMP
SAMPLE #: 214777	CLIENT SAMPLE ID: WRL-MW3B-0901			DATE SAMPLED: 09/20/01	
CADMIUM	<0.005	MG/L	09/28/01	EPA 6020	NS
CHROMIUM	<0.005	MG/L	09/28/01	EPA 6020	NS
IRON	0.260	MG/L	09/25/01	EPA 6010	NS
LEAD	<0.005	MG/L	09/28/01	EPA 6020	NS
MAGNESIUM	10.9	MG/L	09/25/01	EPA 6010	NS
MANGANESE	0.008	MG/L	09/28/01	EPA 6020	NS
METALS DIGESTION	YES		09/21/01	EPA 3005	BRD
SELENIUM	<0.005	MG/L	09/28/01	EPA 6020	NS
SILICA	13.4	MG/L	11/01/01	EPA 200.7	25-067 (NY)



E.A. ENGINEERING & SCIENCE TECHNOLOGY
737 FLY RD.

PROJECT #: 997629
RECEIVED: 09/20/01

EAST SYRACUSE NY 13057
ATTN: MR. SCOTT GRAHAM

P.O. #
CLIENT JOB NUMBER:

TEST PERFORMED	RESULTS	UNITS	DATE PERFORMED	METHOD NUMBER	PERFORMED BY
SAMPLE #: 214777	CLIENT SAMPLE ID: WRL-MW3B-0901			DATE SAMPLED: 09/20/01	
SODIUM	44.9	MG/L	09/25/01	EPA 6010	NS
THALLIUM	<0.005	MG/L	09/28/01	EPA 6020	NS
ZINC	<0.005	MG/L	09/28/01	EPA 6020	NS
SAMPLE #: 214778	CLIENT SAMPLE ID: WRL-MW3B-0901			DATE SAMPLED: 09/20/01	
SULFATE	23.1	MG/L	10/03/01	EPA 375.2	DMP
SAMPLE #: 214779	CLIENT SAMPLE ID: WRL-MW3B-0901			DATE SAMPLED: 09/20/01	
CHROMIUM, HEXAVALENT	<10	UG/L @ 16:15	09/20/01	SM18 3500-CR D	DMP
SAMPLE #: 214780	CLIENT SAMPLE ID: WRL-MW7B-0901			DATE SAMPLED: 09/20/01	
PHENOLICS	<2	UG/L	09/20/01	EPA 420.2	DMP
SAMPLE #: 214781	CLIENT SAMPLE ID: WRL-MW7B-0901			DATE SAMPLED: 09/20/01	
NITROGEN, AMMONIA	<1	MG/L	09/24/01	EPA 350.2	DMP
SAMPLE #: 214782	CLIENT SAMPLE ID: WRL-MW7B-0901			DATE SAMPLED: 09/20/01	
CADMIUM	<0.005	MG/L	09/28/01	EPA 6020	NS
CHROMIUM	0.231	MG/L	09/28/01	EPA 6020	NS
IRON	6.0	MG/L	09/25/01	EPA 6010	NS
LEAD	<0.005	MG/L	09/28/01	EPA 6020	NS



E.A. ENGINEERING & SCIENCE TECHNOLOGY
737 FLY RD.

PROJECT #: 997629
RECEIVED: 09/20/01

EAST SYRACUSE NY 13057
ATTN: MR. SCOTT GRAHAM

P.O. #
CLIENT JOB NUMBER:

TEST PERFORMED	RESULTS	UNITS	DATE PERFORMED	METHOD NUMBER	PERFORMED BY
SAMPLE #: 214782	CLIENT SAMPLE ID: WRL-MW7B-0901		DATE SAMPLED: 09/20/01		
MAGNESIUM	10.4	MG/L	09/25/01	EPA 6010	NS
MANGANESE	0.151	MG/L	09/28/01	EPA 6020	NS
METALS DIGESTION	YES		09/21/01	EPA 3005	BRD
SELENIUM	<0.005	MG/L	09/28/01	EPA 6020	NS
SILICA	19.1	MG/L	11/01/01	EPA 200.7	25-067 (NY)
SODIUM	56.8	MG/L	09/25/01	EPA 6010	NS
THALLIUM	<0.005	MG/L	09/28/01	EPA 6020	NS
ZINC	0.011	MG/L	09/28/01	EPA 6020	NS
SAMPLE #: 214783	CLIENT SAMPLE ID: WRL-MW7B-0901		DATE SAMPLED: 09/20/01		
SULFATE	37.0	MG/L	10/03/01	EPA 375.2	DMP
SAMPLE #: 214784	CLIENT SAMPLE ID: WRL-MW7B-0901		DATE SAMPLED: 09/20/01		
CHROMIUM, HEXAVALENT	180	UG/L @ 16:15	09/20/01	SM18 3500-CR D	DMP
SAMPLE #: 214785	CLIENT SAMPLE ID: WRL-MW8B-0901		DATE SAMPLED: 09/20/01		
PHENOLICS	<2	UG/L	10/04/01	EPA 420.2	DMP
SAMPLE #: 214786	CLIENT SAMPLE ID: WRL-MW8B-0901		DATE SAMPLED: 09/20/01		
NITROGEN, AMMONIA	<1	MG/L	09/24/01	EPA 350.2	DMP



E.A. ENGINEERING & SCIENCE TECHNOLOGY
737 FLY RD.

PROJECT #: 997629
RECEIVED: 09/20/01

EAST SYRACUSE NY 13057
ATTN: MR. SCOTT GRAHAM

P.O. #
CLIENT JOB NUMBER:

TEST PERFORMED	RESULTS	UNITS	DATE PERFORMED	METHOD NUMBER	PERFORMED BY
SAMPLE #: 214787	CLIENT SAMPLE ID: WRL-MW8B-0901			DATE SAMPLED: 09/20/01	
CADMIUM	<0.005	MG/L	09/28/01	EPA 6020	NS
CHROMIUM	0.136	MG/L	09/28/01	EPA 6020	NS
IRON	1.3	MG/L	09/25/01	EPA 6010	NS
LEAD	<0.005	MG/L	09/28/01	EPA 6020	NS
MAGNESIUM	62.1	MG/L	09/25/01	EPA 6010	NS
MANGANESE	0.190	MG/L	09/28/01	EPA 6020	NS
METALS DIGESTION	YES		09/21/01	EPA 3005	BRD
SELENIUM	0.125	MG/L	09/28/01	EPA 6020	NS
SILICA	15.3	MG/L	11/01/01	EPA 200.7	25-067 (NY)
SODIUM	174	MG/L	09/25/01	EPA 6010	NS
THALLIUM	<0.005	MG/L	09/28/01	EPA 6020	NS
ZINC	0.021	MG/L	09/28/01	EPA 6020	NS
SAMPLE #: 214788	CLIENT SAMPLE ID: WRL-MW8B-0901			DATE SAMPLED: 09/20/01	
SULFATE	419	MG/L	10/03/01	EPA 375.2	DMP
SAMPLE #: 214789	CLIENT SAMPLE ID: WRL-MW8B-0901			DATE SAMPLED: 09/20/01	
CHROMIUM, HEXAVALENT	146	UG/L @ 16:15	09/20/01	SM18 3500-CR D	DMP



E.A. ENGINEERING & SCIENCE TECHNOLOGY
737 FLY RD.

PROJECT #: 997629
RECEIVED: 09/20/01

EAST SYRACUSE NY 13057
ATTN: MR. SCOTT GRAHAM

P.O. #
CLIENT JOB NUMBER:

TEST PERFORMED	RESULTS	UNITS	DATE PERFORMED	METHOD NUMBER	PERFORMED BY
SAMPLE #: 214790	CLIENT SAMPLE ID: WRL-DUP-0901			DATE SAMPLED: 09/19/01	
PHENOLICS	<2	UG/L	09/20/01	EPA 420.2	DMP
SAMPLE #: 214791	CLIENT SAMPLE ID: WRL-DUP-0901			DATE SAMPLED: 09/19/01	
NITROGEN, AMMONIA	<1	MG/L	09/24/01	EPA 350.2	DMP
SAMPLE #: 214792	CLIENT SAMPLE ID: WRL-DUP-0901			DATE SAMPLED: 09/19/01	
CADMIUM	<0.005	MG/L	09/28/01	EPA 6020	NS
CHROMIUM	<0.005	MG/L	09/28/01	EPA 6020	NS
IRON	0.103	MG/L	09/25/01	EPA 6010	NS
LEAD	<0.005	MG/L	09/28/01	EPA 6020	NS
MAGNESIUM	67.6	MG/L	09/25/01	EPA 6010	NS
MANGANESE	0.067	MG/L	09/28/01	EPA 6020	NS
METALS DIGESTION	YES		09/21/01	EPA 3005	BRD
SELENIUM	<0.005	MG/L	09/28/01	EPA 6020	NS
SILICA	12.3	MG/L	11/01/01	EPA 200.7	25-067 (NY)
SODIUM	65.2	MG/L	09/25/01	EPA 6010	NS
THALLIUM	<0.005	MG/L	09/28/01	EPA 6020	NS
ZINC	<0.005	MG/L	09/28/01	EPA 6020	NS



E.A. ENGINEERING & SCIENCE TECHNOLOGY
737 FLY RD.

PROJECT #: 997629
RECEIVED: 09/20/01

EAST SYRACUSE NY 13057
ATTN: MR. SCOTT GRAHAM

P.O. #
CLIENT JOB NUMBER:

TEST PERFORMED	RESULTS	UNITS	DATE PERFORMED	METHOD NUMBER	PERFORMED BY
SAMPLE #: 214793	CLIENT SAMPLE ID: WRL-DUP-0901			DATE SAMPLED: 09/19/01	
SULFATE	270	MG/L	10/03/01	EPA 375.2	DMP
SAMPLE #: 214794	CLIENT SAMPLE ID: WRL-DUP-0901			DATE SAMPLED: 09/19/01	
CHROMIUM, HEXAVALENT	<10	UG/L @ 10:30	09/20/01	SM18 3500-CR D	DMP
SAMPLE #: 214795	CLIENT SAMPLE ID: WRL-MW6B-0901			DATE SAMPLED: 09/19/01	
PHENOLICS	<2	UG/L	09/20/01	EPA 420.2	DMP
SAMPLE #: 214796	CLIENT SAMPLE ID: WRL-MW6B-0901			DATE SAMPLED: 09/19/01	
NITROGEN, AMMONIA	<1	MG/L	09/24/01	EPA 350.2	DMP
SAMPLE #: 214797	CLIENT SAMPLE ID: WRL-MW6B-0901			DATE SAMPLED: 09/19/01	
CADMIUM	<0.005	MG/L	09/28/01	EPA 6020	NS
CHROMIUM	0.007	MG/L	09/28/01	EPA 6020	NS
IRON	0.186	MG/L	09/25/01	EPA 6010	NS
LEAD	<0.005	MG/L	09/28/01	EPA 6020	NS
MAGNESIUM	69.2	MG/L	09/25/01	EPA 6010	NS
MANGANESE	0.079	MG/L	09/28/01	EPA 6020	NS
METALS DIGESTION	YES		09/21/01	EPA 3005	BRD
SELENIUM	<0.005	MG/L	09/28/01	EPA 6020	NS
SILICA	12.1	MG/L	11/01/01	EPA 200.7	25-067 (NY)

Page 7



Environmental
LABORATORY SERVICES

E.A. ENGINEERING & SCIENCE TECHNOLOGY
737 FLY RD.

PROJECT #: 997629
RECEIVED: 09/20/01

EAST SYRACUSE NY 13057
ATTN: MR. SCOTT GRAHAM

P.O. #
CLIENT JOB NUMBER:

TEST PERFORMED	RESULTS	UNITS	DATE PERFORMED	METHOD NUMBER	PERFORMED BY
SAMPLE #: 214797	CLIENT SAMPLE ID: WRL-MW6B-0901			DATE SAMPLED: 09/19/01	
SODIUM	66.8	MG/L	09/25/01	EPA 6010	NS
THALLIUM	<0.005	MG/L	09/28/01	EPA 6020	NS
ZINC	<0.005	MG/L	09/28/01	EPA 6020	NS
SAMPLE #: 214798	CLIENT SAMPLE ID: WRL-MW6B-0901			DATE SAMPLED: 09/19/01	
SULFATE	252	MG/L	10/03/01	EPA 375.2	DMP
SAMPLE #: 214799	CLIENT SAMPLE ID: WRL-MW6B-0901			DATE SAMPLED: 09/19/01	
CHROMIUM, HEXAVALENT	<10	UG/L @ 10:30	09/20/01	SM18 3500-CR D	DMP
SAMPLE #: 214800	CLIENT SAMPLE ID: WRL-MW2B-0901			DATE SAMPLED: 09/19/01	
PHENOLICS	13.6	UG/L	09/20/01	EPA 420.2	DMP
SAMPLE #: 214801	CLIENT SAMPLE ID: WRL-MW2B-0901			DATE SAMPLED: 09/19/01	
NITROGEN, AMMONIA	2.0	MG/L	09/24/01	EPA 350.2	DMP
SAMPLE #: 214802	CLIENT SAMPLE ID: WRL-MW2B-0901			DATE SAMPLED: 09/19/01	
CADMIUM	<0.005	MG/L	09/28/01	EPA 6020	NS
CHROMIUM	0.333	MG/L	09/28/01	EPA 6020	NS
IRON	0.980	MG/L	09/25/01	EPA 6010	NS
LEAD	0.039	MG/L	09/28/01	EPA 6020	NS



E.A. ENGINEERING & SCIENCE TECHNOLOGY
737 FLY RD.

PROJECT #: 997629
RECEIVED: 09/20/01

EAST SYRACUSE NY 13057
ATTN: MR. SCOTT GRAHAM

P.O. #
CLIENT JOB NUMBER:

TEST PERFORMED	RESULTS	UNITS	DATE PERFORMED	METHOD NUMBER	PERFORMED BY
SAMPLE #: 214802	CLIENT SAMPLE ID: WRL-MW2B-0901			DATE SAMPLED: 09/19/01	
MAGNESIUM	1.4	MG/L	09/25/01	EPA 6010	NS
MANGANESE	0.030	MG/L	09/28/01	EPA 6020	NS
METALS DIGESTION	YES		09/21/01	EPA 3005	BRD
SELENIUM	0.008	MG/L	09/28/01	EPA 6020	NS
SILICA	2.91	MG/L	11/01/01	EPA 200.7	25-067 (NY)
SODIUM	57.1	MG/L	09/25/01	EPA 6010	NS
THALLIUM	<0.005	MG/L	09/28/01	EPA 6020	NS
ZINC	0.023	MG/L	09/28/01	EPA 6020	NS
SAMPLE #: 214803	CLIENT SAMPLE ID: WRL-MW2B-0901			DATE SAMPLED: 09/19/01	
SULFATE	13.9	MG/L	10/03/01	EPA 375.2	DMP
SAMPLE #: 214804	CLIENT SAMPLE ID: WRL-MW2B-0901			DATE SAMPLED: 09/19/01	
CHROMIUM, HEXAVALENT	299	UG/L @ 10:30	09/20/01	SM18 3500-CR D	DMP
SAMPLE #: 214810	CLIENT SAMPLE ID: WRL-RB-0901			DATE SAMPLED: 09/20/01	
PHENOLICS	<2	UG/L	09/20/01	EPA 420.2	DMP
SAMPLE #: 214811	CLIENT SAMPLE ID: WRL-RB-0901			DATE SAMPLED: 09/20/01	
NITROGEN, AMMONIA	<1	MG/L	09/24/01	EPA 350.2	DMP



E.A. ENGINEERING & SCIENCE TECHNOLOGY
737 FLY RD.

PROJECT #: 997629
RECEIVED: 09/20/01

EAST SYRACUSE NY 13057
ATTN: MR. SCOTT GRAHAM

P.O. #
CLIENT JOB NUMBER:

TEST PERFORMED	RESULTS	UNITS	DATE PERFORMED	METHOD NUMBER	PERFORMED BY
SAMPLE #: 214812	CLIENT SAMPLE ID: WRL-RB-0901			DATE SAMPLED: 09/20/01	
CADMIUM	<0.005	MG/L	09/28/01	EPA 6020	NS
CHROMIUM	<0.005	MG/L	09/28/01	EPA 6020	NS
IRON	<0.025	MG/L	09/25/01	EPA 6010	NS
LEAD	<0.005	MG/L	09/28/01	EPA 6020	NS
MAGNESIUM	<1.0	MG/L	09/25/01	EPA 6010	NS
MANGANESE	<0.005	MG/L	09/28/01	EPA 6020	NS
METALS DIGESTION	YES		09/21/01	EPA 3005	BRD
SELENIUM	<0.005	MG/L	09/28/01	EPA 6020	NS
SILICA	<0.21	MG/L	11/01/01	EPA 200.7	25-067 (NY)
SODIUM	<1.0	MG/L	09/25/01	EPA 6010	NS
THALLIUM	<0.005	MG/L	09/28/01	EPA 6020	NS
ZINC	<0.005	MG/L	09/28/01	EPA 6020	NS
SAMPLE #: 214813	CLIENT SAMPLE ID: WRL-RB-0901			DATE SAMPLED: 09/20/01	
SULFATE	<2	MG/L	10/03/01	EPA 375.2	DMP
SAMPLE #: 214814	CLIENT SAMPLE ID: WRL-RB-0901			DATE SAMPLED: 09/20/01	
CHROMIUM, HEXAVALENT	<10	UG/L @ 16:15	09/20/01	SM18 3500-CR D	DMP



E.A. ENGINEERING & SCIENCE TECHNOLOGY
737 FLY RD.

PROJECT #: 997629
RECEIVED: 09/20/01

EAST SYRACUSE NY 13057
ATTN: MR. SCOTT GRAHAM

P.O. #
CLIENT JOB NUMBER:

TEST PERFORMED	RESULTS	UNITS	DATE PERFORMED	METHOD NUMBER	PERFORMED BY
SAMPLE #: 214815	CLIENT SAMPLE ID: WRL-SWB-0901			DATE SAMPLED: 09/20/01	
PHENOLICS	<2	UG/L	09/20/01	EPA 420.2	DMP
SAMPLE #: 214816	CLIENT SAMPLE ID: WRL-SWB-0901			DATE SAMPLED: 09/20/01	
NITROGEN, AMMONIA	<1	MG/L	09/24/01	EPA 350.2	DMP
SAMPLE #: 214817	CLIENT SAMPLE ID: WRL-SWB-0901			DATE SAMPLED: 09/20/01	
CADMIUM	<0.005	MG/L	09/28/01	EPA 6020	NS
CHROMIUM	<0.005	MG/L	09/28/01	EPA 6020	NS
IRON	<0.025	MG/L	09/25/01	EPA 6010	NS
LEAD	<0.005	MG/L	09/28/01	EPA 6020	NS
MAGNESIUM	<1.0	MG/L	09/25/01	EPA 6010	NS
MANGANESE	<0.005	MG/L	09/28/01	EPA 6020	NS
METALS DIGESTION	YES		09/21/01	EPA 3005	BRD
SELENIUM	<0.005	MG/L	09/28/01	EPA 6020	NS
SILICA	<0.21	MG/L	11/01/01	EPA 200.7	25-067 (NY)
SODIUM	<1.0	MG/L	09/25/01	EPA 6010	NS
THALLIUM	<0.005	MG/L	09/28/01	EPA 6020	NS
ZINC	<0.005	MG/L	09/28/01	EPA 6020	NS



E.A. ENGINEERING & SCIENCE TECHNOLOGY
737 FLY RD.

PROJECT #: 997629
RECEIVED: 09/20/01

EAST SYRACUSE NY 13057
ATTN: MR. SCOTT GRAHAM

P.O. #
CLIENT JOB NUMBER:

TEST PERFORMED	RESULTS	UNITS	DATE PERFORMED	METHOD NUMBER	PERFORMED BY
SAMPLE #: 214818	CLIENT SAMPLE ID: WRL-SWB-0901			DATE SAMPLED: 09/20/01	
SULFATE	<2	MG/L	10/03/01	EPA 375.2	DMP
SAMPLE #: 214819	CLIENT SAMPLE ID: WRL-SWB-0901			DATE SAMPLED: 09/20/01	
CHROMIUM, HEXAVALENT	<10	UG/L @ 16:15	09/20/01	SM18 3500-CR D	DMP
SAMPLE #: 214825	CLIENT SAMPLE ID: WRL-L1-0901			DATE SAMPLED: 09/20/01	
PHENOLICS	109	UG/L	09/20/01	EPA 420.2	DMP
SAMPLE #: 214826	CLIENT SAMPLE ID: WRL-L1-0901			DATE SAMPLED: 09/20/01	
NITROGEN, AMMONIA	4.9	MG/L	09/24/01	EPA 350.2	DMP
SAMPLE #: 214827	CLIENT SAMPLE ID: WRL-L1-0901			DATE SAMPLED: 09/20/01	
CADMIUM	<0.005	MG/L	09/28/01	EPA 6020	NS
CHROMIUM	0.413	MG/L	09/28/01	EPA 6020	NS
IRON	0.044	MG/L	09/25/01	EPA 6010	NS
LEAD	<0.005	MG/L	09/28/01	EPA 6020	NS
MAGNESIUM	<1.0	MG/L	09/25/01	EPA 6010	NS
MANGANESE	<0.005	MG/L	09/28/01	EPA 6020	NS
METALS DIGESTION	YES		09/21/01	EPA 3005	BRD
SELENIUM	0.022	MG/L	09/28/01	EPA 6020	NS
SILICA	0.77	MG/L	11/01/01	EPA 200.7	25-067 (NY)

Page 12



E.A. ENGINEERING & SCIENCE TECHNOLOGY
737 FLY RD.

PROJECT #: 997629
RECEIVED: 09/20/01

EAST SYRACUSE NY 13057
ATTN: MR. SCOTT GRAHAM

P.O. #
CLIENT JOB NUMBER:

TEST PERFORMED	RESULTS	UNITS	DATE PERFORMED	METHOD NUMBER	PERFORMED BY
SAMPLE #: 214827 CLIENT SAMPLE ID: WRL-L1-0901			DATE SAMPLED: 09/20/01		
SODIUM	79.2	MG/L	09/25/01	EPA 6010	NS
THALLIUM	<0.005	MG/L	09/28/01	EPA 6020	NS
ZINC	<0.005	MG/L	09/28/01	EPA 6020	NS
SAMPLE #: 214828 CLIENT SAMPLE ID: WRL-L1-0901			DATE SAMPLED: 09/20/01		
SULFATE	14.1*	MG/L	10/03/01	EPA 375.2	DMP
* Low spike recovery due to sample matrix interference.					
SAMPLE #: 214829 CLIENT SAMPLE ID: WRL-L1-0901			DATE SAMPLED: 09/20/01		
CHROMIUM, HEXAVALENT	448	UG/L @ 16:15	09/20/01	SM18 3500-CR D	DMP



Douglas W. Mendrala
Laboratory Director

10/22/01
Date

All tests performed under NYS ELAP Laboratory Certification # 11375 unless otherwise stated.



Attachment E

Engineering Inspection Checklist

**LANDFILL CAP INSPECTION CHECKLIST
WITMER ROAD LANDFILL, NIAGARA FALLS, NEW YORK**

EA Personnel: HAYWARD
Date: 9/18/01
Weather: SUNNY 75°F

1. Inspection of ground surface for exposure of geotextile cover (cap erosion):
NO CAP EROSION OR EXPOSED GEOTEXTILE NOTED.
2. Inspection of ground surface for differential settlement resulting in soil cracking or ponded water:
NONE NOTED.
3. Identification of stressed vegetation:
NONE NOTED. GRASS HAS BEEN MOWED.
4. Identification of seeps, rooted vegetation (trees), and/or animal burrows:
NONE NOTED.
5. Identification of deteriorating equipment (i.e., monitoring wells, fencing, or drainage structures): GREEN MARKING STAKE AT MW-4B WAS BENT, APPARENTLY BY MOWER—NO DAMAGE TO WELL. STRAIGHTENED STAKE. NO OTHER DETERIORATION NOTED.
6. Inspection of stormwater drainage swales for erosion, sloughing, or flow-through:
NONE NOTED.
7. Inspection of east side of the landfill (Niagara Mohawk Power Corporation parcel) along the intermittent stream for the presence of erosion or sloughing:
NONE NOTED.
8. Inspection of access roads:
NO ISSUES OR DEFICIENCIES NOTED