

*MTU-MJA*



7 August 2001

RECEIVED

AUG 09 2001

NYSDEC - REG. 9  
FOIL  
Y REL UNREL

Mr. Michael Hinton, P.E.  
Environmental Engineer II  
New York State Department  
of Environmental Conservation  
Division of Environmental Remediation  
270 Michigan Avenue  
Region 9  
Buffalo, New York 14203-2999

RE: Second Quarter Year 2001 Monitoring Event Letter Report, Site No. 932001,  
Airco Properties Inc., Witmer Road Landfill, Niagara Falls, New York  
EA Project No. 12040.69

Dear Mr. Hinton:

EA Engineering, P.C. and its affiliate EA Engineering, Science, and Technology are pleased to provide three copies of the Second Quarter Year 2001 Monitoring Event Letter Report. During December 2000, the post-closure monitoring and facility maintenance program was initiated at the Witmer Road Landfill located in Niagara Falls, New York. Post-closure monitoring and facility maintenance is required by New York State Solid Waste Management Facilities Regulations (6 NYCRR Part 360-2.15[k][4]) and stipulated in the Order on Consent No. B9-0470-94-12. The purpose of this monitoring event letter report is to summarize the analytical results of the second quarter Year 2001 ground-water monitoring event that was completed at this site in June 2001.

**OBJECTIVES**

In accordance with the Revised Final Post-Closure Monitoring and Facility Maintenance Plan (EA 2001a)<sup>1</sup>, environmental monitoring points will be maintained and sampled during the post-closure monitoring period. This includes collection of ground-water, surface water, and leachate samples. The Revised Final Post-Closure Monitoring and Facility Maintenance Plan (EA 2001a) documents sampling locations and sampling parameters and methods, in addition to other required maintenance activities, such as landfill cap inspections. It is anticipated that within 5 years of the start of post-closure monitoring, this plan will be re-evaluated based on the data collected at the site so that the monitoring plan will be focused to address site-specific issues that may be identified.

1. EA Engineering, Science, and Technology. 2001a. Interim Remedial Measure Report Documenting Closure of the Witmer Road Landfill, Niagara Falls, New York. Appendix A – Revised Final Post-Closure Monitoring and Facility Maintenance Plan. January.

---

The objectives of the Post-Closure Monitoring and Facility Maintenance Program are to:

- Collect representative ground-water and surface water samples in order to monitor any potential leachate migration from the landfill, and to document the effectiveness of the recently installed landfill capping system.
- Evaluate these data to determine whether any potential impacts may be occurring that could affect human health or the environment
- Provide this information to the BOC Group and the New York State Department of Environmental Conservation (NYSDEC).

As noted in the Revised Final Post-Closure Monitoring and Facility Maintenance Plan (EA 2001a), the results of the quarterly sampling events will be summarized in a letter report detailing the findings of the environmental sampling. Monitoring event letter reports will be limited to documenting the results of each sampling round. This letter report summarizes the findings of the second post-closure monitoring event completed at this site. Beginning with calendar year 2001, an annual report will be issued that will provide an assessment of site analytical data trends, other findings, conclusions, and recommendations. No annual report for 2000 was prepared as only one round of data was collected for post-closure monitoring during 2000. Therefore, the first annual report will document findings for quarterly monitoring events during the 2001 calendar year.

## **BACKGROUND**

The Witmer Road Landfill is part of the Vanadium Corporation of America site that is located in the Town of Niagara Falls, New York (Figure 1). The Vanadium site is approximately 150 acres. This quarterly sampling event focused on the 25-acre Airco parcel operated by the BOC Group. The site contains waste material from the operation of onsite and nearby production facilities.

An Immediate Investigative Work Assignment was conducted by NYSDEC for a portion of the 150-acre parcel in August 1997. Approximately 70 acres from the Niagara Mohawk Power Corporation and New York Power Authority (NYPA) parcel were investigated. During the investigation, NYSDEC determined that the site had been used by Vanadium Corporation of America (the owners of the site from 1924 to 1964) to dispose of wood, brick, ash, lime slag, ferrochromium silicon slag, and ferrochromium silicon dust. According to the Immediate Investigative Work Assignment, much of the surface material consisted of fill, including fly ash, dust, slag, and cinder materials.

Analysis of site ground water during the Immediate Investigative Work Assignment indicated that surface water and ground-water standards were exceeded for hexavalent chromium and pH. Based on the Immediate Investigative Work Assignment and other investigations, the facility has been listed as a Class 2 Hazardous Waste Site in the New York State Registry of Inactive Hazardous Waste Sites (Site No. 932001). A Class 2 listing indicates a significant threat to public health and the environment, and requires remedial action.

Remedial measures were completed at the Witmer Road Landfill during 2000, which included completion of an impermeable cap and leachate relief system. A complete description of the history of the site, and the construction details of the landfill capping system, can be found in the Interim Remedial Measure Report (EA 2001b)<sup>2</sup>.

## MONITORING EVENT FIELD ACTIVITIES

### Monitoring Well Gauging

The site monitoring wells (MW-1B through MW-8B) were gauged prior to sampling on 12 June 2001. The depth to water ranged from 5.97 ft at MW-5B to 13.11 ft at MW-2B. Gauging data are summarized in the table below:

Well ID	Gauging Date	Depth to Water (ft MSL)	Well Elevation (ft AMSL)	Corrected Water Elevation (ft MSL)
MW-1B	12 JUN 01	11.11	617.77	606.66
MW-2B	12 JUN 01	13.11	615.88	602.77
MW-3B	12 JUN 01	8.67	611.22	602.55
MW-4B	12 JUN 01	7.85	606.68	598.83
MW-5B	12 JUN 01	5.97	605.48	599.51
MW-6B	12 JUN 01	6.76	603.47	596.71
MW-7B	12 JUN 01	9.31	609.48	600.17
MW-8B	12 JUN 01	5.57	611.62	606.05

NOTE: MSL = Mean sea level.  
AMSL = Above mean sea level.

Figure 2 provides the interpreted ground-water potentiometric surface contour map based on gauging data collected on 12 June 2001.

### Ground-Water Sampling Procedures

Monitoring wells were sampled on 13 June 2001. Eight ground-water, one leachate, and one surface water sample were collected from the site monitoring wells. The wells were purged using dedicated bailers due to low recharge and well volume. Monitoring wells MW-2B, MW-4B, MW-5B, MW-7B, and MW-8B were bailed dry at least once and allowed to recharge prior to sample collection. Monitoring wells MW-1B, MW-3B, and MW-6B had adequate recharge rates; consequently, 4 wells volumes were removed and water quality readings allowed to stabilize prior to sample collection. One surface water and one leachate sample were also collected. Samples were submitted to Environmental Laboratory Services of North Syracuse, New York for analysis of phenolics by U.S. Environmental Protection Agency (EPA) Method 420.2, sulfate by EPA Method 375.3, ammonia (expressed as nitrogen) by EPA Method 350.2, and Target Analyte List metals by EPA Series 6010/620, including hexavalent chromium.

2. EA. 2001b. Interim Remedial Measure Report Documenting Closure of the Witmer Road Landfill, Niagara Falls, New York. January.

Ground-water sampling results were compared to NYSDEC Ambient Water Quality Standards (AWQS)<sup>3</sup> and guidance values for GA waters. Surface water and leachate samples were compared to NYSDEC AWQS for Class D waters. If no Class D standards were applicable for a particular compound, analytical results were compared to the more stringent Class C standards. Analytical results are summarized on the table provided in Attachment A. Copies of the field notebook, including the results for well gauging, purging, and sampling, are provided in Attachment B. Laboratory chain-of-custody records are provided in Attachment C. Laboratory Form I analytical results are included in Attachment D.

## **ANALYTICAL RESULTS**

Based on the analytical results collected during the Fourth Quarter 2000 and First Quarter 2001, NYSDEC has approved a reduction in the sampling requirements for the remaining 2001 sampling event. As per a letter to NYSDEC dated 5 June 2000, samples will be analyzed for water quality parameters; ammonia, phenolics, and sulfate, and total (unfiltered) metals.

Summary tables listing analytical results compared to applicable NYSDEC AWQS are included in Attachment A. Notable results of chemical analyses are as follows.

### **Metals**

Unfiltered metals samples were collected from each of the site monitoring wells. Notable results included the following:

- Chromium, hexavalent chromium, iron, magnesium, manganese, and sodium were detected in ground-water samples at concentrations in excess of NYSDEC AWQS.
- Iron and selenium were detected in the surface water sample in excess of NYSDEC AWQS standards.
- Chromium and hexavalent chromium were detected in excess of the NYSDEC AWQS in the leachate sample.

### **Water Quality Parameters**

Water quality parameters, including ammonia (expressed as N), phenolics, and sulfate, were also analyzed. Notable results included the following:

- Phenolics were detected above NYSDEC AWQS in the sample collected from monitoring well MW-7B.
- Sulfate was detected in excess of NYSDEC AWQS in samples collected from monitoring wells MW-6B and the associated duplicate, and MW-8B.

---

3. New York State Department of Environmental Conservation. 1998. Division of Water Technical and Operational Guidance Series (1.1.1) Ambient Water Quality Standards and Guidance Values and Ground-Water Effluent Limitations. June.

- Water quality parameters did not exceed NYSDEC AWQS in the surface water or leachate samples.

## LANDFILL INSPECTION

Landfill cap inspections were conducted on 22 May 2000 and 19 June 2001. The Landfill Cap Inspection Checklist is provided as Attachment E. Notable results of the inspection are summarized below:

- Three main "washout" locations were observed on the west side of the landfill. Two of 3 washout locations were converted to rock-lined drainage swales. The third "washout" location was repaired according to the original cap design.
- The following areas were regraded:
  - The southern access road
  - The Niagara Mohawk Power Corporation ditch to the east of the landfill
- The geotextile fabric, that was exposed at locations along the eastern access road, has been covered by additional stone.
- The relief pipe discharge was redirected to the south to avoid contact with the abutting property to the west.

If you have any questions regarding the results of this Second Quarter 2001 Monitoring Event, please do not hesitate to contact Charles McLeod at (845) 565-8100.

Sincerely,

EA ENGINEERING, P.C.



Charles E. McLeod, Jr., P.E.  
Vice President

EA ENGINEERING, SCIENCE,  
AND TECHNOLOGY



Scott Graham  
Project Geologist

CEM/caw  
Attachments

cc: M. Resh (BOC)  
D. Hettrick (NYSDOH)  
Town of Niagara Falls (Town Clerk)

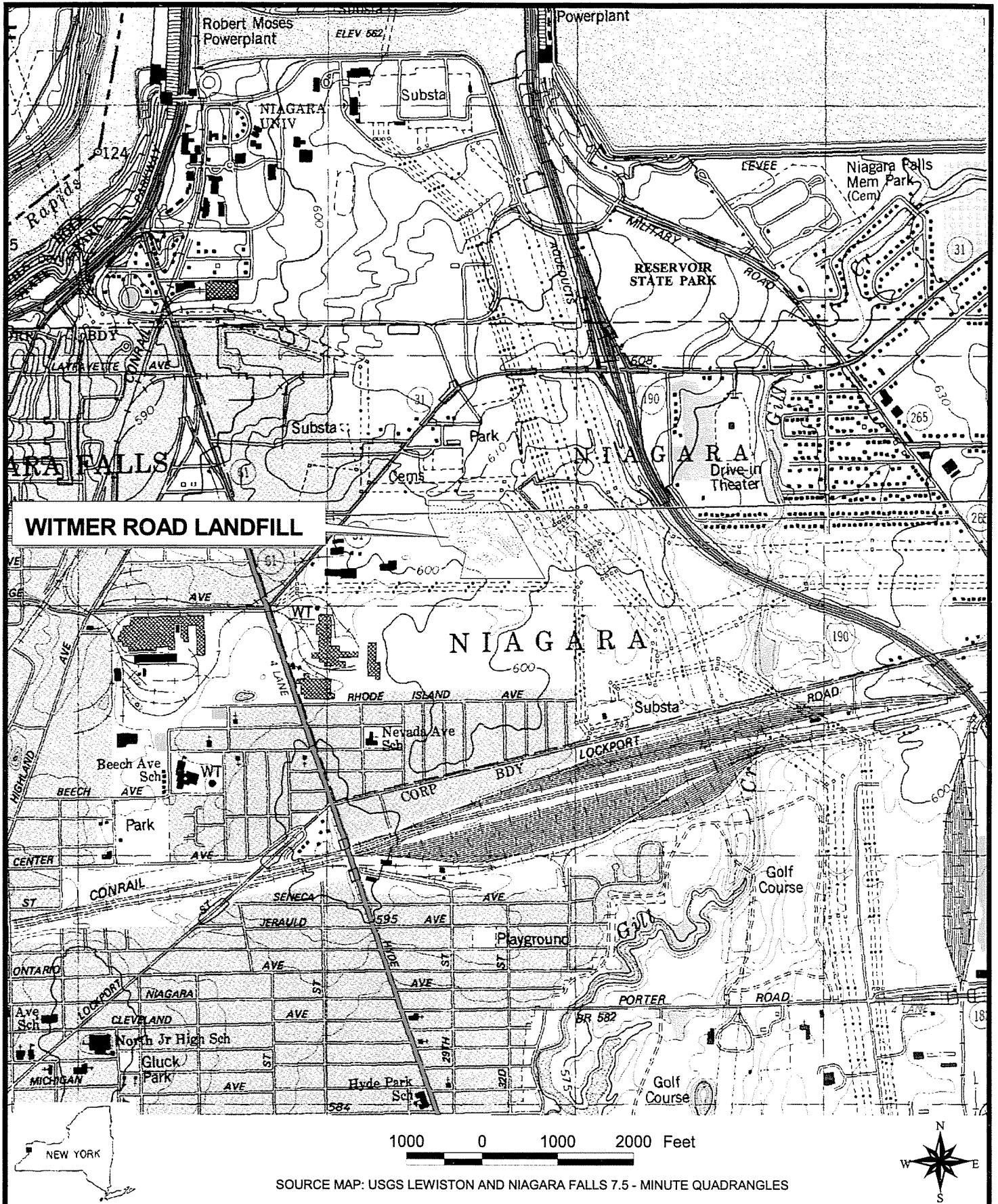

EA ENGINEERING,  
SCIENCE, AND  
TECHNOLOGY

WITMER ROAD LANDFILL  
NIAGARA FALLS, NEW YORK

FIGURE I  
SITE LOCATION MAP

PROJECT MGR	DESIGNED BY	DRAWN BY	CHECKED BY	SCALE	DATE	PROJECT No	FILE No
CEM	BT	BT	CEM	AS SHOWN	24 JULY 2001	12040.69	I:\BOC-NIAGARA-GIS\BOC.APR

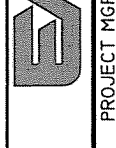
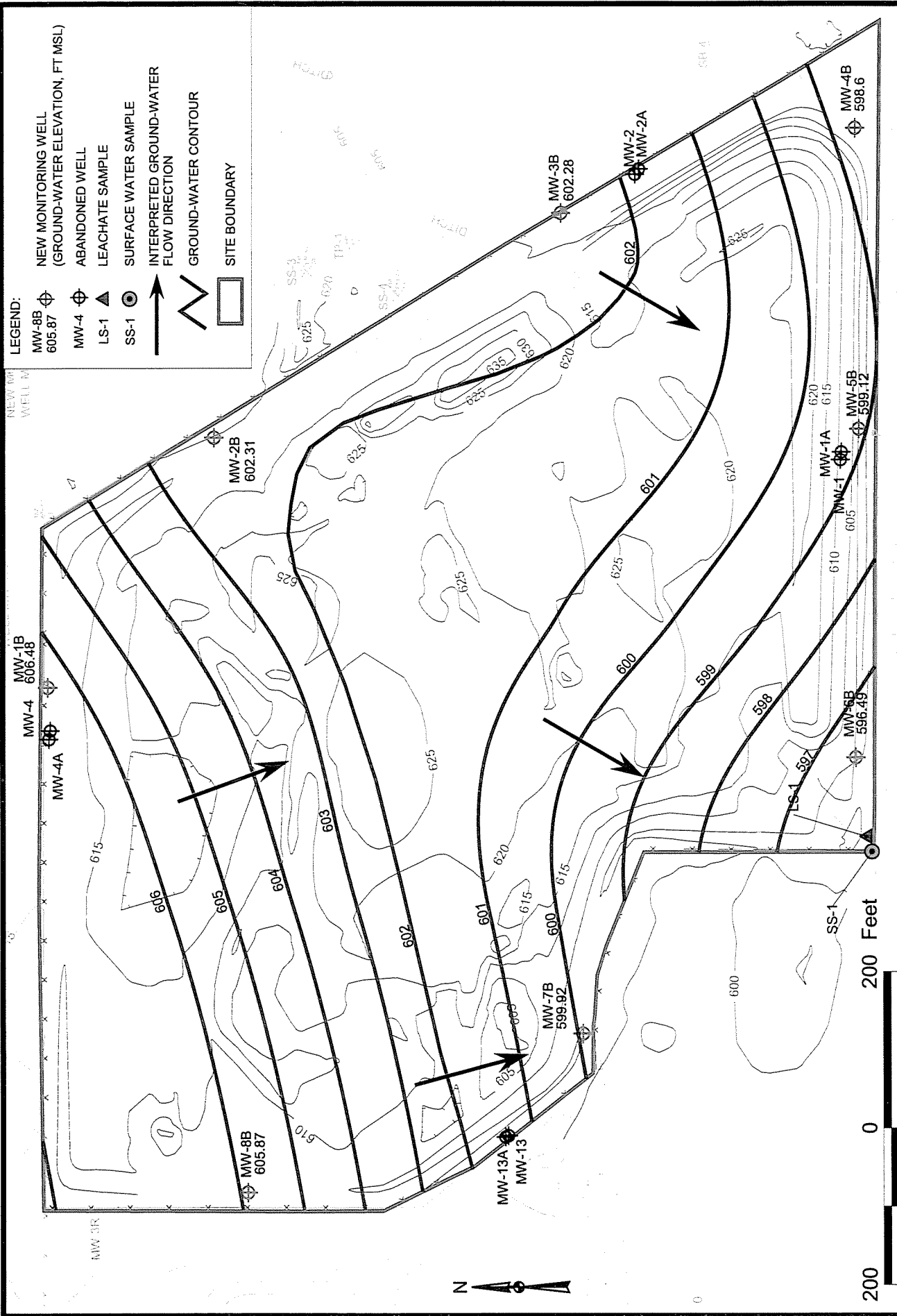

EA ENGINEERING,  
SCIENCE, AND  
TECHNOLOGY

WITMER ROAD LANDFILL  
NIAGARA FALLS, NEW YORK

FIGURE 2  
GROUND-WATER CONTOUR MAP  
JUNE 2001

PROJECT MGR CEM	DESIGNED BY BT	DRAWN BY BT	CHECKED BY GMC	SCALE AS SHOWN	DATE 23 JULY 2001	PROJECT No 12040.69	FILE No I:\BOC-NIAGARA-GIS\ BOC.APR
--------------------	-------------------	----------------	-------------------	-------------------	----------------------	------------------------	---

## **Attachment A**

### **Summary of Analytical Data**



ATTACHMENT A SUMMARY OF ANALYTICAL RESULTS OF GROUND-WATER, SURFACE WATER,  
AND LEACHATE SAMPLES COLLECTED IN JUNE 2001,  
WITMER ROAD LANDFILL, NIAGARA FALLS, NEW YORK

**Ground Water**

**Baseline Metals by EPA Method 6010/6020 (mg/L)**

**Total (Unfiltered)**

		WRL MW1B	WRL MW2B	WRL MW3B	WRL MW4B	WRL MW5B	WRL MW6B	WRL MW6B (Dup)	WRL MW7B	WRL MW8B
<b>Compound/Element</b>	<b>AWQS</b>									
Chromium	0.05	(<0.005U)	<b>0.368</b>	0.01	<b>0.2</b>	0.007	0.016	0.017	<b>0.296</b>	<b>0.366</b>
Chromium, Hexavalent	0.05	(<0.01U)	<b>0.36</b>	(<0.01U#)	<b>0.175#</b>	(<0.01U)	(<0.01U)	(<0.01U)	<b>0.274</b>	<b>0.313</b>
Iron	0.3	<b>0.386</b>	<b>0.583</b>	<b>2.6</b>	<b>5.9</b>	<b>0.667</b>	<b>11.9</b>	<b>12.2</b>	<b>6.8</b>	<b>0.701</b>
Lead	0.025	(<0.005U)	(<0.005U)	(<0.005U)	0.014	(<0.005U)	0.006	0.006	(<0.005U)	(<0.005U)
Magnesium	35*	<b>55.6</b>	1.1	12.4	<b>50.5</b>	<b>70.2</b>	<b>85.2</b>	<b>84.4</b>	9.3	<b>67.1</b>
Manganese	0.3	<b>0.628</b>	0.024	0.066	0.107	0.051	<b>0.434</b>	<b>0.439</b>	0.161	0.073
Selenium	0.01	(<0.005U)	0.008	(<0.005U)	(<0.005U)	(<0.005U)	(<0.005U)	(<0.005U)	(<0.005U)	<b>0.211</b>
Silica	---	24.7	7.1	33	43.2	22.7	120	118	60.4	21.3
Sodium	20	<b>100</b>	<b>48</b>	<b>46.7</b>	<b>68.5</b>	<b>64.4</b>	<b>67.8</b>	<b>67.1</b>	<b>57.1</b>	<b>111</b>
Zinc	2*	0.261	0.02	0.017	0.089	0.015	0.024	0.025	0.014	0.011

**Water Quality Parameters (mg/L)**

		WRL MW1B	WRL MW2B	WRL MW3B	WRL MW4B	WRL MW5B	WRL MW6B	WRL MW6B (Dup)	WRL MW7B	WRL MW8B
<b>Compound/Element</b>	<b>AWQS</b>									
Ammonia (expressed as N)	2	(<1U)	1.5	(<1U)	(<1U)	(<1U)	(<1U)	(<1U)	(<1U)	(<1U)
Phenolics	0.001	(<0.002U)	(<0.002U)	(<0.002U)	(<0.002U)	(<0.002U)	(<0.002U)	(<0.002U)	<b>0.007</b>	(<0.002U)
Sulfate	250	167	15	26.8	190	192	<b>299</b>	<b>316</b>	43.1	<b>434</b>

**Surface Water**

**Baseline Metals by EPA Method 6010/6020 (mg/L)**

**Total (Unfiltered)**

		WRL SS
<b>Compound/Element</b>	<b>AWQS</b>	
Chromium	---	0.011
Chromium, Hexavalent	0.016	(<0.01U)
Iron	0.3	<b>1.4</b>
Lead	---	(<0.005U)
Magnesium	---	7.6
Manganese	---	0.038
Selenium	0.0046	<b>0.009</b>
Silica	---	30.3
Sodium	---	94.6
Zinc	---	(<0.005U)

**Water Quality Parameters (mg/L)**

		WRL SS
<b>Compound/Element</b>	<b>AWQS</b>	
Ammonia (expressed as N)	---	12.2
Phenolics	---	0.212
Sulfate	---	498

ATTACHMENT A (CONTINUED)

Leachate

Baseline Metals by EPA Method 6010/6020 (mg/L)

Total (Unfiltered)

		WRL L1
Compound/Element	AWQS	
Chromium	---	0.63
Chromium, Hexavalent	0.016	<del>0.555</del>
Iron	0.3	(<0.025U)
Lead	---	(<0.005U)
Magnesium	---	(<1U)
Manganese	---	(<0.005U)
Selenium	---	0.026
Silica	---	8.2
Sodium	---	70.1
Zinc	---	(<0.005U)

Water Quality Parameters (mg/L)

		WRL L1
Compound/Element	AWQS	
Ammonia (expressed as N)	---	4.01
Phenolics	---	0.009
Sulfate	---	12.4

QA/QC

Baseline Metals by EPA Method 6010/6020 (mg/L)

Total (Unfiltered)

		Rinse Blank	Source Water Blank
Compound/Element	AWQS		
Chromium	---	(<0.005U)	(<0.005U)
Chromium, Hexavalent	---	(<0.01U)	(<0.01U)
Iron	---	(<0.025U)	(<0.025U)
Lead	---	(<0.005U)	(<0.005U)
Magnesium	---	(<1U)	(<1U)
Manganese	---	(<0.005U)	(<0.005U)
Selenium	---	(<0.005U)	(<0.005U)
Silica	---	3	2.8
Sodium	---	(<1U)	(<1U)
Zinc	---	(<0.005U)	(<0.005U)

Water Quality Parameters (mg/L)

		Rinse Blank	Source Water Blank
Compound/Element	AWQS		
Ammonia (expressed as N)	---	(<1U)	(<1U)
Phenolics	---	(<0.002U)	(<0.002U)
Sulfate	---	(<2U)	(<2U)

ATTACHMENT A (CONTINUED)

**TABLE NOTES**

- AWQS = New York State Ambient Water Quality Standards and Guidance Values from Division of Water and Technical and Operational Guidance Series (1.1.1) June 1998.
- \* = Indicated guidance value.
- \*\* = Standard calculated based on sample hardness as per NYW AWQS.
- # = Sample received outside holding time.
- U = Not detected. Sample quantitation limits shown as (<\_\_U).

Only those analytes detected in at least one of the samples is shown on this table. Results shaded and in boldface indicate concentrations in excess of New York State Ambient Water Quality Standards or Guidance Values.

**Analytical Methods for Water Quality Parameters**

- Ammonia (expressed as Nitrogen) = EPA 350.2
- Phenolics = EPA 420.2
- Sulfate = EPA 375.3

**Attachment B**

**Field Monitoring and  
Sampling Notes**

T12JUN01

- @ 3:30 pm Arrive onsite to sample (M/EP)  
 surface water and leachate  
 - Calibrate Horiba

## Well Gauging

Well ID	DTW	DTB
MW 6B	6.76	22.98
MW 7B	9.31	21.72
MW 8B	5.57	15.60
MW 1B	11.11	27.90
MW 2B	13.11	27.58
MW 3B	8.67	18.35
MW 4B	7.85	15.05
MW 5B	5.97	14.17

## SURFACE WATER QUALITY

pH	10.71	WRL-SSD)
Cond	0.146	Sample collected
Temp	024.3	@ 1600
DO	9.29	
Turb	97.0	
Sal	0.1	
TDS	0.9	
ORP	-46	

Tue 6/12/01

LEACHATE WATER QUALITY

PH 12.53  
 Cond 0.746  
 Temp 15.1  
 DO 11.45  
 Turb 15.0  
 Sal 0.4  
 TDS 4.7  
 ORP -41

WRLC-LO1  
 Sample collected  
 @ 1620

1715 Complete well gauging, drop off drums and depart + pick up ice and drop samples at UPS

~~Anthony M. Murphy  
 Director~~

W 13 June 01

0640 Arrive onsite G9JM and begin purge of MW4B

MW-4B

DTW: 7.85      DTB: 15.05

Initial	1	2	3	4	5
Time	0710	0716	0800	0812	0850
Volume	1.2	2.4	3.6	4.8	—

COND	0.124	0.131	0.132	99.4	93.8	98.6
TEMP	13.0	11.3	10.6	12.1	12.2	12.9
DO	6.53	16.70	13.43	11.21	10.51	13.88
TURB	9.1	9114	145.0	78.6	26.7	14.2
SAL	0.1	0.1	0.1	0.0	0.0	0.0
TDS	0.8	0.9	0.9	0.63	0.60	0.63
ORP	116	128	136	118	130	158

WRL - MW4B-0601 collected @ 0850

Dry after 2 volumes, then allowed to recharge

Dry after 3.5 volumes, then allowed to recharge - Took final WQ and sampled

W 13 Jun 01

# MW-5B

DTW 5.97 DTB 14.17

	Inital	1	2	3	4	5	6
Time	0729	0738	0750	1337			
Volume (gal)	init	1.3	2.6				
pH	7.56	7.54	7.54	7.10			
Cond	0.120	0.159	0.145	0.120			
Temp	15.7	13.6	13.8	15.4			
DO	7.22	15.12	7.29	16.32			
Turb	8.6	15.3	83.9	308			
Sal	0.9	0.1	0.1	0.1			
TDS	10	1.0	0.9	0.8			
ORP	159	134	141	199			

WRL - MW-5B - 0601 collected @

1337

Prv after 2 volumes, then allowed to recharge

W 13 Jun 01

# MW-3B

DTW 8.67 DTB 18.35

	Inital	1	2	3	4	5	6
Time	0741	0748	0800	0810	0820		
Volume	init	1.7	3.4	5.1	6.8		
pH	9.30	10.46	9.35	8.82	8.64		
Cond	34.2	37.8	42.0	43.4	43.1		
Temp	13.0	11.3	11.5	11.7	12.1		
DO	10.52	10.04	11.03	10.19	10.19		
Turb	10.6	120.0	39.1	93.2	33.0		
Sal	0.0	0.0	0.0	0.0	0.0		
TDS	0.23	0.24	0.27	0.28	0.29		
ORP	79	52	50	44	109		

WRL - MW3B - 0601 collected @

0835

W13June01

MW-6B

DTW: 6.76	DTB: 22.98			
Initial	1	2	3	4
Time	0925	0940	0950	1005
Volume	2.75	5.25	8.00	10.25
pH	7.49	7.43	7.53	7.52
Conduct	0.127	0.131	0.130	0.121
Temp	20.2	13.3	12.8	13.8
DO	11.42	16.01	15.89	13.77
Turb	9.5	71.1	625	>1,000
Sal	0.1	0.1	0.1	0.1
TDS	0.8	0.8	0.8	0.8
ORP	172	168	208	187

WRL-MW6B-0601 collected @ 1015

WRL-MWDUP-0601 collected at this well

W13June01

MW-7B

DTW: 9.31	DTB: 21.72					
Initial	1	2	3	4	5	6
Time	1013	1013	1013	1013	1013	1013
Vol	2.1	2.1	2.1	2.1	2.1	2.1
pH	8.92	8.92	8.92	8.92	8.92	8.92
Cond	41.9	41.9	41.9	41.9	41.9	41.9
Temp	14.7	13.4	13.4	13.4	13.4	13.4
DO	9.28	9.67	9.67	9.67	9.67	9.67
Turb	30.7	490	490	490	490	490
Sal	0.0	0.0	0.0	0.0	0.0	0.0
TDS	0.28	0.27	0.27	0.27	0.27	0.27
ORP	17	152	152	152	152	152

MW7B went dry after 1.5 volumes. Then allowed to recharge

WRL-MW7B-0601 collected @ 1405



W13 Jun 01

MW-8B

DTW: 5.57 DTB: 15.60

Time	Initial	1	2
Volume	1220	1.7	1425
pH	7.77	7.32	7.40
Cond	0.174	0.182	0.178
Temp	16.3	14.7	15.8
DO	12.00	11.36	12.00
Turb	25.3	113.0	92.4
SAL	0.1	0.1	0.1
TDS	1.1	1.2	1.1
ORP	153	185	198

MW8B went dry after 1 well  
Volume. Then allowed to recharge.

WRL-MW8B-0601 collected  
@ 1425

W13 Jun 01

MW-1B

DTW: 11.11 DTB: 27.90

Time	Initial	1	2	3	4
Volume	1220	1235	1250	1300	1315
pH	7.45	6.87	6.98	6.94	6.99
Cond	0.192	0.154	0.154	0.156	0.154
Temp	15.0	16.4	15.4	16.0	16.8
DO	12.62	10.24	5.67	12.68	6.96
Turb	25.3	105	64.7	46.5	32.3
SAL	0.1	0.1	0.1	0.1	0.1
TDS	1.0	1.0	1	1.0	1.0
ORP	163	188	170	149	138

WRL-MW1B-0601 collected  
@ 1325

W B Jun 01

mw2B

DTG: 13:11 DTB: 27:58

	1	2
Time	13:07	14:50
Vol	2.4	-
pH	11.74	11.80
Cond	0.444	0.432
DO	12.6	15.2
Turb	8.11	11.75
SHL	129.0	37.4
TDS	0.2	0.2
ORP	2.8	2.8
	4	37

mw2B went dry after 1  
well volume. Then allowed to  
recharge.

WRL - mw2B collected @ 14:50

W B Jun 01

1520 Label drums - 1 from  
21 Mar and 1 from 13 Jan  
as NON-TAZ purge  
water

1525 Depart site

~~W B Jun 01  
1520  
1525~~

TH 14 June 01

Arrived @ Environmental Labs  
with samples - 0900

Relinquished samples @ 0909

Obtained two more sets of  
Bottles + two more sets of  
chains.

WRL-RB-0601 collected  
6/14/01 0930 @  
Laboratory site.

WRL-SWB01-0601 collected  
6/14/01 0945 @  
Laboratory site.

**Attachment C**

**Laboratory Chain-of-Custody  
Documents**



**Environmental**  
LABORATORY SERVICES  
7280 Caswell Street, Hancock Air Park North Syracuse, NY 13212  
(315) 458-8033 FAX (315) 458-0249 (800) 843-8265

**CHAIN OF CUSTODY RECORD**  
and Authorization for Analysis

Name: Scott Graham		Title:															
Company: Env. Engineering		Dept.:															
Address: 337 Fly Rd.		Job/PO No.:															
City, State, Zip: East Syracuse, NY 13057																	
<b>The following services may result in additional charges:</b> <input type="checkbox"/> Telephone Results Telephone No. 431-4230 Advance Agreement Required <input type="checkbox"/> Express Service <input type="checkbox"/> Fax Results Fax No. <input type="checkbox"/> 1 Week <input type="checkbox"/> 48 Hour																	
ELN Number	To be completed by Sampler. Please remember to record this information on the container label.							Number of Containers	Container Type/Preservative								Analyses Required, Remarks, and/or Special Instructions
	*Date	*Time	*Comp.	*Grab	*Matrix	*Sampling Location			Plastic/HNO <sub>3</sub>	Plastic/H <sub>2</sub> SO <sub>4</sub>	Plastic/NaOH+Ascorbic Acid	Plastic/NaOH+Zinc Acetate	Glass/No Preservative	Glass/Sodium Thiosulfate	Amber Glass/No Pres.	Amber Glass/H <sub>2</sub> SO <sub>4</sub>	
213063	6/6/01	0835		✓	A20	WR - MW38 - 0601	1	Plastic/HNO <sub>3</sub>	Plastic/H <sub>2</sub> SO <sub>4</sub>	Plastic/NaOH+Ascorbic Acid	Plastic/NaOH+Zinc Acetate	Glass/No Preservative	Glass/Sodium Thiosulfate	Amber Glass/No Pres.	Amber Glass/H <sub>2</sub> SO <sub>4</sub>	Other: (specify)	Chloride
213064				↓			1	Plastic/HNO <sub>3</sub>	Plastic/H <sub>2</sub> SO <sub>4</sub>	Plastic/NaOH+Ascorbic Acid	Plastic/NaOH+Zinc Acetate	Glass/No Preservative	Glass/Sodium Thiosulfate	Amber Glass/No Pres.	Amber Glass/H <sub>2</sub> SO <sub>4</sub>	Other: (specify)	HCl
213065				↓			1	Plastic/HNO <sub>3</sub>	Plastic/H <sub>2</sub> SO <sub>4</sub>	Plastic/NaOH+Ascorbic Acid	Plastic/NaOH+Zinc Acetate	Glass/No Preservative	Glass/Sodium Thiosulfate	Amber Glass/No Pres.	Amber Glass/H <sub>2</sub> SO <sub>4</sub>	Other: (specify)	Chloride
213066				↓			1	Plastic/HNO <sub>3</sub>	Plastic/H <sub>2</sub> SO <sub>4</sub>	Plastic/NaOH+Ascorbic Acid	Plastic/NaOH+Zinc Acetate	Glass/No Preservative	Glass/Sodium Thiosulfate	Amber Glass/No Pres.	Amber Glass/H <sub>2</sub> SO <sub>4</sub>	Other: (specify)	Chloride
213067				↓			1	Plastic/HNO <sub>3</sub>	Plastic/H <sub>2</sub> SO <sub>4</sub>	Plastic/NaOH+Ascorbic Acid	Plastic/NaOH+Zinc Acetate	Glass/No Preservative	Glass/Sodium Thiosulfate	Amber Glass/No Pres.	Amber Glass/H <sub>2</sub> SO <sub>4</sub>	Other: (specify)	Chloride
Containers Dispensed by: [Signature]		Date: 6/10/01	Time: 10:25	Container(s) Received by:				Date:	Time:								
Relinquished by: [Signature]		Date: 6/11/01	Time: 0909	Received by:				Date:	Time:								
Relinquished by:		Date:	Time:	Received by:				Date:	Time:								
Relinquished by:		Date:	Time:	Received by:				Date:	Time:								
Relinquished by:		Date:	Time:	Received at Lab by:				Date:	Time:								
Sampler Signature:		White - LABORATORY			Canary - ACCOMPANIES RESULTS			Pink - CLIENT									
Your signature authorizes ELS to analyze the sample(s) as indicated.										Please return completed form and all sample containers to Environmental Laboratory Services.		2217.ELS..202.0910					



**Environmental LABORATORY SERVICES**  
 7280 Caswell Street, Hancock Air Park North Syracuse, NY 13212  
 (315) 458-8033 FAX (315) 458-0249 (800) 843-8255

# CHAIN OF CUSTODY RECORD

## and Authorization for Analysis

Name		Title		Analyses Required, Remarks, and/or Special Instructions																			
Company		Dept.		Glass/No Preservatives		Plastic/HNO <sub>3</sub>		Plastic/H <sub>2</sub> SO <sub>4</sub>		Plastic/NaOH+Ascorbic Acid		Plastic/NaOH+Zinc Acetate		Glass/No Preservative		Glass/Sodium Thiosulfate		Amber Glass/No Pres.		Amber Glass/H <sub>2</sub> SO <sub>4</sub>		Other: (specify)	
Address		Job/PO No.		Number of Containers		*Date		*Time		*Comp.		*Grab		*Matrix		*Sampling Location							
City, State, Zip		Express Service		Advance Agreement Required		<input type="checkbox"/> 1 Week <input type="checkbox"/> 48 Hour																	
Telephone Results		Telephone No.		Fax No.		To be completed by Sampler. Please remember to record this information on the container label.																	
Fax Results		Telephone No.		Fax No.																			
ELS Number						213067		6/2/01		0835				H2O		WRL-PW38-6601							
Containers Dispensed by:		Date:		Time:		Container(s) Received by:		Date:		Time:		Received by:		Date:		Time:		Received by:		Date:		Time:	
Relinquished by:		Date:		Time:																			
Relinquished by:		Date:		Time:																			
Relinquished by:		Date:		Time:																			
Relinquished by:		Date:		Time:																			
Sampler Signature:		Date:		Time:		Received at Lab by:		Date:		Time:		Received by:		Date:		Time:		Received by:		Date:		Time:	

Please return completed form and all sample containers to Environmental Laboratory Services.

Canary - ACCOMPANIES RESULTS  
 Your signature authorizes ELS to analyze the sample(s) as indicated.



**Environmental**  
LABORATORY SERVICES  
7280 Caswell Street, Hancock Air Park North Syracuse, NY 13212  
(315) 458-8033 FAX (315) 458-0249 (800) 843-8265

**GAIN OF CUSTODY RECORD**  
and Authorization for Analysis

Name: Scott G. Dean		Title:																	
Company: E.A. Engineering		Dept.:																	
Address: 707 E. 5th St.		Job/PO No.:																	
City, State, Zip: East Syracuse, NY 13057																			
<b>The following services may result in additional charges:</b> <input type="checkbox"/> Telephone Results Telephone No. 315-458-0249 Advance Agreement Required Express Service <input type="checkbox"/> Fax Results Fax No. 315-458-0249 <input type="checkbox"/> 1 Week <input type="checkbox"/> 48 Hour																			
To be completed by Sampler. Please remember to record this information on the container label.																			
ELS Number	*Date	*Time	*Comp.	*Grab	*Matrix	*Sampling Location	Number of Containers	Plastic/No Preservatives	Plastic/HNO <sub>3</sub>	Plastic/H <sub>2</sub> SO <sub>4</sub>	Plastic/NaOH+Ascorbic Acid	Plastic/NaOH+Zinc Acetate	Glass/No Preservative	Glass/Sodium Thiosulfate	Amber Glass/No Pres.	Amber Glass/H <sub>2</sub> SO <sub>4</sub>	Other: (specify)	Analyses Required, Remarks, and/or Special Instructions	
213068	6/12/01	1620		✓	H <sub>2</sub> O	WRL-LOL	1	Amber Glass/No Pres.											
213069	6/12/01	1620		✓	H <sub>2</sub> O		1	Plastic/NaOH+Ascorbic Acid											
213090	6/12/01	1620		✓	H <sub>2</sub> O		1	Plastic/NaOH+Ascorbic Acid											
213071	6/12/01	1620		✓	H <sub>2</sub> O		1	Plastic/NaOH+Ascorbic Acid											
213072	6/12/01	1620		✓	H <sub>2</sub> O		1	Plastic/NaOH+Ascorbic Acid											
Containers Dispensed by: [Signature]		Date: 6/12/01	Time: 10:25	Container(s) Received by:		Date:	Time:												
Relinquished by: [Signature]		Date: 6/12/01	Time: 1650	Received by:		Date:	Time:												
Relinquished by:		Date:	Time:	Received by:		Date:	Time:												
Relinquished by:		Date:	Time:	Received by:		Date:	Time:												
Relinquished by:		Date:	Time:	Received at Lab by:		Date:	Time:												
Relinquished by:		Date:	Time:	Received at Lab by:		Date:	Time:												
Your signature authorizes ELS to analyze the sample(s) as indicated.																			
Sampler Signature:																			

White - LABORATORY  
Please return completed form and all sample containers to Environmental Laboratory Services.

Canary - ACCOMPANIES RESULTS

Pink - CLIENT

2217.ELS.202.9310



**Environmental  
LABORATORY SERVICES**  
7280 Caswell Street, Hancock Air Park North Syracuse, NY 13212  
(315) 458-8033 FAX (315) 458-0249 (800) 843-8265

**CHAIN OF CUSTODY RECORD  
and Authorization for Analysis**

<b>Name</b>	Scott Graham				<b>Title</b>					Analyses Required, Remarks, and/or Special Instructions
<b>Company</b>	E.A. Engineering Science				<b>Dept.</b>					
<b>Address</b>	757 E. Rd				<b>Job/PO No.</b>					
<b>City, State, Zip</b>	East Syracuse, NY 13057				<b>Number of Containers</b>					
<b>The following services may result in additional charges:</b>										
<input type="checkbox"/> Telephone Results Telephone No. 431 4290		<input type="checkbox"/> Fax Results Fax No. _____		<input type="checkbox"/> 1 Week <input type="checkbox"/> 48 Hour		<input type="checkbox"/> Advance Agreement Required		<input type="checkbox"/> Express Service		
To be completed by Sampler. Please remember to record this information on the container label.										
<b>ELN Number</b>	<b>*Date</b>	<b>*Time</b>	<b>*Comp.</b>	<b>*Grab</b>	<b>*Matrix</b>	<b>*Sampling Location</b>				
213072	6/26/01	1620		✓	140	WRL - L.O.L.				
<b>Containers Dispensed by:</b>			<b>Date</b>	<b>Time</b>	<b>Container(s) Received by:</b>		<b>Date</b>	<b>Time</b>		
			6/27/01	16:25						
<b>Relinquished by:</b>			<b>Date</b>	<b>Time</b>	<b>Received by:</b>		<b>Date</b>	<b>Time</b>		
			6/27/01	16:56						
<b>Relinquished by:</b>			<b>Date</b>	<b>Time</b>	<b>Received by:</b>		<b>Date</b>	<b>Time</b>		
<b>Relinquished by:</b>			<b>Date</b>	<b>Time</b>	<b>Received by:</b>		<b>Date</b>	<b>Time</b>		
<b>Relinquished by:</b>			<b>Date</b>	<b>Time</b>	<b>Received at Lab by:</b>		<b>Date</b>	<b>Time</b>		





**Environmental**  
LABORATORY SERVICES  
7280 Caswell Street, Hancock Air Park North Syracuse, NY 13212  
(315) 458-8033 FAX (315) 458-0249 (800) 843-8265

CHAIN OF CUSTODY RECORD  
and Authorization for Analysis

Name <u>Scott Graham</u>		Title					Analyses Required, Remarks, and/or Special Instructions	
Company <u>E.A. Engineering Inc</u>		Dept.			Container Type/Preservative			
Address <u>207 P.O. Rd.</u>		Job/PO No.			Plastic/HNO <sub>3</sub>	Plastic/NaOH+Ascorbic Acid		Other: (specify)
City, State, Zip <u>East Syracuse, NY 13057</u>		Telephone No. <u>441-4200</u>	Advance Agreement Required <input type="checkbox"/> 1 Week <input type="checkbox"/> 48 Hour		Plastic/H <sub>2</sub> SO <sub>4</sub>	Glass/No Preservative		Amber Glass/No Pres.
<input type="checkbox"/> Telephone Results <input type="checkbox"/> Fax Results The following services may result in additional charges: <input type="checkbox"/> Express Service		Fax No. <u>441-4200</u>	To be completed by Sampler. Please remember to record this information on the container label. Containers		Glass/Sodium Thiosulfate	Amber Glass/H <sub>2</sub> SO <sub>4</sub>		
ELS Number	*Date	*Time	*Comp.	*Grab	*Matrix	*Sampling Location		
<u>213073</u>	<u>6/12/01</u>	<u>1600</u>		<u>✓</u>	<u>430</u>	<u>WRL-SSOL</u>		
<u>213074</u>	↓	↓		↓	↓			
<u>213075</u>	↓	↓		↓	↓			
<u>213076</u>	↓	↓		↓	↓			
<u>213099</u>	↓	↓		↓	↓			

Containers Dispensed by: <u>Scott Graham</u>	Date <u>6/12/01</u>	Time <u>10:25</u>	Container(s) Received by:	Date	Time
Relinquished by: <u>Scott Graham</u>	Date <u>6/12/01</u>	Time <u>1650</u>	Received by:	Date	Time
Relinquished by:	Date	Time	Received by:	Date	Time
Relinquished by:	Date	Time	Received by:	Date	Time
Relinquished by:	Date	Time	Received at Lab by:	Date <u>6/12/01</u>	Time <u>11:00</u>

White - LABORATORY      Pink - CLIENT

Canary - ACCOMPANIES RESULTS

Please return completed form and all sample containers to Environmental Laboratory Services.



**Environmental**  
LABORATORY SERVICES  
7280 Caswell Street, Hancock Air Park North Syracuse, NY 13212  
(315) 458-8033 FAX (315) 458-0249 (800) 843-8265

# CHAIN OF CUSTODY RECORD and Authorization for Analysis

Name		Title		Express Service		Advance Agreement Required		Containers		Container Type/Preservative									Analyses Required, Remarks, and/or Special Instructions
Company		Dept.		Job/PO No.		Number of Containers		To be completed by Sampler. Please remember to record this information on the container label.		Plastic/HNO <sub>3</sub>	Plastic/H <sub>2</sub> SO <sub>4</sub>	Plastic/NaOH+Ascorbic Acid	Plastic/NaOH+Zinc Acetate	Glass/No Preservative	Glass/Sodium Thiosulfate	Amber Glass/No Pres.	Amber Glass/H <sub>2</sub> SO <sub>4</sub>	Other: (specify)	
213077		6/14/01		1600		✓		M40 WRL-SSOL											
Containers Dispensed by:		Date 6/14/01		Time 10:25		Container(s) Received by:				Date		Time		Date		Time			
Relinquished by:		Date 6/14/01		Time 16:50		Received by:				Date		Time		Date		Time			
Relinquished by:		Date		Time		Received by:				Date		Time		Date		Time			
Relinquished by:		Date		Time		Received by:				Date		Time		Date		Time			
Relinquished by:		Date		Time		Received at Lab by:				Date		Time		Date		Time			

White - LABORATORY  
Please return completed form and all sample containers to Environmental Laboratory Services.

Pink - CLIENT  
2217 ELS..202.9310



**Environmental**  
LABORATORY SERVICES  
7280 Caswell Street, Hancock Air Park North Syracuse, NY 13212  
(315) 458-8033 FAX (315) 458-0249 (800) 843-8265

**CHAIN OF CUSTODY RECORD**  
and Authorization for Analysis

Name: <u>Scott Graham</u>		Title:																	
Company: <u>E.A. Engineering</u>		Dept.:																	
Address: <u>732 E. Rd.</u>		Job/PO No.:																	
City, State, Zip: <u>East Syracuse, NY 13057</u>																			
The following services may result in additional charges: <input type="checkbox"/> Telephone Results Telephone No. <u>401-4000</u> Advance Agreement Required <input type="checkbox"/> 1 Week <input type="checkbox"/> 48 Hour <input type="checkbox"/> Fax Results Fax No. _____																			
To be completed by Sampler. Please remember to record this information on the container label.																			
ELS Number	*Date	*Time	*Comp.	*Grab	*Matrix	*Sampling Location	Number of Containers	Plastic/No Preservatives	Plastic/HNO <sub>3</sub>	Plastic/H <sub>2</sub> SO <sub>4</sub>	Plastic/NaOH+Ascorbic Acid	Plastic/NaOH+Zinc Acetate	Glass/No Preservative	Glass/Sodium Thiosulfate	Amber Glass/No Pres.	Amber Glass/H <sub>2</sub> SO <sub>4</sub>	Other: (specify)	Analyses Required, Remarks, and/or Special Instructions	
213018	6/26/01	0850		✓	170	WRL - MW4B-001	1	Amber Glass/H <sub>2</sub> SO <sub>4</sub>											
213019	↓	↓		↓	↓		1	Plastic/H <sub>2</sub> SO <sub>4</sub>											
213020	↓	↓		↓	↓		1	Plastic/H <sub>2</sub> SO <sub>4</sub>											
213021	↓	↓		↓	↓		1	Plastic/H <sub>2</sub> SO <sub>4</sub>											
213022	↓	↓		↓	↓		1	Plastic/H <sub>2</sub> SO <sub>4</sub>											
Containers Dispensed by: <u>[Signature]</u> Date: <u>6-13-01</u> Time: <u>10:25</u> Container(s) Received by:																			
Relinquished by: <u>[Signature]</u> Date: <u>6/14/01</u> Time: <u>0909</u> Received by:																			
Relinquished by: _____ Date: _____ Time: _____ Received by:																			
Relinquished by: _____ Date: _____ Time: _____ Received by:																			
Relinquished by: _____ Date: _____ Time: _____ Received at Lab by: <u>[Signature]</u>																			
Your signature authorizes ELS to analyze the sample(s) as indicated.																			
Sampler Signature: _____ Date: <u>6/14/01</u> Time: _____																			



**Environmental**  
LABORATORY SERVICES  
7280 Caswell Street, Hancock Air Park North Syracuse, NY 13212  
(315) 458-8033 FAX (315) 458-0249 (800) 843-8265

# CHAIN OF CUSTODY RECORD

## and Authorization for Analysis

Name: <u>Scott Graham</u>		Title: _____	Analyses Required, Remarks, and/or Special Instructions														
Company: <u>E.A. Engineering Science</u>		Dept: _____	Other: (specify) _____														
Address: <u>797 E. Rd.</u>		Job/PO No: _____	Amber Glass/H <sub>2</sub> SO <sub>4</sub> _____														
City, State, Zip: <u>East Syracuse, NY 13057</u>		Express Service <input type="checkbox"/>	Amber Glass/No Pres. _____														
<b>The following services may result in additional charges:</b> <input type="checkbox"/> Telephone Results Telephone No. <u>431 4280</u> Advance Agreement Required <input type="checkbox"/> 1 Week <input type="checkbox"/> 48 Hour <input type="checkbox"/> Fax Results Fax No. _____		Number of Containers	Glass/Sodium Thiosulfate _____														
To be completed by Sampler. Please remember to record this information on the container label.		*Date	*Time	*Comp.	*Grab	*Matrix	*Sampling Location	Glass/No Preservative _____									
ELS Number								Plastic/NaOH+Zinc Acetate _____									
<u>213082</u>		<u>6/17/01</u>	<u>0850</u>		<input checked="" type="checkbox"/>	<u>H<sub>2</sub>O WRL-MWYB-0001</u>	Plastic/NaOH+Ascorbic Acid _____										
								Plastic/H <sub>2</sub> SO <sub>4</sub> _____									
								Plastic/HNO <sub>3</sub> _____									
								Plastic/No Preservatives _____									
								Plastic/H <sub>2</sub> SO <sub>4</sub> _____									
								Plastic/NaOH+Ascorbic Acid _____									
								Plastic/NaOH+Zinc Acetate _____									
								Glass/No Preservative _____									
								Glass/Sodium Thiosulfate _____									
								Amber Glass/No Pres. _____									
								Amber Glass/H <sub>2</sub> SO <sub>4</sub> _____									
								Other: (specify) _____									

Containers Dispensed by: _____	Date <u>6-17-01</u>	Time <u>10:25</u>	Container(s) Received by: _____	Date _____	Time _____
Relinquished by: _____	Date <u>6-17-01</u>	Time <u>0909</u>	Received by: _____	Date _____	Time _____
Relinquished by: _____	Date _____	Time _____	Received by: _____	Date _____	Time _____
Relinquished by: _____	Date _____	Time _____	Received by: _____	Date _____	Time _____
Relinquished by: _____	Date _____	Time _____	Received at Lab by: _____	Date <u>6-17-01</u>	Time <u>1:00</u>

Your signature authorizes ELS to analyze the sample(s) as indicated.

Sampler Signature: \_\_\_\_\_

White - LABORATORY Please return completed form and all sample containers to Environmental Laboratory Services.

Canary - ACCOMPANIES RESULTS

Pink - CLIENT 2217.ELS..202.9310



**Environmental**  
LABORATORY SERVICES  
7280 Caswell Street, Hancock Air Park North Syracuse, NY 13212  
(315) 458-8033 FAX (315) 458-0249 (800) 843-8265

**CHAIN OF CUSTODY** nECoRL  
and Authorization for Analysis

Name	Title	
Company	Dept.	
Address	Job/PO No.	
City, State, Zip	City, State, Zip	

**The following services may result in additional charges:**  
 Telephone Results Telephone No. \_\_\_\_\_  
 Fax Results Telephone No. \_\_\_\_\_  
 1 Week Express Service  48 Hour Advance Agreement Required

ELS Number	*Date	*Time	*Comp.	*Grab	*Matrix	*Sampling Location	Containers										Analyses Required, Remarks, and/or Special Instructions													
							Plastic/No Preservatives	Plastic/HNO <sub>3</sub>	Plastic/H <sub>2</sub> SO <sub>4</sub>	Plastic/NaOH+Ascorbic Acid	Plastic/NaOH+Zinc Acetate	Glass/No Preservative	Glass/Sodium Thiosulfate	Amber Glass/No Pres.	Amber Glass/H <sub>2</sub> SO <sub>4</sub>	Other: (specify)														
213032	6/19/01	1337		✓	140	WRL- mWSB-0601	Amber	Plastic/HNO <sub>3</sub>	Plastic/H <sub>2</sub> SO <sub>4</sub>	Plastic/NaOH+Ascorbic Acid	Plastic/NaOH+Zinc Acetate	Glass/No Preservative	Glass/Sodium Thiosulfate	Amber Glass/No Pres.	Amber Glass/H <sub>2</sub> SO <sub>4</sub>	Other: (specify)	Plastic/No Preservatives	Plastic/HNO <sub>3</sub>	Plastic/H <sub>2</sub> SO <sub>4</sub>	Plastic/NaOH+Ascorbic Acid	Plastic/NaOH+Zinc Acetate	Glass/No Preservative	Glass/Sodium Thiosulfate	Amber Glass/No Pres.	Amber Glass/H <sub>2</sub> SO <sub>4</sub>	Other: (specify)	Analyses Required, Remarks, and/or Special Instructions			
213034							Plastic/HNO <sub>3</sub>	Plastic/H <sub>2</sub> SO <sub>4</sub>	Plastic/NaOH+Ascorbic Acid	Plastic/NaOH+Zinc Acetate	Glass/No Preservative	Glass/Sodium Thiosulfate	Amber Glass/No Pres.	Amber Glass/H <sub>2</sub> SO <sub>4</sub>	Other: (specify)															
213035							Plastic/HNO <sub>3</sub>	Plastic/H <sub>2</sub> SO <sub>4</sub>	Plastic/NaOH+Ascorbic Acid	Plastic/NaOH+Zinc Acetate	Glass/No Preservative	Glass/Sodium Thiosulfate	Amber Glass/No Pres.	Amber Glass/H <sub>2</sub> SO <sub>4</sub>	Other: (specify)															
213036							Plastic/HNO <sub>3</sub>	Plastic/H <sub>2</sub> SO <sub>4</sub>	Plastic/NaOH+Ascorbic Acid	Plastic/NaOH+Zinc Acetate	Glass/No Preservative	Glass/Sodium Thiosulfate	Amber Glass/No Pres.	Amber Glass/H <sub>2</sub> SO <sub>4</sub>	Other: (specify)															
213037							Plastic/HNO <sub>3</sub>	Plastic/H <sub>2</sub> SO <sub>4</sub>	Plastic/NaOH+Ascorbic Acid	Plastic/NaOH+Zinc Acetate	Glass/No Preservative	Glass/Sodium Thiosulfate	Amber Glass/No Pres.	Amber Glass/H <sub>2</sub> SO <sub>4</sub>	Other: (specify)															

Containers Dispensed by:	Date	Time	Container(s) Received by:	Date	Time
Relinquished by:	Date	Time	Received by:	Date	Time
Relinquished by:	Date	Time	Received by:	Date	Time
Relinquished by:	Date	Time	Received by:	Date	Time
Relinquished by:	Date	Time	Received at Lab by:	Date	Time

White - LABORATORY Please return completed form and all sample containers to Environmental Laboratory Services.  
 Canary - ACCOMPANIES RESULTS  
 Pink - CLIENT  
 2217.EL.S., 202.93.10



**Environmental**  
LABORATORY SERVICES  
7280 Caswell Street, Hancock Air Park North Syracuse, NY 13212  
(315) 458-8033 FAX (315) 458-0249 (800) 843-8265

# CHAIN OF CUSTODY RECORD and Authorization for Analysis

Name: <u>Scott Graham</u>		Title: _____															
Company: <u>E.A. Engineering Solutions</u>		Dept.: _____															
Address: <u>707 E.D. Rd.</u>		Job/PO No.: _____															
City, State, Zip: <u>East Syracuse, NY 13057</u>		_____															
<b>The following services may result in additional charges:</b> <input type="checkbox"/> Telephone Results Telephone No. <u>401-4260</u> Advance Agreement Required <input type="checkbox"/> 1 Week <input type="checkbox"/> 48 Hour <input type="checkbox"/> Fax Results Fax No. _____																	
To be completed by Sampler. Please remember to record this information on the container label.																	
ELS Number	*Date	*Time	*Comp.	*Grab	*Matrix	*Sampling Location	Number of Containers	Container Type/Preservative								Analyses Required, Remarks, and/or Special Instructions  <u>None</u>	
<u>213087</u>	<u>6/17/07</u>	<u>1337</u>		<input checked="" type="checkbox"/>	<u>MO</u>	<u>WRL-MO5B-6601</u>	<u>1</u>	Plastic/HNO <sub>3</sub>	Plastic/H <sub>2</sub> SO <sub>4</sub>	Plastic/NaOH+Ascorbic Acid	Plastic/NaOH+Zinc Acetate	Glass/No Preservative	Glass/Sodium Thiosulfate	Amber Glass/No Pres.	Amber Glass/H <sub>2</sub> SO <sub>4</sub>		Other: (specify)

Containers Dispensed by: [Signature] Date: 6-17-07 Time: 1337 Container(s) Received by: \_\_\_\_\_ Date: \_\_\_\_\_ Time: \_\_\_\_\_

Relinquished by: [Signature] Date: 6/17/07 Time: 0907 Received by: \_\_\_\_\_ Date: \_\_\_\_\_ Time: \_\_\_\_\_

Relinquished by: \_\_\_\_\_ Date: \_\_\_\_\_ Time: \_\_\_\_\_ Received by: \_\_\_\_\_ Date: \_\_\_\_\_ Time: \_\_\_\_\_

Relinquished by: \_\_\_\_\_ Date: \_\_\_\_\_ Time: \_\_\_\_\_ Received by: \_\_\_\_\_ Date: \_\_\_\_\_ Time: \_\_\_\_\_

Your signature authorizes ELS to analyze the sample(s) as indicated.  
 Relinquished by: \_\_\_\_\_ Date: \_\_\_\_\_ Time: \_\_\_\_\_ Received at Lab by: [Signature] Date: 6/17/07 Time: 9:09

Sampler Signature: \_\_\_\_\_ **White - LABORATORY** Please return completed form and all sample containers to Environmental Laboratory Services. **Pink - CLIENT** 2217.ELS.,202.9310



# CHAIN OF CUSTODY RECORD

## and Authorization for Analysis

**Environmental LABORATORY SERVICES**  
 7280 Caswell Street, Hancock Air Park North Syracuse, NY 13212  
 (315) 459-8033 FAX (315) 459-0249 (800) 843-8265

Name: Scott Chapman		Title:					
Company: E.A. Engineering		Dept.:					
Address: 727 Ely Rd		Job/PO No.:					
City, State, Zip: East Syracuse, NY 13057		Telephone No.: 431-4230					
<input type="checkbox"/> Telephone Results    Telephone No. _____ <input type="checkbox"/> Fax Results    Fax No. _____		Advance Agreement Required <input type="checkbox"/> 1 Week <input type="checkbox"/> 48 Hour					
Express Service <b>The following services may result in additional charges:</b>							
To be completed by Sampler. Please remember to record this information on the container label.							
ELS Number	*Date	*Time	*Comp.	*Grab	*Matrix	*Sampling Location	Number of Containers
17455	6/17/01	10:15			Water	WRL - m468B-0601	1
17504							1
17505							1
17506							1
17507							1
Container Type/Preservative Plastic/HNO <sub>3</sub> Plastic/H <sub>2</sub> SO <sub>4</sub> Plastic/NaOH+Ascorbic Acid    Plastic/NaOH+Zinc Acetate    Glass/No Preservative    Glass/Sodium Thiosulfate    Amber Glass/No Pres.    Amber Glass/H <sub>2</sub> SO <sub>4</sub> Other: (specify)							
Analyses Required, Remarks, and/or Special Instructions							
Containers Dispensed by: [Signature]    Date: 6-17-01    Time: 10:25				Container(s) Received by:			
Relinquished by: [Signature]    Date: 6/17/01    Time: 09:09				Received by:			
Relinquished by: [Signature]    Date: 6/17/01    Time:				Received by:			
Relinquished by: [Signature]    Date:    Time:				Received by:			
Relinquished by: [Signature]    Date:    Time:				Received at Lab by: [Signature]    Date: 6/19/01    Time:			
Your signature authorizes ELS to analyze the sample(s) as indicated.				<b>White - LABORATORY</b> <b>Pink - CLIENT</b>			
Sampler Signature:				Canary - ACCOMPANIES RESULTS    Please return completed form and all sample containers to Environmental Laboratory Services.			







**Environmental LABORATORY SERVICES**  
 7280 Caswell Street, Hancock Air Park North Syracuse, NY 13212  
 (315) 458-8033 FAX (315) 458-0249 (800) 843-8265

**CHAIN OF CUSTODY RECORD**  
 and Authorization for Analysis

Name		Title		Company		Dept.		Job/PO No.										
Scott Collins		Lab Manager		E.A. Engineering														
City, State, Zip		East Syracuse, NY 13057																
<b>The following services may result in additional charges:</b> <input type="checkbox"/> Telephone Results Telephone No. _____ Advance Agreement Required <input type="checkbox"/> Fax Results Telephone No. _____ Fax No. _____ <input type="checkbox"/> 1 Week <input type="checkbox"/> 48 Hour Express Service																		
To be completed by Sampler. Please remember to record this information on the container label.																		
ELS Number	Date	*Time	*Comp.	*Grab	*Matrix	*Sampling Location	Number of Containers	Container Type/Preservative			Analyses Required, Remarks, and/or Special Instructions							
								Plastic/No Preservatives	Plastic/HNO <sub>3</sub>	Plastic/NaOH+Ascorbic Acid		Plastic/NaOH+Zinc Acetate	Glass/No Preservative	Glass/Sodium Thiosulfate	Amber Glass/No Pres.	Amber Glass/H <sub>2</sub> SO <sub>4</sub>	Other: (specify)	
213093	6/13/04			✓	40	WEL-MANUP-0601	1	Amber									Phenol	
213094				↓			1	Plastic									H <sub>2</sub> O	
213095				↓			1	Plastic										CO <sub>2</sub> / NaOH / Thiosulfate
213096				↓			1	Plastic										Sulfate
213097							1	Plastic										Water
Containers Dispensed by:		Date 6/12/04		Time 12:25		Container(s) Received by:		Date		Time								
Relinquished by:		Date 6/14/04		Time 09:08		Received by:		Date		Time								
Relinquished by:		Date		Time		Received by:		Date		Time								
Relinquished by:		Date		Time		Received by:		Date		Time								
Relinquished by:		Date		Time		Received at Lab by:		Date		Time								
Your signature authorizes ELS to analyze the sample(s) as indicated.		Date		Time		Received at Lab by:		Date		Time								
Sampler Signature:		Date		Time		Received at Lab by:		Date		Time								

White - LABORATORY  
 Please return completed form and all sample containers to Environmental Laboratory Services.

Canary - ACCOMPANIES RESULTS  
 Pink - CLIENT

White - LABORATORY  
 Please return completed form and all sample containers to Environmental Laboratory Services.



**Environmental  
LABORATORY SERVICES**  
7280 Caswell Street, Hancock Air Park North Syracuse, NY 13212  
(315) 458-8033 FAX (315) 458-0249 (800) 843-8265

# CHAIN OF CUSTODY RECORD and Authorization for Analysis

Name <u>Scott Graham</u>		Title _____	Analyses Required, Remarks, and/or Special Instructions												
Company <u>E.A. Engineering Science</u>		Dept. _____													
Address <u>707 Fly Rd.</u>		Job/PO No. _____													
City, State, Zip <u>East Syracuse, NY 13057</u>		_____													
<b>The following services may result in additional charges:</b> <input type="checkbox"/> Telephone Results Telephone No. <u>431 4220</u> Advance Agreement Required <input type="checkbox"/> Fax Results Fax No. _____ <input type="checkbox"/> 1 Week <input type="checkbox"/> 48 Hour Express Service															
To be completed by Sampler. Please remember to record this information on the container label. Number of Containers _____															
ELS Number	*Date	*Time	*Comp.	*Grab	*Matrix	*Sampling Location	Plastic/HNO <sub>3</sub>	Plastic/H <sub>2</sub> SO <sub>4</sub>	Plastic/NaOH+Ascorbic Acid	Plastic/NaOH+Zinc Acetate	Glass/No Preservative	Glass/Sodium Thiosulfate	Amber Glass/No Pres.	Amber Glass/H <sub>2</sub> SO <sub>4</sub>	Other: (specify)
213097	6/13/01			✓	H <sub>2</sub> O	ORL-MADUP-0601									
Containers Dispensed by: <u>[Signature]</u>		Date <u>6.12.01</u>	Time <u>10:25</u>	Container(s) Received by:		Date	Time								
Relinquished by: <u>[Signature]</u>		Date <u>6/14/01</u>	Time <u>0905</u>	Received by:		Date	Time								
Relinquished by:		Date	Time	Received by:		Date	Time								
Relinquished by:		Date	Time	Received by:		Date	Time								
Relinquished by:		Date	Time	Received at Lab by: <u>[Signature]</u>		Date <u>6/14/01</u>	Time <u>9:00 AM</u>								
Your signature authorizes ELS to analyze the sample(s) as indicated.															
Sampler Signature:		<b>White - LABORATORY</b> Please return completed form and all sample containers to Environmental Laboratory Services.													
		<b>Pink - CLIENT</b> 2217.ELS..202.9310													



# CHAIN OF CUSTODY RECORD

## and Authorization for Analysis

**Environmental LABORATORY SERVICES**  
 7280 Caswell Street, Hancock Air Park North Syracuse, NY 13212  
 (315) 458-8033 FAX (315) 458-0249 (800) 843-8265

Name: Scott Graham Title: \_\_\_\_\_  
 Company: E.A. Engineering Dept.: \_\_\_\_\_  
 Address: 702 E. Rd. Job/PO No.: \_\_\_\_\_  
 City, State, Zip: East Syracuse, NY 13057

**The following services may result in additional charges:**  
 Telephone Results Telephone No. 471-4100 Advance Agreement Required  1 Week  48 Hour  
 Fax Results Fax No. \_\_\_\_\_

To be completed by Sampler. Please remember to record this information on the container label.

ELS Number	*Date	*Time	*Comp.	*Grab	*Matrix	*Sampling Location	Number of Containers	Container Type/Preservative								Analyses Required, Remarks, and/or Special Instructions						
								Plastic/HNO <sub>3</sub>	Plastic/H <sub>2</sub> SO <sub>4</sub>	Plastic/NaOH+Ascorbic Acid	Plastic/NaOH+Zinc Acetate	Glass/No Preservative	Glass/Sodium Thiosulfate	Amber Glass/No Pres.	Amber Glass/H <sub>2</sub> SO <sub>4</sub>		Other: (specify)					
213018	6/13/01	1325		✓	None	WRL MW1B-02.01	1	Plastic/No Preservatives														
213019							1															
213100							1															
213101							1															
213102							1															

Containers Dispensed by: [Signature] Date: 6-12-01 Time: 10:25 Container(s) Received by: \_\_\_\_\_ Date: \_\_\_\_\_ Time: \_\_\_\_\_  
 Relinquished by: [Signature] Date: 6/14/01 Time: 08:09 Received by: \_\_\_\_\_ Date: \_\_\_\_\_ Time: \_\_\_\_\_  
 Relinquished by: \_\_\_\_\_ Date: \_\_\_\_\_ Time: \_\_\_\_\_ Received by: \_\_\_\_\_ Date: \_\_\_\_\_ Time: \_\_\_\_\_  
 Relinquished by: \_\_\_\_\_ Date: \_\_\_\_\_ Time: \_\_\_\_\_ Received by: \_\_\_\_\_ Date: \_\_\_\_\_ Time: \_\_\_\_\_  
 Relinquished by: \_\_\_\_\_ Date: \_\_\_\_\_ Time: \_\_\_\_\_ Received at Lab by: [Signature] Date: 6/14/01 Time: 08:09





**Environmental**  
LABORATORY SERVICES

7280 Caswell Street, Hancock Air Park North Syracuse, NY 13212  
(315) 458-8033 FAX (315) 458-0249 (800) 843-8265

**CHAIN OF CUSTODY RECORD**  
and Authorization for Analysis

Name	Scott, William		Title					
Company	Eco-Protection Inc.				Dept.			
Address	327 J. St.							
City, State, Zip	East Syracuse, NY 13057				Job/PO No.			
<b>The following services may result in additional charges:</b>								
<input type="checkbox"/> Telephone Results <input type="checkbox"/> Fax Results		Telephone No. 401-4220 Fax No. _____		Express Service Advance Agreement Required <input type="checkbox"/> 1 Week <input type="checkbox"/> 48 Hour				
To be completed by Sampler. Please remember to record this information on the container label.								
ELS Number	*Date	*Time	*Comp.	*Grab	*Matrix	*Sampling Location	Number of Containers	
							Plastic/HNO <sub>3</sub>	Plastic/H <sub>2</sub> SO <sub>4</sub>
213103	6/23/05	1405		✓	As	WRL - MW1B-0601	1	
213104	↓	↓			↓	↓	1	
213105	↓	↓			↓	↓	1	
213106	↓	↓			↓	↓	1	
213107	↓	↓			↓	↓	1	

Container Type/Preservative	Analyses Required, Remarks, and/or Special Instructions
Plastic/No Preservatives	
Plastic/HNO <sub>3</sub>	
Plastic/H <sub>2</sub> SO <sub>4</sub>	
Plastic/NaOH+Ascorbic Acid	
Plastic/NaOH+Zinc Acetate	
Glass/No Preservative	
Glass/Sodium Thiosulfate	
Amber Glass/No Pres.	
Amber Glass/H <sub>2</sub> SO <sub>4</sub>	
Other: (specify)	

Containers Dispensed by:	Date	Time	Container(s) Received by:	Date	Time
William Scott	6-11-01	14:23			
William Scott	6/23/05	08:09			

Relinquished by:	Date	Time	Received by:	Date	Time
William Scott					

Your signature authorizes ELS to analyze the sample(s) as indicated.

White - LABORATORY      Pink - CLIENT

Sampller Signature: \_\_\_\_\_      Date: 6/23/05      Time: 08:09

Please return completed form and all sample containers to Environmental Laboratory Services.  
2217.ELS..202.9910



**Environmental LABORATORY SERVICES**  
 7280 Caswell Street, Hancock Air Park North Syracuse, NY 13212  
 (315) 458-8033 FAX (315) 458-0249 (800) 843-8265

# CHAIN OF CUSTODY RECORD and Authorization for Analysis

Name	Company	Address	City, State, Zip	Title	Dept.	Job/PO No.	Container Type/Preservative							Analyses Required, Remarks, and/or Special Instructions							
Name: Scott Johnson Company: E.A. Engineering Science Address: 302 D. Rd. City, State, Zip: East Syracuse, NY 13050							<input type="checkbox"/> Telephone Results    Telephone No. 421 4200    Advance Agreement Required <input type="checkbox"/> Fax Results    Fax No. <input type="checkbox"/> 1 Week <input type="checkbox"/> 48 Hour    Express Service		Number of Containers: _____ To be completed by Sampler. Please remember to record this information on the container label.												
ELN Number	*Date	*Time	*Comp.	*Grab	*Matrix	*Sampling Location	Plastic/HNO <sub>3</sub>	Plastic/H <sub>2</sub> SO <sub>4</sub>	Plastic/NaOH+Ascorbic Acid	Plastic/NaOH+Zinc Acetate	Glass/No Preservative	Glass/Sodium Thiosulfate	Amber Glass/No Pres.	Amber Glass/H <sub>2</sub> SO <sub>4</sub>	Other: (Specify)						
213107	6/12/01	1405		✓	H <sub>2</sub> O	WRL - MWRB - C601															
Containers Dispensed by: <i>SP Johnson</i> Date: 6/12/01    Time: 10:25    Container(s) Received by: Relinquished by: <i>John Keyes</i> Date: 6/14/01    Time: 0809    Received by: Relinquished by:    Date:    Time:    Received by: Relinquished by:    Date:    Time:    Received by: Relinquished by:    Date:    Time:    Received by:																					
Your signature authorizes ELS to analyze the sample(s) as indicated.							Date: 6/14/01    Time: 11:00														
Sampler Signature: _____							White - LABORATORY    Please return completed form and all sample containers to Environmental Laboratory Services. Canary - ACCOMPANIES RESULTS Pink - CLIENT    2217.ELS..202.9310														



**Environmental LABORATORY SERVICES**  
 7280 Caswell Street, Hancock Air Park North Syracuse, NY 13212  
 (315) 458-8033 FAX (315) 458-0249 (800) 843-8265

**CHAIN OF CUSTODY RECORD**  
 and Authorization for Analysis

Name		Title		Company		Dept.		Job/PO No.											
White - Laboratory		E.A. Engineering		E.A. Engineering															
Address		City, State, Zip		Telephone No.		Fax No.		Number of Containers											
727 E. Rd.		East Syracuse, NY 13057		431 4280				1											
<b>The following services may result in additional charges:</b> <input type="checkbox"/> Telephone Results    Telephone No. _____    Advance Agreement Required <input type="checkbox"/> Fax Results    Fax No. _____ <input type="checkbox"/> 1 Week <input type="checkbox"/> 48 Hour <input type="checkbox"/> Express Service																			
To be completed by Sampler. Please remember to record this information on the container label.																			
ELN Number	*Date	*Time	*Comp.	*Grab	*Matrix	*Sampling Location	Plastic/No Preservatives	Plastic/HNO <sub>3</sub>	Plastic/H <sub>2</sub> SO <sub>4</sub>	Plastic/NaOH+Ascorbic Acid	Plastic/NaOH+Zinc Acetate	Glass/No Preservative	Glass/Sodium Thiosulfate	Amber Glass/No Pres.	Amber Glass/H <sub>2</sub> SO <sub>4</sub>	Other: (specify)	Analyses Required, Remarks, and/or Special Instructions		
21305	6/19/01	1450		✓	As	well - mw28-001													
21309																			
21310																			
21311																			
21312																			
21313																			
21314																			
21315																			
21316																			
Containers Dispensed by:		Date		Time		Container(s) Received by:		Date		Time		Date		Time		Date		Time	
Relinquished by:		Date		Time		Received by:		Date		Time		Date		Time		Date		Time	
Relinquished by:		Date		Time		Received by:		Date		Time		Date		Time		Date		Time	
Relinquished by:		Date		Time		Received by:		Date		Time		Date		Time		Date		Time	
Relinquished by:		Date		Time		Received at Lab by:		Date		Time		Date		Time		Date		Time	
Your signature authorizes ELS to analyze the sample(s) as indicated.		Date		Time		Received at Lab by:		Date		Time		Date		Time		Date		Time	
White - LABORATORY		Date		Time		Received at Lab by:		Date		Time		Date		Time		Date		Time	
Please return completed form and all sample containers to Environmental Laboratory Services.		Date		Time		Received at Lab by:		Date		Time		Date		Time		Date		Time	
Pink - CLIENT		Date		Time		Received at Lab by:		Date		Time		Date		Time		Date		Time	



**Environmental**  
**LABORATORY SERVICES**  
 7280 Caswell Street, Hancock Air Park North Syracuse, NY 13212  
 (315) 458-8033 FAX (315) 458-0249 (800) 843-8265

**CHAIN OF CUSTODY RECORD**  
 and Authorization for Analysis

Name: Scott Graham		Title:	Analyses Required, Remarks, and/or Special Instructions																						
Company: E.S. Environmental Science		Dept.:	Container Type/Preservative																						
Address: 7280 Caswell St.		Job/PO No.:	Plastic/HNO <sub>3</sub>	Plastic/H <sub>2</sub> SO <sub>4</sub>	Plastic/NaOH+Ascorbic Acid	Plastic/NaOH+Zinc Acetate	Glass/No Preservative	Glass/Sodium Thiosulfate	Amber Glass/No Pres.	Amber Glass/H <sub>2</sub> SO <sub>4</sub>	Other: (specify)														
City, State, Zip: East Syracuse, NY 13057			Number of Containers																						
<input type="checkbox"/> Telephone Results Telephone No. 458-4260 <input type="checkbox"/> Fax Results Fax No. _____			<input type="checkbox"/> Advance Agreement Required <input type="checkbox"/> 1 Week <input type="checkbox"/> 48 Hour Express Service																						
To be completed by Sampler. Please remember to record this information on the container label.																									
ELS Number	*Date	*Time	*Comp.	*Grab	*Matrix	*Sampling Location																			
213112	6/19/01	1450		✓	1300	WRL-PAULR-SCA																			
Containers Dispensed by: [Signature]		Date:	6-12-01	Time:	10:25	Container(s) Received by:																			
Relinquished by: [Signature]		Date:	6/19/01	Time:	0909	Received by:																			
Relinquished by:		Date:		Time:		Received by:																			
Relinquished by:		Date:		Time:		Received by:																			
Relinquished by:		Date:		Time:		Received at Lab by:																			
Relinquished by:		Date:		Time:		Received at Lab by:																			
Your signature authorizes ELS to analyze the sample(s) as indicated.																									
Sampler Signature:																									





**Environmental**  
LABORATORY SERVICES  
7280 Caswell Street, Hancock Air Park North Syracuse, NY 13212  
(315) 458-8033 FAX (315) 458-0249 (800) 843-8265

**CHAIN OF CUSTODY RECORD**  
and Authorization for Analysis

Name: Scott Graham		Title:	Analyses Required, Remarks, and/or Special Instructions													
Company: E.A. Engineering Inc		Dept:	Container Type/Preservative								Other: (specify)					
Address: 207 Fly Rd.		Job/PO No.:	Plastic/HNO <sub>3</sub>	Plastic/H <sub>2</sub> SO <sub>4</sub>	Plastic/NaOH+Ascorbic Acid	Plastic/NaOH+Zinc Acetate	Glass/No Preservative	Glass/Sodium Thiosulfate	Amber Glass/No Pres.	Amber Glass/H <sub>2</sub> SO <sub>4</sub>						
City, State, Zip: East Syracuse, NY 13057		Express Service														
<input type="checkbox"/> Telephone Results Telephone No. 431-1230 <input type="checkbox"/> Fax Results Fax No.		Advance Agreement Required														
		<input type="checkbox"/> 1 Week <input type="checkbox"/> 48 Hour														
To be completed by Sampler. Please remember to record this information on the container label.		Number of Containers														
ELS Number	*Date	*Time	*Comp.	*Grab	*Matrix	*Sampling Location										
213116	6/15/01	1425	✓	✓	WAL	WAL-PHOS-C601										
213117	↓	↓	↓	↓	↓	↓										
213118	↓	↓	↓	↓	↓	↓										
213119	↓	↓	↓	↓	↓	↓										
213120	↓	↓	↓	↓	↓	↓										
Containers Dispensed by: [Signature]		Date: 6-17-01	Time: 10:25	Container(s) Received by:												
Relinquished by: [Signature]		Date: 6/17/01	Time: 2:09	Received by:												
Relinquished by:		Date:	Time:	Received by:												
Relinquished by:		Date:	Time:	Received by:												
Relinquished by:		Date:	Time:	Received at Lab by: [Signature]												
Your signature authorizes ELS to analyze the sample(s) as indicated.																
Sampler Signature:																





**Environmental**  
LABORATORY SERVICES  
7280 Caswell Street, Hancock Air Park North Syracuse, NY 13212  
(315) 458-8033 FAX (315) 458-0249 (800) 843-8265

**CHAIN OF CUSTODY RECORD**  
and Authorization for Analysis

Name: Svein Eriksson Title: \_\_\_\_\_  
 Company: CAA Engineering Inc Dept.: \_\_\_\_\_  
 Address: 237 E. 8th St. Job/PO No.: \_\_\_\_\_

City, State, Zip: East Syracuse, NY 13057  
 The following services may result in additional charges:  
 Telephone Results Telephone No. 444 4280 Advance Agreement Required  1 Week  48 Hour  
 Fax Results Fax No. \_\_\_\_\_ Express Service

To be completed by Sampler. Please remember to record this information on the container label.

ELS Number	*Date	*Time	*Comp.	*Grab	*Matrix	*Sampling Location	Number of Containers	Container Type/Preservative								Analyses Required, Remarks, and/or Special Instructions								
								Plastic/HNO <sub>3</sub>	Plastic/H <sub>2</sub> SO <sub>4</sub>	Plastic/NaOH+Ascorbic Acid	Plastic/NaOH+Zinc Acetate	Glass/No Preservative	Glass/Sodium Thiosulfate	Amber Glass/No Pres.	Amber Glass/H <sub>2</sub> SO <sub>4</sub>		Other: (specify)							
213266	6/1/01	0930		✓	H <sub>2</sub> O	well - R801-a-01	1	Plastic/No Preservatives																
213267							1																	
213268							1																	
213269							1																	
213270							1																	

Containers Dispensed by: \_\_\_\_\_ Date: \_\_\_\_\_ Time: \_\_\_\_\_  
 Relinquished by: [Signature] Date: 6/1/01 Time: 0940  
 Relinquished by: \_\_\_\_\_ Date: \_\_\_\_\_ Time: \_\_\_\_\_  
 Relinquished by: \_\_\_\_\_ Date: \_\_\_\_\_ Time: \_\_\_\_\_  
 Relinquished by: \_\_\_\_\_ Date: \_\_\_\_\_ Time: \_\_\_\_\_

Your signature authorizes ELS to analyze the sample(s) as indicated.

Sampler Signature: \_\_\_\_\_ Date: 6/1/01 Time: \_\_\_\_\_

White - LABORATORY  
 Received by: \_\_\_\_\_ Date: \_\_\_\_\_ Time: \_\_\_\_\_  
 Received by: \_\_\_\_\_ Date: \_\_\_\_\_ Time: \_\_\_\_\_  
 Received by: \_\_\_\_\_ Date: \_\_\_\_\_ Time: \_\_\_\_\_  
 Received at Lab by: [Signature] Date: 6/1/01 Time: \_\_\_\_\_

Canary - ACCOMPANIES RESULTS  
 Pink - CLIENT  
 Please return completed form and all sample containers to Environmental Laboratory Services.  
 2217.ELS.:202.9310



**Environmental LABORATORY SERVICES**  
 7280 Caswell Street, Hancock Air Park North Syracuse, NY 13212  
 (315) 458-8033 FAX (315) 458-0249 (800) 843-8265

**CHAIN OF CUSTODY RECORD**  
 and Authorization for Analysis

Name: <u>Scott Graham</u>		Title: _____	Analyses Required, Remarks, and/or Special Instructions													
Company: <u>E.A. Engineering Ltd</u>		Dept: _____														
Address: <u>308 Fl. Rd.</u>		Job/PO No.: _____														
City, State, Zip: <u>East Syracuse, NY 13057</u>																
<b>The following services may result in additional charges:</b> <input type="checkbox"/> Telephone Results Telephone No. <u>511 4200</u> Advance Agreement Required <input type="checkbox"/> Fax Results Fax No. _____ <input type="checkbox"/> 1 Week <input type="checkbox"/> 48 Hour Express Service			Number of Containers													
To be completed by Sampler. Please remember to record this information on the container label.																
ELS Number	*Date	*Time	*Comp.	*Grab	*Matrix	*Sampling Location	Container Type/Preservative					Date	Time			
13271	6/1/01	0945	✓		412	WRL - Sobolow	Plastic/HNO <sub>3</sub>	Plastic/H <sub>2</sub> SO <sub>4</sub>	Plastic/NaOH+Ascorbic Acid	Plastic/NaOH+Zinc Acetate	Glass/No Preservative	Glass/Sodium Thiosulfate	Amber Glass/No Pres.	Amber Glass/H <sub>2</sub> SO <sub>4</sub>	Other: (specify)	
13272	↓	↓			↓	↓										
13273	↓	↓			↓	↓										
13274	↓	↓			↓	↓										
13275	↓	↓			↓	↓										
Containers Dispensed by: _____			Date: _____	Time: _____	Container(s) Received by: _____			Date: _____	Time: _____							
Relinquished by: <u>[Signature]</u>			Date: <u>6/1/01</u>	Time: <u>0940</u>	Received by: _____			Date: _____	Time: _____							
Relinquished by: _____			Date: _____	Time: _____	Received by: _____			Date: _____	Time: _____							
Relinquished by: _____			Date: _____	Time: _____	Received by: _____			Date: _____	Time: _____							
Relinquished by: _____			Date: _____	Time: _____	Received at Lab by: <u>[Signature]</u>			Date: <u>6/1/01</u>	Time: <u>1140</u>							
Your signature authorizes ELS to analyze the sample(s) as indicated.									Pink - CLIENT							
Sampler Signature: _____									2217.ELS..202.9310							

**White - LABORATORY** Please return completed form and all sample containers to Environmental Laboratory Services.  
**Canary - ACCOMPANIES RESULTS**  
**Pink - CLIENT**

**Attachment D**

**Laboratory Form I Documents**

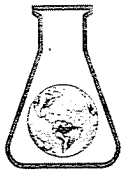

**Environmental**  
LABORATORY SERVICES

7280 Caswell Street, Hancock Air Park, North Syracuse, NY 13212  
(315) 458-8033, FAX (315) 458-0249, (800) 842-4667

Certified in:  
• Connecticut  
• Delaware  
• Maryland  
• Massachusetts  
• New Hampshire  
• New Jersey  
• New York  
• Pennsylvania  
• Rhode Island

E.A. ENGINEERING & SCIENCE TECHNOLOGY  
737 FLY RD.

PROJECT #: 996929  
RECEIVED: 06/14/01

EAST SYRACUSE NY 13057  
ATTN: MR. SCOTT GRAHAM

P.O. #  
CLIENT JOB NUMBER:

TEST PERFORMED	RESULTS	UNITS	DATE PERFORMED	METHOD NUMBER	PERFORMED BY
<b>SAMPLE #: 213063</b>	<b>CLIENT SAMPLE ID: WRL-MW3B-0601</b>			<b>DATE SAMPLED: 06/13/01</b>	
PHENOLICS	<0.002	MG/L	06/22/01	EPA 420.2	DMP
<b>SAMPLE #: 213064</b>	<b>CLIENT SAMPLE ID: WRL-MW3B-0601</b>			<b>DATE SAMPLED: 06/13/01</b>	
NITROGEN, AMMONIA	<1	MG/L	06/26/01	EPA 350.2	DMP
<b>SAMPLE #: 213065</b>	<b>CLIENT SAMPLE ID: WRL-MW3B-0601</b>			<b>DATE SAMPLED: 06/13/01</b>	
CADMIUM	<0.005	MG/L	06/22/01	EPA 6020	NS
CHROMIUM	0.010	MG/L	06/22/01	EPA 6020	NS
IRON	2.6	MG/L	06/20/01	EPA 6010	NS
LEAD	<0.005	MG/L	06/22/01	EPA 6020	NS
MAGNESIUM	12.4	MG/L	06/20/01	EPA 6010	NS
MANGANESE	0.066	MG/L	06/22/01	EPA 6020	NS
METALS DIGESTION	YES		06/15/01	EPA 3005	BRD
SELENIUM	<0.005	MG/L	06/22/01	EPA 6020	NS
SILICA	33.0	MG/L	06/20/01	EPA 6010	10903 (NY)
SODIUM	46.7	MG/L	06/20/01	EPA 6010	NS
THALLIUM	<0.005	MG/L	06/22/01	EPA 6020	NS
ZINC	0.017	MG/L	06/22/01	EPA 6020	NS

E.A. ENGINEERING & SCIENCE TECHNOLOGY  
737 FLY RD.

PROJECT #: 996929  
RECEIVED: 06/14/01

EAST SYRACUSE NY 13057  
ATTN: MR. SCOTT GRAHAM

P.O. #  
CLIENT JOB NUMBER:

TEST PERFORMED	RESULTS	UNITS	DATE PERFORMED	METHOD NUMBER	PERFORMED BY
SAMPLE #: 213066	CLIENT SAMPLE ID: WRL-MW3B-0601			DATE SAMPLED: 06/13/01	
SULFATE	26.8	MG/L	06/15/01	EPA 375.3	DMP
SAMPLE #: 213067	CLIENT SAMPLE ID: WRL-MW3B-0601			DATE SAMPLED: 06/13/01	
CHROMIUM, HEXAVALENT	<0.010*	MG/L @ 10:45	06/14/01	SM18 3500-CR D	DMP
* Sample received over hold time.					
SAMPLE #: 213068	CLIENT SAMPLE ID: WRL-LO1			DATE SAMPLED: 06/12/01	
PHENOLICS	0.009	MG/L	06/28/01	EPA 420.2	DMP
SAMPLE #: 213069	CLIENT SAMPLE ID: WRL-LO1			DATE SAMPLED: 06/12/01	
NITROGEN, AMMONIA	4.01	MG/L	06/26/01	EPA 350.2	DMP
SAMPLE #: 213070	CLIENT SAMPLE ID: WRL-LO1			DATE SAMPLED: 06/12/01	
CADMIUM	<0.005	MG/L	06/22/01	EPA 6020	NS
CHROMIUM	0.630	MG/L	06/22/01	EPA 6020	NS
IRON	<0.025	MG/L	06/20/01	EPA 6010	NS
LEAD	<0.005	MG/L	06/22/01	EPA 6020	NS
MAGNESIUM	<1.0	MG/L	06/20/01	EPA 6010	NS
MANGANESE	<0.005	MG/L	06/22/01	EPA 6020	NS
METALS DIGESTION	YES		06/15/01	EPA 3005	BRD



E.A. ENGINEERING & SCIENCE TECHNOLOGY  
737 FLY RD.

PROJECT #: 996929  
RECEIVED: 06/14/01

EAST SYRACUSE NY 13057  
ATTN: MR. SCOTT GRAHAM

P.O. #  
CLIENT JOB NUMBER:

TEST PERFORMED	RESULTS	UNITS	DATE PERFORMED	METHOD NUMBER	PERFORMED BY
SAMPLE #: 213070	CLIENT SAMPLE ID: WRL-LO1			DATE SAMPLED: 06/12/01	
SELENIUM	0.026	MG/L	06/22/01	EPA 6020	NS
SILICA	8.2	MG/L	06/21/01	EPA 6010	10903 (NY)
SODIUM	70.1	MG/L	06/20/01	EPA 6010	NS
THALLIUM	<0.005	MG/L	06/22/01	EPA 6020	NS
ZINC	<0.005	MG/L	06/22/01	EPA 6020	NS
SAMPLE #: 213071	CLIENT SAMPLE ID: WRL-LO1			DATE SAMPLED: 06/12/01	
SULFATE	12.4	MG/L	06/15/01	EPA 375.3	DMP
SAMPLE #: 213072	CLIENT SAMPLE ID: WRL-LO1			DATE SAMPLED: 06/12/01	
CHROMIUM, HEXAVALENT	0.555	MG/L @13:40	06/13/01	SM18 3500-CR D	DMP
SAMPLE #: 213073	CLIENT SAMPLE ID: WRL-SS01			DATE SAMPLED: 06/12/01	
PHENOLICS	0.212	MG/L	06/28/01	EPA 420.2	DMP
SAMPLE #: 213074	CLIENT SAMPLE ID: WRL-SS01			DATE SAMPLED: 06/12/01	
NITROGEN, AMMONIA	12.2	MG/L	06/26/01	EPA 350.2	DMP
SAMPLE #: 213075	CLIENT SAMPLE ID: WRL-SS01			DATE SAMPLED: 06/12/01	
CADMIUM	<0.005	MG/L	06/22/01	EPA 6020	NS
CHROMIUM	0.011	MG/L	06/22/01	EPA 6020	NS





E.A. ENGINEERING & SCIENCE TECHNOLOGY  
737 FLY RD.

PROJECT #: 996929  
RECEIVED: 06/14/01

EAST SYRACUSE NY 13057  
ATTN: MR. SCOTT GRAHAM

P.O. #  
CLIENT JOB NUMBER:

TEST PERFORMED	RESULTS	UNITS	DATE PERFORMED	METHOD NUMBER	PERFORMED BY
SAMPLE #: 213075      CLIENT SAMPLE ID: WRL-SS01			DATE SAMPLED: 06/12/01		
IRON	1.4	MG/L	06/20/01	EPA 6010	NS
LEAD	<0.005	MG/L	06/22/01	EPA 6020	NS
MAGNESIUM	7.6	MG/L	06/20/01	EPA 6010	NS
MANGANESE	0.038	MG/L	06/22/01	EPA 6020	NS
METALS DIGESTION	YES		06/15/01	EPA 3005	BRD
SELENIUM	0.009	MG/L	06/22/01	EPA 6020	NS
SILICA	30.3	MG/L	06/21/01	EPA 6010	10903 (NY)
SODIUM	94.6	MG/L	06/20/01	EPA 6010	NS
THALLIUM	<0.005	MG/L	06/22/01	EPA 6020	NS
ZINC	<0.005	MG/L	06/22/01	EPA 6020	NS
SAMPLE #: 213076      CLIENT SAMPLE ID: WRL-SS01			DATE SAMPLED: 06/12/01		
SULFATE	498	MG/L	06/15/01	EPA 375.3	DMP
SAMPLE #: 213077      CLIENT SAMPLE ID: WRL-SS01			DATE SAMPLED: 06/12/01		
CHROMIUM, HEXAVALENT	<0.010	MG/L @ 13:40	06/13/01	SM18 3500-CR D	DMP
SAMPLE #: 213078      CLIENT SAMPLE ID: WRL-MW4B-0601			DATE SAMPLED: 06/13/01		
PHENOLICS	<0.002	MG/L	06/22/01	EPA 420.2	DMP



E.A. ENGINEERING & SCIENCE TECHNOLOGY  
737 FLY RD.

PROJECT #: 996929  
RECEIVED: 06/14/01

EAST SYRACUSE NY 13057  
ATTN: MR. SCOTT GRAHAM

P.O. #  
CLIENT JOB NUMBER:

TEST PERFORMED	RESULTS	UNITS	DATE PERFORMED	METHOD NUMBER	PERFORMED BY
SAMPLE #: 213079 CLIENT SAMPLE ID: WRL-MW4B-0601			DATE SAMPLED: 06/13/01		
NITROGEN, AMMONIA	<1	MG/L	06/26/01	EPA 350.2	DMP
SAMPLE #: 213080 CLIENT SAMPLE ID: WRL-MW4B-0601			DATE SAMPLED: 06/13/01		
CADMIUM	<0.005	MG/L	06/22/01	EPA 6020	NS
CHROMIUM	0.200	MG/L	06/22/01	EPA 6020	NS
IRON	5.9	MG/L	06/20/01	EPA 6010	NS
LEAD	0.014	MG/L	06/22/01	EPA 6020	NS
MAGNESIUM	50.5	MG/L	06/20/01	EPA 6010	NS
MANGANESE	0.107	MG/L	06/22/01	EPA 6020	NS
METALS DIGESTION	YES		06/15/01	EPA 3005	BRD
SELENIUM	<0.005	MG/L	06/22/01	EPA 6020	NS
SILICA	43.2	MG/L	06/20/01	EPA 6010	10903 (NY)
SODIUM	68.5	MG/L	06/20/01	EPA 6010	NS
THALLIUM	<0.005	MG/L	06/22/01	EPA 6020	NS
ZINC	0.089	MG/L	06/22/01	EPA 6020	NS
SAMPLE #: 213081 CLIENT SAMPLE ID: WRL-MW4B-0601			DATE SAMPLED: 06/13/01		
SULFATE	190	MG/L	06/15/01	EPA 375.3	DMP



E.A. ENGINEERING & SCIENCE TECHNOLOGY  
737 FLY RD.

PROJECT #: 996929  
RECEIVED: 06/14/01

EAST SYRACUSE NY 13057  
ATTN: MR. SCOTT GRAHAM

P.O. #  
CLIENT JOB NUMBER:

TEST PERFORMED	RESULTS	UNITS	DATE PERFORMED	METHOD NUMBER	PERFORMED BY
SAMPLE #: 213082	CLIENT SAMPLE ID: WRL-MW4B-0601			DATE SAMPLED: 06/13/01	
CHROMIUM, HEXAVALENT	0.175*	MG/L @ 10:45	06/14/01	SM18 3500-CR D	DMP
* Sample received over hold time.					
SAMPLE #: 213083	CLIENT SAMPLE ID: WRL-MW5B-0601			DATE SAMPLED: 06/13/01	
PHENOLICS	<0.002	MG/L	06/22/01	EPA 420.2	DMP
SAMPLE #: 213084	CLIENT SAMPLE ID: WRL-MW5B-0601			DATE SAMPLED: 06/13/01	
NITROGEN, AMMONIA	<1	MG/L	06/26/01	EPA 350.2	DMP
SAMPLE #: 213085	CLIENT SAMPLE ID: WRL-MW5B-0601			DATE SAMPLED: 06/13/01	
CADMIUM	<0.005	MG/L	06/22/01	EPA 6020	NS
CHROMIUM	0.007	MG/L	06/22/01	EPA 6020	NS
IRON	0.667	MG/L	06/20/01	EPA 6010	NS
LEAD	<0.005	MG/L	06/22/01	EPA 6020	NS
MAGNESIUM	70.2	MG/L	06/20/01	EPA 6010	NS
MANGANESE	0.051	MG/L	06/22/01	EPA 6020	NS
METALS DIGESTION	YES		06/15/01	EPA 3005	BRD
SELENIUM	<0.005	MG/L	06/22/01	EPA 6020	NS
SILICA	22.7	MG/L	06/20/01	EPA 6010	10903 (NY)
SODIUM	64.4	MG/L	06/20/01	EPA 6010	NS



E.A. ENGINEERING & SCIENCE TECHNOLOGY  
737 FLY RD.

PROJECT #: 996929  
RECEIVED: 06/14/01

EAST SYRACUSE NY 13057  
ATTN: MR. SCOTT GRAHAM

P.O. #  
CLIENT JOB NUMBER:

TEST PERFORMED	RESULTS	UNITS	DATE PERFORMED	METHOD NUMBER	PERFORMED BY
SAMPLE #: 213085	CLIENT SAMPLE ID: WRL-MW5B-0601			DATE SAMPLED: 06/13/01	
THALLIUM	<0.005	MG/L	06/22/01	EPA 6020	NS
ZINC	0.015	MG/L	06/22/01	EPA 6020	NS
SAMPLE #: 213086	CLIENT SAMPLE ID: WRL-MW5B-0601			DATE SAMPLED: 06/13/01	
SULFATE	192	MG/L	06/15/01	EPA 375.3	DMP
SAMPLE #: 213087	CLIENT SAMPLE ID: WRL-MW5B-0601			DATE SAMPLED: 06/13/01	
CHROMIUM, HEXAVALENT	<0.010	MG/L @ 10:45	06/14/01	SM18 3500-CR D	DMP
SAMPLE #: 213088	CLIENT SAMPLE ID: WRL-MW6B-0601			DATE SAMPLED: 06/13/01	
PHENOLICS	<0.002	MG/L	06/22/01	EPA 420.2	DMP
SAMPLE #: 213089	CLIENT SAMPLE ID: WRL-MW6B-0601			DATE SAMPLED: 06/13/01	
NITROGEN, AMMONIA	<1	MG/L	06/26/01	EPA 350.2	DMP
SAMPLE #: 213090	CLIENT SAMPLE ID: WRL-MW6B-0601			DATE SAMPLED: 06/13/01	
CADMIUM	<0.005	MG/L	06/22/01	EPA 6020	NS
CHROMIUM	0.016	MG/L	06/22/01	EPA 6020	NS
IRON	11.9	MG/L	06/20/01	EPA 6010	NS
LEAD	0.006	MG/L	06/22/01	EPA 6020	NS
MAGNESIUM	85.2	MG/L	06/20/01	EPA 6010	NS



E.A. ENGINEERING & SCIENCE TECHNOLOGY  
737 FLY RD.

PROJECT #: 996929  
RECEIVED: 06/14/01

EAST SYRACUSE NY 13057  
ATTN: MR. SCOTT GRAHAM

P.O. #  
CLIENT JOB NUMBER:

TEST PERFORMED	RESULTS	UNITS	DATE PERFORMED	METHOD NUMBER	PERFORMED BY
SAMPLE #: 213090	CLIENT SAMPLE ID: WRL-MW6B-0601			DATE SAMPLED: 06/13/01	
MANGANESE	0.434	MG/L	06/22/01	EPA 6020	NS
METALS DIGESTION	YES		06/15/01	EPA 3005	BRD
SELENIUM	<0.005	MG/L	06/22/01	EPA 6020	NS
SILICA	120	MG/L	06/20/01	EPA 6010	10903 (NY)
SODIUM	67.8	MG/L	06/20/01	EPA 6010	NS
THALLIUM	<0.005	MG/L	06/22/01	EPA 6020	NS
ZINC	0.024	MG/L	06/22/01	EPA 6020	NS
SAMPLE #: 213091	CLIENT SAMPLE ID: WRL-MW6B-0601			DATE SAMPLED: 06/13/01	
SULFATE	299	MG/L	06/15/01	EPA 375.3	DMP
SAMPLE #: 213092	CLIENT SAMPLE ID: WRL-MW6B-0601			DATE SAMPLED: 06/13/01	
CHROMIUM, HEXAVALENT	<0.010	MG/L @ 10:45	06/14/01	SM18 3500-CR D	DMP
SAMPLE #: 213093	CLIENT SAMPLE ID: WRL-MWDUP-0601			DATE SAMPLED: 06/13/01	
PHENOLICS	<0.002	MG/L	06/22/01	EPA 420.2	DMP
SAMPLE #: 213094	CLIENT SAMPLE ID: WRL-MWDUP-0601			DATE SAMPLED: 06/13/01	
NITROGEN, AMMONIA	<1	MG/L	06/26/01	EPA 350.2	DMP



E.A. ENGINEERING & SCIENCE TECHNOLOGY  
737 FLY RD.

PROJECT #: 996929  
RECEIVED: 06/14/01

EAST SYRACUSE NY 13057  
ATTN: MR. SCOTT GRAHAM

P.O. #  
CLIENT JOB NUMBER:

TEST PERFORMED	RESULTS	UNITS	DATE PERFORMED	METHOD NUMBER	PERFORMED BY
SAMPLE #: 213095 CLIENT SAMPLE ID: WRL-MWDUP-0601			DATE SAMPLED: 06/13/01		
CADMIUM	<0.005	MG/L	06/22/01	EPA 6020	NS
CHROMIUM	0.017	MG/L	06/22/01	EPA 6020	NS
IRON	12.2	MG/L	06/20/01	EPA 6010	NS
LEAD	0.006	MG/L	06/22/01	EPA 6020	NS
MAGNESIUM	84.4	MG/L	06/20/01	EPA 6010	NS
MANGANESE	0.439	MG/L	06/22/01	EPA 6020	NS
METALS DIGESTION	YES		06/15/01	EPA 3005	BRD
SELENIUM	<0.005	MG/L	06/22/01	EPA 6020	NS
SILICA	118	MG/L	06/20/01	EPA 6010	10903 (NY)
SODIUM	67.1	MG/L	06/20/01	EPA 6010	NS
THALLIUM	<0.005	MG/L	06/22/01	EPA 6020	NS
ZINC	0.025	MG/L	06/22/01	EPA 6020	NS
SAMPLE #: 213096 CLIENT SAMPLE ID: WRL-MWDUP-0601			DATE SAMPLED: 06/13/01		
SULFATE	316	MG/L	06/15/01	EPA 375.3	DMP
SAMPLE #: 213097 CLIENT SAMPLE ID: WRL-MWDUP-0601			DATE SAMPLED: 06/13/01		
CHROMIUM, HEXAVALENT	<0.010	MG/L @ 10:45	06/14/01	SM18 3500-CR D	DMP



E.A. ENGINEERING & SCIENCE TECHNOLOGY  
737 FLY RD.

PROJECT #: 996929  
RECEIVED: 06/14/01

EAST SYRACUSE NY 13057  
ATTN: MR. SCOTT GRAHAM

P.O. #  
CLIENT JOB NUMBER:

TEST PERFORMED	RESULTS	UNITS	DATE PERFORMED	METHOD NUMBER	PERFORMED BY
SAMPLE #: 213098	CLIENT SAMPLE ID: WRL-MW1B-0601			DATE SAMPLED: 06/13/01	
PHENOLICS	<0.002	MG/L	06/22/01	EPA 420.2	DMP
SAMPLE #: 213099	CLIENT SAMPLE ID: WRL-MW1B-0601			DATE SAMPLED: 06/13/01	
NITROGEN, AMMONIA	<1	MG/L	06/26/01	EPA 350.2	DMP
SAMPLE #: 213100	CLIENT SAMPLE ID: WRL-MW1B-0601			DATE SAMPLED: 06/13/01	
CADMIUM	<0.005	MG/L	06/22/01	EPA 6020	NS
CHROMIUM	<0.005	MG/L	06/22/01	EPA 6020	NS
IRON	0.386	MG/L	06/20/01	EPA 6010	NS
LEAD	<0.005	MG/L	06/22/01	EPA 6020	NS
MAGNESIUM	55.6	MG/L	06/20/01	EPA 6010	NS
MANGANESE	0.628	MG/L	06/22/01	EPA 6020	NS
METALS DIGESTION	YES		06/15/01	EPA 3005	BRD
SELENIUM	<0.005	MG/L	06/22/01	EPA 6020	NS
SILICA	24.7	MG/L	06/20/01	EPA 6010	10903 (NY)
SODIUM	100	MG/L	06/20/01	EPA 6010	NS
THALLIUM	<0.005	MG/L	06/22/01	EPA 6020	NS
ZINC	0.261	MG/L	06/22/01	EPA 6020	NS



E.A. ENGINEERING & SCIENCE TECHNOLOGY  
737 FLY RD.

PROJECT #: 996929  
RECEIVED: 06/14/01

EAST SYRACUSE NY 13057  
ATTN: MR. SCOTT GRAHAM

P.O. #  
CLIENT JOB NUMBER:

TEST PERFORMED	RESULTS	UNITS	DATE PERFORMED	METHOD NUMBER	PERFORMED BY
SAMPLE #: 213101	CLIENT SAMPLE ID: WRL-MW1B-0601			DATE SAMPLED: 06/13/01	
SULFATE	167	MG/L	06/15/01	EPA 375.3	DMP
SAMPLE #: 213102	CLIENT SAMPLE ID: WRL-MW1B-0601			DATE SAMPLED: 06/13/01	
CHROMIUM, HEXAVALENT	<0.010	MG/L @ 10:45	06/14/01	SM18 3500-CR D	DMP
SAMPLE #: 213103	CLIENT SAMPLE ID: WRL-MW7B-0601			DATE SAMPLED: 06/13/01	
PHENOLICS	0.007	MG/L	06/28/01	EPA 420.2	DMP
SAMPLE #: 213104	CLIENT SAMPLE ID: WRL-MW7B-0601			DATE SAMPLED: 06/13/01	
NITROGEN, AMMONIA	<1	MG/L	06/26/01	EPA 350.2	DMP
SAMPLE #: 213105	CLIENT SAMPLE ID: WRL-MW7B-0601			DATE SAMPLED: 06/13/01	
CADMIUM	<0.005	MG/L	06/22/01	EPA 6020	NS
CHROMIUM	0.296	MG/L	06/22/01	EPA 6020	NS
IRON	6.8	MG/L	06/20/01	EPA 6010	NS
LEAD	<0.005	MG/L	06/22/01	EPA 6020	NS
MAGNESIUM	9.3	MG/L	06/20/01	EPA 6010	NS
MANGANESE	0.161	MG/L	06/22/01	EPA 6020	NS
METALS DIGESTION	YES		06/15/01	EPA 3005	BRD
SELENIUM	<0.005	MG/L	06/22/01	EPA 6020	NS
SILICA	60.4	MG/L	06/20/01	EPA 6010	10903 (NY)





E.A. ENGINEERING & SCIENCE TECHNOLOGY  
737 FLY RD.

PROJECT #: 996929  
RECEIVED: 06/14/01

EAST SYRACUSE NY 13057  
ATTN: MR. SCOTT GRAHAM

P.O. #  
CLIENT JOB NUMBER:

TEST PERFORMED	RESULTS	UNITS	DATE PERFORMED	METHOD NUMBER	PERFORMED BY
SAMPLE #: 213105	CLIENT SAMPLE ID: WRL-MW7B-0601			DATE SAMPLED: 06/13/01	
SODIUM	57.1	MG/L	06/20/01	EPA 6010	NS
THALLIUM	<0.005	MG/L	06/22/01	EPA 6020	NS
ZINC	0.014	MG/L	06/22/01	EPA 6020	NS
SAMPLE #: 213106	CLIENT SAMPLE ID: WRL-MW7B-0601			DATE SAMPLED: 06/13/01	
SULFATE	43.1	MG/L	06/15/01	EPA 375.3	DMP
SAMPLE #: 213107	CLIENT SAMPLE ID: WRL-MW7B-0601			DATE SAMPLED: 06/13/01	
CHROMIUM, HEXAVALENT	0.274	MG/L @ 10:45	06/14/01	SM18 3500-CR D	DMP
SAMPLE #: 213108	CLIENT SAMPLE ID: WRL-MW2B-0601			DATE SAMPLED: 06/13/01	
PHENOLICS	<0.002	MG/L	06/28/01	EPA 420.2	DMP
SAMPLE #: 213109	CLIENT SAMPLE ID: WRL-MW2B-0601			DATE SAMPLED: 06/13/01	
NITROGEN, AMMONIA	1.50	MG/L	06/26/01	EPA 350.2	DMP
SAMPLE #: 213110	CLIENT SAMPLE ID: WRL-MW2B-0601			DATE SAMPLED: 06/13/01	
CADMIUM	<0.005	MG/L	06/22/01	EPA 6020	NS
CHROMIUM	0.368	MG/L	06/22/01	EPA 6020	NS
IRON	0.583	MG/L	06/20/01	EPA 6010	NS
LEAD	<0.005	MG/L	06/22/01	EPA 6020	NS



E.A. ENGINEERING & SCIENCE TECHNOLOGY  
737 FLY RD.

PROJECT #: 996929  
RECEIVED: 06/14/01

EAST SYRACUSE NY 13057  
ATTN: MR. SCOTT GRAHAM

P.O. #  
CLIENT JOB NUMBER:

TEST PERFORMED	RESULTS	UNITS	DATE PERFORMED	METHOD NUMBER	PERFORMED BY
SAMPLE #: 213110	CLIENT SAMPLE ID: WRL-MW2B-0601			DATE SAMPLED: 06/13/01	
MAGNESIUM	1.1	MG/L	06/20/01	EPA 6010	NS
MANGANESE	0.024	MG/L	06/22/01	EPA 6020	NS
METALS DIGESTION	YES		06/15/01	EPA 3005	BRD
SELENIUM	0.008	MG/L	06/22/01	EPA 6020	NS
SILICA	7.1	MG/L	06/20/01	EPA 6010	10903 (NY)
SODIUM	48.0	MG/L	06/20/01	EPA 6010	NS
THALLIUM	<0.005	MG/L	06/22/01	EPA 6020	NS
ZINC	0.020	MG/L	06/22/01	EPA 6020	NS
SAMPLE #: 213111	CLIENT SAMPLE ID: WRL-MW2B-0601			DATE SAMPLED: 06/13/01	
SULFATE	15.0	MG/L	06/15/01	EPA 375.3	DMP
SAMPLE #: 213112	CLIENT SAMPLE ID: WRL-MW2B-0601			DATE SAMPLED: 06/13/01	
CHROMIUM, HEXAVALENT	0.360	MG/L @ 10:45	06/14/01	SM18 3500-CR D	DMP
SAMPLE #: 213116	CLIENT SAMPLE ID: WRL-MW8B-0601			DATE SAMPLED: 06/13/01	
PHENOLICS	<0.002	MG/L	06/28/01	EPA 420.2	DMP
SAMPLE #: 213117	CLIENT SAMPLE ID: WRL-MW8B-0601			DATE SAMPLED: 06/13/01	
NITROGEN, AMMONIA	<1	MG/L	06/26/01	EPA 350.2	DMP



E.A. ENGINEERING & SCIENCE TECHNOLOGY  
737 FLY RD.

PROJECT #: 996929  
RECEIVED: 06/14/01

EAST SYRACUSE NY 13057  
ATTN: MR. SCOTT GRAHAM

P.O. #  
CLIENT JOB NUMBER:

TEST PERFORMED	RESULTS	UNITS	DATE PERFORMED	METHOD NUMBER	PERFORMED BY
<b>SAMPLE #: 213118</b>	<b>CLIENT SAMPLE ID: WRL-MW8B-0601</b>			<b>DATE SAMPLED: 06/13/01</b>	
CADMIUM	<0.005	MG/L	06/22/01	EPA 6020	NS
CHROMIUM	0.366	MG/L	06/22/01	EPA 6020	NS
IRON	0.701	MG/L	06/20/01	EPA 6010	NS
LEAD	<0.005	MG/L	06/22/01	EPA 6020	NS
MAGNESIUM	67.1	MG/L	06/20/01	EPA 6010	NS
MANGANESE	0.073	MG/L	06/22/01	EPA 6020	NS
METALS DIGESTION	YES		06/15/01	EPA 3005	BRD
SELENIUM	0.211	MG/L	06/22/01	EPA 6020	NS
SILICA	21.3	MG/L	06/20/01	EPA 6010	10903 (NY)
SODIUM	111	MG/L	06/20/01	EPA 6010	NS
THALLIUM	<0.005	MG/L	06/22/01	EPA 6020	NS
ZINC	0.011	MG/L	06/22/01	EPA 6020	NS
<b>SAMPLE #: 213119</b>	<b>CLIENT SAMPLE ID: WRL-MW8B-0601</b>			<b>DATE SAMPLED: 06/13/01</b>	
SULFATE	434	MG/L	06/15/01	EPA 375.3	DMP
<b>SAMPLE #: 213120</b>	<b>CLIENT SAMPLE ID: WRL-MW8B-0601</b>			<b>DATE SAMPLED: 06/13/01</b>	
CHROMIUM, HEXAVALENT	0.313	MG/L @ 10:45	06/14/01	SM18 3500-CR D	DMP



E.A. ENGINEERING & SCIENCE TECHNOLOGY  
737 FLY RD.

PROJECT #: 996929  
RECEIVED: 06/14/01

EAST SYRACUSE NY 13057  
ATTN: MR. SCOTT GRAHAM

P.O. #  
CLIENT JOB NUMBER:

TEST PERFORMED	RESULTS	UNITS	DATE PERFORMED	METHOD NUMBER	PERFORMED BY
<b>SAMPLE #: 213266</b>	<b>CLIENT SAMPLE ID: WRL-RB01-0601</b>		<b>DATE SAMPLED: 06/14/01</b>		
PHENOLICS	<0.002	MG/L	06/28/01	EPA 420.2	DMP
<b>SAMPLE #: 213267</b>	<b>CLIENT SAMPLE ID: WRL-RB01-0601</b>		<b>DATE SAMPLED: 06/14/01</b>		
NITROGEN, AMMONIA	<1	MG/L	06/26/01	EPA 350.2	DMP
<b>SAMPLE #: 213268</b>	<b>CLIENT SAMPLE ID: WRL-RB01-0601</b>		<b>DATE SAMPLED: 06/14/01</b>		
CADMIUM	<0.005	MG/L	06/22/01	EPA 6020	NS
CHROMIUM	<0.005	MG/L	06/22/01	EPA 6020	NS
IRON	<0.025	MG/L	06/20/01	EPA 6010	NS
LEAD	<0.005	MG/L	06/22/01	EPA 6020	NS
MAGNESIUM	<1.0	MG/L	06/20/01	EPA 6010	NS
MANGANESE	<0.005	MG/L	06/22/01	EPA 6020	NS
METALS DIGESTION	YES		06/15/01	EPA 3005	BRD
SELENIUM	<0.005	MG/L	06/22/01	EPA 6020	NS
SILICA	3.0	MG/L	06/20/01	EPA 6010	10903 (NY)
SODIUM	<1.0	MG/L	06/20/01	EPA 6010	NS
THALLIUM	<0.005	MG/L	06/22/01	EPA 6020	NS
ZINC	<0.005	MG/L	06/22/01	EPA 6020	NS



E.A. ENGINEERING & SCIENCE TECHNOLOGY  
737 FLY RD.

PROJECT #: 996929  
RECEIVED: 06/14/01

EAST SYRACUSE NY 13057  
ATTN: MR. SCOTT GRAHAM

P.O. #  
CLIENT JOB NUMBER:

TEST PERFORMED	RESULTS	UNITS	DATE PERFORMED	METHOD NUMBER	PERFORMED BY
SAMPLE #: 213269	CLIENT SAMPLE ID: WRL-RB01-0601			DATE SAMPLED: 06/14/01	
SULFATE	<2.0	MG/L	06/15/01	EPA 375.3	DMP
SAMPLE #: 213270	CLIENT SAMPLE ID: WRL-RB01-0601			DATE SAMPLED: 06/14/01	
CHROMIUM, HEXAVALENT	<0.010	MG/L @ 10:45	06/14/01	SM18 3500-CR D	DMP
SAMPLE #: 213271	CLIENT SAMPLE ID: WRL-SWB01-0601			DATE SAMPLED: 06/14/01	
PHENOLICS	<0.002	MG/L	06/28/01	EPA 420.2	DMP
SAMPLE #: 213272	CLIENT SAMPLE ID: WRL-SWB01-0601			DATE SAMPLED: 06/14/01	
NITROGEN, AMMONIA	<1	MG/L	06/26/01	EPA 350.2	DMP
SAMPLE #: 213273	CLIENT SAMPLE ID: WRL-SWB01-0601			DATE SAMPLED: 06/14/01	
CADMIUM	<0.005	MG/L	06/22/01	EPA 6020	NS
CHROMIUM	<0.005	MG/L	06/22/01	EPA 6020	NS
IRON	<0.025	MG/L	06/20/01	EPA 6010	NS
LEAD	<0.005	MG/L	06/22/01	EPA 6020	NS
MAGNESIUM	<1.0	MG/L	06/20/01	EPA 6010	NS
MANGANESE	<0.005	MG/L	06/22/01	EPA 6020	NS
METALS DIGESTION	YES		06/15/01	EPA 3005	BRD
SELENIUM	<0.005	MG/L	06/22/01	EPA 6020	NS
SILICA	2.8	MG/L	06/20/01	EPA 6010	10903 (NY)

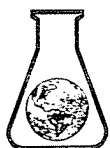

E.A. ENGINEERING & SCIENCE TECHNOLOGY  
737 FLY RD.

PROJECT #: 996929  
RECEIVED: 06/14/01

EAST SYRACUSE NY 13057  
ATTN: MR. SCOTT GRAHAM

P.O. #  
CLIENT JOB NUMBER:

TEST PERFORMED	RESULTS	UNITS	DATE PERFORMED	METHOD NUMBER	PERFORMED BY
SAMPLE #: 213273	CLIENT SAMPLE ID: WRL-SWB01-0601			DATE SAMPLED: 06/14/01	
SODIUM	<1.0	MG/L	06/20/01	EPA 6010	NS
THALLIUM	<0.005	MG/L	06/22/01	EPA 6020	NS
ZINC	<0.005	MG/L	06/22/01	EPA 6020	NS
SAMPLE #: 213274	CLIENT SAMPLE ID: WRL-SWB01-0601			DATE SAMPLED: 06/14/01	
SULFATE	<2.0	MG/L	06/15/01	EPA 375.3	DMP
SAMPLE #: 213275	CLIENT SAMPLE ID: WRL-SWB01-0601			DATE SAMPLED: 06/14/01	
CHROMIUM, HEXAVALENT	<0.010	MG/L @ 10:45	06/14/01	SM18 3500-CR D	DMP

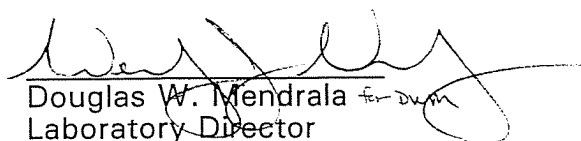
  
Douglas W. Mendrala  
Laboratory Director

07/03/01  
Date

All tests performed under NYS ELAP Laboratory Certification # 11375 unless otherwise stated.



## **Attachment E**

### **Engineering Inspection Checklist**

**LANDFILL CAP INSPECTION  
WITMER ROAD LANDFILL, NIAGARA FALLS, NEW YORK**

EA Personnel: Donald Conan

NYSDEC Personnel: Mike Hinton

Other Personnel: Kevin P. (SLC Superintendent)

Date: 19 June, 2001

Weather: Partly Cloudy, no precipitation, windy, 85° F

**General:**

Don Conan performed a preliminary inspection of the landfill with Mike Hinton and John Kuhn (SLC) on 22 May 2001. The purpose of the preliminary inspection was to identify necessary repair work. A site-walk was conducted and the following items were noted:

- There were three main "washout" locations on the west side of the landfill. Due to the severity of 2 of the wash-out locations, a suggestion was made to consider converting the wash-outs to armored drainage swales,
- The southern access road was rutted and required grading,
- The geotextile was exposed at a few locations along the eastern access road. Run-of-crusher road material will be delivered and placed to provide required cover,
- The NiMO ditch to the east of the landfill required some grading to minimize ponding of water within the ditch.

Between the preliminary inspection date (22 May 2001) and the mobilization date for repair work (18 June 2001) the following issues were raised and resolved as follows:

- It was decided to convert 2 of the 3 "washout" locations to rock-lined drainage swales, the third will be repaired per the original cap design.
- The property owner to the west of the site was concerned about the leachate drain discharging across their property. Redirecting the leachate under the southern fence was added to the repair list.

A preconstruction site-walk was conducted on 18 June 2001 by Don Conan and Mike Hinton to evaluate changes in site conditions from the 22 May 2001 preliminary inspection. Two "washout" locations on the south side of the landfill were added to the repair list at this time.



**1. Inspection of ground surface for exposure of geotextile cover (cap erosion):**

Repair work to the 5 aforementioned "washouts" was approved by NYSDEC.

**2. Inspection of ground surface for differential settlement resulting in soil cracking or ponded water:**

None noted.

**3. Identification of stressed vegetation:**

None noted. The first mowing is scheduled for the second week of July 2001.

**4. Identification of seeps, rooted vegetation (trees), and/or animal burrows:**

Flow from the cap underdrain that daylights at the southwest corner of the site was redirected to flow under the south fence. The repair was approved by NYSDEC. NYSDEC is concerned that the flowrate from the cap underdrain is not decreasing. NYSDEC stated that letting the drain freely discharge was considered a temporary measure and if the flow did not slow down, some action (e.g. cap the drain, or treat the leachate) may be required.

No rooted vegetation or animal burrows were observed during the inspection. However, paw prints from a small dog or coyote were observed in mud near the southwest corner.

**5. Identification of deteriorating equipment (i.e., monitoring wells, fencing, or drainage structures):**

None noted.

**6. Inspection of stormwater drainage swales for erosion, sloughing, or flow-through:**

The ditch along the west side of the site that had been filled in with silt due to wash-out of upgradient topsoil cover was regraded.

**7. Inspection of east side of the landfill (Niagara Mohawk Power Corporation parcel) along the intermittent stream for the presence of erosion or sloughing:**

Regrading of the NiMo ditch was approved by NYSDEC.

**8. Inspection of access roads:**

Repair work to the access road included adding and grading run-of crush stone to areas where the geotextile was exposed. The repair work was approved by NYSDEC