



ecology and environment engineering, p.c.

BUFFALO CORPORATE CENTER

368 Pleasant View Drive, Lancaster, New York 14086
Tel: 716/684-8060, Fax: 716/684-0844

October 8, 2007

Mr. William Welling PE, Project Manager
New York State Department of Environmental Conservation
Division of Environmental Remediation
625 Broadway, 12th Floor
Albany, New York 12233 - 7013

Re: Mr. C's Dry Cleaners Site, Contract # D004442.DC13, Site # 9-15-157
September 2007 Operations, Maintenance, and Monitoring Report

Dear Mr. Welling:

Ecology and Environment Engineering, P.C. (EEEEPC) is pleased to provide the September 2007 Operation, Maintenance, and Monitoring (OM&M) Report for the Mr. C's Dry Cleaners Site, NYSDEC Site # 9-15-157, located in East Aurora, New York. Copies of weekly inspection reports provided from EEEPC's subcontractor Iyer Environmental Group, PLLC (IEG) are provided in Attachment A. Selected pages from the individual analytical data package prepared by Mitkem Laboratories (MTK) is provided as Attachment B. The full analytical report along with QA/QC information will be retained by EEEPC. All analytical results for the report were analyzed at the lowest detection limits in accordance with the standard method. Completed Soil Vapor Mitigation System Inspection Forms and signed access agreements for the First Presbyterian Church and 27 Whaley Avenue locations are provided as Attachment C. Remedial treatment system utility costs for the Mr. C's and Agway sites are provided as Attachment D.

In review of the on-site treatment system operations, monitoring and maintenance for September 2007, EEEPC offers the following comments and highlights:

Operational Summary

Mr. C's Site – Remedial Operations Information

- The treatment system was operational for 100.0% of the period between 8/28/07 and 10/1/07. Table 1 is provided to indicate the monthly operational time of the treatment equipment from the time of system startup.
- The effluent totalizer readings for the month of September 2007 indicate that approximately 804,420 gallons of groundwater were processed through the remedial treatment system for the period 8/28/07 and 10/1/07. Table 2 provides a summary of groundwater volume treated since system start-up. Historical volumes are based on totalizer readings provided by the O&M subcontractor's weekly inspection forms.

Mr. William Welling PE, Project Manager

October 5, 2007

Page 2 of 3

- Filters in the influent bag filter units were checked but not replaced during September 2007. Filter gauge pressure readings observed during weekly inspections ranged between 5 and 9 psi, which is within the 15 psi operational limit indicated in the system O&M Manual.
- Checklists for weekly system inspections from IEG are provided as Attachment A for 8/28/07, 9/4/07, 9/10/07, 9/17/07, 9/24/07 and 10/1/07. Weekly system checks indicated that the air stripper differential pressure remained between 0.04 and 0.05 inches of water with air stripper pressure between 28.0 and 38.0 inches of water during the month of September 2007.
- The feed rate for the sequestering agent has been adjusted weekly between 6.5 and 10 ml/min, based on visual observations of mineral deposits on the stripping trays and analytical results from the effluent samples. The feed rate is being closely monitored by EEEPC and IEG personnel, with the intent of optimizing the feed rate at or near the manufacturer's recommended injection rate of 5 ml/min. Visual inspection of the stripper trays is being performed weekly by IEG during inspections.
- The analytical results from compliance sampling performed on September 4, 2007 (Attachment B) were received by EEEPC on September 25, 2007. A review of the data revealed a PCE effluent level of 2 ppb, which is in compliance with the discharge limit of 10 ppb for the site. All other contaminants detected were either below the level of detection or not detected. Mitkem Laboratories has been requested to provide analytical data to sub ppb accuracy, which will allow more accurate determination of effluent contaminant levels. EEEPC and IEG continue to monitor the status of the effluent PCE levels closely.
- EEEPC and IEG personnel will begin retraction and cleaning of pumps in wells RW-1 through PW-8 in October and November 2007.

Agway Site Remedial Information

- All systems continue to be operational at the site.
- IEG has replaced missing bolts on several of the on-site well caps. In some cases, the threads on the bolt flanges are stripped or bolt tabs broken off. Caps with stripped threads will be chased and rethreaded as required to insure secure fastening of the well cap. Caps damaged beyond repair will be replaced.
- The air sparge system compressor experienced an unscheduled shutdown during the week of September 28 due to an electrical circuit malfunction. IEG electrical personnel rewired portions of the power supply system which were corroded and replaced the compressor switch. The compressor was restarted on October 3, 2007.
- The system treatment shed has been leveled and the compressor has been bolted to the treatment shed floor.
- The soil vapor extraction blower drive motor bearings have been replaced and noise levels for the unit have returned to normal.
- Vents ordered for the treatment shed were delivered the week of September 7, but the retailer sent incorrectly sized units. IEG is planning to install the correctly sized vent units when they become available.

Mr. William Welling PE, Project Manager

October 8, 2007

Page 3 of 3

- The air/water separator drum upstream of the SVE blower has developed a leak at the base. Since the unit is under vacuum, IEG personnel will patch the leak externally to restore the unit to full functionality. A more permanent repair or replacement may be necessary in the future.
- Testing to evaluate the performance of individual SVE system components including sparge points, compressor, manometers and extraction blower will be conducted in October and November 2007 by EEEPC and IEG personnel.
- The Village of East Aurora DPW has installed a temporary metal cover on Monitoring Well MPI-14B which was destroyed during pavement milling operations in August 2007. Paving materials appear to have entered the well, and prevented EEEPC personnel from retrieving a sample during August 2007 as a result. Currently, the operational status of the well is being evaluated by EEEPC.
- Soil Vapor Mitigation systems at the First Presbyterian Church and at 27 Whaley Avenue were inspected by EEEPC personnel on September 12, 2007. The inspections revealed both systems to be in continuous operation at each location. Completed Inspection forms for these installations are provided as Attachment C.

Subslab Depressurization Systems (SSDS)

- Performed routine inspections at both the 27 Whaley Avenue and 9 Paine Avenue (First Presbyterian Church of East Aurora) on September 12, 2007. One SSDS is located at 27 Whaley Avenue and three systems are located in the basement of the Presbyterian Church. Both systems were checked for leakage, vacuum, and general operation. Copy of the individual inspection reports for both facilities is provided as **Attachment C** of the September 2007 report.
- The third floor wall anchors for the vent stack on SSDS #3 at the church have come off the wall. IEG was called to put the anchor repairs on the future maintenance schedule.
- Access agreements for operations and maintenance for both locations were issued to the property owners. Both agreements have been signed and returned. A copy of both signed access agreements are provided in the September 2007 report.

Mr. C's and Agway Energy Usage information

- A copy of the site utility costs from the Mr. C's and Agway remedial operations for September 2007 and year to date are provided as Attachment D.

Analytical Summary – Groundwater

EEEPC and IEG personnel collected samples of influent and effluent groundwater for the reporting period 8/28/07 to 10/1/07 on September 4, 2007. Overall cleanup efficiency for the September 2007 reporting period was 100.00% based on the September 4, 2007 analytical results. The summary of analytical results for the September 4, 2007 sampling events are presented in Table 3.

Mr. William Welling PE, Project Manager

October 8, 2007

Page 3 of 3

The September 2007 monthly analytical results indicate that the treated groundwater effluent is below the site specific Effluent Discharge Limitation Requirements (SPDES Equivalency Permit) for all compounds. The summary of Effluent Discharge Criteria & Analytical Compliance Results are presented in Table 4.

- Approximately 11.54 pounds of chlorinated volatile organic compounds (cVOCs) were removed from the influent groundwater based on calculations using the effluent discharge analytical results during the reporting period. A summary of the calculated pounds of cVOC's by month and by date are located in Table 5. These values are calculated based on effluent totalizer readings and assume that non-detect values given in the analytical data package = 0 $\mu\text{g/L}$, and that the monthly samples are indicative of the influent characteristics and system performance for the entire reporting period.

If you have questions regarding the September 2007 O&M report summary submitted, please call me at 716-684-8060.

Very Truly Yours,

Ecology and Environment Engineering, P. C.



Michael G. Steffan
Project Manager

cc: D. Szymanski, Region 9, NYSDEC - Buffalo w/ attachments
D. Iyer, IEG - w/attachments
D. Miller, EEEPC - Buffalo w/ attachments
J. Kohler, EEEPC - Buffalo w/ attachments
CTF- 002700.DC13.02.01.01

Table 1
Mr. C's Dry Cleaners Site Remediation
Site #9-15-157
System Operational Time

Month	Reporting Hours	Operational Up-time ¹
September 2002 ²	576	100%
October 2002	744	99.33%
November 2002	720	93.41%
December 2002	744	80.65%
January 2003	744	59.15%
February 2003	672	63.39%
March 2003	744	82.39%
April 2003	720	100%
May 2003	744	100%
June 2003	720	90.00%
July 2003	744	100%
August 2003	744	100%
September 1-4, 2003	96	100%
October 22 -29, 2003 ³	168	100%
October 29 - November 25, 2003	648	99%
November 25 - December 29, 2003	816	100%
December 29, 2003 – January 26, 2004	672	100%
January 26 – February 24, 2004	696	100%
February 24 – March 29, 2004	816	99.97%
March 29 – April 26, 2004	672	99.70%
April 26 – May 24, 2004	696	73.70%
May 24 – June 21, 2004	696	99.43%
June 22 – July 26, 2004	840	100%
July 27 – August 23, 2004	672	100%
August 23 - September 27, 2004	840	97.62%
September 27 - October 25, 2004	672	90.33%
October 25 - November 23, 2004	696	92.17%
November 23 - December 27, 2004	816	97.06%
December 27, 2004 - January 31, 2005	840	100%
January 31, 2005 - February 28, 2005	660	98.20%
February 28, 2005 - April 4, 2005	828	98.60%
April 4, 2005 - May 2, 2005	696	87.50%
May 2, 2005 - June 6, 2005	840	91.43%
June 6, 2005 - July 6, 2005	744	86.60%
July 6, 2005 - August 1, 2005	605.5	97.00%
August 1, 2005 - August 29, 2005	696	100.00%
Totals Page 1	25037.5	93.80%

Table 1
Mr. C's Dry Cleaners Site Remediation
Site #9-15-157
System Operational Time

Month	Reporting Hours	Operational Up-time
Totals forward from Page 1 (8/29/05)	25037.5	93.80%
October 3, 2005 - October 31, 2005	672	100.00%
October 31, 2005 - November 28, 2005	672	98.06%
November 28, 2005 - January 3, 2006	854	98.84%
January 3, 2006 - February 6, 2006	816	100.00%
February 6, 2006 - March 6, 2006	696	100.00%
March 6, 2006 - April 3, 2006	696	100.00%
April 3, 2006 - May 1, 2006	689	98.99%
May 1, 2006 - May 30, 2006	689	98.99%
May 31, 2006 - July 3, 2006	812	99.50%
July 3, 2006 - July 30, 2006	624	99.50%
July 30, 2006 - August 28, 2006	696	100.00%
August 28, 2006 - October 2, 2006	834	99.30%
October 2, 2006 - October 30, 2006	628	96.91%
October 30, 2006 - November 27, 2006	672	100.00%
November 27, 2006 - December 27, 2006	672	100.00%
December 27, 2006 - February 6, 2007	983	99.00%
February 6, 2007 - February 26, 2007	480	100.00%
February 26, 2007 - March 26, 2007	672	100.00%
March 26, 2007 - May 1, 2007	888	100.00%
May 1, 2007 - May 29, 2007	696	100.00%
May 29, 2007 - June 25, 2007	643	99.25%
June 25, 2007 - July 24, 2007	696	100.00%
July 25, 2007 - August 28, 2007	792	100.00%
August 28, 2007-September 1, 2007	816	100.00%

Total Hours **42,425.50**
Average Operational Up-time = **94.47%**

NOTES:

1. Up-time based as percentage of total reporting hours
2. Treatment system operated by the Tyree Organization Ltd. from 9/02-9/03.
3. Treatment system operated by O&M Enterprises Inc. from 10/03 - 7/07.
4. Treatment system operated by Iyer Environmental Group from 7/07 to present

Table 2
Mr. C's Dry Cleaners Site Remediation
Site #9-15-157
Monthly Process Water Volumes

Month	Actual Period	Gallons
September 2002 ¹	9/5/02 - 10/2/02	4,362,477
October 2002 ¹	10/2/02 - 11/4/02	4,290,429
November 2002 ¹	11/4/02 - 12/2/02	3,326,126
December 2002 ¹	12/2/02 - 1/7/03	3,349,029
January 2003 ¹	1/7/03 - 2/3/03	1,973,144
February 2003 ¹	2/3/03 - 3/10/03	2,158,771
March 2003 ¹	3/10/03 - 4/7/03	3,263,897
April 2003 ¹	4/7/03 - 5/2/03	2,574,928
May 2003 ¹	5/2/03 - 6/2/03	1,652,538
June 2003 ¹	6/2/03 - 6/30/03	2,002,990
July 2003 ¹	6/30/03 - 7/29/03	2,543,978
August 2003 ¹	7/29/03 - 8/25/03	2,042,424
September 2003 ¹	8/25/03 - 10/22/03	370,446
October 2003 ²	10/22/03 - 10/29/03	67,424
November 2003 ²	10/29/03 - 11/25/03	224,278
December 2003 ²	11/25/03 - 12/29/03	1,496,271
January 2004 ²	12/29/03 - 01/26/04	688,034
February 2004 ²	01/26/04 - 02/24/04	736,288
March 2004 ²	02/24/04 - 03/29/04	2,164,569
April 2004 ²	03/29/04 - 04/26/04	1,741,730
May 2004 ²	4/26/2004 - 5/24/2004	1,408,095
June 2004 ²	5/24/2004 - 6/21/2004	972,132
July 2004 ²	6/22/2004 - 7/26/2004	1,858,790
August 2004 ²	7/27/04 - 8/23/04	1,289,960
September 2004 ²	8/23/04 - 9/27/04	1,201,913
October 2004 ²	9/27/04 - 10/25/04	937,560
November 2004 ²	10/25/04 - 11/23/04	1,098,158
December 2004 ²	11/23/04 - 12/27/04	1,556,063
January 2005 ²	12/27/04 - 1/31/05	1,798,238
February 2005 ²	1/31/05 - 2/28/05	1,271,562
March 2005 ²	2/28/05 - 4/4/05	1,295,692
April 2005 ²	4/4/05 - 5/2/05	1,652,510
May 2005 ²	5/2/05 - 6/6/05	1,423,099
June 2005 ²	6/6/05 - 7/6/05	877,988
July 2005 ²	7/6/05 - 8/1/05	1,283,302
August 2005 ²	8/1/05 - 8/29/05	1,443,195
Total Page 1	9/5/02 - 8/29/05	62,398,028

NOTES:

1. System operated by Tyree Organization Ltd. From 9/02 - 9/03
2. System operated by O&M Enterprises from 9/03 - 7/07
3. System operated by IEG from 7/07 to present

Table 2
Mr. C's Dry Cleaners Site Remediation
Site #9-15-157
Monthly Process Water Volumes

Month	Actual Period	Gallons
Total from Page 1	9/5/02 - 8/29/05	62,398,028
September 2005 ²	8/29/05 - 10/3/05	1,591,248
October 2005 ²	10/3/05 - 10/31/05	1,204,074
November 2005 ²	10/31/05 - 11/28/05	1,038,170
December 2005 ²	11/28/05 - 1/3/06	1,182,854
January 2006 ²	1/3/06 - 2/6/06	1,401,821
February 2006 ²	2/6/06 - 3/6/06	1,927,556
March 2006 ²	3/6/06 - 4/3/06	1,838,541
April 2006 ²	4/3/06 - 5/1/06	1,116,192
May 2006 ²	5/1/06 - 5/30/06	1,053,047
June 2006 ²	5/30/06 - 7/3/06	1,092,786
July 2006 ²	7/3/06 - 7/30/06	813,264
August 2006 ²	7/30/06 - 8/28/06	860,366
September 2006 ²	8/28/06 - 10/2/06	1,107,730
October 2006 ²	10/2/06 - 10/30/06	818,535
November 2006 ²	10/30/06 - 11/27/06	903,959
December 2006 ²	11/27/06 - 12/27/06	967,671
January 2007 ²	12/27/06 - 2/6/07	1,229,105
February 2007 ²	2/6/07 - 2/26/07	913,610
March 2007 ²	2/26/07 - 3/26/07	882,228
April 2007 ²	3/26/07 - 5/1/07	1,127,096
May 2007 ²	5/1/07 - 5/29/07	853,697
June 2007 ²	5/29/07 - 6/25/07	755,060
July 2007 ³	6/25/07 - 7/24/07	785,379
August 2007 ³	7/25/07 - 8/28/07	899,340
September 2007 ³	8/2/07 - 10/1/07	804,420
Total Gallons Treated To Date:		89,565,777

NOTES:

1. System operated by Tyree Organization Ltd. From 9/02 - 9/03
2. System operated by O&M Enterprises from 10/03 - 7/07
3. System operated by IEG PLLC from 7/07 - present

Table 4
 Mr. C's Dry Cleaners Site Remediation
 Site #9-15-157
 Effluent Discharge Criteria & Analytical Compliance Results

Parameter/Analyte	Daily Maximum ¹	Units	September 4, 2007 Effluent Analytical Values - Compliance
Flow	216,000	gpd	23,659.41 gpd ⁶
pH	6.0 - 9.0	standard units	6.9
1,1 Dichloroethene	10	µg/L	ND (<1.0)
1,2 Dichloroethane	10	µg/L	ND (<1.0)
Trichloroethene	10	µg/L	ND (<1.0)
Tetrachloroethene	10	µg/L	2.00
Vinyl Chloride	10	µg/L	ND (<1.0)
Benzene	5	µg/L	ND (<1.0)
Ethylbenzene	5	µg/L	ND (<1.0)
Methylene Chloride	10	µg/L	ND (<1.0)
1,1,1 Trichloroethane	10	µg/L	ND (<1.0)
Toluene	5	µg/L	ND (<1.0)
Methyl-t-Butyl Ether (MTBE)	NA	µg/L	ND (<1.0)
o-Xylene ³	5	µg/L	NA
m, p-Xylene ³	10	µg/L	NA
Total Xylenes	NA	µg/L	ND (<1.0)
Iron, total	600	µg/L	NA ⁹
Aluminum	4,000	µg/L	NA ⁹
Copper	48	µg/L	NA ⁹
Lead	11	µg/L	NA ⁹
Manganese	2,000	µg/L	NA ⁹
Silver	100	µg/L	NA ⁹
Vanadium	28	µg/L	NA ⁹
Zinc	230	µg/L	NA ⁹
Total Dissolved Solids	850	mg/L	NA ⁹
Total Suspended Solids	20	mg/L	NA ⁹
Hardness	N/A	mg/l	490
Cyanide, Free	10	µg/L	NA ⁹

NOTES:

- "Daily Maximum" excerpted from Attachment E of Addendum 1 to the Construction Contract Documents.
- Analytical report did not differentiate between o-Xylene and m, p-Xylene. Total Xylene value reported is given in each line.
- Shaded cells indicate that analytical value exceeds the "Daily Maximum"
- "ND" indicates that the compound was not detected and lists the practical quantitation limit in parentheses.
- "NA" indicates that analyses were not performed and data is unavailable.
- Average flows based on effluent readings taken August 28, 2007 through October 1, 2007. Total gallons: 804,420 divided by 816 operating hours (34 operating days).
- "J" indicates an estimated value below the detection limit.
- "B" indicates analyte found in the associated blank.
- Removed from the required analysis list by NYSDCE Region 9 in February 2005.

Table 3
Mr. C's Dry Cleaners Site Remediation
NYSDEC Site #9-15-157
September 2007 VOC Analytical Summary

Compound	9/4/2007 Sampling Results				
	Influent Concentration*		Effluent Concentration*		Cleanup Efficiency
	(ug/L)		(ug/L)		(%)
Acetone	50	U	ND(<1.0)	U	NA
Benzene	10	U	ND(<1.0)	U	NA
2-Butanone	50	U	ND(<1.0)	U	NA
cis-1, 2-Dichloroethene	13		ND(<1.0)	U	100%
Methylene chloride	10	U	ND(<1.0)	U	NA
Methyl tert-butyl ether (MTBE)	10	U	ND(<1.0)	U	100%
Tetrachloroethene	1500		ND(<1.0)	U	100%
Toluene	10	U	ND(<1.0)	U	NA
Trichloroethene	56		ND(<1.0)	U	100%
Total Xylenes	10	U	ND(<1.0)	U	NA
Sept 4, 2007 TOTALS (in ug/L) = 1719.00			0.0		100%

Notes:

1. "NA" = Not applicable
2. "ND" or "U" = Compound analyzed, but was not detected. Detection limit in parentheses
3. "J" indicates an estimated value below the practical quantitation limit but above the method detection limit.
4. Non-detect values are assumed to be equal to zero for calculation of monthly average concentrations.
5. "D" = Compounds identified in analysis required secondary dilution factoring.

* (<50) - Detection Limit

Table 5
Mr. C's Dry Cleaners Site Remediation
Site #9-15-157
Monthly VOCs Removed From Groundwater

Month	Actual Period	Influent VOCs (µg/L)	Effluent VOCs (µg/L)	VOCs Removed (lbs.)
September 2002 ⁶	9/5/02 - 10/2/02	1297	1	47.2
October 2002 ⁶	10/2/02 - 11/4/02	2000	1	71.6
November 2002 ⁶	11/4/02 - 12/2/02	1685	0	46.8
December 2002 ⁶	12/2/02 - 1/7/03	1586	9	44.1
January 2003 ⁶	1/7/03 - 2/3/03	1803	10	29.5
February 2003 ⁶	2/3/03 - 3/10/03	1985	3	35.7
March 2003 ⁶	3/10/03 - 4/7/03	1990	5	54.1
April 2003 ⁶	4/7/03 - 5/2/03	1656	3	35.5
May 2003 ⁶	5/2/03 - 6/2/03	1623	7	22.3
June 2003 ⁶	6/2/03 - 6/30/03	5787	6	96.6
July 2003 ⁶	6/30/03 - 7/29/03	1356	1	28.8
August 2003 ⁶	7/29/03 - 8/25/03	1263	3	21.5
September 2003 ⁶	8/25/03 - 10/22/03	1263	3	3.9
October 2003 ⁷	10/22/03 - 10/29/03	1693.69	1.47	1.0
November 2003 ⁷	10/29/03 - 11/25/03	2510.83	4.4	4.7
December 2003 ⁷	11/25/03 - 12/29/03	503.3	10.5	6.2
January 2004 ⁷	12/29/03 - 01/26/04	3667	15.8	21.0
February 2004 ⁷	01/26/04 - 02/24/04	3348.6	26.7	20.4
March 2004 ⁷	02/24/04 - 03/29/04	1939.3	4.96	34.9
April 2004 ⁷	03/29/04 - 04/26/04	2255	0.0	32.8
May 2004 ⁷	4/26/2004 - 5/24/2004	2641	13.3	30.9
June 2004 ⁷	5/24/2004 - 6/21/2004	1454	1.7	22.5
July 2004 ⁷	6/22/2004 - 7/26/2004	1313	3.6	20.3
August 2004 ⁷	7/27/04 - 8/23/04	2305	7.4	24.7
September 2004 ⁷	8/23/04 - 9/27/04	1453	6.7	14.5
October 2004 ⁷	9/27/04 - 10/25/04	1504	14.3	11.7
November 2004 ⁷	10/25/04 - 11/23/04	1480	36.42	13.2
December 2004 ^{7,8}	11/23/04 - 12/27/04	1562	132.21	18.6
January 2005 ⁷	12/27/04 - 1/31/05	1264	47.5	18.3
February 2005 ⁹	1/31/05 - 2/28/05	1538	53.2	15.8
March 2005 ⁹	2/28/05 - 4/4/05	931	56.0	9.5
April 2005 ⁹	4/4/05 - 5/2/05	1269	111.7	15.96
May 2005 ⁹	5/2/05 - 6/6/05	1431	319.0	13.20
June 2005 ⁹	6/6/05 - 7/6/05	1126	12	8.16
July 2005 ⁹	7/6/05 - 8/1/05	1575	5.90	16.80
August 2005 ⁹	8/1/05 - 8/29/05	1359	51.26	15.70
Total pounds of VOCs removed from inception to August 2005 =				928.04

Table 5
Mr. C's Dry Cleaners Site Remediation
Site #9-15-157
Monthly VOCs Removed From Groundwater

Month	Actual Period	Influent VOCs (µg/L)	Effluent VOCs (µg/L)	VOCs Removed (lbs.)
Total pounds of VOCs removed from inception to August 2005 =				928.04
September 2005 ⁹	8/29/05 - 10/3/05	1239	0.47	16.50
October 2005 ⁹	10/3/05 - 10/31/05	1454	0.81	14.60
November 2005 ⁹	10/31/05 - 11/28/05	2266	6.80	0.00
December 2005	11/28/05 - 1/3/06	1166	1.30	11.50
January 2006	1/3/06 - 2/6/06	1679	11.87	13.62
February 2006	2/6/06 - 3/6/06	1465	90.20	16.56
March 2006	3/6/06 - 4/4/06	1475	2.00	22.43
April 2006	4/4/06 - 5/1/06	1465	8.80	13.56
May 2006	5/1/06 - 5/30/06	1263	0.00	11.07
June 2006	5/30/06 - 7/3/06	1994	1.40	18.17
July 2006	7/3/06 - 7/30/06	2010	1.40	13.64
August 2006	7/30/06 - 8/28/06	1296	8.60	9.24
September 2006	8/28/06 - 10/2/06	1384	2.90	12.77
October 2006	10/2/06 - 10/30/06	1262	3.90	8.56
November 2006	10/30/06 - 11/27/06	1152	10.30	8.61
December 2006	11/27/06 - 12/27/06	1210	16.20	9.63
January 2007	12/27/06 - 2/6/07	1406	1.30	14.40
February 2007	2/6/07 - 2/26/07	1017	4.70	7.72
March 2007	2/26/07 - 3/26/07	1693	0.80	12.47
April 2007	3/26/07 - 5/1/07	1665	3.10	15.63
May 2007	5/1/07 - 5/29/07	1666	0.76	11.86
June 2007	5/29/07 - 6/25/07	1478	15.50	9.21
July 2007	6/25/07 - 7/24/07	1268	8.90	8.25
August 2007	7/25/07 - 8/28/07	1429	0.00	10.72
September 2007	8/28/07-10/1/07	1719	0.00	11.54
Total pounds of VOCs removed since inception =				1230.30

NOTES:

- Calculations are based on monthly water samples and assumes samples are representative of the entire reporting period.
- Calculations assume that non-detect values = 0 ug/L.
- Total VOCs summations include estimated "J" values.
- Calculations are based on effluent totalizer readings.
- "Influent VOCs" and "Effluent VOCs" values given above is the summation of values for individual compounds given in monthly analytical reports.
- No samples were collected in September 2003. August 2003 values are used.
- Treatment system operated by Tyree Organization, Ltd. from 9/02 to 9/03.
- Treatment system operated by O&M Enterprises from 10/03 to 7/07.
- Treatment system operated by IEG from 7/07 to present.

CONVERSIONS:

1 pound = 453.5924 grams
1 gallon = 3.785 liters

Based on the Analytical Results from September 4, 2007:

Pounds of VOCs removed calculated by the following formula:

$$1719 \text{ ug/L} - 0.0 \text{ ug/L} * (.8 \text{ g}/10^6 \text{ ug}) * (1 \text{ lb}/453.5924 \text{ g}) * 804,420 \text{ gallons} * (3.785 \text{ L}/\text{gallon}) \sim 11.54 \text{ lbs}$$

where 804,420 gallons is the monthly process water volume.

Attachment A
IEG Weekly Inspection Reports
September 2007

Including:

8/28/07

9/4/07

9/10/07

9/17/07

9/24/07

10/1/07

MR. C's DRY CLEANERS SITE
NYSDEC Site #9-15-157
OM&M: SITE INSPECTION FORM

DATE: <u>28-Aug-07</u>		ACTIVITIES: <u>Site Inspection</u>									
INSPECTION PERSONNEL: <u>R. Allen</u>		OTHER PERSONNEL: <u>---</u>									
WEATHER CONDITIONS: <u>Sunny, hot</u>		OUTSIDE TEMPERATURE (° F): <u>80</u>									
ARE WELL PUMPS OPERATING IN AUTO: YES: <input checked="" type="checkbox"/> NO: <input type="checkbox"/> If "NO", provide explanation below											
PROVIDE WATER LEVEL READINGS ON CONTROL PANEL											
RW-1	ON: <input checked="" type="checkbox"/>	OFF: <u>4</u> ft	PW-5 ON: <input checked="" type="checkbox"/> OFF: <u>5</u> ft								
PW-2	ON: <input type="checkbox"/>	OFF: <input checked="" type="checkbox"/> <u>6</u> ft	PW-6 ON: <input type="checkbox"/> OFF: <input checked="" type="checkbox"/> <u>7</u> ft								
PW-3	ON: <input type="checkbox"/>	OFF: <input checked="" type="checkbox"/> <u>3</u> ft	PW-7 ON: <input checked="" type="checkbox"/> OFF: <input type="checkbox"/> <u>11</u> ft								
PW-4	ON: <input type="checkbox"/>	OFF: <input checked="" type="checkbox"/> <u>7</u> ft	PW-8 ON: <input type="checkbox"/> OFF: <input checked="" type="checkbox"/> <u>4</u> ft								
EQUALIZATION TANK: <u>4</u> ft		Last Alarm D/T/Condition: <u>6/25/07 Air Stripper Pressure Low</u>									
DID YOU TURN PW-7 ON? (WHILE ON SITE) YES: <input type="checkbox"/> NO: <input checked="" type="checkbox"/>		DID YOU TURN PW-7 OFF? YES: <input type="checkbox"/> NO: <input checked="" type="checkbox"/>									
INFLUENT FLOW RATE: <u>77.5</u> gpm		INFLUENT TOTALIZER READING: <u>4,728,788.0</u> gallons									
SEQUESTERING AGENT DRUM LEVEL: <u>12</u> inches		(x 1.7=) AMOUNT OF AGENT REMAINING: <u>20.4</u> gallons									
SEQUESTERING AGENT FEED RATE: <u>10.0</u> ml/min		METERING PUMP PRESSURE: <u>3</u> psi									
BAG FILTER PRESSURES:											
LEFT: <table border="1" style="display: inline-table; border-collapse: collapse;"><tr><td style="text-align: center;">Top</td><td style="text-align: center;">Bottom</td></tr><tr><td style="text-align: center;">0</td><td style="text-align: center;">0</td></tr></table> psi		Top	Bottom	0	0	RIGHT: <table border="1" style="display: inline-table; border-collapse: collapse;"><tr><td style="text-align: center;">Top</td><td style="text-align: center;">Bottom</td></tr><tr><td style="text-align: center;">9</td><td style="text-align: center;">0</td></tr></table> psi		Top	Bottom	9	0
Top	Bottom										
0	0										
Top	Bottom										
9	0										
INFLUENT FEED PUMP IN USE: #1 <input checked="" type="checkbox"/> #2 <input type="checkbox"/>		INFLUENT PUMP PRESSURE: <u>29</u> psi									
AIR STRIPPER BLOWER IN USE: #1 <input type="checkbox"/> #2 <input checked="" type="checkbox"/>		AIR STRIPPER PRESSURE: <u>33</u> in. H ₂ O									
AIR STRIPPER DIFFERENTIAL PRESSURE: <u>0.05</u> in. H ₂ O		DISCHARGE PRESSURE: <u>1</u> in. H ₂ O									
EFFLUENT PUMP IN USE: #1 <input checked="" type="checkbox"/> #2 <input type="checkbox"/>		EFFLUENT FEED PUMP PRESSURE: <u>9.0</u> psi									
EFFLUENT FLOW RATE: <u>90</u> gpm		EFFLUENT TOTALIZER READING: <u>3,884,519</u> 816430 gallons									
ARE BUILDING HEATERS IN USE? YES: <input type="checkbox"/> NO: <input checked="" type="checkbox"/>		INSIDE TEMPERATURE (° F): <u>85</u>									
IS SUMP PUMP IN USE: YES: <input checked="" type="checkbox"/> NO: <input type="checkbox"/>		ARE ANY LEAKS PRESENT? YES: <input checked="" type="checkbox"/> NO: <input type="checkbox"/>									
WATER LEVEL IN SUMP: <u>7</u> in.		TREATMENT BUILDING CLEAN & ORGANIZED? YES: <input checked="" type="checkbox"/> NO: <input type="checkbox"/>									

MR. C's DRY CLEANERS SITE
NYSDEC Site #90150157
SITE INSPECTION FORM

SAMPLES COLLECTED? YES: _____ NO:

	Sample ID	Time of Sampling	pH	Turbidity	Temp.	SP Cond
AIR STRIPPER INFLUENT:	_____	_____	_____	_____	_____	_____
AIR STRIPPER EFFLUENT:	_____	_____	_____	_____	_____	_____

IS THERE EVIDENCE OF TAMPERING/VANDALISM OF WELLS: ? YES: _____ NO:

WERE MANHOLES INSPECTED? YES: NO: _____

WERE ELECTRICAL BOXES INSPECTED? YES: NO: _____

IS WATER PRESENT IN ANY MANHOLES OR ELECTRICAL BOXES? YES: _____ NO:

If yes, provide manhole/electric box ID and description of any corrective measures below:

INCLUDE REMARKS & DESCRIBE ANY OTHER SYSTEM MAINTENANCE PERFORMED ON MR. C's SITE

Remarks: Bag filters have water underneath them from previous leaks. Left bag filter gauge never reads above "0".

Ordered 2 55-gallon drums of Redux 380, to be delivered week of 9/3/07

Other Actions: Cleaned dust out of front area of Treatment Room.

AGWAY

SYSTEM VACUUM: <u>-14</u> in. H ₂ O				AIR PRESSURE: <u>0</u> psi					
SP-1:	<u>0</u>	scfm	<u>0</u>	psi	PW-5:	<u>0</u>	scfm	<u>0</u>	psi
SP-2:	<u>0</u>	scfm	<u>0</u>	psi	PW-6:	<u>0</u>	scfm	<u>0</u>	psi
SP-3:	<u>0</u>	scfm	<u>0</u>	psi	PW-7:	<u>0</u>	scfm	<u>0</u>	psi
SP-4:	<u>0</u>	scfm	<u>0</u>	psi	PW-8:	<u>0</u>	scfm	<u>0</u>	psi

INCLUDE REMARKS & DESCRIBE ANY OTHER SYSTEM MAINTENANCE PERFORMED ON AGWAY SITE

Remarks: Compressor does not work

Ordered vents for shed from Royal Shed. Shed needs to be leveled.

Other Actions: Contacted electrician to look at shed Sept 4, Tuesday.

MR. C's DRY CLEANERS SITE
NYSDEC Site #9-15-157
OM&M: SITE INSPECTION FORM

DATE: 4-Sep-07 ACTIVITIES: Site Inspection

INSPECTION PERSONNEL: D. Iyer, R. Allen (IEG) OTHER PERSONNEL: M. Steffan & T. Heinz (EEPC), R. Carroll (IEG)

WEATHER CONDITIONS: Sunny, warm OUTSIDE TEMPERATURE (° F): 75

ARE WELL PUMPS OPERATING IN AUTO: YES: NO: If "NO", provide explanation below

PROVIDE WATER LEVEL READINGS ON CONTROL PANEL

RW-1	ON: <input type="checkbox"/>	OFF: <input checked="" type="checkbox"/> <u>8</u> ft	PW-5	ON: <input checked="" type="checkbox"/>	OFF: <input type="checkbox"/> <u>6</u> ft
PW-2	ON: <input type="checkbox"/>	OFF: <input checked="" type="checkbox"/> <u>5</u> ft	PW-6	ON: <input type="checkbox"/>	OFF: <input checked="" type="checkbox"/> <u>7</u> ft
PW-3	ON: <input type="checkbox"/>	OFF: <input checked="" type="checkbox"/> <u>6</u> ft	PW-7	ON: <input checked="" type="checkbox"/>	OFF: <input type="checkbox"/> <u>11</u> ft
PW-4	ON: <input checked="" type="checkbox"/>	OFF: <input type="checkbox"/> <u>4</u> ft	PW-8	ON: <input type="checkbox"/>	OFF: <input checked="" type="checkbox"/> <u>4</u> ft

EQUALIZATION TANK: 4 ft Last Alarm D/T/Condition: 6/25/07 Air Stripper Low Pressure

DID YOU TURN PW-7 ON? (WHILE ON SITE) YES: NO: DID YOU TURN PW-7 OFF? YES: NO:

INFLUENT FLOW RATE: 4.87 gpm INFLUENT TOTALIZER READING: 4,987,767.0 gallons

SEQUESTERING AGENT DRUM LEVEL: 3 inches (x 1.7=) AMOUNT OF AGENT REMAINING: 5.1 gallons

SEQUESTERING AGENT FEED RATE: 9.0 ml/min METERING PUMP PRESSURE: 4 psi

		Top	Bottom		Top	Bottom
BAG FILTER PRESSURES:	LEFT:	<u>0</u>	<u>0</u> psi	RIGHT:	<u>5</u>	<u>0</u> psi

INFLUENT FEED PUMP IN USE: #1 #2 INFLUENT PUMP PRESSURE: 5 psi

AIR STRIPPER BLOWER IN USE: #1 #2 AIR STRIPPER PRESSURE: 30 in. H₂O

AIR STRIPPER DIFFERENTIAL PRESSURE: 0.04 in. H₂O DISCHARGE PRESSURE: 1 in. H₂O

EFFLUENT PUMP IN USE: #1 #2 EFFLUENT FEED PUMP PRESSURE: 9.0 psi

EFFLUENT FLOW RATE: 76 gpm EFFLUENT TOTALIZER READING: 39,013,040 985030 gallons

ARE BUILDING HEATERS IN USE? YES: NO: INSIDE TEMPERATURE (° F): 73

IS SUMP PUMP IN USE: YES: NO: ARE ANY LEAKS PRESENT? YES: NO:

WATER LEVEL IN SUMP: 8 in. TREATMENT BUILDING CLEAN & ORGANIZED? YES: NO:

MR. C's DRY CLEANERS SITE
NYSDEC Site #90150157
SITE INSPECTION FORM

SAMPLES COLLECTED? YES: NO:

	Sample ID	Time of Sampling	pH	Turbidity	Temp.
AIR STRIPPER INFLUENT:	INF	11:00 AM	7.18	5.63	16.9
AIR STRIPPER EFFLUENT:	EFF	11:30 PM	8.28	5.06	18.6

IS THERE EVIDENCE OF TAMPERING/VANDALISM OF WELLS? YES: NO:

WERE MANHOLES INSPECTED? YES: NO:

WERE ELECTRICAL BOXES INSPECTED? YES: NO:

IS WATER PRESENT IN ANY MANHOLES OR ELECTRICAL BOXES? YES: NO:

If yes, provide manhole/electric box ID and description of any corrective measures below:

INCLUDE REMARKS & DESCRIBE ANY OTHER SYSTEM MAINTENANCE PERFORMED ON MR. C's SITE

Remarks: Lowered sequestering agent pump to 2.25 / 1.0. Rechecked sequestering agent feed rate - 6.5.
 Effluent Totalizer Meter has badly scratched cover. Will try to buff out scratches or replace cover.

Other Actions: Poured the remainder of sequestering agent from (2) used drums into the current drum. Approximately 1 gallon from each of the used up drums was recovered. Future pours will go into jug to prime the calibration cylinder.

AGWAY

SYSTEM VACUUM: <u>-14</u> in. H ₂ O			AIR PRESSURE: <u>25</u> psi		
SP-1:	<u>0</u> scfm	<u>2.5</u> psi	PW-5:	<u>0</u> scfm	<u>27</u> psi
SP-2:	<u>0</u> scfm	<u>0</u> psi	PW-6:	<u>3</u> scfm	<u>9</u> psi
SP-3:	<u>0</u> scfm	<u>0</u> psi	PW-7:	<u>2.4</u> scfm	<u>17</u> psi
SP-4:	<u>0</u> scfm	<u>0</u> psi	PW-8:	<u>0</u> scfm	<u>28</u> psi

INCLUDE REMARKS & DESCRIBE ANY OTHER SYSTEM MAINTENANCE PERFORMED ON AGWAY SITE

Remarks: Rex Carroll (IEG) repaired faulty compressor wiring and electrical switch. Vacuum Blower Motor needs bearing work.
 Vents for shed came in but were the wrong ones. Shed needs leveling.

Other Actions: IEG will address Vacuum Motor repair next week.

MR. C's DRY CLEANERS SITE
 NYSDEC Site #9-15-157
OM&M: PIEZOMETER WATER LEVEL LOG

Date: 4-Sep-07

Measurements taken by: R. Allen

RW-1	<u>17.95</u> ft	Comments:
PZ-1A	ft	Comments: <u>Car on well</u>
PZ-1B	<u>12.62</u> ft	Comments:
PZ-1C	<u>13.90</u> ft	Comments:
PZ-1D	<u>13.91</u> ft	Comments:
PW-2	<u>21.84</u> ft	Comments:
PZ-2A	<u>12.40</u> ft	Comments:
PZ-2B	<u>12.69</u> ft	Comments:
PZ-2C	<u>12.10</u> ft	Comments:
PZ-2D	ft	Comments:
PW-3	<u>19.68</u> ft	Comments:
PZ-3A	<u>12.89</u> ft	Comments:
PZ-3B	<u>12.97</u> ft	Comments:
PZ-3C	<u>13.44</u> ft	Comments:
PZ-3D	<u>12.89</u> ft	Comments:
PW-4	<u>25.59</u> ft	Comments:
PZ-4A	<u>12.83</u> ft	Comments:
PZ-4B	<u>12.41</u> ft	Comments:
PZ-4C	<u>12.59</u> ft	Comments:
PZ-4D	<u>11.95</u> ft	Comments:

PW-5	<u>24.00</u> ft	Comments:
PZ-5A	<u>12.09</u> ft	Comments:
PZ-5B	<u>12.23</u> ft	Comments:
PZ-5C	<u>11.81</u> ft	Comments:
PZ-5D	<u>12.63</u> ft	Comments:
PW-6	<u>21.65</u> ft	Comments:
PZ-6A	<u>12.92</u> ft	Comments:
PZ-6B	ft	Comments: <u>Car on well</u>
PZ-6C	<u>13.03</u> ft	Comments:
PZ-6D	<u>12.67</u> ft	Comments: <u>Shown as RW-1 on map</u>
PW-7	<u>15.71</u> ft	Comments:
MPI-6S	<u>12.50</u> ft	Comments:
PZ-7B	<u>12.75</u> ft	Comments:
OW-B	<u>12.58</u> ft	Comments:
PZ-7D	<u>12.33</u> ft	Comments:
PW-8	<u>21.51</u> ft	Comments:
PZ-8A	<u>9.49</u> ft	Comments:
PZ-8B	<u>9.41</u> ft	Comments:
PZ-8C	<u>9.02</u> ft	Comments:
PZ-8D	<u>9.32</u> ft	Comments:

PUMPS IN OPERATION DURING MEASUREMENTS

RW-1 pump on? Yes No

PW-2 pump on? Yes No

PW-3 pump on? Yes No

PW-4 pump on? Yes No

PW-5 pump on? Yes No

PW-6 pump on? Yes No

PW-7 pump on? Yes No

PW-8 pump on? Yes No

MR. C's DRY CLEANERS SITE
NYSDEC Site #9-15-157
OM&M: SITE INSPECTION FORM

DATE: Sep 10, 2007 ACTIVITIES: Site Inspection

INSPECTION PERSONNEL: D. Iyer, R. Allen (IEG) OTHER PERSONNEL: _____

WEATHER CONDITIONS: Partly cloudy, warm OUTSIDE TEMPERATURE (° F): 65

ARE WELL PUMPS OPERATING IN AUTO: YES: NO: _____ If "NO", provide explanation below

PROVIDE WATER LEVEL READINGS ON CONTROL PANEL

RW-1	ON: _____	OFF: <input checked="" type="checkbox"/>	<u>8</u> ft	PW-5	ON: <input checked="" type="checkbox"/>	OFF: _____	<u>6</u> ft
PW-2	ON: _____	OFF: <input checked="" type="checkbox"/>	<u>6</u> ft	PW-6	ON: _____	OFF: <input checked="" type="checkbox"/>	<u>7</u> ft
PW-3	ON: <input checked="" type="checkbox"/>	OFF: _____	<u>14</u> ft	PW-7	ON: <input checked="" type="checkbox"/>	OFF: _____	<u>11</u> ft
PW-4	ON: <input checked="" type="checkbox"/>	OFF: _____	<u>4</u> ft	PW-8	ON: _____	OFF: <input checked="" type="checkbox"/>	<u>6</u> ft

EQUALIZATION TANK: 4 ft Last Alarm D/T/Condition: 6/19/07 Air Stripper Low Pressure

DID YOU TURN PW-7 ON? (WHILE ON SITE) YES: _____ NO: DID YOU TURN PW-7 OFF? YES: _____ NO: _____

INFLUENT FLOW RATE: 14.75 gpm INFLUENT TOTALIZER READING: 5,213,662.0 gallons

SEQUESTERING AGENT DRUM LEVEL: 27 inches (x 1.7=) AMOUNT OF AGENT REMAINING: 45.9 gallons

SEQUESTERING AGENT FEED RATE: 6.5 ml/min METERING PUMP PRESSURE: 4 psi

		Top	Bottom		Top	Bottom
BAG FILTER PRESSURES:	LEFT:	<u>0</u>	<u>0</u> psi	RIGHT:	<u>9</u>	<u>0</u> psi

INFLUENT FEED PUMP IN USE: #1 #2 _____ INFLUENT PUMP PRESSURE: 4 psi

AIR STRIPPER BLOWER IN USE: #1 _____ #2 AIR STRIPPER PRESSURE: 28 in. H₂O

AIR STRIPPER DIFFERENTIAL PRESSURE: 0.04 in. H₂O DISCHARGE PRESSURE: 1 in. H₂O

EFFLUENT PUMP IN USE: #1 #2 _____ EFFLUENT FEED PUMP PRESSURE: 9.0 psi

EFFLUENT FLOW RATE: 85 gpm EFFLUENT TOTALIZER READING: 39,157,450 131690 gallons

ARE BUILDING HEATERS IN USE? YES: _____ NO: INSIDE TEMPERATURE (° F): 76.6

IS SUMP PUMP IN USE: YES: NO: _____ ARE ANY LEAKS PRESENT? YES: NO: _____

WATER LEVEL IN SUMP: 8.0 in. TREATMENT BUILDING CLEAN & ORGANIZED? YES: NO: _____

MR. C's DRY CLEANERS SITE
NYSDEC Site #90150157
SITE INSPECTION FORM

SAMPLES COLLECTED? YES: _____ NO: ✓

	Sample ID	Time of Sampling	pH	Turbidity	Temp.	SP Cond
AIR STRIPPER INFLUENT:	_____	_____	_____	_____	_____	_____
AIR STRIPPER EFFLUENT:	_____	_____	_____	_____	_____	_____

IS THERE EVIDENCE OF TAMPERING/VANDALISM OF WELLS: ? YES: _____ NO: ✓
WERE MANHOLES INSPECTED? YES: ✓ NO: _____
WERE ELECTRICAL BOXES INSPECTED? YES: ✓ NO: _____
IS WATER PRESENT IN ANY MANHOLES OR ELECTRICAL BOXES? YES: _____ NO: ✓

If yes, provide manhole/electric box ID and description of any corrective measures below:

INCLUDE REMARKS & DESCRIBE ANY OTHER SYSTEM MAINTENANCE PERFORMED ON MR. C's SITE

Remarks: 2 1/4" O.D. PVC sanitary sewer line hanging from ceiling is dripping over Effluent Meter; needs repair

Other Actions:

AGWAY

SYSTEM VACUUM: <u> -15 </u> in. H ₂ O			AIR PRESSURE: <u> 84 </u> psi		
SP-1: <u> 0 </u> scfm	<u> 5.0 </u> psi	PW-5: <u> 0.0 </u> scfm	<u> 28 </u> psi		
SP-2: <u> 0 </u> scfm	<u> 2.5 </u> psi	PW-6: <u> 3.0 </u> scfm	<u> 7 </u> psi		
SP-3: <u> 0 </u> scfm	<u> 2.5 </u> psi	PW-7: <u> 2.8 </u> scfm	<u> 16 </u> psi		
SP-4: <u> 0 </u> scfm	<u> 3.0 </u> psi	PW-8: <u> 0.0 </u> scfm	<u> >30 </u> psi		

INCLUDE REMARKS & DESCRIBE ANY OTHER SYSTEM MAINTENANCE PERFORMED ON AGWAY SITE

Remarks: Shed should be leveled. Compressor is working. Ordered proper vents (4).

Other Actions: COMPRESSOR - Champion Pneumatic Machinery CO. Inc., Princeton, IL (Model VR3-6, Serial # R15 96197)
Service Call (815) 875-3321

MR. C's DRY CLEANERS SITE
NYSDEC Site #9-15-157
OM&M: SITE INSPECTION FORM

DATE: <u>17-Sep-07</u>		ACTIVITIES: <u>Site Inspection</u>	
INSPECTION PERSONNEL: <u>R. Allen</u>		OTHER PERSONNEL: <u>----</u>	
WEATHER CONDITIONS: <u>Sunny, warm</u>		OUTSIDE TEMPERATURE (°F): <u>70</u>	
ARE WELL PUMPS OPERATING IN AUTO: YES: <input checked="" type="checkbox"/> NO: <input type="checkbox"/> If "NO", provide explanation below			
PROVIDE WATER LEVEL READINGS ON CONTROL PANEL			
RW-1	ON: <input type="checkbox"/>	OFF: <input checked="" type="checkbox"/> <u>11</u> ft	PW-5 ON: <input checked="" type="checkbox"/> OFF: <input type="checkbox"/> <u>7</u> ft
PW-2	ON: <input type="checkbox"/>	OFF: <input checked="" type="checkbox"/> <u>5</u> ft	PW-6 ON: <input type="checkbox"/> OFF: <input checked="" type="checkbox"/> <u>3</u> ft
PW-3	ON: <input checked="" type="checkbox"/>	OFF: <input type="checkbox"/> <u>14</u> ft	PW-7 ON: <input checked="" type="checkbox"/> OFF: <input type="checkbox"/> <u>11</u> ft
PW-4	ON: <input checked="" type="checkbox"/>	OFF: <input type="checkbox"/> <u>5</u> ft	PW-8 ON: <input type="checkbox"/> OFF: <input checked="" type="checkbox"/> <u>5</u> ft
EQUALIZATION TANK: <u>4</u> ft		Last Alarm D/T/Condition: <u>9/10/07 Stripper Low Pressure</u>	
DID YOU TURN PW-7 ON? (WHILE ON SITE) YES: <input type="checkbox"/> NO: <input checked="" type="checkbox"/>		DID YOU TURN PW-7 OFF? YES: <input type="checkbox"/> NO: <input type="checkbox"/>	
INFLUENT FLOW RATE: <u>22</u> gpm		INFLUENT TOTALIZER READING: <u>5,475,435.0</u> gallons	
SEQUESTERING AGENT DRUM LEVEL: <u>19</u> inches		(x 1.7=) AMOUNT OF AGENT REMAINING: <u>32.3</u> gallons	
SEQUESTERING AGENT FEED RATE: <u>8.0</u> ml/min		METERING PUMP PRESSURE: <u>4</u> psi	
BAG FILTER PRESSURES:			
		Top	Bottom
LEFT:	<u>0</u>	<u>0</u> psi	RIGHT: <u>9</u> <u>0</u> psi
INFLUENT FEED PUMP IN USE: #1 <input checked="" type="checkbox"/> #2 <input type="checkbox"/>		INFLUENT PUMP PRESSURE: <u>5</u> psi	
AIR STRIPPER BLOWER IN USE: #1 <input type="checkbox"/> #2 <input checked="" type="checkbox"/>		AIR STRIPPER PRESSURE: <u>37</u> in. H ₂ O	
AIR STRIPPER DIFFERENTIAL PRESSURE: <u>0.04</u> in. H ₂ O		DISCHARGE PRESSURE: <u>1</u> in. H ₂ O	
EFFLUENT PUMP IN USE: #1 <input checked="" type="checkbox"/> #2 <input type="checkbox"/>		EFFLUENT FEED PUMP PRESSURE: <u>8.0</u> psi	
EFFLUENT FLOW RATE: <u>90</u> gpm		EFFLUENT TOTALIZER READING: <u>39,326,850</u> 301150 gallons	
ARE BUILDING HEATERS IN USE? YES: <input type="checkbox"/> NO: <input checked="" type="checkbox"/>		INSIDE TEMPERATURE (°F): <u>75</u>	
IS SUMP PUMP IN USE: YES: <input checked="" type="checkbox"/> NO: <input type="checkbox"/>		ARE ANY LEAKS PRESENT? YES: <input checked="" type="checkbox"/> NO: <input type="checkbox"/>	
WATER LEVEL IN SUMP: <u>8.5</u> in.		TREATMENT BUILDING CLEAN & ORGANIZED? YES: <input checked="" type="checkbox"/> NO: <input type="checkbox"/>	

MR. C's DRY CLEANERS SITE
NYSDEC Site #90150157
SITE INSPECTION FORM

SAMPLES COLLECTED? YES: _____ NO: √

	Sample ID	Time of Sampling	pH	Turbidity	Temp.	SP Cond
AIR STRIPPER INFLUENT:	_____	_____	_____	_____	_____	_____
AIR STRIPPER EFFLUENT:	_____	_____	_____	_____	_____	_____

IS THERE EVIDENCE OF TAMPERING/VANDALISM OF WELLS: ? YES: _____ NO: √

WERE MANHOLES INSPECTED? YES: √ NO: _____

WERE ELECTRICAL BOXES INSPECTED? YES: √ NO: _____

IS WATER PRESENT IN ANY MANHOLES OR ELECTRICAL BOXES? YES: _____ NO: √

If yes, provide manhole/electric box ID and description of any corrective measures below:

INCLUDE REMARKS & DESCRIBE ANY OTHER SYSTEM MAINTENANCE PERFORMED ON MR. C's SITE

Remarks: Sanitary line has slow leak.

Other Actions: Made appointment with Bill Rogers (Building Maintenance Person) for Wed, Sep 26, afternoon to fix leak.

AGWAY

SYSTEM VACUUM: _____ in. H ₂ O				AIR PRESSURE: _____ psi			
SP-1:	_____	scfm	_____	psi	PW-5:	_____	scfm

							psi
SP-2:	_____	scfm	_____	psi	PW-6:	_____	scfm

							psi
SP-3:	_____	scfm	_____	psi	PW-7:	_____	scfm

							psi
SP-4:	_____	scfm	_____	psi	PW-8:	_____	scfm

							psi

INCLUDE REMARKS & DESCRIBE ANY OTHER SYSTEM MAINTENANCE PERFORMED ON AGWAY SITE

Remarks: System is shut down for repair. Vacuum Blower Motor was repaired by S&S Electric and returned to shed today.

Other Actions: Recommend a padlock be put on electric box outside shed.

MR. C's DRY CLEANERS SITE
NYSDEC Site #9-15-157
OM&M: SITE INSPECTION FORM

DATE: <u>24-Sep-07</u>		ACTIVITIES: <u>Site Inspection</u>	
INSPECTION PERSONNEL: <u>R. Allen</u>		OTHER PERSONNEL: <u>B. Rogers</u>	
WEATHER CONDITIONS: <u>Sunny, hot</u>		OUTSIDE TEMPERATURE (° F): <u>80</u>	
ARE WELL PUMPS OPERATING IN AUTO: YES: <input checked="" type="checkbox"/> NO: <input type="checkbox"/> If "NO", provide explanation below			
PROVIDE WATER LEVEL READINGS ON CONTROL PANEL			
RW-1	ON: <input checked="" type="checkbox"/>	OFF: <u>6</u> ft	PW-5 ON: <input checked="" type="checkbox"/> OFF: <u>6</u> ft
PW-2	ON: <input type="checkbox"/>	OFF: <input checked="" type="checkbox"/> <u>5</u> ft	PW-6 ON: <input type="checkbox"/> OFF: <input checked="" type="checkbox"/> <u>7</u> ft
PW-3	ON: <input checked="" type="checkbox"/>	OFF: <u>14</u> ft	PW-7 ON: <input checked="" type="checkbox"/> OFF: <u>11</u> ft
PW-4	ON: <input checked="" type="checkbox"/>	OFF: <u>7</u> ft	PW-8 ON: <input checked="" type="checkbox"/> OFF: <u>6</u> ft
EQUALIZATION TANK: <u>4</u> ft		Last Alarm D/T/Condition: <u>9/10/07 Air Stripper Low Pressure</u>	
DID YOU TURN PW-7 ON? (WHILE ON SITE) YES: <input type="checkbox"/> NO: <input checked="" type="checkbox"/>		DID YOU TURN PW-7 OFF? YES: <input type="checkbox"/> NO: <input type="checkbox"/>	
INFLUENT FLOW RATE: <u>74.85</u> gpm		INFLUENT TOTALIZER READING <u>5,733,344.0</u> gallons	
SEQUESTERING AGENT DRUM LEVEL: <u>11</u> inches		(x 1.7=) AMOUNT OF AGENT REMAINING: <u>18.7</u> gallons	
SEQUESTERING AGENT FEED RATE: <u>7.0</u> ml/min		METERING PUMP PRESSURE: <u>4</u> psi	
BAG FILTER PRESSURES:		Top Bottom	Top Bottom
LEFT: <u>0</u> <u>0</u> psi		RIGHT: <u>5</u> <u>0</u> psi	
INFLUENT FEED PUMP IN USE: #1 <input checked="" type="checkbox"/> #2 <input type="checkbox"/>		INFLUENT PUMP PRESSURE: <u>5</u> psi	
AIR STRIPPER BLOWER IN USE: #1 <input type="checkbox"/> #2 <input checked="" type="checkbox"/>		AIR STRIPPER PRESSURE: <u>37</u> in. H ₂ O	
AIR STRIPPER DIFFERENTIAL PRESSURE: <u>0.04</u> in. H ₂ O		DISCHARGE PRESSURE: <u>1.0</u> in. H ₂ O	
EFFLUENT PUMP IN USE: #1 <input checked="" type="checkbox"/> #2 <input type="checkbox"/>		EFFLUENT FEED PUMP PRESSURE: <u>9.0</u> psi	
EFFLUENT FLOW RATE: <u>90</u> gpm		EFFLUENT TOTALIZER READING: <u>39,492,530</u> 468950 gallons	
ARE BUILDING HEATERS IN USE? YES: <input type="checkbox"/> NO: <input checked="" type="checkbox"/>		INSIDE TEMPERATURE (° F): <u>83.7</u>	
IS SUMP PUMP IN USE: YES: <input checked="" type="checkbox"/> NO: <input type="checkbox"/>		ARE ANY LEAKS PRESENT? YES: <input checked="" type="checkbox"/> NO: <input type="checkbox"/>	
WATER LEVEL IN SUMP: <u>8.5</u> in.		TREATMENT BUILDING CLEAN & ORGANIZED? YES: <input checked="" type="checkbox"/> NO: <input type="checkbox"/>	

MR. C's DRY CLEANERS SITE
NYSDEC Site #90150157
SITE INSPECTION FORM

SAMPLES COLLECTED? YES: _____ NO: ✓

	Sample ID	Time of Sampling	pH	Turbidity	Temp.	Sp. Cond.
AIR STRIPPER INFLUENT:	_____	_____	_____	_____	_____	_____
AIR STRIPPER EFFLUENT:	_____	_____	_____	_____	_____	_____

IS THERE EVIDENCE OF TAMPERING/VANDALISM OF WELLS: ? YES: _____ NO: ✓

WERE MANHOLES INSPECTED? YES: ✓ NO: _____

WERE ELECTRICAL BOXES INSPECTED? YES: ✓ NO: _____

IS WATER PRESENT IN ANY MANHOLES OR ELECTRICAL BOXES? YES: _____ NO: ✓

If yes, provide manhole/electric box ID and description of any corrective measures below:

INCLUDE REMARKS & DESCRIBE ANY OTHER SYSTEM MAINTENANCE PERFORMED ON MR. C's SITE

Remarks: Sep 26, 07, met with Bill Rogers (Building Maintenance) to fix leak in sanitary line in Treatment Room.

Other Actions: Inspected MW-14B on Fillmore Ave. Formulated plan to patch over in the event the well is abandoned;
 or to install new ring and top cover in the event well is recovered.

Inspected SVE System pipe on the west side of the First Presbyterian Preschool.

Formulated plan for repair of loose pipe - to be performed next week.

AGWAY

SYSTEM VACUUM: <u> -15 </u> in. H ₂ O				AIR PRESSURE: <u> 120 </u> psi			
SP-1:	<u> 0.0 </u>	scfm	<u> 5.0 </u> psi	PW-5:	<u> 0.0 </u>	scfm	<u> 0.0 </u> psi
SP-2:	<u> 0.0 </u>	scfm	<u> 3.0 </u> psi	PW-6:	<u> 0.0 </u>	scfm	<u> 0.0 </u> psi
SP-3:	<u> 0.0 </u>	scfm	<u> 2.5 </u> psi	PW-7:	<u> 0.0 </u>	scfm	<u> 0.0 </u> psi
SP-4:	<u> 0.0 </u>	scfm	<u> 3.0 </u> psi	PW-8:	<u> 0.0 </u>	scfm	<u> 0.0 </u> psi

INCLUDE REMARKS & DESCRIBE ANY OTHER SYSTEM MAINTENANCE PERFORMED ON AGWAY SITE

Remarks: Vents for shed are on order. Shed should be leveled. Timers may need re-setting after replacement of vacuum blower motor. Need to secure electric box outside shed with a padlock.

Other Actions:

MR. C's DRY CLEANERS SITE
NYSDEC Site #9-15-157
OM&M: SITE INSPECTION FORM

DATE: <u>Oct 1,2007</u>		ACTIVITIES: <u>Site Inspection</u>	
INSPECTION PERSONNEL: <u>R. Allen</u>		OTHER PERSONNEL: <u>---</u>	
WEATHER CONDITIONS: <u>Sunny, warm</u>		OUTSIDE TEMPERATURE (° F): <u>78</u>	
ARE WELL PUMPS OPERATING IN AUTO: YES: <input checked="" type="checkbox"/> NO: <input type="checkbox"/> If "NO", provide explanation below			
PROVIDE WATER LEVEL READINGS ON CONTROL PANEL			
RW-1	ON: <input type="checkbox"/>	OFF: <input checked="" type="checkbox"/> <u>8</u> ft	PW-5 ON: <input checked="" type="checkbox"/> OFF: <input type="checkbox"/> <u>7</u> ft
PW-2	ON: <input checked="" type="checkbox"/>	OFF: <input type="checkbox"/> <u>7</u> ft	PW-6 ON: <input checked="" type="checkbox"/> OFF: <input type="checkbox"/> <u>5</u> ft
PW-3	ON: <input checked="" type="checkbox"/>	OFF: <input type="checkbox"/> <u>14</u> ft	PW-7 ON: <input checked="" type="checkbox"/> OFF: <input type="checkbox"/> <u>11</u> ft
PW-4	ON: <input checked="" type="checkbox"/>	OFF: <input type="checkbox"/> <u>6</u> ft	PW-8 ON: <input type="checkbox"/> OFF: <input checked="" type="checkbox"/> <u>7</u> ft
EQUALIZATION TANK: <u>4</u> ft		Last Alarm D/T/Condition: <u>9/10/07 Air Stripper Low Pressure</u>	
DID YOU TURN PW-7 ON? (WHILE ON SITE) YES: <input type="checkbox"/> NO: <input checked="" type="checkbox"/>		DID YOU TURN PW-7 OFF? YES: <input type="checkbox"/> NO: <input type="checkbox"/>	
INFLUENT FLOW RATE: <u>68.94</u> gpm		INFLUENT TOTALIZER READING: <u>5,977,409.8</u> gallons	
SEQUESTERING AGENT DRUM LEVEL: <u>3</u> inches		(x 1.7=) AMOUNT OF AGENT REMAINING: <u>5.1</u> gallons	
SEQUESTERING AGENT FEED RATE: <u>8.0</u> ml/min		METERING PUMP PRESSURE: <u>4</u> psi	
BAG FILTER PRESSURES:			
	Top	Bottom	
LEFT:	<u>0</u>	<u>0</u> psi	RIGHT: <u>5</u> <u>0</u> psi
INFLUENT FEED PUMP IN USE: #1 <input checked="" type="checkbox"/> #2 <input type="checkbox"/>		INFLUENT PUMP PRESSURE: <u>5</u> psi	
AIR STRIPPER BLOWER IN USE: #1 <input type="checkbox"/> #2 <input checked="" type="checkbox"/>		AIR STRIPPER PRESSURE: <u>38.0</u> in. H ₂ O	
AIR STRIPPER DIFFERENTIAL PRESSURE: <u>0.04</u> in. H ₂ O		DISCHARGE PRESSURE: <u>1.0</u> in. H ₂ O	
EFFLUENT PUMP IN USE: #1 <input checked="" type="checkbox"/> #2 <input type="checkbox"/>		EFFLUENT FEED PUMP PRESSURE: <u>8.0</u> psi	
EFFLUENT FLOW RATE: <u>94</u> gpm		EFFLUENT TOTALIZER READING: <u>39,649,610</u> 627430 gallons	
ARE BUILDING HEATERS IN USE? YES: <input type="checkbox"/> NO: <input checked="" type="checkbox"/>		INSIDE TEMPERATURE (° F): <u>80.4</u>	
IS SUMP PUMP IN USE: YES: <input checked="" type="checkbox"/> NO: <input type="checkbox"/>		ARE ANY LEAKS PRESENT? YES: <input type="checkbox"/> NO: <input checked="" type="checkbox"/>	
WATER LEVEL IN SUMP: <u>9.0</u> in.		TREATMENT BUILDING CLEAN & ORGANIZED? YES: <input checked="" type="checkbox"/> NO: <input type="checkbox"/>	

MR. C's DRY CLEANERS SITE
NYSDEC Site #90150157
SITE INSPECTION FORM

SAMPLES COLLECTED? YES: √ NO:

	Sample ID	Time of Sampling	pH	Turbidity	Temp.	Sp. Cond.
AIR STRIPPER INFLUENT:	AS Influent	1:00 PM	7.33	5.87	18.7	2569
AIR STRIPPER EFFLUENT:	AS Effluent	1:00 PM	8.51	4.76	19.1	2440

IS THERE EVIDENCE OF TAMPERING/VANDALISM OF WELLS: ? YES: NO: √
 WERE MANHOLES INSPECTED? YES: √ NO:
 WERE ELECTRICAL BOXES INSPECTED? YES: √ NO:
 IS WATER PRESENT IN ANY MANHOLES OR ELECTRICAL BOXES? YES: NO: √

If yes, provide manhole/electric box ID and description of any corrective measures below:

INCLUDE REMARKS & DESCRIBE ANY OTHER SYSTEM MAINTENANCE PERFORMED ON MR. C's SITE

Remarks: Sanitary line leak repair by IEG is good.

Other Actions: Put site notebooks in large water resistant plastic tote. Consolidated spare sampling bottles into large cooler.

Placed last REDUX drum in service; 4 empty drums on-site.

Fixed soil vapor riser pipe on west wall of Presbyterian Church building to the extent possible (10/03).

AGWAY

SYSTEM VACUUM: <u> -16 </u> in. H ₂ O				AIR PRESSURE: <u> 0 </u> psi			
SP-1:	<u> 0.0 </u>	scfm	<u> 4.0 </u> psi	PW-5:	<u> 0.0 </u>	scfm	<u> 0.0 </u> psi
SP-2:	<u> 0.0 </u>	scfm	<u> 0.0 </u> psi	PW-6:	<u> 0.0 </u>	scfm	<u> 0.0 </u> psi
SP-3:	<u> 0.0 </u>	scfm	<u> 0.0 </u> psi	PW-7:	<u> 0.0 </u>	scfm	<u> 0.0 </u> psi
SP-4:	<u> 0.0 </u>	scfm	<u> 0.0 </u> psi	PW-8:	<u> 0.0 </u>	scfm	<u> 0.0 </u> psi

INCLUDE REMARKS & DESCRIBE ANY OTHER SYSTEM MAINTENANCE PERFORMED ON AGWAY SITE

Remarks: Compressor was not running and was cool to the touch on 10/1; repaired compressor on 10/3.

A/W separator drum appears to be leaking in the bottom; will be checked and leak caulked to the extent possible.

Other Actions: Put padlock on outside electric box. Replaced shed padlock with one that is keyed the same as new electric box padlock. Installed rubber shims under SVE barrel to quiet vibration noise. Leveled Agway shed.

MR. C's DRY CLEANERS SITE
 NYSDEC Site #9-15-157
OM&M: PIEZOMETER WATER LEVEL LOG

Date: 1-Oct-07

Measurements taken by: R. Allen

RW-1	<u>18.93</u> ft	Comments: _____
PZ-1A	_____ ft	Comments: <u>Car on well</u>
PZ-1B	<u>12.60</u> ft	Comments: _____
PZ-1C	<u>13.72</u> ft	Comments: _____
PZ-1D	<u>13.87</u> ft	Comments: _____
PW-2	<u>23.15</u> ft	Comments: _____
PZ-2A	<u>12.21</u> ft	Comments: _____
PZ-2B	<u>12.71</u> ft	Comments: _____
PZ-2C	<u>12.17</u> ft	Comments: _____
PZ-2D	_____ ft	Comments: <u>Cannot locate</u>
PW-3	<u>12.98</u> ft	Comments: _____
PZ-3A	<u>12.87</u> ft	Comments: _____
PZ-3B	<u>12.95</u> ft	Comments: _____
PZ-3C	<u>13.42</u> ft	Comments: _____
PZ-3D	<u>12.92</u> ft	Comments: _____
PW-4	<u>23.83</u> ft	Comments: _____
PZ-4A	<u>12.73</u> ft	Comments: _____
PZ-4B	<u>12.35</u> ft	Comments: _____
PZ-4C	<u>12.51</u> ft	Comments: _____
PZ-4D	<u>11.93</u> ft	Comments: _____

PW-5	<u>22.16</u> ft	Comments: _____
PZ-5A	<u>11.72</u> ft	Comments: _____
PZ-5B	<u>12.19</u> ft	Comments: _____
PZ-5C	<u>11.78</u> ft	Comments: _____
PZ-5D	<u>12.48</u> ft	Comments: _____
PW-6	<u>21.45</u> ft	Comments: _____
PZ-6A	<u>12.90</u> ft	Comments: _____
PZ-6B	<u>12.73</u> ft	Comments: _____
PZ-6C	<u>12.98</u> ft	Comments: _____
PZ-6D	<u>12.64</u> ft	Comments: <u>Shown as RW-1 on map</u>
PW-7	<u>15.52</u> ft	Comments: _____
MPI-6S	<u>12.45</u> ft	Comments: _____
PZ-7B	<u>12.69</u> ft	Comments: _____
OW-B	<u>12.54</u> ft	Comments: _____
PZ-7D	<u>12.30</u> ft	Comments: _____
PW-8	<u>20.17</u> ft	Comments: _____
PZ-8A	<u>9.46</u> ft	Comments: _____
PZ-8B	<u>9.37</u> ft	Comments: _____
PZ-8C	<u>8.98</u> ft	Comments: _____
PZ-8D	<u>9.33</u> ft	Comments: _____

PUMPS IN OPERATION DURING MEASUREMENTS			
RW-1 pump on?	<u>Yes</u>	<input checked="" type="checkbox"/> No	
PW-2 pump on?	<input checked="" type="checkbox"/> Yes	_____ No	
PW-3 pump on?	<input checked="" type="checkbox"/> Yes	_____ No	
PW-4 pump on?	<input checked="" type="checkbox"/> Yes	_____ No	
PW-5 pump on?	<input checked="" type="checkbox"/> Yes	_____ No	
PW-6 pump on?	<input checked="" type="checkbox"/> Yes	_____ No	
PW-7 pump on?	<input checked="" type="checkbox"/> Yes	_____ No	
PW-8 pump on?	_____ Yes	<input checked="" type="checkbox"/> No	

Attachment B
Analytical Report from
Mitkem Corporation

Analytical Data Package/SDG: #F1244
Sampled: September 4, 2007



"Environmental Testing For The New Millennium"

RECEIVED
BY MGS / DATE 9/25/07
EEPC

September 24, 2007

Ecology & Environment Engineering P.C.
368 Pleasantview Drive
Lancaster, NY 14086
Attn: Mr. Michael Steffan

RE: Client Project: Mr. C's Dry Cleaners Site (Compliance)
Lab Work Order #: F1244

Dear Mr. Steffan:

Enclosed please find the data report of the required analyses for the samples associated with the above referenced project.

If you have any questions regarding this report, please don't hesitate to call me.

We appreciate your business.

Sincerely,

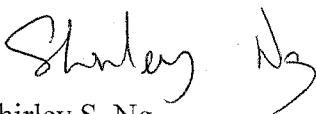
Shirley S. Ng
Project Manager

Mitkem Corporation

New York State Department of Environmental Conservation Sample Identification and Analytical Requirements Summary

Project Name : Mr. C's Dry Cleaning -- 002700.DC13.02.01.02

SDG : F1244

Customer Sample ID	Laboratory Sample ID	Analytical Requirements				
		MSVOA Method #	MSSEMI Method #	GC* Method #	ME	Other
INFLUENT	F1244-01	SW8260B_W			SM2340_W	SEE DATA
DISCHARGE	F1244-02	SW8260B_W			SM2340_W	SEE DATA
TRIP BLANK	F1244-03	SW8260B_W				

Mitkem Corporation

New York State Department of Environmental Conservation Sample Preparation and Analysis Summary MSVOA

Project Name : Mr. C's Dry Cleaning -- 002700.DC13.02.01.02

SDG : F1244

Laboratory Sample ID	Matrix	Date Collected	Date Received By Lab	Date Extracted	Date Analyzed
SW8260B_W					
F1244-01A	AQ	9/4/2007	9/5/2007	NA	9/7/2007
F1244-02A	AQ	9/4/2007	9/5/2007	NA	9/7/2007
F1244-03A	AQ	9/4/2007	9/5/2007	NA	9/7/2007

Mitkem Corporation

New York State Department of Environmental Conservation Sample Preparation and Analysis Summary MSVOA

Project Name : Mr. C's Dry Cleaning -- 002700.DC13.02.01.02

SDG : F1244

Laboratory Sample ID	Matrix	Analytical Protocol	Extraction Method	Low/Medium Level	Dil/Conc Factor
SW8260B_W					
F1244-01A	AQ	SW8260B_W	NA	LOW	1
F1244-02A	AQ	SW8260B_W	NA	LOW	1
F1244-03A	AQ	SW8260B_W	NA	LOW	1

Mitkem Corporation

New York State Department of Environmental Conservation Sample Preparation and Analysis Summary ME

Project Name : Mr. C's Dry Cleaning -- 002700.DC13.02.01.02

SDG : F1244

Laboratory Sample ID	Matrix	Metals Requested	Date Received By Lab	Date Analyzed
SM2340_W				
F1244-01C	AQ	SM2340_W	9/5/2007	9/18/2007
F1244-02C	AQ	SM2340_W	9/5/2007	9/18/2007

Analytical Data Package for Ecology & Environment Engineering, P.C. (EEEEPC)

Client Project No.: Mr. C's Dry Cleaners Site (Complicance)

Mitkem Work Order ID: F1244

September 24, 2007

Prepared For: Ecology & Environment Engineering P.C.
368 Pleasantview Drive
Lancaster, NY 14086
Attn: Mr. Michael Steffan

Prepared By: Mitkem Corporation
175 Metro Center Boulevard
Warwick, RI 02886
(401) 732-3400

SDG Narrative

Mitkem Corporation submits the enclosed data package in response to Ecology & Environment, Inc's Mr. C's Dry Cleaners (Compliance) project. Under this deliverable, analyses results are presented for three aqueous samples that were received on September 5, 2007. Analyses were performed per discussion with client, specifications in the project's contract and the chain of custody form. Following the narrative is the Mitkem Work Order for cross-referencing client sample ID and laboratory sample ID.

The analyses were performed according to NYSDEC ASP protocols (2000update) and reported per NYSDEC ASP requirement for Category A deliverable with the exception of hardness and pH. The analysis results for hardness and pH are presented in the standard Mitkem format.

The following observation and/or deviations are observed for the following analyses:

1. Overall observation:

Where needed, manual integrations were performed to improve data quality. The corrections were reviewed and associated hardcopies generated and reported as required. Manual integrations are coded to provide the data reviewer justification for such action. The codes are labeled on the ion chromatogram signal (GC/MS signal) and chromatogram for GC based analysis as follows:

- M1 peak tailing or fronting.
- M2 peak co-elution.
- M3 rising or falling baseline.
- M4 retention time shift.
- M5 miscellaneous – under this category, the justification is explained.
- M6 software did not integrate peak
- M7 partial peak integration

The enclosed report includes the originals of all data with the exception of logbook pages and certain initial calibrations. Photocopies of logbook pages are included, with the originals maintained on file at the laboratory. The originals of initial calibrations that are shared among several cases are maintained on file at the laboratory, with photocopies included in the data package.

2. Volatile Analysis:

To meet specific project requirements, a 1ppb standard was analyzed to achieve a lower reporting limit. All the target analytes with the exception of the ketones have been reported to 1ppb. The ketones have been reported to 5 ppb.

Trap used for instruments V1: OI Analytical #10 trap containing 8 cm each of Tenax, silica gel and carbon molecular sieve.

GC column used: 30 m x 0.25 mm id (1.4 um film thickness) DB-624 capillary column.

Aqueous samples were hydrochloric acid preserved, pH <2.

Surrogate recovery: recoveries were within the QC limits.

Laboratory control sample/ laboratory control sample duplicate: spike recoveries were within the QC limits. Replicate RPDs were within the QC limits.

Sample analysis: due to high concentration of target analytes expected, sample INFLUENT was initial analyzed at 10x dilution. No other unusual observation was made for this analysis.

2. Wet Chemistry Analyses:

Duplicate: duplicate analysis was performed on sample INFLUENT for pH. Replicate RPDs were within the QC limits.

Sample analysis: no unusual observation was made for the analysis.

All pages in this report have been numbered consecutively, starting with the title page and ending with a page saying only "Last Page of Data Report".

I certify that this data package is in compliance, both technically and for completeness, for other than the conditions detailed above. Release of the data contained in this hardcopy data package has been authorized by the laboratory manager or his designee, as verified by the following signature.

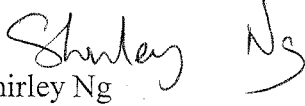
Shirley Ng
Project Manager
09/24/07

Client ID: ENE

Project: Mr. C's Dry Cleaning Compliance

Location: 002700.DC13.02.01.02

Comments: report thru LIMS. VOA---1 ppb ICAL needed, sample 01 may need 10X dilution--VOA only.

Case:

SDG:

PO: 002700.DC13.02.01.02

Report Level: ASP-A

EDD: ENE

HC Due: 09/24/07

Fax Due:

Sample ID	HS Client Sample ID	Collection Date	Date Recv'd	Matrix	Test Code	Lab Test Comments	Hold	MS	SEL	Storage
F1244-01A	INFLUENT	09/04/2007 10:30	09/05/2007	Aqueous	OLM4.2_VOA_W	OLM, NYS--ADD LCS, 1 ppb I	<input type="checkbox"/>	<input type="checkbox"/>	<input type="checkbox"/>	VOA
F1244-01B	INFLUENT	09/04/2007 10:30	09/05/2007	Aqueous	SM4500_H+		<input type="checkbox"/>	<input type="checkbox"/>	<input type="checkbox"/>	B4
F1244-01C	INFLUENT	09/04/2007 10:30	09/05/2007	Aqueous	SM2340_W		<input type="checkbox"/>	<input type="checkbox"/>	<input type="checkbox"/>	M4
F1244-02A	DISCHARGE	09/04/2007 10:30	09/05/2007	Aqueous	OLM4.2_VOA_W	OLM, NYS--ADD LCS, 1 ppb I	<input type="checkbox"/>	<input type="checkbox"/>	<input type="checkbox"/>	VOA
F1244-02B	DISCHARGE	09/04/2007 10:30	09/05/2007	Aqueous	SM4500_H+		<input type="checkbox"/>	<input type="checkbox"/>	<input type="checkbox"/>	B4
F1244-02C	DISCHARGE	09/04/2007 10:30	09/05/2007	Aqueous	SM2340_W		<input type="checkbox"/>	<input type="checkbox"/>	<input type="checkbox"/>	M4
F1244-03A	TRIP BLANK	09/04/2007 10:30	09/05/2007	Aqueous	OLM4.2_VOA_W	OLM, NYS--ADD LCS, 1 ppb I	<input type="checkbox"/>	<input type="checkbox"/>	<input type="checkbox"/>	VOA

Sample Transmittal Documentation

MITKEM CORPORATION

Sample Condition Form

Received By: <u>UEG</u>		Reviewed By: <u>KP</u>		Date: <u>9/5/07</u>		MITKEM Workorder #: <u>F1244</u>	
Client Project: <u>Mr. C</u>				Client: <u>EME</u>			Soil Headspace or Air Bubbles ≥ 1/4"
		Lab Sample ID		Preservation (pH)		VOA Matrix	
				HNO ₃	H ₂ SO ₄	HCl	NaOH
1) Cooler Sealed <input checked="" type="radio"/> Yes / No		<u>F1244</u>	<u>01</u>	<u><2</u>			<u>H</u>
		<u>F1244</u>	<u>02</u>	<u><2</u>			<u>H</u>
2) Custody Seal(s) <input checked="" type="radio"/> Present / Absent		<u>F1244</u>	<u>03</u>				<u>H</u>
<input checked="" type="radio"/> Coolers / Bottles							
<input checked="" type="radio"/> Intact / Broken							
3) Custody Seal Number(s) <u>N/A</u>							
4) Chain-of-Custody <input checked="" type="radio"/> Present / Absent							
5) Cooler Temperature <u>4°C</u>							
Coolant Condition <u>ICE</u>							
6) Airbill(s) <input checked="" type="radio"/> Present / Absent							
Airbill Number(s) <u>FedEx</u>							
<u>8616 4719 6214</u>							
7) Sample Bottles <input checked="" type="radio"/> Intact/Broken/Leaking							
8) Date Received <u>9/5/07</u>							
9) Time Received <u>9:10</u>							
Preservative Name/Lot No:							

VOA Matrix Key:

US = Unpreserved Soil **A** = Air

UA = Unpreserved Aqu. **H** = HCl

M = MeOH **E** = Encore

N = NaHSO₄ **F** = Freeze

See Sample Condition Notification/Corrective Action Form yes / no

Rad OK yes/ no



* Volatiles *

1A
VOLATILE ORGANICS ANALYSIS DATA SHEET

EPA SAMPLE NO.

INFLUENT

Lab Name: MITKEM CORPORATION

Contract:

Lab Code: MITKEM

Case No.:

SAS No.:

SDG No.: MF1244

Matrix: (soil/water) WATER

Lab Sample ID: F1244-01A

Sample wt/vol: 5.000 (g/mL) ML

Lab File ID: V1I9409

Level: (low/med) LOW

Date Received: 09/05/07

% Moisture: not dec. _____

Date Analyzed: 09/07/07

GC Column: DB-624 ID: 0.25 (mm)

Dilution Factor: 10.0

Soil Extract Volume: _____ (uL)

Soil Aliquot Volume: _____ (uL)

CAS NO.	COMPOUND	CONCENTRATION UNITS: (ug/L or ug/Kg) UG/L	Q
75-71-8	Dichlorodifluoromethane	10	U
74-87-3	Chloromethane	10	U
75-01-4	Vinyl Chloride	10	U
74-83-9	Bromomethane	10	U
75-00-3	Chloroethane	10	U
75-69-4	Trichlorofluoromethane	10	U
75-35-4	1,1-Dichloroethene	10	U
67-64-1	Acetone	50	U
75-15-0	Carbon Disulfide	10	U
75-09-2	Methylene Chloride	10	U
156-60-5	trans-1,2-Dichloroethene	10	U
1634-04-4	Methyl tert-butyl ether	10	U
75-34-3	1,1-Dichloroethane	10	U
78-93-3	2-Butanone	50	U
156-59-2	cis-1,2-Dichloroethene	13	
67-66-3	Chloroform	10	U
71-55-6	1,1,1-Trichloroethane	10	U
56-23-5	Carbon Tetrachloride	10	U
107-06-2	1,2-Dichloroethane	10	U
71-43-2	Benzene	10	U
79-01-6	Trichloroethene	56	
78-87-5	1,2-Dichloropropane	10	U
75-27-4	Bromodichloromethane	10	U
10061-01-5	cis-1,3-Dichloropropene	10	U
108-10-1	4-Methyl-2-pentanone	50	U
108-88-3	Toluene	10	U
10061-02-6	trans-1,3-Dichloropropene	10	U
79-00-5	1,1,2-Trichloroethane	10	U
127-18-4	Tetrachloroethene	1500	
591-78-6	2-Hexanone	50	U
124-48-1	Dibromochloromethane	10	U
106-93-4	1,2-Dibromoethane	10	U
108-90-7	Chlorobenzene	10	U
100-41-4	Ethylbenzene	10	U

1A
VOLATILE ORGANICS ANALYSIS DATA SHEET

EPA SAMPLE NO.

INFLUENT

Lab Name: MITKEM CORPORATION

Contract:

Lab Code: MITKEM Case No.:

SAS No.:

SDG No.: MF1244

Matrix: (soil/water) WATER

Lab Sample ID: F1244-01A

Sample wt/vol: 5.000 (g/mL) ML

Lab File ID: V1I9409

Level: (low/med) LOW

Date Received: 09/05/07

% Moisture: not dec. _____

Date Analyzed: 09/07/07

GC Column: DB-624 ID: 0.25 (mm)

Dilution Factor: 10.0

Soil Extract Volume: _____ (uL)

Soil Aliquot Volume: _____ (uL)

CAS NO.	COMPOUND	CONCENTRATION UNITS: (ug/L or ug/Kg) UG/L	Q
-----	m,p-Xylene	10	U
95-47-6-----	o-Xylene	10	U
1330-20-7-----	Xylene (Total)	10	U
100-42-5-----	Styrene	10	U
75-25-2-----	Bromoform	10	U
98-82-8-----	Isopropylbenzene	10	U
79-34-5-----	1,1,2,2-Tetrachloroethane	10	U
541-73-1-----	1,3-Dichlorobenzene	10	U
106-46-7-----	1,4-Dichlorobenzene	10	U
95-50-1-----	1,2-Dichlorobenzene	10	U
96-12-8-----	1,2-Dibromo-3-chloropropane	10	U
120-82-1-----	1,2,4-Trichlorobenzene	10	U
76-13-1-----	1,1,2-Trichloro-1,2,2-Triflu	10	U
79-20-9-----	Methyl Acetate	10	U
110-81-7-----	Cyclohexane	10	U
108-87-2-----	Methylcyclohexane	10	U

1A
VOLATILE ORGANICS ANALYSIS DATA SHEET

EPA SAMPLE NO.

DISCHARGE

Lab Name: MITKEM CORPORATION Contract: _____

Lab Code: MITKEM Case No.: _____ SAS No.: _____ SDG No.: MF1244

Matrix: (soil/water) WATER Lab Sample ID: F1244-02A

Sample wt/vol: 5.000 (g/mL) ML Lab File ID: V1I9408

Level: (low/med) LOW Date Received: 09/05/07

% Moisture: not dec. _____ Date Analyzed: 09/07/07

GC Column: DB-624 ID: 0.25 (mm) Dilution Factor: 1.0

Soil Extract Volume: _____ (uL) Soil Aliquot Volume: _____ (uL)

CAS NO.	COMPOUND	CONCENTRATION UNITS: (ug/L or ug/Kg) UG/L	Q
75-71-8	Dichlorodifluoromethane	1	U
74-87-3	Chloromethane	1	U
75-01-4	Vinyl Chloride	1	U
74-83-9	Bromomethane	1	U
75-00-3	Chloroethane	1	U
75-69-4	Trichlorofluoromethane	1	U
75-35-4	1,1-Dichloroethene	1	U
67-64-1	Acetone	5	U
75-15-0	Carbon Disulfide	1	U
75-09-2	Methylene Chloride	1	U
156-60-5	trans-1,2-Dichloroethene	1	U
1634-04-4	Methyl tert-butyl ether	1	U
75-34-3	1,1-Dichloroethane	1	U
78-93-3	2-Butanone	5	U
156-59-2	cis-1,2-Dichloroethene	1	U
67-66-3	Chloroform	1	U
71-55-6	1,1,1-Trichloroethane	1	U
56-23-5	Carbon Tetrachloride	1	U
107-06-2	1,2-Dichloroethane	1	U
71-43-2	Benzene	1	U
79-01-6	Trichloroethene	1	U
78-87-5	1,2-Dichloropropane	1	U
75-27-4	Bromodichloromethane	1	U
10061-01-5	cis-1,3-Dichloropropene	1	U
108-10-1	4-Methyl-2-pentanone	5	U
108-88-3	Toluene	1	U
10061-02-6	trans-1,3-Dichloropropene	1	U
79-00-5	1,1,2-Trichloroethane	1	U
127-18-4	Tetrachloroethene	2	
591-78-6	2-Hexanone	5	U
124-48-1	Dibromochloromethane	1	U
106-93-4	1,2-Dibromoethane	1	U
108-90-7	Chlorobenzene	1	U
100-41-4	Ethylbenzene	1	U

1A
VOLATILE ORGANICS ANALYSIS DATA SHEET

EPA SAMPLE NO.

DISCHARGE

Lab Name: MITKEM CORPORATION Contract: _____

Lab Code: MITKEM Case No.: _____ SAS No.: _____ SDG No.: MF1244

Matrix: (soil/water) WATER Lab Sample ID: F1244-02A

Sample wt/vol: 5.000 (g/mL) ML Lab File ID: VII9408

Level: (low/med) LOW Date Received: 09/05/07

% Moisture: not dec. _____ Date Analyzed: 09/07/07

GC Column: DB-624 ID: 0.25 (mm) Dilution Factor: 1.0

Soil Extract Volume: _____ (uL) Soil Aliquot Volume: _____ (uL)

CAS NO.	COMPOUND	CONCENTRATION UNITS: (ug/L or ug/Kg) UG/L	Q
-----	m,p-Xylene		1 U
95-47-6-----	o-Xylene		1 U
1330-20-7-----	Xylene (Total)		1 U
100-42-5-----	Styrene		1 U
75-25-2-----	Bromoform		1 U
98-82-8-----	Isopropylbenzene		1 U
79-34-5-----	1,1,2,2-Tetrachloroethane		1 U
541-73-1-----	1,3-Dichlorobenzene		1 U
106-46-7-----	1,4-Dichlorobenzene		1 U
95-50-1-----	1,2-Dichlorobenzene		1 U
96-12-8-----	1,2-Dibromo-3-chloropropane		1 U
120-82-1-----	1,2,4-Trichlorobenzene		1 U
76-13-1-----	1,1,2-Trichloro-1,2,2-Triflu		1 U
79-20-9-----	Methyl Acetate		1 U
110-81-7-----	Cyclohexane		1 U
108-87-2-----	Methylcyclohexane		1 U

1A
VOLATILE ORGANICS ANALYSIS DATA SHEET

EPA SAMPLE NO.

TRIP BLANK

Lab Name: MITKEM CORPORATION

Contract:

Lab Code: MITKEM

Case No.:

SAS No.:

SDG No.: MF1244

Matrix: (soil/water) WATER

Lab Sample ID: F1244-03A

Sample wt/vol: 5.000 (g/mL) ML

Lab File ID: V1I9479

Level: (low/med) LOW

Date Received: 09/05/07

% Moisture: not dec. _____

Date Analyzed: 09/10/07

GC Column: DB-624 ID: 0.25 (mm)

Dilution Factor: 1.0

Soil Extract Volume: _____ (uL)

Soil Aliquot Volume: _____ (uL)

CAS NO.	COMPOUND	CONCENTRATION UNITS: (ug/L or ug/Kg) UG/L	Q
75-71-8	Dichlorodifluoromethane	1	U
74-87-3	Chloromethane	1	U
75-01-4	Vinyl Chloride	1	U
74-83-9	Bromomethane	1	U
75-00-3	Chloroethane	1	U
75-69-4	Trichlorofluoromethane	1	U
75-35-4	1,1-Dichloroethene	1	U
67-64-1	Acetone	5	U
75-15-0	Carbon Disulfide	1	U
75-09-2	Methylene Chloride	1	U
156-60-5	trans-1,2-Dichloroethene	1	U
1634-04-4	Methyl tert-butyl ether	1	U
75-34-3	1,1-Dichloroethane	1	U
78-93-3	2-Butanone	5	U
156-59-2	cis-1,2-Dichloroethene	1	U
67-66-3	Chloroform	1	U
71-55-6	1,1,1-Trichloroethane	1	U
56-23-5	Carbon Tetrachloride	1	U
107-06-2	1,2-Dichloroethane	1	U
71-43-2	Benzene	1	U
79-01-6	Trichloroethene	1	U
78-87-5	1,2-Dichloropropane	1	U
75-27-4	Bromodichloromethane	1	U
10061-01-5	cis-1,3-Dichloropropene	1	U
108-10-1	4-Methyl-2-pentanone	5	U
108-88-3	Toluene	1	U
10061-02-6	trans-1,3-Dichloropropene	1	U
79-00-5	1,1,2-Trichloroethane	1	U
127-18-4	Tetrachloroethene	1	U
591-78-6	2-Hexanone	5	U
124-48-1	Dibromochloromethane	1	U
106-93-4	1,2-Dibromoethane	1	U
108-90-7	Chlorobenzene	1	U
100-41-4	Ethylbenzene	1	U

1A
VOLATILE ORGANICS ANALYSIS DATA SHEET

EPA SAMPLE NO.

TRIP BLANK

Lab Name: MITKEM CORPORATION

Contract:

Lab Code: MITKEM

Case No.:

SAS No.:

SDG No.: MF1244

Matrix: (soil/water) WATER

Lab Sample ID: F1244-03A

Sample wt/vol: 5.000 (g/mL) ML

Lab File ID: V1I9479

Level: (low/med) LOW

Date Received: 09/05/07

% Moisture: not dec. _____

Date Analyzed: 09/10/07

GC Column: DB-624 ID: 0.25 (mm)

Dilution Factor: 1.0

Soil Extract Volume: _____ (uL)

Soil Aliquot Volume: _____ (uL)

CAS NO.	COMPOUND	CONCENTRATION UNITS: (ug/L or ug/Kg) UG/L	Q
-----	m,p-Xylene		1 U
95-47-6-----	o-Xylene		1 U
1330-20-7-----	Xylene (Total)		1 U
100-42-5-----	Styrene		1 U
75-25-2-----	Bromoform		1 U
98-82-8-----	Isopropylbenzene		1 U
79-34-5-----	1,1,2,2-Tetrachloroethane		1 U
541-73-1-----	1,3-Dichlorobenzene		1 U
106-46-7-----	1,4-Dichlorobenzene		1 U
95-50-1-----	1,2-Dichlorobenzene		1 U
96-12-8-----	1,2-Dibromo-3-chloropropane		1 U
120-82-1-----	1,2,4-Trichlorobenzene		1 U
76-13-1-----	1,1,2-Trichloro-1,2,2-Triflu		1 U
79-20-9-----	Methyl Acetate		1 U
110-81-7-----	Cyclohexane		1 U
108-87-2-----	Methylcyclohexane		1 U



* Wet Chemistry *

Mitkem Corporation

Date: 19-Sep-07

Client: Ecology and Environment

Client Sample ID: INFLUENT

Lab ID: F1244-01

Project: Mr. C's Dry Cleaning

Collection Date: 09/04/07 10:30

Analyses	Result	Qual	RL	Units	DF	Date Analyzed	Batch ID
HARDNESS by Calculation Hardness, Ca/Mg (As CaCO3)	500			SM2340_W 4.0 mg/L CaCO3		109/18/2007 19:01	32240
pH VALUE pH	6.9			SM4500_H+ 1.0 S.U.		109/05/2007 0:00	R23761

Qualifiers: ND - Not Detected at the Reporting Limit
J - Analyte detected below quantitation limits
B - Analyte detected in the associated Method Blank
DF - Dilution Factor

S - Spike Recovery outside accepted recovery limits
R - RPD outside accepted recovery limits
E - Value above quantitation range
RL - Reporting Limit

Mitkem Corporation

Date: 19-Sep-07

Client: Ecology and Environment

Client Sample ID: DISCHARGE

Lab ID: F1244-02

Project: Mr. C's Dry Cleaning

Collection Date: 09/04/07 10:30

Analyses	Result	Qual	RL	Units	DF	Date Analyzed	Batch ID
HARDNESS by Calculation							
Hardness, Ca/Mg (As CaCO ₃)	490			4.0 mg/L CaCO ₃		109/18/2007 19:04	32240
pH VALUE							
pH	8.2			1.0 S.U.		109/05/2007 0:00	R23761

Qualifiers: ND - Not Detected at the Reporting Limit
J - Analyte detected below quantitation limits
B - Analyte detected in the associated Method Blank
DF - Dilution Factor

S - Spike Recovery outside accepted recovery limits
R - RPD outside accepted recovery limits
E - Value above quantitation range
RL - Reporting Limit

ANALYTICAL QC SUMMARY REPORT

CLIENT: Ecology and Environment
 Work Order: F1244
 Project: Mr. C's Dry Cleaning

TestCode: SM2340_W

Sample ID: MB-32240	SampType: MBLK	TestCode: SM2340_W	Prep Date: 9/14/2007	Run ID: OPTIMA3_070918F
Client ID: MB-32240	Batch ID: 32240	Units: mg/L CaCO3	Analysis Date: 9/18/2007	SeqNo: 692384
Analyte	Result	PQL	SPK Ref Val	RPD Ref Val
Hardness, Ca/Mg (As CaCO3)	ND	4.0	%REC LowLimit HighLimit	%RPD RPDLimit Qual

0037

Qualifiers: ND - Not Detected at the Reporting Limit
 J - Analyte detected below quantitation limits
 S - Spike Recovery outside accepted recovery limits
 R - RPD outside accepted recovery limits
 B - Analyte detected in the associated Method Blank

ANALYTICAL QC SUMMARY REPORT

CLIENT: Ecology and Environment
Work Order: F1244
Project: Mr. C's Dry Cleaning

TestCode: SM4500_H+

Sample ID: F1244-01BDUP Samp Type: DUP TestCode: SM4500_H+ Run ID: PH METER_070905A
Client ID: INFLUENT Batch ID: R23761 Units: S.U. SeqNo: 686778

Prep Date: 9/5/2007
Analysis Date: 9/5/2007

Analyte	SPK value	SPK Ref Val	%REC	LowLimit	HighLimit	RPD Ref Val	%RPD	RPDLimit	Qual
pH	6.970	0	0	0	0	6.920	0.72	20	

0038

Qualifiers: ND - Not Detected at the Reporting Limit S - Spike Recovery outside accepted recovery limits B - Analyte detected in the associated Method Blank
J - Analyte detected below quantitation limits R - RPD outside accepted recovery limits

Last Page of Data Report

Attachment C
Soil Vapor Mitigation System Inspection Forms
First Presbyterian Church
27 Whaley Avenue

**System Inspection Field Form
Soil Vapor Mitigation System
Mr. C's Dry Cleaners Site
Village of East Aurora, Erie County, NY
NYSDEC Site # 9-15-157**

STRUCTURE INSPECTION FORM

Routine or Non-Routine (underline one)

Address: First Presbyterian Church 9 Payne St. Tracking Number: PCI-001

Date of Inspection: 9/12/07
Date of Last Inspection: 3/17/07

Have the following items changed since the last visit?

	No	Yes	If yes, explain...
Building Footprint	x		
Basement/Slab Occupancy	x		
Heating/Ventilating Systems	x		
Basement Finish	x		
Crawlspace	x		
Drains, Sumps, Floor Cracks	x		
Wall Penetrations, Cracks	x		
Appliances (in basement)	x		
Ownership	x		
Siding	x		

***If any of these items have changed, a redesign may be required.
Contact the maintenance supervisor for field review.***

Deviations/Comments

Fan stack support on west exterior building wall is loose at the roof line. IEG notified .

Notations

NRI – Non-routine Inspection

PCI - Post Commissioning Inspection

RI - Routine Inspection

Performed by: MG Steffan/JJ Kohler Date: 9/12/07

**Re-Commissioning Field Form
Soil Vapor Mitigation System
Mr. C's Dry Cleaners Site
Village of East Aurora, Erie County, NY
NYSDEC Site # 9-15-157**

TEST DATA AND BACKDRAFT

Routine or Non-Routine (underline one)

Address: First Presbyterian Church 9 Payne St. _____ Tracking Number: _____ PCI-001
 Date of Inspection: 9/12/07
 Date of Last Inspection: n/a

Manometer Reading at Fan Inlet

Prior Visit: see below Date: _____
 As found: _____
 As left: _____

Manometer Reading at Suction Points (SSD#)

SSD#	Suction Points							
	1	2	3	4	5	6	7	8
Manometer Reading (Prior)	+1"	+2"	+4"					
Manometer Reading (As Found)	+1"	+2"	+4"					
Manometer Reading (As Left)								

Valves and manometers installed at proper location? Yes

Communication Test (* See Comments)

Fan On	Suction Points							
	Point A	Point B	Point C	Point D	Point E	Point F	Point G	Point H
Test point identifier	1-A	1-B	2-A	2-B	2-C	2-D	3-A	3-B/3-C
Micromanometer Reading	+1"	+1"	+2"	+2"	+2"	+2"	+4"	+4"/
Distance to Closest SSP (ft)								
Smoke Test	OK	OK	OK	OK	OK	OK	OK	OK/OK

Fan Off-N/A	Suction Points							
	Point A	Point B	Point C	Point D	Point E	Point F	Point G	Point H
Test point identifier	NOT PERFORMED							
Micromanometer Reading								
Distance to Closest SSP (ft)								
Smoke Test								

	As Found*		As Left*	
	Yes	No	Yes	No
All fans in operation?	x	_____	x	_____
Winter conditions simulated?	_____	x	_____	x
Each test point tested?	x	_____	x	_____
Each test point sealed after testing?	x	_____	x	_____
Vacuum <-0.004 observed at each test point?	x	_____	x	_____
Smoke entered each test point?	x	_____	x	_____
All valves set prior to re-commissioning comm. test?	_____	x	_____	x

	As Found		As Left	
	Yes	No	Yes	No
Backdraft Test				
Windows closed?	x		x	
Venting appliances on?	x		x	
Doors closed?	x		x	
Combustion sources on?	x		x	
Backdraft Review				
Hot water heater?	n/a		n/a	
Furnace/Boiler?	x		x	
Fireplace?	n/a		n/a	
Dryer?	n/a		n/a	
Owner notified of existing backdraft condition?		none		noted
Was a previous backdraft condition present during any previous visit?		no		

	As Left	
	Yes	No
Redline Drawing		
Piping redlines complete?	x	
Each switch and electrical tie in are identified?	x	
Cracks/penetrations are identified?	x	Fans checkd
As-built notes are complete?	x	
New ventilation devices identified?		x

Deviations/Comments

- * As-found conditions = before corrective action.
- * As-left conditions = after corrective action.

Performed by: MG Steffan/JJ Kohler Date: 9/12/07

**System Inspection Field Form
Soil Vapor Mitigation System
Mr. C's Dry Cleaners Site
Village of East Aurora, Erie County, NY
NYSDEC Site # 9-15-157**

FAN AND ELECTRICAL INSPECTION FORM

Routine or Non-Routine (underline one)

Address: First Presbyterian Church 9 Payne St. Tracking Number: PCI-001

Date of Inspection: 9/12/07 Date of Last Inspection: 3/17/07

Electric Meter Number: Last visit: n/a Current visit: n/a

Equipment Documentation

As Found		Manometer Reading (in. H ₂ O)	
Fan Model	Suction Point	Prior	Current
Vesta	#1		1"
Vesta	#2		2"
Vesta	#3		4"

As Left		Manometer Reading (in. H ₂ O)	
Fan Model	Suction Point	Prior	Current
Vesta	#1		1"
Vesta	#2		2"
Vesta	#3		4"

System Re-commissioning

Is there a differential pressure shown in U-Tube manometer?

If yes, provide readings.

Was each fan shroud removed? No Fan shrouds present

Is each fan mounted securely?

Are coupling connections secured?

Does each fan run when the switch is in the ON position?

Does each fan shut down when the switch is in the OFF position?

Is excessive noise heard when fan is running?

Does each fan induce suction when running?

Is switch is locked in the ON position?

As Found		As Left	
Yes	No	Yes	No
<u>x</u>	<u>_____</u>	<u>x</u>	<u>_____</u>
<u>_____</u>	<u>n/a</u>	<u>_____</u>	<u>_____</u>
<u>x</u>	<u>_____</u>	<u>x</u>	<u>_____</u>
<u>x</u>	<u>_____</u>	<u>x</u>	<u>_____</u>
<u>x</u>	<u>_____</u>	<u>x</u>	<u>_____</u>
<u>_____</u>	<u>x</u>	<u>_____</u>	<u>x</u>
<u>x</u>	<u>_____</u>	<u>x</u>	<u>_____</u>
<u>x</u>	<u>_____</u>	<u>x</u>	<u>_____</u>

Electrical Check

Are Romex connections secured?

Is each junction box closed?

Are conduit properly supported?

Does each fan start when the switch is ON position?

Are any appliances affected by fan operation?

Does each fan stop when the switch is in OFF position?

Are mitigation system labels applied?

Are the correct labels applied in the proper locations?

<u>x</u>	<u>_____</u>	<u>x</u>	<u>_____</u>
<u>x</u>	<u>_____</u>	<u>x</u>	<u>_____</u>
<u>x</u>	<u>_____</u>	<u>x</u>	<u>_____</u>
<u>x</u>	<u>_____</u>	<u>x</u>	<u>_____</u>
<u>_____</u>	<u>x</u>	<u>_____</u>	<u>x</u>
<u>x</u>	<u>_____</u>	<u>x</u>	<u>_____</u>
<u>x</u>	<u>_____</u>	<u>x</u>	<u>_____</u>
<u>x</u>	<u>_____</u>	<u>x</u>	<u>_____</u>

Deviations/Comments

Fan stack support on west exterior building wall is loose at the roof line. IEG was notified and repair was completed on 9/25/07

Performed by: MG Steffan/JJ Kohler Date: 9/12/07

**System Inspection Field Form
Soil Vapor Mitigation System
Mr. C's Dry Cleaners Site
Village of East Aurora, Erie County, NY
NYSDEC Site # 9-15-157**

PIPING, SLAB, AND WALL INSPECTION FORM

Routine or Non-Routine (underline one)

Address: First Presbyterian Church 9 Payne St. Tracking Number: PCI-001

Date of Inspection: 9/12/07
Date of Last Inspection: 3/17/07

	As Found		As Left	
	Yes	No	Yes	No
Piping Check				
Is glue evident at joints?	x	_____	x	_____
Are system suction points sealed?	x	_____	x	_____
Is piping system properly supported?	x	_____	x	_____
Are valves and manometers installed at proper locations?	x	_____	x	_____
Is excessive noise heard in piping joints?	_____	x	_____	x
Were piping modifications and 10% of old joints smoke tested?	x	_____	x	_____
Does smoke enter joints?	_____	x	_____	x
If yes: Was joint re-sealed?	_____	_____	_____	_____
Does smoke enter re-sealed joint?	_____	x	_____	x
Slab Check				
Was each identified slab crack, repair, or modification smoke tested?	-	_____	-	_____
Does smoke enter?	-	_____	-	_____
If yes: Was area re-sealed with approved sealant*?	-	_____	-	_____
Does smoke enter re-sealed area?	-	_____	-	_____
Check/clean drain(s)/Dranjer(s) TM ?	x	_____	x	_____
Were drain(s)/Dranjer(s) TM smoke-tested?	x	_____	x	_____
Wall Check				
Was each visible wall crack smoke tested?	x	_____	x	_____
Is movement observed at wall cracks?	_____	x	_____	x
If yes: Was crack was re-sealed with approved sealant?	_____	_____	-	_____
Does smoke enter re-sealed crack?	_____	_____	-	_____
Was the open course of top wall smoke tested?	_____	_____	-	_____
Does smoke enter top course?	_____	x	_____	x
If yes: Open block re-sealed with approved sealant?	-	_____	-	_____
Does smoke enter open block tops?	_____	x	_____	x

Deviations/Comments

Water stains noted on lower half of SE play room wall, water leaking into room interior
(wet carpeting and wall staining). Noted water noise in suction point in fan #1-does not
affect operations. Exterior storm water drainage issues from roof and surrounding ground
area noted on south side of church outside play room.

Performed by: MG Steffan/JJ Kohler Date: 9/12/07

* approved sealant shall be an odorless, non-toxic, non-flammable, environmentally safe product



ecology and environment engineering, p.c.

International Specialists in the Environment

BUFFALO CORPORATE CENTER 368 Pleasant View Drive, Lancaster, New York 14086
Tel: 716/684-8060, Fax: 716/684-0844

Mr. C's Dry Cleaners Site
NYSDEC Site No.: 9-15-157
NYSDEC Work Assignment No.: D004442-DC02 & DC13
Village of East Aurora, Erie County, New York

Sub-slab Depressurization System Initial Commissioning Review

Street Address: 9 Paine Avenue
City/State/ Zip: East Aurora, New York 14052

Property Owner: First Presbyterian Church of East Aurora

Property Owner Phone Number(s): Church – 716-652-0160, Bill Larson – 716-652-7650

Date of Installation: October 2004

Date of Startup Operation: October 2004

System Installation Inspected by: Ecology and Environment Engineering, P. C.

Inspector(s): Greg Jones and M. Steffan

Property Owner Field Procedures Performed:

- | | |
|---|---|
| <input checked="" type="checkbox"/> Access Agreement signed by Owner | <input checked="" type="checkbox"/> Operating Instructions Installed |
| <input checked="" type="checkbox"/> Inspection of Final System Installation | <input checked="" type="checkbox"/> Emergency Contact Information Installed |
| <input checked="" type="checkbox"/> Review of Sub-slab Communication Test Results | <input checked="" type="checkbox"/> Review of System Operations with Property Owner |
| <input checked="" type="checkbox"/> Acceptable Cleanup at Completion | |

Additional Comments:

Subcontractor Project Documentation Received:

Subcontractor Name: Mitigation Tech, 55 Shumway Road, Brockport, New York 14420 - 585-637-7430

- | | |
|--|---|
| <input checked="" type="checkbox"/> Photo documentation | <input checked="" type="checkbox"/> Record drawings – Seeler Eng, P. C. |
| <input type="checkbox"/> Sub-slab Communication Test Results | <input checked="" type="checkbox"/> Product warranties |

Additional Comments:

- Post commissioning inspection or air sampling required within the next heating season or 11/05. – **Air Sampling 1/25/05, 6/26/06**
- Routine Inspection and Maintenance 18 months after Post commission inspection (PCI) & air sampling - **RI – 3/17/07, PCI – 9/12/07**

Submitted By: M. Steffan Dated: 9/18/07

**System Inspection Field Form
Soil Vapor Mitigation System
Mr. C's Dry Cleaners Site
Village of East Aurora, Erie County, NY
NYSDEC Site # 9-15-157**

STRUCTURE INSPECTION FORM

Routine or Non-Routine (underline one)

Address: 27 Whaley Avenue Tracking Number: PCI-002

Date of Inspection: 9/12/07
Date of Last Inspection: June '06

Have the following items changed since the last visit?

	No	Yes	If yes, explain...
Building Footprint	x		
Basement/Slab Occupancy	x		
Heating/Ventilating Systems	x		Forced hot air/hot water tank
Basement Finish	x		
Crawlspace	x		No crawl spaces below livable areas
Drains, Sumps, Floor Cracks	x		Floor drain/hole in basement floor w/ clear sealed cover
Wall Penetrations, Cracks	x		
Appliances (in basement)	x		Washer and dryer
Ownership		x	Mr. David DuBois 465-4027 (cell)
Siding	x		

***If any of these items have changed, a redesign may be required.
Contact the maintenance supervisor for field review.***

Deviations/Comments

Former property owner Scott Higley
One test point at SSVE point #1 installed.
All other suction points sealed at floor line

Notations

NRI - Non-Routine Inspectio

PCI - Post Commissioning Inspection

RI - Routine Inspection

Performed by: MG Steffan/JJ Kohler Date: 9/12/07

**Re-Commissioning Field Form
Soil Vapor Mitigation System
Mr. C's Dry Cleaners Site
Village of East Aurora, Erie County, NY
NYSDEC Site # 9-15-157**

TEST DATA AND BACKDRAFT

Routine or Non-Routine (underline one)

Address: 27 Whaley Avenue Tracking Number: PCI-002
 Date of Inspection: 9/12/07
 Date of Last Inspection: n/a

Manometer Reading at Fan Inlet

Prior Visit: _____ Date: _____
 As found: _____
 As left: _____

Manometer Reading at Suction Points (SSD#)-Located on Point #3

Suction Points								
SSD#	1	2	3	4	5	6	7	8
Manometer Reading (Prior)	-	-	-	-	-	-		
Manometer Reading (As Found)	+1.5"	+1.5"						
Manometer Reading (As Left)								

Valves and manometers installed at proper location? Yes

Communication Test (* See Comments)

Suction Points								
Fan On	Point A	Point B	Point C	Point D	Point E	Point F	Point G	Point H
Test point identifier	P-1	P-2	P-3	P-4	P-5	P-6		
Micromanometer Reading			+1.5"					
Distance to Closest SSP (ft)								
Smoke Test	yes	yes	yes	yes	yes	yes		

Suction Points								
Fan Off-N/A	Point A	Point B	Point C	Point D	Point E	Point F	Point G	Point H
Test point identifier	Not Performed							
Micromanometer Reading								
Distance to Closest SSP (ft)								
Smoke Test								

	As Found*		As Left*	
	Yes	No	Yes	No
All fans in operation?	<u>x</u>	_____	<u>x</u>	_____
Winter conditions simulated?	_____	<u>x</u>	_____	<u>x</u>
Each test point tested?	<u>x</u>	_____	<u>x</u>	_____
Each test point sealed after testing?	<u>x</u>	_____	<u>x</u>	_____
Vacuum <-0.004 observed at each test point?	<u>x</u>	_____	<u>x</u>	_____
Smoke entered each test point?	<u>x</u>	_____	<u>x</u>	_____
All valves set prior to re-commissioning comm. test?	<u>x</u>	_____	<u>x</u>	_____

	As Found		As Left	
	Yes	No	Yes	No
Backdraft Test				
Windows closed?	x		x	
Venting appliances on?	x		x	
Doors closed?	x		x	
Combustion sources on?	x		x	
Backdraft Review				
Hot water heater?	x		x	
Furnace/Boiler?	-		-	
Fireplace?	-		-	
Dryer?	n/a		n/a	
Owner notified of existing backdraft condition?		n/a		n/a
Was a previous backdraft condition present during any previous visit?	no	x		x

	As Left	
	Yes	No
Redline Drawing		
Piping redlines complete?	x	
Each switch and electrical tie in are identified?	x	
Cracks/penetrations are identified?	-	-
As-built notes are complete?	x	
New ventilation devices identified?	-	-

Deviations/Comments

- * As-found conditions = before corrective action.
- * As-left conditions = after corrective action.

Performed by: MG Steffan/JJ Kohler Date: 9/12/07

System Inspection Field Form
 Soil Vapor Mitigation System
 Mr. C's Dry Cleaners Site
 Village of East Aurora, Erie County, NY
 NYSDEC Site # 9-15-157

CRAWLSPACE INSPECTION FORM

Routine or Non-Routine (underline one)

Address: 27 Whaley Avenue Tracking Number: PCI-002

Date of Inspection: 9/12/07

Inaccessible Crawlspace	As Found*		As Left*	
	Crawlspace 1	Crawlspace 2	Crawlspace 1	Crawlspace 2
Suction Point #				
Crawlspace Volume	cf.	cf.	cf.	cf.
Suction Pipe Diameter	in.	in.	in.	in.
Manometer reading	in. WC	in. WC	in. WC	in. WC

Accessible Crawlspace	As Found*		As Left*	
	Crawlspace 1	Crawlspace 2	Crawlspace 1	Crawlspace 2
Suction Point #				
Smoke test each membrane				
Smoke entered seam				

Deviations/Comments

"No Crawl Spaces"

EPDM on floor of existing fruit cellar. Smoke test performed on liner and seams.

No intake of smoke noted during construction.

- * As-found conditions = before corrective action.
- * As-left conditions = after corrective action.

Performed by: MG Steffan/JJ Kohler Date: 9/12/07

**System Inspection Field Form
Soil Vapor Mitigation System
Mr. C's Dry Cleaners Site
Village of East Aurora, Erie County, NY
NYSDEC Site # 9-15-157**

PIPING, SLAB, AND WALL INSPECTION FORM

Routine or Non-Routine (underline one)

Address: 27 Whaley Avenue Tracking Number: PCI-002

Date of Inspection: 9/12/07

Date of Last Inspection:

	As Found		As Left	
	Yes	No	Yes	No
Piping Check				
Is glue evident at joints?	x	_____	x	_____
Are system suction points sealed?	x	_____	x	_____
Is piping system properly supported?	x	_____	x	_____
Are valves and manometers installed at proper locations?	x	_____	x	_____
Is excessive noise heard in piping joints?	_____	x	_____	x
Were piping modifications and 10% of old joints smoke tested?	x	_____	x	_____
Does smoke enter joints?	_____	x	_____	x
If yes: Was joint re-sealed?	_____	_____	_____	_____
Does smoke enter re-sealed joint?	n/a	_____	n/a	_____
Slab Check				
Was each identified slab crack, repair, or modification smoke tested?	x	_____	x	_____
Does smoke enter?	_____	x	_____	x
If yes: Was area re-sealed with approved sealant*?	n/a	_____	_____	n/a
Does smoke enter re-sealed area?	n/a	_____	_____	n/a
Check/clean drain(s)/Dranjer(s) TM ?	x	_____	x	_____
Were drain(s)/Dranjer(s) TM smoke-tested?	x	_____	x	_____
Wall Check				
Was each visible wall crack smoke tested?	n/a	_____	n/a	_____
Is movement observed at wall cracks?	n/a	_____	n/a	_____
If yes: Was crack was re-sealed with approved sealant?	n/a	_____	n/a	_____
Does smoke enter re-sealed crack?	n/a	_____	n/a	_____
Was the open course of top wall smoke tested?	n/a	_____	n/a	_____
Does smoke enter top course?	n/a	_____	n/a	_____
If yes: Open block re-sealed with approved sealant?	n/a	_____	n/a	_____
Does smoke enter open block tops?	n/a	_____	n/a	_____

Deviations/Comments

Performed by: MG Steffan/JJ Kohler Date: 9/12/07

* approved sealant shall be an odorless, non-toxic, non-flammable, environmentally safe product

**System Inspection Field Form
Soil Vapor Mitigation System
Mr. C's Dry Cleaners Site
Village of East Aurora, Erie County, NY
NYSDEC Site # 9-15-157**

FAN AND ELECTRICAL INSPECTION FORM

Routine or Non-Routine (underline one)

Address: 27 Whaley Avenue Tracking Number: PCI-001

Date of Inspection: 9/12/07 Date of Last Inspection: n/a

Electric Meter Number: Last visit: n/a Current visit: n/a

Equipment Documentation

As Found		Manometer Reading (in. H ₂ O)	
Fan Model	Suction Point	Prior	Current
Vesta	P3		+1.5"

As Left		Manometer Reading (in. H ₂ O)	
Fan Model	Suction Point	Prior	Current
Vesta	P3		+1.5"

System Re-commissioning

Is there a differential pressure shown in U-Tube manometer?

If yes, provide readings.

Was each fan shroud removed? No Fan shrouds present

Is each fan mounted securely?

Are coupling connections secured?

Does each fan run when the switch is in the ON position?

Does each fan shut down when the switch is in the OFF position?

Is excessive noise heard when fan is running?

Does each fan induce suction when running?

Is switch is locked in the ON position?

As Found		As Left	
Yes	No	Yes	No
	x		x
n/a		n/a	
n/a		n/a	
x		x	
x		x	
x		x	
x		x	
	x		x
x		x	
	No switch		No switch

Electrical Check

Are Romex connections secured?

Is each junction box closed?

Are conduit properly supported?

Does each fan start when the switch is ON position?

Are any appliances affected by fan operation?

Does each fan stop when the switch is in OFF position?

Are mitigation system labels applied?

Are the correct labels applied in the proper locations?

x		x	
n/a		n/a	
x		x	
x		x	
	x		x
x		x	
x		x	
x		x	

Deviations/Comments

The fan is located in the attic of the second floor apartment

Performed by: MG Steffan/JJ Kohler Date: 9/12/07

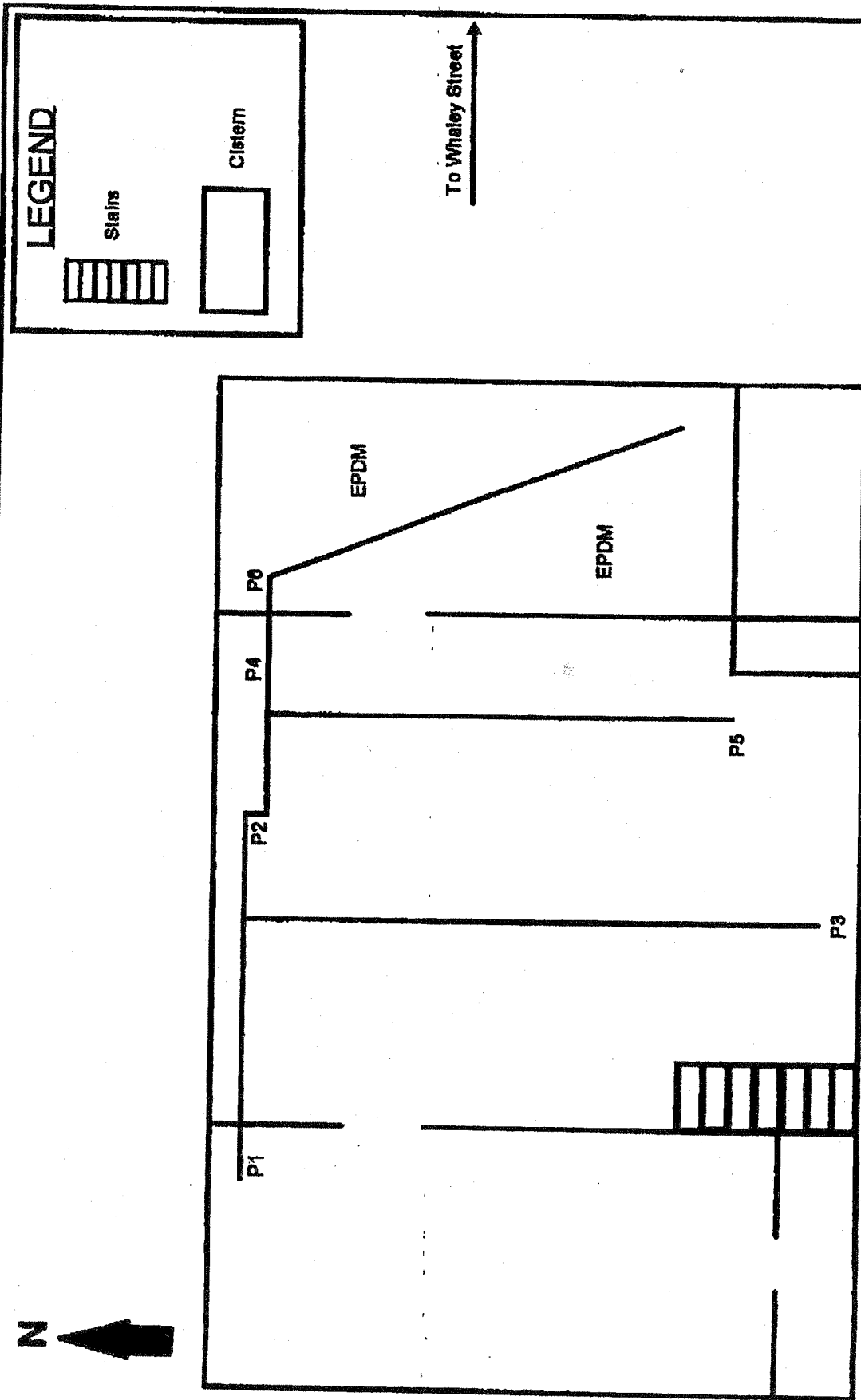

OP-TECH ENVIRONMENTAL SERVICES, INC.		Date:	February 2005	Project No.:	FDCH 0003
27 Whaley Street Basement	NYSDEC Region 9 27 Whaley Street East Aurora, NY	Scale:	Not To Scale	Figure No.:	1
		Drawn By:	LG/jaw	Location:	East Aurora, NY



OP-TECH

ENVIRONMENTAL SERVICES, INC.

January 3, 2005

Mr. David J. Chiusano
 Remediation Bureau E, Section A
 Division of Environmental Remediation
 NYS Department of Environmental Conservation
 625 Broadway, 12th Floor
 Albany, New York 12233-7013

RE: MR. C'S DRY CLEANERS SITE #915157
 QUOTATION FOR SYSTEM INSTALLATION
 27 WHALEY STREET - EAST AURORA, NY

Dear David:

Op-Tech Environmental Services is pleased to provide the following quotation to evaluate and install an active sub-slab depressurization system in the residence located at 27 Whaley Street in East Aurora, New York. Op-Tech will utilize Mitigation Technologies to install the system.

On Wednesday December 29, 2004 the residence was evaluated to determine the appropriate remediation method. Based on the evaluation, Mitigation Technologies has recommended the systems as outlined in their attached quotation.

The total estimated cost of the project is listed below. This cost is based on a subcontractor markup of 10% and 15 hours of Op-Tech project management time. In addition, I have estimated the cost associated with the site evaluation.

System Installation

Mitigation Tech (\$2,200+ 10%)	\$2,420.00
Op-Tech Management (15 hours)	\$ 825.00

Site Evaluation

Mitigation Tech (\$330 + 10%)	\$ 363.00
Op-Tech	\$ 165.00

mitigation tech radon correction specialists

January 3, 2004

Ms. Linda Grimmer
OP-TECH Environmental Services, Inc.
108 Sawyer Ave.
Tonawanda, NY 14150
Via fax: 716-873-7807

Re: Sub-slab Ventilation -- DEC Site # 915157 (Mr. C's Cleaners)
Higley residence, 27 Whalcy St., East Aurora, NY

Based on our discussion and survey, following is our proposal to provide environmental gas mitigation by active sub-slab depressurization. Cost and system configuration are considered to be close estimates based on field observations and homeowner consultation. All work will comply with EPA Radon mitigation standard 402-R93-078.

Furnish and Install:

- Professional consultation, design and supervision
- (1) FESTA Technologies 3.92 wci Legend [or as indicated by field measurement] centrifugal in-line fan to provide sub-slab ventilation via 3" schedule 40 pvc pipe to roof exhaust, attic fan and interior pipe to roof exhaust, with switched electrical connection
- (6) Suction points as follows: connection via 2" or 3" pvc pipe to cavities in sub-slab, with urethane seal, strategically located based on field observations at approximately uniform intervals at or near main basement perimeter, with balancing valve(s)
- (1) suction point at horizontal air collection loop recessed in front dirt basement area
- .045" EPDM rubberized membrane to cover front dirt basement area
- (1) Vacuum indicator on vertical pipe run
- Seal floor cracks and openings to sub-slab with urethane caulk or mortar
- Vacuum testing to measure and balance effective pressure field
- Three year warranty; labor and installed components; although system design is based on achieving a sufficient pressure differential, no specific warranty of effectiveness -- effectiveness shall be determined by continuing field measurement provided by others
- Customer to clear work area
- Monthly fan operating cost is approximately \$8.00

Labor and Material:.....\$2200.00

MITIGATION TECH

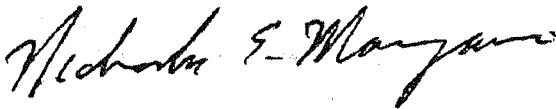

Nicholas E. Mougamis EPA listing # 15415-I ; NEHA ID# 100722

Please contact me at (716) 873-7680 or Nick, of Mitigation Tech, at (585) 402-9812, should you have questions or require additional information. Thank you.

Sincerely,

OP-TECH ENVIRONMENTAL SERVICES, INC.

Linda J. Grimmer
Buffalo Branch Manager

/ljg
2005.01.01

Enclosure

Cc: Gregory P. Sutton, P.E., NYSDEC



ecology and environment engineering, p.c.

International Specialists in the Environment

BUFFALO CORPORATE CENTER 368 Pleasant View Drive, Lancaster, New York 14086
Tel: 716/684-8060, Fax: 716/684-0844

Mr. C's Dry Cleaners Site
NYSDEC Site No.: 9-15-157
NYSDEC Work Assignment No.: D004442-DC02 & DC13
Village of East Aurora, Erie County, New York

Sub-slab Depressurization System **Initial Commissioning Review**

Street Address: 27 Whaley Avenue
City/State/ Zip: East Aurora, New York 14052

Property Owner: Dave DuBois

Property Owner Phone Number(s): 716-465-4027

Date of Installation: February 2005

Date of Startup Operation: February 2005

System Installation Inspected by: Ecology and Environment Engineering, P. C.

Inspector(s): Greg Jones and M. Steffan

Property Owner Field Procedures Performed:

- | | |
|---|---|
| <input checked="" type="checkbox"/> Access Agreement signed by Owner | <input checked="" type="checkbox"/> Operating Instructions Installed |
| <input checked="" type="checkbox"/> Inspection of Final System Installation | <input checked="" type="checkbox"/> Emergency Contact Information Installed |
| <input checked="" type="checkbox"/> Review of Sub-slab Communication Test Results | <input checked="" type="checkbox"/> Review of System Operations with Property Owner |
| <input checked="" type="checkbox"/> Acceptable Cleanup at Completion | |

Additional Comments:

Subcontractor Project Documentation Received:

Subcontractor Name: OP-TECH / Mitigation Tech, 55 Shumway Road, Brockport, New York 14420
- 585-637-7430

- | | |
|--|---|
| <input checked="" type="checkbox"/> Photo documentation | <input checked="" type="checkbox"/> Record drawings – Sketches only |
| <input type="checkbox"/> Sub-slab Communication Test Results | <input checked="" type="checkbox"/> Product warranties |

Additional Comments:

- Post commissioning inspection or air sampling required within the next heating season or 11/05. – **Air Sampling 6/26/06**
- Routine Inspection and Maintenance 18 months after Post commission inspection (PCI) & air sampling - **RI – 6/26/06, PCI – 9/12/07**

Submitted By: M. Steffan Dated: 9/18/07

Attachment D
Summary of Site Utility Costs and Projections
April 2007 to September 2007

Mr. C's Dry Cleaners Site - Remedial Treatment Utility Costs

NYSDEC Work Assignment #DC13.02.01.01

12 Months of System Operation and Maintenance

September 2007 Report

Gas and Electric		Utility Budget:												ATTACHMENT C			
Utility Provider	Account #	E&E Cost Center	Description	May-2007	Jun-2007	Jul-2007	Aug-2007	Sep-2007	Oct-2007	Nov-2007	Dec-2007	Electric:	Telephone:	Gas	Total:	Ave./Month	
New York State E&G	06-311-11-002616-26	002700.DC13.02.01	Mr. C's Electric Costs	\$ 1,560.80	\$ 1,342.24	\$ 1,295.51	\$ 1,199.44						\$25,800.00	\$540.00	\$720.00	\$27,060.00	
New York State E&G	76-311-11-015900-18		Agway Site - Electric	\$189.80	\$613.49	\$538.92	\$174.13										
National Fuel Gas	5819628-05	002700.DC13.02.01	Mr. C's Natural Gas Costs	\$ 66.14	\$ -	\$ -	\$ -										
			Totals	\$ 1,816.74	\$ 1,955.73	\$ 1,834.43	\$ 1,373.57	\$ -	\$ -	\$ -	\$ -	\$ -	\$ -	\$ -	\$ -	\$ -	\$ -
			Mr. C's Electric Costs	Jan-2008	Feb-2008	Mar-2008	Apr-2008										Ave./Month
			Agway Electric														\$ 1,799.33
			Mr. C's Natural Gas Costs														\$ 505.45
			Totals	\$0.00	\$ -	\$ -	\$ -	\$ -	\$ -	\$ -	\$ -	\$ -	\$ -	\$ -	\$ -	\$ -	\$ 66.14
			Electric		\$ 6,201.28												\$ 2,370.92
			Natural Gas		\$ 66.14												
Grand Total - NYSE&G/National Fuel Gas Costs To Date				\$	6,267.42												
Phone																	
Utility Provider	Phone #	E&E Cost Center	Location Description	May-2007	Jun-2007	Jul-2007	Aug-2007	Sep-2007	Oct-2007	Nov-2007	Dec-2007						
Verizon	716-652-0094	002700.DC13.02.01	Mr. C's Telephone Costs	\$ 44.89	\$ 44.98	\$ 46.71	\$ 55.95										
Account#																	
	716 652 0094 416 26 2			Jan-2008	Feb-2008	Mar-2008	Apr-2008										Ave./Month
																	\$ 64.18
Grand Total - Verizon Costs to Date				\$	192.53												
Grand Total All Utilities To Date				\$	6,459.95												
*****This includes initial connection fees for the phone company of approximately \$180.																	

Mr. C's Dry Cleaners Site - Remedial Treatment Utility Costs
NYSDEC Work Assignment #DC13
12 Months of System Operation and Maintenance
September 2007 Report

Monthly Treatment System Operational Time by O&M Services				Budget Remaining:	Electric:	\$19,598.72	ATTACHMENT C
Month	Possible OP Hours	Actual OP Hours	Up-Time Percent	Percent Capacity*	Telephone:	\$347.47	
					Gas	\$653.86	
					Total:	\$20,600.05	
September-03	96	96	100.00%	58%	General Operation Comments		
October-03	168	168	100.00%	6%	Shutdown by Tyree after Separable Part B Inspection		
November-03	720	720	100.00%	5%	Official Startup by O&M Enterprises on 10/22/03		
December-03	744	744	100.00%	28%			
January-04	672	672	100.00%	16%			
February-04	696	696	100.00%	21%			
March-04	816	815	99.88%	51%			
April-04	672	670	99.70%	50%			
May-04	696	513	73.71%	43%			Equipment shutdown- low flow of water to air stripper - 5/17-24/04
June-04	696	692	99.43%	30%			Individual pumps shutdown for inspection and cleaning
July-04	840	840	100.00%	47%			100% operational
August-04	672	672	100.00%	42%			100% operational
September-04	840	820	97.62%	31%			Temporary Stripper Shutdown
October-04	672	607	90.33%	33%			65 hour weekend shutdown due to low pressure problems with the airstripper
November-04	696	641.5	92.17%	37%			
December-04	816	792	97.06%	42%			GAC units removed from treatment system operations
January-05	840	840	100.00%	46%			GAC units removed from project site 1/14/05
February-05	672	660	98.21%	41%			Unit cleaned February 4, 2005
March-05	840	828	98.57%	33%			Unit shut down for additional cleaning and sequestering agent review.
April-05	696	609	87.50%	58%			Unit cleaned April 8, 2005. Back in service until new sequestering agent approved and installed.
May-05	840	768	91.43%	36%			Unit re-cleaned and new water treatment chemical started operations on 5/19/05
June-05	744	644	86.56%	30%			Extremely dry month of June.
July-05	624	605.5	97.04%	44%			Extremely dry month of July.
August-05	696	696	100.00%	44%			Extremely dry month of August.
September-05	864	864	100.00%	40%			Extremely dry month of September.
October-05	672	672	100.00%	39%			Extremely dry month of October.
November-05	672	659	98.07%	34%			Power outage occurred November 6, 2005
December-05	864	854	98.84%	29.6%			Air Stripper cleaning occurred on 12/27/05
January-06	816	816	100.00%	36.7%			
February-06	696	696	100.00%	54.8%			
March-06	696	696	100.00%	56.4%			
April-06	696	689	98.99%	34.3%			Dry month, 5 hours for cleaning the stripper
May-06	696	689	98.99%	32.3%			Dry month, 5 hours for cleaning the stripper
June-06	816	812	99.51%	28.6%			
July-06	624	621	99.52%	27.8%			
August-06	696	696	100.00%	26.4%			
September-06	840	834	99.29%	28.2%			Stripper cleaning performed
October-06	628	609	96.91%	27.0%			power outage from severe winter storm 10/12-10/14
November-06	672	672	100.00%	28.7%			
December-06	720	706	98.06%	28.6%			
January-07	984	983	99.90%	26.7%			Cold month.
February-07	480	480	100.00%	40.7%			Extra Cold month.
March-07	672	672	100.00%	28.1%			
April-07	888	888	100.00%	27.1%			
May-07	696	696	100.00%	26.2%			Dry month
June-07	648	644	99.38%	25.1%			
July-07	696	696	100.00%	24.1%			
August-07	792	792	100.00%	21.1%			
September-07	816	816	100.00%	21.0%			Dry month
Totals to Date	34804	34061	97.86%				Based on OM services provided by EEEPC/OMEI since 9/03.

* Percent Capacity is based on initial operating groundwater flows from the eight installed pumps from 9/02. Evaluated on total gallons discharged for monthly operating time.
 Maximum pump discharges calculated as an average of 78 gpm as the total for all 8 pumps at the site if all pumps operate 100%. With the exception of groundwater pump RW-1, all others run on a batch basis.
 The system is a batch process and is dependent on the level of groundwater to the level controls of each groundwater pump.

Mr. C's Dry Cleaners Site - Remedial Treatment Utility Costs										
NYSDEC Work Assignment #DC13										
12 Months of System Operation and Maintenance										
September 2007 Report										
Mr. C's Electric	\$	1,799.33								
Agway Electric	\$	505.45								
Mr. C's Gas	\$	66.14								
Mr. C's Telephone	\$	64.18								
Ave. Utility Cost Total	\$	2,435.09	times	12 month Estimate	\$31,656.21					
ATTACHMENT C										